

OWWO

COUNTY LEA FIELD Jalmat STATE NM MN 09263
 OPR CONTINENTAL OIL CO. MAP
 2 Farney "A-5"
 Sec 5, T-23-S, R-36-E CO-ORD
 1980' FSL, 660' FEL of Sec

Re-Cmp 12-14-70	CLASS		EL	
	FORMATION	DATUM	FORMATION	DATUM
LOGS & SX TUBING				
10 3/4" at 194' w/225 sx				
7 5/8" at 3176' w/900 sx				
5 1/2" at 3670' w/200 sx				
LOGS EL GR RA IND HC A				
	TD 3796'; PBD 3632'			

(Seven Rivers) Perfs 3585-3611' NO NEW POTENTIAL.

Distribution limited and publication prohibited by subscribers' agreement.
 Reproduction rights reserved by Williams & Lee Logging Service, Inc.

CON: PROP DEPTH 3611' TYPE WO
 DATE

5-11-71 F.R.C. 5-13-71; Opr's Elev. 3488' LF
 PD 3611' WO (Seven Rivers)
 (Orig. comp 7-22-37 from OH 3670-3785',
 OTD 3796', OPR 3785'; OWWO & Re-Cmp 6-19-50
 thru Perfs 3300-3585', OPB 3617'; OWWO & Re-Cmp
 5-20-57 thru Perfs 3327-3464', OPB 3617')
 TD 3796'; PBD 3632'; COMPLETE
 Sqzd (3327-3464') w/100 sx
 Drilled out to 3632'
 Perf (Seven Rivers) @ 3585', 3587', 3595', 3609',
 3609', 3611' w/1 SPI
 Acid (3585-3611') 3500 gals (LSTNE)

5-13-71 COMPLETION REPORTED

NUMBER OF COPIES RECEIVED	
DISTRIBUTION	
SANTA FE	
FILE	
U.S.G.S.	
LAND OFFICE	
TRANSPORTER	OIL
	GAS
PRODUCTION OFFICE	
OPERATOR	

NEW MEXICO OIL CONSERVATION COMMISSION
WELL LOCATION AND ACREAGE DEDICATION PLAT
 SEE INSTRUCTIONS FOR COMPLETING THIS FORM ON THE REVERSE SIDE

FORM C-128
 Revised 5/1/57

NOBLES OFFICE O. C. C.
 Nov 25 2 55 PM '63

SECTION A

Operator Continental Oil Company		Lease Farney A-5		Well No. 2
Unit Letter I	Section 5	Township 23-S	Range 36-E	County Lea
Actual Footage Location of Well: 1980 feet from the South line and 660 feet from the East line				
Ground Level Elev. 2771	Producing Formation Yates		Pool Jalmat	Dedicated Acreage: 240 Acres

1. Is the Operator the only owner in the dedicated acreage outlined on the plat below? YES NO ("Owner" means the person who has the right to drill into and to produce from any pool and to appropriate the production either for himself or for himself and another. (65-3-29 (e) NMSA 1935 Comp.)
2. If the answer to question one is "no," have the interests of all the owners been consolidated by communitization agreement or otherwise? YES NO . If answer is "yes," Type of Consolidation _____
3. If the answer to question two is "no," list all the owners and their respective interests below:

Owner	Land Description

SECTION B

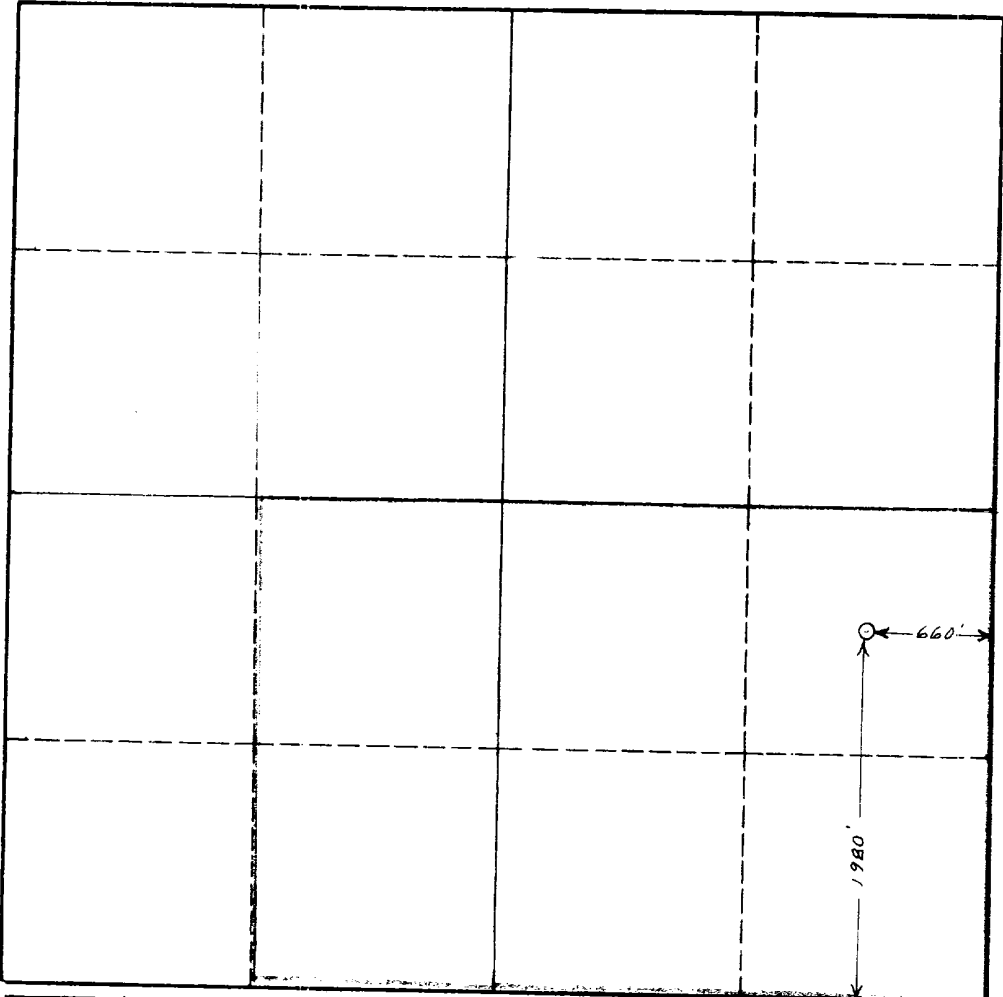

CERTIFICATION

I hereby certify that the information in SECTION A above is true and complete to the best of my knowledge and belief.

Name
Position District Supt.
Company Continental Oil Company
Date November 22, 1963

NMOCC-5 SW HFW ABS
File Pan Am-Hbs-3

I hereby certify that the well location shown on the plat in SECTION B was plotted from field notes of actual surveys made by me or under my supervision, and that the same is true and correct to the best of my knowledge and belief.

Date Surveyed
Registered Professional Engineer and/or Land Surveyor
Certificate No.

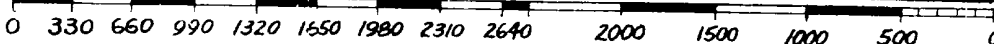

INSTRUCTIONS FOR COMPLETION OF FORM C-128

1. Operator shall furnish and certify to the information called for in Section A.
2. Operator shall outline the dedicated acreage for *both* oil and gas wells on the plat in Section B.
3. A registered professional engineer or land surveyor registered in the State of New Mexico or approved by the Commission shall show on the plat the location of the well and certify this information in the space provided.
4. All distances shown on the plat must be from the outer boundaries of the Section.
5. If additional space is needed for listing owners and their respective interests as required in question 3 of Section A, please use space below.

INSTRUCTIONS

1. Is this gas well a dual completion? Yes No ✓
2. If the answer to Question 1 is Yes, are there any other dually completed wells within the dedicated acreage? Yes No

A separate plat must be filed for each gas well, outlining the area dedicated to such well and showing the location of all other wells (oil and gas) within the outlined area.

Mail in duplicate to the district office for the district in which the well is located.

RECEIVED
DEC 14 1953
OIL CONSERVATION COMMISSION
HOBBBS-OFFICE

NEW MEXICO
OIL CONSERVATION COMMISSION

Gas Well Plat

Date 11/4/53

Continental Oil Co. Farney A-5 2
Operator Lease Well No.

Name of Producing Formation Yates Pool Jalco.

No. Acres Dedicated to the Well 160

SECTION 5 TOWNSHIP 23 RANGE 36

			2 ⊙
		1 ●	

I hereby certify that the information given above is true and complete to the best of my knowledge.

Name [Signature]
Position Asst. Supt.
Representing Continental Oil Co.
Address Box 427 Hobbs, N. M.

(over)

INSTRUCTIONS

1. Is this gas well a dual completion? Yes No ✓

2. If the answer to Question 1 is Yes, are there any
 other dually completed wells within the dedicated
 acreage? Yes No

A separate plat must be filed for each gas well, outlining the area dedicated to such well and showing the location of all other wells (oil and gas) within the outlined area.

Mail in duplicate to the district office for the district in which the well is located.