

CERTIFIED SURVEYS

HOME STAKE OIL &
GAS COMPANY

SARAH JOHNSTON #2

LEA COUNTY, NEW MEXICO

SEC. 22-T22S-R37E

SUR: J - 1600/S & 2288/E

BHL: ~~J~~ - 1363/S & 2516/E

JUNE 10, 1999

sperry-sun
DRILLING SERVICES

A HALLIBURTON COMPANY



sperry-sun

DRILLING SERVICES

A HALLIBURTON COMPANY

9800 West Reno / Oklahoma City, OK 73127 / 405-324-2222 / 405-324-1009 (Fax)

June 10, 1999

Re: Home Stake Oil & Gas Company
Sarah Johnston #2
Sec. 22-T22S-R37E
Lea County, New Mexico

Enclosed please find the original surveys performed on the referenced well by Halliburton/Sperry Sun.

<u>Name & Title of Surveyor</u>	<u>Drainhole Number</u>	<u>Surveyed Depths</u>	<u>Dates Performed</u>	<u>Type of Survey</u>
John Strahan Directional Driller	Sidetrack	5305' - 7375'	05/25/99 - 06/06/99	Directional/MWD

If any other information is required, please contact the undersigned at the letterhead address and phone number.

Dave Egedahl
Operations Engineer

My Commission Expires: 11-30-99

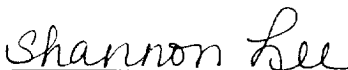
Shannon Lee
Notary Public



HALLIBURTON

POST WELL SUMMARY

From May 25, 1999 To June 6, 1999

Page 1
6/10/99 3:15:04 pm
Version VER2.2.6

Job No.:
Operator: HOMESTAKE OIL & GAS
Field: LEA COUNTY, NEW MEXICO
Well: HOMESTK

AFE No.: SEC. 22-T22S-R37E
Location: LEA COUNTY, NEW MEXICO
MWD Operator(s): MATT, DON/JASON
Dir'l Driller(s): JOHN STRAHAN

Company Man: KEN MOZINGO

FOOTAGE DRILLING AVERAGE DRILLING AVERAGE DRILLING
DRILLED HOURS ROP DAYS FTG/DAY HRS/DAY

2070.00 136.50 15.16 11.58 178.80 11.79

RUN BHA DEPTH ANGLE IN OUT BIT MODEL NOZZLES (/32nd) MOTOR Description_CAP STAB DISTANCE REASON FOR TRIP
No. No. IN IN OUT HRS S

1 1 5305.00 0.48 5804.00 11.10 11.10 499.00 59.50 8.39 2.13 0 1838 ----- 65M-047
1 2 5804.00 11.10 7375.00 12.10 1571.00 77.00 20.40 0.06 0 1825 ----- HT64136

1 1 7-7/8" F47-HPS 12 12 12 6-1/2" SLO-SPEED 5/6 ----- MP - Motor performance
X 1.50° bend
1 2 7-7/8" F47-HPS 12 12 12 6-1/2" SLO-SPEED 5/6 ----- <undefined>
X 1.50° bend

RUN BHA SLIDE ROTATE SLIDE ROTATE ROTATE CIRCULATE
No. No. FTG FTG HRS S

1 1 386.00 113.00 52.75 6.75 16.74 60.00 KICK OFF & BUILD 3 DEG/100 TO 15.3 @ S47W
1 2 238.00 1333.00 14.00 63.00 21.16 101.67 FINISH BUILDING ANGLE & HOLD TO TD

HALLIBURTON DRILLING SYSTEMS

Page 1

Survey Report

Date: 6/10/99
 Time: 3:42 pm
 Wellpath ID: HOMESTK
 Date Created: 5/28/99
 Last Revision: 6/10/99

*Calculated using the Minimum Curvature Method
 Computed using PDS VER2.2.6
 Vertical Section Plane: 224.29 deg.*

Survey Reference: WELLHEAD
 Vertical Section Reference: WELLHEAD
 Closure Reference: WELLHEAD
 TVD Reference: WELLHEAD

HOME STAKE OIL & GAS COMPANY
 LEA COUNTY, NEW MEXICO
 McMORMACK; SILURIAN, SOUTH
 SARAH JOHNSTON #2
 SEC. 22 - T22S - R37E

SURVEY

Measured Depth (ft)	Incl (deg.)	Drift Dir. (deg.)	Course Length (ft)	TVD (ft)	Vertical Section (ft)	TOTAL Rectangular Offsets (ft)		DLS (dg/100ft)	
TIE-IN TO GYRO SURVEY @ 5200' MD									
5200.00	0.95	50.57	0.00	5198.60	-93.57	51.30 N	81.41 E	0.00	
5282.00	0.70	37.20	82.00	5280.59	-94.74	52.13 N	82.24 E	0.38	
BHA #1 @ 5305' 6 1/2" SS 5/6 x 1.5° BEND - F47-HPS									
5313.00	0.40	30.20	31.00	5311.59	-95.03	52.38 N	82.41 E	0.99	
5344.00	0.10	320.50	31.00	5342.59	-95.14	52.49 N	82.44 E	1.22	
5376.00	0.70	240.90	32.00	5374.59	-94.96	52.42 N	82.26 E	2.15	
5407.00	1.30	219.50	31.00	5405.58	-94.43	52.05 N	81.87 E	2.25	
5438.00	2.20	224.50	31.00	5436.57	-93.48	51.36 N	81.23 E	2.94	
5470.00	3.20	225.60	32.00	5468.53	-91.97	50.29 N	80.16 E	3.13	
5501.00	4.20	223.60	31.00	5499.47	-89.97	48.87 N	78.76 E	3.25	
5533.00	5.30	224.90	32.00	5531.36	-87.32	46.97 N	76.90 E	3.45	
5595.00	7.40	224.90	62.00	5592.97	-80.47	42.11 N	72.06 E	3.39	
5658.00	9.00	230.60	63.00	5655.33	-71.51	36.11 N	65.39 E	2.85	
5720.00	9.90	230.40	62.00	5716.49	-61.39	29.64 N	57.54 E	1.45	
5783.00	10.40	232.20	63.00	5778.50	-50.37	22.70 N	48.87 E	0.94	
BHA #2 @ 5804' 6 1/2" SS 5/6 X 1.5° BEND - F47-HPS									
5846.00	12.50	228.80	63.00	5840.25	-37.94	14.72 N	39.25 E	3.50	
5940.00	14.60	224.10	94.00	5931.63	-15.95	0.49 S	23.35 E	2.52	
6032.00	14.80	224.20	92.00	6020.61	7.39	17.24 S	7.09 E	0.22	
6126.00	14.00	225.80	94.00	6111.66	30.77	33.77 S	9.44W	0.95	
6220.00	13.40	224.30	94.00	6202.99	53.02	49.50 S	25.20W	0.74	

HALLIBURTON DRILLING SYSTEMS

Page 2

Date: 6/10/99

Survey Report

Wellpath ID: HOMESTK

Measured Depth (ft)	Incl (deg.)	Drift Dir. (deg.)	Course Length (ft)	TVD (ft)	Vertical Section (ft)	TOTAL Rectangular Offsets (ft)		DLS (dg/100ft)
6314.00	14.60	226.80	94.00	6294.19	75.75	65.40 S	41.44W	1.43
6409.00	14.30	228.00	95.00	6386.19	99.42	81.45 S	58.89W	0.45
6471.00	14.40	227.60	62.00	6446.25	114.76	91.77 S	70.27W	0.23
6566.00	13.90	228.70	95.00	6538.37	137.93	107.27 S	87.57W	0.60
6628.00	13.50	229.60	62.00	6598.61	152.56	116.87 S	98.67W	0.73
6691.00	12.90	230.00	63.00	6659.94	166.88	126.16 S	109.66W	0.96
6754.00	12.80	223.20	63.00	6721.37	180.86	135.77 S	119.82W	2.40
6816.00	14.80	226.00	62.00	6781.58	195.64	146.28 S	130.22W	3.40
6910.00	15.10	227.10	94.00	6872.39	219.87	162.95 S	147.83W	0.44
7004.00	14.80	229.20	94.00	6963.21	244.06	179.13 S	165.89W	0.66
7098.00	13.80	228.50	94.00	7054.30	267.21	194.41 S	183.37W	1.08
7161.00	13.40	227.00	63.00	7115.53	281.99	204.36 S	194.34W	0.85
7325.00	12.10	225.50	164.00	7275.49	318.16	229.37 S	220.50W	0.82
PROJECTION TO TD @ 7375' MD								
7375.00	12.10	225.50	50.00	7324.38	328.64	236.72 S	227.97W	0.00

HOME STATE OIL & GAS CO
 DELAWARE COUNTY, NEW MEXICO
 NEWBROOK SURVEY SOUTH
 SARAH JOHNSTON #2
 SEC 22, T28S - R3E
 (REVISED 5-25-00) ORIGINAL

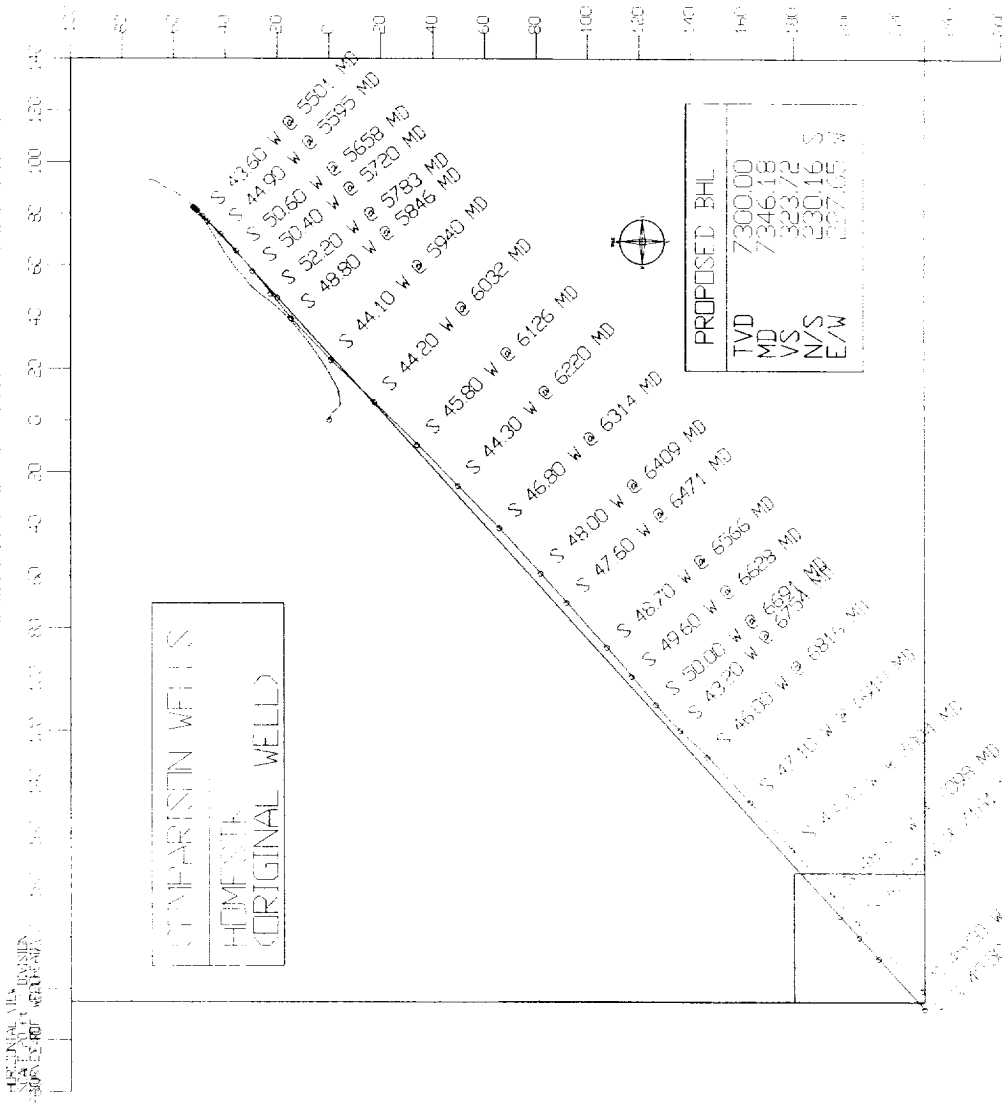

PROPOSED BHL	
TVD	7300.00
MD	7346.18
VS	323.72
N/S	230.16 S
E/W	127.65 W

COMPARISON WELLS
 HOME STATE
 (ORIGINAL WELL)

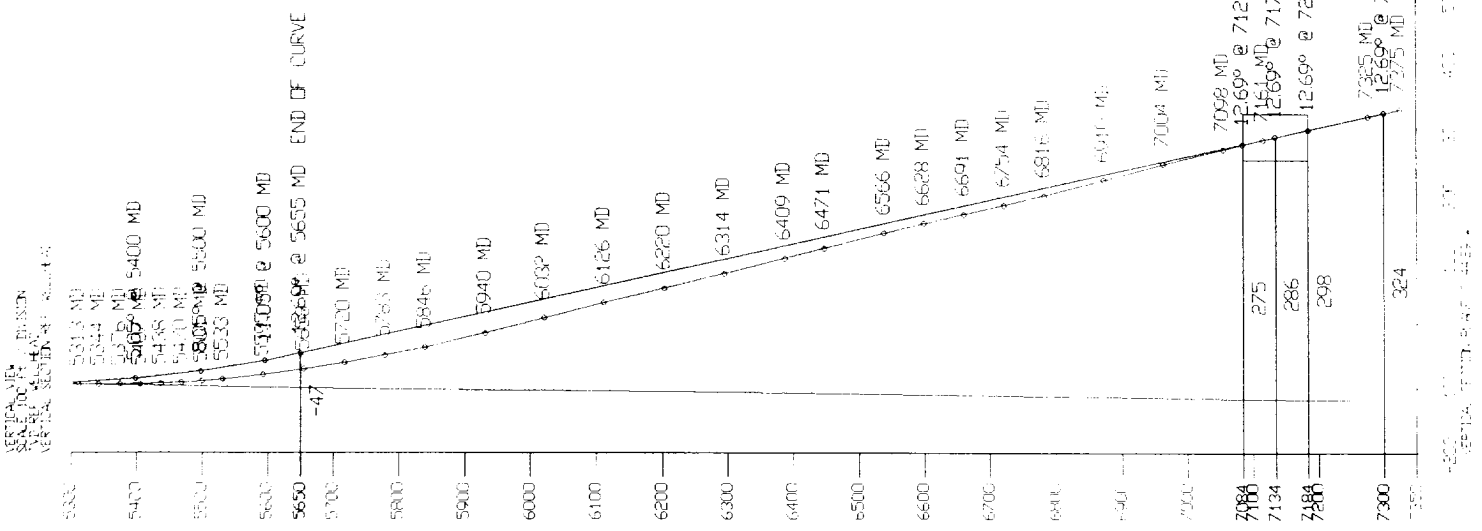

TARGET TOP (50' SQUARE, 205' S & 300' W @ 7084' TVD)
 TARGET BOX
 TARGET BOTTOM ... HOLE BELOW NEED NOTICE IN TARGET

275
 286
 298
 324

WELL ID	DEPTH (MD)
7305 MD	7305
7320 MD	7320
7346 MD	7346
7375 MD	7375

ORIGINAL VERT. SECTION
 SOURCE: 100' WELLHEAD

VERTICAL SECTION

6/11/99 10:28 am

