

District I
1625 N. French Dr., Hobbs, NM 88240

District II
811 South First, Artesia, NM 88210

District III
1000 Rio Brazos Rd., Aztec, NM 87410

District IV
2040 South Pacheco, Santa Fe, NM 87505

State of New Mexico
Energy, Minerals & Natural Resources Department

Form C-101
Revised March 17, 1999

OIL CONSERVATION DIVISION
2040 South Pacheco
Santa Fe, NM 87505

Submit to appropriate District Office
State Lease - 6 Copies
Fee Lease - 5 Copies

AMENDED REPORT

APPLICATION FOR PERMIT TO DRILL, RE-ENTER, DEEPEN, PLUGBACK, OR ADD A ZONE

| | | | | |
|--|--|-------------------------------|--|------------------------------|
| 1 Operator Name and Address Apache Corporation 2000 Post Oak Blvd. Ste. 100 Houston, Texas 77056-4400 | | Attn: Dennis Bickford | | 2 OGRID Number 000873 |
| 4 Property Code 26470 19152 | | 5 Property Name H Corrigan | | 3 API Number 30-025-35136 |
| | | | | 6 Well No. 12 |

7 Surface Location

| UL or lot no. | Section | Township | Range | Lot Idn | Feet from the | North/South Line | Feet from the | East/West Line | County |
|---------------|---------|----------|-------|---------|---------------|------------------|---------------|----------------|--------|
| A 1 | 4 | 22S | 37E | | 728 | North | 410 | East | Lea |

8 Proposed Bottom Hole Location If Different From Surface

| UL or lot no. | Section | Township | Range | Lot Idn | Feet from the | North/South Line | Feet from the | East/West Line | County |
|---|---------|----------|-------|---------|--|------------------|---------------|----------------|--------|
| 9 Proposed Pool 1 Eunice; San Andres | | | | | 10 Proposed Pool 2 Penrose Skelly; Grayburg | | | | |

| | | | | |
|------------------------|---------------------------|----------------------------|-------------------------|-----------------------------------|
| 11 Work Type Code N | 12 Well Type Code O | 13 Cable/Rotary R | 14 Lease Type Code P | 15 Ground Level Elevation 3446 |
| 16 Multiple | 17 Proposed Depth 4500 | 18 Formation San Andres | 19 Contractor | 20 Spud Date ASAP |

21 Proposed Casing and Cement Program

| Hole Size | Casing Size | Casing weight/foot | Setting Depth | Sacks of Cement | Estimated TOC |
|-----------|-------------|--------------------|---------------|-----------------|----------------------|
| 12-1/4 | 8-5/8 | 24# | 1100' | 450 | Circulate to Surface |
| 7-7/8 | 5-1/2 | 17# | 4500' | 700 | Circulate to Surface |
| | | | | | |

22 Describe the proposed program. If this application is to DEEPEN or PLUG BACK give the data on the present productive zone and proposed new productive zone. Describe the blowout prevention program, if any. Use additional sheets if necessary.

Propose to drill 12-1/4" hole to 1100' or 50' into Anhydrite Formation, run and set 1100' of 8-5/8" casing and cement.
Lead: Class "C" + 2% Calcium Chloride + 0.25 lb/sx cello flake + 0.005% gps FP-6L + 6% bentonite
Tail: Class "C" + 2% Calcium Chloride + 0.005 gps FP-6L
 Drill 7-7/8" hole to 4500', run and set 5-1/2" casing and cement
Lead: 35/65 POZ "C" + 5% Sodium Chloride + 0.25 lb/sx cello flake + 0.005 gps FP-6L + 8% bentonite
Tail: 50/50 POZ "H" + 5% Sodium Chloride + 0.25 lb/sx cello flake + 1% FL-25 + 0.005 gps FL-6L + bentonite

Blow Out Prevention: See attached copy

| | | | |
|---|---------------------|--|------------------|
| 23 I hereby certify that the information given above is true and complete to the best of my knowledge and belief. | | OIL CONSERVATION DIVISION | |
| Signature: <i>Everett Ouzts</i> | | Approved by: <i>[Signature]</i> | |
| Printed Name: Everett Ouzts | | Title: <i>SUPV. OF OIL & GAS</i> | |
| Title: Engineering Technician | | Approval Date: | Expiration Date: |
| Date: 8/11/00 | Phone: 915-631-3733 | Conditions of Approval: Attached <input type="checkbox"/> | |

Permit Expires 1 Year From Approval
Date Unless Drilling Underway *MP*

DISTRICT I
P.O. Box 1980, Hobbs, NM 88241-1980

State of New Mexico
Energy, Minerals and Natural Resources Department

Form C-102
Revised February 10, 1994
Submit to Appropriate District Office
State Lease - 4 Copies
Fee Lease - 3 Copies

DISTRICT II
P.O. Drawer DD, Artesia, NM 88211-0719

DISTRICT III
1000 Rio Brazos Rd., Aztec, NM 87410

OIL CONSERVATION DIVISION
P.O. Box 2088
Santa Fe, New Mexico 87504-2088

DISTRICT IV
P.O. BOX 2088, SANTA FE, N.M. 87504-2088

AMENDED REPORT

WELL LOCATION AND ACREAGE DEDICATION PLAT

| | | |
|--|-------------------------------------|---------------------------------|
| API Number 30-025- 35136 | Pool Code 24150 | Pool Name Eunice; San Andres |
| Property Code 49152 26470 | Property Name H. CORRIGAN | Well Number 12 |
| OGRID No. 000873 | Operator Name APACHE CORPORATION | Elevation 3446 |

Surface Location

| UL or lot No. | Section | Township | Range | Lot Idn | Feet from the | North/South line | Feet from the | East/West line | County |
|---------------|---------|----------|-------|---------|---------------|------------------|---------------|----------------|--------|
| 1 | 4 | 22 S | 37 E | | 728 | NORTH | 410 | EAST | LEA |

Bottom Hole Location If Different From Surface

| UL or lot No. | Section | Township | Range | Lot Idn | Feet from the | North/South line | Feet from the | East/West line | County |
|---------------|---------|----------|-------|---------|---------------|------------------|---------------|----------------|--------|
| | | | | | | | | | |

| | | | |
|-----------------------|-----------------|--------------------|-----------|
| Dedicated Acres 40 | Joint or Infill | Consolidation Code | Order No. |
|-----------------------|-----------------|--------------------|-----------|

NO ALLOWABLE WILL BE ASSIGNED TO THIS COMPLETION UNTIL ALL INTERESTS HAVE BEEN CONSOLIDATED OR A NON-STANDARD UNIT HAS BEEN APPROVED BY THE DIVISION

| | | | | | |
|----------------------|----------------------|----------------------|----------------------|---|---|
| LOT 4 39.91 ACRES | LOT 3 39.86 ACRES | LOT 2 39.80 ACRES | LOT 1 39.75 ACRES | <p>NAD 27 NMEZ GEODETIC COORD'S Y=520676 X=861944</p> | <p>OPERATOR CERTIFICATION</p> <p>I hereby certify the the information contained herein is true and complete to the best of my knowledge and belief.</p> <p><i>Everett Ouzts</i> Signature</p> <p>Everett Ouzts Printed Name</p> <p>Engineering Technician Title</p> <p>08/11/00 Date</p> |
| | | | | | |

LOCATION VERIFICATION MAP

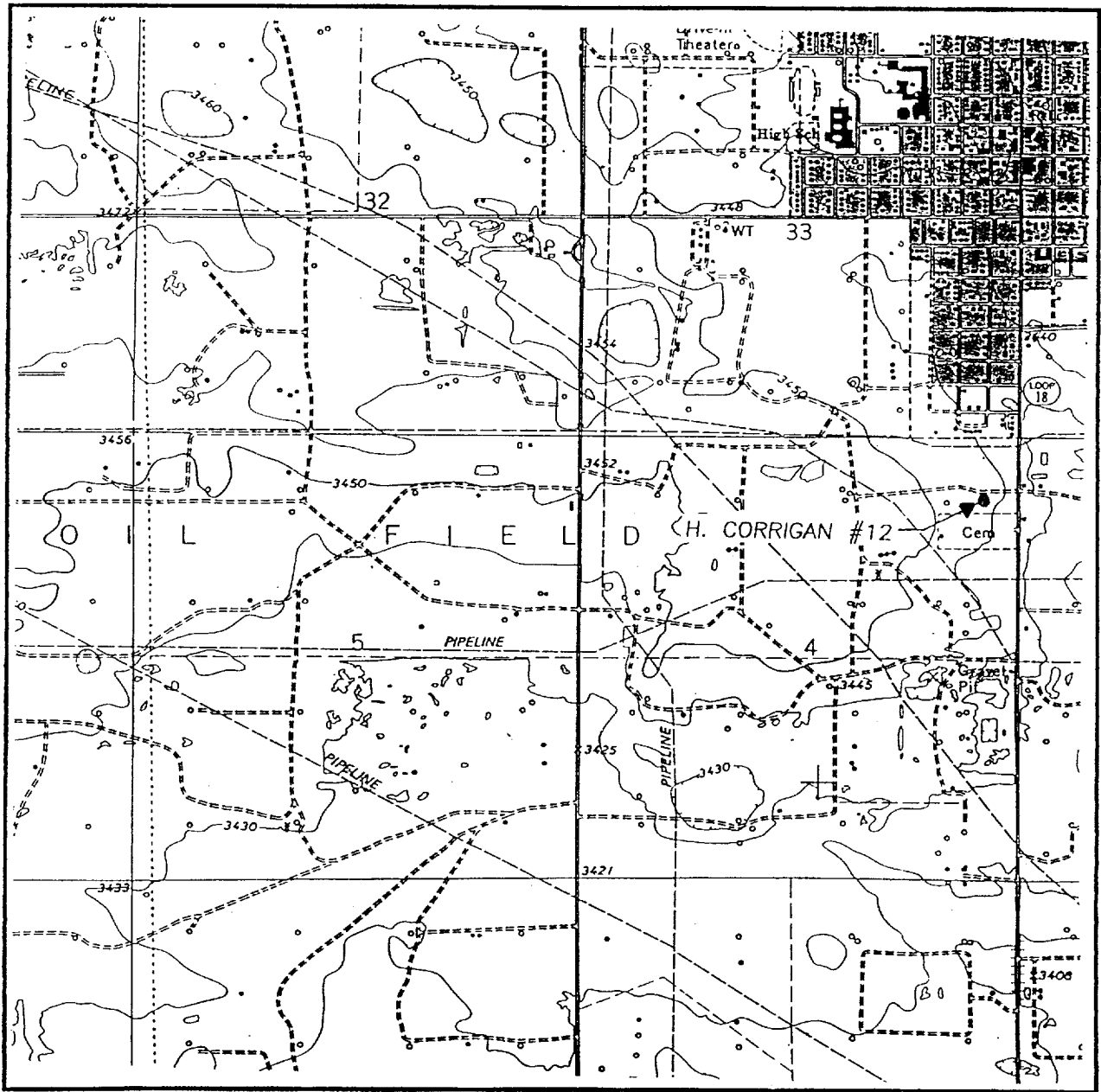

SCALE: 1" = 2000'

CONTOUR INTERVAL:
EUNICE - 10'

SEC. 4 TWP. 22-S RGE. 37-E

SURVEY N.M.P.M.

COUNTY LEA

DESCRIPTION 728' FNL & 410' FEL

ELEVATION 3446

OPERATOR APACHE CORPORATION

LEASE H. CORRIGAN

U.S.G.S. TOPOGRAPHIC MAP

EUNICE, N.M.

JOHN WEST SURVEYING
HOBBS, NEW MEXICO
(505) 393-3117

VICINITY MAP

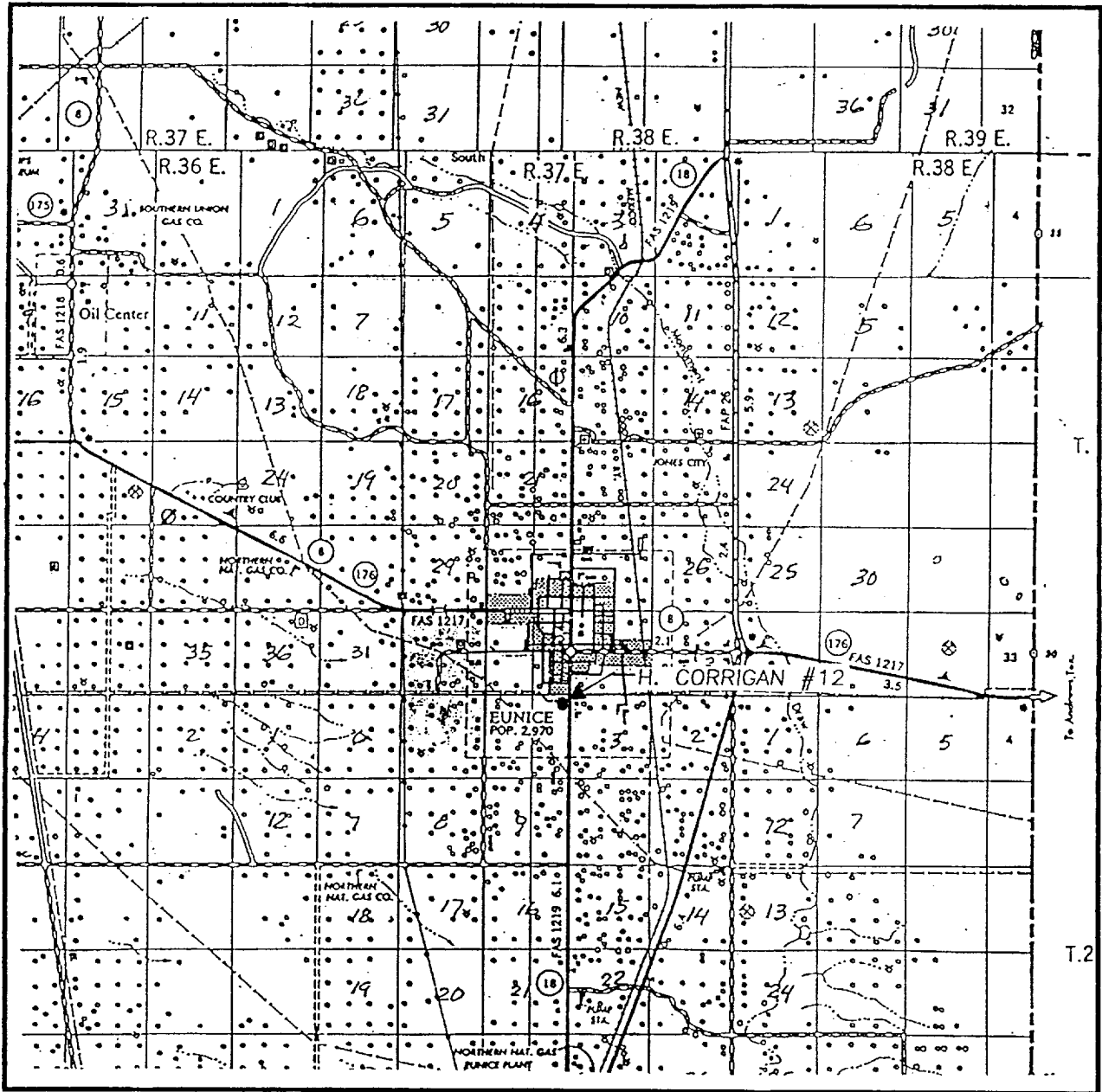

SCALE: 1" = 2 MILES

SEC. 4 TWP. 22-S RGE. 37-E

SURVEY N.M.P.M.

COUNTY LEA

DESCRIPTION 728' FNL & 410' FEL

ELEVATION 3446

OPERATOR APACHE CORPORATION

LEASE H. CORRIGAN

JOHN WEST SURVEYING
HOBBS, NEW MEXICO
(505) 393-3117

Alacne Corporation

WESTERN REGION

H CORRIGAN

LEA COUNTY, NEW MEXICO

| | | |
|------------------|----------------|---------|
| WFLN | DATE IN CHARGE | DATE |
| WFLN REQUIRMENTS | CHARGE | 4/25/78 |
| | | |

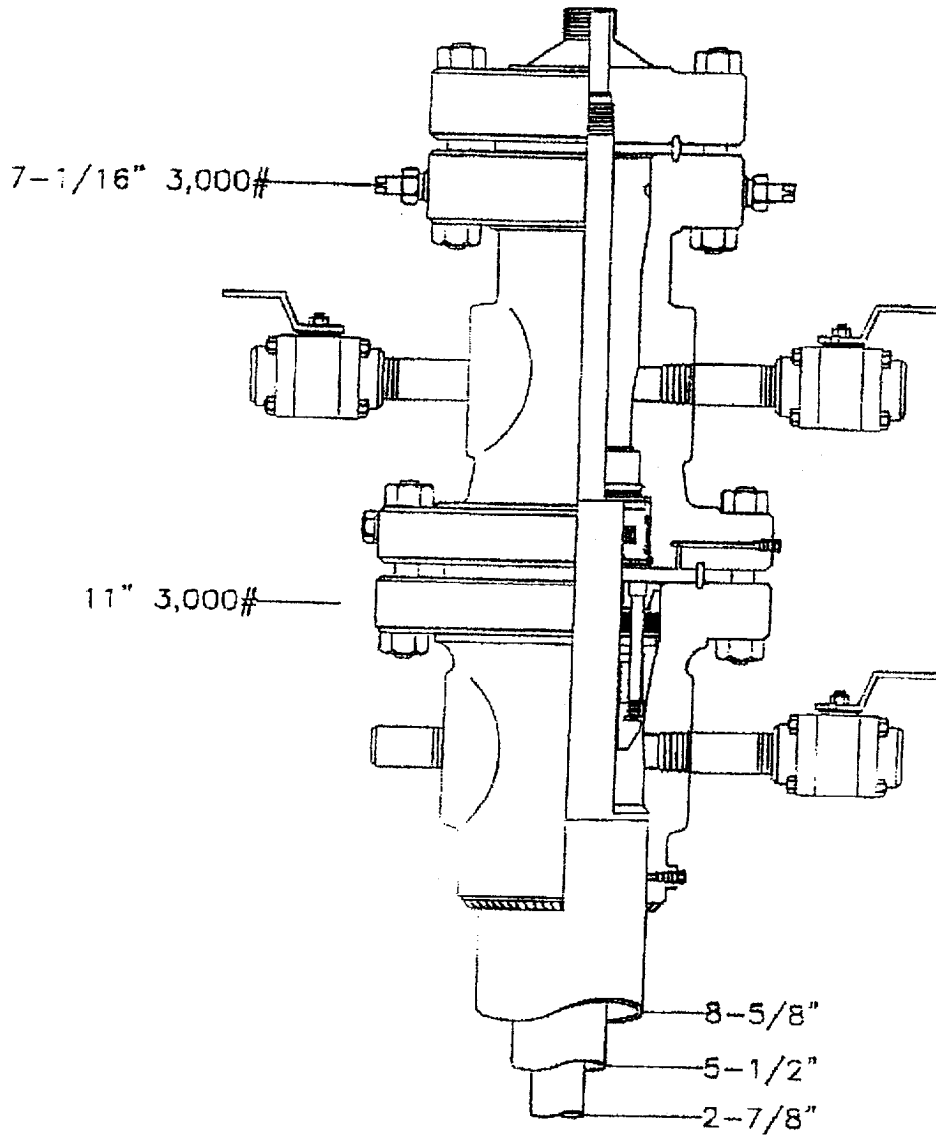

ELF
ABOVE DATE DOES NOT
INDICATE WHEN
CONFIDENTIAL LOGS
WILL BE RELEASED