

Submit to Appropriate  
District Office  
State Lease - 4 copies  
Fee Lease - 3 copies

State of New Mexico  
Energy, Minerals and Natural Resources Department

Form C-102  
Revised 1-1-89

**OIL CONSERVATION DIVISION**

P.O. Box 2088  
Santa Fe, New Mexico 87504-2088

**DISTRICT I**  
P.O. Box 1980, Hobbs, NM 88240

**DISTRICT II**  
P.O. Drawer DD, Artesia, NM 88210

**DISTRICT III**  
1000 Rio Brazos Rd., Aztec, NM 87410

**WELL LOCATION AND ACREAGE DEDICATION PLAT**

All Distances must be from the outer boundaries of the section

Operator Samedan Oil Corporation			Lease Hughes B-4			Well No. 3		
Unit Letter D	Section 17	Township 23 South	Range 37 East	County NMPM Lea				
Actual Footage Location of Well: 660 feet from the North line and 330 feet from the West line								
Ground level Elev. 3323.8	Producing Formation Yates		Pool Jalpat T-Y-SR			Dedicated Acreage: 80 Acres		

- Outline the acreage dedicated to the subject well by colored pencil or hatchure marks on the plat below.
- If more than one lease is dedicated to the well, outline each and identify the ownership thereof (both as to working interest and royalty).
- If more than one lease of different ownership is dedicated to the well, have the interest of all owners been consolidated by communitization, unitization, force-pooling, etc.?
 

Yes     No    If answer is "yes" type of consolidation \_\_\_\_\_

If answer is "no" list the owners and tract descriptions which have actually been consolidated. (Use reverse side of this form if necessary.) \_\_\_\_\_

No allowable will be assigned to the well until all interests have been consolidated (by communitization, unitization, forced-pooling, or otherwise) or until a non-standard unit, eliminating such interest, has been approved by the Division.

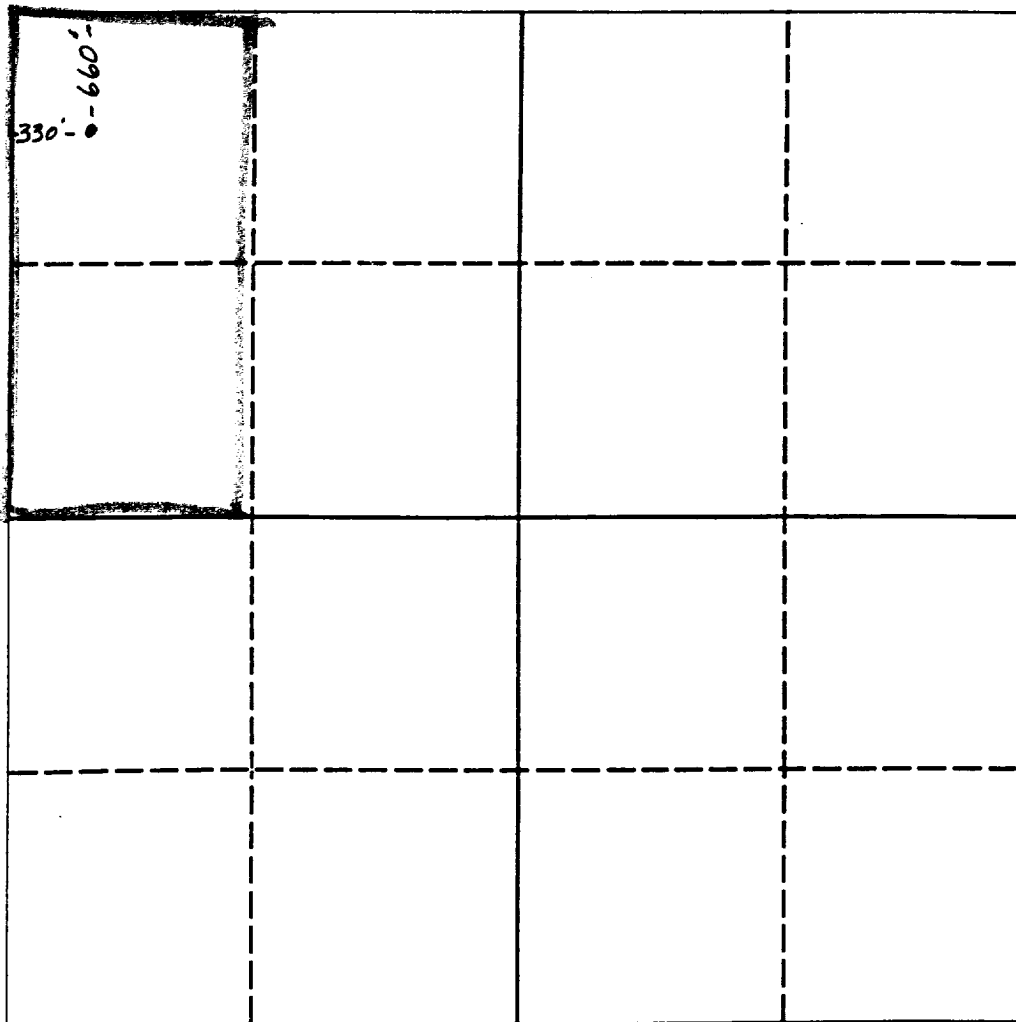

**OPERATOR CERTIFICATION**

I hereby certify that the information contained herein is true and complete to the best of my knowledge and belief.

*Judy Throneberry*  
Signature  
Judy Throneberry  
Printed Name  
Division Production Clerk  
Position  
Samedan Oil Corporation  
Company  
10/23/92  
Date

**SURVEYOR CERTIFICATION**

I hereby certify that the well location shown on this plat was plotted from field notes of actual surveys made by me or under my supervision, and that the same is true and correct to the best of my knowledge and belief.

11-3-65  
Date Surveyed  
John W. West  
Signature & Seal of Professional Surveyor

676  
Certificate No.

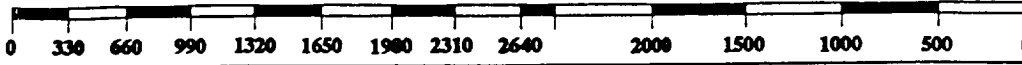

20-025-21411

COUNTY LEA FIELD Langlie-Mattix STATE NM  
 OPR SAMEDAN OIL CORPORATION MAP  
11 Hughes B-4  
Sec. 17, T-23-S, R-37-E CO-ORD  
660' FNL & 330' FWL of Sec.  
 Spd 11-29-65 CLASS EL. XXXXXXXXXX  
 Cmp 12-18-65 FORMATION DATUM FORMATION DATUM

CSG & SX - TUBING						
8 5/8"	387'	230				
4 1/2"	3686'	400				
LOGS EL GR RA IND HC A						
			TD 3686'			

IP Queen Perfs 3556-3671' Flwd 185 BOPD + 5 BW. Pot. Based on 24 hr test thru 14/64" chk., TP 380#, CP 800#, Gas Volume 222 MCFGPD.

Distribution limited and publication prohibited by subscribers' agreement.  
 Reproduction rights reserved by Williams & Lee Scouting Service, Inc.

CONT. Leatherwood Drlg. Co. PROP DEPTH 3650' TYPE  
 DATE

- F.R. 11-18-65  
 PD 3650' - Queen  
 Contractor - Leatherwood Drlg. Co.
- 12-6-65 Drlg. 3502'.  
 8 5/8" casing @ 387' W/230 sx.
- 12-13-65 TD 3686', prep to rec load.  
 4 1/2" casing @ 3686' W/400 sx.  
 Perf @ 3556', 3564', 3569', 3575', 3580',  
 3586', 3594', 3598', 3606', 3610', 3636',  
 3646', 3667', 3671'  
 Frac (3556-3671') 40,000 gals oil + 50,000#  
 sd.
- 12-20-65 TD 3686', COMPLETED.  
 LOG TOPS: Yates 2704', Seven Rivers 2997',  
 Queen 3372', Penrose 3544'.