

**N MEXICO OIL CONSERVATION COMMISS**  
**WELL LOCATION AND ACREAGE DEDICATION PLAT**

Form C-102  
 Supersedes C-128  
 Effective 1-1-65

All distances must be from the outer boundaries of the Section

Operator <b>GETTY OIL COMPANY</b>			Lease <b>Federal 33</b>		Well No. <b>1</b>
Unit Letter <b>G</b>	Section <b>33</b>	Township <b>26 South</b>	Range <b>33 East</b>	County <b>Lea</b>	
Actual Footage Location of Well:					
1650 feet from the North line and		1980 feet from the East line			
Ground Level Elev. <b>3227.6</b>	Producing Formation <b>Atoka-Morrow</b>	Pool <b>Undesignated Morrow</b>	Dedicated Acreage: <b>308.12</b> Acres		

1. Outline the acreage dedicated to the subject well by colored pencil or hachure marks on the plat below.
2. If more than one lease is dedicated to the well, outline each and identify the ownership thereof (both as to working interest and royalty).
3. If more than one lease of different ownership is dedicated to the well, have the interests of all owners been consolidated by communitization, unitization, force-pooling, etc?

☐ Yes ☒ No If answer is "yes," type of consolidation \_\_\_\_\_

If answer is "no," list the owners and tract descriptions which have actually been consolidated. (Use reverse side of this form if necessary.) \_\_\_\_\_

No allowable will be assigned to the well until all interests have been consolidated (by communitization, unitization, forced-pooling, or otherwise) or until a non-standard unit, eliminating such interests, has been approved by the Commission.

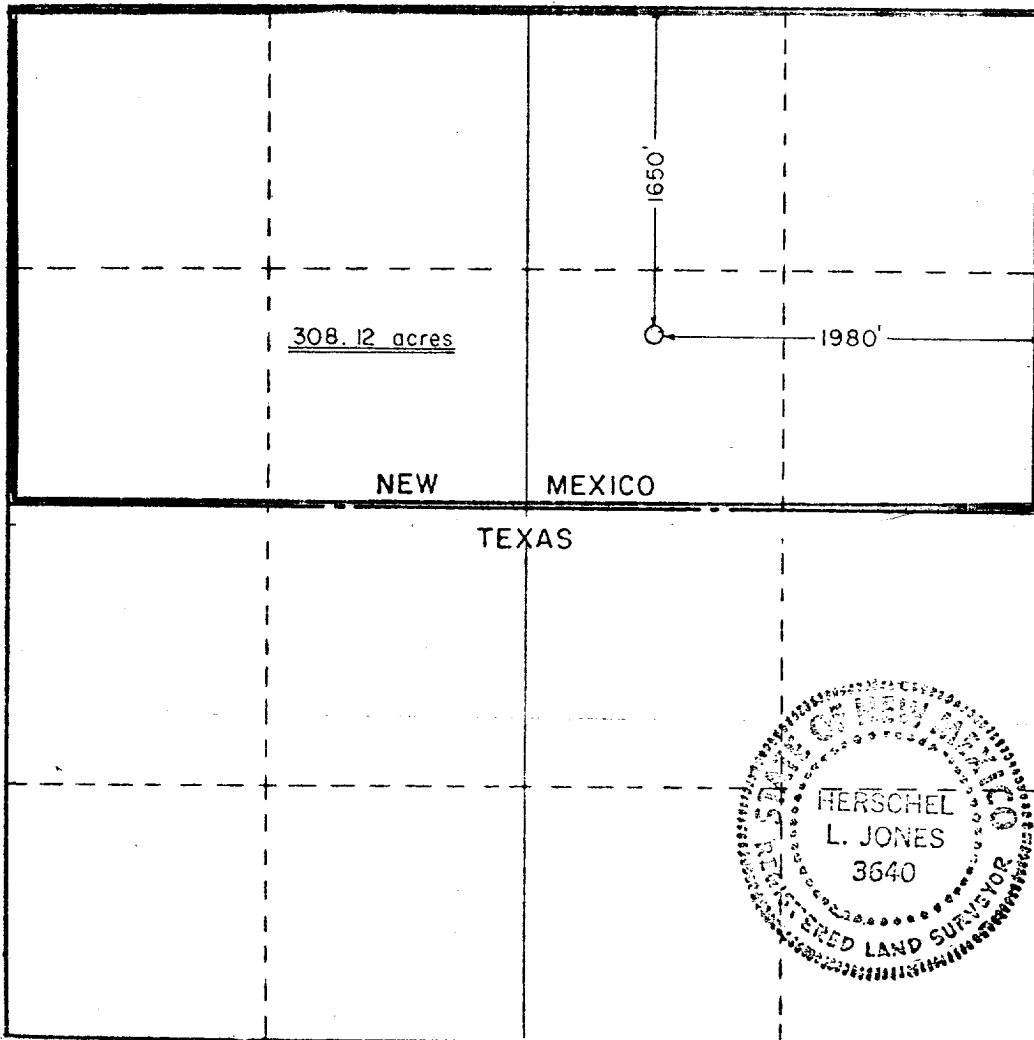

**CERTIFICATION**

*I hereby certify that the information contained herein is true and complete to the best of my knowledge and belief.*

*Dale R. Crockett*  
 Name

Dale R. Crockett

Position  
 Area Supervisor

Company  
 Getty Oil Company

Date  
 October 30, 1980

*I hereby certify that the well location shown on this plat was plotted from field notes of actual surveys made by me or under my supervision, and that the same is true and correct to the best of my knowledge and belief.*

Date Surveyed  
 October 28, 1980

Registered Professional Engineer  
 and/or Land Surveyor

*Herschel L. Jones*  
 Certificate No. 3640

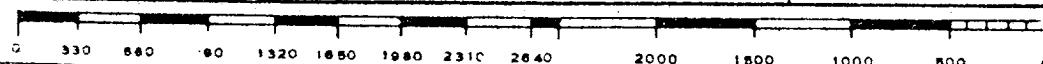

RECEIVED

NOV 18 1980

OIL CONSERVATION DIV.

2/16/81  
Comptroller General  
18/1/81  
5/1/81  
Conservation Division  
9/18/82  
Conservation Division  
9/18/82  
Conservation Division