

(SUBMIT IN TRIPLICATE)

UNITED STATES  
DEPARTMENT OF THE INTERIOR  
GEOLOGICAL SURVEY

Land Office New Mexico  
Lease No. 0766  
Office Corral "A"  
Unit

1959 FEB 15 PM 3:35

SUNDRY NOTICES AND REPORTS ON WELLS

NOTICE OF INTENTION TO DRILL	<input checked="" type="checkbox"/>	SUBSEQUENT REPORT OF WATER SHUT-OFF	
NOTICE OF INTENTION TO CHANGE PLANS		SUBSEQUENT REPORT OF SHOOTING OR ACIDIZING	
NOTICE OF INTENTION TO TEST WATER SHUT-OFF		SUBSEQUENT REPORT OF ALTERING CASING	
NOTICE OF INTENTION TO RE-DRILL OR REPAIR WELL		SUBSEQUENT REPORT OF RE-DRILLING OR REPAIR	
NOTICE OF INTENTION TO SHOOT OR ACIDIZE		SUBSEQUENT REPORT OF ABANDONMENT	
NOTICE OF INTENTION TO PULL OR ALTER CASING		SUPPLEMENTARY WELL HISTORY	
NOTICE OF INTENTION TO ABANDON WELL			

(INDICATE ABOVE BY CHECK MARK NATURE OF REPORT, NOTICE, OR OTHER DATA)

February 12, 1959

Well No. 1 is located 2310 ft. from S line and 2310 ft. from E line of sec. 25

N 1/4 Sec. 25 (1/4 Sec. and Sec. No.)      25E (Twp.)      37E (Range)      N.M.P.M. (Meridian)  
Justice Range (Field)      Don (County or Subdivision)      New Mexico (State or Territory)

The elevation of the derrick floor above sea level is 3070 ft.

DETAILS OF WORK

(State names of and expected depths to objective sands; show sizes, weights, and lengths of proposed casings; indicate mudding jobs, cementing points, and all other important proposed work)

We propose to drill this well to a TD of 7200'. 13-3/8" casing will be set at approximately 950' and cement circulated to surface. 9-5/8" casing will be set at approximately 3400' with DV Tool at approximately 1000'. Sufficient cement will be pumped around bottom of casing to bring cement to DV Tool and sufficient cement will be pumped through DV Tool to bring top of cement to bottom of 13-3/8" casing. This well is to be finally completed in the Brinkard and Fusselman Zones by running 7" casing to TD with DV Tool set at approximately 4000' and sufficient cement pumped around bottom of casing to bring cement to DV Tool and sufficient cement through DV Tool to bring cement to bottom of 9-5/8" casing. Two parallel strings of tubing will be run in order for each zone to produce through a separate string of tubing.

I understand that this plan of work must receive approval in writing by the Geological Survey before operations may be commenced.

Company Anderson-Prichard Oil Corporation  
Address Box 196  
Midland, Texas  
By [Signature]  
Title District Superintendent



NEW MEXICO OIL CONSERVATION COMMISSION  
**WELL LOCATION AND ACREAGE DEDICATION PLATS**

FORM C-128  
 Revised 5/1/57

SEE INSTRUCTIONS FOR COMPLETING THIS FORM ON THE REVERSE SIDE

SECTION A

1959 FEB 15 PM 3:35  
 No. 35

Operator **ANDERSON PRICHARD OIL CORP.** Lease **GARLSON "A"**

Unit Letter **J** Section **25** Township **25 SOUTH** Range **37 EAST** County **LEA**

Actual Footage Location of Well:  
**2310** feet from the **SOUTH** line and **2310** feet from the **EAST** line

Ground Level Elev. **3070' DF** Producing Formation **Drinkard & Fusselman** Pool **Justice Deep** Dedicated Acreage: **40** Acres

1. Is the Operator the only owner in the dedicated acreage outlined on the plat below? YES  NO  ("Owner" means the person who has the right to drill into and to produce from any pool and to appropriate the production either for himself or for himself and another. (65-3-29 (e) NMSA 1935 Comp.)
2. If the answer to question one is "no," have the interests of all the owners been consolidated by communitization agreement or otherwise? YES  NO  If answer is "yes," Type of Consolidation \_\_\_\_\_
3. If the answer to question two is "no," list all the owners and their respective interests below.

RECEIVED  
 FEB 16 1959  
 U. S. GEOLOGICAL SURVEY  
 HOBBS, NEW MEXICO

Owner \_\_\_\_\_ Land Description \_\_\_\_\_

SECTION B

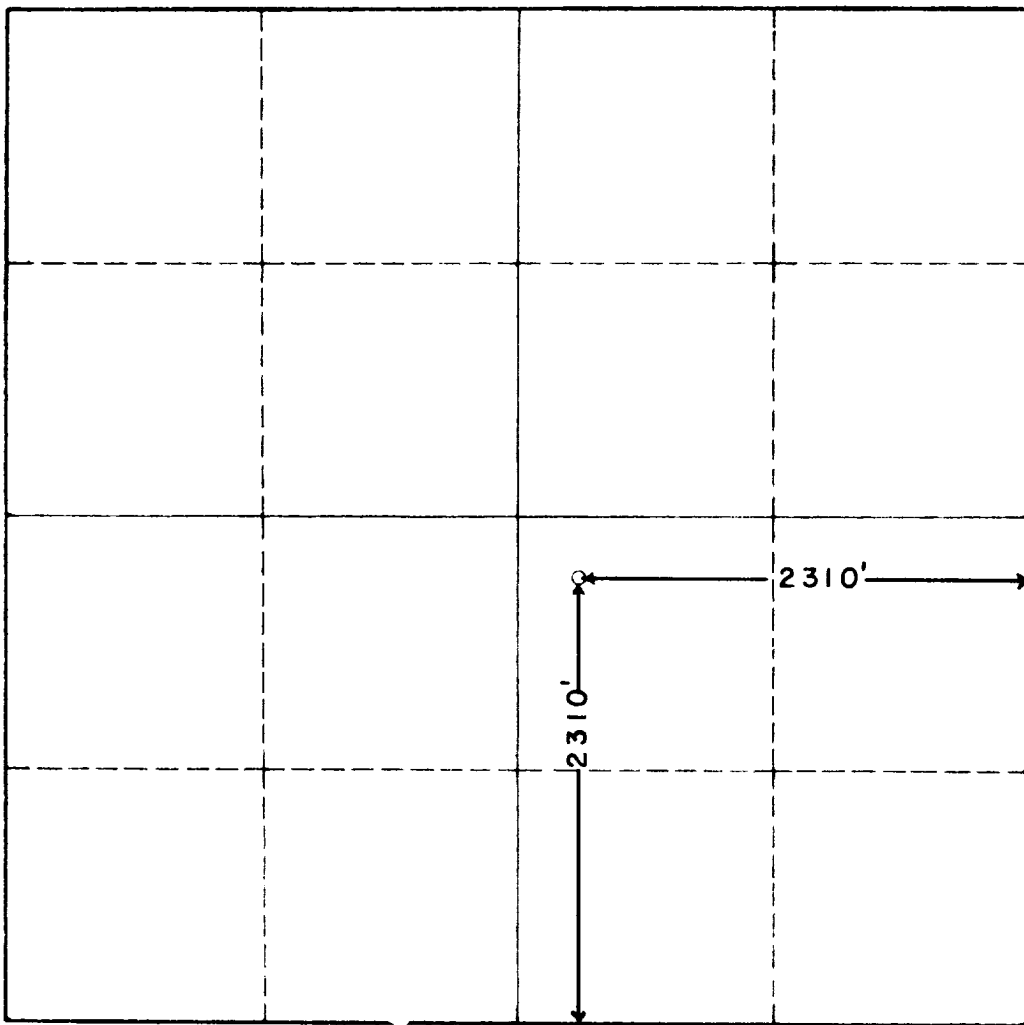

CERTIFICATION

I hereby certify that the information in SECTION A above is true and complete to the best of my knowledge and belief.

Name \_\_\_\_\_  
**District Superintendent**  
 Position  
**Anderson-Prichard Oil Corp.**  
 Company  
**February 12, 1959**  
 Date

I hereby certify that the well location shown on the plat in SECTION B was plotted from field notes of actual surveys made by me or under my supervision, and that the same is true and correct to the best of my knowledge and belief.

Date Surveyed **2-11-59**  
 Registered Professional Engineer and/or Land Surveyor, **JOHN W. WEST**  
*John W. West*  
 Certificate No. \_\_\_\_\_  
 N. M. - P. E. & L. S. NO. 676

0 330 660 990 1320 1650 1980 2310 2640 2000 1500 1000 500 0