

|                        |  |
|------------------------|--|
| NO. OF COPIES RECEIVED |  |
| DISTRIBUTION           |  |
| SANTA FE               |  |
| FILE                   |  |
| U.S.G.S.               |  |
| LAND OFFICE            |  |
| OPERATOR               |  |

5A. Indicate Type of Lease  
STATE  REC   
5. State Oil & Gas Lease No.  
-

APPLICATION FOR PERMIT TO DRILL, DEEPEN, OR PLUG BACK

1a. Type of Work  
b. Type of Well DRILL  DEEPEN  PLUG BACK   
DIL WELL  GAS WELL  OTHER  SINGLE ZONE  MULTIPLE ZONE

2. Name of Operator  
James A. Leonard

3. Address of Operator  
P.O. Box 367, Round Rock, Texas 78664

4. Location of Well UNIT LETTER G LOCATED 1980 FEET FROM THE North LINE AND 1980 FEET FROM THE East LINE OF SEC. 35 TWP. 25S RGE. 33E NMPM

7. Unit Agreement Name  
-

8. Farm or Lease Name  
Amoco Johnson "35"

9. Well No.  
1

10. Field and Pool, or Wildcat  
Wildcat

12. County  
Lea

19. Proposed Depth  
5300

19A. Formation  
Delaware

20. Rotary or C.T.  
Rotary

21. Elevations (show whether DF, RT, etc.)  
3334.0 GL

21A. Kind & Status Plug. Bond  
Blanket Single

21B. Drilling Contractor  
Marc Drilling Corp.

22. Approx. Date Work will start  
August 1, 1982

23. PROPOSED CASING AND CEMENT PROGRAM

| SIZE OF HOLE | SIZE OF CASING | WEIGHT PER FOOT | SETTING DEPTH | SACKS OF CEMENT | EST. TOP |
|--------------|----------------|-----------------|---------------|-----------------|----------|
| 11"          | 8 5/8          | 24              | 400           | 200             | Surface  |
| 7 7/8        | 4 1/2          | 10.5            | 5300          | 1800            | Surface  |

- The above casing and cementing program will be used to drill to the Delaware Sand.
- The surface hole will be drilled w/ fresh water, 10# brine mud system will be used from under the surface casing to total depth (5300').
- Blow-out preventors will be utilized from 400' to TD.

APPROVAL VALID FOR 180 DAYS  
PERMIT EXPIRES 1/20/83  
UNLESS DRILLING UNDERWAY

IN ABOVE SPACE DESCRIBE PROPOSED PROGRAM; IF PROPOSAL IS TO DEEPEN OR PLUG BACK, GIVE DATA ON PRESENT PRODUCTIVE ZONE AND PROPOSED NEW PRODUCTIVE ZONE. GIVE BLOWOUT PREVENTER PROGRAM, IF ANY.

I hereby certify that the information above is true and complete to the best of my knowledge and belief.

Signed Les Clements Title Consulting Petroleum Engineer Date June 30, 1982

(This space for State Use)  
Approved by Les Clements TITLE \_\_\_\_\_ DATE JUL 20 1982  
Oil & Gas Insp. \_\_\_\_\_

CONDITIONS OF APPROVAL, IF ANY:

NEW MEXICO OIL CONSERVATION COMMISSION  
WELL LOCATION AND ACREAGE DEDICATION PLAT

Form C-102  
Supersedes C-128  
Effective 1-1-65

All distances must be from the outer boundaries of the Section

|  |                                   |                              |               |                             |            |
|--|-----------------------------------|------------------------------|---------------|-----------------------------|------------|
| Operator <i>J. A. Leonard</i><br>J. A. LEONARD |                                   | Lease AMOCO JOHNSON 35       |               |                             | Well No. 1 |
| Tract Letter G                                 | Section 35                        | Township 25 SOUTH            | Range 33 EAST | County LEA                  |            |
| Actual Footage Location of Well:               |                                   |                              |               |                             |            |
| 1980 feet from the NORTH line and              |                                   | 1980 feet from the EAST line |               |                             |            |
| Ground Level Elev. 3334.0'                     | Producing Formation Delaware Sand |                              | Pool Wildcat  | Dedicated Acreage: 40 Acres |            |

1. Outline the acreage dedicated to the subject well by colored pencil or hachure marks on the plat below.
2. If more than one lease is dedicated to the well, outline each and identify the ownership thereof (both as to working interest and royalty).
3. If more than one lease of different ownership is dedicated to the well, have the interests of all owners been consolidated by communitization, unitization, force-pooling, etc?

Yes  No If answer is "yes," type of consolidation \_\_\_\_\_

If answer is "no," list the owners and tract descriptions which have actually been consolidated. (Use reverse side of this form if necessary.) \_\_\_\_\_

No allowable will be assigned to the well until all interests have been consolidated (by communitization, unitization, forced-pooling, or otherwise) or until a non-standard unit, eliminating such interests, has been approved by the Commission.

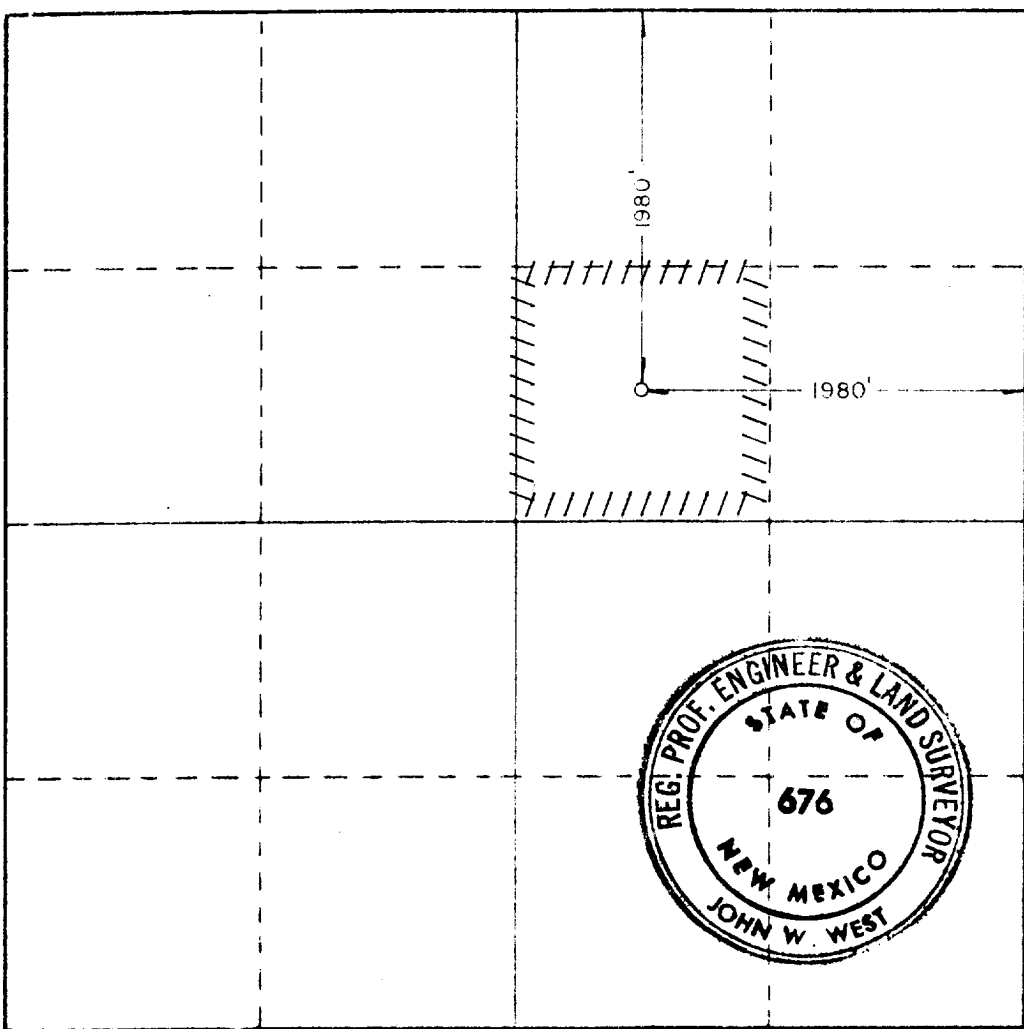

CERTIFICATION

I hereby certify that the information contained herein is true and complete to the best of my knowledge and belief.

*Mohammed Yamin Merchant*  
Name

Mohammed Yamin Merchant  
Position  
Consulting Pet, Engineer

Company  
for J, A, Leonard

Date  
June 30, 1982

I hereby certify that the well location shown on this plat was plotted from field notes of actual surveys made by me or under my supervision, and that the same is true and correct to the best of my knowledge and belief.

Date Surveyed  
JUNE 5, 1982

Registered Professional Engineer and/or Land Surveyor

*John W. West*

Certificate No JOHN W. WEST 676  
PATRICK A. ROMERO 6863  
Ronald J. Eidson 3239

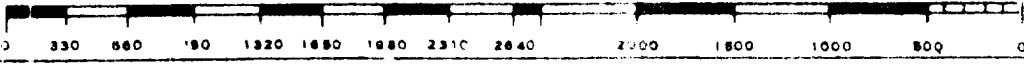

RECEIVED

JUN 30 1982

O.C.D.  
HOBBS OFFICE

FILE