

NO. OF COPIES RECEIVED		
DISTRIBUTION		
SANTA FE		
FILE		
U.S.G.S.		
LAND OFFICE		
OPERATOR		

NEW MEXICO OIL CONSERVATION COMMISSION

Form C-101  
Revised 1-1-65 *30-025-24171*

5A. Indicate Type of Lease  
STATE  FEE

5. State Oil & Gas Lease No.  
**K-3908**

APPLICATION FOR PERMIT TO DRILL, DEEPEN, OR PLUG BACK

1a. Type of Work DRILL <input checked="" type="checkbox"/> DEEPEN <input type="checkbox"/> PLUG BACK <input type="checkbox"/>		7. Unit Agreement Name	
b. Type of Well OIL WELL <input checked="" type="checkbox"/> GAS WELL <input type="checkbox"/> OTHER <input type="checkbox"/> SINGLE ZONE <input checked="" type="checkbox"/> MULTIPLE ZONE <input type="checkbox"/>		8. Farm or Lease Name <b>State 1-2</b>	
2. Name of Operator <b>Corinne Grace</b>		9. Well No. <b>2</b>	
3. Address of Operator <b>P. O. Box 1418, Carlsbad, New Mexico 88220</b>		10. Field and Pool, or Wildcat	
4. Location of Well UNIT LETTER <b>I</b> LOCATED <b>1980</b> FEET FROM THE <b>South</b> LINE AND <b>660</b> FEET FROM THE <b>East</b> LINE OF SEC. <b>10</b> TWP. <b>12S</b> RGE. <b>34E</b> NMPM		12. County <b>Lea</b>	
		19. Proposed Depth <b>5000</b>	19A. Formation <b>San Andres</b>
		20. Rotary or C.T. <b>Rotary &amp; C.T.</b>	
21. Elevations (Show whether DF, RT, etc.)	21A. Kind & Status Plug. Bond <b>Blanket</b>	21B. Drilling Contractor <b>Osbourne Drilling Co.</b>	22. Approx. Date Work will start <b>When approved</b>

23. PROPOSED CASING AND CEMENT PROGRAM

SIZE OF HOLE	SIZE OF CASING	WEIGHT PER FOOT	SETTING DEPTH	SACKS OF CEMENT	EST. TOP
<b>12 1/4</b>	<b>8 5/8</b>	<b>26#</b>	<b>350</b>	<b>300</b>	<b>Circ.</b>
<b>7 7/8</b>	<b>4 1/2</b>	<b>9.5#</b>	<b>5000</b>	<b>200</b>	

APPROVAL VALID  
FOR 90 DAYS UNLESS  
DRILLING COMMENCED,  
EXPIRES 5-11-74

IN ABOVE SPACE DESCRIBE PROPOSED PROGRAM: IF PROPOSAL IS TO DEEPEN OR PLUG BACK, GIVE DATA ON PRESENT PRODUCTIVE ZONE AND PROPOSED NEW PRODUCTIVE ZONE. GIVE BLOWOUT PREVENTER PROGRAM, IF ANY.

I hereby certify that the information above is true and complete to the best of my knowledge and belief.

Signed *Corinne Grace* Title **Agent** Date **2/11/74**

(This space for State Use)

APPROVED BY *[Signature]* TITLE *[Signature]* DATE \_\_\_\_\_

CONDITIONS OF APPROVAL, IF ANY:

**NEW MEXICO OIL CONSERVATION COMMISSION  
WELL LOCATION AND ACREAGE DEDICATION PLAT**

Form C-102  
Supersedes C-128  
Effective 1-1-65

All distances must be from the outer boundaries of the Section.

Operator <b>CORINNE GRACE</b>		Lease <i>State 1-2</i>			Well No. <i>2</i>
Tract letter <b>"I"</b>	Section <b>10</b>	Township <b>12 South</b>	Range <b>34 East</b>	County <b>LEA</b>	
Actual Footage Location of Well: <b>1980</b> feet from the <b>South</b> line and <b>660</b> feet from the <b>East</b> line					
Ground Level Elev.	Producing Formation <i>San Andres</i>		Pool <i>Ranger Lake Sandstones</i>	Dedicated Acreage: <b>40</b> Acres	

1. Outline the acreage dedicated to the subject well by colored pencil or hachure marks on the plat below.
2. If more than one lease is dedicated to the well, outline each and identify the ownership thereof (both as to working interest and royalty).
3. If more than one lease of different ownership is dedicated to the well, have the interests of all owners been consolidated by communitization, unitization, force-pooling, etc?

Yes  No If answer is "yes," type of consolidation \_\_\_\_\_

If answer is "no," list the owners and tract descriptions which have actually been consolidated. (Use reverse side of this form if necessary.) \_\_\_\_\_

No allowable will be assigned to the well until all interests have been consolidated (by communitization, unitization, forced-pooling, or otherwise) or until a non-standard unit, eliminating such interests, has been approved by the Commission

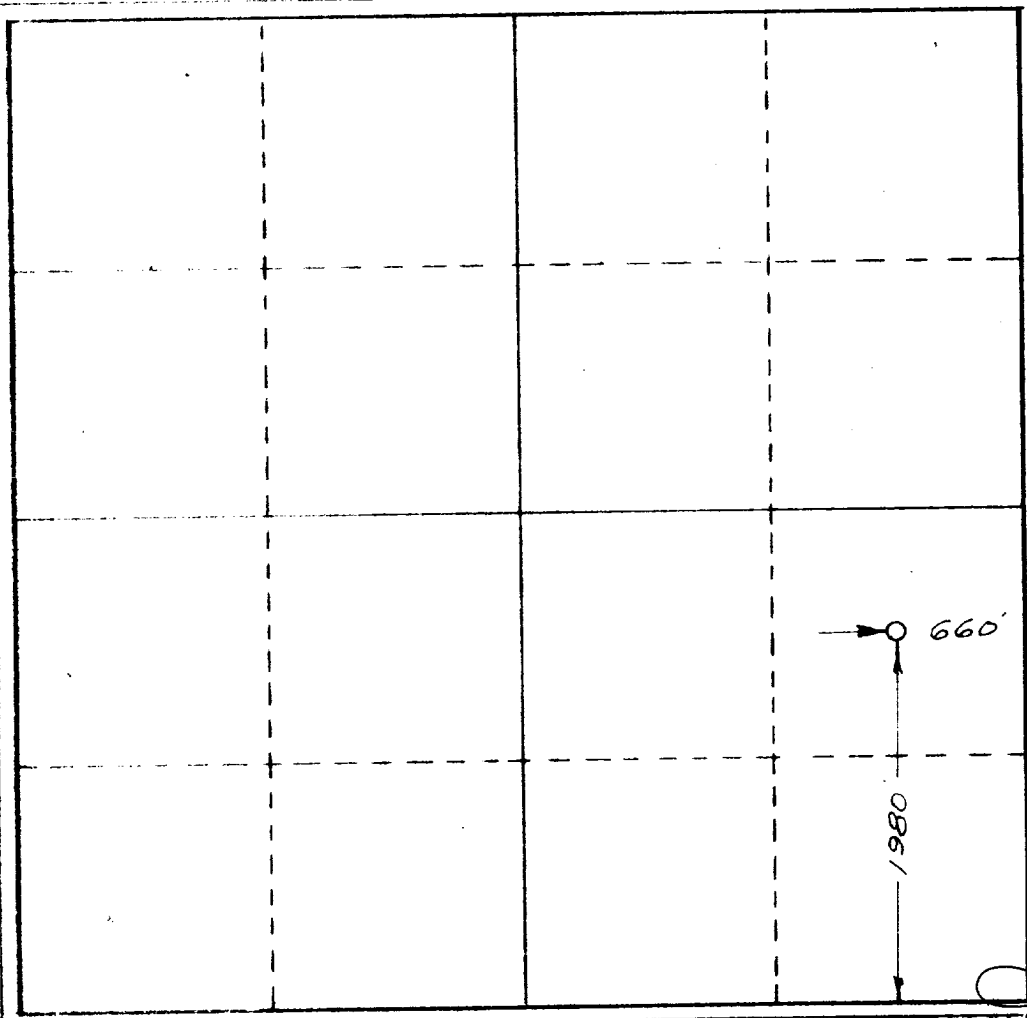

**CERTIFICATION**

I hereby certify that the information contained herein is true and complete to the best of my knowledge and belief.

Name *Hershel Jones*  
 Position *Agent*  
 Company *Corinne Grace*  
 Date *2/11/74*

I hereby certify that the well location shown on this plat was plotted from field notes of actual surveys made by me or under my supervision, and that the same is true and correct to the best of my knowledge and belief.

Date Surveyed  
**February 11, 1974**

Registered Professional Engineer  
and/or Land Surveyor  
**HERSCHEL JONES**  
No. **12540**

Certificate

