

UNITED STATES  
DEPARTMENT OF THE INTERIOR  
GEOLOGICAL SURVEY

30-041-20563

APPLICATION FOR PERMIT TO DRILL, DEEPEN, OR PLUG BACK

1a. TYPE OF WORK  
 DRILL  DEEPEN  PLUG BACK   
 b. TYPE OF WELL  
 OIL WELL  GAS WELL  OTHER  SINGLE ZONE  MULTIPLE ZONE

2. NAME OF OPERATOR  
 SUNDANCE OIL COMPANY

3. ADDRESS OF OPERATOR  
 Suite 910, 1776 Lincoln St., Denver, CO 80203

4. LOCATION OF WELL (Report location clearly and in accordance with any State requirements.)  
 At surface  
 1980' FSL and 1980' FEL, Unit J  
 At proposed prod. zone  
 Same

14. DISTANCE IN MILES AND DIRECTION FROM NEAREST TOWN OR POST OFFICE\*  
 18 miles southeast of Kenna, New Mexico

15. DISTANCE FROM PROPOSED\* LOCATION TO NEAREST PROPERTY OR LEASE LINE, FT. (Also to nearest drlg. unit line, if any)  
 660

16. NO. OF ACRES IN LEASE  
 550

17. NO. OF ACRES ASSIGNED TO THIS WELL  
 40

18. DISTANCE FROM PROPOSED LOCATION\* TO NEAREST WELL, DRILLING, COMPLETED, OR APPLIED FOR, ON THIS LEASE, FT.  
 1320

19. PROPOSED DEPTH  
 4420

20. ROTARY OR CABLE TOOLS  
 Rotary

21. ELEVATIONS (Show whether DF, RT, GR, etc.)  
 4463.2' GL

22. APPROX. DATE WORK WILL START\*  
 December 30, 1980

23. PROPOSED CASING AND CEMENTING PROGRAM

SIZE OF HOLE	SIZE OF CASING	WEIGHT PER FOOT	SETTING DEPTH	QUANTITY OF CEMENT
12 1/4"	8 5/8"	24	1900 CIRCULATED	300 sx Econ & 100 sx Class C
7 7/8"	4 1/2"	10.5	4420	300 sx 50/50 Poz

Well will be drilled to total depth and evaluated by running logs and DST's when necessary. Casing will be run when logs and DST's indicate possible commercial production.

IN ABOVE SPACE DESCRIBE PROPOSED PROGRAM: If proposal is to deepen or plug back, give data on present productive zone and proposed new productive zone. If proposal is to drill or deepen directionally, give pertinent data on subsurface locations and measured and true vertical depths. Give blowout preventer program, if any.

24. SIGNED Richard O. Dimit TITLE Vice President, Production DATE October 29, 1980  
 (This space for Federal or State office use)

PERMIT NO. \_\_\_\_\_ APPROVAL DATE \_\_\_\_\_

APPROVED BY (Orig. Sgd.) PETER W. CHESTER TITLE ACTING DISTRICT ENGINEER DATE NOV 26 1980  
 CONDITIONS OF APPROVAL, IF ANY:

NEW MEXICO OIL CONSERVATION COMMISSION  
WELL LOCATION AND ACREAGE DEDICATION PLAT

Form C-102  
Supersedes C-128  
Effective 1-1-65

All distances must be from the outer boundaries of the Section

Operator <b>Sundance Oil Co.</b>			Lease <b>Cone</b>			Well No. <b>26</b>		
Tract Letter <b>J</b>	Section <b>27</b>	Township <b>7 South</b>		Range <b>32 East</b>	County <b>Roosevelt</b>			
Actual Footage Location of Well: <b>1980</b> feet from the <b>south</b> line and <b>1980</b> feet from the <b>east</b> line								
Ground Level Elev. <b>4463.2</b>	Producing Formation <b>San Andres</b>			Pool <b>Tomahawk</b>		Dedicated Acreage: <b>40</b> Acres		

1. Outline the acreage dedicated to the subject well by colored pencil or hachure marks on the plat below.
2. If more than one lease is dedicated to the well, outline each and identify the ownership thereof (both as to working interest and royalty).
3. If more than one lease of different ownership is dedicated to the well, have the interests of all owners been consolidated by communitization, unitization, force-pooling, etc?

Yes     No    If answer is "yes," type of consolidation \_\_\_\_\_

If answer is "no," list the owners and tract descriptions which have actually been consolidated. (Use reverse side of this form if necessary.) \_\_\_\_\_

No allowable will be assigned to the well until all interests have been consolidated (by communitization, unitization, forced-pooling, or otherwise) or until a non-standard unit, eliminating such interests, has been approved by the Commission.

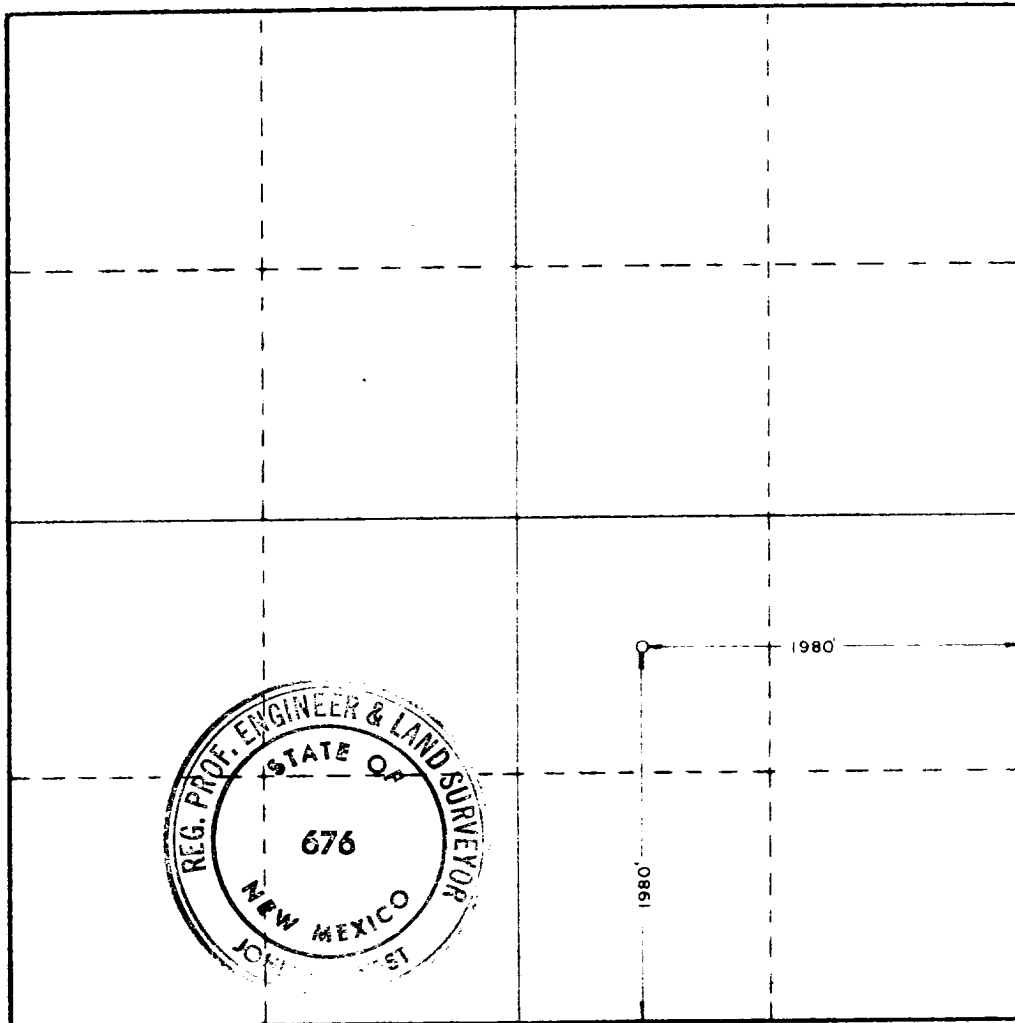

**CERTIFICATION**

*I hereby certify that the information contained herein is true and complete to the best of my knowledge and belief.*

*Richard O. Dimit*  
Name

Richard O. Dimit

Position

Vice President, Production

Company

Sundance Oil Company

Date

October 27, 1980

*I hereby certify that the well location shown on this plat was plotted from field notes of actual surveys made by me or under my supervision, and that the same is true and correct to the best of my knowledge and belief.*

Date Surveyed

Oct. 16, 1980

Registered Professional Engineer and/or Land Surveyor

*John W. West*

Certificate No. **JOHN W. WEST 676**  
**PATRICK A. ROMERO 6665**  
**Ronald J. Eideon 3239**

Attachment to Form 9-331 C  
Application for Permit to Drill

Sundance Oil Company, Cone Federal #26  
1980' FSL and 1980' FEL of Section 27, T.7S., R.32E.  
Roosevelt County, New Mexico

1. The geologic name of the surface information is Triassic red beds overlain by wind blown sands.
2. The estimated tops of important geologic markers are as follows:

Rustler	1870'
Salado	1900'
Yates	2290'
San Andres	3450'
P-1	4150'
P-2	4235'
T.D.	4420'

3. The estimated depths at which anticipated water, oil, gas or other mineral bearing formations will be encountered are as follows:

Ogalala	150' water
Salado	1900' salt
San Andres	3450' oil and gas
P-1	4150' oil and gas
P-2	4235' oil and gas

4. The proposed casing program is as follows:

Surface: New 8 5/8", 24#/ft., ST&C.  
Production: New 4 1/2", 10.5#/ft., ST&C, K-55.

5. A sketch of an API Series 900 Blowout Preventer is attached. Pipe rams and blinds will be checked to 1000 psi for 30 minutes when BOP is installed. BOP will be checked when casing is set and operated daily for checks.

6. The proposed mud program is as follows:

0-1900' spud mud	8.5 - 9.0#/gal.
1900-3500' native mud	9.0 - 9.5#/gal.
3500-T.D. salt gel	9.0 - 10.0#/gal.

7. The auxiliary equipment to be used is:

- a. Kelly cocks.
- b. Floats at the bit.
- c. Stabbing valve on rig floor with sub to fit drill pipe.

8. It is proposed to run 2" and 5" GR, CNL, FDC/MLL logs from TD to 1800'.

9. No abnormal pressures or temperatures are expected to be encountered in this well.

10. The anticipated starting date for this well is December 30, 1980. Estimated duration of drilling operations is 10 to 12 days.