



DAVID FEATHER
ENVIRONMENTAL SUPERVISOR
DIRECT: (432) 818-1615
E-MAIL: DAVID.FEATHER@APACHECORP.COM

October 25, 2019

Mr. Bradford Billings
State of New Mexico Oil Conservation Division
1220 South St Francis Drive
Santa Fe, NM 87505

RE: 1RP-2304 Turner Battery

Mr. Billings,

In compliance with 19.15.29.15(B) NMAC and the agreement submitted by Apache Corporation on November 8, 2018, Apache Corporation is submitting information related to deferment request for the release occurring October 1, 2009. Apache is respectfully submitting the deferment request for your approval. Unless further information is requested by NMOCD, Apache Corporation considers this release deferred.

If there are any questions, please feel free to contact me by telephone at 432-818-1615 or by e-mail at David.Feather@ApacheCorp.com.

Sincerely,

A handwritten signature in blue ink, appearing to read "David Feather".

David Feather
Environmental Supervisor
Apache Corporation - Permian Basin Region

Attachment: Deferment Report Dated October 23, 2019

Trinity Oilfield Services & Rentals, LLC

Environmental Site Summary & Deferment Request



Company: Apache Corporation Address: 2530 W. Marland St., Hobbs, NM 88240 Telephone #: (575) 393-7106

Site Name: Turner Battery NMOCD Reference#: 1RP-2304

Surface Owner: Deck Estate Mineral Owner: State of New Mexico

Unit Letter: K (NE/SW) Section: 22 Township: 21S Range: 37E County: Lea GPS Coordinates: 32.460968 N -103.151845 W

Date/Time of Release: 10/1/2009 Type of Release: ☒ Crude Oil ☒ Produced Water

Volume(s) Released: 130 bbls Produced Water & 50 bbls Crude Oil Volume(s) Recovered: 125 bbls Produced Water & 45 bbls Crude Oil

Closure Criteria for Impacted Soil (mg/kg; See Appendix C, "Closure Criteria Justification"):

Benzene: 10 BTEX: 50 GRO+DRO: 1,000 TPH: ☐ 100 Chloride: ☐ 600
☒ 2,500 ☒ 10,000
☐ 20,000

Background Information:

On October 1, 2009, Apache Corporation discovered a release at the Turner Battery. The water leg on a gun barrel tank became clogged, causing the tank to overflow, and resulting in the release of approximately 130 barrels (bbls) of produced water and 50 bbls of crude oil. The spill was confined to the earthen containment berm surrounding the tank battery. During initial response activities, the obstruction in the water leg was removed, and a vacuum truck was utilized to recover approximately 125 bbls of produced water and 45 bbls of crude oil.

The release was immediately reported to the New Mexico Oil Conservation Division's (NMOCD) Hobbs District Office. The NMOCD "Release Notification & Corrective Action" form (C-141) is provided as Appendix A. A "Site Location Map" is provided as Figure 1.

At some point following the release, additional remediation of the affected area took place. However, no extant documentation or work records of such activities could be located. In addition, no records or analytical results from soil sampling could be obtained from Cardinal Laboratories in Hobbs, New Mexico, as the Environmental Protection Agency's (EPA) mandated time period for record retention has elapsed.

On July 25, 2019, Apache requested Trinity Oilfield Services & Rentals, LLC (Trinity), assume remediation activities at the release site.

Summary of Field Activities:

On August 2, 2019, representatives of Trinity conducted a sampling event to assess the current state of the site. A hand auger was utilized to advance a series of 4 boreholes (SP-1 through SP-4) in the inferred affected area inside the containment area to investigate the extent of impacted soil. The auger holes were advanced to total depths of 2 feet below ground surface (bgs). Soil samples were collected at ground surface and 1-foot vertical intervals, and confirmation samples were submitted to Cardinal Laboratories for analysis of chloride, total petroleum hydrocarbons (TPH), and benzene, toluene, ethylbenzene, and total xylene (BTEX) concentrations using EPA Methods 4500-Cl B, SW 846-8015 Mod, and SW 846-8021B, respectively.

Laboratory analytical results indicated BTEX constituent concentrations were less than the appropriate laboratory method detection limit (MDL) in all submitted soil samples. Sum total concentrations of Gas Range Organics and Diesel Range Organics (GRO + DRO) ranged from less than the laboratory MDL in samples SP-3 @ Surface, SP-3 @ 1', and SP-3 @ 2' to 8,060 mg/kg in sample SP-2 @ Surface. TPH concentrations ranged from less than the laboratory MDL in samples SP-3 @ Surface, SP-3 @ 1', and SP-3 @ 2' to 12,590 mg/kg in sample SP-2 @ Surface. Chloride concentrations ranged from less than the laboratory MDL in samples SP-1 @ 2', SP-2 @ Surface, SP-2 @ 1', and SP-4 @ 2' to 80.0 mg/kg in sample SP-3 @ 1'.

Based on these laboratory analytical results, delineation of the areas represented by auger holes SP-1, SP-2, and SP-3

Trinity Oilfield Services & Rentals, LLC

Environmental Site Summary & Deferment Request



Summary of Field Activities (cont.)

had been achieved. However, additional vertical delineation was required in the area represented by auger hole SP-4.

On August 16, 2019, auger hole SP-4 was re-entered and further advanced to a total depth of 7 feet bgs. Soil samples were collected at 1-foot vertical intervals, and confirmation samples were submitted to Cardinal Laboratories for analysis of TPH and BTEX concentrations. Laboratory analytical results indicated BTEX constituent concentrations were less than the appropriate laboratory MDL in all submitted soil samples. GRO + DRO concentrations ranged from less than the laboratory MDL in sample SP-4 @ 7' to 568 mg/kg in sample SP-4 @ 5'. TPH concentrations ranged from less than the laboratory MDL in sample SP-4 @ 7' to 757 mg/kg in sample SP-4 @ 5'.

Based on these laboratory analytical results, vertical delineation of the area represented by auger hole SP-4 had been achieved.

Locations of the auger holes are depicted in Figure 2, "Sample Location Map", and Figure 3, "Sample Location Map (Historical Aerial)". Current photographs of the release site are provided in Appendix B. Laboratory analytical results are summarized in Table 1, and an analytical report is provided in Appendix D.

Deferment Request:

Soil samples collected from the inferred impacted area were analyzed by an NMOC approved laboratory, and chloride and BTEX constituent concentrations were below the Closure Criteria listed in Table I of Section 19.15.29.12 of the New Mexico Administrative Code (NMAC) for a site where depth to groundwater is 51-100 feet bgs (see Appendix C, "Closure Criteria Justification", for more information).

The GRO+DRO and TPH contamination in the areas represented by auger holes SP-2 and SP-4 has been vertically delineated. Based on the shallow depth of impact (i.e., ground surface to 2 feet bgs), the contamination "does not cause an imminent risk to human health, the environment, or ground water." Pursuant to Section 19.15.29.12.C(2) NMAC, since the impacted area is immediately around production equipment, Apache hereby requests approval to defer further remediation until such time that the tank battery is decommissioned and removed.

Enclosures:

- Figure 1: Site Location Map
- Figure 2: Sample Location Map
- Figure 3: Sample Location Map (Historical Aerial)
- Table 1: Concentrations of Benzene, BTEX, TPH & Chloride in Soil
- Appendix A: Release Notification & Corrective Action (Form C-141)
- Appendix B: Photographs
- Appendix C: Closure Criteria Justification
- Appendix D: Laboratory Analytical Results

 10/23/2019
Ben J. Arguijo
Project Manager

Figures

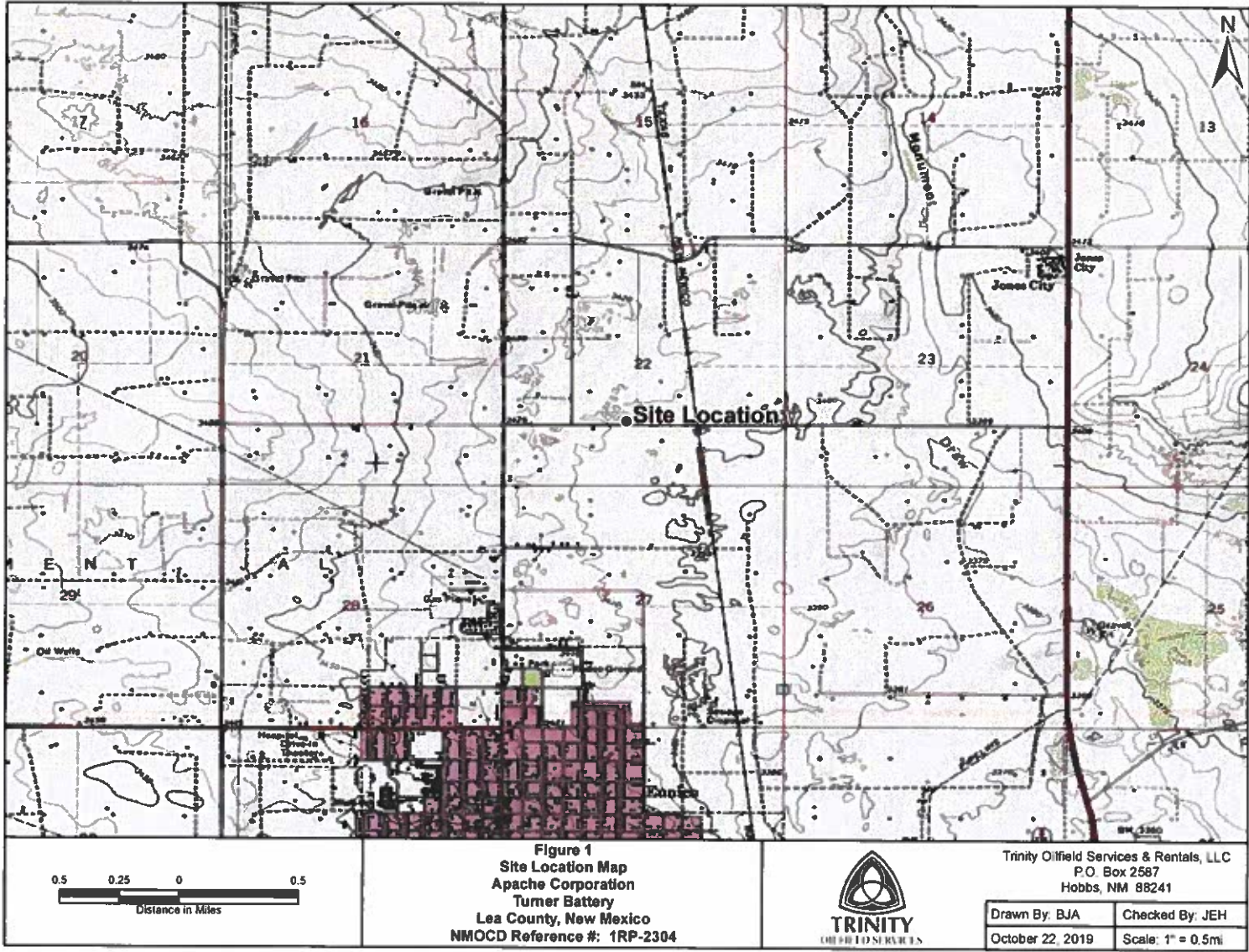
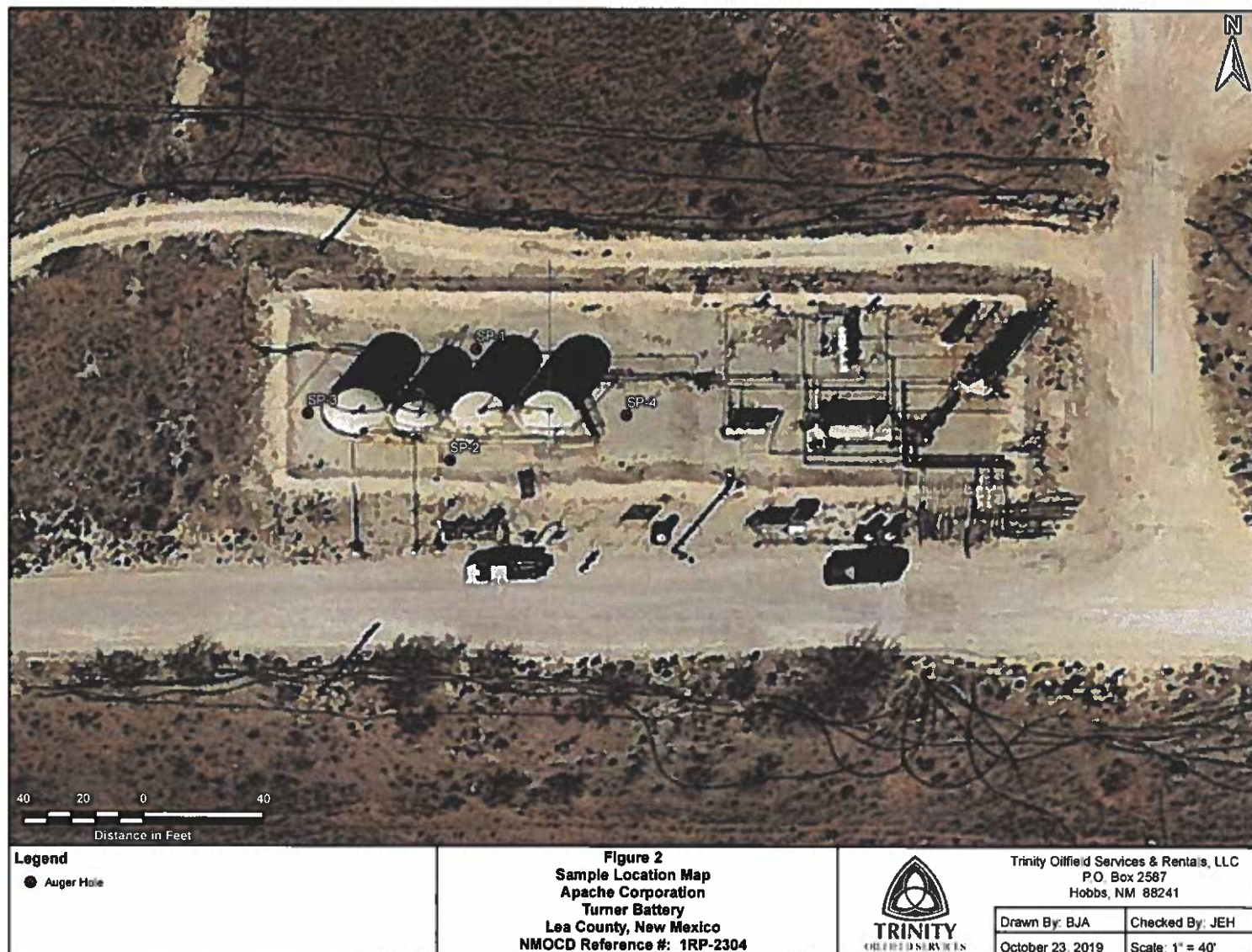

Figure 1
Site Location Map
Apache Corporation
Turner Battery
Lea County, New Mexico
NMOCD Reference #: 1RP-2304



Trinity Oilfield Services & Rentals, LLC
P.O. Box 2587
Hobbs, NM 88241

Drawn By: BJA	Checked By: JEJH
October 22, 2019	Scale: 1" = 0.5mi





Tables

TABLE 1
CONCENTRATIONS OF BENZENE, BTEX, TPH & CHLORIDE IN SOIL

APACHE CORPORATION
TURNER BATTERY
LEA COUNTY, NEW MEXICO
NMOCD REFERENCE #: 1RP-2304



SAMPLE LOCATION	SAMPLE DEPTH (BGS)	SAMPLE DATE	SOIL STATUS	EPA SW-846 Method 8021B					EPA SW-846 Method 8015M					4500-Cl B
				BENZENE (mg/kg)	TOLUENE (mg/kg)	ETHYL-BENZENE (mg/kg)	TOTAL XYLENES (mg/kg)	TOTAL BTEX (mg/kg)	GRO C6-C12 (mg/kg)	C12-C28 (mg/kg)	GRO+ DRO (mg/kg)	MRO C28-C35 (mg/kg)	TPH C6-C35 (mg/kg)	CHLORIDE (mg/kg)
NMOCD Closure Limits (mg/kg)				10	NE	NE	NE	50	NE	NE	1,000	NE	2,500	10,000
SP-1 @ Surface	Surface	8/2/2019	In-Situ	<0.050	<0.050	<0.050	<0.150	<0.300	<10.0	16.8	16.8	13.1	29.9	320
SP-1 @ 1'	1'	8/2/2019	In-Situ	<0.050	<0.050	<0.050	<0.150	<0.300	<50.0	66.5	66.5	68.3	135	32.0
SP-1 @ 2'	2'	8/2/2019	In-Situ	<0.050	<0.050	<0.050	<0.150	<0.300	<50.0	232	232	223	455	<16.0
SP-2 @ Surface	Surface	8/2/2019	In-Situ	<0.050	<0.050	<0.050	<0.150	<0.300	<50.0	8,060	8,060	4,530	12,590	<16.0
SP-2 @ 1'	1'	8/2/2019	In-Situ	<0.050	<0.050	<0.050	<0.150	<0.300	<10.0	555	555	470	1,025	<16.0
SP-2 @ 2'	2'	8/2/2019	In-Situ	<0.050	<0.050	<0.050	<0.150	<0.300	<10.0	360	360	341	701	16.0
SP-3 @ Surface	Surface	8/2/2019	In-Situ	<0.050	<0.050	<0.050	<0.150	<0.300	<10.0	<10.0	<10.0	<10.0	<10.0	112
SP-3 @ 1'	1'	8/2/2019	In-Situ	<0.050	<0.050	<0.050	<0.150	<0.300	<10.0	<10.0	<10.0	<10.0	<10.0	80.0
SP-3 @ 2'	2'	8/2/2019	In-Situ	<0.050	<0.050	<0.050	<0.150	<0.300	<10.0	<10.0	<10.0	<10.0	<10.0	48.0
SP-4 @ Surface	Surface	8/2/2019	In-Situ	<0.050	<0.050	<0.050	<0.150	<0.300	<10.0	216	216	173	389	16.0
SP-4 @ 1'	1'	8/2/2019	In-Situ	<0.050	<0.050	<0.050	<0.150	<0.300	<50.0	5,180	5,180	2,700	7,880	16.0
SP-4 @ 2'	2'	8/2/2019	In-Situ	<0.050	<0.050	<0.050	<0.150	<0.300	<50.0	2,440	2,440	1,160	3,600	<16.0
SP-4 @ 3'	3'	8/16/2019	In-Situ	<0.050	<0.050	<0.050	<0.150	<0.300	<10.0	195	195	167	362	-
SP-4 @ 4'	4'	8/16/2019	In-Situ	<0.050	<0.050	<0.050	<0.150	<0.300	<10.0	27.0	27.0	21.9	48.9	-
SP-4 @ 5'	5'	8/16/2019	In-Situ	<0.050	<0.050	<0.050	<0.150	<0.300	<50.0	568	568	189	757	-
SP-4 @ 6'	6'	8/16/2019	In-Situ	<0.050	<0.050	<0.050	<0.150	<0.300	<10.0	64.6	64.6	52.9	118	-
SP-4 @ 7'	7'	8/16/2019	In-Situ	<0.050	<0.050	<0.050	<0.150	<0.300	<10.0	<10.0	<10.0	<10.0	<10.0	-

NE = Not Established

- = Not Analyzed

Concentrations in BOLD exceed the NMOCD Closure Limit

Appendices

Appendix A

Release Notification & Corrective Action (Form C-141)

District I
1625 N. French Dr., Hobbs, NM 88240
District II
1301 W. Grand Avenue, Artesia, NM 88210
District III
1000 Rio Brazos Road, Aztec, NM 87418
District IV
1220 S. St. Francis Dr., Santa Fe, NM 87505

RECEIVED
OCT 09 2019
HOBBSOCD

State of New Mexico
Energy Minerals and Natural Resources
Oil Conservation Division
1220 South St. Francis Dr.
Santa Fe, NM 87505

Form C-141
Revised October 10, 2003

Submit 2 Copies to appropriate
District Office in accordance
with Rule 116 on back
side of form

Release Notification and Corrective Action

OPERATOR

☒ Initial Report ☐ Final Report

Name of Company Apache Corporation	Contact Natalie Gladden
Address P.O. Box 1849 Eunice, NM 88231	Telephone No. 575-390-4186
Facility Name Turner Battery (nearest well Turner #22)	Facility Type Battery
Surface Owner Deck Estate	Mineral Owner State
Lease No. 30-025-37203	

LOCATION OF RELEASE

Unit Letter	Section	Township	Range	Feet from the	North/South Line	Feet from the	East/West Line	County
K	22	21S	37E	1980	FSL	1980	FWL	Lea

Latitude _____ Longitude _____

NATURE OF RELEASE

Type of Release Produced Water and Oil	Volume of Release 130wtr/50oil	Volume Recovered 125wtr/45oil
Source of Release Water leg on gun bbl	Date and Hour of Occurrence 10/1/09 1:00pm	Date and Hour of Discovery 10/1/09 1:45pm
Was Immediate Notice Given? <input checked="" type="checkbox"/> Yes <input type="checkbox"/> No <input type="checkbox"/> Not Required	If YES, To Whom? Jeff Leiking	
By Whom? Natalie Gladden	Date and Hour 2pm	
Was a Watercourse Reached? <input type="checkbox"/> Yes <input checked="" type="checkbox"/> No	If YES, Volume Impacting the Watercourse.	
If a Watercourse was Impacted, Describe Fully.*		
Describe Cause of Problem and Remedial Action Taken.* Water leg on the gun bbl, plugged up causing the tanks to overflow. All fluid remained inside the containment walls.		
Describe Area Affected and Cleanup Action Taken.* Vacuum trucks were called out to recover standing fluid. Hyrdotech will be out 10/2 to vacuum out contaminated soil. Contaminated soil will be hauled off to Sundance Disposal.		
I hereby certify that the information given above is true and complete to the best of my knowledge and understand that pursuant to NMOCD rules and regulations all operators are required to report and/or file certain release notifications and perform corrective actions for releases which may endanger public health or the environment. The acceptance of a C-141 report by the NMOCD marked as "Final Report" does not relieve the operator of liability should their operations have failed to adequately investigate and remediate contamination that pose a threat to ground water, surface water, human health or the environment. In addition, NMOCD acceptance of a C-141 report does not relieve the operator of responsibility for compliance with any other federal, state, or local laws and/or regulations.		

Signature: <i>Natalie Gladden</i>		OIL CONSERVATION DIVISION	
Printed Name: Natalie Gladden		Approved by: <i>Jeff Leiking</i> ENV. ENGINEER: <i>Jeff Leiking</i> District Supervisor:	
Title: EH&S Environmental Tech	Approval Date: 10/09/09	Expiration Date: 12/09/09	
E-mail Address: natalie.gladden@apachecorp.com	Conditions of Approval: SUBMIT FINAL C-141 BY 12/09/09.		Attached <input type="checkbox"/>
Date: 10/1/09 Phone: 575/390-4186			IRP-09.10.2304

* Attach Additional Sheets If Necessary

FGRL0928757083

State of New Mexico
Oil Conservation Division

Incident ID	
District RP	
Facility ID	
Application ID	

Site Assessment/Characterization

This information must be provided to the appropriate district office no later than 90 days after the release discovery date.

What is the shallowest depth to groundwater beneath the area affected by the release?	<u>70</u> (ft bgs)
Did this release impact groundwater or surface water?	<input type="checkbox"/> Yes <input checked="" type="checkbox"/> No
Are the lateral extents of the release within 300 feet of a continuously flowing watercourse or any other significant watercourse?	<input type="checkbox"/> Yes <input checked="" type="checkbox"/> No
Are the lateral extents of the release within 200 feet of any lakebed, sinkhole, or playa lake (measured from the ordinary high-water mark)?	<input type="checkbox"/> Yes <input checked="" type="checkbox"/> No
Are the lateral extents of the release within 300 feet of an occupied permanent residence, school, hospital, institution, or church?	<input type="checkbox"/> Yes <input checked="" type="checkbox"/> No
Are the lateral extents of the release within 500 horizontal feet of a spring or a private domestic fresh water well used by less than five households for domestic or stock watering purposes?	<input type="checkbox"/> Yes <input checked="" type="checkbox"/> No
Are the lateral extents of the release within 1000 feet of any other fresh water well or spring?	<input type="checkbox"/> Yes <input checked="" type="checkbox"/> No
Are the lateral extents of the release within incorporated municipal boundaries or within a defined municipal fresh water well field?	<input type="checkbox"/> Yes <input checked="" type="checkbox"/> No
Are the lateral extents of the release within 300 feet of a wetland?	<input type="checkbox"/> Yes <input checked="" type="checkbox"/> No
Are the lateral extents of the release overlying a subsurface mine?	<input type="checkbox"/> Yes <input checked="" type="checkbox"/> No
Are the lateral extents of the release overlying an unstable area such as karst geology?	<input type="checkbox"/> Yes <input checked="" type="checkbox"/> No
Are the lateral extents of the release within a 100-year floodplain?	<input type="checkbox"/> Yes <input checked="" type="checkbox"/> No
Did the release impact areas not on an exploration, development, production, or storage site?	<input type="checkbox"/> Yes <input checked="" type="checkbox"/> No

Attach a comprehensive report (electronic submittals in .pdf format are preferred) demonstrating the lateral and vertical extents of soil contamination associated with the release have been determined. Refer to 19.15.29.11 NMAC for specifics.

Characterization Report Checklist: *Each of the following items must be included in the report.*

- ☒ Scaled site map showing impacted area, surface features, subsurface features, delineation points, and monitoring wells.
- ☐ Field data
- ☒ Data table of soil contaminant concentration data
- ☒ Depth to water determination
- ☒ Determination of water sources and significant watercourses within 1/2-mile of the lateral extents of the release
- ☒ Boring or excavation logs
- ☒ Photographs including date and GIS information
- ☒ Topographic/Aerial maps
- ☒ Laboratory data including chain of custody

If the site characterization report does not include completed efforts at remediation of the release, the report must include a proposed remediation plan. That plan must include the estimated volume of material to be remediated, the proposed remediation technique, proposed sampling plan and methods, anticipated timelines for beginning and completing the remediation. The closure criteria for a release are contained in Table 1 of 19.15.29.12 NMAC, however, use of the table is modified by site- and release-specific parameters.

Form C-141

Page 4

State of New Mexico
Oil Conservation Division

Incident ID	
District RP	
Facility ID	
Application ID	

I hereby certify that the information given above is true and complete to the best of my knowledge and understand that pursuant to OCD rules and regulations all operators are required to report and/or file certain release notifications and perform corrective actions for releases which may endanger public health or the environment. The acceptance of a C-141 report by the OCD does not relieve the operator of liability should their operations have failed to adequately investigate and remediate contamination that pose a threat to groundwater, surface water, human health or the environment. In addition, OCD acceptance of a C-141 report does not relieve the operator of responsibility for compliance with any other federal, state, or local laws and/or regulations.

Printed Name: Bruce BAKER Title: Environmental Tech SR.
Signature: Bruce Baker Date: 10-28-19
email: larry.baker@apachecorp.com Telephone: 432-631-6982

OCD Only

Received by: _____ Date: _____

Form C-141

Page 5

State of New Mexico
Oil Conservation Division

Incident ID	nGRL0928757748
District RP	
Facility ID	
Application ID	

Remediation Plan**Remediation Plan Checklist:** Each of the following items must be included in the plan.

- ☐ Detailed description of proposed remediation technique
☐ Scaled sitemap with GPS coordinates showing delineation points
☐ Estimated volume of material to be remediated
☐ Closure criteria is to Table 1 specifications subject to 19.15.29.12(C)(4) NMAC
☐ Proposed schedule for remediation (note if remediation plan timeline is more than 90 days OCD approval is required)

Deferral Requests Only: Each of the following items must be confirmed as part of any request for deferral of remediation.

- ☒ Contamination must be in areas immediately under or around production equipment where remediation could cause a major facility deconstruction.
☒ Extents of contamination must be fully delineated.
☒ Contamination does not cause an imminent risk to human health, the environment, or groundwater.

I hereby certify that the information given above is true and complete to the best of my knowledge and understand that pursuant to OCD rules and regulations all operators are required to report and/or file certain release notifications and perform corrective actions for releases which may endanger public health or the environment. The acceptance of a C-141 report by the OCD does not relieve the operator of liability should their operations have failed to adequately investigate and remediate contamination that pose a threat to groundwater, surface water, human health or the environment. In addition, OCD acceptance of a C-141 report does not relieve the operator of responsibility for compliance with any other federal, state, or local laws and/or regulations.

Printed Name: Bruce Baker Title: Environmental Tech SR.
 Signature: Bruce Baker Date: 10-28-19
 email: larry.baker@apachecorp.com Telephone: 482-681-6982

OCD Only

Received by: _____ Date: _____

☐ Approved ☐ Approved with Attached Conditions of Approval ☐ Denied ☒ Deferral Approved

Signature: Bradford Billings Date: 07/12/2021

Appendix B

Photographs

Apache Corporation – Turner Battery
Unit Letter "K" (NE/SW), Section 22, Township 21S, Range 37E

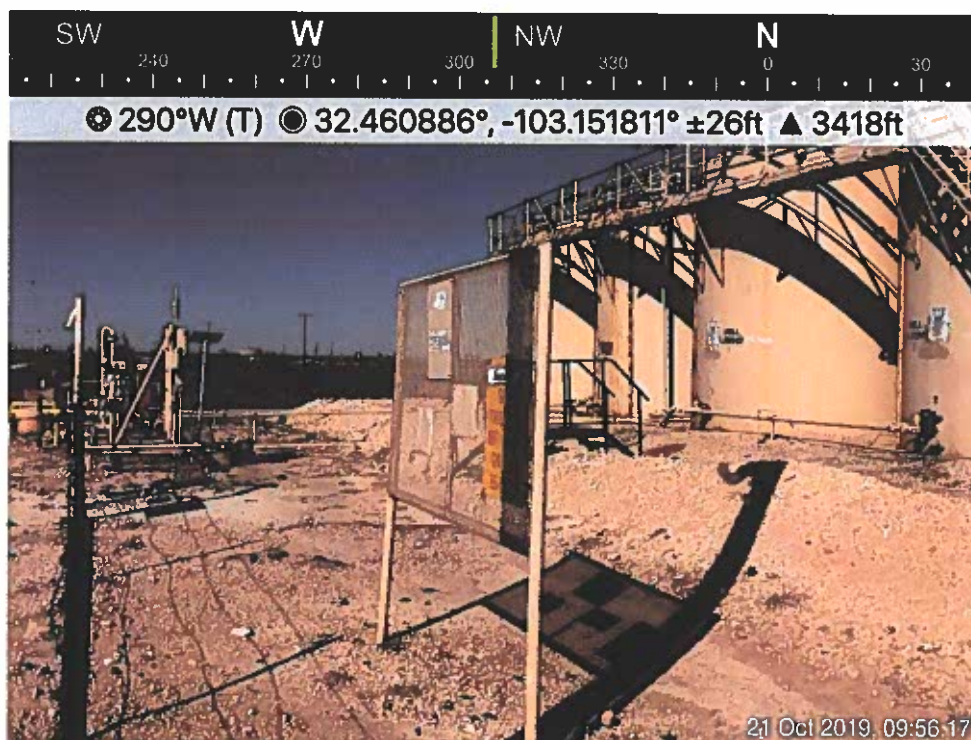
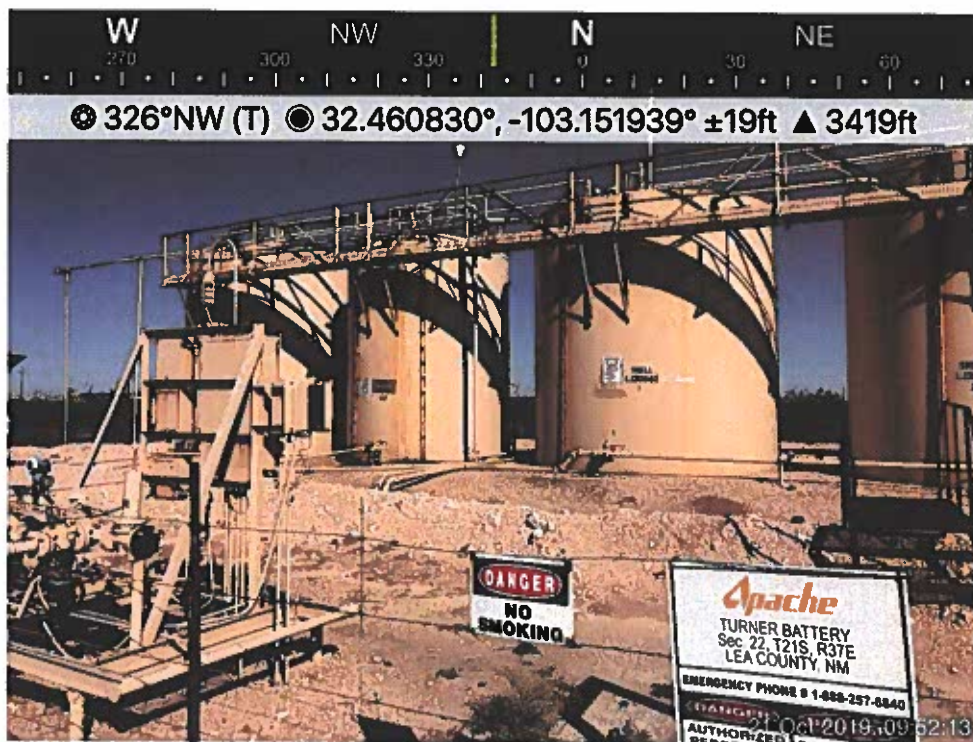

Apache Corporation – Turner Battery
Unit Letter "K" (NE/SW), Section 22, Township 21S, Range 37E

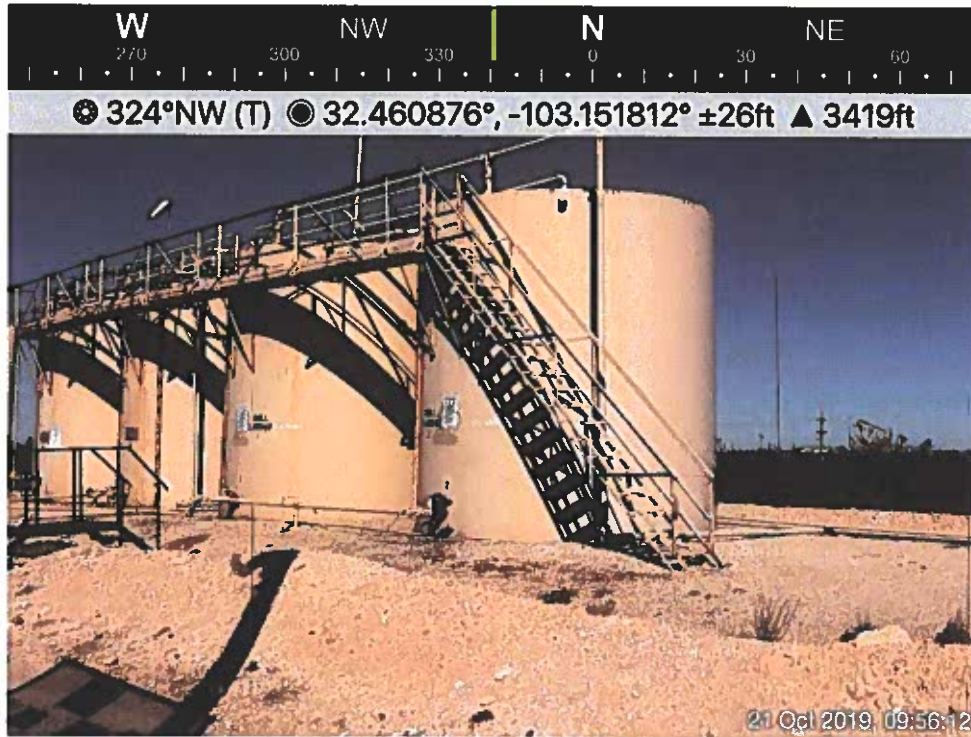

Apache Corporation – Turner Battery
Unit Letter "K" (NE/SW), Section 22, Township 21S, Range 37E

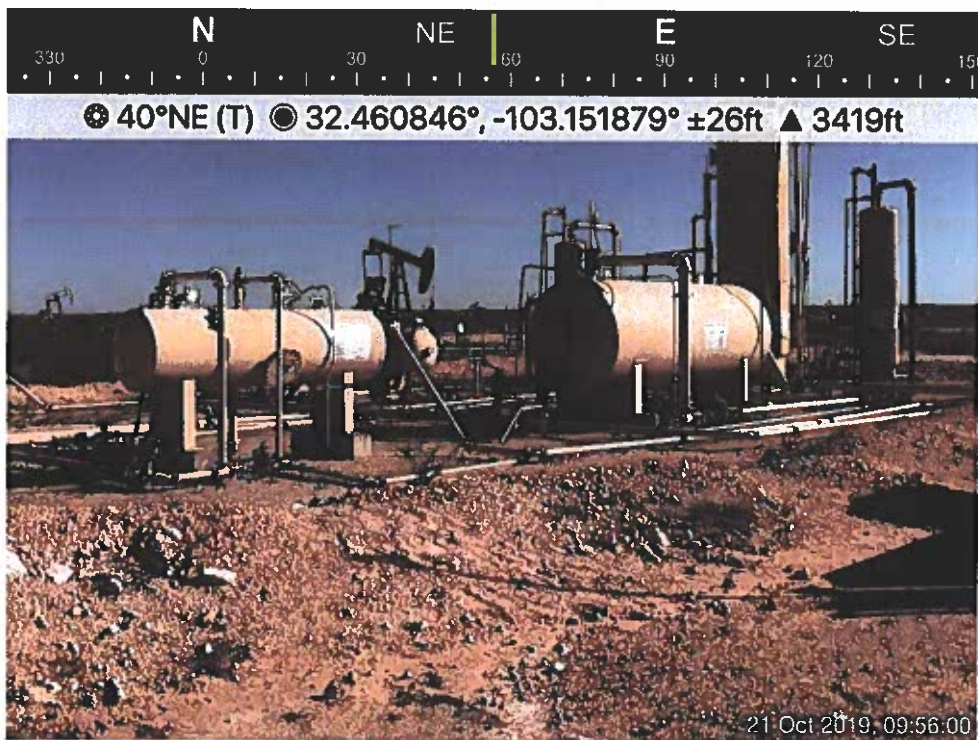
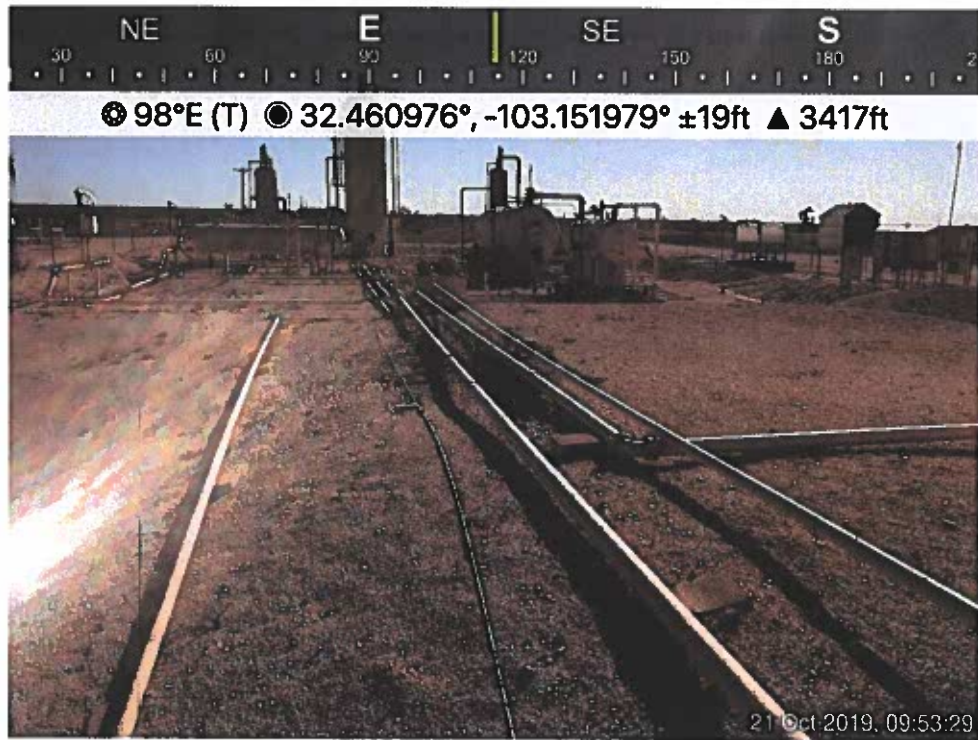

Appendix C

Closure Criteria Justification

**TABLE 3
CLOSURE CRITERIA JUSTIFICATION**

**APACHE CORPORATION
TURNER BATTERY
LEA COUNTY, NEW MEXICO
NMOCD REFERENCE #: 1RP-2304**



Groundwater, Water Wells & Other Water Sources	
Depth to groundwater (ft)?	70
Horizontal distance (ft) from all water sources within 0.5 miles?	1,505 - 2,612
Within 500' of a spring or a private, domestic fresh water well used by less than 5 households for domestic or stock watering purposes?	No
Within 1000' of any fresh water well or spring?	No
Surface Water	
Horizontal distance (ft) to nearest significant watercourse?	>1,000
Within 300' of any continuously flowing watercourse or any other significant watercourse?	No
Within 200' of any lakebed, sinkhole or playa lake?	No
Human-Occupied, Environmental & Other Areas	
Within incorporated municipal boundaries or within a defined municipal fresh water well field?	No
Within 300' of an occupied permanent residence, school, hospital, institution or church?	No
Within 300' of a wetland?	No
Within the area overlying a subsurface mine?	No
Within an unstable area?	No
Within a 100-year floodplain?	No

Closure Criteria (mg/kg)*				
Benzene	BTEX	GRO + DRO	TPH	Chloride
10	50	1,000	2,500	10,000

*Numerical limits or natural background level, whichever is greater

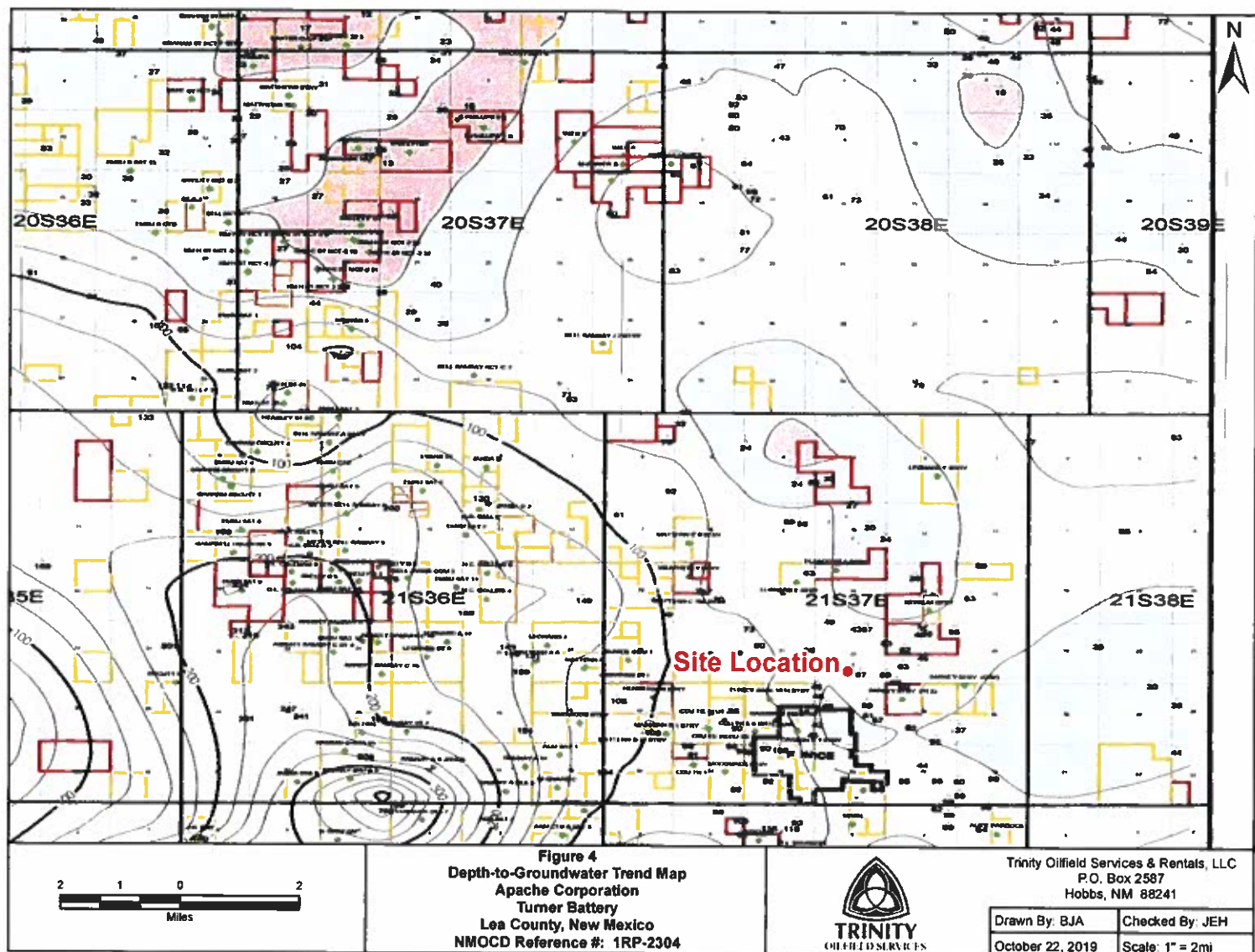

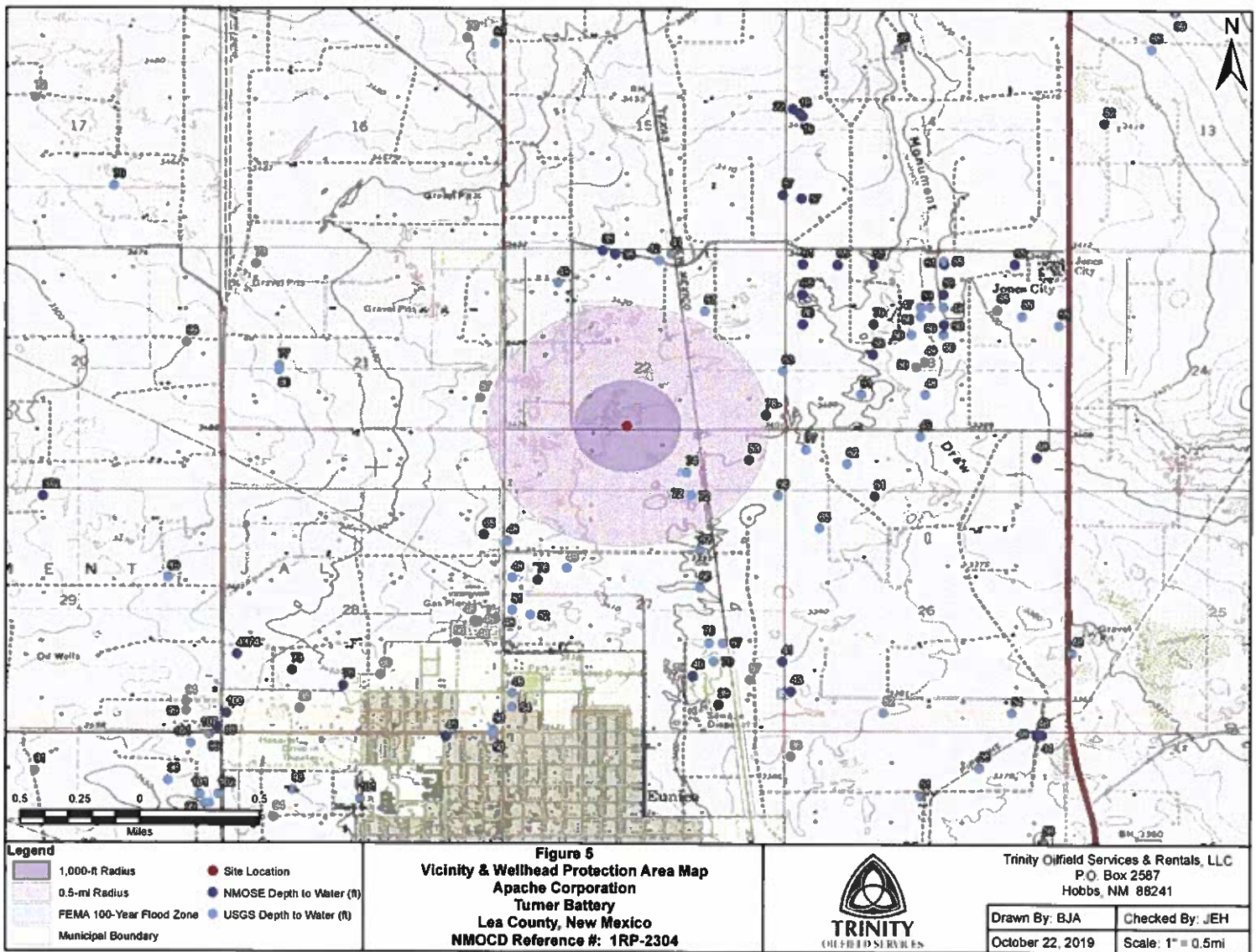



New Mexico Office of the State Engineer

Water Column/Average Depth to Water

(A CLW##### in the POD suffix indicates the POD has been replaced & no longer serves a water right file.)

(R=POD has been replaced, O=orphaned, C=the file is closed)

(quarters are 1=NW 2=NE 3=SW 4=SE)

(quarters are smallest to largest)

(NAD83 UTM in meters)

(In feet)

POD Number	POD Sub-Code	basin	County	Q 64	Q 16	Q 4	Sec	Tws	Rng	X	Y	Distance	Depth Well	Depth Water	Water Column
CP 00251 POD1	CP	LE		2	3	4	22	21S	37E	674099	3592915*	415	103		
CP 01636 POD3	CP	LE		2	2	1	27	21S	37E	673782	3592501	540	96		
CP 00733 POD1	CP	LE			3	3	22	21S	37E	673196	3592801*	558	7864		
CP 00732 POD1	CP	LE			4	1	22	21S	37E	673584	3593613*	588	6633		
CP 00017 POD1	CP	LE		2	1	2	27	21S	37E	674106	3592513*	661	101		
CP 00881	CP	LE			4	4	22	21S	37E	674402	3592824*	731	95	53	42
CP 00285 POD1	CP	LE		3	1	2	27	21S	37E	673906	3592313*	751	80		
CP 00252 POD1	CP	LE		4	2	4	22	21S	37E	674493	3593125*	795	106	78	28

Average Depth to Water: **65 feet**

Minimum Depth: **53 feet**

Maximum Depth: **78 feet**

Record Count: 8

UTM NAD83 Radius Search (in meters):

Easting (X): 673701.96

Northing (Y): 3593036.33

Radius: 804.67

*UTM location was derived from PLSS - see Help

The data is furnished by the NMOSE/ISC and is accepted by the recipient with the expressed understanding that the OSE/ISC make no warranties, expressed or implied, concerning the accuracy, completeness, reliability, usability, or suitability for any particular purpose of the data.

10/22/19 2:11 PM

Page 1 of 1

WATER COLUMN/ AVERAGE
DEPTH TO WATER

Appendix D

Laboratory Analytical Reports



PHONE (575) 393-2326 • 101 E. MARLAND • HOBBS, NM 88240

August 08, 2019

BRUCE BAKER

APACHE CORP - HOBBS

2350 W. MARLAND BLVD.

HOBBS, NM 88240

RE: TURNER BATTERY

Enclosed are the results of analyses for samples received by the laboratory on 08/02/19 15:50.

Cardinal Laboratories is accredited through Texas NELAP under certificate number T104704398-18-11. Accreditation applies to drinking water, non-potable water and solid and chemical materials. All accredited analytes are denoted by an asterisk (*). For a complete list of accredited analytes and matrices visit the TCEQ website at www.tceq.texas.gov/field/ga/lab_accred_certif.html.

Cardinal Laboratories is accredited through the State of Colorado Department of Public Health and Environment for:

Method EPA 552.2	Haloacetic Acids (HAA-5)
Method EPA 524.2	Total Trihalomethanes (TTHM)
Method EPA 524.4	Regulated VOCs (V1, V2, V3)

Accreditation applies to public drinking water matrices.

This report meets NELAP requirements and is made up of a cover page, analytical results, and a copy of the original chain-of-custody. If you have any questions concerning this report, please feel free to contact me.

Sincerely,

A handwritten signature in black ink, appearing to read "Mike Snyder", is written over a horizontal line.

Mike Snyder For Celey D. Keene

Lab Director/Quality Manager



PHONE (575) 393-2326 • 101 E. MARLAND • HOBBS, NM 88240

Analytical Results For:

APACHE CORP - HOBBS
 BRUCE BAKER
 2350 W. MARLAND BLVD.
 HOBBS NM, 88240
 Fax To: (575) 393-2432

Received: 08/02/2019
 Reported: 08/08/2019
 Project Name: TURNER BATTERY
 Project Number: NONE GIVEN
 Project Location: NONE GIVEN

Sampling Date: 08/02/2019
 Sampling Type: Soil
 Sampling Condition: Cool & Intact
 Sample Received By: Tamara Oldaker

Sample ID: SP - 1 SURFACE 32.460938 (H902660-01)

BTEX 8021B		mg/kg	Analyzed By: MS						
Analyte	Result	Reporting Limit	Analyzed	Method Blank	BS	% Recovery	True Value QC	RPD	Qualifier
Benzene*	<0.050	0.050	08/07/2019	ND	1.97	98.6	2.00	0.0670	
Toluene*	<0.050	0.050	08/07/2019	ND	2.00	100	2.00	0.0988	
Ethylbenzene*	<0.050	0.050	08/07/2019	ND	1.96	97.9	2.00	1.29	
Total Xylenes*	<0.150	0.150	08/07/2019	ND	5.99	99.8	6.00	1.39	
Total BTEX	<0.300	0.300	08/07/2019	ND					

Surrogate: 4-Bromofluorobenzene (PIE) 107 % 73.3-129

Chloride, SM4500Cl-B		mg/kg	Analyzed By: AC						
Analyte	Result	Reporting Limit	Analyzed	Method Blank	BS	% Recovery	True Value QC	RPD	Qualifier
Chloride	320	16.0	08/07/2019	ND	416	104	400	3.92	

TPH 8015M		mg/kg	Analyzed By: MS						
Analyte	Result	Reporting Limit	Analyzed	Method Blank	BS	% Recovery	True Value QC	RPD	Qualifier
GRO C6-C10*	<10.0	10.0	08/05/2019	ND	205	103	200	2.05	
DRO >C10-C28*	16.8	10.0	08/05/2019	ND	205	102	200	3.94	
EXT DRO >C28-C36	13.1	10.0	08/05/2019	ND					

Surrogate: 1-Chlorooctane 68.2 % 41-142

Surrogate: 1-Chlorooctadecane 69.0 % 37.6-147

Cardinal Laboratories

*=Accredited Analyte

PLEASE NOTE: Liability and Damages. Cardinal's liability and client's exclusive remedy for any claim arising, whether based in contract or tort, shall be limited to the amount paid by client for analyses. All claims, including those for negligence and any other cause whatsoever shall be deemed waived unless made in writing and received by Cardinal within thirty (30) days after completion of the applicable service. In no event shall Cardinal be liable for incidental or consequential damages, including, without limitation, business interruptions, loss of use, or loss of profits incurred by client, its subsidiaries, affiliates or successors arising out of or related to the performance of the services hereunder by Cardinal, regardless of whether such claim is based upon any of the above stated reasons or otherwise. Results relate only to the samples identified above. This report shall not be reproduced except in full with written approval of Cardinal Laboratories.

Mike Snyder For Celey D. Keene, Lab Director/Quality Manager



PHONE (575) 393-2326 • 101 E. MARLAND • HOBBS, NM 88240

Analytical Results For:

APACHE CORP - HOBBS
 BRUCE BAKER
 2350 W. MARLAND BLVD.
 HOBBS NM, 88240
 Fax To: (575) 393-2432

Received: 08/02/2019
 Reported: 08/08/2019
 Project Name: TURNER BATTERY
 Project Number: NONE GIVEN
 Project Location: NONE GIVEN

Sampling Date: 08/02/2019
 Sampling Type: Soil
 Sampling Condition: Cool & Intact
 Sample Received By: Tamara Oldaker

Sample ID: SP - 1 @ 1' -103.152039 (H902660-02)**BTEX 80218****mg/kg****Analyzed By: MS**

Analyte	Result	Reporting Limit	Analyzed	Method Blank	BS	% Recovery	True Value QC	RPD	Qualifier
Benzene*	<0.050	0.050	08/07/2019	ND	1.97	98.6	2.00	0.0670	
Toluene*	<0.050	0.050	08/07/2019	ND	2.00	100	2.00	0.0988	
Ethylbenzene*	<0.050	0.050	08/07/2019	ND	1.96	97.9	2.00	1.29	
Total Xylenes*	<0.150	0.150	08/07/2019	ND	5.99	99.8	6.00	1.39	
Total BTEX	<0.300	0.300	08/07/2019	ND					

Surrogate: 4-Bromofluorobenzene (PIE) 110 % 73.3-129

Chloride, SM4500Cl-B**mg/kg****Analyzed By: AC**

Analyte	Result	Reporting Limit	Analyzed	Method Blank	BS	% Recovery	True Value QC	RPD	Qualifier
Chloride	32.0	16.0	08/07/2019	ND	416	104	400	3.92	

TPH 8015M**mg/kg****Analyzed By: MS**

Analyte	Result	Reporting Limit	Analyzed	Method Blank	BS	% Recovery	True Value QC	RPD	Qualifier
GRO C6-C10*	<50.0	50.0	08/05/2019	ND	205	103	200	2.05	
DRO >C10-C28*	66.5	50.0	08/05/2019	ND	205	102	200	3.94	
EXT DRO >C28-C36	68.3	50.0	08/05/2019	ND					

Surrogate: 1-Chlorooctane 69.4 % 41-142

Surrogate: 1-Chlorooctadecane 79.4 % 37.6-147

Cardinal Laboratories

* = Accredited Analyte

PLEASE NOTE: Liability and Damages. Cardinal's liability and client's exclusive remedy for any claim arising, whether based in contract or tort, shall be limited to the amount paid by client for analyses. All claims, including those for negligence and any other cause whatsoever shall be deemed waived unless made in writing and received by Cardinal within thirty (30) days after completion of the applicable service. In no event shall Cardinal be liable for incidental or consequential damages, including, without limitation, business interruptions, loss of use, or loss of profits incurred by client, its subsidiaries, affiliates or successors arising out of or related to the performance of the services hereunder by Cardinal, regardless of whether such claim is based upon any of the above stated reasons or otherwise. Results relate only to the samples identified above. This report shall not be reproduced except in full with written approval of Cardinal Laboratories.

Mike Snyder For Celey D. Keene, Lab Director/Quality Manager



PHONE (575) 393-2326 • 101 E. MARLAND • HOBBS, NM 88240

Analytical Results For:

APACHE CORP - HOBBS
 BRUCE BAKER
 2350 W. MARLAND BLVD.
 HOBBS NM, 88240
 Fax To: (575) 393-2432

Received: 08/02/2019
 Reported: 08/08/2019
 Project Name: TURNER BATTERY
 Project Number: NONE GIVEN
 Project Location: NONE GIVEN

Sampling Date: 08/02/2019
 Sampling Type: Soil
 Sampling Condition: Cool & Intact
 Sample Received By: Tamara Oldaker

Sample ID: SP - 1 @ 2' (H902660-03)**BTEX 80218****mg/kg****Analyzed By: MS**

Analyte	Result	Reporting Limit	Analyzed	Method Blank	BS	% Recovery	True Value QC	RPD	Qualifier
Benzene*	<0.050	0.050	08/07/2019	ND	1.97	98.6	2.00	0.0670	
Toluene*	<0.050	0.050	08/07/2019	ND	2.00	100	2.00	0.0988	
Ethylbenzene*	<0.050	0.050	08/07/2019	ND	1.96	97.9	2.00	1.29	
Total Xylenes*	<0.150	0.150	08/07/2019	ND	5.99	99.8	6.00	1.39	
Total BTEX	<0.300	0.300	08/07/2019	ND					

Surrogate: 4-Bromofluorobenzene (PIC) 106 % 73.3-129

Chloride, SM4500Cl-B**mg/kg****Analyzed By: AC**

Analyte	Result	Reporting Limit	Analyzed	Method Blank	BS	% Recovery	True Value QC	RPD	Qualifier
Chloride	<16.0	16.0	08/07/2019	ND	416	104	400	3.92	

TPH 8015M**mg/kg****Analyzed By: MS**

Analyte	Result	Reporting Limit	Analyzed	Method Blank	BS	% Recovery	True Value QC	RPD	Qualifier
GRO C6-C10*	<50.0	50.0	08/05/2019	ND	205	103	200	2.05	
DRO >C10-C28*	232	50.0	08/05/2019	ND	205	102	200	3.94	
EXT DRO >C28-C36	223	50.0	08/05/2019	ND					

Surrogate: 1-Chlorooctane 73.0 % 41-142

Surrogate: 1-Chlorooctadecane 86.2 % 37.6-147

Cardinal Laboratories

* = Accredited Analyte

PLEASE NOTE: Liability and Damages. Cardinal's liability and client's exclusive remedy for any claim arising, whether based in contract or tort, shall be limited to the amount paid by client for analyses. All claims, including those for negligence and any other cause whatsoever shall be deemed waived unless made in writing and received by Cardinal within thirty (30) days after completion of the applicable service. In no event shall Cardinal be liable for incidental or consequential damages, including, without limitation, business interruptions, loss of use, or loss of profits incurred by client, its subsidiaries, affiliates or successors arising out of or related to the performance of the services hereunder by Cardinal, regardless of whether such claim is based upon any of the above stated reasons or otherwise. Results relate only to the samples identified above. This report shall not be reproduced except in full with written approval of Cardinal Laboratories.

Mike Snyder For Celey D. Keene, Lab Director/Quality Manager



PHONE (575) 393-2326 • 101 E. MARLAND • HOBBS, NM 88240

Analytical Results For:

APACHE CORP - HOBBS
 BRUCE BAKER
 2350 W. MARLAND BLVD.
 HOBBS NM, 88240
 Fax To: (575) 393-2432

Received: 08/02/2019
 Reported: 08/08/2019
 Project Name: TURNER BATTERY
 Project Number: NONE GIVEN
 Project Location: NONE GIVEN

Sampling Date: 08/02/2019
 Sampling Type: Soil
 Sampling Condition: Cool & Intact
 Sample Received By: Tamara Oldaker

Sample ID: SP - 2 SURFACE 32.461292 (H902660-04)**BTEX 8021B****mg/kg****Analyzed By: MS**

Analyte	Result	Reporting Limit	Analyzed	Method Blank	BS	% Recovery	True Value QC	RPD	Qualifier
Benzene*	<0.050	0.050	08/07/2019	ND	1.97	98.6	2.00	0.0670	
Toluene*	<0.050	0.050	08/07/2019	ND	2.00	100	2.00	0.0988	
Ethylbenzene*	<0.050	0.050	08/07/2019	ND	1.96	97.9	2.00	1.29	
Total Xylenes*	<0.150	0.150	08/07/2019	ND	5.99	99.8	6.00	1.39	
Total BTEX	<0.300	0.300	08/07/2019	ND					

Surrogate: 4-Bromofluorobenzene (PID) 106 % 73.3-129

Chloride, SM4500Cl-B**mg/kg****Analyzed By: AC**

Analyte	Result	Reporting Limit	Analyzed	Method Blank	BS	% Recovery	True Value QC	RPD	Qualifier
Chloride	<16.0	16.0	08/07/2019	ND	416	104	400	3.92	

TPH 8015M**mg/kg****Analyzed By: MS****S-06**

Analyte	Result	Reporting Limit	Analyzed	Method Blank	BS	% Recovery	True Value QC	RPD	Qualifier
GRO C6-C10*	<50.0	50.0	08/05/2019	ND	188	94.0	200	0.506	
DRO >C10-C28*	8060	50.0	08/05/2019	ND	189	94.7	200	1.05	
EXT DRO >C28-C36	4530	50.0	08/05/2019	ND					

Surrogate: 1-Chlorooctane 97.3 % 41-142

Surrogate: 1-Chlorooctadecane 340 % 37.6-147

Cardinal Laboratories

* = Accredited Analyte

PLEASE NOTE: Liability and Damages. Cardinal's liability and client's exclusive remedy for any claim arising, whether based in contract or tort, shall be limited to the amount paid by client for analyses. All claims, including those for negligence and any other cause whatsoever shall be deemed waived unless made in writing and received by Cardinal within thirty (30) days after completion of the applicable service. In no event shall Cardinal be liable for incidental or consequential damages, including, without limitation, business interruptions, loss of use, or loss of profits incurred by client, its subsidiaries, affiliates or successors arising out of or related to the performance of the services hereunder by Cardinal, regardless of whether such claim is based upon any of the above stated reasons or otherwise. Results relate only to the samples identified above. This report shall not be reproduced except in full with written approval of Cardinal Laboratories.

Mike Snyder For Celey D. Keene, Lab Director/Quality Manager



PHONE (575) 393-2326 • 101 E. MARLAND • HOBBS, NM 88240

Analytical Results For:

APACHE CORP - HOBBS
 BRUCE BAKER
 2350 W. MARLAND BLVD.
 HOBBS NM, 88240
 Fax To: (575) 393-2432

Received: 08/02/2019
 Reported: 08/08/2019
 Project Name: TURNER BATTERY
 Project Number: NONE GIVEN
 Project Location: NONE GIVEN

Sampling Date: 08/02/2019
 Sampling Type: Soil
 Sampling Condition: Cool & Intact
 Sample Received By: Tamara Oldaker

Sample ID: SP - 2 @ 1 -103.151627 (H902660-05)

BTEX 80218		mg/kg	Analyzed By: MS						
Analyte	Result	Reporting Limit	Analyzed	Method Blank	BS	% Recovery	True Value QC	RPD	Qualifier
Benzene*	<0.050	0.050	08/07/2019	ND	1.97	98.6	2.00	0.0670	
Toluene*	<0.050	0.050	08/07/2019	ND	2.00	100	2.00	0.0988	
Ethylbenzene*	<0.050	0.050	08/07/2019	ND	1.96	97.9	2.00	1.29	
Total Xylenes*	<0.150	0.150	08/07/2019	ND	5.99	99.8	6.00	1.39	
Total BTEX	<0.300	0.300	08/07/2019	ND					

Surrogate: 4-Bromofluorobenzene (PIL) 105 % 73.3-129

Chloride, SM4500Cl-B		mg/kg	Analyzed By: AC						
Analyte	Result	Reporting Limit	Analyzed	Method Blank	BS	% Recovery	True Value QC	RPD	Qualifier
Chloride	<16.0	16.0	08/07/2019	ND	416	104	400	3.92	

TPH 8015M		mg/kg	Analyzed By: MS						
Analyte	Result	Reporting Limit	Analyzed	Method Blank	BS	% Recovery	True Value QC	RPD	Qualifier
GRO C6-C10*	<10.0	10.0	08/06/2019	ND	188	94.0	200	0.506	
DRO >C10-C28*	555	10.0	08/06/2019	ND	189	94.7	200	1.05	
EXT DRO >C28-C36	470	10.0	08/06/2019	ND					

Surrogate: 1-Chlorooctane 100 % 41-142

Surrogate: 1-Chlorooctadecane 131 % 37.6-147

Cardinal Laboratories

*=Accredited Analyte

PLEASE NOTE: Liability and Damages. Cardinal's liability and client's exclusive remedy for any claim arising, whether based in contract or tort, shall be limited to the amount paid by client for analyses. All claims, including those for negligence and any other cause whatsoever shall be deemed waived unless made in writing and received by Cardinal within thirty (30) days after completion of the applicable service. In no event shall Cardinal be liable for incidental or consequential damages, including, without limitation, business interruptions, loss of use, or loss of profits incurred by client, its subsidiaries, affiliates or successors arising out of or related to the performance of the services hereunder by Cardinal, regardless of whether such claim is based upon any of the above stated reasons or otherwise. Results relate only to the samples identified above. This report shall not be reproduced except in full with written approval of Cardinal Laboratories.

Mike Snyder For Celey D. Keene, Lab Director/Quality Manager



PHONE (575) 393-2326 • 101 E. MARLAND • HOBBS, NM 88240

Analytical Results For:

APACHE CORP - HOBBS
 BRUCE BAKER
 2350 W. MARLAND BLVD.
 HOBBS NM, 88240
 Fax To: (575) 393-2432

Received: 08/02/2019
 Reported: 08/08/2019
 Project Name: TURNER BATTERY
 Project Number: NONE GIVEN
 Project Location: NONE GIVEN

Sampling Date: 08/02/2019
 Sampling Type: Soil
 Sampling Condition: Cool & Intact
 Sample Received By: Tamara Oldaker

Sample ID: SP - 2 @ 2' (H902660-06)

BTEX 8021B		mg/kg	Analyzed By: MS						
Analyte	Result	Reporting Limit	Analyzed	Method Blank	BS	% Recovery	True Value QC	RPD	Qualifier
Benzene*	<0.050	0.050	08/07/2019	ND	1.97	98.6	2.00	0.0670	
Toluene*	<0.050	0.050	08/07/2019	ND	2.00	100	2.00	0.0988	
Ethylbenzene*	<0.050	0.050	08/07/2019	ND	1.96	97.9	2.00	1.29	
Total Xylenes*	<0.150	0.150	08/07/2019	ND	5.99	99.8	6.00	1.39	
Total BTEX	<0.300	0.300	08/07/2019	ND					

Surrogate: 4-Bromofluorobenzene (PIE) 106 % 73.3-129

Chloride, SM4500Cl-B		mg/kg	Analyzed By: AC						
Analyte	Result	Reporting Limit	Analyzed	Method Blank	BS	% Recovery	True Value QC	RPD	Qualifier
Chloride	16.0	16.0	08/07/2019	ND	416	104	400	3.92	

TPH 8015M		mg/kg	Analyzed By: MS						
Analyte	Result	Reporting Limit	Analyzed	Method Blank	BS	% Recovery	True Value QC	RPD	Qualifier
GRO C6-C10*	<10.0	10.0	08/06/2019	ND	188	94.0	200	0.506	
DRO >C10-C28*	360	10.0	08/06/2019	ND	189	94.7	200	1.05	
EXT DRO >C28-C36	341	10.0	08/06/2019	ND					

Surrogate: 1-Chlorooctane 99.8 % 41-142

Surrogate: 1-Chlorooctadecane 134 % 37.6-147

Cardinal Laboratories

*=Accredited Analyte

PLEASE NOTE: Liability and Damages. Cardinal's liability and client's exclusive remedy for any claim arising, whether based in contract or tort, shall be limited to the amount paid by client for analyses. All claims, including those for negligence and any other cause whatsoever shall be deemed waived unless made in writing and received by Cardinal within thirty (30) days after completion of the applicable service. In no event shall Cardinal be liable for incidental or consequential damages, including, without limitation, business interruptions, loss of use, or loss of profits incurred by client, its subsidiaries, affiliates or successors arising out of or related to the performance of the services hereunder by Cardinal, regardless of whether such claim is based upon any of the above stated reasons or otherwise. Results relate only to the samples identified above. This report shall not be reproduced except in full with written approval of Cardinal Laboratories.

Mike Snyder For Celey D. Keene, Lab Director/Quality Manager



PHONE (575) 393-2326 • 101 E. MARLAND • HOBBS, NM 88240

Analytical Results For:

APACHE CORP - HOBBS
 BRUCE BAKER
 2350 W. MARLAND BLVD.
 HOBBS NM, 88240
 Fax To: (575) 393-2432

Received: 08/02/2019
 Reported: 08/08/2019
 Project Name: TURNER BATTERY
 Project Number: NONE GIVEN
 Project Location: NONE GIVEN

Sampling Date: 08/02/2019
 Sampling Type: Soil
 Sampling Condition: Cool & Intact
 Sample Received By: Tamara Oldaker

Sample ID: SP - 3 SURFACE 32.461021 (H902660-07)**BTEX 8021B**

mg/kg

Analyzed By: MS

Analyte	Result	Reporting Limit	Analyzed	Method Blank	BS	% Recovery	True Value QC	RPD	Qualifier
Benzene*	<0.050	0.050	08/07/2019	ND	1.97	98.6	2.00	0.0670	
Toluene*	<0.050	0.050	08/07/2019	ND	2.00	100	2.00	0.0988	
Ethylbenzene*	<0.050	0.050	08/07/2019	ND	1.96	97.9	2.00	1.29	
Total Xylenes*	<0.150	0.150	08/07/2019	ND	5.99	99.8	6.00	1.39	
Total BTEX	<0.300	0.300	08/07/2019	ND					

Surrogate: 4-Bromofluorobenzene (PIE) 105 % 73.3-129

Chloride, SM4500Cl-B

mg/kg

Analyzed By: AC

Analyte	Result	Reporting Limit	Analyzed	Method Blank	BS	% Recovery	True Value QC	RPD	Qualifier
Chloride	112	16.0	08/07/2019	ND	416	104	400	3.92	

TPH 8015M

mg/kg

Analyzed By: MS

Analyte	Result	Reporting Limit	Analyzed	Method Blank	BS	% Recovery	True Value QC	RPD	Qualifier
GRO C6-C10*	<10.0	10.0	08/05/2019	ND	188	94.0	200	0.506	
DRO >C10-C28*	<10.0	10.0	08/05/2019	ND	189	94.7	200	1.05	
EXT DRO >C28-C36	<10.0	10.0	08/05/2019	ND					

Surrogate: 1-Chlorooctane 96.3 % 41-142

Surrogate: 1-Chlorooctadecane 92.5 % 37.6-147

Cardinal Laboratories

*=Accredited Analyte

PLEASE NOTE: Liability and Damages. Cardinal's liability and client's exclusive remedy for any claim arising, whether based in contract or tort, shall be limited to the amount paid by client for analyses. All claims, including those for negligence and any other cause whatsoever shall be deemed waived unless made in writing and received by Cardinal within thirty (30) days after completion of the applicable service. In no event shall Cardinal be liable for incidental or consequential damages, including, without limitation, business interruptions, loss of use, or loss of profits incurred by client, its subsidiaries, affiliates or successors arising out of or related to the performance of the services hereunder by Cardinal, regardless of whether such claim is based upon any of the above stated reasons or otherwise. Results relate only to the samples identified above. This report shall not be reproduced except in full with written approval of Cardinal Laboratories.

Mike Snyder For Celey D. Keene, Lab Director/Quality Manager



PHONE (575) 393-2326 • 101 E. MARLAND • HOBBS, NM 88240

Analytical Results For:

APACHE CORP - HOBBS
 BRUCE BAKER
 2350 W. MARLAND BLVD.
 HOBBS NM, 88240
 Fax To: (575) 393-2432

Received: 08/02/2019
 Reported: 08/08/2019
 Project Name: TURNER BATTERY
 Project Number: NONE GIVEN
 Project Location: NONE GIVEN

Sampling Date: 08/02/2019
 Sampling Type: Soil
 Sampling Condition: Cool & Intact
 Sample Received By: Tamara Oldaker

Sample ID: SP - 3 @ 1' -103.152031 (H902660-08)**BTEX 80218****mg/kg****Analyzed By: MS**

Analyte	Result	Reporting Limit	Analyzed	Method Blank	BS	% Recovery	True Value QC	RPD	Qualifier
Benzene*	<0.050	0.050	08/08/2019	ND	1.97	98.6	2.00	0.0670	
Toluene*	<0.050	0.050	08/08/2019	ND	2.00	100	2.00	0.0988	
Ethylbenzene*	<0.050	0.050	08/08/2019	ND	1.96	97.9	2.00	1.29	
Total Xylenes*	<0.150	0.150	08/08/2019	ND	5.99	99.8	6.00	1.39	
Total BTEX	<0.300	0.300	08/08/2019	ND					

Surrogate: 4-Bromofluorobenzene (PIC) 106 % 73.3-129

Chloride, SM4500Cl-B**mg/kg****Analyzed By: AC**

Analyte	Result	Reporting Limit	Analyzed	Method Blank	BS	% Recovery	True Value QC	RPD	Qualifier
Chloride	80.0	16.0	08/07/2019	ND	416	104	400	3.92	

TPH 8015M**mg/kg****Analyzed By: MS**

Analyte	Result	Reporting Limit	Analyzed	Method Blank	BS	% Recovery	True Value QC	RPD	Qualifier
GRO C6-C10*	<10.0	10.0	08/05/2019	ND	188	94.0	200	0.506	
DRO >C10-C28*	<10.0	10.0	08/05/2019	ND	189	94.7	200	1.05	
EXT DRO >C28-C36	<10.0	10.0	08/05/2019	ND					

Surrogate: 1-Chlorooctane 91.4 % 41-142

Surrogate: 1-Chlorooctadecane 87.7 % 37.6-147

Cardinal Laboratories

* = Accredited Analyte

PLEASE NOTE: Liability and Damages. Cardinal's liability and client's exclusive remedy for any claim arising, whether based in contract or tort, shall be limited to the amount paid by client for analyses. All claims, including those for negligence and any other cause whatsoever shall be deemed waived unless made in writing and received by Cardinal within thirty (30) days after completion of the applicable service. In no event shall Cardinal be liable for incidental or consequential damages, including, without limitation, business interruptions, loss of use, or loss of profits incurred by client, its subsidiaries, affiliates or successors arising out of or related to the performance of the services hereunder by Cardinal, regardless of whether such claim is based upon any of the above stated reasons or otherwise. Results relate only to the samples identified above. This report shall not be reproduced except in full with written approval of Cardinal Laboratories.

Mike Snyder For Celey D. Keene, Lab Director/Quality Manager



PHONE (575) 393-2326 • 101 E. MARLAND • HOBBS, NM 88240

Analytical Results For:

APACHE CORP - HOBBS
 BRUCE BAKER
 2350 W. MARLAND BLVD.
 HOBBS NM, 88240
 Fax To: (575) 393-2432

Received: 08/02/2019
 Reported: 08/08/2019
 Project Name: TURNER BATTERY
 Project Number: NONE GIVEN
 Project Location: NONE GIVEN

Sampling Date: 08/02/2019
 Sampling Type: Soil
 Sampling Condition: Cool & Intact
 Sample Received By: Tamara Oldaker

Sample ID: SP - 3 @ 2' (H902660-09)

BTEX 80218		mg/kg		Analyzed By: MS					
Analyte	Result	Reporting Limit	Analyzed	Method Blank	BS	% Recovery	True Value QC	RPD	Qualifier
Benzene*	<0.050	0.050	08/08/2019	ND	1.97	98.6	2.00	0.0670	
Toluene*	<0.050	0.050	08/08/2019	ND	2.00	100	2.00	0.0988	
Ethylbenzene*	<0.050	0.050	08/08/2019	ND	1.96	97.9	2.00	1.29	
Total Xylenes*	<0.150	0.150	08/08/2019	ND	5.99	99.8	6.00	1.39	
Total BTEX	<0.300	0.300	08/08/2019	ND					

Surrogate: 4-Bromofluorobenzene (PIE) 107 % 73.3-129

Chloride, SM4500Cl-B		mg/kg		Analyzed By: AC					
Analyte	Result	Reporting Limit	Analyzed	Method Blank	BS	% Recovery	True Value QC	RPD	Qualifier
Chloride	48.0	16.0	08/07/2019	ND	416	104	400	3.92	

TPH 8015M		mg/kg		Analyzed By: MS					
Analyte	Result	Reporting Limit	Analyzed	Method Blank	BS	% Recovery	True Value QC	RPD	Qualifier
GRO C6-C10*	<10.0	10.0	08/05/2019	ND	188	94.0	200	0.506	
DRO >C10-C28*	<10.0	10.0	08/05/2019	ND	189	94.7	200	1.05	
EXT DRO >C28-C36	<10.0	10.0	08/05/2019	ND					

Surrogate: 1-Chlorooctane 90.6 % 41-142

Surrogate: 1-Chlorooctadecane 86.0 % 37.6-147

Cardinal Laboratories

* = Accredited Analyte

PLEASE NOTE: Liability and Damages. Cardinal's liability and client's exclusive remedy for any claim arising, whether based in contract or tort, shall be limited to the amount paid by client for analyses. All claims, including those for negligence and any other cause whatsoever shall be deemed waived unless made in writing and received by Cardinal within thirty (30) days after completion of the applicable service. In no event shall Cardinal be liable for incidental or consequential damages, including, without limitation, business interruptions, loss of use, or loss of profits incurred by client, its subsidiaries, affiliates or successors arising out of or related to the performance of the services hereunder by Cardinal, regardless of whether such claim is based upon any of the above stated reasons or otherwise. Results relate only to the samples identified above. This report shall not be reproduced except in full with written approval of Cardinal Laboratories.

Mike Snyder For Celey D. Keene, Lab Director/Quality Manager



PHONE (575) 393-2326 • 101 E. MARLAND • HOBBS, NM 88240

Analytical Results For:

APACHE CORP - HOBBS
 BRUCE BAKER
 2350 W. MARLAND BLVD.
 HOBBS NM, 88240
 Fax To: (575) 393-2432

Received: 08/02/2019
 Reported: 08/08/2019
 Project Name: TURNER BATTERY
 Project Number: NONE GIVEN
 Project Location: NONE GIVEN

Sampling Date: 08/02/2019
 Sampling Type: Soil
 Sampling Condition: Cool & Intact
 Sample Received By: Tamara Oldaker

Sample ID: SP - 4 SURFACE (H902660-10)**BTEX 8021B****mg/kg****Analyzed By: ms**

Analyte	Result	Reporting Limit	Analyzed	Method Blank	BS	% Recovery	True Value QC	RPD	Qualifier
Benzene*	<0.050	0.050	08/06/2019	ND	1.98	98.9	2.00	0.851	
Toluene*	<0.050	0.050	08/06/2019	ND	2.05	102	2.00	0.652	
Ethylbenzene*	<0.050	0.050	08/06/2019	ND	1.94	96.8	2.00	0.429	
Total Xylenes*	<0.150	0.150	08/06/2019	ND	5.90	98.3	6.00	0.117	
Total BTEX	<0.300	0.300	08/06/2019	ND					

Surrogate: 4-Bromofluorobenzene (PID) 102 % 73.3-129

Chloride, SM4500Cl-B**mg/kg****Analyzed By: AC**

Analyte	Result	Reporting Limit	Analyzed	Method Blank	BS	% Recovery	True Value QC	RPD	Qualifier
Chloride	16.0	16.0	08/07/2019	ND	416	104	400	3.92	

TPH 8015M**mg/kg****Analyzed By: MS**

Analyte	Result	Reporting Limit	Analyzed	Method Blank	BS	% Recovery	True Value QC	RPD	Qualifier
GRO C6-C10*	<10.0	10.0	08/06/2019	ND	188	94.0	200	0.506	
DRO >C10-C28*	216	10.0	08/06/2019	ND	189	94.7	200	1.05	
EXT DRO >C28-C36	173	10.0	08/06/2019	ND					

Surrogate: 1-Chlorooctane 98.0 % 41-142

Surrogate: 1-Chlorooctadecane 116 % 37.6-147

Cardinal Laboratories

*=Accredited Analyte

PLEASE NOTE: Liability and Damages. Cardinal's liability and client's exclusive remedy for any claim arising, whether based in contract or tort, shall be limited to the amount paid by client for analyses. All claims, including those for negligence and any other cause whatsoever shall be deemed waived unless made in writing and received by Cardinal within thirty (30) days after completion of the applicable service. In no event shall Cardinal be liable for incidental or consequential damages, including, without limitation, business interruptions, loss of use, or loss of profits incurred by client, its subsidiaries, affiliates or successors arising out of or related to the performance of the services hereunder by Cardinal, regardless of whether such claim is based upon any of the above stated reasons or otherwise. Results relate only to the samples identified above. This report shall not be reproduced except in full with written approval of Cardinal Laboratories.

Mike Snyder For Celey D. Keene, Lab Director/Quality Manager



PHONE (575) 393-2326 • 101 E. MARLAND • HOBBS, NM 88240

Analytical Results For:

APACHE CORP - HOBBS
 BRUCE BAKER
 2350 W. MARLAND BLVD.
 HOBBS NM, 88240
 Fax To: (575) 393-2432

Received: 08/02/2019
 Reported: 08/08/2019
 Project Name: TURNER BATTERY
 Project Number: NONE GIVEN
 Project Location: NONE GIVEN

Sampling Date: 08/02/2019
 Sampling Type: Soil
 Sampling Condition: Cool & Intact
 Sample Received By: Tamara Oldaker

Sample ID: SP - 4 @ 1' 32.440102 (H902660-11)**BTEX 8021B****mg/kg****Analyzed By: ms**

Analyte	Result	Reporting Limit	Analyzed	Method Blank	BS	% Recovery	True Value QC	RPD	Qualifier
Benzene*	<0.050	0.050	08/06/2019	ND	1.98	98.9	2.00	0.851	
Toluene*	<0.050	0.050	08/06/2019	ND	2.05	102	2.00	0.652	
Ethylbenzene*	<0.050	0.050	08/06/2019	ND	1.94	96.8	2.00	0.429	
Total Xylenes*	<0.150	0.150	08/06/2019	ND	5.90	98.3	6.00	0.117	
Total BTEX	<0.300	0.300	08/06/2019	ND					

Surrogate: 4-Bromofluorobenzene (PIE) 102 % 73.3-129

Chloride, SM4500Cl-B**mg/kg****Analyzed By: AC**

Analyte	Result	Reporting Limit	Analyzed	Method Blank	BS	% Recovery	True Value QC	RPD	Qualifier
Chloride	16.0	16.0	08/07/2019	ND	416	104	400	3.92	

TPH 8015M**mg/kg****Analyzed By: MS****S-06**

Analyte	Result	Reporting Limit	Analyzed	Method Blank	BS	% Recovery	True Value QC	RPD	Qualifier
GRO C6-C10*	<50.0	50.0	08/05/2019	ND	188	94.0	200	0.506	
DRO >C10-C28*	5180	50.0	08/05/2019	ND	189	94.7	200	1.05	
EXT DRO >C28-C36	2700	50.0	08/05/2019	ND					

Surrogate: 1-Chlorooctane 103 % 41-142

Surrogate: 1-Chlorooctadecane 406 % 37.6-147

Cardinal Laboratories

* = Accredited Analyte

PLEASE NOTE: Liability and Damages. Cardinal's liability and client's exclusive remedy for any claim arising, whether based in contract or tort, shall be limited to the amount paid by client for analyses. All claims, including those for negligence and any other cause whatsoever shall be deemed waived unless made in writing and received by Cardinal within thirty (30) days after completion of the applicable service. In no event shall Cardinal be liable for incidental or consequential damages, including, without limitation, business interruptions, loss of use, or loss of profits incurred by client, its subsidiaries, affiliates or successors arising out of or related to the performance of the services hereunder by Cardinal, regardless of whether such claim is based upon any of the above stated reasons or otherwise. Results relate only to the samples identified above. This report shall not be reproduced except in full with written approval of Cardinal Laboratories.

Mike Snyder For Celey D. Keene, Lab Director/Quality Manager



PHONE (575) 393-2326 • 101 E. MARLAND • HOBBS, NM 88240

Analytical Results For:

APACHE CORP - HOBBS
 BRUCE BAKER
 2350 W. MARLAND BLVD.
 HOBBS NM, 88240
 Fax To: (575) 393-2432

Received: 08/02/2019
 Reported: 08/08/2019
 Project Name: TURNER BATTERY
 Project Number: NONE GIVEN
 Project Location: NONE GIVEN

Sampling Date: 08/02/2019
 Sampling Type: Soil
 Sampling Condition: Cool & Intact
 Sample Received By: Tamara Oldaker

Sample ID: SP - 4 @ 2' -103.178841 (H902660-12)**BTEX 8021B****mg/kg****Analyzed By: ms**

Analyte	Result	Reporting Limit	Analyzed	Method Blank	BS	% Recovery	True Value QC	RPD	Qualifier
Benzene*	<0.050	0.050	08/06/2019	ND	1.98	98.9	2.00	0.851	
Toluene*	<0.050	0.050	08/06/2019	ND	2.05	102	2.00	0.652	
Ethylbenzene*	<0.050	0.050	08/06/2019	ND	1.94	96.8	2.00	0.429	
Total Xylenes*	<0.150	0.150	08/06/2019	ND	5.90	98.3	6.00	0.117	
Total BTEX	<0.300	0.300	08/06/2019	ND					

Surrogate: 4-Bromofluorobenzene (PIC) 101 % 73.3-129

Chloride, SM4500Cl-B**mg/kg****Analyzed By: AC**

Analyte	Result	Reporting Limit	Analyzed	Method Blank	BS	% Recovery	True Value QC	RPD	Qualifier
Chloride	<16.0	16.0	08/07/2019	ND	416	104	400	3.92	

TPH 8015M**mg/kg****Analyzed By: MS****S-06**

Analyte	Result	Reporting Limit	Analyzed	Method Blank	BS	% Recovery	True Value QC	RPD	Qualifier
GRO C6-C10*	<50.0	50.0	08/05/2019	ND	188	94.0	200	0.506	
DRO >C10-C28*	2440	50.0	08/05/2019	ND	189	94.7	200	1.05	
EXT DRO >C28-C36	1160	50.0	08/05/2019	ND					

Surrogate: 1-Chlorooctane 103 % 41-142

Surrogate: 1-Chlorooctadecane 273 % 37.6-147

Cardinal Laboratories

*=Accredited Analyte

PLEASE NOTE: Liability and Damages. Cardinal's liability and client's exclusive remedy for any claim arising, whether based in contract or tort, shall be limited to the amount paid by client for analyses. All claims, including those for negligence and any other cause whatsoever shall be deemed waived unless made in writing and received by Cardinal within thirty (30) days after completion of the applicable service. In no event shall Cardinal be liable for incidental or consequential damages, including, without limitation, business interruptions, loss of use, or loss of profits incurred by client, its subsidiaries, affiliates or successors arising out of or related to the performance of the services hereunder by Cardinal, regardless of whether such claim is based upon any of the above stated warranties or otherwise. Results relate only to the samples identified above. This report shall not be reproduced except in full with written approval of Cardinal Laboratories.

Mike Snyder For Celey D. Keene, Lab Director/Quality Manager



PHONE (575) 393-2326 • 101 E. MARLAND • HOBBS, NM 88240

Notes and Definitions

- S-06 The recovery of this surrogate is outside control limits due to sample dilution required from high analyte concentration and/or matrix interference's.
- QM-07 The spike recovery was outside acceptance limits for the MS and/or MSD. The batch was accepted based on acceptable LCS recovery.
- ND Analyte NOT DETECTED at or above the reporting limit
- RPD Relative Percent Difference
- ** Samples not received at proper temperature of 6°C or below.
- *** Insufficient time to reach temperature.
- Chloride by SM4500Cl-B does not require samples be received at or below 6°C
Samples reported on an as received basis (wet) unless otherwise noted on report

Cardinal Laboratories

*=Accredited Analyte

PLEASE NOTE: Liability and Damages. Cardinal's liability and client's exclusive remedy for any claim arising, whether based in contract or tort, shall be limited to the amount paid by client for analyses. All claims, including those for negligence and any other cause whatsoever shall be deemed waived unless made in writing and received by Cardinal within thirty (30) days after completion of the applicable service. In no event shall Cardinal be liable for incidental or consequential damages, including, without limitation, business interruptions, loss of use, or loss of profits incurred by client, its subsidiaries, affiliates or successors arising out of or related to the performance of the services hereunder by Cardinal, regardless of whether such claim is based upon any of the above stated reasons or otherwise. Results relate only to the samples identified above. This report shall not be reproduced except in full with written approval of Cardinal Laboratories.

Mike Snyder For Celey D. Keene, Lab Director/Quality Manager

Page 14 of 16

101 East Marland, Hobbs, NM 88240
(575) 393-2326 FAX (575) 393-2476

Company Name: Apache Corporation Project Manager: Bruce Baker				BILL TO				ANALYSIS REQUEST													
Address:				P.O. #:																	
City:		State:		Zip:		Company:															
Phone #:		Fax #:		Attn:																	
Project #:		Project Owner:		Address:																	
Project Name: Turner Battery				City:																	
Project Location: TURNER BATTERY				State:				Zip:													
Sampler Name: Daniel Raster				Phone #:																	
Fax #:																					

FOR LAB USE ONLY		G/RAB OR (COMP. # CONTAINERS)	# GROUNDWATER	MATRIX					PRESERV.	SAMPLING		CL	EXT TPH	BTX		
Lab I.D.	Sample I.D.			WASTEWATER	SOIL	SOLID	SLUDGE	OTHER :		ACID/BASE	ICE / COOL				OTHER :	DATE
H902660	1 SP-1 surface 32.460938															
	2 SP-1 @ 1-103-152039															
	3 SP-1 @ 2															
	4 SP-2 Surface 32.461292															
	5 SP-2 @ 1 -103-151627															
	6 SP-2 @ 2															
	7 SP-3 surface 32.461021															
	8 SP-3 @ 1 -103-152031															
	9 SP-3 @ 2															
	10 SP-4 Surface															

PLEASE NOTE: Liability and Damages. Cardinal's liability and client's exclusive remedy for any claim arising whether based in contract or tort, shall be limited to the amount paid by the client for the analysis. All claims, including those for negligence and any other cause whatsoever shall be deemed waived unless made in writing and received by Cardinal within 30 days after completion of the applicable service. In no event shall Cardinal be liable for incidental or consequential damages, including without limitation, business interruption, loss of use, or loss of profits incurred by client, its subsidiaries, affiliates or successors arising out of or related to the performance of services hereunder by Cardinal, regardless of whether such claim is based upon any of the above stated reasons or otherwise.

Relinquished By: 	Date: 8-2-19	Received By: 	Phone Result: <input type="checkbox"/> Yes <input checked="" type="checkbox"/> No	Add'l Phone #:
	Time: 10:50		Fax Result: <input type="checkbox"/> Yes <input checked="" type="checkbox"/> No	Add'l Fax #:
Relinquished By:	Date:	Received By:	REMARKS:	
	Time:			

Delivered By: (Circle One) 1.3c	#97	Sample Condition Cool Intact <input checked="" type="checkbox"/> Yes <input type="checkbox"/> No	CHECKED BY: (Initials) ro.
Sampler - UPS - Bus - Other: Corrected 1.7c			

Page 16 of 16



CHAIN-OF-CUSTODY AND ANALYSIS REQUEST

101 East Marland, Hobbs, NM 88240
(575) 393-2326 FAX (575) 393-2476

Company Name: <u>Apache Corporation</u>		BILL TO		ANALYSIS REQUEST																						
Project Manager: <u>Bruce Baker</u>		P.O. #:		<div style="display: flex; justify-content: space-around;"> <div>CL</div> <div>EXT TPH</div> <div>BIEX</div> </div>																						
Address:		Company:																								
City:	State: Zip:	Attn:																								
Phone #:	Fax #:	Address:																								
Project #:	Project Owner:	City:																								
Project Name: <u>Turner Battery</u>		State: Zip:																								
Project Location: <u>Turner Battery</u>		Phone #:																								
Sampler Name: <u>Daniel Raiser</u>		Fax #:																								
FOR LAB USE ONLY	Lab I.D.	Sample I.D.	GRAB OR (COMP. #) CONTAINERS	MATRIX				PRESERV.	SAMPLING																	
				GROUNDWATER	WASTEWATER	SOIL	OIL	SILUDGE	OTHER	ACID/BASE	ICE / COOL	OTHER	DATE	TIME												
	H902660												8-2-19													
	11 SP-4@2-32-440102												8-2-19													
	12 SP-4@2-103-128841																									

PLEASE NOTE: Liability and Damages. Cardinal's liability and client's exclusive remedy for any claim arising whether based in contract or tort, shall be limited to the amount paid by the client for the analyses. All claims, including those for negligence and any other cause whatsoever shall be deemed waived unless made in writing and received by Cardinal within 30 days after completion of the applicable service. In no event shall Cardinal be liable for incidental or consequential damages, including without limitation, business interruptions, loss of time, or loss of profits incurred by client, its subsidiaries, affiliates or successors arising out of or related to the performance of services hereunder by Cardinal, regardless of whether such claim is based upon any of the above stated causes of services.

Relinquished By:	Date: <u>8-2-19</u>	Received By:	Phone Result: <input type="checkbox"/> Yes <input type="checkbox"/> No	Add'l Phone #:
<u>Daniel Raiser</u>	Time: <u>12:50</u>	<u>Jamona D. White</u>	Fax Result: <input type="checkbox"/> Yes <input type="checkbox"/> No	Add'l Fax #:
Relinquished By:	Date:	Received By:	REMARKS:	
	Time:			
Delivered By: (Circle One) <u>1.3c</u>	<u>#97</u>	Sample Condition	CHECKED BY: (Initials)	
Sampler - UPS - Bus - Other: <u>Corrected 1.78</u>		Cool <input checked="" type="checkbox"/> Intact <input type="checkbox"/>	<u>JD</u>	
		Yes <input checked="" type="checkbox"/> No <input type="checkbox"/>		



PHONE (575) 393-2326 • 101 E. MARLAND • HOBBS, NM 88240

August 20, 2019

BRUCE BAKER

APACHE CORP - HOBBS

2350 W. MARLAND BLVD.

HOBBS, NM 88240

RE: TURNER BATTERY

Enclosed are the results of analyses for samples received by the laboratory on 08/16/19 15:50.

Cardinal Laboratories is accredited through Texas NELAP under certificate number T104704398-18-11. Accreditation applies to drinking water, non-potable water and solid and chemical materials. All accredited analytes are denoted by an asterisk (*). For a complete list of accredited analytes and matrices visit the TCEQ website at www.tceq.texas.gov/field/ga/lab_accred_certif.html.

Cardinal Laboratories is accredited through the State of Colorado Department of Public Health and Environment for:

Method EPA 552.2	Haloacetic Acids (HAA-5)
Method EPA 524.2	Total Trihalomethanes (TTHM)
Method EPA 524.4	Regulated VOCs (V1, V2, V3)

Accreditation applies to public drinking water matrices.

This report meets NELAP requirements and is made up of a cover page, analytical results, and a copy of the original chain-of-custody. If you have any questions concerning this report, please feel free to contact me.

Sincerely,

A handwritten signature in black ink that reads "Celey D. Keene".

Celey D. Keene

Lab Director/Quality Manager



PHONE (575) 393-2326 • 101 E. MARLAND • HOBBS, NM 88240

Analytical Results For:

APACHE CORP - HOBBS
 BRUCE BAKER
 2350 W. MARLAND BLVD.
 HOBBS NM, 88240
 Fax To: (575) 393-2432

Received: 08/16/2019
 Reported: 08/20/2019
 Project Name: TURNER BATTERY
 Project Number: NONE GIVEN
 Project Location: NONE GIVEN

Sampling Date: 08/16/2019
 Sampling Type: Soil
 Sampling Condition: Cool & Intact
 Sample Received By: Jodi Henson

Sample ID: SP. 4 @ 3' (H902828-01)

BTEX 80218		mg/kg		Analyzed By: MS					
Analyte	Result	Reporting Limit	Analyzed	Method Blank	BS	% Recovery	True Value QC	RPD	Qualifier
Benzene*	<0.050	0.050	08/20/2019	ND	1.83	91.3	2.00	1.39	
Toluene*	<0.050	0.050	08/20/2019	ND	2.02	101	2.00	0.977	
Ethylbenzene*	<0.050	0.050	08/20/2019	ND	2.09	105	2.00	0.730	
Total Xylenes*	<0.150	0.150	08/20/2019	ND	6.33	105	6.00	0.921	
Total BTEX	<0.300	0.300	08/20/2019	ND					

Surrogate: 4-Bromofluorobenzene (PIL) 104 % 73.3-129

TPH 8015M		mg/kg		Analyzed By: MS					
Analyte	Result	Reporting Limit	Analyzed	Method Blank	BS	% Recovery	True Value QC	RPD	Qualifier
GRO C6-C10*	<10.0	10.0	08/19/2019	ND	216	108	200	0.0102	
DRO >C10-C28*	195	10.0	08/19/2019	ND	216	108	200	1.23	
EXT DRO >C28-C36	167	10.0	08/19/2019	ND					

Surrogate: 1-Chlorooctane 100 % 41-142

Surrogate: 1-Chlorooctadecane 121 % 37.6-147

Cardinal Laboratories

*=Accredited Analyte

PLEASE NOTE: Liability and Damages. Cardinal's liability and client's exclusive remedy for any claim arising, whether based in contract or tort, shall be limited to the amount paid by client for analyses. All claims, including those for negligence and any other cause whatsoever shall be deemed waived unless made in writing and received by Cardinal within thirty (30) days after completion of the applicable service. In no event shall Cardinal be liable for incidental or consequential damages, including, without limitation, business interruptions, loss of use, or loss of profits incurred by client, its subsidiaries, affiliates or successors arising out of or related to the performance of the services hereunder by Cardinal, regardless of whether such claim is based upon any of the above stated reasons or otherwise. Results relate only to the samples identified above. This report shall not be reproduced except in full with written approval of Cardinal Laboratories.

Celey D. Keene, Lab Director/Quality Manager



PHONE (575) 393-2326 • 101 E. MARLAND • HOBBS, NM 88240

Analytical Results For:

APACHE CORP - HOBBS
 BRUCE BAKER
 2350 W. MARLAND BLVD.
 HOBBS NM, 88240
 Fax To: (575) 393-2432

Received: 08/16/2019
 Reported: 08/20/2019
 Project Name: TURNER BATTERY
 Project Number: NONE GIVEN
 Project Location: NONE GIVEN

Sampling Date: 08/16/2019
 Sampling Type: Soil
 Sampling Condition: Cool & Intact
 Sample Received By: Jodi Henson

Sample ID: SP. 4 @ 4' (H902828-02)**BTEX 8021B****mg/kg****Analyzed By: MS**

Analyte	Result	Reporting Limit	Analyzed	Method Blank	BS	% Recovery	True Value QC	RPD	Qualifier
Benzene*	<0.050	0.050	08/20/2019	ND	1.83	91.3	2.00	1.39	
Toluene*	<0.050	0.050	08/20/2019	ND	2.02	101	2.00	0.977	
Ethylbenzene*	<0.050	0.050	08/20/2019	ND	2.09	105	2.00	0.730	
Total Xylenes*	<0.150	0.150	08/20/2019	ND	6.33	105	6.00	0.921	
Total BTEX	<0.300	0.300	08/20/2019	ND					

Surrogate: 4-Bromofluorobenzene (PIL) 106 % 73.3-129

TPH 8015M**mg/kg****Analyzed By: MS**

Analyte	Result	Reporting Limit	Analyzed	Method Blank	BS	% Recovery	True Value QC	RPD	Qualifier
GRO C6-C10*	<10.0	10.0	08/19/2019	ND	216	108	200	0.0102	
DRO >C10-C28*	27.0	10.0	08/19/2019	ND	216	108	200	1.23	
EXT DRO >C28-C36	21.9	10.0	08/19/2019	ND					

Surrogate: 1-Chlorooctane 105 % 41-142

Surrogate: 1-Chlorooctadecane 113 % 37.6-147

Cardinal Laboratories

*=Accredited Analyte

PLEASE NOTE: Liability and Damages. Cardinal's liability and client's exclusive remedy for any claim arising, whether based in contract or tort, shall be limited to the amount paid by client for analyses. All claims, including those for negligence and any other cause whatsoever shall be deemed waived unless made in writing and received by Cardinal within thirty (30) days after completion of the applicable service. In no event shall Cardinal be liable for incidental or consequential damages, including, without limitation, business interruptions, loss of use, or loss of profits incurred by client, its subsidiaries, affiliates or successors arising out of or related to the performance of the services hereunder by Cardinal, regardless of whether such claim is based upon any of the above stated reasons or otherwise. Results relate only to the samples identified above. This report shall not be reproduced except in full with written approval of Cardinal Laboratories.

Celey D. Keene, Lab Director/Quality Manager



PHONE (575) 393-2326 • 101 E. MARLAND • HOBBS, NM 88240

Analytical Results For:

APACHE CORP - HOBBS
 BRUCE BAKER
 2350 W. MARLAND BLVD.
 HOBBS NM, 88240
 Fax To: (575) 393-2432

Received: 08/16/2019
 Reported: 08/20/2019
 Project Name: TURNER BATTERY
 Project Number: NONE GIVEN
 Project Location: NONE GIVEN

Sampling Date: 08/16/2019
 Sampling Type: Soil
 Sampling Condition: Cool & Intact
 Sample Received By: Jodi Henson

Sample ID: SP. 4 @ 5' (H902828-03)**BTEX 8021B**

mg/kg

Analyzed By: MS

Analyte	Result	Reporting Limit	Analyzed	Method Blank	BS	% Recovery	True Value QC	RPD	Qualifier
Benzene*	<0.050	0.050	08/20/2019	ND	1.83	91.3	2.00	1.39	
Toluene*	<0.050	0.050	08/20/2019	ND	2.02	101	2.00	0.977	
Ethylbenzene*	<0.050	0.050	08/20/2019	ND	2.09	105	2.00	0.730	
Total Xylenes*	<0.150	0.150	08/20/2019	ND	6.33	105	6.00	0.921	
Total BTEX	<0.300	0.300	08/20/2019	ND					

Surrogate: 4-Bromofluorobenzene (PIL) 109 % 73.3-129

TPH 8015M

mg/kg

Analyzed By: MS

Analyte	Result	Reporting Limit	Analyzed	Method Blank	BS	% Recovery	True Value QC	RPD	Qualifier
GRO C6-C10*	<50.0	50.0	08/19/2019	ND	216	108	200	0.0102	
DRO >C10-C28*	568	50.0	08/19/2019	ND	216	108	200	1.23	
EXT DRO >C28-C36	189	50.0	08/19/2019	ND					

Surrogate: 1-Chlorooctane 86.2 % 41-142

Surrogate: 1-Chlorooctadecane 124 % 37.6-147

Cardinal Laboratories

* = Accredited Analyte

PLEASE NOTE: Liability and Damages. Cardinal's liability and client's exclusive remedy for any claim arising, whether based in contract or tort, shall be limited to the amount paid by client for analyses. All claims, including those for negligence and any other cause whatsoever shall be deemed waived unless made in writing and received by Cardinal within thirty (30) days after completion of the applicable service. In no event shall Cardinal be liable for incidental or consequential damages, including, without limitation, business interruptions, loss of use, or loss of profits incurred by client, its subsidiaries, affiliates or successors arising out of or related to the performance of the services hereunder by Cardinal, regardless of whether such claim is based upon any of the above stated reasons or otherwise. Results relate only to the samples identified above. This report shall not be reproduced except in full with written approval of Cardinal Laboratories.

Celey D. Keene, Lab Director/Quality Manager



PHONE (575) 393-2326 • 101 E. MARLAND • HOBBS, NM 88240

Analytical Results For:

APACHE CORP - HOBBS
 BRUCE BAKER
 2350 W. MARLAND BLVD.
 HOBBS NM, 88240
 Fax To: (575) 393-2432

Received: 08/16/2019
 Reported: 08/20/2019
 Project Name: TURNER BATTERY
 Project Number: NONE GIVEN
 Project Location: NONE GIVEN

Sampling Date: 08/16/2019
 Sampling Type: Soil
 Sampling Condition: Cool & Intact
 Sample Received By: Jodi Henson

Sample ID: SP. 4 @ 6' (H902828-04)**BTEX 8021B**

mg/kg

Analyzed By: MS

Analyte	Result	Reporting Limit	Analyzed	Method Blank	BS	% Recovery	True Value QC	RPD	Qualifier
Benzene*	<0.050	0.050	08/20/2019	ND	1.83	91.3	2.00	1.39	
Toluene*	<0.050	0.050	08/20/2019	ND	2.02	101	2.00	0.977	
Ethylbenzene*	<0.050	0.050	08/20/2019	ND	2.09	105	2.00	0.730	
Total Xylenes*	<0.150	0.150	08/20/2019	ND	6.33	105	6.00	0.921	
Total BTEX	<0.300	0.300	08/20/2019	ND					

Surrogate: 4-Bromofluorobenzene (PIL) 106 % 73.3-129

TPH 8015M

mg/kg

Analyzed By: MS

Analyte	Result	Reporting Limit	Analyzed	Method Blank	BS	% Recovery	True Value QC	RPD	Qualifier
GRO C6-C10*	<10.0	10.0	08/20/2019	ND	205	103	200	3.16	
DRO >C10-C28*	64.6	10.0	08/20/2019	ND	194	97.1	200	3.77	
EXT DRO >C28-C36	52.9	10.0	08/20/2019	ND					

Surrogate: 1-Chlorooctane 96.7 % 41-142

Surrogate: 1-Chlorooctadecane 109 % 37.6-147

Cardinal Laboratories

*=Accredited Analyte

PLEASE NOTE: Liability and Damages. Cardinal's liability and client's exclusive remedy for any claim arising, whether based in contract or tort, shall be limited to the amount paid by client for analyses. All claims, including those for negligence and any other cause whatsoever shall be deemed waived unless made in writing and received by Cardinal within thirty (30) days after completion of the applicable service. In no event shall Cardinal be liable for incidental or consequential damages, including, without limitation, business interruptions, loss of use, or loss of profits incurred by client, its subsidiaries, affiliates or successors arising out of or related to the performance of the services hereunder by Cardinal, regardless of whether such claim is based upon any of the above stated reasons or otherwise. Results relate only to the samples identified above. This report shall not be reproduced except in full with written approval of Cardinal Laboratories.

Celey D. Keene, Lab Director/Quality Manager



PHONE (575) 393-2326 • 101 E. MARLAND • HOBBS, NM 88240

Analytical Results For:

APACHE CORP - HOBBS
 BRUCE BAKER
 2350 W. MARLAND BLVD.
 HOBBS NM, 88240
 Fax To: (575) 393-2432

Received: 08/16/2019
 Reported: 08/20/2019
 Project Name: TURNER BATTERY
 Project Number: NONE GIVEN
 Project Location: NONE GIVEN

Sampling Date: 08/16/2019
 Sampling Type: Soil
 Sampling Condition: Cool & Intact
 Sample Received By: Jodi Henson

Sample ID: SP. 4 @ 7' (H902828-05)**BTEX 8021B**

mg/kg

Analyzed By: MS

Analyte	Result	Reporting Limit	Analyzed	Method Blank	BS	% Recovery	True Value QC	RPD	Qualifier
Benzene*	<0.050	0.050	08/20/2019	ND	1.83	91.3	2.00	1.39	
Toluene*	<0.050	0.050	08/20/2019	ND	2.02	101	2.00	0.977	
Ethylbenzene*	<0.050	0.050	08/20/2019	ND	2.09	105	2.00	0.730	
Total Xylenes*	<0.150	0.150	08/20/2019	ND	6.33	105	6.00	0.921	
Total BTEX	<0.300	0.300	08/20/2019	ND					

Surrogate: 4-Bromofluorobenzene (PIL) 106 % 73.3-129

TPH 8015M

mg/kg

Analyzed By: MS

Analyte	Result	Reporting Limit	Analyzed	Method Blank	BS	% Recovery	True Value QC	RPD	Qualifier
GRO C6-C10*	<10.0	10.0	08/20/2019	ND	205	103	200	3.16	
DRO >C10-C28*	<10.0	10.0	08/20/2019	ND	194	97.1	200	3.77	
EXT DRO >C28-C36	<10.0	10.0	08/20/2019	ND					

Surrogate: 1-Chlorooctane 94.9 % 41-142

Surrogate: 1-Chlorooctadecane 100 % 37.6-147

Cardinal Laboratories

*=Accredited Analyte

PLEASE NOTE: Liability and Damages. Cardinal's liability and client's exclusive remedy for any claim arising, whether based in contract or tort, shall be limited to the amount paid by client for analyses. All claims, including those for negligence and any other cause whatsoever shall be deemed waived unless made in writing and received by Cardinal within thirty (30) days after completion of the applicable service. In no event shall Cardinal be liable for incidental or consequential damages, including, without limitation, business interruptions, loss of use, or loss of profits incurred by client, its subsidiaries, affiliates or successors arising out of or related to the performance of the services hereunder by Cardinal, regardless of whether such claim is based upon any of the above stated reasons or otherwise. Results relate only to the samples identified above. This report shall not be reproduced except in full with written approval of Cardinal Laboratories.

Celey D. Keene, Lab Director/Quality Manager



PHONE (575) 393-2326 • 101 E. MARLAND • HOBBS, NM 88240

Notes and Definitions

- QR-03 The RPD value for the sample duplicate or MS/MSD was outside of QC acceptance limits due to matrix interference. QC batch accepted based on LCS and/or LCSD recovery and/or RPD values.
- QM-07 The spike recovery was outside acceptance limits for the MS and/or MSD. The batch was accepted based on acceptable LCS recovery.
- ND Analyte NOT DETECTED at or above the reporting limit
- RPD Relative Percent Difference
- ** Samples not received at proper temperature of 6°C or below.
- *** Insufficient time to reach temperature.
- Chloride by SM4500Cl-B does not require samples be received at or below 6°C
Samples reported on an as received basis (wet) unless otherwise noted on report

Cardinal Laboratories

*=Accredited Analyte

PLEASE NOTE: Liability and Damages. Cardinal's liability and client's exclusive remedy for any claim arising, whether based in contract or tort, shall be limited to the amount paid by client for analyses. All claims, including those for negligence and any other cause whatsoever shall be deemed waived unless made in writing and received by Cardinal within thirty (30) days after completion of the applicable service. In no event shall Cardinal be liable for incidental or consequential damages, including, without limitation, business interruptions, loss of use, or loss of profits incurred by client, its subsidiaries, affiliates or successors arising out of or related to the performance of the services hereunder by Cardinal, regardless of whether such claim is based upon any of the above stated reasons or otherwise. Results relate only to the samples identified above. This report shall not be reproduced except in full with written approval of Cardinal Laboratories.

Celey D. Keene, Lab Director/Quality Manager



CHAIN-OF-CUSTODY AND ANALYSIS REQUEST

101 East Marland, Hobbs, NM 88240
(575) 393-2326 FAX (575) 393-2476

Company Name: <u>Apache Corporation</u>				BILL TO				ANALYSIS REQUEST																													
Project Manager: <u>Bruce Baker</u>				P.O. #:																																	
Address:				Company:																																	
City:		State:		Zip:		Attn:																															
Phone #:		Fax #:		Address:																																	
Project #:		Project Owner:		City:																																	
Project Name: <u>Turner Battery</u>				State:																Zip:																	
Project Location: <u>Turner Battery</u>				Phone #:																																	
Sampler Name: <u>Daniel Rastler</u>				Fax #:																																	
FOR LAB USE ONLY																																					
Lab I.D.		Sample I.D.		GIRAS OR (COMP. #) CONTAINERS		MATRIX														PRESERV		SAMPLING															
						GROUNDWATER WASTEWATER SOIL OIL SLUDGE OTHER														ACID/BASE ICE / COOL OTHER		DATE		TIME													
<u>H902828</u>																						<u>8/16/19</u>		<u>9:00</u>													
<u>1</u>		<u>SP-4 @ 3</u>										<u>9:05</u>																									
<u>2</u>		<u>SP-4 @ 4</u>										<u>9:07</u>																									
<u>3</u>		<u>SP-4 @ 5</u>										<u>9:11</u>																									
<u>4</u>		<u>SP-4 @ 6</u>										<u>9:15</u>																									
<u>5</u>		<u>SP-4 @ 7</u>																																			

PLEASE NOTE: Liability and Damages. Cardinal's liability and client's exclusive remedy for any claim arising whether based in contract or tort, shall be limited to the amount paid by the client for the analysis. All claims, including those for negligence and any other cause whatsoever shall be deemed waived unless made in writing and received by Cardinal within 30 days after completion of the applicable service. In no event shall Cardinal be liable for incidental or consequential damages including without limitation, business interruptions, loss of use, or loss of profits incurred by client, its subsidiaries, affiliates or employees arising out of or related to the performance of services hereunder by Cardinal, regardless of whether such claim is based upon any of the above stated services or otherwise.

Relinquished By: <u>[Signature]</u>		Date: <u>8-16-19</u>	Received By: <u>[Signature]</u>		Phone Result: <input type="checkbox"/> Yes <input type="checkbox"/> No	Add'l Phone #: _____
Relinquished By:		Date:	Received By:		Fax Result: <input type="checkbox"/> Yes <input type="checkbox"/> No	Add'l Fax #: _____
Delivered By: (Circle One)		Time: <u>3:32</u>	Sample Condition		REMARKS:	
Sampler - UPS - Bus - Other:		<u>3.70</u> <u>#97</u>	Cool <input type="checkbox"/> Intact <input type="checkbox"/>		Email to Bruce and Jeff	
			Yes <input type="checkbox"/> No <input type="checkbox"/>			
			CHECKED BY: <u>[Signature]</u>			

District I

1625 N. French Dr., Hobbs, NM 88240
Phone:(575) 393-6161 Fax:(575) 393-0720

District II

811 S. First St., Artesia, NM 88210
Phone:(575) 748-1283 Fax:(575) 748-9720

District III

1000 Rio Brazos Rd., Aztec, NM 87410
Phone:(505) 334-6178 Fax:(505) 334-6170

District IV

1220 S. St Francis Dr., Santa Fe, NM 87505
Phone:(505) 476-3470 Fax:(505) 476-3462

State of New Mexico
Energy, Minerals and Natural Resources
Oil Conservation Division
1220 S. St Francis Dr.
Santa Fe, NM 87505

CONDITIONS

Action 2112

CONDITIONS

Operator: APACHE CORPORATION 303 Veterans Airpark Ln Midland, TX 79705	OGRID: 873
	Action Number: 2112
	Action Type: [C-141] Release Corrective Action (C-141)

CONDITIONS

Created By	Condition	Condition Date
bbillings	Final assessment and remediation is deferred until P&A or access becomes available.	7/12/2021