

ID NO. 162292

NSL - 8496

Revised March 23, 2017

| | | | |
|-----------|-----------|-------|-------------------------------|
| RECEIVED: | REVIEWER: | TYPE: | APP NO: pLEL2233429146 |
|-----------|-----------|-------|-------------------------------|

ABOVE THIS TABLE FOR OCD DIVISION USE ONLY

NEW MEXICO OIL CONSERVATION DIVISION
 - Geological & Engineering Bureau -
 1220 South St. Francis Drive, Santa Fe, NM 87505

**ADMINISTRATIVE APPLICATION CHECKLIST**

THIS CHECKLIST IS MANDATORY FOR ALL ADMINISTRATIVE APPLICATIONS FOR EXCEPTIONS TO DIVISION RULES AND REGULATIONS WHICH REQUIRE PROCESSING AT THE DIVISION LEVEL IN SANTA FE

Applicant: Cimarex Energy Co. **OGRID Number:** 215099
Well Name: Scoter 6-31 Federal Com 47H **API:** Pending
Pool: Purple Sage; Wolfcamp **Pool Code:** 98220

SUBMIT ACCURATE AND COMPLETE INFORMATION REQUIRED TO PROCESS THE TYPE OF APPLICATION INDICATED BELOW

- 1) **TYPE OF APPLICATION:** Check those which apply for [A]
 A. Location - Spacing Unit - Simultaneous Dedication
☒ NSL ☐ NSP (PROJECT AREA) ☐ NSP (PRORATION UNIT) ☐ SD
 B. Check one only for [I] or [II]
 [I] Commingling - Storage - Measurement
☐ DHC ☐ CTB ☐ PLC ☐ PC ☐ OLS ☐ OLM
 [II] Injection - Disposal - Pressure Increase - Enhanced Oil Recovery
☐ WFX ☐ PMX ☐ SWD ☐ IPI ☐ EOR ☐ PPR

2) **NOTIFICATION REQUIRED TO:** Check those which apply.

- A. ☒ Offset operators or lease holders
 B. ☐ Royalty, overriding royalty owners, revenue owners
 C. ☐ Application requires published notice
 D. ☐ Notification and/or concurrent approval by SLO
 E. ☒ Notification and/or concurrent approval by BLM
 F. ☐ Surface owner
 G. ☒ For all of the above, proof of notification or publication is attached, and/or,
 H. ☐ No notice required

FOR OCD ONLY

- ☐ Notice Complete
☐ Application Content Complete

- 3) **CERTIFICATION:** I hereby certify that the information submitted with this application for administrative approval is **accurate** and **complete** to the best of my knowledge. I also understand that **no action** will be taken on this application until the required information and notifications are submitted to the Division.

Note: Statement must be completed by an individual with managerial and/or supervisory capacity.

Deana M. Bennett

Print or Type Name

Signature

November 29, 2022

Date

505-848-1834

Phone Number

deana.bennett@modrall.com

e-mail Address



**Non-Standard Location Application
Scoter 6-31 Federal Com 47H**

Table of Contents

Administrative Checklist

Application Cover Letter

- **Exhibit A: C-102**
- **Exhibit B: Letter from Reservoir Engineer**
- **Exhibit C: Plat Showing Affected Tracts**
- **Exhibit D: Notice Information**
 - **Notice Letter**
 - **Chart Showing Offsets**
 - **Certified Mailing List**



MODRALL SPERLING

L A W Y E R S

November 29, 2022

Deana M. Bennett
505.848.1834
dmb@modrall.com

VIA E-FILING

Director Adrienne Sandoval
And
OCD Engineering Bureau
Oil Conservation Division
New Mexico Department of Energy,
Minerals and Natural Resources
1220 South Saint Francis Drive
Santa Fe, New Mexico 87505

Re: Application of Cimarex Energy Co. for administrative approval of unorthodox well location for its Scoter 6-31 Federal Com 47H Well located in the E/2 of Section 6, Township 25 South, Range 27 East, and the E/2 of Section 31, Township 24 South, Range 27 East, NMPM, Eddy County, New Mexico.

Dear Director Sandoval/OCD Engineering Bureau:

Pursuant to Division rules 19.15.16.15(C)(6) and 19.15.15.13 NMAC, Cimarex Energy Co. (OGRID 215099) seeks administrative approval of an unorthodox well location ("NSL") for its Scoter 6-31 Federal Com 47H well (API No. pending) (the "Well"). The Well will be located in a 640-acre, more or less, standard spacing unit underlying the E/2 of Section 6, Township 25 South, Range 27 East, and the E/2 of Section 31, Township 24 South, Range 27 East, NMPM, Eddy County, New Mexico, and will be in the Purple Sage Wolfcamp Gas Pool (Pool ID: 98220). A C-102 for the Well is attached as Exhibit A.

The Purple Sage Wolfcamp Gas Pool has special pool rules which establish 320-acre building blocks and 330' foot setback requirements. The Well will have setbacks of 100' for the toe and heel, which requires an NSL approval. As shown on Exhibit A, this is a horizontal well that will be drilled as follows:

- Surface Hole Location: 305' FSL & 221' FEL of Section 6-T25S-R27E;
- First Take Point: 100' FSL & 1,826' FEL of Section 6-T25S-R27E;

Modrall Sperling
Roehl Harris & Sisk P.A.

500 Fourth Street NW
Suite 1000
Albuquerque,
New Mexico 87102

PO Box 2168
Albuquerque,
New Mexico 87103-2168

Tel: 505.848.1800
www.modrall.com

- Last Take Point/Bottom Hole Location: 100' FNL & 1,826' FEL of Section 31-T24S-R27E.

Cimarex has included as Exhibit B a letter explaining why this application is needed. Cimarex also provides a map of the area, attached as Exhibit C, which shows the tracts upon which the unorthodox location will encroach.

As discussed above, the first and last take points for the Well are closer than 330' from the boundary of the spacing unit. Specifically, the first take point would be 100' from the South line of Section 6, Township 25 South, Range 27 East, and the last take point would be 100' from the North line of Section 31, Township 24 South, Range 27 East. *See* Exhibit A (C-102). The unorthodox location will encroach towards the NE/4 of Section 7 of Township 25 South, Range 27 East and the SE/4 of Section 30, Township 24 South, Range 27 East. Cimarex has confirmed that the tracts adjoining the spacing unit by a corner are more the 330' away from the unorthodox locations requested.

Pursuant to Rule 19.15.4.12(A)(2) and Rule 19.15.2.7(A)(3), Cimarex is providing notice as follows:

- To Chevron USA Inc., 1400 Smith St., Houston, TX 77002, and 6301 Deauville Blvd., Midland, TX 79706, as the operator of the SE/4 of Section 30-T24S-R27E.
- To the working interest owners in the NE/4 of Section 7 because Cimarex is the operator in the E/2 of Sections 7 and 18-T25S-R27E pursuant to a JOA:
 - Chevron USA Inc., 1400 Smith St., Houston, TX 77002
 - Chevron USA Inc., 6301 Deauville Blvd., Midland, TX 79706

Cimarex is also providing notice to the Bureau of Land Management. Proof of mailing, along with a copy of the notice letter sent to affected parties, is attached hereto as Exhibit D.

Your attention to this matter is appreciated.

Sincerely,



Earl E. DeBrine
Deana M. Bennett
Bryce H. Smith

Attorney for Cimarex Energy Co.

District I
1625 N. French Dr., Hobbs, NM 88240
Phone: (505) 393-6161 Fax: (505) 393-0720
District II
811 S. First St., Artesia, NM 88210
Phone: (505) 746-1283 Fax: (505) 746-9720
District III
1000 Rio Brazos Road, Aztec, NM 87410
Phone: (505) 334-6178 Fax: (505) 334-6170
District IV
1220 E. St. Francis Dr., Santa Fe, NM 87505
Phone: (505) 476-3460 Fax: (505) 476-3462

State of New Mexico
Energy, Minerals & Natural Resources Department
OIL CONSERVATION DIVISION
1220 South St. Francis Dr.
Santa Fe, NM 87505

Form C-102
Revised August 1, 2011
Submit one copy to appropriate
District Office

☐ AMENDED REPORT

WELL LOCATION AND ACREAGE DEDICATION PLAT

| | | |
|----------------------------------|---|---|
| ¹ API Number | ² Pool Code 98220 | ³ Pool Name Purple Sage; Wolfcamp |
| ⁴ Property Code | ⁵ Property Name SCOTER 6-31 FEDERAL COM | ⁶ Well Number 47H |
| ⁷ ODRID No. 215099 | ⁸ Operator Name CIMAREX ENERGY CO. | ⁹ Elevation 3332.8' |

"Surface Location

| UL or lot no. P | Section 6 | Township 25S | Range 27E | Lot No. | Feet from the 305 | North/South line SOUTH | Feet from the 221 | East/West line EAST | County EDDY |
|--------------------|--------------|-----------------|--------------|---------|----------------------|---------------------------|----------------------|------------------------|----------------|
|--------------------|--------------|-----------------|--------------|---------|----------------------|---------------------------|----------------------|------------------------|----------------|

"Bottom Hole Location If Different From Surface

| UL or lot no. B | Section 31 | Township 24S | Range 27E | Lot No. | Feet from the 100 | North/South line NORTH | Feet from the 1826 | East/West line EAST | County EDDY |
|--------------------|---------------|-----------------|--------------|---------|----------------------|---------------------------|-----------------------|------------------------|----------------|
|--------------------|---------------|-----------------|--------------|---------|----------------------|---------------------------|-----------------------|------------------------|----------------|

| | | | |
|---|-------------------------------|----------------------------------|-------------------------|
| ¹⁰ Dedicated Acres 638.44 | ¹¹ Joint or Teiler | ¹² Consolidation Code | ¹³ Order No. |
|---|-------------------------------|----------------------------------|-------------------------|

No allowable will be assigned to this completion until all interests have been consolidated or a non-standard unit has been approved by the division.

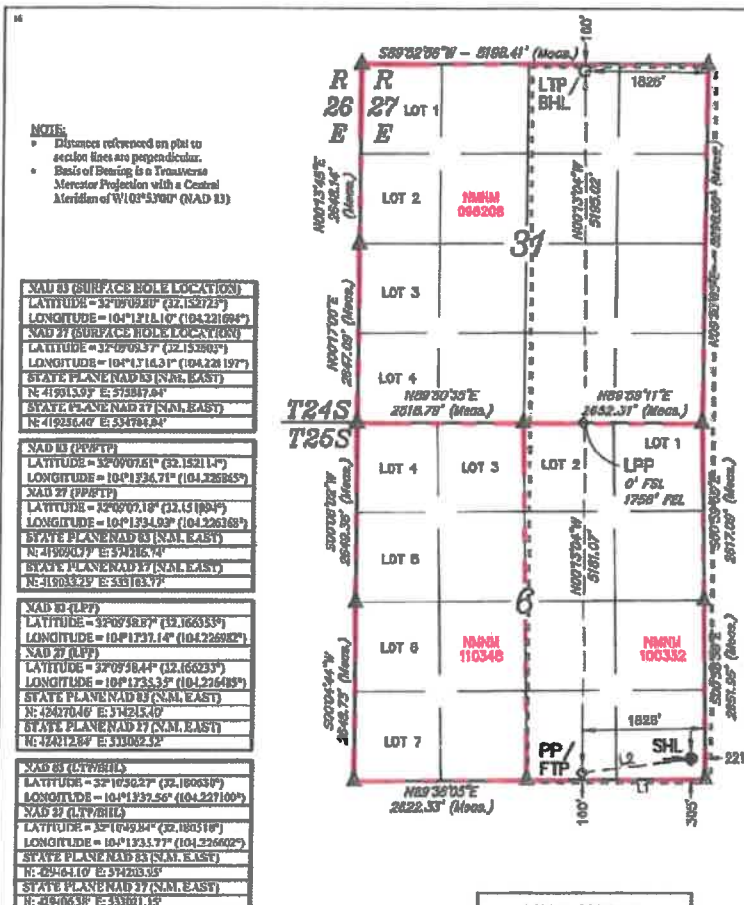

"OPERATOR CERTIFICATION

I hereby certify that the information contained herein is true and complete to the best of my knowledge and belief, and that this organization either owns a working interest or undivided mineral interest in the land including the proposed bottom hole location or has a right to drill this well on this location pursuant to a contract with an owner of such a mineral or working interest, or in a voluntary pooling agreement or a compulsory pooling order heretofore entered by the division.

Signature: *K. Schlichting* Date: 4/17/2022

Printed Name: Karicia Schlichting

Email Address: karicia.schlichting@coterra.com

"SURVEYOR CERTIFICATION

I hereby certify that the well location shown on this plat was plotted from field notes of actual surveys made by me or under my supervision, and that the same is true and correct to the best of my belief.

May 10, 2017

Date of Survey
Signature and Seal of Professional Surveyor:



Certificate Number:

LINE TABLE

| LINE | DIRECTION | LENGTH |
|------|-------------|----------|
| L1 | N89°35'10"E | 2648.27' |
| L2 | S82°18'01"W | 1618.16' |



SCALE

DRAWN BY: S.F. 05-20-17
REV: 5 E.C. 02-17-22
(PP & BHL MOVE)

- = SURFACE HOLE LOCATION
- ◆ = PENETRATION POINT/FIRST TAKE POINT/LPP
- = LAST TAKE POINT/BOTTOM HOLE LOCATION
- ▲ = SECTION CORNER LOCATED

EXHIBIT

A



November 9, 2022

VIA E-FILING

Director Adrienne Sandoval and OCD Engineering Bureau
Oil Conservation Division
Energy, Minerals and Natural Resources Department
1220 South Saint Francis Drive
Santa Fe, New Mexico 87505

Re: Application of Cimarex Energy Co. for administrative approval of non-standard locations for Scoter 6-31 Federal Com 46H; Scoter 6-31 Federal Com 47H; Scoter 6-31 Federal Com 48H wells, located in the E/2 of Section 6, Township 25 South, Range 27 East, and Section 31, Township 24 South, Range 27 East, NMPM, Eddy County, New Mexico

Dear Director Sandoval/OCD Engineering Bureau

Cimarex Energy Co., OGRID Number 215099, respectfully requests administrative approval of non-standards location ("NSL") for the following wells (the "Wells"):

- Scoter 6-31 Federal Com 46H (API No. Pending);
- Scoter 6-31 Federal Com 47H (API No. Pending); and
- Scoter 6-31 Federal Com 48H (API No. Pending);

Cimarex is submitting three separate non-standard location applications, one for each well. The Wells will be completed within a standard 640 acre, more or less, spacing unit in the Purple Sage Wolfcamp Gas Pool (Pool ID: 98220). Cimarex is requesting non-standard location approval for the Wells to allow the setbacks to be less than 330' from the northern and southern boundaries of the horizontal spacing unit. Allowing Cimarex to complete the Wells at this non-standard location will result in the greatest recovery of reserves from all of the Wells and will reduce waste.

Thank you for your consideration. Should you have any questions please contact me at brett.stewart@coterra.com or (432)571-7889.

Sincerely,

A handwritten signature in black ink that reads "Brett Stewart". The signature is written in a cursive, flowing style.

Brett Stewart
Reservoir Engineer
Cimarex Energy Co.

Scoter 6-31 Federal Com E/2 Wells

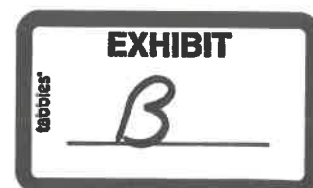

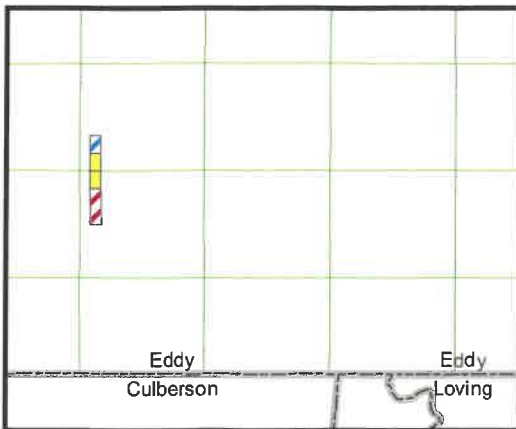
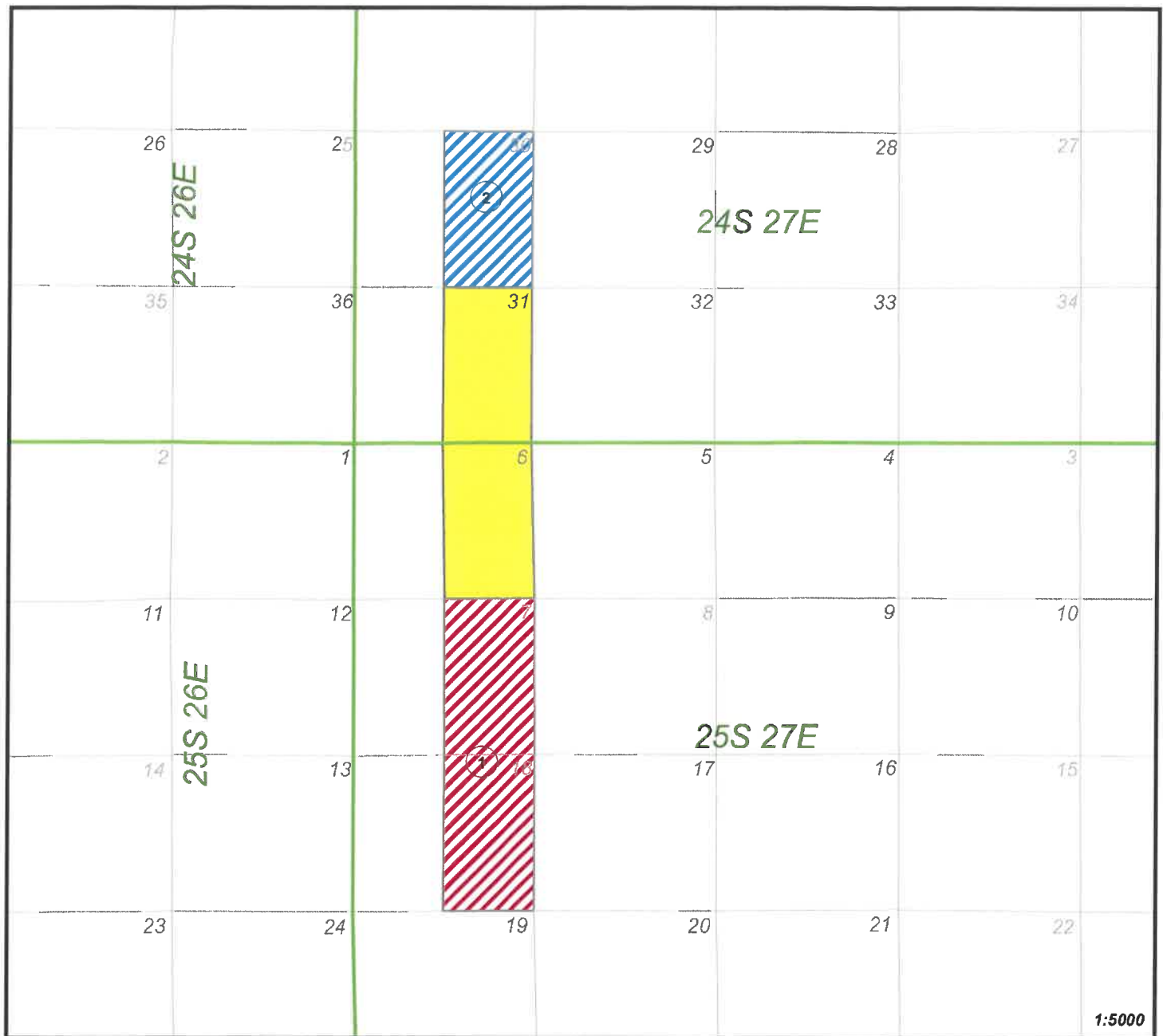

Scoter 6-31 (E2)



Cimarex



1) Cimarex, Operator
Chevron USA



2) Chevron USA
USA BLM

Eddy County, New Mexico

Township 24 South, Range 27 East, N.M.P.M.

Section 31: E2

Township 25 South, Range 27 East, N.M.P.M.

Section 6: E2

Released to Imaging: 12/27/2022 10:02:33 AM



LEGACY
ONSHORE



MODRALL SPERLING

L A W Y E R S

November 29, 2022

Deana M. Bennett
505.848.1834
dmb@modrall.com

VIA CERTIFIED MAIL

TO AFFECTED PARTIES

Re: Applications of Cimarex Energy Co. for administrative approval of unorthodox well locations for its Scoter 6-31 Federal Com 46H; Scoter 6-31 Federal Com 47H; and Scoter 6-31 Federal Com 48H wells, located in the E/2 of Section 6, Township 25 South, Range 27 East, and the E/2 of Section 31, Township 24 South, Range 27 East, NMPM, Eddy County, New Mexico

Dear Sir or Madam:

Enclosed are copies of the above-referenced applications filed with the New Mexico Oil Conservation Division on this date. Any objections that you have to these applications must be filed in writing with the New Mexico Oil Conservation Division, 1220 South St. Francis Drive, Santa Fe, New Mexico 87505, within twenty (20) days from the date the Division receives the above-referenced applications. If no objection is received within this twenty-day period, the applications may be approved administratively by the Division.

If you have any questions concerning this application, please contact:

Brett Stewart
Reservoir Engineer
Cimarex Energy Co.
Brett.Stewart@coterra.com
(432) 571-7889

Sincerely,

Earl E. DeBrine
Deana M. Bennett
Bryce H. Smith
Attorneys for Cimarex Energy Co.

Modrall Sperling
Roehl Harris & Sisk P.A.
500 Fourth Street NW
Suite 1000
Albuquerque,
New Mexico 87102

PO Box 2168
Albuquerque,
New Mexico 87103-2168

Tel: 505.848.1800
www.modrall.com

Scoter 6-31 Federal Com



| Offsetting Sections | Operator | WIOs If Needed N/A if Cimarex IS NOT operator | Date Notice Letter Sent |
|-----------------------|---|---|-------------------------|
| Section 30, T24S-R27E | Chevron USA Inc. 1400 Smith St. Houston, TX 77002 and Chevron USA Inc. 6301 Deauville Blvd. Midland, TX 79706 | N/A | 11/29/2022 |
| Section 7, T25S-R27E | Cimarex Energy Co. | Chevron USA Inc. 1400 Smith St. Houston, TX 77002 and Chevron USA Inc. 6301 Deauville Blvd. Midland, TX 79706 | 11/29/2022 |

Other Notice Parties:

| Other Notice Parties | Date Notice Letter Sent |
|---------------------------|-------------------------|
| Bureau of Land Management | 11/29/2022 |

Carlene Schuman
 Modrall Sperlberg Roehl Harris & Sisk P.A.
 100 Fourth Street, Suite 1000
 Albuquerque NM 87102

PS Form 3877

Type of Mailing: CERTIFIED MAIL
 11/29/2022

Firm Mailing Book ID: 237301

| Line | USPS Article Number | Name, Street, City, State, Zip | Postage | Service Fee | RR Fee | Rest.Del.Fee | Reference Contents |
|---------------------|-----------------------------|--|---------------|----------------|---------------|----------------|------------------------|
| 1 | 9314 8699 0430 0101 9251 14 | Chevron USA Inc. 6301 Deauville Blvd. Midland TX 79706 | \$2.64 | \$4.00 | \$2.00 | \$0.00 | 82762.128Scoter Notice |
| 2 | 9314 8699 0430 0101 9251 21 | United States of America Bureau of Land Management 301 Dinosaur Tr. Santa Fe NM 87508 | \$2.64 | \$4.00 | \$2.00 | \$0.00 | 82762.128Scoter Notice |
| 3 | 9314 8699 0430 0101 9251 38 | Chevron USA Inc. 1400 Smith St. Houston TX 77002 | \$2.64 | \$4.00 | \$2.00 | \$0.00 | 82762.128Scoter Notice |
| Totals: | | | \$7.92 | \$12.00 | \$6.00 | \$0.00 | |
| Grand Total: | | | | | | \$25.92 | |

List Number of Pieces
Listed by Sender

Total Number of Pieces
Received at Post Office

Postmaster:
Name of receiving employee

Dated:

District I
1823 N. French Dr., Hobbs, NM 88240
Phone: (575) 393-6161 Fax: (575) 393-0720

District II
511 A First St., Artesia, NM 88210
Phone: (575) 748-1283 Fax: (575) 748-9120

District III
1000 Rio Pecos Road, Arice, NM 87410
Phone: (505) 334-6178 Fax: (505) 334-6170

District IV
1220 S. St. Francis Dr., Santa Fe, NM 87505
Phone: (505) 476-3460 Fax: (505) 476-3462

State of New Mexico
Energy, Minerals & Natural Resources Department
OIL CONSERVATION DIVISION
1220 South St. Francis Dr.
Santa Fe, NM 87505

Form C-102
Revised August 1, 2011
Submit one copy to appropriate
District Office

☐ AMENDED REPORT

WELL LOCATION AND ACREAGE DEDICATION PLAT

| | | | | | |
|----------------------|--|--|--|--------------------------------------|--|
| 1 API Number | | 2 Pool Code 98220 | | 3 Pool Name Purple Sage; Wolfcamp | |
| 4 Property Code | | 5 Property Name SCOTER 6-31 FEDERAL COM | | 6 Well Number 47H | |
| 7 GRID No. 215089 | | 8 Operator Name CIMAREX ENERGY CO. | | 9 Elevation 3332.8' | |

"Surface Location

| UL or lot no. P | Section 6 | Township 25S | Range 27E | Lat Ida | Feet from the 305 | North/South line SOUTH | Feet from the 221 | East/West line EAST | County EDDY |
|--------------------|--------------|-----------------|--------------|---------|----------------------|---------------------------|----------------------|------------------------|----------------|
|--------------------|--------------|-----------------|--------------|---------|----------------------|---------------------------|----------------------|------------------------|----------------|

"Bottom Hole Location If Different From Surface

| UL or lot no. B | Section 31 | Township 24S | Range 27E | Lat Ida | Feet from the 100 | North/South line NORTH | Feet from the 1826 | East/West line EAST | County EDDY |
|--------------------|---------------|-----------------|--------------|---------|----------------------|---------------------------|-----------------------|------------------------|----------------|
|--------------------|---------------|-----------------|--------------|---------|----------------------|---------------------------|-----------------------|------------------------|----------------|

11 Dedicated Acres
688.44

No allowable will be assigned to this completion until all interests have been consolidated or a non-standard unit has been approved by the division.

NOTE:

- Distances referenced on plat to section lines are perpendicular.
- Basin of Boring is a Transverse Mercator Projection with a Central Meridian of W103°53'00" (NAD 83)

NAD 83 (SURFACE HOLE LOCATION)
LATITUDE = 32°09'48.8" (32.152121°)
LONGITUDE = 104°17'18.1" (104.221694°)
NAD 27 (SURFACE HOLE LOCATION)
LATITUDE = 32°09'03.3" (32.153693°)
LONGITUDE = 104°17'18.3" (104.221197°)
STATE PLANE NAD 83 (N.M. EAST)
N: 419013.97 E: 513867.84
STATE PLANE NAD 27 (N.M. EAST)
N: 419284.40 E: 514784.64

NAD 83 (PPR-TP)
LATITUDE = 32°09'01.6" (32.152114°)
LONGITUDE = 104°17'34.7" (104.226835°)
NAD 27 (PPR-TP)
LATITUDE = 32°09'02.1" (32.151894°)
LONGITUDE = 104°17'34.9" (104.226188°)
STATE PLANE NAD 83 (N.M. EAST)
N: 419990.77 E: 514216.74
STATE PLANE NAD 27 (N.M. EAST)
N: 419033.22 E: 513183.72

NAD 83 (LPP)
LATITUDE = 32°09'48.7" (32.162353°)
LONGITUDE = 104°17'37.1" (104.226824°)
NAD 27 (LPP)
LATITUDE = 32°09'48.4" (32.162035°)
LONGITUDE = 104°17'35.3" (104.226485°)
STATE PLANE NAD 83 (N.M. EAST)
N: 424704.6 E: 514215.40
STATE PLANE NAD 27 (N.M. EAST)
N: 424712.84 E: 513082.32

NAD 83 (LTP/BHL)
LATITUDE = 32°10'30.2" (32.16950°)
LONGITUDE = 104°17'37.5" (104.227100°)
NAD 27 (LTP/BHL)
LATITUDE = 32°10'49.8" (32.180316°)
LONGITUDE = 104°17'35.7" (104.226602°)
STATE PLANE NAD 83 (N.M. EAST)
N: 429464.10 E: 514203.35
STATE PLANE NAD 27 (N.M. EAST)
N: 429466.38 E: 513301.15

LINE TABLE

| LINE | DIRECTION | LENGTH |
|------|-------------|----------|
| L1 | N89°35'10"E | 2640.27' |
| L2 | S82°18'01"W | 1818.18' |

SCALE
DRAWN BY: S.F. 05-20-17
REV: 5 E.C. 02-17-22
(PP & BHL MOVE)

"OPERATOR CERTIFICATION"
I hereby certify that the information contained herein is true and complete to the best of my knowledge and belief, and that this information either owns a working interest or retained mineral interest in the land including the proposed bottom hole location or has a right to drill this well at this location pursuant to a contract with an owner of such a mineral or working interest, or to a voluntary pooling agreement or a temporary pooling order heretofore entered by the division.

Signature: *K. Schilling* Date: 4/17/2022
Printed Name: Karla Schilling
Email Address: karla.schilling@coterra.com

"SURVEYOR CERTIFICATION"
I hereby certify that the well location shown on this plat was plotted from field notes of actual surveys made by me or under my supervision, and that the same is true and correct to the best of my belief.

Date of Survey: May 10, 2017
Signature and Seal of Professional Surveyor:
Paul Buchele
PAUL BUCHELE
NEW MEXICO
23-17
02-17-22
PROFESSIONAL SURVEYOR

Certificate Number:

EXHIBIT
A



November 29, 2022

Deana M. Bennett
505.848.1834
dmb@modrall.com

VIA CERTIFIED MAIL

TO AFFECTED PARTIES

Re: Applications of Cimarex Energy Co. for administrative approval of unorthodox well locations for its Scoter 6-31 Federal Com 46H; Scoter 6-31 Federal Com 47H; and Scoter 6-31 Federal Com 48H wells, located in the E/2 of Section 6, Township 25 South, Range 27 East, and the E/2 of Section 31, Township 24 South, Range 27 East, NMPM, Eddy County, New Mexico

Dear Sir or Madam:

Enclosed are copies of the above-referenced applications filed with the New Mexico Oil Conservation Division on this date. Any objections that you have to these applications must be filed in writing with the New Mexico Oil Conservation Division, 1220 South St. Francis Drive, Santa Fe, New Mexico 87505, within twenty (20) days from the date the Division receives the above-referenced applications. If no objection is received within this twenty-day period, the applications may be approved administratively by the Division.

If you have any questions concerning this application, please contact:

Brett Stewart
Reservoir Engineer
Cimarex Energy Co.
Brett.Stewart@coterra.com
(432) 571-7889

Sincerely,

Earl E. DeBrine
Deana M. Bennett
Bryce H. Smith
Attorneys for Cimarex Energy Co.

Modrall Sperling
Roehl Harris & Sisk P.A.
500 Fourth Street NW
Suite 1000
Albuquerque,
New Mexico 87102

PO Box 2168
Albuquerque,
New Mexico 87103-2168

Tel: 505.848.1800
www.modrall.com

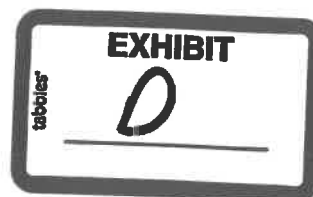
Scoter 6-31 Federal Com



| Offsetting Sections | Operator | WIOs If Needed N/A if Cimarex IS NOT operator | Date Notice Letter Sent |
|-----------------------|---|---|-------------------------|
| Section 30, T24S-R27E | Chevron USA Inc. 1400 Smith St. Houston, TX 77002 and Chevron USA Inc. 6301 Deauville Blvd. Midland, TX 79706 | N/A | 11/29/2022 |
| Section 7, T25S-R27E | Cimarex Energy Co. | Chevron USA Inc. 1400 Smith St. Houston, TX 77002 and Chevron USA Inc. 6301 Deauville Blvd. Midland, TX 79706 | 11/29/2022 |

Other Notice Parties:

| Other Notice Parties | Date Notice Letter Sent |
|---------------------------|-------------------------|
| Bureau of Land Management | 11/29/2022 |

PS Form 3877

Type of Mailing: CERTIFIED MAIL
11/29/2022

Firm Mailing Book ID: 237301

Arlene Schuman
Modrall Sperling Rochl Harris & Sisk P.A.
100 Fourth Street, Suite 1000
Albuquerque NM 87102

| Line | USPS Article Number | Name, Street, City, State, Zip | Postage | Service Fee | RR Fee | Rest.Del.Fee | Reference Contents |
|----------------|-----------------------------|--|---------------------|----------------|----------------|---------------|------------------------|
| 1 | 9314 8699 0430 0101 9251 14 | Chevron USA Inc. 6301 Deauville Blvd. Midland TX 79706 | \$2.64 | \$4.00 | \$2.00 | \$0.00 | 82762.128Scoter Notice |
| 2 | 9314 8699 0430 0101 9251 21 | United States of America Bureau of Land Management 301 Dinosaur Tr. Santa Fe NM 87508 | \$2.64 | \$4.00 | \$2.00 | \$0.00 | 82762.128Scoter Notice |
| 3 | 9314 8699 0430 0101 9251 38 | Chevron USA Inc. 1400 Smith St. Houston TX 77002 | \$2.64 | \$4.00 | \$2.00 | \$0.00 | 82762.128Scoter Notice |
| Totals: | | | \$7.92 | \$12.00 | \$6.00 | \$0.00 | |
| | | | Grand Total: | | \$25.92 | | |

List Number of Pieces
Listed by SenderTotal Number of Pieces
Received at Post OfficePostmaster:
Name of receiving employee

Dated:

3



November 29, 2022

Deana M. Bennett
505.848.1834
dmb@modrall.com

VIA CERTIFIED MAIL

TO AFFECTED PARTIES

Re: Applications of Cimarex Energy Co. for administrative approval of unorthodox well locations for its Scoter 6-31 Federal Com 46H; Scoter 6-31 Federal Com 47H; and Scoter 6-31 Federal Com 48H wells, located in the E/2 of Section 6, Township 25 South, Range 27 East, and the E/2 of Section 31, Township 24 South, Range 27 East, NMPM, Eddy County, New Mexico

Dear Sir or Madam:

Enclosed are copies of the above-referenced applications filed with the New Mexico Oil Conservation Division on this date. Any objections that you have to these applications must be filed in writing with the New Mexico Oil Conservation Division, 1220 South St. Francis Drive, Santa Fe, New Mexico 87505, within twenty (20) days from the date the Division receives the above-referenced applications. If no objection is received within this twenty-day period, the applications may be approved administratively by the Division.

If you have any questions concerning this application, please contact:

Brett Stewart
Reservoir Engineer
Cimarex Energy Co.
Brett.Stewart@coterra.com
(432) 571-7889

Sincerely,

Earl E. DeBrine
Deana M. Bennett
Bryce H. Smith
Attorneys for Cimarex Energy Co.

Modrall Sperling
Roehl Harris & Sisk P.A.
500 Fourth Street NW
Suite 1000
Albuquerque,
New Mexico 87102

PO Box 2168
Albuquerque,
New Mexico 87103-2168

Tel: 505.848.1800
www.modrall.com

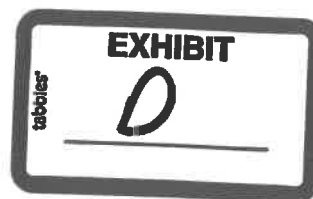
Scoter 6-31 Federal Com



| Offsetting Sections | Operator | WIOs If Needed N/A if Cimarex IS NOT operator | Date Notice Letter Sent |
|-----------------------|---|---|-------------------------|
| Section 30, T24S-R27E | Chevron USA Inc. 1400 Smith St. Houston, TX 77002 and Chevron USA Inc. 6301 Deauville Blvd. Midland, TX 79706 | N/A | 11/29/2022 |
| Section 7, T25S-R27E | Cimarex Energy Co. | Chevron USA Inc. 1400 Smith St. Houston, TX 77002 and Chevron USA Inc. 6301 Deauville Blvd. Midland, TX 79706 | 11/29/2022 |

Other Notice Parties:

| Other Notice Parties | Date Notice Letter Sent |
|---------------------------|-------------------------|
| Bureau of Land Management | 11/29/2022 |

Carlene Schuman
 100 Fourth Street, Suite 1000
 Albuquerque NM 87102

PS Form 3877

Type of Mailing: CERTIFIED MAIL
 11/29/2022

Firm Mailing Book ID: 237301

| Line | USPS Article Number | Name, Street, City, State, Zip | Postage | Service Fee | RR Fee | Rest.Del.Fee | Reference Contents |
|----------------|-----------------------------|--|---------------------|----------------|----------------|---------------|------------------------|
| 1 | 9314 8699 0430 0101 9251 14 | Chevron USA Inc. 6301 Deauville Blvd. Midland TX 79706 | \$2.64 | \$4.00 | \$2.00 | \$0.00 | 82762.128Scoter Notice |
| 2 | 9314 8699 0430 0101 9251 21 | United States of America Bureau of Land Management 301 Dinosaur Tr. Santa Fe NM 87508 | \$2.64 | \$4.00 | \$2.00 | \$0.00 | 82762.128Scoter Notice |
| 3 | 9314 8699 0430 0101 9251 38 | Chevron USA Inc. 1400 Smith St. Houston TX 77002 | \$2.64 | \$4.00 | \$2.00 | \$0.00 | 82762.128Scoter Notice |
| Totals: | | | \$7.92 | \$12.00 | \$6.00 | \$0.00 | |
| | | | Grand Total: | | \$25.92 | | |

List Number of Pieces
 Listed by Sender

Total Number of Pieces
 Received at Post Office

Postmaster:
 Name of receiving employee

Dated:



November 9, 2022

VIA E-FILING

Director Adrienne Sandoval and OCD Engineering Bureau
Oil Conservation Division
Energy, Minerals and Natural Resources Department
1220 South Saint Francis Drive
Santa Fe, New Mexico 87505

Re: Application of Cimarex Energy Co. for administrative approval of non-standard locations for Scoter 6-31 Federal Com 46H; Scoter 6-31 Federal Com 47H; Scoter 6-31 Federal Com 48H wells, located in the E/2 of Section 6, Township 25 South, Range 27 East, and Section 31, Township 24 South, Range 27 East, NMPM, Eddy County, New Mexico

Dear Director Sandoval/OCD Engineering Bureau

Cimarex Energy Co., OGRID Number 215099, respectfully requests administrative approval of non-standards location ("NSL") for the following wells (the "Wells"):

- Scoter 6-31 Federal Com 46H (API No. Pending);
- Scoter 6-31 Federal Com 47H (API No. Pending); and
- Scoter 6-31 Federal Com 48H (API No. Pending);

Cimarex is submitting three separate non-standard location applications, one for each well. The Wells will be completed within a standard 640 acre, more or less, spacing unit in the Purple Sage Wolfcamp Gas Pool (Pool ID: 98220). Cimarex is requesting non-standard location approval for the Wells to allow the setbacks to be less than 330' from the northern and southern boundaries of the horizontal spacing unit. Allowing Cimarex to complete the Wells at this non-standard location will result in the greatest recovery of reserves from all of the Wells and will reduce waste.

Thank you for your consideration. Should you have any questions please contact me at brett.stewart@coterra.com or (432)571-7889.

Sincerely,

A handwritten signature in black ink that reads "Brett Stewart". The signature is written in a cursive, flowing style.

Brett Stewart
Reservoir Engineer
Cimarex Energy Co.

Scoter 6-31 Federal Com E/2 Wells



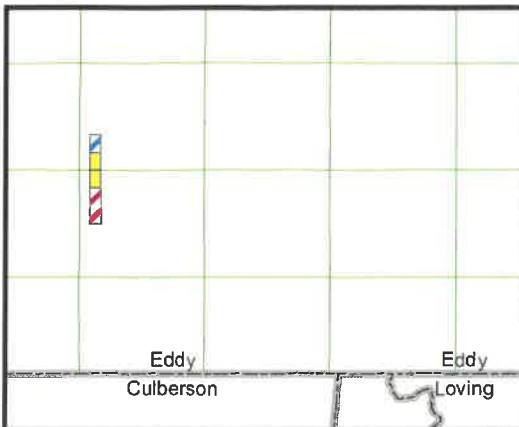
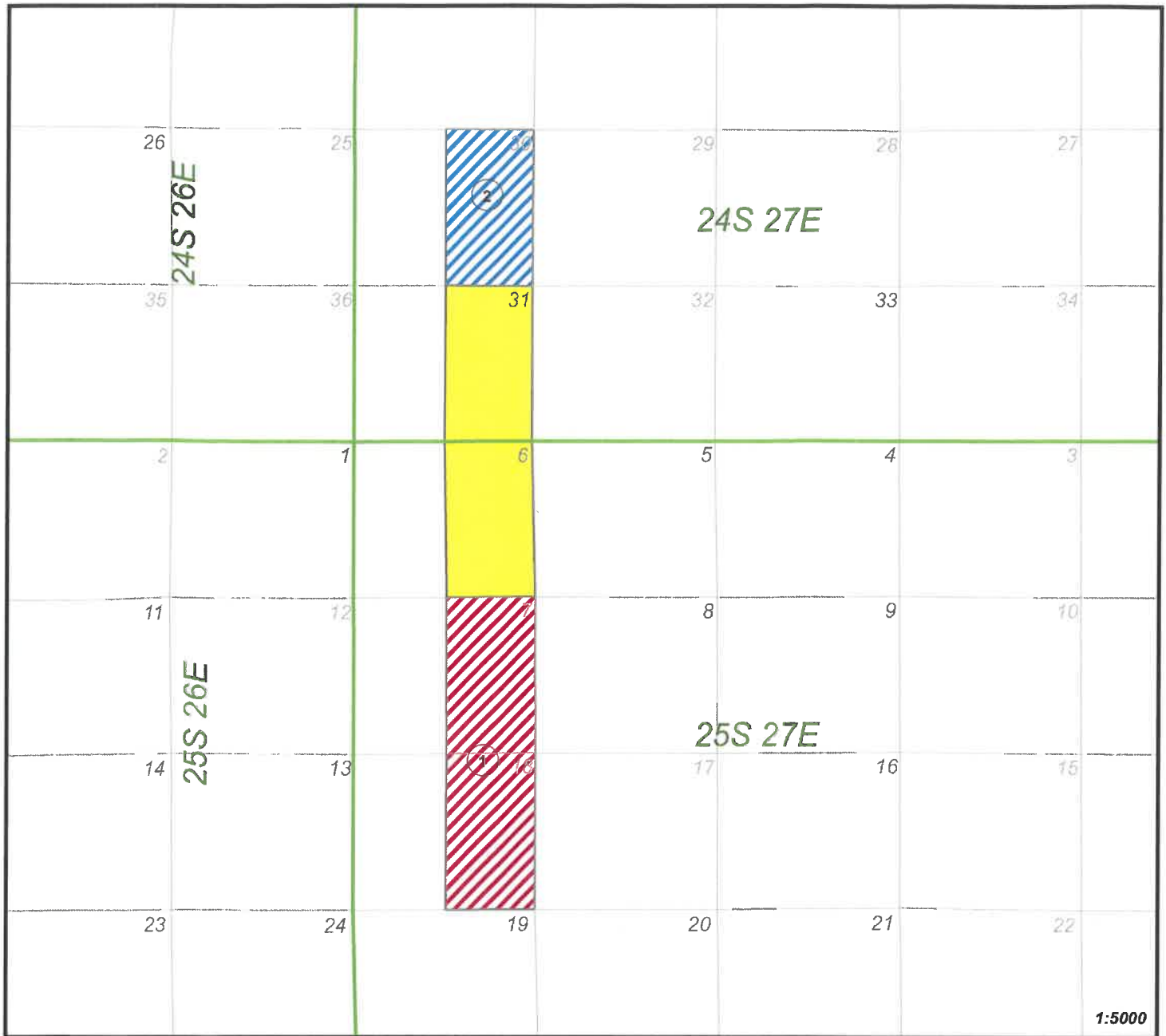

Scoter 6-31 (E2)



Cimarex



1) Cimarex, Operator
Chevron USA



2) Chevron USA
USA BLM

Eddy County, New Mexico

Township 24 South, Range 27 East, N.M.P.M.

Section 31: E2

Township 25 South, Range 27 East, N.M.P.M.

Section 6: E2

Released to Imaging: 12/27/2022 10:02:33 AM

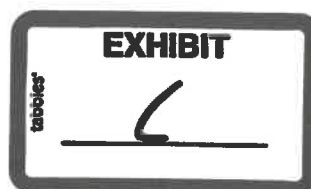

LEGACY
ONSHORE

District I

1625 N. French Dr., Hobbs, NM 88240
Phone:(575) 393-6161 Fax:(575) 393-0720

District II

811 S. First St., Artesia, NM 88210
Phone:(575) 748-1283 Fax:(575) 748-9720

District III

1000 Rio Brazos Rd., Aztec, NM 87410
Phone:(505) 334-6178 Fax:(505) 334-6170

District IV

1220 S. St Francis Dr., Santa Fe, NM 87505
Phone:(505) 476-3470 Fax:(505) 476-3462

State of New Mexico
Energy, Minerals and Natural Resources
Oil Conservation Division
1220 S. St Francis Dr.
Santa Fe, NM 87505

CONDITIONS

Action 162292

CONDITIONS

| | |
|--|--|
| Operator: CIMAREX ENERGY CO. 600 N. Marienfeld Street Midland, TX 79701 | OGRID: 215099 |
| | Action Number: 162292 |
| | Action Type: [UF-NSL] Non-Standard Location (NSL) |

CONDITIONS

| Created By | Condition | Condition Date |
|------------|--|----------------|
| llowe | NSL - 8496 is approved. The approved Order can be retrieved at the following OCD website link. https://ocdimage.emnrd.nm.gov/imaging/AEOrderCriteria.aspx | 11/30/2022 |