

Santa Fe Main Office  
 Phone: (505) 476-3441  
 General Information  
 Phone: (505) 629-6116

State of New Mexico  
 Energy, Minerals and Natural Resources Department

Form C-107-B  
 Revised August 1, 2011

**OIL CONSERVATION DIVISION**  
 1220 S. St Francis Drive  
 Santa Fe, New Mexico 87505

Submit the original application to the Santa Fe office with one copy to the appropriate District Office.

Online Phone Directory Visit:  
<https://www.emnrd.nm.gov/oed/contact-us/>

**APPLICATION FOR SURFACE COMMINGLING (DIVERSE OWNERSHIP)**

OPERATOR NAME: J R Oil Ltd., Co. OGRID 256073  
 OPERATOR ADDRESS: PO Box 2975 Hobbs, NM 88241  
 APPLICATION TYPE:

Pool Commingling  Lease Commingling  Pool and Lease Commingling  Off-Lease Storage and Measurement (Only if not Surface Commingled)

LEASE TYPE:  Fee  State  Federal

Is this an Amendment to existing Order?  Yes  No If "Yes", please include the appropriate Order No. \_\_\_\_\_  
 Have the Bureau of Land Management (BLM) and State Land office (SLO) been notified in writing of the proposed commingling  
 Yes  No

**(A) POOL COMMINGLING**  
 Please attach sheets with the following information

(1) Pool Names and Codes	Gravities / BTU of Non-Commingled Production	Calculated Gravities / BTU of Commingled Production	Calculated Value of Commingled Production	Volumes
Majamar Grayburg-San Andres [43329]	34.6 deg / 1,500	37.8 deg 1,263 BTU	12 BOPD 13 MCFD	2 BOPD, 1 MCFD
Corbin Abo [13150]	38.4 deg / 1,243			10 BOPD, 12 MCFD

(2) Are any wells producing at top allowables?  Yes  No  
 (3) Has all interest owners been notified by certified mail of the proposed commingling?  Yes  No.  
 (4) Measurement type:  Metering  Other (Specify)  
 (5) Will commingling decrease the value of production?  Yes  No If "yes", describe why commingling should be approved

**(B) LEASE COMMINGLING**  
 Please attach sheets with the following information

(1) Pool Name and Code.  
 (2) Is all production from same source of supply?  Yes  No  
 (3) Has all interest owners been notified by certified mail of the proposed commingling?  Yes  No  
 (4) Measurement type:  Metering  Other (Specify)

**(C) POOL and LEASE COMMINGLING**  
 Please attach sheets with the following information

(1) Complete Sections A and E.

**(D) OFF-LEASE STORAGE and MEASUREMENT**  
 Please attached sheets with the following information

(1) Is all production from same source of supply?  Yes  No  
 (2) Include proof of notice to all interest owners.

**(E) ADDITIONAL INFORMATION (for all application types)**  
 Please attach sheets with the following information

(1) A schematic diagram of facility, including legal location.  
 (2) A plat with lease boundaries showing all well and facility locations. Include lease numbers if Federal or State lands are involved.  
 (3) Lease Names, Lease and Well Numbers, and API Numbers.

I hereby certify that the information above is true and complete to the best of my knowledge and belief.

SIGNATURE:  TITLE: Engineer DATE: Jan 28, 2026

TYPE OR PRINT NAME Ian Petersen TELEPHONE NO.: (432) 634-4922

E-MAIL ADDRESS: ipetersen@jroil.com

Santa Fe Main Office  
 Phone: (505) 476-3441  
 General Information  
 Phone: (505) 629-6116

State of New Mexico  
 Energy, Minerals and Natural Resources Department

Form C-107-B  
 Revised August 1, 2011

**OIL CONSERVATION DIVISION**  
 1220 S. St Francis Drive  
 Santa Fe, New Mexico 87505

Submit the original application to the Santa Fe office with one copy to the appropriate District Office.

Online Phone Directory Visit:  
<https://www.emnrd.nm.gov/oed/contact-us/>

**APPLICATION FOR SURFACE COMMINGLING (DIVERSE OWNERSHIP)**

OPERATOR NAME: J R OilLtd., Co. OGRID 256073  
 OPERATOR ADDRESS: PO Box 2975 Hobbs, NM 88241  
 APPLICATION TYPE:

Pool Commingling  Lease Commingling  Pool and Lease Commingling  Off-Lease Storage and Measurement (Only if not Surface Commingled)

LEASE TYPE:  Fee  State  Federal

Is this an Amendment to existing Order?  Yes  No If "Yes", please include the appropriate Order No. \_\_\_\_\_  
 Have the Bureau of Land Management (BLM) and State Land office (SLO) been notified in writing of the proposed commingling  
 Yes  No

**(A) POOL COMMINGLING**  
 Please attach sheets with the following information

(1) Pool Names and Codes	Gravities / BTU of Non-Commingled Production	Calculated Gravities / BTU of Commingled Production	Calculated Value of Commingled Production	Volumes
Majamar Grayburg-San Andres [43329]	34.6 deg / 1,500	37.8 deg 1,263 BTU	12 BOPD 13 MCFD	2 BOPD, 1 MCFD
Corbin Abo [13150]	38.4 deg / 1,243			10 BOPD, 12 MCFD

(2) Are any wells producing at top allowables?  Yes  No  
 (3) Has all interest owners been notified by certified mail of the proposed commingling?  Yes  No.  
 (4) Measurement type:  Metering  Other (Specify)  
 (5) Will commingling decrease the value of production?  Yes  No If "yes", describe why commingling should be approved

**(B) LEASE COMMINGLING**  
 Please attach sheets with the following information

(1) Pool Name and Code.  
 (2) Is all production from same source of supply?  Yes  No  
 (3) Has all interest owners been notified by certified mail of the proposed commingling?  Yes  No  
 (4) Measurement type:  Metering  Other (Specify)

**(C) POOL and LEASE COMMINGLING**  
 Please attach sheets with the following information

(1) Complete Sections A and E.

**(D) OFF-LEASE STORAGE and MEASUREMENT**  
 Please attached sheets with the following information

(1) Is all production from same source of supply?  Yes  No  
 (2) Include proof of notice to all interest owners.

**(E) ADDITIONAL INFORMATION (for all application types)**  
 Please attach sheets with the following information

(1) A schematic diagram of facility, including legal location.  
 (2) A plat with lease boundaries showing all well and facility locations. Include lease numbers if Federal or State lands are involved.  
 (3) Lease Names, Lease and Well Numbers, and API Numbers.

I hereby certify that the information above is true and complete to the best of my knowledge and belief.

SIGNATURE:  TITLE: Engineer DATE: Jan 28, 2026

TYPE OR PRINT NAME Ian Petersen TELEPHONE NO.: (432) 634-4922

E-MAIL ADDRESS: ipetersen@jroil.com

RECEIVED:	REVIEWER:	TYPE:	APP NO:
-----------	-----------	-------	---------

ABOVE THIS TABLE FOR OCD DIVISION USE ONLY

**NEW MEXICO OIL CONSERVATION DIVISION**  
 - Geological & Engineering Bureau -  
 1220 South St. Francis Drive, Santa Fe, NM 87505



**ADMINISTRATIVE APPLICATION CHECKLIST**

THIS CHECKLIST IS MANDATORY FOR ALL ADMINISTRATIVE APPLICATIONS FOR EXCEPTIONS TO DIVISION RULES AND REGULATIONS WHICH REQUIRE PROCESSING AT THE DIVISION LEVEL IN SANTA FE

**Applicant:** \_\_\_\_\_ **OGRID Number:** \_\_\_\_\_  
**Well Name:** \_\_\_\_\_ **API:** \_\_\_\_\_  
**Pool:** \_\_\_\_\_ **Pool Code:** \_\_\_\_\_

**SUBMIT ACCURATE AND COMPLETE INFORMATION REQUIRED TO PROCESS THE TYPE OF APPLICATION INDICATED BELOW**

- 1) **TYPE OF APPLICATION:** Check those which apply for [A]
- A. Location – Spacing Unit – Simultaneous Dedication  
 NSL       NSP (PROJECT AREA)       NSP (PRORATION UNIT)       SD
- B. Check one only for [ I ] or [ II ]
- [ I ] Commingling – Storage – Measurement  
 DHC    CTB    PLC    PC    OLS    OLM
- [ II ] Injection – Disposal – Pressure Increase – Enhanced Oil Recovery  
 WFX    PMX    SWD    IPI    EOR    PPR

- 2) **NOTIFICATION REQUIRED TO:** Check those which apply.
- A.  Offset operators or lease holders  
 B.  Royalty, overriding royalty owners, revenue owners  
 C.  Application requires published notice  
 D.  Notification and/or concurrent approval by SLO  
 E.  Notification and/or concurrent approval by BLM  
 F.  Surface owner  
 G.  For all of the above, proof of notification or publication is attached, and/or,  
 H.  No notice required

<u>FOR OCD ONLY</u>	
<input type="checkbox"/>	Notice Complete
<input type="checkbox"/>	Application Content Complete

3) **CERTIFICATION:** I hereby certify that the information submitted with this application for administrative approval is **accurate** and **complete** to the best of my knowledge. I also understand that **no action** will be taken on this application until the required information and notifications are submitted to the Division.

**Note: Statement must be completed by an individual with managerial and/or supervisory capacity.**

\_\_\_\_\_  
 Print or Type Name

  
 \_\_\_\_\_  
 Signature

\_\_\_\_\_  
Date

\_\_\_\_\_  
Phone Number

\_\_\_\_\_  
e-mail Address



---

---

**P.O. Box 53657  
Lubbock, TX 79453**

New Mexico Oil Conservation Division  
Administrative Permitting  
1220 S. St. Francis Drive  
Santa Fe, NM 87505

FROM: Ian Petersen, Engineer  
JR Oil, Ltd. Co., Operator  
P. O. Box 53657  
Lubbock, TX 79453  
(432) 634-4922  
ipetersen@jroil.com

SUBJECT: State CL Surface Commingle

DATE: January 28, 2026

---

J R Oil respectfully requests permission to surface commingle the State CL #4 and State CL #5 production batteries. Respective facilities are already located on the same pad. Both wells share the same State lease (E0-2439-0005). J R Oil possesses 100% of the working interests.

Well details are as follows:

State CL #4 (30-025-01576), Corbin Abo [13150] pool

State CL #5 (30-025-01577), Maljamar Grayburg San-Andres [43329] pool

Work plan consists of

- 1) Disconnecting the CL #4 gas sales meter, well connection, and separator
- 2) Move CL #4 separator to the CL #5 berm
- 3) Connect CL #4 flow line to CL #5 header, connect the header to the separator, then the separator to the heater
  - a. Connect separator gas discharge to the CL #5 gas sales line
- 4) Commingle CL #5 oil tanks with the CL #4 oil tank

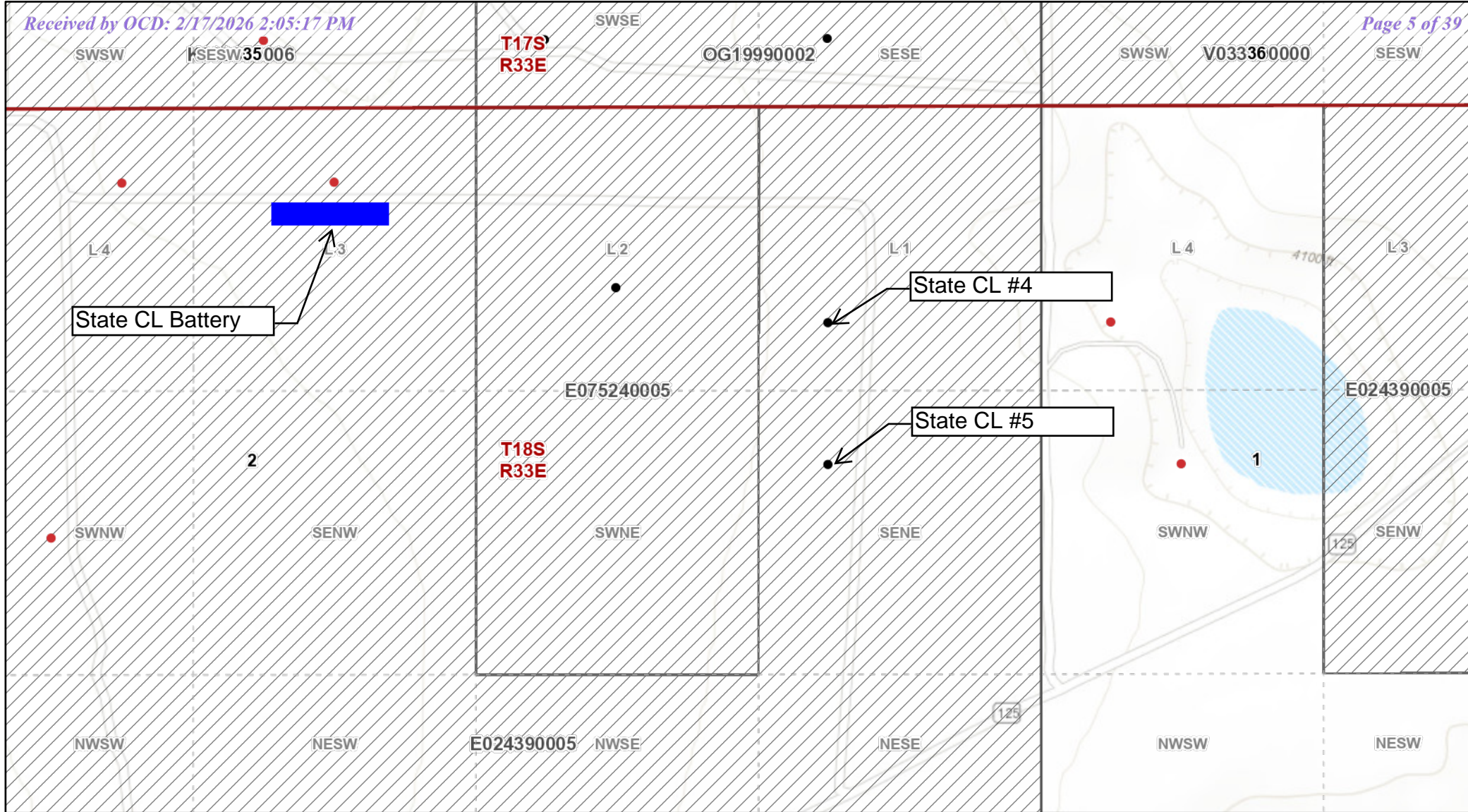

### State CL leases

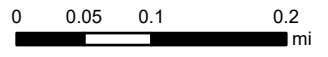

**New Mexico State Land Office**

Disclaimer:  
 The New Mexico State Land Office assumes no responsibility or liability for, or in connection with the accuracy, reliability or use of the information provided herein with respect to State Land Office data or data from other sources.

Data pertaining to New Mexico State Trust Lands are provisional and subject to revision, and do not constitute an official record of title. Official records may be reviewed at the New Mexico State Land Office in Santa Fe, New Mexico.

Released to Imaging: 2/25/2026 2:26:31 PM  
 Map Created: 11/13/2025

- Subdivisions
- Sections
- Townships
- County Boundaries
- State Boundary
- County Seats

- NMOCD\_Inactive Symbology
- Miscellaneous
  - CO2 Cancelled
  - CO2, Plugged
  - CO2, Temporarily Abandoned
  - Gas, Cancelled

- Gas, Plugged
- Gas, Temporarily Abandoned
- Injection, Cancelled
- Injection, Plugged
- Injection, Temporarily Abandoned
- Oil, Cancelled

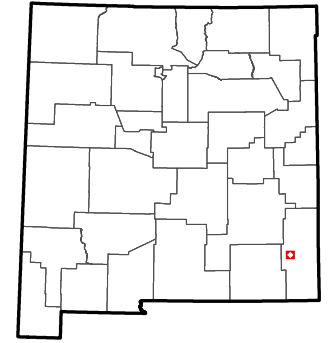

### State CL Battery (current)

382' FNL, 2,040' FWL, S2 T18S R33E

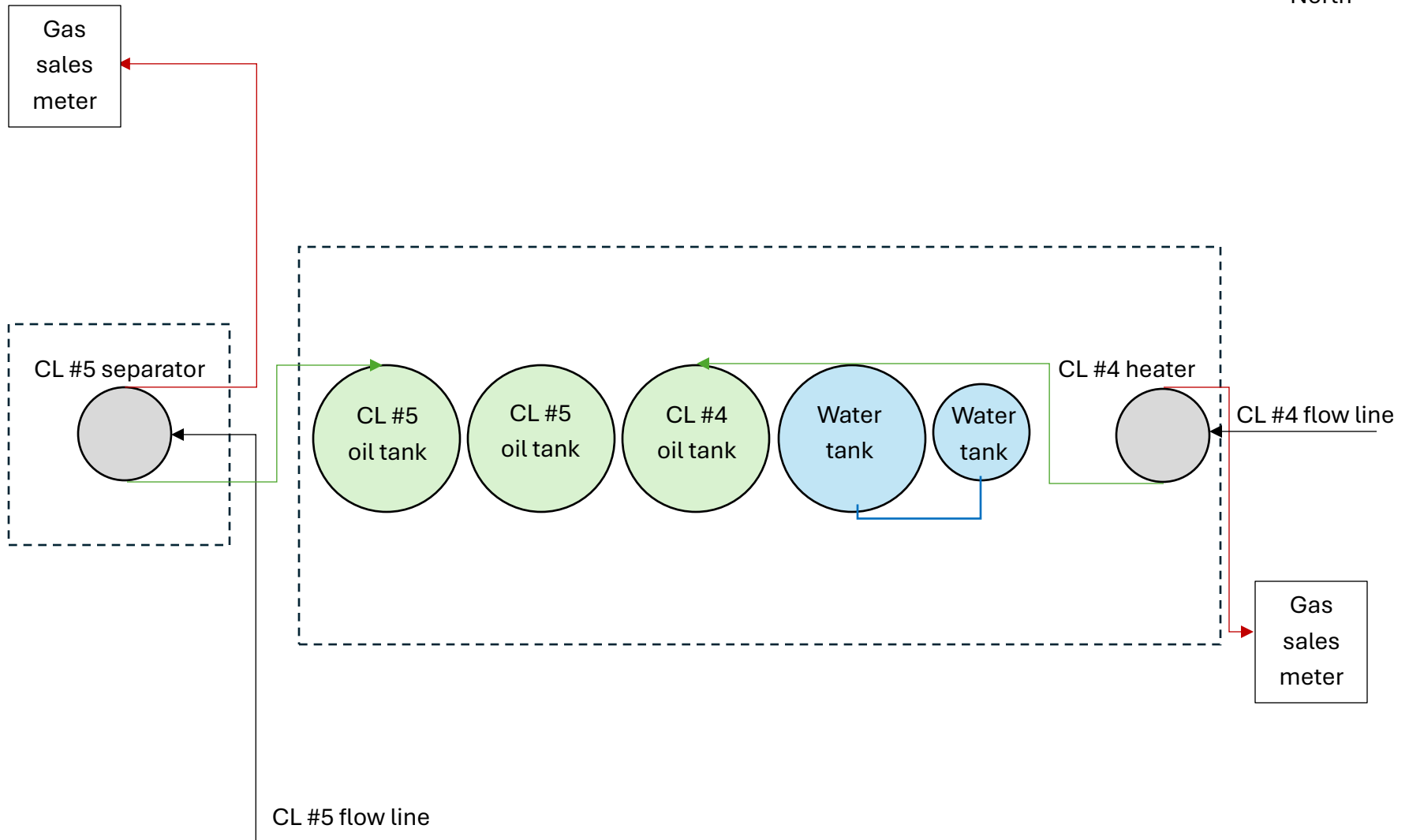
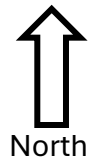

### State CL Battery (proposed)

382' FNL, 2,040' FWL, S2 T18S R33E

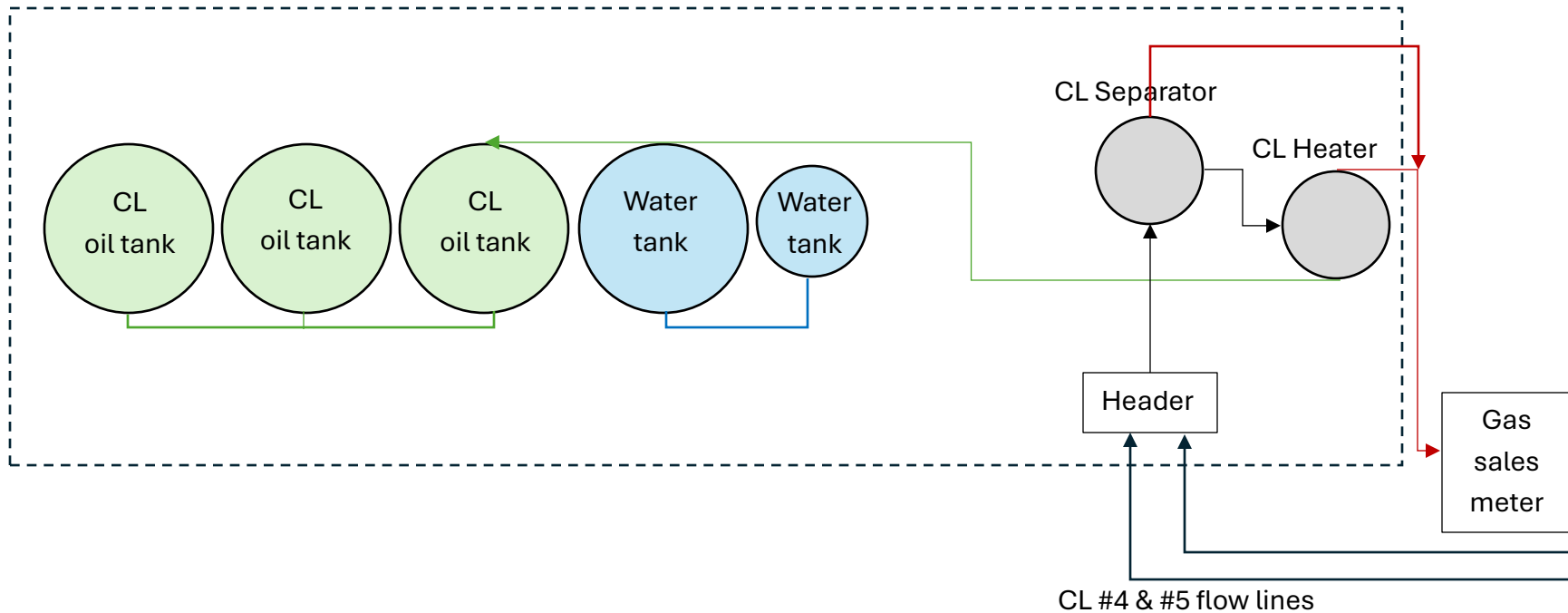



---

---

**P.O. Box 53657  
Lubbock TX 79453**

January 28, 2026

New Mexico Oil Conservation Division  
1220 South St. Francis Drive  
Santa Fe, NM 87505

Re: Surface Commingle Application  
State CL #004 API: 30-025-01576  
A-02-T18S-R33E  
State CL #005 API: 30-025-01577  
H-02-T18S-R33E  
Lea County, NM

Gentlemen:

Concerning JR Oil's application to surface commingle production in the subject wells, this letter serves to confirm the following: All working, royalty and overriding royalty interests are identical between the Maljamar Grayburg San Andres (Pool Code: 43329) and Corbin Abo (Pool Code: 13150) in the spacing units dedicated to these formations. Therefore, no notice to interest owners is required.

The spacing unit is comprised of an SLO Lease. Therefore, pursuant to Subsection C.(1) of 19.15.12.10 (2)(c) NMAC, written notice has been sent to New Mexico State Land Office as of the date of this letter.

If you have any questions or concerns, please contact the undersigned using the information provided below.

Sincerely,

**J R OIL, LTD. CO.**

By: **COLT ENERGY, LLC**

A handwritten signature in cursive script that reads 'Drew Alfred'.

---

Drew Alfred, Landman

SENDER: COMPLETE THIS SECTION

COMPLETE THIS SECTION ON DELIVERY

- Complete items 1, 2, and 3.
- Print your name and address on the reverse so that we can return the card to you.
- Attach this card to the back of the mailpiece, or on the front if space permits.

1. Article Addressed to:

Commissioner of Public Lands  
 Attn: Commingling Manager  
 PO Box 1148  
 Santa Fe, NM 87504-1148



9590 9402 3217 7196 1191 17

A. Signature

X

- Agent
- Addressee

B. Received by (Printed Name)

Marcus Barela

C. Date of Delivery

2/4/26

D. Is delivery address different from item 1? If YES, enter delivery address below:

- Yes
- No

3. Service Type

- Adult Signature
- Adult Signature Restricted Delivery
- Certified Mail®
- Certified Mail Restricted Delivery
- Collect on Delivery
- Collect on Delivery Restricted Delivery
- Mail Restricted Delivery
- Priority Mail Express®
- Registered Mail™
- Registered Mail Restricted Delivery
- Return Receipt for Merchandise
- Signature Confirmation™
- Signature Confirmation Restricted Delivery

2. Article Number (Transfer from service label)

9589 0710 5270 1799 0110 14

PS Form 3811, July 2015 PSN 7530-02-000-9053

Domestic Return Receipt



---

---

**P.O. Box 53657  
Lubbock TX 79453**

New Mexico State Land Office  
Commissioner of Public Lands  
Attn: Commingling Manager  
PO Box 1148  
Santa Fe, NM 87504

FROM: Ian Petersen, Engineer  
J R Oil, Ltd. Co., Operator  
P. O. Box 53657  
Lubbock, TX 79453  
(432) 634-4922  
ipetersen@jroil.com

SUBJECT: State CL Surface Commingle

DATE: January 28, 2026

---

J R Oil respectfully requests permission to surface commingle oil & gas production at the subject tank battery. Attached is the NMOCD application and details. Both facilities are already located on the same pad and share the same State lease (E0-2439-0005). J R Oil possesses 100% of the working interests.

If you have questions regarding the lease please contact

Drew Alfred  
Landman  
(512) 913-4966  
drew@valleyviewenergy.com

If you have technical questions please contact

Ian Petersen  
Engineer  
(432) 634-4922  
ipetersen@jroil.com

RECEIVED:	REVIEWER:	TYPE:	APP NO:
-----------	-----------	-------	---------

ABOVE THIS TABLE FOR OCD DIVISION USE ONLY

**NEW MEXICO OIL CONSERVATION DIVISION**  
 - Geological & Engineering Bureau -  
 1220 South St. Francis Drive, Santa Fe, NM 87505



**ADMINISTRATIVE APPLICATION CHECKLIST**

THIS CHECKLIST IS MANDATORY FOR ALL ADMINISTRATIVE APPLICATIONS FOR EXCEPTIONS TO DIVISION RULES AND REGULATIONS WHICH REQUIRE PROCESSING AT THE DIVISION LEVEL IN SANTA FE

**Applicant:** \_\_\_\_\_ **OGRID Number:** \_\_\_\_\_  
**Well Name:** \_\_\_\_\_ **API:** \_\_\_\_\_  
**Pool:** \_\_\_\_\_ **Pool Code:** \_\_\_\_\_

**SUBMIT ACCURATE AND COMPLETE INFORMATION REQUIRED TO PROCESS THE TYPE OF APPLICATION INDICATED BELOW**

- 1) **TYPE OF APPLICATION:** Check those which apply for [A]
- A. Location – Spacing Unit – Simultaneous Dedication  
 NSL       NSP (PROJECT AREA)       NSP (PRORATION UNIT)       SD
- B. Check one only for [ I ] or [ II ]
- [ I ] Commingling – Storage – Measurement  
 DHC    CTB    PLC    PC    OLS    OLM
- [ II ] Injection – Disposal – Pressure Increase – Enhanced Oil Recovery  
 WFX    PMX    SWD    IPI    EOR    PPR

- 2) **NOTIFICATION REQUIRED TO:** Check those which apply.
- A.  Offset operators or lease holders  
 B.  Royalty, overriding royalty owners, revenue owners  
 C.  Application requires published notice  
 D.  Notification and/or concurrent approval by SLO  
 E.  Notification and/or concurrent approval by BLM  
 F.  Surface owner  
 G.  For all of the above, proof of notification or publication is attached, and/or,  
 H.  No notice required

<u>FOR OCD ONLY</u>	
<input type="checkbox"/>	Notice Complete
<input type="checkbox"/>	Application Content Complete

3) **CERTIFICATION:** I hereby certify that the information submitted with this application for administrative approval is **accurate** and **complete** to the best of my knowledge. I also understand that **no action** will be taken on this application until the required information and notifications are submitted to the Division.

**Note: Statement must be completed by an individual with managerial and/or supervisory capacity.**

\_\_\_\_\_  
 Print or Type Name

\_\_\_\_\_  
 Signature

\_\_\_\_\_  
Date

\_\_\_\_\_  
Phone Number

\_\_\_\_\_  
e-mail Address

Santa Fe Main Office  
 Phone: (505) 476-3441  
 General Information  
 Phone: (505) 629-6116

State of New Mexico  
 Energy, Minerals and Natural Resources Department

Form C-107-B  
 Revised August 1, 2011

**OIL CONSERVATION DIVISION**  
 1220 S. St Francis Drive  
 Santa Fe, New Mexico 87505

Submit the original application to the Santa Fe office with one copy to the appropriate District Office.

Online Phone Directory Visit:  
<https://www.emnrd.nm.gov/oed/contact-us/>

**APPLICATION FOR SURFACE COMMINGLING (DIVERSE OWNERSHIP)**

OPERATOR NAME: J R Oil Ltd., Co. OGRID 256073  
 OPERATOR ADDRESS: PO Box 2975 Hobbs, NM 88241  
 APPLICATION TYPE:

Pool Commingling    Lease Commingling    Pool and Lease Commingling    Off-Lease Storage and Measurement (Only if not Surface Commingled)

LEASE TYPE:    Fee    State    Federal

Is this an Amendment to existing Order?    Yes    No   If "Yes", please include the appropriate Order No. \_\_\_\_\_  
 Have the Bureau of Land Management (BLM) and State Land office (SLO) been notified in writing of the proposed commingling  
 Yes    No

**(A) POOL COMMINGLING**  
 Please attach sheets with the following information

(1) Pool Names and Codes	Gravities / BTU of Non-Commingled Production	Calculated Gravities / BTU of Commingled Production	Calculated Value of Commingled Production	Volumes
Maljamar Grayburg-San Andres [43329]	34.6 deg / 1,500	37.8 deg 1,263 BTU	12 BOPD 13 MCFD	2 BOPD, 1 MCFD
Corbin Abo [13150]	38.4 deg / 1,243			10 BOPD, 12 MCFD

(2) Are any wells producing at top allowables?    Yes    No  
 (3) Has all interest owners been notified by certified mail of the proposed commingling?    Yes    No.  
 (4) Measurement type:    Metering    Other (Specify)  
 (5) Will commingling decrease the value of production?    Yes    No   If "yes", describe why commingling should be approved

**(B) LEASE COMMINGLING**  
 Please attach sheets with the following information

(1) Pool Name and Code.  
 (2) Is all production from same source of supply?    Yes    No  
 (3) Has all interest owners been notified by certified mail of the proposed commingling?    Yes    No  
 (4) Measurement type:    Metering    Other (Specify)

**(C) POOL and LEASE COMMINGLING**  
 Please attach sheets with the following information

(1) Complete Sections A and E.

**(D) OFF-LEASE STORAGE and MEASUREMENT**  
 Please attached sheets with the following information

(1) Is all production from same source of supply?    Yes    No  
 (2) Include proof of notice to all interest owners.

**(E) ADDITIONAL INFORMATION (for all application types)**  
 Please attach sheets with the following information

(1) A schematic diagram of facility, including legal location.  
 (2) A plat with lease boundaries showing all well and facility locations. Include lease numbers if Federal or State lands are involved.  
 (3) Lease Names, Lease and Well Numbers, and API Numbers.

I hereby certify that the information above is true and complete to the best of my knowledge and belief.

SIGNATURE:    TITLE: Engineer   DATE: Jan 28, 2026

TYPE OR PRINT NAME Ian Petersen   TELEPHONE NO.: (432) 634-4922

E-MAIL ADDRESS: ipetersen@jroil.com

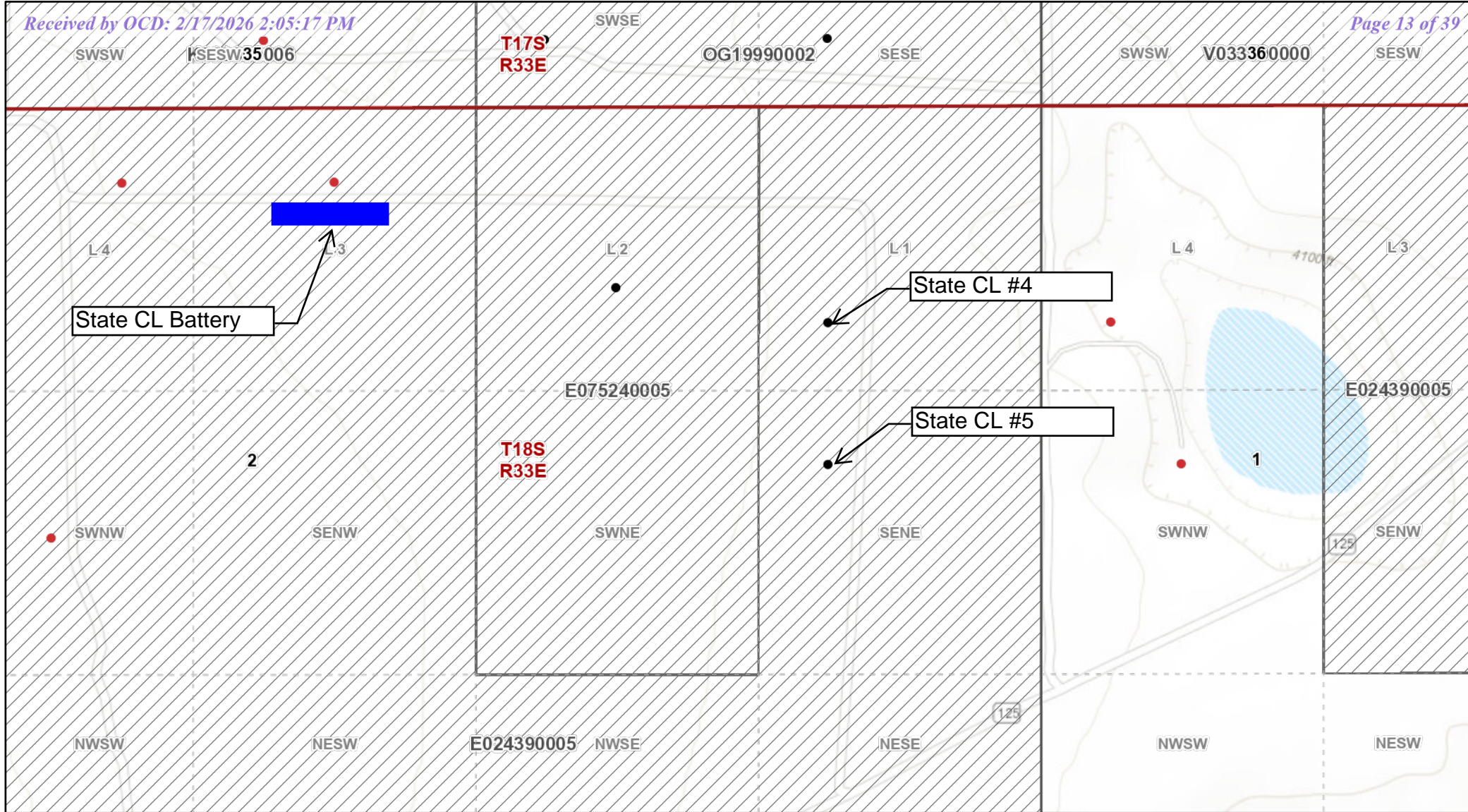

### State CL leases

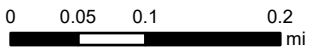

New Mexico State Land Office

Disclaimer:  
 The New Mexico State Land Office assumes no responsibility or liability for, or in connection with the accuracy, reliability or use of the information provided herein with respect to State Land Office data or data from other sources.

Data pertaining to New Mexico State Trust Lands are provisional and subject to revision, and do not constitute an official record of title. Official records may be reviewed at the New Mexico State Land Office in Santa Fe, New Mexico.

Released to Imaging: 2/25/2026 2:26:31 PM  
 Map Created: 11/13/2025

- Subdivisions
- Sections
- Townships
- County Boundaries
- State Boundary
- County Seats

- NMOCD\_Inactive Symbology
- Miscellaneous
  - CO2 Cancelled
  - CO2, Plugged
  - CO2, Temporarily Abandoned
  - Gas, Cancelled

- Gas, Plugged
- Gas, Temporarily Abandoned
- Injection, Cancelled
- Injection, Plugged
- Injection, Temporarily Abandoned
- Oil, Cancelled

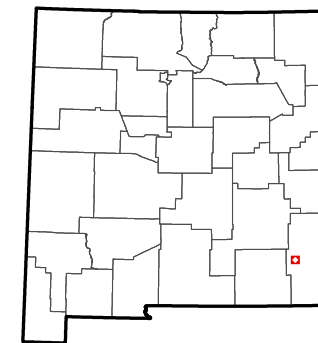



---

---

**P.O. Box 53657  
Lubbock TX 79453**

January 28, 2026

New Mexico Oil Conservation Division  
1220 South St. Francis Drive  
Santa Fe, NM 87505

Re: Surface Commingle Application  
State CL #004 API: 30-025-01576  
A-02-T18S-R33E  
State CL #005 API: 30-025-01577  
H-02-T18S-R33E  
Lea County, NM

Gentlemen:

Concerning JR Oil's application to surface commingle production in the subject wells, this letter serves to confirm the following: All working, royalty and overriding royalty interests are identical between the Maljamar Grayburg San Andres (Pool Code: 43329) and Corbin Abo (Pool Code: 13150) in the spacing units dedicated to these formations. Therefore, no notice to interest owners is required.

The spacing unit is comprised of an SLO Lease. Therefore, pursuant to Subsection C.(1) of 19.15.12.10 (2)(c) NMAC, written notice has been sent to New Mexico State Land Office as of the date of this letter.

If you have any questions or concerns, please contact the undersigned using the information provided below.

Sincerely,

**J R OIL, LTD. CO.**

By: **COLT ENERGY, LLC**

A handwritten signature in cursive script that reads 'Drew Alfred'.

---

Drew Alfred, Landman



---

---

**P.O. Box 53657  
Lubbock, TX 79453**

New Mexico Oil Conservation Division  
Administrative Permitting  
1220 S. St. Francis Drive  
Santa Fe, NM 87505

FROM: Ian Petersen, Engineer  
JR Oil, Ltd. Co., Operator  
P. O. Box 53657  
Lubbock, TX 79453  
(432) 634-4922  
ipetersen@jroil.com

SUBJECT: State CL Surface Commingle

DATE: January 28, 2026

---

J R Oil respectfully requests permission to surface commingle the State CL #4 and State CL #5 production batteries. Respective facilities are already located on the same pad. Both wells share the same State lease (E0-2439-0005). J R Oil possesses 100% of the working interests.

Well details are as follows:

State CL #4 (30-025-01576), Corbin Abo [13150] pool

State CL #5 (30-025-01577), Maljamar Grayburg San-Andres [43329] pool

Work plan consists of

- 1) Disconnecting the CL #4 gas sales meter, well connection, and separator
- 2) Move CL #4 separator to the CL #5 berm
- 3) Connect CL #4 flow line to CL #5 header, connect the header to the separator, then the separator to the heater
  - a. Connect separator gas discharge to the CL #5 gas sales line
- 4) Commingle CL #5 oil tanks with the CL #4 oil tank

### State CL Battery (current)

382' FNL, 2,040' FWL, S2 T18S R33E

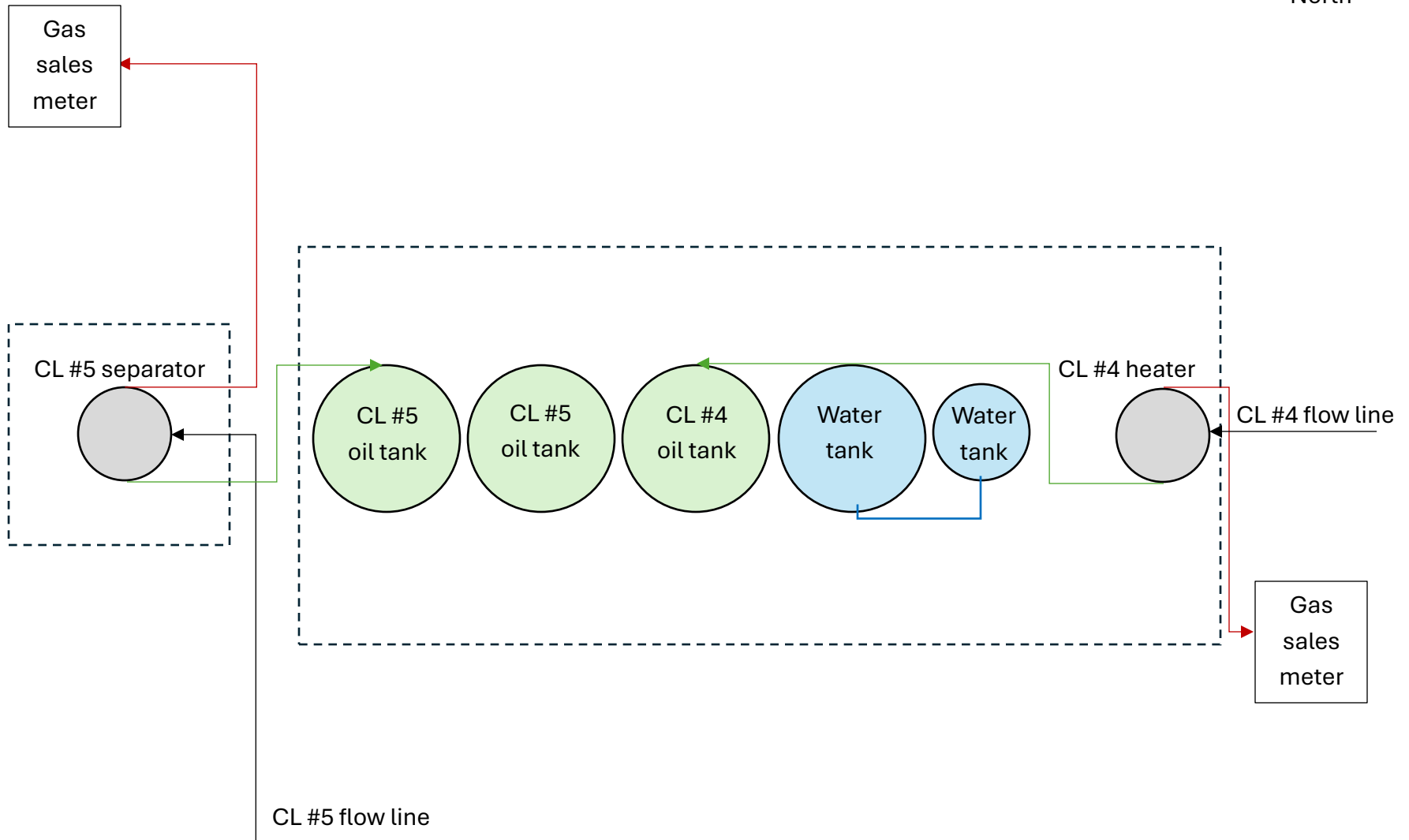
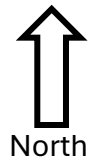

### State CL Battery (proposed)

382' FNL, 2,040' FWL, S2 T18S R33E

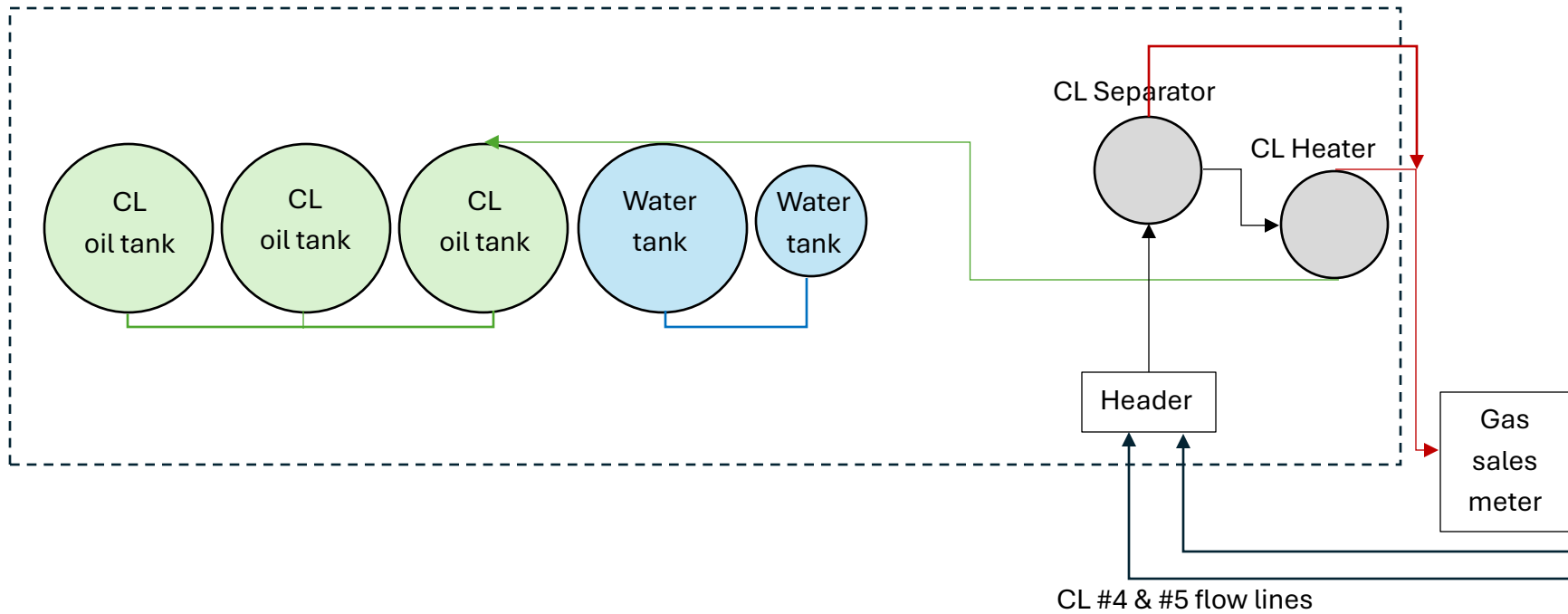
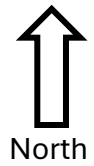



---

---

**P.O. Box 53657  
Lubbock, TX 79453**

New Mexico Oil Conservation Division  
Administrative Permitting  
1220 S. St. Francis Drive  
Santa Fe, NM 87505

FROM: Ian Petersen, Engineer  
JR Oil, Ltd. Co., Operator  
P. O. Box 53657  
Lubbock, TX 79453  
(432) 634-4922  
ipetersen@jroil.com

SUBJECT: State CL Surface Commingle

DATE: January 28, 2026

---

J R Oil respectfully requests permission to surface commingle the State CL #4 and State CL #5 production batteries. Respective facilities are already located on the same pad. Both wells share the same State lease (E0-2439-0005). J R Oil possesses 100% of the working interests.

Well details are as follows:

State CL #4 (30-025-01576), Corbin Abo [13150] pool

State CL #5 (30-025-01577), Maljamar Grayburg San-Andres [43329] pool

Work plan consists of

- 1) Disconnecting the CL #4 gas sales meter, well connection, and separator
- 2) Move CL #4 separator to the CL #5 berm
- 3) Connect CL #4 flow line to CL #5 header, connect the header to the separator, then the separator to the heater
  - a. Connect separator gas discharge to the CL #5 gas sales line
- 4) Commingle CL #5 oil tanks with the CL #4 oil tank

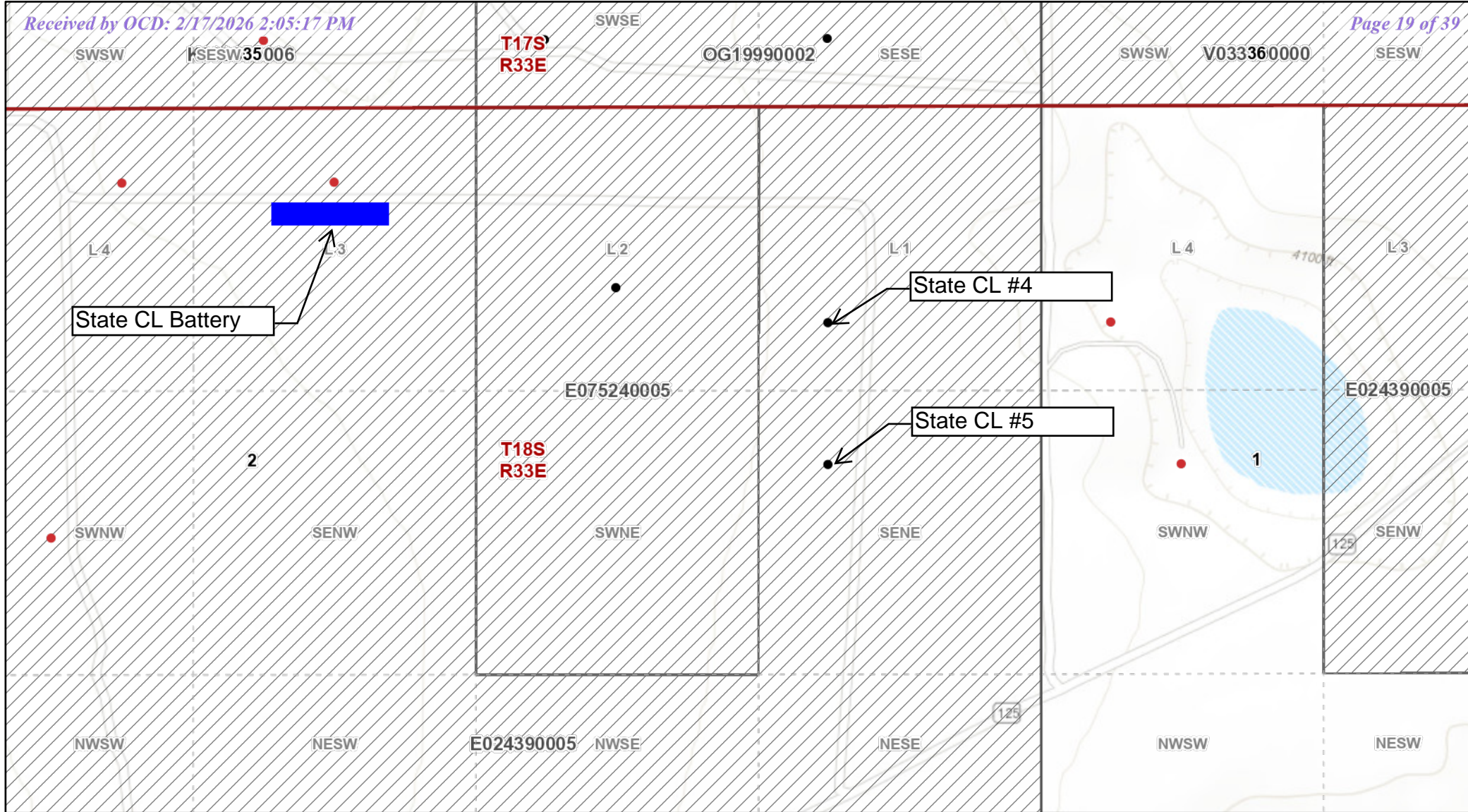

### State CL leases

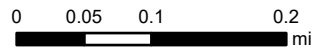

**New Mexico State Land Office**

Disclaimer:  
 The New Mexico State Land Office assumes no responsibility or liability for, or in connection with the accuracy, reliability or use of the information provided herein with respect to State Land Office data or data from other sources.

Data pertaining to New Mexico State Trust Lands are provisional and subject to revision, and do not constitute an official record of title. Official records may be reviewed at the New Mexico State Land Office in Santa Fe, New Mexico.

Released to Imaging: 2/25/2026 2:26:31 PM  
 Map Created: 11/13/2025

- Subdivisions
- Sections
- Townships
- County Boundaries
- State Boundary
- County Seats

- NMOCD\_Inactive Symbology
- Miscellaneous
  - CO2 Cancelled
  - CO2, Plugged
  - CO2, Temporarily Abandoned
  - Gas, Cancelled

- Gas, Plugged
- Gas, Temporarily Abandoned
- Injection, Cancelled
- Injection, Plugged
- Injection, Temporarily Abandoned
- Oil, Cancelled

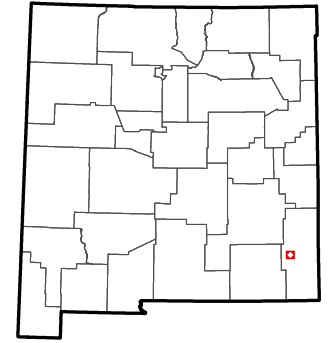



### State CL Battery (proposed)

382' FNL, 2,040' FWL, S2 T18S R33E

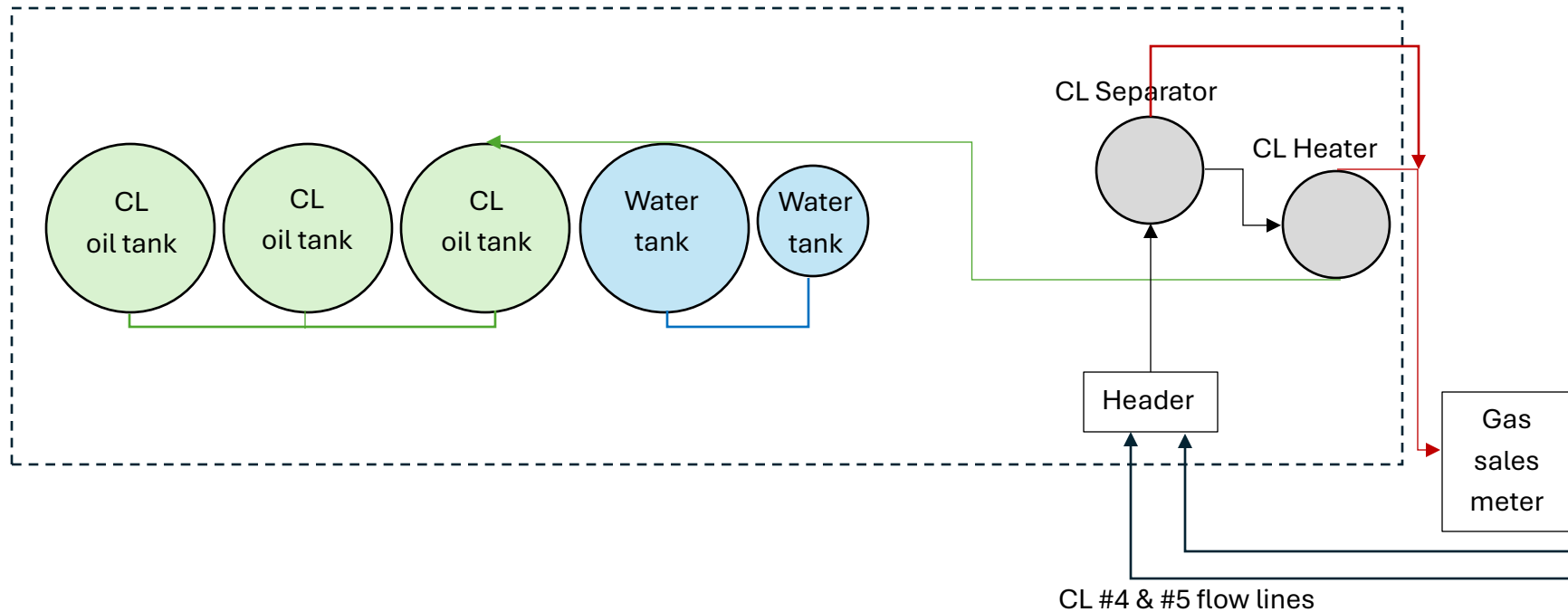
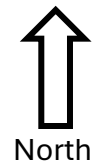



---

---

**P.O. Box 53657  
Lubbock TX 79453**

January 28, 2026

New Mexico Oil Conservation Division  
1220 South St. Francis Drive  
Santa Fe, NM 87505

Re: Surface Commingle Application  
State CL #004 API: 30-025-01576  
A-02-T18S-R33E  
State CL #005 API: 30-025-01577  
H-02-T18S-R33E  
Lea County, NM

Gentlemen:

Concerning JR Oil's application to surface commingle production in the subject wells, this letter serves to confirm the following: All working, royalty and overriding royalty interests are identical between the Maljamar Grayburg San Andres (Pool Code: 43329) and Corbin Abo (Pool Code: 13150) in the spacing units dedicated to these formations. Therefore, no notice to interest owners is required.

The spacing unit is comprised of an SLO Lease. Therefore, pursuant to Subsection C.(1) of 19.15.12.10 (2)(c) NMAC, written notice has been sent to New Mexico State Land Office as of the date of this letter.

If you have any questions or concerns, please contact the undersigned using the information provided below.

Sincerely,

**J R OIL, LTD. CO.**

By: **COLT ENERGY, LLC**

A handwritten signature in cursive script that reads 'Drew Alfred'.

---

Drew Alfred, Landman

SENDER: COMPLETE THIS SECTION

COMPLETE THIS SECTION ON DELIVERY

- Complete items 1, 2, and 3.
- Print your name and address on the reverse so that we can return the card to you.
- Attach this card to the back of the mailpiece, or on the front if space permits.

A. Signature  Agent  
 Addressee

B. Received by (Printed Name)  Agent  
 Marcus Barela  Addressee

C. Date of Delivery  
 2/4/26

1. Article Addressed to:  
 Commissioner of Public Lands  
 Attn: Commingling Manager  
 PO Box 1148  
 Santa Fe, NM 87504-1148

D. Is delivery address different from item 1?  Yes  
 If YES, enter delivery address below:  No



9590 9402 3217 7196 1191 17

3. Service Type
- Adult Signature
  - Adult Signature Restricted Delivery
  - Certified Mail®
  - Certified Mail Restricted Delivery
  - Collect on Delivery
  - Collect on Delivery Restricted Delivery
  - Priority Mail Express®
  - Registered Mail™
  - Registered Mail Restricted Delivery
  - Return Receipt for Merchandise
  - Signature Confirmation™
  - Signature Confirmation Restricted Delivery

2. Article Number (Transfer from service label)  
 9589 0710 5270 1799 0110 14

PS Form 3811, July 2015 PSN 7530-02-000-9053

Domestic Return Receipt



---

---

**P.O. Box 53657  
Lubbock TX 79453**

New Mexico State Land Office  
Commissioner of Public Lands  
Attn: Commingling Manager  
PO Box 1148  
Santa Fe, NM 87504

FROM: Ian Petersen, Engineer  
J R Oil, Ltd. Co., Operator  
P. O. Box 53657  
Lubbock, TX 79453  
(432) 634-4922  
ipetersen@jroil.com

SUBJECT: State CL Surface Commingle

DATE: January 28, 2026

---

J R Oil respectfully requests permission to surface commingle oil & gas production at the subject tank battery. Attached is the NMOCD application and details. Both facilities are already located on the same pad and share the same State lease (E0-2439-0005). J R Oil possesses 100% of the working interests.

If you have questions regarding the lease please contact

Drew Alfred  
Landman  
(512) 913-4966  
drew@valleyviewenergy.com

If you have technical questions please contact

Ian Petersen  
Engineer  
(432) 634-4922  
ipetersen@jroil.com

RECEIVED:	REVIEWER:	TYPE:	APP NO:
-----------	-----------	-------	---------

ABOVE THIS TABLE FOR OCD DIVISION USE ONLY

**NEW MEXICO OIL CONSERVATION DIVISION**  
 - Geological & Engineering Bureau -  
 1220 South St. Francis Drive, Santa Fe, NM 87505



**ADMINISTRATIVE APPLICATION CHECKLIST**

THIS CHECKLIST IS MANDATORY FOR ALL ADMINISTRATIVE APPLICATIONS FOR EXCEPTIONS TO DIVISION RULES AND REGULATIONS WHICH REQUIRE PROCESSING AT THE DIVISION LEVEL IN SANTA FE

**Applicant:** \_\_\_\_\_ **OGRID Number:** \_\_\_\_\_  
**Well Name:** \_\_\_\_\_ **API:** \_\_\_\_\_  
**Pool:** \_\_\_\_\_ **Pool Code:** \_\_\_\_\_

**SUBMIT ACCURATE AND COMPLETE INFORMATION REQUIRED TO PROCESS THE TYPE OF APPLICATION INDICATED BELOW**

- 1) **TYPE OF APPLICATION:** Check those which apply for [A]  
 A. Location – Spacing Unit – Simultaneous Dedication  
 NSL       NSP (PROJECT AREA)       NSP (PRORATION UNIT)       SD
- B. Check one only for [ I ] or [ II ]  
 [ I ] Commingling – Storage – Measurement  
 DHC    CTB    PLC    PC    OLS    OLM  
 [ II ] Injection – Disposal – Pressure Increase – Enhanced Oil Recovery  
 WFX    PMX    SWD    IPI    EOR    PPR

- 2) **NOTIFICATION REQUIRED TO:** Check those which apply.  
 A.  Offset operators or lease holders  
 B.  Royalty, overriding royalty owners, revenue owners  
 C.  Application requires published notice  
 D.  Notification and/or concurrent approval by SLO  
 E.  Notification and/or concurrent approval by BLM  
 F.  Surface owner  
 G.  For all of the above, proof of notification or publication is attached, and/or,  
 H.  No notice required

<u>FOR OCD ONLY</u>	
<input type="checkbox"/>	Notice Complete
<input type="checkbox"/>	Application Content Complete

3) **CERTIFICATION:** I hereby certify that the information submitted with this application for administrative approval is **accurate** and **complete** to the best of my knowledge. I also understand that **no action** will be taken on this application until the required information and notifications are submitted to the Division.

**Note: Statement must be completed by an individual with managerial and/or supervisory capacity.**

\_\_\_\_\_  
 Print or Type Name

\_\_\_\_\_  
 Signature

\_\_\_\_\_  
Date

\_\_\_\_\_  
Phone Number

\_\_\_\_\_  
e-mail Address

Santa Fe Main Office  
 Phone: (505) 476-3441  
 General Information  
 Phone: (505) 629-6116

State of New Mexico  
 Energy, Minerals and Natural Resources Department

Form C-107-B  
 Revised August 1, 2011

**OIL CONSERVATION DIVISION**  
 1220 S. St Francis Drive  
 Santa Fe, New Mexico 87505

Submit the original application to the Santa Fe office with one copy to the appropriate District Office.

Online Phone Directory Visit:  
<https://www.emnrd.nm.gov/oed/contact-us/>

**APPLICATION FOR SURFACE COMMINGLING (DIVERSE OWNERSHIP)**

OPERATOR NAME: J R Oil Ltd., Co. OGRID 256073  
 OPERATOR ADDRESS: PO Box 2975 Hobbs, NM 88241  
 APPLICATION TYPE:

Pool Commingling  Lease Commingling  Pool and Lease Commingling  Off-Lease Storage and Measurement (Only if not Surface Commingled)

LEASE TYPE:  Fee  State  Federal

Is this an Amendment to existing Order?  Yes  No If "Yes", please include the appropriate Order No. \_\_\_\_\_  
 Have the Bureau of Land Management (BLM) and State Land office (SLO) been notified in writing of the proposed commingling  
 Yes  No

**(A) POOL COMMINGLING**  
 Please attach sheets with the following information

(1) Pool Names and Codes	Gravities / BTU of Non-Commingled Production	Calculated Gravities / BTU of Commingled Production	Calculated Value of Commingled Production	Volumes
Majamar Grayburg-San Andres [43329]	34.6 deg / 1,500	37.8 deg 1,263 BTU	12 BOPD 13 MCFD	2 BOPD, 1 MCFD
Corbin Abo [13150]	38.4 deg / 1,243			10 BOPD, 12 MCFD

(2) Are any wells producing at top allowables?  Yes  No  
 (3) Has all interest owners been notified by certified mail of the proposed commingling?  Yes  No.  
 (4) Measurement type:  Metering  Other (Specify)  
 (5) Will commingling decrease the value of production?  Yes  No If "yes", describe why commingling should be approved

**(B) LEASE COMMINGLING**  
 Please attach sheets with the following information

(1) Pool Name and Code.  
 (2) Is all production from same source of supply?  Yes  No  
 (3) Has all interest owners been notified by certified mail of the proposed commingling?  Yes  No  
 (4) Measurement type:  Metering  Other (Specify)

**(C) POOL and LEASE COMMINGLING**  
 Please attach sheets with the following information

(1) Complete Sections A and E.

**(D) OFF-LEASE STORAGE and MEASUREMENT**  
 Please attached sheets with the following information

(1) Is all production from same source of supply?  Yes  No  
 (2) Include proof of notice to all interest owners.

**(E) ADDITIONAL INFORMATION (for all application types)**  
 Please attach sheets with the following information

(1) A schematic diagram of facility, including legal location.  
 (2) A plat with lease boundaries showing all well and facility locations. Include lease numbers if Federal or State lands are involved.  
 (3) Lease Names, Lease and Well Numbers, and API Numbers.

I hereby certify that the information above is true and complete to the best of my knowledge and belief.

SIGNATURE:  TITLE: Engineer DATE: Jan 28, 2026

TYPE OR PRINT NAME Ian Petersen TELEPHONE NO.: (432) 634-4922

E-MAIL ADDRESS: ipetersen@jroil.com

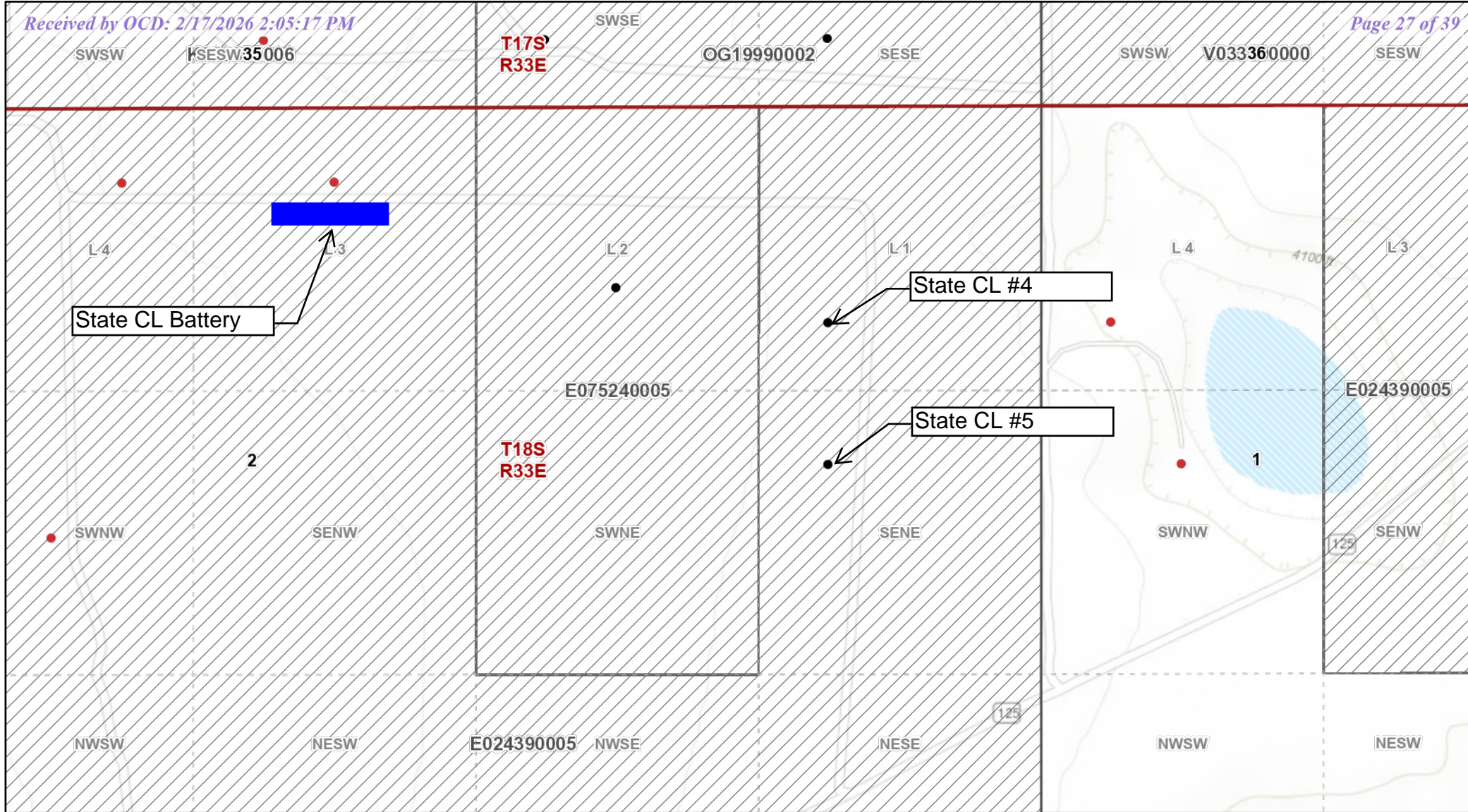

### State CL leases

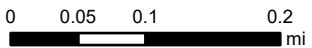

**New Mexico State Land Office**

Disclaimer:  
The New Mexico State Land Office assumes no responsibility or liability for, or in connection with the accuracy, reliability or use of the information provided herein with respect to State Land Office data or data from other sources.

Data pertaining to New Mexico State Trust Lands are provisional and subject to revision, and do not constitute an official record of title. Official records may be reviewed at the New Mexico State Land Office in Santa Fe, New Mexico.

Released to Imaging: 2/25/2026 2:26:31 PM  
Map Created: 11/13/2025

- Subdivisions
- Sections
- Townships
- County Boundaries
- State Boundary
- County Seats

NMOCD\_Inactive

Symbology

- Miscellaneous
- CO2 Cancelled
- CO2, Plugged
- CO2, Temporarily Abandoned
- Gas, Cancelled

- Gas, Plugged
- Gas, Temporarily Abandoned
- Injection, Cancelled
- Injection, Plugged
- Injection, Temporarily Abandoned
- Oil, Cancelled

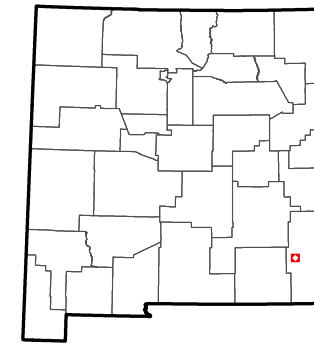



---

---

**P.O. Box 53657  
Lubbock TX 79453**

January 28, 2026

New Mexico Oil Conservation Division  
1220 South St. Francis Drive  
Santa Fe, NM 87505

Re: Surface Commingle Application  
State CL #004 API: 30-025-01576  
A-02-T18S-R33E  
State CL #005 API: 30-025-01577  
H-02-T18S-R33E  
Lea County, NM

Gentlemen:

Concerning JR Oil's application to surface commingle production in the subject wells, this letter serves to confirm the following: All working, royalty and overriding royalty interests are identical between the Maljamar Grayburg San Andres (Pool Code: 43329) and Corbin Abo (Pool Code: 13150) in the spacing units dedicated to these formations. Therefore, no notice to interest owners is required.

The spacing unit is comprised of an SLO Lease. Therefore, pursuant to Subsection C.(1) of 19.15.12.10 (2)(c) NMAC, written notice has been sent to New Mexico State Land Office as of the date of this letter.

If you have any questions or concerns, please contact the undersigned using the information provided below.

Sincerely,

**J R OIL, LTD. CO.**

By: **COLT ENERGY, LLC**

A handwritten signature in cursive script that reads 'Drew Alfred'.

---

Drew Alfred, Landman



---

---

**P.O. Box 53657  
Lubbock, TX 79453**

New Mexico Oil Conservation Division  
Administrative Permitting  
1220 S. St. Francis Drive  
Santa Fe, NM 87505

FROM: Ian Petersen, Engineer  
JR Oil, Ltd. Co., Operator  
P. O. Box 53657  
Lubbock, TX 79453  
(432) 634-4922  
ipetersen@jroil.com

SUBJECT: State CL Surface Commingle

DATE: January 28, 2026

---

J R Oil respectfully requests permission to surface commingle the State CL #4 and State CL #5 production batteries. Respective facilities are already located on the same pad. Both wells share the same State lease (E0-2439-0005). J R Oil possesses 100% of the working interests.

Well details are as follows:

State CL #4 (30-025-01576), Corbin Abo [13150] pool

State CL #5 (30-025-01577), Maljamar Grayburg San-Andres [43329] pool

Work plan consists of

- 1) Disconnecting the CL #4 gas sales meter, well connection, and separator
- 2) Move CL #4 separator to the CL #5 berm
- 3) Connect CL #4 flow line to CL #5 header, connect the header to the separator, then the separator to the heater
  - a. Connect separator gas discharge to the CL #5 gas sales line
- 4) Commingle CL #5 oil tanks with the CL #4 oil tank

### State CL Battery (current)

382' FNL, 2,040' FWL, S2 T18S R33E

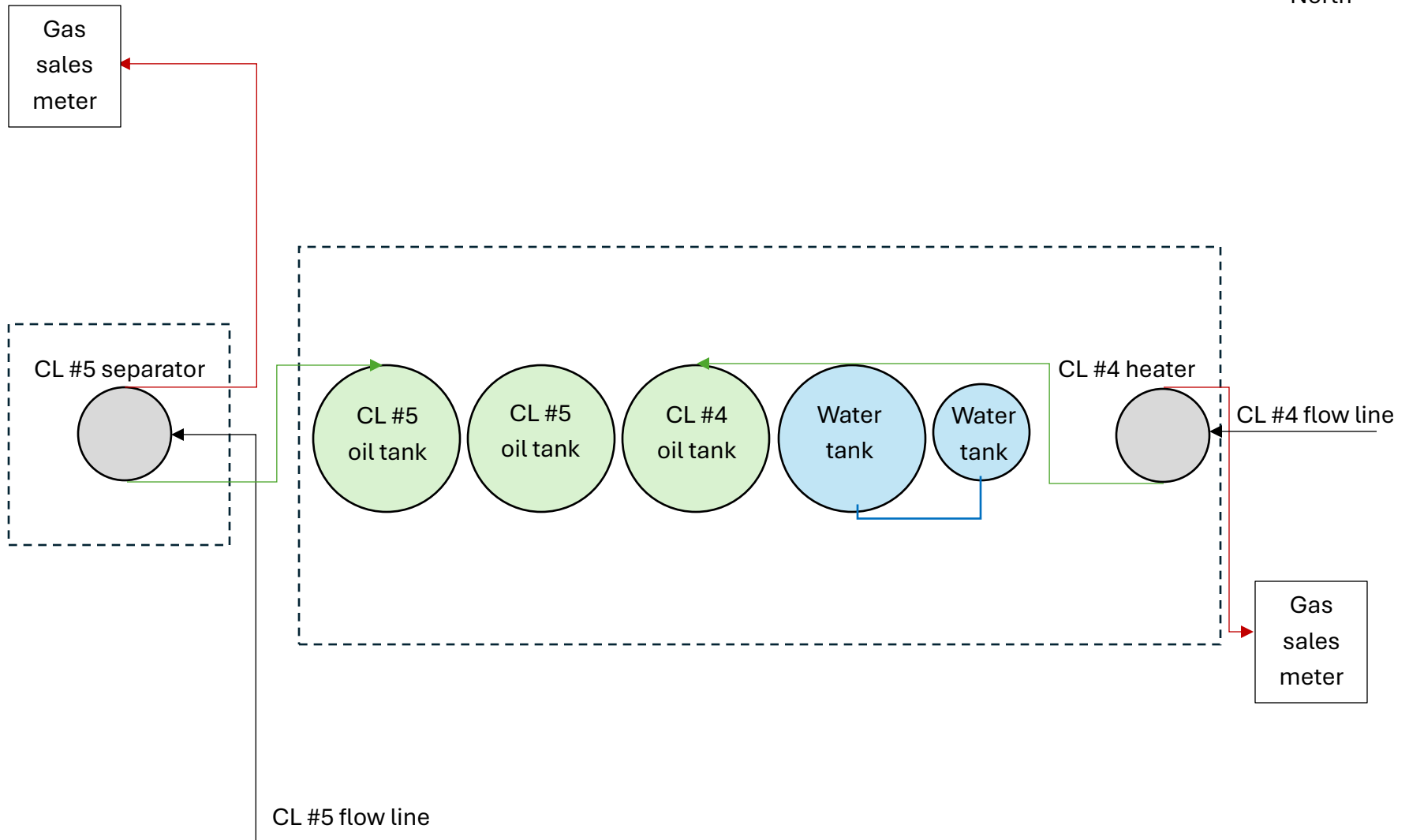
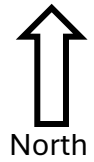

### State CL Battery (proposed)

382' FNL, 2,040' FWL, S2 T18S R33E

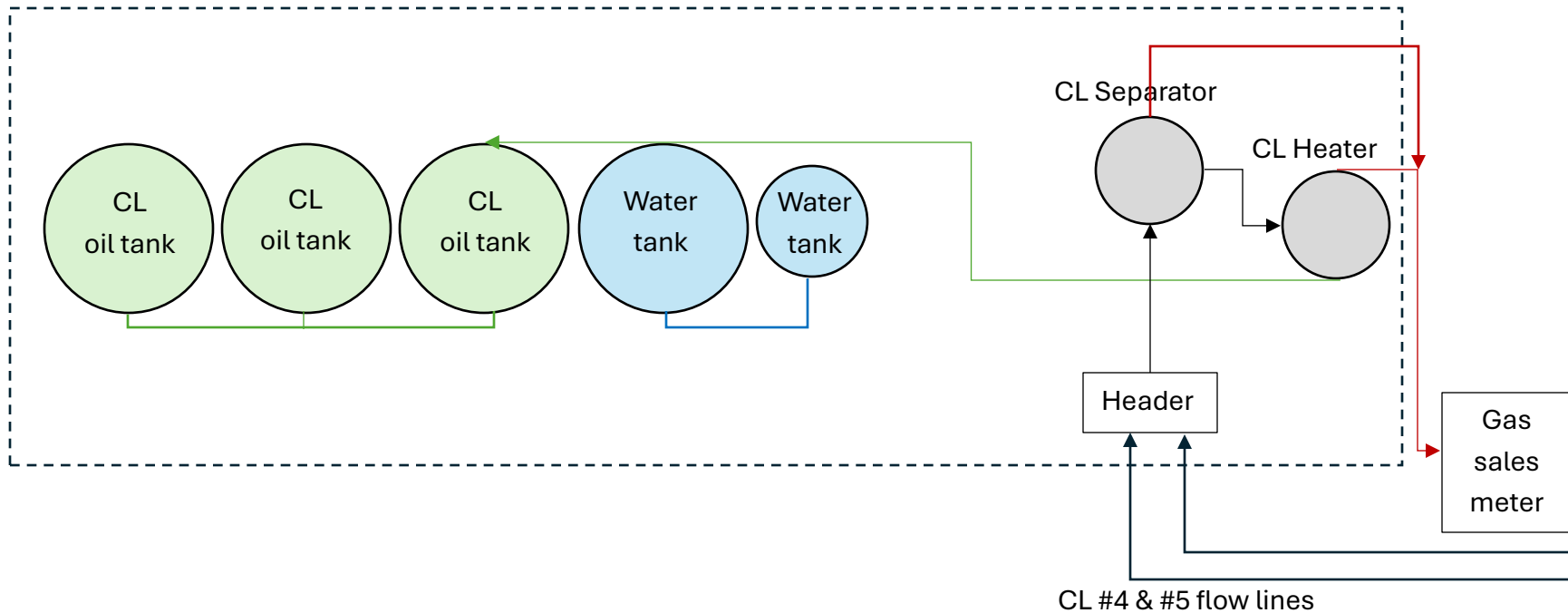
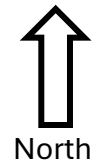

ALERT: WINTER WEATHER IN THE NORTH CENTRAL AND NORTHEASTERN US MAY DELAY FI...

# USPS Tracking®

FAQs >

Tracking Number:

Remove X

## 9589071052701799011014

Copy

Add to Informed Delivery (<https://informedelivery.usps.com/>)

### Latest Update

Your item was picked up at the post office at 7:52 am on February 4, 2026 in SANTA FE, NM 87501.

Get More Out of USPS Tracking:

**USPS Tracking Plus®**

Feedback

#### Delivered

**Delivered, Individual Picked Up at Post Office**

SANTA FE, NM 87501

February 4, 2026, 7:52 am

#### In Transit to Next Facility

February 3, 2026

#### Departed USPS Facility

ALBUQUERQUE, NM 87101

February 2, 2026, 6:37 pm

#### Arrived at USPS Facility

ALBUQUERQUE, NM 87101

February 2, 2026, 11:56 am

#### Arrived at USPS Regional Origin Facility

AMARILLO TX DISTRIBUTION CENTER

January 31, 2026, 9:54 pm

#### Departed Post Office

HOBBS, NM 88240  
January 30, 2026, 3:55 am

**USPS in possession of item**

HOBBS, NM 88240  
January 29, 2026, 10:32 am

Hide Tracking History

[What Do USPS Tracking Statuses Mean?](https://faq.usps.com/s/article/Where-is-my-package) (https://faq.usps.com/s/article/Where-is-my-package)

**Text & Email Updates**



**USPS Tracking Plus®**



**Product Information**



See Less ^

Track Another Package

Enter tracking or barcode numbers

## Need More Help?

Contact USPS Tracking support for further assistance.

**FAQs**

RECEIVED:	REVIEWER:	TYPE:	APP NO:
-----------	-----------	-------	---------

ABOVE THIS TABLE FOR OCD DIVISION USE ONLY

**NEW MEXICO OIL CONSERVATION DIVISION**  
 - Geological & Engineering Bureau -  
 1220 South St. Francis Drive, Santa Fe, NM 87505



**ADMINISTRATIVE APPLICATION CHECKLIST**

THIS CHECKLIST IS MANDATORY FOR ALL ADMINISTRATIVE APPLICATIONS FOR EXCEPTIONS TO DIVISION RULES AND REGULATIONS WHICH REQUIRE PROCESSING AT THE DIVISION LEVEL IN SANTA FE

**Applicant:** \_\_\_\_\_ **OGRID Number:** \_\_\_\_\_  
**Well Name:** \_\_\_\_\_ **API:** \_\_\_\_\_  
**Pool:** \_\_\_\_\_ **Pool Code:** \_\_\_\_\_

**SUBMIT ACCURATE AND COMPLETE INFORMATION REQUIRED TO PROCESS THE TYPE OF APPLICATION INDICATED BELOW**

- 1) **TYPE OF APPLICATION:** Check those which apply for [A]  
 A. Location – Spacing Unit – Simultaneous Dedication  
 NSL       NSP (PROJECT AREA)       NSP (PRORATION UNIT)       SD
- B. Check one only for [ I ] or [ II ]  
 [ I ] Commingling – Storage – Measurement  
 DHC    CTB    PLC    PC    OLS    OLM  
 [ II ] Injection – Disposal – Pressure Increase – Enhanced Oil Recovery  
 WFX    PMX    SWD    IPI    EOR    PPR

- 2) **NOTIFICATION REQUIRED TO:** Check those which apply.  
 A.  Offset operators or lease holders  
 B.  Royalty, overriding royalty owners, revenue owners  
 C.  Application requires published notice  
 D.  Notification and/or concurrent approval by SLO  
 E.  Notification and/or concurrent approval by BLM  
 F.  Surface owner  
 G.  For all of the above, proof of notification or publication is attached, and/or,  
 H.  No notice required

<u>FOR OCD ONLY</u>	
<input type="checkbox"/>	Notice Complete
<input type="checkbox"/>	Application Content Complete

3) **CERTIFICATION:** I hereby certify that the information submitted with this application for administrative approval is **accurate** and **complete** to the best of my knowledge. I also understand that **no action** will be taken on this application until the required information and notifications are submitted to the Division.

**Note: Statement must be completed by an individual with managerial and/or supervisory capacity.**

\_\_\_\_\_  
 Print or Type Name

\_\_\_\_\_  
 Signature

\_\_\_\_\_  
Date

\_\_\_\_\_  
Phone Number

\_\_\_\_\_  
e-mail Address

**STATE OF NEW MEXICO  
ENERGY, MINERALS AND NATURAL RESOURCES DEPARTMENT  
OIL CONSERVATION DIVISION**

**APPLICATION FOR SURFACE COMMINGLING  
SUBMITTED BY JR OIL, LTD. CO.**

**ORDER NO. PC-1413**

**ORDER**

The Director of the New Mexico Oil Conservation Division (“OCD”), having considered the application and the recommendation of the OCD Engineering Bureau, issues the following Order.

**FINDINGS OF FACT**

1. JR Oil, LTD. Co. (“Applicant”) submitted a complete application to surface commingle the oil and gas production from the pools and leases described in Exhibit A (“Application”).
2. Applicant included a complete list of the wells currently dedicated to each pool and lease.
3. Applicant proposed a method to allocate the oil and gas production to the pools, leases, and wells to be commingled.
4. Applicant certified the commingling of oil and gas production from the pools, leases, and wells will not in reasonable probability reduce the value of the oil and gas production to less than if it had remained segregated.
5. Applicant submitted a certification by a licensed attorney or qualified petroleum landman that the ownership in the pools, leases, and wells to be commingled is identical as defined in 19.15.12.7(B) NMAC.
6. Applicant provided notice of the Application to the Bureau of Land Management (“BLM”) or New Mexico State Land Office (“NMSLO”), as applicable.

**CONCLUSIONS OF LAW**

7. OCD has jurisdiction to issue this Order pursuant to the Oil and Gas Act, NMSA 1978, §§ 70-2-6, 70-2-11, 70-2-12, 70-2-16, and 70-2-17, 19.15.12. NMAC, and 19.15.23. NMAC.
8. Applicant satisfied the notice requirements for the Application in accordance with 19.15.12.10(A)(2) NMAC, 19.15.12.10(C)(4)(c) NMAC, and 19.15.12.10(C)(4)(e) NMAC, as applicable.
9. Applicant satisfied the notice requirements for the Application in accordance with 19.15.23.9(A)(5) NMAC and 19.15.23.9(A)(6) NMAC, as applicable.
10. Applicant’s proposed method of allocation, as modified herein, complies with 19.15.12.10(B)(1) NMAC or 19.15.12.10(C)(1) NMAC, as applicable.

11. Commingling of oil and gas production from state, federal, or tribal leases shall not commence until approved by the BLM or NMSLO, as applicable, in accordance with 19.15.12.10(B)(3) NMAC and 19.15.12.10(C)(4)(h) NMAC.
12. By granting the Application with the conditions specified below, this Order prevents waste and protects correlative rights, public health, and the environment.

### **ORDER**

1. Applicant is authorized to surface commingle oil and gas production from the pools and leases as described in Exhibit A.

Applicant is authorized to surface commingle oil and gas production from the wells included in Exhibit A, provided that they produce from a pool and lease described in Exhibit A.

Applicant is authorized to store and measure oil and gas production off-lease, as applicable, from the pools and leases as described in Exhibit A at a central tank battery or gas title transfer meter described in Exhibit A.

2. The oil and gas production for each well identified in Exhibit A shall be separated and metered prior to commingling it with production from another well.
3. If Applicant recovers oil or gas production from produced water prior to Applicant injecting it or transferring custody of it, then that production shall be allocated to each well in the proportion that it contributed to the total produced water.
4. If Applicant recovers gas production using a vapor recovery unit (VRU), then that gas production shall be allocated to each well in the proportion that it contributed to the total oil production.
5. Applicant shall measure and market the commingled oil at a central tank battery described in Exhibit A in accordance with this Order and 19.15.18.15 NMAC or 19.15.23.8 NMAC.
6. Applicant shall measure and market the commingled gas at a well pad, central delivery point, central tank battery, or gas title transfer meter described in Exhibit A in accordance with this Order and 19.15.19.9 NMAC, provided however that if the gas is vented or flared, and regardless of the reason or authorization pursuant to 19.15.28.8(B) NMAC for such venting or flaring, Applicant shall measure or estimate the gas in accordance with 19.15.28.8(E) NMAC.
7. Applicant shall calibrate the meters used to measure or allocate oil and gas production in accordance with 19.15.12.10(C)(2) NMAC.
8. Applicant shall install and utilize vessels that are appropriately designed to ensure sufficient separation of the fluids and to accurately measure oil and gas production.

9. If the commingling of oil and gas production from any pool, lease, or well reduces the value of the commingled oil and gas production to less than if it had remained segregated, no later than sixty (60) days after the decrease in value has occurred Applicant shall submit a new surface commingling application to OCD to amend this Order to remove the pool, lease, or well whose oil and gas production caused the decrease in value. If Applicant fails to submit a new application, this Order shall terminate on the following day, and if OCD denies the application, this Order shall terminate on the date of such action.
10. Applicant shall not commence commingling oil or gas production from state, federal, or tribal leases until approved by the BLM or NMSLO, as applicable.
11. If OCD determines that Applicant has failed to comply with any provision of this Order, OCD may take any action authorized by the Oil and Gas Act or the New Mexico Administrative Code (NMAC).
12. OCD retains jurisdiction of this matter and reserves the right to modify or revoke this Order as it deems necessary.

**STATE OF NEW MEXICO  
OIL CONSERVATION DIVISION**



Gerasimos Razatos for Albert Chang

**ALBERT C. S. CHANG  
DIRECTOR**

**DATE:** 2/24/2026

State of New Mexico  
Energy, Minerals and Natural Resources Department

## Exhibit A

**Order: PC-1413**  
**Operator: JR Oil, LTD. Co. (256073)**  
**Central Tank Battery: State CL Central Tank Battery**  
**Central Tank Battery Location: UL C, Section 2, Township 18 South Range 33 East**  
**Gas Title Transfer Meter Location: UL C, Section 2, Township 18 South Range 33 East**

### Pools

Pool Name	Pool Code
CORBIN;ABO	13150
MALJAMAR;GRAYBURG-SAN ANDRES	43329

### Leases as defined in 19.15.12.7(C) NMAC

Lease	UL or Q/Q	S-T-R
SLO Lease E0-2439-0005	NE4, E2NW, W2SE, NESE	01-18S-33E
	ALL Minus B, G	02-18S-33E

### Wells

Well API	Well Name	UL or Q/Q	S-T-R	Pool
30-025-01576	STATE CL #004	NENE	02-18S-33E	13150
30-025-01577	STATE CL #005	SENE	02-18S-33E	43329

Sante Fe Main Office  
Phone: (505) 476-3441

General Information  
Phone: (505) 629-6116

Online Phone Directory  
<https://www.emnrd.nm.gov/ocd/contact-us>

**State of New Mexico**  
**Energy, Minerals and Natural Resources**  
**Oil Conservation Division**  
**1220 S. St Francis Dr.**  
**Santa Fe, NM 87505**

CONDITIONS

Action 554717

**CONDITIONS**

Operator: J R OIL, LTD. CO. P.O. Box 53657 Lubbock, TX 79453	OGRID: 256073
	Action Number: 554717
	Action Type: [C-107] Surface Commingle or Off-Lease (C-107B)

**CONDITIONS**

Created By	Condition	Condition Date
sarah.clelland	Please review the content of the order to ensure you are familiar with the authorities granted and any conditions of approval. If you have any questions regarding this matter, please email us at <a href="mailto:OCD.Engineer@emnrd.nm.gov">OCD.Engineer@emnrd.nm.gov</a> .	2/25/2026