

Case Number.

4/66

---

Application

Transcripts.

Small Exhibits

ETC.

BEFORE THE  
NEW MEXICO OIL CONSERVATION COMMISSION  
Santa Fe, New Mexico  
July 9, 1969

EXAMINER HEARING

IN THE MATTER OF:

Application of Sam Boren for a dual  
completion and salt water disposal,  
Lea County, New Mexico.

Case No. 4166

BEFORE: Daniel S. Nutter, Examiner.

TRANSCRIPT OF HEARING

MR. NUTTER: Call Case 4166.

MR. HATCH: Case 4166, application of Sam Boren for a dual completion and salt water disposal, Lea County, New Mexico.

MR. KELLAHIN: If the Examiner please, may the record show the same appearances and -- as was in Case 4165, and that the witness has been sworn?

MR. NUTTER: The record will so show.

(Whereupon, Applicant's Exhibits "A" and "B" were marked for identification.)

RALPH VINEY

called as a witness, having been first duly sworn, was examined and testified as follows:

DIRECT EXAMINATION

BY MR. KELLAHIN:

Q Mr. Viney, you are the same Mr. Viney who testified in Case 4165?

A Yes, sir.

Q Are you familiar with the application of Sam Boren in Case 4166?

A Yes, sir.

Q What's proposed by the applicant in this case?

A Applicant proposes to dispose of produced salt water through the casing annulus, and in thereby doing, request a dual completion for such permission.

Q Now, referring to what has been marked as Applicant's Exhibit "A," consisting of numbered Exhibits One, Two, Three and Four, would you give us the information that's shown in that exhibit?

A Yes sir, basically, Mr. Boren -- if I may read the first paragraph of Exhibit "A," "Mr. Boren requests permission to dually complete the captioned well to permit oil production from the Bough "B" perforations at 9,972 feet, 9,974 feet and 9,976 feet and to dispose of produced salt water through the intermediate casing-production casing annulus into the San Andres and Glorieta formations in the open hole interval from 4,060 feet to 6,562 feet."

Q Now --

A All right --

Q Pardon me.

A -- Exhibit One is the same lease plat that was shown previously, but outlines Mr. Boren's acreage as held and now under farmout by Mr. Boren.

Exhibit Two is a copy of the application for multiple completion, which sets forth the pool name, or the -- excuse me, the well location, the pool designation, the top and bottom of the Bough "B" section and the perforations and the producing method of the well.

We have also listed and show a list of the offset producers and leases and owners within a two-mile radius of the proposed well or the -- of the well.

Exhibit Three now of Exhibit "A," Case Number 4166 is a diagramatic sketch and is not necessarily to scale, but pictorally shows the casing strings used in this well and the cement tops as either determined visually or calculated.

Q With reference now to the cement top on your eight and five-eighths inch casing, is this calculated or --

A Yes sir, that's a calculated top. Mr. Boren

did not run any surveys on the well.

Q And is the same true with respect to the four and a half inch casing?

A This is right, and the cement top was calculated at 6562.

Q So that would leave open behind the pipe the San Andres and the top of the Glorieta formations, is that correct?

A That is correct, yes sir.

Q Do either one of these formations produce in the vicinity of this well?

A Not that we can find, no sir, they don't.

Q To your knowledge, has it ever produced within a two-mile radius of this well?

A No sir, not that I know of, no sir.

Q And the proposal is to continue production through the casing, the four and a half inch, and inject the water down the annulus, is that correct?

A Yes, sir. Mr. Kellahin, we did not show the tubing string on this --

Q What tubing string?

A There's a tubing string in this well. The packer is set at -- I've got the date, the date of that,

but it's above the perforations. We did not show it because this is not a casing type disposal well, but rather an annulus type --

Q And this would be an open hole --

A Yes sir, this is an open hole disposal.

Q Have you run any tests in the disposal zone?

A Yes sir, we ran the annulus into the zone, and water was pumped into the disposal zone at the rate of six barrels per minute at an injection pressure of eleven hundred pounds.

Q Now, referring to Exhibit Number Four of Exhibit "A," would you identify that?

A Yes sir, Exhibit Number Four is the application by the operator to dispose of water -- of salt water by injection into a porous formation. Basically, this shows all of the casing strings, the setting depths, sacks of cement used and the calculated tops of said cement.

Q What is the source of the water that will be disposed of in this well?

A This will be produced salt water from the Bough "B" zone.

Q And it will be from the Boren leases, is that correct?

A Yes sir, this is correct.

Q Will you make it available to anyone else for disposal?

A Yes sir, if they so request.

Q Now, what volume do you anticipate you would inject into the well?

A Currently, it looks like about fifty barrels a day.

Q In your opinion, will the well take that volume of water?

A The injectivity tests show that that amount of water we need will probably have to be pumped. We do not know, but it will be pumped.

Q Would the use of the well in the manner in which you propose cause any damage, in your opinion, to any fresh water zones or any producing zones in the area?

A No sir, not the way the cement -- the way the strings are cemented, I do not believe so, no sir.

Q Do you have any information on any fresh



water zones?

A No sir, we do not.

Q Do you know whether there are any fresh water zones there or not?

A This we could not find out. We have not found any.

Q You have not found any?

A No, sir.

Q Now, referring to what has been marked as Exhibit "B," is that the log of the subject well?

A Yes sir, this is an electric log, gamma ray log, and it's just filed for the -- for record purposes so that you may see the entire section of the --

Q And have the formation tops been marked on the log?

A No sir, they have not, and the only -- the only top that we could mark would be the top of the Bough "B," which could be read from the Exhibit Three of Exhibit "A" of 4165.

MR. NUTTER: You have calculated the top of the San Andres, or could you give it to us --

A Yes, it's shown on the diagramatic,

9  
it's 4063. If you will see Exhibit Three of Exhibit "A," 4166, the top of the San Andres is marked and the top of the Glorieta is marked.

For the record, we can give you the rest of the tops that are not marked. If you would like them, we can put them in the record and you can place them on the log. The Rustler zone at 1922; Tansell at 2621; Yates, 2745; Seven Rivers, 2952; San Andres, 4063; Glorieta, 5510; Tubb, 6950; Ovue, 7753; Wolf Camp, 9070; Bough "C," 10020; Cisco, 10120; Ranger Lake, 10240; Canyon, 10500; Strawn, 10935.

Q (By Mr. Kellahin) Were Exhibits -- has Exhibit "C," consisting of separate numbered exhibits, prepared by you or under your supervision?

A Yes, they were.

Q And Exhibit "B" is a log of the subject property, is that correct?

A Yes, sir.

I offer in evidence Exhibit "A" and Exhibit "B."

MR. NUTTER: Applicant's Exhibit "A"

and Exhibit "B" will be admitted in evidence.

(Whereupon, Applicant's Exhibits "A" and "B" were offered and admitted in evidence.)

MR. NUTTER: I believe this log has been identified as Exhibit Five. It was probably originally intended to be a portion of Exhibit One, so we'd better have that marked.

MR. KELLAHIN: It's marked on back.

MR. NUTTER: Oh, is it?

MR. KELLAHIN: Yes.

MR. NUTTER: Fine.

MR. KELLAHIN: I had it marked, since it was a separate instrument.

MR. NUTTER: I'll scratch Exhibit Five off the front of it then.

A Right.

MR. KELLAHIN: Yes. That completes the examination of the witness, Mr. Nutter.

CROSS EXAMINATION

BY MR. NUTTER:

Q Mr. Viney, I realize that your discussion on the first page of Exhibit "A" states that this

will be a closed type system. However, inasmuch as you have an area of pipe between the casing shoe on the surface pipe at 365 and the top of the cement on the intermediate string at 1830, you have an interval there that is not cemented. Will it be possible that there might be some corrosion through the annulus here, that water could migrate into some formation that it isn't intended to go into?

A This is always a possibility, yes sir.

Q Can this water be treated to prevent corrosion?

A Yes sir, we can add chemicals.

Q And thereupon, tests could be conducted to determine whether corrosion is taking place?

A Yes sir, we could run this in conjunction with injection.

MR. NUTTER: Thank you. Are there any further questions of the witness.

You may be excused.

(Witness excused.)

MR. NUTTER: Do you have anything further, Mr. Kellahin?

MR. KELLAHIN: No, that's all, Mr. Nutter.

MR. NUTTER: Does anyone have anything further they wish to offer in Case 4166?

MR. HATCH: I might remind you that the telegram and letters referred to both cases.

MR. NUTTER: Thank you.

If there's nothing further, Case 4166, we'll take the case under advisement.

And this next one, this is the one that you wanted -- where LeMay was going to testify on, wasn't it?

MR. KELLAHIN: That's correct.

I N D E XWITNESSPAGE

RALPH VINEY

Direct Examination by Mr. Kellahin  
Cross Examination by Mr. Nutter2  
10EXHIBITMARKEDOFFERED AND  
ADMITTEDApplicant's Exhibit's  
"A" and "B"

2

10

STATE OF NEW MEXICO }  
COUNTY OF BERNALILLO }

I, JERRY MARTINEZ, Notary Public in and for the County of McKinley, State of New Mexico, do hereby certify that the foregoing and attached Transcript of Hearing before the New Mexico Oil Conservation Commission was reported by me and that the same is a true and correct record of the said proceedings, to the best of my knowledge, skill and ability.

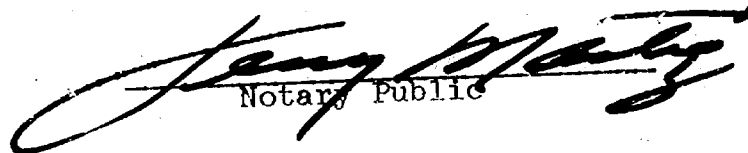
  
Notary Public

My Commission Expires:  
January 24, 1970.

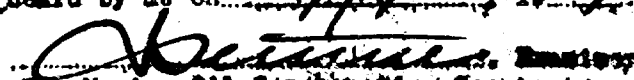
I do hereby certify that the foregoing is  
a complete record of the proceedings in  
the Examiner hearing of Case No. 4762  
heard by me on 7/9, 1969.  
  
New Mexico Oil Conservation Commission



TENNECO OIL COMPANY • P. O. BOX 1031 • 1800 WILCO BUILDING • MIDLAND, TEXAS 79701

July 3, 1969

4166

C  
New Mexico Oil Conservation Commission  
P. O. Box 2088  
Santa Fe, New Mexico 87501

Re: Request for Special Pool Rules  
and Annular Salt Water Disposal  
East Bagley (Penn) Field  
Lea County, New Mexico

Gentlemen:

O  
Tenneco Oil Company, as an operator in the East Bagley (Penn) Field, Lea County, New Mexico is aware of the pending hearing covering the subject wells. We support Mr. Boren's request of 160 acre spacing and proration units and the assignment of 80 acre allowables to wells in this area. We also have no objection to this operator's request for the annular disposal of salt water in his Barbera State "A" Well No. 1.

P  
Yours very truly,

TENNECO OIL COMPANY

ORIGINAL  
SIGNED BY: F. J. McDONALD

F. J. McDonald  
District Production Superintendent

Y JFC:gs

RECEIVED

JUL 8 RECD

RALPH H. VINEY





## OIL CONSERVATION COMMISSION

STATE OF NEW MEXICO  
P. O. BOX 2088 - SANTA FE  
87501

GOVERNOR  
DAVID F. CARGO  
CHAIRMAN

LAND COMMISSIONER  
ALEX J. ARMIJO  
MEMBER

STATE GEOLOGIST  
A. L. PORTER, JR.  
SECRETARY - DIRECTOR

July 16, 1969

Mr. Jason Kellahin  
Kellahin & Fox  
Attorneys at Law  
Post Office Box 1769  
Santa Fe, New Mexico

Re: Case No. 4166  
Order No. R-3796  
Applicant:  
Sam Boren

Dear Sir:

Enclosed herewith are two copies of the above-referenced Commission order recently entered in the subject case.

Very truly yours,

A. L. PORTER, Jr.  
Secretary-Director

ALP/ir

Copy of order also sent to:

Hobbs OCC x

Artesia OCC           

Aztec OCC           

Other            State Engineer Office

BEFORE THE OIL CONSERVATION COMMISSION  
OF THE STATE OF NEW MEXICO

IN THE MATTER OF THE HEARING  
CALLED BY THE OIL CONSERVATION  
COMMISSION OF NEW MEXICO FOR  
THE PURPOSE OF CONSIDERING:

CASE No. 4166  
Order No. R-3796

APPLICATION OF SAM BOREN FOR A  
DUAL COMPLETION AND SALT WATER  
DISPOSAL, LEA COUNTY, NEW MEXICO.

ORDER OF THE COMMISSION

BY THE COMMISSION:

This cause came on for hearing at 9 a.m. on July 9, 1969,  
at Santa Fe, New Mexico, before Examiner Daniel S. Nutter.

NOW, on this 15th day of July, 1969, the Commission, a  
quorum being present, having considered the testimony, the record,  
and the recommendations of the Examiner, and being fully advised  
in the premises,

FINDS:

(1) That due public notice having been given as required by  
law, the Commission has jurisdiction of this cause and the subject  
matter thereof.

(2) That the applicant, Sam Boren, seeks authority to  
complete his Barbera State "A" Well No. 1, located in Unit P  
of Section 6, Township 12 South, Range 34 East, NMPM, East  
Bagley-Pennsylvanian Pool, Lea County, New Mexico, as a dual  
completion to produce oil from the East Bagley-Pennsylvanian  
Pool through 2 3/8-inch tubing and to dispose of produced salt  
water down the annulus between the 4 1/2-inch production casing  
string and the 8 5/8-inch intermediate casing string into the  
San Andres and Glorieta formations in the open-hole interval  
from approximately 4060 feet to 6562 feet.

(3) That the produced salt water should be continuously  
treated prior to injection to prevent casing corrosion and coupon  
corrosion tests should be conducted continuously on said well and

-2-

CASE No. 4166  
Order No. R-3796

the results thereof filed quarterly with the Commission until further notice from the Secretary-Director of the Commission.

(4) That approval of the dual completion and salt water disposal as set out above will prevent the drilling of unnecessary wells, and will otherwise prevent waste and protect correlative rights.

IT IS THEREFORE ORDERED:

(1) That the applicant, Sam Boren, is hereby authorized to complete his Barbera State "A" Well No. 1, located in Unit P of Section 6, Township 12 South, Range 34 East, NMPM, East Bagley-Pennsylvanian Pool, Lea County, New Mexico, as a dual completion to produce oil from the East Bagley-Pennsylvanian Pool through 2 3/8-inch tubing and to dispose of produced salt water down the annulus between the 4 1/2-inch production casing string and the 8 5/8-inch intermediate casing string into the San Andres and Glorieta formations in the open-hole interval from approximately 4060 feet to 6562 feet;

PROVIDED HOWEVER, that the produced salt water shall be continuously treated prior to injection to prevent casing corrosion; that coupon corrosion tests shall be conducted continuously on said well and the results thereof filed quarterly with the Commission until further notice from the Secretary-Director of the Commission;

PROVIDED FURTHER, that the applicant shall submit monthly reports of his disposal operations in accordance with Rules 704 and 1120 of the Commission Rules and Regulations.

(2) That jurisdiction of this cause is retained for the entry of such further orders as the Commission may deem necessary.

DONE at Santa Fe, New Mexico, on the day and year hereinabove designated.

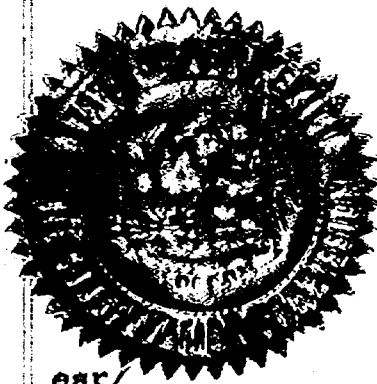

esr/

STATE OF NEW MEXICO  
OIL CONSERVATION COMMISSION

DAVID F. CARGO, Chairman

ALEX J. ARMIJO, Member

A. L. PORTER, Jr., Member & Secretary

DOCKET NO. 19-69

DOCKET: EXAMINER HEARING - WEDNESDAY - JULY 9, 1969

9 A.M. - OIL CONSERVATION COMMISSION CONFERENCE ROOM,  
STATE LAND OFFICE BUILDING - SANTA FE, NEW MEXICO

The following cases will be heard before Daniel S. Nutter, Examiner, or  
Elvis A. Utz, Alternate Examiner:

CASE 4160: Application of Roger C. Hanks for pool redelineation, Roosevelt County, New Mexico. Applicant, in the above-styled cause, seeks the redelineation of certain pool boundaries to include the deletion of the NE/4 of Section 29 from the South Prairie-Cisco Pool and the extension of the Middle Allison-Pennsylvanian Pool to include all of Section 29, the SE/4 of Section 30, and the N/2 of Section 32, all in Township 8 South, Range 36 East, Roosevelt County, New Mexico.

CASE 4161: Application of Roger C. Hanks for special pool rules, Lea County, New Mexico. Applicant, in the above-styled cause, seeks the promulgation of special pool rules for the North Mescalero-Cisco Pool, Lea County, New Mexico, including a provision for 160-acre spacing and proration units and the assignment of 80-acre allowables.

CASE 3786: (Reopened)

In the matter of Case No. 3786 being reopened pursuant to the provisions of Order No. R-3437, which order established special rules and regulations for the North Paduca-Delaware Pool, Lea County, New Mexico, including provisions for the classification of and spacing for oil and gas wells and a special gas-liquid ratio limitation. All interested parties may appear and show cause why the special rules and regulations should not be discontinued.

CASE 4162: Application of Western States Producing Company for a dual completion and salt water disposal, Roosevelt County, New Mexico. Applicant, in the above-styled cause, seeks authority to dually complete its State 30 Well No. 2 located in Unit M of Section 30, Township 7 South, Range 33 East, Roosevelt County, New Mexico, in such a manner as to permit the production of oil from the Chaveroo-San Andres Pool and the disposal of produced salt water through 8 5/8 X 4 1/2 inch casing-casing annulus into the Yates, Seven Rivers, and Queen formations in the open-hole interval from approximately 1825 feet to 3785 feet.

- CASE 4163: Application of Pan American Petroleum Corporation for a non-standard gas proration unit, Lea County, New Mexico. Applicant, in the above-styled cause, seeks approval of a 181-acre non-standard gas proration unit for its Pike Federal Well No. 1 located in Unit A of Section 6, Township 23 South, Range 38 East, Tubb Gas Pool, Lea County, New Mexico, said unit to comprise the N/2 N/2 of said Section 6.
- CASE 4164: Application of Mobil Oil Corporation for an unorthodox location, Lea County, New Mexico. Applicant, in the above-styled cause, seeks authority to drill its Fristoe Well No. 8 at an unorthodox location 2470 feet from the North line and 430 feet from the East line of Section 3, Township 25 South, Range 37 East, Langlie Mattix Pool, Lea County, New Mexico.
- CASE 4165: Application of Sam Boren for special pool rules, Lea County, New Mexico. Applicant, in the above-styled cause, seeks the promulgation of special pool rules for the East Bagley-Pennsylvanian Pool, Lea County, New Mexico, including a provision for 160-acre spacing and proration units and the assignment of 80-acre allowables.
- CASE 4166: Application of Sam Boren for a dual completion and salt water disposal, Lea County, New Mexico. Applicant, in the above-styled cause, seeks authority to dually complete his Barbera State "A" Well No. 1 located in Unit P of Section 6, Township 12 South, Range 34 East, Lea County, New Mexico, in such a manner as to permit the production of oil from the East Bagley-Pennsylvanian Pool and the disposal of produced salt water through the intermediate casing-production casing annulus into the San Andres and Glorieta formations in the open-hole interval from approximately 4060 feet to 6562 feet.
- CASE 4167: Application of Charles B. Read for a dual completion and salt water disposal, Lea County, New Mexico. Applicant, in the above-styled cause, seeks authority to dually complete his Hobbs "Y" Well No. 1 located in Unit J of Section 29, Township 12 South, Range 34 East, Lea County, New Mexico, in such a manner as to permit the production of oil from the East Hightower-Pennsylvanian Pool and the disposal of produced salt water through the intermediate casing-production casing annulus into the San Andres, Glorieta, Yeso, and Abo formations in the open-hole interval from approximately 4195 feet to 7720 feet.

- CASE 4168: Application of Charles B. Read for salt water disposal, Lea County, New Mexico. Applicant, in the above-styled cause, seeks authority to dispose of produced salt water into the Seven Rivers Reef formation in the open-hole interval between 3783 feet and 3797 feet in his Sinclair State Well No. 1 located 2310 feet from the South and West lines of Section 2, Township 21 South, Range 33 East, Lynch Pool, Lea County, New Mexico.
- CASE 4169: Application of Mask, Jennings, Keohane and Westall for an exception to Order No. R-3221, as amended, Eddy County, New Mexico. Applicants, in the above-styled cause, seek an exception to Order No. R-3221, as amended, which order prohibits the disposal of water produced in conjunction with the production of oil on the surface of the ground in Lea, Eddy, Chaves and Roosevelt Counties, New Mexico, after January 1, 1969. Said exception would be for applicants' wells in the E/2 NW/4 and the NE/4 of Section 2, Township 19 South, Range 31 East, Shugart Pool, Eddy County, New Mexico. Applicants seek authority to dispose of salt water produced by said wells in an unlined surface pit located in Unit C of said Section 2.
- CASE 4170: Application of H. C. Hood for pool redelineation, Lea County, New Mexico. Applicant, in the above-styled cause, seeks the redelineation of the High Plains-Pennsylvanian Pool by the deletion of the SW/4 of Section 14 and the SE/4 of Section 15, Township 14 South, Range 34 East, Lea County, New Mexico.

BEFORE EXAMINER NUTTER  
OIL CONSERVATION COMMISSION  
EXHIBIT NO. 17  
CASE NO. 4166

CASE NO. 4166

NEW MEXICO OIL CONSERVATION COMMISSION

EXAMINER HEARING

WEDNESDAY, JULY 9, 1969

NEW MEXICO OIL CONSERVATION COMMISSION  
EXAMINER HEARING

Wednesday, July 9, 1969

CASE 4166

Application of Sam Boren Oil Company for a Dual Completion and Salt Water Disposal

Barbera State "A" Well No. 1

Location being designated as Unit P, 660 feet from the south line and 660 feet from the east line, Section 6, Township 12 South, Range 34 East, N.M.P.M.

DUAL COMPLETION AND SALT WATER DISPOSAL REQUEST

Mr. Boren requests permission to dually complete the captioned well to permit oil production from the Bough "B" perforations at 9,972', 9,974' and 9,976' and to dispose of produced salt water through the intermediate casing-production casing annulus into the San Andres and Glorieta formations in the open hole interval from 4,060' to 6,562'.

A Land Lease Map of the East Bagley Field is included as Exhibit 1.

Exhibit 2 is New Mexico Oil Conservation Commission Form C-107 (Application for Multiple Completion).

Exhibit 3 is a diagrammatic sketch of the well bore and casing strings.

New Mexico Oil Conservation Commission Form C-108 (Application to Dispose of Salt Water by Injection into a Porous Formation) is included as Exhibit 4. The casing size, setting depths, amount of cement used, and the method used to determine the top of the cement are set forth on this exhibit. These are also pictorially shown on the above Exhibit 3.

Exhibit 5 is an electrical log of the well in question.

It is proposed to dispose of the produced salt water down the annular space between the intermediate 8-5/8" casing string and the 4-1/2" production string into the San Andres and Glorieta formations between the base of the 8-5/8" casing at 4,060' and the top of the cement in the 7-7/8" hole at 6,562'. On an annular disposal capacity test, water was pumped into the proposed disposal zones at a rate of 6 barrels per minute with an injection pressure of 1,100 psig.

The well was potentialized June 1, 1969 and on a pump test produced 212 barrels of oil, 75 barrels of water and 254 MCF of gas. Currently the well is producing approximately 75 barrels of oil and 50 barrels of water per day. The produced water will be handled in a close-type system.

Mr. Boren requests that permission be granted for the multiple completion and the annular salt water disposal into the San Andres and Glorieta formations.



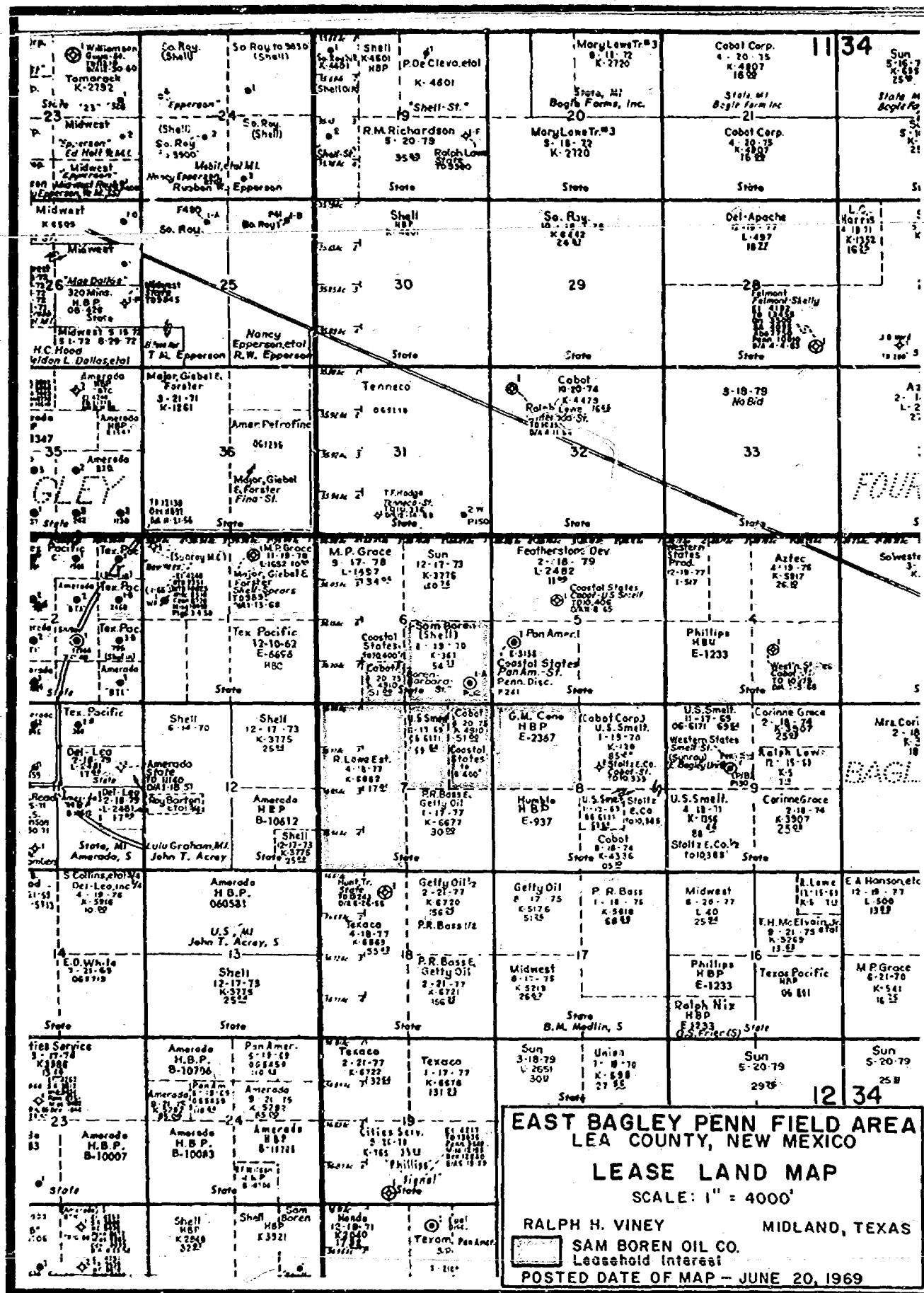

NEW MEXICO OIL CONSERVATION COMMISSION  
SANTA FE, NEW MEXICO  
APPLICATION FOR MULTIPLE COMPLETION

Form C-107  
5-1-61  
EXHIBIT 2  
July 9, 1969  
CASE 4166

Operator <b>SAM BOREN OIL COMPANY</b>		County <b>Lea</b>	Date <b>July 3, 1969</b>
Address <b>4520 West Highway 80, Midland, Texas 79701</b>		Lease <b>Barbera State "A"</b>	Well No. <b>1</b>
Location of Well <b>P</b>	Unit <b>6</b>	Township <b>12 South</b>	Range <b>34 East</b>

1. Has the New Mexico Oil Conservation Commission heretofore authorized the multiple completion of a well in these same pools or in the same zones within one mile of the subject well? YES \_\_\_\_\_ NO X
2. If answer is yes, identify one such instance: Order No. \_\_\_\_\_ : Operator Lease, and Well No.: \_\_\_\_\_

3. The following facts are submitted:	Upper Zone	Intermediate Zone	Lower Zone
a. Name of Pool and Formation	<b>East Bagley Pennsylvanian</b>		
b. Top and Bottom of Pay Section (Perforations)	<b>9,969 - 9,981' — Baugh "B"</b> <b>9,972, 9,974 &amp; 9,976'</b>		
c. Type of production (Oil or Gas)	<b>Oil</b>		
d. Method of Production (Flowing or Artificial Lift)	<b>Artificial Lift</b>		

4. The following are attached. (Please check YES or NO)

- |                                     |                                     |                                                                                                                                                                                                                                                                                                                                                                                                 |
|-------------------------------------|-------------------------------------|-------------------------------------------------------------------------------------------------------------------------------------------------------------------------------------------------------------------------------------------------------------------------------------------------------------------------------------------------------------------------------------------------|
| Yes                                 | No                                  |                                                                                                                                                                                                                                                                                                                                                                                                 |
| <input checked="" type="checkbox"/> | <input type="checkbox"/>            | a. Diagrammatic Sketch of the Multiple Completion, showing all casing strings, including diameters and setting depths, centralizers and/or turbolizers and location thereof, quantities used and top of cement, perforated intervals, tubing strings, including diameters and setting depth, location and type of packers and side door chokes, and such other information as may be pertinent. |
| <input checked="" type="checkbox"/> | <input type="checkbox"/>            | b. Plat showing the location of all wells on applicant's lease, all offset wells on offset leases, and the names and addresses of operators of all leases offsetting applicant's lease.                                                                                                                                                                                                         |
| <input type="checkbox"/>            | <input checked="" type="checkbox"/> | c. Waivers consenting to such multiple completion from each offset operator, or in lieu thereof, evidence that said offset operators have been furnished copies of the application.*                                                                                                                                                                                                            |
| <input checked="" type="checkbox"/> | <input type="checkbox"/>            | d. Electrical log of the well or other acceptable log with tops and bottoms of producing zones and intervals of perforation indicated thereon. (If such log is not available at the time application is filed it shall be submitted as provided by Rule 112-A.)                                                                                                                                 |

5. List all offset operators to the lease on which this well is located together with their correct mailing address.

**Coastal States Gas Producing Company, Wilco Bldg., Midland, Texas**

**U. S. Smelting & Refining Company, Salt Lake City, Utah**

**Cabot Corporation, Wilco Bldg., Midland, Texas**

**Sun Oil Company, Vaughn Bldg., Midland, Texas**

**Ralph Lowe Estate, Midland Towers, Midland, Texas**

**Featherstone Development Company - Address unknown**

**M. P. Grace - Address unknown**

6. Were all operators listed in Item 5 above notified and furnished a copy of this application? YES \_\_\_\_\_ NO X. If answer is yes, give date of such notification \_\_\_\_\_.

CERTIFICATE: I, the undersigned, state that I am the Agent of the Sam Boren Oil Company (company), and that I am authorized by said company to make this report; and that this report was prepared under my supervision and direction and that the facts stated therein are true, correct and complete to the best of my knowledge.

Signature

\*Should waivers from all offset operators not accompany an application for administrative approval, the New Mexico Oil Conservation Commission will hold the application for a period of twenty (20) days from date of receipt by the Commission's Santa Fe office. If, after said twenty-day period, no protest nor request for hearing is received by the Santa Fe office, the application will then be processed.

NOTE: If the proposed multiple completion will result in an unorthodox well location and/or a non-standard proration unit in one or more of the producing zones, then separate application for approval of the same should be filed simultaneously with this application.

EXHIBIT 3  
July 9, 1969  
CASE 4166

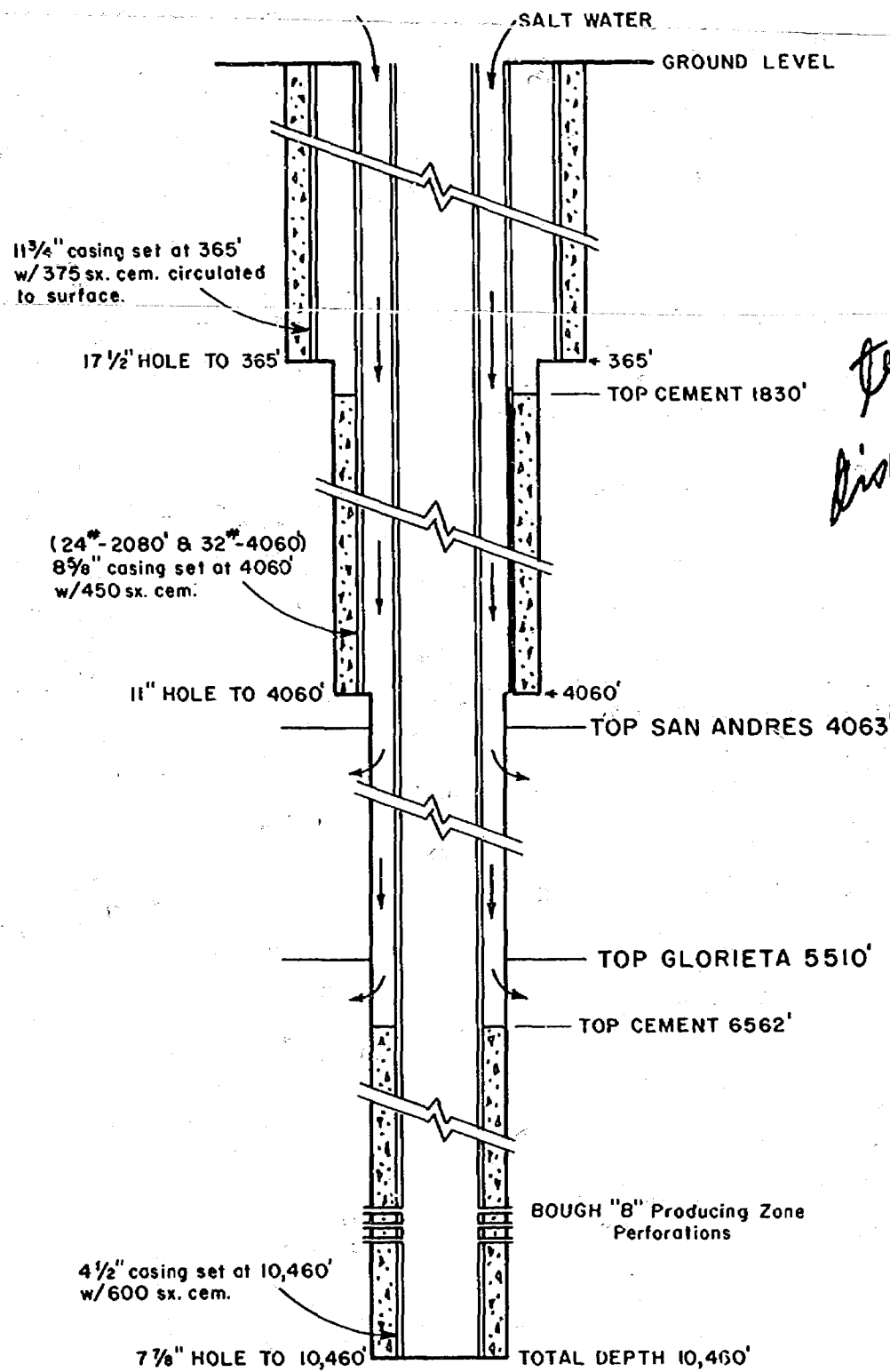

EXAMINER HEARING  
JULY 9, 1969  
CASE 4166

SAM BOREN OIL COMPANY  
NO. 1 BARBERA STATE "A"

NEW MEXICO OIL CONSERVATION COMMISSION  
APPLICATION TO DISPOSE OF SALT WATER BY INJECTION INTO A POROUS FORMATION

OPERATOR <b>SAM BOREN OIL COMPANY</b>		ADDRESS <b>4520 West Highway 80, Midland, Texas 79701</b>	
LEASE NAME <b>Barbera State "A"</b>	WELL NO. <b>1</b>	FIELD <b>East Bagley Pennsylvanian</b>	COUNTY <b>Lea</b>
LOCATION UNIT LETTER <b>P</b> : WELL IS LOCATED <b>660</b> FEET FROM THE <b>South</b> LINE AND <b>660</b> FEET FROM THE			
East LINE, SECTION <b>6</b> TOWNSHIP <b>12 South</b> RANGE <b>34 East</b> NMPM.			

NAME OF STRING	SIZE	SETTING DEPTH	SACKS CEMENT	TOP OF CEMENT	TOP DETERMINED BY
SURFACE CASING	11-3/4"	365'	375	Circulated to Surface	
INTERMEDIATE 0-2,080 24# 2,080-4,060 32#	8-5/8"	4,060'	450	1,830'	Calculation
LONG STRING	4-1/2"	10,460'	600	6,562'	Calculation

TUBING	2-3/8"	9,942	NAME, MODEL AND DEPTH OF TUBING PACKER		
NAME OF PROPOSED INJECTION FORMATION <b>San Andres and Glorieta</b>			TOP OF FORMATION <b>San Andres 4,063'</b> <b>Glorieta 5,510'</b>	BOTTOM OF FORMATION <b>San Andres 5,500'</b> <b>Glorieta 6,950'</b>	
IS INJECTION THROUGH TUBING, CASING, OR ANNULUS? <b>Annulus</b>			PERFORATIONS OR OPEN HOLE <b>Open Hole</b>	PROPOSED INTERVAL(S) OF INJECTION <b>4,060 to 6,562'</b>	
IS THIS A NEW WELL DRILLED FOR DISPOSAL? <b>No</b>			IF ANSWER IS NO, FOR WHAT PURPOSE WAS WELL ORIGINALLY DRILLED? <b>Oil Producer. Well also to be used for Salt Water disposal.</b>		
HAS WELL EVER BEEN PERFORATED IN ANY ZONE OTHER THAN THE PROPOSED INJECTION ZONE? <b>Yes</b>					
LIST ALL SUCH PERFORATED INTERVALS AND SACKS OF CEMENT USED TO SEAL OFF OR SQUEEZE EACH <b>9,972, 9,974 and 9,976'</b>					
DEPTH OF BOTTOM OF DEEPEST FRESH WATER ZONE IN THIS AREA <b>Unknown</b>		DEPTH OF BOTTOM OF NEXT HIGHER OIL OR GAS ZONE IN THIS AREA <b>9,970'</b>		DEPTH OF TOP OF NEXT LOWER OIL OR GAS ZONE IN THIS AREA <b>9,970'</b>	
ANTICIPATED DAILY INJECTION VOLUME (BBLS.) <b>50</b>	MINIMUM <b>30</b>	MAXIMUM <b>100</b>	OPEN OR CLOSED TYPE SYSTEM <b>Closed</b>	IS INJECTION TO BE BY GRAVITY OR PRESSURE? <b>Pressure</b>	APPROX. PRESSURE (PSI) <b>Unknown</b>
ANSWER YES OR NO WHETHER THE FOLLOWING WATERS ARE MINERALIZED TO SUCH A DEGREE AS TO BE UNFIT FOR DOMESTIC, STOCK, IRRIGATION, OR OTHER GENERAL USE - <b>Yes</b>			WATER TO BE DISPOSED OF <b>Produced Salt Water</b>		
NAME AND ADDRESS OF SURFACE OWNER (OR LESSEE, IF STATE OR FEDERAL LAND) <b>Gordon M. Cone, P. O. Box 1148, Lovington, New Mexico</b>			LIST NAMES AND ADDRESSES OF ALL OPERATORS WITHIN ONE-HALF (1/2) MILE OF THIS INJECTION WELL		
			<b>Coastal States Gas Producing Company, Wilco Bldg., Midland, Texas</b>		
			<b>U. S. Smelting &amp; Refining Company, Salt Lake City, Utah</b>		
			<b>Sun Oil Company, Vaughn Bldg., Midland, Texas</b>		
			<b>Featherstong Development Corp., Address unknown</b>		
			<b>Ralph Lowe Estate, Midland Towers, Midland, Texas</b>		
			<b>M. P. Grace, Address unknown</b>		
HAVE COPIES OF THIS APPLICATION BEEN SENT TO EACH OF THE FOLLOWING? <b>No</b>		SURFACE OWNER <b>No</b>		EACH OPERATOR WITHIN ONE-HALF MILE OF THIS WELL <b>No</b>	
ARE THE FOLLOWING ITEMS ATTACHED TO THIS APPLICATION (SEE RULE 701-B) <b>Yes</b>		PLAT OF AREA <b>Yes</b>		ELECTRICAL LOG <b>Yes</b>	
				DIAGRAMMATIC SKETCH OF WELL <b>Yes</b>	

I hereby certify that the information above is true and complete to the best of my knowledge and belief.

Agent for Sam Boren Oil Company

July 7, 1969  
(Date)

(Signature)

(Title)

NOTE: Should waivers from the surface owner and all operators within one-half mile of the proposed injection well not accompany this application, the New Mexico Oil Conservation Commission will hold the application for a period of 15 days from the date of receipt by the Commission's Santa Fe office. If at the end of the 15-day waiting period no protest has been received by the Santa Fe office, the application will be processed. If a protest is received, the application will be set for hearing, if the applicant so requests. SEE RULE 701.

NEW MEXICO OIL CONSERVATION COMMISSION  
APPLICATION TO DISPOSE OF SALT WATER BY INJECTION INTO A POROUS FORMATION

OPERATOR <b>SAM BOREN OIL COMPANY</b>		ADDRESS <b>4520 West Highway 80, Midland, Texas 79701</b>	
LEASE NAME <b>Barbera State "A"</b>	WELL NO. <b>1</b>	FIELD <b>East Bagley Pennsylvanian</b>	COUNTY <b>Lea</b>
LOCATION UNIT LETTER <b>P</b> ; WELL IS LOCATED <b>660</b> FEET FROM THE <b>South</b> LINE AND <b>660</b> FEET FROM THE <b>East</b> LINE, SECTION <b>6</b> TOWNSHIP <b>12 South</b> RANGE <b>34 East</b> HMPM.			
CASING AND TUBING DATA			
NAME OF STRING	SIZE	SETTING DEPTH	SACKS CEMENT
SURFACE CASING	<b>11-3/4"</b>	<b>365'</b>	<b>375</b>
INTERMEDIATE <b>0-2,080 24#</b> <b>2,080-4,060 32#</b>	<b>8-5/8"</b>	<b>4,060'</b>	<b>450</b>
LONG STRING	<b>4-1/2"</b>	<b>10,460'</b>	<b>600</b>
TUBING	<b>2-3/8"</b>	<b>9,942</b>	NAME, MODEL AND DEPTH OF TUBING PACKER
NAME OF PROPOSED INJECTION FORMATION <b>San Andres and Glorieta</b>		TOP OF FORMATION <b>San Andres 4,063'</b> <b>Glorieta 5,510'</b>	BOTTOM OF FORMATION <b>San Andres 5,500'</b> <b>Glorieta 6,950'</b>
IS INJECTION THROUGH TUBING, CASING, OR ANNULUS? <b>Annulus</b>		PERFORATIONS OR OPEN HOLE <b>Open Hole</b>	PROPOSED INTERVAL(S) OF INJECTION <b>4,060 to 6,562'</b>
IS THIS A NEW WELL DRILLED FOR DISPOSAL? <b>No</b>	IF ANSWER IS NO, FOR WHAT PURPOSE WAS WELL ORIGINALLY DRILLED? <b>Oil Producer. Well also to be used for Salt Water disposal.</b>		HAS WELL EVER BEEN PERFORATED IN ANY ZONE OTHER THAN THE PROPOSED INJECTION ZONE? <b>Yes</b>
LIST ALL SUCH PERFORATED INTERVALS AND SACKS OF CEMENT USED TO SEAL OFF OR SQUEEZE EACH <b>9,972, 9,974 and 9,976'</b>			
DEPTH OF BOTTOM OF DEEPEST FRESH WATER ZONE IN THIS AREA <b>Unknown</b>		DEPTH OF TOP OF NEXT LOWER OIL OR GAS ZONE IN THIS AREA <b>9,970'</b>	
ANTICIPATED DAILY INJECTION VOLUME (BBL'S.) <b>50</b>	MINIMUM <b>30</b>	MAXIMUM <b>100</b>	OPEN OR CLOSED TYPE SYSTEM <b>Closed</b>
ANSWER YES OR NO WHETHER THE FOLLOWING WATERS ARE MINERALIZED TO SUCH A DEGREE AS TO BE UNFIT FOR DOMESTIC, STOCK, IRRIGATION, OR OTHER GENERAL USE <b>Yes</b>		WATER TO BE DISPOSED OF <b>Produced Salt Water</b>	IS INJECTION TO BE BY GRAVITY OR PRESSURE? <b>Pressure</b>
NAME AND ADDRESS OF SURFACE OWNER (OR LESSEE, IF STATE OR FEDERAL LAND) <b>Gordon M. Cone, P. O. Box 1148, Lovington, New Mexico</b>		APPROX. PRESSURE (PSI) <b>Unknown</b>	
LIST NAMES AND ADDRESSES OF ALL OPERATORS WITHIN ONE-HALF (1/2) MILE OF THIS INJECTION WELL			
<b>Coastal States Gas Producing Company, Wilco Bldg., Midland, Texas</b>			
<b>U. S. Smelting &amp; Refining Company, Salt Lake City, Utah</b>			
<b>Sun Oil Company, Vaughn Bldg., Midland, Texas</b>			
<b>Featherstong Development Corp., Address unknown</b>			
<b>Ralph Lowe Estate, Midland Towers, Midland, Texas</b>			
<b>M. P. Grace, Address unknown</b>			
HAVE COPIES OF THIS APPLICATION BEEN SENT TO EACH OF THE FOLLOWING?	SURFACE OWNER <b>No</b>		
	EACH OPERATOR WITHIN ONE-HALF MILE OF THIS WELL <b>No</b>		
ARE THE FOLLOWING ITEMS ATTACHED TO THIS APPLICATION (SEE RULE 701-B)	PLAN OF AREA <b>Yes</b>	ELECTRICAL LOG <b>Yes</b>	DIAGRAMMATIC SKETCH OF WELL <b>Yes</b>

I hereby certify that the information above is true and complete to the best of my knowledge and belief.

*Ralph Lowe*  
(Signature)

**Agent for Sam Boren Oil Company**  
(Title)

**July 7, 1969**  
(Date)

NOTE: Should waivers from the surface owner and all operators within one-half mile of the proposed injection well not accompany this application, the New Mexico Oil Conservation Commission will hold the application for a period of 15 days from the date of receipt by the Commission's Santa Fe office. If at the end of the 15-day waiting period no protest has been received by the Santa Fe office, the application will be processed. If a protest is received, the application will be set for hearing, if the applicant so requests. SEE RULE 701.

NEW MEXICO OIL CONSERVATION COMMISSION  
SANTA FE, NEW MEXICO  
APPLICATION FOR MULTIPLE COMPLETION

Form C-107  
5-1-61

Operator <b>SAM BOREN OIL COMPANY</b>		County <b>Lea</b>	Date <b>July 3, 1969</b>
Address <b>4520 West Highway 80, Midland, Texas 79701</b>		Lease <b>Barbera State "A"</b>	Well No. <b>1</b>
Location of Well <b>P</b>	Unit <b>6</b>	Township <b>12 South</b>	Range <b>34 East</b>

1. Has the New Mexico Oil Conservation Commission heretofore authorized the multiple completion of a well in these same pools or in the same zones within one mile of the subject well? YES \_\_\_\_\_ NO X
2. If answer is yes, identify one such instance: Order No. \_\_\_\_\_; Operator Lease, and Well No.: \_\_\_\_\_

3. The following facts are submitted:	Upper Zone	Intermediate Zone	Lower Zone
a. Name of Pool and Formation	<b>East Bagley Pennsylvanian</b>		
b. Top and Bottom of Pay Section (Perforations)	<b>9,969 - 9,981' 9,972, 9,974 &amp; 9,976'</b>		
c. Type of production (Oil or Gas)	<b>Oil</b>		
d. Method of Production (Flowing or Artificial Lift)	<b>Artificial Lift</b>		

4. The following are attached. (Please check YES or NO)

- |                                     |                                     |                                                                                                                                                                                                                                                                                                                                                                                                 |
|-------------------------------------|-------------------------------------|-------------------------------------------------------------------------------------------------------------------------------------------------------------------------------------------------------------------------------------------------------------------------------------------------------------------------------------------------------------------------------------------------|
| Yes                                 | No                                  |                                                                                                                                                                                                                                                                                                                                                                                                 |
| <input checked="" type="checkbox"/> | <input type="checkbox"/>            | a. Diagrammatic Sketch of the Multiple Completion, showing all casing strings, including diameters and setting depths, centralizers and/or turbolizers and location thereof, quantities used and top of cement, perforated intervals, tubing strings, including diameters and setting depth, location and type of packers and side door chokes, and such other information as may be pertinent. |
| <input checked="" type="checkbox"/> | <input type="checkbox"/>            | b. Plat showing the location of all wells on applicant's lease, all offset wells on offset leases, and the names and addresses of operators of all leases offsetting applicant's lease.                                                                                                                                                                                                         |
| <input type="checkbox"/>            | <input checked="" type="checkbox"/> | c. Waivers consenting to such multiple completion from each offset operator, or in lieu thereof, evidence that said offset operators have been furnished copies of the application.*                                                                                                                                                                                                            |
| <input checked="" type="checkbox"/> | <input type="checkbox"/>            | d. Electrical log of the well or other acceptable log with tops and bottoms of producing zones and intervals of perforation indicated thereon. (If such log is not available at the time application is filed it shall be submitted as provided by Rule 112-A.)                                                                                                                                 |

5. List all offset operators to the lease on which this well is located together with their correct mailing address.

**Coastal States Gas Producing Company, Wilco Bldg., Midland, Texas**

**U. S. Smelting & Refining Company, Salt Lake City, Utah**

**Cabot Corporation, Wilco Bldg., Midland, Texas**

**Sun Oil Company, Vaughn Bldg., Midland, Texas**

**Ralph Lowe Estate, Midland Towers, Midland, Texas**

**Featherstone Development Company - Address unknown**

**M. P. Grace - Address unknown**

6. Were all operators listed in Item 5 above notified and furnished a copy of this application? YES \_\_\_\_\_ NO X. If answer is yes, give date of such notification \_\_\_\_\_.

CERTIFICATE: I, the undersigned, state that I am the Agent of the Sam Boren Oil Company (company), and that I am authorized by said company to make this report; and that this report was prepared under my supervision and direction and that the facts stated therein are true, correct and complete to the best of my knowledge.

*Ralph H. V. Mag*  
Signature

\*Should waivers from all offset operators not accompany an application for administrative approval, the New Mexico Oil Conservation Commission will hold the application for a period of twenty (20) days from date of receipt by the Commission's Santa Fe office. If, after said twenty-day period, no protest nor request for hearing is received by the Santa Fe office, the application will then be processed.

NOTE: If the proposed multiple completion will result in an unorthodox well location and/or a non-standard proration unit in one or more of the producing zones, then separate application for approval of the same should be filed simultaneously with this application.

July 9, 1969

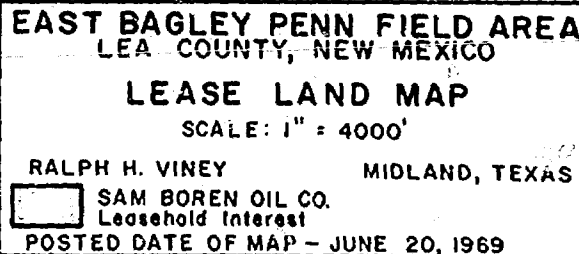

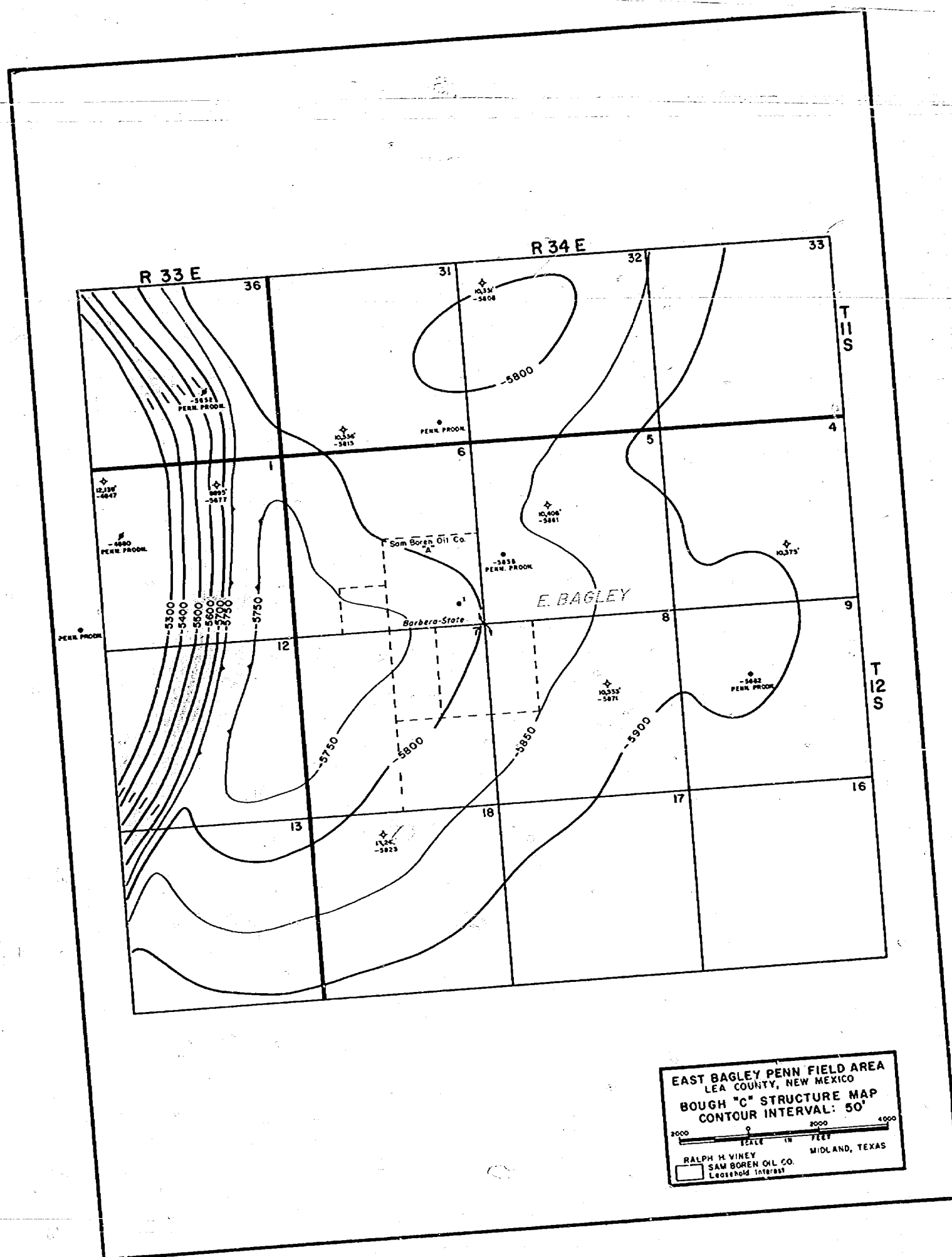



RALPH H. VINEY

H

Consultant to the Oil and Gas Industry

Central Building  
MIDLAND, TEXAS 79701  
915 682-5346  
June 16, 1969  
JUN 16 1969  
MAIN OFFICE

Case 4166

New Mexico Oil Conservation Commission  
Post Office Box 2088  
Santa Fe, New Mexico 87501

Gentlemen:

Request for ~~Special Pool Rules for the East Bagley (Penn) Field,~~  
~~Lea County, New Mexico, and Annular Salt Water Disposal for~~  
Barbera State "A" Well No. 1

Sam Boren respectfully requests a hearing before the Commission to consider ~~the promulgation of special rules for the captioned field and~~ permission to dispose of salt water in the San Andres zone through the annular casing space in the captioned well.

In the request for special pool rules, Mr. Boren is asking for the provision of 160-acre spacing and proration units together with the assignment of 80-acre allowables to the proposed units.

✓ Mr. Boren intends to inject water down the annular space between the 4½" and 8-5/8" casing and dispose of such water between the base of the 8-5/8" casing in the annular space between the 7-7/8" hole and the 4½" casing in the San Andres zone between the base of the 8-5/8" casing at 4,060' and the top of the cement at 6,562'.

✓ The lease and well in question is the Sam Boren Oil Company Barbera State "A" Lease Well No. 1, State Lease No. K 367, Bagley (Penn) Field, Lea County, New Mexico. The well is located 660' FSL and 660' FEL of Section 6, Township 12 South, Range 34 East, N.M.P.M.

Mr. Boren respectfully requests of the Oil Conservation Commission, a hearing of this application at the first open available date.

Very truly yours,

Ralph H. Viney

Agent

RHV:mm

cc: Mr. J. D. Ramey  
Box 1980  
Hobbs, New Mexico 88240

Mr. F. J. McDonald  
Tenneco Oil Company  
Wilco Building  
Midland, Texas 79701

Mr. J. D. Rankin  
Sam Boren Oil Company  
4520 West Highway 80  
Midland, Texas 79701

Mr. Sam Boren  
225 Park Cities Bank Building  
Dallas, Texas 75205

DOCKET MAILED

Date 6-25-69

Case 4166

Form C-105  
Revised 1-1-65

AM 8 34

NO. OF COPIES RECEIVED	
DISTRIBUTION	
SANTA FE	
FILE	
U.S.G.S.	
LAND OFFICE	
OPERATOR	

NEW MEXICO OIL CONSERVATION COMMISSION  
WELL COMPLETION OR RECOMPLETION REPORT AND LOG

5a. Indicate Type of Lease	State <input checked="" type="checkbox"/> Fee <input type="checkbox"/>
5. State Oil & Gas Lease No.	2307

10. TYPE OF WELL	OIL <input checked="" type="checkbox"/> GAS <input type="checkbox"/> DRY <input type="checkbox"/> OTHER <input type="checkbox"/>	7. Unit Agreement Name
11. TYPE OF COMPLETION	NEW <input checked="" type="checkbox"/> WORK OVER <input type="checkbox"/> DEEPEN <input type="checkbox"/> PLUG BACK <input type="checkbox"/> DIFF. RESVR. <input type="checkbox"/> OTHER <input type="checkbox"/>	8. Farm or Lease Name
2. Name of Operator	Sam Boren	9. Well No.
3. Address of Operator	Box 953 Midland Texas 79701	10. Field and Pool, or Wildcat
4. Location of Well		11. Bagley (Penn)
UNIT LETTER: P	LOCATED 560 FEET FROM THE South LINE AND 560 FEET FROM East	12. County
THE East	LINE OF SEC. 8 TWP. 12S RGE. 34E NMPM	13. State

15. Date Spudded	16. Date T.D. Reached	17. Date Compl. (Ready to Prod.)	18. Elevations (DF, RKB, RT, GR, etc.)	19. Elev. Casinghead
5-16-69	5-25-69	6-1-69	4186 GL	
20. Total Depth	21. Plug Back T.D.	22. If Multiple Compl., How Many	23. Intervals Drilled By	24. Cable Tools
11,180	10,460		6-11180	
24. Producing Interval(s), of this completion - Top, Bottom, Name				25. Was Directional Survey Made
9972-74-76 (Penn)				Yes
26. Type Electric and Other Logs Run				27. Was Well Cored
Gamma Ray Neutron				No

28. CASING RECORD (Report all strings set in well)					
CASING SIZE	WEIGHT LB./FT.	DEPTH SET	HOLE SIZE	CEMENTING RECORD	AMOUNT PULLED
11-3/4	42	365	17-1/2	375	0
8-5/8	28	2060	9-7/8		0
8-5/8	32	4030	9-7/8	450	0
4-1/2	11.6	10460	7-7/8	590	0

29. LINER RECORD					30. TUBING RECORD		
SIZE	TOP	BOTTOM	SACKS CEMENT	SCREEN	SIZE	DEPTH SET	PACKER SET
					2	9942	9942

31. Perforation Record (Interval, size and number)		32. ACID, SHOT, FRACTURE, CEMENT SQUEEZE, ETC.	
DEPTH INTERVAL	AMOUNT AND KIND MATERIAL USED	DEPTH INTERVAL	AMOUNT AND KIND MATERIAL USED
9972-74-76	1000 gal. acid		

33. PRODUCTION		Well Status (Prod. or Shut-in)	
Date First Production	Production Method (Flowing, gas lift, pumping - Size and type pump)	Producing	
6-1-69	Flowing		
Date of Test	Hours Tested	Choke Size	Prod'n. For Test Period
6-1-69	24		
Flow Tubing Press.	Casing Pressure	Calculated 24-Hour Rate	Oil - Bbl.
0	Backlog		212
		Gas - MCF	250
		Water - Bbl.	75
		Oil Gravity - API (Corr.)	42.0

34. Disposition of Gas (Sold, used for fuel, vented, etc.)	Test Witnessed By
Sold	Wynen Beck

35. List of Attachments
Inclination survey and log

36. I hereby certify that the information shown on both sides of this form is true and complete to the best of my knowledge and belief.

SIGNED	TITLE	Agent	DATE	6-2-69
--------	-------	-------	------	--------



DRAFT

GMH/esr

BEFORE THE OIL CONSERVATION COMMISSION  
OF THE STATE OF NEW MEXICO

IN THE MATTER OF THE HEARING  
CALLED BY THE OIL CONSERVATION  
COMMISSION OF NEW MEXICO FOR  
THE PURPOSE OF CONSIDERING:

CASE No. 4166

Order No. R- ~~3796~~

APPLICATION OF SAM BOREN FOR A  
DUAL COMPLETION AND SALT WATER  
DISPOSAL, LEA COUNTY, NEW MEXICO.

ORDER OF THE COMMISSION

BY THE COMMISSION:

This cause came on for hearing at 9 a.m. on July 9, 1969,  
at Santa Fe, New Mexico, before Examiner Daniel S. Nutter.

NOW, on this            day of July, 1969, the Commission, a  
quorum being present, having considered the testimony, the record,  
and the recommendations of the Examiner, and being fully advised  
in the premises,

FINDS:

(1) That due public notice having been given as required by  
law, the Commission has jurisdiction of this cause and the subject  
matter thereof.

(2) That the applicant, Sam Boren, seeks authority to  
complete his Barbera State "A" Well No. 1, located in Unit P  
of Section 6, Township 12 South, Range 34 East, NMPM, East  
Bagley-Pennsylvanian Pool, Lea County, New Mexico, as a dual  
completion to produce oil from the East Bagley-Pennsylvanian  
Pool through <sup>2 3/8-inch</sup> tubing and to dispose of produced salt  
water down the annulus between the 4 1/2-inch production  
casing string and the 8 5/8-inch intermediate casing string  
into the San Andres and Glorieta formations in the open-hole  
interval from approximately 4060 feet to 6562 feet.

(3) That the produced salt water should be continuously treated prior to injection to prevent casing corrosion and coupon corrosion tests should be conducted continuously on said well and the results thereof filed quarterly with the Commission until further notice from the Secretary-Director of the Commission.

(4) That approval of the dual completion and salt water disposal as set out above will prevent the drilling of unnecessary wells, and will otherwise prevent waste and protect correlative rights.

IT IS THEREFORE ORDERED:

(1) That the applicant, Sam Boren, is hereby authorized to complete his Barbera State "A" Well No. 1, located in Unit P of Section 6, Township 12 South, Range 34 East, NMPM, East Bagley-Pennsylvanian Pool, Lea County, New Mexico, as a dual completion to produce oil from the East Bagley-Pennsylvanian Pool through 2 3/8" <sup>inch</sup> tubing and to dispose of produced salt water down the annulus between the 4 1/2 -inch production casing string and the 8 5/8 -inch intermediate casing string into the San Andres and Glorieta formations in the open-hole interval from approximately 4060 feet to 6562 feet;

PROVIDED HOWEVER, that the produced salt water shall be continuously treated prior to injection to prevent casing corrosion; that coupon corrosion tests shall be conducted continuously on said well and the results thereof filed quarterly with the Commission until further notice from the Secretary-Director of the Commission;

PROVIDED FURTHER, that the applicant shall submit monthly reports of his disposal operations in accordance with Rules 704 and 1120 of the Commission Rules and Regulations.

(2) That jurisdiction of this cause is retained for the entry of such further orders as the Commission may deem necessary.

DONE at Santa Fe, New Mexico, on the day and year hereinabove designated.