

CASE 4667:

NORTHWESTERN NEW MEXICO  
NOMENCLATURE

Case Number

4667

Application

Transcripts

Small Exhibits

ETC.

DEC COURT NO 1  
NO 4667

(a) That a new pool in San Juan County, New Mexico, classified as an oil pool for Pennsylvanian production, be and the same is hereby created and designated as the Buena Suerte-Pennsylvanian Oil Pool, consisting of the following described area:

Based on:

(b) That a new pool in Sandoval County, New Mexico, classified as an oil pool for Dakota production, be and the same is hereby created and designated as the Five Lakes-Dakota Oil Pool, consisting of the following described area:

**Based on:**

Refiners Petroleum Corp., #2 Cuba Union  
A-26-22N-3W  
1P 240 BOPD

(c) That a new pool in San Juan County, New Mexico, classified as a gas pool for Fruitland production, be and the same is hereby created and designated as the South Gallegos-Fruitland Pool, consisting of the following described area:

Township 26 North, Range 12 West, NMPM  
Section 11: S/2 and NW/4  
Section 12: All

Case No. 4667

Based on:

Discovery Well:  
Skelly Oil Co., #1 Navajo G  
K-12-26N-12W  
AOF 2216 MCF, SICP 350 #/7 days  
Perf. 1100 - 1113  
Completed 5-27-68

Skelly Oil Co., #9 J. W. Goddard  
E-11-26N-12W  
AOF 1971 MCF

Skelly Oil Co., #1 Navajo L  
I-11-26N-12W  
AOF 1573 MCF, SICP 373 #

Skelly Oil Co., #3 J. W. Goddard  
K-11-26N-12W  
AOF 1814 MCF, SICP 350 #

Jerome P. McHugh, #1 Allen  
C-12-26N-12W  
AOF 2135 MCF

- (d) That a new pool in Rio Arriba County, New Mexico, classified as an oil pool for Gallup-Dakota production, be and the same is hereby created and designated as the West Lindrith-Gallup-Dakota Oil Pool, consisting of the following described area:

Township 25 North, Range 4 West, NMPM  
Section 15: SE/4  
Section 21: SE/4  
Section 22: All  
Section 27: All  
Section 28: All  
Section 32: SE/4  
Section 33: All  
Section 34: All

Based on:

Continental Oil Co., #4 Jicarilla 22  
J-15-25N-4W  
DHC-66

Continental Oil Co., #2 Jicarilla 22  
J-21-25N-4W  
DHC-65

Continental Oil Co., #3 Jicarilla 22  
D-22-25N-4W  
DHC-67

Continental Oil Co., #6 Jicarilla 22  
A-22-25N-4W  
DHC-102

Continental Oil Co., #1 Jicarilla 22  
J-22-25N-4W  
IP Gallup 55  
Dakota 61

Continental Oil Co., #5 Jicarilla 22  
L-22-25N-4W  
DHC-Order R-4071

Continental Oil Co., #13 Jicarilla 28  
A-27-25N-4W  
DHC-Order R-4203

Continental Oil Co., #2 Jicarilla 28  
D-27-25N-4W  
IP Gallup 88 BOPD  
Dakota 44 BOPD

Continental Oil Co., #7 Jicarilla 28  
J-27-25N-4W  
DHC-60

Continental Oil Co., #12 Jicarilla 28  
L-27-25N-4W  
DHC-Order R-4203

Continental Oil Co., #9 Jicarilla 28  
A-28-25N-4W  
DHC-Order R-4071

Continental Oil Co., #8 Jicarilla 28  
C-28-25N-4W  
DHC-56

Continental Oil Co., #1 Jicarilla 28  
J-28-25N-4W  
DHC-57

Continental Oil Co., #10 Jicarilla 28  
L-28-25N-4W  
DHC-Order R-4071

Continental Oil Co., #3 Jicarilla 30  
J-32-25N-4W  
DHC-61

Continental Oil Co., #11 Jicarilla 28  
B-33-25N-4W  
DHC-Order R-4071

Continental Oil Co., #6 Jicarilla 28  
D-33-25N-4W  
DHC-64

Continental Oil Co., #5 Jicarilla 28  
J-33-25N-4W  
DHC-58

Continental Oil Co., #4 Jicarilla 28  
D-34-25N-4W  
DHC-62

Continental Oil Co., #3 Jicarilla 28  
P-34-25N-4W  
DHC-63

- (e) That a new pool in Sandoval County, New Mexico, classified as an oil pool for Mesaverde production, be and the same is hereby created and designated as the Parlay-Mesaverde Oil Pool, consisting of the following described area:

-4-  
Case No. 4667

Township 22 North, Range 3 West, NMPM  
Section 29: N/2

Based on:

Discovery Well:  
Tesoro Petroleum Corp., #1 Parlay  
H-29-22N-3W  
IP 336 BOPD  
Perf. 4340 - 4370  
Completed 10-4-71

Tesoro Petroleum Corp., #2 Parlay  
F-29-22N-3W  
IP 80PD

- (f) That a new pool in San Juan County, New Mexico, classified as an oil pool for Gallup production, be and the same is hereby created and designated as the Rattlesnake-Gallup Oil Pool, consisting of the following described area:

Township 29 North, Range 19 West, NMPM  
Section 2: NE/4

Based on:

Discovery Well:  
Eastern Petroleum Co., #23 Navajo  
G-2-29N-19W  
IP 18 BOPD  
Open hole 195 - 420  
Completed 7-19-68

Eastern Petroleum Corp., #45 Navajo  
A-2-29N-19W  
IP 7 BOPD

- (g) That a new pool in San Juan County, New Mexico, classified as an oil pool for Dakota production, be and the same is hereby created and designated as the Snake Eyes-Dakota Oil Pool, consisting of the following described area:

Township 21 North, Range 8 West, NMPM  
Section 17: SW/4 SE/4  
Section 20: N/2 & SW/4

Based on:

Discovery Well:  
Drilled as: Davis Oil Co., #1 Snake Eyes  
Now: Anderson Oil Company, #1 Snake Eyes  
C-20-21N-8W  
IP 48 BOPD  
Perf. 4594 - 4634  
Completed 7-29-71

Anderson Oil Co., #1 Schram-Hanson Federal  
O-17-21N-8W  
IP 264 BOPD

Tenneco Oil Co., #2 Snake Eyes  
K-20-21N-8W  
IP 3697 MCF, SICP 1525 #

Dismiss

- (h) That a new pool in San Juan County, New Mexico, classified as a gas pool for Pennsylvanian production, be and the same is hereby created and designated as the North Tocito Dome-Pennsylvanian Pool, consisting of the following described area:

Township 26 North, Range 18 West, NMPM  
Section 9: E/2  
Section 10: SW/4

Based on:

Discovery Well:  
Campbell, Kiel, Rothwell, #1 Navajo Tocito  
G-9-26N-18W  
IP 16,095 MCF, SITP 2546, #/6 days  
Perf. 6322- 6328  
Completed 12-2-67

Southern Gulf Production Co., #4 Navajo Tocito  
L-10-26N-18W  
IP 6864 MCF, SICP 2585 #/3 days

- (i) That a new pool in San Juan County, New Mexico, classified as a gas pool for Pictured Cliffs production, be and the same is hereby created and designated as the Waw-Pictured Cliffs Pool, consisting of the following described area:

Township 27 North, Range 13 West, NMPM  
Section 32: SW/4

Based on:

Discovery Well:  
Dugan Production Corp., #1 Waw  
L-32-27N-13W  
■ AOF 603 MCF, SICP 197 psig  
Perf. 1325 - 1329  
Completed 6-20-70

- (j) That the Angels Peak-Gallup Oil Pool in San Juan County, New Mexico, as heretofore classified, defined, and described, be and the same is hereby extended to include therein:

Township 26 North, Range 9 West, NMPM  
Section 17: E/2

Add: Section 15: NW/4  
Section 16: All

Based on:

El Paso Natural Gas Co., #11 Ballard  
D-15-26N-9W  
IP 25 BOPD

El Paso Natural Gas Co., #160 Huerfano Unit  
O-17-26N-9W  
■ AOF 517 MCF, SICP 992 #/16 days

- (k) That the Aztec-Pictured Cliffs Pool in San Juan County, New Mexico, as heretofore classified, defined, and described, be and the same is hereby extended to include therein:

Township 28 North, Range 9 West, NMPM  
Section 31: SW/4

-6-  
Case No. 4667

Add: Township 31 North, Range 12 West, NMPM  
Section 27: N/2  
Section 28: N/2 & SE/4

Based on:

El Paso Natural Gas Co., #2 Hancock B  
L-31-28N-9W  
AOF 2005 MCF, SICP 569 #/13 days

Aztec Oil & Gas Co., #13 Thompson  
F-28-31N-12W  
AOF 242 MCF, SICP 612 #

Aztec Oil & Gas Co., #14 Thompson  
I-28-31N-12W  
AOF TSTM ■■■

- (1) That the Ballard-Pictured Cliffs Pool in Rio Arriba, San Juan and Sandoval Counties, New Mexico, as heretofore classified, defined, and described, be and the same is hereby extended to include therein:

Township 22 North, Range 2 West, NMPM  
Section 6: SW/4

Township 22 North, Range 3 West, NMPM  
Section 2: NE/4

Township 23 North, Range 4 West, NMPM  
Section 24: SE/4

Based on:

Amoco Production Co., #1 Jicarilla Tribal 358  
M-6-22N-2W  
AOF 6541 MCF, SICP 734 #/7 days

Amoco Production Co., #3 Jicarilla Tribal 360  
A-2-22N-3W  
AOF 7759 MCF, SICP 694 #/7 days

Amoco Production Co., #2 Jicarilla Tribal 390  
I-24-23N-4W  
AOF 1343 MCF, SITP 701 #/7 days

- (m) That the Blanco-Mesaverde Pool in Rio Arriba and San Juan Counties, New Mexico, as heretofore classified, defined, and described, be and the same is hereby extended to include therein:

Township 26 North, Range 5 West, NMPM  
Section 13: All  
Section 24: W/2

Township 29 North, Range 10 West, NMPM  
Section 3: All  
Section 10: All

Based on:

Tenneco Oil Co., #8 Jicarilla C  
E-13-26N-5W  
AOF 4369 MCF, SICP 1060 #

Tenneco Oil Co., #7 Jicarilla C  
M-13-26N-5W  
AOF 3431 MCF, SICP 1092 #

Tenneco Oil Co., #4 Jicarilla C  
F-24-26N-5W  
AOF 2308 MCF, SICP 1214 #

Aztec Oil & Gas Co., #18 Hare  
H-10-29N-10W  
AOF 4164 MCF, SICP 958 #

Aztec Oil & Gas Co., #14 Hare  
K-10-29N-10W  
AOF 1311 MCF, SICP 908 #

- (n) That the Blanco-Pictured Cliffs Pool in San Juan County, New Mexico, as heretofore classified, defined, and described, be and the same is hereby extended to include therein:

Township 30 North, Range 10 West, NMPM  
Section 1: W/2

Township 31 North, Range 11 West, NMPM  
Section 25: NW/4

Based on:

El Paso Natural Gas Co., #4 Sunray B  
E-1-30N-10W  
AOF 7282 MCF, SICP 925 #/7 days

El Paso Natural Gas Company, #5 Sunray B  
M-1-30N-10W  
AOF 5397 MCF, SICP 925 #/11 days

Aztec Oil & Gas Co., #3 Bruington  
C-25-31N-11W  
AOF 2928 MCF, SICP 824 #

- (o) That the South Blanco-Pictured Cliffs Pool in Rio Arriba, San Juan and Sandoval Counties, New Mexico, as heretofore classified, defined, and described, be and the same is hereby extended to include therein:

Township 23 North, Range 2 West, NMPM

Section 16: SW/4

Section 17: SE/4

Section 20: N/2

Section 21: All

Section 28: NW/4

Add: Township 25 North, Range 4 West, NMPM

Section 2: W/2

Section 3: All

Section 4: All

Township 26 North, Range 4 West, NMPM

Section 35: SW/4

Based on:

Dyna Ray Oil & Gas Co., Inc., #3 Jicarilla R 165  
D-28-23N-2W  
AOF 1582 MCF, SICP 652 #/8 days

Southern Union Production Co., #3 Jicarilla B  
K-35-26N-4W  
AOF 732 MCF, SICP 1049 #/7 days

- (p) That the BS Mesa-Gallup Pool in Rio Arriba County, New Mexico, as heretofore classified, defined, and described, be and the same is hereby extended to include therein:

Township 26 North, Range 4 West, NMPM  
Section 3: N/2  
Section 9: NE/4  
Section 10: NW/4

Based on:

Amoco Production Co., #7 Jicarilla Apache 102  
G-3-26N-4W  
IP 183 MCF

Amoco Production Co., #12 Jicarilla Apache 102  
G-9-26N-4W  
AOF 259 MCF, SICP 1293 #/7 days

Amoco Production Co., #11 Jicarilla Apache 102  
C-10-26N-4W  
AOF 596 MCF, SICP 1230 #/7 days

- (q) That the Choz Mesa-Pictured Cliffs Pool in Rio Arriba County, New Mexico, as heretofore classified, defined, and described, be and the same is hereby extended to include therein:

Township 29 North, Range 3 West, NMPM  
Section 30: S/2

Based on:

El Paso Natural Gas Company, #2 Indian A  
N-30-29N-3W  
AOF 7984 MCF, SICP 1109 #

- (r) That the Fulcher Kutz-Pictured Cliffs Pool in San Juan County, New Mexico, as heretofore classified, defined, and described, be and the same is hereby extended to include therein:

Township 29 North, Range 11 West, NMPM  
Section 6: NE/4

Based on:

Pubco Petroleum Corp., #18 Federal  
G-6-29N-11W  
AOF 231 MCF, SITP 333#

- (s) That the Gallegos-Gallup Oil Pool in San Juan County, New Mexico, as heretofore classified, defined, and described, be and the same is hereby extended to include therein:

Township 26 North, Range 11 West, NMPM  
Section 24: S/2

Based on:

Alamo Petroleum Co., #1 Davis Federal  
L-24-26N-11W  
IP 5 BOPD

- (t) That the Hogback-Dakota Oil Pool in San Juan County, New Mexico, as heretofore classified, defined, and described, be and the same is hereby extended to include therein:

Township 29 North, Range 16 West NMPM

Section 7: SW/4 SW/4

Section 18: NW/4 NW/4

Based on:

W. C. Imbt, #2 Navajo 7A

M-7-29N-16W

IP 80 BOPD

W. C. Imbt, #1 Navajo 18A

D-18-29N-16W

IP 79 BOPD

- (u) That the Kutz-Fruitland Pool in San Juan County, New Mexico, as heretofore classified, defined, and described, be and the same is hereby extended to include therein:

Township 28 North, Range 11 West NMPM

Section 24: NW/4

Section 25: N/2

Based on:

Chaparral Oil & Gas Co., #2 Sally

F-24-28N-11W

AOF 252 MCF, SICP 500 #/7 days

Southern Union Production Co., #12 Angel Peak B

A-25-28N-11W

AOF 894 MCF, SICP 654 #/7 days

- (v) That the Lone Pine-Dakota Oil Pool in McKinley County, New Mexico, as heretofore classified, defined, and described, be and the same is hereby extended to include therein:

Township 17 North, Range 8 West, NMPM

Section 7: S/2

Section 8: E/2 NW 4, N/2 SW/4 & SE/4 SW/4

Section 17: NE/4 NW/4

Section 18: E/2 SE/4

Township 17 North, Range 9 West, NMPM

Section 12: E/2 SE/4

Section 13: NE/4 NW/4

Section 24: E/2 NW/4

Based on:

Tenneco Oil Co., #12 SFPRR

I-7-17N-8W

IP 1085 MCF, SICP 187 #

Tenneco Oil Co., #15 SFPRR

J-7-17N-8W

IP 350 BOPD

Tesoro Petroleum Corporation, #27 SFPRR

K-7-17N-8W

IP 105 BOPD

Tesoro Petroleum Corporation, #26 Santa Fe Railroad

N-7-17N-8W

IP 105 BOPD

Tenneco Oil Co., #11 SFPRR  
P-7-17N-8W  
IP 226 BOPD

Claude C. Kennedy, #1 BSK Edna  
F-8-17N-8W  
IP Confidential

Beard Oil Co., #2 Joe Toledo  
L-8-17N-8W  
IP 368 BOPD

Tenneco Oil Co., #2 Kagoso  
I-18-17N-8W  
IP 61 BOPD

Tenneco Oil Co., #44 Hospah  
P-12-17N-9W  
AOF 459 MCF, SICP 800 #

Tenneco Oil Co., #13 SFPRR  
C-24-17N-9W  
IP 148 BOPD

- (w) That the Lybrook-Gallup Oil Pool in Rio Arriba, San Juan and Sandoval Counties, New Mexico, as heretofore classified, defined, and described, be and the same is hereby extended to include therein:

Township 23 North, Range 6 West, NMPM

Section 7: SW/4 & SE/4 NW/4  
Section 18: W/2  
Section 19: All  
Section 20: SW/4  
Section 30: W/2  
Section 31: NW/4 NW/4

Township 23 North, Range 7 West, NMPM

Section 3: SW/4  
Section 4: E/2 SE/4  
Section 5: All  
Section 13: All  
Section 14: SE/4 & E/2 NE/4  
Section 22: NE/4 & NE/4 SE/4  
Section 23: N/2  
Section 24: NW/4 & NW/4 SW/4

Township 24 North, Range 7 West, NMPM

Section 29: SW/4  
Section 32: W/2

Based on:

Petroleum Consultants, Inc., #1 McBee B  
F-7-23N-6W  
IP 6 BOPD

Stanley J. Stanley, #1 Chapman  
N-20-23N-6W  
IP 75 BOPD

Tesoro Petroleum Corp., #1 Quinella  
D-31-23N-6W  
IP 52 BOPD

-10A-  
Case No. 4667

Paragraph (w) continued

BCO, Inc., #1 Federal A  
E-23-23N-7W  
IP 60 80PD

Byron Oil Industries, #1 Hanson Federal  
L-3-23N-7W  
IP 168 BOPD

Dugan Production Co., #1 Sapp C  
M-5-23N-7W  
IP 23 BOPD

BCO, Inc., #22 Federal B  
I-22-23N-7W  
IP 23 BOPD

Petroleum Consultants, Inc., #1 Rogers C  
L-24-23N-7W  
IP 80 BOPD

Petroleum Consultants, #3 Connie  
K-29-24N-7W  
IP 100 BOPD

Dugan Production Corp., #1 State  
E-32-24N-7W  
IP 97 BOPD

- (x) That the Otero-Chacra Pool in Rio Arriba County, New Mexico, as heretofore classified, defined, and described, be and the same is hereby extended to include therein:

Township 25 North, Range 4 West, NMPM  
Section 31: NW/4

Township 25 North, Range 5 West, NMPM  
Section 3: W/2  
Section 10: N/2  
Section 11: NW/4  
Section 35: N/2  
Section 36: N/2

Township 25 North, Range 6 West, NMPM  
Section 1: All  
Section 3: N/2  
~~Section 6: NE/4~~

Delete —

Township 26 North, Range 5 West, NMPM  
Section 34: W/2

Township 26 North, Range 6 West, NMPM  
Section 18: SW/4  
Section 19: W/2 & SE/4  
Section 20: SW/4  
Section 26: SW/4  
Section 28: All  
Section 29: W/2  
Section 30: All  
Section 31: N/2

Township 26 North, Range 7 West, NMPM  
Section 12: W/2  
Section 13: N/2 & SE/4

-12-  
Case No. 4667

Based on:

Continental Oil Co., #4 Jicarilla 30  
F-31-25N-4W  
AOF 1014 MCF, SICP 870 #

Amoco Production Co., #21 Jicarilla Cont. 146  
K-3-25N-5W  
AOF 1190 MCF, SICP 829 #/7 days

Southern Union Production Co., #13 Jicarilla K  
E-11-25N-5W  
AOF 6630 MCF, SICP 603 #/22 days

EPNG Co., #151 Canyon Largo Unit  
E-1-25N-6W  
AOF 1209 MCF, SICP 912 #/11 days

EPNG Co., #152 Canyon Largo Unit  
O-1-25N-6W  
AOF 1461 MCF, SICP 857 #/9 days

EPNG Co., #150 Canyon Largo Unit  
D-3-25N-6W  
AOF 2961 MCF, SICP 852 #/14 days

Marathon Oil Co., #3 Jicarilla Apache  
D-34-26N-5W  
AOF 968 MCF, SICP 885 #/7 days

EPNG Co., #9 Vaughn  
M-26-26N-6W  
AOF 1251 MCF, SICP 928 #/11 days

EPNG Co., #11 Vaughn  
E-28-26N-6W  
AOF 654 MCF, SICP 777 #/7 days

EPNG Co., #10 Vaughn  
I-28-26N-6W  
AOF 1334 MCF, SICP 930 #/15 days

EPNG Co., #16 Vaughn  
L-28-26N-6W  
AOF 385 MCF, SICP 540 #/13 days

EPNG Co., #17 Vaughn  
K-29-26N-6W  
AOF 1046 MCF, SICP 781 #/13 days

EPNG Co., #11 Klein  
I-30-26N-6W  
AOF 1573 MCF, SITP 846 #/7 days

EPNG Co., #3 Klein A  
A-31-26N-6W  
AOF 955 MCF, SICP 812 #/11 days

Merrion & Bayless, #1 Fields Com  
F-31-26N-6W  
AOF 3105 MCF, SICP 727 #/8 days

EPNG Co., #189 Rincon Unit  
D-12-26N-7W  
AOF 1069 MCF, SICP 1003 #

- (y) That the Otero-Gallup Oil Pool in Rio Arriba County, New Mexico, as heretofore classified, defined, and described, be and the same is hereby extended to include therein:

Township 24 North, Range 5 West, NMPPM

Section 3: W/2  
Section 4: All  
Section 5: SE/4, S/2 NE/4 & NE/4 NE/4  
Section 9: N/2 & E/2 SW/4  
Section 10: NW/4, SW/4 NE/4 & NW/4 SW/4

*Addition* —

Township 25 North, Range 5 West, NMPPM

Section 33: SE/4

Based on:

Southern Union Production Co., #3 Jicarilla L  
E-3-24N-5W  
IP 23 BOPD

Southern Union Production Co., #2 Jicarilla N  
N-3-24N-5W  
IP 25 BOPD

Southern Union Production Co., #1 Jicarilla N  
K-4-24N-5W  
IP 15 BOPD

Southern Union Production Co., #4 Jicarilla L  
G-9-24N-5W  
IP 30 BOPD

Southern Union Production Co., #2 Jicarilla L  
G-10-24N-5W  
IP 17 BOPD

Continental Oil Co., #7 Northeast Haynes  
L-10-24N-5W  
IP 10 BOPD

- (z) That the Pinon-Fruitland Pool in San Juan County, New Mexico, as heretofore classified, defined, and described, be and the same is hereby extended to include therein:

*Delete*

Township 28 North, Range 12 West, NMPPM

Section 13: SW/4  
Section 14: SE/4

Add:

Township 28 North, Range 11 West, NMPPM

Section 19: W/2

Based on:

Amoco Petroleum Co., #257 Gallegos Canyon Unit  
K-19-28N-11W  
AOF 1050 MCF, SICP 506 #/7 days

- (aa) That the Slick Rock-Dakota Oil Pool in San Juan County, New Mexico, as heretofore classified, defined, and described, be and the same is hereby extended to include therein:

Township 30 North, Range 16 West, NMPPM

Section 31: W/2 SW/4 & SW/4 NW/4

Township 30 North, Range 17 West, NMPM  
Section 36: NE/4 NE/4

Based on:

Rijan Oil Company, Inc., #9 Rijan  
E-31-30N-16W  
IP 36 BOPD

Rijan Oil Company, Inc., #11 Rijan  
E-31-30N-16W  
IP 66 BOPD

Rijan Oil Company, Inc., #13 Rijan  
L-31-30N-16W  
IP 50 BOPD

Rijan Oil Company, Inc., #8 Rijan  
M-31-30N-16W  
IP 25 BOPD

W. M. Gallaway, #37 Deb  
A-36-30N-17W  
IP 11 BOPD

- (bb) That the Wild Horse-Gallup Pool in Rio Arriba County, New Mexico, as heretofore classified, defined, and described, be and the same is hereby extended to include therein:

Township 26 North, Range 3 West, NMPM  
Section 19: SW/4

Township 26 North, Range 4 West, NMPM  
Section 12: SW/4  
Section 13: NW/4  
Section 24: NW/4

Based on:

Jerome P. McHugh, #4 Apache  
L-19-26N-3W  
AOF 453 MCF, SICP 1330 #

Aztec Oil & Gas Co., #2 Jicarilla 101  
M-12-26N-4W  
IP 790 MCF, SICP 1673

Southern Union Production Co., #12 Jicarilla A  
D-24-26N-4W  
AOF 7019 MCF, SITP 909 #/15 days.

## HISTORY

Order R-2824

December 7, 1964

Application by Continental Oil Company

Approved down-hole commingling by the use of a dual flow down-hole choke in its Jicarilla 28 #1, J-28, subject to rehearing in June, 1965.

Order R-2824-A

August 16, 1965

Recall of Order R-2824

Continue R-2824 in effect provided that annual tests be taken to establish zone allowables.

Order R-2978

October 13, 1965

Application of Continental Oil Company

Approved administrative approval procedure for down-hole commingling by use of a dual flow down-hole choke in marginal Gallup-marginal Dakota oil wells in Rio Arriba County.

Set out application requirements and required semi-annual test until the Secretary-Director approved annual tests for your allowable assignment.

## LETTER

October 3, 1968

ALP/DSN to Continental Oil Company.

Approved request to replace the dual flow down-hole choke assemblies required by R-2978 with the "D" landing nipple with a standing valve and Camco MM mandrel with the RG double check valve.

*9/28/70 9/20/70 9/28/70*  
DHC - 56, 57, 58, 60, 61, 62, 63, 64, 65, 66, & 67

Order R-4071

December 1, 1970

Application of Continental Oil Company

Approved down-hole commingling of four undrilled wells being the Jicarilla 22 #5, L-22, Jicarilla 28 #9, A-28, Jicarilla 28 #10, L-28, and the Jicarilla 28 #11, B-33. The zone allowable allocation factors being 53 % of the oil and 39% of the gas for the Gallup zone and 47% of the oil and 61% of the gas for the Dakota zone. These factors are average of the prior completions in the area.

Order R-4203

October 8, 1971

Application of Continental Oil Company

Authorization for Jicarilla 28 #12, I-27, and Jicarilla 28 # 13, A-27, to be commingled down-hole with the same allocation factors assigned by R-4071.

Also, set out an administrative approval of other undrilled wells to be completed in a like manner and with the same allocation factors.

DHC-102 Dec 30, 1971

Order R-4245

January 27, 1972

Application of Manning Oil & Gas Company

Approval of down-hole commingling for its Apache #100, A-3-24N-4W, and authorized the Secretary-Director to approve others without hearing in sections 1, 2, 3 & 4 of T24N, R4W. Allocation assigned to the zones as in R-4071 and R-4203.

BEFORE EXAMINER UTZ  
OIL CONSERVATION COMMISSION

*DEC* EXHIBIT NO. 2

CASE NO. 4667

Submitted by DEC

Hearing Date 2-16-72

COUNTY *Rio Arriba* POOL *West Lindrith Gallup-Dakota Oil Pool*

TOWNSHIP *25 North* RANGE *4 West* NMPM

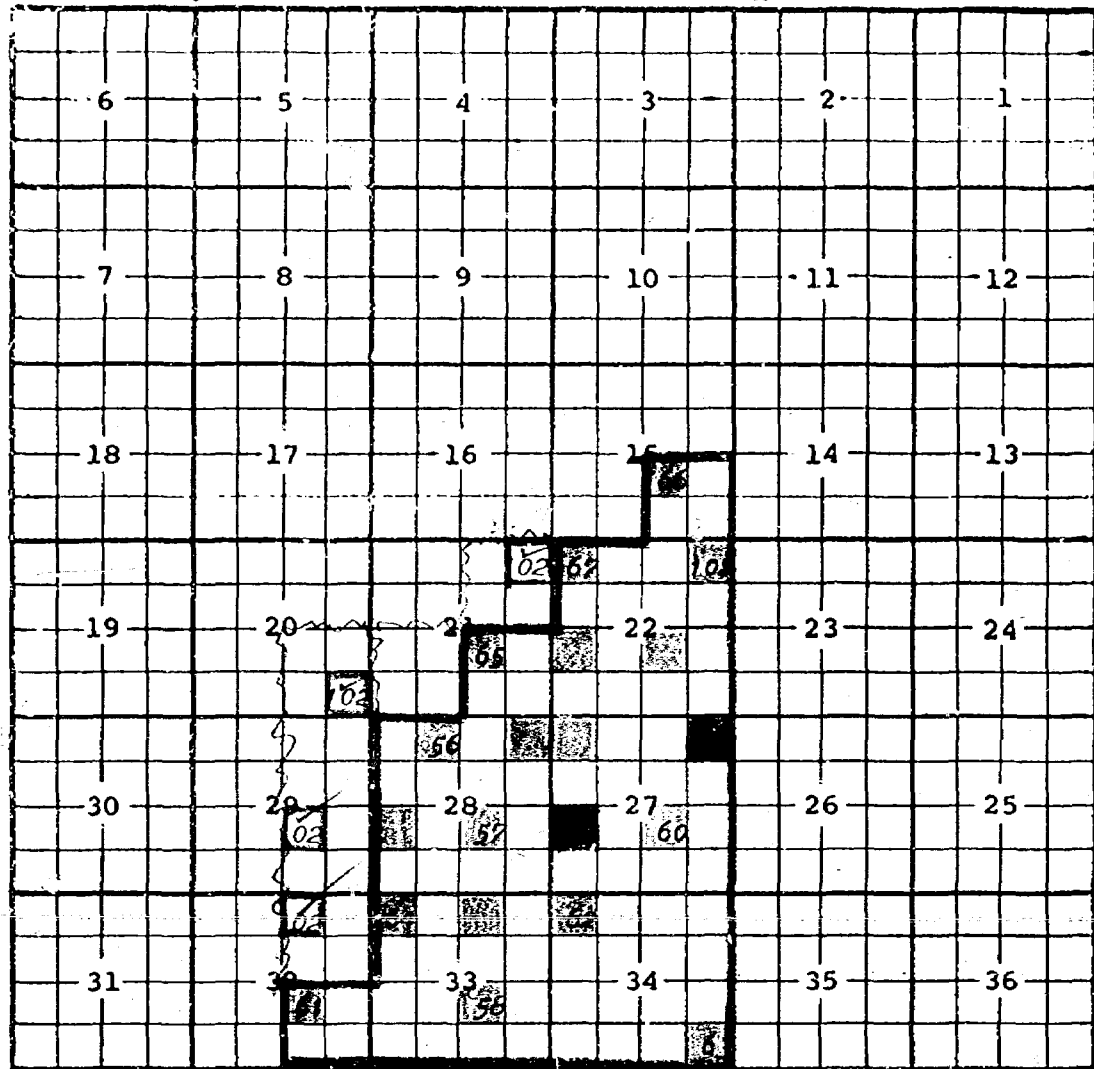

- ☒ Down-hole commingling approved by administrative order shown.
- ☒ Down-hole commingling approved by Order R-4071.
- ☒ Down-hole commingling approved by Order R-4302.
- ☐ Completed with parallel casing strings. Not yet commingled.

BEFORE EXAMINER UTZ	
OIL CONSERVATION COMMISSION	
EXHIBIT NO.	3
CASE NO.	4667
Submitted by	
Hearing Date	

DHC #56	September 8, 1970		
Jicarilla 28 #8, C-28-25-4			
Assignment:	Upper 60 %	Lower 40%	
Test data:	Upper 66.67%	Lower 33.33%	
DHC #57	September 20, 1970		
Jicarilla 28 #1, J-28-25-4			
Assignment:	Upper 50%	Lower 50%	
Test data:	Upper 53.35%	Lower 46.65%	
DHC #58	September 20, 1970		
Jicarilla 28 #5, J-33-25-4			
Assignments:	Upper 60%	Lower 40%	
Test data:	Upper 62.54%	Lower 37.46%	
DHC #60	September 28, 1970		
Jicarilla 28 #7, J-27-25-4			
Assignments:	Upper 60%	Lower 40%	
Test data:	Upper 14.36%	Lower 85.64%	
DHC #61	September 28, 1970		
Jicarilla 30 #3, J-32-25-4			
Assignments:	Upper 70%	Lower 30%	
Test data:	Upper 64.72%	Lower 35.28%	
DHC #62	September 28, 1970		
Jicarilla 28 #4, D-34-25-4			
Assignments:	Upper 80%	Lower 20%	
Test data:	Upper 71.27%	Lower 28.73%	
DHC #63	September 28, 1970		
Jicarilla 28#3, P-34-25-4			
Assignments:	Upper 45%	Lower 55%	
Test data:	Upper 33.33%	Lower 66.67%	
DHC #64	September 28, 1970		
Jicarilla 28 #6, D-33-25-4			
Assignments:	Upper 50%	Lower 50%	
Test data:	Upper 54.66%	Lower 45.34%	
DHC #65	September 28, 1970		
Jicarilla 22 #2, J-21-25-4			
Assignments:	Upper 60%	Lower 40%	
Test data:	Upper 56.65%	Lower 43.35%	
DHC #66	September 28, 1970		
Jicarilla 22 #4, J-15-25-4			
Assignments:	Upper 55%	Lower 45%	
Test data:	Upper 43.35%	Lower 56.65%	
DHC #67	September 28, 1970		
Jicarilla 22 #3, D-22-25-4			
Assignments:	Upper 10%	Lower 90%	
Test data:	Upper 10.09%	Lower 89.91%	
DHC #102	December 30, 1971		
Jicarilla 22 #6, A-22-25-4			

BEFORE EXAMINER UTZ OIL CONSERVATION COMMISSION	EXHIBIT NO. <u>4</u>
	CASE NO. <u>4967</u>
Submitted by _____	Hearing Date _____

Jicarilla 22 #7, A-21-25-4  
Jicarilla 20 #5, P-20-25-4  
Jicarilla 30 #5, B-32-25-4  
Jicarilla 30 #6, J-29-25-4

*Test data not required with application*

Allowable assignments to each of the above five wells is the same as set out in R-4071 and R-4203, being 53% of the oil and 39% of the gas for the Gallup zone and 47% of the oil and 61% of the gas for the Dakota zone.

	Jicarilla Lease	Well Number	Unit Letter	Section	Down-hole Comm. Approval Order	1		2		3	4	5	
						Volume	thru	Percentages	thru	Volume	Volume	Volume	
						1970	1970	1971	1971	during	thru	both	
												zones	
1	22	1	J-22			26030	76	58		1500	27530		1
2						8447	24	42		1066	9513	37043	2
3	22	2	J-21		65	9956	60	60		2940	12896		3
4						6585	40	40		1989	8574	21470	4
5	22	3	D-22		67	2830	27	10		479	3309		5
6						7705	73	90		4420	12125	15434	6
7	22	4	J-15		66	4814	54	55		2178	6992		7
8						4136	46	45		1766	5920	12912	8
9	22	5	L-22		R-4071								9
10													10
11	22	6	A-22		102								11
12													12
13	28	1	J-28		57	38179	42	50		2332	40511		13
14						53678	58	50		2334	56012	96523	14
15	28	2	D-27			15227					15227		15
16						25812				1404	27216	42443	16
17	28	3	P-34		63	20683	42	45		3082	23765		17
18						28227	58	55		3724	31951	55716	18
19	28	4	D-34		62	4771	61	83		1332	6103		19
20						3105	39	17		281	3386	9489	20
21	28	5	J-33		58	11223	42	60		6417	17640		21
22						15320	58	40		4296	19616	37256	22
23	28	6	D-33		64	7017	38	50		3603	10620		23
24						11673	62	50		3602	15275	25895	24
25	28	7	J-27		60	4892	36	60		1221	6113		25
26						8532	64	40		813	9345	15458	26
27	28	8	D-28		56	10314	62	60		3883	14197		27
28						6448	38	40		2580	9028	23225	28
29	28	9	A-28		R-4071			49		3849	3849		29
30								51		3986	3986	7835	30
31	28	10	L-28		R-4071			53		937	937		31
32								47		841	841	1778	32
33	28	11	B-33		R-4071			52		1029	1029		33
34								48		941	941	1970	34
35	28	12	L-27		R-4203			52		525	525		35
36								48		478	478	1003	36
37	28	13	A-27		R-4203								37
38													38
39	30	3	J-32		61	28396	67	71		2769	31165		39
40						12923	33	29		1149	15072	46237	40

TOTAL PRODUCTION: GALLUP 222,408; DAKOTA 229,279 BARRELS. GRAND TOTAL 451,687 BARRELS

Top line each well is Gallup, second line is Dakota.

Line 1. This well not commingled.

Line 9. First production in November 1971. Error in reporting. Volumes omitted.

Line 11. No production in 1971.

Line 15. This well not commingled. No Gallup production reported since March 1966.

Line 19. No Dakota production reported from August 1970 to March 1971.

Line 29. First production February 1971.

Line 31. First production November 1971.

Line 33. First production November 1971.

Line 35. First production December 1971.

Line 37. No production in 1971.

BEFORE EXAMINER UTZ  
OIL CONSERVATION COMMISSION

EXHIBIT NO. 5

CASE NO. 4667

Submitted by

Hearing Date

BEFORE THE OIL CONSERVATION COMMISSION  
OF THE STATE OF NEW MEXICO

IN THE MATTER OF THE HEARING  
CALLED BY THE OIL CONSERVATION  
COMMISSION OF THE STATE OF  
NEW MEXICO FOR THE PURPOSE  
OF CONSIDERING:

CASE NO. 4667  
Order No. R-4260

THE APPLICATION OF THE OIL  
CONSERVATION COMMISSION UPON  
ITS OWN MOTION FOR AN ORDER  
CREATING AND EXTENDING CERTAIN  
POOLS IN MCKINLEY, RIO ARRIBA,  
SANDOVAL, AND SAN JUAN COUNTIES,  
NEW MEXICO.

ORDER OF THE COMMISSION

BY THE COMMISSION:

This cause came on for hearing at 9 o'clock a.m. on February 16, 1972, at Santa Fe, New Mexico, before the Oil Conservation Commission of New Mexico, hereinafter referred to as the "Commission."

NOW, on this 22nd day of February, 1972, the Commission, a quorum being present, having considered the testimony presented and the exhibits received at said hearing, and being fully advised in the premises,

FINDS:

(1) That due public notice having been given as required by law, the Commission has jurisdiction of this cause and the subject matter thereof.

(2) That there is need for the creation of a new pool in San Juan County, New Mexico, for the production of oil from the Pennsylvanian formation, said pool to bear the designation of Buena Suerte-Pennsylvanian Oil Pool. Said Buena Suerte-Pennsylvanian Oil Pool was discovered by the Tenneco Oil Company Pah Well No. 1, located in Unit L of Section 3, Township 25 North, Range 11 West, NMPM. It was completed in the Pennsylvanian formation on July 28, 1971. The top of the perforations is at 10,956 feet.

-2-

CASE NO. 4667

Order No. R-4260

(3) That there is need for the creation of a new pool in Sandoval County, New Mexico, for the production of oil from the Dakota formation, said pool to bear the designation of Five Lakes-Dakota Oil Pool. Said Five Lakes-Dakota Oil Pool was discovered by the Refiners Petroleum Corporation Cuba Union Well No. 1, located in Unit A of Section 25, Township 22 North, Range 3 West, NMPM. It was completed in the Dakota formation on October 8, 1970. The top of the perforations is at 6,878 feet.

(4) That there is need for the creation of a new pool in San Juan County, New Mexico, for the production of gas from the Fruitland formation, said pool to bear the designation of South Gallegos-Fruitland Pool. Said South Gallegos-Fruitland Pool was discovered by the Skelly Oil Company Navajo G Well No. 1, located in Unit K of Section 12, Township 26 North, Range 12 West, NMPM. It was completed in the Fruitland formation on May 27, 1968. The top of the perforations is at 1,100 feet.

(5) That there is need for the creation of a new pool in Rio Arriba County, New Mexico, for the production of oil from the Gallup-Dakota formation, said pool to bear the designation of West Lindrith Gallup-Dakota Oil Pool.

(6) That there is need for the creation of a new pool in Sandoval County, New Mexico, for the production of oil from the Mesaverde formation, said pool to bear the designation of Parlay-Mesaverde Oil Pool. Said Parlay-Mesaverde Oil Pool was discovered by the Tesoro Petroleum Corporation Parlay Well No. 1, located in Unit H of Section 29, Township 22 North, Range 3 West, NMPM. It was completed in the Mesaverde formation on October 4, 1971. The top of the perforations is at 4,340 feet.

(7) That there is need for the creation of a new pool in San Juan County, New Mexico, for the production of oil from the Gallup formation, said pool to bear the designation of Rattlesnake-Gallup Oil Pool. Said Rattlesnake-Gallup Oil Pool was discovered by the Eastern Petroleum Company Navajo Well No. 23, located in Unit G of Section 2, Township 29 North, Range 19 West, NMPM. It was completed in the Gallup formation on July 19, 1968. The casing shoe is at 195 feet.

(8) That the proposed creation of a new pool in Sections 17 and 20, Township 21 North, Range 8 West, NMPM, San Juan County, New Mexico, for the production of oil from the Dakota formation should be dismissed.

-3-

CASE NO. 2667

Order No. R-4260

(9) That there is need for the creation of a new pool in San Juan County, New Mexico, for the production of gas from the Pennsylvanian formation, said pool to bear the designation of North Tocito Dome-Pennsylvanian Pool. Said North Tocito Dome-Pennsylvanian Pool was discovered by the Campbell, Kiel, & Rothwell Navajo Tocito Well No. 1, located in Unit G of Section 9, Township 26 North, Range 18 West, NMPM. It was completed in the Pennsylvanian formation on December 2, 1967. The top of the perforations is at 6,322 feet.

(10) That there is need for the creation of a new pool in San Juan County, New Mexico, for the production of gas from the Pictured Cliffs formation, said pool to bear the designation of Waw-Pictured Cliffs Pool. Said Waw-Pictured Cliffs Pool was discovered by the Dugan Production Corporation Waw Well No. 1, located in Unit L of Section 32, Township 27 North, Range 13 West, NMPM. It was completed in the Pictured Cliffs formation on June 20, 1970. The top of the perforations is at 1,325 feet.

(11) That there is need for certain extensions to the Lone Pine-Dakota Oil Pool in McKinley County, New Mexico, the BS Mesa-Gallup Pool, the Choza Mesa-Pictured Cliffs Pool, the Otero-Chacra Pool, the Otero-Gallup Oil Pool and the Wild Horse-Gallup Pool in Rio Arriba County, New Mexico, the Angels Peak-Gallup Oil Pool, the Aztec-Pictured Cliffs Pool, the Blanco-Pictured Cliffs Pool, the Fulcher Kutz-Pictured Cliffs Pool, the Gallegos-Gallup Oil Pool, the Hogback-Dakota Oil Pool, the Kutz-Fruitland Pool, the Pinion-Fruitland Pool and the Slick Rock-Dakota Oil Pool in San Juan County, New Mexico, the Blanco-Mesaverde Pool in Rio Arriba and San Juan Counties, New Mexico, and the Ballard-Pictured cliffs, the South Blanco-Pictured Cliffs and the Lybrook-Gallup Oil Pool in Rio Arriba, Sandoval, and San Juan Counties, New Mexico.

IT IS THEREFORE ORDERED:

(a) That a new pool in San Juan County, New Mexico, classified as an oil pool for Pennsylvanian production, is hereby created and designated as the Buena Suerte-Pennsylvanian Oil Pool, consisting of the following-described area:

TOWNSHIP 25 NORTH, RANGE 11 WEST, NMPM  
Section 3: SW/4

-4-

CASE NO. 4667

Order No. R-4260

(b) That a new pool in Sandoval County, New Mexico, classified as an oil pool for Dakota production, is hereby created and designated as the Five Lakes-Dakota Oil Pool, consisting of the following-described area:

TOWNSHIP 22 NORTH, RANGE 3 WEST, NMPM

Section 24: SE/4 SW/4

Section 25: N/2

Section 26: NE/4 NE/4

(c) That a new pool in San Juan County, New Mexico, classified as a gas pool for Fruitland production, is hereby created and designated as the South Gallegos-Fruitland Pool, consisting of the following-described area:

TOWNSHIP 26 NORTH, RANGE 12 WEST, NMPM

Section 11: S/2 and NW/4

Section 12: All

(d) That a new pool in Rio Arriba County, New Mexico, classified as an oil pool for Gallup-Dakota production, is hereby created and designated as the West Lindrith Gallup-Dakota Oil Pool, consisting of the following-described area:

TOWNSHIP 25 NORTH, RANGE 4 WEST, NMPM

Section 15: SE/4

Section 20: SE/4

Section 21: S/2 and NE/4

Section 22: All

Section 27: All

Section 28: All

Section 29: E/2

Section 32: E/2

Section 33: All

Section 34: All

(e) That a new pool in Sandoval County, New Mexico, classified as an oil pool for Mesaverde production, is hereby created and designated as the Parlay-Mesaverde Oil Pool, consisting of the following-described area:

TOWNSHIP 22 NORTH, RANGE 3 WEST, NMPM

Section 29: N/2

-5-

CASE NO. 4667

Order No. R-4260

(f) That a new pool in San Juan County, New Mexico, classified as an oil pool for Gallup production, is hereby created and designated as the Rattlesnake-Gallup Oil Pool, consisting of the following-described area:

TOWNSHIP 29 NORTH, RANGE 19 WEST, NMPM  
Section 2: NE/4

(g) That the proposed creation of a new pool in San Juan County, New Mexico, classified as an oil pool for Dakota production and designated as the Snake Eyes-Dakota Oil Pool, consisting of the following-described area:

TOWNSHIP 21 NORTH, RANGE 8 WEST, NMPM  
Section 17: SW/4 SE/4  
Section 20: N/2 and SW/4

is hereby dismissed.

(h) That a new pool in San Juan County, New Mexico, classified as a gas pool for Pennsylvanian production, is hereby created and designated as the North Tocito Dome-Pennsylvanian Pool, consisting of the following-described area:

TOWNSHIP 26 NORTH, RANGE 18 WEST, NMPM  
Section 9: E/2  
Section 10: SW/4

(i) That a new pool in San Juan County, New Mexico, classified as a gas pool for Pictured Cliffs production, is hereby created and designated as the Waw-Pictured Cliffs Pool, consisting of the following-described area:

TOWNSHIP 27 NORTH, RANGE 13 WEST, NMPM  
Section 32: SW/4

(j) That the Angels Peak-Gallup Oil Pool in San Juan County, New Mexico, as heretofore classified, defined, and described, is hereby extended to include therein:

TOWNSHIP 26 NORTH, RANGE 9 WEST, NMPM  
Section 17: E/2

-6-

CASE NO. 4667

Order No. R-4260

(k) That the Aztec-Pictured Cliffs Pool in San Juan County, New Mexico, as heretofore classified, defined, and described, is hereby extended to include therein:

TOWNSHIP 28 NORTH, RANGE 9 WEST, NMPM

Section 31: SW/4

TOWNSHIP 31 NORTH, RANGE 12 WEST, NMPM

Section 27: N/2

Section 28: N/2 and SE/4

(l) That the Ballard-Pictured Cliffs Pool in Rio Arriba, San Juan, and Sandoval Counties, New Mexico, as heretofore classified, defined, and described, is hereby extended to include therein:

TOWNSHIP 22 NORTH, RANGE 2 WEST, NMPM

Section 6: SW/4

TOWNSHIP 22 NORTH, RANGE 3 WEST, NMPM

Section 2: NE/4

TOWNSHIP 23 NORTH, RANGE 4 WEST, NMPM

Section 24: SE/4

(m) That the Blanco-Mesaverde Pool in Rio Arriba and San Juan Counties, New Mexico, as heretofore classified, defined, and described, is hereby extended to include therein:

TOWNSHIP 26 NORTH, RANGE 5 WEST, NMPM

Section 13: All

Section 24: W/2

TOWNSHIP 29 NORTH, RANGE 10 WEST, NMPM

Section 3: All

Section 10: All

(n) That the Blanco-Pictured Cliffs Pool in San Juan County, New Mexico, as heretofore classified, defined, and described, is hereby extended to include therein:

TOWNSHIP 30 NORTH, RANGE 10 WEST, NMPM

Section 1: W/2

TOWNSHIP 31 NORTH, RANGE 11 WEST, NMPM

Section 25: NW/4

-7-  
CASE NO. 4667  
Order No. R-4260

(o) That the South Blanco-Pictured Cliffs Pool in Rio Arriba, Sandoval and San Juan Counties, New Mexico, as heretofore classified, defined, and described, is hereby extended to include therein:

TOWNSHIP 23 NORTH, RANGE 2 WEST, NMPM

Section 16: SW/4  
Section 17: SE/4  
Section 20: N/2  
Section 21: All  
Section 28: NW/4

TOWNSHIP 25 NORTH, RANGE 4 WEST, NMPM

Section 2: W/2  
Section 3: All  
Section 4: All

TOWNSHIP 26 NORTH, RANGE 4 WEST, NMPM

Section 35: SW/4

(p) That the BS Mesa-Gallup Pool in Rio Arriba County, New Mexico, as heretofore classified, defined, and described, is hereby extended to include therein:

TOWNSHIP 26 NORTH, RANGE 4 WEST, NMPM

Section 3: N/2  
Section 9: NE/4  
Section 10: NW/4

(q) That the Choza Mesa-Pictured Cliffs Pool in Rio Arriba County, New Mexico, as heretofore classified, defined, and described, is hereby extended to include therein:

TOWNSHIP 29 NORTH, RANGE 3 WEST, NMPM

Section 30: S/2

(r) That the Fulcher Kutz-Pictured Cliffs Pool in San Juan County, New Mexico, as heretofore classified, defined, and described, is hereby extended to include therein:

TOWNSHIP 29 NORTH, RANGE 11 WEST, NMPM

Section 6: NE/4

(s) That the Gallegos-Gallup Oil Pool in San Juan County, New Mexico, as heretofore classified, defined, and

-8-

CASE NO. 4667  
Order No. R-4260

described, is hereby extended to include therein:

TOWNSHIP 26 NORTH, RANGE 11 WEST, NMPM  
Section 24: S/2

(t) That the Hogback-Dakota Oil Pool in San Juan County, New Mexico, as heretofore classified, defined, and described, is hereby extended to include therein:

TOWNSHIP 29 NORTH, RANGE 16 WEST, NMPM  
Section 7: SW/4 SW/4  
Section 18: NW/4 NW/4

(u) That the Kutz-Fruitland Pool in San Juan County, New Mexico, as heretofore classified, defined, and described, is hereby extended to include therein:

TOWNSHIP 28 NORTH, RANGE 11 WEST, NMPM  
Section 24: NW/4  
Section 25: N/2

(v) That the Lone Pine-Dakota Oil Pool in McKinley County, New Mexico, as heretofore classified, defined, and described, is hereby extended to include therein:

TOWNSHIP 17 NORTH, RANGE 8 WEST, NMPM  
Section 7: S/2  
Section 8: E/2 NW/4, N/2 SW/4 and SE/4 SW/4  
Section 17: NE/4 NW/4  
Section 18: E/2 SE/4

TOWNSHIP 17 NORTH, RANGE 9 WEST, NMPM  
Section 12: E/2 SE/4  
Section 13: NE/4 NW/4  
Section 24: E/2 NW/4

(w) That the Lybrook-Gallup Oil Pool in Rio Arriba, Sandoval and San Juan Counties, New Mexico, as heretofore classified, defined, and described, is hereby extended to include therein:

TOWNSHIP 23 NORTH, RANGE 6 WEST, NMPM  
Section 7: SW/4 and SE/4 NW/4  
Section 18: W/2  
Section 19: All  
Section 20: SW/4  
Section 30: W/2  
Section 31: NW/4 NW/4

-9-

CASE NO. 4667

Order No. R-4260

TOWNSHIP 23 NORTH, RANGE 7 WEST, NMPM

Section 3: SW/4  
Section 4: E/2 SE/4  
Section 5: All  
Section 13: All  
Section 14: SE/4 and E/2 NE/4  
Section 22: NE/4 and NE/4 SE/4  
Section 23: N/2  
Section 24: NW/4 and NW/4 SW/4

TOWNSHIP 24 NORTH, RANGE 7 WEST, NMPM

Section 29: SW/4  
Section 32: W/2

(x) That the Otero-Chacra Pool in Rio Arriba County, New Mexico, as heretofore classified, defined, and described, is hereby extended to include therein:

TOWNSHIP 25 NORTH, RANGE 4 WEST, NMPM

Section 31: NW/4

TOWNSHIP 25 NORTH, RANGE 5 WEST, NMPM

Section 3: W/2  
Section 10: N/2  
Section 11: NW/4  
Section 35: N/2  
Section 36: N/2

TOWNSHIP 25 NORTH, RANGE 6 WEST, NMPM

Section 1: All  
Section 3: N/2

TOWNSHIP 26 NORTH, RANGE 5 WEST, NMPM

Section 34: W/2

TOWNSHIP 26 NORTH, RANGE 6 WEST, NMPM

Section 18: SW/4  
Section 19: W/2 and SE/4  
Section 20: SW/4  
Section 26: SW/4  
Section 28: All  
Section 29: W/2  
Section 30: All  
Section 31: N/2

-10-

CASE NO. 4667

Order No. R-4260

TOWNSHIP 26 NORTH, RANGE 7 WEST, NMPM

Section 12: W/2

Section 13: N/2 and SE/4

(y) That the Otero-Gallup Oil Pool in Rio Arriba County, New Mexico, as heretofore classified, defined, and described, is hereby extended to include therein:

TOWNSHIP 24 NORTH, RANGE 5 WEST, NMPM

Section 3: W/2

Section 4: All

Section 5: SE/4, S/2 NE/4 and NE/4 NE/4

Section 9: N/2 and E/2 SW/4

Section 10: NW/4, SW/4 NE/4, and NW/4 SW/4

TOWNSHIP 25 NORTH, RANGE 5 WEST, NMPM

Section 33: SE/4

(z) That the Pinion-Fruitland Pool in San Juan County, New Mexico, as heretofore classified, defined, and described, is hereby extended to include therein:

TOWNSHIP 28 NORTH, RANGE 11 WEST, NMPM

Section 19: W/2

(aa) That the Slick Rock-Dakota Oil Pool in San Juan County, New Mexico, as heretofore classified, defined, and described, is hereby extended to include therein:

TOWNSHIP 30 NORTH, RANGE 16 WEST, NMPM

Section 31: W/2 SW/4 and SW/4 NW/4

TOWNSHIP 30 NORTH, RANGE 17 WEST, NMPM

Section 36: NE/4 NE/4

(bb) That the Wild Horse-Gallup Pool in Rio Arriba County, New Mexico, as heretofore classified, defined, and described, is hereby extended to include therein:

TOWNSHIP 26 NORTH, RANGE 3 WEST, NMPM

Section 19: SW/4

TOWNSHIP 26 NORTH, RANGE 4 WEST, NMPM

Section 12: SW/4

Section 13: NW/4

Section 24: SW/4

-11-

CASE NO. 4667

Order No. R-4260

IT IS FURTHER ORDERED:

(1) That, pursuant to Section 65-3-14.5, NMSA 1953, contained in Chapter 271, Laws of 1969, any well which, by virtue of any of the above pool extensions, is subject to pool rules providing for spacing or proration units larger than the one which is presently dedicated thereto, shall have 60 days from the effective date of this order in which to file new Forms C-102 dedicating a standard unit for the pool to said well, or to obtain a non-standard unit approved by the Commission. Pending such compliance, the well shall receive a maximum allowable in the same proportion to a standard allowable for the pool that the acreage dedicated to the well bears to a standard unit for the pool. Failure to file Forms C-102 dedicating a standard unit to the well or to obtain a non-standard unit approved by the Commission within said 60-day period shall subject the well to cancellation of allowable.

(2) That the effective date of this order and all creations and extensions included herein shall be March 1, 1972.

DONE at Santa Fe, New Mexico, on the day and year hereinabove designated.

STATE OF NEW MEXICO  
OIL CONSERVATION COMMISSION

  
BRUCE KING, Chairman

  
ALEX J. ARMILLO, Member

  
A. L. PORTER, Jr., Member & Secretary

S E A L

dr/

*Create*  
*a*  
*(th)* That a new pool in San Juan County, New Mexico, classified as an oil pool for Pennsylvanian production, be and the same is hereby created and designated as the Bueno Suerte-Pennsylvanian Oil Pool, consisting of the following described area: *The Discovery*

*well is the*

Township 25 North, Range 11 West, NMPM  
Section 3: SW/4

Based on:

~~Discovery Well:~~  
Tenneco Oil Co. #1 Pah Well No. 1, located in  
L-3-25N-11W  
IP-192-80PP  
Perf-10,956-10,958'  
Completed-7-28-71

*Unit 4 of Sec 3,  
T 25 N, R 11 W, NMPM  
Said pool would  
comprise:*

*Create*  
*(b)* That a new pool in Sandoval County, New Mexico, classified as an oil pool for Dakota production, be and the same is hereby created and designated as the Five Lakes-Dakota Oil Pool, consisting of the following described area: *The Discovery*

*well is the*

Township 22 North, Range 3 West, NMPM  
Section 24: SE/4 SW/4  
Section 25: N/2  
Section 26: NE/4 NE/4

Based on:

~~Discovery Well:~~  
Refiners Petroleum Corp., # Cuba Union well No. 1, located  
A-25-22N-3W  
IP-441-80PP  
Perf-6878-7110'  
Completed-10-8-70

*in Unit A of Sec 25,  
T 22 N, R 3 W, NMPM.  
Said pool  
would comprise:*

*Created*

(A) ~~That~~ a new pool in San Juan County, New Mexico, classified as a gas pool for Fruitland production, be and the same is hereby created and designated as the South Gallegos - Fruitland Pool, consisting of the following described area: *The discovery well*

*is the*

Township 26 North, Range 12 West, NMPM  
Section 11: S/2 and NW/4  
Section 12: All

Based on:

~~Discovery well:~~  
~~Skelly Oil Co., Navajo G~~ well No 1, located in,  
~~K-12-26N-12W~~ Unit K of Section  
~~AOF 2216 MCF, STCP 350#/77 days~~ 12 7 26N R 12W  
~~Perf. 1100' - 1113'~~ NMPM.  
~~Completed 5-27-68~~ Said pool is a self  
completing

*no discovery well*

*Created*

(A) ~~That~~ a new pool in Rio Arriba County, New Mexico, classified as an oil pool for Gallup-Dakota production, be and the same is hereby created and designated as the West Lindrith - Gallup-Dakota Oil Pool, consisting of the following described area: *The discovery well*

*is the*

✓ Township 25 North, Range 4 West, NMPM  
Section 15: SE/4  
Section 21: SE/4  
Section 22: All  
Section 27: All  
Section 28: All  
Section 32: SE/4  
Section 33: All  
Section 34: All

*Created*  
(e) That a new pool in Sandoval County, New Mexico, classified as an oil pool for Mesaverde production, be and the same is hereby created and designated as the Parlay-Mesaverde Oil Pool, consisting of the following described area: *The discovery well is the*

Based on:

Township 22 North, Range 3 West, NMPM  
Section: 29: N/2

**Discovery Well:**

Tesoro Petroleum Corp., # Parlay

H-29-22N-3W

IP-336-80PD

Perf. 4340' - 4370'

Completed 10-4-71

*Well No. 1, located  
in Unit H of Section  
29, T 22 N, R 3 W NMPM  
Said pool would  
comprise:*

*Created*  
(f) That a new pool in San Juan County, New Mexico, classified as an oil pool for Gallup production, be and the same is hereby created and designated as the Rattlesnake-Gallup Oil Pool, consisting of the following described area: *The discovery well is the*

Based on:

Township 29 North, Range 19 West, NMPM  
Section 2: NE/4

**Discovery Well:**

Eastern Petroleum Co., #23 Navajo

G-2-29N-19W

IP-18-80PD

Open hole 1951' - 4201'

Completed 7-19-68

*Well No. 23, located  
in Unit G of Section  
2, T 29 N R 19 W NMPM  
Said pool would  
comprise:*

(g) <sup>create</sup> That a new pool in San Juan County, New Mexico, classified as an oil pool for Dakota production, be and the same is hereby created and designated as the Snake Eyes-Dakota Oil Pool, ~~consisting of the following described area:~~ *The discovery*

*well is the*

Township 21 North, Range 8 West, NMPM  
Section 17: SW/4, SE/4 ~~(cont'd)~~  
Section 20: N/2 & SW/4

Based on:

Discovery Well:  
~~Drilled by~~ Davis Oil Co., Snake Eyes  
Now: ~~Anderson Oil Co., #1 Snake Eyes~~  
~~G-20-21N-8W~~  
~~IP-48-80PD~~  
~~Perf. 4594' - 4634'~~  
~~Completed 7-29-71~~

*Well No. 1,  
located in  
Unit C of  
Sec 20, T21N,  
R8W, NMPM.  
5 ac pool would  
comprise:*

(h) <sup>create</sup> That a new pool in San Juan County, New Mexico, classified as a gas pool for Pennsylvanian production, be and the same is hereby created and designated as the North Tocito Dome-Pennsylvanian Pool, ~~consisting of the following described area:~~ *The discovery*

*well is the*

Township 26 North, Range 18 West, NMPM  
Section 9: E/2  
Section 10: SW/4

Based on:

~~Discovery Well:~~  
Campbell, Kiel & Rothwell, ~~#~~ Navajo Tocito  
~~G-9-26N-18W~~  
~~IP-16,095 MCF, SITP 2546 #/6 days~~  
~~Perf. 6322' - 6328'~~  
~~Completed 12-2-67~~

*Well No. 1,  
located in Unit  
C of Section 9  
T26N R18W  
NMPM.  
5 ac pool  
would comprise:*

*Created*  
(i) That a new pool in San Juan County, New Mexico, classified as a gas pool for Pictured Cliffs production, be and the same is hereby created and designated as the Waw-Pictured Cliffs Pool, consisting of the following described area: *The Discovery*

*well is the*  
Township 27 North, Range 13 West, NMPM  
Section 32: SW/4

Based on:

~~Discovery Well:~~

Dugan Production Corp, Waw well No. 1, located in

L-32-27N-13W

ADP 603 MCF, SICP 197 psig

Completed 6-20-70

Perforated : 1325'-1329'

*Unit 1 L of Sec 32  
T 27N R 13 W NMPM*

*5 acre pool would  
acquire;*

*Extend*  
(i) That the Angels Peak-Gallup Oil Pool in San Juan County, New Mexico, as heretofore classified, defined, and described, be and the same is hereby extended to include therein:

✓ Township 26 North, Range 9 West, NMPM  
Section 17: E/2

*Extend*  
(L) That the Aztec-Pictured Cliffs Pool in San Juan  
County, New Mexico, as ~~heretofore classified, defined, and described, be and~~  
~~the same is hereby extended~~ to include therein:

✓ Township 28 North, Range 9 West, NMPM  
Section 31: SW/4

*Extend*  
(L) That the Ballard-Pictured Cliffs Pool in Rio Arriba, San Juan &  
Sandoval Counties, New Mexico, as ~~heretofore classified, defined, and described, be and~~  
~~the same is hereby extended~~ to include therein:

✓ Township 22 North, Range 2 West, NMPM  
Section 6: SW/4

✓ Township 22 North, Range 3 West, NMPM  
Section 2: NE/4

✓ Township 23 North, Range 4 West, NMPM  
Section 24: SE/4

*Extend*  
(M) That the Blanco-Mesaverde Pool in Rio Arriba & San Juan  
Counties, New Mexico, as ~~heretofore classified, defined, and described, be and~~  
~~the same is hereby extended to include therein:~~

✓ Township 26 North, Range 5 West, NMPM  
Section 13: All  
Section 24: W/2

✓ Township 29 North, Range 10 West, NMPM  
Section 3: All  
Section 10: All

*Extend*  
(n) That the Blanco-Pictured Cliffs Pool in San Juan  
County, New Mexico, as ~~heretofore classified, defined, and described, be and~~  
~~the same is hereby extended to include therein:~~

✓ Township 30 North, Range 10 West, NMPM  
Section 1: W/2

Township 31 North, Range 11 West, NMPM  
Section 25: NW/4

*Sandoval* (o) *Extend* That the South Blanco-Pictured Cliffs Pool in Rio Arriba, ~~San Juan~~ <sup>and</sup>  
Sandoval County, New Mexico, as heretofore classified, defined, and described, be and  
the same is hereby extended to include therein:

Township 23 North, Range 2 West, NMPM

Section 16: SW/4

✓ Section 17: SE/4

Section 20: N/2

Section 21: All

Section 28: NW/4

*Extend* (A) That the BS Mesa-Gallup Pool in Rio Arriba  
County, New Mexico, as heretofore classified, defined, and described, be and  
the same is hereby extended to include therein:

Township 26 North, Range 4 West, NMPM

✓ Section 3: N/2

Section 9: NE/4

Section 10: NW/4

*Extend*  
(f) That the Choza Mesa-Pictured Cliffs Pool in Rio Arriba  
County, New Mexico, as ~~heretofore classified, defined, and described, be and~~  
the same is hereby extended to include therein:

✓ Township 29 North, Range 3 West, NMPM  
Section 30: S/2

*Extend*  
(R) That the Fulcher Kutz-Pictured Cliffs Pool in San Juan  
County, New Mexico, as ~~heretofore classified, defined, and described, be and~~  
the same is hereby extended to include therein:

✓ Township 29 North, Range 11 West, NMPM  
Section 6: NE/4

*Extend*  
(14) That the Gallegos-Gallup Oil Pool in San Juan  
County, New Mexico, as heretofore classified, defined, and described, be and  
the same is hereby extended to include therein:

✓ Township 26 North, Range 11 West, NMPM  
Section 24: S/2

*Extend*  
(15) That the Hogback-Dakota Oil Pool in San Juan  
County, New Mexico, as heretofore classified, defined, and described, be and  
the same is hereby extended to include therein:

✓ Township 29 North, Range 16 West, NMPM  
Section 7: SW/4 SW/4  
Section 18: NW/4 NW/4

*144* *Extend*  
That the Kutz-Fruitland Pool in San Juan  
County       , New Mexico, as heretofore classified, defined, and described, be and  
the same is hereby extended to include therein:

✓ Township 28 North, Range 11 West, NMPM  
Section 24: NW/4  
Section 25: N/2

*(v)* *Extend* "D"  
*(55)* That the Lone Pine-Dakota Oil Pool in McKinley  
County       , New Mexico, as heretofore classified, defined, and described, be and  
the same is hereby extended to include therein:

✓ Township 17 North, Range 8 West, NMPM  
Section 7: S/2  
Section 8: E/2 NW/4, N/2 SW/4 & SE/4 SW/4  
Section 17: NE/4 NW/4  
Section 18: E/2 SE/4

✓ Township 17 North, Range 9 West, NMPM  
Section 12: E/2 SE/4  
Section 13: NE/4 NW/4  
Section 24: E/2 NW/4

*(145)* *Extend*  
That the Lybrook-Gallup Oil Pool in Rio Arriba, San Juan &  
Sandoval Counties, New Mexico, as heretofore classified, defined, and described, be and  
the same is hereby extended to include therein:

Township 23 North, Range 6 West, NMPM

✓ Section 7: SW/4 & SE/4 NW/4  
Section 18: W/2  
Section 19: All  
Section 20: SW/4  
Section 30: W/2  
Section 31: NW/4 NW/4

Township 23 North, Range 7 West, NMPM

Section 3: SW/4  
Section 4: E/2 SE/4  
✓ Section 5: All  
Section 13: All  
Section 14: SE/4 & E/2 NE/4  
Section 22: NE/4 & NE/4 SE/4  
Section 23: N/2  
Section 24: NW/4 & NW/4 SW/4

Township 24 North, Range 7 West, NMPM

✓ Section 29: SW/4  
Section 32: W/2

(X) (4) That the Otero-Chacra Pool in Rio Arriba  
County y, New Mexico, as heretofore classified, defined, and described, be and  
the same is hereby extended to include therein:

✓ Township 25 North, Range 4 West, NMPM  
Section 30: NW/4

Township 25 North, Range 5 West, NMPM  
Section 3: W/2  
✓ Section 10: N/2  
Section 11: NW/4  
Section 35: N/2  
Section 36: N/2

Township 25 North, Range 6 West, NMPM  
Section 1: All  
✓ Section 3: N/2  
Section 6: NE/4

✓ Township 26 North, Range 5 West, NMPM  
Section 34: W/2

Township 26 North, Range 6 West, NMPM  
Section 18: SW/4  
Section 19: W/2 & SE/4  
✓ Section 20: SW/4  
Section 26: SW/4  
Section 28: All  
Section 29: W/2  
Section 30: All  
Section 31: N/2

continued

✓ Township 26 North, Range 7 West, NMPM  
Section 12: W/2  
Section 13: N/2 & SE/4

(Y)  
That the Otero-Gallup Oil Pool in Rio Arriba  
County       , New Mexico, as ~~heretofore classified, defined, and described, be and~~  
the same is hereby extended to include therein:

Township 24 North, Range 5 West, NMPM

Section 3: W/2

Section 4: All

✓ Section 5: SE/4, S/2 NE/4 & NE/4 NE/4

Section 9: N/2 & E/2 SW/4

Section 10: NW/4 & SW/4 NE/4

✓ Township 25 North, Range 5 West, NMPM

Section 33: SE/4

(Z)  
That the Pinon-Fruitland Pool in San Juan  
County       , New Mexico, as ~~heretofore classified, defined, and described, be and~~  
the same is hereby extended to include therein:

Township 28 North, Range 12 West, NMPM

✓ Section 13: SW/4

Section 14: SE/4

(aa)

~~(c)~~

That the Slick Rock-Dakota Oil Pool in San Juan  
County     , New Mexico, as ~~heretofore classified, defined, and described, be and~~  
~~the same is hereby extended to include therein:~~

✓ Township 30 North, Range 16 West, NMPM  
Section 31: W/2 SW/4 & SW/4 NW/4

✓ Township 30 North, Range 17 West, NMPM  
Section 36: NE/4 NE/4

(bb)

~~(c)~~

*Extend*

That the Wild Horse-Gallup Pool in Rio Arriba  
County     , New Mexico, as ~~heretofore classified, defined, and described, be and~~  
~~the same is hereby extended to include therein:~~

✓ Township 26 North, Range 3 West, NMPM  
Section 19: SW/4

✓ Township 26 North, Range 4 West, NMPM  
Section 12: SW/4  
Section 13: NW/4  
Section 24: NW/4

(Case 4666 continued)

(g) Extend the Sawyer-San Andres Gas Pool in Lea County, New Mexico, to include therein:

TOWNSHIP 9 SOUTH, RANGE 37 EAST, NMPM  
SECTION 24: NE/4 NW/4

(h) Extend the Shugart Pool in Eddy County, New Mexico, to include therein:

TOWNSHIP 18 SOUTH, RANGE 30 EAST, NMPM  
SECTION 26: E/2

(i) Extend the Sulimar-Queen Pool in Chaves County, New Mexico, to include therein:

TOWNSHIP 15 SOUTH, RANGE 29 EAST, NMPM  
SECTION 26: NW/4 SE/4 and NE/4 SW/4

(j) Extend the Tres Papalotes-Pennsylvanian Pool in Lea County, New Mexico, to include therein:

TOWNSHIP 14 SOUTH, RANGE 34 EAST, NMPM  
SECTION 31: NE/4  
SECTION 32: All

TOWNSHIP 15 SOUTH, RANGE 34 EAST, NMPM  
SECTION 5: NE/4

(k) Extend the Wantz-Granite Wash Pool in Lea County, New Mexico, to include therein:

TOWNSHIP 22 SOUTH, RANGE 37 EAST, NMPM  
SECTION 11: E/2  
SECTION 12: SW/4

CASE 4667: Northwest New Mexico nomenclature case calling for an order for the creation and extension of certain pools in San Juan, Rio Arriba, McKinley and Sandoval Counties, New Mexico,

(a) Create a new pool in San Juan County, New Mexico, classified as an oil pool for Pennsylvanian Buena production, be and the same is hereby created and designated as the Buena Suerte-Pennsylvanian Oil Pool. The discovery well

(e) Create a new pool in Sandoval County, New Mexico, classified as an oil pool for Mesaverde production, be and the same is hereby created and designated as the Parlay-Mesaverde Oil Pool. The discovery well is the Tesoro Petroleum Corporation Parlay Well No. 1, located in Unit H of Section 29, Township 22 North, Range 3 West, NMPM. Said pool would comprise:

TOWNSHIP 22 NORTH, RANGE 3 WEST, NMPM  
SECTION 29: N/2

(f) Create a new pool in San Juan County, New Mexico, classified as an oil pool for Gallup production, be and the same is hereby created and designated as the Rattlesnake-Gallup Oil Pool. The discovery well is the Navajo Well No. 23, located in Unit G of Section 2, Township 29 North, Range 19 West, NMPM. Said pool would comprise:

TOWNSHIP 29 NORTH, RANGE 19 WEST, NMPM  
SECTION 2: NE/4

*Dismissed*  
(g) Create a new pool in San Juan County, New Mexico, classified as an oil pool for Dakota production, be and the same is hereby created and designated as the Snake Eyes-Dakota Oil Pool. The discovery well is the Davis Oil Co., Snake Eyes Well No. 1, located in Unit C of Section 20, Township 21 North, Range 8 West, NMPM. Said pool would comprise:

TOWNSHIP 21 NORTH, RANGE 8 WEST, NMPM  
SECTION 17: SW/4 SE/4  
SECTION 20: N/2 and SW/4

(h) Create a new pool in San Juan County, New Mexico, classified as a gas pool for Pennsylvanian production, be and the same is hereby created and designated as the North Tocito Dome-Pennsylvanian Pool. The discovery well is the Campbell, Kiel & Rothwell Navajo Tocito Well No. 1, located in Unit G of Section 9, Township 26 North, Range 18 West, NMPM. Said pool would comprise:

TOWNSHIP 26 NORTH, RANGE 18 WEST, NMPM  
SECTION 9: E/2  
SECTION 10: SW/4

(i) Create a new pool in San Juan County, New Mexico, classified as a gas pool for Pictured Cliffs production, be and the same is hereby created and designated as the Waw-Pictured Cliffs Pool. The discovery well is the Dugan Production Corp., Waw Well No. 1, located in Unit L of Section 32, Township 27 North, Range 13 West, NMPM. Said pool would comprise:

TOWNSHIP 27 NORTH, RANGE 13 WEST, NMPM  
SECTION 32: SW/4

(j) Extend the Angels Peak-Gallup Oil Pool in San Juan County, New Mexico, to include therein:

TOWNSHIP 26 NORTH, RANGE 9 WEST, NMPM  
SECTION 17: E/2

(k) Extend the Aztec-Pictured Cliffs Pool in San Juan County, New Mexico, to include therein:

TOWNSHIP 28 NORTH, RANGE 9 WEST, NMPM  
SECTION 31: SW/4

(l) Extend the Ballard-Pictured Cliffs Pool in Rio Arriba, San Juan and Sandoval Counties, New Mexico, to include therein:

TOWNSHIP 22 NORTH, RANGE 2 WEST, NMPM  
SECTION 6: SW/4

TOWNSHIP 22 NORTH, RANGE 3 WEST, NMPM  
SECTION 2: NE/4

TOWNSHIP 23 NORTH, RANGE 4 WEST, NMPM  
SECTION 24: SE/4

(m) Extend the Blanco-Mesaverde Pool in Rio Arriba and San Juan Counties, New Mexico, to include therein:

TOWNSHIP 26 NORTH, RANGE 5 WEST, NMPM  
SECTION 13: All  
SECTION 24: W/2

TOWNSHIP 29 NORTH, RANGE 10 WEST, NMPM  
SECTION 3: All  
SECTION 10: All

(n) Extend the Blanco-Pictured Cliffs Pool in San Juan County, New Mexico, to include therein:

TOWNSHIP 30 NORTH, RANGE 10 WEST, NMPM  
SECTION 1: W/2

TOWNSHIP 31 NORTH, RANGE 11 WEST, NMPM  
SECTION 25: NW/4

(o) Extend the South Blanco-Pictured Cliffs Pool in Rio Arriba and Sandoval Counties, New Mexico, to include therein:

TOWNSHIP 23 NORTH, RANGE 2 WEST, NMPM  
SECTION 16: SW/4  
SECTION 17: SE/4  
SECTION 20: N/2  
SECTION 21: All  
SECTION 28: NW/4

(p) Extend the BS Mesa-Gallup Pool in Rio Arriba County, New Mexico, to include therein:

TOWNSHIP 26 NORTH, RANGE 4 WEST, NMPM  
SECTION 3: N/2  
SECTION 9: NE/4  
SECTION 10: NW/4

(q) Extend the Choza Mesa-Pictured Cliffs Pool in Rio Arriba County, New Mexico, to include therein:

TOWNSHIP 29 NORTH, RANGE 3 WEST, NMPM  
SECTION 30: S/2

(r) Extend the Fulcher Kutz-Pictured Cliffs Pool in San Juan County, to include therein:

TOWNSHIP 29 NORTH, RANGE 11 WEST, NMPM  
SECTION 6: NE/4

(s) Extend the Gallegos-Gallup Oil Pool in San Juan County, New Mexico, to include therein:

TOWNSHIP 26 NORTH, RANGE 11 WEST, NMPM  
SECTION 24: S/2

(t) Extend the Hogback-Dakota Oil Pool in San Juan County, New Mexico, to include therein:

TOWNSHIP 29 NORTH, RANGE 16 WEST, NMPM  
SECTION 7: SW/4 SW/4  
SECTION 18: NW/4 NW/4

(u) Extend the Kutz-Fruitland Pool in San Juan County, New Mexico, to include therein:

TOWNSHIP 28 NORTH, RANGE 11 WEST, NMPM  
SECTION 24: NW/4  
SECTION 25: N/2

(v) Extend the Lone Pine-Dakota "D" Oil Pool in McKinley County, New Mexico, to include therein:

TOWNSHIP 17 NORTH, RANGE 8 WEST, NMPM  
SECTION 7: S/2  
SECTION 8: E/2 NW/4, N/2 SW/4 & SE/4 SW/4  
SECTION 17: NE/4 NW/4  
SECTION 18: E/2 SE/4

TOWNSHIP 17 NORTH, RANGE 9 WEST, NMPM  
SECTION 12: E/2 SE/4  
SECTION 13: NE/4 NW/4  
SECTION 24: E/2 NW/4

(w) Extend the Lybrook-Gallup Oil Pool in Rio Arriba, San Juan and Sandoval Counties, New Mexico, to include therein:

TOWNSHIP 23 NORTH, RANGE 6 WEST, NMPM  
SECTION 7: SW/4 & SE/4 NW/4  
SECTION 18: W/2  
SECTION 19: All  
SECTION 20: SW/4  
SECTION 30: W/2  
SECTION 31: NW/4 NW/4

TOWNSHIP 23 NORTH, RANGE 7 WEST, NMPM  
SECTION 3: SW/4  
SECTION 4: E/2 SE/4  
SECTION 5: All  
SECTION 13: All  
SECTION 14: SE/4 & E/2 NE/4

(w) continued

TOWNSHIP 23 NORTH, RANGE 7 WEST, NMPM  
SECTION 22: NE/4 & NE/4 SE/4  
SECTION 23: N/2  
SECTION 24: NW/4 & NW/4 SW/4

TOWNSHIP 24 NORTH, RANGE 7 WEST, NMPM  
SECTION 29: SW/4  
SECTION 32: W/2

(x) Extend the Otero-Chacra Pool in Rio Arriba County, New Mexico, to include therein:

TOWNSHIP 25 NORTH, RANGE 4 WEST, NMPM  
SECTION 31: NW/4

TOWNSHIP 25 NORTH, RANGE 5 WEST, NMPM  
SECTION 3: W/2  
SECTION 10: N/2  
SECTION 11: NW/4  
SECTION 35: N/2  
SECTION 36: N/2

TOWNSHIP 25 NORTH, RANGE 6 WEST, NMPM  
SECTION 1: All  
SECTION 3: N/2  
SECTION 6: NE/4

TOWNSHIP 26 NORTH, RANGE 5 WEST, NMPM  
SECTION 34: W/2

TOWNSHIP 26 NORTH, RANGE 6 WEST, NMPM  
SECTION 18: SW/4  
SECTION 19: W/2 & SE/4  
SECTION 20: SW/4  
SECTION 26: SW/4  
SECTION 28: All  
SECTION 29: W/2  
SECTION 30: All  
SECTION 31: N/2

TOWNSHIP 26 NORTH, RANGE 7 WEST, NMPM  
SECTION 12: W/2  
SECTION 13: N/2 & SE/4

(y) Extend the Otero-Gallup Oil Pool in Rio Arriba County, New Mexico, to include therein:

TOWNSHIP 24 NORTH, RANGE 5 WEST, NMPM  
SECTION 3: W/2  
SECTION 4: All  
SECTION 5: SE/4, S/2 NE/4 & NE/4 NE/4  
SECTION 9: N/2 & E/2 SW/4  
SECTION 10: NW/4 & SW/4 NE/4

TOWNSHIP 25 NORTH, RANGE 5 WEST, NMPM  
SECTION 33: SE/4

(z) Extend the Pinon-Fruitland Pool in San Juan County, New Mexico, to include therein:

TOWNSHIP 28 NORTH, RANGE 12 WEST, NMPM  
SECTION 13: SW/4  
SECTION 14: SE/4

(aa) Extend the Slick Rock-Dakota Oil Pool in San Juan County, to include therein:

TOWNSHIP 30 NORTH, RANGE 16 WEST, NMPM  
SECTION 31: W/2 SW/4 & SW/4 NW/4

TOWNSHIP 30 NORTH, RANGE 17 WEST, NMPM  
SECTION 36: NE/4 NE/4

(bb) Extend the Wild Horse-Gallup Pool in Rio Arriba County, New Mexico, to include therein:

TOWNSHIP 26 NORTH, RANGE 3 WEST, NMPM  
SECTION 19: SW/4

TOWNSHIP 26 NORTH, RANGE 4 WEST, NMPM  
SECTION 12: SW/4  
SECTION 13: NW/4  
SECTION 24: NW/4

(Case 4666 continued)

(g) Extend the Sawyer-San Andres Gas Pool in Lea County, New Mexico, to include therein:

TOWNSHIP 9 SOUTH, RANGE 37 EAST, NMPM  
SECTION 24: NE/4 NW/4

(h) Extend the Shugart Pool in Eddy County, New Mexico, to include therein:

TOWNSHIP 18 SOUTH, RANGE 30 EAST, NMPM  
SECTION 26: E/2

(i) Extend the Sulimar-Queen Pool in Chaves County, New Mexico, to include therein:

TOWNSHIP 15 SOUTH, RANGE 29 EAST, NMPM  
SECTION 26: NW/4 SE/4 and NE/4 SW/4

(j) Extend the Tres Papalotes-Pennsylvanian Pool in Lea County, New Mexico, to include therein:

TOWNSHIP 14 SOUTH, RANGE 34 EAST, NMPM  
SECTION 31: NE/4  
SECTION 32: All

TOWNSHIP 15 SOUTH, RANGE 34 EAST, NMPM  
SECTION 5: NE/4

(k) Extend the Wantz-Granite Wash Pool in Lea County, New Mexico, to include therein:

TOWNSHIP 22 SOUTH, RANGE 37 EAST, NMPM  
SECTION 11: E/2  
SECTION 12: SW/4

CASE 4667: Northwest New Mexico nomenclature case calling for an order for the creation and extension of certain pools in San Juan, Rio Arriba, McKinley and Sandoval Counties, New Mexico,

(a) Create a new pool in San Juan County, New Mexico, classified as an oil pool for Pennsylvanian Buena production, be and the same is hereby created and designated as the Buena Suerte-Pennsylvanian Oil Pool. The discovery well

Case 4667 continued - (a)

is the Tenneco Oil Company Pah Well No. 1, located in Unit L of Section 3, Township 25 North, Range 11 West, NMPM. Said pool would comprise:

TOWNSHIP 25 NORTH, RANGE 11 WEST, NMPM  
SECTION 3: SW/4

(b) Create a new pool in Sandoval County, New Mexico, classified as an oil pool for Dakota production, be and the same is hereby created and designated as the Five Lakes-Dakota Oil Pool. The discovery well is the Refiners Petroleum Corporation Cuba Union Well No. 1, located in Unit A of Section 25, Township 22 North, Range 3 West, NMPM. Said pool would comprise:

TOWNSHIP 22 NORTH, RANGE 3 WEST, NMPM  
SECTION 24: SE/4 SW/4  
SECTION 25: N/2  
SECTION 26: NE/4 NE/4

(c) Create a new pool in San Juan County, New Mexico, classified as a gas pool for Fruitland production, be and the same is hereby created and designated as the South Gallegos-Fruitland Pool. The discovery well is the Skelly Oil Company Navajo G Well No. 1, located in Unit K of Section 12, Township 26 North, Range 12 West, NMPM. Said pool would comprise:

TOWNSHIP 26 NORTH, RANGE 12 WEST, NMPM  
SECTION 11: S/2 and NW/4  
SECTION 12: All

(d) Create a new pool in Rio Arriba County, New Mexico, classified as an oil pool for Gallup-Dakota production, be and the same is hereby created and designated as the West Lindrith Gallup-Dakota Oil Pool. Said pool would comprise:

TOWNSHIP 25 NORTH, RANGE 4 WEST, NMPM  
SECTION 15: SE/4  
SECTION 21: SE/4  
SECTION 22: All  
SECTION 27: All  
SECTION 28: All  
SECTION 32: SE/4  
SECTION 33: All  
SECTION 34: All

(e) Create a new pool in Sandoval County, New Mexico, classified as an oil pool for Mesaverde production, be and the same is hereby created and designated as the Parlay-Mesaverde Oil Pool. The discovery well is the Tesoro Petroleum Corporation Parlay Well No. 1, located in Unit H of Section 29, Township 22 North, Range 3 West, NMPM. Said pool would comprise:

TOWNSHIP 22 NORTH, RANGE 3 WEST, NMPM  
SECTION 29: N/2

(f) Create a new pool in San Juan County, New Mexico, classified as an oil pool for Gallup production, be and the same is hereby created and designated as the Rattlesnake-Gallup Oil Pool. The discovery well is the Navajo Well No. 23, located in Unit G of Section 2, Township 29 North, Range 19 West, NMPM. Said pool would comprise:

TOWNSHIP 29 NORTH, RANGE 19 WEST, NMPM  
SECTION 2: NE/4

(g) Create a new pool in San Juan County, New Mexico, classified as an oil pool for Dakota production, be and the same is hereby created and designated as the Snake Eyes-Dakota Oil Pool. The discovery well is the Davis Oil Co., Snake Eyes Well No. 1, located in Unit C of Section 20, Township 21 North, Range 8 West, NMPM. Said pool would comprise:

TOWNSHIP 21 NORTH, RANGE 8 WEST, NMPM  
SECTION 17: SW/4 SE/4  
SECTION 20: N/2 and SW/4

(h) Create a new pool in San Juan County, New Mexico, classified as a gas pool for Pennsylvanian production, be and the same is hereby created and designated as the North Tocito Dome-Pennsylvanian Pool. The discovery well is the Campbell, Kiel & Rothwell Navajo Tocito Well No. 1, located in Unit G of Section 9, Township 26 North, Range 18 West, NMPM. Said pool would comprise:

TOWNSHIP 26 NORTH, RANGE 18 WEST, NMPM  
SECTION 9: E/2  
SECTION 10: SW/4

(i) Create a new pool in San Juan County, New Mexico, classified as a gas pool for Pictured Cliffs production, be and the same is hereby created and designated as the Waw-Pictured Cliffs Pool. The discovery well is the Dugan Production Corp., Waw Well No. 1, located in Unit L of Section 32, Township 27 North, Range 13 West, NMPM. Said pool would comprise:

TOWNSHIP 27 NORTH, RANGE 13 WEST, NMPM  
SECTION 32: SW/4

(j) Extend the Angels Peak-Gallup Oil Pool in San Juan County, New Mexico, to include therein:

TOWNSHIP 26 NORTH, RANGE 9 WEST, NMPM  
SECTION 17: E/2

(k) Extend the Aztec-Pictured Cliffs Pool in San Juan County, New Mexico, to include therein:

TOWNSHIP 28 NORTH, RANGE 9 WEST, NMPM  
SECTION 31: SW/4

(l) Extend the Ballard-Pictured Cliffs Pool in Rio Arriba, San Juan and Sandoval Counties, New Mexico, to include therein:

TOWNSHIP 22 NORTH, RANGE 2 WEST, NMPM  
SECTION 6: SW/4

TOWNSHIP 22 NORTH, RANGE 3 WEST, NMPM  
SECTION 2: NE/4

TOWNSHIP 23 NORTH, RANGE 4 WEST, NMPM  
SECTION 24: SE/4

(m) Extend the Blanco-Mesaverde Pool in Rio Arriba and San Juan Counties, New Mexico, to include therein:

TOWNSHIP 26 NORTH, RANGE 5 WEST, NMPM  
SECTION 13: All  
SECTION 24: W/2

TOWNSHIP 29 NORTH, RANGE 10 WEST, NMPM  
SECTION 3: All  
SECTION 10: All

(n) Extend the Blanco-Pictured Cliffs Pool in San Juan County, New Mexico, to include therein:

TOWNSHIP 30 NORTH, RANGE 10 WEST, NMPM  
SECTION 1: W/2

TOWNSHIP 31 NORTH, RANGE 11 WEST, NMPM  
SECTION 25: NW/4

(o) Extend the South Blanco-Pictured Cliffs Pool in Rio Arriba and Sandoval Counties, New Mexico, to include therein:

TOWNSHIP 23 NORTH, RANGE 2 WEST, NMPM  
SECTION 16: SW/4  
SECTION 17: SE/4  
SECTION 20: N/2  
SECTION 21: All  
SECTION 28: NW/4

(p) Extend the BS Mesa-Gallup Pool in Rio Arriba County, New Mexico, to include therein:

TOWNSHIP 26 NORTH, RANGE 4 WEST, NMPM  
SECTION 3: N/2  
SECTION 9: NE/4  
SECTION 10: NW/4

(q) Extend the Choza Mesa-Pictured Cliffs Pool in Rio Arriba County, New Mexico, to include therein:

TOWNSHIP 29 NORTH, RANGE 3 WEST, NMPM  
SECTION 30: S/2

(r) Extend the Fulcher Kutz-Pictured Cliffs Pool in San Juan County, to include therein:

TOWNSHIP 29 NORTH, RANGE 11 WEST, NMPM  
SECTION 6: NE/4

(s) Extend the Gallegos-Gallup Oil Pool in San Juan County, New Mexico, to include therein:

TOWNSHIP 26 NORTH, RANGE 11 WEST, NMPM  
SECTION 24: S/2

(t) Extend the Hogback-Dakota Oil Pool in San Juan County, New Mexico, to include therein:

TOWNSHIP 29 NORTH, RANGE 16 WEST, NMPM

SECTION 7: SW/4 SW/4

SECTION 18: NW/4 NW/4

(u) Extend the Kutz-Fruitland Pool in San Juan County, New Mexico, to include therein:

TOWNSHIP 28 NORTH, RANGE 11 WEST, NMPM

SECTION 24: NW/4

SECTION 25: N/2

(v) Extend the Lone Pine-Dakota "D" Oil Pool in McKinley County, New Mexico, to include therein:

TOWNSHIP 17 NORTH, RANGE 8 WEST, NMPM

SECTION 7: S/2

SECTION 8: E/2 NW/4, N/2 SW/4 & SE/4 SW/4

SECTION 17: NE/4 NW/4

SECTION 18: E/2 SE/4

TOWNSHIP 17 NORTH, RANGE 9 WEST, NMPM

SECTION 12: E/2 SE/4

SECTION 13: NE/4 NW/4

SECTION 24: E/2 NW/4

(w) Extend the Lybrook-Gallup Oil Pool in Rio Arriba, San Juan and Sandoval Counties, New Mexico, to include therein:

TOWNSHIP 23 NORTH, RANGE 6 WEST, NMPM

SECTION 7: SW/4 & SE/4 NW/4

SECTION 18: W/2

SECTION 19: All

SECTION 20: SW/4

SECTION 30: W/2

SECTION 31: NW/4 NW/4

TOWNSHIP 23 NORTH, RANGE 7 WEST, NMPM

SECTION 3: SW/4

SECTION 4: E/2 SE/4

SECTION 5: All

SECTION 13: All

SECTION 14: SE/4 & E/2 NE/4

(w) continued

TOWNSHIP 23 NORTH, RANGE 7 WEST, NMPM  
SECTION 22: NE/4 & NE/4 SE/4  
SECTION 23: N/2  
SECTION 24: NW/4 & NW/4 SW/4

TOWNSHIP 24 NORTH, RANGE 7 WEST, NMPM  
SECTION 29: SW/4  
SECTION 32: W/2

(x) Extend the Otero-Chacra Pool in Rio Arriba County, New Mexico, to include therein:

TOWNSHIP 25 NORTH, RANGE 4 WEST, NMPM  
SECTION 31: NW/4

TOWNSHIP 25 NORTH, RANGE 5 WEST, NMPM  
SECTION 3: W/2  
SECTION 10: N/2  
SECTION 11: NW/4  
SECTION 35: N/2  
SECTION 36: N/2

TOWNSHIP 25 NORTH, RANGE 6 WEST, NMPM  
SECTION 1: All  
SECTION 3: N/2  
SECTION 6: NE/4

TOWNSHIP 26 NORTH, RANGE 5 WEST, NMPM  
SECTION 34: W/2

TOWNSHIP 26 NORTH, RANGE 6 WEST, NMPM  
SECTION 18: SW/4  
SECTION 19: W/2 & SE/4  
SECTION 20: SW/4  
SECTION 26: SW/4  
SECTION 28: All  
SECTION 29: W/2  
SECTION 30: All  
SECTION 31: N/2

TOWNSHIP 26 NORTH, RANGE 7 WEST, NMPM  
SECTION 12: W/2  
SECTION 13: N/2 & SE/4

(y) Extend the Otero-Gallup Oil Pool in Rio Arriba County, New Mexico, to include therein:

TOWNSHIP 24 NORTH, RANGE 5 WEST, NMPM

SECTION 3: W/2

SECTION 4: All

SECTION 5: SE/4, S/2 NE/4 & NE/4 NE/4

SECTION 9: N/2 & E/2 SW/4

SECTION 10: NW/4 & SW/4 NE/4

TOWNSHIP 25 NORTH, RANGE 5 WEST, NMPM

SECTION 33: SE/4

(z) Extend the Pinon-Fruitland Pool in San Juan County, New Mexico, to include therein:

TOWNSHIP 28 NORTH, RANGE 12 WEST, NMPM

SECTION 13: SW/4

SECTION 14: SE/4

(aa) Extend the Slick Rock-Dakota Oil Pool in San Juan County, to include therein:

TOWNSHIP 30 NORTH, RANGE 16 WEST, NMPM

SECTION 31: W/2 SW/4 & SW/4 NW/4

TOWNSHIP 30 NORTH, RANGE 17 WEST, NMPM

SECTION 36: NE/4 NE/4

(bb) Extend the Wild Horse-Gallup Pool in Rio Arriba County, New Mexico, to include therein:

TOWNSHIP 26 NORTH, RANGE 3 WEST, NMPM

SECTION 19: SW/4

TOWNSHIP 26 NORTH, RANGE 4 WEST, NMPM

SECTION 12: SW/4

SECTION 13: NW/4

SECTION 24: NW/4

dearnley-meier reporting service

SPECIALIZING IN: DEPOSITIONS, HEARINGS, STATEMENTS, EXPERT TESTIMONY, DAILY COPY, CONVENTIONS  
 208 SIMMS BLDG. • P.O. BOX 1092 • PHONE 243-6691 • ALBUQUERQUE, NEW MEXICO 87103  
 FIRST NATIONAL BANK BLDG. EAST • ALBUQUERQUE, NEW MEXICO 87108

BEFORE THE  
 NEW MEXICO OIL CONSERVATION COMMISSION  
 MORGAN HALL, STATE LAND OFFICE BUILDING  
 SANTA FE, NEW MEXICO  
 February 16, 1972

EXAMINER HEARING

IN THE MATTER OF:

Northwest New Mexico nomenclature  
 case calling for an order for the  
 creation and extension of certain  
 pools in San Juan, Rio Arriba,  
 McKinley and Sandoval Counties,  
 New Mexico.

CASE NO. 4667

BEFORE: Elvis A. Utz  
 Examiner

TRANSCRIPT OF HEARING

dearnley-meier reporting service, inc.

SPECIALIZING IN: DEPOSITIONS, HEARINGS, STATEMENTS, EXPERT TESTIMONY, DAILY COPY, CONVENTIONS  
 209 SIMMS BLDG., P.O. BOX 1092, PHOENIX 243-6891, ALBUQUERQUE, NEW MEXICO 87103  
 FIRST NATIONAL BANK BLDG. EAST, ALBUQUERQUE, NEW MEXICO 87108

1 MR. UTZ: Case 4667.

2 MR. HATCH: Northwest New Mexico nomenclature  
 3 case calling for an order for the creation and extension of  
 4 certain pools in San Juan, Rio Arriba, McKinley and Sandoval  
 5 Counties, New Mexico.

6 A. R. KENDRICK,

7 was called as a witness and, having been already duly  
 8 sworn, testified as follows:

9 DIRECT EXAMINATION

10 BY MR. HATCH:

11 Q Will you identify yourself for the record, please?

12 A A. R. Kendrick, Engineer with the New Mexico Oil  
 13 Conservation Commission in District III.

14 MR. HATCH: I think the record will show that  
 15 Mr. Kendrick has already been sworn.

16 MR. UTZ: Let the record show that this is the  
 17 same Mr. Kendrick that testified in the previous Case.

18 Q (By Mr. Hatch) Are you prepared to make recommendations  
 19 to the Examiner creating extensions to certain pools  
 20 in San Juan, Rio Arriba, McKinley and Sandoval Counties,  
 21 New Mexico?

22 A Yes, sir.

23 Q Are your recommendations prepared in the form of an  
 24 Exhibit?

25 A Yes, I have one Exhibit which includes all the

dearnley-meier reporting services

SPECIALIZING IN: DEPOSITIONS, HEARINGS, STATEMENTS, EXPERT TESTIMONY, DAILY COPY, CONVENTIONS  
209 SIMMS BLDG. • P.O. BOX 1092 • PHONE 243-6691 • ALBUQUERQUE, NEW MEXICO 87103  
FIRST NATIONAL BANK BLDG. EAST • ALBUQUERQUE, NEW MEXICO 87108

1 paragraphs advertised, and I have some other information  
2 that might be submitted, but not in the form of an  
3 Exhibit.

4 Q Is the Docket that has been distributed that includes  
5 paragraphs (a) through (bb) the same as your Exhibit?

6 A My Exhibit is in the same order relating to the new  
7 field and the acreage involved and the expansion and  
8 is in the same order as the paragraphs shown in the  
9 Docket.

10 Q And do I understand correctly that you do not want  
11 to discuss paragraph (d) of that, at the present  
12 time, but you would like to go ahead with paragraphs  
13 (a) through (bb) and leave paragraph (d) and come back  
14 to it?

15 A Yes.

16 Q Would you refer to your Exhibit 1 and paragraphs (a)  
17 through (bb) and point out to the Commissioner any  
18 differences between -- or differences that need to  
19 be added or taken away?

20 MR. UTZ: Is this as compared to the Docket  
21 that has been distributed?

22 MR. HATCH: Yes.

23 A I would like to dismiss for further study paragraph (g)  
24 which deals with the Snake Eyes-Dakota Oil Pool in  
25 Township 21 North, Range 8 West.

dearnley-meier reporting

SPECIALIZING IN: DEPOSITIONS, HEARINGS, STATEMENTS, EXPERT TESTIMONY, DAILY COPY, CONVENTIONS  
 209 SIMMS BLDG., P.O. BOX 1092, PHONE 243-6681, ALBUQUERQUE, NEW MEXICO 87103  
 FIRST NATIONAL BANK BLDG. EAST, ALBUQUERQUE, NEW MEXICO 87108

1 Q Is that paragraph (g) as in George. The wells in  
 2 the pool are currently undergoing production tests  
 3 to determine whether this is a gas pool or an oil  
 4 pool.

5 In paragraph (j) the Angels Peak-Gallup Oil Pool,  
 6 I would like to add Township 26 North, Range 9 West,  
 7 Section 15, in the northwest quarter and Section 16.

8 In paragraph (k), relating to the Aztec-Pictured  
 9 Cliffs Pool, I would like the following added: Township  
 10 31 North, Range 12 West, Section 27, the north half,  
 11 and Section 28, the north half and the southeast  
 12 quarter.

13 Q Excuse me, did you say Section 12?

14 A No, sir, Range 12 West, Sections 27 and 28.

15 Q Go ahead.

16 A In paragraph (o) the South Blanco-Pictured Cliffs  
 17 Pool, I would like to add: Township 25 North, Range  
 18 4 West, Section 2, the west half, Section 3, all, and  
 19 Section 4, all. Also Township 26 North, Range 4 West,  
 20 Section 35, the southwest quarter.

21 Paragraph (x) relates to the Otero-Chacra Pool.  
 22 Delete: Township 25 North, Range 6 West, Section 6,  
 23 the northeast quarter.

24 In Paragraph (y), relating to the Otero-Gallup  
 25 Oil Pool, I would like to add Township 24 North, Range 5

dearnley-meier reporting

SPECIALIZING IN: DEPOSITIONS, HEARINGS, STATEMENTS, EXPERT TESTIMONY, DAILY COPY, CONVENTIONS  
 209 SIMMS BLDG. • P.O. BOX 1092 • PHONE 243-6691 • ALBUQUERQUE, NEW MEXICO 87103  
 FIRST NATIONAL BANK BLDG. EAST • ALBUQUERQUE, NEW MEXICO 87108

1 West, Section 10, the northwest quarter and the  
 2 southwest quarter.

3 In paragraph (z), relating to the Pinon-Fruitland  
 4 Pool, I would like to delete Township 28 North, Range  
 5 12 West, Section 13, the southwest quarter and Section  
 6 14, the southeast quarter and replace that with  
 7 Township 28 North, Range 11 West, Section 19 of the  
 8 west half.

9 Q Mr. Kendrick, your Exhibit 1 contains additions to  
 10 the Docket concerning the well upon which you based  
 11 your extensions and deletions; doesn't it?

12 A Yes, the name of the operator or the name and number  
 13 of the well, and location, and its initial potential so  
 14 far as it was known for each well completed within the  
 15 acreage is listed in Exhibit 1.

16 Q Do you have anything further except for paragraph (d)  
 17 that you would like to present at this time?

18 A No, sir.

19 Q Would you turn to paragraph (d) -- you have some  
 20 other Exhibits to present concerning paragraph (d);  
 21 do you not?

22 A I have some other information that might be presented  
 23 in the form of Exhibits or not, it is information that  
 24 would clarify any discussion on paragraph (d).

25 Q Would you go through each of those Exhibits for the

dearnley-meier reporting

SPECIALIZING IN: DEPOSITIONS, HEARINGS, STATEMENTS, EXPERT TESTIMONY, DAILY COPY, CONVENTIONS  
209 SIMMS BLDG. • P.O. BOX 1092 • PHONE 243-6691 • ALBUQUERQUE, NEW MEXICO 87103  
FIRST NATIONAL BANK BLDG. EAST • ALBUQUERQUE, NEW MEXICO 87108

1 Examiner, pointing out what they contain and the  
2 purpose of the Exhibits, please?

3 A The first of these would be a history of the well  
4 operating in the area which I may have overlooked.

5 Q This would be marked Exhibit 2?

6 A Yes, this would be Exhibit 2 in this Case. It merely  
7 relates to some of the operations in the area wherein  
8 the original wells were completed.

9 These two zones were dual completions in  
10 December of 1964, by Order R-D-28-24. The Applicant,  
11 Continental Oil Company, received approval for downhole  
12 commingling in unit J of Section 28, subject to a  
13 Rehearing in June of 1965.

14 The Rehearing was actually held in August of  
15 1965 -- excuse me, the Order was signed in August  
16 wherein Order R-224 was to remain in effect provided  
17 annual tests be taken to determine the zones allowable  
18 information and productivity of the Gallup-Dakota  
19 zone.

20 On October 13th, Order R-2978 provided for the  
21 Continental Oil Company administrative approval procedure  
22 for downhole commingling in the Gallup-Dakota Pool  
23 in Rio Arriba County.

24 The Application required that the Commission  
25 be provided with semi-annual tests until annual tests

dearnley-meier reporting

SPECIALIZING IN: DEPOSITIONS, HEARINGS, STATEMENTS, EXPERT TESTIMONY, DAILY COPY, CONVENTIONS  
 209 SIMMS BLDG., P.O. BOX 1092, PIONE 243-0591, ALBUQUERQUE, NEW MEXICO 87103  
 FIRST NATIONAL BANK BLDG. EAS ALBUQUERQUE, NEW MEXICO 87108

1 were approved on October 3, 1968, in a letter from  
 2 the Secretary-Director of the Commission to the  
 3 Continental Oil Company, and it approved Continental's  
 4 request to replace the dual flow downhole commingling  
 5 required by Order 2978.

6 Administrative Orders were issued on September 6,  
 7 1970, September 20, 1970, and on September 28, 1970,  
 8 for the wells in the area identified with their legal  
 9 description as contained in paragraph (d) of this Case.

10 On December 1, 1970, Order R-4071 approved  
 11 Continental's Application for downhole commingling  
 12 for four undrilled wells in this area with the  
 13 allowable assignment based on the average production  
 14 factors from the then completed downhole wells or the  
 15 history of the production of the wells in the area.

16 These factors were set out at fifty-three percent  
 17 of the oil and thirty-nine percent of the gas in the  
 18 Gallup zone and forty-seven percent of the oil and  
 19 sixteen percent of the gas in the Dakota zone.

20 On October 8, 1971, Order R-4302 approved  
 21 Continental's Application for downhole commingling  
 22 for two additional wells to be drilled after the  
 23 Hearing and it set out the same allocation factors  
 24 as were assigned in Order R-4071. This Order also  
 25 set out administrative approval of undrilled wells to

dearnley-meier reporting services

SPECIALIZING IN: DEPOSITIONS, HEARINGS, STATEMENTS, EXPERT TESTIMONY, DAILY COPY, CONVENTIONS  
209 SIMMS BLDG., P.O. BOX 1092, PHONE 243-6891, ALBUQUERQUE, NEW MEXICO 87103  
FIRST NATIONAL BANK BLDG., EAST ALBUQUERQUE, NEW MEXICO 87108

1 be completed in like manner and the same allocation  
2 factors.

3 On December 30, 1971, a downhole commingling  
4 Order, DHC-102 was issued approving downhole commingling  
5 for five new wells, yet to be drilled at that time.

6 On January 27, 1972, Order 4245 approved the  
7 Application of Manning Oil and Gas Company for downhole  
8 commingling on the Apache 100 Well, located in  
9 Section 3 which offset one of the wells included in  
10 this Case today.

11 The allowable factors were the same as in Order  
12 R-4302.

13 Q Would you say that most of the wells in the area  
14 described by paragraph (d) are being commingled at  
15 the well bore?

16 A All of the wells completed in either the Gallup or  
17 Dakota zone in the area, are downhole commingled except  
18 two.

19 Q Do you have anything further you want to add in  
20 addition to Exhibit 2?

21 A No.

22 Exhibit 3 is the area plat of this acreage and,  
23 as the numbers show, these are forty acre tracts and  
24 the Order Number for each is shown. Those colored  
25 in solid green were issued prior to the time gas was

dearnley-meier reporting

SPECIALIZING IN: DEPOSITIONS, HEARINGS, STATEMENTS, EXPERT TESTIMONY, DAILY COPY, CONVENTIONS  
 209 SIMMS BLDG. • P.O. BOX 1092 • PHONE 243-6091 • ALBUQUERQUE, NEW MEXICO 87103  
 FIRST NATIONAL BANK BLDG. EAST • ALBUQUERQUE, NEW MEXICO 87108

1 considered in the allocation formula.

2 Those colored in light blue are wells approved  
 3 by Order R-4071. Those in dark blue were approved  
 4 by Order R-4302.

5 The two wells colored in orange are completed  
 6 with parallel casing string and are not yet downhole  
 7 commingled.

8 One well in the northeast quarter of the northeast  
 9 quarter of Section 22 is colored in solid green and  
 10 this is one of the wells approved by Administrative  
 11 Order DHC-102 and has the same allowable factor as  
 12 those wells colored in blue.

13 Q Mr. Kendrick, the different colors on here represent  
 14 different Orders, either Administrative or otherwise,  
 15 and they also really represent different allocation  
 16 factors as far as oil and gas to the zones are  
 17 concerned?

18 A Yes.

19 Q And they are scattered throughout the entire area?

20 A Yes, principally along the northwest edge of the  
 21 outlined area and the southeast corner of the outlined  
 22 area.

23 Q Have you determined how it was allocated, on what  
 24 basis?

25 A As to those Administrative Orders?

dearnley-meier

SPECIALIZING IN: DEPOSITIONS, HEARINGS, STATEMENTS, EXPERT TESTIMONY, DAILY COPY, CONVENTIONS  
 209 SIMMS BLDG., P.O. BOX 1042, PHONE 243-6691, ALBUQUERQUE, NEW MEXICO 87103  
 FIRST NATIONAL BANK BLDG., EAST ALBUQUERQUE, NEW MEXICO 87106

1 Q Yes.

2 A Yes, they were allocated on the basis of a decline  
 3 curve submitted by the Applicant at the time they  
 4 applied for downhole commingling.

5 The decline curve along with a productivity  
 6 summary was submitted as part of the Application.

7 Q The colors on here are representative of the  
 8 allocation factors and they are scattered over the  
 9 area?

10 A Those colored in blue, however, in between some of  
 11 those are some of these with various allocation  
 12 factors, but all those colored in blue are wells  
 13 covered by Administrative Order DHC-102 and have the  
 14 same allocation formula.

15 Q Do you have anything further to add to your testimony  
 16 concerning Exhibit 3?

17 A I think it might be kept in mind as to where these  
 18 locations are colored in solid green, when we are  
 19 referring to Exhibit 4.

20 Q Would you turn to Exhibit 4 and explain it?

21 A Exhibit 4 is a list of the Administrative Downhole  
 22 Commingling Orders showing the Order Number and the  
 23 date it was issued and the name and number of the  
 24 well, the allocation of the well, and it shows the  
 25 percentage assignment to the upper zone and lower

dearnley-meier reporting services

SPECIALIZING IN: DEPOSITIONS, HEARINGS, STATEMENTS, EXPERT TESTIMONY, DAILY COPY, CONVENTIONS  
 209 SIMMS BLDG., P.O. BOX 1002 • PHONE 243-6891 • ALBUQUERQUE, NEW MEXICO 87103  
 FIRST NATIONAL BANK BLDG. EAST • ALBUQUERQUE, NEW MEXICO 87106

1 zone and it shows from Exhibit 7 of the Applicant's  
 2 Application Form, the test data showing the amount of  
 3 oil and the amount of oil produced during that month  
 4 from each of the zones.

5 I have calculated these amounts of oil in  
 6 percentages and this shows that although the depletion  
 7 curve summary may be right in the long term, that these  
 8 assignments of percentages, do not necessarily fit  
 9 the current production percentages.

10 For example, if you will refer to DHC-60, the  
 11 upper zone was sixty percent while, in testing during  
 12 July of 1970, that well produced slightly over fourteen  
 13 percent.

14 Q Excuse me, fourteen percent would have been the  
 15 production before it was commingled?

16 A This is true.

17 Q Continue.

18 A One other case is DHC-66, and the allocation for  
 19 production was fifty-five percent for the upper  
 20 zone while the actual upper zone allowable produced  
 21 was less than forty-five percent.

22 So our current allocations do not fit our current  
 23 production percentages.

24 Q Will you identify Exhibit 5 for the Commissioner?

25 A Exhibit 5 is a production summary for all these

dearnley-meier reporting

SPECIALIZING IN: DEPOSITIONS, HEARINGS, STATEMENTS, EXPERT TESTIMONY, DAILY COPY, CONVENTIONS  
 209 SIMMS BLDG., P.O. BOX 1082 • PHONE 243-6691 • ALBUQUERQUE, NEW MEXICO 87103  
 FIRST NATIONAL BANK BLDG. EAST • ALBUQUERQUE, NEW MEXICO 87108

1 wells inside the outlined area or legal description  
 2 of the proposed pool.

3 The first column on the left is the lease  
 4 number; the second column is the well number; and  
 5 immediately following, is the unit letter and section  
 6 number. Then to the right of that wide space is the  
 7 downhole commingling approval order number as referred  
 8 to on the prior Exhibits.

9 Column one is the tabulation and shows the  
 10 cumulative volume produced by each zone for each well  
 11 through December 31, 1970.

12 The top line of each well relates to the shallow  
 13 zone of the Gallup formation. The second line for  
 14 each well relates to the Dakota formation. In  
 15 column two of the tabulation you will find the  
 16 percentage of production by each zone.

17 On the left-hand side is the percentage of  
 18 production through 1970, the percentage of what is  
 19 shown in column one and the percentage of production  
 20 on the right-hand side of the column shows the  
 21 percentage during 1971.

22 Q Mr. Kendrick, may I interrupt you a minute? If you  
 23 would take J-22 and then go through what the numbers  
 24 relate to, whether it is either the Gallup or the  
 25 Dakota zone, and give the actual numbers, I think then

dearney-meier reporting

SPECIALIZING IN: DEPOSITIONS, HEARINGS, STATEMENTS, EXPERT TESTIMONY, DAILY COPY, CONVENTIONS  
 200 SIMMS BLDG., P.O. BOX 1092, PHONE 243-8891, ALBUQUERQUE, NEW MEXICO 87103  
 FIRST NATIONAL BANK BLDG., EAST ALBUQUERQUE, NEW MEXICO 87106

1 that the Commissioner will know what these numbers  
 2 are for.

3 A All right. Twenty-two is the lease number; one is  
 4 the well number, and J-22 is the first well on the  
 5 page. It had a cumulative production through December  
 6 31, 1970 in the Gallup zone of 26,030, or seventy-six  
 7 percent of the production of the well.

8 The Dakota zone produced 8,447 barrels or  
 9 twenty-four percent of production from that well during  
 10 1971.

11 After downhill commingling, the Gallup zone was  
 12 to have produced 1,500 barrels, or fifty-eight  
 13 percent and the Dakota zone was to have produced 1,066  
 14 barrels or forty-two percent.

15 Q May I interrupt you for just one minute? This well  
 16 is not commingled; is it?

17 A No, excuse me, this well was not commingled.

18 Q All right, now, would you take any other particular  
 19 well you want to point out on this Exhibit and go  
 20 through it?

21 A On Tabulation line twenty-five, the lease number is  
 22 twenty-eight, the well number is seven. The history  
 23 of that well shows that the Gallup zone produced  
 24 thirty-six percent of its oil through 1970, by the  
 25 allocation formula in Order DHC-60. During 1971

dearnley-meier reporting

SPECIALIZING IN: DEPOSITIONS, HEARINGS, STATEMENTS, EXPERT TESTIMONY, DAILY COPY, CONVENTIONS  
 200 SIMMS BLDG., P.O. BOX 1092, PHONE 243-6591 • ALBUQUERQUE, NEW MEXICO 87109  
 FIRST NATIONAL BANK BLDG., EAST • ALBUQUERQUE, NEW MEXICO 87108

1 sixty percent of production was attributed to the  
 2 Gallup zone.

3 On line twenty-one, lease number 28 and well  
 4 number 5, during 1970, production was reported at  
 5 forty-two percent in the Gallup, but during 1971,  
 6 there was sixty percent attributed to the Gallup and  
 7 that was through downhill commingling Order DHC-58.

8 I think this Exhibit shows that our record  
 9 keeping is not exactly accurate for the production  
 10 rates at the present time.

11 I think the operator would be better off  
 12 administratively if we combined this into one pool  
 13 known as the West Lindrith Gallup-Dakota Oil Pool,  
 14 with certain vertical limits to be from the base  
 15 of the Dakota production interval upwards through the  
 16 Gallup formation and we declared this one common source  
 17 of supply.

18 Q If I understand your testimony, you are testifying  
 19 that practically all of the wells now in the area  
 20 are commingled in those two zones and that under various  
 21 Commission Orders certain production has been  
 22 attributed to various zones, but it isn't accurately  
 23 reflected as to where the production is coming from?

24 A True. Some of the allocations are based on history  
 25 and some are based on the projections of the decline curve.

dearley-meier reporting

SPECIALIZING IN: DEPOSITIONS, HEARINGS, STATEMENTS, EXPERT TESTIMONY, DAILY COPY, CONVENTIONS  
 209 SIMMS BLDG., P.O. BOX 1092, PHONE 243-6691 • ALBUQUERQUE, NEW MEXICO 87103  
 FIRST NATIONAL BANK BLDG. EAST • ALBUQUERQUE, NEW MEXICO 87106

1 So these two adjacent wells may have considerable  
 2 variation in allowable assignments in both the upper  
 3 and lower zones.

4 Q I don't think you have testified as to what you  
 5 expect in the future. Do you expect for wells that  
 6 are drilled in the future, for the operator to ask  
 7 for commingling in the wells for these two zones, or  
 8 do you expect the operator to come in with single  
 9 completions?

10 A In looking at the productivity of this area, it  
 11 would not be economical to complete a single Gallup  
 12 or a single Dakota well, so they will be asking for  
 13 downhole commingling in each instance in this immediate  
 14 area, in my opinion.

15 Q And for those reasons, you are asking approval for  
 16 one pool containing those two formations?

17 A Yes, sir.

18 Q Were Exhibits 1 through 5 prepared by you?

19 A Yes, sir.

20 MR. HATCH: I would like to move the introduction  
 21 of Exhibits 1 through 5.

22 MR. UTZ: Without objection, they will be entered  
 23 into the record of this case.

24 (Whereupon Exhibits 1 through 5 were admitted  
 25 in evidence.)

dearnley-meier reporting

SPECIALIZING IN: DEPOSITIONS, HEARINGS, STATEMENTS, EXPERT TESTIMONY, DAILY COPY, CONVENTIONS  
 209 SIMMS BLDG., P.O. BOX 1092, PHONE 243-6691, ALBUQUERQUE, NEW MEXICO 87103  
 FIRST NATIONAL BANK BLDG. EAST, ALBUQUERQUE, NEW MEXICO 87108

1 MR. UTZ: And you are recommending cumulative  
 2 production for both zones?

3 THE WITNESS: Yes, lump all production in one  
 4 and declare it all one pool.

5 MR. UTZ: Is there any great difference in  
 6 pressure in these two zones?

7 THE WITNESS: No. If you will refer to line  
 8 fifteen on Exhibit 4, lease number twenty-eight, well  
 9 number 2 --

10 MR. UTZ: I think that is Exhibit Number 5.

11 THE WITNESS: Exhibit 5. If you will look at  
 12 line fifteen, this well is not commingled and no Gallup  
 13 production has been recorded since March of 1966.

14 Possibly the Dakota would help the Gallup produce  
 15 and salvage what oil is there.

16 MR. UTZ: Any further questions?

17 (No response.)

18 MR. UTZ: If not, the witness may be excused.

19 (Witness excused.)

20 MR. UTZ: Any statements?

21 MR. PARR: I am Charles Parr with Continental  
 22 Oil Company and I would like to make a short statement.

23 MR. UTZ: You may proceed.

24 MR. PARR: Continental Oil Company highly  
 25 recommends that you approve forming this pool. We further

dearnley-meier reporting

SPECIALIZING IN: DEPOSITIONS, HEARINGS, STATEMENTS, EXPERT TESTIMONY, DAILY COPY, CONVENTIONS  
209 SIMMS BLDG., P.O. BOX 1092, PHONE 242-6691, ALBUQUERQUE, NEW MEXICO 87103  
FIRST NATIONAL BANK BLDG. EAST, ALBUQUERQUE, NEW MEXICO 87108

1 recommend that, if possible, this pool be expanded to include  
2 another 960 acres.

3 We have logged a well called Thirty, Number Five,  
4 in the northwest quarter of Section 32, Township 25 North,  
5 Range 4 West; we have drilled a well called Thirty, Number  
6 Six, in the northwest quarter of the southeast quarter of  
7 Section 29, of the same township; and we have drilled a well  
8 called Twenty, Number Two in the southeast quarter of the  
9 southeast quarter of Section 20 in the same township.

10 Wells have also been drilled -- Well Twenty-two,  
11 Number Seven, in the northeast quarter of Section ~~Twenty~~  
12 we propose, if this is possible, that in addition to the  
13 land outlined by Mr. Kendrick, the pool should include  
14 the northeast -- pardon me, I will start from a different area.

15 In Section 21, Township 25 North, Range 4 West,  
16 we would include the northeast quarter and the southeast  
17 quarter in Section 20, and include the southeast quarter in  
18 Section 29 including the east halves of Sections 29 and 32  
19 in the northeast quarter.

20 There are an additional 960 acres in each case.

21 These wells have penetrated the Gallup-Dakota  
22 zones and one of them was drilled on Friday, the Thirty,  
23 Number Five.

24 I have information on testing and Well Twenty-two,  
25 Number Seven, was finalized and Continental reported it on

dearnley-meier reporting service

SPECIALIZING IN: DEPOSITIONS, HEARINGS, STATEMENTS, EXPERT TESTIMONY, DAILY COPY, CONVENTIONS  
 209 SIMMS BLDG., P.O. BOX 1092 • PHONE 243-9991 • ALBUQUERQUE, NEW MEXICO 87103  
 FIRST NATIONAL BANK BLDG. EAST • ALBUQUERQUE, NEW MEXICO 87108

1 February 5, 1970, as being commingled and it showed  
 2 thirty-six percent oil and 196 MCF of gas.

3 Our Number Seven Well, in Section 21 -- the Number  
 4 Five Well, showed in a report of February 5, 1972, that it  
 5 made forty-seven percent oil and 490 MCF of gas.

6 MR. KENDRICK: All these wells you have mentioned,  
 7 are those approved and shown in my plat as outlined in green  
 8 by Administrative Order DHC-102?

9 MR. PARR: Yes.

10 MR. HATCH: Mr. Parr, I think this is outside of  
 11 the advertising on this Case, however, I think all of this  
 12 would be within the one pool and would be governed by this  
 13 and would come up at the next nomenclature Hearing.

14 MR. PARR: We do have four leases and you can see  
 15 that in most of the areas there is nobody within a half a  
 16 mile (indicating).

17 MR. HATCH: I think Mr. Kendrick could make an  
 18 addition here, if he so desired.

19 MR. KENDRICK: I think Mr. Parr stated that he  
 20 wanted the northeast quarter in Section 21?

21 MR. PARR: The southwest -- the northeast and  
 22 southwest, I was reading it wrong, the northeast and southwest.

23 MR. KENDRICK: I have no objection to bringing  
 24 these additions into the pool at the present time.

25 MR. UTZ: What paragraph would this be?

dearnley-meier reporting service

SPECIALIZING IN: DEPOSITIONS, HEARINGS, STATEMENTS, EXPERT TESTIMONY, DAILY COPY, CONVENTIONS  
209 SIMMS BLDG. • P.O. BOX 1092 • PHONE 243-6691 • ALBUQUERQUE, NEW MEXICO 87103  
FIRST NATIONAL BANK BLDG. EAST • ALBUQUERQUE, NEW MEXICO 87108

1  
2  
3  
4  
5  
6  
7  
8  
9  
10  
11  
12  
13  
14  
15  
16  
17  
18  
19  
20  
21  
22  
23  
24  
25

MR. KENDRICK: Paragraph (d).

MR. UTZ: And, it is your recommendation that we add these Sections that Mr. Parr suggested here?

MR. KENDRICK: Yes, the acres he defined.

MR. UTZ: Any further questions?

(No response.)

MR. UTZ: Any further statements?

(No response.)

MR. UTZ: The Case will be taken under advisement.  
This Hearing will be adjourned.

(Whereupon the Hearing was adjourned at 4:30 P.M.)

dearnley-meier reporting service

SPECIALIZING IN: DEPOSITIONS, HEARINGS, STATEMENTS, EXPERT TESTIMONY, DAILY COPY, CONVENTIONS

209 SIMMS BLDG., P.O. BOX 1092 • PHONE 243-6891 • ALBUQUERQUE, NEW MEXICO 87103  
FIRST NATIONAL BANK BLDG. EAST • ALBUQUERQUE, NEW MEXICO 87108

1 STATE OF NEW MEXICO )  
2 ) ss  
3 COUNTY OF BERNALILLO )

4 I, RICHARD E. McCORMICK, a Certified Shorthand Reporter,  
5 in and for the County of Bernalillo, State of New Mexico,  
6 do hereby certify that the foregoing and attached Transcript  
7 of Hearing before the New Mexico Oil Conservation Commission  
8 was reported by me; and that the same is a true and correct  
9 record of the said proceedings to the best of my knowledge,  
10 skill and ability.

11 Richard E. McCormick  
12 CERTIFIED SHORTHAND REPORTER

13  
14  
15  
16  
17  
18  
19  
20  
21  
22 I do hereby certify that the foregoing is  
23 a complete record of the proceedings in  
24 the foregoing hearing of case No. 4667  
25 heard by me on 7-16-72 19-72

Richard E. McCormick, Reporter  
New Mexico Oil Conservation Commission

dearnley-meier reporting service

SPECIALIZING IN: DEPOSITIONS, HEARINGS, STATEMENTS, EXPERT TESTIMONY, DAILY COPY, CONVENTIONS  
 209 SIMMS BLDG., P.O. BOX 1092 • PHONE 243-6691 • ALBUQUERQUE, NEW MEXICO 87103  
 FIRST NATIONAL BANK BLDG. EAST • ALBUQUERQUE, NEW MEXICO 87108

I N D E XWITNESS:PAGEA. R. KENDRICK

Direct Examination by Mr. Hatch

3

E X H I B I T SCOMMISSION'SOFFEREDADMITTED

Exhibit 1 Kendrick's Paragraphs

3

16

Exhibit 2 History of Well

6

16

Exhibit 3 Area Plat

9

16

Exhibit 4 Administrative DHC  
Orders List

11

16

Exhibit 5 Production Summary

12

16



## OIL CONSERVATION COMMISSION

STATE OF NEW MEXICO  
P. O. BOX 2088 - SANTA FE  
87501

February 22, 1972

GOVERNOR  
BRUCE KING  
CHAIRMAN

LAND COMMISSIONER  
ALEX J. ARMijo  
MEMBER

STATE GEOLOGIST  
A. L. PORTER, JR.  
SECRETARY - DIRECTOR

Mr. C. M. Tarr  
Continental Oil Company  
152 N. Durbin  
Casper, Wyoming 82601

Re: Case No. 4667  
Order No. R-4260  
Applicant: OCC

Dear Sir:

Enclosed herewith are two copies of the above-referenced Commission order recently entered in the subject case.

Very truly yours,

A. L. PORTER, Jr.  
Secretary-Director

ALP/ir

Copy of order also sent to:

Hobbs OCC x

Artesia OCC       

Aztec OCC x

Other

CHANGES

- (j) Angels Peak-Gallup Oil Pool  
Add: Township 26 North, Range 9 West  
Section 15: NW/4  
Section 16: All
- (k) Aztec-Pictured Cliffs Pool  
Add: Township 31 North, Range 12 West  
Section 27: N/2  
Section 28: N/2 & SE/4
- (o) South Blanco-Pictured Cliffs Pool  
Add: Township 25 North, Range 4 West  
Section 2: W/2  
Section 3: All  
Section 4: All  
  
Township 26 North, Range 4 West  
Section 35: SW/4
- (x) Otero-Chacra Pool  
Delete: Township 25 North, Range 6 West  
Section 6: NE/4
- (y) Otero-Gallup Oil Pool  
Add: Township 24 North, Range 5 West  
Section 10: NW/4 SW/4
- (z) Pinon-Fruitland Pool  
Delete: Township 28 North, Range 12 West  
Section 13: SW/4  
Section 14: SE/4  
  
Add: Township 28 North, Range 11 West  
Section 19: W/2

(d) 25N - 4W.  
Add: 21 NE/4, SW/4  
20 SE/4  
29 E/2  
32 NE/4  
*Chaco*

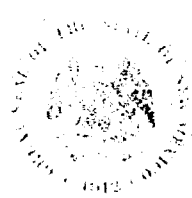

*Continued with letter 1/25*  
**OIL CONSERVATION COMMISSION**

STATE OF NEW MEXICO  
1000 RIO BRAZOS ROAD - AZTEC

87410

GOVERNOR  
BRUCE KING  
CHAIRMAN

LAND COMMISSIONER  
ALEX J. ARMIJO  
MEMBER

STATE GEOLOGIST  
A. L. PORTER, JR.  
SECRETARY - DIRECTOR

January 24, 1972

*Case 4667 NW Nomen.*

Mr. George Hatch  
Oil Conservation Commission  
P. O. Box 2088  
Santa Fe, New Mexico

Re: Northwest Nomenclature Case  
February 16, 1972

*Received by  
New Mexico Oil  
Conservation Comm.  
1-25-72  
JAP*

Dear George:

Listed below is information for the legal ad for the above captioned case:

In the matter of the application of the Oil Conservation Commission of New Mexico upon its own motion for the creation of the following pools:

South Gallegos-Fruitland Pool in Township 26 North,  
Range 12 West, San Juan County;

Waw-Pictured Cliffs Pool in Township 27 North, Range  
13 West, San Juan County;

Parlay-Mesaverde Oil Pool in Township 22 North, Range  
3 West, Sandoval County;

Rattlesnake-Gallup Oil Pool in Township 29 North, Range  
19 West, San Juan County;

West Lindrith-Gallup-Dakota Oil Pool in Township 25  
North, Range 4 West, Rio Arriba County;

Five Lakes-Dakota Oil Pool in Township 22 North, Range  
3 West, Sandoval County;

Snake Eyes-Dakota Oil Pool in Township 21 North, Range  
8 West, San Juan County;

Buena Suerte-Pennsylvanian Oil Pool in Township 25 North,  
Range 11 West, San Juan County;

North Tóito Dome-Pennsylvanian Pool in Township 26 North,  
Range 18 West, San Juan County;

and for the extension of the following pools in the counties as shown:

McKinley County

Lone Pine-Dakota Oil Pool

RECEIVED  
JAN 25 1972  
OIL CONSERVATION COMM.

January 24, 1972

Mr. George Hatch  
Page 2

RECEIVED

JAN 25 1972

WILDERNESS CONSERVATION COMM.

Rio Arriba County

Choza Mesa-Pictured Cliffs Pool ✓  
Gavilan-Pictured Cliffs Pool ✓  
Otero-Chacra Pool ✓  
BS Mesa-Gallup Pool ✓  
Otero-Gallup Oil Pool ✓  
Wild Horse-Gallup Pool ✓

San Juan County

Kutz-Fruitland Pool ✓  
Pinon-Fruitland Pool ✓  
Aztec-Pictured Cliffs Pool ✓  
Blanco-Pictured Cliffs Pool ✓  
Fulcher Kutz-Pictured Cliffs Pool ✓  
Angels Peak-Gallup Pool ✓  
Gallegos-Gallup Oil Pool ✓  
Mesa-Gallup Oil Pool ✓  
Hogback-Dakota Oil Pool ✓  
Slick Rock-Dakota Oil Pool ✓

Rio Arriba and San Juan Counties ✓

Blanco-Mesaverde Pool ✓

Rio Arriba, Sandoval and San Juan Counties

Ballard-Pictured Cliffs Pool ✓  
South Blanco-Pictured Cliffs Pool ✓  
Lybrook-Gallup Oil Pool ✓

Yours very truly,

  
A. R. Kendrick  
Engineer, District #3

ARK:mc



## OIL CONSERVATION COMMISSION

STATE OF NEW MEXICO  
1000 RIO BRAZOS ROAD - AZTEC  
87410

GOVERNOR  
BRUCE KING  
CHAIRMAN

LAND COMMISSIONER  
ALEX J. ARMIJO  
MEMBER

STATE GEOLOGIST  
A. L. PORTER, JR.  
SECRETARY - DIRECTOR

January 28, 1972

Mr. A. L. Porter, Jr.  
Oil Conservation Commission  
P. O. Box 2088  
Santa Fe, New Mexico

RECEIVED  
JAN 31 1972  
OIL CONSERVATION COMM.

Re: Northwest Nomenclature Case, February 16, 1972

Dear Pete:

I advertised in the subject case to establish the West Lindrith-Gallup Dakota Oil Pool.

The rumors I heard in the office in Santa Fe indicated some internal objection to the area being treated as a single pool.

The area was advertised at an earlier hearing, but due to an error in the legal ad the paragraph was deleted from the order.

It is my opinion that the staff should present a single position in each case before the public.

The enclosed plat shows the pool outline proposed and all wells currently producing in the pool with the approved order for each well with down-hole commingling.

The exhibits in Case 4462 presented by Continental Oil Company show that the reservoir is a stratigraphic trap without known abrupt changes.

In Case 4646 heard January 19, 1972, the applicant asked for similar commingling of the production in Section 3, just south of this area.

The Continental Oil Company is the operator of all the acreage within the proposed pool boundary.

The only objections I have heard are: 1. keeping production records by zones, and 2. the unknown horizontal limits of the pool.

In my opinion the production records by zones are not accurate; because, we have approved the use of averages for zone assignments. As far as the unknown horizontal limits, this pool is similar to every other pool being developed.

If the decision is to vacate this paragraph at this time, I would appreciate learning of it prior to the preparation of my exhibit.

Yours very truly,

*A. R. Kendrick*  
A. R. Kendrick  
Engineer, District #3

ARK:mc  
Encl: Plat

POOL West Lindrith-Gallup Dakota Oil Pool

RANGE 4 West

NMPM

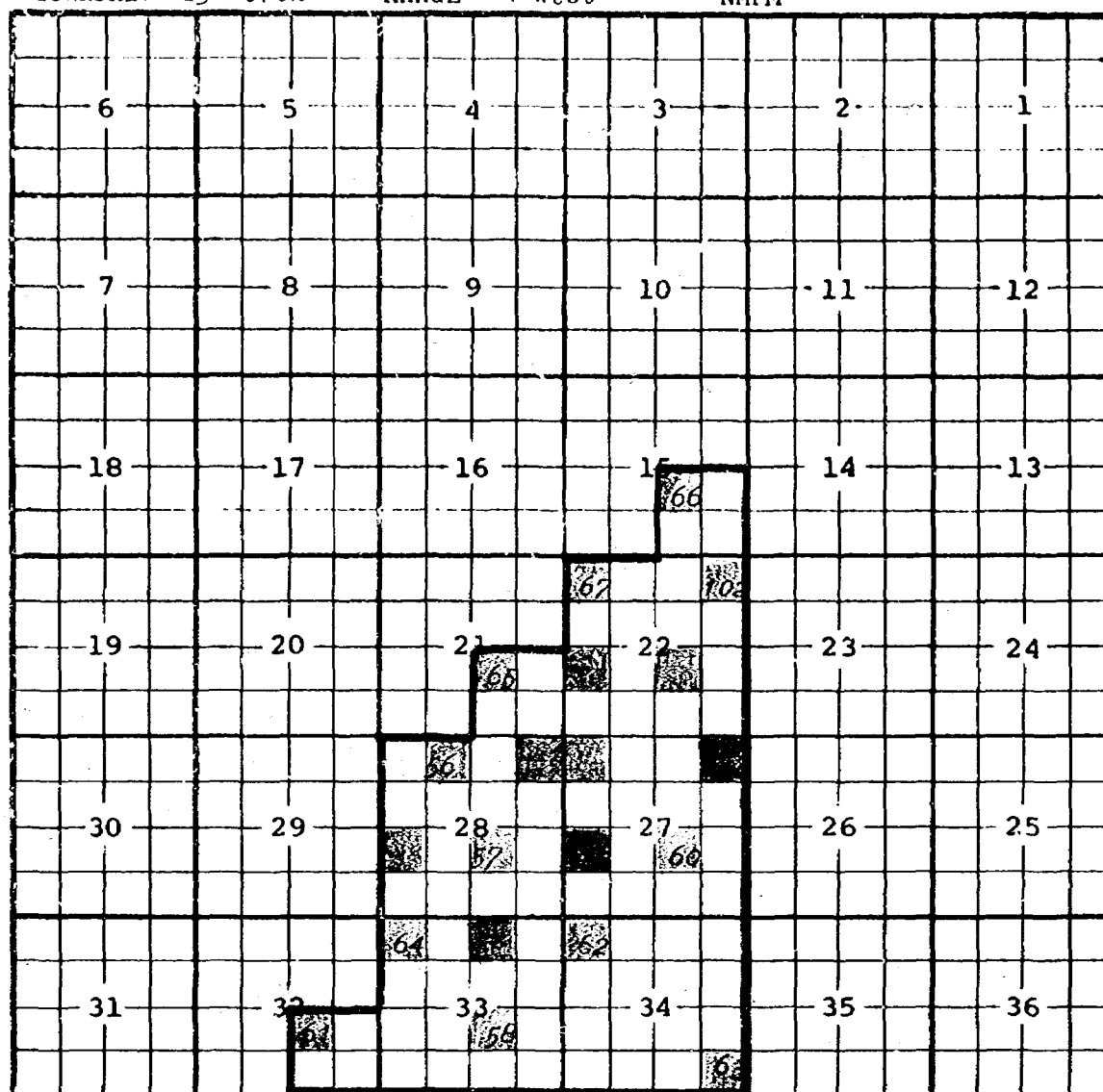

22



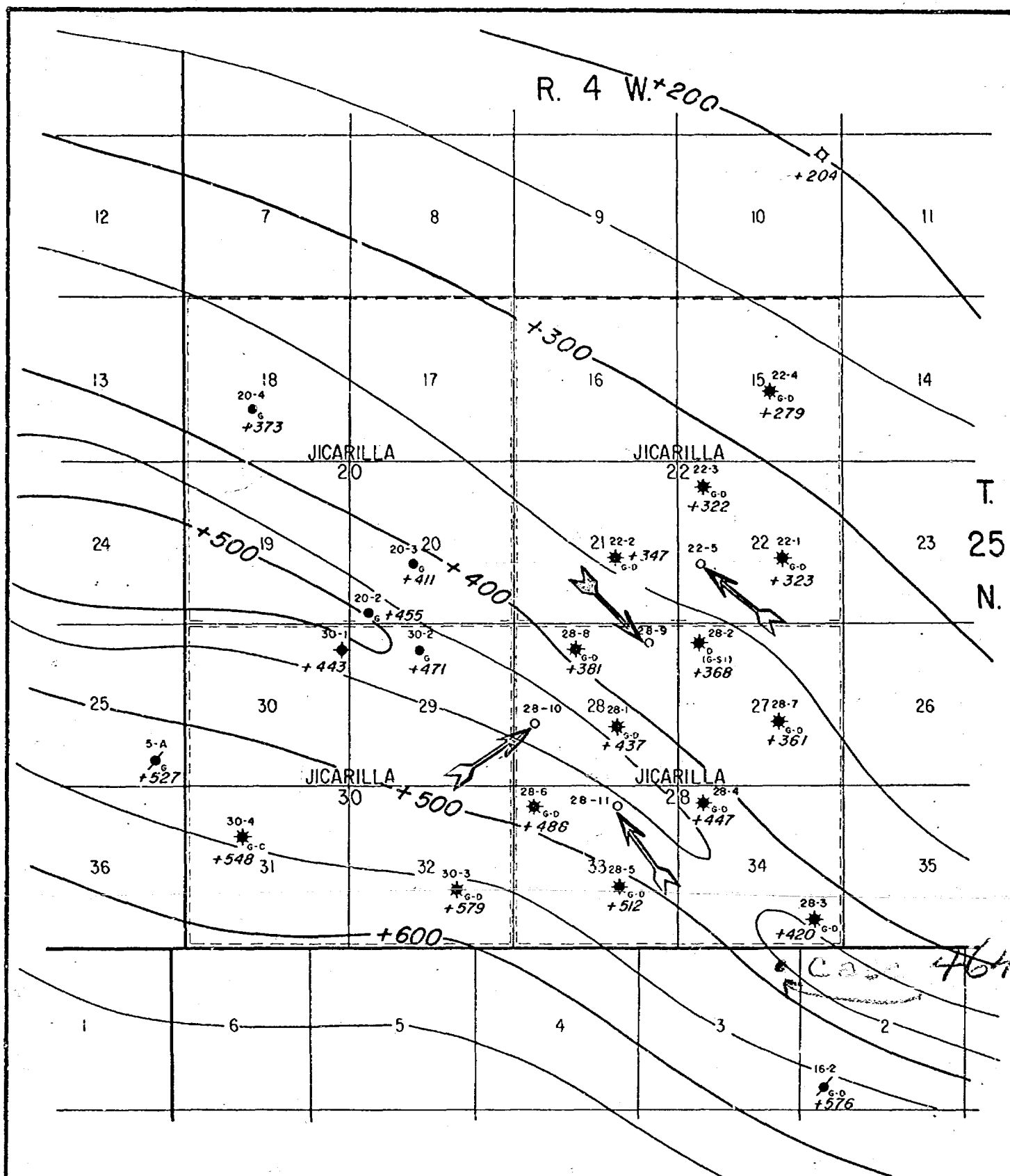

# — LEGEND —

- LOCATION
- GALLUP OIL WELL
- DAKOTA OIL WELL
- ★ DUAL - GALLUP (Oil) CHACRA (Gas)
- ★ DUAL - GALLUP (Oil) DAKOTA (Oil-Gas)
- ✱ SHUT-IN WELL
- ✱ ABANDONED WELL

**CONTINENTAL OIL COMPANY**  
PRODUCTION DEPARTMENT  
Casper, Wyoming



**WEST LINDRITH BLOCK**  
JICARILLA APACHE LEASES

**STRUCTURE MAP—TOP 1st. GALLUP SAND**

Contour Interval - 50'

County: Rio Arriba

State: New Mexico

Engineer: J.A. Mozzo

Draftsman: B.S.

Date: 7-23

Scale: 1" = 4000'

Sheet:

BEFORE THE OIL CONSERVATION COMMISSION  
OF THE STATE OF NEW MEXICO

Page 1

IN THE MATTER OF THE HEARING  
CALLED BY THE OIL CONSERVATION  
COMMISSION OF THE STATE OF  
NEW MEXICO FOR THE PURPOSE  
OF CONSIDERING:

CASE No. 4667  
Order No. R-4260

THE APPLICATION OF THE OIL  
CONSERVATION COMMISSION UPON  
ITS OWN MOTION FOR AN ORDER  
Creating And Extending Certain  
Pools In McKinley, Rio Arriba,  
Sandoval, And San Juan Counties,  
New Mexico.

ORDER OF THE COMMISSION

BY THE COMMISSION:

This cause came on for hearing at 9 o'clock a.m. on February 16, 1972  
at Santa Fe, New Mexico, before the Oil Conservation Commission of New Mexico,  
hereinafter referred to as the "Commission."

NOW, on this \_\_\_\_\_ day of February, 1972, the Commission, a quorum  
being present, having considered the testimony presented and the exhibits  
received at said hearing, and being fully advised in the premises,

FINDS:

(1) That due public notice having been given as required by law, the  
Commission has jurisdiction of this cause and the subject matter thereof.

(2) *That there is need for the creation of a new pool in San Juan County,  
New Mexico, for the production of oil from the Pennsylvanian formation, said pool  
to bear the designation of Buena Suerte - Pennsylvanian Oil Pool. Said Buena  
Suerte - Pennsylvanian Oil Pool was discovered by the Tenneco Oil Company  
Pah Well No. 1, located in Unit L of Section 3, Township 25 North, Range 11  
West, NMPM. It was completed in the Pennsylvanian formation on July  
28, 1971. The top of the perforations is at 10,956 feet.*

- (3) That there is need for the creation of a new pool in Sandoval County, New Mexico, for the production of oil from the Dakota formation, said pool to bear the designation of Five Lakes-Dakota Oil Pool. Said Five Lakes-Dakota Oil Pool was discovered by the Refiners Petroleum Corporation Cuba Union Well No. 1, located in Unit A of Section 25, Township 22 North, Range 3 West, NMPM. It was completed in the Dakota formation on October 8, 1970. The top of the perforations is at 6,878 feet.
- (4) That there is need for the creation of a new pool in San Juan County, New Mexico, for the production of gas from the Fruitland formation, said pool to bear the designation of South Gallegos-Fruitland Pool. Said South Gallegos-Fruitland Pool was discovered by the Skelly Oil Company ~~Navajo G~~ Well No. 1, located in Unit K of Section 12, Township 26 North, Range 12 West, NMPM. It was completed in the Fruitland formation on May 27, 1968. The top of the perforations is at 1100 feet.
- (5) That there is need for the creation of a new pool in Rio Arriba County, New Mexico, for the production of ~~gas~~ oil from the Gallup-Dakota formation, said pool to bear the designation of West Lindrith Gallup-Dakota Oil Pool. ~~Said West Lindrith Gallup-Dakota Oil Pool was discovered by~~
- (6) That there is need for the creation of a new pool in Sandoval County, New Mexico, for the production of oil from the Mesaverde formation, said pool to bear the designation of Parlay-Mesaverde Oil Pool. Said Parlay-Mesaverde Oil Pool was discovered by the Tesoro Petroleum Corporation Parlay Well No. 1, located in Unit H of Section 29, Township 22 North, Range 3 West, NMPM. It was completed in the Mesaverde formation on ~~the~~ October 4, 1971. The top of the perforations is at 4340 feet.
- (7) That there is need for the creation of a new pool in San Juan County, New Mexico, for the production of oil from the Gallup formation, said pool to bear the designation of Rattlesnake-Gallup Oil Pool. Said Rattlesnake-Gallup Oil Pool was discovered by the Eastern Petroleum Company Navajo Well No. 23, located in Unit G of Section 2, Township 29 North, Range 19 West, NMPM. It was completed in the Gallup formation on July 19, 1968. ~~The top of the perforations is at~~ The casing shoe is at 195 feet.

(8) That the proposed creation of a new pool in Sections 17 and 20, Township 21 North, Range 8 West, NMPM, San Juan County, New Mexico, for the production of oil from the Dakota formation should be dismissed.

(9) That there is need for the creation of a new pool in San Juan County, New Mexico, for the production of gas from the Pennsylvanian formation, said pool to bear the designation of North Tocito Dome-Pennsylvanian Pool. Said North Tocito Dome-Pennsylvanian Pool was discovered by the Campbell, Kiel, & Rothwell Navajo Tocito Well No. 1, located in Unit G of Section 9, Township 26 North, Range 18 West, NMPM. It was completed in the Pennsylvanian formation on December 2, 1967. The top of the perforations is at 6322 feet.

(10) That there is need for the creation of a new pool in San Juan County, New Mexico, for the production of gas from the Pictured Cliffs formation, said pool to bear the designation of Waw-Picture Cliffs Pool. Said Waw-Pictured Cliffs Pool was discovered by the Dugan Production Corporation Waw Well No. 1, located in Unit L of Section 32, Township 27 North, Range 13 West, NMPM. It was completed in the Pictured Cliffs formation on June 20, 1970. The top of the perforations is at 1325 feet.

(11) That there is need for ~~the~~ certain extensions to the Lone Pine-Dakota Oil Pool in McKinley County, New Mexico, the BS Mesa-Gallup Pool, the Chozas Mesa-Pictured Cliffs Pool, the Otero-Chacra Pool, the Otero-Gallup Oil Pool and the Wild Horse-Gallup Pool in Rio Arriba County, New Mexico, the Angels Peak-Gallup Oil Pool, the Aztec-Pictured Cliffs Pool, the Blanco-Pictured Cliffs Pool, the Fulcher Kutz-Pictured Cliffs Pool, the Gallegos-Gallup Oil Pool, the Hogback-Dakota Oil Pool, the Kutz-Fruitland Pool, the Pinion-Fruitland Pool and the Slick Rock-Dakota Oil Pool in San Juan County, New Mexico, the Blanco-Mesaverde Pool in Rio Arriba and San Juan Counties, New Mexico, and the Ballard-Pictured Cliffs, the South Blanco-Pictured Cliffs and the Lybrook-Gallup Oil Pool in Rio Arriba, Sandoval, and San Juan Counties, New Mexico.

It Is Therefore Ordered:

(a) That a new pool in San Juan  
County y, New Mexico, classified as an oil pool for  
Pennsylvanian production, is hereby created and designated as the  
Buena Suerte - Pennsylvanian Oil Pool, consisting  
of the following-described area:

Township 25 North, Range 11 West, NMPM  
Section 3: SW 1/4

(b) That a new pool in Sandoval  
County y, New Mexico, classified as an oil pool for  
Dakota production, is hereby created and designated as the  
Five Lakes - Dakota Oil Pool, consisting  
of the following-described area:

Township 22 North, Range 3 West, NMPM  
Section 24: SE 1/4 SW 1/4  
Section 25: N 1/2  
Section 26: NE 1/4 NE 1/4

(c) That a new pool in San Juan  
County y, New Mexico, classified as a gas pool for  
Fruitland production, is hereby created and designated as the  
South Gallegos - Fruitland Pool, consisting  
of the following-described area:

Township 26 North, Range 12 West, NMPM  
Section 11: S 1/2 and NW 1/4  
Section 12: All

(d) That a new pool in Rio Arriba  
County y, New Mexico, classified as an oil pool for  
Gallup - Dakota production, is hereby created and designated as the  
West Lindrith Gallup - Dakota Oil Pool, consisting  
of the following-described area:

Township 25 North, Range 4 West, NMPM  
Section 15: SE 1/4  
Section 20: SE 1/4  
Section 21: S 1/2 and NE 1/4  
Section 22: All  
Section 27: All  
Section 28: All  
Section 29: E 1/2  
Section 32: E 1/2  
Section 33: All  
Section 34: All

(e) That a new pool in Sandoval County, New Mexico, classified as an oil pool for Mesaverde production, is hereby created and designated as the Parlay-Mesaverde Oil Pool, consisting of the following-described area:

Township 22 North, Range 3 West, NMPM  
Section 29: N/2

(f) That a new pool in San Juan County, New Mexico, classified as an oil pool for Gallup production, is hereby created and designated as the Rattlesnake-Gallup Oil Pool, consisting of the following-described area:

Township 29 North, Range 19 West, NMPM  
Section 2: NE 1/4

(g) That the proposed creation of a new pool in San Juan County, New Mexico, classified as an oil pool for Dakota production and designated as the Snake Eyes-Dakota Oil Pool, consisting of the following described area:

Township 21 North, Range 8 West, NMPM

Section 17: SW 1/4 SE 1/4

Section 20: N/2 and SW 1/4

is hereby dismissed

(h) That a new pool in San Juan County, New Mexico, classified as a gas pool for Pennsylvanian production, is hereby created and designated as the North Tocito Dome-Pennsylvanian Pool, consisting of the following-described area:

Township 26 North, Range 18 West, NMPM

Section 9: E 1/2

Section 10: SW 1/4

(i) That a new pool in San Juan County, New Mexico, classified as a gas pool for Pictured Cliffs production, is hereby created and designated as the Waw-Pictured Cliffs Pool, consisting of the following-described area:

Township 27 North, Range 13 West, NMPM

Section 32: SW 1/4

(j) That the Angels Peak - Gallup Oil Pool in San Juan County, New Mexico, as heretofore classified, defined, and described, is hereby extended to include therein:

TOWNSHIP 26 NORTH, RANGE 9 West, NMPM  
Section 17: E/2

(k) That the Aztec - Pictured Cliffs Pool in San Juan County, New Mexico, as heretofore classified, defined, and described, is hereby extended to include therein:

TOWNSHIP 28 NORTH, RANGE 9 West, NMPM  
Section 31: SW/4

Township 31 North, Range 12 West, NMPM  
Section 27: N/2  
Section 28: N/2 and SE/4

(l) That the Ballard - Pictured Cliffs Pool in Rio Arriba, Sandoval, & Sandoval Counties, New Mexico, as heretofore classified, defined, and described, is hereby extended to include therein:

TOWNSHIP 22 NORTH, RANGE 2 West, NMPM  
Section 6: SW/4

Township 22 North, Range 3 West, NMPM  
Section 2: NE/4

Township 23 North, Range 4 West, NMPM  
Section 24: SE/4

(m) That the Blanco - Mesaverde Pool in Rio Arriba & San Juan Counties, New Mexico, as heretofore classified, defined, and described, is hereby extended to include therein:

TOWNSHIP 26 NORTH, RANGE 5 West, NMPM  
Section 13: All  
Section 24: W/2

Township 29 North, Range 10 West, NMPM  
Section 3: All  
Section 10: All

(n) That the Blanco - Pictured Cliffs Pool in San Juan County, New Mexico, as heretofore classified, defined, and described, is hereby extended to include therein:

TOWNSHIP 30 NORTH, RANGE 10 West, NMPM  
Section 1: W/2

Township 31 North, Range 11 West, NMPM  
Section 25: NW/4

(O) That the South Blanco - Pictured Cliffs Pool in Rio Arriba, Sandoval & San Juan Counties, New Mexico, as heretofore classified, defined, and described, is hereby extended to include therein:

TOWNSHIP 23 NORTH, RANGE 2 West, NMPM

Section 16: SW/4

Section 17: SE/4

Section 20: N/2

Section 21: All

Section 28: NW/4

Township 25 North, Range 4 West, NMPM

Section 2: W/2

Section 3: All

Section 4: All

Township 26 North, Range 4 West, NMPM

Section 35: SW/4

(P) That the BS Mesa - Gallup Pool in Rio Arriba County, New Mexico, as heretofore classified, defined, and described, is hereby extended to include therein:

TOWNSHIP 26 NORTH, RANGE 4 West, NMPM

Section 3: N/2

Section 9: NE/4

Section 10: NW/4

(Q) That the Choza Mesa - Pictured Cliffs Pool in Rio Arriba County, New Mexico, as heretofore classified, defined, and described, is hereby extended to include therein:

TOWNSHIP 29 NORTH, RANGE 3 West, NMPM

Section 30: S/2

(R) That the Fulcher Kutz - Pictured Cliffs Pool in San Juan County, New Mexico, as heretofore classified, defined, and described, is hereby extended to include therein:

TOWNSHIP 29 NORTH, RANGE 11 West, NMPM

Section 6: NE/4

(S) That the Gallegos - Gallup Oil Pool in San Juan County, New Mexico, as heretofore classified, defined, and described, is hereby extended to include therein:

TOWNSHIP 26 NORTH, RANGE 11 West, NMPM

Section 24: S/2

(T) That the Hogback - Dakota Oil Pool in San Juan County, New Mexico, as heretofore classified, defined, and described, is hereby extended to include therein:

TOWNSHIP 29 NORTH, RANGE 16 West, NMPM

Section 7: SW/4 SW/4

Section 18: NW/4 NW/4

(u) That the Kutz - Fruitland Pool in San Juan County, New Mexico, as heretofore classified, defined, and described, is hereby extended to include therein:

TOWNSHIP 28 NORTH, RANGE 11 West, NMPM  
Section 24: NW 1/4  
Section 25: N 1/2

(v) That the Lone Pine - Dakota Oil Pool in McKinley County, New Mexico, as heretofore classified, defined, and described, is hereby extended to include therein:

TOWNSHIP 17 NORTH, RANGE 8 West, NMPM  
Section 7: S 1/2  
Section 8: E 1/2 NW 1/4, N 1/2 SW 1/4 and SE 1/4 SW 1/4  
Section 17: NE 1/4 NW 1/4  
Section 18: E 1/2 SE 1/4

Township 17 North, Range 9 West, NMPM  
Section 12: E 1/2 SE 1/4  
Section 13: NE 1/4 NW 1/4  
Section 24: E 1/2 NW 1/4

(w) That the Lybrook - Gallup Oil Pool in Rio Arriba, Sandoval & San Juan Counties, New Mexico, as heretofore classified, defined, and described, is hereby extended to include therein:

TOWNSHIP 23 NORTH, RANGE 6 West, NMPM  
Section 7: SW 1/4 & SE 1/4 NW 1/4  
Section 18: W 1/2  
Section 19: All  
Section 20: SW 1/4  
Section 30: W 1/2  
Section 31: NW 1/4 NW 1/4

Township 23 North, Range 7 West, NMPM  
Section 3: SW 1/4  
Section 4: E 1/2 SE 1/4  
Section 5: All  
Section 13: All  
Section 14: SE 1/4 and E 1/2 NE 1/4  
Section 22: NE 1/4 and NE 1/4 SE 1/4  
Section 23: N 1/2  
Section 24: NW 1/4 and NW 1/4 SW 1/4

Township 24 North, Range 7 West, NMPM  
Section 29: SW 1/4  
Section 32: W 1/2

(X) That the Otero - Chacra Pool  
in Rio Arriba County, New Mexico, as heretofore classified,  
defined, and described, is hereby extended to include therein:

TOWNSHIP 25 NORTH, RANGE 4 West, NMPM  
Section 31: NW/4

Township 25 North, Range 5 West, NMPM  
Section 3: W/2  
Section 10: N/2  
Section 11: NW/4  
Section 35: N/2  
Section 36: N/2

Township 25 North, Range 6 West, NMPM  
Section 1: All  
Section 3: N/2

Township 26 North, Range 5 West, NMPM  
Section 34: W/2

Township 26 North, Range 6 West, NMPM  
Section 18: SW/4  
Section 19: W/2 and SE/4  
Section 20: SW/4  
Section 26: SW/4  
Section 28: All  
Section 29: W/2  
Section 30: All  
Section 31: N/2

Township 26 North, Range 7 West, NMPM  
Section 12: W/2  
Section 13: N/2 and SE/4

(Y) That the Otero - Gallup Oil Pool  
in Rio Arriba County, New Mexico, as heretofore classified,  
defined, and described, is hereby extended to include therein:

TOWNSHIP 24 NORTH, RANGE 5 West, NMPM

Section 3: W/2  
Section 4: All  
Section 5: SE/4, S/2 NE/4 and NE/4 NE/4  
Section 9: N/2 and E/2 SW/4  
Section 10: NW/4, SW/4 NE/4, and NW/4 SW/4

Township 25 North, Range 5 West, NMPM  
Section 33: SE/4

(2) That the Pinion-Fruitland Pool in San Juan County, New Mexico, as heretofore classified, defined, and described, is hereby extended to include therein:

TOWNSHIP 28 NORTH, RANGE 11 West, NMPM  
Section 19: W/2

(aa) That the Slick Rock-Dakota Oil Pool in San Juan County, New Mexico, as heretofore classified, defined, and described, is hereby extended to include therein:

TOWNSHIP 30 NORTH, RANGE 16 West, NMPM  
Section 31: W/2 SW/4 and SW/4 NW/4

Township 30 North, Range 17 West, NMPM  
Section 36: NE/4 NE/4

(bb) That the Wild Horse-Gallup Pool in Rio Arriba County, New Mexico, as heretofore classified, defined, and described, is hereby extended to include therein:

TOWNSHIP 26 NORTH, RANGE 3 West, NMPM  
Section 19: SW/4

Township 26 North, Range 4 West, NMPM  
Section 12: SW/4  
Section 13: NW/4  
Section 24: NW/4

IT IS FURTHER ORDERED:

(1) That, pursuant to Section 65-3-14.5, NMSA 1953, contained in Chapter 271, Laws of 1969, any well which, by virtue of any of the above pool extensions, is subject to pool rules providing for spacing or pro-ration units larger than the one which is presently dedicated thereto, shall have 60 days from the effective date of this order in which to file new Forms C-102 dedicating a standard unit for the pool to said well, or to obtain a non-standard unit approved by the Commission. Pending such compliance, the well shall receive a maximum allowable in the same proportion to a standard allowable for the pool that the acreage dedicated to the well bears to a standard unit for the pool. Failure to file Forms C-102 dedicating a standard unit to the well or to obtain a non-standard unit approved by the Commission within said 60-day period shall subject the well to cancellation of allowable.

(2) That the effective date of this order and all creations and extensions included herein shall be March 1, 1972.

DONE at Santa Fe, New Mexico, on the day and year hereinabove designated.

STATE OF NEW MEXICO  
OIL CONSERVATION COMMISSION

BRUCE KING, Chairman

ALEX ARMIJO, Member

A. L. PORTER, Jr., Member & Secretary