

CASE 4943: Application of M. W.
STAPLES FOR AN UNORTHODOX OIL
WELL LOCATION, EDDY COUNTY.

Copy to
May 9, 1973

Copy to May 23, 1973

CASE No.

4943

Application,

Transcripts,

Small Exhibits

ETC.

dearnley, meier & associates

209 SIMMS BLDG. • P.O. BOX 1092 • PHONE 243-6691 • ALBUQUERQUE, NEW MEXICO 87103
1216 FIRST NATIONAL BANK BLDG. EAST • ALBUQUERQUE, NEW MEXICO 87108

1
2
3
4
5
6
7
8
9
10
11
12
13
14
15
16
17
18
19
20
21
22
23
24
25

BEFORE THE
NEW MEXICO OIL CONSERVATION COMMISSION
CONFERENCE ROOM, STATE LAND OFFICE BUILDING
SANTA FE, NEW MEXICO

May 23, 1973

EXAMINER HEARING

IN THE MATTER OF:

Application of M. W. Staples
for an unorthodox oil well
location, Eddy County,
New Mexico.

Case No. 4943

BEFORE: Elvis A. Utz,
Examiner.

TRANSCRIPT OF HEARING

dearnley, meier & associates

209 SIMMS BLDG. • P.O. BOX 1082 • PHONE 243-6691 • ALBUQUERQUE, NEW MEXICO 87103
1216 FIRST NATIONAL BANK BLDG. EAST • ALBUQUERQUE, NEW MEXICO 87106

1 MR. UTZ: Case 4943, continued from the May 9th,
2 1973 Examiner Hearing.

3 MR. CARR: Case 4943: Application of M. W. Staples
4 for an unorthodox oil well location, Eddy County, New Mexico.

5 MR. LOSEE: A. J. Losee, of Losee and Carson,
6 Artesia, appearing on behalf of the Applicant. I have one
7 witness to be sworn.

8 * * * *

9 N. RAYMOND LAMB,
10 was called as a witness, and after being duly sworn according
11 to law, testified as follows:

12 MR. LOSEE: Before we commence, Mr. Examiner, I
13 would like to move to amend the name of the party who is
14 making application. M. W. Staples is a working interest
15 owner, but the operator of record is Arewood Limited. That
16 is the operating company, and they will be the sole general
17 partner.

18 * * * *

19 DIRECT EXAMINATION

20 BY MR. LOSEE:

21 Q State your name, residence, and occupation.

22 A N. Raymond Lamb, Artesia, New Mexico, consulting
23 petroleum engineer.

24 Q Have you previously testified before the Commission and
25 had your qualifications accepted?

dearnley, meier & associates

209 SIMMS BLDG., P.O. BOX 1092 • PHONE 243-6691 • ALBUQUERQUE, NEW MEXICO 87103
1216 FIRST NATIONAL BANK BLDG. EAST • ALBUQUERQUE, NEW MEXICO 87108

1 A Yes.

2 MR. LOSEE: Are Mr. Lamb's qualifications accepted?

3 MR. UTZ: Yes, they are.

4 Q (By Mr. Losee) Will you state the purpose of this
5 application, Mr. Lamb?

6 A The Applicant in this case would desire to join four
7 forty-acre tracts into a proration unit to permit the
8 oil production from Well No. 2, which is located 1930
9 feet from the north and 1330 feet from the east line
10 of Section 20, Township 18 South, Range 28 East, so
11 that production can continue above the economic limits
12 of this operation.

13 Q Would you briefly explain the history behind the request
14 for this application?

15 A This property in the Northeast quarter of Section 20
16 has been in several hands, and was acquired by Arewood
17 Limited in 1971 from the Stallworth people, who had
18 a secondary recovery water project operated by Ryder
19 Scott. The project itself was not a great success,
20 and Arewood Limited continued to produce the property
21 by injecting produced water into the Vanderventer
22 No. 2. In November, 1972, the casing surface pressure
23 on the well indicated mechanical problems. Either
24 the packer was leaking or there was a hole in the
25 tubing, and the water was not being injected into the

dearnley, meier & associates

200 SIMMS BLDG., P.O. BOX 1092, PHONE 243-6691 • ALBUQUERQUE, NEW MEXICO 87103
1216 FIRST NATIONAL BANK BLDG. EAST • ALBUQUERQUE, NEW MEXICO 87108

1 zones they had anticipated.

2 In December, 1972, it was determined that this
3 well should be plugged in an attempt to remedy the
4 mechanical problems.

5 After a very short period of backflowing, that
6 is water that had been injected, the well commenced
7 to produce oil in the neighborhood of ten to fifteen
8 barrels of oil per day.

9 As the fluids increased, the oil increased along
10 with it. This is not normally the procedure from the
11 flow-back of an injection well in that only water is
12 produced, and gradually decreased within a reasonable
13 time to permit the remedial work to be undertaken.

14 Now, some six months have gone by since the
15 well began to flow back, and the oil has not been
16 depleted as of this date.

17 Q Did the representatives from Arewood have a conference
18 in Artesia for a test allowable for this well?

19 A Yes. In view of the flow-back, it was necessary to
20 have an understanding from the Commission as to the
21 disposition of the oil, and they received a test
22 allowable to permit disposal of the allowable produced
23 from the input well.

24 Q Mr. Lamb, this injection well at this unorthodox
25 location was originally authorized by Order R-4331,

dearnley, meier & associates

209 SIMMS BLDG., P.O. BOX 1092 • PHONE 243-6691 • ALBUQUERQUE, NEW MEXICO 87103
1216 FIRST NATIONAL BANK BLDG. EAST • ALBUQUERQUE, NEW MEXICO 87103

1 isn't that correct?

2 A Yes.

3 Q Please refer to what has been marked as Exhibit One,
4 and explain what is shown by that exhibit.

5 A Exhibit One is just a general map of the Artesia pool
6 area, and shows the Northeast quarter of Section 20
7 as related to the other oil production in the area.

8 Q And it also shows the offset operators?

9 A Yes.

10 Q Please refer to Exhibit Two, and explain what that is.

11 A Exhibit Two consists of the Northeast quarter of Section
12 20, Township 18 South, Range 28 East of Eddy County,
13 New Mexico, and shows the exact locations of all
14 wells in this 160 acres, and the total depths and
15 in some cases the top of the San Andreas formation.

16 Q Why don't you, before you leave this, briefly give
17 the present production from each of the wells?

18 A The No. 1 Vanderverter in November, 1972 shows twenty-
19 eight barrels production. The Vanderverter No. 2
20 was zero production. The Humble State No. 1 produced
21 eighty-four barrels. The Humble State No. 2, the pink
22 dot, produced 204 barrels. The Rotary Well, which is
23 the dark blue dot, produced 190 barrels. This adds
24 up to a total of 516 barrels.

25 Q And this area is now making 1,000 barrels a day?

dearnley, meier & associates

209 SIMMS BLDG. • P.O. BOX 1092 • PHONE 243-6691 • ALBUQUERQUE, NEW MEXICO 87103
1216 FIRST NATIONAL BANK BLDG. EAST • ALBUQUERQUE, NEW MEXICO 87108

1 A Yes, with the production from the Vanderventer No. 2.

2 Q How much does the Vanderventer No. 2 make?

3 A May I give you the March, 1973 figure?

4 MR. UTZ: Okay.

5 A The Vanderventer No. 1 and 2 produced 570 barrels.

6 The Humble No. 1 produced 107 barrels. The Humble

7 No. 2 produced 210 barrels. The Rotary produced 155

8 barrels. I believe this comes to 463 barrels for the

9 acreage not covered by the Vanderventer.

10 MR. UTZ: What was the Humble State again?

11 THE WITNESS: One hundred seven for the Humble

12 State No. 1. The Humble State No. 2 was 210, and the Rotary

13 was 155. This gives a total for March, 1973 on the quarter

14 section of 1,033 barrels.

15 Q (By Mr. Losee) Mr. Lamb, the entire Northeast quarter

16 is owned by the State of New Mexico, the minerals

17 underlying that?

18 A That's correct.

19 Q And those are all university lands, is that not correct?

20 A That's correct.

21 Q Please refer to what has been marked as Exhibit Three,
22 and explain what that is.

23 A Exhibit Three is purely a record of the Oil Commission
24 file in Artesia, and is submitted solely for the
25 Examiner's convenience.

dearnley, meier & associates

209 SIMMS BLDG., P.O. BOX 1092, PHONE 243-6691 • ALBUQUERQUE, NEW MEXICO 87103
1216 FIRST NATIONAL BANK BLDG. EAST • ALBUQUERQUE, NEW MEXICO 87108

1 Q Please refer to what has been marked as Exhibit Four,
2 and explain what that is.

3 A Exhibit Four is a photocopy of March, 1973 production,
4 and that is what I just read to you.

5 Q Please refer to what has been marked as Exhibit Five,
6 and tell us what that is.

7 A Exhibit Number Five is a monthly production curve on
8 the forty-acre tracts. It shows the 1970 monthly
9 production, the '71 monthly production, and the '72
10 monthly production.

11 You will note the increase in production beginning
12 with the flow-back of the Vanderventer No. 2, and you
13 can see that it was quite a dramatic increase.

14 Q Please refer to what has been marked as Exhibit Number
15 Six, and explain what is portrayed by that exhibit.

16 A Exhibit Six is a log on the Vanderventer No. 2. On
17 this exhibit, there is a combination of data from
18 Exhibit Number Seven, which is a temporary tracer
19 survey run by Del-temp Logs. The information is
20 contained on one composite log. You will note that
21 the packer is set just above 2,000 feet, and that the
22 perforated zone is at about 2,020 feet, and then
23 again at 2,120 feet, and again above and below 2,300
24 feet, and at 2,450 feet.

25 These are identified in the right-hand column,

dearnley, meier & associates

209 SIMMS BLDG., P.O. BOX 1092 • PHONE 243-6691 • ALBUQUERQUE, NEW MEXICO 87103
1216 FIRST NATIONAL BANK BLDG. EAST • ALBUQUERQUE, NEW MEXICO 87108

1 the upper one being the Loco Hills, and then the
2 Metex, the Premier, and the Lower Premier, and the
3 Lovington. The top of the San Andreas is indicated
4 at 2,310. This log also shows the amount of acid
5 injected into each one of these zones, and you will
6 note in each case, it is 200 gallons.

7 Immediately to the right in red are the pressures
8 as reported by the acid company. In the upper zone,
9 the Loco Hills, it was 1,900 pounds to brack and 1,600
10 pounds to treat. The instantaneous shut-in pressure
11 was 1,100 pounds. In the Metex, the pressure was
12 2,300 to brack and 1,400 to treat, with 1,100
13 instantaneous shut-in.

14 In the Premier, the pressure to brack was 2,750
15 while the pressure to treat was 1,300 with an
16 instantaneous shut-in of 950. In the Lower Premier,
17 the pressure to brack was 2,000, and the pressure to
18 treat was 1,700, with an instantaneous shut-in of 1,300.

19 In the Lovington, the pressure to brack was
20 2,000 with 1,700 to treat, and 1,100 instantaneous
21 shut-in.

22 You will note there are some variations in the
23 treatment which is customary in the Lower Greyberg,
24 and the Lovington sand member.

25 The unusual thing about this series of logs is

dearnley, meier & associates

209 SIMMS BLDG. • P.O. BOX 1092 • PHONE 243-4891 • ALBUQUERQUE, NEW MEXICO 87103
1216 FIRST NATIONAL BANK BLDG. EAST • ALBUQUERQUE, NEW MEXICO 87108

1 that the lower pressure was not taking any fluid on
2 the date of the temperature survey which was April
3 30th, 1969. The other zones were taking fluid, and
4 this would indicate that the main part of the injected
5 water in the Vanderventer No. 2 was going into the
6 Loco Hills and Metex and Premier.

7 Q Please refer to Exhibit Number Seven, and tell us
8 what that is.

9 A This is the tracer survey referred to before, giving
10 the details of the survey. The tracer survey supports
11 the evidence on Exhibit Six.

12 Q Mr. Lamb, is the ownership of the royalties in the
13 entire Northeast quarter the same, to wit, the State
14 of New Mexico?

15 A No, there are certain overriding interests.

16 Q I said royalty interests.

17 A Royalty? Yes.

18 Q Now, the overriding royalty ownership is different
19 throughout the Northeast quarter, is that correct?

20 A That's correct.

21 Q Are the owners of all the overriding royalties and
22 working interests in the Northeast quarter entered
23 in agreement whereby the production from the Vanderventer
24 No. 2 Well will be shared by all of those interest
25 owners on a surface acre basis?

dearnley, meier & associates

209 SIMMS BLDG., P.O. BOX 1092 • PHONE 243-6691 • ALBUQUERQUE, NEW MEXICO 87103
1216 FIRST NATIONAL BANK BLDG. EAST • ALBUQUERQUE, NEW MEXICO 87108

1 A That's correct.

2 MR. LOSEE: I will offer into evidence a Xerox
3 copy of that agreement with the signatures of all the
4 interest owners.

5 Q (By Mr. Losee) In your opinion, will the approval of
6 this application protect correlative rights and
7 prevent waste?

8 A Supported by the instrument handed to the Commission,
9 the correlative rights will be protected by this
10 application, and it certainly will prevent waste.

11 Q Were Exhibits One through Seven prepared by you or
12 under your supervision?

13 A They were.

14 MR. LOSEE: I have no further questions of the
15 witness.

16 MR. UTZ: Exhibits One through Seven will be
17 entered into the record of this case.

18 (Whereupon Applicant's Exhibits One through Seven,
19 respectively, were entered in evidence.)

20 MR. UTZ: Are there any questions of this witness?
21 (No response)

22 MR. UTZ: If not, the witness may be excused.
23 (Witness excused.)

24 MR. LOSEE: Mr. Examiner, I have made the State
25 Land Office aware of the agreement, and they are the only

dearnley, meier & associates

203 SIMMS BLDG. • P.O. BOX 1092 • PHONE 243-6691 • ALBUQUERQUE, NEW MEXICO 87103
1216 FIRST NATIONAL BANK BLDG. EAST • ALBUQUERQUE, NEW MEXICO 87108

1 party that has executed this.

2 MR. UTZ: Are there any further statements in
3 this case?

4 (No response)

5 MR. UTZ: Case 4943 will be taken under advisement.

6 This hearing is adjourned.

7 * * * *

8 STATE OF NEW MEXICO)
9) ss
COUNTY OF BERNALILLO)

10
11 I, RICHARD E. McCORMICK, a Certified Shorthand
12 Reporter, in and for the County of Bernalillo, State of
13 New Mexico, do hereby certify that the foregoing and attached
14 Transcript of Hearing before the New Mexico Oil Conservation
15 Commission was reported by me; and that the same is a true
16 and correct record of the said proceedings to the best of
17 my knowledge, skill and ability.

18
19 Richard E. McCormick
20 CERTIFIED SHORTHAND REPORTER

21
22 I do hereby certify that the foregoing is
23 a complete record of the proceedings in
24 the Examiner hearing of Case No. 4943.
25 heard by me on May 23, 1973.
Examiner
New Mexico Oil Conservation Commission

dearnley, meier & associates

209 SIMMS BLDG., P.O. BOX 1092, PHONE 243-6691, ALBUQUERQUE, NEW MEXICO 87103
1216 FIRST NATIONAL BANK BLDG. EAST, ALBUQUERQUE, NEW MEXICO 871081
2
3
4
5
6
7
8
9
10
11
12
13
14
15
16
17
18
19
20
21
22
23
24
25I N D E XWITNESSPAGE

N. RAYMOND LAMB

Direct Examination by Mr. Losee

3

E X H I B I T SEXHIBITADMITTEDOFFERED

Applicant's #1	Map	11	6
Applicant's #2	Well locations	11	6
Applicant's #3	O. C. C. file	11	7
Applicant's #4	March, 1973 production	11	8
Applicant's #5	Monthly production curve	11	8
Applicant's #6	Log	11	8
Applicant's #7	Temporary tracer survey	11	8

dearnley, meier & mc cormick

209 SIMMS BLDG. • P.O. BOX 1092 • PHONE 243-6691 • ALBUQUERQUE, NEW MEXICO 87103
1216 FIRST NATIONAL BANK BLDG. EAST • ALBUQUERQUE, NEW MEXICO 87108

1
2
3
4
5
6
7
8
9
10
11
12
13
14
15
16
17
18
19
20
21
22
23
24
25

BEFORE THE
NEW MEXICO OIL CONSERVATION COMMISSION
OIL CONSERVATION COMMISSION CONFERENCE ROOM
STATE LAND OFFICE BUILDING
SANTA FE, NEW MEXICO
May 9, 1973

EXAMINER HEARING

IN THE MATTER OF:

Application of M. W. Staples for
an unorthodox oil well location,
Eddy County, New Mexico.

Case No. 4943

BEFORE: Daniel S. Nutter
Examiner

TRANSCRIPT OF HEARING

1 MR. NUTTER: We will call next Case 4943.

2 MR. CARR: Case 4943, Application of M. W. Staples for
3 an unorthodox oil well location, Eddy County, New Mexico.

4 MR. NUTTER: We have received a request from the
5 Applicant in this case that the case be continued to May 23.
6 It will be continued to the Examiner's Hearing scheduled for
7 this same place at 9:00 A.M. May, 23, 1973.

8

9

10

11

12

13

14

15

16

17

18

19

20

21

22

23

24

25

1 STATE OF NEW MEXICO)
 2) ss.
 3 COUNTY OF BERNALILLO)

4 I, JOHN DE LA ROSA, a Certified Shorthand Reporter, do
 5 hereby certify that the foregoing and attached Transcript of
 6 Hearing before the New Mexico Oil Conservation Commission was
 7 reported by me; and that the same is a true and correct record
 8 of the said proceedings, to the best of my knowledge, skill
 9 and ability.

10 
 11 CERTIFIED SHORTHAND REPORTER

12
 13
 14
 15
 16
 17
 18
 19
 20
 21
 22
 23 I do hereby certify that the foregoing is
 24 a complete record of the proceedings in
 the Examiner hearing of Case No. 4943,
 heard by me on 5/9, 1973.

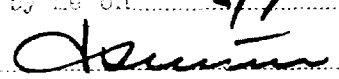
25  Examiner
 New Mexico Oil Conservation Commission

BEFORE THE
NEW MEXICO OIL CONSERVATION COMMISSION
OIL CONSERVATION COMMISSION CONFERENCE ROOM
STATE LAND OFFICE BUILDING
SANTA FE, NEW MEXICO
Wednesday, April 11, 1973

EXAMINER HEARING

IN THE MATTER OF:

Application of M.W. Staples for
an unorthodox oil well location,
Eddy County, New Mexico.

Case No. 4943

BEFORE: Elvis A. Utz

TRANSCRIPT OF HEARING

1 MR. UTZ: Case 4943.

2 MR. CARR: Case 4943, application of M.W. Staples
3 for an unorthodox oil well location, Eddy County, New
4 Mexico.

5 MR. UTZ: We have had a request from counsel for
6 Mr. Staples requesting that this case be continued to
7 May 9, 1973. The case will be continued to that date.

8 As for the rest of the docket, we will call the
9 cases in order.

10 * * * * *

11 STATE OF NEW MEXICO)
12) ss.
13 COUNTY OF BERNALILLO)

14 I, JANET RUSSELL, a Certified Shorthand Reporter, do
15 hereby certify that the foregoing and attached Transcript of
16 Hearing before the New Mexico Oil Conservation Commission was
17 reported by me; and that the same is a true and correct record
18 of the said proceedings; to the best of my knowledge, skill,
19 and ability.

20 Janet Russell
21 CERTIFIED SHORTHAND REPORTER

22
23 I do hereby certify that the foregoing is
24 a complete record of the proceedings in
25 the Examiner hearing of Case No. 4943
heard by me on April 11, 1973
W. D. M., Examiner
New Mexico Oil Conservation Commission



OIL CONSERVATION COMMISSION

STATE OF NEW MEXICO

P. O. BOX 2088 - SANTA FE

87501

GOVERNOR
BRUCE KING
CHAIRMAN

**LAND COMMISSIONER
ALEX J. ARMIJO
MEMBER**

STATE GEOLOGIST
A. L. PORTER, JR.
SECRETARY - DIRECTOR

June 25, 1973

Mr. A.J. Losee
Losee & Carson
Attorneys at Law
Post Office Box 239
Artesia, New Mexico 88210

Re: Case No. 4943
Order No. R-4559
Applicant:
M. W. Staples

Dear Sir:

Enclosed herewith are two copies of the above-referenced Commission order recently entered in the subject case.

Very truly yours,

A. L. Porter, Jr.

A. L. PORTER, Jr.
Secretary-Director

ALP/ir

Copy of order also sent to:

Hobbs OCC x
Artesia OCC x
Aztec OCC

Other _____

BEFORE THE OIL CONSERVATION COMMISSION
OF THE STATE OF NEW MEXICO

IN THE MATTER OF THE HEARING
CALLED BY THE OIL CONSERVATION
COMMISSION OF NEW MEXICO FOR
THE PURPOSE OF CONSIDERING:

CASE NO. 4943
Order No. R-4559

APPLICATION OF M. W. STAPLES FOR
AN UNORTHODOX OIL WELL LOCATION,
EDDY COUNTY, NEW MEXICO.

ORDER OF THE COMMISSION

BY THE COMMISSION:

This cause came on for hearing at 9 a.m. on May 23, 1973,
at Santa Fe, New Mexico, before the Examiner Elvis A. Utz.

NOW, on this 25th day of June, 1973, the Commission, a
quorum being present, having considered the testimony, the
record, and the recommendations of the Examiner, and being fully
advised in the premises,

FINDS:

(1) That due public notice having been given as required
law, the Commission has jurisdiction of this cause and the
subject matter thereof.

(2) That the applicant, M. W. Staples, is the operator of
the Vanderventer Well No. 2, authorized by Order No. R-3341, as
a waterflood injection well in the Artesia Pool, Eddy County,
New Mexico.

(3) That the applicant seeks authority to produce oil
from said well located at an unorthodox location 1310 feet from
the North line and 1330 feet from the East line of Section 20,
Township 18 South, Range 28 East, NMPM, Eddy County, New Mexico.

(4) That the proposed unorthodox location will provide an
efficient oil producing pattern.

(5) That approval of the subject application will afford
the applicant the opportunity to produce his just and equitable
share of the oil in the Artesia Pool, and will otherwise prevent
waste and protect correlative rights.

-2-

Case No. 4943
Order No. R-4559

(6) That Order No. R-3341 should be superseded.

IT IS THEREFORE ORDERED:

(1) That the applicant, M. W. Staples, is hereby authorized to produce oil from his Vanderverter Well No. 2, located 1310 feet from the North line and 1330 feet from the East line of Section 20, Township 18 South, Range 28 East, NMPM, Artesia Pool, Eddy County, New Mexico.

(2) That Order No. R-3341 is hereby superseded.

(3) That jurisdiction of this cause is retained for the entry of such further orders as the Commission may deem necessary.

DONE at Santa Fe, New Mexico, on the day and year hereinabove designated.

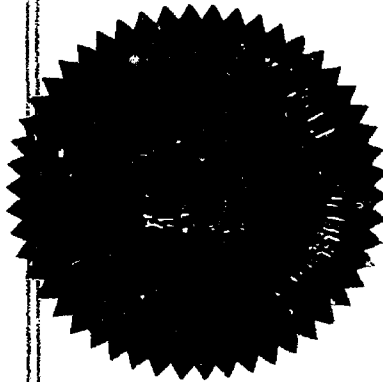

STATE OF NEW MEXICO
OIL CONSERVATION COMMISSION

I. R. Trujillo
I. R. TRUJILLO, Chairman

ALEX J. ARMIJO, Member

A. L. Porter, Jr.
A. L. PORTER, Jr., Member & Secretary

S E A L

ac/

June 4949
Grand 5-22-73
June 5-25-73

Account of the Shipton on the
Ogwood. T.L.D. and NSL for
their 1310' N
+ 1330' E line. 20.18S-28E.
This was used in injection well
operated by P-4341 and
Charles Ray during oil.

Therrell

(s) Extend the West Sawyer-San Andres Pool in Lea County, New Mexico, to include therein:

TOWNSHIP 9 SOUTH, RANGE 37 EAST, NMPM
Section 22: SE/4
Section 23: E/2 SW/4

(t) Extend the West Tres Papalotes-Pennsylvanian Pool in Lea County, New Mexico, to include therein:

TOWNSHIP 14 SOUTH, RANGE 34 EAST, NMPM
Section 29: NW/4

(u) Extend the Twin Lakes-San Andres Pool in Chaves County, New Mexico, to include therein:

TOWNSHIP 9 SOUTH, RANGE 28 EAST, NMPM
Section 1: SE/4 NW/4 and NE/4 SW/4

CASE 4943: (Continued from the May 9, 1973 Examiner Hearing)

Application of M. W. Staples for an unorthodox oil well location, Eddy County, New Mexico. Applicant, in the above-styled cause, seeks authority to produce oil from his Vanderverter Well No. 2 located 1310 feet from the North line and 1330 feet from the East line of Section 20, Township 18 South, Range 28 East, Artesia Pool, Eddy County, New Mexico. Said well was drilled as an injection well at said location pursuant to authority granted by Order No. R-3341.

A. J. LOSEE
JOEL M. CARSON

LAW OFFICES
LOSEE & CARSON, P.A.
300 AMERICAN HOME BUILDING
P. O. DRAWER 239
ARTESIA, NEW MEXICO 88210

AREA CODE 505
746-3508

4 May 1973

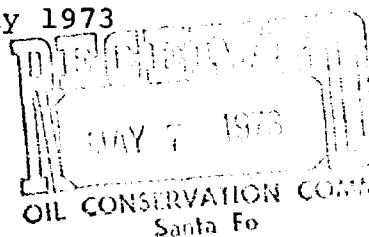

Mr. Daniel S. Nutter
Oil Conservation Commission
P. O. Box 2088
Santa Fe, New Mexico 87501

*File
Case 4943*

Dear Dan:

This will confirm my telephone request and your continuance of the application of M. W. Staples for an unorthodox oil well location, Eddy County, New Mexico, from May 9, 1973, to May 23, 1973.

Very truly yours,

LOSEE & CARSON, P.A.

A handwritten signature in dark ink, appearing to read "A. J. Losee".
A. J. Losee

AJL:jw

cc: Mr. M. W. Staples
Mr. Raymond Lamb

DOCKET: EXAMINER HEARING - WEDNESDAY - MAY 9, 1973

9 A.M. - OIL CONSERVATION COMMISSION CONFERENCE ROOM
STATE LAND OFFICE BUILDING - SANTA FE, NEW MEXICO

The following cases will be heard before Daniel S. Nutter, Examiner, or Elvis A. Utz, Alternate Examiner:

- ALLOWABLE: (1) Consideration of the allowable production of gas for June, 1973, from seventeen prorated pools in Lea, Eddy, Roosevelt and Chaves Counties, New Mexico;
- (2) Consideration of the allowable production of gas from nine prorated pools in San Juan, Rio Arriba, and Sandoval Counties, New Mexico, for June, 1973.

CASE 4943: (Continued from the April 11, 1973 Examiner Hearing)

Application of M. W. Staples for an unorthodox oil well location, Eddy County, New Mexico. Applicant, in the above-styled cause, seeks authority to produce oil from his Vanderventer Well No. 2 located 1310 feet from the North line and 1330 feet from the East line of Section 20, Township 18 South, Range 28 East, Artesia Pool, Eddy County, New Mexico. Said well was drilled as an injection well at said location pursuant to authority granted by Order No. R-3341.

CASE 4928: (Continued from the April 11, 1973, Examiner Hearing)

Application of Union Oil Company of California for compulsory pooling, Eddy County, New Mexico. Applicant, in the above-styled cause, seeks an order pooling all mineral interests in the Morrow formation underlying all of Section 11, Township 21 South, Range 25 East, Catclaw Draw-Morrow Gas Pool, Eddy County, New Mexico, to be dedicated to the Atlantic Richfield Oil Company Pure-Federal Well No. 11 located in Unit K of said Section 11. Applicant further seeks a provision for the payment of proper costs to be borne by applicant for such well and the related well equipment, a provision for allocation of actual operating costs, and the establishment of charges for supervision of such well and the designation of an operator thereof; and for such other relief as proper. Also to be considered will be the risk involved in drilling the subject well.

CASE 4932: (Continued from the April 11, 1973, Examiner Hearing)

Application of Atlantic Richfield Company for a non-standard proration unit, Eddy County, New Mexico. Applicant, in the above-styled cause, seeks approval for a 340.94-acre non-standard gas proration unit comprising the W/2 of Section 11, Township 21 South, Range 25 East, Catclaw Draw-Morrow Gas Pool, Eddy County, New Mexico, to be dedicated to its Pure Federal Well No. 1 located in Unit K of said Section 11.

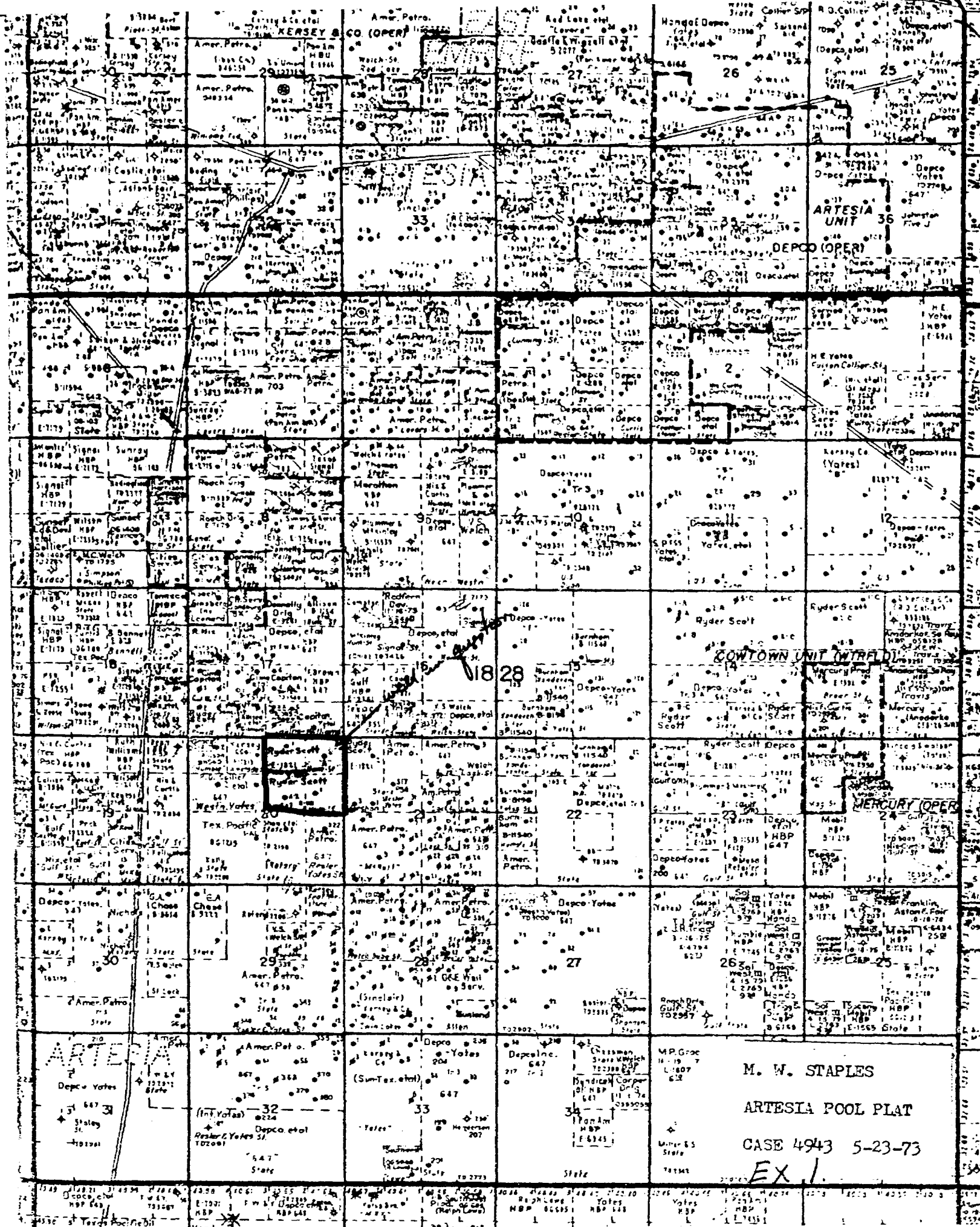

Artesia Pool - Queen - Grayburg & San Andres

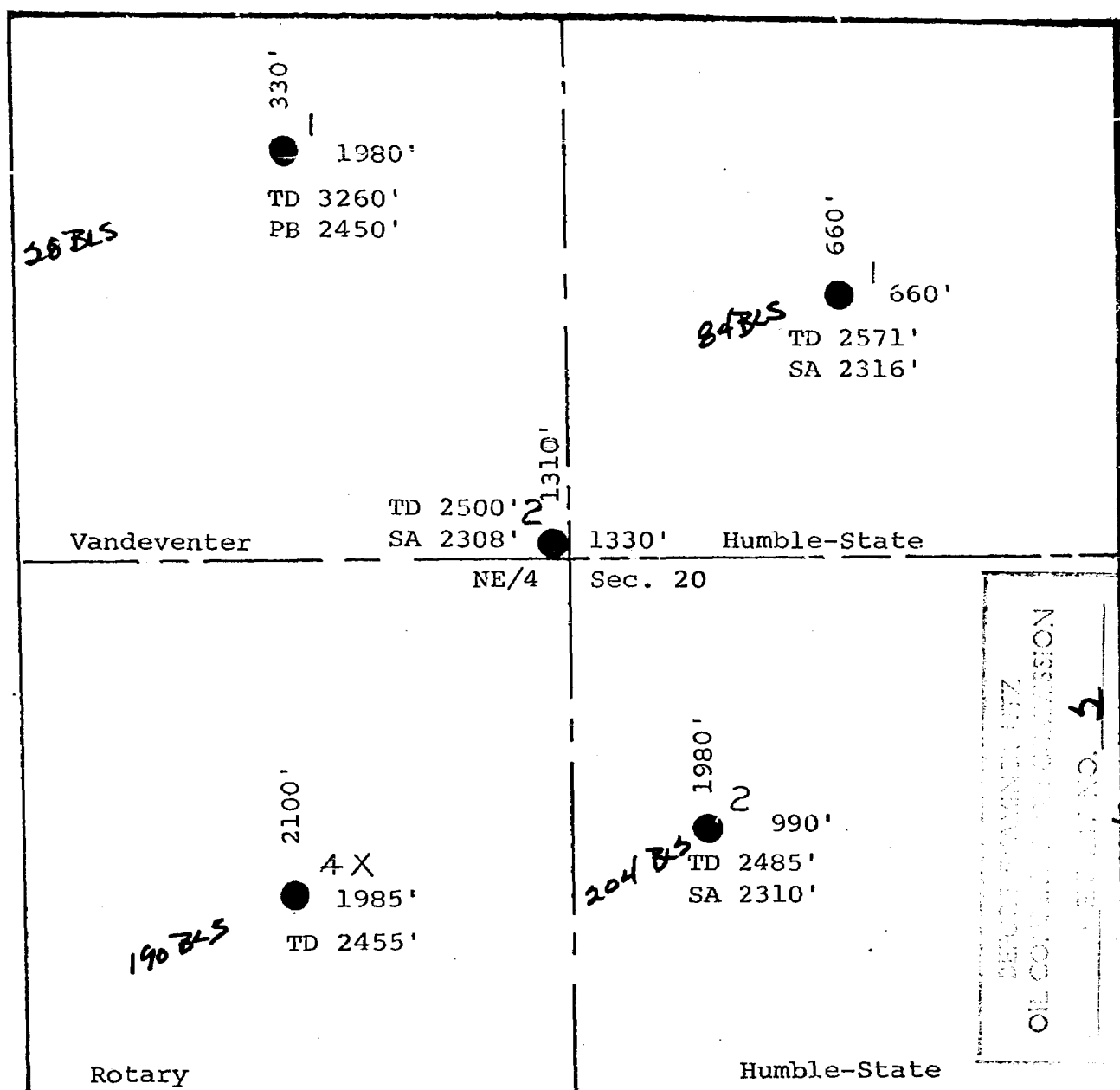

5/6 BLS
Total

transformation

Sec. 20, Township 18 South, Range 28 East
Eddy County, New Mexico

Reg. Geol. Engr. #929

April 10, 1973

TOTAL w/ Vanderweide #2
1000 BLS ±

<1053 - MARCH 1973>^N

N. Raymond Lamb

Case 4943

$$E_x \approx$$

NEW MEXICO OIL CONSERVATION COMMISSION
WELL LOCATION AND ACREAGE DEDICATION PLAT

Form C-102
Supersedes C-128
Effective 1-1-65

All distances must be from the outer boundaries of the Section.

Operator Ryder Scott Management Company		Lease State Vanderwater		Well No. 2
Unit Letter 0	Section 00	Township 1S South	Range 23 East	County McKenzie
Actual Footage Location of Well: 1310 feet from the North line and 1320 feet from the East line				
Ground Level Elev. 3327	Producing Formation Grayburg San Andres		Pool Artesia	Dedicated Acreage: Acres

1. Outline the acreage dedicated to the subject well by colored pencil or hachure marks on the plat below.
2. If more than one lease is dedicated to the well, outline each and identify the ownership thereof (both as to working interest and royalty).
3. If more than one lease of different ownership is dedicated to the well, have the interests of all owners been consolidated by communitization, unitization, force-pooling, etc?

☐ Yes ☐ No If answer is "yes," type of consolidation _____

If answer is "no," list the owners and tract descriptions which have actually been consolidated. (Use reverse side of this form if necessary.) _____

No allowable will be assigned to the well until all interests have been consolidated (by communitization, unitization, forced-pooling, or otherwise) or until a non-standard unit, eliminating such interests, has been approved by the Commission.

315 E		1310'
00		1320'
00		Case 4943 EX 3

CERTIFICATION

I hereby certify that the information contained herein is true and complete to the best of my knowledge and belief.

Joann S. Halsey
Name

Agent

Position

Ryder Scott Management Co.
Company

Nov. 2, 1967
Date

Date

BEFORE EXAMINER UNIT
OIL CONSERVATION COMMISSION

UNIT NO. **3**

CASE NO. **4943**

Submitted by **ARWOOD**

Hearing Date **5/23/73**

I hereby certify that the well location shown on this plat was plotted from field notes of actual surveys made by me or under my supervision, and that the same is true and correct to the best of my knowledge and belief.

Date Surveyed

October 30, 1967

Registered Professional Engineer
and/or Land Surveyor

Joann S. Halsey
Certificate No.

7-11-3-20-542

0 330 660 990 1320 1650 1980 2310 2640 2000 1500 1000 500

NO. OF COPIES RECEIVED	1/2
DISTRIBUTION	
SANTA FE	1/2
FILE	1/2
U.S.G.S.	2
LAND OFFICE	1/2
OPERATOR	1/2

NEW MEXICO OIL CONSERVATION COMMISSION

30-015-20103

Form C-101
Revised 1-4-65

5A. Indicate Type of Lease STATE <input checked="" type="checkbox"/> FEE <input type="checkbox"/>
5. State Oil & Gas Lease No. E 1821
7. Unit Agreement Name
8. Firm or Lease Name Vandeventer State
9. Well No. 2
10. Field and Pool, or Wildcat Artesia Pool
12. County Eddy
19. Proposed Depth 2500'
19A. Formation Grayburg S. A.
20. Rotary or C.T. Rotary
21. Elevations (Show whether D.F., R.T., etc.) 3597 GL
21A. Kind & Status Plug. Bond \$10,000 Blanket
21B. Drilling Contractor W E K Drig. Co.
22. Approx. Date Work will start on approval

APPLICATION FOR PERMIT TO DRILL, DEEPEN, OR PLUG BACK

1a. Type of Work	1b. Type of Well DRILL <input checked="" type="checkbox"/> DEEPEN <input type="checkbox"/> PLUG BACK <input type="checkbox"/> OIL WELL <input type="checkbox"/> GAS WELL <input type="checkbox"/> OTHER Injection well <input type="checkbox"/> SINGLE ZONE <input type="checkbox"/> MULTIPLE ZONE <input type="checkbox"/>
2. Name of Operator Ryder Scott Management Company	3. Address of Operator 922 - 8th Street, Wichita Falls, Texas 76301
4. Location of Well UNIT LETTER B LOCATED 1310 FEET FROM THE North LINE 1330 FEET FROM THE East LINE OF SEC. 20 T.18S R.28E N.1/4	5. Location of Well UNIT LETTER B LOCATED 1310 FEET FROM THE North LINE 1330 FEET FROM THE East LINE OF SEC. 20 T.18S R.28E N.1/4
6. Location of Well UNIT LETTER B LOCATED 1310 FEET FROM THE North LINE 1330 FEET FROM THE East LINE OF SEC. 20 T.18S R.28E N.1/4	6. Location of Well UNIT LETTER B LOCATED 1310 FEET FROM THE North LINE 1330 FEET FROM THE East LINE OF SEC. 20 T.18S R.28E N.1/4

23. PROPOSED CASING AND CEMENT PROGRAM

SIZE OF HOLE	SIZE OF CASING	WEIGHT PER FOOT	SETTING DEPTH	SACKS OF CEMENT	EST. TOP
11"	8-5/8"	20#	500'	Circulated	
7-7/8"	4-1/2"	9.5#	2500'	150 sx	1735'

Well to be drilled for dual injection. Four zones, Loco Hills, Metex, Premier and Lovington, will be perforated, 4 SPF, and treated separately w/acid w/packers. Loco Hills zone will be separated by 2-3/8" tbg. & packer and water will be injected into the other three zones, unseparated, down the annulus.

APPROVAL VALID
FOR 90 DAYS UNLESS
DRILLING COMMENCED,

EXPIRES 2-12-68

R-3341

IN ABOVE SPACE DESCRIBE PROPOSED PROGRAM: IF PROPOSAL IS TO DEEPEN OR PLUG BACK, GIVE DATA ON PRESENT PRODUCTIVE ZONE AND PROPOSED NEW PRODUCTIVE ZONE. GIVE BLOWOUT PREVENTER PROGRAM, IF ANY.

I hereby certify that the information above is true and complete to the best of my knowledge and belief.

Signed James S. Halber Title Agent Date Nov. 2, 1967

(This space for State Use)

APPROVED BY W. A. Gressitt TITLE OIL AND GAS INSPECTOR DATE NOV 14 1967

CONDITIONS OF APPROVAL, IF ANY:

INSTRUCTIONS

This form is to be filed with the appropriate District Office of the Commission not later than 20 days after the completion of any newly-drilled or deepened well. It shall be accompanied by one copy of all electrical and radio-activity logs run on the well and a summary of all special tests conducted, including drill stem tests. All depths reported shall be measured depths. In the case of directionally drilled wells, true vertical depths shall also be reported. For multiple completions, Items 30 through 34 shall be reported for each zone. The form is to be filed in quintuplicate except on state land, where six copies are required. See Rule 1105.

INDICATE FORMATION TOPS IN CONFORMANCE WITH GEOGRAPHICAL SECTION OF STATE

Southeastern New Mexico

Northwestern New Mexico

T. Anhy _____	T. Canyon _____	T. Ojo Alamo _____	T. Penn. "B" _____
T. Salt _____	T. Strawn _____	T. Kirtland-Fruitland _____	T. Penn. "C" _____
B. Salt _____	T. Atoka _____	T. Pictured Cliffs _____	T. Penn. "D" _____
T. Yates _____	T. Miss _____	T. Cliff House _____	T. Leadville _____
T. 7 Rivers _____	T. Devonian _____	T. Menefee _____	T. Madison _____
T. Queen _____	T. Silurian _____	T. Point Lookout _____	T. Elbert _____
T. Grayburg _____	T. Montoya _____	T. Mancos _____	T. McCracken _____
T. San Andres _____	T. Simpson _____	T. Gallup _____	T. Ignacio Qtzite _____
T. Glorieta _____	T. McKee _____	Base Greenhorn _____	T. Granite _____
T. Paddock _____	T. Ellenburger _____	T. Dakota _____	T. _____
T. Blinberry _____	T. Gr. Wash _____	T. Morrison _____	T. _____
T. Tubb _____	T. Granite _____	T. Todilto _____	T. _____
T. Drinkard _____	T. Delaware Sand _____	T. Entrada _____	T. _____
T. Abo _____	T. Dore Springs _____	T. Wingate _____	T. _____
T. Wolfcamp _____	T. _____	T. Chinle _____	T. _____
T. Penn. _____	T. _____	T. Permian _____	T. _____
T. Cisco (Bough C) _____	T. _____	T. Penn. "A" _____	T. _____

FORMATION RECORD (Attach additional sheets if necessary)

From	To	Thickness in Feet	Formation	From	To	Thickness in Feet	Formation
1996	2008	12	Loco Hills - oil show				
2126	2131	5	Metex - oil show				
2179	2184	5	Upper Premier- oil show				
2258	2262	4	Main Premier - oil show				
2274	2284	10	Main Premier - oil show				
2418	2424	6	Lovington - oil show				

NO. OF COPIES RECEIVED	
DISTRIBUTION	
SANTA FE	
FILE	
U.S.G.S.	
LAND OFFICE	
OPERATOR	

**NEW MEXICO OIL CONSERVATION COMMISSION
WELL COMPLETION OR RECOMPLETION REPORT AND LOG**

Form C-105
Revised 1-1-65

5a. Indicate Type of Lease	
State <input checked="" type="checkbox"/>	Fee <input type="checkbox"/>
5. State Oil & Gas Lease No.	
E-1821	

1. TYPE OF WELL		7. Unit Agreement Name	
OIL WELL <input type="checkbox"/> GAS WELL <input type="checkbox"/> DRY <input type="checkbox"/> OTHER <u>Injection well</u>			
2. TYPE OF COMPLETION		8. Farm or Lease Name	
NEW WELL <input checked="" type="checkbox"/> WORK OVER <input type="checkbox"/> DEEPEN <input type="checkbox"/> PLUG BACK <input type="checkbox"/> DIFF. RECVR. <input type="checkbox"/> OTHER <input type="checkbox"/>		Vandevanter State	
3. Name of Operator		9. Well No.	
Ryder Scott Management Company		2	
4. Address of Operator		10. Field and Pool, or Wildcat	
922 - 8th Street, Wichita Falls, Texas 76301		Artesia Pool	

UNIT LETTER <u>B</u>	LOCATED <u>1310</u> FEET FROM THE <u>North</u> LINE AND <u>1330</u> FEET FROM	12. County
THE EAST LINE OF SEC. <u>20</u>	TWP. <u>18S</u> RGE. <u>28E</u>	<u>Eddy</u>

15. Date Spudded	16. Date T.D. Reached	17. Date Compl. (Ready to Prod.)	18. Elevations (DF, RKB, RT, GR, etc.)	19. Elev. Casinghead
11/29/67	12/5/67	1/5/68	3604 KB 3697 GL	3699
20. Total Depth	21. Plug Back T.D.	22. If Multiple Compl., How Many	23. Intervals Drilled By	24. Was Directional Survey Made
2500			Rotary Tools <u>X</u> Cable Tools	
24. Producing Interval(s), of this completion - Top, Bottom, Name				
2016-30 Loco Hills; 2124-28 Metex; 2200-05 Upper Premier; 2292-2306 Premier; 2446-54 Lovington				
25. Type Electric and Other Logs Run				27. Was Well Cored
Gamma Ray - Acoustilog				Yes

28. CASING RECORD (Report all strings set in well)					
CASING SIZE	WEIGHT LB./FT.	DEPTH SET	HOLE SIZE	CEMENTING RECORD	AMOUNT PULLED
8-5/8"	24	505	11"	210 sax-circulated	None
4-1/2"	9.5	2500	7-7/8"	325 sax	None

29. LINER RECORD					30. TUBING RECORD		
SIZE	TOP	BOTTOM	SACKS CEMENT	SCREEN	SIZE	DEPTH SET	PACKER SET
					2-3/8	2366	2266

31. Perforation Record (Interval, size and number) 2016-20; 2022-30; 2124-28; 2200-05; 2292-96; 2302-06; 2446-54. All 4 SPF, .5" bullets. Total 148 holes.	32. ACID, SHOT, FRACTURE, CEMENT SQUEEZE, ETC.	
	DEPTH INTERVAL	AMOUNT AND KIND MATERIAL USED
	2016-30	200 gal. BDA
	2124-28	200 gal. BDA
	2200-05	200 gal. BDA
	2292-2306	200 gal. BDA
33. PRODUCTION 2446-54 200 gal. BDA		

Date First Production		Production Method (Flowing, gas lift, pumping - Size and type pump)				Well Status (Prod. or Shut-in)	
Injection well							
Date of Test	Hours Tested	Choke Size	Prod'n. For Test Period	Oil - Bbl.	Gas - MCF	Water - Bbl.	Gas - Oil Ratio
Flow Tubing Press.	Casing Pressure	Calculated 24-Hour Rate	Oil - Bbl.	Gas - MCF	Water - Bbl.	Oil Gravity - API (Corr.)	

34. Disposition of Gas (Sold, used for fuel, vented, etc.)	Test Witnessed By

35. List of Attachments
Gamma Ray - Acoustilog (Deviation Survey to follow)

36. I hereby certify that the information shown on both sides of this form is true and complete to the best of my knowledge and belief.		
SIGNED <u>Maude Rowland</u>	TITLE <u>Ass't. Prod. Supt.</u>	DATE <u>1/19/68</u>

NO. OF COPIES RECEIVED	
DISTRIBUTION	
SANTA FE	
FILE	
U.S.G.S.	
LAND OFFICE	
OPERATOR	

NEW MEXICO OIL CONSERVATION COMMISSION

Form C-103
Supersedes Old
C-102 and C-103
Effective 1-1-65

<p align="center">SUNDRY NOTICES AND REPORTS ON WELLS (DO NOT USE THIS FORM FOR PROPOSALS TO DRILL OR TO DEEPEN OR PLUG BACK TO A DIFFERENT RESERVOIR. USE "APPLICATION FOR PERMIT" (FORM C-101) FOR SUCH PROPOSALS.)</p>		<p>5a. Indicate Type of Lease State <input checked="" type="checkbox"/> Fee <input type="checkbox"/></p>
<p>1. <input type="checkbox"/> OIL WELL <input type="checkbox"/> GAS WELL <input type="checkbox"/> OTHER: Injection well</p>		<p>5. State Oil & Gas Lease No. E-1821</p>
<p>2. Name of Operator Ryder Scott Management Company</p>		<p>7. Unit Agreement Name</p>
<p>3. Address of Operator 922 - 8th Street, Wichita Falls, Texas 76301</p>		<p>8. Farm or Lease Name Vandeventer State</p>
<p>4. Location of well UNIT LETTER E, 1310 FEET FROM THE North LINE AND 1330 FEET FROM THE East LINE, SECTION 20 TOWNSHIP 18S RANGE 28E NMPM.</p>		<p>9. Well No. 2</p>
<p>15. Elevation (Show whether DF, RT, GR, etc.) 3597 GL</p>		<p>10. Field and Pool, or Wildcat Artesia Pool</p>
		<p>12. County Eddy</p>

16. Check Appropriate Box To Indicate Nature of Notice, Report or Other Data

NOTICE OF INTENTION TO:		SUBSEQUENT REPORT OF:	
PERFORM REMEDIAL WORK <input type="checkbox"/>	PLUG AND ABANDON <input type="checkbox"/>	REMEDIAL WORK <input type="checkbox"/>	ALTERING CASING <input type="checkbox"/>
TEMPORARILY ABANDON <input type="checkbox"/>	CHANGE PLANS <input type="checkbox"/>	COMMENCE DRILLING OPER. <input checked="" type="checkbox"/>	PLUG AND ABANDONMENT <input type="checkbox"/>
PULL OR ALTER CASING <input type="checkbox"/>	OTHER <input type="checkbox"/>	CASING TEST AND CEMENT JOB <input type="checkbox"/>	OTHER <input type="checkbox"/>

17. Describe Proposed or Completed Operations (Clearly state all pertinent details, and give pertinent dates, including estimated date of starting any proposed work) SEE RULE 1103.

Well spudded at 8:00 P. M. on 11/29/67.

18. I hereby certify that the information above is true and complete to the best of my knowledge and belief.

SIGNED <u><i>James S. Halsey</i></u>	TITLE <u>Agent</u>	DATE <u>1/8/68</u>
APPROVED BY _____	TITLE _____	DATE _____
CONDITIONS OF APPROVAL, IF ANY:		

NO. OF COPIES RECEIVED	
DISTRIBUTION	
SANTA FE	
FILE	
U.S.G.S.	
LAND OFFICE	
OPERATOR	

NEW MEXICO OIL CONSERVATION COMMISSION

Form C-103
Supersedes Old
C-102 and C-103
Effective 1-1-65

5a. Indicate Type of Lease State <input checked="" type="checkbox"/> Fee <input type="checkbox"/>	
5. State Oil & Gas Lease No. E-1821	
SUNDY NOTICES AND REPORTS ON WELLS <small>(DO NOT USE THIS FORM FOR PROPOSALS TO DRILL OR TO DEEPEN OR PLUG BACK TO A DIFFERENT RESERVOIR. USE "APPLICATION FOR PERMIT - 1" (FORM C-101) FOR SUCH PROPOSALS.)</small>	
1. <input type="checkbox"/> OIL WELL <input type="checkbox"/> GAS WELL <input type="checkbox"/> OTHER- Injection Well	7. Unit Agreement Name
2. Name of Operator Ryder Scott Management Company	8. Farm or Lease Name Vandeventer State
3. Address of Operator 922 - 8th Street, Wichita Falls, Texas 76301	9. Well No. 2
4. Location of Well UNIT LETTER B 1310 FEET FROM THE North LINE AND 1330 FEET FROM THE East LINE, SECTION 20 TOWNSHIP 18S RANGE 28E NMPM.	10. Field and Pool, or Wildcat Artesia
15. Elevation (Show whether DF, RT, GR, etc.) 3697 GL	12. County Eddy

16. Check Appropriate Box To Indicate Nature of Notice, Report or Other Data

NOTICE OF INTENTION TO:		SUBSEQUENT REPORT OF:	
PERFORM REMEDIAL WORK <input type="checkbox"/>	PLUG AND ABANDON <input type="checkbox"/>	REMEDIAL WORK <input type="checkbox"/>	ALTERING CASING <input type="checkbox"/>
TEMPORARILY ABANDON <input type="checkbox"/>	CHANGE PLANS <input type="checkbox"/>	COMMENCE DRILLING OPNS. <input type="checkbox"/>	PLUG AND ABANDONMENT <input type="checkbox"/>
PULL OR ALTER CASING <input type="checkbox"/>	OTHER <input type="checkbox"/>	CASING TEST AND CEMENT JOBS <input checked="" type="checkbox"/>	OTHER <input type="checkbox"/>

17. Describe Proposed or Completed Operations (Clearly state all pertinent details, and give pertinent dates, including estimated date of starting any proposed work) SEE RULE 1103.

11/30/67 Ran 505' 24# 8-5/8" casing.
Cemented with 210 sacks cement-cement circulated.

12/6/67 Ran 2500' 4-1/2" 9.5# casing & cemented with 325 sax.

18. I hereby certify that the information above is true and complete to the best of my knowledge and belief.

SIGNED MacCowan TITLE Ass't. Prod. Supt. DATE 1/19/68

APPROVED BY _____ TITLE _____ DATE _____

CONDITIONS OF APPROVAL, IF ANY:

NO. OF COPIES RECEIVED	
DISTRIBUTION	
SANTA FE	
FILE	
U.S.G.S.	
LAND OFFICE	
OPERATOR	

RECEIVED

NEW MEXICO OIL CONSERVATION COMMISSION

JAN 30 1968

Form C-103
Supersedes Old
C-102 and C-103
Effective 1-1-65

O. C. C.
ARTESIA, OFFICE

5a. Indicate Type of Lease	
State <input checked="" type="checkbox"/>	Fee <input type="checkbox"/>
5. State Oil & Gas Lease No.	
E 1821	

SUNDY NOTICES AND REPORTS ON WELLS (DO NOT USE THIS FORM FOR PROPOSALS TO DRILL OR TO DEEPEN OR PLUG BACK TO A DIFFERENT RESERVOIR. USE "APPLICATION FOR PERMIT -" (FORM C-101) FOR SUCH PROPOSALS.)	
1. <input type="checkbox"/> OIL WELL <input type="checkbox"/> GAS WELL <input type="checkbox"/> OTHER- Injection Well	7. Unit Agreement Name
2. Name of Operator Ryder Scott Management Company	8. Farm or Lease Name Vandeventer State
3. Address of Operator 922-8th Street Wichita Falls, Texas 76301	9. Well No. 2
4. Location of Well UNIT LETTER B 1310 FEET FROM THE North LINE AND 1330 FEET FROM THE East LINE, SECTION 20 TOWNSHIP 18S RANGE 28E NMPM.	10. Field and Pool, or Wildcat Artesia Pool
15. Elevation (Show whether DF, RT, GR, etc.) 3597 GL	12. County Eddy

16. Check Appropriate Box To Indicate Nature of Notice, Report or Other Data	
NOTICE OF INTENTION TO:	SUBSEQUENT REPORT OF:
PERFORM REMEDIAL WORK <input type="checkbox"/>	REMEDIAL WORK <input type="checkbox"/>
TEMPORARILY ABANDON <input type="checkbox"/>	COMMENCE DRILLING OPNS. <input type="checkbox"/>
PULL OR ALTER CASING <input type="checkbox"/>	CASING TEST AND CEMENT JOB <input type="checkbox"/>
OTHER <input type="checkbox"/>	OTHER Beginning Water Injection <input checked="" type="checkbox"/>
PLUG AND ABANDON <input type="checkbox"/>	ALTERING CASING <input type="checkbox"/>
CHANGE PLANS <input type="checkbox"/>	PLUG AND ABANDONMENT <input type="checkbox"/>

17. Describe Proposed or Completed Operations (Clearly state all pertinent details, and give pertinent dates, including estimated date of starting any proposed work) SEE RULE 1103.

1-20-68 - Begin Water Injection.

Injection into Loco Hills zone through tubing; injection into Metex, Premier and Lovington zones, unseparated, down the annulus.

18. I hereby certify that the information above is true and complete to the best of my knowledge and belief.		
SIGNED <u>Don S. Halsey</u>	TITLE <u>Agent</u>	DATE <u>Jan. 29, 1968</u>
APPROVED BY _____	TITLE _____	DATE _____
CONDITIONS OF APPROVAL, IF ANY:		

NO. OF COPIES RECEIVED	5
DISTRIBUTION	
SANTA FE	/
FILE	/
U.S.G.S.	
LAND OFFICE	
OPERATOR	3+

RECEIVED RECEIVED

NEW MEXICO OIL CONSERVATION COMMISSION

JAN 30 1968

JAN 22 1968

O. C. C.

O. C. C.
ARTESIA, OFFICE

Form C-103
Supersedes Old
C-102 and C-103
Effective 1-1-65

5a. Indicate Type of Lease	
State <input checked="" type="checkbox"/>	Fee <input type="checkbox"/>
5. State Oil & Gas Lease No.	
E-1821	

SUNDY NOTICES AND REPORTS ON WELLS

(DO NOT USE THIS FORM FOR PROPOSALS TO DRILL OR TO DEEPEN OR PLUG BACK TO A DIFFERENT RESERVOIR.
USE "APPLICATION FOR PERMIT" (FORM C-101) FOR SUCH PROPOSALS.)

1. <input type="checkbox"/> OIL WELL <input type="checkbox"/> GAS WELL <input type="checkbox"/> OTHER: Injection Well		7. Unit Agreement Name
2. Name of Operator Ryder Scott Management Company		8. Farm or Lease Name Vandover State
3. Address of Operator 922 - 8th Street, Wichita Falls, Texas 76301		9. Well No. 2
4. Location of Well UNIT LETTER B 1310 FEET FROM THE North LINE AND 1330 FEET FROM THE East LINE, SECTION 20 TOWNSHIP 18S RANGE 28E NMPM.		10. Field and Pool, or Wildcat Artesia
15. Elevation (Show whether DF, RT, GR, etc.) 3697 GL		12. County Eddy

16. Check Appropriate Box To Indicate Nature of Notice, Report or Other Data	
NOTICE OF INTENTION TO:	SUBSEQUENT REPORT OF:
PERFORM REMEDIAL WORK <input type="checkbox"/>	REMEDIAL WORK <input type="checkbox"/>
TEMPORARILY ABANDON <input type="checkbox"/>	COMMENCE DRILLING OPNS. <input type="checkbox"/>
PULL OR ALTER CASING <input type="checkbox"/>	CASING TEST AND CEMENT JOB <input checked="" type="checkbox"/>
PLUG AND ABANDON <input type="checkbox"/>	ALTERING CASING <input type="checkbox"/>
CHANGE PLANS <input type="checkbox"/>	PLUG AND ABANDONMENT <input type="checkbox"/>
OTHER <input type="checkbox"/>	OTHER <input type="checkbox"/>

17. Describe Proposed or Completed Operations (Clearly state all pertinent details, and give pertinent dates, including estimated date of starting any proposed work) SEE RULE 1103.

11/30/67 Ran 505' 24# 8-5/8" casing.
Cemented with 210 sacks cement-2% CaCl.
cement circulated. WOC 18 hrs. Tested 600# for 30 min. O.K.

12/6/67 Ran 2500' 4-1/2" 9.5# casing & cemented with 325 sax.
WOC 18 hrs. Tested 1500# for 30 min. O.K.

18. I hereby certify that the information above is true and complete to the best of my knowledge and belief.

SIGNED

W. A. Gressett

TITLE Ass't. Prod. Supt.

DATE 1/19/68

APPROVED BY

W. A. Gressett

TITLE

FEB 1 1968

DATE

FEB 1 1968

CONDITIONS OF APPROVAL, IF ANY:

NO. OF COPIES RECEIVED	
DISTRIBUTION	
SANTA FE	
FILE	
U.S.G.S.	
LAND OFFICE	
OPERATOR	

NEW MEXICO OIL CONSERVATION COMMISSION

Form C-103
Supersedes Old
C-102 and C-103
Effective 1-1-65

5a. Indicate Type of Lease State <input checked="" type="checkbox"/> Fee <input type="checkbox"/>
5. State Oil & Gas Lease No. E-1821

<p align="center">SUNDRY NOTICES AND REPORTS ON WELLS (DO NOT USE THIS FORM FOR PROPOSALS TO DRILL OR TO DEEPEN OR PLUG BACK TO A DIFFERENT RESERVOIR. USE "APPLICATION FOR PERMIT -" (FORM C-101) FOR SUCH PROPOSALS.)</p>	
1. OIL WELL <input type="checkbox"/> GAS WELL <input type="checkbox"/> OTHER- Injection well	7. Unit Agreement Name
2. Name of Operator Ryder Scott Management Company	8. Farm or Lease Name Vandevanter State
3. Address of Operator 922 - 8th Street, Wichita Falls, Texas 76301	9. Well No. 2
4. Location of Well UNIT LETTER <u>B</u> <u>1310</u> FEET FROM THE <u>North</u> LINE AND <u>1330</u> FEET FROM THE <u>East</u> LINE, SECTION <u>20</u> TOWNSHIP <u>18S</u> RANGE <u>28E</u> NMPM.	10. Field and Pool, or Wildcat Artesia
15. Elevation (Show whether DF, RT, GR, etc.) 3697 GL	12. County Eddy

<p align="center">16. Check Appropriate Box To Indicate Nature of Notice, Report or Other Data</p>	
<p align="center">NOTICE OF INTENTION TO:</p> <p>PERFORM REMEDIAL WORK <input type="checkbox"/></p> <p>TEMPORARILY ABANDON <input type="checkbox"/></p> <p>PULL OR ALTER CASING <input type="checkbox"/></p> <p>OTHER <input type="checkbox"/></p>	<p align="center">SUBSEQUENT REPORT OF:</p> <p>REMEDIAL WORK <input type="checkbox"/></p> <p>COMMENCE DRILLING OPNS. <input type="checkbox"/></p> <p>CASING TEST AND CEMENT JOBS <input type="checkbox"/></p> <p>OTHER <u>Reset packer</u> <input checked="" type="checkbox"/></p>

17. Describe Proposed or Completed Operations (Clearly state all pertinent details, and give pertinent dates, including estimated date of starting any proposed work) SEE RULE 1103.

February 10, 1968 Re-set packer at 2062' to isolate Loco Hills zone. Re-ran tubing - 2062'.

Began injection into well with packer at 2366' on 2-23-68; after packer set at correct depth, injection into Loco Hills zone through tubing. Injection into Metex, Premier and Lovington zones - unseparated - through casing.

18. I hereby certify that the information above is true and complete to the best of my knowledge and belief.		
SIGNED <u>Joann S. Halsey</u>	TITLE <u>Agent</u>	DATE <u>3/8/68</u>
APPROVED BY _____	TITLE _____	DATE _____
CONDITIONS OF APPROVAL, IF ANY:		

TREATMENT REPORT

DWL-404-1 PRINTED IN U.S.A.

DOWELL

DOWELL DIVISION OF THE DOW CHEMICAL COMPANY

DATE

1-5-68

WELL NAME AND NUMBER

VALLEY CENTER ST NO 2

LOCATION

SE 20-18-28

CUSTOMER REPRESENTATIVE

M. H. H. H. H.

TREATMENT NUMBER

5-13-3120

POOL

ARTESIA

FORMATION

Lago Hills

TUBING

A ☒ B ☐ C ☐

CASING

A ☐ B ☐ C ☐

ANNULUS

A ☐ B ☐ C ☐

ALLOWABLE PRESSURE

TSG: 4000 CSG: OPEN

COUNTY

EDDY

STATE

NEW MEXICO

OIL

A ☐ B ☐ C ☐

TYPE OF WELL

A ☐ B ☐ C ☐

WATER

A ☐ B ☐ C ☐

INJ.

A ☐ B ☐ C ☐

TYPE OF SERVICE

ACIDIZING

AGE OF WELL

NEW WELL ☒ REROW ☐

TOTAL DEPTH

3500

CIRC. DMT.

—

CUST. NAME

RYDER SCOTT MPT CO

CASING SIZE

4 1/2-9.5#

CASING DEPTH

9300

TUBING SIZE

2 1/2 EUE

TUBING DEPTH

STABLE

ADDRESS

922 8TH STREET
WICHITA FALLS, TEXAS 76301

LINER SIZE

—

LINER DEPTH

—

PACKER TYPE

RTSIRP

PACKER DEPTH

ZONES

OPEN HOLE

—

CSG. OR ANNUL. VOL.

—

TSG VOLUME

12

STATIC DMT.

90°F

CITY

STATE & ZIP CODE

REMARKS:

USE BRIDGE PLUG & PACKER TO STABLE
ZONES TO BE ACIDIZED

PERFORATED INTERVALS

DEPTH	NO. OF HOLES	DEPTH	NO. OF HOLES	DEPTH	NO. OF HOLES
2446-59	—	2129-28	—	—	—
2292-2306	—	2016-30	—	—	—
2200-05	—	—	—	—	—

FOR CONVERSION PURPOSES 24 BBLS EQUALS 1000 GALLONS

ARRIVED ON LOCATION: 9:00 AM

TIME	INJECTION		PRESSURE		SERVICE REMARKS
	RATE	BBLS IN	CSG.	TBG.	
10:58					START PUMP VIA TSG & SPOT 200 GAL BDA AHD @ 2446-59
11:06			OPEN	2000	BROKE FORMATION @ 2446-59 - CONTINUE FLUSH AHD W/FW
11:07				1700	PRESSURE READING
11:08	2.5	5		1300	ALL FLUSH - 1100 # ISDP - START MOVE TO NEXT ZONE
11:40					START SPOT 200 GAL BDA AHD @ 2292-2306
11:48				1650	BROKE FORMATION @ 2292-2306 - CONTINUE FLUSH AHD W/FW
11:50	2.5	5		1200	ALL FLUSH - 1000 # ISDP - START MOVE TO NEXT ZONE
12:31					START PUMP VIA TSG & SPOT 200 GAL BDA AHD @ 2200-2205
12:39				800	PUMPING INTO FORMATION 2200-2205 - CONTINUE FLUSH AHD W/FW
12:42				1300	SPEED PUMP RATE
12:43				2750	FORMATION BROKE TO 2200 # CONTINUE FW FLUSH
12:46	2.1	15		1300	ALL FLUSH - 950 # ISDP - START MOVE TO NEXT ZONE
1:16					START PUMP VIA TSG & SPOT 200 GAL BDA AHD @ 2129-28
1:22				700	FORMATION FEEDING - SPEED RATE
1:23				2300	PRESSURE BROKE TO 1900
1:24	2.5	5		1400	ALL FLUSH - 1200 # ISDP - START MOVE TO NEXT ZONE
1:51					START SPOT 200 GAL BDA AHD @ 2016-30
1:57				1900	BROKE FORMATION 2016-30 CONTINUE FW FLUSH
1:59				1600	PRESSURE READING
2:03	3.0	18		1400	ALL FLUSH - 1100 # ISDP

TIME LEFT LOCATION	AVG. LIQUID INJ. RATE	ADJ. INJ. RATE (SOLIDS INC.)	TOTAL FLUID PUMPED	PROPS AND LIQUIDS INJECTED		
				TYPE	SIZE OR PURPOSE	AMOUNT
3:00 PM	2.5 BPM	—	ACID 24 BBL 48 BBL	BDA	ACIDIZE	1000 GAL
MAX. PRESSURE	AVG. PRESSURE	FINAL PUMP IN PRESSURE	SHUT IN PRESSURE			
2750 #	—	1400 #	IMMEDIATE 15 MINUTE			
DOWELL LOCATION		DOWELL ENGINEER				
ARTESIA, NEW MEXICO		FRANK LOOP				
CALL BACK	DATE	CUSTOMER REP. CONTACTED	CUSTOMER CONSIDERED SERVICE	SATISFACTORY <input type="checkbox"/> UNSATISFACTORY <input type="checkbox"/> UNKNOWN <input type="checkbox"/>	PROD. BEFORE TREATMENT TEST <input type="checkbox"/> ALLOWABLE <input type="checkbox"/>	PROD. AFTER TREATMENT TEST <input type="checkbox"/> ALLOWABLE <input type="checkbox"/>

NO. OF COPIES RECEIVED	
DISTRIBUTION	
SANTA FE	
FILE	
U.S.G.S.	
LAND OFFICE	
OPERATOR	

NEW MEXICO OIL CONSERVATION COMMISSION

Form C-103
Supersedes Old
C-102 and C-103
Effective 1-1-65

5a. Indicate Type of Lease State <input checked="" type="checkbox"/> Fee <input type="checkbox"/>	
5. State Oil & Gas Lease No. E-1821	
SUNDY NOTICES AND REPORTS ON WELLS <small>(DO NOT USE THIS FORM FOR PROPOSALS TO DRILL OR TO DEEPEN OR PLUG BACK TO A DIFFERENT RESERVOIR. USE "APPLICATION FOR PERMIT -" (FORM C-101) FOR SUCH PROPOSALS.)</small>	
1. <input type="checkbox"/> OIL WELL <input type="checkbox"/> GAS WELL <input checked="" type="checkbox"/> OTHER- Injection well	7. Unit Agreement Name
2. Name of Operator Ryder Scott Management Company	8. Farm or Lease Name Vandeventer State
3. Address of Operator 922 - 8th Street, Wichita Falls, Texas 76301	9. Well No. 2
4. Location of Well UNIT LETTER <u>B</u> <u>1310</u> FEET FROM THE <u>North</u> LINE AND <u>1330</u> FEET FROM THE <u>East</u> LINE, SECTION <u>20</u> TOWNSHIP <u>18S</u> RANGE <u>28E</u> NMPM.	10. Field and Pool, or Wildcat Artesia
15. Elevation (Show whether DF, RT, GR, etc.) 3697 GL	12. County Eddy

Check Appropriate Box To Indicate Nature of Notice, Report or Other Data	
NOTICE OF INTENTION TO: PERFORM REMEDIAL WORK <input type="checkbox"/> PLUG AND ABANDON <input type="checkbox"/> TEMPORARILY ABANDON <input type="checkbox"/> CHANGE PLANS <input type="checkbox"/> PULL OR ALTER CASING <input type="checkbox"/> OTHER <input type="checkbox"/>	SUBSEQUENT REPORT OF: REMEDIAL WORK <input type="checkbox"/> ALTERING CASING <input type="checkbox"/> COMMENCE DRILLING OPNS. <input type="checkbox"/> PLUG AND ABANDONMENT <input type="checkbox"/> CASING TEST AND CEMENT JOBS <input type="checkbox"/> OTHER <u>Begin water injection & re-set packer</u> <input checked="" type="checkbox"/>

17. Describe Proposed or Completed Operations (Clearly state all pertinent details, and give pertinent dates, including estimated date of starting any proposed work) SEE RULE 1103.

Began injection on January. 23, 1968 with packer @ 2366.

On 2-10-68 re-set packer @ 2062 injection into the Loco Hills Zone through casing-tubing annulus & into the Metex, Premier & Lovington Zones through tubing.

NO. OF COPIES RECEIVED	
DISTRIBUTION	
SANTA FE	
FILE	
U.S.G.S.	
LAND OFFICE	
OPERATOR	

NEW MEXICO OIL CONSERVATION COMMISSION

Form C-103
Supersedes Old
C-102 and C-103
Effective 1-1-65

5a. Indicate Type of Lease State <input checked="" type="checkbox"/> Fee <input type="checkbox"/>	
5. State Oil & Gas Lease No. E-1821	
SUNDY NOTICES AND REPORTS ON WELLS (DO NOT USE THIS FORM FOR PROPOSALS TO DRILL OR TO DEEPEN OR PLUG BACK TO A DIFFERENT RESERVOIR. USE "APPLICATION FOR PERMIT -" (FORM C-101) FOR SUCH PROPOSALS.)	
1. <input type="checkbox"/> OIL WELL <input type="checkbox"/> GAS WELL <input type="checkbox"/> OTHER- Injection well	7. Unit Agreement Name
2. Name of Operator Ryder Scott Management Company	8. Farm or Lease Name Vandeventer State
3. Address of Operator 922 - 8th Street, Wichita Falls, Texas 76301	9. Well No. 2
4. Location of Well UNIT LETTER <u>B</u> <u>1310</u> FEET FROM THE <u>North</u> LINE AND <u>1330</u> FEET FROM THE <u>East</u> LINE, SECTION <u>20</u> TOWNSHIP <u>18S</u> RANGE <u>28E</u> NMPM.	10. Field and Pool, or Wildcat Artesa
15. Elevation (Show whether DF, RT, GR, etc.) 3697 GL	12. County Eddy

16. Check Appropriate Box To Indicate Nature of Notice, Report or Other Data

NOTICE OF INTENTION TO:		SUBSEQUENT REPORT OF:	
PERFORM REMEDIAL WORK <input type="checkbox"/>	PLUG AND ABANDON <input type="checkbox"/>	REMEDIAL WORK <input type="checkbox"/>	ALTERING CASING <input type="checkbox"/>
TEMPORARILY ABANDON <input type="checkbox"/>	CHANGE PLANS <input type="checkbox"/>	COMMENCE DRILLING OPNS. <input type="checkbox"/>	PLUG AND ABANDONMENT <input type="checkbox"/>
PULL OR ALTER CASING <input type="checkbox"/>	OTHER <input type="checkbox"/>	CASING TEST AND CEMENT JOBS <input type="checkbox"/>	OTHER <input checked="" type="checkbox"/> Begin water injection & re-set packer

17. Describe Proposed or Completed Operations (Clearly state all pertinent details, and give pertinent dates, including estimated date of starting any proposed work) SEE RULE 1703.

Began injection on January 23, 1968 with packer @ 2366.

On 2-10-68 re-set packer @ 2062 injection into the Loco Hills Zone through casing-tubing annulus & into the Metex, Premier & Lovington Zones through tubing.

18. I hereby certify that the information above is true and complete to the best of my knowledge and belief.

Memo

From

W.A. GRESSETT SUPER
& OIL & GAS INSP.

To: Joann

Please re-file Form C-103 on the #2 Vandeventer State showing the following.

Began injection on 1-22-68 with packer @ 2366

On 2-10-68 Re-set packer @ 2062 injection into the Loco Hills Zone through casing-tubing annulus & into the Metex, Premier & Lovington Zones through tubing.

Thanks,

W. A. Gressett

RYDER-SCOTT MANAGEMENT CO.
MAR 13 1968
RECEIVED

DATE March 13, 1968

DATE



A DIVISION OF DRESSER INDUSTRIES, INC.

Perforating Formation Collar CHART

COMPANY Ryder, Scott Mgmt. Co.
 WELL Dandevanter State No. 2
 FIELD Nichols Area
 LOCATION 1310 F.N.E. 1330 F.E.L.; 20-185-28 E
 COUNTY _____ STATE _____

ZERO POINT G.L. + 7'TOTAL DEPTH (CUST.) 2500TOTAL DEPTH (LANE WELLS) 2488PERM. DATUM G.L.

CASING RECORD

Casing Size	Wt. (Lb./Ft.)	Depth
<u>4 1/2"</u>		<u>TD</u>

PERFORATED ZONES

DEPTH	SHOTS
FROM <u>2454</u> TO <u>2446</u>	<u>32</u>
FROM <u>2356</u> TO <u>2302</u>	<u>16</u>
FROM <u>2226</u> TO <u>2222</u>	<u>16</u>
FROM <u>2205</u> TO <u>2200</u>	<u>20</u>
FROM <u>2128</u> TO <u>2124</u>	<u>16</u>
FROM <u>2030</u> TO <u>2022</u>	<u>32</u>
FROM <u>2020</u> TO <u>2116</u>	<u>16</u>
FROM _____ TO _____	
FROM _____ TO _____	

TYPE GUN "E" SIZE 3 1/4" LENGTH 2'

TYPE GUN _____ SIZE _____ LENGTH _____

DATE 12-29-67 S.O. NO. 3080 SERVICE UNIT NP1223OPERATOR Daugh WITNESSED BY Mr. Norwood

This Perforating-Formation-Collar Chart is offered to locate collars with respect to the formation and to correlate collars with open hole logs. Quality checks or calibrations are not made since the chart is not intended for formation evaluation. Only this field copy is made. No copies are retained in Lane-Wells files.

REMARKS OR OTHER DATA

No Reset to O.H. Log

FORMATION
 Gamma Intensity Increases
 →

DEPTH

COLLAR LOG
 PERFORATIONS

MARCH 1973 MONTHLY STATISTICAL REPORT
CONTINUED, ARTESIA QUEEN GRAYBURG SA

SOUTHEAST OIL SEC

DESCRIPTION				OIL		GAS		WATER		DAYS	GAS DISPOSITION		CUMULATIVE	
WELL	S	T	H	ALLOWABLE	PRODUCTION	ALLOWABLE	PRODUCTION	PRODUCTION	PROD		VOLUME	DISP	GAS O.P.	VO
SAVIS C	FEDERAL													
10	13	189	28E	31P	29			TSTM	20	30				
4P	13	189	28E	SHUT-IN										
				31	29				28					
ROGER HARRIS	TRAVIS													
10	13	189	28E	155P	114			111	50					
21	13	189	28E	186P	164			107	30					
				341	278			218	80				218P	P
				1488	993			332	434					

MACCO LTD														
MACRAIDA	STATE													
10	20	189	28E	217P	38			3200	31					
PUMBLE	STATE													
1H	20	189	28E	186P	107			60	30					
2A	20	189	28E	372P	201			750						
				558	308			810						
VERSHON	STATE													
1E	21	189	28E	31P	4			300						
20	21	189	28E	31P										
3E	21	189	28E	SHUT-IN										
				62	4			300						
POWELL	STATE													
1M	17	189	28E	SHUT-IN										
ROTARY	STATE													
2G	20	189	28E	341P	155			220	31					
5U	20	189	28E	62P	10			130	31					
6B	29	189	28E	31P	7			140	31					
7U	20	189	28E	SHUT-IN										
8U	20	189	28E											
				434	172			490						
STATE	A													
10	14	189	28E	62P	26			130	31					
20	14	189	28E	186P	139			140	31					
30	14	189	28E											
				248	165			270						
COMMINGLED WITH STATE A B AND C BATTERY														
STATE	AL													
1K	20	189	28E	SHUT-IN										
STATE	B													
3F	14	189	28E											
4E	14	189	28E	310P	200			1430	31					
14N	14	189	28E											
15P	14	189	28E	186P	150			150	31					
16E	13	189	28E	341P	255			120	31					
				837	605			1700						
COMMINGLED WITH STATE A B AND C BATTERY														
STATE	C													
10	13	189	28E	93P	70			60	31					
20	13	189	28E	62P	34			270	31					
5B	14	189	28E											
6A	14	189	28E	868P	720			270	31					
7G	14	189	28E	341P	260			150	31					
8H	14	189	28E	SHUT-IN										
9M	14	189	28E	341P	130			90	31					
10C	23	189	28E	155P	90			115	31					
11B	23	189	28E	124P	176			135	31					
				1984	1480			1090						
COMMINGLED WITH STATE A B AND C BATTERY														
ANDREVENTER	STATE													
1P	20	189	28E	775P	570			260	31					
2B	20	189	28E											
				775	570			260						
WESTERN YATES	STATE													
1F	20	189	28E	SHUT-IN										
2E	20	189	28E	186P	72			180	31					
				186	72			180						

Case 4943
EX 4

Submitted by [Signature]

ARWOOD, LTD.
VANDEVENTER STATE LEASE
#1 UNIT B, SEC. 20, T18S, R28E, EDDY COUNTY, N.M.

ACUFF & ESSER CO., N. Y. NO. 350100
Five Years by Months or Shorter, Note X 100 Horizontal,
MAX IN U. S. A.

Barrels per month

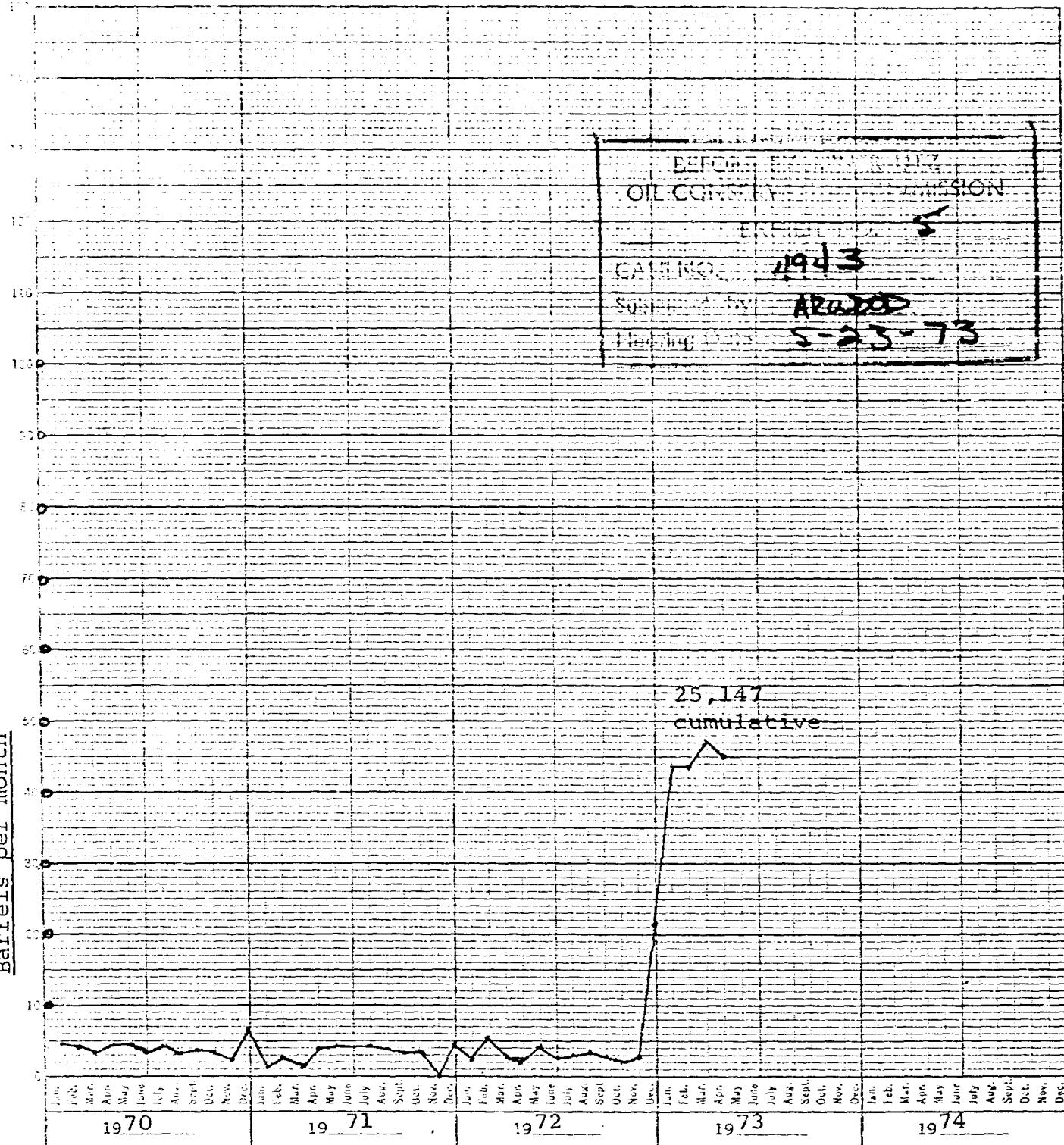

OIL PRODUCTION CURVE
BBLs. BY MONTHS

Case 4943
EX 5

DISTRIBUTION AGREEMENT

WHEREAS, pursuant to the authority granted by Order No. R-3341 entered on October 25, 1967, in Case No. 3678 of the Oil Conservation Commission of New Mexico ("Commission"), the Vandeventer No. 2 Well was drilled at a location 1,310 feet from the North line and 1,330 feet from the East line of Section 20, Township 18 South, Range 28 East, N.M.P.M. (the "Vandeventer Well"), to a total depth of 2,500 feet and utilized as an injection well in the Artesia-Nichols Waterflood Project; and

WHEREAS, the Vandeventer Well has now commenced to produce oil from the Queen-Grayburg-San Andres formations consolidated by the Commission into the Artesia Pool (collectively the "Artesia Pool"), and operator has applied to the Commission for authority to produce oil from the Artesia Pool through the Vandeventer Well at its unorthodox oil well location; and

WHEREAS, the undersigned are the owners of all of the royalty, overriding royalty, production payment, working or other leasehold interests in the NE/4 of said Section 20, and in order to prevent waste and protect correlative rights desire to enter into this agreement for the proportionate distribution of the proceeds of oil produced from the Artesia Pool through the Vandeventer Well.

NOW, THEREFORE, in consideration of the premises, One Dollar and other valuable consideration in hand paid to each of the undersigned by the other of the undersigned, the receipt and sufficiency of which are hereby acknowledged, it is agreed as follows:

1. Effective May 1, 1973, at 7:00 A.M., in lieu of all other claims, rights and interests under existing agreements or otherwise, the undersigned shall accept and receive the proceeds from the sale of oil and gas produced, saved and marketed from the Artesia Pool through the Vandeventer Well, the following decimals of 8/8ths of all production, to-wit:

Commissioner of Public Lands12500000
First National Bank of Santa Fe, Trustee00625000
Exxon Corporation01953125
Rhodia M. Christensen00356368
R. H. Siegfried, Inc.01069102
M. W. Staples & R.J. O'Connell Trustees.01425473
M. A. Waters00610350
Glenann Wilkerson00356365
W. E. Dean01562500
D. W. Hutchinson VI01562500
T. H. and Mazie Ragsdale00781250
Leonard Nichols00683592
Margaret Boller Nichol00683592
Waterflood Associates, Inc.75830783

If the interests of any of the undersigned in the NE/4 of said Section 20 are production payment interests and such interest shall be liquidated and paid before termination of this agreement, the above distribution schedule shall be revised by removing the liquidated production payment interest owner and by increasing the interest of those of the undersigned who would be entitled to such liquidated production payment interest under existing agreements.

2. The continued operation or production from the Vandeventer Well for oil and gas shall be construed and considered as the continued operation or production under existing agreements on all of the NE/4 of said Section 20.

3. This agreement shall remain in force and effect so long as oil or gas is or can be produced from the Artesia Pool through the Vandeventer Well. This agreement shall be binding upon the undersigned and shall extend to and be binding upon the respective heirs, successors and assigns of the undersigned.

4. This agreement may be executed in any number of counterparts, no one of which needs to be executed by all parties, and shall be binding upon all parties who have executed such a counterpart with the same force and effect as if all parties had signed the same document.

EXECUTED this April 30th, 1973.

Alex J. Armijo
Commissioner of Public Lands
State of New Mexico

ATTEST:

FIRST NATIONAL BANK OF SANTA
FE, TRUSTEE

Cashier

By: _____
President
Exxon Corporation

By: H. Jack Naumann
H. Jack Naumann, Division Landman
Expl. Dept., Exxon Company, U.S.A.
a Division of Exxon Corporation,
Agent and Attorney in Fact

Ruth H. Christensen

ATTEST:

R. H. SIEGFRIED, INC.

Secretary

By: _____
President

R. J. O'Connell

M. W. Staples

M. A. Waters

Glenann Wilkerson

W. E. Dean

D. W. Hutchinson VI

Mazie Ragsdale

T. H. Ragsdale

Leonard Nichols

Margaret Boller Nichol

ATTEST:

WATERFLOOD ASSOCIATES, INC.

Secretary

By: President

CORPORATE ACKNOWLEDGMENT

STATE OF TEXAS)
 : ss.
COUNTY OF MIDLAND)

The foregoing instrument was acknowledged before me
this 30th day of April, 1973, by H. Jack Naumann,
Agent and Attorney in Fact for Exxon Corporation,
a corporation, on behalf of said
corporation.

My commission expires:
June 1, 1973.

Devery B. Kitzman
Notary Public

INDIVIDUAL ACKNOWLEDGMENT

STATE OF _____)
 : ss.
COUNTY OF _____)

The foregoing instrument was acknowledged before me
this _____ day of April, 1973, by _____.

My commission expires:

Notary Public

M. W. Staples

M. A. Waters

Glenann Wilkerson

W. E. Dean

D. W. Hutchinson VI
T. H. RAGSDALE ESTATE

Mazie Ragsdale (a widow)

XXXXXXXXXXXXXXX Executrix.

Leonard Nichols

Margaret Boller Nichol

ATTEST:

WATERFLOOD ASSOCIATES, INC.

Asst. Secretary

President

CORPORATE ACKNOWLEDGMENT

STATE OF Texas)
COUNTY OF Dallas) SS.

The foregoing instrument was acknowledged before me this 20th day of April, 1973, by M. M. Staples President of Water M. Good Associates, Inc., a corporation, on behalf of said corporation.

My commission expires:

June 1, 1973

Notary Public

INDIVIDUAL ACKNOWLEDGMENT

STATE OF Texas)
COUNTY OF Dallas) SS.

The foregoing instrument was acknowledged before me
this 23 day of April, 1973, by Leopold Nichols

My commission expires:

6-1-73

Notary Public

INDIVIDUAL ACKNOWLEDGMENT

STATE OF Texas)
COUNTY OF Dallas) ss.

The foregoing instrument was acknowledged before me this
23rd day of April, 1973 by Margaret Butler Nichols

My commission expires:

6-1-73

Chas. S. Graham
Notary Public

INDIVIDUAL ACKNOWLEDGMENT

STATE OF New Mexico)
COUNTY OF Eddy) ss.

The foregoing instrument was acknowledged before me this
27th day of April, 1973 by M. A. Waters

My commission expires:

7-28-75

Theresa H. H.
Notary Public

INDIVIDUAL ACKNOWLEDGMENT

STATE OF New Mexico)
COUNTY OF Eddy)

The foregoing instrument was acknowledged before me this
4th day of May, 1973 by Mazie Ragsdale, widow of
T. H. Ragsdale, deceased; and Mazie Ragsdale, Executrix of
the Will and Estate of T. H. Ragsdale, deceased.

My commission expires:

Oct. 8, 1974

Lela E. Blacett
Notary Public

INDIVIDUAL ACKNOWLEDGMENT

STATE OF _____)
COUNTY OF _____)

The foregoing instrument was acknowledged before me this
_____ day of _____, 1973 by _____

My commission expires:

Notary Public

If the interests of any of the undersigned in the NE/4 of said Section 20 are production payment interests and such interest shall be liquidated and paid before termination of this agreement, the above distribution schedule shall be revised by removing the liquidated production payment interest owner and by increasing the interest of those of the undersigned who would be entitled to such liquidated production payment interest under existing agreements.

2. The continued operation or production from the Vandeventer Well for oil and gas shall be construed and considered as the continued operation or production under existing agreements on all of the NE/4 of said Section 20.

3. This agreement shall remain in force and effect so long as oil or gas is or can be produced from the Artesia Pool through the Vandeventer Well. This agreement shall be binding upon the undersigned and shall extend to and be binding upon the respective heirs, successors and assigns of the undersigned.

4. This agreement may be executed in any number of counterparts, no one of which needs to be executed by all parties, and shall be binding upon all parties who have executed such a counterpart with the same force and effect as if all parties had signed the same document.

EXECUTED this April ____, 1973.

ATTEST:

Cashier

ATTEST:

Secretary

ATTEST:

Asst. Secretary

Alex J. Armijo
Commissioner of Public Lands
State of New Mexico

FIRST NATIONAL BANK OF SANTA
FE, TRUSTEE

By: _____
President

HUMBLE OIL & REFINING COMPANY

By: _____
President

Rhodia M. Christensen
Rhodia M. Christensen

R. H. SIEGFRIED, INC.

By: *[Signature]*
President

R. J. O'Connell & M. W. Staples, Trustees

By: M. W. Staples

XX

M. A. Waters

Glenann Wilkerson
Glenann Wilkerson

W. E. Dean

D. W. Hutchinson VI
D. W. Hutchinson VI

Mazie Ragsdale

T. H. Ragsdale

Leonard Nichols

Margaret Boller Nichol

ATTEST:

WATERFLOOD ASSOCIATES, INC.

Secretary

By: _____
President

CORPORATE ACKNOWLEDGMENT

STATE OF Oklahoma)
COUNTY OF Tulsa) : ss.

The foregoing instrument was acknowledged before me
this 24th day of April, 1973, by R. H. Dieffler,
President of R. H. Dieffler, Inc.,
a corporation, on behalf of said
corporation.

My commission expires:
7-1-76

LeRoy Barnum
Notary Public

INDIVIDUAL ACKNOWLEDGMENT

STATE OF Texas)
COUNTY OF Dallas) : ss.

The foregoing instrument was acknowledged before me
this 19th day of April, 1973, by M. W. Staples

My commission expires:
June 1, 1973

Dorothy Lane Taylor
Notary Public

INDIVIDUAL ACKNOWLEDGMENT

STATE OF Oklahoma)
COUNTY OF Tulsa) ss.

The foregoing instrument was acknowledged before me this
24th day of April, 1973 by Rodine M. Christman

My commission expires:

7-1-76

Perry Borneman
Notary Public

INDIVIDUAL ACKNOWLEDGMENT

STATE OF Oklahoma)
COUNTY OF Tulsa) ss.

The foregoing instrument was acknowledged before me this
24th day of April, 1973 by Blanca Stillman

My commission expires:

7-1-76

Perry Borneman
Notary Public

INDIVIDUAL ACKNOWLEDGMENT

STATE OF Oklahoma)
COUNTY OF Oklahoma)

The foregoing instrument was acknowledged before me this
3rd day of May, 1973 by D. W. Hutchison

My commission expires:

12-8-75

D. W. Hutchison
Notary Public

INDIVIDUAL ACKNOWLEDGMENT

STATE OF _____)
COUNTY OF _____)

The foregoing instrument was acknowledged before me this
_____ day of _____, 1973 by _____

My commission expires:

Notary Public

R. J. ~~XXXXXXXX~~ O'Connell

M. W. Staples

M. A. Waters

Glenann Wilkerson

W. E. Dean
W. E. Dean

D. W. Hutchinson VI

Mazie Ragsdale

T. H. Ragsdale

Leonard Nichols

Margaret Boller Nichol

ATTEST:

WATERFLOOD ASSOCIATES, INC.

Secretary

By: _____
President

CORPORATE ACKNOWLEDGMENT

STATE OF _____)
: SS.
COUNTY OF _____)

The foregoing instrument was acknowledged before me
this _____ day of April, 1973, by _____,
President of _____,
a corporation, on behalf of said
corporation.

My commission expires: _____

Notary Public

INDIVIDUAL ACKNOWLEDGMENT

STATE OF TEXAS)
: SS.
COUNTY OF BELAR)

The foregoing instrument was acknowledged before me
this 4 day of April, 1973, by _____

My commission expires:
6-1-73

Ida Anderson
Notary Public

If the interests of any of the undersigned in the NE/4 of said Section 20 are production payment interests and such interest shall be liquidated and paid before termination of this agreement, the above distribution schedule shall be revised by removing the liquidated production payment interest owner and by increasing the interest of those of the undersigned who would be entitled to such liquidated production payment interest under existing agreements.

2. The continued operation or production from the Vandeventer Well for oil and gas shall be construed and considered as the continued operation or production under existing agreements on all of the NE/4 of said Section 20.

3. This agreement shall remain in force and effect so long as oil or gas is or can be produced from the Artesia Pool through the Vandeventer Well. This agreement shall be binding upon the undersigned and shall extend to and be binding upon the respective heirs, successors and assigns of the undersigned.

4. This agreement may be executed in any number of counterparts, no one of which needs to be executed by all parties, and shall be binding upon all parties who have executed such a counterpart with the same force and effect as if all parties had signed the same document.

EXECUTED this April ____, 1973.

Alex J. Armijo
Commissioner of Public Lands
State of New Mexico

ATTEST:

FIRST NATIONAL BANK OF SANTA
FE, TRUSTEE

W. H. MacGillivray
Cashier

By: Charles B. Balth
Asst. Vice President & Trust Officer

ATTEST:

HUMBLE OIL & REFINING COMPANY

Secretary

By: _____
President

Rhodia M. Christensen

ATTEST:

R. H. SIEGFRIED, INC.

Secretary

By: _____
President

R. J. ~~XXXXXX~~ O'Connell

M. W. Staples

M. A. Waters

Glenann Wilkerson

W. E. Dean

D. W. Hutchinson VI

Mazie Ragsdale

T. H. Ragsdale

Leonard Nichols

Margaret Boller Nichol

ATTEST:

WATERFLOOD ASSOCIATES, INC.

Secretary

By:

President

CORPORATE ACKNOWLEDGMENT

STATE OF New Mexico)
COUNTY OF Santa Fe) ss.

The foregoing instrument was acknowledged before me
this 2nd day of May, 1973, by Charles D. Batts,
Vice President of First National Bank of Santa Fe,
a corporation, on behalf of said
corporation.

My commission expires:

~~MY COMMISSION expires January 12, 1976~~

Leonas C de Baco
Notary Public

INDIVIDUAL ACKNOWLEDGMENT

STATE OF _____)
COUNTY OF _____) ss.

The foregoing instrument was acknowledged before me
this _____ day of April, 1973, by _____

My commission expires:

Notary Public

A. J. LOSEE
JOEL M. CARSON

LAW OFFICES
LOSEE & CARSON, P.A.
300 AMERICAN HOME BUILDING
P. O. DRAWER 239
ARTESIA, NEW MEXICO 88210

AREA CODE 505
746-3508

18 May 1973

File Case 4943

Mr. Elvis A. Utz, Examiner
Oil Conservation Commission
P. O. Box 2088
Santa Fe, New Mexico 87501

Re: M. W. Staples Application, Case No. 4943

Dear Elvis:

Enclosed, you will please find three copies of the subject application, which has been set for a continued hearing on the May 23, 1973, docket.

Very truly yours,

LOSEE & CARSON, P.A.

A. J. Losee

AJL:jw
Enclosures

cc: Mr. M. W. Staples w/enclosure
Mr. N. Raymond Lamb w/enclosure

BEFORE THE OIL CONSERVATION COMMISSION
OF THE STATE OF NEW MEXICO

IN THE MATTER OF THE APPLICATION)
OF M. W. STAPLES FOR AN)
UNORTHODOX OIL WELL LOCATION,) Case No. 4943
ARTESIA POOL, EDDY COUNTY, NEW)
MEXICO.)

APPLICATION

COMES M. W. STAPLES, by his attorneys, and in
support hereof, respectfully states:

1. Applicant is the operator of the formations comprising the Artesia Pool underlying the NE/4 of Section 20, Township 18 South, Range 28 East, N.M.P.M., Eddy County, New Mexico.
2. That by Order No. R-3341, entered on October 25, 1967, in Case No. 3678, the Oil Conservation Commission of New Mexico ("Commission") authorized the drilling of the Vandeventer No. 2 Well at a location 1,310 feet from the North line and 1,330 feet from the East line of said Section 20 as an injection well in the Artesia-Nichols Waterflood Project.
3. The said Vandeventer No. 2 Well has now commenced to produce oil from the Queen-Grayburg-San Andres formation, consolidated by the Commission into the Artesia Pool, and applicant seeks an exception from the well spacing requirements of Rule 104-C-I to permit the production of oil from said well at its unorthodox oil well location.
4. All of the interest owners in the Artesia Pool underlying the NE/4 of said Section 20 have entered into a Distribution Agreement, effective May 1, 1973, at 7:00 A.M.,

and to remain in force and effect so long as oil or gas is or can be produced from the Artesia Pool through the said Vandeventer Well, providing in effect for the pooling of said well on an acreage basis throughout the entire NE/4 of said Section 20.

5. The approval of this application will afford applicant the opportunity to produce its just and equitable share of oil in the Artesia Pool, will prevent waste and will protect correlative rights.

WHEREFORE, applicant prays that upon hearing, the Commission enter its Order authorizing applicant to produce oil from his Vandeventer Well No. 2 at its unorthodox oil well location, and for such other relief as may be just in the premises.

M. W. STAPLES

By: 

A. J. Losee, for

LOSEE & CARSON, P.A.
P. O. Drawer 239
Artesia, New Mexico 88210

Attorneys for Applicant

BEFORE THE OIL CONSERVATION COMMISSION
OF THE STATE OF NEW MEXICO

IN THE MATTER OF THE HEARING
CALLED BY THE OIL CONSERVATION
COMMISSION OF NEW MEXICO FOR
THE PURPOSE OF CONSIDERING:

CASE NO. 4943

APPLICATION OF M.W. STAPLES FOR AN
UNORTHODOX OIL WELL LOCATION, EDDY
COUNTY, NEW MEXICO.

Order No. R-4559

ORDER OF THE COMMISSION

BY THE COMMISSION:

This cause came on for hearing at 9 a.m. on May 23, 1973
at Santa Fe, New Mexico, before Examiner Elvis A. Utz.

NOW, on this day of June, 1973, the Commission,
a quorum being present, having considered the testimony, the record,
and the recommendations of the Examiner, and being fully advised
in the premises,

FINDS:

(1) That due public notice having been given as required by
law, the Commission has jurisdiction of this cause and the subject
matter thereof.

(2) That the applicant, M.W. Staples, is the operator of
the Vanderventer Well No. 2, ~~an injection well~~ authorized by
as a waterflood injection well in the
Order No. R-3341, Artesia Pool, Eddy County, New Mexico.

(3) That the applicant seeks authority to produce oil from
said well located at an unorthodox location 1310 feet from the
North line and 1330 feet from the East line of Section 20,
Township 18 South, Range 28 East, NMPM, Eddy County, New Mexico.

II II

(4) That the proposed unorthodox location ~~is~~ **WILL**
~~necessary to~~ provide an efficient oil producing pattern.

SUBJECT APPLICATION

(5) That approval of the ~~requested administrative~~
~~procedure~~ will afford the applicant the opportunity to
produce ~~its~~ ^{his} just and equitable share of the oil in the
Artesia Pool, ~~provided said wells are drilled no closer than~~
and will otherwise prevent waste and
protect correlative rights.
~~330 feet to the outer boundary of the above described unit~~
~~area nor closer than 10 feet to any quarter quarter section~~
~~or subdivision boundary.~~

(6) Order No. R-3341 should be superseded.
That

IT IS THEREFORE ORDERED:

(1) That the applicant, M. W. Staples, is hereby
authorized to produce oil from ~~its~~ ^{his} Vanderventer Well No. 2,
located ~~at~~ 1310 feet from the North line and 1330 feet
from the East line of Section 20, Township 18 South, Range
28 East, NMPM, Artesia Pool, Eddy County, New Mexico.

(2) That Order No. R-3341 is hereby superseded.

(3) That jurisdiction of this cause is retained for
the entry of such further orders as the Commission may deem
necessary.

DONE at Santa Fe, New Mexico, on the day and year
hereinabove designated.

20 Losee

2 1/2" pipe
1 1/2" pipe

N of well

200 MCF / day
50 MCF / day

Hank Willis Union of Calif.

Artesia Nichols Wt Hld Proj.

Well was auth as inj wtd @ 1000 ft
loc. Produced oil instead.

R-3341

M.W. Staples Vandeventer Well No. 2

1310 FNL 1330 FEL 20-18-28
Artesia Pool