

CASE 3700: Application of LONE  
STAR PRODUCING CO. for salt  
water disposal, Roosevelt County.

CASE 3700: Application of LONE  
STAR PRODUCING CO. for salt  
water disposal, Roosevelt County.

BEFORE THE OIL CONSERVATION COMMISSION  
OF THE STATE OF NEW MEXICO

IN THE MATTER OF THE HEARING  
CALLED BY THE OIL CONSERVATION  
COMMISSION OF NEW MEXICO FOR  
THE PURPOSE OF CONSIDERING:

CASE No. 3700  
Order No. R-3358

APPLICATION OF LONE STAR PRODUCING  
COMPANY FOR SALT WATER DISPOSAL,  
ROOSEVELT COUNTY, NEW MEXICO.

ORDER OF THE COMMISSION

BY THE COMMISSION:

This cause came on for hearing at 9 a.m. on December 20, 1967, at Santa Fe, New Mexico, before Examiner Daniel S. Nutter.

NOW, on this 22nd day of December, 1967, the Commission, a quorum being present, having considered the testimony, the record, and the recommendations of the Examiner, and being fully advised in the premises,

FINDS:

(1) That due public notice having been given as required by law, the Commission has jurisdiction of this cause and the subject matter thereof.

(2) That the applicant, Lone Star Producing Company, is the owner and operator of the Federal New Mexico "D" Well No. 1, located in Unit A of Section 29, Township 8 South, Range 36 East, NMPM, South Prairie Field, Roosevelt County, New Mexico.

(3) That the applicant proposes to utilize said well to dispose of produced salt water into the San Andres formation, with injection into the perforated interval from approximately 4910 feet to 5015 feet.

(4) That the injection should be accomplished through 2 3/8-inch internally plastic-coated tubing installed in a packer set at approximately 4900 feet; that the casing-tubing annulus should be filled with an inert fluid; and that a pressure gauge should be attached to the annulus or the annulus left open at the surface in order to determine leakage in the tubing or packer.

-2-

CASE No. 3700  
Order No. R-3358

(5) That approval of the subject application will prevent the drilling of unnecessary wells and otherwise prevent waste and protect correlative rights.

IT IS THEREFORE ORDERED:

(1) That the applicant, Lone Star Producing Company, is hereby authorized to utilize its Federal New Mexico "D" Well No. 1, located in Unit A of Section 29, Township 8 South, Range 36 East, NMPM, South Prairie Field, Roosevelt County, New Mexico, to dispose of produced salt water into the San Andres formation, injection to be accomplished through 2 3/8-inch tubing installed in a packer set at approximately 4900 feet, with injection into the perforated interval from approximately 4910 feet to 5015 feet;

PROVIDED HOWEVER, that the tubing shall be internally plastic-coated; that the casing-tubing annulus shall be filled with an inert fluid and that a pressure gauge shall be attached to the annulus or the annulus left open at the surface in order to determine leakage in the tubing or packer.

(2) That the applicant shall submit monthly reports of its disposal operations in accordance with Rules 704 and 1120 of the Commission Rules and Regulations.

(3) That jurisdiction of this cause is retained for the entry of such further orders as the Commission may deem necessary.

DONE at Santa Fe, New Mexico, on the day and year hereinabove designated.

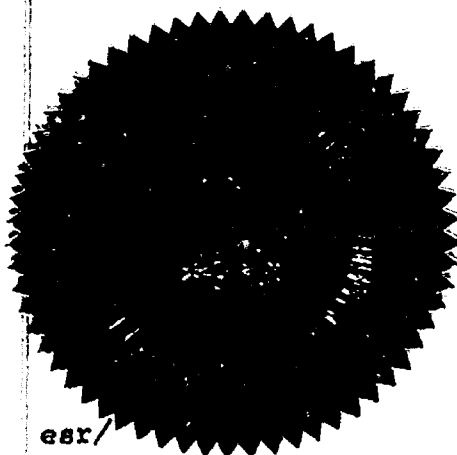

STATE OF NEW MEXICO  
OIL CONSERVATION COMMISSION

*David F. Cargo*  
DAVID F. CARGO, Chairman

*Guyton B. Hays*  
GUYTON B. HAYS, Member

*A. L. Porter, Jr.*  
A. L. PORTER, Jr., Member & Secretary

esr/



dearnley-meier reporting service, inc.

SPECIALIZING IN: DEPOSITIONS, HEARINGS, STATEMENTS, EXPERT TESTIMONY, DAILY COPY, CONVENTIONS  
1120 SIMMS BLDG. • P. O. BOX 1092 • PHONE 243-6691 • ALBUQUERQUE, NEW MEXICO

BEFORE THE  
NEW MEXICO OIL CONSERVATION COMMISSION  
Santa Fe, New Mexico  
December 20, 1967  
EXAMINER HEARING

-----  
IN THE MATTER OF: )

Application of Lone Star Pro- )  
ducing Company for salt water )  
disposal, Roosevelt County, )  
New Mexico. )  
----- )

Case No. 3700

BEFORE: Daniel S. Nutter, Examiner

TRANSCRIPT OF HEARING

## NEW MEXICO OIL CONSERVATION COMMISSION

## EXAMINER HEARING

SANTA FE, NEW MEXICO

Hearing Date DECEMBER 20, 1967 TIME: 9 A.M.

NAME	REPRESENTING	LOCATION
Jack Willock	Tanner Oil Company	Dumas, Idaho
Wm. J. Lingo	RW BYRAM & Co.	Santa Fe
W. C. Blackburn	Continental Oil Co.	Casper, Wyoming
R. A. Harrison	P. A. Oil Prod	Midland, Tex.
Dale McCarter	Texas Inc	Hobbs, N.M.
A. L. Porter, Jr.	o.c.	Santa Fe, N.M.
Bonnie Kelly	White Oilfield Services	S.F.
James W. Kellaher	Kellaher & Fox	Santa Fe, N.M.
W. Morris	Midwest (Montgomery Ward)	South of
St. River		
Jack R. McGraw	Coastal States	Midland, Tex
W D Elliott	✓	Corpus Christi, Tex
ROBERT ZINKE	✓	Midland, Texas
Wm. W. Matson	Midwest Oil Corp	Midland, Tex.
J. R. Rowan	"	"
John R. Pulte	Midwest Oil Corp	Midland
Q. L. Jones		
Q. L. Henshaw	H & S Oil Co	Artesia, N.M.
H. T. R. Spence	H & S Oil Co	Artesia, N.M.

## NEW MEXICO OIL CONSERVATION COMMISSION

## EXAMINER HEARING

SANTA FE, NEW MEXICO

Hearing Date DECEMBER 20, 1967 TIME: 9 A.M.

NAME	REPRESENTING	LOCATION
Jack Willock	Tanoco Oil Company	Demingo, Colorado
Minz Doffman	RW BYRAM & Co.	Santa Fe
W. C. Blackburn	Continental Oil Co.	Corpus Christi, Texas
R. H. Halvorsen	RTA OIL PROD	Midland, Texas
Dale M. Carter	Teneco Inc.	Hobbs, N.M.
A. L. Porter, Jr.	OCC	Santa Fe, N.M.
Burke Kelly	Wells Fargo & Co.	SF
James W. Kellaher	Kellaher & Fox	Santa Fe, N.M.
St. George	Midwest (Mortgage) Administration	Santa Fe
Jack R. McGraw	Coastal States	Midland, Texas
W D Elliott	✓	Corpus Christi, Texas
ROBERT ZINKE	✓	Midland, Texas

MR. NUTTER: The hearing will come to order, please. The first case will be number 3700.

MR. HATCH: Case 3700. Application of Lone Star Producing Company for salt water disposal, Roosevelt County.

MR. HINKLE: Clarence Hinkle, Hinkle, Bondurant and Christy of Roswell, representing Lone Star. We have one witness and about three exhibits, I think.

I'd like to have Mr. Ochsner sworn.

MR. HATCH: Will you stand, please.

(Witness sworn.)

MR. HINKLE: Let's let her identify these exhibits and get them in there.

(Whereupon, Applicant's Exhibits Numbers 1, 2, and 3 were marked for identification.)

JOHN D. OCHSNER

called as a witness, having been first duly sworn, was examined and testified as follows:

DIRECT EXAMINATION

BY MR. HINKLE:

Q State your name.

A John Ochsner.

Q Where do you live?



A Midland, Texas.

MR. NUTTER: Would you spell your name for the record, please?

A O-c-h-s-n-e-r.

Q By whom are you employed?

A Lone Star Producing Company.

Q In what capacity?

A As district engineer.

Q Have you previously testified before the New Mexico Oil Conservation Commission?

A Yes, sir, I have.

Q Your qualifications as a petroleum engineer are a matter of record?

A Yes, they are.

Q Are you familiar with Lone Star's operations in New Mexico?

A Yes, I am.

Q Have you made a study of the South Prairie Pool and of the South Prairie Cisco Pools?

A Yes, I have.

Q And of all the wells that have been drilled in that area?

A Yes.

Q Are you familiar with the application of Lone Star in this case?

A Yes, I am.

Q What are they seeking to do?

A Lone Star is seeking to dispose of salt water produced from the South Prairie Cisco Pool in the South Prairies-San Andres Pool and by disposing of it in the Lone Star Federal New Mexico "D" Number 1 Well, which is located in Section 29, Township 8 South, Range 36 East, in the northeast quarter of the northeast quarter of that section.

Q Refer to Lone Star's Exhibit Number 1 and explain what this is and what it shows.

A This is a plat of the area showing the proposed injection well location and the limits of the South Prairie Cisco Pool and the South Prairie-San Andres Pool.

Q Those are the limits as defined by the Oil Conservation Commission?

A Yes, they are. And the wells are color coded thereon and shown as the Pennsylvanian and the San Andres Well that have produced or are producing in the fields.

Q Does Lone Star have any producing wells in either of these pools?

A Yes, we have two Pennsylvanian producers and one

San Andres producer in the second field.

Q Where are they located?

A The San Andres Well is located in Section 20, the northeast quarter of the northeast quarter, which is the Federal Lone Star, Federal New Mexico "C" Number 1, and the two Cisco producers are Lone Star Federal New Mexico Number 1 and the Federal New Mexico "B" Number 2, which are located in Sections 20 and 21.

Q Are these wells, as well as the other wells in both pools, producing considerable water?

A Yes, they are.

Q What is the status of your South Prairie-San Andres Well located in the northeast of the northeast quarter?

A The Lone Star Federal C-1, which is a San-Andres well is presently making two hundred and six barrels of oil per month and twelve hundred and sixty-nine barrels of water, and we are planning to plug this well in the near future.

Q So when this is plugged, you, or Lone Star, will not have any wells, as far as the San Andres Pool is concerned?

A That's correct.

MR. NUTTER: What formation is that well producing from?

A The San Andres.

MR. NUTTER: This is a San Andres Well?

A Yes, the second well is - we have one San Andres Well, which is the C-1 and is making the previous two hundred barrels per month, and we are planning to plug this in the near future.

Q Does Lone Star own the lease on which your proposed injection well in the northeast of Section 29 is located?

A That is correct. Lone Star owns the offsetting developed leases from the proposed injection well.

Q What is the history of the proposed injection well?

A The proposed injection well was drilled initially by Cosden Petroleum Corporation in November of 1960 and was drilled to a total depth of ninety-seven hundred and fifty-nine feet and completed in the Cisco Formation. The Cisco was a water-dry formation. The well watered out and was plugged and abandoned in January of 1962, and Lone Star obtained the lease after Cosden had plugged the well and abandoned, and re-entered it on

November the 12th, 1964, and deepened it to twelve thousand and eighty-nine feet to test the Atoka formation. It was dry in the Atoka, plugged back, a liner was set and the San Andres was tested from forty-nine hundred and forty-seven feet to five thousand twenty-seven feet. Water was obtained on the tests.

Q You did not obtain any oil in the San Andres formation at all?

A No commercial. We obtained only a slight show in the San Andres well, testing it at two perforations.

Q Do you have an electrical log of the injection well, proposed injection well?

A Yes, we do.

Q Refer to Exhibit 2 and explain what it shows.

A If I may borrow one of those for just a minute.

The subject log of the well shows the top of the San Andres at depth of 4,045 feet, the base of the San Andres at 5495 feet, the proposed injection zone from 4910 to 5,015 feet and the previously producing Cisco Zone or Bough "C" Zone is at 9,693 feet.

Q Does the log of that well correlate with your San Andres Well, as far as the San Andres formation is concerned, located in the northeast, northeast of Section 20?

A The individual zones, it's a more strati-

graphic, the San Andres, the stratigraphic in here, and the individual productive zones are difficult to correlate, but the intervals do correlate, the San Andres. It's correlative from one well to the other well in the field.

Q I believe you testified that Lone Star is going to plug, shortly, the well located in the northeast, north-east of Section 20.

A That is correct.

Q When that well is plugged then, how far will it be from the injection well to the closest San Andres well which is producing?

A It will be a little over a mile to the closest producer.

Q Now, refer to your Exhibit Number 3 and explain what this shows.

A This is a diagrammatic sketch of the proposed salt water disposal installation showing surface casing set at 472 feet of thirteen and three-eighths inch casing, which was cemented with 350 sacks and circulated. Eight and five-eighths inch casing was set to 4210 feet, cemented with 1700 sacks and it circulated. A four and a half inch liner is presently set at 3800 feet to 5100 feet and this has also been cemented. Tubing will be set to -- two and three-eighths inch tubing will be set to a proximate depth of 4910 feet

with a Baker Model D. Packer set at approximately 4900 feet, and injection will be into preforations from 4910 feet to 5,015 feet. This will be through plastic coated tubing with a treated fluid in the annulus.

The well will be drilled out. Plugs presently in the well will be drilled out to a proximate depth of 5,060 feet, and cement plugs presently in the well are from 7,425 feet to 7,500 feet and the plug will be from 5,060 feet to 5,213 feet. Deeper, 9,575 to 9800 feet. 9,975 feet to 10,500; 12,025 to 12,100 and 12,275 to 12,050.

The sketch also shows that the original hole, which was drilled by Cosden and completed in the Cisco Zone, when the well was deepened to the Atoka, the five and a half, which was left in the well by Cosden, was -- the well was deviated outside the old hole and around the five and a half inch casing left in the well, and deepened to the Cisco.

Q By completing this well in the manner in which you have described, in your opinion, will the injected water be confined to the San Andres formation?

A Yes, it will.

Q What are the quantities of water which you propose to inject into this well?

A The estimated volume of salt water would be

approximately two thousand barrels per day with an estimated injection pressure of eighteen hundred pounds. The volume could change since other operators have requested that we dispose of their water. Lone Star is currently producing about thirty thousand barrels per month or approximately a thousand barrels per day, so some of this did include injecting water for other operators who have contacted us in the field.

Q If this well is approved by the Commission as an injection well, do you contemplate going ahead with it as quickly as possible?

A Yes, we would like to inject water by January the 1st of 1968.

Q And you are considering disposing of the water produced from other wells other than Lone Star's in this particular case?

A We have been contacted by other operators who have requested this.

Q Have you had any objection from any of the offset operators or any of the lease owners in the area as to using this well as an injection well?

A We have not been advised of any objection to our disposal well.

Q Did you furnish a copy of this application with



Figure 1. The effect of the concentration of the *Agrobacterium* suspension on the transformation efficiency of *Agrobacterium* strains.

100

1. The first part of the document discusses the importance of maintaining accurate records of all transactions, including sales, purchases, and expenses. It emphasizes the need for consistency and transparency in financial reporting.

2. The second part of the document outlines the various methods used to collect and analyze data, including surveys, interviews, and focus groups. It highlights the importance of selecting appropriate samples and ensuring the reliability of the data collected.

3. The third part of the document describes the process of identifying and measuring the variables that influence the outcome of the study. It discusses the challenges of operationalizing abstract concepts and the importance of using valid and reliable measurement tools.

4. The fourth part of the document discusses the various statistical techniques used to analyze the data, including descriptive statistics, inferential statistics, and regression analysis. It emphasizes the importance of interpreting the results in the context of the research question.

5. The fifth part of the document discusses the importance of communicating the findings of the study to the relevant stakeholders. It emphasizes the need for clear and concise reporting and the importance of providing practical recommendations based on the research findings.

1984  
1985  
1986  
1987  
1988

1. The Board of Directors of the Corporation shall have the right to elect and remove the members of the Board of Directors of the Corporation.

1997

Q Now, apparently even the Pennsylvanian is being abandoned down here in this south end now, isn't it?

A Yes, it is. We have plugged out in Section 28, the -- well, both Cisco wells have been abandoned and in the Section 21, the southwest, southwest well, our B-1 has been abandoned, and the well immediately north of the proposed injection well in 20, our Federal New Mexico Number 2 Well, has been abandoned. Almost all wells in the Pennsylvanian are producing in excess of fifty percent water and are in advanced stages of depletion. **Most** wells have watered out, and it appears that the large Kobe pumps are possibly overcoming the major affect of the water drive and, so, production is continuing.

Q Now, you mentioned that your company is producing at the rate of about a thousand barrels a day, correct?

A Of water.

Q Of water?

A Yes.

Q And if the San Andres Well -- I think you mentioned it made 1269 barrels of water one month.

A That's correct. Two hundred and six oil, and 1269 water.

Q So most of the waters that you're producing is coming from those two Pennsylvanian wells, then?

A Yes, that is our main concern. Our major oil production is also coming from the Cisco.

Q And when you plug and abandon that San Andres well, that's not going to really change your water production too much?

A No, that is correct.

Q Do you have any estimates on the ability of the San Andres to take the water here?

A The only information we have is in the east crossroads, which is somewhat removed from this, the San Andres. We're injecting in the San Andres, in the east crossroads for disposal and we're getting comparable volumes to this in the San Andres there.

Q Comparable to two thousand barrels a day?

A Yes, I believe our pressure has increased over there to near two thousand and we may be faced with opening additional interval or changing not too long in the future over there. But this zone, the San Andres, over here appears to be better, more permeable and better developed than it does in that area over there.

Q Do you know whether any of the operators in this field presently have disposal systems?

A We know of no other disposal systems.

Q So this would be the first one for this area?

A That's correct.

Q Do you know what the total amount of water that's been produced in the field as of today?

A I can give you an estimate here. Approximately 58,000 barrels per month from the Cisco and 1500 from the San Andres.

Q Well, at the current rates of production then, if your well would take two thousand barrels a day, it would take care of the water produced in the field, wouldn't it?

A Yes, I feel sure it would. Initially, it would be just a matter of how long it would probably maintain this.

Q What do you think of the possibility of some of these Cisco wells down in the south end here taking water, in the event the San Andres can't take them?

A We had initially considered putting water into the Cisco in our previously abandoned Federal 3-3, which is due east out of this well, but since our main production, our production we have now is from this zone, we were afraid we might end up cycling water or affect our production from these two wells, so we did not inject at this time in there.

Q I see.

MR. NUTTER: Are there any further questions of Mr. Ochsner? He may be excused.

Do you have anything further, Mr. Hinkle?

MR. HINKLE: That's all I have.

MR. NUTTER: Does anyone else have anything else to offer in Case Number 3700? If not, we'll take this case under advisement and call the next case, 3701.

\* \* \*

I N D E X

<u>WITNESS</u>	<u>PAGE</u>
JOHN D. OCHSNER	
Direct Examination by Mr. Hinkle	2
Cross Examination by Mr. Nutter	11

<u>EXHIBIT</u>	<u>MARKED</u>	<u>OFFERED AND ADMITTED</u>
Applicant's 1, 2, & 3	2	11

1. 2. 3. 4. 5. 6. 7. 8. 9. 10. 11. 12. 13. 14. 15. 16. 17. 18. 19. 20. 21. 22. 23. 24. 25. 26. 27. 28. 29. 30. 31. 32. 33. 34. 35. 36. 37. 38. 39. 40. 41. 42. 43. 44. 45. 46. 47. 48. 49. 50. 51. 52. 53. 54. 55. 56. 57. 58. 59. 60. 61. 62. 63. 64. 65. 66. 67. 68. 69. 70. 71. 72. 73. 74. 75. 76. 77. 78. 79. 80. 81. 82. 83. 84. 85. 86. 87. 88. 89. 90. 91. 92. 93. 94. 95. 96. 97. 98. 99. 100. 101. 102. 103. 104. 105. 106. 107. 108. 109. 110. 111. 112. 113. 114. 115. 116. 117. 118. 119. 120. 121. 122. 123. 124. 125. 126. 127. 128. 129. 130. 131. 132. 133. 134. 135. 136. 137. 138. 139. 140. 141. 142. 143. 144. 145. 146. 147. 148. 149. 150. 151. 152. 153. 154. 155. 156. 157. 158. 159. 160. 161. 162. 163. 164. 165. 166. 167. 168. 169. 170. 171. 172. 173. 174. 175. 176. 177. 178. 179. 180. 181. 182. 183. 184. 185. 186. 187. 188. 189. 190. 191. 192. 193. 194. 195. 196. 197. 198. 199. 200. 201. 202. 203. 204. 205. 206. 207. 208. 209. 210. 211. 212. 213. 214. 215. 216. 217. 218. 219. 220. 221. 222. 223. 224. 225. 226. 227. 228. 229. 230. 231. 232. 233. 234. 235. 236. 237. 238. 239. 240. 241. 242. 243. 244. 245. 246. 247. 248. 249. 250. 251. 252. 253. 254. 255. 256. 257. 258. 259. 260. 261. 262. 263. 264. 265. 266. 267. 268. 269. 270. 271. 272. 273. 274. 275. 276. 277. 278. 279. 280. 281. 282. 283. 284. 285. 286. 287. 288. 289. 290. 291. 292. 293. 294. 295. 296. 297. 298. 299. 300. 301. 302. 303. 304. 305. 306. 307. 308. 309. 310. 311. 312. 313. 314. 315. 316. 317. 318. 319. 320. 321. 322. 323. 324. 325. 326. 327. 328. 329. 330. 331. 332. 333. 334. 335. 336. 337. 338. 339. 340. 341. 342. 343. 344. 345. 346. 347. 348. 349. 350. 351. 352. 353. 354. 355. 356. 357. 358. 359. 360. 361. 362. 363. 364. 365. 366. 367. 368. 369. 370. 371. 372. 373. 374. 375. 376. 377. 378. 379. 380. 381. 382. 383. 384. 385. 386. 387. 388. 389. 390. 391. 392. 393. 394. 395. 396. 397. 398. 399. 400. 401. 402. 403. 404. 405. 406. 407. 408. 409. 410. 411. 412. 413. 414. 415. 416. 417. 418. 419. 420. 421. 422. 423. 424. 425. 426. 427. 428. 429. 430. 431. 432. 433. 434. 435. 436. 437. 438. 439. 440. 441. 442. 443. 444. 445. 446. 447. 448. 449. 450. 451. 452. 453. 454. 455. 456. 457. 458. 459. 460. 461. 462. 463. 464. 465. 466. 467. 468. 469. 470. 471. 472. 473. 474. 475. 476. 477. 478. 479. 480. 481. 482. 483. 484. 485. 486. 487. 488. 489. 490. 491. 492. 493. 494. 495. 496. 497. 498. 499. 500. 501. 502. 503. 504. 505. 506. 507. 508. 509. 510. 511. 512. 513. 514. 515. 516. 517. 518. 519. 520. 521. 522. 523. 524. 525. 526. 527. 528. 529. 530. 531. 532. 533. 534. 535. 536. 537. 538. 539. 540. 541. 542. 543. 544. 545. 546. 547. 548. 549. 550. 551. 552. 553. 554. 555. 556. 557. 558. 559. 560. 561. 562. 563. 564. 565. 566. 567. 568. 569. 570. 571. 572. 573. 574. 575. 576. 577. 578. 579. 580. 581. 582. 583. 584. 585. 586. 587. 588. 589. 590. 591. 592. 593. 594. 595. 596. 597. 598. 599. 600. 601. 602. 603. 604. 605. 606. 607. 608. 609. 610. 611. 612. 613. 614. 615. 616. 617. 618. 619. 620. 621. 622. 623. 624. 625. 626. 627. 628. 629. 630. 631. 632. 633. 634. 635. 636. 637. 638. 639. 640. 641. 642. 643. 644. 645. 646. 647. 648. 649. 650. 651. 652. 653. 654. 655. 656. 657. 658. 659. 660. 661. 662. 663. 664. 665. 666. 667. 668. 669. 670. 671. 672. 673. 674. 675. 676. 677. 678. 679. 680. 681. 682. 683. 684. 685. 686. 687. 688. 689. 690. 691. 692. 693. 694. 695. 696. 697. 698. 699. 700. 701. 702. 703. 704. 705. 706. 707. 708. 709. 710. 711. 712. 713. 714. 715. 716. 717. 718. 719. 720. 721. 722. 723. 724. 725. 726. 727. 728. 729. 730. 731. 732. 733. 734. 735. 736. 737. 738. 739. 740. 741. 742. 743. 744. 745. 746. 747. 748. 749. 750. 751. 752. 753. 754. 755. 756. 757. 758. 759. 760. 761. 762. 763. 764. 765. 766. 767. 768. 769. 770. 771. 772. 773. 774. 775. 776. 777. 778. 779. 780. 781. 782. 783. 784. 785. 786. 787. 788. 789. 790. 791. 792. 793. 794. 795. 796. 797. 798. 799. 800. 801. 802. 803. 804. 805. 806. 807. 808. 809. 810. 811. 812. 813. 814. 815. 816. 817. 818. 819. 820. 821. 822. 823. 824. 825. 826. 827. 828. 829. 830. 831. 832. 833. 834. 835. 836. 837. 838. 839. 840. 84

1998, 1999, 2000, 2001, 2002, 2003, 2004, 2005, 2006, 2007, 2008, 2009, 2010, 2011, 2012, 2013, 2014, 2015, 2016, 2017, 2018, 2019, 2020, 2021, 2022, 2023, 2024, 2025, 2026, 2027, 2028, 2029, 2030, 2031, 2032, 2033, 2034, 2035, 2036, 2037, 2038, 2039, 2040, 2041, 2042, 2043, 2044, 2045, 2046, 2047, 2048, 2049, 2050, 2051, 2052, 2053, 2054, 2055, 2056, 2057, 2058, 2059, 2060, 2061, 2062, 2063, 2064, 2065, 2066, 2067, 2068, 2069, 2070, 2071, 2072, 2073, 2074, 2075, 2076, 2077, 2078, 2079, 2080, 2081, 2082, 2083, 2084, 2085, 2086, 2087, 2088, 2089, 2090, 2091, 2092, 2093, 2094, 2095, 2096, 2097, 2098, 2099, 2100, 2101, 2102, 2103, 2104, 2105, 2106, 2107, 2108, 2109, 2110, 2111, 2112, 2113, 2114, 2115, 2116, 2117, 2118, 2119, 2120, 2121, 2122, 2123, 2124, 2125, 2126, 2127, 2128, 2129, 2130, 2131, 2132, 2133, 2134, 2135, 2136, 2137, 2138, 2139, 2140, 2141, 2142, 2143, 2144, 2145, 2146, 2147, 2148, 2149, 2150, 2151, 2152, 2153, 2154, 2155, 2156, 2157, 2158, 2159, 2160, 2161, 2162, 2163, 2164, 2165, 2166, 2167, 2168, 2169, 2170, 2171, 2172, 2173, 2174, 2175, 2176, 2177, 2178, 2179, 2180, 2181, 2182, 2183, 2184, 2185, 2186, 2187, 2188, 2189, 2190, 2191, 2192, 2193, 2194, 2195, 2196, 2197, 2198, 2199, 2200, 2201, 2202, 2203, 2204, 2205, 2206, 2207, 2208, 2209, 2210, 2211, 2212, 2213, 2214, 2215, 2216, 2217, 2218, 2219, 2220, 2221, 2222, 2223, 2224, 2225, 2226, 2227, 2228, 2229, 2230, 2231, 2232, 2233, 2234, 2235, 2236, 2237, 2238, 2239, 2240, 2241, 2242, 2243, 2244, 2245, 2246, 2247, 2248, 2249, 2250, 2251, 2252, 2253, 2254, 2255, 2256, 2257, 2258, 2259, 2260, 2261, 2262, 2263, 2264, 2265, 2266, 2267, 2268, 2269, 2270, 2271, 2272, 2273, 2274, 2275, 2276, 2277, 2278, 2279, 2280, 2281, 2282, 2283, 2284, 2285, 2286, 2287, 2288, 2289, 2290, 2291, 2292, 2293, 2294, 2295, 2296, 2297, 2298, 2299, 2300, 2301, 2302, 2303, 2304, 2305, 2306, 2307, 2308, 2309, 2310, 2311, 2312, 2313, 2314, 2315, 2316, 2317, 2318, 2319, 2320, 2321, 2322, 2323, 2324, 2325, 2326, 2327, 2328, 2329, 2330, 2331, 2332, 2333, 2334, 2335, 2336, 2337, 2338, 2339, 2340, 2341, 2342, 2343, 2344, 2345, 2346, 2347, 2348, 2349, 2350, 2351, 2352, 2353, 2354, 2355, 2356, 2357, 2358, 2359, 2360, 2361, 2362, 2363, 2364, 2365, 2366, 2367, 2368, 2369, 2370, 2371, 2372, 2373, 2374, 2375, 2376, 2377, 2378, 2379, 2380, 2381, 2382, 2383, 2384, 2385, 2386, 2387, 2388, 2389, 2390, 2391, 2392, 2393, 2394, 2395, 2396, 2397, 2398, 2399, 2400, 2401, 2402, 2403, 2404, 2405, 2406, 2407, 2408, 2409, 2410, 2411, 2412, 2413, 2414, 2415, 2416, 2417, 2418, 2419, 2420, 2421, 2422, 2423, 2424, 2425, 2426, 2427, 2428, 2429, 2430, 2431, 2432, 2433, 2434, 2435, 2436, 2437, 2438, 2439, 2440, 2441, 2442, 2443, 2444, 2445, 2446, 2447, 2448, 2449, 2450, 2451, 2452, 2453, 2454, 2455, 2456, 2457, 2458, 2459, 2460, 2461, 2462, 2463, 2464, 2465, 2466, 2467, 2468, 2469, 2470, 2471, 2472, 2473, 2474, 2475, 2476, 2477, 2478, 2479, 2480, 2481, 2482, 2483, 2484, 2485, 2486, 2487, 2488, 2489, 2490, 2491, 2492, 2493, 2494, 2495, 2496, 2497, 2498, 2499, 2500, 2501, 2502, 2503, 2504, 2505, 2506, 2507, 2508, 2509, 2510, 2511, 2512, 2513, 2514, 2515, 2516, 2517, 2518, 2519, 2520, 2521, 2522, 2523, 2524, 2525, 2526, 2527, 2528, 2529, 2530, 2531, 2532, 2533, 2534, 2535, 2536, 2537, 2538, 2539, 2540, 2541, 2542, 2543, 2544, 2545, 2546, 2547, 2548, 2549, 2550, 2551, 2552, 2553, 2554, 2555, 2556, 2557, 2558, 2559, 2560, 2561, 2562, 2563, 2564, 2565, 2566, 2567, 2568, 2569, 2570, 2571, 2572, 2573, 2574, 2575, 2576, 2577, 2578, 2579, 2580, 2581, 2582, 2583, 2584, 2585, 2586, 2587, 2588, 2589, 2590, 2591, 2592, 2593, 2594, 2595, 2596, 2597, 2598, 2599, 2600, 2601, 2602, 2603, 2604, 2605, 2606, 2607, 2608, 2609, 2610, 2611, 2612, 2613, 2614, 2615, 2616, 2617, 2618, 2619, 2620, 2621, 2622, 2623, 2624, 2625, 2626, 2627, 2628, 2629, 2630, 2631, 2632, 2633, 2634, 2635, 2636, 2637, 2638, 2639, 2640, 2641, 2642, 2643, 2644, 2645, 2646, 2647, 2648, 2649, 2650, 2651, 2652, 2653, 2654, 2655, 2656, 2657, 2658, 2659, 2660, 2661, 2662, 2663, 2664, 2665, 2666, 2667, 2668, 2669, 2670, 2671, 2672, 2673, 2674, 2675, 2676, 2677, 2678, 2679, 26

SECRET

[illegible]

State of New Mexico  
Oil Conservation Commission



STATE GEOLOGIST  
A. L. PORTER, JR.  
SECRETARY - DIRECTOR

December 22, 1967

Re: Case No. 3700  
Order No. R-3358  
Applicant:  
  
**LONE STAR PRODUCING COMPANY**

Enclosed herewith are two copies of the above-referenced Commission order recently entered in the subject case.

A. L. Porter, Jr.  
Secretary-Director

Hobbs OCC x  
 Artesia OCC \_\_\_\_\_  
 Aztec OCC \_\_\_\_\_  
 Other \_\_\_\_\_



DOCKET: EXAMINER HEARING - WEDNESDAY - DECEMBER 20, 1967

9 A.M. OIL CONSERVATION COMMISSION CONFERENCE ROOM,  
STATE LAND OFFICE BUILDING - SANTA FE, NEW MEXICO

The following cases will be heard before Daniel S. Nutter, Examiner, or Elvis A. Utz, Alternate Examiner:

CASE 3695 continued from the November 29, 1967, Examiner Hearing

Application of Tenneco Oil Company for Special Pool Rules, McKinley County, New Mexico. Applicant, in the above-styled cause, seeks the promulgation of special pool rules for the South Hospah Upper Sand Oil Pool and the South Hospah Lower Sand Oil Pool, McKinley County, New Mexico, to provide that wells drilled in said pools could be located anywhere on the 40-acre unit except that no well could be located closer than 330 feet to the outer boundary of the lease nor closer than 200 feet to another well producing from the same pool. Applicant further proposes that any existing well not located in accordance with the above requirements be granted an exception to said requirements.

CASE 3698: Application of H & S Oil Company for a unit agreement, Eddy County, New Mexico. Applicant, in the above-styled cause, seeks the approval of the West Artesia Grayburg Unit Area comprising 640 acres, more or less, of state and fee lands in Sections 7, 8, and 17, Township 18 South, Range 28 East, Artesia Pool, Eddy County, New Mexico.

CASE 3699: Application of H & S Oil Company for a waterflood project, Eddy County, New Mexico. Applicant, in the above-styled cause, seeks authority to institute a waterflood project in its West Artesia Grayburg Unit by the injection of water into the Grayburg formation through 8 wells located in Sections 7, 8, and 17, Township 18 South, Range 28 East, Artesia Pool, Eddy County, New Mexico.

CASE 3700: Application of Lone Star Producing Company for salt water disposal, Roosevelt County, New Mexico. Applicant, in the above-styled cause, seeks authority to dispose of produced salt water into the San Andres formation through the perforated interval from 4910 to 5015 feet in the Federal New Mexico "D" Well No. 1 located in Unit A of Section 2, Township 8 South, Range 36 East, South Prairie Field, Roosevelt County, New Mexico.

CASE 3701: Application of Coastal States Gas Producing Company for special pool rules, Lea County, New Mexico. Applicant, in the above-styled cause, seeks the promulgation of special pool rules for the Baum Wolfcamp Pool in Township 14 South, Range 33 East, Lea County, New Mexico, including a provision for 160-acre spacing and proration units.

- CASE 3702: Application of Coastal States Gas Producing Company for an exception to Order No. R-3221, Lea County, New Mexico. Applicant, in the above-styled cause, on its own behalf and as operator of the Flying "M" Unit Area, seeks an exception to the provision of Paragraph (6) of the Commission Order No. R-3221 which requires that certain unlined pits used for the disposal of produced water be filled, leveled, and compacted. Applicant proposes that said pits be left open in the Flying "M" San Andres Pool, Lea County, New Mexico, to permit their use for temporary emergency storage of produced water in connection with individual tank batteries connected to the Flying "M" San Andres Pressure Maintenance Project operated by Coastal States Gas Producing Company.
- CASE 3703: Application of Texaco Inc. for salt water disposal, Lea County, New Mexico. Applicant, in the above-styled cause, seeks authority to dispose of produced salt water into the Abo formation in the perforated interval from 9013 to 9046 feet in its New Mexico "CW" State Well No. 2 located in Unit L of Section 18, Township 17 South, Range 37 East, Midway-Abo Pool, Lea County, New Mexico.
- CASE 3704: Application of New Mexico Salt Water Disposal Company, Inc., for salt water disposal, Lea County, New Mexico. Applicant, in the above-styled cause, seeks authority to dispose of produced salt water into the Bough "D" zone of the Pennsylvanian formation in the perforated interval from 9844 to 9875 feet in its Ainsworth Well No. 1 located in Unit H of Section 19, Township 9 South, Range 34 East, Vada-Pennsylvanian Pool, Lea County, New Mexico.
- CASE 3705: Application of Midwest Oil Corporation for salt water disposal, Lea County, New Mexico. Applicant, in the above-styled cause, seeks authority to dispose of produced salt water into the Bough zone of the Pennsylvanian formation in the perforated interval from 9784 to 9810 feet in its Ainsworth State Well No. 1, formerly the Sunray DX State I Well No. 1, located in Unit N of Section 36, Township 9 South, Range 33 East, Lane-Pennsylvanian Pool, Lea County, New Mexico.
- CASE 3706: Application of Major, Giebel & Forster for an amendment to Order No. R-3307, Lea County, New Mexico. Applicant, in the above-styled cause, seeks the amendment of Order No. R-3307 to designate Major, Giebel & Forster as operators of the NW/4 SW/4 of Section 6, Township 13 South, Range 38 East, West Bronco-Devonian Pool, Lea County, New Mexico, rather than Vasicek and Fullinwider dba V. F. Petroleum, who were originally designated as operators of said compulsorily pooled unit.

CLARENCE E. HINKLE  
W. E. BONDURANT, JR.  
S. B. CHRISTY IV  
LEWIS C. COX, JR.  
PAUL W. EATON, JR.  
CONRAD E. COFFIELD  
HAROLD L. HENSLEY, JR.  
MICHAEL R. WALLER  
ST. RT D. SHANOR

LAW OFFICES  
HINKLE, BONDURANT & CHRISTY  
600 HINKLE BUILDING  
ROSWELL, NEW MEXICO 88201

November 24, 1967

MIDLAND, TEXAS OFFICE  
521 MIDLAND TOWER  
(815) MU 3-4691  
OF COUNSEL: HIRAM M. DOW  
TELEPHONE (505) 622-6510  
POST OFFICE BOX 10

*Copy 3700*

New Mexico Oil Conservation Commission  
State Land Office Building  
Santa Fe, New Mexico 87501

Gentlemen:

We enclose herewith in triplicate application of Lone Star Producing Company for disposal of produced water from applicant's well in the South Prairie-Cisco Pool by injection into Federal NM "D" No. 1 well located in the NE $\frac{1}{4}$  Section 29, Township 8 South, Range 36 East, N.M.P.M., Roosevelt County, New Mexico. You will find attached the exhibits referred to in paragraph 2 except that there is only enclosed one copy of the electrical log. If you need additional copies, they will be furnished and filed with you at the time of the hearing as we were not furnished with sufficient copies to file the log in triplicate.

We are sending a complete copy of the application to the State Engineer and enclose copy of our letter of transmittal.

Yours sincerely,

HINKLE, BONDURANT & CHRISTY

By 

CEH:pv  
Enclosures

P. S. We would request that this matter be set down for hearing at the December 20, 1967 examiner's hearing.

C.E.H.

BUCKET MAILED

Date 12-1-67  
*R*

BEFORE THE NEW MEXICO OIL CONSERVATION COMMISSION

SANTA FE, NEW MEXICO

APPLICATION OF LONE STAR PRODUCING  
COMPANY FOR DISPOSAL OF PRODUCED  
WATER FROM APPLICANT'S WELLS IN THE  
SOUTH PRAIRIE-CISCO POOL BY INJECTION  
INTO FEDERAL NM "D" NO. 1 WELL LOCATED  
IN NE $\frac{1}{4}$  SECTION 29, TOWNSHIP 8 SOUTH,  
RANGE 36 EAST, N.M.P.M., ROOSEVELT  
COUNTY, SAID WATER TO BE INJECTED IN  
THE SAN ANDRES ZONE FROM WHICH WELLS  
IN THE SOUTH PRAIRIE-SAN ANDRES POOL ARE  
PRODUCING.

*Case 3700*

Oil Conservation Commission  
Box 2088  
Santa Fe, New Mexico

Comes Lone Star Producing Company with offices at Midland, Texas, acting by and through the undersigned attorneys, and hereby makes application for approval of disposal of produced water from applicant's wells in the South Prairie-Cisco Pool by injection into the Federal NM "D" No. 1 well located in the NE $\frac{1}{4}$  Section 29, Township 8 South, Range 36 East, N.M.P.M., Roosevelt County and in support thereof respectfully shows:

1. That applicant is the owner of certain operating rights under Federal lease NM 0523202 embracing the NE $\frac{1}{4}$  Section 29, Township 8 South, Range 36 East, N.M.P.M., upon which is located Federal NM "D" No. 1 well located 660 feet from the North and East lines of said Section 29. That said well was completed as a well capable of producing oil and gas in paying quantities from the South Prairie-Cisco Pool situated in Roosevelt County, but has now ceased to produce and applicant is desirous of using said well for the disposal of water being produced in connection with 3 other wells located in said pool owned by applicant.

2. That there is filed herewith and made a part hereof the following:

(a) A plat showing the location of the proposed injection well and the location of all other wells within a radius of 2 miles from said proposed injection well and the formation from which said wells are producing or have produced. The plat also indicates the owners of oil and gas leases within said 2 mile radius.

(b) Electrical log of the proposed injection well.

(c) A diagrammatic sketch of the proposed injection well showing all casing strings, including diameters and setting depths; quantities used and tops of cement; perforations or open hole intervals; tubing strings, including diameters and setting depths; and the type and location of packers.

3. That a copy of this application, complete with plat, log and diagrammatic sketch have been mailed to the State Engineer's office, Capitol Building, Santa Fe, New Mexico.

4. Applicant proposes to inject produced salt or brackish water into said well in such a manner that the water injected will be confined to disposal in the same formation from which the wells in the South Prairie-San Andres Pool are producing so that it will not contaminate other formations.

5. Applicant requests that this matter be set down for hearing at the examiner's hearing to be held on December 20, 1967.

Respectfully submitted,

LONE STAR PRODUCING COMPANY

By   
Hinkle, Bondurant & Christy  
Attorneys for Applicant  
P. O. Box 10  
Roswell, New Mexico

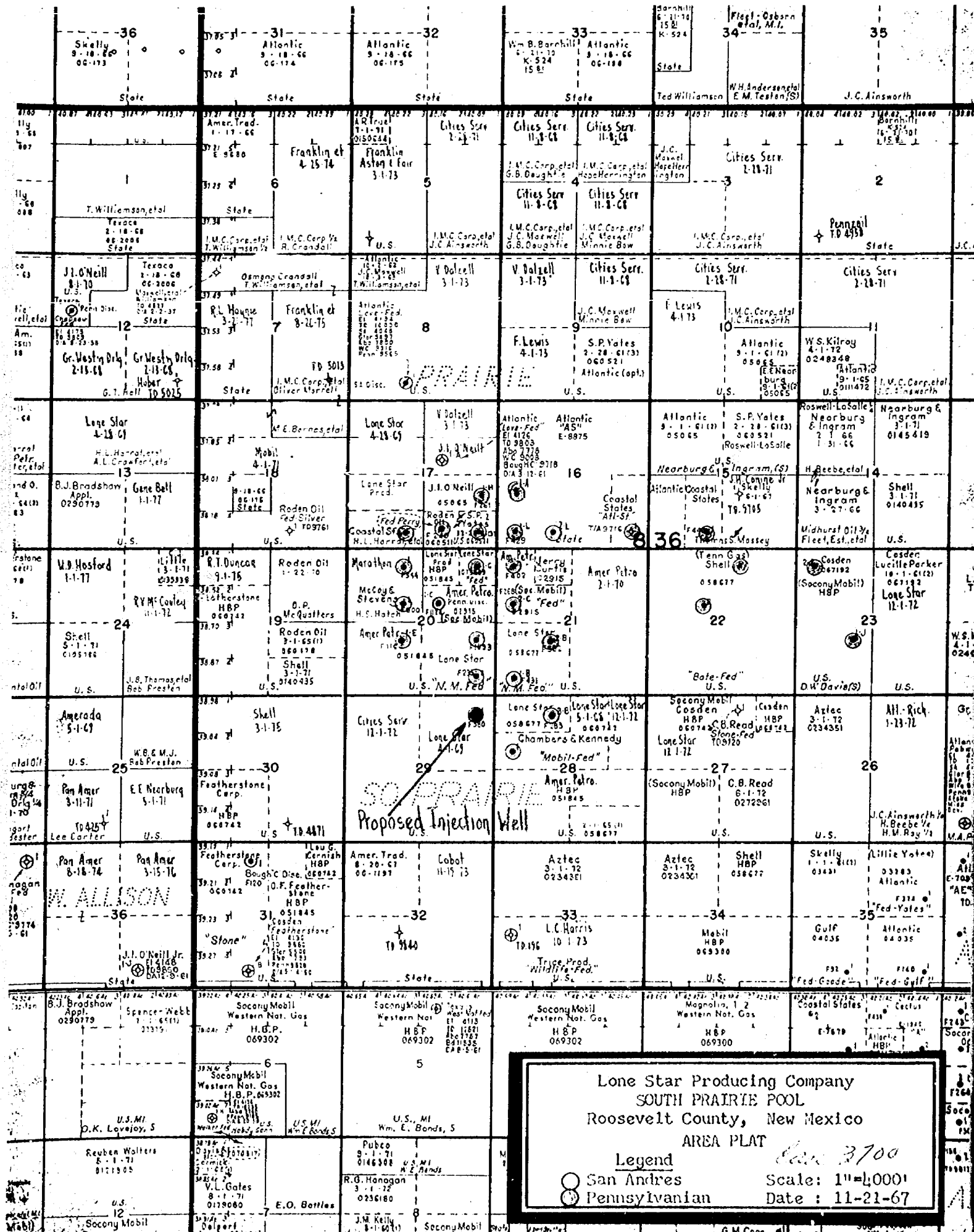

DIAGRAMMATIC SKETCH  
of  
Proposed Salt Water Disposal  
Lone Star Prod. Co. Federal N.M. "D" No. 1  
Roosevelt County, New Mexico  
South Prairie Pool

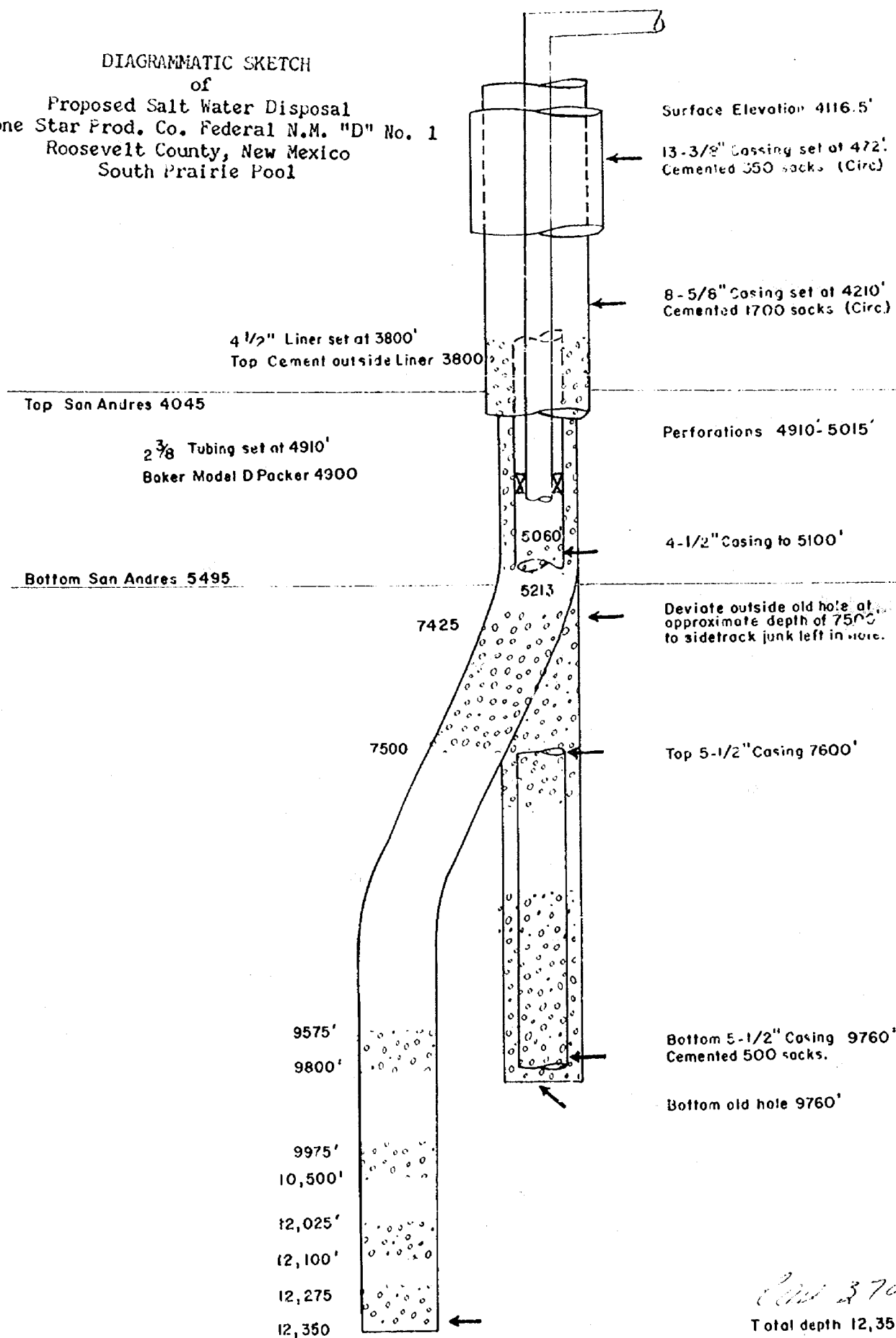

COPY

HINKLE, BONDURANT & CHRISTY

November 24, 1967

*Case 3700*

Mr. S. E. Reynolds  
New Mexico State Engineer  
Capitol Building  
Santa Fe, New Mexico 87501

Dear Mr. Reynolds:

There is enclosed herewith application of Lone Star Producing Company for water disposal. Applicant proposes to dispose of produced water into the South Prairie-San Andres Pool by injection of the water into Federal NM "D" No. 1 well located in the NE $\frac{1}{4}$  Section 29, Township 8 South, Range 36 East, Roosevelt County, New Mexico. We have requested that this matter be set down for hearing at the examiner's hearing to be held on December 20, 1967.

Yours very truly,

HINKLE, BONDURANT & CHRISTY

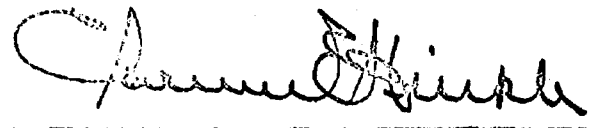
By 

CEH:pv  
Enclosures



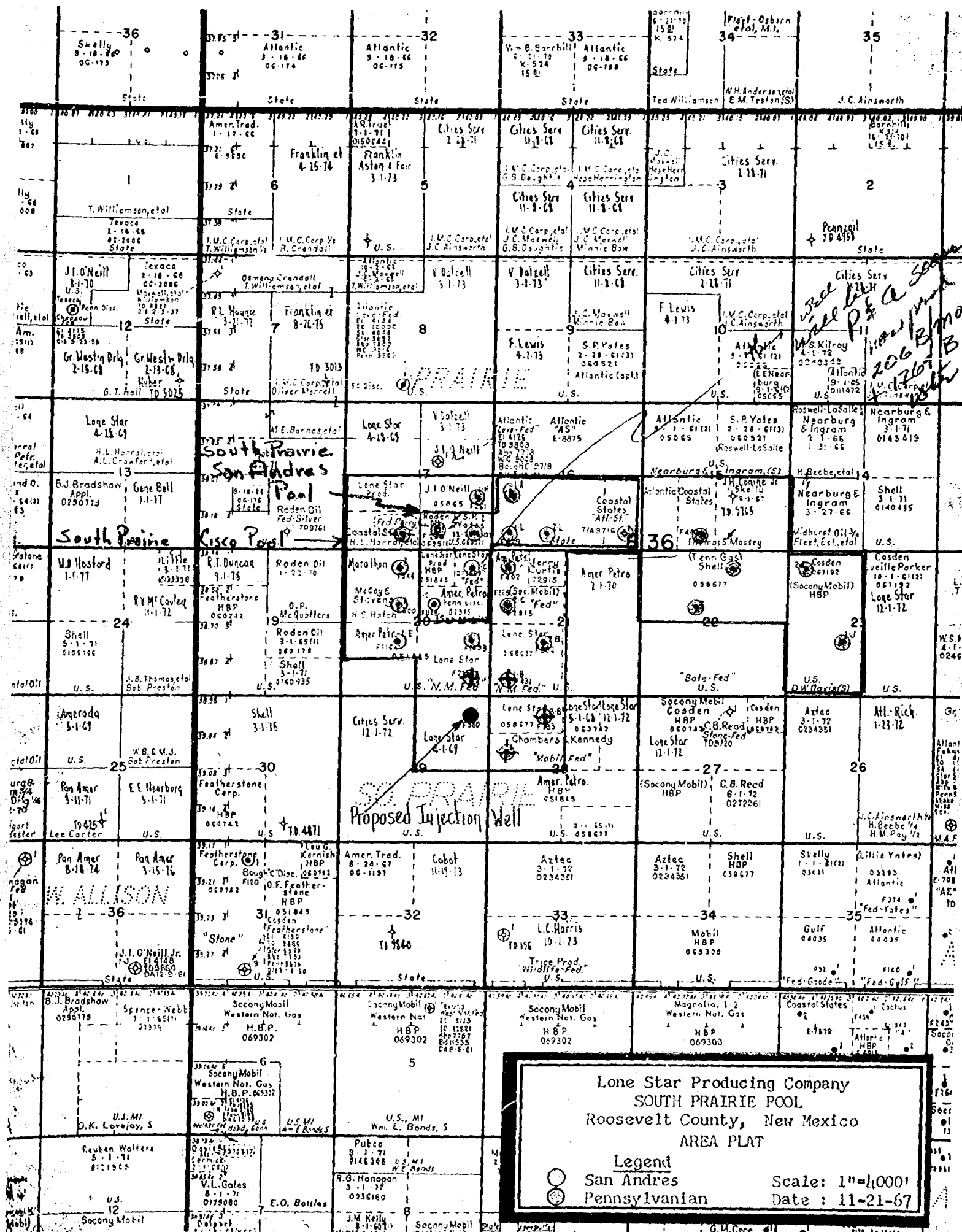

DIAGRAMMATIC SKETCH  
 of  
 Proposed Salt Water Disposal  
 Lone Star Prod. Co. Federal N.M. "D" No. 1  
 Roosevelt County, New Mexico  
 South Prairie Pool

