

CASE 3710:

SOUTHEASTERN NEW MEXICO
NOMENCLATURE

Case No.

3710

Application, Transcript,
Small Exhibits, Etc.

BEFORE THE OIL CONSERVATION COMMISSION
OF THE STATE OF NEW MEXICO

IN THE MATTER OF THE HEARING
CALLED BY THE OIL CONSERVATION
COMMISSION OF NEW MEXICO FOR
THE PURPOSE OF CONSIDERING:

CASE No. 3710
Order No. R-3367

THE APPLICATION OF THE OIL CONSERVATION
COMMISSION UPON ITS OWN MOTION FOR AN
ORDER CREATING, RE-CREATING, CONTRACTING,
AND EXTENDING CERTAIN POOLS IN CHAVES,
LEA, AND ROOSEVELT COUNTIES, NEW MEXICO.

ORDER OF THE COMMISSION

BY THE COMMISSION:

This cause came on for hearing at 9 a.m. on January 17, 1968, at Santa Fe, New Mexico, before the Oil Conservation Commission of New Mexico, hereinafter referred to as the "Commission."

NOW, on this 22nd day of January, 1968, the Commission, a quorum being present, having considered the testimony presented and the exhibits received at said hearing, and being fully advised in the premises,

FINDS:

(1) That due public notice having been given as required by law, the Commission has jurisdiction of this cause and the subject matter thereof.

(2) That there is need for the creation of a new oil pool in Lea County, New Mexico, for the production of oil from the San Andres formation, said pool to bear the designation of North Mescalero-San Andres Pool. Said North Mescalero-San Andres Pool was discovered by Cattle Land Oil Company, Atlantic State No. 1, located in Unit G of Section 1, Township 10 South, Range 32 East, NMPM. It was completed in San Andres on September 4, 1967. The top of perforations is 4133 feet.

(3) That there is need for the re-creation of the East Mason-Delaware Pool in Lea County, New Mexico, inasmuch as the

-2-

CASE No. 3710

Order No. R-3367

East Mason-Delaware Pool and the North Mason-Delaware Pool constitute different common sources of supply.

(4) That there is need for the deletion of certain acreage from the North Mason-Delaware Pool in Lea County, New Mexico, in order that said acreage may be included in the newly re-created East Mason-Delaware Pool.

(5) That there is need for the deletion of certain acreage from the Lane-Pennsylvanian Pool in Lea County, New Mexico, because said acreage was previously included in the Middle Lane Permo-Pennsylvanian Pool.

(6) That there is need for certain extensions to the Tomtom San Andres Pool in Chaves County, New Mexico, the Baum-Wolfcamp Pool, the South Corbin-Wolfcamp Pool, the Midway-Abo Pool, the North Morton Permo-Pennsylvanian Pool, the Morton-Wolfcamp Pool, and the Vada-Pennsylvanian Pool, all in Lea County, New Mexico, and the Todd-Lower San Andres Pool in Roosevelt County, New Mexico.

IT IS THEREFORE ORDERED:

(a) That a new pool in Lea County, New Mexico, classified as an oil pool for San Andres production, is hereby created and designated as the North Mescalero-San Andres Pool, consisting of the following-described area:

TOWNSHIP 10 SOUTH, RANGE 32 EAST, NMPM

Section 1: NE/4

(b) That a previously existing pool in Lea County, New Mexico, classified as an oil pool for Delaware production, is hereby re-created and designated as the East Mason-Delaware Pool, consisting of the following-described area:

TOWNSHIP 26 SOUTH, RANGE 32 EAST, NMPM

Section 16: SW/4

Section 17: S/2

Section 20: N/2

Section 21: NW/4

(c) That the North Mason-Delaware Pool in Lea County, New Mexico, as heretofore classified, defined, and described, is

-3-

CASE No. 3710

Order No. R-3367

hereby contracted by the deletion of the following-described area:

TOWNSHIP 26 SOUTH, RANGE 32 EAST, NMPM

Section 16: SW/4

Section 17: S/2

Section 19: NE/4

Section 20: N/2

Section 21: NW/4

(d) That the Lane-Pennsylvanian Pool in Lea County, New Mexico, as heretofore classified, defined, and described, is hereby contracted by the deletion of the following-described area:

TOWNSHIP 10 SOUTH, RANGE 33 EAST, NMPM

Section 11: NE/4

(e) That the Baum-Wolfcamp Pool in Lea County, New Mexico, as heretofore classified, defined, and described, is hereby extended to include therein:

TOWNSHIP 14 SOUTH, RANGE 33 EAST, NMPM

Section 6: NE/4

(f) That the South Corbin-Wolfcamp Pool in Lea County, New Mexico, as heretofore classified, defined, and described, is hereby extended to include therein:

TOWNSHIP 18 SOUTH, RANGE 33 EAST, NMPM

Section 20: SE/4

Section 21: SW/4

(g) That the Midway-Abo Pool in Lea County, New Mexico, as heretofore classified, defined, and described, is hereby extended to include therein:

TOWNSHIP 17 SOUTH, RANGE 36 EAST, NMPM

Section 13: NE/4

(h) That the North Morton Permo-Pennsylvanian Pool in Lea County, New Mexico, as heretofore classified, defined, and described, is hereby extended to include therein:

TOWNSHIP 14 SOUTH, RANGE 35 EAST, NMPM

Section 31: E/2

-4-

CASE No. 3710
Order No. R-3367

(i) That the Morton-Wolfcamp Pool in Lea County, New Mexico, as heretofore classified, defined, and described, is hereby extended to include therein:

TOWNSHIP 15 SOUTH, RANGE 34 EAST, NMPM
Section 13: NE/4

(j) That the Todd-Lower San Andres Pool in Roosevelt County, New Mexico, as heretofore classified, defined, and described, is hereby extended to include therein:

TOWNSHIP 7 SOUTH, RANGE 36 EAST, NMPM
Section 19: SE/4
Section 29: SW/4
Section 31: SE/4

(k) That the Tom-tom San Andres Pool in Chaves County, New Mexico, as heretofore classified, defined, and described, is hereby extended to include therein:

TOWNSHIP 7 SOUTH, RANGE 31 EAST, NMPM
Section 35: SW/4

TOWNSHIP 8 SOUTH, RANGE 31 EAST, NMPM
Section 2: NW/4

(l) That the Vada-Pennsylvanian Pool in Lea County, New Mexico, as heretofore classified, defined, and described, is hereby extended to include therein:

TOWNSHIP 9 SOUTH, RANGE 34 EAST, NMPM
Section 20: S/2
Section 21: NE/4
Section 27: NW/4
Section 28: N/2

IT IS FURTHER ORDERED:

That the effective date of this order and all creations, re-creations, contractions, and extensions included herein shall be February 1, 1968.

-5-

CASE No. 3710
Order No. R-3367

DONE at Santa Fe, New Mexico, on the day and year hereinabove designated.

STATE OF NEW MEXICO
OIL CONSERVATION COMMISSION

DAVID F. CARGO, Chairman

GUYTON B. HAYS, Member

A. L. PORTER, Jr., Member & Secretary

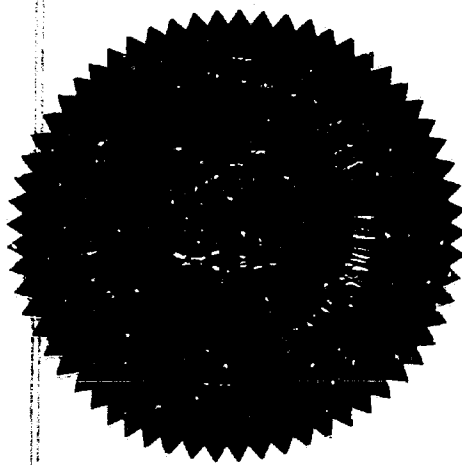

esr/

Docket No. 2-68

DOCKET: REGULAR HEARING - WEDNESDAY - JANUARY 17, 1968

OIL CONSERVATION COMMISSION - 9 A.M. - MORGAN HALL - STATE LAND OFFICE BUILDING,
SANTA FE, NEW MEXICO

ALLOWABLE: (1) Consideration of the oil allowable for February, 1968;

(2) Consideration of the allowable production of gas for February, 1968, from thirteen prorated pools in Lea, Eddy and Roosevelt Counties, New Mexico. Consideration of the allowable production of gas from nine prorated pools in San Juan, Rio Arriba and Sandoval Counties, New Mexico for February, 1968.

CASE 3710: Southeastern nomenclature case calling for an order for the creation, extension and contraction of certain pools in Lea, Roosevelt and Chaves Counties, New Mexico.

(a) Create a new pool in Lea County, New Mexico, classified as an oil pool for San Andres production and designated as the North Mescalero-San Andres Pool. The discovery well for said pool is Cattle Land Oil Company's Atlantic State Well No. 1 located in Unit G of Section 1, Township 10 South, Range 32 East. Said pool would comprise the following-described acreage:

TOWNSHIP 10 SOUTH, RANGE 32 EAST, NMPM
SECTION 1: NE/4

(b) Recreate the East Mason Delaware Pool, Lea County, New Mexico, to comprise the following-described acreage:

TOWNSHIP 26 SOUTH, RANGE 32 EAST, NMPM
SECTION 16: SW/4
SECTION 17: S/2
SECTION 20: N/2
SECTION 21: NW/4

(c) Contract the North Mason Delaware Pool by the deletion of the following-described acreage:

TOWNSHIP 26 SOUTH, RANGE 32 EAST, NMPM
SECTION 16: SW/4
SECTION 17: S/2
SECTION 19: NE/4
SECTION 20: N/2
SECTION 21: NW/4

(d) Contract the Lane Pennsylvanian Pool, Lea County, New Mexico, by the deletion of the following-described acreage:

TOWNSHIP 10 SOUTH, RANGE 33 EAST, NMPM
SECTION 11: NE/4

The above contraction is necessary inasmuch as said lands were previously included in the Middle Lane Permo-Pennsylvanian Pool.

- (e) Extend the Baum-Wolfcamp Pool to include therein:

TOWNSHIP 14 SOUTH, RANGE 33 EAST, NMPPM
SECTION 6: NE/4

- (f) Extend the South Corbin-Wolfcamp Pool to include therein:

TOWNSHIP 18 SOUTH, RANGE 33 EAST, NMPPM
SECTION 20: SE/4
SECTION 21: SW/4

- (g) Extend the Midway-Abo Pool to include therein:

TOWNSHIP 17 SOUTH, RANGE 36 EAST, NMPPM
SECTION 13: NE/4

- (h) Extend the North Morton-Permo-Pennsylvanian Pool to include therein:

TOWNSHIP 14 SOUTH, RANGE 35 EAST, NMPPM
SECTION 31: NE/4

- (i) Extend the Morton-Wolfcamp Pool to include therein:

TOWNSHIP 15 SOUTH, RANGE 34 EAST, NMPPM
SECTION 13: NE/4

- (j) Extend the Todd-Lower San Andres Pool to include therein:

TOWNSHIP 7 SOUTH, RANGE 36 EAST, NMPPM
SECTION 19: SE/4
SECTION 29: SW/4
SECTION 31: SE/4

- (k) Extend the Tom-tom San Andres Pool to include therein:

TOWNSHIP 7 SOUTH, RANGE 31 EAST, NMPPM
SECTION 35: SW/4

TOWNSHIP 8 SOUTH, RANGE 31 EAST, NMPPM
SECTION 2: NW/4

- (l) Extend the Vada-Pennsylvanian Pool to include therein:

TOWNSHIP 9 SOUTH, RANGE 34 EAST, NMPPM
SECTION 20: SE/4
SECTION 21: NE/4

NOMENCLATURE ADVERTISEMENT FOR JANUARY, 1968

CASE 3710

In the matter of the application of the Oil Conservation Commission of New Mexico upon its own motion for an order for the creation of a new pool in Lea County, New Mexico, the recreation of a pool in Lea County, New Mexico, the deletion of existing pools in Lea County, New Mexico, and the extension of certain existing pools in Chaves, Lea, and Roosevelt Counties, New Mexico, and giving notice to all persons and parties interested in the subject matter thereof to appear and show cause why such creations, recreations, deletions, and extensions should not be made.

a) CREATE A new pool in Lea County, New Mexico, classified as an oil pool for San Andres production and designated as the North Mescalero-San Andres Pool. The discovery well is Cattle Land Oil Company, Atlantic State No. 1, located in Unit C of Section 1, Township 10 South, Range 32 East, NMPM. Said pool described as:

✓ TOWNSHIP 10 SOUTH, RANGE 32 EAST, NMPM
SECTION 1: NE/4

? b) RECREATE A pool in Lea County, New Mexico, classified as an oil pool for Delaware production and designated as the East Mason-Delaware Pool. Said pool described as:

✓ TOWNSHIP 26 SOUTH, RANGE 32 EAST, NMPM
SECTION 16: SW/4
SECTION 17: S/2
SECTION 20: N/2
SECTION 21: NW/4

? c) DELETE the Lane-Pennsylvanian Pool in Lea County, New Mexico, described as:

TOWNSHIP 10 SOUTH, RANGE 33 EAST, NMPM
SECTION 11: NE/4

? d) DELETE the North Mason-Delaware Pool in Lea County, New Mexico, described as:

TOWNSHIP 26 SOUTH, RANGE 32 EAST, NMPM
SECTION 16: SW/4
SECTION 17: S/2
SECTION 19: NE/4
SECTION 20: N/2
SECTION 21: NW/4

✓ e) EXTEND the Baum-Wolfcamp Pool in Lea County, New Mexico, to include therein:

✓ TOWNSHIP 14 SOUTH, RANGE 33 EAST, NMPM
SECTION 6: NE/4

✓ f) EXTEND the South Corbin-Wolfcamp Pool in Lea County, New Mexico, to include therein:

✓ TOWNSHIP 18 SOUTH, RANGE 33 EAST, NMPM
SECTION 20: SE/4
SECTION 21: SW/4

*October hearing
attended the
Middle Range
Permian Pool
include to
T10SR33E
Sec 11: N/2
Sec 13: SW/4
Sec 15: E/2 NW/4*

AM OFFICE

7 DEC 18 AM

January, 1968 Nomenclature

g) EXTEND the Midway-Abo Pool in Lea County, New Mexico, to include therein:

✓ ✓ ✓ TOWNSHIP 17 SOUTH, RANGE 36 EAST, NMPM
SECTION 13: NE/4

h) EXTEND the North Morton-Permo Pennsylvanian Pool in Lea County, New Mexico, to include therein:

✓ ✓ ✓ TOWNSHIP 14 SOUTH, RANGE 35 EAST, NMPM
SECTION 31: NE/4

i) EXTEND the Morton-Wolfcamp Pool in Lea County, New Mexico, to include therein:

✓ ✓ ✓ TOWNSHIP 15 SOUTH, RANGE 34 EAST, NMPM
SECTION 13: NE/4

j) EXTEND the Todd-Lower San Andres Pool in Roosevelt County, New Mexico, to include therein:

✓ ✓ ✓ TOWNSHIP 7 SOUTH, RANGE 36 EAST, NMPM
SECTION 19: SE/4
SECTION 29: SW/4
SECTION 31: SE/4

k) EXTEND the Tom-tom San Andres Pool in Chaves County, New Mexico, to include therein:

✓ ✓ ✓ TOWNSHIP 7 SOUTH, RANGE 31 EAST, NMPM
SECTION 35: SW/4

✓ TOWNSHIP 8 SOUTH, RANGE 31 EAST, NMPM
SECTION 2: NW/4

l) EXTEND the Vada-Pennsylvanian Pool in Lea County, New Mexico, to include therein:

✓ ✓ ✓ TOWNSHIP 9 SOUTH, RANGE 34 EAST, NMPM
SECTION 20: SE/4
SECTION 21: NE/4

dearnley-meier reporting service, inc.

SPECIALIZING IN: DEPOSITIONS, HEARINGS, STATEMENTS, EXPERT TESTIMONY, DAILY COPY, CONVENTIONS

1120 SIMMS BLDG. • P. O. BOX 1092 • PHONE 243-6691 • ALBUQUERQUE, NEW MEXICO

BEFORE THE
NEW MEXICO OIL CONSERVATION COMMISSION
Santa Fe, New Mexico
January 17, 1968

REGULAR HEARING

IN THE MATTER OF:

Southeastern nomenclature case
calling for an order for the
creation, extension and contraction
of certain pools in Lea, Roosevelt
and Chaves Counties, New Mexico.

BEFORE: A. L. Porter, Examiner

TRANSCRIPT OF HEARING

MR. PORTER: We will take up Case 3710.

MR. HATCH: Case 3710. Southeastern nomenclature case calling for an order for the creation, extension and contraction of certain pools in Lea, Roosevelt and Chaves Counties, New Mexico.

(Witness sworn.)

JOE D. RAMEY

called as a witness, having been first duly sworn, was examined and testified as follows:

DIRECT EXAMINATION

BY MR. HATCH:

Q Will you state your name and position for the record?

A Joe D. Ramey, supervisor of the Commission's District 1.

Q Are you prepared to make recommendations to the Commission concerning the creation extension and contraction of certain pools in Lea, Roosevelt and Chaves Counties, New Mexico?

A Yes, I am.

Q Are your recommendations prepared in the form of an exhibit?

A Yes.

Q What is that exhibit?

A Southeast Nomenclature Exhibit 1, paragraphs A through L.

Q Would you refer to your exhibit that you just mentioned and to the docket that has been distributed and point out any substantial differences between the two and any corrections that need to be made?

A I have no corrections to be made. I have additions in paragraphs H and L. Under paragraph H, the addition is in Section 31, the southeast quarter. In paragraph L, I have three additions in Section 20, the southeast quarter, Section 27, the northwest quarter, and Section 28, the north half. The rest of the paragraphs are as advertised on the docket.

Q And do you recommend to the Commission that the pools be created, extended and contracted as advertised and corrected by the additions in this hearing?

A Yes, sir.

Q Was Southeast Nomenclature Exhibit 1 prepared by you or under your supervision?

A Yes, sir, it was.

MR. HATCH: I would like to move the introduction of Southeast Nomenclature Exhibit 1 into evidence at this time.

MR. PORTER: If there are no objections, the exhibit

will be admitted.

(Whereupon, Southeast Nomenclature Exhibit 1 was offered and admitted in evidence.)

MR. PORTER: Any questions of Mr. Ramey? I have one.

CROSS EXAMINATION

BY MR. PORTER:

Q Mr. Ramey, did you indicate why you are recreating pools in the East Mason Delaware?

A No, I just never have been able to find out why the East Mason Delaware was abolished through some mistake somewhere. It was abolished and added to the North Mason Delaware Pool but there is evidently separation between the two pools and it is a factor of allowable. The allowable for the East Mason is considerably higher than that for the North Mason.

Q In other words, it creates an inequity as far as people who own wells in the East Mason Delaware.

MR. PORTER: If there are no further question, Mr. Ramey may be excused.

(Witness excused.)

MR. PORTER: Anything else to be offered in the case? Case will be taken under advisement and the hearing is adjourned.

I, KAY EMBREE, Notary Public in and for the County of Bernalillo, State of New Mexico, do hereby certify that the foregoing and attached Transcript of Hearing before the New Mexico Oil Conservation Commission was reported by me; and that the same is a true and correct record of the said proceedings, to the best of my knowledge, skill and ability.

Witness my Hand and Seal this 30th day of
January, 1968.

Kay Embree
Notary Public

My Commission Expires:

November 19, 1971

CASE 3710: (a) CREATION OF A NEW OIL POOL

COUNTY LEA POOL NORTH MESCALERO-SAN ANDRES

| TOWNSHIP | 10 South | RANGE | 32 East | NMPM |
|----------|----------|-------|---------|------|
| 6 | 5 | 4 | 3 | 2 |
| 7 | 8 | 9 | 10 | 11 |
| 18 | 17 | 16 | 15 | 14 |
| 19 | 20 | 21 | 22 | 23 |
| 30 | 29 | 28 | 27 | 26 |
| 31 | 32 | 33 | 34 | 35 |
| | | | | 36 |

PURPOSE: One completed oil well capable of producing.

CATTLE LAND OIL COMPANY - Atlantic State #1 in Unit G of Section 1-10-32.

Completed in San Andres on September 4, 1967. Top of Perforations 4133'.

Proposed pool boundary colored in red. SECTION 1: NE/4

*Southwest Nomenclature
Exhibit #1 para 2-6*

CASE 3710: (b) RECREATION OF A NEW OIL POOL

COUNTY LEA POOL EAST MASON-DELAWARE

TOWNSHIP 26 South RANGE 32 East NMFM

| | | | | | |
|----|----|----|---------------|----|----|
| 6 | 5 | 4 | 3 | 2 | 1 |
| 7 | 8 | 9 | 10 | 11 | 12 |
| 18 | 17 | 16 | 15 | 14 | 13 |
| 19 | 20 | 21 | 22 | 23 | 24 |
| 30 | 29 | 28 | 27 | 26 | 25 |
| 31 | 32 | 33 | State Line 34 | 35 | 36 |

PURPOSE: Due to allowable and acreage, the East Mason-Delaware Pool should be recreated and acreage removed from the North Mason-Delaware Pool.

Proposed pool boundary colored in red. SECTION 16: SW/4

SECTION 17: S/2

SECTION 20: N/2

SECTION 21: NW/4

CASE 3710: (c) DELETION OF AN EXISTING OIL POOL
COUNTY LEA POOL NORTH MASON-DELAWARE

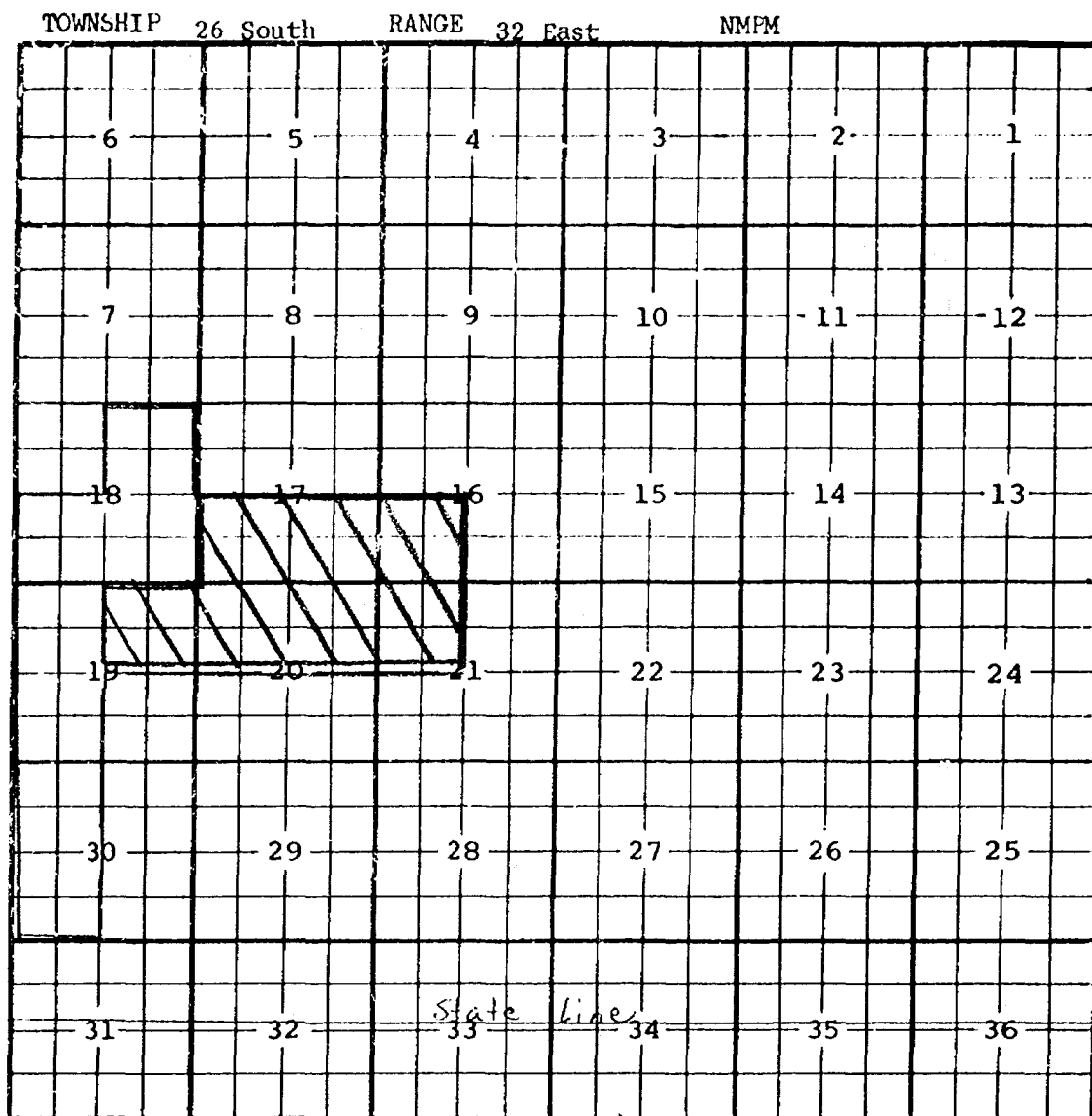

PURPOSE: To correct pool nomenclature. Due to allowable difference, the East Mason-Delaware Pool and North Mason-Delaware Pool should never have been combined.

Pool boundary colored in red.
Proposed pool deletion colored in blue. SECTION 16: SW/4
SECTION 17: S/2
SECTION 19: NE/4
SECTION 20: N/2
SECTION 21: NW/4

[Faint handwritten notes and illegible markings are visible across the page.]

CASE 3710: (e) EXTENSION OF AN EXISTING OIL POOL

COUNTY LEA POOL BAUM-WOLECAMP

TOWNSHIP 14 South RANGE 33 East NMPM

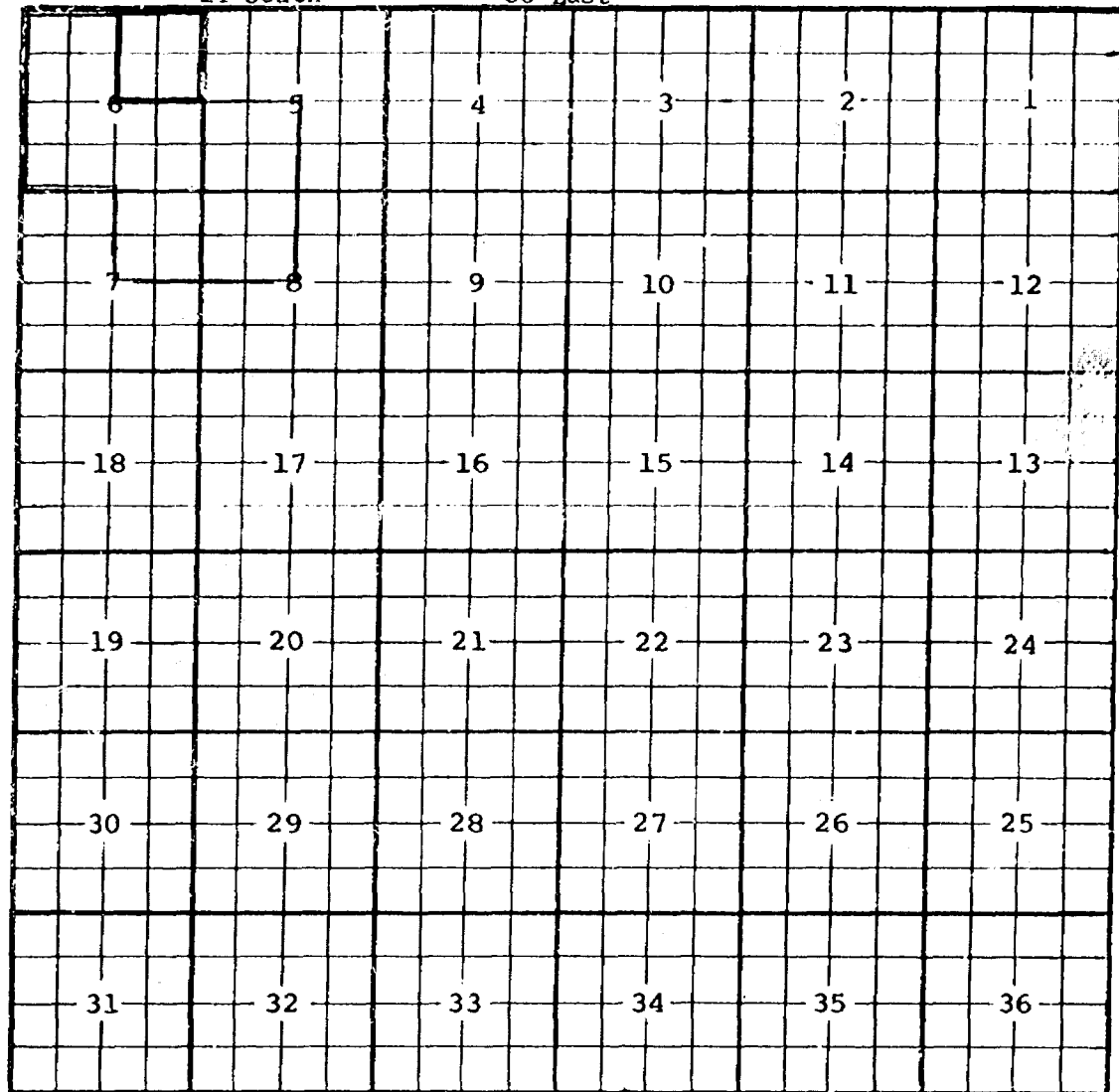

PURPOSE: One completed oil well capable of producing.

COASTAL STATES GAS PRODUCING COMPANY - State "6" #1 in Unit B of Section 6-14-33. Completed in Pennsylvanian on November 9, 1967. Top of Perforations 9906'.

Pool boundary colored in red.

Proposed pool extension colored in green. SECTION 6: NE/4

CASE 3710: (F) EXTENSION OF AN EXISTING OIL POOL
COUNTY LEA POOL SOUTH CORBIN-WOLFCAMP

| TOWNSHIP | 18 South | RANGE | 33 East | NMFM | |
|----------|----------|-------|---------|------|----|
| 6 | 5 | 4 | 3 | 2 | 1 |
| 7 | 8 | 9 | 10 | 11 | 12 |
| 18 | 17 | 16 | 15 | 14 | 13 |
| 19 | 20 | 21 | 22 | 23 | 24 |
| 30 | 29 | 28 | 27 | 26 | 25 |
| 31 | 32 | 33 | 34 | 35 | 36 |

PURPOSE: One completed oil well capable of producing.
AZTEC OIL & GAS COMPANY - Federal PA #1 in Unit J of Section 20-18-33.
Completed in Wolfcamp on November 6, 1967. Top of Perforations 11,103'.
Pool boundary colored in red.
Proposed pool extension colored in green. SECTION 20: SE/4
SECTION 21: SW/4

CASE 3710: (g) EXTENSION OF AN EXISTING OIL POOL

COUNTY LEA POOL MIDWAY-ABO

| TOWNSHIP | 17 South | RANGE | 36 East | NMPM |
|----------|----------|-------|---------|------|
| 6 | 5 | 4 | 3 | 2 |
| 7 | 8 | 9 | 10 | 11 |
| 18 | 17 | 16 | 15 | 14 |
| 19 | 20 | 21 | 22 | 23 |
| 30 | 29 | 28 | 27 | 26 |
| 31 | 32 | 33 | 34 | 35 |
| | | | | 36 |

PURPOSE: One completed oil well capable of producing.

SUNRAY DX OIL COMPANY - New Mexico "EE" State #1 in Unit H of Section 13-17-36. Completed in Upper Abo on August 15, 1967. Top of Perforations 8903'.

Pool boundary colored in red.

Proposed pool extension colored in green. SECTION 13: NE/4

CASE 3710: (h) EXTENSION OF AN EXISTING OIL POOL

COUNTY LEA POOL NORTH MORTON PERMO-PENNSYLVANIAN

| TOWNSHIP | | 14 South | | RANGE | | 35 East | | NMFM | |
|----------|--|----------|--|-------|--|---------|--|------|----|
| | | | | | | | | | |
| | | 6 | | 5 | | 4 | | 3 | |
| | | | | | | | | 2 | |
| | | | | | | | | | 1 |
| | | | | | | | | | |
| | | 7 | | 8 | | 9 | | 10 | |
| | | | | | | | | 11 | |
| | | | | | | | | | 12 |
| | | | | | | | | | |
| | | 18 | | 17 | | 16 | | 15 | |
| | | | | | | | | 14 | |
| | | | | | | | | | 13 |
| | | | | | | | | | |
| | | 19 | | 20 | | 21 | | 22 | |
| | | | | | | | | 23 | |
| | | | | | | | | | 24 |
| | | | | | | | | | |
| | | 30 | | 29 | | 28 | | 27 | |
| | | | | | | | | 26 | |
| | | | | | | | | | 25 |
| | | | | | | | | | |
| | | 31 | | 32 | | 33 | | 34 | |
| | | | | | | | | 35 | |
| | | | | | | | | | 36 |

PURPOSE: One completed oil well capable of producing.

OLEN F. FEATHERSTONE - Amerada Federal #1 in Unit H of Section 31-14-35. Completed in Permo Pennsylvanian on November 9, 1967. Top of Perforations 10,445'.

ADDITION--OLEN F. FEATHERSTONE - Tenneco Fee #1 in Unit J of Section 31-14-35. Completed in Permo Pennsylvanian on December 14, 1967. Top of Perforations 10,450'.

Pool boundary colored in red.

Proposed pool extensions colored in green. SECTION 31: NE/4

ADDITION-----SECTION 31: SE/4

CASE 3710: (i) EXTENSION OF AN EXISTING OIL POOL

COUNTY LEA POOL MORTON-WOLFECAMP

TOWNSHIP 15 South RANGE 34 East NMFM

| | | | | | |
|----|----|----|----|----|----|
| 6 | 5 | 4 | 3 | 2 | 1 |
| 7 | 8 | 9 | 10 | 11 | 12 |
| 18 | 17 | 16 | 15 | 14 | 13 |
| 19 | 20 | 21 | 22 | 23 | 24 |
| 30 | 29 | 28 | 27 | 26 | 25 |
| 31 | 32 | 33 | 34 | 35 | 36 |

PURPOSE: One completed oil well capable of producing.

UNION OIL COMPANY OF CALIFORNIA - Arreguy #1 in Unit B of Section 13-15-34. Completed in Wolfcamp on November 1, 1967. Top of Perforations 10,310'.

Pool boundary colored in red.

Proposed pool extension colored in green. SECTION 13: NE/4

CASE 3710: (j) EXTENSION OF AN EXISTING OIL POOL

COUNTY ROOSEVELT POOL TODD-LOWER SAN ANDRES

| TOWNSHIP | 7 South | RANGE | 36 East | NMFM | |
|----------|---------|-------|---------|------|----|
| 6 | 5 | 4 | 3 | 2 | 1 |
| 7 | 8 | 9 | 10 | 11 | 12 |
| 18 | 17 | 16 | 15 | 14 | 13 |
| 19 | 20 | 21 | 22 | 23 | 24 |
| 30 | 29 | 28 | 27 | 26 | 25 |
| 31 | 32 | 33 | 34 | 35 | 36 |

PURPOSE: Three completed oil wells capable of producing.

SKELLY OIL COMPANY - Linam "A" #1 in Unit P of Section 19-7-36. Completed in San Andres on November 25, 1967. Top of Perforations 4266'.

PAN AMERICAN PETROLEUM CORPORATION - Peterson "A" Federal #1 in Unit M of Section 29-7-36. Completed in San Andres on November 22, 1967. Top of Perforations 4247'.

FRANKLIN, ASTON & FAIR, INC. - Atlantic Smith State #1 in Unit J of Section 31-7-36. Completed in Lower San Andres on November 21, 1967. Top of Perforations 4280'.

Pool boundary colored in red.

Proposed pool extensions colored in green. SECTION 19: SE/4

SECTION 29: SW/4

SECTION 31: SE/4

CASE 3710: (k) EXTENSION OF AN EXISTING OIL POOL (Continued on next page)

COUNTY CHAVES POOL TOM-TOM SAN ANDRES

| TOWNSHIP | 7 South | RANGE | 31 East | NMFM | |
|----------|---------|-------|---------|------|----|
| 6 | 5 | 4 | 3 | 2 | 1 |
| 7 | 8 | 9 | 10 | 11 | 12 |
| 18 | 17 | 16 | 15 | 14 | 13 |
| 19 | 20 | 21 | 22 | 23 | 24 |
| 30 | 29 | 28 | 27 | 26 | 25 |
| 31 | 32 | 33 | 34 | 35 | 36 |

PURPOSE: Two completed oil wells capable of producing.

PAN AMERICAN PETROLEUM CORPORATION - Miller Federal #4 in Unit L of Section 35-7-31. Completed in San Andres on November 1, 1967. Top of Perforations 3932'.

Pool boundary colored in red.

Proposed pool extension colored in green. SECTION 35: SW/4

CASE 3710: (k) EXTENSION OF AN EXISTING OIL POOL (Continued)

COUNTY CHAVES POOL TOM-TOM SAN ANDRES

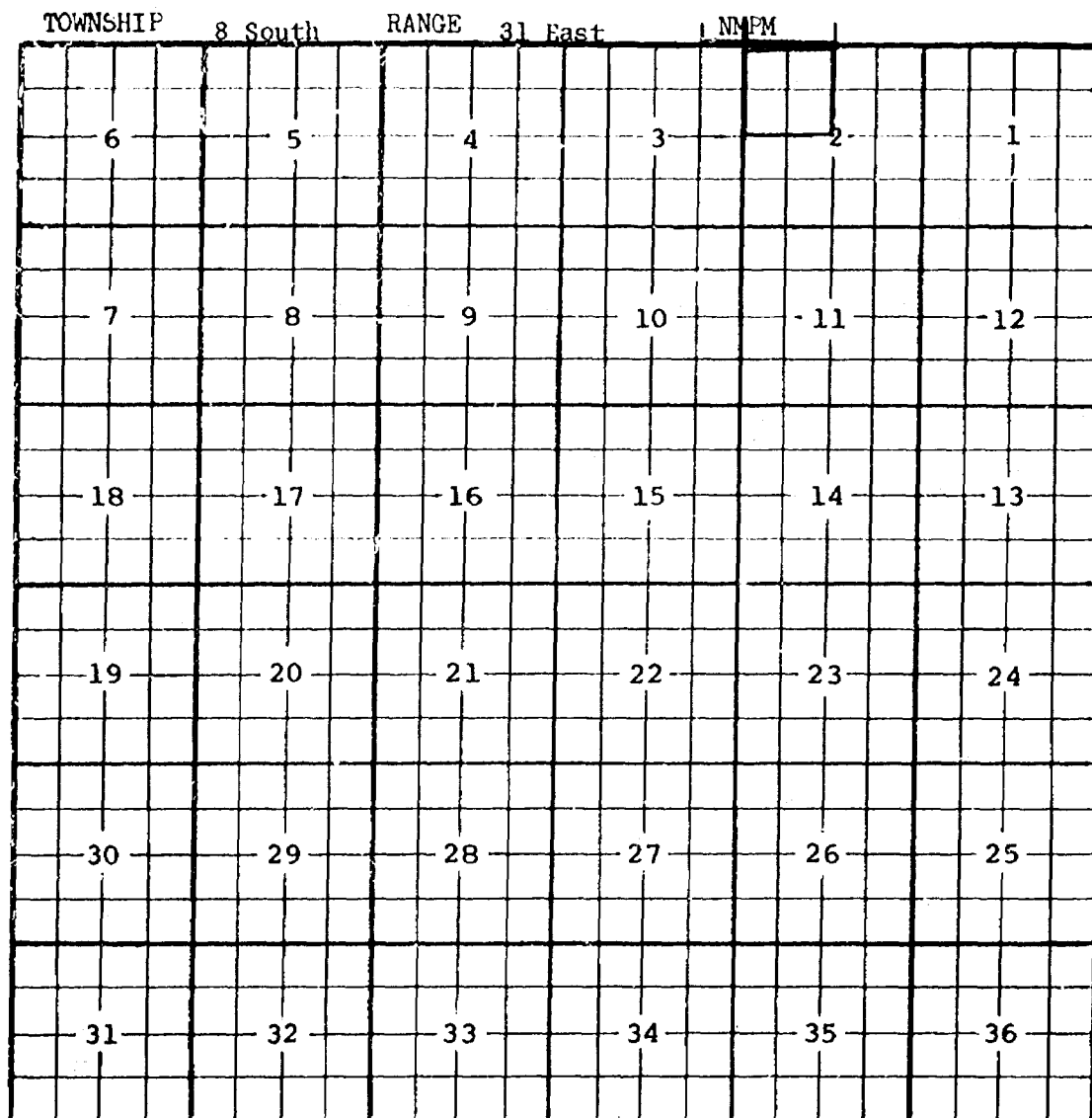

PURPOSE: As stated on preceding page, paragraph (k), Exhibit I.
 UNION TEXAS PETROLEUM CORPORATION - New Mexico #1 in Unit D of Section
 2-8-31. Completed in San Andres on October 28, 1967. Top of Perforations
 3881'.

Pool boundary colored in red.

Proposed pool extension colored in green. SECTION 2: NW/4

CASE 3710: (1) EXTENSION OF AN EXISTING OIL POOL

COUNTY LEA POOL VADA-PENNSYLVANIAN

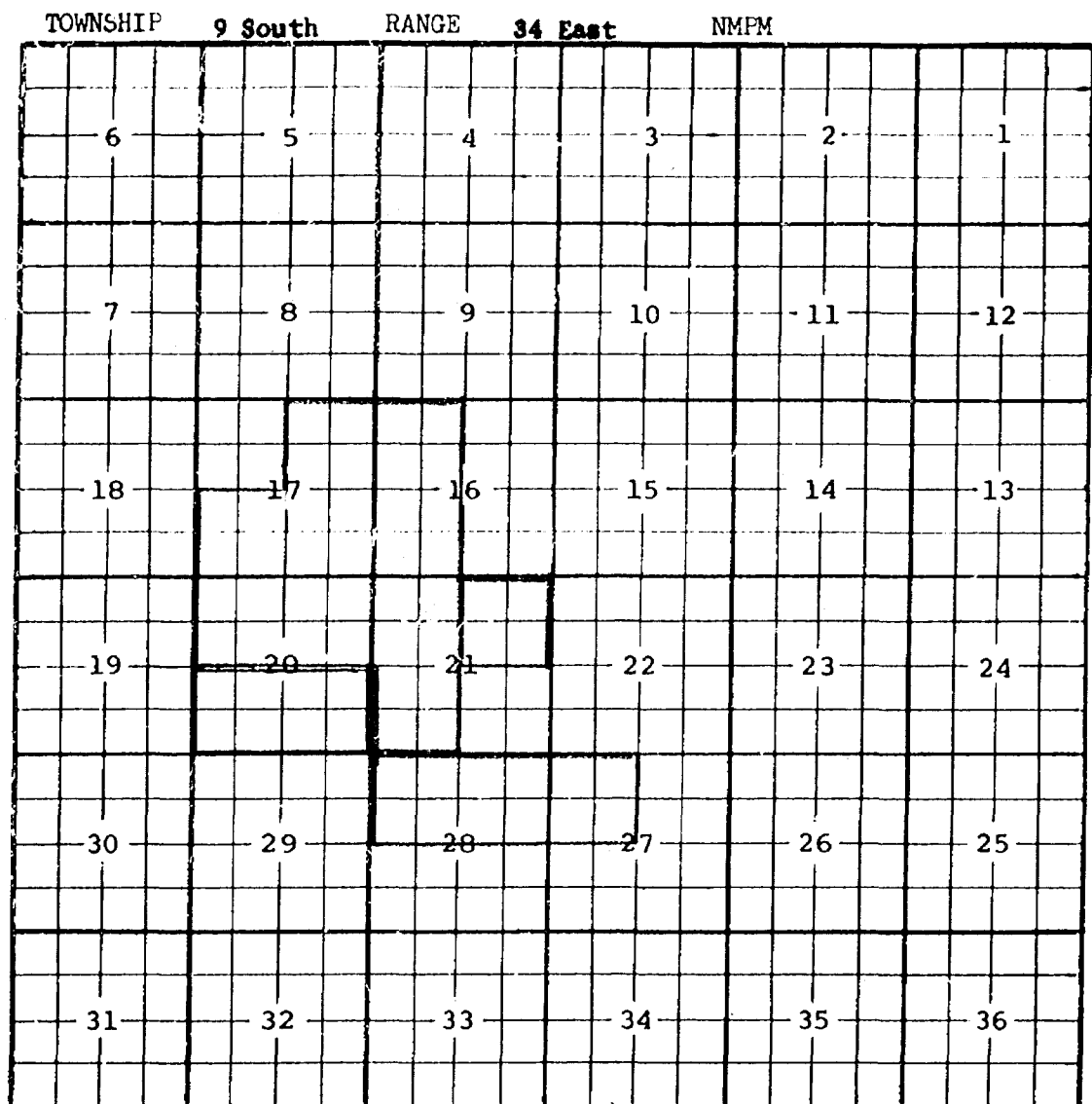

PURPOSE: Two completed oil wells capable of producing. (Wells listed on attached sheet).

Pool boundary colored in red.

Proposed pool extensions colored in green. SECTION 20: SE/4

SECTION 21: NE/4

ADDITIONS-----SECTION 20: SW/4

SECTION 27: NW/4

SECTION 28: N/2

| | | | | |
|----------|---------|-------|--------------------|------|
| COUNTY | LEA | POOL | VADA-PENNSYLVANIAN | |
| TOWNSHIP | 9 South | RANGE | 34 East | NMPM |

BTA OIL PRODUCERS - Vada "B" 673 Ltd. #2 in Unit J of Section 20-9-34. Completed in Bough C on November 18, 1967. Top of Perforations 9848'.

BTA OIL PRODUCERS - Vada "C" 673 Ltd. #3 in Unit B of Section 21-9-34. Completed in Bough C on November 26, 1967. Top of Perforations 9790'.

ADDITION--MIDWEST OIL CORPORATION - Vada Lee Pruitt "C" #1 in Unit K of Section 20-9-34. Completed in Pennsylvanian on December 10, 1967. Top of Perforations 9815'.

ADDITION--THE SUPERIOR OIL COMPANY - Hutcherson Com #1 in Unit C of Section 27-9-34. Completed in Bough "C" on December 18, 1967. Top of Perforations 9835'.

ADDITION--BTA OIL PRODUCERS - Vada "D" 673 Ltd. #4 in Unit D of Section 28-9-34. Completed in Pennsylvanian on December 26, 1967. Top of Perforations 9849'.