

CASE NO.

6380

---

APPLICATION,  
TRANSCRIPTS,  
SMALL EXHIBITS,

ETC.

## NEW MEXICO OIL CONSERVATION COMMISSION

EXAMINER HEARINGSANTA FE, NEW MEXICOHearing Date NOVEMBER 21, 1978 Time: 9:00 A.M.

NAME	REPRESENTING	LOCATION
<del>R. R. Hendrich</del> Tom Kellin Fuell N. Wilson	El Paso Natural Gas Co Huddle Law Firm Kellin & Fox Archie Engmann for EP Petroleum	El Paso Midland Santa Fe Lawrence, Tex
Leo Skinner Peter Mickson Bob Malaise Dennis Zeller L. T. Carr W. Mack Carr, Jr.	DURHAM, Inc. Durham Inc. ARCO ARCO Self	MIDLAND, TX Midland TX Midland TX Midland TX Self Carr
Robert H. Strand Paul Eswhite Joel M. Carson Eddie Mahood William F. Carr Samuel Hogan	Haring & Yates Co. " " Losee, Parsons & Dickson Yates Petroleum Corp Cation, Cation and Gentry Acorn Oil Corp	Roswell, N.M. Artesia, N.M. Artesia, N.M. Artesia, N.M. Santa Fe, N.M. Hartshorn, Tex

STATE OF NEW MEXICO  
ENERGY AND MINERALS DEPARTMENT  
OIL CONSERVATION DIVISION  
State Land Office Building  
Santa Fe, New Mexico  
21 November 1978

EXAMINER HEARING

IN THE MATTER OF:

Application of Harvey E. Yates  
Company, Inc., for a dual  
completion, Eddy County, New Mexico

CASE  
6380

BEFORE: Daniel S. Nutter

TRANSCRIPT OF HEARING

A P P E A R A N C E S

For the Oil Conservation  
Division:

Lynn Teschendorf, Esq.  
Legal Counsel for the Division  
State Land Office Bldg.  
Santa Fe, New Mexico 87501

For the Applicant:

Robert Strand, Esq.  
P. O. BOX 1933  
Roswell, New Mexico

SALLY WALTON BOYD  
CERTIFIED SHORTHAND REPORTER  
3080 Plaza Blanca, Suite 101, Santa Fe, New Mexico 87501

I N D E X

PAUL G. WHITE	3
Direct Examination by Mr. Strand	10
Cross Examination by Mr. Nutter	11
Redirect Examination by Mr. Strand	

E X H I B I T S

Applicant Exhibit Number One, Plat	10
Applicant Exhibit Two, Letter	10
Applicant Exhibit Three, Schematic	10
Applicant Exhibit Four, Log	10
Applicant Exhibit Five, Document	10
Applicant Exhibit Six, Document	10
Applicant Exhibit Seven, Document	10
Applicant Exhibit Eight, Flow test	10

SALLY WALTON BOYD  
CERTIFIED SHORTHAND REPORTER  
3020 Plaza Blanca (SOS) 411-4463  
Santa Fe, New Mexico 87501

1 MR. NUTTER: We'll call next Case 6380.

2 MS. TESCHENDORF: Case 6380. Application of  
3 Harvey E. Yates Company, Inc., for a dual completion, Eddy  
4 County, New Mexico.

5 MR. STRAND: I'm Robert Strand, Roswell, New  
6 Mexico. I'm the attorney for Harvey Yates Company, and in  
7 Case 6380 we will have one witness, Mr. Paul White.

8 (Witness sworn.)  
9

10 PAUL G. WHITE

11 being called as a witness and having been duly sworn upon  
12 his oath, testified as follows, to-wit:  
13

14 DIRECT EXAMINATION

15 BY MR. STRAND:

16 Q State your name, please.

17 A Paul G. White.

18 Q Mr. White, what is your occupation?

19 A Petroleum Engineer.

20 Q Have you been retained by Harvey Yates Com-  
21 pany for the purpose of testifying as to the application in  
22 Case Number 6380?

23 A Yes, sir.

24 Q Have you testified before the Commission  
25 previously?

SALLY WALTON BOYD  
CERTIFIED SHORTHAND REPORTER  
2026 Plaza Elanosa (S.B.) 411-4661  
Santa Fe, New Mexico 87501

SALLY WALTON BOYD  
CERTIFIED SHORTHAND REPORTER  
3020 Plaza Blanca (505) 471-4462  
Santa Fe, New Mexico 87501

1 A Yes, I have.

2 Q Are your qualifications a matter of record  
3 before the Commission?

4 A Yes, sir, they are.

5 MR. STRAND: Mr. Examiner, are Mr. White's  
6 qualifications satisfactory?

7 MR. NUTTER: Yes, they are.

8 Q (Mr. Strand continuing.) Mr. White, would  
9 you briefly explain the purpose of the application in Case  
10 Number 6380?

11 A Harvey Yates seeks to obtain approval for  
12 a dual completion of the upper zone in the Pennsylvanian,  
13 or Canyon Zone, and the lower zone in the Morrow Gas Zone,  
14 in their Travis Deep No. 3 Well.

15 Q Mr. White, would you briefly describe the  
16 completion and production history in the Travis 3 Well?

17 A The Travis No. 3 Well was completed first in  
18 the Morrow Zone and flowed for sixty days on the emergency  
19 period and then a bridge plug was set over the Morrow Zone  
20 and this bridge plug is in place now, and the well was per-  
21 forated in the Canyon Zone and is producing from the Canyon  
22 oil zone at the present time.

23 The well is located 1980 feet from the east  
24 line, 660 feet from the north line, Section 13, Township 18  
25 South, Range 28 East, Eddy County, New Mexico.

SALLY WALTON BOYD  
CERTIFIED SHORTHAND REPORTER  
3030 Plaza Blanca (66) 411-9402  
Santa Fe, New Mexico 87501

1 Q Mr. White, I refer you to what has been marked  
2 as Exhibit Number One, and was this exhibit prepared by you  
3 or under your supervision?

4 A It was prepared under my supervision.

5 Q Would you please identify the exhibit and  
6 explain its contents?

7 A This exhibit shows the location of the Travis  
8 Deep No. 3 Well, and in Section 13, 18, 28, and it also  
9 shows in red a boundary of an area covered by an operating  
10 agreement, and the operator of this unit that is bound by  
11 red on the plat. It's operated by HEYCO, or Harvey E. Yates  
12 Company.

13 Q Mr. White, referring to page two of the ex-  
14 hibit, does this show the leases and wells offsetting the  
15 Travis Deep No. 3 Well?

16 A Yes, sir, it does.

17 Q You refer to an operating agreement. What  
18 are the depth limitations under that agreement?

19 A The depth limitations are basically from  
20 500 feet below the base of the San Andres to the top of the  
21 Barnett Shale.

22 Q Mr. White, is the Travis 3 Well, and all of  
23 the offset wells shown on page two, are they all within that  
24 depth limitation and subject to that agreement?

25 A Yes, sir, that is correct.

SALLY WALTON BOYD  
CERTIFIED SHORTHAND REPORTER  
3030 Plaza Blanca (906) 471-2462  
Santa Fe, New Mexico 87501

1 Q I refer you to what has been marked as Exhibit  
2 Number Two. Will you please identify this exhibit and ex-  
3 plain its contents?

4 A Exhibit Number Two is a letter written by  
5 Mr. Fred Yates and this letter went out to all of the offset  
6 operators, and it requests the temporarily abandoning of  
7 the Morrow Zone, or bridging off the Morrow Zone, and at-  
8 tempting a completion in the Canyon, and then at the future  
9 at some future date drilling this well, dual completing the  
10 well.

11 AFE's, or authorizations for expenditures,  
12 were sent out to all of the offset operators, and these are  
13 signed and we have signed copies, not -- we have signed  
14 copies of all the offset operators in the area, and also  
15 a copy of the authorization of expenditure which was mailed  
16 out.

17 MR. NUTTER: Now by offset operators you mean  
18 the interest owners in this operating area?

19 A Yes, sir, that's correct.

20 MR. NUTTER: They're participating owners,  
21 actually?

22 A Yes, sir, that's correct.

23 MR. NUTTER: Okay.

24 Q (Mr. Strand continuing.) Mr. White, I refer  
25 refer you to what has been marked as Exhibit Number Three.



SALLY WALTON BOYD  
CERTIFIED SHORTHAND REPORTER  
2020 Plaza Blanca (S.E.) 471-4462  
Santa Fe, New Mexico 87501

1 Was this exhibit prepared by you or under your supervision?

2 A Yes, sir, this exhibit was prepared by me.

3 Q Would you please identify and explain this  
4 exhibit?

5 A This is a schematic diagram of the mechanical  
6 dual completion of the Travis Deep No. 3, as proposed by  
7 Harvey E. Yates Company.

8 It shows all of the casing, tubing, the paral-  
9 lel strings of tubing, the packers and their position in  
10 the well, the Canyon oil perforations, and the Morrow gas  
11 perforations, plugged back TD, and tops of cement.

12 Q Mr. White, in your opinion does this proposed  
13 procedure and technique conform with accepted engineering  
14 practices?

15 A Yes, sir, it does, and in fact is the, pro-  
16 bably, the best method of dually completing this well.

17 Q And in your opinion it does comply with the  
18 rules and regulations of the Commission?

19 A Yes, sir.

20 Q Mr. White, please refer to the Exhibit Number  
21 Four and identify this exhibit.

22 A Exhibit Number Four is a collar and perfor-  
23 ating log on the Travis Deep Unit No. 3, and we have, for  
24 purposes of examination, we have colored in the Morrow Gas  
25 Zone in red down at 10,973 to 10,994, and then on the same

SALLY WALTON BOYD  
CERTIFIED SHORTHAND REPORTER  
3030 Plaza Blanca (909) 471-4452  
Santa Fe, New Mexico 87501

1 log we have colored in blue the Canyon oil zone overall  
2 perforations from 9830 down to 9920.

3 Q Mr. White, in your opinion would this log  
4 tend to show that the intervals as you've designated them  
5 are separate and distinct?

6 A Yes, sir.

7 Q Two zones?

8 A Yes, sir, that is correct.

9 Q Referring to Exhibit Number Five, was this  
10 exhibit prepared by you or under your supervision?

11 A Yes, sir, it was prepared under my supervision

12 Q Would you please explain the data that's con-  
13 tained in that exhibit?

14 A This exhibit was prepared to show the dif-  
15 ference in the quality or the kind of liquids which are  
16 produced from the two zones, indicating that they are dis-  
17 tinct zones. This shows actual sales of crude oil from the  
18 Morrow Zone and it's evident that this gravity of this liquid  
19 is in the 52 to 59 degree range API, and the gravity in the  
20 Canyon Zone, or the liquids sold from there in May of '78,  
21 is in the range of 41 to 46 gravity, showing a distinct dif-  
22 ference in the gravity of the crude oil and the condensate  
23 from the Morrow Zone.

24 Q Mr. White, referring to Exhibit Number Six  
25 and Seven, were these also prepared by you?

SALLY WALTON BOYD  
CERTIFIED SHORTHAND REPORTER  
3350 Plaza Blanca (Ses) 411-4102  
Santa Fe, New Mexico 87501

1 A Yes, sir, they were prepared by me.

2 Q Would you please explain the data contained  
3 in those two exhibits?

4 A We used Exhibit Six to identify the differ-  
5 ences in the liquids and we used Exhibit Seven -- Six and  
6 Seven to identify the difference in the gas quality from the  
7 two zones.

8 These exhibits were taken directly from a  
9 gas chromatigraph furnished by El Paso Pipeline Company,  
10 the purchaser of the gas, and it shows the 10 percent of the  
11 different products in the gas. It identified the specific  
12 gravity and BTU in the Morrow Zone as specific gravity .969,  
13 BTU 1661.

14 And in the Canyon Zone the specific gravity  
15 of the gas was .688 and the BTU of that gas was 1192,  
16 which indicates quite a difference in the -- in the gas from  
17 the Morrow and the gas from the Canyon.

18 Q Referring to Exhibit Number Eight, did you  
19 again prepare this exhibit?

20 A Yes, sir, I prepared this exhibit.

21 Q Will you explain the content?

22 A Yes, sir. This is a flow test conducted on  
23 the Morrow Zone on March the 7th, 1978, and the Canyon Zone,  
24 conducted on May 17th, 1978.

25 We've prepared this exhibit mainly to show

1 the difference in flowing pressures on the two zones and the  
2 difference in gas/liquid ratios. The exhibit shows that  
3 the gas/liquid ratio of the Morrow Zone is 101,050-to-1  
4 and the gas/liquid ratio on the Canyon Zone is 1290 cubic  
5 feet to one barrel, indicating the wide difference in the  
6 gas/liquid ratios from the two zones.

7 Q What was the source of this particular data?

8 A The source of the data on the flow test was  
9 from field tests run by the pumper in the field.

10 Q Mr. White, is it your opinion, then, that  
11 these two zones which you've referred to are separate and  
12 distinct zones of production?

13 A Yes, sir, that is correct.

14 MR. STRAND: Mr. Examiner, I move the admission  
15 of Exhibits One through Eight.

16 MR. NUTTER: Applicant's Exhibits One through  
17 Eight will be admitted in evidence.

18  
19 CROSS EXAMINATION

20 BY MR. NUTTER:

21 Q Mr. White, do you have any idea as to the  
22 respective bottom hole pressures for these two zones?

23 A No, sir, we had the -- we had the Morrow  
24 bottom hole pressure but we did not have the Canyon bottom  
25 hole pressure.

SALLY WALTON BOYD  
CERTIFIED SHORTHAND REPORTER  
3030 Plaza Blanca (S.B.) 471-4463  
Santa Fe, New Mexico 87501

SALLY WALTON BOYD  
CERTIFIED SHORTHAND REPORTER  
302 Plaza Alamosa (915) 411-2443  
Santa Fe, New Mexico 87501

1 A The Morrow bottom hole pressure will run  
2 about 1000 psi over the Canyon bottom hole pressure.

3 MR. NUTTER: Are there any further questions  
4 of Mr. White? He may be excused.

5 Do you have anything further, Mr. Strand?

6 MR. STRAND: Just one -- a couple more ques-  
7 tions, Mr. Examiner.

8 REDIRECT EXAMINATION

9  
10 BY MR. STRAND:

11 Q Mr. White, do you feel that approval of this  
12 application will provide Harvey E. Yates Company the oppor-  
13 tunity to produce its just and equitable share of production?

14 A Yes, sir, I do.

15 Q Do you also feel it will prevent waste and  
16 protect correlative rights?

17 A Yes, sir.

18 MR. STRAND: That's all I have, Mr. Examiner.

19 MR. NUTTER: If there are no further questions  
20 of the witness, he may be excused.

21 Do you have anything further, Mr. Strand?

22 MR. STRAND: Nothing further.

23 MR. NUTTER: Does anyone have anything they  
24 wish to offer in Case Number 6380?

25 We'll take the case under advisement.

(Hearing concluded.)

# REPORTER'S CERTIFICATE

I, SALLY WALTON BOYD, a Court Reporter, DO HEREBY CERTIFY that the foregoing and attached Transcript of Hearing before the Oil Conservation Division was reported by me; that said transcript is a full, true, and correct record of the hearing, prepared by me to the best of my ability, knowledge, and skill, from my notes taken at the time of the hearing.

Sally W. Boyd CSR  
Sally W. Boyd, C.S.R.

SALLY WALTON BOYD  
CERTIFIED COURT REPORTER  
1430 Park, Suite 1000  
Dallas, Texas 75201

I do hereby certify that the foregoing is a complete record of the proceedings in the Examiner hearing of Case No. 6389 heard by me on 11/21 1978.  
[Signature], Examiner  
Oil Conservation Division



STATE OF NEW MEXICO  
ENERGY AND MINERALS DEPARTMENT  
OIL CONSERVATION DIVISION

IN THE MATTER OF THE HEARING  
CALLED BY THE OIL CONSERVATION  
DIVISION FOR THE PURPOSE OF  
CONSIDERING:

CASE NO. 6380  
Order No. R-5899

APPLICATION OF HARVEY E. YATES  
COMPANY, INC. FOR A DUAL COMPLETION,  
EDDY, COUNTY, NEW MEXICO

ORDER OF THE DIVISION

BY THE DIVISION:

This cause came on for hearing at 9 o'clock a. m. on  
November 21, 1978, at Santa Fe, New Mexico, before Examiner  
Daniel S. Nutter.

NOW, on this 16th day of January, 1979, the Division  
Director, having considered the testimony, the record, and  
the recommendations of the Examiner, and being fully advised  
in the premises,

FINDS:

(1) That due public notice having been given as required  
by law, the Division has jurisdiction of this cause and the  
subject matter thereof.

(2) That the applicant, Harvey E. Yates Company, Inc.,  
seeks authority to complete its Travis Deep Unit Well No. 3,  
located in Unit B of Section 13, Township 18 South, Range 28  
East, NMPM, Eddy County, New Mexico, as a dual completion  
(conventional) to produce oil from the Travis-Upper Pennsylvanian  
Pool and gas from the Morrow formation through parallel strings  
of tubing, with separation of the zones to be achieved by means  
of a packer set at approximately 9700 feet.

(3) That the mechanics of the proposed dual completion are  
feasible and in accord with good conservation practices.

(4) That approval of the subject application will prevent  
waste and protect correlative rights.

IT IS THEREFORE ORDERED:

(1) That the applicant, Harvey E. Yates Company, Inc.,



-2-

Case No. 6380  
Order No. R-5899

is hereby authorized to complete its Travis Deep Unit Well No. 3, located in Unit B of Section 13, Township 18 South, Range 28 East, NMPM, Eddy County, New Mexico, as a dual completion (conventional) to produce oil from the Travis-Upper Pennsylvanian Pool and gas from the Morrow formation, through parallel strings of tubing, separated by a packer set at approximately 9700 feet.

PROVIDED HOWEVER, that the applicant shall complete, operate, and produce said well in accordance with the provisions of Rule 112-A of the Division Rules and Regulations insofar as said rule is not inconsistent with this order;

PROVIDED FURTHER, that the applicant shall take Packer Leakage Tests upon completion and annually thereafter during the Annual Shut In Pressure Test Period for the Morrow gas zone.

(2) That jurisdiction of this cause is retained for the entry of such further orders as the Division may deem necessary.

DONE at Santa Fe, New Mexico, on the day and year hereinabove designated.

STATE OF NEW MEXICO  
OIL CONSERVATION DIVISION

  
JOE D. RAMSEY  
Director

  
S E A L

jt/

HARVEY E. YATES COMPANY  
 TRAVIS DEEP #3 WELL  
 PLATS SHOWING LOCATION OF  
 OFFSET WELLS, OFFSET LEASES,  
 AND OPERATORS OF OFFSET LEASES.

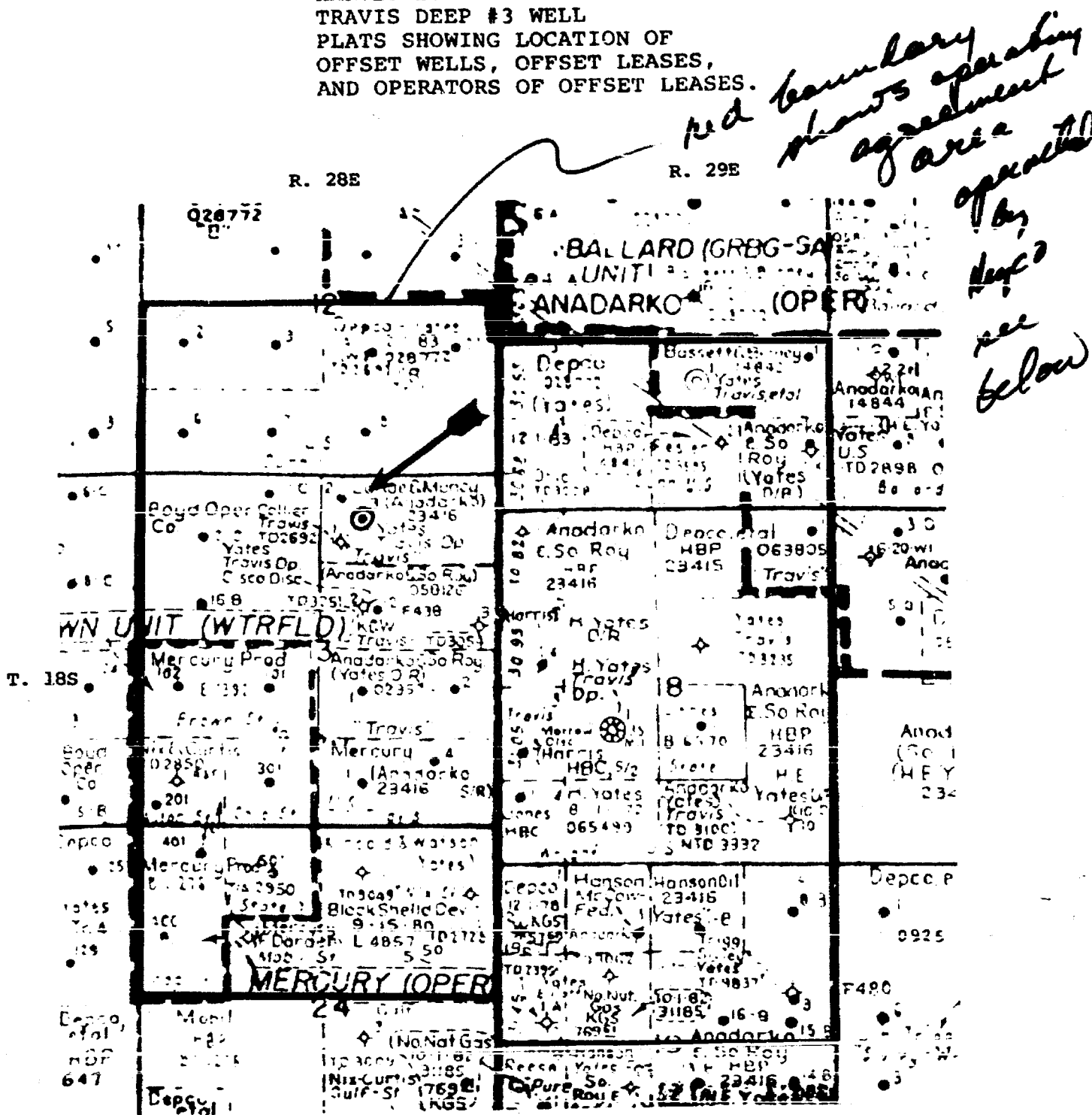

The area outlined in red represents the unit area covered by a joint operating agreement dated June 1, 1976 designating Harvey E. Yates Company as operator and covering depths from 500' below the base of the San Andreas Formation down to the top of the Barnett Shale or 100 feet below the deepest stratigraphic interval penetrated in the initial test well drilled under said agreement but, in any event not below the top of the Solid Mississippian Lime.

Exhibit No. \_\_\_\_\_

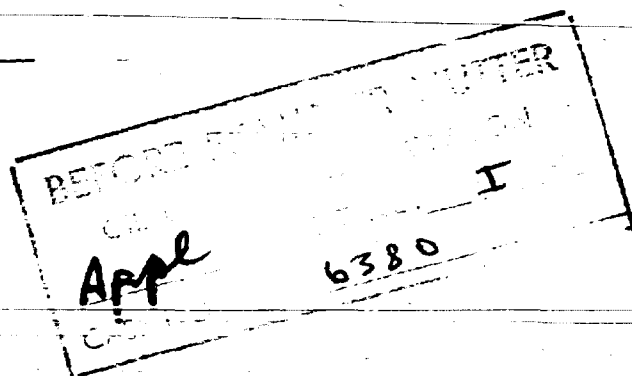

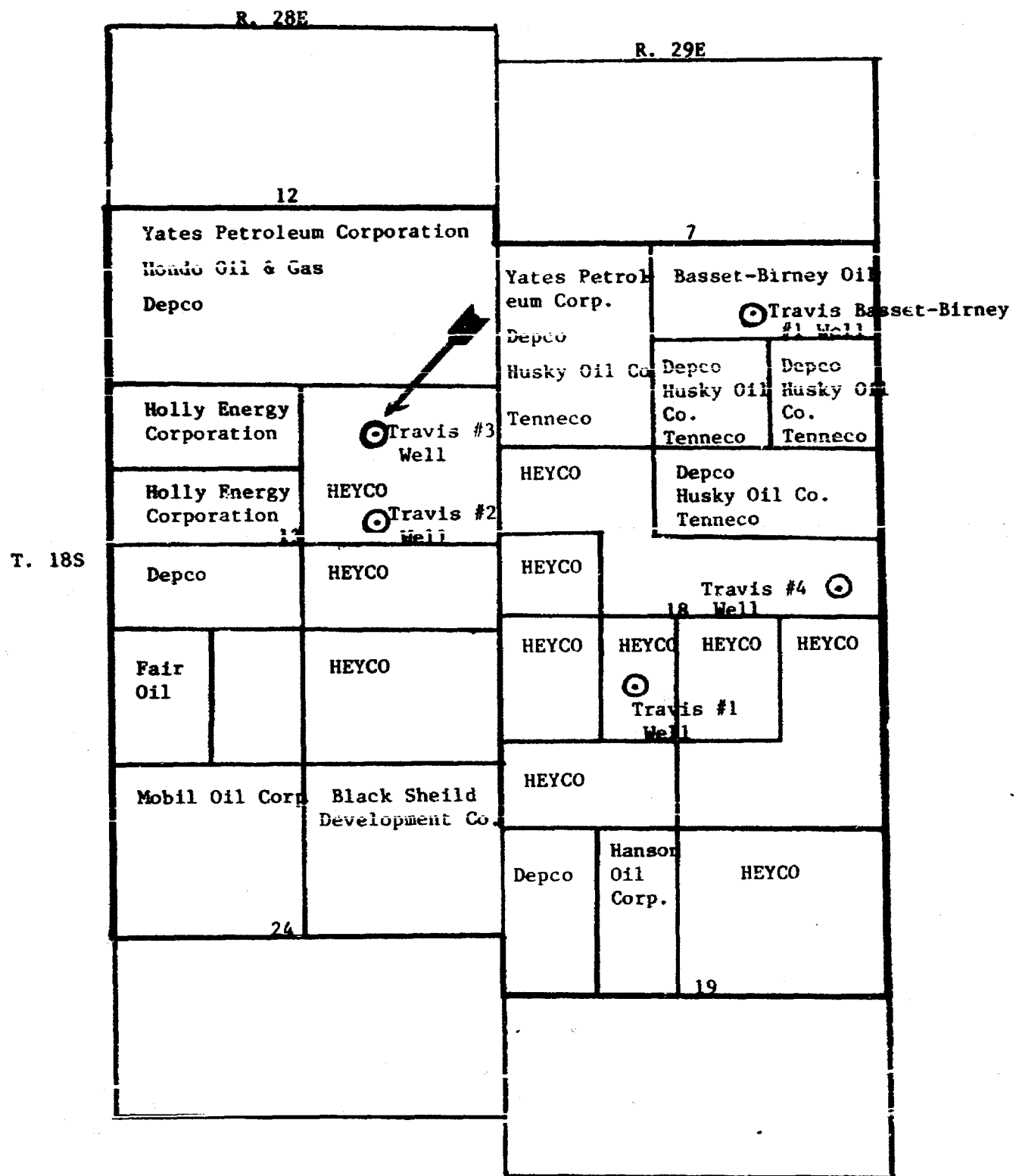

PHONE (505) 923-6601

**HEYCO**

PETROLEUM PRODUCERS



**HARVEY E. YATES COMPANY, INC.**

SUITE 1000 SECURITY NATIONAL BANK BUILDING  
Mailing Address: P. O. Box 1933

ROSWELL, NEW MEXICO 88201

April 28, 1978

TRAVIS DEEP UNIT WORKING INTEREST OWNERS  
(See Attached Mailing List)

Re: Harvey E. Yates Company,  
Travis Deep Com Well #3  
NW/4 NE/4 Sec. 13,  
T-18S, R-28E, N.M.P.M.  
Eddy County, New Mexico

Gentlemen:

The captioned well was completed as a Morrow producer. We have sold the Morrow production for 60 days under an emergency contract to El Paso Natural Gas Company. This contract ended April 15, 1978.

We now recommend temporarily abandoning the Morrow and attempting a completion in the Canyon. As you are aware, the Canyon is present in the #2 Travis, and is a prolific oil zone. The porosity zones to be perforated occur in the interval 9830-9920'.

At some future time after entering into a long-term contract for the disposition of Morrow gas, assuming our completion in the Canyon is successful, we will dually complete this well.

Attached are two copies of an AFE covering the costs of testing and completing this well in the Canyon formation. If you are in agreement with this proposal, please sign and return one copy to us at your earliest convenience.

Yours very truly,

Fred G. Yates  
Vice President

/jr  
Attachment

EXHIBIT NO.

BEFORE EXAMINER NUTTER	
OIL CONSERVATION DIVISION	
Appl	EXHIBIT NO. II
CASE NO.	6380

HARVEY E. YATES COMPANY

AFE To Plug Off Morrow Formation And  
Recomplete in Canyon Formation

INTANGIBLES

Well Service Unit	\$7,000.00	
Baker Packers and Rental Tools	4,000.00	
Perforating	3,500.00	
Treating - Acidizing	5,000.00	
Test Tank	500.00	
BOP	300.00	
Completion Fluids	1,000.00	
Engineering Services	3,000.00	
Transportation	500.00	
Pump Truck	250.00	
Wire Line Services	2,000.00	
Labor	<u>1,000.00</u>	
Total Intangibles		\$28,050.00

TANGIBLES

LP Separator	1,000.00	
Miscellaneous Connections and Valves	<u>500.00</u>	
Total Tangibles		<u>1,500.00</u>
Total Tangible and Intangible		<u><u>29,550.00</u></u>

APPROVED BY:

\_\_\_\_\_

Company: \_\_\_\_\_

Date: \_\_\_\_\_

JULY 2 & 1970

HARVEY E. YATES COMPANY  
*Travis Deep Conn. well #3*  
AFE To Plug Off Morrow Formation And  
Recomplete in Canyon Formation

INTANGIBLES

Well Service Unit	\$7,000.00
Baker Packers and Rental Tools	4,000.00
Perforating	3,500.00
Treating - Acidizing	5,000.00
Test Tank	500.00
BOP	300.00
Completion Fluids	1,000.00
Engineering Services	3,000.00
Transportation	500.00
Pump Truck	250.00
Wire Line Services	2,000.00
Labor	<u>1,000.00</u>
 Total Intangibles	 \$28,050.00

TANGIBLES

LP Separator	1,000.00
Miscellaneous Connections and Valves	<u>500.00</u>
 Total Tangibles	 <u>1,500.00</u>
 Total Tangible and Intangible	 <u><u>29,550.00</u></u>

ATTEST:

By: Edward B. Dunning  
Assistant Cashier

Rogers Aston  
Rogers Aston, Co-Trustee of the "C"  
Trust U/W/O Bert Aston  
and

First National Bank in Dallas,  
Co-Trustee of the "C" Trust  
U/W/O Bert Aston

By: Ernest M. Barnett  
Vice President-Trust

RECEIVED MAY 22 1978

HARVEY E. YATES COMPANY

AFE To Plug Off Morrow Formation And  
Recomplete in Canyon Formation

INTANGIBLES

Well Service Unit	\$7,000.00	
Baker Packers and Rental Tools	4,000.00	
Perforating	3,500.00	
Treating - Acidizing	5,000.00	
Test Tank	500.00	
BOP	300.00	
Completion Fluids	1,000.00	
Engineering Services	3,000.00	
Transportation	500.00	
Pump Truck	250.00	
Wire Line Services	2,000.00	
Labor	<u>1,000.00</u>	
Total Intangibles		\$28,050.00

TANGIBLES

LP Separator	1,000.00	
Miscellaneous Connections and Valves	<u>500.00</u>	
Total Tangibles		<u>1,500.00</u>
Total Tangible and Intangible		<u>29,550.00</u>

APPROVED BY:



Company: Mobil Oil Corporation

Date: 5/18/78

HARVEY E. YATES COMPANY

AFE To Plug Off Morrow Formation And  
Recomplete in Canyon Formation

INTANGIBLES

Well Service Unit	\$7,000.00	
Baker Packers and Rental Tools	4,000.00	
Perforating	3,500.00	
Treating - Acidizing	5,000.00	
Test Tank	500.00	
BOP	300.00	
Completion Fluids	1,000.00	
Engineering Services	3,000.00	
Transportation	500.00	
Pump Truck	250.00	
Wire Line Services	2,000.00	
Labor	1,000.00	
Total Intangibles		\$28,050.00

TANGIBLES

LP Separator	1,000.00	
Miscellaneous Connections and Valves	500.00	
Total Tangibles		<u>1,500.00</u>
Total Tangible and Intangible		<u>29,550.00</u>

APPROVED BY:

*[Signature]*

Company: Hondo Oil & Gas Company

Date: May 18, 1978



HARVEY E. YATES COMPANY  
AFE To Plug Off Morrow Formation And  
Recomplete in Canyon Formation

INTANGIBLES

Well Service Unit	\$7,000.00	
Baker Packers and Rental Tools	4,000.00	
Perforating	3,500.00	
Treating - Acidizing	5,000.00	
Test Tank	500.00	
ROP	300.00	
Completion Fluids	1,000.00	
Engineering Services	3,000.00	
Transportation	500.00	
Pump Truck	250.00	
Wire Line Services	2,000.00	
Labor	<u>1,000.00</u>	
Total Intangibles		\$28,050.00

TANGIBLES

LP Separator	1,000.00	
Miscellaneous Connections and Valves	<u>500.00</u>	
Total Tangibles		<u>1,500.00</u>
Total Tangible and Intangible		<u>29,550.00</u>

APPROVED BY:

*D. H. Meyer*

Company: *Harvey E. Yates Co.*

Date: *7-14-78*

HARVEY E. YATES COMPANY  
 AFE To Plug Off Morrow Formation And  
 Recomplete in Canyon Formation

INTANGIBLES

Well Service Unit	\$7,000.00	
Baker Packers and Rental Tools	4,000.00	
Perforating	3,500.00	
Treating - Acidizing	5,000.00	
Test Tank	500.00	
BOP	300.00	
Completion Fluids	1,000.00	
Engineering Services	3,000.00	
Transportation	500.00	
Pump Truck	250.00	
Wire Line Services	2,000.00	
Labor	1,000.00	
		\$28,050.00
Total Intangibles		

TANGIBLES

LP Separator	1,000.00	
Miscellaneous Connections and Valves	500.00	
		<u>1,500.00</u>
Total Tangibles		
Total Tangible and Intangible		<u>29,550.00</u>

APPROVED BY:

Rogers Aston  
 Company: Rogers Aston, individually, and as Trustee  
 of Esther Aston Trusts Nos. 1 & 2.  
 Date: May 12, 1978

HARVEY E. YATES COMPANY

AFE To Plug Off Morrow Formation And  
Recomplete in Canyon Formation

INTANGIBLES

Well Service Unit	\$7,000.00	
Baker Packers and Rental Tools	4,000.00	
Perforating	3,500.00	
Treating - Acidizing	5,000.00	
Test Tank	500.00	
BOP	300.00	
Completion Fluids	1,000.00	
Engineering Services	3,000.00	
Transportation	500.00	
Pump Truck	250.00	
Wire Line Services	2,000.00	
Labor	1,000.00	
Total Intangibles		\$28,050.00

TANGIBLES

LP Separator	1,000.00	
Miscellaneous Connections and Valves	500.00	
Total Tangibles		<u>1,500.00</u>
Total Tangible and Intangible		<u>29,550.00</u>

APPROVED BY

*John A. G. T.*  
Company: *Yates Pet Corp + Bassett + Birney*

Date: *5-11-78*

HARVEY E. YATES COMPANY

AFE To Plug Off Morrow Formation And  
Recomplete in Canyon Formation

INTANGIBLES

Well Service Unit	\$7,000.00	
Baker Packers and Rental Tools	4,000.00	
Perforating	3,500.00	
Treating - Acidizing	5,000.00	
Test Tank	500.00	
BOP	300.00	
Completion Fluids	1,000.00	
Engineering Services	3,000.00	
Transportation	500.00	
Pump Truck	250.00	
Wire Line Services	2,000.00	
Labor	<u>1,000.00</u>	
Total Intangibles		\$28,050.00

TANGIBLES

LP Separator	1,000.00	
Miscellaneous Connections and Valves	<u>500.00</u>	
Total Tangibles		<u>1,500.00</u>
Total Tangible and Intangible		<u><u>29,550.00</u></u>

APPROVED BY:

C. D. Cummings for H. J.

Company: Dillco Inc.

Date: 5-1-75

HARVEY E. YATES COMPANY

AFE To Plug Off Morrow Formation And  
Recomplete in Canyon Formation

INTANGIBLES

Well Service Unit	\$7,000.00	
Baker Packers and Rental Tools	4,000.00	
Perforating	3,500.00	
Treating - Acidizing	5,000.00	
Test Tank	500.00	
BOP	300.00	
Completion Fluids	1,000.00	
Engineering Services	3,000.00	
Transportation	500.00	
Pump Truck	250.00	
Wire Line Services	2,000.00	
Labor	<u>1,000.00</u>	
Total Intangibles		\$28,050.00

TANGIBLES

LP Separator	1,000.00	
Miscellaneous Connections and Valves	<u>500.00</u>	
Total Tangibles		<u>1,500.00</u>
Total Tangible and Intangible		<u><u>29,550.00</u></u>

APPROVED BY:

J. J. Parsham

Company: HOLLY ENERGY, INC.

Date: May 3, 1978

RECEIVED MAY 05 1978

HARVEY E. YATES COMPANY

AFE To Plug Off Morrow Formation And  
Recomplete in Canyon Formation

INTANGIBLES

Well Service Unit	\$7,000.00	
Baker Packers and Rental Tools	4,000.00	
Perforating	3,500.00	
Treating - Acidizing	5,000.00	
Test Tank	500.00	
BOP	300.00	
Completion Fluids	1,000.00	
Engineering Services	3,000.00	
Transportation	500.00	
Pump Truck	250.00	
Wire Line Services	2,000.00	
Labor	<u>1,000.00</u>	
Total Intangibles		\$28,050.00

TANGIBLES

LP Separator	1,000.00	
Miscellaneous Connections and Valves	<u>500.00</u>	
Total Tangibles		<u>1,500.00</u>
Total Tangible and Intangible		<u>29,550.00</u>

APPROVED BY:

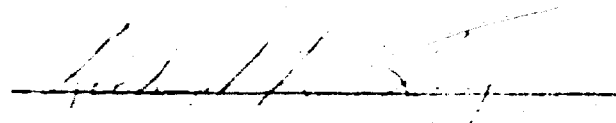

Company: FAIR OIL, LTD.

Date: 5-2-78

APPROVED MAY 04 1973

HARVEY E. YATES COMPANY

AFE To Plug Off Morrow Formation And  
Recomplete in Canyon Formation

INTANGIBLES

Well Service Unit	\$7,000.00
Baker Packers and Rental Tools	4,000.00
Perforating	3,500.00
Treating - Acidizing	5,000.00
Test Tank	500.00
BOP	300.00
Completion Fluids	1,000.00
Engineering Services	3,000.00
Transportation	500.00
Pump Truck	250.00
Wire Line Services	2,000.00
Labor	<u>1,000.00</u>

Total Intangibles

\$28,050.00

TANGIBLES

LP Separator	1,000.00
Miscellaneous Connections and Valves	<u>500.00</u>

Total Tangibles

1,500.00

Total Tangible and Intangible

29,550.00

APPROVED BY: \_\_\_\_\_

Company: \_\_\_\_\_

Date: \_\_\_\_\_

RECEIVED MAY 02 1978

7 KAVIS #3

HARVEY E. YATES COMPANY

AFE To Plug Off Morrow Formation And  
Recomplete in Canyon Formation

INTANGIBLES

Well Service Unit	\$7,000.00	
Baker Packers and Rental Tools	4,000.00	
Perforating	3,500.00	
Treating - Acidizing	5,000.00	
Test Tank	500.00	
BOP	300.00	
Completion Fluids	1,000.00	
Engineering Services	3,000.00	
Transportation	500.00	
Pump Truck	250.00	
Wire Line Services	2,000.00	
Labor	1,000.00	
Total Intangibles		\$28,050.00

TANGIBLES

LP Separator	1,000.00	
Miscellaneous Connections and Valves	500.00	
Total Tangibles		<u>1,500.00</u>
Total Tangible and Intangible		<u>29,550.00</u>

APPROVED BY:

Reagan & Stuart

Company: Hansen Oil Corporation

Date: 5-1-78



HARVEY E. YATES COMPANY

AFE To Plug Off Morrow Formation And  
Recomplete in Canyon Formation

INTANGIBLES

Well Service Unit	\$7,000.00	
Baker Packers and Rental Tools	4,000.00	
Perforating	3,500.00	
Treating - Acidizing	5,000.00	
Test Tank	500.00	
BOP	300.00	
Completion Fluids	1,000.00	
Engineering Services	3,000.00	
Transportation	500.00	
Pump Truck	250.00	
Wire Line Services	2,000.00	
Labor	1,000.00	
Total Intangibles		\$28,050.00

TANGIBLES

LP Separator	1,000.00	
Miscellaneous Connections and Valves	500.00	
Total Tangibles		<u>1,500.00</u>
Total Tangible and Intangible		<u>29,550.00</u>

APPROVED BY:

John L. Anderson Jr.

Company: Reed & Stevens, Inc.

Date: 5-1-78

HARVEY E. YATES COMPANY

TRAVIS DEEP UNIT NO 3

1980 FEL, 660 FNL 13-185-28E EDDY

SCHEMATIC - DUAL COMPLETION

GROUND LEVEL ELEV: 3639'

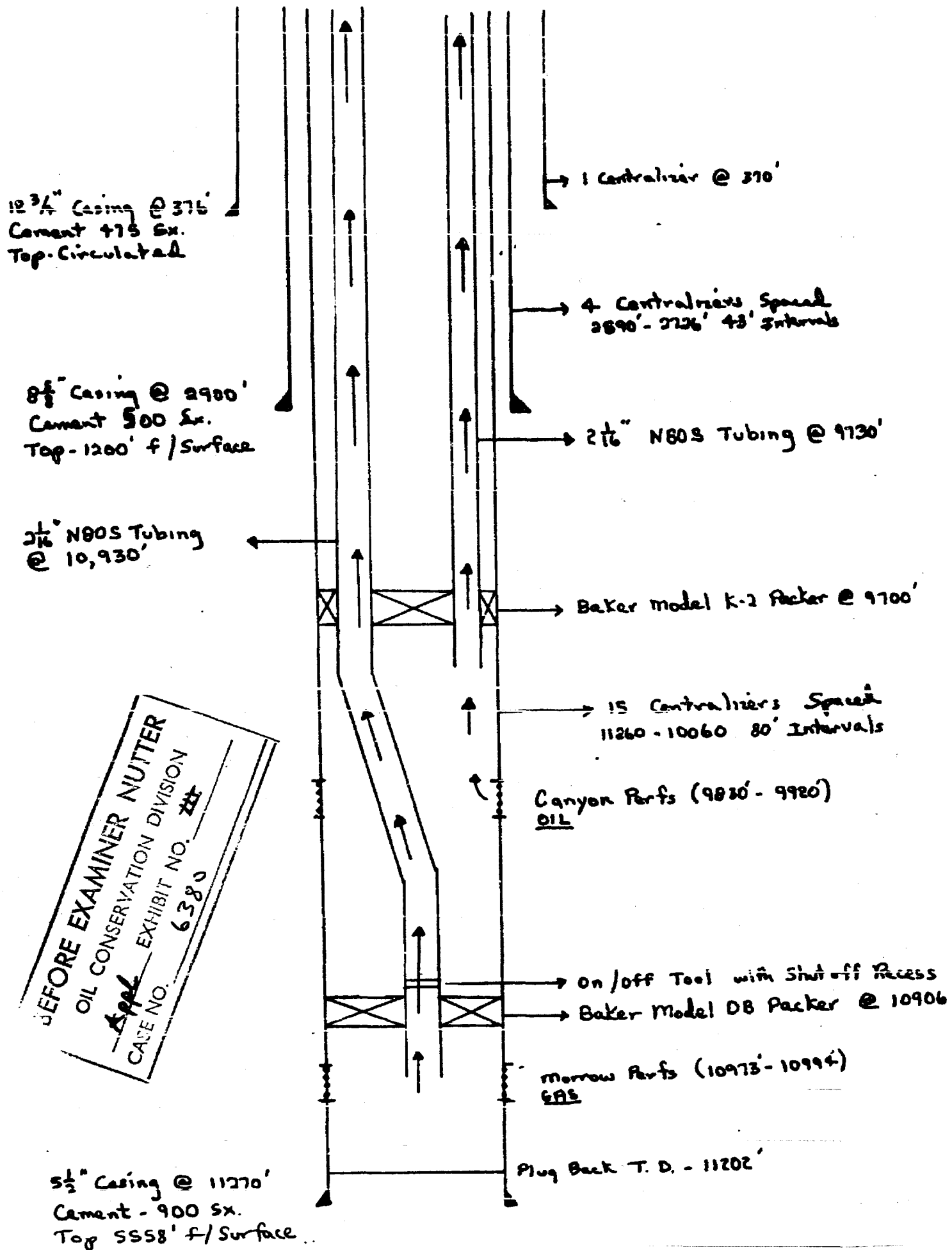

BEFORE EXAMINER NUTTER  
OIL CONSERVATION DIVISION  
CASE NO. 6380  
EXHIBIT NO. 24

EXHIBIT NO

HARVEY E. YATES COMPANY  
 TRAVIS DEEP UNIT NO. 3  
 1980' FEL, 660' FNL, 13-18S-28E  
 EDDY COUNTY, NEW MEXICO

November 17, 1978

NAVAJO CRUDE OIL PURCHASING

MORROW ZONE

SALE DATE

GRAVITY OF LIQUID

NET BARRELS

3-06-78  
 3-12-78  
 3-17-78  
 3-21-78  
 3-28-78  
 3-31-78

52.0  
 52.2  
 52.6  
 59.8  
 52.0  
 53.5

203.42  
 172.06  
 167.33  
 193.61  
 180.65  
 179.10

NAVAJO CRUDE OIL PRUCHASING

CANYON ZONE

SALE DATE

GRAVITY OF LIQUID

NET BARRELS

5-16-78  
 5-19-78  
 5-19-78  
 5-24-78  
 5-25-78  
 5-27-78  
 5-28-78  
 5-28-78  
 5-28-78  
 5-29-78  
 5-30-78  
 5-31-78  
 5-31-78

41.2  
 45.2  
 45.2  
 48.7  
 45.5  
 46.7  
 46.3  
 46.3  
 46.3  
 45.5  
 46.6  
 46.2  
 46.2

198.86  
 170.95  
 170.95  
 173.09  
 198.82  
 164.15  
 179.12  
 176.80  
 199.58  
 156.84  
 169.53  
 200.34  
 198.26

EXHIBIT NO.

BEFORE EXAMINER MUTTER  
 OIL COMMISSION DIVISION  
 CASE NO. 6380

HARVEY E. YATES COMPANY  
TRAVIS DEEP UNIT NO. 3  
1980' FEL, 660' FNL, 13-18S-28E  
EDDY COUNTY, NEW MEXICO  
November 17, 1978

GAS CROMATOGRAPH (MORROW ZONE)

DATE: 6-5-78

<u>PRODUCT</u>	<u>NORMAL MOL%</u>	<u>GPM</u>
CO 2	00.00	0.000
H2S	00.00	0.000
N 2	00.00	0.000
METHANE	47.20	0.000
ETHANE	30.88	8.254
PROPANE	14.96	4.115
ISO-BUTANE	01.68	0.549
NORM-BUTANE	03.59	1.131
ISO-PENTANE	00.61	0.223
NORM-PENTANE	00.32	0.116
HEXANE PLUS	<u>00.76</u>	<u>0.332</u>

TOTALS 100.00 14.720

SPECIFIC GRAVITY 0.969  
BTU 1661

EXHIBIT NO.

BEFORE EXAMINER

OIL CONSERVATION DISTRICT

*Appl* EXHIBIT NO. VI

CASE NO. 6380

HARVEY E. YATES' COMPANY  
TRAVIS DEEP UNIT NO. 3  
1980' FEL, 660' FNL, 13-18S-28E  
EDDY COUNTY, NEW MEXICO  
November 17, 1978

GAS CROMATOGRAPH (CANYON)

DATE: 6-5-78

<u>PRODUCT</u>	<u>NORMAL MOL%</u>	<u>GPM</u>
CO 2	00.27	0.000
H2S	00.00	0.000
N 2	01.44	0.000
METHANE	80.07	0.000
ETHANE	12.95	3.462
PROPANE	03.78	1.040
ISO-BUTANE	00.36	0.118
NORM-BUTANE	00.75	0.236
ISO-PENTANE	00.13	0.048
NORM-PENTANE	00.13	0.047
HEXANE PLUS	<u>00.12</u>	<u>0.052</u>
TOTALS	100.00	5.003

SPECIFIC GRAVITY 0.688  
BTU 1192

EXHIBIT NO.

BEFORE EXAMINER NUTTER  
OIL CONSERVATION DIVISION  
APR 11 1979 EXHIBIT NO. VII  
CASE NO. 6380

HARVEY E. YATES COMPANY  
TRAVIS DEEP UNIT NO. 3  
1980' FEL, 660' FNL, 13-18S-28E  
EDDY COUNTY, NEW MEXICO

November 17, 1978

FLOW TEST MORROW ZONE (March 7, 1978)

GAS:

576.0 MCF

OIL/CONDENSATE

5.7 BBLs

WATER

-0-

TUBING PRESSURE

2591 psig

CHOKE

16/64

GAS - LIQUID RATIO

101,050 cubic feet to 1 barrel

FLOW TEST CANYON ZONE (May 17, 1978)

GAS:

148.0 MCF

OIL/CONDENSATE

114 BBLs

WATER

\*22 BBLs

TUBING PRESSURE

580 psig

CHOKE

24/64

GAS - LIQUID RATIO

1290 cubic feet to 1 barrel

\*LOAD WATER

EXHIBIT NO.

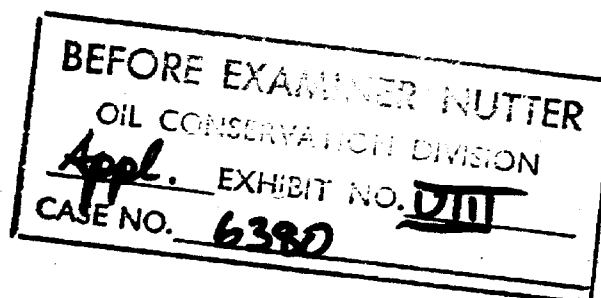

- CASE 6380: Application of Harvey E. Yates Company, Inc., for a dual completion, Eddy County, New Mexico. Applicant, in the above-styled cause, seeks approval for the dual completion of its Travis Deep Well No. 3 located in Unit B of Section 13, Township 18 South, Range 23 East, to produce oil from the Travis-Upper Pennsylvanian Pool and gas from the Morrow formation, Eddy County, New Mexico, through parallel strings of tubing.
- CASE 6381: Application of Yates Petroleum Corporation for downhole commingling, Eddy County, New Mexico. Applicant, in the above-styled cause, seeks approval for the downhole commingling of East Cottonwood Creek-Wolfcamp and Atoka production within the wellbore of its Lizzie Howard "HK" Well No. 1 located in Unit K of Section 13, Township 16 South, Range 25 East, Eddy County, New Mexico.
- CASE 6382: Application of Yates Petroleum Corporation for downhole commingling, Eddy County, New Mexico. Applicant, in the above-styled cause, seeks approval for the downhole commingling of Permo-Penn and Little Box Canyon-Atoka production within the wellbore of its Federal "HQ" Well No. 1 located in Unit K of Section 5, Township 21 South, Range 22 East, Eddy County, New Mexico.
- CASE 6383: Application of Yates Petroleum Corporation for downhole commingling, Eddy County, New Mexico. Applicant, in the above-styled cause, seeks approval for the downhole commingling of Eagle Creek Permo-Penn and the West Atoka-Morrow production within the wellbore of its Powell "DG" Com. Well No. 1 located in Unit O of Section 35, Township 17 South, Range 25 East, Eddy County, New Mexico.
- CASE 6384: Application of Yates Petroleum Corporation for downhole commingling, Eddy County, New Mexico. Applicant, in the above-styled cause, seeks approval for the downhole commingling of Permo-Penn and Atoka production within the wellbore of its Federal "AB" Com. Well No. 5 located in Unit L of Section 21, Township 18 South, Range 25 East, Eddy County, New Mexico.
- CASE 6385: Application of Yates Petroleum Corporation for downhole commingling, Eddy County, New Mexico. Applicant, in the above-styled cause, seeks approval for the downhole commingling of Box Canyon Permo-Penn and Box Canyon-Strawn production within the wellbore of its Huber I-A Federal Well No. 2 located in Unit P of Section 15, Township 21 South, Range 21 East, Eddy County, New Mexico.
- CASE 6386: Application of Atlantic Richfield Company for compulsory pooling, Lea County, New Mexico. Applicant, in the above-styled cause, seeks an order pooling all mineral interests in the Ellenburger, Devonian, and McKee formations underlying the N/2 of Section 21, Township 22 South, Range 36 East, Lea County, New Mexico, to be dedicated to its Langley Greer Com Well No. 1 located 1650 feet from the North line and 1980 feet from the West line of said Section 21. Also to be considered will be the cost of drilling and completing said well and the allocation of the cost thereof as well as actual operating costs and charges for supervision. Also to be considered will be the designation of applicant as operator of the well and a charge for risk involved in drilling said well.
- CASE 6387: Application of R B Petroleum Company for pool reclassification, San Juan County, New Mexico. Applicant, in the above-styled cause, seeks the reclassification of the North Tocito Dome-Pennsylvanian Pool as an associated pool and the promulgation of special pool rules therefor. In the alternative, applicant seeks the abolishment of the North Tocito Dome-Pennsylvanian Pool and the inclusion of the abolished lands in the Tocito Dome Pennsylvanian "D" Associated Pool.
- CASE 6388: Application of Amoco Production Company for compulsory pooling, Eddy County, New Mexico. Applicant, in the above-styled cause, seeks an order pooling all mineral interests in the Pennsylvanian formation underlying the E/2 of Section 20, Township 23 South, Range 29 East, Eddy County, New Mexico, to be dedicated to a well to be drilled at a standard location thereon. Also to be considered will be the cost of drilling and completing said well and the allocation of the cost thereof as well as actual operating costs and charges for supervision. Also to be considered will be the designation of applicant as operator of the well and a charge for risk involved in drilling said well.
- CASE 6389: Application of Durham, Inc., for pool contraction and extension, Eddy County, New Mexico. Applicant, in the above-styled cause, seeks the contraction of the Indian Basin-Morrow Gas Pool by the deletion therefrom of the N/2 of Section 8, Township 21 South, Range 24 East, Eddy County, New Mexico, or in the alternative, all of said Section 8, and the extension of the Cemetery-Morrow Gas Pool to include the aforesaid N/2 or all of said Section 8.
- CASE 6390: Application of C & E Operators for compulsory pooling, San Juan County, New Mexico. Applicant, in the above-styled cause, seeks an order pooling all mineral interests down thru the Pictured Cliffs formation underlying the SW/4 of Section 10, Township 30 North, Range 11 West, San Juan County, New Mexico, to be dedicated to a well to be drilled at a standard location thereon. Also to be considered will be the cost of drilling and completing said well and the allocation of the cost thereof as well as actual operating costs and charges for supervision. Also to be considered will be the designation of applicant as operator of the well and a charge for risk involved in drilling said well.

Docket No. 37-78

Dockets Nos. 39-78 and 40-78 are tentatively set for hearing on December 7 and 20, 1978. Applications for hearing must be filed at least 22 days in advance of hearing date.

DOCKET: COMMISSION HEARING - TUESDAY - NOVEMBER 14, 1978

OIL CONSERVATION COMMISSION - 9 A.M. - ROOM 205  
STATE LAND OFFICE BUILDING, SANTA FE, NEW MEXICO

The following cases are continued from the November 7, 1978, Commission Hearing.

CASE 6146: (DE NOVO) (Continued and Readvertised)

Application of Jerome P. McHugh for downhole commingling, Rio Arriba County, New Mexico. Applicant, in the above-styled cause, seeks approval for the downhole commingling of Taspacito-Gallup and Basin-Dakota production within the wellbore of his Jicarilla Well No. 5 located in Unit D of Section 29, Township 26 North, Range 4 West, Rio Arriba County, New Mexico.

Upon application of Jerome P. McHugh this case will be heard De Novo pursuant to the provisions of Rule 1220.

CASE 6266: (DE NOVO)

Application of Harvey E. Yates Company for an unorthodox gas well location, Eddy County, New Mexico. Applicant, in the above-styled cause, seeks approval for the unorthodox location of an Upper Pennsylvanian test well to be located 660 feet from the North and East lines or, in the alternative, 990 feet from the North and East lines of Section 23, Township 22 South, Range 23 East, Indian Basin-Upper Pennsylvanian Gas Pool, Eddy County, New Mexico, all of said Section 23 to be dedicated to the well.

Upon application of Harvey E. Yates Company this case will be heard De Novo pursuant to the provisions of Rule 1220.

CASE 6377: Application of Durham, Inc., for compulsory pooling, Eddy County, New Mexico. Applicant, in the above-styled cause, seeks an order pooling all mineral interests in the Morrow formation underlying Section 8, Township 21 South, Range 24 East, Indian Basin-Morrow Gas Pool, Eddy County, New Mexico, to be dedicated to a well to be drilled 1650 feet from the North and East lines of said Section 8. Also to be considered will be the cost of drilling and completing said well and the allocation of the cost thereof as well as actual operating costs and charges for supervision. Also to be considered will be the designation of applicant as operator of the well and a charge for risk involved in drilling said well.

CASE 6378: In the matter of the hearing called by the Oil Conservation Division on the motion of Shell Oil Company to permit Corinne Grace and all other interested parties to appear and show cause why Division Order No. R-3713, which pooled all of Section 8, Township 21 South, Range 24 East, Eddy County, New Mexico, should not be declared null and void, if said pooling order has not already automatically expired due to non-production.

CASE 6379: Application of Shell Oil Company for pool contraction and pool extension, Eddy County, New Mexico. Applicant, in the above-styled cause, seeks the contraction of the Indian Basin-Morrow Gas Pool by the deletion therefrom of the N/2 of Section 8, Township 21 South, Range 24 East, Eddy County, New Mexico, or in the alternative, all of said Section 8, and the extension of the Cemetery-Morrow Gas Pool to include the aforesaid N/2 or all of said Section 8.

\*\*\*\*\*

Docket No. 38-78

DOCKET: EXAMINER HEARING - TUESDAY - NOVEMBER 21, 1978

9 A.M. - OIL CONSERVATION DIVISION CONFERENCE ROOM,  
STATE LAND OFFICE BUILDING, SANTA FE, NEW MEXICO

The following cases will be heard before Daniel S. Nutter, Examiner, or Richard L. Stamets, Alternate Examiner:

ALLOWABLE: (1) Consideration of the allowable production of gas for December, 1978, from fifteen prorated pools in Lea, Eddy, and Chaves Counties, New Mexico.

(2) Consideration of the allowable production of gas for December, 1978, from four prorated pools in San Juan, Rio Arriba, and Sandoval Counties, New Mexico.



CASE 6391: Application of Acoma Oil Corporation for downhole commingling, Lea County, New Mexico. Applicant, in the above-styled cause, seeks approval for the downhole commingling of Blinbry, Watts-Abe, and Drinkard production within the wellbore of its Sarkeys Well No. 1 located in Unit A of Section 26, Township 21 South, Range 37 East, Lea County, New Mexico.

CASE 6364: (Continued from October 25, 1978, Examiner Hearing)

Application of Adobe Oil Company for compulsory pooling, Lea County, New Mexico. Applicant, in the above-styled cause, seeks an order pooling all mineral interests from the surface to the base of the Ellenburger formation underlying the NW/4 SE/4 of Section 23, Township 20 South, Range 38 East, Lea County, New Mexico, to be dedicated to a proposed oil well to be drilled at a standard location thereon. Applicant seeks the pooling of the SE/4 of said Section 23 in the event said drilling results in a gas well. Also to be considered will be the cost of drilling and completing said well and the allocation of the cost thereof as well as actual operating costs and charges for supervision. Also to be considered will be the designation of applicant as operator of the well and a charge for risk involved in drilling said well.

PHONE (808) 872-2201

**HEYCO**

PETROLEUM PRODUCERS



**HARVEY E. YATES COMPANY, INC.**

SUITE 1000 SECURITY NATIONAL BANK BUILDING

ROSWELL, NEW MEXICO 88201

October 30, 1978

NOV - 1 1978

Case 6380

CONSERVATION COMMISSION

Santa Fe

Oil Conservation Commission

Box 2088

Santa Fe, New Mexico 87501

Attn: Mr. Dan Nutter

Re: Dual Completion  
Travis Deep #3  
Unit B, Section 13  
T18S, R28E, N.M.P.M.  
Eddy County, New Mexico

Dear Mr. Nutter:

Confirming my telephone application for dual completion of the above referenced well, I enclose an original and two copies of form C-107 with Exhibits.

As we discussed by phone, this application will be set for examiner hearing on November 11, 1978.

hmr  
21

Very truly yours,

Robert H. Strand

RHS/sj  
Enclosures

NEW MEXICO OIL CONSERVATION COMMISSION  
SANTA FE, NEW MEXICO  
APPLICATION FOR MULTIPLE COMPLETION

Form C-107  
5-1-51

NOV - 1 1978

Case  
6380

Operator <b>Harvey E. Yates Company</b>		County <b>Eddy</b>	Date <b>10-30-78</b>
Address <b>P. O. Box 1933, Roswell, N. M. 88201</b>		Lease <b>Travis Deep</b>	Well No. <b>3</b>
Location of Well <b>B</b>	Unit <b>13</b>	Township <b>18S</b>	Range <b>28E</b>

1. Has the New Mexico Oil Conservation Commission heretofore authorized the multiple completion of a well in these same pools or in the same zones within one mile of the subject well? YES \_\_\_\_\_ NO X
2. If answer is yes, identify one such instance: Order No. \_\_\_\_\_ ; Operator Lease, and Well No.: \_\_\_\_\_

3. The following facts are submitted:	Upper Zone	Intermediate Zone	Lower Zone
a. Name of Pool and Formation	Travis Upper Penn		Morrow
b. Top and Bottom of Pay Section (Perforations)	9830' - 9920'		10,973' - 10,994'
c. Type of production (Oil or Gas)	Oil		Gas
d. Method of Production (Flowing or Artificial Life)	Flowing		Flowing

4. The following are attached. (Please check YES or NO)

- |                                     |                          |                                                                                                                                                                                                                                                                                                                                                                                                 |
|-------------------------------------|--------------------------|-------------------------------------------------------------------------------------------------------------------------------------------------------------------------------------------------------------------------------------------------------------------------------------------------------------------------------------------------------------------------------------------------|
| Yes                                 | No                       |                                                                                                                                                                                                                                                                                                                                                                                                 |
| <input checked="" type="checkbox"/> | <input type="checkbox"/> | a. Diagrammatic Sketch of the Multiple Completion, showing all casing strings, including diameters and setting depths, centralizers and/or turbolizers and location thereof, quantities used and top of cement, perforated intervals, tubing strings, including diameters and setting depth, location and type of packers and side door chokes, and such other information as may be pertinent. |
| <input checked="" type="checkbox"/> | <input type="checkbox"/> | b. Plat showing the location of all wells on applicant's lease, all offset wells on offset leases, and the names and addresses of operators of all leases offsetting applicant's lease.                                                                                                                                                                                                         |
| <input type="checkbox"/>            | <input type="checkbox"/> | c. Waivers consenting to such multiple completion from each offset operator, or in lieu thereof, evidence that said offset operators have been furnished copies of the application.*                                                                                                                                                                                                            |
| <input type="checkbox"/>            | <input type="checkbox"/> | d. Electrical log of the well or other acceptable log with tops and bottoms of producing zones and intervals of perforation indicated thereon. (If such log is not available at the time application is filed it shall be submitted as provided by Rule 112-A.)                                                                                                                                 |

5. List all offset operators to the lease on which this well is located together with their correct mailing address.

6. Were all operators listed in Item 5 above notified and furnished a copy of this application? YES NA NO \_\_\_\_\_. If answer is yes, give date of such notification \_\_\_\_\_.

CERTIFICATE: I, the undersigned, state that I am the Attorney of the Harvey E. Yates Company (company), and that I am authorized by said company to make this report; and that this report was prepared under my supervision and direction and that the facts stated therein are true, correct and complete to the best of my knowledge.

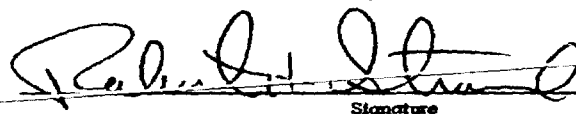
  
Signature

\*Should waivers from all offset operators not accompany an application for administrative approval, the New Mexico Oil Conservation Commission will hold the application for a period of twenty (20) days from date of receipt by the Commission's Santa Fe office. If, after said twenty-day period, no protest nor request for hearing is received by the Santa Fe office, the application will then be processed.

NOTE: If the proposed multiple completion will result in an unorthodox well location and/or a non-standard perforation unit in one or more of the producing zones, then separate application for approval of the same should be filed simultaneously with this application.

HARVEY E. YATES COMPANY  
Travis Deep No. 3-B-18-28  
Eddy County, New Mexico  
MULTIPLE COMPLETION INSTALLATION

1. Centralizer @ 370'

12 3/4" @ 376' w/ 475 lbs

4. Centralizers - 45'

Spacing 2890' - 2726'

8 5/8" @ 2900' w/ 900 lbs

CEMENT CURE TO SURFACE

CEMENT CURE 1200'

15. 2 1/8" OD, 3.40" ID, DSS THD, N-80 TBY.

14. 2 1/8" OD, 3.40" ID, GST THD, N-80 TBY.

13. 2 1/8" X 1.50" Seating nipple

12. BAKER MODEL "S" SNAP LATCH SEAL ASSY (1" ID)

11. BAKER 45B MODEL K-2 DG Packer

10. 2 1/8" 15 tubing

9830' - 9840' KB - 6 Holes

9864' - 9875' KB - 6 Holes

9891' - 9894' KB - 6 Holes

9911' - 9920' KB - 6 Holes

15. Centralizers - 80 FT

Spacing 11240' to 10060' KB

9. 2 3/8" x 2 7/8" OD BENT JOINT

8. 2 3/8" OD N-80 tubing

7. ON-OFF Tool w/ 1.81" F profile @ 10904' KB

6. BAKER 44-26 Model DB RRP Packer @ 10906' KB

5. Tubing Seal Assembly

4. 2 3/8" X 1.50" BFC "F" nipple @ 10921' KB

3. Perforated sub 10928' - 10934' KB

2. VANNTAGE tubing release sub w/ 1.50" profile

1. VANN Tool perforating gun

10,971' - 10,975' KB

PERFS:

10973' to 10994' KB

Gas 84 holes

PBTD 11201' KB

5 1/2" @ 11270' w/ 900 lbs TD

DRAWN BY: PECK HARDEE, P.E.

Exhibit B to Application of  
Harvey E. Yates Company (HEYCO) for Dual  
Completion of The Travis #3 Well

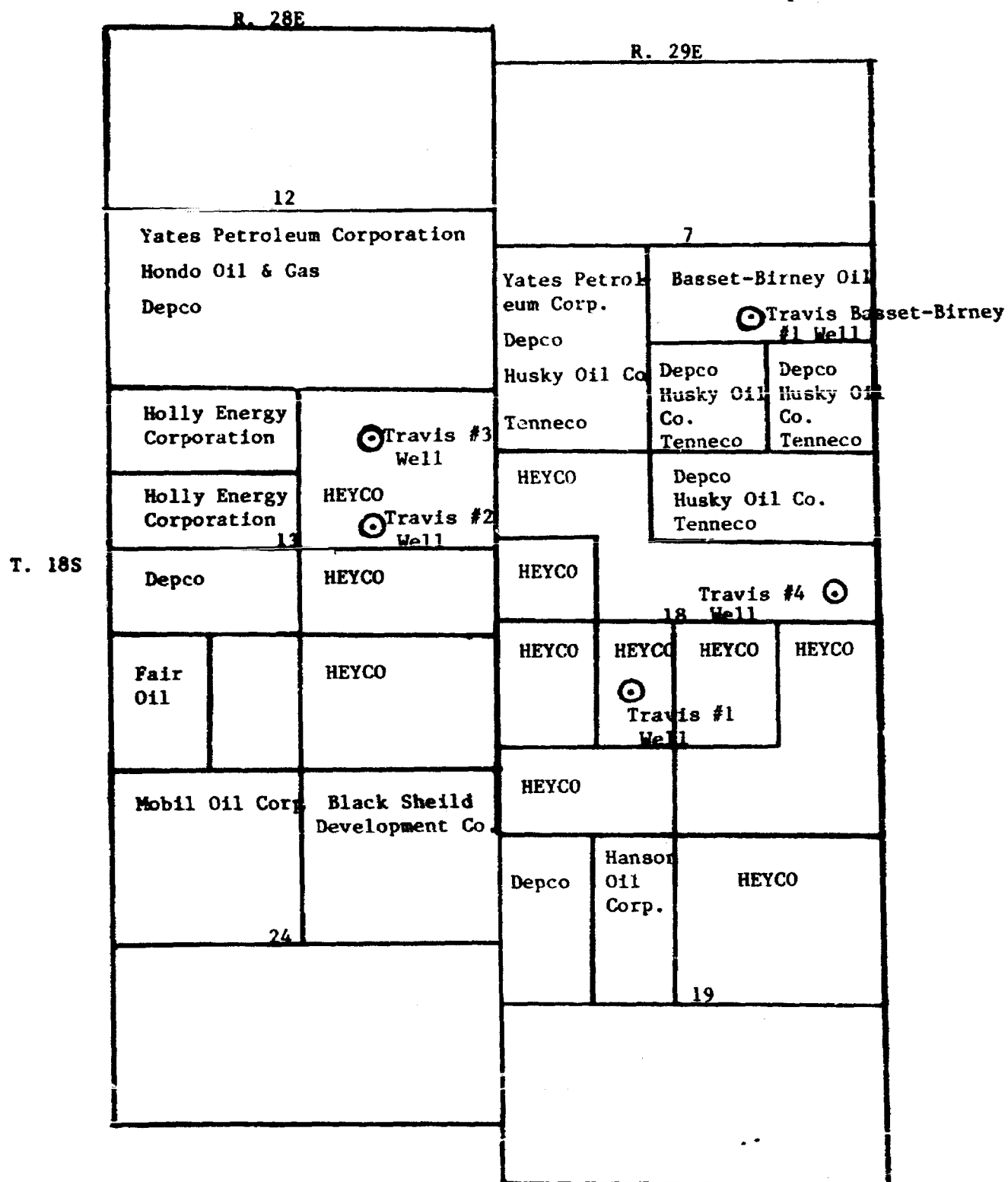

All leases offsetting The Travis #3 Well insofar as they cover the zones proposed for Dual Completion, are subject to a Joint Operating Agreement dated June 1, 1976 designating Harvey E. Yates Company as Operator.

# Memo

From  
D. S. NUTTER  
CHIEF ENGINEER

To

Norway, Elgin, Co

Travis Dwyer W. C. #2

B 13-183-28 E Edd,

Local Concept

Oil Travis-Lipper Pump

Moran Gas

parallel strings

Booster Strand 623-6601

ROUGH

dr/

STATE OF NEW MEXICO  
ENERGY AND MINERALS DEPARTMENT  
OIL CONSERVATION DIVISION

IN THE MATTER OF THE HEARING  
CALLED BY THE OIL CONSERVATION  
DIVISION FOR THE PURPOSE OF  
CONSIDERING:

CASE NO. 6380

Order No. R- 5899

APPLICATION OF HARVEY E. YATES COMPANY, INC.  
FOR A DUAL COMPLETION, EDDY  
COUNTY, NEW MEXICO.

ORDER OF THE DIVISION

BY THE DIVISION:

This cause came on for hearing at 9 o'clock a.m. on  
November 21, 1978, at Santa Fe, New Mexico, before  
Examiner Daniel S. Nutter

NOW, on this (8<sup>th</sup> day) day of ~~December~~ <sup>January</sup>, 1979, the  
Division Director, having considered the testimony, the record,  
and the recommendations of the Examiner, and being fully advised  
in the premises,

FINDS:

(1) That due public notice having been given as required by  
law, the Division has jurisdiction of this cause and the subject  
matter thereof.

(2) That the applicant, Harvey E. Yates Company, Inc.,  
seeks authority to complete its <sup>Unit</sup> Travis Deep Well No. 3,  
Well No. --- located in Unit B of Section 13, Town-  
ship 18 South, Range 28 East, NMPM, Eddy  
County, New Mexico, as a dual completion (conventional) to  
(combination)  
(tubingless)  
oil  
produce gas from the Travis-Upper Pennsylvanian Pool and gas  
from the Morrow formation through parallel strings of tubing,  
with separation of the zones to be achieved by means  
of a packer set at approximately 9700.

(3) That the mechanics of the proposed dual completion are feasible and in accord with good conservation practices.

(4) That approval of the subject application will prevent waste and protect correlative rights.

IT IS THEREFORE ORDERED:

(1) That the applicant, Harvey E. Yates Company, Inc., is hereby authorized to complete its Travis Deep Well No. 3 <sup>Unit</sup> ~~Well No.~~ \_\_\_\_\_, located in Unit B of Section 13, Township 18 South, Range 28 East, NMPM, Eddy County, New Mexico, as a dual completion (conventional) ~~(combination)~~ ~~(subingless)~~

oil to produce ~~gas~~ from the Travis-Upper Pennsylvanian Pool and gas from the Morrow formation, through parallel strings of tubing, separated by a packer set at approximately 9700 feet.

PROVIDED HOWEVER, that the applicant shall complete, operate, and produce said well in accordance with the provisions of Rule 112-A of the Division Rules and Regulations insofar as said rule is not inconsistent with this order;

PROVIDED FURTHER, that the applicant shall take Packer Leakage Tests tests upon completion and annually thereafter during the Annual Shut In Pressure Test Period for the Morrow gas zone. ~~Pool~~

(2) That jurisdiction of this cause is retained for the entry of such further orders as the Division may deem necessary.

DONE at Santa Fe, New Mexico, on the day and year hereinabove designated.



5023 TS

**Amberg**

MADE IN U.S.A.  
NEW BRUNSWICK CONSTRUCTION  
NEW BRUNSWICK CONSTRUCTION, INC., NEW JERSEY  
NEW BRUNSWICK CONSTRUCTION, INC., NEW JERSEY