

see C-141 Remediation Plan
for further details

WV - 11/15/2022



PHONE (575) 397-6388 • FAX (575) 397- 0397 • 1324 W. MARLAND • P.O. BOX 805 • HOBBS, NM 88241-0805
E-MAIL: cbrunson@bbcinternational.com

DELINEATION/REMEDATION WORKPLAN

OXY – WEST BRAVO DOME 1830 162 (Leak Date: 10/3/20)

Incident ID: NAPP2112765886

This delineation workplan and remediation proposal addresses the releases associated with Incident ID #NAPP2112765886.

The following information includes:

1. Appropriate completed and signed C-141 pages.
2. Scaled digital site map with spill area demarcated and leak point identified along with sample point locations and areas of remediation at appropriate depths.
3. GPS information for sample points and sample methodology.
4. Depth to groundwater information (i.e., pdf of OSE search results, USGS search results).
5. Watercourse/features map within 1000 feet.
6. BLM Cave Karst map.
7. FEMA National Flood map.
8. Laboratory analysis results summary table and original laboratory analysis reports.
9. Potentially other pertinent information as necessary for site specific purposes.

Based on the information included in this package and the NMOCD rules, the following remediation is proposed:

OXY will excavate the spill area as depicted on the following site diagram. The leak area near SP1 (GREEN shade on diagram) will require zero remediation. The leak area near SP2 and SP3 (ORANGE shade on diagram) will be excavated to a depth of 2 feet.

OXY will collect bottom and sidewall confirmation samples every 200 square feet. The estimated amount of soil to be excavated is 171 cubic yards. The remediation will be completed within 90 days of approval.

The entire site will then be backfilled with clean soil and revegetated (if warranted) to the standards of the appropriate agency or private surface owner.
All excavated materials will be disposed of at an NMOCD-approved disposal facility.

Form C-141

Page 3

State of New Mexico
Oil Conservation Division

Incident ID	NAPP2112765886
District RP	
Facility ID	
Application ID	

Site Assessment/Characterization*This information must be provided to the appropriate district office no later than 90 days after the release discovery date.*

What is the shallowest depth to groundwater beneath the area affected by the release?	47 (ft bgs)
Did this release impact groundwater or surface water?	<input type="checkbox"/> Yes <input checked="" type="checkbox"/> No
Are the lateral extents of the release within 300 feet of a continuously flowing watercourse or any other significant watercourse?	<input type="checkbox"/> Yes <input checked="" type="checkbox"/> No
Are the lateral extents of the release within 200 feet of any lakebed, sinkhole, or playa lake (measured from the ordinary high-water mark)?	<input type="checkbox"/> Yes <input checked="" type="checkbox"/> No
Are the lateral extents of the release within 300 feet of an occupied permanent residence, school, hospital, institution, or church?	<input type="checkbox"/> Yes <input checked="" type="checkbox"/> No
Are the lateral extents of the release within 500 horizontal feet of a spring or a private domestic fresh water well used by less than five households for domestic or stock watering purposes?	<input type="checkbox"/> Yes <input checked="" type="checkbox"/> No
Are the lateral extents of the release within 1000 feet of any other fresh water well or spring?	<input type="checkbox"/> Yes <input checked="" type="checkbox"/> No
Are the lateral extents of the release within incorporated municipal boundaries or within a defined municipal fresh water well field?	<input type="checkbox"/> Yes <input checked="" type="checkbox"/> No
Are the lateral extents of the release within 300 feet of a wetland?	<input type="checkbox"/> Yes <input checked="" type="checkbox"/> No
Are the lateral extents of the release overlying a subsurface mine?	<input type="checkbox"/> Yes <input checked="" type="checkbox"/> No
Are the lateral extents of the release overlying an unstable area such as karst geology?	<input type="checkbox"/> Yes <input checked="" type="checkbox"/> No
Are the lateral extents of the release within a 100-year floodplain?	<input type="checkbox"/> Yes <input checked="" type="checkbox"/> No
Did the release impact areas not on an exploration, development, production, or storage site?	<input type="checkbox"/> Yes <input checked="" type="checkbox"/> No

Attach a comprehensive report (electronic submittals in .pdf format are preferred) demonstrating the lateral and vertical extents of soil contamination associated with the release have been determined. Refer to 19.15.29.11 NMAC for specifics.

Characterization Report Checklist: *Each of the following items must be included in the report.*

- ☒ Scaled site map showing impacted area, surface features, subsurface features, delineation points, and monitoring wells.
- ☐ Field data
- ☒ Data table of soil contaminant concentration data
- ☒ Depth to water determination
- ☒ Determination of water sources and significant watercourses within ½-mile of the lateral extents of the release
- ☐ Boring or excavation logs
- ☐ Photographs including date and GIS information
- ☒ Topographic/Aerial maps
- ☒ Laboratory data including chain of custody

If the site characterization report does not include completed efforts at remediation of the release, the report must include a proposed remediation plan. That plan must include the estimated volume of material to be remediated, the proposed remediation technique, proposed sampling plan and methods, anticipated timelines for beginning and completing the remediation. The closure criteria for a release are contained in Table 1 of 19.15.29.12 NMAC, however, use of the table is modified by site- and release-specific parameters.

Form C-141

State of New Mexico
Oil Conservation Division

Page 4

Incident ID	NAPP2112765886
District RP	
Facility ID	
Application ID	

I hereby certify that the information given above is true and complete to the best of my knowledge and understand that pursuant to OCD rules and regulations all operators are required to report and/or file certain release notifications and perform corrective actions for releases which may endanger public health or the environment. The acceptance of a C-141 report by the OCD does not relieve the operator of liability should their operations have failed to adequately investigate and remediate contamination that pose a threat to groundwater, surface water, human health or the environment. In addition, OCD acceptance of a C-141 report does not relieve the operator of responsibility for compliance with any other federal, state, or local laws and/or regulations.

Printed Name: Wade Dittrich Title: Environmental CoordinatorSignature: Date: 6-16-21email: wade_dittrich@oxy.comTelephone: (575) 390-2828**OCD Only**

Received by: _____

Date: _____

Form C-141

State of New Mexico
Oil Conservation Division

Page 5

Incident ID	NAPP2112765886
District RP	
Facility ID	
Application ID	

Remediation Plan

Remediation Plan Checklist: Each of the following items must be included in the plan.

- ☒ Detailed description of proposed remediation technique
- ☒ Scaled sitemap with GPS coordinates showing delineation points
- ☒ Estimated volume of material to be remediated
- ☒ Closure criteria is to Table 1 specifications subject to 19.15.29.12(C)(4) NMAC
- ☒ Proposed schedule for remediation (note if remediation plan timeline is more than 90 days OCD approval is required)

Deferral Requests Only: Each of the following items must be confirmed as part of any request for deferral of remediation.

- ☐ Contamination must be in areas immediately under or around production equipment where remediation could cause a major facility deconstruction.
- ☐ Extents of contamination must be fully delineated.
- ☐ Contamination does not cause an imminent risk to human health, the environment, or groundwater.

I hereby certify that the information given above is true and complete to the best of my knowledge and understand that pursuant to OCD rules and regulations all operators are required to report and/or file certain release notifications and perform corrective actions for releases which may endanger public health or the environment. The acceptance of a C-141 report by the OCD does not relieve the operator of liability should their operations have failed to adequately investigate and remediate contamination that pose a threat to groundwater, surface water, human health or the environment. In addition, OCD acceptance of a C-141 report does not relieve the operator of responsibility for compliance with any other federal, state, or local laws and/or regulations.

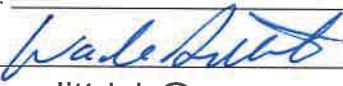
Printed Name: Wade Dittrich Title: Environmental Coordinator
 Signature:  Date: 6-16-21
 email: wade_dittrich@oxy.com Telephone: (575) 390-2828

OCD Only

Received by: _____ Date: _____

☐ Approved ☐ Approved with Attached Conditions of Approval ☐ Denied ☐ Deferral Approved

Signature:  Date: 11/15/2022

Remediation plan approved with the following conditions for final closure report content;

1. Provide executive summary of work
2. Wetland & Karst maps
3. Topo map showing any well head protection areas within 1/2 mile from the release
4. Aerial map showing any significant watercourse within 1/2 mile of any horizontal boundary of the release
5. Clearly show horizontal delineation/confirmation samples for entire release perimeter
6. All confirmation samples must meet reclamation standards for 0-4 ft. below grade (chloride - 600 mg/kg, total TPH - 100 mg/kg, benzene - 10 mg/kg, total BTEX - 50 mg/kg)
7. Any/all field notes
8. Photos prior to backfilling showing; Title/Header, date/time of photo, orientation of photo (direction viewed), GIS data for any/all sample points, annotation or explanation to imagery content
9. Remedial activity documentation [e.g. confirmation sampling notification(s)]
10. Deadline to complete remediation and submit final report: 2/15/2023.

Oxy W.Bravo Dome 1830 162G

Leak Date 10/3/20
Harding County, NM
Incident ID: NAPP 2112765886

Legend

 2' Excavation

 Leak Date

 Sample Points

 Zero Excavation

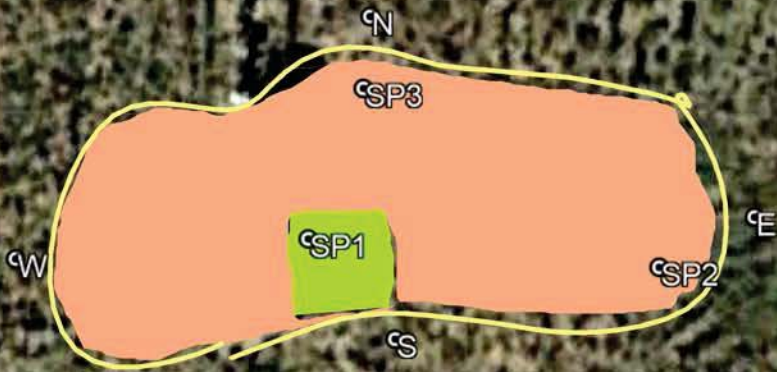

WEST BRAVO DOME 1830 162G
SAMPLE POINTS

SP1	N 35.792579°	W-103.755199°
SP2	N 35.792568°	W-103.755044°
SP3	N 35.792632°	W-103.755175°
NORTH	N 35.792658°	W 35.792658°
EAST	N 35.792658°	W-103.755002°
SOUTH	N 35.792543°	W-103.755161°
WEST	N 35.792571°	W-103.755328°

Laboratory Analytical Results Summary
Oxy, West Bravo Dome 1830 162G(10-30-20)

		Sample ID	SP N @ SURFACE	SP E @ SURFACE	SP W @ SURFACE	SP S @ SURFACE
Analyte	Method	Date	3/31/20	4/1/20	4/2/20	4/3/20
			mg/kg	mg/kg	mg/kg	mg/kg
Benzene	BTEX 8021B		<0.050	<0.050	<0.050	<0.050
Toluene	BTEX 8021B		<0.050	<0.050	<0.050	<0.050
Ethylbenzene	BTEX 8021B		<0.050	<0.050	<0.050	<0.050
Total Xylenes	BTEX 8021B		<0.150	<0.150	<0.150	<0.150
Total BTEX	BTEX 8021B		<0.300	<0.300	<0.300	<0.300
Chloride	SM4500Cl-B		<16.0	<16.0	<16.0	<16.0
GRO	TPH 8015M		<10.0	<10.0	<10.0	<10.0
DRO	TPH 8015M		<10.0	<10.0	<10.0	<10.0
EXT DRO	TPH 8015M		<10.0	<10.0	<10.0	<10.0

		Sample ID	SP 1 @ SURFACE	SP 1 @ 1'	SP 1 @ 2'	SP 1 @ 3'	SP 1 @ 4'	SP 1 @ 5'
Analyte	Method	Date	5/13/20	5/13/20	5/13/20	5/13/20	5/13/20	5/13/20
			mg/kg	mg/kg	mg/kg	mg/kg	mg/kg	mg/kg
Benzene	BTEX 8021B		<0.050	<0.050	N/A	N/A	N/A	N/A
Toluene	BTEX 8021B		<0.050	<0.050	N/A	N/A	N/A	N/A
Ethylbenzene	BTEX 8021B		<0.050	<0.050	N/A	N/A	N/A	N/A
Total Xylenes	BTEX 8021B		<0.150	<0.150	N/A	N/A	N/A	N/A
Total BTEX	BTEX 8021B		<0.300	<0.300	N/A	N/A	N/A	N/A
Chloride	SM4500Cl-B		0.0	26.0	480	320	<16.0	<16.0
GRO	TPH 8015M		<10.0	<10.0	N/A	N/A	N/A	N/A
DRO	TPH 8015M		<10.0	<10.0	N/A	N/A	N/A	N/A
EXT DRO	TPH 8015M		<10.0	<10.0	N/A	N/A	N/A	N/A

		Sample ID	SP 2 @ SURFACE	SP 2 @ 1'	SP 2 @ 2'	SP 2 @ 3'	SP 2 @ 4'
Analyte	Method	Date	5/13/20	5/13/20	5/13/20	5/13/20	5/13/20
			mg/kg	mg/kg	mg/kg	mg/kg	mg/kg
Benzene	BTEX 8021B		<0.050	<0.050	N/A	N/A	N/A
Toluene	BTEX 8021B		<0.050	<0.050	N/A	N/A	N/A
Ethylbenzene	BTEX 8021B		<0.050	<0.050	N/A	N/A	N/A
Total Xylenes	BTEX 8021B		<0.150	<0.150	N/A	N/A	N/A
Total BTEX	BTEX 8021B		<0.300	<0.300	N/A	N/A	N/A
Chloride	SM4500Cl-B		6130.0	2760.0	336	<16.0	32
GRO	TPH 8015M		<10.0	<10.0	N/A	N/A	N/A
DRO	TPH 8015M		<10.0	<10.0	N/A	N/A	N/A
EXT DRO	TPH 8015M		<10.0	<10.0	N/A	N/A	N/A

		Sample ID	SP 3 @ SURFACE	SP 3 @ 1'	SP 3 @ 2'	SP 3 @ 3'
Analyte	Method	Date	5/13/20	5/13/20	5/13/20	5/13/20
			mg/kg	mg/kg	mg/kg	mg/kg
Benzene	BTEX 8021B		<0.050	<0.050	N/A	N/A
Toluene	BTEX 8021B		<0.050	<0.050	N/A	N/A
Ethylbenzene	BTEX 8021B		<0.050	<0.050	N/A	N/A
Total Xylenes	BTEX 8021B		<0.150	<0.150	N/A	N/A
Total BTEX	BTEX 8021B		<0.300	<0.300	N/A	N/A
Chloride	SM4500Cl-B		7840.0	2640.0	<16.0	<16.0
GRO	TPH 8015M		<10.0	<10.0	N/A	N/A
DRO	TPH 8015M		<10.0	<10.0	N/A	N/A
EXT DRO	TPH 8015M		<10.0	<10.0	N/A	N/A

PHONE (575) 393-2326 ° 101 E. MARLAND ° HOBBS, NM 88240

May 20, 2021

Cliff Brunson

BBC International, Inc.

P.O. Box 805

Hobbs, NM 88241

RE: WEST BRAVO DOME 1830 162 G

Enclosed are the results of analyses for samples received by the laboratory on 05/17/21 16:45.

Cardinal Laboratories is accredited through Texas NELAP under certificate number T104704398-20-13. Accreditation applies to drinking water, non-potable water and solid and chemical materials. All accredited analytes are denoted by an asterisk (*). For a complete list of accredited analytes and matrices visit the TCEQ website at

www.tceq.texas.gov/field/qa/lab_accred_certif.html.

Cardinal Laboratories is accredited through the State of Colorado Department of Public Health and Environment for:

Method EPA 552.2	Total Haloacetic Acids (HAA-5)
Method EPA 524.2	Total Trihalomethanes (TTHM)
Method EPA 524.4	Regulated VOCs (V1, V2, V3)

Cardinal Laboratories is accredited through the State of New Mexico Environment Department for:

Method SM 9223-B	Total Coliform and E. coli (Colilert MMO-MUG)
Method EPA 524.2	Regulated VOCs and Total Trihalomethanes (TTHM)
Method EPA 552.2	Total Haloacetic Acids (HAA-5)

Accreditation applies to public drinking water matrices for State of Colorado and New Mexico.

This report meets NELAP requirements and is made up of a cover page, analytical results, and a copy of the original chain-of-custody. If you have any questions concerning this report, please feel free to contact me.

Sincerely,

Celey D. Keene

Lab Director/Quality Manager



PHONE (575) 393-2326 ° 101 E. MARLAND ° HOBBS, NM 88240

Analytical Results For:

BBC International, Inc.
P.O. Box 805
Hobbs NM, 88241

Project: WEST BRAVO DOME 1830 162 G
Project Number: (10-3-20)
Project Manager: Cliff Brunson
Fax To: (575) 397-0397

Reported:
20-May-21 15:20

Sample ID	Laboratory ID	Matrix	Date Sampled	Date Received
SP N @ SURFACE	H211279-01	Soil	13-May-21 08:50	17-May-21 16:45
SP E @ SURFACE	H211279-02	Soil	13-May-21 08:09	17-May-21 16:45
SP W @ SURFACE	H211279-03	Soil	13-May-21 08:17	17-May-21 16:45
SP S @ SURFACE	H211279-04	Soil	13-May-21 08:24	17-May-21 16:45
SP 1 @ SURFACE	H211279-05	Soil	13-May-21 08:30	17-May-21 16:45
SP 1 @ 1'	H211279-06	Soil	13-May-21 08:38	17-May-21 16:45
SP 1 @ 2'	H211279-07	Soil	13-May-21 08:51	17-May-21 16:45
SP 1 @ 3'	H211279-08	Soil	13-May-21 09:03	17-May-21 16:45
SP 1 @ 4'	H211279-09	Soil	13-May-21 09:14	17-May-21 16:45
SP 1 @ 5'	H211279-10	Soil	13-May-21 09:25	17-May-21 16:45
SP 2 @ SURFACE	H211279-11	Soil	13-May-21 09:38	17-May-21 16:45
SP 2 @ 1'	H211279-12	Soil	13-May-21 09:50	17-May-21 16:45
SP 2 @ 2'	H211279-13	Soil	13-May-21 09:58	17-May-21 16:45
SP 2 @ 3'	H211279-14	Soil	13-May-21 10:10	17-May-21 16:45
SP 2 @ 4'	H211279-15	Soil	13-May-21 10:19	17-May-21 16:45
SP 3 @ SURFACE	H211279-16	Soil	13-May-21 10:31	17-May-21 16:45
SP 3 @ 1'	H211279-17	Soil	13-May-21 10:43	17-May-21 16:45
SP 3 @ 2'	H211279-18	Soil	13-May-21 10:55	17-May-21 16:45
SP 3 @ 3'	H211279-19	Soil	13-May-21 11:10	17-May-21 16:45

05/20/21 - Client changed the project name. This is the revised report and will replace the one sent earlier 05/20/21.

Cardinal Laboratories

*=Accredited Analyte

PLEASE NOTE: Liability and Damages. Cardinal's liability and client's exclusive remedy for any claim arising, whether based in contract or tort, shall be limited to the amount paid by client for analyses. All claims, including those for negligence or any other cause whatsoever shall be deemed waived unless made in writing and received by Cardinal within thirty (30) days after completion of the applicable service. In no event shall Cardinal be liable for incidental or consequential damage including, without limitation, business interruptions, loss of use, or loss of profits incurred by client, its subsidiaries, affiliates or successors arising out of or related to the performance of the services hereunder by Cardinal, regardless of whether such claim is based upon any of the above stated reasons or otherwise. Results relate only to the samples identified above. This report shall not be reproduced except in full with written approval of Cardinal Laboratories.

Celey D. Keene, Lab Director/Quality Manager



PHONE (575) 393-2326 ° 101 E. MARLAND ° HOBBS, NM 88240

Analytical Results For:

BBC International, Inc.
P.O. Box 805
Hobbs NM, 88241

Project: WEST BRAVO DOME 1830 162 G
Project Number: (10-3-20)
Project Manager: Cliff Brunson
Fax To: (575) 397-0397

Reported:
20-May-21 15:20

SP N @ SURFACE
H211279-01 (Soil)

Analyte	Result	MDL	Reporting Limit	Units	Dilution	Batch	Analyst	Analyzed	Method	Notes
---------	--------	-----	-----------------	-------	----------	-------	---------	----------	--------	-------

Cardinal Laboratories**Inorganic Compounds**

Chloride	<16.0		16.0	mg/kg	4	1051816	GM	18-May-21	4500-Cl-B	
----------	-------	--	------	-------	---	---------	----	-----------	-----------	--

Volatile Organic Compounds by EPA Method 8021

Benzene*	<0.050		0.050	mg/kg	50	1051812	MS	18-May-21	8021B	
Toluene*	<0.050		0.050	mg/kg	50	1051812	MS	18-May-21	8021B	
Ethylbenzene*	<0.050		0.050	mg/kg	50	1051812	MS	18-May-21	8021B	
Total Xylenes*	<0.150		0.150	mg/kg	50	1051812	MS	18-May-21	8021B	
Total BTEX	<0.300		0.300	mg/kg	50	1051812	MS	18-May-21	8021B	

Surrogate: 4-Bromofluorobenzene (PID) 107 % 69.9-140 1051812 MS 18-May-21 8021B

Petroleum Hydrocarbons by GC FID

GRO C6-C10*	<10.0		10.0	mg/kg	1	1051805	MS	18-May-21	8015B	
DRO >C10-C28*	<10.0		10.0	mg/kg	1	1051805	MS	18-May-21	8015B	
EXT DRO >C28-C36	<10.0		10.0	mg/kg	1	1051805	MS	18-May-21	8015B	

Surrogate: 1-Chlorooctane 103 % 44.3-133 1051805 MS 18-May-21 8015B

Surrogate: 1-Chlorooctadecane 102 % 38.9-142 1051805 MS 18-May-21 8015B

Cardinal Laboratories

*=Accredited Analyte

PLEASE NOTE: Liability and Damages. Cardinal's liability and client's exclusive remedy for any claim arising, whether based in contract or tort, shall be limited to the amount paid by client for analyses. All claims, including those for negligence or any other cause whatsoever shall be deemed waived unless made in writing and received by Cardinal within thirty (30) days after completion of the applicable service. In no event shall Cardinal be liable for incidental or consequential damage including, without limitation, business interruptions, loss of use, or loss of profits incurred by client, its subsidiaries, affiliates or successors arising out of or related to the performance of the services hereunder by Cardinal, regardless of whether such claim is based upon any of the above stated reasons or otherwise. Results relate only to the samples identified above. This report shall not be reproduced except in full with written approval of Cardinal Laboratories.

Celey D. Keene, Lab Director/Quality Manager



PHONE (575) 393-2326 ° 101 E. MARLAND ° HOBBS, NM 88240

Analytical Results For:

BBC International, Inc.
P.O. Box 805
Hobbs NM, 88241

Project: WEST BRAVO DOME 1830 162 G
Project Number: (10-3-20)
Project Manager: Cliff Brunson
Fax To: (575) 397-0397

Reported:
20-May-21 15:20

SP E @ SURFACE**H211279-02 (Soil)**

Analyte	Result	MDL	Reporting Limit	Units	Dilution	Batch	Analyst	Analyzed	Method	Notes
---------	--------	-----	-----------------	-------	----------	-------	---------	----------	--------	-------

Cardinal Laboratories**Inorganic Compounds**

Chloride	<16.0		16.0	mg/kg	4	1051816	GM	18-May-21	4500-Cl-B	
----------	-------	--	------	-------	---	---------	----	-----------	-----------	--

Volatile Organic Compounds by EPA Method 8021

Benzene*	<0.050		0.050	mg/kg	50	1051812	MS	18-May-21	8021B	
Toluene*	<0.050		0.050	mg/kg	50	1051812	MS	18-May-21	8021B	
Ethylbenzene*	<0.050		0.050	mg/kg	50	1051812	MS	18-May-21	8021B	
Total Xylenes*	<0.150		0.150	mg/kg	50	1051812	MS	18-May-21	8021B	
Total BTEX	<0.300		0.300	mg/kg	50	1051812	MS	18-May-21	8021B	

Surrogate: 4-Bromofluorobenzene (PID)			107 %	69.9-140		1051812	MS	18-May-21	8021B	
---------------------------------------	--	--	-------	----------	--	---------	----	-----------	-------	--

Petroleum Hydrocarbons by GC FID

GRO C6-C10*	<10.0		10.0	mg/kg	1	1051805	MS	18-May-21	8015B	
DRO >C10-C28*	<10.0		10.0	mg/kg	1	1051805	MS	18-May-21	8015B	
EXT DRO >C28-C36	<10.0		10.0	mg/kg	1	1051805	MS	18-May-21	8015B	

Surrogate: 1-Chlorooctane			101 %	44.3-133		1051805	MS	18-May-21	8015B	
---------------------------	--	--	-------	----------	--	---------	----	-----------	-------	--

Surrogate: 1-Chlorooctadecane			98.5 %	38.9-142		1051805	MS	18-May-21	8015B	
-------------------------------	--	--	--------	----------	--	---------	----	-----------	-------	--

Cardinal Laboratories

*=Accredited Analyte

PLEASE NOTE: Liability and Damages. Cardinal's liability and client's exclusive remedy for any claim arising, whether based in contract or tort, shall be limited to the amount paid by client for analyses. All claims, including those for negligence or any other cause whatsoever shall be deemed waived unless made in writing and received by Cardinal within thirty (30) days after completion of the applicable service. In no event shall Cardinal be liable for incidental or consequential damage including, without limitation, business interruptions, loss of use, or loss of profits incurred by client, its subsidiaries, affiliates or successors arising out of or related to the performance of the services hereunder by Cardinal, regardless of whether such claim is based upon any of the above stated reasons or otherwise. Results relate only to the samples identified above. This report shall not be reproduced except in full with written approval of Cardinal Laboratories.

Celey D. Keene, Lab Director/Quality Manager



PHONE (575) 393-2326 ° 101 E. MARLAND ° HOBBS, NM 88240

Analytical Results For:

BBC International, Inc.
P.O. Box 805
Hobbs NM, 88241

Project: WEST BRAVO DOME 1830 162 G
Project Number: (10-3-20)
Project Manager: Cliff Brunson
Fax To: (575) 397-0397

Reported:
20-May-21 15:20

SP W @ SURFACE**H211279-03 (Soil)**

Analyte	Result	MDL	Reporting Limit	Units	Dilution	Batch	Analyst	Analyzed	Method	Notes
---------	--------	-----	-----------------	-------	----------	-------	---------	----------	--------	-------

Cardinal Laboratories**Inorganic Compounds**

Chloride	<16.0		16.0	mg/kg	4	1051816	GM	18-May-21	4500-Cl-B	
----------	-------	--	------	-------	---	---------	----	-----------	-----------	--

Volatile Organic Compounds by EPA Method 8021

Benzene*	<0.050		0.050	mg/kg	50	1051812	MS	18-May-21	8021B	
Toluene*	<0.050		0.050	mg/kg	50	1051812	MS	18-May-21	8021B	
Ethylbenzene*	<0.050		0.050	mg/kg	50	1051812	MS	18-May-21	8021B	
Total Xylenes*	<0.150		0.150	mg/kg	50	1051812	MS	18-May-21	8021B	
Total BTEX	<0.300		0.300	mg/kg	50	1051812	MS	18-May-21	8021B	

Surrogate: 4-Bromofluorobenzene (PID)			106 %	69.9-140		1051812	MS	18-May-21	8021B	
---------------------------------------	--	--	-------	----------	--	---------	----	-----------	-------	--

Petroleum Hydrocarbons by GC FID

GRO C6-C10*	<10.0		10.0	mg/kg	1	1051805	MS	18-May-21	8015B	
DRO >C10-C28*	<10.0		10.0	mg/kg	1	1051805	MS	18-May-21	8015B	
EXT DRO >C28-C36	<10.0		10.0	mg/kg	1	1051805	MS	18-May-21	8015B	

Surrogate: 1-Chlorooctane			100 %	44.3-133		1051805	MS	18-May-21	8015B	
---------------------------	--	--	-------	----------	--	---------	----	-----------	-------	--

Surrogate: 1-Chlorooctadecane			98.8 %	38.9-142		1051805	MS	18-May-21	8015B	
-------------------------------	--	--	--------	----------	--	---------	----	-----------	-------	--

Cardinal Laboratories

*=Accredited Analyte

PLEASE NOTE: Liability and Damages. Cardinal's liability and client's exclusive remedy for any claim arising, whether based in contract or tort, shall be limited to the amount paid by client for analyses. All claims, including those for negligence or any other cause whatsoever shall be deemed waived unless made in writing and received by Cardinal within thirty (30) days after completion of the applicable service. In no event shall Cardinal be liable for incidental or consequential damage including, without limitation, business interruptions, loss of use, or loss of profits incurred by client, its subsidiaries, affiliates or successors arising out of or related to the performance of the services hereunder by Cardinal, regardless of whether such claim is based upon any of the above stated reasons or otherwise. Results relate only to the samples identified above. This report shall not be reproduced except in full with written approval of Cardinal Laboratories.

Celey D. Keene, Lab Director/Quality Manager



PHONE (575) 393-2326 ° 101 E. MARLAND ° HOBBS, NM 88240

Analytical Results For:

BBC International, Inc.
P.O. Box 805
Hobbs NM, 88241

Project: WEST BRAVO DOME 1830 162 G
Project Number: (10-3-20)
Project Manager: Cliff Brunson
Fax To: (575) 397-0397

Reported:
20-May-21 15:20

SP S @ SURFACE**H211279-04 (Soil)**

Analyte	Result	MDL	Reporting Limit	Units	Dilution	Batch	Analyst	Analyzed	Method	Notes
---------	--------	-----	-----------------	-------	----------	-------	---------	----------	--------	-------

Cardinal Laboratories**Inorganic Compounds**

Chloride	<16.0		16.0	mg/kg	4	1051816	AC	19-May-21	4500-Cl-B	
----------	-------	--	------	-------	---	---------	----	-----------	-----------	--

Volatile Organic Compounds by EPA Method 8021

Benzene*	<0.050		0.050	mg/kg	50	1051812	MS	18-May-21	8021B	
Toluene*	<0.050		0.050	mg/kg	50	1051812	MS	18-May-21	8021B	
Ethylbenzene*	<0.050		0.050	mg/kg	50	1051812	MS	18-May-21	8021B	
Total Xylenes*	<0.150		0.150	mg/kg	50	1051812	MS	18-May-21	8021B	
Total BTEX	<0.300		0.300	mg/kg	50	1051812	MS	18-May-21	8021B	

Surrogate: 4-Bromofluorobenzene (PID)			103 %	69.9-140		1051812	MS	18-May-21	8021B	
---------------------------------------	--	--	-------	----------	--	---------	----	-----------	-------	--

Petroleum Hydrocarbons by GC FID

GRO C6-C10*	<10.0		10.0	mg/kg	1	1051805	MS	18-May-21	8015B	
DRO >C10-C28*	<10.0		10.0	mg/kg	1	1051805	MS	18-May-21	8015B	
EXT DRO >C28-C36	<10.0		10.0	mg/kg	1	1051805	MS	18-May-21	8015B	

Surrogate: 1-Chlorooctane			98.8 %	44.3-133		1051805	MS	18-May-21	8015B	
---------------------------	--	--	--------	----------	--	---------	----	-----------	-------	--

Surrogate: 1-Chlorooctadecane			96.9 %	38.9-142		1051805	MS	18-May-21	8015B	
-------------------------------	--	--	--------	----------	--	---------	----	-----------	-------	--

Cardinal Laboratories

*=Accredited Analyte

PLEASE NOTE: Liability and Damages. Cardinal's liability and client's exclusive remedy for any claim arising, whether based in contract or tort, shall be limited to the amount paid by client for analyses. All claims, including those for negligence or any other cause whatsoever shall be deemed waived unless made in writing and received by Cardinal within thirty (30) days after completion of the applicable service. In no event shall Cardinal be liable for incidental or consequential damage including, without limitation, business interruptions, loss of use, or loss of profits incurred by client, its subsidiaries, affiliates or successors arising out of or related to the performance of the services hereunder by Cardinal, regardless of whether such claim is based upon any of the above stated reasons or otherwise. Results relate only to the samples identified above. This report shall not be reproduced except in full with written approval of Cardinal Laboratories.

Celey D. Keene, Lab Director/Quality Manager



PHONE (575) 393-2326 ° 101 E. MARLAND ° HOBBS, NM 88240

Analytical Results For:

BBC International, Inc.
P.O. Box 805
Hobbs NM, 88241

Project: WEST BRAVO DOME 1830 162 G
Project Number: (10-3-20)
Project Manager: Cliff Brunson
Fax To: (575) 397-0397

Reported:
20-May-21 15:20

SP 1 @ SURFACE**H211279-05 (Soil)**

Analyte	Result	MDL	Reporting Limit	Units	Dilution	Batch	Analyst	Analyzed	Method	Notes
---------	--------	-----	-----------------	-------	----------	-------	---------	----------	--------	-------

Cardinal Laboratories**Inorganic Compounds**

Chloride	24400		16.0	mg/kg	4	1051816	AC	19-May-21	4500-Cl-B	
-----------------	--------------	--	------	-------	---	---------	----	-----------	-----------	--

Volatile Organic Compounds by EPA Method 8021

Benzene*	<0.050	0.050	mg/kg	50	1051812	MS	18-May-21	8021B	
Toluene*	<0.050	0.050	mg/kg	50	1051812	MS	18-May-21	8021B	
Ethylbenzene*	<0.050	0.050	mg/kg	50	1051812	MS	18-May-21	8021B	
Total Xylenes*	<0.150	0.150	mg/kg	50	1051812	MS	18-May-21	8021B	
Total BTEX	<0.300	0.300	mg/kg	50	1051812	MS	18-May-21	8021B	

Surrogate: 4-Bromofluorobenzene (PID)	110 %	69.9-140	1051812	MS	18-May-21	8021B	
---------------------------------------	-------	----------	---------	----	-----------	-------	--

Petroleum Hydrocarbons by GC FID

GRO C6-C10*	<10.0	10.0	mg/kg	1	1051805	MS	18-May-21	8015B	
DRO >C10-C28*	<10.0	10.0	mg/kg	1	1051805	MS	18-May-21	8015B	
EXT DRO >C28-C36	<10.0	10.0	mg/kg	1	1051805	MS	18-May-21	8015B	

Surrogate: 1-Chlorooctane	97.3 %	44.3-133	1051805	MS	18-May-21	8015B	
---------------------------	--------	----------	---------	----	-----------	-------	--

Surrogate: 1-Chlorooctadecane	97.4 %	38.9-142	1051805	MS	18-May-21	8015B	
-------------------------------	--------	----------	---------	----	-----------	-------	--

Cardinal Laboratories

*=Accredited Analyte

PLEASE NOTE: Liability and Damages. Cardinal's liability and client's exclusive remedy for any claim arising, whether based in contract or tort, shall be limited to the amount paid by client for analyses. All claims, including those for negligence or any other cause whatsoever shall be deemed waived unless made in writing and received by Cardinal within thirty (30) days after completion of the applicable service. In no event shall Cardinal be liable for incidental or consequential damage including, without limitation, business interruptions, loss of use, or loss of profits incurred by client, its subsidiaries, affiliates or successors arising out of or related to the performance of the services hereunder by Cardinal, regardless of whether such claim is based upon any of the above stated reasons or otherwise. Results relate only to the samples identified above. This report shall not be reproduced except in full with written approval of Cardinal Laboratories.

Celey D. Keene, Lab Director/Quality Manager



PHONE (575) 393-2326 ° 101 E. MARLAND ° HOBBS, NM 88240

Analytical Results For:

BBC International, Inc.
P.O. Box 805
Hobbs NM, 88241

Project: WEST BRAVO DOME 1830 162 G
Project Number: (10-3-20)
Project Manager: Cliff Brunson
Fax To: (575) 397-0397

Reported:
20-May-21 15:20

SP 1 @ 1'
H211279-06 (Soil)

Analyte	Result	MDL	Reporting Limit	Units	Dilution	Batch	Analyst	Analyzed	Method	Notes
---------	--------	-----	-----------------	-------	----------	-------	---------	----------	--------	-------

Cardinal Laboratories**Inorganic Compounds**

Chloride	2600		16.0	mg/kg	4	1051909	AC	19-May-21	4500-Cl-B	QM-07
-----------------	-------------	--	------	-------	---	---------	----	-----------	-----------	-------

Volatile Organic Compounds by EPA Method 8021

Benzene*	<0.050		0.050	mg/kg	50	1051812	MS	18-May-21	8021B	
Toluene*	<0.050		0.050	mg/kg	50	1051812	MS	18-May-21	8021B	
Ethylbenzene*	<0.050		0.050	mg/kg	50	1051812	MS	18-May-21	8021B	
Total Xylenes*	<0.150		0.150	mg/kg	50	1051812	MS	18-May-21	8021B	
Total BTEX	<0.300		0.300	mg/kg	50	1051812	MS	18-May-21	8021B	

Surrogate: 4-Bromofluorobenzene (PID) 101 % 69.9-140 1051812 MS 18-May-21 8021B

Petroleum Hydrocarbons by GC FID

GRO C6-C10*	<10.0		10.0	mg/kg	1	1051805	MS	18-May-21	8015B	
DRO >C10-C28*	<10.0		10.0	mg/kg	1	1051805	MS	18-May-21	8015B	
EXT DRO >C28-C36	<10.0		10.0	mg/kg	1	1051805	MS	18-May-21	8015B	

Surrogate: 1-Chlorooctane 102 % 44.3-133 1051805 MS 18-May-21 8015B

Surrogate: 1-Chlorooctadecane 102 % 38.9-142 1051805 MS 18-May-21 8015B

Cardinal Laboratories

*=Accredited Analyte

PLEASE NOTE: Liability and Damages. Cardinal's liability and client's exclusive remedy for any claim arising, whether based in contract or tort, shall be limited to the amount paid by client for analyses. All claims, including those for negligence or any other cause whatsoever shall be deemed waived unless made in writing and received by Cardinal within thirty (30) days after completion of the applicable service. In no event shall Cardinal be liable for incidental or consequential damage including, without limitation, business interruptions, loss of use, or loss of profits incurred by client, its subsidiaries, affiliates or successors arising out of or related to the performance of the services hereunder by Cardinal, regardless of whether such claim is based upon any of the above stated reasons or otherwise. Results relate only to the samples identified above. This report shall not be reproduced except in full with written approval of Cardinal Laboratories.

Celey D. Keene, Lab Director/Quality Manager



PHONE (575) 393-2326 ° 101 E. MARLAND ° HOBBS, NM 88240

Analytical Results For:BBC International, Inc.
P.O. Box 805
Hobbs NM, 88241Project: WEST BRAVO DOME 1830 162 G
Project Number: (10-3-20)
Project Manager: Cliff Brunson
Fax To: (575) 397-0397Reported:
20-May-21 15:20**SP 1 @ 2'**
H211279-07 (Soil)

Analyte	Result	MDL	Reporting Limit	Units	Dilution	Batch	Analyst	Analyzed	Method	Notes
---------	--------	-----	--------------------	-------	----------	-------	---------	----------	--------	-------

Cardinal Laboratories**Inorganic Compounds**

Chloride	480		16.0	mg/kg	4	1051909	AC	19-May-21	4500-Cl-B	
----------	-----	--	------	-------	---	---------	----	-----------	-----------	--

Cardinal Laboratories

*=Accredited Analyte

PLEASE NOTE: Liability and Damages. Cardinal's liability and client's exclusive remedy for any claim arising, whether based in contract or tort, shall be limited to the amount paid by client for analyses. All claims, including those for negligence or any other cause whatsoever shall be deemed waived unless made in writing and received by Cardinal within thirty (30) days after completion of the applicable service. In no event shall Cardinal be liable for incidental or consequential damage including, without limitation, business interruptions, loss of use, or loss of profits incurred by client, its subsidiaries, affiliates or successors arising out of or related to the performance of the services hereunder by Cardinal, regardless of whether such claim is based upon any of the above stated reasons or otherwise. Results relate only to the samples identified above. This report shall not be reproduced except in full with written approval of Cardinal Laboratories.

A handwritten signature in black ink, appearing to read "Celey D. Keene".

Celey D. Keene, Lab Director/Quality Manager



PHONE (575) 393-2326 ° 101 E. MARLAND ° HOBBS, NM 88240

Analytical Results For:

BBC International, Inc.
P.O. Box 805
Hobbs NM, 88241

Project: WEST BRAVO DOME 1830 162 G
Project Number: (10-3-20)
Project Manager: Cliff Brunson
Fax To: (575) 397-0397

Reported:
20-May-21 15:20

SP 1 @ 3'
H211279-08 (Soil)

Analyte	Result	MDL	Reporting Limit	Units	Dilution	Batch	Analyst	Analyzed	Method	Notes
---------	--------	-----	--------------------	-------	----------	-------	---------	----------	--------	-------

Cardinal Laboratories**Inorganic Compounds**

Chloride	320		16.0	mg/kg	4	1051909	AC	19-May-21	4500-Cl-B	
-----------------	------------	--	------	-------	---	---------	----	-----------	-----------	--

Cardinal Laboratories

*=Accredited Analyte

PLEASE NOTE: Liability and Damages. Cardinal's liability and client's exclusive remedy for any claim arising, whether based in contract or tort, shall be limited to the amount paid by client for analyses. All claims, including those for negligence or any other cause whatsoever shall be deemed waived unless made in writing and received by Cardinal within thirty (30) days after completion of the applicable service. In no event shall Cardinal be liable for incidental or consequential damage including, without limitation, business interruptions, loss of use, or loss of profits incurred by client, its subsidiaries, affiliates or successors arising out of or related to the performance of the services hereunder by Cardinal, regardless of whether such claim is based upon any of the above stated reasons or otherwise. Results relate only to the samples identified above. This report shall not be reproduced except in full with written approval of Cardinal Laboratories.

Celey D. Keene, Lab Director/Quality Manager



PHONE (575) 393-2326 ° 101 E. MARLAND ° HOBBS, NM 88240

Analytical Results For:

BBC International, Inc.
P.O. Box 805
Hobbs NM, 88241

Project: WEST BRAVO DOME 1830 162 G
Project Number: (10-3-20)
Project Manager: Cliff Brunson
Fax To: (575) 397-0397

Reported:
20-May-21 15:20

SP 1 @ 4'
H211279-09 (Soil)

Analyte	Result	MDL	Reporting Limit	Units	Dilution	Batch	Analyst	Analyzed	Method	Notes
---------	--------	-----	--------------------	-------	----------	-------	---------	----------	--------	-------

Cardinal Laboratories**Inorganic Compounds**

Chloride	<16.0		16.0	mg/kg	4	1051909	AC	19-May-21	4500-Cl-B	
----------	-------	--	------	-------	---	---------	----	-----------	-----------	--

Cardinal Laboratories

*=Accredited Analyte

PLEASE NOTE: Liability and Damages. Cardinal's liability and client's exclusive remedy for any claim arising, whether based in contract or tort, shall be limited to the amount paid by client for analyses. All claims, including those for negligence or any other cause whatsoever shall be deemed waived unless made in writing and received by Cardinal within thirty (30) days after completion of the applicable service. In no event shall Cardinal be liable for incidental or consequential damage including, without limitation, business interruptions, loss of use, or loss of profits incurred by client, its subsidiaries, affiliates or successors arising out of or related to the performance of the services hereunder by Cardinal, regardless of whether such claim is based upon any of the above stated reasons or otherwise. Results relate only to the samples identified above. This report shall not be reproduced except in full with written approval of Cardinal Laboratories.

Celey D. Keene, Lab Director/Quality Manager



PHONE (575) 393-2326 ° 101 E. MARLAND ° HOBBS, NM 88240

Analytical Results For:

BBC International, Inc.
P.O. Box 805
Hobbs NM, 88241

Project: WEST BRAVO DOME 1830 162 G
Project Number: (10-3-20)
Project Manager: Cliff Brunson
Fax To: (575) 397-0397

Reported:
20-May-21 15:20

SP 1 @ 5'
H211279-10 (Soil)

Analyte	Result	MDL	Reporting Limit	Units	Dilution	Batch	Analyst	Analyzed	Method	Notes
---------	--------	-----	-----------------	-------	----------	-------	---------	----------	--------	-------

Cardinal Laboratories**Inorganic Compounds**

Chloride	<16.0		16.0	mg/kg	4	1051909	AC	19-May-21	4500-Cl-B	
----------	-------	--	------	-------	---	---------	----	-----------	-----------	--

Cardinal Laboratories

*=Accredited Analyte

PLEASE NOTE: Liability and Damages. Cardinal's liability and client's exclusive remedy for any claim arising, whether based in contract or tort, shall be limited to the amount paid by client for analyses. All claims, including those for negligence or any other cause whatsoever shall be deemed waived unless made in writing and received by Cardinal within thirty (30) days after completion of the applicable service. In no event shall Cardinal be liable for incidental or consequential damage including, without limitation, business interruptions, loss of use, or loss of profits incurred by client, its subsidiaries, affiliates or successors arising out of or related to the performance of the services hereunder by Cardinal, regardless of whether such claim is based upon any of the above stated reasons or otherwise. Results relate only to the samples identified above. This report shall not be reproduced except in full with written approval of Cardinal Laboratories.

Celey D. Keene, Lab Director/Quality Manager



PHONE (575) 393-2326 ° 101 E. MARLAND ° HOBBS, NM 88240

Analytical Results For:

BBC International, Inc.
P.O. Box 805
Hobbs NM, 88241

Project: WEST BRAVO DOME 1830 162 G
Project Number: (10-3-20)
Project Manager: Cliff Brunson
Fax To: (575) 397-0397

Reported:
20-May-21 15:20

SP 2 @ SURFACE**H211279-11 (Soil)**

Analyte	Result	MDL	Reporting Limit	Units	Dilution	Batch	Analyst	Analyzed	Method	Notes
---------	--------	-----	-----------------	-------	----------	-------	---------	----------	--------	-------

Cardinal Laboratories**Inorganic Compounds**

Chloride	6130		16.0	mg/kg	4	1051909	AC	19-May-21	4500-Cl-B	
-----------------	-------------	--	------	-------	---	---------	----	-----------	-----------	--

Volatile Organic Compounds by EPA Method 8021

Benzene*	<0.050	0.050	mg/kg	50	1051812	MS	18-May-21	8021B	
Toluene*	<0.050	0.050	mg/kg	50	1051812	MS	18-May-21	8021B	
Ethylbenzene*	<0.050	0.050	mg/kg	50	1051812	MS	18-May-21	8021B	
Total Xylenes*	<0.150	0.150	mg/kg	50	1051812	MS	18-May-21	8021B	
Total BTEX	<0.300	0.300	mg/kg	50	1051812	MS	18-May-21	8021B	

Surrogate: 4-Bromofluorobenzene (PID)	107 %	69.9-140	1051812	MS	18-May-21	8021B
---------------------------------------	-------	----------	---------	----	-----------	-------

Petroleum Hydrocarbons by GC FID

GRO C6-C10*	<10.0	10.0	mg/kg	1	1051805	MS	18-May-21	8015B
DRO >C10-C28*	<10.0	10.0	mg/kg	1	1051805	MS	18-May-21	8015B
EXT DRO >C28-C36	<10.0	10.0	mg/kg	1	1051805	MS	18-May-21	8015B

Surrogate: 1-Chlorooctane	95.6 %	44.3-133	1051805	MS	18-May-21	8015B
---------------------------	--------	----------	---------	----	-----------	-------

Surrogate: 1-Chlorooctadecane	95.9 %	38.9-142	1051805	MS	18-May-21	8015B
-------------------------------	--------	----------	---------	----	-----------	-------

Cardinal Laboratories

*=Accredited Analyte

PLEASE NOTE: Liability and Damages. Cardinal's liability and client's exclusive remedy for any claim arising, whether based in contract or tort, shall be limited to the amount paid by client for analyses. All claims, including those for negligence or any other cause whatsoever shall be deemed waived unless made in writing and received by Cardinal within thirty (30) days after completion of the applicable service. In no event shall Cardinal be liable for incidental or consequential damage including, without limitation, business interruptions, loss of use, or loss of profits incurred by client, its subsidiaries, affiliates or successors arising out of or related to the performance of the services hereunder by Cardinal, regardless of whether such claim is based upon any of the above stated reasons or otherwise. Results relate only to the samples identified above. This report shall not be reproduced except in full with written approval of Cardinal Laboratories.

Celey D. Keene, Lab Director/Quality Manager



PHONE (575) 393-2326 ° 101 E. MARLAND ° HOBBS, NM 88240

Analytical Results For:

BBC International, Inc.
P.O. Box 805
Hobbs NM, 88241

Project: WEST BRAVO DOME 1830 162 G
Project Number: (10-3-20)
Project Manager: Cliff Brunson
Fax To: (575) 397-0397

Reported:
20-May-21 15:20

SP 2 @ 1'
H211279-12 (Soil)

Analyte	Result	MDL	Reporting Limit	Units	Dilution	Batch	Analyst	Analyzed	Method	Notes
---------	--------	-----	-----------------	-------	----------	-------	---------	----------	--------	-------

Cardinal Laboratories**Inorganic Compounds**

Chloride	2760		16.0	mg/kg	4	1051909	AC	19-May-21	4500-Cl-B	
-----------------	-------------	--	------	-------	---	---------	----	-----------	-----------	--

Volatile Organic Compounds by EPA Method 8021

Benzene*	<0.050	0.050	mg/kg	50	1051812	MS	18-May-21	8021B	
Toluene*	<0.050	0.050	mg/kg	50	1051812	MS	18-May-21	8021B	
Ethylbenzene*	<0.050	0.050	mg/kg	50	1051812	MS	18-May-21	8021B	
Total Xylenes*	<0.150	0.150	mg/kg	50	1051812	MS	18-May-21	8021B	
Total BTEX	<0.300	0.300	mg/kg	50	1051812	MS	18-May-21	8021B	

Surrogate: 4-Bromofluorobenzene (PID)	108 %	69.9-140	1051812	MS	18-May-21	8021B	
---------------------------------------	-------	----------	---------	----	-----------	-------	--

Petroleum Hydrocarbons by GC FID

GRO C6-C10*	<10.0	10.0	mg/kg	1	1051805	MS	18-May-21	8015B	
DRO >C10-C28*	<10.0	10.0	mg/kg	1	1051805	MS	18-May-21	8015B	
EXT DRO >C28-C36	<10.0	10.0	mg/kg	1	1051805	MS	18-May-21	8015B	

Surrogate: 1-Chlorooctane	104 %	44.3-133	1051805	MS	18-May-21	8015B	
---------------------------	-------	----------	---------	----	-----------	-------	--

Surrogate: 1-Chlorooctadecane	103 %	38.9-142	1051805	MS	18-May-21	8015B	
-------------------------------	-------	----------	---------	----	-----------	-------	--

Cardinal Laboratories

*=Accredited Analyte

PLEASE NOTE: Liability and Damages. Cardinal's liability and client's exclusive remedy for any claim arising, whether based in contract or tort, shall be limited to the amount paid by client for analyses. All claims, including those for negligence or any other cause whatsoever shall be deemed waived unless made in writing and received by Cardinal within thirty (30) days after completion of the applicable service. In no event shall Cardinal be liable for incidental or consequential damage including, without limitation, business interruptions, loss of use, or loss of profits incurred by client, its subsidiaries, affiliates or successors arising out of or related to the performance of the services hereunder by Cardinal, regardless of whether such claim is based upon any of the above stated reasons or otherwise. Results relate only to the samples identified above. This report shall not be reproduced except in full with written approval of Cardinal Laboratories.

Celey D. Keene, Lab Director/Quality Manager



PHONE (575) 393-2326 ° 101 E. MARLAND ° HOBBS, NM 88240

Analytical Results For:

BBC International, Inc.
P.O. Box 805
Hobbs NM, 88241

Project: WEST BRAVO DOME 1830 162 G
Project Number: (10-3-20)
Project Manager: Cliff Brunson
Fax To: (575) 397-0397

Reported:
20-May-21 15:20

SP 2 @ 2'
H211279-13 (Soil)

Analyte	Result	MDL	Reporting Limit	Units	Dilution	Batch	Analyst	Analyzed	Method	Notes
---------	--------	-----	-----------------	-------	----------	-------	---------	----------	--------	-------

Cardinal Laboratories**Inorganic Compounds**

Chloride	336		16.0	mg/kg	4	1051909	AC	19-May-21	4500-Cl-B	
-----------------	------------	--	------	-------	---	---------	----	-----------	-----------	--

Cardinal Laboratories

*=Accredited Analyte

PLEASE NOTE: Liability and Damages. Cardinal's liability and client's exclusive remedy for any claim arising, whether based in contract or tort, shall be limited to the amount paid by client for analyses. All claims, including those for negligence or any other cause whatsoever shall be deemed waived unless made in writing and received by Cardinal within thirty (30) days after completion of the applicable service. In no event shall Cardinal be liable for incidental or consequential damage including, without limitation, business interruptions, loss of use, or loss of profits incurred by client, its subsidiaries, affiliates or successors arising out of or related to the performance of the services hereunder by Cardinal, regardless of whether such claim is based upon any of the above stated reasons or otherwise. Results relate only to the samples identified above. This report shall not be reproduced except in full with written approval of Cardinal Laboratories.

Celey D. Keene, Lab Director/Quality Manager



PHONE (575) 393-2326 ° 101 E. MARLAND ° HOBBS, NM 88240

Analytical Results For:

BBC International, Inc.
P.O. Box 805
Hobbs NM, 88241

Project: WEST BRAVO DOME 1830 162 G
Project Number: (10-3-20)
Project Manager: Cliff Brunson
Fax To: (575) 397-0397

Reported:
20-May-21 15:20

SP 2 @ 3'
H211279-14 (Soil)

Analyte	Result	MDL	Reporting Limit	Units	Dilution	Batch	Analyst	Analyzed	Method	Notes
---------	--------	-----	-----------------	-------	----------	-------	---------	----------	--------	-------

Cardinal Laboratories**Inorganic Compounds**

Chloride	<16.0		16.0	mg/kg	4	1051909	AC	19-May-21	4500-Cl-B	
----------	-------	--	------	-------	---	---------	----	-----------	-----------	--

Cardinal Laboratories

*=Accredited Analyte

PLEASE NOTE: Liability and Damages. Cardinal's liability and client's exclusive remedy for any claim arising, whether based in contract or tort, shall be limited to the amount paid by client for analyses. All claims, including those for negligence or any other cause whatsoever shall be deemed waived unless made in writing and received by Cardinal within thirty (30) days after completion of the applicable service. In no event shall Cardinal be liable for incidental or consequential damage including, without limitation, business interruptions, loss of use, or loss of profits incurred by client, its subsidiaries, affiliates or successors arising out of or related to the performance of the services hereunder by Cardinal, regardless of whether such claim is based upon any of the above stated reasons or otherwise. Results relate only to the samples identified above. This report shall not be reproduced except in full with written approval of Cardinal Laboratories.

Celey D. Keene, Lab Director/Quality Manager



PHONE (575) 393-2326 ° 101 E. MARLAND ° HOBBS, NM 88240

Analytical Results For:BBC International, Inc.
P.O. Box 805
Hobbs NM, 88241Project: WEST BRAVO DOME 1830 162 G
Project Number: (10-3-20)
Project Manager: Cliff Brunson
Fax To: (575) 397-0397Reported:
20-May-21 15:20**SP 2 @ 4'**
H211279-15 (Soil)

Analyte	Result	MDL	Reporting Limit	Units	Dilution	Batch	Analyst	Analyzed	Method	Notes
---------	--------	-----	--------------------	-------	----------	-------	---------	----------	--------	-------

Cardinal Laboratories**Inorganic Compounds**

Chloride	32.0		16.0	mg/kg	4	1051909	AC	19-May-21	4500-Cl-B	
-----------------	-------------	--	------	-------	---	---------	----	-----------	-----------	--

Cardinal Laboratories

*=Accredited Analyte

PLEASE NOTE: Liability and Damages. Cardinal's liability and client's exclusive remedy for any claim arising, whether based in contract or tort, shall be limited to the amount paid by client for analyses. All claims, including those for negligence or any other cause whatsoever shall be deemed waived unless made in writing and received by Cardinal within thirty (30) days after completion of the applicable service. In no event shall Cardinal be liable for incidental or consequential damage including, without limitation, business interruptions, loss of use, or loss of profits incurred by client, its subsidiaries, affiliates or successors arising out of or related to the performance of the services hereunder by Cardinal, regardless of whether such claim is based upon any of the above stated reasons or otherwise. Results relate only to the samples identified above. This report shall not be reproduced except in full with written approval of Cardinal Laboratories.

A handwritten signature in black ink, appearing to read "Celey D. Keene".

Celey D. Keene, Lab Director/Quality Manager



PHONE (575) 393-2326 ° 101 E. MARLAND ° HOBBS, NM 88240

Analytical Results For:

BBC International, Inc.
P.O. Box 805
Hobbs NM, 88241

Project: WEST BRAVO DOME 1830 162 G
Project Number: (10-3-20)
Project Manager: Cliff Brunson
Fax To: (575) 397-0397

Reported:
20-May-21 15:20

SP 3 @ SURFACE**H211279-16 (Soil)**

Analyte	Result	MDL	Reporting Limit	Units	Dilution	Batch	Analyst	Analyzed	Method	Notes
---------	--------	-----	-----------------	-------	----------	-------	---------	----------	--------	-------

Cardinal Laboratories**Inorganic Compounds**

Chloride	7840		16.0	mg/kg	4	1051909	AC	19-May-21	4500-Cl-B	
----------	------	--	------	-------	---	---------	----	-----------	-----------	--

Volatile Organic Compounds by EPA Method 8021

Benzene*	<0.050		0.050	mg/kg	50	1051812	MS	18-May-21	8021B	
Toluene*	<0.050		0.050	mg/kg	50	1051812	MS	18-May-21	8021B	
Ethylbenzene*	<0.050		0.050	mg/kg	50	1051812	MS	18-May-21	8021B	
Total Xylenes*	<0.150		0.150	mg/kg	50	1051812	MS	18-May-21	8021B	
Total BTEX	<0.300		0.300	mg/kg	50	1051812	MS	18-May-21	8021B	

Surrogate: 4-Bromofluorobenzene (PID)			107 %		69.9-140	1051812	MS	18-May-21	8021B	
---------------------------------------	--	--	-------	--	----------	---------	----	-----------	-------	--

Petroleum Hydrocarbons by GC FID

GRO C6-C10*	<10.0		10.0	mg/kg	1	1051805	MS	19-May-21	8015B	
DRO >C10-C28*	<10.0		10.0	mg/kg	1	1051805	MS	19-May-21	8015B	
EXT DRO >C28-C36	<10.0		10.0	mg/kg	1	1051805	MS	19-May-21	8015B	

Surrogate: 1-Chlorooctane			97.9 %		44.3-133	1051805	MS	19-May-21	8015B	
---------------------------	--	--	--------	--	----------	---------	----	-----------	-------	--

Surrogate: 1-Chlorooctadecane			94.6 %		38.9-142	1051805	MS	19-May-21	8015B	
-------------------------------	--	--	--------	--	----------	---------	----	-----------	-------	--

Cardinal Laboratories

*=Accredited Analyte

PLEASE NOTE: Liability and Damages. Cardinal's liability and client's exclusive remedy for any claim arising, whether based in contract or tort, shall be limited to the amount paid by client for analyses. All claims, including those for negligence or any other cause whatsoever shall be deemed waived unless made in writing and received by Cardinal within thirty (30) days after completion of the applicable service. In no event shall Cardinal be liable for incidental or consequential damage including, without limitation, business interruptions, loss of use, or loss of profits incurred by client, its subsidiaries, affiliates or successors arising out of or related to the performance of the services hereunder by Cardinal, regardless of whether such claim is based upon any of the above stated reasons or otherwise. Results relate only to the samples identified above. This report shall not be reproduced except in full with written approval of Cardinal Laboratories.

Celey D. Keene, Lab Director/Quality Manager



PHONE (575) 393-2326 ° 101 E. MARLAND ° HOBBS, NM 88240

Analytical Results For:

BBC International, Inc.
P.O. Box 805
Hobbs NM, 88241

Project: WEST BRAVO DOME 1830 162 G
Project Number: (10-3-20)
Project Manager: Cliff Brunson
Fax To: (575) 397-0397

Reported:
20-May-21 15:20

SP 3 @ 1'
H211279-17 (Soil)

Analyte	Result	MDL	Reporting Limit	Units	Dilution	Batch	Analyst	Analyzed	Method	Notes
---------	--------	-----	-----------------	-------	----------	-------	---------	----------	--------	-------

Cardinal Laboratories**Inorganic Compounds**

Chloride	2640		16.0	mg/kg	4	1051909	AC	19-May-21	4500-Cl-B	
-----------------	-------------	--	------	-------	---	---------	----	-----------	-----------	--

Volatile Organic Compounds by EPA Method 8021

Benzene*	<0.050	0.050	mg/kg	50	1051813	MS	19-May-21	8021B	
Toluene*	<0.050	0.050	mg/kg	50	1051813	MS	19-May-21	8021B	
Ethylbenzene*	<0.050	0.050	mg/kg	50	1051813	MS	19-May-21	8021B	
Total Xylenes*	<0.150	0.150	mg/kg	50	1051813	MS	19-May-21	8021B	
Total BTEX	<0.300	0.300	mg/kg	50	1051813	MS	19-May-21	8021B	

Surrogate: 4-Bromofluorobenzene (PID)	104 %	69.9-140	1051813	MS	19-May-21	8021B
---------------------------------------	-------	----------	---------	----	-----------	-------

Petroleum Hydrocarbons by GC FID

GRO C6-C10*	<10.0	10.0	mg/kg	1	1051806	MS	18-May-21	8015B
DRO >C10-C28*	<10.0	10.0	mg/kg	1	1051806	MS	18-May-21	8015B
EXT DRO >C28-C36	<10.0	10.0	mg/kg	1	1051806	MS	18-May-21	8015B

Surrogate: 1-Chlorooctane	104 %	44.3-133	1051806	MS	18-May-21	8015B
---------------------------	-------	----------	---------	----	-----------	-------

Surrogate: 1-Chlorooctadecane	99.4 %	38.9-142	1051806	MS	18-May-21	8015B
-------------------------------	--------	----------	---------	----	-----------	-------

Cardinal Laboratories

*=Accredited Analyte

PLEASE NOTE: Liability and Damages. Cardinal's liability and client's exclusive remedy for any claim arising, whether based in contract or tort, shall be limited to the amount paid by client for analyses. All claims, including those for negligence or any other cause whatsoever shall be deemed waived unless made in writing and received by Cardinal within thirty (30) days after completion of the applicable service. In no event shall Cardinal be liable for incidental or consequential damage including, without limitation, business interruptions, loss of use, or loss of profits incurred by client, its subsidiaries, affiliates or successors arising out of or related to the performance of the services hereunder by Cardinal, regardless of whether such claim is based upon any of the above stated reasons or otherwise. Results relate only to the samples identified above. This report shall not be reproduced except in full with written approval of Cardinal Laboratories.

Celey D. Keene, Lab Director/Quality Manager



PHONE (575) 393-2326 ° 101 E. MARLAND ° HOBBS, NM 88240

Analytical Results For:

BBC International, Inc.
P.O. Box 805
Hobbs NM, 88241

Project: WEST BRAVO DOME 1830 162 G
Project Number: (10-3-20)
Project Manager: Cliff Brunson
Fax To: (575) 397-0397

Reported:
20-May-21 15:20

SP 3 @ 2'
H211279-18 (Soil)

Analyte	Result	MDL	Reporting Limit	Units	Dilution	Batch	Analyst	Analyzed	Method	Notes
---------	--------	-----	--------------------	-------	----------	-------	---------	----------	--------	-------

Cardinal Laboratories**Inorganic Compounds**

Chloride	<16.0		16.0	mg/kg	4	1051909	AC	19-May-21	4500-Cl-B	
----------	-------	--	------	-------	---	---------	----	-----------	-----------	--

Cardinal Laboratories

*=Accredited Analyte

PLEASE NOTE: Liability and Damages. Cardinal's liability and client's exclusive remedy for any claim arising, whether based in contract or tort, shall be limited to the amount paid by client for analyses. All claims, including those for negligence or any other cause whatsoever shall be deemed waived unless made in writing and received by Cardinal within thirty (30) days after completion of the applicable service. In no event shall Cardinal be liable for incidental or consequential damage including, without limitation, business interruptions, loss of use, or loss of profits incurred by client, its subsidiaries, affiliates or successors arising out of or related to the performance of the services hereunder by Cardinal, regardless of whether such claim is based upon any of the above stated reasons or otherwise. Results relate only to the samples identified above. This report shall not be reproduced except in full with written approval of Cardinal Laboratories.

Celey D. Keene, Lab Director/Quality Manager



PHONE (575) 393-2326 ° 101 E. MARLAND ° HOBBS, NM 88240

Analytical Results For:

BBC International, Inc.
P.O. Box 805
Hobbs NM, 88241

Project: WEST BRAVO DOME 1830 162 G
Project Number: (10-3-20)
Project Manager: Cliff Brunson
Fax To: (575) 397-0397

Reported:
20-May-21 15:20

SP 3 @ 3'
H211279-19 (Soil)

Analyte	Result	MDL	Reporting Limit	Units	Dilution	Batch	Analyst	Analyzed	Method	Notes
---------	--------	-----	--------------------	-------	----------	-------	---------	----------	--------	-------

Cardinal Laboratories**Inorganic Compounds**

Chloride	<16.0		16.0	mg/kg	4	1051909	AC	19-May-21	4500-Cl-B	
----------	-------	--	------	-------	---	---------	----	-----------	-----------	--

Cardinal Laboratories

*=Accredited Analyte

PLEASE NOTE: Liability and Damages. Cardinal's liability and client's exclusive remedy for any claim arising, whether based in contract or tort, shall be limited to the amount paid by client for analyses. All claims, including those for negligence or any other cause whatsoever shall be deemed waived unless made in writing and received by Cardinal within thirty (30) days after completion of the applicable service. In no event shall Cardinal be liable for incidental or consequential damage including, without limitation, business interruptions, loss of use, or loss of profits incurred by client, its subsidiaries, affiliates or successors arising out of or related to the performance of the services hereunder by Cardinal, regardless of whether such claim is based upon any of the above stated reasons or otherwise. Results relate only to the samples identified above. This report shall not be reproduced except in full with written approval of Cardinal Laboratories.

Celey D. Keene, Lab Director/Quality Manager



PHONE (575) 393-2326 ° 101 E. MARLAND ° HOBBS, NM 88240

Analytical Results For:

BBC International, Inc.
P.O. Box 805
Hobbs NM, 88241

Project: WEST BRAVO DOME 1830 162 G
Project Number: (10-3-20)
Project Manager: Cliff Brunson
Fax To: (575) 397-0397

Reported:
20-May-21 15:20

Inorganic Compounds - Quality Control**Cardinal Laboratories**

Analyte	Result	Reporting Limit	Units	Spike Level	Source Result	%REC	%REC Limits	RPD	RPD Limit	Notes
---------	--------	--------------------	-------	----------------	------------------	------	----------------	-----	--------------	-------

Batch 1051816 - 1:4 DI Water**Blank (1051816-BLK1)**

Prepared & Analyzed: 18-May-21

Chloride	ND	16.0	mg/kg							
----------	----	------	-------	--	--	--	--	--	--	--

LCS (1051816-BS1)

Prepared & Analyzed: 18-May-21

Chloride	416	16.0	mg/kg	400		104	80-120			
----------	-----	------	-------	-----	--	-----	--------	--	--	--

LCS Dup (1051816-BSD1)

Prepared & Analyzed: 18-May-21

Chloride	416	16.0	mg/kg	400		104	80-120	0.00	20	
----------	-----	------	-------	-----	--	-----	--------	------	----	--

Batch 1051909 - 1:4 DI Water**Blank (1051909-BLK1)**

Prepared & Analyzed: 19-May-21

Chloride	ND	16.0	mg/kg							
----------	----	------	-------	--	--	--	--	--	--	--

LCS (1051909-BS1)

Prepared & Analyzed: 19-May-21

Chloride	416	16.0	mg/kg	400		104	80-120			
----------	-----	------	-------	-----	--	-----	--------	--	--	--

LCS Dup (1051909-BSD1)

Prepared & Analyzed: 19-May-21

Chloride	400	16.0	mg/kg	400		100	80-120	3.92	20	
----------	-----	------	-------	-----	--	-----	--------	------	----	--

Cardinal Laboratories

*=Accredited Analyte

PLEASE NOTE: Liability and Damages. Cardinal's liability and client's exclusive remedy for any claim arising, whether based in contract or tort, shall be limited to the amount paid by client for analyses. All claims, including those for negligence or any other cause whatsoever shall be deemed waived unless made in writing and received by Cardinal within thirty (30) days after completion of the applicable service. In no event shall Cardinal be liable for incidental or consequential damage including, without limitation, business interruptions, loss of use, or loss of profits incurred by client, its subsidiaries, affiliates or successors arising out of or related to the performance of the services hereunder by Cardinal, regardless of whether such claim is based upon any of the above stated reasons or otherwise. Results relate only to the samples identified above. This report shall not be reproduced except in full with written approval of Cardinal Laboratories.

Celey D. Keene, Lab Director/Quality Manager



PHONE (575) 393-2326 • 101 E. MARLAND • HOBBS, NM 88240

Analytical Results For:

BBC International, Inc.
P.O. Box 805
Hobbs NM, 88241

Project: WEST BRAVO DOME 1830 162 G
Project Number: (10-3-20)
Project Manager: Cliff Brunson
Fax To: (575) 397-0397

Reported:
20-May-21 15:20

Volatile Organic Compounds by EPA Method 8021 - Quality Control**Cardinal Laboratories**

Analyte	Result	Reporting Limit	Units	Spike Level	Source Result	%REC	%REC Limits	RPD	RPD Limit	Notes
---------	--------	-----------------	-------	-------------	---------------	------	-------------	-----	-----------	-------

Batch 1051812 - Volatiles**Blank (1051812-BLK1)**

Prepared & Analyzed: 18-May-21

Benzene	ND	0.050	mg/kg							
Toluene	ND	0.050	mg/kg							
Ethylbenzene	ND	0.050	mg/kg							
Total Xylenes	ND	0.150	mg/kg							
Total BTEX	ND	0.300	mg/kg							
Surrogate: 4-Bromofluorobenzene (PID)	0.0544		mg/kg	0.0500		109	69.9-140			

LCS (1051812-BS1)

Prepared & Analyzed: 18-May-21

Benzene	1.91	0.050	mg/kg	2.00		95.3	89.9-120			
Toluene	2.13	0.050	mg/kg	2.00		106	90.8-117			
Ethylbenzene	2.15	0.050	mg/kg	2.00		108	88.9-116			
m,p-Xylene	4.27	0.100	mg/kg	4.00		107	85.5-118			
o-Xylene	2.08	0.050	mg/kg	2.00		104	85.5-118			
Total Xylenes	6.36	0.150	mg/kg	6.00		106	85.5-118			
Surrogate: 4-Bromofluorobenzene (PID)	0.0529		mg/kg	0.0500		106	69.9-140			

LCS Dup (1051812-BSD1)

Prepared & Analyzed: 18-May-21

Benzene	1.94	0.050	mg/kg	2.00		97.2	89.9-120	1.95	10.3	
Toluene	2.20	0.050	mg/kg	2.00		110	90.8-117	3.16	10.5	
Ethylbenzene	2.20	0.050	mg/kg	2.00		110	88.9-116	2.49	10.8	
m,p-Xylene	4.37	0.100	mg/kg	4.00		109	85.5-118	2.30	10.7	
o-Xylene	2.12	0.050	mg/kg	2.00		106	85.5-118	1.79	10.7	
Total Xylenes	6.49	0.150	mg/kg	6.00		108	85.5-118	2.14	10.7	
Surrogate: 4-Bromofluorobenzene (PID)	0.0543		mg/kg	0.0500		109	69.9-140			

Batch 1051813 - Volatiles**Blank (1051813-BLK1)**

Prepared: 18-May-21 Analyzed: 19-May-21

Benzene	ND	0.050	mg/kg							
Toluene	ND	0.050	mg/kg							
Ethylbenzene	ND	0.050	mg/kg							
Total Xylenes	ND	0.150	mg/kg							

Cardinal Laboratories

*=Accredited Analyte

PLEASE NOTE: Liability and Damages. Cardinal's liability and client's exclusive remedy for any claim arising, whether based in contract or tort, shall be limited to the amount paid by client for analyses. All claims, including those for negligence or any other cause whatsoever shall be deemed waived unless made in writing and received by Cardinal within thirty (30) days after completion of the applicable service. In no event shall Cardinal be liable for incidental or consequential damage including, without limitation, business interruptions, loss of use, or loss of profits incurred by client, its subsidiaries, affiliates or successors arising out of or related to the performance of the services hereunder by Cardinal, regardless of whether such claim is based upon any of the above stated reasons or otherwise. Results relate only to the samples identified above. This report shall not be reproduced except in full with written approval of Cardinal Laboratories.

Celey D. Keene, Lab Director/Quality Manager



PHONE (575) 393-2326 • 101 E. MARLAND • HOBBS, NM 88240

Analytical Results For:

BBC International, Inc.
P.O. Box 805
Hobbs NM, 88241

Project: WEST BRAVO DOME 1830 162 G
Project Number: (10-3-20)
Project Manager: Cliff Brunson
Fax To: (575) 397-0397

Reported:
20-May-21 15:20

Volatile Organic Compounds by EPA Method 8021 - Quality Control**Cardinal Laboratories**

Analyte	Result	Reporting Limit	Units	Spike Level	Source Result	%REC	%REC Limits	RPD	RPD Limit	Notes
---------	--------	-----------------	-------	-------------	---------------	------	-------------	-----	-----------	-------

Batch 1051813 - Volatiles**Blank (1051813-BLK1)**

Prepared: 18-May-21 Analyzed: 19-May-21

Total BTEX	ND	0.300	mg/kg							
Surrogate: 4-Bromofluorobenzene (PID)	0.0515		mg/kg	0.0500		103	69.9-140			
LCS (1051813-BS1)										
Prepared: 18-May-21 Analyzed: 19-May-21										
Benzene	1.82	0.050	mg/kg	2.00		91.1	89.9-120			
Toluene	2.05	0.050	mg/kg	2.00		102	90.8-117			
Ethylbenzene	2.10	0.050	mg/kg	2.00		105	88.9-116			
m,p-Xylene	4.19	0.100	mg/kg	4.00		105	85.5-118			
o-Xylene	2.02	0.050	mg/kg	2.00		101	85.5-118			
Total Xylenes	6.21	0.150	mg/kg	6.00		103	85.5-118			
Surrogate: 4-Bromofluorobenzene (PID)	0.0545		mg/kg	0.0500		109	69.9-140			

LCS Dup (1051813-BS1)

Prepared: 18-May-21 Analyzed: 19-May-21

Benzene	1.91	0.050	mg/kg	2.00		95.5	89.9-120	4.76	10.3	
Toluene	2.17	0.050	mg/kg	2.00		108	90.8-117	5.82	10.5	
Ethylbenzene	2.22	0.050	mg/kg	2.00		111	88.9-116	5.61	10.8	
m,p-Xylene	4.46	0.100	mg/kg	4.00		111	85.5-118	6.28	10.7	
o-Xylene	2.15	0.050	mg/kg	2.00		107	85.5-118	6.01	10.7	
Total Xylenes	6.61	0.150	mg/kg	6.00		110	85.5-118	6.19	10.7	
Surrogate: 4-Bromofluorobenzene (PID)	0.0556		mg/kg	0.0500		111	69.9-140			

Cardinal Laboratories

*=Accredited Analyte

PLEASE NOTE: Liability and Damages. Cardinal's liability and client's exclusive remedy for any claim arising, whether based in contract or tort, shall be limited to the amount paid by client for analyses. All claims, including those for negligence or any other cause whatsoever shall be deemed waived unless made in writing and received by Cardinal within thirty (30) days after completion of the applicable service. In no event shall Cardinal be liable for incidental or consequential damage including, without limitation, business interruptions, loss of use, or loss of profits incurred by client, its subsidiaries, affiliates or successors arising out of or related to the performance of the services hereunder by Cardinal, regardless of whether such claim is based upon any of the above stated reasons or otherwise. Results relate only to the samples identified above. This report shall not be reproduced except in full with written approval of Cardinal Laboratories.

Celey D. Keene, Lab Director/Quality Manager



PHONE (575) 393-2326 • 101 E. MARLAND • HOBBS, NM 88240

Analytical Results For:

BBC International, Inc.
P.O. Box 805
Hobbs NM, 88241

Project: WEST BRAVO DOME 1830 162 G
Project Number: (10-3-20)
Project Manager: Cliff Brunson
Fax To: (575) 397-0397

Reported:
20-May-21 15:20

Petroleum Hydrocarbons by GC FID - Quality Control**Cardinal Laboratories**

Analyte	Result	Reporting Limit	Units	Spike Level	Source Result	%REC	%REC Limits	RPD	RPD Limit	Notes
---------	--------	--------------------	-------	----------------	------------------	------	----------------	-----	--------------	-------

Batch 1051805 - General Prep - Organics**Blank (1051805-BLK1)**

Prepared & Analyzed: 18-May-21

GRO C6-C10	ND	10.0	mg/kg							
DRO >C10-C28	ND	10.0	mg/kg							
EXT DRO >C28-C36	ND	10.0	mg/kg							
Surrogate: 1-Chlorooctane	54.5		mg/kg	50.0		109	44.3-133			
Surrogate: 1-Chlorooctadecane	54.7		mg/kg	50.0		109	38.9-142			

LCS (1051805-BS1)

Prepared & Analyzed: 18-May-21

GRO C6-C10	208	10.0	mg/kg	200		104	83.4-129			
DRO >C10-C28	222	10.0	mg/kg	200		111	84.3-133			
Total TPH C6-C28	430	10.0	mg/kg	400		107	85.3-130			
Surrogate: 1-Chlorooctane	57.0		mg/kg	50.0		114	44.3-133			
Surrogate: 1-Chlorooctadecane	57.8		mg/kg	50.0		116	38.9-142			

LCS Dup (1051805-BS1)

Prepared & Analyzed: 18-May-21

GRO C6-C10	220	10.0	mg/kg	200		110	83.4-129	5.70	12.6	
DRO >C10-C28	233	10.0	mg/kg	200		117	84.3-133	5.10	12.1	
Total TPH C6-C28	454	10.0	mg/kg	400		113	85.3-130	5.39	11.6	
Surrogate: 1-Chlorooctane	58.4		mg/kg	50.0		117	44.3-133			
Surrogate: 1-Chlorooctadecane	59.2		mg/kg	50.0		118	38.9-142			

Batch 1051806 - General Prep - Organics**Blank (1051806-BLK1)**

Prepared & Analyzed: 18-May-21

GRO C6-C10	ND	10.0	mg/kg							
DRO >C10-C28	ND	10.0	mg/kg							
EXT DRO >C28-C36	ND	10.0	mg/kg							
Surrogate: 1-Chlorooctane	54.1		mg/kg	50.0		108	44.3-133			
Surrogate: 1-Chlorooctadecane	51.3		mg/kg	50.0		103	38.9-142			

Cardinal Laboratories

*=Accredited Analyte

PLEASE NOTE: Liability and Damages. Cardinal's liability and client's exclusive remedy for any claim arising, whether based in contract or tort, shall be limited to the amount paid by client for analyses. All claims, including those for negligence or any other cause whatsoever shall be deemed waived unless made in writing and received by Cardinal within thirty (30) days after completion of the applicable service. In no event shall Cardinal be liable for incidental or consequential damage including, without limitation, business interruptions, loss of use, or loss of profits incurred by client, its subsidiaries, affiliates or successors arising out of or related to the performance of the services hereunder by Cardinal, regardless of whether such claim is based upon any of the above stated reasons or otherwise. Results relate only to the samples identified above. This report shall not be reproduced except in full with written approval of Cardinal Laboratories.

Celey D. Keene, Lab Director/Quality Manager



PHONE (575) 393-2326 ° 101 E. MARLAND ° HOBBS, NM 88240

Analytical Results For:

BBC International, Inc.
P.O. Box 805
Hobbs NM, 88241

Project: WEST BRAVO DOME 1830 162 G
Project Number: (10-3-20)
Project Manager: Cliff Brunson
Fax To: (575) 397-0397

Reported:
20-May-21 15:20

Petroleum Hydrocarbons by GC FID - Quality Control**Cardinal Laboratories**

Analyte	Result	Reporting Limit	Units	Spike Level	Source Result	%REC	%REC Limits	RPD	RPD Limit	Notes
---------	--------	--------------------	-------	----------------	------------------	------	----------------	-----	--------------	-------

Batch 1051806 - General Prep - Organics**LCS (1051806-BS1)**

Prepared & Analyzed: 18-May-21

GRO C6-C10	224	10.0	mg/kg	200		112	83.4-129			
DRO >C10-C28	223	10.0	mg/kg	200		111	84.3-133			
Total TPH C6-C28	447	10.0	mg/kg	400		112	85.3-130			
Surrogate: 1-Chlorooctane	57.0		mg/kg	50.0		114	44.3-133			
Surrogate: 1-Chlorooctadecane	56.2		mg/kg	50.0		112	38.9-142			

LCS Dup (1051806-BS1)

Prepared & Analyzed: 18-May-21

GRO C6-C10	236	10.0	mg/kg	200		118	83.4-129	4.98	12.6	
DRO >C10-C28	239	10.0	mg/kg	200		119	84.3-133	7.06	12.1	
Total TPH C6-C28	475	10.0	mg/kg	400		119	85.3-130	6.02	11.6	
Surrogate: 1-Chlorooctane	58.4		mg/kg	50.0		117	44.3-133			
Surrogate: 1-Chlorooctadecane	56.2		mg/kg	50.0		112	38.9-142			

Cardinal Laboratories

*=Accredited Analyte

PLEASE NOTE: Liability and Damages. Cardinal's liability and client's exclusive remedy for any claim arising, whether based in contract or tort, shall be limited to the amount paid by client for analyses. All claims, including those for negligence or any other cause whatsoever shall be deemed waived unless made in writing and received by Cardinal within thirty (30) days after completion of the applicable service. In no event shall Cardinal be liable for incidental or consequential damage including, without limitation, business interruptions, loss of use, or loss of profits incurred by client, its subsidiaries, affiliates or successors arising out of or related to the performance of the services hereunder by Cardinal, regardless of whether such claim is based upon any of the above stated reasons or otherwise. Results relate only to the samples identified above. This report shall not be reproduced except in full with written approval of Cardinal Laboratories.

Celey D. Keene, Lab Director/Quality Manager

PHONE (575) 393-2326 • 101 E. MARLAND • HOBBS, NM 88240

Notes and Definitions

QM-07	The spike recovery was outside acceptance limits for the MS and/or MSD. The batch was accepted based on acceptable LCS recovery.
ND	Analyte NOT DETECTED at or above the reporting limit
RPD	Relative Percent Difference
**	Samples not received at proper temperature of 6°C or below.
***	Insufficient time to reach temperature.
-	Chloride by SM4500Cl-B does not require samples be received at or below 6°C Samples reported on an as received basis (wet) unless otherwise noted on report

Cardinal Laboratories

*=Accredited Analyte

PLEASE NOTE: Liability and Damages. Cardinal's liability and client's exclusive remedy for any claim arising, whether based in contract or tort, shall be limited to the amount paid by client for analyses. All claims, including those for negligence or any other cause whatsoever shall be deemed waived unless made in writing and received by Cardinal within thirty (30) days after completion of the applicable service. In no event shall Cardinal be liable for incidental or consequential damage including, without limitation, business interruptions, loss of use, or loss of profits incurred by client, its subsidiaries, affiliates or successors arising out of or related to the performance of the services hereunder by Cardinal, regardless of whether such claim is based upon any of the above stated reasons or otherwise. Results relate only to the samples identified above. This report shall not be reproduced except in full with written approval of Cardinal Laboratories.

A handwritten signature in cursive script, appearing to read "Celey D. Keene".

Celey D. Keene, Lab Director/Quality Manager



CARDINAL LABORATORIES

101 East Marland, Hobbs, NM 88240

(505) 393-2326 FAX (505) 393-2476

CHAIN-OF-CUSTODY AND ANALYSIS REQUEST

Company Name: BBC International, Inc.				BILL TO				ANALYSIS REQUEST																	
Project Manager: Cliff Brunson				P.O. #:																					
Address: P.O. Box 805				Company: OXY																					
City: Hobbs State: NM Zip: 88241				Attn: WADE																					
Phone #: 575-397-6388 Fax #: 575-397-0397				Address:																					
Project #: Project Owner: Oxy				City:																					
Project Name: WEST BRAVO DOME 1820 162 G (10-3-20) * 1830				State: Zip:																					
Project Location:				Phone #:																					
Sampler Name: SIMON RENDON				Fax #:																					
FOR LAB USE ONLY						MATRIX		PRESERV.		SAMPLING															
Lab I.D.	Sample I.D.	(GRAB OR C/OMP.	# CONTAINERS	GROUNDWATER	WASTEWATER	SOIL	OIL	SLUDGE	OTHER :	ACID/BASE:	ICE / COOL	OTHER :	DATE	TIME	CL	BTEX	TPH	EXT							
H211279													5-13-21	9:38	✓	✓	✓								
11	SP2 @ SURFACE	G	I			I					I		5-13-21	9:50	✓	✓	✓								
12	SP2 @ 1'												5-13-21	9:58	✓										
13	SP2 @ 2'												5-13-21	10:10	✓										
14	SP2 @ 3'												5-13-21	10:19	✓										
15	SP2 @ 4'												5-13-21	10:31	✓	✓	✓								
16	SP3 @ SURFACE												5-13-21	10:43	✓	✓	✓								
17	SP3 @ 1'												5-13-21	10:55	✓										
18	SP3 @ 2'												5-13-21	11:10	✓										
19	SP3 @ 3'																								

PLEASE NOTE: Liability and Damages. Cardinal's liability and client's exclusive remedy for any claim arising whether based in contract or tort, shall be limited to the amount paid by the client for the analyses. All claims including those for negligence and any other cause whatsoever shall be deemed waived unless made in writing and received by Cardinal within 30 days after completion of the applicable service. In no event shall Cardinal be liable for incidental or consequential damages, including without limitation, business interruptions, loss of use, or loss of profits incurred by client, its subsidiaries, affiliates or successors arising out of or related to the performance of services hereunder by Cardinal, regardless of whether such claim is based upon any of the above stated reasons or otherwise.

Relinquished By: Simon Rendon	Date: 5-17-21	Received By: Israel Rona	Phone Result: <input type="checkbox"/> Yes <input type="checkbox"/> No	Add'l Phone #:
	Time: 8:00 AM		Fax Result: <input type="checkbox"/> Yes <input type="checkbox"/> No	Add'l Fax #:
Relinquished By: Israel Rona	Date: 5-17-21	Received By: Tamara Aldabe	REMARKS:	
	Time: 4:45 PM			
Delivered By: (Circle One)	Sample Condition	CHECKED BY: (Initials)		
Sampler - UPS - Bus - Other: 0.8c #113	Cool Intact	Yes No		
	Yes No	Yes No		

† Cardinal cannot accept verbal changes. Please fax written changes to 505-393-2476

Oxy, West Bravo Dome 1820 162G, 3000 ft' H2O

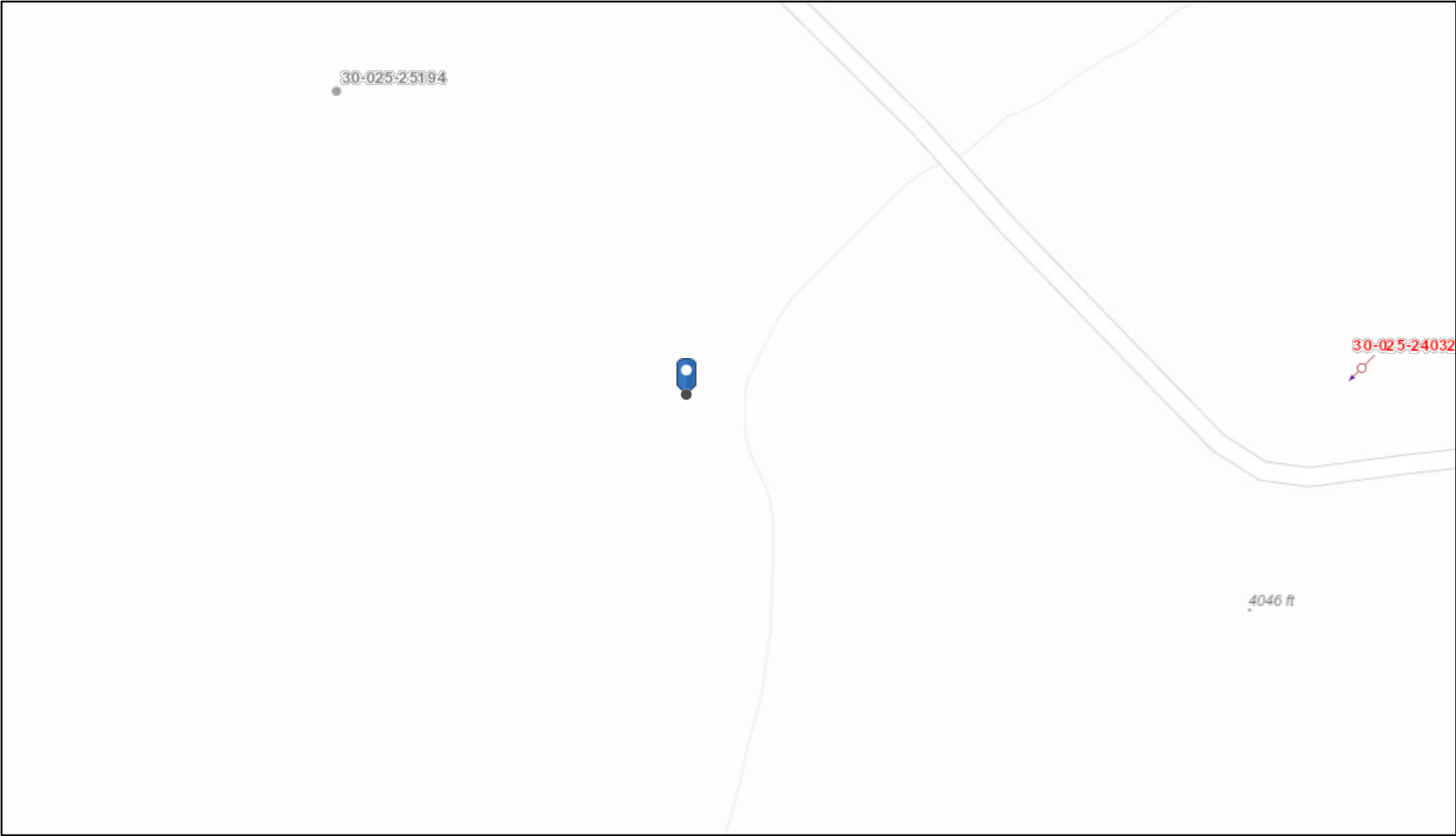

6/28/2021, 3:32:17 PM

- | | | | | |
|---------------------|----------------------------|----------------|----------------------------|--------------------|
| Wells - Large Scale | CO2, Cancelled | Gas, Active | Gas, Temporarily Abandoned | Injection, Plugged |
| undefined | CO2, New | Gas, Cancelled | Injection, Active | |
| Miscellaneous | CO2, Plugged | Gas, New | Injection, Cancelled | |
| CO2, Active | CO2, Temporarily Abandoned | Gas, Plugged | Injection, New | |

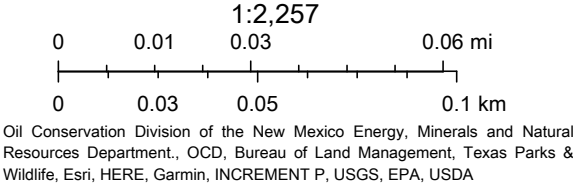



FEMA Flood Map Service Center: Search By Address

Navigation

Search

Languages

MSC Home (/portal/)

MSC Search by Address
(/portal/search)

MSC Search All Products
(/portal/advanceSearch)

▼ MSC Products and Tools
(/portal/resources/productsandtools)

Hazus
(/portal/resources/hazus)

LOMC Batch Files
(/portal/resources/lomc)

Product Availability
(/portal/productAvailability)

MSC Frequently Asked
Questions (FAQs)
(/portal/resources/faq)

MSC Email Subscriptions
(/portal/subscriptionHome)

Contact MSC Help
(/portal/resources/contact)

Enter an address, place, or coordinates: ?

W103.55361 N35.81491

Search

Whether you are in a high risk zone or not, you may need [flood insurance \(https://www.fema.gov/national-flood-insurance-program\)](https://www.fema.gov/national-flood-insurance-program) because most homeowners insurance doesn't cover flood damage. If you live in an area with low or moderate flood risk, you are 5 times more likely to experience flood than a fire in your home over the next 30 years. For many, a National Flood Insurance Program's flood insurance policy could cost less than \$400 per year. Call your insurance agent today and protect what you've built.

Learn more about [steps you can take \(https://www.fema.gov/what-mitigation\)](https://www.fema.gov/what-mitigation) to reduce flood risk damage.

Search Results—Products for **HARDING COUNTY UNINCORPORATED AREAS**

Show ALL Products » (<https://msc.fema.gov/portal/availabilitySearch?addcommunity=350129&communityName=HARDING>)

FEMA has not completed a study to determine flood hazard for the selected location; therefore, a flood map has not been published at this time. You can contact your community or the FEMA FMIX for more information about flood risk and flood insurance in your community.

You can choose a new flood map or move the location pin by selecting a different location on the locator map below or by entering a new location in the search field above. It may take a minute or more during peak hours to generate a dynamic FIRMette. If you are a person with a disability, are blind, or have low vision, and need assistance, please contact a map specialist (<https://msc.fema.gov/portal/resources/contact>).

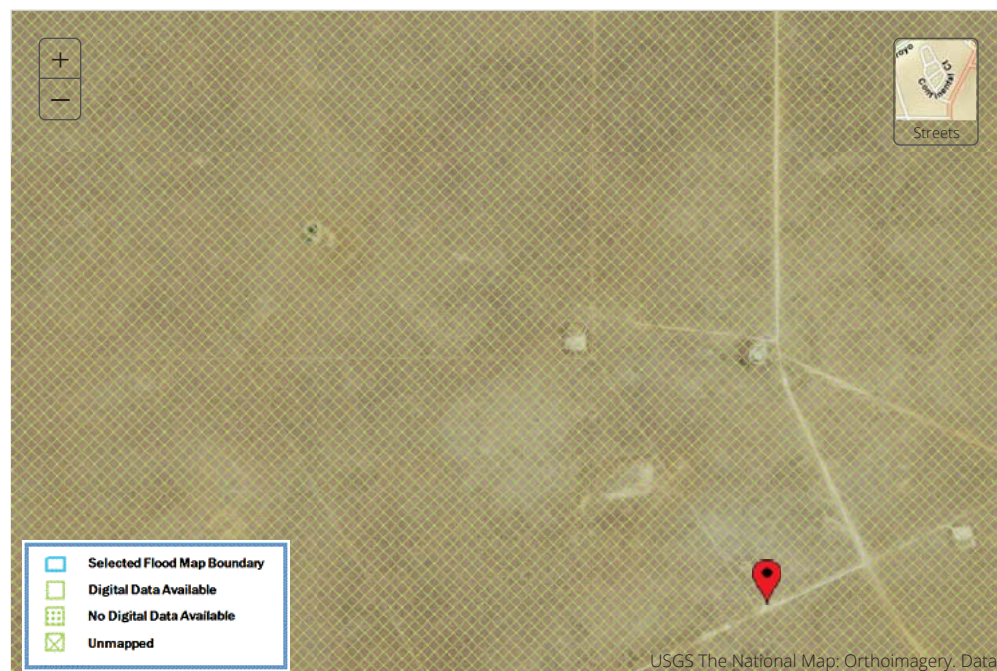

[Share This Page.](#)

[Home \(//www.fema.gov/\)](https://www.fema.gov/) [Download Plug-ins \(//www.fema.gov/download-plugin-ins\)](https://www.fema.gov/download-plugin-ins) [About Us \(//www.fema.gov/about-us\)](https://www.fema.gov/about-us) [Privacy Policy \(//www.fema.gov/privacy-policy\)](https://www.fema.gov/privacy-policy) [FOIA \(//www.fema.gov/foia\)](https://www.fema.gov/foia) [Office of the Inspector General \(//www.oig.dhs.gov/\)](https://www.oig.dhs.gov/) [Strategic Plan \(//www.fema.gov/fema-strategic-plan\)](https://www.fema.gov/fema-strategic-plan) [Whitehouse.gov \(//www.whitehouse.gov\)](https://www.whitehouse.gov/) [DHS.gov](https://www.dhs.gov/)

<http://www.dhs.gov>, [Ready.gov \(http://www.ready.gov\)](http://www.ready.gov), [USA.gov \(http://www.usa.gov\)](http://www.usa.gov), DisasterAssistance.gov
(<http://www.disasterassistance.gov/>)



(<https://www.oig.dhs.gov/hotline>)

 Official website of the Department of Homeland Security



USGS Home
Contact USGS
Search USGS

National Water Information System: Web Interface

USGS Water Resources

Data Category:
Groundwater

Geographic Area:
New Mexico

GO

Click to hide News Bulletins

- Explore the **NEW** [USGS National Water Dashboard](#) to access real-time data from over 13,500 stations nationwide.
- [Full News](#) 

Groundwater levels for New Mexico

Click to hide state-specific text

* **IMPORTANT:** [Next Generation Station Page](#)

Search Results -- 1 sites found

Agency code = usgs

site_no list =

- 354929103433302

Minimum number of levels = 1

[Save file of selected sites](#) to local disk for future upload

USGS 354929103433302 18N.30E.02.111A

Harding County, New Mexico
Latitude 35°49'29", Longitude 103°43'33" NAD27
Land-surface elevation 4,433 feet above NAVD88
This well is completed in the Other aquifers (N9999OTHER) national aquifer.

Output formats

Table of data

Tab-separated data

Graph of data

Reselect period

Date	Time	<div>Water-level date-time accuracy</div>	<div>Parameter code</div>	Water level, feet below land surface	Water level, feet above specific vertical datum	Referenced vertical datum	<div>Status</div>	<div>Method of measurement</div>	<div>Measuring agency</div>	<div>Source of measurement</div>	<div>Water-level approval status</div>
<div></div>	<div></div>	<div></div>	<div></div>	<div></div>	<div></div>	<div></div>	<div></div>	<div></div>	<div></div>	<div></div>	<div></div>
1992-02-04			D62610		4383.00	NGVD29	1	S			A
1992-02-04			D62611		4385.12	NAVD88	1	S			A
1992-02-04			D72019	47.88			1	S			A

Explanation		
Section	Code	Description
Water-level date-time accuracy	D	Date is accurate to the Day
Parameter code	62610	Groundwater level above NGVD 1929, feet
Parameter code	62611	Groundwater level above NAVD 1988, feet
Parameter code	72019	Depth to water level, feet below land surface
Referenced vertical datum	NAVD88	North American Vertical Datum of 1988
Referenced vertical datum	NGVD29	National Geodetic Vertical Datum of 1929
Status	1	Static
Method of measurement	S	Steel-tape measurement.
Measuring agency		Not determined
Source of measurement		Not determined
Water-level approval status	A	Approved for publication -- Processing and review completed.

[Questions about sites/data?](#)
[Feedback on this web site](#)
[Automated retrievals](#)
[Help](#)

[Data Tips](#)
[Explanation of terms](#)
[Subscribe for system changes](#)
[News](#)

AccessibilityFOIAPrivacyPolicies and Notices

[U.S. Department of the Interior](#) | [U.S. Geological Survey](#)

Title: Groundwater for New Mexico: Water Levels

URL: <https://nwis.waterdata.usgs.gov/nm/nwis/gwlevels?>

Page Contact Information: [New Mexico Water Data Maintainer](#)

Page Last Modified: 2021-04-27 12:25:40 EDT

0.39 0.35 nadww01



District I

1625 N. French Dr., Hobbs, NM 88240
Phone:(575) 393-6161 Fax:(575) 393-0720

District II

811 S. First St., Artesia, NM 88210
Phone:(575) 748-1283 Fax:(575) 748-9720

District III

1000 Rio Brazos Rd., Aztec, NM 87410
Phone:(505) 334-6178 Fax:(505) 334-6170

District IV

1220 S. St Francis Dr., Santa Fe, NM 87505
Phone:(505) 476-3470 Fax:(505) 476-3462

State of New Mexico
Energy, Minerals and Natural Resources
Oil Conservation Division
1220 S. St Francis Dr.
Santa Fe, NM 87505

CONDITIONS

Action 38245

CONDITIONS

Operator: OXY USA INC P.O. Box 4294 Houston, TX 772104294	OGRID: 16696
	Action Number: 38245
	Action Type: [C-141] Release Corrective Action (C-141)

CONDITIONS

Created By	Condition	Condition Date
nvelez	Remediation plan approved with the following conditions for final closure report content; 1. Provide executive summary of work 2. Wetland & Karst maps 3. Topo map showing any well head protection areas within 1/2 mile from the release 4. Aerial map showing any significant watercourse within 1/2 mile of any horizontal boundary of the release 5. Clearly show horizontal delineation/confirmation samples for entire release perimeter 6. All confirmation samples must meet reclamation standards for 0-4 ft. below grade (chloride - 600 mg/kg, total TPH - 100 mg/kg, benzene - 10 mg/kg, total BTEX - 50 mg/kg) 7. Any/all field notes 8. Photos prior to backfilling showing; Title/Header, date/time of photo, orientation of photo (direction viewed), GIS data for any/all sample points, annotation or explanation to imagery content 9. Remedial activity documentation [e.g. confirmation sampling notification(s)] 10. Deadline to complete remediation and submit final report: 2/15/2023.	11/15/2022