

District I
1625 N. French Dr., Hobbs, NM 88240
District II
1301 W. Grand Avenue, Artesia, NM 88210
District III
1000 Rio Brazos Road, Aztec, NM 87410
District IV
1220 S. St. Francis Dr., Santa Fe, NM 87505

State of New Mexico
Energy Minerals and Natural Resources
Oil Conservation Division
1220 South St. Francis Dr.
Santa Fe, NM 87505

Form C-141
Revised October 10, 2003

Submit 2 Copies to appropriate
District Office in accordance
with Rule 116 on back
side of form

2RP-3372

Release Notification and Corrective Action

OPERATOR

☐ Initial Report ☒ Final Report

Name of Company	Enterprise Field Services LLC	Contact	Alena Miro
	PO Box 4324, Houston, TX 77252	Telephone No.	575-628-6802
Facility Name	Pipeline ROW, Mercury Fee Line	Facility Type:	Gas Gathering Pipeline
Surface Owner	Private-McDonald	Mineral Owner	NA
		Lease No.	NA

LOCATION OF RELEASE

Unit Letter	Section	Township	Range	Feet from the	North/South Line	Feet from the	East/West Line	County
	20	23S	28E					Eddy

Latitude **32.304890 N** Longitude **-104.126170 W**

NATURE OF RELEASE

Type of Release	Natural Gas and Pipeline Liquids	Volume of Release	799 MCF, 5 BBL of PPL liquids	Volume Recovered	N/A
Source of Release	Pipeline Leak	Date and Hour of Occurrence	11/15/2013 0930 (MST)	Date and Hour of Discovery	11/15/2013 15:00 (MST)
Was Immediate Notice Given?	<input checked="" type="checkbox"/> Yes <input type="checkbox"/> No <input type="checkbox"/> Not Required	If YES, To Whom?	NMOCD Region 2, Mike Bratcher		
By Whom?	Jim Heap	Date and Hour	11/15/2013 @ 15:30 MST		
Was a Watercourse Reached?	<input type="checkbox"/> Yes <input checked="" type="checkbox"/> No	If YES, Volume Impacting the Watercourse.			

If a Watercourse was Impacted, Describe Fully.*



Describe Cause of Problem and Remedial Action Taken.*

Suspected internal corrosion. The line was isolated, blown-down and repaired. Loss volume includes blow-down.

Describe Area Affected and Cleanup Action Taken.*

Soil remediation activities are outlined in the attached report.

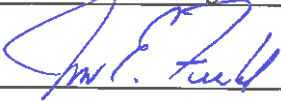
I hereby certify that the information given above is true and complete to the best of my knowledge and understand that pursuant to NMOCD rules and regulations all operators are required to report and/or file certain release notifications and perform corrective actions for releases which may endanger public health or the environment. The acceptance of a C-141 report by the NMOCD marked as "Final Report" does not relieve the operator of liability should their operations have failed to adequately investigate and remediate contamination that pose a threat to ground water, surface water, human health or the environment. In addition, NMOCD acceptance of a C-141 report does not relieve the operator of responsibility for compliance with any other federal, state, or local laws and/or regulations.

Signature:				OIL CONSERVATION DIVISION	
Printed Name:	Jon E. Fields	Approved by District Supervisor:			
Title:	Director, Field Environmental	Approval Date:	4/17/2023	Expiration Date:	
E-mail Address:	jefields@eprod.com	Conditions of Approval:		Attached <input type="checkbox"/>	
Date:	3-17-2017	Phone:		713-318-6595	

* Attach Additional Sheets If Necessary



January 30, 2014

AMARILLO
921 North Blvins
Amarillo, Texas 79107
Phone 806.467.0807
Fax 806.467.0822

Mr. Mike Bratcher
NMOCD District 2
811 S. 1st Street
Artesia, NM 88210

ARTESIA
408 West Texas Avenue
Artesia, New Mexico 88210
Phone 575.746.8768

Subject: Remedial Activities and Closure Report
Enterprise Products
Mercury Fee Line Leak

FORT COLLINS
1811 East Mulberry Street
Fort Collins, Colorado
Phone 970.818.5330

Dear Mr. Bratcher,

MIDLAND
2301 State Hwy 349
Midland, Texas 79706
Phone 432.522.2133
Fax 432.522.2180

Enterprise Products (Enterprise) contracted Talon/LPE (Talon) to perform soil assessment and remediation services at the above referenced location. The incident description, soil sampling results, remediation activities and closure request are submitted herein.

OKLAHOMA CITY
7700 North Hudson Avenue
Suite 10
Oklahoma City, Oklahoma 73118
Phone 405.486.7030

Incident Date

The release was discovered on November 15, 2013

SAN ANTONIO
13111 Lookout Way
San Antonio, Texas 78233
Phone 210.265.8025

Background Information

WOODWARD
1211 34th Street
Suite 13
Woodward, Oklahoma 73801
Phone 580.377.1194

The Enterprise Mercury Fee Line Leak is located approximately eighteen (18) miles Southeast of Carlsbad, New Mexico. The legal location for this site is Section 20, Township 23 South, and Range 28 East. More specifically the latitude and longitude for the release are 32.290787 North and 104.117796 West. A site plan is presented in Appendix I.

According to the soil survey provided by the United States Department of Agriculture Natural Resources Conservation Service, the soil in this area is made up of the Gypsum land-Cottonwood complex with 0 to 3 percent slopes. Per the New Mexico Bureau of Geology and Mineral Resources, the local surface and shallow geology is comprised of alluvium that is Holocene to upper Pleistocene in age. Drainage courses in this area are normally dry. Groundwater in the project vicinity is approximately 50-feet below ground surface (bgs) according to the New Mexico Office of the State Engineer. See Appendix II for the referenced groundwater data.

ENVIRONMENTAL CONSULTING
ENGINEERING
DRILLING
CONSTRUCTION
SPILL MANAGEMENT
GENERAL CONTRACTING

The ranking for this site is **10** based on the following:

Toll Free 866.742.0742
www.talonlpe.com

Depth to ground water	50-100'
Wellhead Protection Area	>1000'
Distance to surface water body	>1000'

Incident Description

The release was discovered on November 14, 2013 by Enterprise personnel. The pipeline was excavated in order to replace the compromised section of pipe. Talon mobilized personnel to conduct soil sampling within the trench. The results of these sampling activities are summarized in the table below.

Laboratory Results

See Appendix III for complete report of laboratory results.

Sample ID	Depth (feet)	BTEX (mg/kg)	Chlorides (mg/kg)	TPH (mg/kg) GRO	TPH (mg/kg) DRO
S-1	6.5	ND	896	ND	ND
S-2	6.5	330	5280	6930	7300
S-3	6.5	ND	1090	10.6	ND
S-4	6.5	ND	1760	ND	ND
S-5	6.5	ND	1040	ND	ND
S-6	6.5	73.6	3600	2580	6120

Laboratory Results

See Appendix III for complete report of laboratory results.

Sample ID	Depth (feet)	BTEX (mg/kg)	Chlorides (mg/kg)	TPH (mg/kg) GRO	TPH (mg/kg) DRO
BG-1	0	--	25600	--	--
BG-1	6.5	--	1250	--	--
S-2	8.5	ND	1470	ND	ND
S-4	7	--	640	--	--
S-6	7	ND	384	ND	ND

(--) Analyte Not Tested

(ND) Analyte Not Detected

Based upon the site ranking of 10, NMOCD Recommended Remedial Action Levels (RRAL's) are 50 mg/kg for BTEX, 10 mg for Benzene, 1,000 mg/kg for TPH.

Remedial Actions

- The excavation was expanded vertically and horizontally utilizing field chloride titrations and Photo Ionization Detector (PID) readings to guide the excavation.
- Confirmation soil samples were taken at sample locations S-2, S-4, and S-6.
- Background soil samples were taken and analyzed for total chlorides.
- Based on the analytical results from the confirmation sampling, the elevated background chloride levels, and excavation constraints due to infrastructure NMOCD granted permission to backfill the excavation.
- The excavation was backfilled with top soil and contoured to match the surrounding terrain.

Closure

On behalf of Enterprise Energy Partners L.P. we respectfully request that no further actions be required and that closure with regard to this release be granted.

If we can provide additional information or be of further assistance, please contact our office at (575)-746-8768.

Respectfully submitted,
TALON/LPE

Sheldon L. Hitchcock
Environmental Scientist

David J. Adkins
District Manager

SITE PLAN

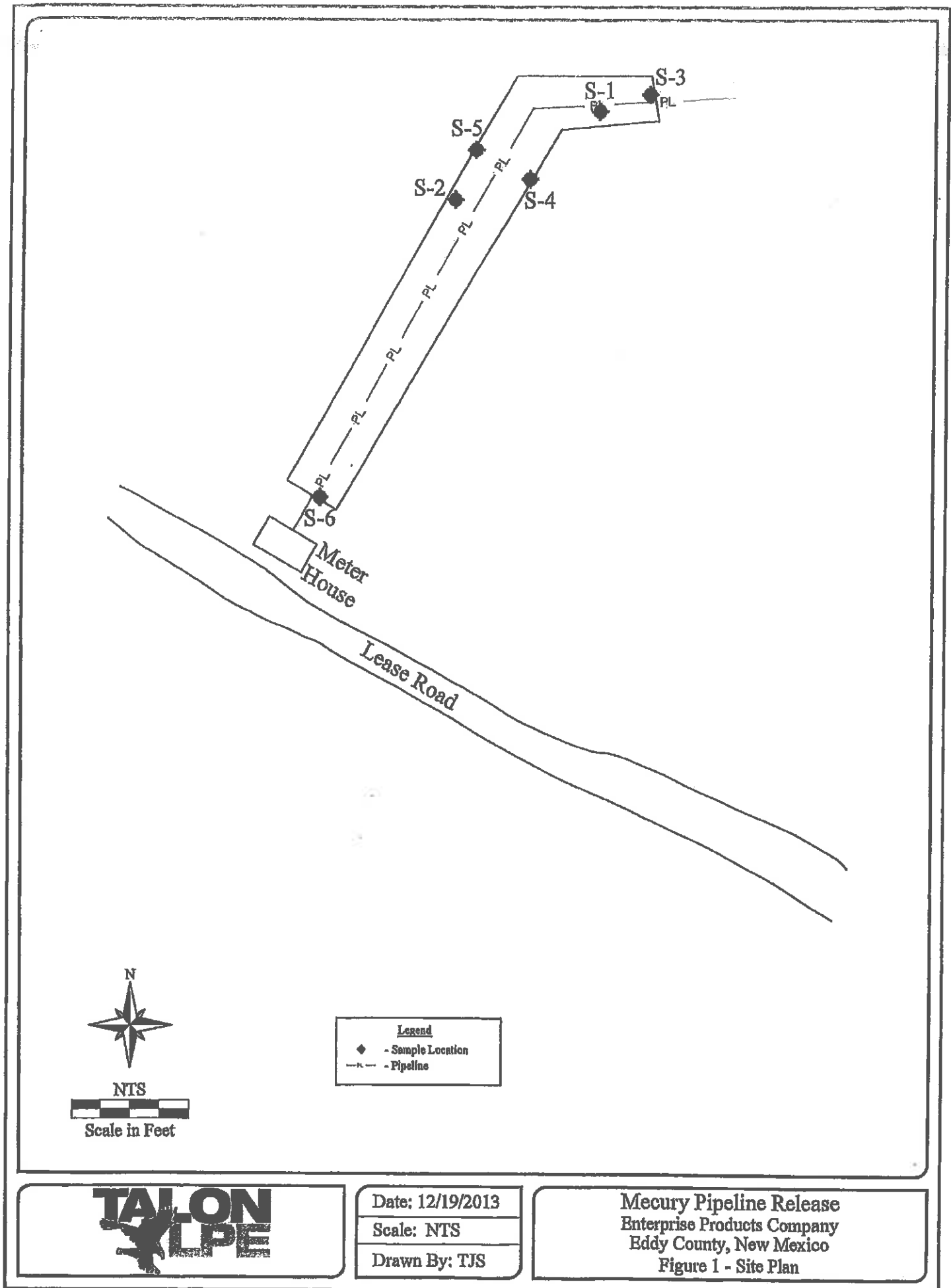

GROUNDWATER DATA INITIAL C-141



New Mexico Office of the State Engineer Water Column/Average Depth to Water

(A CLW#### in the
POD suffix indicates the
POD has been replaced
& no longer serves a
water right file.)

(R=POD has
been replaced,
O=orphaned,
C=the file is
closed)

(quarters are 1=NW 2=NE 3=SW 4=SE)
(quarters are smallest to largest)

(NAD83 UTM in meters)

(in feet)

POD Number	POD Sub-Code	basin	County	Q Q Q	64-16	4 Sec	Tws	Rng	X	Y	Distance	Depth Well	Depth Water	Water Column
C 00851	C		ED		3	17	23S	28E	583438	3574217*	1029	200	50	150

Average Depth to Water: 50 feet

Minimum Depth: 50 feet

Maximum Depth: 50 feet

Record Count: 1

Basin/County Search:

UTM NAD83 Radius Search (in meters):

Easting (X): 583241

Northing (Y): 3573207

Radius: 1100

*UTM location was derived from PLSS - see Help

The data is furnished by the NMOSE/ISC and is accepted by the recipient with the expressed understanding that the OSE/ISC make no warranties, expressed or implied, concerning the accuracy, completeness, reliability, usability, or suitability for any particular purpose of the data.

12/12/13 11:23 AM

Page 1 of 1

WATER COLUMN/ AVERAGE
DEPTH TO WATER

District I
1625 N. French Dr., Hobbs, NM 88240
District II
1301 W. Grand Avenue, Artesia, NM 88210
District III
1000 Rio Brazos Road, Aztec, NM 87410
District IV
1220 S. St. Francis Dr., Santa Fe, NM 87505

State of New Mexico
Energy Minerals and Natural Resources
Oil Conservation Division
1220 South St. Francis Dr.
Santa Fe, NM 87505

Rec'd 1/15/2014

NMOCD

Dist 2

Form C-141
Revised October 10, 2003

Submit 2 Copies to appropriate
District Office in accordance
with Rule 116 on back
side of form

PJMWI326331184

Release Notification and Corrective Action

NAB1530752119

OPERATOR

☒ Initial Report ☐ Final Report

Name of Company	Enterprise Field Services LLC	Contact	Jim Heap
	PO Box 4324, Houston, TX 77252	Telephone No.	432-686-5404
Facility Name	Pipeline ROW, Mercury Fee Line	Facility Type:	Gas Gathering Pipeline
Surface Owner	Private-McDonald	Mineral Owner	NA
		Lease No.	NA

LOCATION OF RELEASE

Unit Letter	Section	Township	Range	Feet from the	North/South Line	Feet from the	East/West Line	County
	20	23S	28E					Eddy

Latitude 32.304890 N Longitude -104.126170 W

NATURE OF RELEASE

Type of Release	Natural Gas and Pipeline Liquids	Volume of Release	799 MCF, 5 BBL of PPL liquids	Volume Recovered	TBD
Source of Release	Pipeline Leak	Date and Hour of Occurrence	11/15/2013 0930 (MST)	Date and Hour of Discovery	11/15/2013 15:00 (MST)
Was Immediate Notice Given?	<input checked="" type="checkbox"/> Yes <input type="checkbox"/> No <input type="checkbox"/> Not Required	If YES, To Whom?	NMOCD Region 2, Mike Bratcher		
By Whom?	Jim Heap	Date and Hour	11/15/2013 @ 15:30 MST		
Was a Watercourse Reached?	<input type="checkbox"/> Yes <input checked="" type="checkbox"/> No	If YES, Volume Impacting the Watercourse.			

If a Watercourse was Impacted, Describe Fully.*

Describe Cause of Problem and Remedial Action Taken.*

Suspected internal corrosion. The line was isolated, blown-down and scheduled for repair. Loss volume includes blow-down.

Describe Area Affected and Cleanup Action Taken.*

Any impacted area will be determined when the line is excavated; landowner will be notified. Current observation shows a release of liquids to the surrounding area. Repair schedule is not known at the time of this report.

I hereby certify that the information given above is true and complete to the best of my knowledge and understand that pursuant to NMOCD rules and regulations all operators are required to report and/or file certain release notifications and perform corrective actions for releases which may endanger public health or the environment. The acceptance of a C-141 report by the NMOCD marked as "Final Report" does not relieve the operator of liability should their operations have failed to adequately investigate and remediate contamination that pose a threat to ground water, surface water, human health or the environment. In addition, NMOCD acceptance of a C-141 report does not relieve the operator of responsibility for compliance with any other federal, state, or local laws and/or regulations.

OIL CONSERVATION DIVISION

Signature:	Approved by District Supervisor		
Printed Name: Jon E. Fields	Signed By: [Signature]		
Title: Director, Field Environmental	Approval Date: 11/3/15	Expiration Date: N/A	
E-mail Address: jefields@eprod.com	Conditions of Approval:		Attached <input type="checkbox"/>
Date: Phone: 713-318-6595			

* Attach Additional Sheets If Necessary

2RP-3372

LABORATORY RESULTS



PHONE (575) 393-2326 • 101 E. MARLAND • HOBBS, NM 88240

November 18, 2013

DAVID ADKINS

TALON LPE

408 W. TEXAS AVE.

ARTESIA, NM 88210

RE: MERCURY

Enclosed are the results of analyses for samples received by the laboratory on 11/11/13 13:55.

Cardinal Laboratories is accredited through Texas NELAP under certificate number T104704398-13-5. Accreditation applies to drinking water, non-potable water and solid and chemical materials. All accredited analytes are denoted by an asterisk (*). For a complete list of accredited analytes and matrices visit the TCEQ website at www.tceq.texas.gov/field/qa/lab_accred_certif.html.

Cardinal Laboratories is accredited through the State of Colorado Department of Public Health and Environment for:

Method EPA 552.2	Haloacetic Acids (HAA-5)
Method EPA 524.2	Total Trihalomethanes (TTHM)
Method EPA 524.4	Regulated VOCs (V1, V2, V3)

Accreditation applies to public drinking water matrices.

This report meets NELAP requirements and is made up of a cover page, analytical results, and a copy of the original chain-of-custody. If you have any questions concerning this report, please feel free to contact me.

Sincerely,

Caley D. Keene

Lab Director/Quality Manager



PHONE (575) 393-2326 • 101 E. MARLAND • HOBBS, NM 88240

Analytical Results For:

TALON LPE
DAVID ADKINS
408 W. TEXAS AVE.
ARTESIA NM, 88210
Fax To: (575) 745-8905

Received: 11/11/2013
Reported: 11/18/2013
Project Name: MERCURY
Project Number: 700348.132.02
Project Location: NONE GIVEN

Sampling Date: 11/07/2013
Sampling Type: Soil
Sampling Condition: Cool & Intact
Sample Received By: Jodi Henson

Sample ID: S-1 6.5' (H302743-01)

BTEX 8021B		mg/kg	Analyzed By: MS						
Analyte	Result	Reporting Limit	Analyzed	Method Blank	BS	% Recovery	True Value QC	RPD	Qualifier
Benzene*	<0.050	0.050	11/14/2013	ND	1.75	87.5	2.00	13.1	
Toluene*	<0.050	0.050	11/14/2013	ND	1.75	87.4	2.00	13.0	
Ethylbenzene*	<0.050	0.050	11/14/2013	ND	1.74	87.1	2.00	13.2	
Total Xylenes*	<0.150	0.150	11/14/2013	ND	5.12	85.3	6.00	12.7	
Total BTEX	<0.300	0.300	11/14/2013	ND					

Surrogate: 4-Bromofluorobenzene (PIL) 106 % 89.4-126

Chloride, SM4500Cl-B		mg/kg	Analyzed By: AP						
Analyte	Result	Reporting Limit	Analyzed	Method Blank	BS	% Recovery	True Value QC	RPD	Qualifier
Chloride	896	16.0	11/14/2013	ND	432	108	400	3.77	

TPH 8015H		mg/kg	Analyzed By: MS						
Analyte	Result	Reporting Limit	Analyzed	Method Blank	BS	% Recovery	True Value QC	RPD	Qualifier
GRO C6-C10	<10.0	10.0	11/13/2013	ND	197	98.6	200	7.27	
DRO >C10-C28	<10.0	10.0	11/13/2013	ND	188	94.0	200	9.72	

Surrogate: 1-Chlorooctane 98.2 % 65.2-140

Surrogate: 1-Chlorodecane 111 % 63.6-154

Cardinal Laboratories

* = Accredited Analyte

PLEASE NOTE: Liability and Damages. Cardinal's liability and client's exclusive remedy for any claim arising, whether based in contract or tort, shall be limited to the amount paid by client for analyses. All claims, including those for negligence and any other cause whatsoever shall be deemed waived unless made in writing and received by Cardinal within thirty (30) days after completion of the applicable service. In no event shall Cardinal be held liable for incidental or consequential damages, including, without limitation, business interruptions, loss of use, or loss of profits incurred by client, its subsidiaries, affiliates or processors arising out of or related to the performance of the services furnished by Cardinal, regardless of whether such claim is based upon any of the above stated causes of action. Results relate only to the samples identified above. This report shall not be reproduced except in full with written approval of Cardinal Laboratories.

Celey D. Keene, Lab Director/Quality Manager



PHONE (575) 393-2326 • 101 E. MARLAND • HOBBS, NM 88240

Analytical Results For:

TALON LPE
DAVID ADKINS
408 W. TEXAS AVE.
ARTESIA NM, 88210
Fax To: (575) 745-8905

Received: 11/11/2013
Reported: 11/18/2013
Project Name: MERCURY
Project Number: 700348.132.02
Project Location: NONE GIVEN

Sampling Date: 11/07/2013
Sampling Type: Soil
Sampling Condition: Cool & Intact
Sample Received By: Jodi Henson

Sample ID: S-2 6.5' (H302743-02)

BTX 80218

mg/kg

Analyzed By: MS

Analyte	Result	Reporting Limit	Analyzed	Method Blank	BS	% Recovery	True Value QC	RPD	Qualifier
Benzene*	<5.00	5.00	11/14/2013	ND	1.75	87.5	2.00	13.2	
Toluene*	45.8	5.00	11/14/2013	ND	1.75	87.4	2.00	13.0	
Ethylbenzene*	20.6	5.00	11/14/2013	ND	1.74	87.1	2.00	13.2	
Total Xylenes*	264	15.0	11/14/2013	ND	5.12	85.3	6.00	12.7	
Total BTX	330	30.0	11/14/2013	ND					

Surrogate: 4-Bromofluorobenzene (PIL) 125 % 89.4-126

Chloride, 6N450CI-B

mg/kg

Analyzed By: AP

Analyte	Result	Reporting Limit	Analyzed	Method Blank	BS	% Recovery	True Value QC	RPD	Qualifier
Chloride	5280	16.0	11/14/2013	ND	432	108	400	3.77	

TPH 8015M

mg/kg

Analyzed By: MS

S-04

Analyte	Result	Reporting Limit	Analyzed	Method Blank	BS	% Recovery	True Value QC	RPD	Qualifier
GRO C6-C10	6930	10.0	11/13/2013	ND	197	98.6	200	7.27	
DRO >C10-C28	7300	10.0	11/13/2013	ND	188	94.0	200	9.72	

Surrogate: 1-Chlorooctane 249 % 65.2-140

Surrogate: 1-Chlorooctadecane 169 % 63.6-154

Cardinal Laboratories

* = Accredited Analyte

PLEASE NOTE: Stability and Durability. Cardinal's liability and client's recourse remedy for any claim arising, whether based in contract or tort, shall be limited to the amount paid by client for analysis. All claims, including those for negligence and any other cause whatsoever shall be deemed waived unless made in writing and received by Cardinal within thirty (30) days after completion of the applicable service. In no event shall Cardinal be liable for incidental or consequential damages, including, without limitation, business interruption, loss of use, or loss of profits incurred by client, its subsidiaries, affiliates or successors arising out of or related to the performance of the services rendered by Cardinal, regardless of whether such claim is based upon any of the above stated reasons or otherwise. Results relate only to the samples identified above. This report shall not be reproduced except in full with written approval of Cardinal Laboratories.

Celey D. Keene, Lab Director/Quality Manager



PHONE (575) 393-2326 • 101 E. MARLAND • HOBBS, NM 88240

Analytical Results For:

TALON LPE
DAVID ADKINS
408 W. TEXAS AVE.
ARTESIA NM, 88210
Fax To: (575) 745-8905

Received: 11/11/2013
Reported: 11/18/2013
Project Name: MERCURY
Project Number: 700348.132.02
Project Location: NONE GIVEN

Sampling Date: 11/07/2013
Sampling Type: Soil
Sampling Condition: Cool & Intact
Sample Received By: Jodi Henson

Sample ID: S-3 6.5' (H302743-03)

BTX 80218			mg/kg							Analyzed By: MS	
Analyte	Result	Reporting Limit	Analyzed	Method Blank	BS	% Recovery	True Value QC	RPD	Qualifier		
Benzene*	<0.050	0.050	11/14/2013	ND	1.75	87.5	2.00	13.2			
Toluene*	<0.050	0.050	11/14/2013	ND	1.75	87.4	2.00	13.0			
Ethylbenzene*	<0.050	0.050	11/14/2013	ND	1.74	87.1	2.00	13.2			
Total Xylenes*	<0.150	0.150	11/14/2013	ND	5.12	85.3	6.00	12.7			
Total BTX	<0.300	0.300	11/14/2013	ND							

Surrogate: 1-Bromofluorobenzene (PIL) 108 % 89.4-126

Chloride, SM4500Cl-B			mg/kg		Analyzed By: AP				
Analyte	Result	Reporting Limit	Analyzed	Method Blank	BS	% Recovery	True Value QC	RPD	Qualifier
Chloride	1090	16.0	11/14/2013	ND	432	108	400	3.77	

TPH 801SM		mg/kg		Analyzed By: MS					
Analyte	Result	Reporting Limit	Analyzed	Method Blank	BS	% Recovery	True Value QC	RPD	Qualifier
GRO C6-C10	10.6	10.0	11/13/2013	ND	197	98.6	200	7.27	
DRO >C10-C28	<10.0	10.0	11/13/2013	ND	188	94.0	200	9.72	

Surrogate: 1-Chlorooctane 108 % 65.2-140

Surrogate: 1-Chlorooctadecane 124 % 63.6-134

Cardinal Laboratories

* = Accredited Analyte

PLEASE NOTE: Utility and Storage. Cardinal's liability and client's exclusive remedy for any claim arising, whether based in contract or tort, shall be limited to the amount paid by client for analysis. All claims, including those for negligence and any other cause whatsoever shall be deemed waived unless made in writing and received by Cardinal within thirty (30) days after completion of the applicable service. In no event shall Cardinal be liable for indirect or consequential damages, including, without limitation, business interruption, loss of use, or loss of profits incurred by client, its subsidiaries, affiliates or successors arising out of or related to the performance of the services rendered by Cardinal, regardless of whether such claim is based upon any of the above stated reasons or otherwise. This report shall not be reproduced except in full without approval of Cardinal Laboratories.

Celey D. Keene, Lab Director/Quality Manager



PHONE (575) 393-2326 • 101 E. MARLAND • HOBBS, NM 88240

Analytical Results For:

TALON LPE
DAVID ADKINS
408 W. TEXAS AVE.
ARTESIA NM, 88210
Fax To: (575) 745-8905

Received: 11/11/2013
Reported: 11/18/2013
Project Name: MERCURY
Project Number: 700348.132.02
Project Location: NONE GIVEN

Sampling Date: 11/07/2013
Sampling Type: Soil
Sampling Condition: Cool & Intact
Sample Received By: Jodi Hanson

Sample ID: S-4 6.5' (H302743-04)

BTEX 8021B

mg/kg

Analyzed By: MS

Analyte	Result	Reporting Limit	Analyzed	Method Blank	BS	% Recovery	True Value QC	RPD	Qualifier
Benzene*	<0.050	0.050	11/14/2013	ND	1.75	87.5	2.00	13.2	
Toluene*	<0.050	0.050	11/14/2013	ND	1.75	87.4	2.00	13.0	
Ethylbenzene*	<0.050	0.050	11/14/2013	ND	1.74	87.1	2.00	13.2	
Total Xylenes*	<0.150	0.150	11/14/2013	ND	5.12	85.3	6.00	12.7	
Total BTEX	<0.300	0.300	11/14/2013	ND					

Surrogate: 4-Bromofluorobenzene (PIC) 105 % 89.4-126

Chloride, SM4300Cl-B

mg/kg

Analyzed By: AP

Analyte	Result	Reporting Limit	Analyzed	Method Blank	BS	% Recovery	True Value QC	RPD	Qualifier
Chloride	1760	16.0	11/14/2013	ND	432	108	400	3.77	

TPH 8015M

mg/kg

Analyzed By: MS

Analyte	Result	Reporting Limit	Analyzed	Method Blank	BS	% Recovery	True Value QC	RPD	Qualifier
GRO C6-C10	<10.0	10.0	11/13/2013	ND	197	98.6	200	7.27	
DRO >C10-C28	<10.0	10.0	11/13/2013	ND	188	94.0	200	9.72	

Surrogate: 1-Chlorooctane 103 % 65.2-140

Surrogate: 1-Chlorooctadecane 117 % 63.6-154

Cardinal Laboratories

* = Accredited Analyte

PLEASE NOTE: Liability and Damages. Cardinal's liability and client's exclusive remedy for any claim arising, whether based in contract or tort, shall be limited to the amount paid by client for analysis. All claims, including those for negligence and any other cause whatsoever shall be deemed waived unless made in writing and received by Cardinal within thirty (30) days after completion of the applicable service. It is no event shall Cardinal be liable for accidental or consequential damages, including, without limitation, business interruptions, loss of use, or loss of profits incurred by client, its subsidiaries, affiliates or successors arising out of or related to the performance of the services furnished by Cardinal, regardless of whether such claim is based upon any of the above stated causes or otherwise. Results relate only to the samples described above. This report shall not be reproduced except in full with written approval of Cardinal Laboratories.

Celey D. Keene, Lab Director/Quality Manager



PHONE (575) 393-2326 • 101 E. MARLAND • HOBBS, NM 88240

Analytical Results For:

TALON LPE
DAVID ADKINS
408 W. TEXAS AVE.
ARTESTA NM, 88210
Fax To: (575) 745-8905

Received: 11/11/2013
Reported: 11/18/2013
Project Name: MERCURY
Project Number: 700348.132.02
Project Location: NONE GIVEN

Sampling Date: 11/07/2013
Sampling Type: Soil
Sampling Condition: Cool & Intact
Sample Received By: Jodi Henson

Sample ID: S-5 6.5' (H302743-05)

BTEX 8021B

mg/kg

Analyzed By: MS

Analyte	Result	Reporting Limit	Analyzed	Method Blank	BS	% Recovery	True Value QC	RPD	Qualifier
Benzene*	<0.050	0.050	11/14/2013	ND	1.75	87.5	2.00	13.2	
Toluene*	<0.050	0.050	11/14/2013	ND	1.75	87.4	2.00	13.0	
Ethylbenzene*	<0.050	0.050	11/14/2013	ND	1.74	87.1	2.00	13.2	
Total Xylenes*	<0.150	0.150	11/14/2013	ND	5.12	85.3	6.00	12.7	
Total BTEX	<0.300	0.300	11/14/2013	ND					

Surrogate: 4-Bromofluorobenzene (PIL) 106 % 89.4-126

Chloride, SM4508Cl-B

mg/kg

Analyzed By: AP

Analyte	Result	Reporting Limit	Analyzed	Method Blank	BS	% Recovery	True Value QC	RPD	Qualifier
Chloride	1040	16.0	11/14/2013	ND	432	108	400	3.77	

TPH 8015M

mg/kg

Analyzed By: MS

Analyte	Result	Reporting Limit	Analyzed	Method Blank	BS	% Recovery	True Value QC	RPD	Qualifier
GRO C6-C10	<10.0	10.0	11/13/2013	ND	197	98.6	200	7.27	
DRO >C10-C28	<10.0	10.0	11/13/2013	ND	188	94.0	200	9.72	

Surrogate: 1-Chlorooctane 105 % 65.2-140

Surrogate: 1-Chlorooctadecane 119 % 63.6-154

Cardinal Laboratories

* = Accredited Analyte

PLEASE NOTE: Liability and damages. Cardinal's liability and efforts to defend remedy for any claim arising, whether based in contract or tort, shall be limited to the amount paid by client for analysis. All claims, including those for negligence and any other cause whatsoever shall be deemed waived unless made in writing and received by Cardinal within thirty (30) days after completion of the applicable service. In no event shall Cardinal be liable for incidental or consequential damages, including, without limitation, business interruption, loss of use, or loss of profits incurred by client, its subsidiaries, affiliates or successors arising out of or related to the performance of the service furnished by Cardinal, regardless of whether such claim is based upon any of the above stated causes of damages. Results apply only to the samples identified above. This report shall not be reproduced except in full with written approval of Cardinal Laboratories.

Celey D. Keene, Lab Director/Quality Manager



PHONE (575) 393-2326 • 101 E. MARLAND • HOBBS, NM 88240

Analytical Results For:

TALON LPE
DAVID ADKINS
408 W. TEXAS AVE.
ARTESIA NM, 88210
Fax To: (575) 745-8905

Received: 11/11/2013
Reported: 11/18/2013
Project Name: MERCURY
Project Number: 700348.132.02
Project Location: NONE GIVEN

Sampling Date: 11/07/2013
Sampling Type: Soil
Sampling Condition: Cool & Intact
Sample Received By: Jodi Henson

Sample ID: S-6 6.5' (H302743-06)

BTX 8021B		mg/kg		Analyzed By: MS		S-04			
Analyte	Result	Reporting Limit	Analyzed	Method Blank	BS	% Recovery	True Value QC	RPD	Qualifier
Benzene*	<2.00	2.00	11/14/2013	ND	1.75	87.5	2.00	13.2	
Toluene*	4.67	2.00	11/14/2013	ND	1.75	87.4	2.00	13.0	
Ethylbenzene*	6.26	2.00	11/14/2013	ND	1.74	87.1	2.00	13.2	
Total Xylenes*	62.7	6.00	11/14/2013	ND	5.12	85.3	6.00	12.7	
Total BTX	73.6	12.0	11/14/2013	ND					

Surrogate: 4-Bromofluorobenzene (PIL) 139 % 89.4-126

Chloride, SM4500Cl-B		mg/kg		Analyzed By: AP		S-04			
Analyte	Result	Reporting Limit	Analyzed	Method Blank	BS	% Recovery	True Value QC	RPD	Qualifier
Chloride	3600	16.0	11/14/2013	ND	432	108	400	3.77	

TPH 8015M		mg/kg		Analyzed By: MS		S-04			
Analyte	Result	Reporting Limit	Analyzed	Method Blank	BS	% Recovery	True Value QC	RPD	Qualifier
GRO C6-C10	2580	10.0	11/13/2013	ND	197	98.6	200	7.27	
DRO >C10-C28	6120	10.0	11/13/2013	ND	188	94.0	200	9.72	

Surrogate: 1-Chlorooctane 316 % 65.2-140

Surrogate: 1-Chlorodecane 180 % 63.6-154

Cardinal Laboratories

* = Accredited Analyte

PLEASE NOTE: Liability and Damages. Cardinal's liability and ability to receive payment for any data arising, whether based in contract or tort, shall be limited to the amount paid by client for analysis. At no time, including those for negligence and any other cause whatsoever shall be deemed waived unless made in writing and received by Cardinal within thirty (30) days after completion of the applicable service. In no event shall Cardinal be liable for incidental or consequential damages, including, without limitation, business interruptions, loss of use, or loss of profits sustained by client, its subsidiaries, affiliates or successors arising out of or related to the performance of the service hereunder by Cardinal, regardless of whether such claim is based upon any of the above stated reasons or otherwise. Results relate only to the samples identified above. This report shall not be reproduced except by full written approval of Cardinal Laboratories.

Celest D. Keene, Lab Director/Quality Manager



PHONE (575) 393-2325 • 101 E. MARLAND • HOBBS, NM 88240

Notes and Definitions

- S-04 The surrogate recovery for this sample is outside of established control limits due to a sample matrix effect.
- ND Analyte NOT DETECTED at or above the reporting limit
- RPD Relative Percent Difference
- ** Samples not received at proper temperature of 6°C or below.
- *** Insufficient time to reach temperature.
- Chloride by SM4500C-B does not require samples be received at or below 6°C
- Samples reported on an as received basis (wet) unless otherwise noted on report

Cardinal Laboratories

*-Accredited Analyte

PLEASE NOTE: Liability and Damages. Cardinal's liability and client's exclusive remedy for any claim arising, whether based in contract or tort, shall be limited to the amount paid by client for analysis. All claims, including those for negligence and any other basis whatsoever shall be deemed waived unless made in writing and received by Cardinal within thirty (30) days after completion of the applicable service. In no event shall Cardinal be liable for incidental or consequential damages, including, without limitation, business interruptions, loss of use, or loss of profits incurred by client, its subsidiaries, affiliates or successors arising out of or related to the performance of the services rendered by Cardinal, regardless of whether such claims based upon any of the above stated reasons or otherwise. Results relate only to the samples described above. This report shall not be reproduced except in full with written approval of Cardinal Laboratories.

Celey D. Keene, Lab Director/Quality Manager

Page 6 of 9

101 East Marland, Hobbs, NM 88240
(575) 393-2326 FAX (575) 393-2476

Company Name: Talon / LPE		P.O. #	
Project Manager: S. Hitchcock		Company: Talon / LPE	
Address: 408 W. Texas Ave.		Attn:	
City: Artistic		Address:	
State: NM		City:	
Zip: 88210		State:	
Phone #: 575-746-8768		Phone #:	
Fax #: 575-746-8905		Fax #:	
Project #: 700348.137.02		Project Owner: Enter Price	
Project Name: McClary		Project Location:	
Sample Name: S. Hitchcock		FOR LAB USE ONLY	

Lab I.D.	Sample I.D.	MATRIX					DATE	TIME	PRESERV	SAMPLING
		CONTAINERS	GROUNDWATER	WASTEWATER	SOIL	SLUDGE				
1	5-6.5	1	1	1	1	1	11/7/13	12:37		
2	5-2 6.5	1	1	1	1	1	12:48			
3	5-3 6.5	1	1	1	1	1	12:40			
4	5-4 6.5	1	1	1	1	1	12:43			
5	5-5 6.5	1	1	1	1	1	12:45			
6	5-6 6.5	1	1	1	1	1	12:52			

Date: 11/11/13 Time: 1:35		Received By: Jodi Benson Signature: <i>Jodi Benson</i>	
Relinquished By: S. Hitchcock Signature: <i>S. Hitchcock</i>		Relinquished By:	
Delivered By: (Circle One) Sampler - LPS • Bus • Other:		Date: 5.20	

Date: 11/11/13 Time: 1:35		Received By: Jodi Benson Signature: <i>Jodi Benson</i>	
Relinquished By: S. Hitchcock Signature: <i>S. Hitchcock</i>		Relinquished By:	
Delivered By: (Circle One) Sampler - LPS • Bus • Other:		Date: 5.20	

† Cardinal cannot accept verbal changes. Please fax written changes to 515-393-6416



PHONE (575) 393-2326 • 101 E. MARLAND • HOBBS, NM 88240

February 12, 2014

SHELDON HITCHCOCK

TALON LPE

408 W. TEXAS AVE.

ARTESIA, NM 88210

RE: MERCURY

Enclosed are the results of analyses for samples received by the laboratory on 02/11/14 12:20.

Cardinal Laboratories is accredited through Texas NELAP under certificate number T104704398-13-5. Accreditation applies to drinking water, non-potable water and solid and chemical materials. All accredited analytes are denoted by an asterisk (*). For a complete list of accredited analytes and matrices visit the TCEQ website at www.tceq.texas.gov/field/qa/lab_accred_certif.html.

Cardinal Laboratories is accredited through the State of Colorado Department of Public Health and Environment for:

Method EPA 552.2	Haloacetic Acids (HAA-5)
Method EPA 524.2	Total Trihalomethanes (TTHM)
Method EPA 524.4	Regulated VOCs (V1, V2, V3)

Accreditation applies to public drinking water matrices.

This report meets NELAP requirements and is made up of a cover page, analytical results, and a copy of the original chain-of-custody. If you have any questions concerning this report, please feel free to contact me.

Sincerely,

Celey D. Keene

Lab Director/Quality Manager



PHONE (575) 393-2326 • 101 E. MARLAND • HOBBS, NM 88240

Analytical Results For:

TALON LPE
SHELDON HITCHCOCK
408 W. TEXAS AVE.
ARTESIA NM, 88210
Fax To: (575) 745-8905

Received: 02/11/2014
Reported: 02/12/2014
Project Name: MERCURY
Project Number: 700348.137.02
Project Location: NONE GIVEN

Sampling Date: 02/10/2014
Sampling Type: Soil
Sampling Condition: Cool & Intact
Sample Received By: Jodi Henson

Sample ID: BG-1 0' (H400414-01)

Chloride, SM4500Cl-B

mg/kg

Analyzed By: AP

Analyte	Result	Reporting Limit	Analyzed	Method Blank	BS	% Recovery	True Value QC	RPD	Qualifier
Chloride	25600	16.0	02/12/2014	ND	416	104	400	3.92	

Sample ID: BG-1 6.5' (H400414-02)

Chloride, SM4500Cl-B

mg/kg

Analyzed By: AP

Analyte	Result	Reporting Limit	Analyzed	Method Blank	BS	% Recovery	True Value QC	RPD	Qualifier
Chloride	1250	16.0	02/12/2014	ND	416	104	400	3.92	

Sample ID: S-2 8.5' (H400414-03)

BTEX 8021B

mg/kg

Analyzed By: MS

Analyte	Result	Reporting Limit	Analyzed	Method Blank	BS	% Recovery	True Value QC	RPD	Qualifier
Benzene*	<0.050	0.050	02/11/2014	ND	2.34	117	2.00	4.12	
Toluene*	<0.050	0.050	02/11/2014	ND	2.32	116	2.00	3.68	
Ethylbenzene*	<0.050	0.050	02/11/2014	ND	2.30	115	2.00	4.18	
Total Xylenes*	<0.150	0.150	02/11/2014	ND	6.76	113	6.00	3.04	
Total BTEX	<0.300	0.300	02/11/2014	ND					

Surrogate: 4-Bromofluorobenzene (PFB) 120 % 89.4-126

Chloride, SM4500Cl-B

mg/kg

Analyzed By: AP

Analyte	Result	Reporting Limit	Analyzed	Method Blank	BS	% Recovery	True Value QC	RPD	Qualifier
Chloride	1470	16.0	02/12/2014	ND	416	104	400	3.92	

TPH 8015M

mg/kg

Analyzed By: ms

Analyte	Result	Reporting Limit	Analyzed	Method Blank	BS	% Recovery	True Value QC	RPD	Qualifier
---------	--------	-----------------	----------	--------------	----	------------	---------------	-----	-----------

Cardinal Laboratories

*=Accredited Analyte

PLEASE NOTE: Liability and Damages. Cardinal's liability and client's exclusive remedy for any claim arising, whether based in contract or tort, shall be limited to the amount paid by client for analyses. All claims, including those for negligence and any other cause whatsoever shall be deemed waived unless made in writing and received by Cardinal within thirty (30) days after completion of the applicable service. In no event shall Cardinal be liable for incidental or consequential damages, including, without limitation, business interruptions, loss of use, or loss of profits incurred by client, its subsidiaries, affiliates or successors arising out of or related to the performance of the services hereunder by Cardinal, regardless of whether such claim is based upon any of the above stated reasons or otherwise. Results relate only to the samples identified above. This report shall not be reproduced except in full with written approval of Cardinal Laboratories.

Coley D. Keene, Lab Director/Quality Manager



PHONE (575) 393-2326 • 101 E. MARLAND • HOBBS, NM 88240

Analytical Results For:

TALON LPE
 SHELDON HITCHCOCK
 408 W. TEXAS AVE.
 ARTESIA NM, 88210
 Fax To: (575) 745-8905

Received: 02/11/2014
 Reported: 02/12/2014
 Project Name: MERCURY
 Project Number: 700348.137.02
 Project Location: NONE GIVEN

Sampling Date: 02/10/2014
 Sampling Type: Soil
 Sampling Condition: Cool & Intact
 Sample Received By: Jodi Henson

Sample ID: S-2 8.5' (H400414-03)

TPH 8015M		mg/kg	Analyzed By: ms						
Analyte	Result	Reporting Limit	Analyzed	Method Blank	BS	% Recovery	True Value QC	RPD	Qualifier
GRO C6-C10	<10.0	10.0	02/11/2014	ND	194	96.9	200	0.635	
DRO >C10-C28	<10.0	10.0	02/11/2014	ND	188	94.2	200	1.47	
Surrogate: 1-Chlorooctane	77.4 %	65.2-140							
Surrogate: 1-Chlorooctadecane	80.2 %	63.6-154							

Sample ID: S-4 7' (H400414-04)

Chloride, SM4500Cl-B		mg/kg	Analyzed By: AP						
Analyte	Result	Reporting Limit	Analyzed	Method Blank	BS	% Recovery	True Value QC	RPD	Qualifier
Chloride	640	16.0	02/12/2014	ND	416	104	400	3.92	

Cardinal Laboratories

*=Accredited Analyte

PLEASE NOTE: Liability and Damages. Cardinal's liability and client's exclusive remedy for any claim arising, whether based in contract or tort, shall be limited to the amount paid by client for analyses. All claims, including those for negligence and any other cause whatsoever shall be deemed waived unless made in writing and received by Cardinal within thirty (30) days after completion of the applicable service. In no event shall Cardinal be liable for incidental or consequential damages, including, without limitation, business interruptions, loss of use, or loss of profits incurred by client, its subsidiaries, affiliates or successors arising out of or related to the performance of the services hereunder by Cardinal, regardless of whether such claim is based upon any of the above stated reasons or otherwise. Results relate only to the samples identified above. This report shall not be reproduced except in full with written approval of Cardinal Laboratories.

Caley D. Keene, Lab Director/Quality Manager



PHONE (575) 393-2326 • 101 E. MARLAND • HOBBS, NM 88240

Analytical Results For:

TALON LPE
SHELDON HITCHCOCK
408 W. TEXAS AVE.
ARTESIA NM, 88210
Fax To: (575) 745-8905

Received: 02/11/2014
Reported: 02/12/2014
Project Name: MERCURY
Project Number: 700348.137.02
Project Location: NONE GIVEN

Sampling Date: 02/11/2014
Sampling Type: Soil
Sampling Condition: Cool & Intact
Sample Received By: Jodi Henson

Sample ID: S-6 7' (H400414-05)

BTEX 8021B		mg/kg		Analyzed By: MS					
Analyte	Result	Reporting Limit	Analyzed	Method Blank	BS	% Recovery	True Value QC	RPD	Qualifier
Benzene*	<0.050	0.050	02/11/2014	ND	2.34	117	2.00	4.12	
Toluene*	<0.050	0.050	02/11/2014	ND	2.32	116	2.00	3.68	
Ethylbenzene*	<0.050	0.050	02/11/2014	ND	2.30	115	2.00	4.18	
Total Xylenes*	<0.150	0.150	02/11/2014	ND	6.76	113	6.00	3.04	
Total BTEX	<0.300	0.300	02/11/2014	ND					

Surrogate: 4-Bromofluorobenzene (PIL) 121 % 89.4-126
Chloride, SM4500Cl-B mg/kg

Chloride, SM4500Cl-B		Analyzed By: AP							
Analyte	Result	Reporting Limit	Analyzed	Method Blank	BS	% Recovery	True Value QC	RPD	Qualifier
Chloride	384	16.0	02/12/2014	ND	416	104	400	3.92	
TPH 8015M		Analyzed By: ms							
Analyte	Result	Reporting Limit	Analyzed	Method Blank	BS	% Recovery	True Value QC	RPD	Qualifier

Analyte	Result	Reporting Limit	Analyzed	Method Blank	BS	% Recovery	True Value QC	RPD	Qualifier
GRO C6-C10	<10.0	10.0	02/11/2014	ND	194	96.9	200	0.635	
DRO >C10-C28	<10.0	10.0	02/11/2014	ND	188	94.2	200	1.47	

Surrogate: 1-Chlorooctane 98.8 % 65.2-140

Surrogate: 1-Chlorooctadecane 101 % 63.6-154

Cardinal Laboratories

* = Accredited Analyte

PLEASE NOTE: Liability and Damages. Cardinal's liability and client's exclusive remedy for any claim arising, whether based in contract or tort, shall be limited to the amount paid by client for analysis. All claims, including those for negligence and any other cause whatsoever shall be deemed waived unless made in writing and received by Cardinal within thirty (30) days after completion of the applicable service. In no event shall Cardinal be liable for incidental or consequential damages, including, without limitation, business interruptions, loss of use, or loss of profits incurred by client, its subsidiaries, affiliates or successors arising out of or related to the performance of the services hereunder by Cardinal, regardless of whether such claim is based upon any of the above stated reasons or otherwise. Results relate only to the samples identified above. This report shall not be reproduced except in full with written approval of Cardinal Laboratories.

Celey D. Keene, Lab Director/Quality Manager



PHONE (575) 393-2326 • 101 E. MARLAND • HOBBS, NM 88240

Notes and Definitions

ND	Analyte NOT DETECTED at or above the reporting limit
RPD	Relative Percent Difference
**	Samples not received at proper temperature of 6°C or below.
***	Insufficient time to reach temperature.
✱	Chloride by SM4500Cl-B does not require samples be received at or below 6°C
	Samples reported on an as received basis (wet) unless otherwise noted on report

Cardinal Laboratories

*=Accredited Analyte

PLEASE NOTE: Liability and Damages. Cardinal's liability and client's exclusive remedy for any claim arising, whether based in contract or tort, shall be limited to the amount paid by client for analyses. All claims, including those for negligence and any other cause whatsoever shall be deemed waived unless made in writing and received by Cardinal within thirty (30) days after completion of the applicable service. In no event shall Cardinal be liable for incidental or consequential damages, including, without limitation, business interruptions, loss of use, or loss of profits incurred by client, its subsidiaries, affiliates or successors arising out of or related to the performance of the services hereunder by Cardinal, regardless of whether such claim is based upon any of the above stated reasons or otherwise. Results relate only to the samples identified above. This report shall not be reproduced except in full with written approval of Cardinal Laboratories.

Celey D. Keene, Lab Director/Quality Manager



CARDINAL Laboratoires

CHAIN-OF-CUSTODY AND ANALYSIS REQUEST

101 East Maryland, Hobbs, NM 88240

(575) 393-2326. FAX (575) 393-2476

[illegible]

District I
1625 N. French Dr., Hobbs, NM 88240
Phone:(575) 393-6161 Fax:(575) 393-0720
District II
811 S. First St., Artesia, NM 88210
Phone:(575) 748-1283 Fax:(575) 748-9720
District III
1000 Rio Brazos Rd., Aztec, NM 87410
Phone:(505) 334-6178 Fax:(505) 334-6170
District IV
1220 S. St Francis Dr., Santa Fe, NM 87505
Phone:(505) 476-3470 Fax:(505) 476-3462

State of New Mexico
Energy, Minerals and Natural Resources
Oil Conservation Division
1220 S. St Francis Dr.
Santa Fe, NM 87505

CONDITIONS

Action 206713

CONDITIONS

Operator: ENTERPRISE PRODUCTS OPERATING, LLC P.O. BOX 4324 HOUSTON, TX 77210	OGRID: 374092
	Action Number: 206713
	Action Type: [IM-SD] Incident File Support Doc (ENV) (IM-BNF)

CONDITIONS

Created By	Condition	Condition Date
amaxwell	None	4/17/2023