



303 Veterans Airpark Lane Midland, TX 79705

## **Closure Report**

July 11, 2023

Re: WBDU 68  
Case nAPP2235436061

On 12/19/2022 a release occurred due to a stuffing box failure. The release (GPS: 32.4789391, -103.1807785) is located north of Eunice, New Mexico in unit letter H section 17 township 21S range 37E. A groundwater survey was conducted utilizing NMOSE and NMOCD GIS maps. All data suggest that groundwater beneath the release to be 70 feet. OCD approved remediation plan on 5/1/2023.

The release area was excavated in accordance with the approved remediation plan. Final 5-point bottom and wall samples were collected not to exceed 200 square feet. All samples collected were submitted to a commercial laboratory for analysis of chloride, TPH, and BTEX. All laboratory results were below table one standards for releases 51-100 feet to groundwater. All excavated soil was hauled to an OCD approved disposal facility. The excavation was backfilled with clean imported caliche to restore the lease pad.

Apache Corporation has remediated the release to below table one standards for releases 51-100 feet to groundwater and respectfully request closure of event nAPP2235436061.

Enclosed: C-141, Maps, Sample Data, Laboratory Results, and Photos.

Submitted by.

*Larry Baker*

**Environmental Technician Sr. Staff**

[larry.baker@apachecorp.com](mailto:larry.baker@apachecorp.com)

**Office # 432-818-1654**

Incident ID	
District RP	
Facility ID	
Application ID	

## Closure

The responsible party must attach information demonstrating they have complied with all applicable closure requirements and any conditions or directives of the OCD. This demonstration should be in the form of a comprehensive report (electronic submittals in .pdf format are preferred) including a scaled site map, sampling diagrams, relevant field notes, photographs of any excavation prior to backfilling, laboratory data including chain of custody documents of final sampling, and a narrative of the remedial activities. Refer to 19.15.29.12 NMAC.

**Closure Report Attachment Checklist:** *Each of the following items must be included in the closure report.*

- ☒ A scaled site and sampling diagram as described in 19.15.29.11 NMAC
- ☒ Photographs of the remediated site prior to backfill or photos of the liner integrity if applicable (Note: appropriate OCD District office must be notified 2 days prior to liner inspection)
- ☒ Laboratory analyses of final sampling (Note: appropriate ODC District office must be notified 2 days prior to final sampling)
- ☒ Description of remediation activities

I hereby certify that the information given above is true and complete to the best of my knowledge and understand that pursuant to OCD rules and regulations all operators are required to report and/or file certain release notifications and perform corrective actions for releases which may endanger public health or the environment. The acceptance of a C-141 report by the OCD does not relieve the operator of liability should their operations have failed to adequately investigate and remediate contamination that pose a threat to groundwater, surface water, human health or the environment. In addition, OCD acceptance of a C-141 report does not relieve the operator of responsibility for compliance with any other federal, state, or local laws and/or regulations. The responsible party acknowledges they must substantially restore, reclaim, and re-vegetate the impacted surface area to the conditions that existed prior to the release or their final land use in accordance with 19.15.29.13 NMAC including notification to the OCD when reclamation and re-vegetation are complete.

Printed Name: Larry Baker

Title: Environmental Tech Sr. Staff

Signature: Larry Baker

Date: 7/11/2023

email: larry.baker@apachecorp.com

Telephone: 432-818-1654

**OCD Only**

Received by: \_\_\_\_\_

Date: \_\_\_\_\_

Closure approval by the OCD does not relieve the responsible party of liability should their operations have failed to adequately investigate and remediate contamination that poses a threat to groundwater, surface water, human health, or the environment nor does not relieve the responsible party of compliance with any other federal, state, or local laws and/or regulations.

Closure Approved by: Nelson Velez

Date: 10/03/2023

Printed Name: Nelson Velez

Title: Environmental Specialist - Adv

Remediation has met 19.15.29 NMAC requirements. Soil impacts exceeding the reclamation standards have been left in place and are required to meet 19.15.29.13D (1) NMAC once the site is no longer reasonably needed for production or subsequent drilling operations.

**From:** [Baker, Larry](#)  
**To:** [Nobui, Jennifer, EMNRD](#)  
**Subject:** FW: [EXTERNAL] The Oil Conservation Division (OCD) has approved the application, Application ID: 197469  
**Date:** Wednesday, June 7, 2023 8:15:00 AM

---

Ms. Nobui,

Apache Corporation will be conducting final composite samples for this event on Friday 6/9/2023 at 8:00 am MST. Please let me know if you have any questions or wish to discuss. Thanks and have a good day.

**BRUCE BAKER**

ENVIRONMENTAL TECHNICIAN SR STAFF

direct 432-818-1654 | Cell 432-250-8384

APACHE CORPORATION

303 Veterans Airpark Lane  
Midland, TX 79705

[ApacheCorp.com](#) | [LinkedIn](#) | [Facebook](#) | [Twitter](#) | [StockTwits](#) | [YouTube](#)

---

**From:** OCDOnline@state.nm.us <OCDOnline@state.nm.us>  
**Sent:** Monday, May 1, 2023 11:05 AM  
**To:** Baker, Larry <Larry.Baker@apachecorp.com>  
**Subject:** [EXTERNAL] The Oil Conservation Division (OCD) has approved the application, Application ID: 197469

To whom it may concern (c/o Larry Baker for APACHE CORPORATION),

The OCD has approved the submitted *Application for administrative approval of a release notification and corrective action* (C-141), for incident ID (n#) nAPP2235436061, with the following conditions:

- **Remediation Plan Approved with Conditions. Composite confirmation samples will be collected from the bottom and sidewalls of the excavation from areas representing no more than hundred (200) square feet. Going forward, lateral delineation samples will be collected as depth discrete samples and not 5-point composite samples.**

The signed C-141 can be found in the OCD Online: Imaging under the incident ID (n#).

If you have any questions regarding this application, please contact me.

Thank you,  
Jennifer Nobui  
Environmental Specialist-Advanced

505-470-3407

[Jennifer.Nobui@emnrd.nm.gov](mailto:Jennifer.Nobui@emnrd.nm.gov)

**New Mexico Energy, Minerals and Natural Resources Department**

1220 South St. Francis Drive

Santa Fe, NM 87505

**CAUTION:** This email originated outside of Apache. **DO NOT CLICK** on links or attachments unless you know the content is safe and relevant to Apache business. If you are unsure about this message, click "Report Phish" in Outlook or send to [phish@apachecorp.com](mailto:phish@apachecorp.com)



WBDU #68														
Wall Sample Results														
SAMPLE ID	LAB ID NUMBER	SAMPLE DEPTH	SAMPLE TYPE	SAMPLE DATE	BENZENE	TOLUENE (mg/kg)	ETHYL-BENZENE ( mg/kg)	TOTAL XYLENES (mg/kg)	TOTAL BTX (mg/kg)	GRO C6-C10 (mg/kg)	DRO C10-C28 (mg/kg)	EXT DRO C28-C36 (mg/kg)	TOTAL TPH C6-C36 (mg/kg)	CHLORIDE
W1	H232980-01	0-2'	COMP	6/9/23	<0.050	<0.050	<0.050	<0.150	<0.300	<0.10	<0.10	<0.10	<0.10	64
W2	H232980-02	0-6"	COMP	6/9/23	<0.050	<0.050	<0.050	<0.150	<0.300	<0.10	10.4	<0.10	10.4	96
W3	H232980-03	0-6"	COMP	6/9/23	<0.050	<0.050	<0.050	<0.150	<0.300	<0.10	<0.10	<0.10	<0.10	224
Floor Sample Results														
SAMPLE ID	LAB ID NUMBER	SAMPLE DEPTH	SAMPLE TYPE	SAMPLE DATE	BENZENE	TOLUENE (mg/kg)	ETHYL-BENZENE ( mg/kg)	TOTAL XYLENES (mg/kg)	TOTAL BTX (mg/kg)	GRO C6-C10 (mg/kg)	DRO C10-C28 (mg/kg)	EXT DRO C28-C36 (mg/kg)	TOTAL TPH C6-C36 (mg/kg)	CHLORIDE
B1	H232981-01	2'	COMP	6/9/23	<0.050	<0.050	<0.050	<0.150	<0.300	<0.10	<0.10	<0.10	<0.10	32
B2	H232981-02	6"	COMP	6/9/23	<0.050	<0.050	<0.050	<0.150	<0.300	<0.10	78.6	22.5	101.1	144
B3	H232981-03	6"	COMP	6/9/23	<0.050	<0.050	<0.050	<0.150	<0.300	<0.10	36.7	<0.10	36.7	128
B4	H232981-04	6"	COMP	6/9/23	<0.050	<0.050	<0.050	<0.150	<0.300	<0.10	121	48.1	169.1	368
B5	H232981-05	6"	COMP	6/9/23	<0.050	<0.050	<0.050	<0.150	<0.300	<0.10	67.1	52.1	119.2	336
B6	H232981-06	6"	COMP	6/9/23	<0.050	<0.050	<0.050	<0.150	<0.300	<0.10	<0.10	<0.10	<0.10	1010
B7	H232981-07	6"	COMP	6/9/23	<0.050	<0.050	<0.050	<0.150	<0.300	<0.10	34.2	10.7	44.9	432
B8	H232981-08	6"	COMP	6/9/23	<0.050	<0.050	<0.050	<0.150	<0.300	<0.10	47.1	<0.10	47.1	112
B9	H232981-09	6"	COMP	6/9/23	<0.050	<0.050	<0.050	<0.150	<0.300	<0.10	<0.10	<0.10	<0.10	224
B10	H232981-10	6"	COMP	6/9/23	<0.050	<0.050	<0.050	<0.150	<0.300	<0.10	<0.10	<0.10	<0.10	128
B11	H232981-11	6"	COMP	6/9/23	<0.050	<0.050	<0.050	<0.150	<0.300	<0.10	<0.10	<0.10	<0.10	384
B12	H232981-12	6"	COMP	6/9/23	<0.050	<0.050	<0.050	<0.150	<0.300	<0.10	<0.10	<0.10	<0.10	192
B13	H232981-13	6"	COMP	6/9/23	<0.050	<0.050	<0.050	<0.150	<0.300	<0.10	<0.10	<0.10	<0.10	96
B14	H232981-14	6"	COMP	6/9/23	<0.050	<0.050	<0.050	<0.150	<0.300	<0.10	<0.10	<0.10	<0.10	224
B15	H232981-15	6"	COMP	6/9/23	<0.050	<0.050	<0.050	<0.150	<0.300	<0.10	<0.10	<0.10	<0.10	544
B16	H232981-16	6"	COMP	6/9/23	<0.050	<0.050	<0.050	<0.150	<0.300	<0.10	<0.10	<0.10	<0.10	480
B17	H232981-17	6"	COMP	6/9/23	<0.050	<0.050	<0.050	<0.150	<0.300	<0.10	14.4	28.9	43.3	48
B18	H232981-18	6"	COMP	6/9/23	<0.050	<0.050	<0.050	<0.150	<0.300	<0.10	<0.10	<0.10	<0.10	352
B19	H232981-19	6"	COMP	6/9/23	<0.050	<0.050	<0.050	<0.150	<0.300	<0.10	<0.10	<0.10	<0.10	512
B20	H232981-20	6"	COMP	6/9/23	<0.050	<0.050	<0.050	<0.150	<0.300	<0.10	<0.10	<0.10	<0.10	160
B21	H232981-21	6"	COMP	6/9/23	<0.050	<0.050	<0.050	<0.150	<0.300	<0.10	<0.10	<0.10	<0.10	16
B22	H232981-22	6"	COMP	6/9/23	<0.050	<0.050	<0.050	<0.150	<0.300	<0.10	<0.10	<0.10	<0.10	32
B23	H232981-23	6"	COMP	6/9/23	<0.050	<0.050	<0.050	<0.150	<0.300	<0.10	<0.10	<0.10	<0.10	640
B24	H232981-24	6"	COMP	6/9/23	<0.050	<0.050	<0.050	<0.150	<0.300	<0.10	<0.10	<0.10	<0.10	288

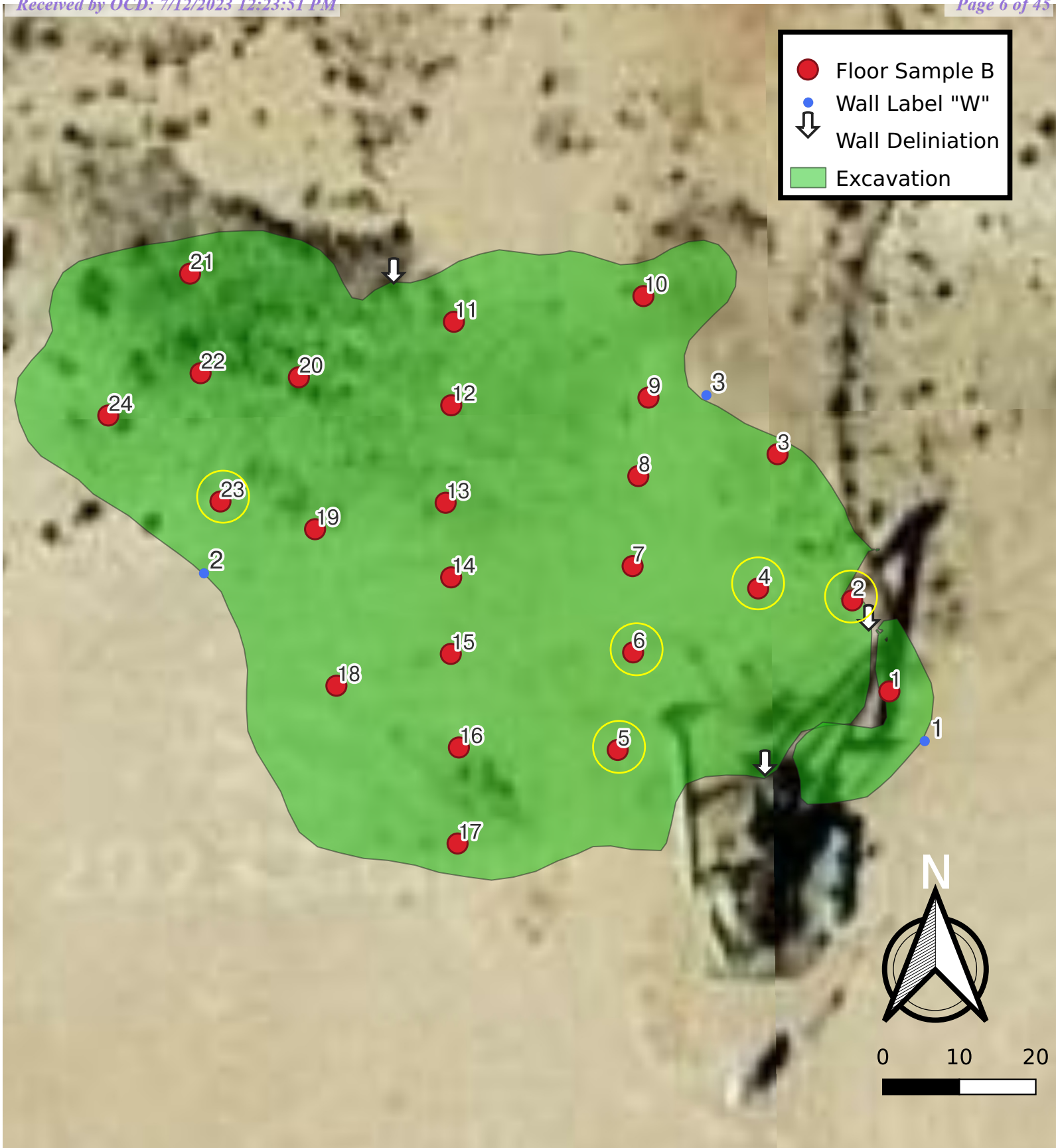

WBDU #68

Sample Map



WBDU #68 Excavation Photos





WBDU #68 Excavation Photos

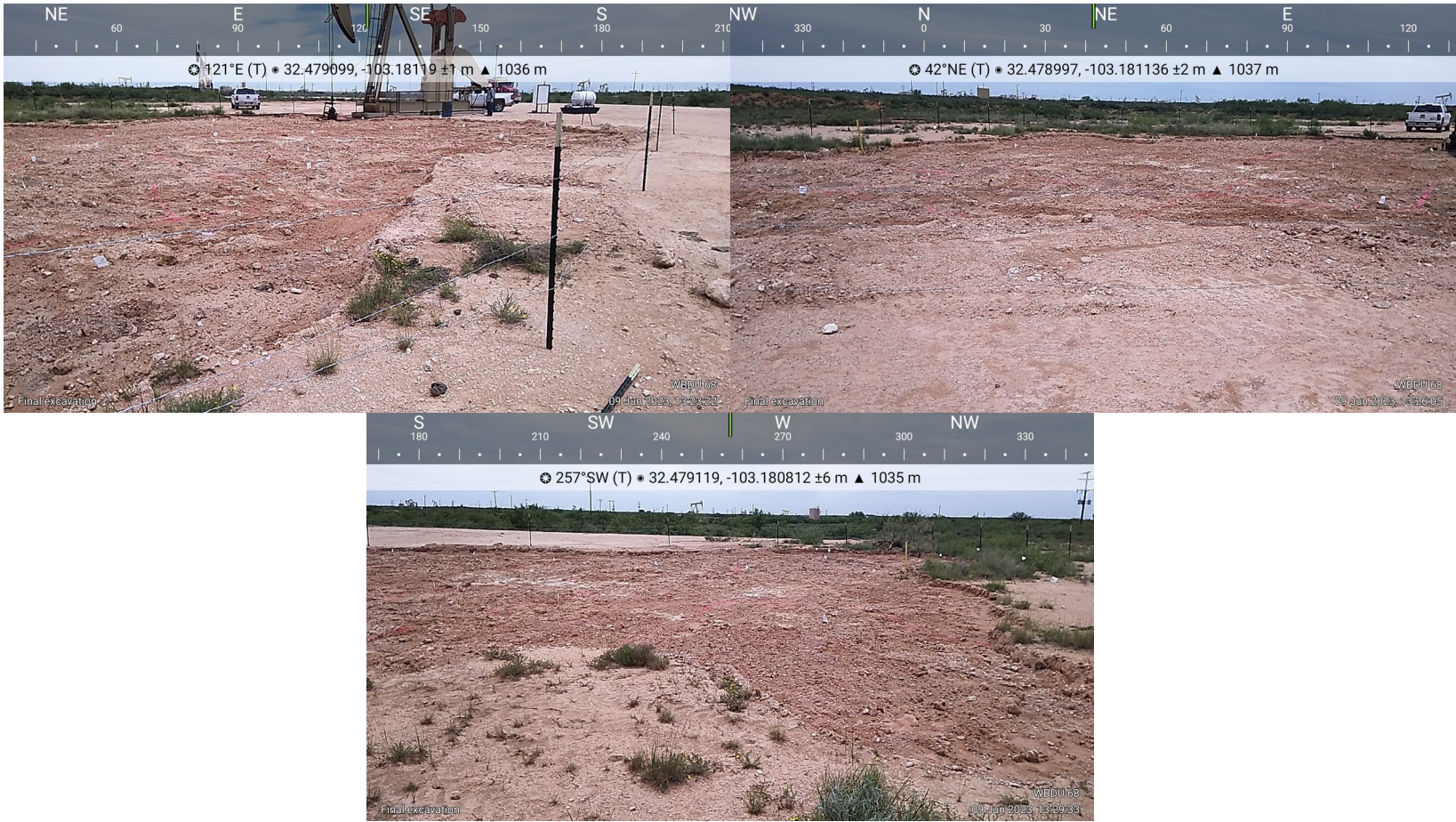



# WBDU #68 Backfill Completed





PHONE (575) 393-2326 ° 101 E. MARLAND ° HOBBS, NM 88240

---

June 14, 2023

BRUCE BAKER

APACHE CORP - HOBBS

2350 W. MARLAND BLVD.

HOBBS, NM 88240

RE: WBDU #68

Enclosed are the results of analyses for samples received by the laboratory on 06/09/23 14:15.

Cardinal Laboratories is accredited through Texas NELAP under certificate number T104704398-22-15. Accreditation applies to drinking water, non-potable water and solid and chemical materials. All accredited analytes are denoted by an asterisk (\*). For a complete list of accredited analytes and matrices visit the TCEQ website at [www.tceq.texas.gov/field/qa/lab\\_accred\\_certif.html](http://www.tceq.texas.gov/field/qa/lab_accred_certif.html).

Cardinal Laboratories is accredited through the State of Colorado Department of Public Health and Environment for:

Method EPA 552.2	Haloacetic Acids (HAA-5)
Method EPA 524.2	Total Trihalomethanes (TTHM)
Method EPA 524.4	Regulated VOCs (V1, V2, V3)

Accreditation applies to public drinking water matrices.

This report meets NELAP requirements and is made up of a cover page, analytical results, and a copy of the original chain-of-custody. If you have any questions concerning this report, please feel free to contact me.

Sincerely,

A handwritten signature in black ink that reads "Celey D. Keene".

Celey D. Keene

Lab Director/Quality Manager



PHONE (575) 393-2326 ° 101 E. MARLAND ° HOBBS, NM 88240

**Analytical Results For:**

APACHE CORP - HOBBS  
 BRUCE BAKER  
 2350 W. MARLAND BLVD.  
 HOBBS NM, 88240  
 Fax To: (575) 393-2432

Received: 06/09/2023  
 Reported: 06/14/2023  
 Project Name: WBDU #68  
 Project Number: NONE GIVEN  
 Project Location: NOT GIVEN

Sampling Date: 06/09/2023  
 Sampling Type: Soil  
 Sampling Condition: Cool & Intact  
 Sample Received By: Shalyn Rodriguez

**Sample ID: W1 BGS 0-2' (H232980-01)**

BTX 8021B		mg/kg		Analyzed By: JH/					
Analyte	Result	Reporting Limit	Analyzed	Method Blank	BS	% Recovery	True Value QC	RPD	Qualifier
Benzene*	<0.050	0.050	06/12/2023	ND	2.16	108	2.00	3.85	
Toluene*	<0.050	0.050	06/12/2023	ND	2.28	114	2.00	6.56	
Ethylbenzene*	<0.050	0.050	06/12/2023	ND	2.24	112	2.00	7.03	
Total Xylenes*	<0.150	0.150	06/12/2023	ND	6.88	115	6.00	5.42	
Total BTX	<0.300	0.300	06/12/2023	ND					

Surrogate: 4-Bromofluorobenzene (PID) 106 % 71.5-134

Chloride, SM4500Cl-B		mg/kg		Analyzed By: AC						
Analyte	Result	Reporting Limit	Analyzed	Method Blank	BS	% Recovery	True Value QC	RPD	Qualifier	
Chloride	64.0	16.0	06/12/2023	ND	432	108	400	0.00		

TPH 8015M		mg/kg		Analyzed By: MS					
Analyte	Result	Reporting Limit	Analyzed	Method Blank	BS	% Recovery	True Value QC	RPD	Qualifier
GRO C6-C10*	<10.0	10.0	06/12/2023	ND	186	92.9	200	16.7	
DRO >C10-C28*	<10.0	10.0	06/12/2023	ND	195	97.7	200	16.0	
EXT DRO >C28-C36	<10.0	10.0	06/12/2023	ND					

Surrogate: 1-Chlorooctane 81.8 % 48.2-134

Surrogate: 1-Chlorooctadecane 83.5 % 49.1-148

Cardinal Laboratories

\*=Accredited Analyte

PLEASE NOTE: Liability and Damages. Cardinal's liability and client's exclusive remedy for any claim arising, whether based in contract or tort, shall be limited to the amount paid by client for analyses. All claims, including those for negligence and any other cause whatsoever shall be deemed waived unless made in writing and received by Cardinal within thirty (30) days after completion of the applicable service. In no event shall Cardinal be liable for incidental or consequential damages, including, without limitation, business interruptions, loss of use, or loss of profits incurred by client, its subsidiaries, affiliates or successors arising out of or related to the performance of the services hereunder by Cardinal, regardless of whether such claim is based upon any of the above stated reasons or otherwise. Results relate only to the samples identified above. This report shall not be reproduced except in full with written approval of Cardinal Laboratories.

Celey D. Keene, Lab Director/Quality Manager



PHONE (575) 393-2326 ° 101 E. MARLAND ° HOBBS, NM 88240

**Analytical Results For:**

APACHE CORP - HOBBS  
 BRUCE BAKER  
 2350 W. MARLAND BLVD.  
 HOBBS NM, 88240  
 Fax To: (575) 393-2432

Received: 06/09/2023  
 Reported: 06/14/2023  
 Project Name: WBDU #68  
 Project Number: NONE GIVEN  
 Project Location: NOT GIVEN

Sampling Date: 06/09/2023  
 Sampling Type: Soil  
 Sampling Condition: Cool & Intact  
 Sample Received By: Shalyn Rodriguez

**Sample ID: W2 BGS 0-6" (H232980-02)**

BTEx 8021B		mg/kg		Analyzed By: JH/						
Analyte	Result	Reporting Limit	Analyzed	Method Blank	BS	% Recovery	True Value QC	RPD	Qualifier	
Benzene*	<0.050	0.050	06/12/2023	ND	2.16	108	2.00	3.85		
Toluene*	<0.050	0.050	06/12/2023	ND	2.28	114	2.00	6.56		
Ethylbenzene*	<0.050	0.050	06/12/2023	ND	2.24	112	2.00	7.03		
Total Xylenes*	<0.150	0.150	06/12/2023	ND	6.88	115	6.00	5.42		
Total BTEx	<0.300	0.300	06/12/2023	ND						

Surrogate: 4-Bromofluorobenzene (PID) 105 % 71.5-134

Chloride, SM4500CI-B		mg/kg		Analyzed By: AC						
Analyte	Result	Reporting Limit	Analyzed	Method Blank	BS	% Recovery	True Value QC	RPD	Qualifier	
Chloride	96.0	16.0	06/12/2023	ND	432	108	400	0.00		

TPH 8015M		mg/kg		Analyzed By: MS					
Analyte	Result	Reporting Limit	Analyzed	Method Blank	BS	% Recovery	True Value QC	RPD	Qualifier
GRO C6-C10*	<10.0	10.0	06/12/2023	ND	186	92.9	200	16.7	
DRO >C10-C28*	10.4	10.0	06/12/2023	ND	195	97.7	200	16.0	
EXT DRO >C28-C36	<10.0	10.0	06/12/2023	ND					

Surrogate: 1-Chlorooctane 78.8 % 48.2-134

Surrogate: 1-Chlorooctadecane 80.8 % 49.1-148

Cardinal Laboratories

\*=Accredited Analyte

PLEASE NOTE: Liability and Damages. Cardinal's liability and client's exclusive remedy for any claim arising, whether based in contract or tort, shall be limited to the amount paid by client for analyses. All claims, including those for negligence and any other cause whatsoever shall be deemed waived unless made in writing and received by Cardinal within thirty (30) days after completion of the applicable service. In no event shall Cardinal be liable for incidental or consequential damages, including, without limitation, business interruptions, loss of use, or loss of profits incurred by client, its subsidiaries, affiliates or successors arising out of or related to the performance of the services hereunder by Cardinal, regardless of whether such claim is based upon any of the above stated reasons or otherwise. Results relate only to the samples identified above. This report shall not be reproduced except in full with written approval of Cardinal Laboratories.

Celey D. Keene, Lab Director/Quality Manager





PHONE (575) 393-2326 ° 101 E. MARLAND ° HOBBS, NM 88240

**Analytical Results For:**

APACHE CORP - HOBBS  
 BRUCE BAKER  
 2350 W. MARLAND BLVD.  
 HOBBS NM, 88240  
 Fax To: (575) 393-2432

Received: 06/09/2023  
 Reported: 06/14/2023  
 Project Name: WBDU #68  
 Project Number: NONE GIVEN  
 Project Location: NOT GIVEN

Sampling Date: 06/09/2023  
 Sampling Type: Soil  
 Sampling Condition: Cool & Intact  
 Sample Received By: Shalyn Rodriguez

**Sample ID: W3 BGS 0-6" (H232980-03)**

BTX 8021B			mg/kg		Analyzed By: MS				
Analyte	Result	Reporting Limit	Analyzed	Method Blank	BS	% Recovery	True Value QC	RPD	Qualifier
Benzene*	<0.050	0.050	06/12/2023	ND	2.36	118	2.00	7.98	QR-03
Toluene*	<0.050	0.050	06/12/2023	ND	2.35	117	2.00	8.07	QR-03
Ethylbenzene*	<0.050	0.050	06/12/2023	ND	2.30	115	2.00	9.07	QR-03
Total Xylenes*	<0.150	0.150	06/12/2023	ND	6.99	116	6.00	8.82	QR-03
Total BTX	<0.300	0.300	06/12/2023	ND					

Surrogate: 4-Bromofluorobenzene (PID) 101 % 71.5-134

Chloride, SM4500CI-B			mg/kg		Analyzed By: AC				
Analyte	Result	Reporting Limit	Analyzed	Method Blank	BS	% Recovery	True Value QC	RPD	Qualifier
Chloride	224	16.0	06/12/2023	ND	432	108	400	0.00	

TPH 8015M			mg/kg		Analyzed By: MS				
Analyte	Result	Reporting Limit	Analyzed	Method Blank	BS	% Recovery	True Value QC	RPD	Qualifier
GRO C6-C10*	<10.0	10.0	06/12/2023	ND	186	92.9	200	16.7	
DRO >C10-C28*	<10.0	10.0	06/12/2023	ND	195	97.7	200	16.0	
EXT DRO >C28-C36	<10.0	10.0	06/12/2023	ND					

Surrogate: 1-Chlorooctane 81.7 % 48.2-134

Surrogate: 1-Chlorooctadecane 84.0 % 49.1-148

Cardinal Laboratories

\*=Accredited Analyte

PLEASE NOTE: Liability and Damages. Cardinal's liability and client's exclusive remedy for any claim arising, whether based in contract or tort, shall be limited to the amount paid by client for analyses. All claims, including those for negligence and any other cause whatsoever shall be deemed waived unless made in writing and received by Cardinal within thirty (30) days after completion of the applicable service. In no event shall Cardinal be liable for incidental or consequential damages, including, without limitation, business interruptions, loss of use, or loss of profits incurred by client, its subsidiaries, affiliates or successors arising out of or related to the performance of the services hereunder by Cardinal, regardless of whether such claim is based upon any of the above stated reasons or otherwise. Results relate only to the samples identified above. This report shall not be reproduced except in full with written approval of Cardinal Laboratories.

Celey D. Keene, Lab Director/Quality Manager



PHONE (575) 393-2326 ° 101 E. MARLAND ° HOBBS, NM 88240

### Notes and Definitions

QR-03	The RPD value for the sample duplicate or MS/MSD was outside of QC acceptance limits due to matrix interference. QC batch accepted based on LCS and/or LCSD recovery and/or RPD values.
ND	Analyte NOT DETECTED at or above the reporting limit
RPD	Relative Percent Difference
**	Samples not received at proper temperature of 6°C or below.
***	Insufficient time to reach temperature.
-	Chloride by SM4500Cl-B does not require samples be received at or below 6°C Samples reported on an as received basis (wet) unless otherwise noted on report

Cardinal Laboratories

\*=Accredited Analyte

PLEASE NOTE: Liability and Damages. Cardinal's liability and client's exclusive remedy for any claim arising, whether based in contract or tort, shall be limited to the amount paid by client for analyses. All claims, including those for negligence and any other cause whatsoever shall be deemed waived unless made in writing and received by Cardinal within thirty (30) days after completion of the applicable service. In no event shall Cardinal be liable for incidental or consequential damages, including, without limitation, business interruptions, loss of use, or loss of profits incurred by client, its subsidiaries, affiliates or successors arising out of or related to the performance of the services hereunder by Cardinal, regardless of whether such claim is based upon any of the above stated reasons or otherwise. Results relate only to the samples identified above. This report shall not be reproduced except in full with written approval of Cardinal Laboratories.

A handwritten signature in black ink, appearing to read "C. D. Keene".

Celey D. Keene, Lab Director/Quality Manager



101 East Marland, Hobbs, NM 88240  
(575) 393-2326 FAX (575) 393-2476

# CHAIN-OF-CUSTODY AND ANALYSIS REQUEST

Company Name: <u>Apache</u>				<b>BILL TO</b>				<b>ANALYSIS REQUEST</b>											
Project Manager: <u>B. Baker</u>				P.O. #:															
Address:				Company:															
City: <u>Hobbs</u> State: <u>NM</u> Zip: <u>88240</u>				Attn:															
Phone #: Fax #:				Address:															
Project #: Project Owner:				City:															
Project Name:				State: Zip:															
Project Location: <u>WBDU #68</u>				Phone #:															
Sampler Name: <u>Jose Quiles</u>				Fax #:															
FOR LAB USE ONLY																			
Lab I.D.		Sample I.D.		(G)RAB OR (C)OMP.		# CONTAINERS		MATRIX				PRESERV		SAMPLING		<u>CI</u> <u>BTEX</u> <u>EXT PH</u>			
				GROUNDWATER		WASTEWATER		SOIL		OIL		SLUDGE		OTHER:				ACID/BASE:	
																		ICE / COOL	
																		OTHER:	
																		DATE	
																		TIME	
<u>H232980</u>																			
<u>1 W1 BGS0-2'</u>				<u>C</u>		<u>1</u>													
<u>2 W2 BGS0-6"</u>				<u>C</u>		<u>1</u>													
<u>3 W3 BGS0-6"</u>				<u>C</u>		<u>1</u>													

PLEASE NOTE: Liability and Damages. Cardinal's liability and client's exclusive remedy for any claim arising whether based in contract or tort, shall be limited to the amount paid by the client for the analyses. All claims including those for negligence and any other cause whatsoever shall be deemed waived unless made in writing and received by Cardinal within 30 days after completion of the applicable service. In no event shall Cardinal be liable for incidental or consequential damages, including without limitation, business interruptions, loss of use, or loss of profits incurred by client, its subsidiaries, affiliates or successors arising out of or related to the performance of services hereunder by Cardinal, regardless of whether such claim is based upon any of the above stated reasons or otherwise.

Relinquished By: <u>Jose Quiles</u>		Date: <u>4/8/23</u>		Received By: <u>Skodriemel</u>		Verbal Result: <input type="checkbox"/> Yes <input type="checkbox"/> No Add'l Phone #:	
Time: <u>2:15</u>						All Results are emailed. Please provide Email address:	
Relinquished By:		Date:		Received By:		REMARKS:	
						<u>E-Mail Results</u>	
Delivered By: (Circle One)		Observed Temp. °C: <u>39.2</u>		Sample Condition		Turnaround Time: <u>Standard</u> <input checked="" type="checkbox"/> <u>Rush</u> <input type="checkbox"/>	
Sampler - UPS - Bus - Other:		Corrected Temp. °C: <u>33.2</u>		Cool <input checked="" type="checkbox"/> Intact <input type="checkbox"/> Yes <input type="checkbox"/> No <input type="checkbox"/>		Bacteria (only) Sample Condition	
				Checked By: (Initials) <u>SR</u>		Cool <input type="checkbox"/> Intact <input type="checkbox"/> Yes <input type="checkbox"/> No <input type="checkbox"/>	
						Thermometer ID #113 Correction Factor -0.6 °C	
						Observed Temp. °C Corrected Temp. °C	

FORM-006 R 3.3 07/16/22

† Cardinal cannot accept verbal changes. Please email changes to celey.keene@cardinallabsnm.com



PHONE (575) 393-2326 ° 101 E. MARLAND ° HOBBS, NM 88240

---

June 14, 2023

BRUCE BAKER

APACHE CORP - HOBBS

2350 W. MARLAND BLVD.

HOBBS, NM 88240

RE: WBDU #68

Enclosed are the results of analyses for samples received by the laboratory on 06/09/23 14:15.

Cardinal Laboratories is accredited through Texas NELAP under certificate number T104704398-22-15. Accreditation applies to drinking water, non-potable water and solid and chemical materials. All accredited analytes are denoted by an asterisk (\*). For a complete list of accredited analytes and matrices visit the TCEQ website at [www.tceq.texas.gov/field/qa/lab\\_accred\\_certif.html](http://www.tceq.texas.gov/field/qa/lab_accred_certif.html).

Cardinal Laboratories is accredited through the State of Colorado Department of Public Health and Environment for:

Method EPA 552.2	Haloacetic Acids (HAA-5)
Method EPA 524.2	Total Trihalomethanes (TTHM)
Method EPA 524.4	Regulated VOCs (V1, V2, V3)

Accreditation applies to public drinking water matrices.

This report meets NELAP requirements and is made up of a cover page, analytical results, and a copy of the original chain-of-custody. If you have any questions concerning this report, please feel free to contact me.

Sincerely,

A handwritten signature in black ink that reads "Celey D. Keene". The signature is written in a cursive style with a large, stylized 'C' and 'K'.

Celey D. Keene

Lab Director/Quality Manager



PHONE (575) 393-2326 ° 101 E. MARLAND ° HOBBS, NM 88240

**Analytical Results For:**

APACHE CORP - HOBBS  
 BRUCE BAKER  
 2350 W. MARLAND BLVD.  
 HOBBS NM, 88240  
 Fax To: (575) 393-2432

Received: 06/09/2023  
 Reported: 06/14/2023  
 Project Name: WBDU #68  
 Project Number: NONE GIVEN  
 Project Location: NOT GIVEN

Sampling Date: 06/09/2023  
 Sampling Type: Soil  
 Sampling Condition: Cool & Intact  
 Sample Received By: Shalyn Rodriguez

**Sample ID: B 1 @ 2' (H232981-01)**

BTX 8021B		mg/kg		Analyzed By: MS					
Analyte	Result	Reporting Limit	Analyzed	Method Blank	BS	% Recovery	True Value QC	RPD	Qualifier
Benzene*	<0.050	0.050	06/12/2023	ND	2.36	118	2.00	7.98	
Toluene*	<0.050	0.050	06/12/2023	ND	2.35	117	2.00	8.07	
Ethylbenzene*	<0.050	0.050	06/12/2023	ND	2.30	115	2.00	9.07	
Total Xylenes*	<0.150	0.150	06/12/2023	ND	6.99	116	6.00	8.82	
Total BTX	<0.300	0.300	06/12/2023	ND					

Surrogate: 4-Bromofluorobenzene (PID) 104 % 71.5-134

Chloride, SM4500Cl-B		mg/kg		Analyzed By: AC						
Analyte	Result	Reporting Limit	Analyzed	Method Blank	BS	% Recovery	True Value QC	RPD	Qualifier	
Chloride	32.0	16.0	06/12/2023	ND	432	108	400	0.00		

TPH 8015M		mg/kg		Analyzed By: MS					
Analyte	Result	Reporting Limit	Analyzed	Method Blank	BS	% Recovery	True Value QC	RPD	Qualifier
GRO C6-C10*	<10.0	10.0	06/12/2023	ND	186	92.9	200	16.7	
DRO >C10-C28*	<10.0	10.0	06/12/2023	ND	195	97.7	200	16.0	
EXT DRO >C28-C36	<10.0	10.0	06/12/2023	ND					

Surrogate: 1-Chlorooctane 88.3 % 48.2-134

Surrogate: 1-Chlorooctadecane 90.8 % 49.1-148

Cardinal Laboratories

\*=Accredited Analyte

PLEASE NOTE: Liability and Damages. Cardinal's liability and client's exclusive remedy for any claim arising, whether based in contract or tort, shall be limited to the amount paid by client for analyses. All claims, including those for negligence and any other cause whatsoever shall be deemed waived unless made in writing and received by Cardinal within thirty (30) days after completion of the applicable service. In no event shall Cardinal be liable for incidental or consequential damages, including, without limitation, business interruptions, loss of use, or loss of profits incurred by client, its subsidiaries, affiliates or successors arising out of or related to the performance of the services hereunder by Cardinal, regardless of whether such claim is based upon any of the above stated reasons or otherwise. Results relate only to the samples identified above. This report shall not be reproduced except in full with written approval of Cardinal Laboratories.

Celey D. Keene, Lab Director/Quality Manager



PHONE (575) 393-2326 ° 101 E. MARLAND ° HOBBS, NM 88240

**Analytical Results For:**

APACHE CORP - HOBBS  
 BRUCE BAKER  
 2350 W. MARLAND BLVD.  
 HOBBS NM, 88240  
 Fax To: (575) 393-2432

Received: 06/09/2023  
 Reported: 06/14/2023  
 Project Name: WBDU #68  
 Project Number: NONE GIVEN  
 Project Location: NOT GIVEN

Sampling Date: 06/09/2023  
 Sampling Type: Soil  
 Sampling Condition: Cool & Intact  
 Sample Received By: Shalyn Rodriguez

**Sample ID: B 2 @ 6" (H232981-02)**

BTEx 8021B		mg/kg		Analyzed By: MS					
Analyte	Result	Reporting Limit	Analyzed	Method Blank	BS	% Recovery	True Value QC	RPD	Qualifier
Benzene*	<0.050	0.050	06/12/2023	ND	2.36	118	2.00	7.98	
Toluene*	<0.050	0.050	06/12/2023	ND	2.35	117	2.00	8.07	
Ethylbenzene*	<0.050	0.050	06/12/2023	ND	2.30	115	2.00	9.07	
Total Xylenes*	<0.150	0.150	06/12/2023	ND	6.99	116	6.00	8.82	
Total BTEx	<0.300	0.300	06/12/2023	ND					

Surrogate: 4-Bromofluorobenzene (PID) 104 % 71.5-134

Chloride, SM4500Cl-B		mg/kg		Analyzed By: AC					
Analyte	Result	Reporting Limit	Analyzed	Method Blank	BS	% Recovery	True Value QC	RPD	Qualifier
Chloride	144	16.0	06/12/2023	ND	432	108	400	0.00	

TPH 8015M		mg/kg		Analyzed By: MS					
Analyte	Result	Reporting Limit	Analyzed	Method Blank	BS	% Recovery	True Value QC	RPD	Qualifier
GRO C6-C10*	<10.0	10.0	06/12/2023	ND	186	92.9	200	16.7	
DRO >C10-C28*	78.6	10.0	06/12/2023	ND	195	97.7	200	16.0	
EXT DRO >C28-C36	22.5	10.0	06/12/2023	ND					

Surrogate: 1-Chlorooctane 103 % 48.2-134

Surrogate: 1-Chlorooctadecane 111 % 49.1-148

Cardinal Laboratories

\*=Accredited Analyte

PLEASE NOTE: Liability and Damages. Cardinal's liability and client's exclusive remedy for any claim arising, whether based in contract or tort, shall be limited to the amount paid by client for analyses. All claims, including those for negligence and any other cause whatsoever shall be deemed waived unless made in writing and received by Cardinal within thirty (30) days after completion of the applicable service. In no event shall Cardinal be liable for incidental or consequential damages, including, without limitation, business interruptions, loss of use, or loss of profits incurred by client, its subsidiaries, affiliates or successors arising out of or related to the performance of the services hereunder by Cardinal, regardless of whether such claim is based upon any of the above stated reasons or otherwise. Results relate only to the samples identified above. This report shall not be reproduced except in full with written approval of Cardinal Laboratories.

Celey D. Keene, Lab Director/Quality Manager



PHONE (575) 393-2326 ° 101 E. MARLAND ° HOBBS, NM 88240

**Analytical Results For:**

APACHE CORP - HOBBS  
 BRUCE BAKER  
 2350 W. MARLAND BLVD.  
 HOBBS NM, 88240  
 Fax To: (575) 393-2432

Received: 06/09/2023  
 Reported: 06/14/2023  
 Project Name: WBDU #68  
 Project Number: NONE GIVEN  
 Project Location: NOT GIVEN

Sampling Date: 06/09/2023  
 Sampling Type: Soil  
 Sampling Condition: Cool & Intact  
 Sample Received By: Shalyn Rodriguez

**Sample ID: B 3 @ 6" (H232981-03)**

BTX 8021B			mg/kg		Analyzed By: MS				
Analyte	Result	Reporting Limit	Analyzed	Method Blank	BS	% Recovery	True Value QC	RPD	Qualifier
Benzene*	<0.050	0.050	06/12/2023	ND	2.36	118	2.00	7.98	QR-03
Toluene*	<0.050	0.050	06/12/2023	ND	2.35	117	2.00	8.07	QR-03
Ethylbenzene*	<0.050	0.050	06/12/2023	ND	2.30	115	2.00	9.07	QR-03
Total Xylenes*	<0.150	0.150	06/12/2023	ND	6.99	116	6.00	8.82	QR-03
Total BTX	<0.300	0.300	06/12/2023	ND					

Surrogate: 4-Bromofluorobenzene (PID) 105 % 71.5-134

Chloride, SM4500CI-B			mg/kg		Analyzed By: AC				
Analyte	Result	Reporting Limit	Analyzed	Method Blank	BS	% Recovery	True Value QC	RPD	Qualifier
Chloride	128	16.0	06/12/2023	ND	432	108	400	0.00	

TPH 8015M			mg/kg		Analyzed By: MS				
Analyte	Result	Reporting Limit	Analyzed	Method Blank	BS	% Recovery	True Value QC	RPD	Qualifier
GRO C6-C10*	<10.0	10.0	06/12/2023	ND	186	92.9	200	16.7	
DRO >C10-C28*	36.7	10.0	06/12/2023	ND	195	97.7	200	16.0	
EXT DRO >C28-C36	<10.0	10.0	06/12/2023	ND					

Surrogate: 1-Chlorooctane 71.1 % 48.2-134

Surrogate: 1-Chlorooctadecane 74.7 % 49.1-148

Cardinal Laboratories

\*=Accredited Analyte

PLEASE NOTE: Liability and Damages. Cardinal's liability and client's exclusive remedy for any claim arising, whether based in contract or tort, shall be limited to the amount paid by client for analyses. All claims, including those for negligence and any other cause whatsoever shall be deemed waived unless made in writing and received by Cardinal within thirty (30) days after completion of the applicable service. In no event shall Cardinal be liable for incidental or consequential damages, including, without limitation, business interruptions, loss of use, or loss of profits incurred by client, its subsidiaries, affiliates or successors arising out of or related to the performance of the services hereunder by Cardinal, regardless of whether such claim is based upon any of the above stated reasons or otherwise. Results relate only to the samples identified above. This report shall not be reproduced except in full with written approval of Cardinal Laboratories.

Celey D. Keene, Lab Director/Quality Manager





PHONE (575) 393-2326 ° 101 E. MARLAND ° HOBBS, NM 88240

**Analytical Results For:**

APACHE CORP - HOBBS  
 BRUCE BAKER  
 2350 W. MARLAND BLVD.  
 HOBBS NM, 88240  
 Fax To: (575) 393-2432

Received: 06/09/2023  
 Reported: 06/14/2023  
 Project Name: WBDU #68  
 Project Number: NONE GIVEN  
 Project Location: NOT GIVEN

Sampling Date: 06/09/2023  
 Sampling Type: Soil  
 Sampling Condition: Cool & Intact  
 Sample Received By: Shalyn Rodriguez

**Sample ID: B 4 @ 6" (H232981-04)**

BTEx 8021B		mg/kg		Analyzed By: MS					
Analyte	Result	Reporting Limit	Analyzed	Method Blank	BS	% Recovery	True Value QC	RPD	Qualifier
Benzene*	<0.050	0.050	06/12/2023	ND	2.36	118	2.00	7.98	
Toluene*	<0.050	0.050	06/12/2023	ND	2.35	117	2.00	8.07	
Ethylbenzene*	<0.050	0.050	06/12/2023	ND	2.30	115	2.00	9.07	
Total Xylenes*	<0.150	0.150	06/12/2023	ND	6.99	116	6.00	8.82	
Total BTEX	<0.300	0.300	06/12/2023	ND					

Surrogate: 4-Bromofluorobenzene (PID) 103 % 71.5-134

Chloride, SM4500Cl-B		mg/kg		Analyzed By: AC						
Analyte	Result	Reporting Limit	Analyzed	Method Blank	BS	% Recovery	True Value QC	RPD	Qualifier	
Chloride	368	16.0	06/12/2023	ND	432	108	400	3.64		

TPH 8015M		mg/kg		Analyzed By: MS					
Analyte	Result	Reporting Limit	Analyzed	Method Blank	BS	% Recovery	True Value QC	RPD	Qualifier
GRO C6-C10*	<10.0	10.0	06/12/2023	ND	186	92.9	200	16.7	
DRO >C10-C28*	121	10.0	06/12/2023	ND	195	97.7	200	16.0	
EXT DRO >C28-C36	48.1	10.0	06/12/2023	ND					

Surrogate: 1-Chlorooctane 81.5 % 48.2-134

Surrogate: 1-Chlorooctadecane 90.5 % 49.1-148

Cardinal Laboratories

\*=Accredited Analyte

PLEASE NOTE: Liability and Damages. Cardinal's liability and client's exclusive remedy for any claim arising, whether based in contract or tort, shall be limited to the amount paid by client for analyses. All claims, including those for negligence and any other cause whatsoever shall be deemed waived unless made in writing and received by Cardinal within thirty (30) days after completion of the applicable service. In no event shall Cardinal be liable for incidental or consequential damages, including, without limitation, business interruptions, loss of use, or loss of profits incurred by client, its subsidiaries, affiliates or successors arising out of or related to the performance of the services hereunder by Cardinal, regardless of whether such claim is based upon any of the above stated reasons or otherwise. Results relate only to the samples identified above. This report shall not be reproduced except in full with written approval of Cardinal Laboratories.

Celey D. Keene, Lab Director/Quality Manager





PHONE (575) 393-2326 ° 101 E. MARLAND ° HOBBS, NM 88240

**Analytical Results For:**

APACHE CORP - HOBBS  
 BRUCE BAKER  
 2350 W. MARLAND BLVD.  
 HOBBS NM, 88240  
 Fax To: (575) 393-2432

Received: 06/09/2023  
 Reported: 06/14/2023  
 Project Name: WBDU #68  
 Project Number: NONE GIVEN  
 Project Location: NOT GIVEN

Sampling Date: 06/09/2023  
 Sampling Type: Soil  
 Sampling Condition: Cool & Intact  
 Sample Received By: Shalyn Rodriguez

**Sample ID: B 5 @ 6" (H232981-05)**

BTEx 8021B		mg/kg		Analyzed By: MS					
Analyte	Result	Reporting Limit	Analyzed	Method Blank	BS	% Recovery	True Value QC	RPD	Qualifier
Benzene*	<0.050	0.050	06/12/2023	ND	2.36	118	2.00	7.98	
Toluene*	<0.050	0.050	06/12/2023	ND	2.35	117	2.00	8.07	
Ethylbenzene*	<0.050	0.050	06/12/2023	ND	2.30	115	2.00	9.07	
Total Xylenes*	<0.150	0.150	06/12/2023	ND	6.99	116	6.00	8.82	
Total BTEx	<0.300	0.300	06/12/2023	ND					

Surrogate: 4-Bromofluorobenzene (PID) 103 % 71.5-134

Chloride, SM4500CI-B		mg/kg		Analyzed By: AC					
Analyte	Result	Reporting Limit	Analyzed	Method Blank	BS	% Recovery	True Value QC	RPD	Qualifier
Chloride	336	16.0	06/12/2023	ND	432	108	400	3.64	

TPH 8015M		mg/kg		Analyzed By: MS					
Analyte	Result	Reporting Limit	Analyzed	Method Blank	BS	% Recovery	True Value QC	RPD	Qualifier
GRO C6-C10*	<10.0	10.0	06/12/2023	ND	186	92.9	200	16.7	
DRO >C10-C28*	67.1	10.0	06/12/2023	ND	195	97.7	200	16.0	
EXT DRO >C28-C36	52.1	10.0	06/12/2023	ND					

Surrogate: 1-Chlorooctane 82.4 % 48.2-134

Surrogate: 1-Chlorooctadecane 90.6 % 49.1-148

Cardinal Laboratories

\*=Accredited Analyte

PLEASE NOTE: Liability and Damages. Cardinal's liability and client's exclusive remedy for any claim arising, whether based in contract or tort, shall be limited to the amount paid by client for analyses. All claims, including those for negligence and any other cause whatsoever shall be deemed waived unless made in writing and received by Cardinal within thirty (30) days after completion of the applicable service. In no event shall Cardinal be liable for incidental or consequential damages, including, without limitation, business interruptions, loss of use, or loss of profits incurred by client, its subsidiaries, affiliates or successors arising out of or related to the performance of the services hereunder by Cardinal, regardless of whether such claim is based upon any of the above stated reasons or otherwise. Results relate only to the samples identified above. This report shall not be reproduced except in full with written approval of Cardinal Laboratories.

Celey D. Keene, Lab Director/Quality Manager



PHONE (575) 393-2326 ° 101 E. MARLAND ° HOBBS, NM 88240

**Analytical Results For:**

APACHE CORP - HOBBS  
 BRUCE BAKER  
 2350 W. MARLAND BLVD.  
 HOBBS NM, 88240  
 Fax To: (575) 393-2432

Received: 06/09/2023  
 Reported: 06/14/2023  
 Project Name: WBDU #68  
 Project Number: NONE GIVEN  
 Project Location: NOT GIVEN

Sampling Date: 06/09/2023  
 Sampling Type: Soil  
 Sampling Condition: Cool & Intact  
 Sample Received By: Shalyn Rodriguez

**Sample ID: B 6 @ 6" (H232981-06)**

BTEx 8021B		mg/kg		Analyzed By: MS						
Analyte	Result	Reporting Limit	Analyzed	Method Blank	BS	% Recovery	True Value QC	RPD	Qualifier	
Benzene*	<0.050	0.050	06/12/2023	ND	2.36	118	2.00	7.98		
Toluene*	<0.050	0.050	06/12/2023	ND	2.35	117	2.00	8.07		
Ethylbenzene*	<0.050	0.050	06/12/2023	ND	2.30	115	2.00	9.07		
Total Xylenes*	<0.150	0.150	06/12/2023	ND	6.99	116	6.00	8.82		
Total BTEX	<0.300	0.300	06/12/2023	ND						

Surrogate: 4-Bromofluorobenzene (PID) 104 % 71.5-134

Chloride, SM4500Cl-B		mg/kg		Analyzed By: AC						
Analyte	Result	Reporting Limit	Analyzed	Method Blank	BS	% Recovery	True Value QC	RPD	Qualifier	
Chloride	1010	16.0	06/12/2023	ND	432	108	400	3.64		

TPH 8015M		mg/kg		Analyzed By: MS					
Analyte	Result	Reporting Limit	Analyzed	Method Blank	BS	% Recovery	True Value QC	RPD	Qualifier
GRO C6-C10*	<10.0	10.0	06/12/2023	ND	186	92.9	200	16.7	
DRO >C10-C28*	<10.0	10.0	06/12/2023	ND	195	97.7	200	16.0	
EXT DRO >C28-C36	<10.0	10.0	06/12/2023	ND					

Surrogate: 1-Chlorooctane 79.0 % 48.2-134

Surrogate: 1-Chlorooctadecane 82.4 % 49.1-148

Cardinal Laboratories

\*=Accredited Analyte

PLEASE NOTE: Liability and Damages. Cardinal's liability and client's exclusive remedy for any claim arising, whether based in contract or tort, shall be limited to the amount paid by client for analyses. All claims, including those for negligence and any other cause whatsoever shall be deemed waived unless made in writing and received by Cardinal within thirty (30) days after completion of the applicable service. In no event shall Cardinal be liable for incidental or consequential damages, including, without limitation, business interruptions, loss of use, or loss of profits incurred by client, its subsidiaries, affiliates or successors arising out of or related to the performance of the services hereunder by Cardinal, regardless of whether such claim is based upon any of the above stated reasons or otherwise. Results relate only to the samples identified above. This report shall not be reproduced except in full with written approval of Cardinal Laboratories.

Celey D. Keene, Lab Director/Quality Manager



PHONE (575) 393-2326 ° 101 E. MARLAND ° HOBBS, NM 88240

**Analytical Results For:**

APACHE CORP - HOBBS  
 BRUCE BAKER  
 2350 W. MARLAND BLVD.  
 HOBBS NM, 88240  
 Fax To: (575) 393-2432

Received: 06/09/2023  
 Reported: 06/14/2023  
 Project Name: WBDU #68  
 Project Number: NONE GIVEN  
 Project Location: NOT GIVEN

Sampling Date: 06/09/2023  
 Sampling Type: Soil  
 Sampling Condition: Cool & Intact  
 Sample Received By: Shalyn Rodriguez

**Sample ID: B 7 @ 6" (H232981-07)**

BTEx 8021B		mg/kg		Analyzed By: MS					
Analyte	Result	Reporting Limit	Analyzed	Method Blank	BS	% Recovery	True Value QC	RPD	Qualifier
Benzene*	<0.050	0.050	06/12/2023	ND	2.36	118	2.00	7.98	
Toluene*	<0.050	0.050	06/12/2023	ND	2.35	117	2.00	8.07	
Ethylbenzene*	<0.050	0.050	06/12/2023	ND	2.30	115	2.00	9.07	
Total Xylenes*	<0.150	0.150	06/12/2023	ND	6.99	116	6.00	8.82	
Total BTEx	<0.300	0.300	06/12/2023	ND					

Surrogate: 4-Bromofluorobenzene (PID) 103 % 71.5-134

Chloride, SM4500CI-B		mg/kg		Analyzed By: AC					
Analyte	Result	Reporting Limit	Analyzed	Method Blank	BS	% Recovery	True Value QC	RPD	Qualifier
Chloride	432	16.0	06/12/2023	ND	432	108	400	3.64	

TPH 8015M		mg/kg		Analyzed By: MS					
Analyte	Result	Reporting Limit	Analyzed	Method Blank	BS	% Recovery	True Value QC	RPD	Qualifier
GRO C6-C10*	<10.0	10.0	06/12/2023	ND	186	92.9	200	16.7	
DRO >C10-C28*	34.2	10.0	06/12/2023	ND	195	97.7	200	16.0	
EXT DRO >C28-C36	10.7	10.0	06/12/2023	ND					

Surrogate: 1-Chlorooctane 81.4 % 48.2-134

Surrogate: 1-Chlorooctadecane 84.9 % 49.1-148

Cardinal Laboratories

\*=Accredited Analyte

PLEASE NOTE: Liability and Damages. Cardinal's liability and client's exclusive remedy for any claim arising, whether based in contract or tort, shall be limited to the amount paid by client for analyses. All claims, including those for negligence and any other cause whatsoever shall be deemed waived unless made in writing and received by Cardinal within thirty (30) days after completion of the applicable service. In no event shall Cardinal be liable for incidental or consequential damages, including, without limitation, business interruptions, loss of use, or loss of profits incurred by client, its subsidiaries, affiliates or successors arising out of or related to the performance of the services hereunder by Cardinal, regardless of whether such claim is based upon any of the above stated reasons or otherwise. Results relate only to the samples identified above. This report shall not be reproduced except in full with written approval of Cardinal Laboratories.

Celey D. Keene, Lab Director/Quality Manager



PHONE (575) 393-2326 ° 101 E. MARLAND ° HOBBS, NM 88240

**Analytical Results For:**

APACHE CORP - HOBBS  
 BRUCE BAKER  
 2350 W. MARLAND BLVD.  
 HOBBS NM, 88240  
 Fax To: (575) 393-2432

Received: 06/09/2023  
 Reported: 06/14/2023  
 Project Name: WBDU #68  
 Project Number: NONE GIVEN  
 Project Location: NOT GIVEN

Sampling Date: 06/09/2023  
 Sampling Type: Soil  
 Sampling Condition: Cool & Intact  
 Sample Received By: Shalyn Rodriguez

**Sample ID: B 8 @ 6" (H232981-08)**

BTEx 8021B		mg/kg		Analyzed By: MS					
Analyte	Result	Reporting Limit	Analyzed	Method Blank	BS	% Recovery	True Value QC	RPD	Qualifier
Benzene*	<0.050	0.050	06/13/2023	ND	2.36	118	2.00	7.98	
Toluene*	<0.050	0.050	06/13/2023	ND	2.35	117	2.00	8.07	
Ethylbenzene*	<0.050	0.050	06/13/2023	ND	2.30	115	2.00	9.07	
Total Xylenes*	<0.150	0.150	06/13/2023	ND	6.99	116	6.00	8.82	
Total BTEx	<0.300	0.300	06/13/2023	ND					

Surrogate: 4-Bromofluorobenzene (PID) 103 % 71.5-134

Chloride, SM4500CI-B		mg/kg		Analyzed By: AC					
Analyte	Result	Reporting Limit	Analyzed	Method Blank	BS	% Recovery	True Value QC	RPD	Qualifier
Chloride	112	16.0	06/12/2023	ND	432	108	400	3.64	

TPH 8015M		mg/kg		Analyzed By: MS					
Analyte	Result	Reporting Limit	Analyzed	Method Blank	BS	% Recovery	True Value QC	RPD	Qualifier
GRO C6-C10*	<10.0	10.0	06/12/2023	ND	186	92.9	200	16.7	
DRO >C10-C28*	47.1	10.0	06/12/2023	ND	195	97.7	200	16.0	
EXT DRO >C28-C36	<10.0	10.0	06/12/2023	ND					

Surrogate: 1-Chlorooctane 84.2 % 48.2-134

Surrogate: 1-Chlorooctadecane 90.4 % 49.1-148

Cardinal Laboratories

\*=Accredited Analyte

PLEASE NOTE: Liability and Damages. Cardinal's liability and client's exclusive remedy for any claim arising, whether based in contract or tort, shall be limited to the amount paid by client for analyses. All claims, including those for negligence and any other cause whatsoever shall be deemed waived unless made in writing and received by Cardinal within thirty (30) days after completion of the applicable service. In no event shall Cardinal be liable for incidental or consequential damages, including, without limitation, business interruptions, loss of use, or loss of profits incurred by client, its subsidiaries, affiliates or successors arising out of or related to the performance of the services hereunder by Cardinal, regardless of whether such claim is based upon any of the above stated reasons or otherwise. Results relate only to the samples identified above. This report shall not be reproduced except in full with written approval of Cardinal Laboratories.

Celey D. Keene, Lab Director/Quality Manager



PHONE (575) 393-2326 ° 101 E. MARLAND ° HOBBS, NM 88240

**Analytical Results For:**

APACHE CORP - HOBBS  
 BRUCE BAKER  
 2350 W. MARLAND BLVD.  
 HOBBS NM, 88240  
 Fax To: (575) 393-2432

Received: 06/09/2023  
 Reported: 06/14/2023  
 Project Name: WBDU #68  
 Project Number: NONE GIVEN  
 Project Location: NOT GIVEN

Sampling Date: 06/09/2023  
 Sampling Type: Soil  
 Sampling Condition: Cool & Intact  
 Sample Received By: Shalyn Rodriguez

**Sample ID: B 9 @ 6" (H232981-09)**

BTX 8021B		mg/kg		Analyzed By: MS					
Analyte	Result	Reporting Limit	Analyzed	Method Blank	BS	% Recovery	True Value QC	RPD	Qualifier
Benzene*	<0.050	0.050	06/13/2023	ND	2.36	118	2.00	7.98	
Toluene*	<0.050	0.050	06/13/2023	ND	2.35	117	2.00	8.07	
Ethylbenzene*	<0.050	0.050	06/13/2023	ND	2.30	115	2.00	9.07	
Total Xylenes*	<0.150	0.150	06/13/2023	ND	6.99	116	6.00	8.82	
Total BTX	<0.300	0.300	06/13/2023	ND					

Surrogate: 4-Bromofluorobenzene (PID) 105 % 71.5-134

Chloride, SM4500CI-B		mg/kg		Analyzed By: AC						
Analyte	Result	Reporting Limit	Analyzed	Method Blank	BS	% Recovery	True Value QC	RPD	Qualifier	
Chloride	224	16.0	06/12/2023	ND	432	108	400	3.64		

TPH 8015M		mg/kg		Analyzed By: MS					
Analyte	Result	Reporting Limit	Analyzed	Method Blank	BS	% Recovery	True Value QC	RPD	Qualifier
GRO C6-C10*	<10.0	10.0	06/12/2023	ND	186	92.9	200	16.7	
DRO >C10-C28*	<10.0	10.0	06/12/2023	ND	195	97.7	200	16.0	
EXT DRO >C28-C36	<10.0	10.0	06/12/2023	ND					

Surrogate: 1-Chlorooctane 99.1 % 48.2-134

Surrogate: 1-Chlorooctadecane 104 % 49.1-148

Cardinal Laboratories

\*=Accredited Analyte

PLEASE NOTE: Liability and Damages. Cardinal's liability and client's exclusive remedy for any claim arising, whether based in contract or tort, shall be limited to the amount paid by client for analyses. All claims, including those for negligence and any other cause whatsoever shall be deemed waived unless made in writing and received by Cardinal within thirty (30) days after completion of the applicable service. In no event shall Cardinal be liable for incidental or consequential damages, including, without limitation, business interruptions, loss of use, or loss of profits incurred by client, its subsidiaries, affiliates or successors arising out of or related to the performance of the services hereunder by Cardinal, regardless of whether such claim is based upon any of the above stated reasons or otherwise. Results relate only to the samples identified above. This report shall not be reproduced except in full with written approval of Cardinal Laboratories.

Celey D. Keene, Lab Director/Quality Manager



PHONE (575) 393-2326 ° 101 E. MARLAND ° HOBBS, NM 88240

**Analytical Results For:**

APACHE CORP - HOBBS  
 BRUCE BAKER  
 2350 W. MARLAND BLVD.  
 HOBBS NM, 88240  
 Fax To: (575) 393-2432

Received: 06/09/2023  
 Reported: 06/14/2023  
 Project Name: WBDU #68  
 Project Number: NONE GIVEN  
 Project Location: NOT GIVEN

Sampling Date: 06/09/2023  
 Sampling Type: Soil  
 Sampling Condition: Cool & Intact  
 Sample Received By: Shalyn Rodriguez

**Sample ID: B 10 @ 6" (H232981-10)**

BTEx 8021B		mg/kg		Analyzed By: MS						
Analyte	Result	Reporting Limit	Analyzed	Method Blank	BS	% Recovery	True Value QC	RPD	Qualifier	
Benzene*	<0.050	0.050	06/13/2023	ND	2.36	118	2.00	7.98		
Toluene*	<0.050	0.050	06/13/2023	ND	2.35	117	2.00	8.07		
Ethylbenzene*	<0.050	0.050	06/13/2023	ND	2.30	115	2.00	9.07		
Total Xylenes*	<0.150	0.150	06/13/2023	ND	6.99	116	6.00	8.82		
Total BTEx	<0.300	0.300	06/13/2023	ND						

Surrogate: 4-Bromofluorobenzene (PID) 104 % 71.5-134

Chloride, SM4500CI-B		mg/kg		Analyzed By: AC						
Analyte	Result	Reporting Limit	Analyzed	Method Blank	BS	% Recovery	True Value QC	RPD	Qualifier	
Chloride	128	16.0	06/12/2023	ND	432	108	400	3.64		

TPH 8015M		mg/kg		Analyzed By: MS					
Analyte	Result	Reporting Limit	Analyzed	Method Blank	BS	% Recovery	True Value QC	RPD	Qualifier
GRO C6-C10*	<10.0	10.0	06/12/2023	ND	186	92.9	200	16.7	
DRO >C10-C28*	<10.0	10.0	06/12/2023	ND	195	97.7	200	16.0	
EXT DRO >C28-C36	<10.0	10.0	06/12/2023	ND					

Surrogate: 1-Chlorooctane 102 % 48.2-134

Surrogate: 1-Chlorooctadecane 107 % 49.1-148

Cardinal Laboratories

\*=Accredited Analyte

PLEASE NOTE: Liability and Damages. Cardinal's liability and client's exclusive remedy for any claim arising, whether based in contract or tort, shall be limited to the amount paid by client for analyses. All claims, including those for negligence and any other cause whatsoever shall be deemed waived unless made in writing and received by Cardinal within thirty (30) days after completion of the applicable service. In no event shall Cardinal be liable for incidental or consequential damages, including, without limitation, business interruptions, loss of use, or loss of profits incurred by client, its subsidiaries, affiliates or successors arising out of or related to the performance of the services hereunder by Cardinal, regardless of whether such claim is based upon any of the above stated reasons or otherwise. Results relate only to the samples identified above. This report shall not be reproduced except in full with written approval of Cardinal Laboratories.

Celey D. Keene, Lab Director/Quality Manager



PHONE (575) 393-2326 ° 101 E. MARLAND ° HOBBS, NM 88240

**Analytical Results For:**

APACHE CORP - HOBBS  
 BRUCE BAKER  
 2350 W. MARLAND BLVD.  
 HOBBS NM, 88240  
 Fax To: (575) 393-2432

Received: 06/09/2023  
 Reported: 06/14/2023  
 Project Name: WBDU #68  
 Project Number: NONE GIVEN  
 Project Location: NOT GIVEN

Sampling Date: 06/09/2023  
 Sampling Type: Soil  
 Sampling Condition: Cool & Intact  
 Sample Received By: Shalyn Rodriguez

**Sample ID: B 11 @ 6" (H232981-11)**

BTEx 8021B		mg/kg		Analyzed By: MS					
Analyte	Result	Reporting Limit	Analyzed	Method Blank	BS	% Recovery	True Value QC	RPD	Qualifier
Benzene*	<0.050	0.050	06/13/2023	ND	2.36	118	2.00	7.98	
Toluene*	<0.050	0.050	06/13/2023	ND	2.35	117	2.00	8.07	
Ethylbenzene*	<0.050	0.050	06/13/2023	ND	2.30	115	2.00	9.07	
Total Xylenes*	<0.150	0.150	06/13/2023	ND	6.99	116	6.00	8.82	
Total BTEX	<0.300	0.300	06/13/2023	ND					

Surrogate: 4-Bromofluorobenzene (PID) 103 % 71.5-134

Chloride, SM4500Cl-B		mg/kg		Analyzed By: AC						
Analyte	Result	Reporting Limit	Analyzed	Method Blank	BS	% Recovery	True Value QC	RPD	Qualifier	
Chloride	384	16.0	06/12/2023	ND	432	108	400	3.64		

TPH 8015M		mg/kg		Analyzed By: MS					
Analyte	Result	Reporting Limit	Analyzed	Method Blank	BS	% Recovery	True Value QC	RPD	Qualifier
GRO C6-C10*	<10.0	10.0	06/12/2023	ND	172	86.0	200	4.89	
DRO >C10-C28*	<10.0	10.0	06/12/2023	ND	149	74.7	200	9.63	
EXT DRO >C28-C36	<10.0	10.0	06/12/2023	ND					

Surrogate: 1-Chlorooctane 97.1 % 48.2-134

Surrogate: 1-Chlorooctadecane 103 % 49.1-148

Cardinal Laboratories

\*=Accredited Analyte

PLEASE NOTE: Liability and Damages. Cardinal's liability and client's exclusive remedy for any claim arising, whether based in contract or tort, shall be limited to the amount paid by client for analyses. All claims, including those for negligence and any other cause whatsoever shall be deemed waived unless made in writing and received by Cardinal within thirty (30) days after completion of the applicable service. In no event shall Cardinal be liable for incidental or consequential damages, including, without limitation, business interruptions, loss of use, or loss of profits incurred by client, its subsidiaries, affiliates or successors arising out of or related to the performance of the services hereunder by Cardinal, regardless of whether such claim is based upon any of the above stated reasons or otherwise. Results relate only to the samples identified above. This report shall not be reproduced except in full with written approval of Cardinal Laboratories.

Celey D. Keene, Lab Director/Quality Manager



PHONE (575) 393-2326 ° 101 E. MARLAND ° HOBBS, NM 88240

**Analytical Results For:**

APACHE CORP - HOBBS  
 BRUCE BAKER  
 2350 W. MARLAND BLVD.  
 HOBBS NM, 88240  
 Fax To: (575) 393-2432

Received: 06/09/2023  
 Reported: 06/14/2023  
 Project Name: WBDU #68  
 Project Number: NONE GIVEN  
 Project Location: NOT GIVEN

Sampling Date: 06/09/2023  
 Sampling Type: Soil  
 Sampling Condition: Cool & Intact  
 Sample Received By: Shalyn Rodriguez

**Sample ID: B 12 @ 6" (H232981-12)**

BTEx 8021B		mg/kg		Analyzed By: MS					
Analyte	Result	Reporting Limit	Analyzed	Method Blank	BS	% Recovery	True Value QC	RPD	Qualifier
Benzene*	<0.050	0.050	06/13/2023	ND	2.36	118	2.00	7.98	
Toluene*	<0.050	0.050	06/13/2023	ND	2.35	117	2.00	8.07	
Ethylbenzene*	<0.050	0.050	06/13/2023	ND	2.30	115	2.00	9.07	
Total Xylenes*	<0.150	0.150	06/13/2023	ND	6.99	116	6.00	8.82	
Total BTEX	<0.300	0.300	06/13/2023	ND					

Surrogate: 4-Bromofluorobenzene (PID) 103 % 71.5-134

Chloride, SM4500Cl-B		mg/kg		Analyzed By: AC						
Analyte	Result	Reporting Limit	Analyzed	Method Blank	BS	% Recovery	True Value QC	RPD	Qualifier	
Chloride	192	16.0	06/12/2023	ND	432	108	400	3.64		

TPH 8015M		mg/kg		Analyzed By: MS					
Analyte	Result	Reporting Limit	Analyzed	Method Blank	BS	% Recovery	True Value QC	RPD	Qualifier
GRO C6-C10*	<10.0	10.0	06/12/2023	ND	172	86.0	200	4.89	
DRO >C10-C28*	<10.0	10.0	06/12/2023	ND	149	74.7	200	9.63	
EXT DRO >C28-C36	<10.0	10.0	06/12/2023	ND					

Surrogate: 1-Chlorooctane 92.3 % 48.2-134

Surrogate: 1-Chlorooctadecane 102 % 49.1-148

Cardinal Laboratories

\*=Accredited Analyte

PLEASE NOTE: Liability and Damages. Cardinal's liability and client's exclusive remedy for any claim arising, whether based in contract or tort, shall be limited to the amount paid by client for analyses. All claims, including those for negligence and any other cause whatsoever shall be deemed waived unless made in writing and received by Cardinal within thirty (30) days after completion of the applicable service. In no event shall Cardinal be liable for incidental or consequential damages, including, without limitation, business interruptions, loss of use, or loss of profits incurred by client, its subsidiaries, affiliates or successors arising out of or related to the performance of the services hereunder by Cardinal, regardless of whether such claim is based upon any of the above stated reasons or otherwise. Results relate only to the samples identified above. This report shall not be reproduced except in full with written approval of Cardinal Laboratories.

Celey D. Keene, Lab Director/Quality Manager





PHONE (575) 393-2326 ° 101 E. MARLAND ° HOBBS, NM 88240

**Analytical Results For:**

APACHE CORP - HOBBS  
 BRUCE BAKER  
 2350 W. MARLAND BLVD.  
 HOBBS NM, 88240  
 Fax To: (575) 393-2432

Received: 06/09/2023  
 Reported: 06/14/2023  
 Project Name: WBDU #68  
 Project Number: NONE GIVEN  
 Project Location: NOT GIVEN

Sampling Date: 06/09/2023  
 Sampling Type: Soil  
 Sampling Condition: Cool & Intact  
 Sample Received By: Shalyn Rodriguez

**Sample ID: B 13 @ 6" (H232981-13)**

BTEx 8021B		mg/kg		Analyzed By: MS					
Analyte	Result	Reporting Limit	Analyzed	Method Blank	BS	% Recovery	True Value QC	RPD	Qualifier
Benzene*	<0.050	0.050	06/13/2023	ND	2.36	118	2.00	7.98	
Toluene*	<0.050	0.050	06/13/2023	ND	2.35	117	2.00	8.07	
Ethylbenzene*	<0.050	0.050	06/13/2023	ND	2.30	115	2.00	9.07	
Total Xylenes*	<0.150	0.150	06/13/2023	ND	6.99	116	6.00	8.82	
Total BTEx	<0.300	0.300	06/13/2023	ND					

Surrogate: 4-Bromofluorobenzene (PID) 101 % 71.5-134

Chloride, SM4500CI-B		mg/kg		Analyzed By: AC					
Analyte	Result	Reporting Limit	Analyzed	Method Blank	BS	% Recovery	True Value QC	RPD	Qualifier
Chloride	96.0	16.0	06/12/2023	ND	432	108	400	3.64	

TPH 8015M		mg/kg		Analyzed By: MS					
Analyte	Result	Reporting Limit	Analyzed	Method Blank	BS	% Recovery	True Value QC	RPD	Qualifier
GRO C6-C10*	<10.0	10.0	06/12/2023	ND	172	86.0	200	4.89	
DRO >C10-C28*	<10.0	10.0	06/12/2023	ND	149	74.7	200	9.63	
EXT DRO >C28-C36	<10.0	10.0	06/12/2023	ND					

Surrogate: 1-Chlorooctane 98.3 % 48.2-134

Surrogate: 1-Chlorooctadecane 105 % 49.1-148

Cardinal Laboratories

\*=Accredited Analyte

PLEASE NOTE: Liability and Damages. Cardinal's liability and client's exclusive remedy for any claim arising, whether based in contract or tort, shall be limited to the amount paid by client for analyses. All claims, including those for negligence and any other cause whatsoever shall be deemed waived unless made in writing and received by Cardinal within thirty (30) days after completion of the applicable service. In no event shall Cardinal be liable for incidental or consequential damages, including, without limitation, business interruptions, loss of use, or loss of profits incurred by client, its subsidiaries, affiliates or successors arising out of or related to the performance of the services hereunder by Cardinal, regardless of whether such claim is based upon any of the above stated reasons or otherwise. Results relate only to the samples identified above. This report shall not be reproduced except in full with written approval of Cardinal Laboratories.

Celey D. Keene, Lab Director/Quality Manager



PHONE (575) 393-2326 ° 101 E. MARLAND ° HOBBS, NM 88240

**Analytical Results For:**

APACHE CORP - HOBBS  
 BRUCE BAKER  
 2350 W. MARLAND BLVD.  
 HOBBS NM, 88240  
 Fax To: (575) 393-2432

Received: 06/09/2023  
 Reported: 06/14/2023  
 Project Name: WBDU #68  
 Project Number: NONE GIVEN  
 Project Location: NOT GIVEN

Sampling Date: 06/09/2023  
 Sampling Type: Soil  
 Sampling Condition: Cool & Intact  
 Sample Received By: Shalyn Rodriguez

**Sample ID: B 14 @ 6" (H232981-14)**

BTEx 8021B		mg/kg		Analyzed By: MS					
Analyte	Result	Reporting Limit	Analyzed	Method Blank	BS	% Recovery	True Value QC	RPD	Qualifier
Benzene*	<0.050	0.050	06/13/2023	ND	2.36	118	2.00	7.98	
Toluene*	<0.050	0.050	06/13/2023	ND	2.35	117	2.00	8.07	
Ethylbenzene*	<0.050	0.050	06/13/2023	ND	2.30	115	2.00	9.07	
Total Xylenes*	<0.150	0.150	06/13/2023	ND	6.99	116	6.00	8.82	
Total BTEX	<0.300	0.300	06/13/2023	ND					

Surrogate: 4-Bromofluorobenzene (PID) 103 % 71.5-134

Chloride, SM4500Cl-B		mg/kg		Analyzed By: AC					
Analyte	Result	Reporting Limit	Analyzed	Method Blank	BS	% Recovery	True Value QC	RPD	Qualifier
Chloride	224	16.0	06/12/2023	ND	432	108	400	3.64	

TPH 8015M		mg/kg		Analyzed By: MS					
Analyte	Result	Reporting Limit	Analyzed	Method Blank	BS	% Recovery	True Value QC	RPD	Qualifier
GRO C6-C10*	<10.0	10.0	06/12/2023	ND	172	86.0	200	4.89	
DRO >C10-C28*	<10.0	10.0	06/12/2023	ND	149	74.7	200	9.63	
EXT DRO >C28-C36	<10.0	10.0	06/12/2023	ND					

Surrogate: 1-Chlorooctane 95.5 % 48.2-134

Surrogate: 1-Chlorooctadecane 101 % 49.1-148

Cardinal Laboratories

\*=Accredited Analyte

PLEASE NOTE: Liability and Damages. Cardinal's liability and client's exclusive remedy for any claim arising, whether based in contract or tort, shall be limited to the amount paid by client for analyses. All claims, including those for negligence and any other cause whatsoever shall be deemed waived unless made in writing and received by Cardinal within thirty (30) days after completion of the applicable service. In no event shall Cardinal be liable for incidental or consequential damages, including, without limitation, business interruptions, loss of use, or loss of profits incurred by client, its subsidiaries, affiliates or successors arising out of or related to the performance of the services hereunder by Cardinal, regardless of whether such claim is based upon any of the above stated reasons or otherwise. Results relate only to the samples identified above. This report shall not be reproduced except in full with written approval of Cardinal Laboratories.

Celey D. Keene, Lab Director/Quality Manager



PHONE (575) 393-2326 ° 101 E. MARLAND ° HOBBS, NM 88240

**Analytical Results For:**

APACHE CORP - HOBBS  
 BRUCE BAKER  
 2350 W. MARLAND BLVD.  
 HOBBS NM, 88240  
 Fax To: (575) 393-2432

Received: 06/09/2023  
 Reported: 06/14/2023  
 Project Name: WBDU #68  
 Project Number: NONE GIVEN  
 Project Location: NOT GIVEN

Sampling Date: 06/09/2023  
 Sampling Type: Soil  
 Sampling Condition: Cool & Intact  
 Sample Received By: Shalyn Rodriguez

**Sample ID: B 15 @ 6" (H232981-15)**

BTEx 8021B		mg/kg		Analyzed By: MS					
Analyte	Result	Reporting Limit	Analyzed	Method Blank	BS	% Recovery	True Value QC	RPD	Qualifier
Benzene*	<0.050	0.050	06/13/2023	ND	2.36	118	2.00	7.98	
Toluene*	<0.050	0.050	06/13/2023	ND	2.35	117	2.00	8.07	
Ethylbenzene*	<0.050	0.050	06/13/2023	ND	2.30	115	2.00	9.07	
Total Xylenes*	<0.150	0.150	06/13/2023	ND	6.99	116	6.00	8.82	
Total BTEX	<0.300	0.300	06/13/2023	ND					

Surrogate: 4-Bromofluorobenzene (PID) 103 % 71.5-134

Chloride, SM4500Cl-B		mg/kg		Analyzed By: AC						
Analyte	Result	Reporting Limit	Analyzed	Method Blank	BS	% Recovery	True Value QC	RPD	Qualifier	
Chloride	544	16.0	06/12/2023	ND	432	108	400	3.64		

TPH 8015M		mg/kg		Analyzed By: MS					
Analyte	Result	Reporting Limit	Analyzed	Method Blank	BS	% Recovery	True Value QC	RPD	Qualifier
GRO C6-C10*	<10.0	10.0	06/12/2023	ND	172	86.0	200	4.89	
DRO >C10-C28*	<10.0	10.0	06/12/2023	ND	149	74.7	200	9.63	
EXT DRO >C28-C36	<10.0	10.0	06/12/2023	ND					

Surrogate: 1-Chlorooctane 94.0 % 48.2-134

Surrogate: 1-Chlorooctadecane 98.6 % 49.1-148

Cardinal Laboratories

\*=Accredited Analyte

PLEASE NOTE: Liability and Damages. Cardinal's liability and client's exclusive remedy for any claim arising, whether based in contract or tort, shall be limited to the amount paid by client for analyses. All claims, including those for negligence and any other cause whatsoever shall be deemed waived unless made in writing and received by Cardinal within thirty (30) days after completion of the applicable service. In no event shall Cardinal be liable for incidental or consequential damages, including, without limitation, business interruptions, loss of use, or loss of profits incurred by client, its subsidiaries, affiliates or successors arising out of or related to the performance of the services hereunder by Cardinal, regardless of whether such claim is based upon any of the above stated reasons or otherwise. Results relate only to the samples identified above. This report shall not be reproduced except in full with written approval of Cardinal Laboratories.

Celey D. Keene, Lab Director/Quality Manager



PHONE (575) 393-2326 ° 101 E. MARLAND ° HOBBS, NM 88240

**Analytical Results For:**

APACHE CORP - HOBBS  
 BRUCE BAKER  
 2350 W. MARLAND BLVD.  
 HOBBS NM, 88240  
 Fax To: (575) 393-2432

Received: 06/09/2023  
 Reported: 06/14/2023  
 Project Name: WBDU #68  
 Project Number: NONE GIVEN  
 Project Location: NOT GIVEN

Sampling Date: 06/09/2023  
 Sampling Type: Soil  
 Sampling Condition: Cool & Intact  
 Sample Received By: Shalyn Rodriguez

**Sample ID: B 16 @ 6" (H232981-16)**

BTEx 8021B		mg/kg		Analyzed By: MS						
Analyte	Result	Reporting Limit	Analyzed	Method Blank	BS	% Recovery	True Value QC	RPD	Qualifier	
Benzene*	<0.050	0.050	06/13/2023	ND	2.36	118	2.00	7.98		
Toluene*	<0.050	0.050	06/13/2023	ND	2.35	117	2.00	8.07		
Ethylbenzene*	<0.050	0.050	06/13/2023	ND	2.30	115	2.00	9.07		
Total Xylenes*	<0.150	0.150	06/13/2023	ND	6.99	116	6.00	8.82		
Total BTEX	<0.300	0.300	06/13/2023	ND						

Surrogate: 4-Bromofluorobenzene (PID) 104 % 71.5-134

Chloride, SM4500Cl-B		mg/kg		Analyzed By: AC						
Analyte	Result	Reporting Limit	Analyzed	Method Blank	BS	% Recovery	True Value QC	RPD	Qualifier	
Chloride	480	16.0	06/12/2023	ND	432	108	400	3.64		

TPH 8015M		mg/kg		Analyzed By: MS					
Analyte	Result	Reporting Limit	Analyzed	Method Blank	BS	% Recovery	True Value QC	RPD	Qualifier
GRO C6-C10*	<10.0	10.0	06/12/2023	ND	172	86.0	200	4.89	
DRO >C10-C28*	<10.0	10.0	06/12/2023	ND	149	74.7	200	9.63	
EXT DRO >C28-C36	<10.0	10.0	06/12/2023	ND					

Surrogate: 1-Chlorooctane 97.1 % 48.2-134

Surrogate: 1-Chlorooctadecane 104 % 49.1-148

Cardinal Laboratories

\*=Accredited Analyte

PLEASE NOTE: Liability and Damages. Cardinal's liability and client's exclusive remedy for any claim arising, whether based in contract or tort, shall be limited to the amount paid by client for analyses. All claims, including those for negligence and any other cause whatsoever shall be deemed waived unless made in writing and received by Cardinal within thirty (30) days after completion of the applicable service. In no event shall Cardinal be liable for incidental or consequential damages, including, without limitation, business interruptions, loss of use, or loss of profits incurred by client, its subsidiaries, affiliates or successors arising out of or related to the performance of the services hereunder by Cardinal, regardless of whether such claim is based upon any of the above stated reasons or otherwise. Results relate only to the samples identified above. This report shall not be reproduced except in full with written approval of Cardinal Laboratories.

Celey D. Keene, Lab Director/Quality Manager



PHONE (575) 393-2326 ° 101 E. MARLAND ° HOBBS, NM 88240

**Analytical Results For:**

APACHE CORP - HOBBS  
 BRUCE BAKER  
 2350 W. MARLAND BLVD.  
 HOBBS NM, 88240  
 Fax To: (575) 393-2432

Received: 06/09/2023  
 Reported: 06/14/2023  
 Project Name: WBDU #68  
 Project Number: NONE GIVEN  
 Project Location: NOT GIVEN

Sampling Date: 06/09/2023  
 Sampling Type: Soil  
 Sampling Condition: Cool & Intact  
 Sample Received By: Shalyn Rodriguez

**Sample ID: B 17 @ 6" (H232981-17)**

BTEx 8021B		mg/kg		Analyzed By: MS					
Analyte	Result	Reporting Limit	Analyzed	Method Blank	BS	% Recovery	True Value QC	RPD	Qualifier
Benzene*	<0.050	0.050	06/13/2023	ND	2.36	118	2.00	7.98	
Toluene*	<0.050	0.050	06/13/2023	ND	2.35	117	2.00	8.07	
Ethylbenzene*	<0.050	0.050	06/13/2023	ND	2.30	115	2.00	9.07	
Total Xylenes*	<0.150	0.150	06/13/2023	ND	6.99	116	6.00	8.82	
Total BTEX	<0.300	0.300	06/13/2023	ND					

Surrogate: 4-Bromofluorobenzene (PID) 103 % 71.5-134

Chloride, SM4500Cl-B		mg/kg		Analyzed By: AC						
Analyte	Result	Reporting Limit	Analyzed	Method Blank	BS	% Recovery	True Value QC	RPD	Qualifier	
Chloride	48.0	16.0	06/12/2023	ND	432	108	400	3.64		

TPH 8015M		mg/kg		Analyzed By: MS					
Analyte	Result	Reporting Limit	Analyzed	Method Blank	BS	% Recovery	True Value QC	RPD	Qualifier
GRO C6-C10*	<10.0	10.0	06/12/2023	ND	172	86.0	200	4.89	
DRO >C10-C28*	14.4	10.0	06/12/2023	ND	149	74.7	200	9.63	
EXT DRO >C28-C36	28.9	10.0	06/12/2023	ND					

Surrogate: 1-Chlorooctane 96.2 % 48.2-134

Surrogate: 1-Chlorooctadecane 105 % 49.1-148

Cardinal Laboratories

\*=Accredited Analyte

PLEASE NOTE: Liability and Damages. Cardinal's liability and client's exclusive remedy for any claim arising, whether based in contract or tort, shall be limited to the amount paid by client for analyses. All claims, including those for negligence and any other cause whatsoever shall be deemed waived unless made in writing and received by Cardinal within thirty (30) days after completion of the applicable service. In no event shall Cardinal be liable for incidental or consequential damages, including, without limitation, business interruptions, loss of use, or loss of profits incurred by client, its subsidiaries, affiliates or successors arising out of or related to the performance of the services hereunder by Cardinal, regardless of whether such claim is based upon any of the above stated reasons or otherwise. Results relate only to the samples identified above. This report shall not be reproduced except in full with written approval of Cardinal Laboratories.

Celey D. Keene, Lab Director/Quality Manager



PHONE (575) 393-2326 ° 101 E. MARLAND ° HOBBS, NM 88240

**Analytical Results For:**

APACHE CORP - HOBBS  
 BRUCE BAKER  
 2350 W. MARLAND BLVD.  
 HOBBS NM, 88240  
 Fax To: (575) 393-2432

Received: 06/09/2023  
 Reported: 06/14/2023  
 Project Name: WBDU #68  
 Project Number: NONE GIVEN  
 Project Location: NOT GIVEN

Sampling Date: 06/09/2023  
 Sampling Type: Soil  
 Sampling Condition: Cool & Intact  
 Sample Received By: Shalyn Rodriguez

**Sample ID: B 18 @ 6" (H232981-18)**

BTEx 8021B		mg/kg		Analyzed By: MS					
Analyte	Result	Reporting Limit	Analyzed	Method Blank	BS	% Recovery	True Value QC	RPD	Qualifier
Benzene*	<0.050	0.050	06/13/2023	ND	2.36	118	2.00	7.98	
Toluene*	<0.050	0.050	06/13/2023	ND	2.35	117	2.00	8.07	
Ethylbenzene*	<0.050	0.050	06/13/2023	ND	2.30	115	2.00	9.07	
Total Xylenes*	<0.150	0.150	06/13/2023	ND	6.99	116	6.00	8.82	
Total BTEX	<0.300	0.300	06/13/2023	ND					

Surrogate: 4-Bromofluorobenzene (PID) 103 % 71.5-134

Chloride, SM4500Cl-B		mg/kg		Analyzed By: AC						
Analyte	Result	Reporting Limit	Analyzed	Method Blank	BS	% Recovery	True Value QC	RPD	Qualifier	
Chloride	352	16.0	06/12/2023	ND	432	108	400	3.64		

TPH 8015M		mg/kg		Analyzed By: MS					
Analyte	Result	Reporting Limit	Analyzed	Method Blank	BS	% Recovery	True Value QC	RPD	Qualifier
GRO C6-C10*	<10.0	10.0	06/12/2023	ND	172	86.0	200	4.89	
DRO >C10-C28*	<10.0	10.0	06/12/2023	ND	149	74.7	200	9.63	
EXT DRO >C28-C36	<10.0	10.0	06/12/2023	ND					

Surrogate: 1-Chlorooctane 99.4 % 48.2-134

Surrogate: 1-Chlorooctadecane 107 % 49.1-148

Cardinal Laboratories

\*=Accredited Analyte

PLEASE NOTE: Liability and Damages. Cardinal's liability and client's exclusive remedy for any claim arising, whether based in contract or tort, shall be limited to the amount paid by client for analyses. All claims, including those for negligence and any other cause whatsoever shall be deemed waived unless made in writing and received by Cardinal within thirty (30) days after completion of the applicable service. In no event shall Cardinal be liable for incidental or consequential damages, including, without limitation, business interruptions, loss of use, or loss of profits incurred by client, its subsidiaries, affiliates or successors arising out of or related to the performance of the services hereunder by Cardinal, regardless of whether such claim is based upon any of the above stated reasons or otherwise. Results relate only to the samples identified above. This report shall not be reproduced except in full with written approval of Cardinal Laboratories.

Celey D. Keene, Lab Director/Quality Manager



PHONE (575) 393-2326 ° 101 E. MARLAND ° HOBBS, NM 88240

**Analytical Results For:**

APACHE CORP - HOBBS  
 BRUCE BAKER  
 2350 W. MARLAND BLVD.  
 HOBBS NM, 88240  
 Fax To: (575) 393-2432

Received: 06/09/2023  
 Reported: 06/14/2023  
 Project Name: WBDU #68  
 Project Number: NONE GIVEN  
 Project Location: NOT GIVEN

Sampling Date: 06/09/2023  
 Sampling Type: Soil  
 Sampling Condition: Cool & Intact  
 Sample Received By: Shalyn Rodriguez

**Sample ID: B 19 @ 6" (H232981-19)**

BTEx 8021B		mg/kg		Analyzed By: MS					
Analyte	Result	Reporting Limit	Analyzed	Method Blank	BS	% Recovery	True Value QC	RPD	Qualifier
Benzene*	<0.050	0.050	06/13/2023	ND	2.36	118	2.00	7.98	
Toluene*	<0.050	0.050	06/13/2023	ND	2.35	117	2.00	8.07	
Ethylbenzene*	<0.050	0.050	06/13/2023	ND	2.30	115	2.00	9.07	
Total Xylenes*	<0.150	0.150	06/13/2023	ND	6.99	116	6.00	8.82	
Total BTEX	<0.300	0.300	06/13/2023	ND					

Surrogate: 4-Bromofluorobenzene (PID) 104 % 71.5-134

Chloride, SM4500Cl-B		mg/kg		Analyzed By: AC					
Analyte	Result	Reporting Limit	Analyzed	Method Blank	BS	% Recovery	True Value QC	RPD	Qualifier
Chloride	512	16.0	06/12/2023	ND	432	108	400	3.64	

TPH 8015M		mg/kg		Analyzed By: MS					
Analyte	Result	Reporting Limit	Analyzed	Method Blank	BS	% Recovery	True Value QC	RPD	Qualifier
GRO C6-C10*	<10.0	10.0	06/12/2023	ND	172	86.0	200	4.89	
DRO >C10-C28*	<10.0	10.0	06/12/2023	ND	149	74.7	200	9.63	
EXT DRO >C28-C36	<10.0	10.0	06/12/2023	ND					

Surrogate: 1-Chlorooctane 96.5 % 48.2-134

Surrogate: 1-Chlorooctadecane 105 % 49.1-148

Cardinal Laboratories

\*=Accredited Analyte

PLEASE NOTE: Liability and Damages. Cardinal's liability and client's exclusive remedy for any claim arising, whether based in contract or tort, shall be limited to the amount paid by client for analyses. All claims, including those for negligence and any other cause whatsoever shall be deemed waived unless made in writing and received by Cardinal within thirty (30) days after completion of the applicable service. In no event shall Cardinal be liable for incidental or consequential damages, including, without limitation, business interruptions, loss of use, or loss of profits incurred by client, its subsidiaries, affiliates or successors arising out of or related to the performance of the services hereunder by Cardinal, regardless of whether such claim is based upon any of the above stated reasons or otherwise. Results relate only to the samples identified above. This report shall not be reproduced except in full with written approval of Cardinal Laboratories.

Celey D. Keene, Lab Director/Quality Manager



PHONE (575) 393-2326 ° 101 E. MARLAND ° HOBBS, NM 88240

**Analytical Results For:**

APACHE CORP - HOBBS  
 BRUCE BAKER  
 2350 W. MARLAND BLVD.  
 HOBBS NM, 88240  
 Fax To: (575) 393-2432

Received: 06/09/2023  
 Reported: 06/14/2023  
 Project Name: WBDU #68  
 Project Number: NONE GIVEN  
 Project Location: NOT GIVEN

Sampling Date: 06/09/2023  
 Sampling Type: Soil  
 Sampling Condition: Cool & Intact  
 Sample Received By: Shalyn Rodriguez

**Sample ID: B 20 @ 6" (H232981-20)**

BTEx 8021B		mg/kg		Analyzed By: JH/						
Analyte	Result	Reporting Limit	Analyzed	Method Blank	BS	% Recovery	True Value QC	RPD	Qualifier	
Benzene*	<0.050	0.050	06/12/2023	ND	2.09	105	2.00	10.1		
Toluene*	<0.050	0.050	06/12/2023	ND	2.16	108	2.00	9.95		
Ethylbenzene*	<0.050	0.050	06/12/2023	ND	2.11	106	2.00	12.7		
Total Xylenes*	<0.150	0.150	06/12/2023	ND	6.54	109	6.00	12.6		
Total BTEX	<0.300	0.300	06/12/2023	ND						

Surrogate: 4-Bromofluorobenzene (PID) 105 % 71.5-134

Chloride, SM4500Cl-B		mg/kg		Analyzed By: AC						
Analyte	Result	Reporting Limit	Analyzed	Method Blank	BS	% Recovery	True Value QC	RPD	Qualifier	
Chloride	160	16.0	06/12/2023	ND	432	108	400	3.64		

TPH 8015M		mg/kg		Analyzed By: MS					
Analyte	Result	Reporting Limit	Analyzed	Method Blank	BS	% Recovery	True Value QC	RPD	Qualifier
GRO C6-C10*	<10.0	10.0	06/12/2023	ND	172	86.0	200	4.89	
DRO >C10-C28*	<10.0	10.0	06/12/2023	ND	149	74.7	200	9.63	
EXT DRO >C28-C36	<10.0	10.0	06/12/2023	ND					

Surrogate: 1-Chlorooctane 95.4 % 48.2-134

Surrogate: 1-Chlorooctadecane 102 % 49.1-148

Cardinal Laboratories

\*=Accredited Analyte

PLEASE NOTE: Liability and Damages. Cardinal's liability and client's exclusive remedy for any claim arising, whether based in contract or tort, shall be limited to the amount paid by client for analyses. All claims, including those for negligence and any other cause whatsoever shall be deemed waived unless made in writing and received by Cardinal within thirty (30) days after completion of the applicable service. In no event shall Cardinal be liable for incidental or consequential damages, including, without limitation, business interruptions, loss of use, or loss of profits incurred by client, its subsidiaries, affiliates or successors arising out of or related to the performance of the services hereunder by Cardinal, regardless of whether such claim is based upon any of the above stated reasons or otherwise. Results relate only to the samples identified above. This report shall not be reproduced except in full with written approval of Cardinal Laboratories.

Celey D. Keene, Lab Director/Quality Manager





PHONE (575) 393-2326 ° 101 E. MARLAND ° HOBBS, NM 88240

**Analytical Results For:**

APACHE CORP - HOBBS  
 BRUCE BAKER  
 2350 W. MARLAND BLVD.  
 HOBBS NM, 88240  
 Fax To: (575) 393-2432

Received: 06/09/2023  
 Reported: 06/14/2023  
 Project Name: WBDU #68  
 Project Number: NONE GIVEN  
 Project Location: NOT GIVEN

Sampling Date: 06/09/2023  
 Sampling Type: Soil  
 Sampling Condition: Cool & Intact  
 Sample Received By: Shalyn Rodriguez

**Sample ID: B 21 @ 6" (H232981-21)**

BTEx 8021B		mg/kg		Analyzed By: JH/						
Analyte	Result	Reporting Limit	Analyzed	Method Blank	BS	% Recovery	True Value QC	RPD	Qualifier	
Benzene*	<0.050	0.050	06/12/2023	ND	2.09	105	2.00	10.1		
Toluene*	<0.050	0.050	06/12/2023	ND	2.16	108	2.00	9.95		
Ethylbenzene*	<0.050	0.050	06/12/2023	ND	2.11	106	2.00	12.7		
Total Xylenes*	<0.150	0.150	06/12/2023	ND	6.54	109	6.00	12.6		
Total BTEX	<0.300	0.300	06/12/2023	ND						

Surrogate: 4-Bromofluorobenzene (PID) 104 % 71.5-134

Chloride, SM4500Cl-B		mg/kg		Analyzed By: AC						
Analyte	Result	Reporting Limit	Analyzed	Method Blank	BS	% Recovery	True Value QC	RPD	Qualifier	
Chloride	16.0	16.0	06/12/2023	ND	432	108	400	3.64		

TPH 8015M		mg/kg		Analyzed By: MS					
Analyte	Result	Reporting Limit	Analyzed	Method Blank	BS	% Recovery	True Value QC	RPD	Qualifier
GRO C6-C10*	<10.0	10.0	06/12/2023	ND	172	86.0	200	4.89	
DRO >C10-C28*	<10.0	10.0	06/12/2023	ND	149	74.7	200	9.63	
EXT DRO >C28-C36	<10.0	10.0	06/12/2023	ND					

Surrogate: 1-Chlorooctane 93.3 % 48.2-134

Surrogate: 1-Chlorooctadecane 100 % 49.1-148

Cardinal Laboratories

\*=Accredited Analyte

PLEASE NOTE: Liability and Damages. Cardinal's liability and client's exclusive remedy for any claim arising, whether based in contract or tort, shall be limited to the amount paid by client for analyses. All claims, including those for negligence and any other cause whatsoever shall be deemed waived unless made in writing and received by Cardinal within thirty (30) days after completion of the applicable service. In no event shall Cardinal be liable for incidental or consequential damages, including, without limitation, business interruptions, loss of use, or loss of profits incurred by client, its subsidiaries, affiliates or successors arising out of or related to the performance of the services hereunder by Cardinal, regardless of whether such claim is based upon any of the above stated reasons or otherwise. Results relate only to the samples identified above. This report shall not be reproduced except in full with written approval of Cardinal Laboratories.

Celey D. Keene, Lab Director/Quality Manager



PHONE (575) 393-2326 ° 101 E. MARLAND ° HOBBS, NM 88240

**Analytical Results For:**

APACHE CORP - HOBBS  
 BRUCE BAKER  
 2350 W. MARLAND BLVD.  
 HOBBS NM, 88240  
 Fax To: (575) 393-2432

Received: 06/09/2023  
 Reported: 06/14/2023  
 Project Name: WBDU #68  
 Project Number: NONE GIVEN  
 Project Location: NOT GIVEN

Sampling Date: 06/09/2023  
 Sampling Type: Soil  
 Sampling Condition: Cool & Intact  
 Sample Received By: Shalyn Rodriguez

**Sample ID: B 22 @ 6" (H232981-22)**

BTEx 8021B		mg/kg		Analyzed By: JH/					
Analyte	Result	Reporting Limit	Analyzed	Method Blank	BS	% Recovery	True Value QC	RPD	Qualifier
Benzene*	<0.050	0.050	06/12/2023	ND	2.09	105	2.00	10.1	
Toluene*	<0.050	0.050	06/12/2023	ND	2.16	108	2.00	9.95	
Ethylbenzene*	<0.050	0.050	06/12/2023	ND	2.11	106	2.00	12.7	
Total Xylenes*	<0.150	0.150	06/12/2023	ND	6.54	109	6.00	12.6	
Total BTEX	<0.300	0.300	06/12/2023	ND					

Surrogate: 4-Bromofluorobenzene (PID) 108 % 71.5-134

Chloride, SM4500Cl-B		mg/kg		Analyzed By: AC						
Analyte	Result	Reporting Limit	Analyzed	Method Blank	BS	% Recovery	True Value QC	RPD	Qualifier	
Chloride	32.0	16.0	06/12/2023	ND	432	108	400	3.64		

TPH 8015M		mg/kg		Analyzed By: MS					
Analyte	Result	Reporting Limit	Analyzed	Method Blank	BS	% Recovery	True Value QC	RPD	Qualifier
GRO C6-C10*	<10.0	10.0	06/12/2023	ND	172	86.0	200	4.89	
DRO >C10-C28*	<10.0	10.0	06/12/2023	ND	149	74.7	200	9.63	
EXT DRO >C28-C36	<10.0	10.0	06/12/2023	ND					

Surrogate: 1-Chlorooctane 93.9 % 48.2-134

Surrogate: 1-Chlorooctadecane 100 % 49.1-148

Cardinal Laboratories

\*=Accredited Analyte

PLEASE NOTE: Liability and Damages. Cardinal's liability and client's exclusive remedy for any claim arising, whether based in contract or tort, shall be limited to the amount paid by client for analyses. All claims, including those for negligence and any other cause whatsoever shall be deemed waived unless made in writing and received by Cardinal within thirty (30) days after completion of the applicable service. In no event shall Cardinal be liable for incidental or consequential damages, including, without limitation, business interruptions, loss of use, or loss of profits incurred by client, its subsidiaries, affiliates or successors arising out of or related to the performance of the services hereunder by Cardinal, regardless of whether such claim is based upon any of the above stated reasons or otherwise. Results relate only to the samples identified above. This report shall not be reproduced except in full with written approval of Cardinal Laboratories.

Celey D. Keene, Lab Director/Quality Manager



PHONE (575) 393-2326 ° 101 E. MARLAND ° HOBBS, NM 88240

**Analytical Results For:**

APACHE CORP - HOBBS  
 BRUCE BAKER  
 2350 W. MARLAND BLVD.  
 HOBBS NM, 88240  
 Fax To: (575) 393-2432

Received: 06/09/2023  
 Reported: 06/14/2023  
 Project Name: WBDU #68  
 Project Number: NONE GIVEN  
 Project Location: NOT GIVEN

Sampling Date: 06/09/2023  
 Sampling Type: Soil  
 Sampling Condition: Cool & Intact  
 Sample Received By: Shalyn Rodriguez

**Sample ID: B 23 @ 6" (H232981-23)**

BTEX 8021B		mg/kg		Analyzed By: JH/						
Analyte	Result	Reporting Limit	Analyzed	Method Blank	BS	% Recovery	True Value QC	RPD	Qualifier	
Benzene*	<0.050	0.050	06/12/2023	ND	2.09	105	2.00	10.1		
Toluene*	<0.050	0.050	06/12/2023	ND	2.16	108	2.00	9.95		
Ethylbenzene*	<0.050	0.050	06/12/2023	ND	2.11	106	2.00	12.7		
Total Xylenes*	<0.150	0.150	06/12/2023	ND	6.54	109	6.00	12.6		
Total BTEX	<0.300	0.300	06/12/2023	ND						

Surrogate: 4-Bromofluorobenzene (PID) 103 % 71.5-134

Chloride, SM4500Cl-B		mg/kg		Analyzed By: AC						
Analyte	Result	Reporting Limit	Analyzed	Method Blank	BS	% Recovery	True Value QC	RPD	Qualifier	
Chloride	640	16.0	06/12/2023	ND	432	108	400	3.64		

TPH 8015M		mg/kg		Analyzed By: MS					
Analyte	Result	Reporting Limit	Analyzed	Method Blank	BS	% Recovery	True Value QC	RPD	Qualifier
GRO C6-C10*	<10.0	10.0	06/12/2023	ND	172	86.0	200	4.89	
DRO >C10-C28*	<10.0	10.0	06/12/2023	ND	149	74.7	200	9.63	
EXT DRO >C28-C36	<10.0	10.0	06/12/2023	ND					

Surrogate: 1-Chlorooctane 93.8 % 48.2-134

Surrogate: 1-Chlorooctadecane 103 % 49.1-148

Cardinal Laboratories

\*=Accredited Analyte

PLEASE NOTE: Liability and Damages. Cardinal's liability and client's exclusive remedy for any claim arising, whether based in contract or tort, shall be limited to the amount paid by client for analyses. All claims, including those for negligence and any other cause whatsoever shall be deemed waived unless made in writing and received by Cardinal within thirty (30) days after completion of the applicable service. In no event shall Cardinal be liable for incidental or consequential damages, including, without limitation, business interruptions, loss of use, or loss of profits incurred by client, its subsidiaries, affiliates or successors arising out of or related to the performance of the services hereunder by Cardinal, regardless of whether such claim is based upon any of the above stated reasons or otherwise. Results relate only to the samples identified above. This report shall not be reproduced except in full with written approval of Cardinal Laboratories.

Celey D. Keene, Lab Director/Quality Manager



PHONE (575) 393-2326 ° 101 E. MARLAND ° HOBBS, NM 88240

**Analytical Results For:**

APACHE CORP - HOBBS  
 BRUCE BAKER  
 2350 W. MARLAND BLVD.  
 HOBBS NM, 88240  
 Fax To: (575) 393-2432

Received: 06/09/2023  
 Reported: 06/14/2023  
 Project Name: WBDU #68  
 Project Number: NONE GIVEN  
 Project Location: NOT GIVEN

Sampling Date: 06/09/2023  
 Sampling Type: Soil  
 Sampling Condition: Cool & Intact  
 Sample Received By: Shalyn Rodriguez

**Sample ID: B 24 @ 6" (H232981-24)**

BTEx 8021B		mg/kg		Analyzed By: JH/					
Analyte	Result	Reporting Limit	Analyzed	Method Blank	BS	% Recovery	True Value QC	RPD	Qualifier
Benzene*	<0.050	0.050	06/12/2023	ND	2.09	105	2.00	10.1	
Toluene*	<0.050	0.050	06/12/2023	ND	2.16	108	2.00	9.95	
Ethylbenzene*	<0.050	0.050	06/12/2023	ND	2.11	106	2.00	12.7	
Total Xylenes*	<0.150	0.150	06/12/2023	ND	6.54	109	6.00	12.6	
Total BTEX	<0.300	0.300	06/12/2023	ND					

Surrogate: 4-Bromofluorobenzene (PID) 109 % 71.5-134

Chloride, SM4500Cl-B		mg/kg		Analyzed By: AC					
Analyte	Result	Reporting Limit	Analyzed	Method Blank	BS	% Recovery	True Value QC	RPD	Qualifier
Chloride	288	16.0	06/12/2023	ND	432	108	400	3.64	

TPH 8015M		mg/kg		Analyzed By: MS					
Analyte	Result	Reporting Limit	Analyzed	Method Blank	BS	% Recovery	True Value QC	RPD	Qualifier
GRO C6-C10*	<10.0	10.0	06/12/2023	ND	172	86.0	200	4.89	
DRO >C10-C28*	<10.0	10.0	06/12/2023	ND	149	74.7	200	9.63	
EXT DRO >C28-C36	<10.0	10.0	06/12/2023	ND					

Surrogate: 1-Chlorooctane 97.7 % 48.2-134

Surrogate: 1-Chlorooctadecane 104 % 49.1-148

Cardinal Laboratories

\*=Accredited Analyte

PLEASE NOTE: Liability and Damages. Cardinal's liability and client's exclusive remedy for any claim arising, whether based in contract or tort, shall be limited to the amount paid by client for analyses. All claims, including those for negligence and any other cause whatsoever shall be deemed waived unless made in writing and received by Cardinal within thirty (30) days after completion of the applicable service. In no event shall Cardinal be liable for incidental or consequential damages, including, without limitation, business interruptions, loss of use, or loss of profits incurred by client, its subsidiaries, affiliates or successors arising out of or related to the performance of the services hereunder by Cardinal, regardless of whether such claim is based upon any of the above stated reasons or otherwise. Results relate only to the samples identified above. This report shall not be reproduced except in full with written approval of Cardinal Laboratories.

Celey D. Keene, Lab Director/Quality Manager



---

PHONE (575) 393-2326 • 101 E. MARLAND • HOBBS, NM 88240

---

### Notes and Definitions

QR-03	The RPD value for the sample duplicate or MS/MSD was outside of QC acceptance limits due to matrix interference. QC batch accepted based on LCS and/or LCSD recovery and/or RPD values.
ND	Analyte NOT DETECTED at or above the reporting limit
RPD	Relative Percent Difference
**	Samples not received at proper temperature of 6°C or below.
***	Insufficient time to reach temperature.
-	Chloride by SM4500Cl-B does not require samples be received at or below 6°C Samples reported on an as received basis (wet) unless otherwise noted on report

---

Cardinal Laboratories

\*=Accredited Analyte

PLEASE NOTE: Liability and Damages. Cardinal's liability and client's exclusive remedy for any claim arising, whether based in contract or tort, shall be limited to the amount paid by client for analyses. All claims, including those for negligence and any other cause whatsoever shall be deemed waived unless made in writing and received by Cardinal within thirty (30) days after completion of the applicable service. In no event shall Cardinal be liable for incidental or consequential damages, including, without limitation, business interruptions, loss of use, or loss of profits incurred by client, its subsidiaries, affiliates or successors arising out of or related to the performance of the services hereunder by Cardinal, regardless of whether such claim is based upon any of the above stated reasons or otherwise. Results relate only to the samples identified above. This report shall not be reproduced except in full with written approval of Cardinal Laboratories.

A handwritten signature in black ink, appearing to read "Celey D. Keene".

---

Celey D. Keene, Lab Director/Quality Manager



101 East Marland, Hobbs, NM 88240  
(575) 393-2326 FAX (575) 393-2476

### CHAIN-OF-CUSTODY AND ANALYSIS REQUEST

Company Name:		Project Manager:		Address:		City:		State:		Zip:		Phone #:		Project #:		Project Name:		Project Location:		Sampler Name:	
Apache		B. Baker				Hobbs		NM		88240								WBDU #68		Jose Quezada	
P.O. #:		Company:		Attn:		Address:		City:		State:		Zip:		Phone #:		Fax #:					
BILL TO		ANALYSIS REQUEST																			
FOR LAB USE ONLY		Lab I.D.		Sample I.D.		(G)RAB OR (C)OMP.		# CONTAINERS		GROUNDWATER		WASTEWATER		SOIL		OIL		SLUDGE		OTHER:	
		H232981				C		1													
		1 B1e2'				C		1													
		2 B2e6"				C		1													
		3 B3e6"				C		1													
		4 B4e6"				C		1													
		5 B5e6"				C		1													
		6 B6e6"				C		1													
		7 B7e6"				C		1													
		8 B8e6"				C		1													
		9 B9e6"				C		1													
		10 B10e6"				C		1													

PLEASE NOTE: Liability and Damages. Cardinal's liability and client's exclusive remedy for any claim arising whether based in contract or tort, shall be limited to the amount paid by the client for the analyses. All claims including those for negligence and any other cause whatsoever shall be deemed waived unless made in writing and received by Cardinal within 30 days after completion of the applicable service. In no event shall Cardinal be liable for incidental or consequential damages, including without limitation, business interruptions, loss of use, or loss of profits incurred by client, its subsidiaries, affiliates or successors arising out of or related to the performance of services hereunder by Cardinal, regardless of whether such claim is based upon any of the above stated reasons or otherwise.

Relinquished By: <i>Jose Quares</i>		Date: <i>6/19/22</i>	Received By: <i>Shodrick</i>		Verbal Result: <input type="checkbox"/> Yes <input type="checkbox"/> No Add'l Phone #:	
Relinquished By:		Time: <i>2:15</i>	Received By:		All Results are emailed. Please provide Email address:	
Delivered By: (Circle One)		Date:	CHECKED BY: (Initials) <i>SL</i>		REMARKS: <i>E-Mail Results</i>	
Sampler - UPS - Bus - Other:		Time:	Turnaround Time: <b>Standard</b> <input checked="" type="checkbox"/> <b>Rush</b> <input type="checkbox"/>		Bacteria (only) Sample Condition	
Observed Temp. °C <i>3.9</i>		Observed Temp. °C	Cool Intact <input checked="" type="checkbox"/> Yes <input type="checkbox"/> No		Cool Intact Observed Temp. °C	
Corrected Temp. °C <i>3.3</i>		Corrected Temp. °C	Thermometer ID #113		Yes <input type="checkbox"/> No <input type="checkbox"/>	
			Correction Factor -0.6°C		Yes <input type="checkbox"/> No <input type="checkbox"/> Corrected Temp. °C	

~~FORM-006 R 3.3 07/18/22~~

† Cardinal cannot accept verbal changes. Please email changes to [celey.keene@cardinallabsnm.com](mailto:celey.keene@cardinallabsnm.com)







101 East Marland, Hobbs, NM 88240  
(575) 393-2326 FAX (575) 393-2476

### CHAIN-OF-CUSTODY AND ANALYSIS REQUEST

Company Name:		Project Manager:		Address:		City:		Phone #:		Project #:		Project Name:		Project Location:		Sampler Name:	
Apache		B. Baker				Hobbs								WBDU #68		Jose	
State:		Zip:		Fax #:		Project Owner:		P.O. #:		Company:		Attn:		Address:		City:	
10M		88240															
State:		Zip:		Fax #:		Project Owner:		P.O. #:		Company:		Attn:		Address:		City:	
10M		88240															
State:		Zip:		Fax #:		Project Owner:		P.O. #:		Company:		Attn:		Address:		City:	
10M		88240															
State:		Zip:		Fax #:		Project Owner:		P.O. #:		Company:		Attn:		Address:		City:	
10M		88240															
State:		Zip:		Fax #:		Project Owner:		P.O. #:		Company:		Attn:		Address:		City:	
10M		88240															
State:		Zip:		Fax #:		Project Owner:		P.O. #:		Company:		Attn:		Address:		City:	
10M		88240															
State:		Zip:		Fax #:		Project Owner:		P.O. #:		Company:		Attn:		Address:		City:	
10M		88240															
State:		Zip:		Fax #:		Project Owner:		P.O. #:		Company:		Attn:		Address:		City:	
10M		88240															
State:		Zip:		Fax #:		Project Owner:		P.O. #:		Company:		Attn:		Address:		City:	
10M		88240															
State:		Zip:		Fax #:		Project Owner:		P.O. #:		Company:		Attn:		Address:		City:	
10M		88240															
State:		Zip:		Fax #:		Project Owner:		P.O. #:		Company:		Attn:		Address:		City:	
10M		88240															
State:		Zip:		Fax #:		Project Owner:		P.O. #:		Company:		Attn:		Address:		City:	
10M		88240															
State:		Zip:		Fax #:		Project Owner:		P.O. #:		Company:		Attn:		Address:		City:	
10M		88240															
State:		Zip:		Fax #:		Project Owner:		P.O. #:		Company:		Attn:		Address:		City:	
10M		88240															
State:		Zip:		Fax #:		Project Owner:		P.O. #:		Company:		Attn:		Address:		City:	
10M		88240															
State:		Zip:		Fax #:		Project Owner:		P.O. #:		Company:		Attn:		Address:		City:	
10M		88240															
State:		Zip:		Fax #:		Project Owner:		P.O. #:		Company:		Attn:		Address:		City:	
10M		88240															
State:		Zip:		Fax #:		Project Owner:		P.O. #:		Company:		Attn:		Address:		City:	
10M		88240															
State:		Zip:		Fax #:		Project Owner:		P.O. #:		Company:		Attn:		Address:		City:	
10M		88240															
State:		Zip:		Fax #:		Project Owner:		P.O. #:		Company:		Attn:		Address:		City:	
10M		88240															
State:		Zip:		Fax #:													

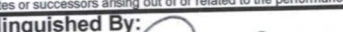
**PLEASE NOTE:** Liability and Damages. Cardinal's liability and client's exclusive remedy for any claim arising whether based in contract or tort, shall be limited to the amount paid by the client for the analyses. All claims including those for negligence and any other cause whatsoever shall be deemed waived unless made in writing and received by Cardinal within 30 days after completion of the applicable service. In no event shall Cardinal be liable for incidental or consequential damages, including without limitation, business interruptions, loss of use, or loss of profits incurred by client, its subsidiaries, or its affiliates, in any event arising out of or related to the performance of services hereunder by Cardinal, regardless of whether such claim is based upon any of the above stated reasons or otherwise.

Relinquished By: 		Date: 6/9/23	Received By: 	Verbal Result: <input type="checkbox"/> Yes <input type="checkbox"/> No Add'l Phone #:
Relinquished By:		Date:	Received By:	All Results are emailed. Please provide Email address:
Relinquished By:		Date:	Received By:	REMARKS: E-Mail Results
Delivered By: (Circle One)		Observed Temp. °C 3.9	Sample Condition Cool Intact	Turnaround Time: Standard <input checked="" type="checkbox"/> Rush <input type="checkbox"/>
Sampler - UPS - Bus - Other:		Corrected Temp. °C 3.3	<input type="checkbox"/> Yes <input type="checkbox"/> Yes <input type="checkbox"/> No <input type="checkbox"/> No	Thermometer ID #113 Correction Factor -0.6°C
			CHECKED BY: (Initials) SR	Bacteria (only) Sample Condition Cool Intact Observed Temp. °C <input type="checkbox"/> Yes <input type="checkbox"/> Yes <input type="checkbox"/> No <input type="checkbox"/> No Corrected Temp. °C

~~FORM-006 R 3.3 07/18/22~~



† Cardinal cannot accept verbal changes. Please email changes to [celey.keene@cardinallabsnm.com](mailto:celey.keene@cardinallabsnm.com)

101 East Marland, Hobbs, NM 88240  
(575) 393-2326 FAX (575) 393-2476

### CHAIN-OF-CUSTODY AND ANALYSIS REQUEST

[illegible]

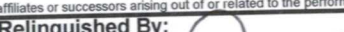
**PLEASE NOTE:** Liability and Damages. Cardinal's liability and client's exclusive remedy for any claim arising whether based in contract or tort, shall be limited to the amount paid by the client for the analyses. All claims including those for negligence and any other cause whatsoever shall be deemed waived unless made in writing and received by Cardinal within 30 days after completion of the applicable service. In no event shall Cardinal be liable for incidental or consequential damages, including without limitation, business interruptions, loss of use, or loss of profits incurred by client, its subsidiaries, affiliates or successors arising out of or related to the performance of services hereunder by Cardinal, regardless of whether such claim is based upon any of the above stated reasons or otherwise.

Relinquished By: 		Date: 4/4/23	Received By: 	Verbal Result: <input type="checkbox"/> Yes <input type="checkbox"/> No Add'l Phone #:
Relinquished By:		Time: 2:15	Received By:	All Results are emailed. Please provide Email address:
Delivered By: (Circle One)		Date:	REMARKS:	
Sampler - UPS - Bus - Other:		Time:	9-Mo'l Results	
Observed Temp. °C 3.9	Sample Condition Cool Intact	CHECKED BY: (Initials) 	Turnaround Time: Standard <input checked="" type="checkbox"/> Rush <input type="checkbox"/>	Bacteria (only) Sample Condition Cool Intact Observed Temp. °C
Corrected Temp. °C 3.3	<input checked="" type="checkbox"/> Yes <input type="checkbox"/> No		Thermometer ID #113	<input type="checkbox"/> Yes <input type="checkbox"/> No
			Correction Factor -0.6°C	<input type="checkbox"/> Yes <input type="checkbox"/> No Corrected Temp. °C



**District I**  
1625 N. French Dr., Hobbs, NM 88240  
Phone:(575) 393-6161 Fax:(575) 393-0720  
**District II**  
811 S. First St., Artesia, NM 88210  
Phone:(575) 748-1283 Fax:(575) 748-9720  
**District III**  
1000 Rio Brazos Rd., Aztec, NM 87410  
Phone:(505) 334-6178 Fax:(505) 334-6170  
**District IV**  
1220 S. St Francis Dr., Santa Fe, NM 87505  
Phone:(505) 476-3470 Fax:(505) 476-3462

**State of New Mexico**  
**Energy, Minerals and Natural Resources**  
**Oil Conservation Division**  
**1220 S. St Francis Dr.**  
**Santa Fe, NM 87505**

CONDITIONS  
  
Action 239050

CONDITIONS

Operator:  APACHE CORPORATION 303 Veterans Airpark Ln Midland, TX 79705	OGRID:  873
	Action Number:  239050
	Action Type:  [C-141] Release Corrective Action (C-141)

CONDITIONS

Created By	Condition	Condition Date
nvelez	Remediation has met 19.15.29 NMAC requirements. Soil impacts exceeding the reclamation standards have been left in place and are required to meet 19.15.29.13D (1) NMAC once the site is no longer reasonably needed for production or subsequent drilling operations.	10/3/2023