

Closure Report

INCIDENT ID#nNV2202857516

Site Description

Site Name:	BRAVO DOME UNIT 1934 -321A
Company:	Oxy USA, Inc.
Legal Description:	U/L A, Section 32, T19N, R34E
County:	HARDING County, NM
GPS Coordinates:	35.85859,-103.34228

Release Data

Date of Release:	11/11/2019
Type of Release:	PRODUCED WATER
Source of Release:	2 INCH POLY FLOWLINE
Volume of Release:	10 BBLS
Volume Recovered:	0 BBLS

Remediation Specifications

Remediation Parameters:	<p>OXY excavated the spill area as depicted on the following site diagram. The leak area SP 1 (TEAL BLUE shade on diagram) was excavated to a depth of 3' Feet. Leak area around SP2, SP3 SP4 (YELLOW shade on diagram) was be excavated to a depth of 4' Feet. OXY collected bottom and sidewall confirmation samples every 200 square feet.</p>
Remediation Activities:	9/10/2024-10/14/2024

Plan Sent to OCD:		
OCD Approval of Plan:		
Plan Sent to BLM:		
BLM Approval of Plan:		

Supporting Documentation

C-141, page 6	signed and included	
Site Diagram	Google Earth map with excavation depths & confirmation sample points	
Pictures	Remediation photos	
Lab Summary/Analysis	Confirmation lab summary/analysis report for 9/16/24 ,9/17/24 ,9/27/24	
Notifications	9/11/2024	

Request for Closure

Based on the completion of the remediation, OXY requests closure approval from the NMOCD. Cliff Brunson, President of BBC International Inc.	11/22/2024
---	------------

OXY, BRAVO DOME UNIT 1934 321A

LEAK DATE :11/11/19
UNION COUNTY, NM
ID#nNV2202857516

Legend

- 3' EXCAVATION
- 4' EXCAVATION
- BOTTOM CONFIRMATION SAMPLE POINT
- LEAK AREA
- SIDEWALL CONFIRMATION SAMPLE POINT

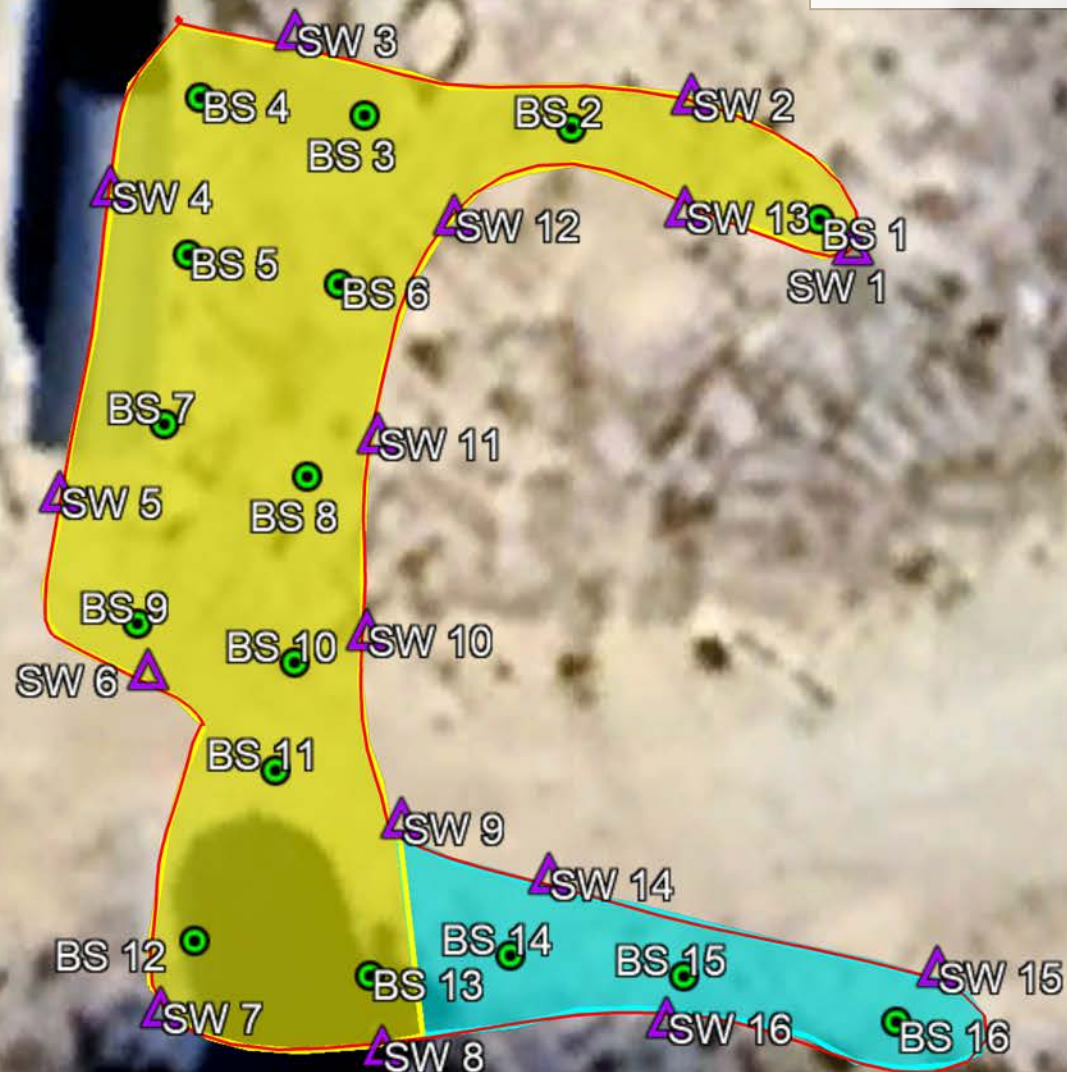

Google Earth



BRAVO DOME UNIT 1934 321A (11/11/19) SAMPLE DATE : 9/16/24-9/17/24

BOTTOM SAMPLE POINTS

BS 1@4'	N 35.838562	W-103.342133
BS 2@4'	N 35.838584	W-103.342209
BS 3@4'	N 35.838587	W-103.342272
BS 4@4'	N 35.838592	W-103.342322
BS 5@4'	N 35.838553	W-103.342326
BS 6@4'	N 35.838546	W-103.342280
BS 7@4'	N 35.838511	W-103.342333
BS 8@4'	N 35.838498	W-103.342289
BS 9@4'	N 35.838462	W-103.342341
BS 10@4'	N 35.838452	W-103.342293
BS 11@4'	N 35.838426	W-103.342299
BS 12@4'	N 35.838384	W-103.342323
BS 13@4'	N 35.838376	W-103.342270
BS 14@3'	N 35.838380	W-103.342227
BS 15@3'	N 35.838375	W-103.342175
BS 16@3'	N 35.838364	W-103.342110

SIDEWALL SAMPLE POINTS

SW 1	N 35.838555	W-103.342123
SW 2	N 35.838592	W-103.342173
SW 3	N 35.838608	W-103.342293
SW 4	N 35.838534	W-103.342357
SW 5	N 35.838494	W-103.342365
SW 6	N 35.838450	W-103.342338
SW 7	N 35.838367	W-103.342334
SW 8	N 35.838358	W-103.342267
SW 9	N 35.838413	W-103.342261
SW 10	N 35.838460	W-103.342272
SW 11	N 35.838508	W-103.342268
SW 12	N 35.838562	W-103.342245
SW 13	N 35.838564	W-103.342175
SW 14	N 35.838401	W-103.342214
SW 15	N 35.838377	W-103.342095
SW 16	N 35.838365	W-103.342181

	Sample ID	BS 1@4'	BS 2@4'	BS 3@4'	BS 4@4'	BS 5@4'	BS 6@4'	BS 7@4'	BS 8@4'	BS 9@4'	BS 10@4'	BS 11@4'	BS 12@4'	BS 13@4'	BS 14@4'	BS 15@4'	BS 16@4'
Analyte	Date	9/16/24	9/16/24	9/16/24	9/16/24	9/16/24	9/16/24	9/16/24	9/16/24	9/16/24	9/16/24	9/16/24	9/16/24	9/16/24	9/16/24	9/16/24	9/16/24
		mg/kg	mg/kg	mg/kg	mg/kg	mg/kg	mg/kg	mg/kg	mg/kg	mg/kg	mg/kg	mg/kg	mg/kg	mg/kg	mg/kg	mg/kg	mg/kg
Benzene		<0.050	<0.050	<0.050	<0.050	<0.050	<0.050	<0.050	<0.050	<0.050	<0.050	<0.050	<0.050	<0.050	<0.050	<0.050	<0.050
Toluene		<0.050	<0.050	<0.050	<0.050	<0.050	<0.050	<0.050	<0.050	<0.050	<0.050	<0.050	<0.050	<0.050	<0.050	<0.050	<0.050
Ethylbenzene		<0.050	<0.050	<0.050	<0.050	<0.050	<0.050	<0.050	<0.050	<0.050	<0.050	<0.050	<0.050	<0.050	<0.050	<0.050	<0.050
Total Xylenes		<0.150	<0.150	<0.150	<0.150	<0.150	<0.150	<0.150	<0.150	<0.150	<0.150	<0.150	<0.150	<0.150	<0.150	<0.150	<0.150
Total BTEX		<0.300	<0.300	<0.300	<0.300	<0.300	<0.300	<0.300	<0.300	<0.300	<0.300	<0.300	<0.300	<0.300	<0.300	<0.300	<0.300
Chloride		32.0	16.0	<16.0	<16.0	<16.0	<16.0	<16.0	<16.0	<16.0	32.0	<16.0	32.0	<16.0	<16.0	16.0	<16.0
GRO		<10.0	<10.0	<10.0	<10.0	<10.0	<10.0	<10.0	<10.0	<10.0	<10.0	<10.0	<10.0	<10.0	<10.0	<10.0	<10.0
DRO		<10.0	<10.0	<10.0	<10.0	<10.0	<10.0	<10.0	<10.0	<10.0	<10.0	<10.0	<10.0	<10.0	<10.0	<10.0	<10.0
EXT DRO		<10.0	<10.0	<10.0	<10.0	<10.0	<10.0	<10.0	<10.0	<10.0	<10.0	<10.0	<10.0	<10.0	<10.0	<10.0	<10.0

	Sample ID	SW 1	SW 2	SW 3	SW 4	SW 5	SW 6	SW 7	SW 8	SW 9	SW 10	SW 11	SW 12	SW 13	SW 14	SW 15	SW 16
Analyte	Date	9/16/24	9/16/24	9/16/24	9/17/24	9/17/24	9/17/24	9/17/24	9/17/24	9/17/24	9/17/24	9/17/24	9/17/24	9/17/24	9/17/24	9/17/24	9/17/24
		mg/kg	mg/kg	mg/kg	mg/kg	mg/kg	mg/kg	mg/kg	mg/kg	mg/kg	mg/kg	mg/kg	mg/kg	mg/kg	mg/kg	mg/kg	mg/kg
Benzene		<0.050	<0.050	<0.050	<0.050	<0.050	<0.050	<0.050	<0.050	<0.050	<0.050	<0.050	<0.050	<0.050	<0.050	<0.050	<0.050
Toluene		<0.050	<0.050	<0.050	<0.050	<0.050	<0.050	<0.050	<0.050	<0.050	<0.050	<0.050	<0.050	<0.050	<0.050	<0.050	<0.050
Ethylbenzene		<0.050	<0.050	<0.050	<0.050	<0.050	<0.050	<0.050	<0.050	<0.050	<0.050	<0.050	<0.050	<0.050	<0.050	<0.050	<0.050
Total Xylenes		<0.150	<0.150	<0.150	<0.150	<0.150	<0.150	<0.150	<0.150	<0.150	<0.150	<0.150	<0.150	<0.150	<0.150	<0.150	<0.150
Total BTEX		<0.300	<0.300	<0.300	<0.300	<0.300	<0.300	<0.300	<0.300	<0.300	<0.300	<0.300	<0.300	<0.300	<0.300	<0.300	<0.300
Chloride		<16.0	<16.0	<16.0	<16.0	<16.0	<16.0	<16.0	<16.0	<16.0	<16.0	<16.0	<16.0	<16.0	<16.0	16.0	16.0
GRO		<10.0	<10.0	<10.0	<10.0	<10.0	<10.0	<10.0	<10.0	<10.0	<10.0	<10.0	<10.0	<10.0	<10.0	<10.0	<10.0
DRO		<10.0	<10.0	<10.0	<10.0	<10.0	<10.0	<10.0	<10.0	<10.0	<10.0	<10.0	<10.0	<10.0	<10.0	<10.0	<10.0
EXT DRO		<10.0	<10.0	<10.0	<10.0	<10.0	<10.0	<10.0	<10.0	<10.0	<10.0	<10.0	<10.0	<10.0	<10.0	<10.0	<10.0

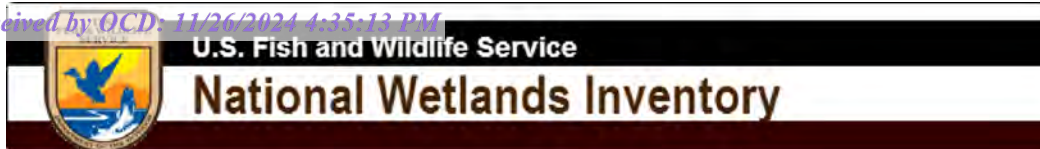

OXY, BRAVO DOME UNIT 1934 321A (11/



October 7, 2024

Wetlands

- Estuarine and Marine Deepwater
- Estuarine and Marine Wetland

- Freshwater Emergent Wetland
- Freshwater Forested/Shrub Wetland
- Freshwater Pond

- Lake
- Other
- Riverine

This map is for general reference only. The US Fish and Wildlife Service is not responsible for the accuracy or currentness of the base data shown on this map. All wetlands related data should be used in accordance with the layer metadata found on the Wetlands Mapper web site.

OXY, BRAVO DOME UNIT 1934 321A (11/11/19) 2,12 MILES OR 11,202.2 FEET TO WATER POD

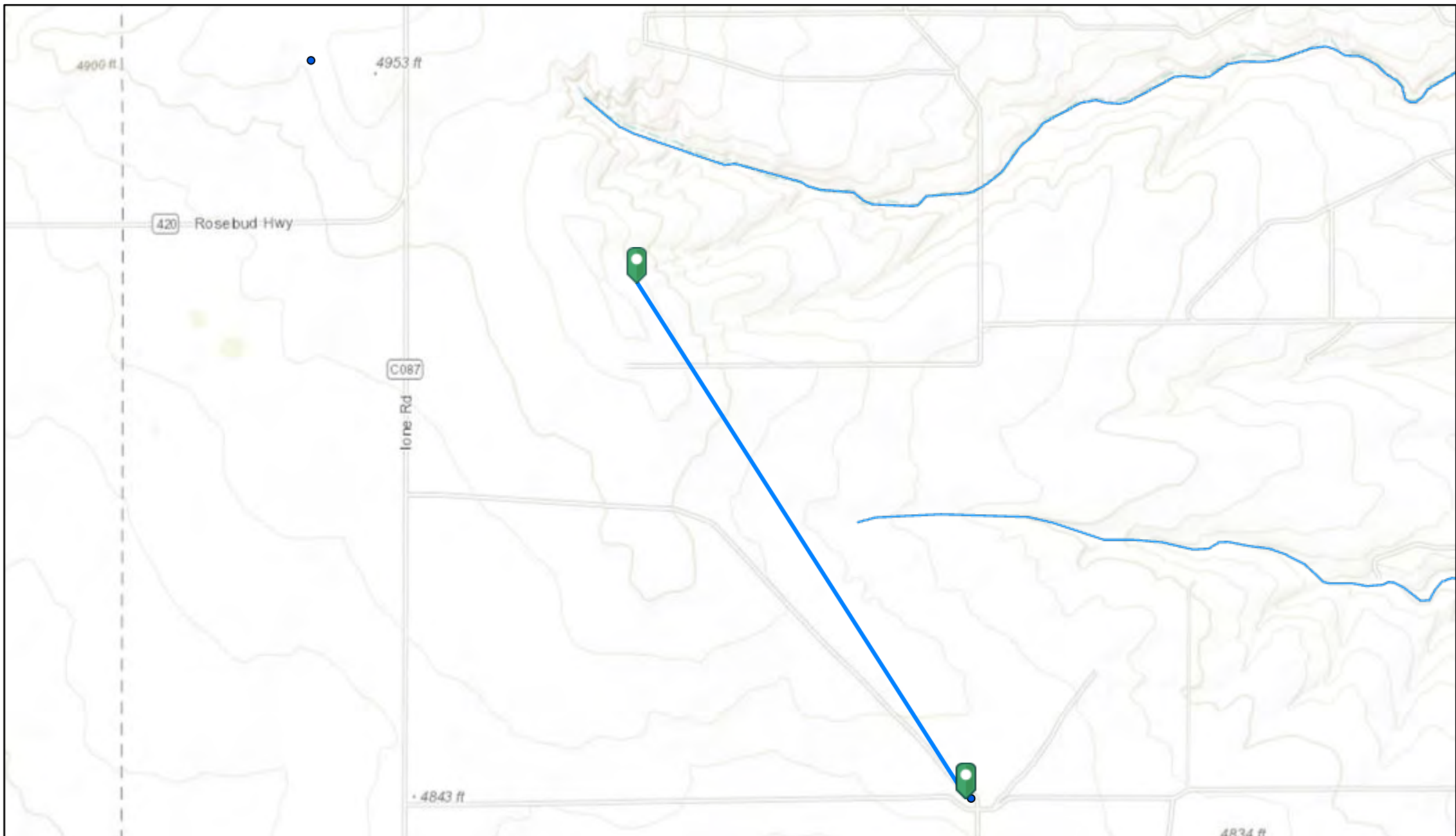

10/28/2024, 3:01:47 PM

- OSE Water PODs
- OSE Streams

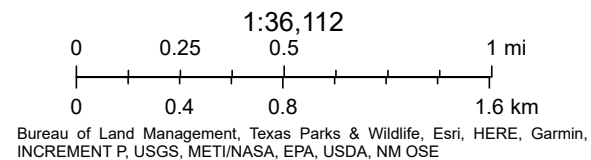

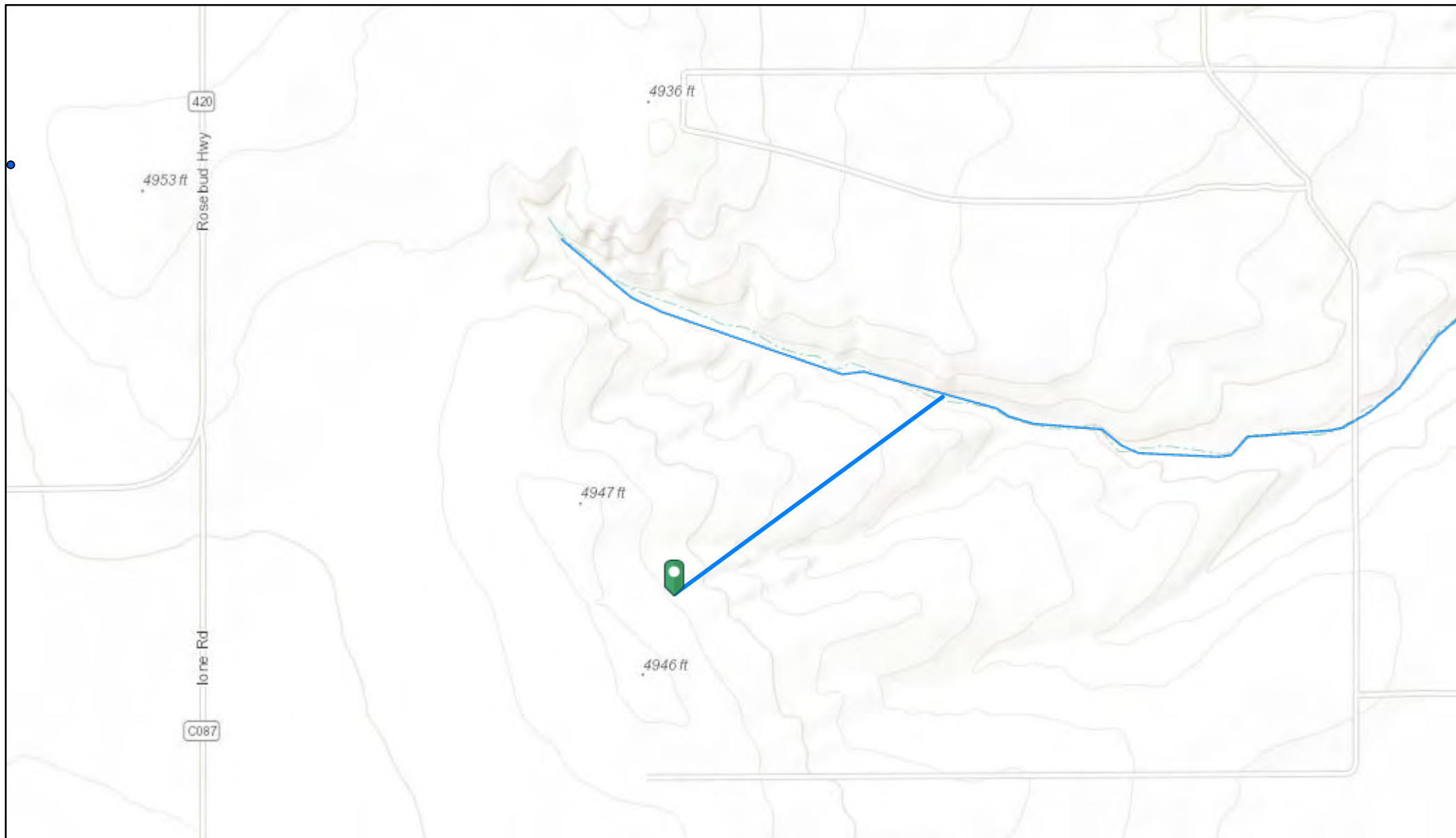

10/28/2024, 2:19:27 PM

- OSE Water PODs
- OSE Streams

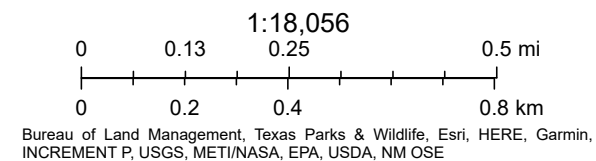



WELL RECORD & LOG

OFFICE OF THE STATE ENGINEER

www.ose.state.nm.us

Received

11/27/2023

Office of the State Engineer
District VII Cimarron Office

1. GENERAL AND WELL LOCATION	OSE POD NO. (WELL NO.) CT-2493 POD1		WELL TAG ID NO 70324		OSE FILE NO(S) CT-2493 POD1			
	WELL OWNER NAME(S) Kirk Fly				PHONE (OPTIONAL) 806-333-2176			
	WELL OWNER MAILING ADDRESS 28 Canyon View Dr				CITY STATE ZIP Dalhart TX 79022			
	WELL LOCATION (FROM GPS)	DEGREES LATITUDE 35.81238 35	MINUTES 48	SECONDS 44.568 N	* ACCURACY REQUIRED: ONE TENTH OF A SECOND * DATUM REQUIRED: WGS 84			
2. DRILLING & CASING INFORMATION	WELL LONGITUDE -103.32174 103		MINUTES 19		SECONDS 18.264 W			
	DESCRIPTION RELATING WELL LOCATION TO STREET ADDRESS AND COMMON LANDMARKS - PLSS (SECTION, TOWNSHIP, RANGE) WHERE AVAILABLE Section 4 Township 18N, Range 34E, Union County SE 1/4, SECTION 4, TOWNSHIP 18 NORTH, RANGE 34 EAST, N.M.P.M.							
	LICENSE NO. WD-1831		NAME OF LICENSED DRILLER Raymond Teeter		NAME OF WELL DRILLING COMPANY 3T Drilling, Inc.			
	DRILLING STARTED 09/19/2023	DRILLING ENDED 09/19/2023	DEPTH OF COMPLETED WELL (FT) 355	BORE HOLE DEPTH (FT) 168	DEPTH WATER FIRST ENCOUNTERED (FT) 168			
3. ANNULAR MATERIAL	COMPLETED WELL IS: <input type="checkbox"/> ARTESIAN *add Centralizer info below <input type="checkbox"/> DRY HOLE <input checked="" type="checkbox"/> SHALLOW (UNCONFINED)			STATIC WATER LEVEL IN COMPLETED WELL (FT) 168		DATE STATIC MEASURED 09/19/2023		
	DRILLING FLUID: <input type="checkbox"/> AIR <input checked="" type="checkbox"/> MUD ADDITIVES - SPECIFY:							
	DRILLING METHOD: <input checked="" type="checkbox"/> ROTARY <input type="checkbox"/> HAMMER <input type="checkbox"/> CABLE TOOL <input type="checkbox"/> OTHER - SPECIFY:					CHECK HERE IF PITLESS ADAPTER IS INSTALLED <input checked="" type="checkbox"/>		
	DEPTH (feet bgl)		BORE HOLE DIAM. (inches)	CASING MATERIAL AND/OR GRADE (include each casing string, and note sections of screen)	CASING CONNECTION TYPE (add coupling diameter)	CASING INSIDE DIAM. (inches)	CASING WALL THICKNESS (inches)	SLOT SIZE (inches)
	FROM	TO						
	0	30	12.25	PVC SDR 21	6-1/8	5	.0375	
	30	200	10	PVC SDR 21	6-1/8	5	.0375	
	200	345	10	PVC SDR 21 - PERF	6-1/8	5	.0375	.050
	345	355	10	PVC SDR 21	6-1/8	5	.0375	
DEPTH (feet bgl)		BORE HOLE DIAM. (inches)	LIST ANNULAR SEAL MATERIAL AND GRAVEL PACK SIZE-RANGE BY INTERVAL (if using Centralizers for Artesian wells- indicate the spacing below)	AMOUNT (cubic feet)	METHOD OF PLACEMENT			
FROM	TO							
0	30	12.25	Cement	21	Topfill			
30	355	10	Gravel # 1 Fine KS	133	Topfill			

FOR OSE INTERNAL USE STOCK

WR-20 WELL RECORD & LOG (Version 09/22/2022)

FILE NO. CT-2493

POD NO. POD1

TRN NO. 749184

Released to Imaging: 3/12/2025 4:28:03 AM

WELL TAG ID NO. 70324

PAGE 1 OF 2

[illegible]

Mike A. Hamman, P.E.
State Engineer



Cimarron Office
PO BOX 481
CIMARRON, NM 87714

STATE OF NEW MEXICO
OFFICE OF THE STATE ENGINEER

Trn Nbr: 749184
File Nbr: CT 02493
Well File Nbr: CT 02493 POD1

Oct. 31, 2023

KIRK FLY
28 CANYON VIEW DR.
DALHART, TX 79022

Greetings:

Enclosed is your copy of the well record for the above numbered permit, which has been accepted for filing.

Sincerely,

A handwritten signature in black ink, appearing to read "Katherine Behrendsen".

Katherine Behrendsen
(575) 376-2410

Enclosure

wellrrcv

**Coordinates****UTM - NAD 83 (m) - Zone 13**

Easting 651622.801

Northing 3964437.892

State Plane - NAD 83 (f) - Zone E

Easting 841266.655

Northing 1752534.598

Degrees Minutes Seconds

Latitude 35 : 48 : 44.568000

Longitude -103 : 19 : 18.264000

Location pulled from Coordinate Search

NEW MEXICO OFFICE
OF THE
STATE ENGINEER

1:18,056

N

**Image Info**

Source: Maxar

Date: 9/7/2021

Resolution (m): 0.5

Accuracy (m): 5

Spatial Information

Land Grant: Not in Land Grant

OSE Administrative Area: Union

County: Union

Groundwater Basin: Clayton

Sub-Basin: Punta de Agua

Abstract Area:

Clayton

Regulation Area:**Eastern Portion of the Clayton CMA****PLSS Description**

SESESESE Qtr of Sec 04 of 018N 034E

*Derived from CADNED: Qtr Sec. locations are
calculated and are only approximations*

POD Information

Owner: Kirk Fly

File Number: CT-2493

POD Status: NoData

Permit Status: NoData

Permit Use: NoData

Purpose: Livestock

JT

10/19/2023



CT-02493 POD1

Clayton Basin

Kirk Fly

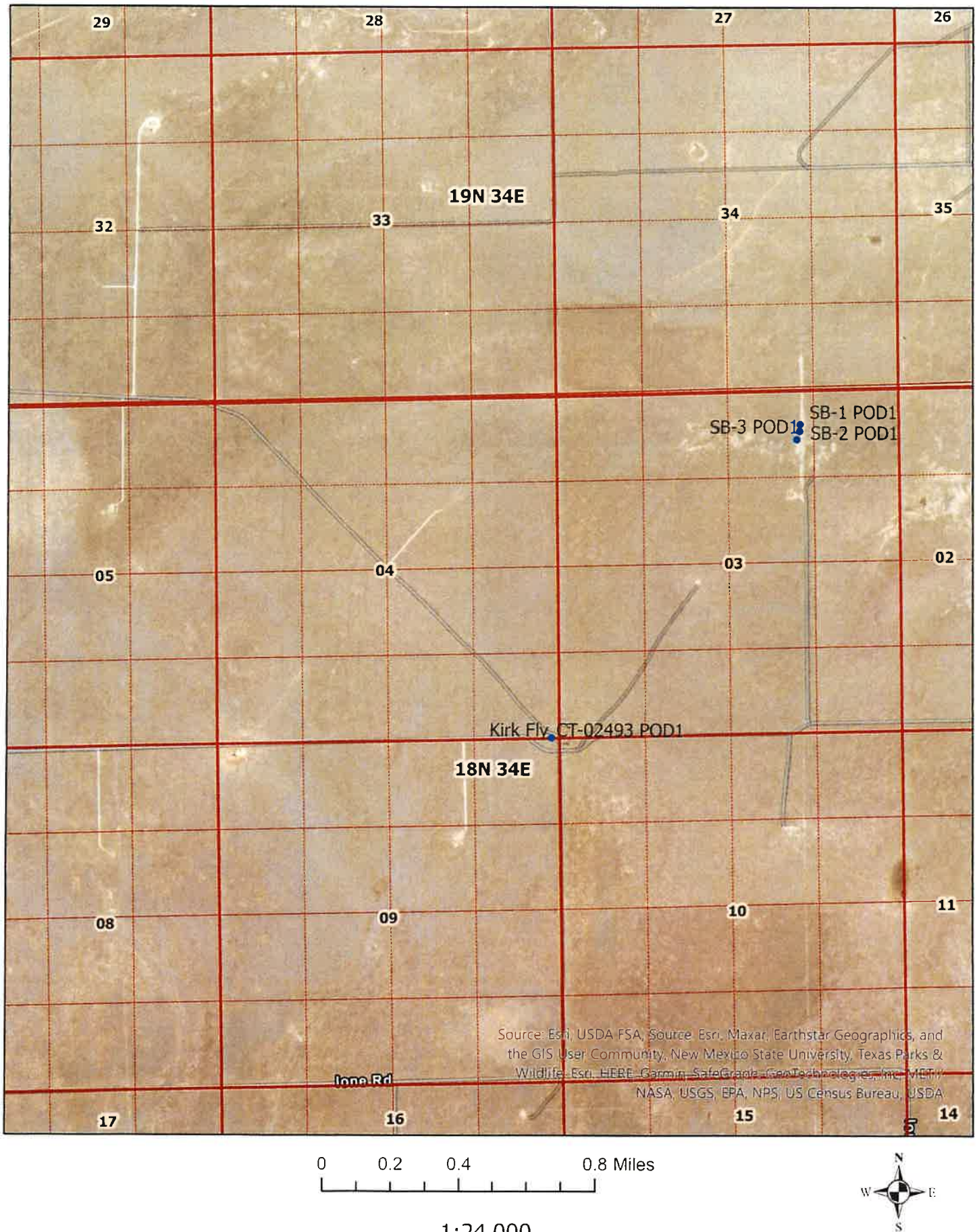



FEMA's National Flood Hazard Layer (NFHL) Viewer

with Web AppBuilder for ArcGIS



35.83859 -103.34228



Show search results for 35.83859 -10...

NFHL Print Tool

Input

Output

OutputMessage

FEMA has not completed a study to determine flood hazard for the selected location; therefore, a flood map has not been published at this time.

OutputFile

undefined: null

300ft

-103.34335, 35.840 Degrees

App State

Click to restore the map extent and layers' visibility where you left off.



BRAVO DOME UNIT 1934 321A (11/11/19)





BRAVO DOME UNIT 1934 321A (11/11/19)





BRAVO DOME UNIT 1934 321A (11/11/19)





BRAVO DOME UNIT 1934 321A (11/11/19)





BRAVO DOME UNIT 1934 321A (11/11/19)



BRAVO DOME UNIT 1934 321A (11/11/19)



BRAVO DOME UNIT 1934 321A (11/11/19)



BRAVO DOME UNIT 1934 321A (11/11/19)



BRAVO DOME UNIT 1934 321A (11/11/19)



BRAVO DOME UNIT 1934 321A (11/11/19)



BRAVO DOME UNIT 1934 321A (11/11/19)



BRAVO DOME UNIT 1934 321A (11/11/19)



BRAVO DOME UNIT 1934 321A (11/11/19)



BRAVO DOME UNIT 1934 321A (11/11/19)



BRAVO DOME UNIT 1934 321A (11/11/19)





PHONE (575) 393-2326 ° 101 E. MARLAND ° HOBBS, NM 88240

September 27, 2024

Cliff Brunson

BBC International, Inc.

P.O. Box 805

Hobbs, NM 88241

RE: BRAVO DOME #1934-321A

Enclosed are the results of analyses for samples received by the laboratory on 09/24/24 9:12.

Cardinal Laboratories is accredited through Texas NELAP under certificate number TX-C24-00112. Accreditation applies to drinking water, non-potable water and solid and chemical materials. All accredited analytes are denoted by an asterisk (*). For a complete list of accredited analytes and matrices visit the TCEQ website at www.tceq.texas.gov/field/qa/lab_accred_certif.html.

Cardinal Laboratories is accredited through the State of Colorado Department of Public Health and Environment for:

Method EPA 552.2	Haloacetic Acids (HAA-5)
Method EPA 524.2	Total Trihalomethanes (TTHM)
Method EPA 524.4	Regulated VOCs (V1, V2, V3)

Accreditation applies to public drinking water matrices.

This report meets NELAP requirements and is made up of a cover page, analytical results, and a copy of the original chain-of-custody. If you have any questions concerning this report, please feel free to contact me.

Sincerely,

A handwritten signature in black ink that reads "Celey D. Keene". The signature is written in a cursive, flowing style.

Celey D. Keene

Lab Director/Quality Manager



PHONE (575) 393-2326 ° 101 E. MARLAND ° HOBBS, NM 88240

Analytical Results For:

BBC International, Inc.
 Cliff Brunson
 P.O. Box 805
 Hobbs NM, 88241
 Fax To: (575) 397-0397

Received: 09/24/2024
 Reported: 09/27/2024
 Project Name: BRAVO DOME #1934-321A
 Project Number: (11/11/19)
 Project Location: OXY-UNION CO NM

Sampling Date: 09/16/2024
 Sampling Type: Soil
 Sampling Condition: Cool & Intact
 Sample Received By: Shalyn Rodriguez

Sample ID: BOTTOM SAMPLE 1 @ 4' (H245772-01)

BTEX 8021B		mg/kg	Analyzed By: JH						
Analyte	Result	Reporting Limit	Analyzed	Method Blank	BS	% Recovery	True Value QC	RPD	Qualifier
Benzene*	<0.050	0.050	09/25/2024	ND	1.98	98.8	2.00	6.67	
Toluene*	<0.050	0.050	09/25/2024	ND	2.07	103	2.00	6.73	
Ethylbenzene*	<0.050	0.050	09/25/2024	ND	2.14	107	2.00	8.29	
Total Xylenes*	<0.150	0.150	09/25/2024	ND	6.42	107	6.00	8.09	
Total BTEX	<0.300	0.300	09/25/2024	ND					

Surrogate: 4-Bromofluorobenzene (PID) 113 % 71.5-134

Chloride, SM4500Cl-B		mg/kg		Analyzed By: CT						
Analyte	Result	Reporting Limit	Analyzed	Method Blank	BS	% Recovery	True Value QC	RPD	Qualifier	
Chloride	32.0	16.0	09/25/2024	ND	416	104	400	3.77		

TPH 8015M		mg/kg		Analyzed By: MS					
Analyte	Result	Reporting Limit	Analyzed	Method Blank	BS	% Recovery	True Value QC	RPD	Qualifier
GRO C6-C10*	<10.0	10.0	09/25/2024	ND	221	110	200	2.77	
DRO >C10-C28*	<10.0	10.0	09/25/2024	ND	208	104	200	0.394	
EXT DRO >C28-C36	<10.0	10.0	09/25/2024	ND					

Surrogate: 1-Chlorooctane 89.5 % 48.2-134

Surrogate: 1-Chlorooctadecane 83.1 % 49.1-148

Cardinal Laboratories

*=Accredited Analyte

PLEASE NOTE: Liability and Damages. Cardinal's liability and client's exclusive remedy for any claim arising, whether based in contract or tort, shall be limited to the amount paid by client for analyses. All claims, including those for negligence and any other cause whatsoever shall be deemed waived unless made in writing and received by Cardinal within thirty (30) days after completion of the applicable service. In no event shall Cardinal be liable for incidental or consequential damages, including, without limitation, business interruptions, loss of use, or loss of profits incurred by client, its subsidiaries, affiliates or successors arising out of or related to the performance of the services hereunder by Cardinal, regardless of whether such claim is based upon any of the above stated reasons or otherwise. Results relate only to the samples identified above. This report shall not be reproduced except in full with written approval of Cardinal Laboratories.

Celey D. Keene, Lab Director/Quality Manager



PHONE (575) 393-2326 ° 101 E. MARLAND ° HOBBS, NM 88240

Analytical Results For:

BBC International, Inc.
 Cliff Brunson
 P.O. Box 805
 Hobbs NM, 88241
 Fax To: (575) 397-0397

Received: 09/24/2024
 Reported: 09/27/2024
 Project Name: BRAVO DOME #1934-321A
 Project Number: (11/11/19)
 Project Location: OXY-UNION CO NM

Sampling Date: 09/16/2024
 Sampling Type: Soil
 Sampling Condition: Cool & Intact
 Sample Received By: Shalyn Rodriguez

Sample ID: BOTTOM SAMPLE 2 @ 4' (H245772-02)

BTEx 8021B		mg/kg		Analyzed By: JH					
Analyte	Result	Reporting Limit	Analyzed	Method Blank	BS	% Recovery	True Value QC	RPD	Qualifier
Benzene*	<0.050	0.050	09/25/2024	ND	1.98	98.8	2.00	6.67	
Toluene*	<0.050	0.050	09/25/2024	ND	2.07	103	2.00	6.73	
Ethylbenzene*	<0.050	0.050	09/25/2024	ND	2.14	107	2.00	8.29	
Total Xylenes*	<0.150	0.150	09/25/2024	ND	6.42	107	6.00	8.09	
Total BTEX	<0.300	0.300	09/25/2024	ND					

Surrogate: 4-Bromofluorobenzene (PID) 106 % 71.5-134

Chloride, SM4500Cl-B		mg/kg		Analyzed By: CT					
Analyte	Result	Reporting Limit	Analyzed	Method Blank	BS	% Recovery	True Value QC	RPD	Qualifier
Chloride	16.0	16.0	09/25/2024	ND	416	104	400	3.77	

TPH 8015M		mg/kg		Analyzed By: MS					
Analyte	Result	Reporting Limit	Analyzed	Method Blank	BS	% Recovery	True Value QC	RPD	Qualifier
GRO C6-C10*	<10.0	10.0	09/25/2024	ND	221	110	200	2.77	
DRO >C10-C28*	<10.0	10.0	09/25/2024	ND	208	104	200	0.394	
EXT DRO >C28-C36	<10.0	10.0	09/25/2024	ND					

Surrogate: 1-Chlorooctane 92.1 % 48.2-134

Surrogate: 1-Chlorooctadecane 85.4 % 49.1-148

Cardinal Laboratories

*=Accredited Analyte

PLEASE NOTE: Liability and Damages. Cardinal's liability and client's exclusive remedy for any claim arising, whether based in contract or tort, shall be limited to the amount paid by client for analyses. All claims, including those for negligence and any other cause whatsoever shall be deemed waived unless made in writing and received by Cardinal within thirty (30) days after completion of the applicable service. In no event shall Cardinal be liable for incidental or consequential damages, including, without limitation, business interruptions, loss of use, or loss of profits incurred by client, its subsidiaries, affiliates or successors arising out of or related to the performance of the services hereunder by Cardinal, regardless of whether such claim is based upon any of the above stated reasons or otherwise. Results relate only to the samples identified above. This report shall not be reproduced except in full with written approval of Cardinal Laboratories.

Celey D. Keene, Lab Director/Quality Manager



PHONE (575) 393-2326 ° 101 E. MARLAND ° HOBBS, NM 88240

Analytical Results For:

BBC International, Inc.
 Cliff Brunson
 P.O. Box 805
 Hobbs NM, 88241
 Fax To: (575) 397-0397

Received: 09/24/2024
 Reported: 09/27/2024
 Project Name: BRAVO DOME #1934-321A
 Project Number: (11/11/19)
 Project Location: OXY-UNION CO NM

Sampling Date: 09/16/2024
 Sampling Type: Soil
 Sampling Condition: Cool & Intact
 Sample Received By: Shalyn Rodriguez

Sample ID: BOTTOM SAMPLE 3 @ 4' (H245772-03)

BTEx 8021B		mg/kg		Analyzed By: JH						
Analyte	Result	Reporting Limit	Analyzed	Method Blank	BS	% Recovery	True Value QC	RPD	Qualifier	
Benzene*	<0.050	0.050	09/25/2024	ND	1.98	98.8	2.00	6.67		
Toluene*	<0.050	0.050	09/25/2024	ND	2.07	103	2.00	6.73		
Ethylbenzene*	<0.050	0.050	09/25/2024	ND	2.14	107	2.00	8.29		
Total Xylenes*	<0.150	0.150	09/25/2024	ND	6.42	107	6.00	8.09		
Total BTEX	<0.300	0.300	09/25/2024	ND						

Surrogate: 4-Bromofluorobenzene (PID) 112 % 71.5-134

Chloride, SM4500Cl-B		mg/kg		Analyzed By: CT						
Analyte	Result	Reporting Limit	Analyzed	Method Blank	BS	% Recovery	True Value QC	RPD	Qualifier	
Chloride	<16.0	16.0	09/25/2024	ND	416	104	400	3.77		

TPH 8015M		mg/kg		Analyzed By: MS					
Analyte	Result	Reporting Limit	Analyzed	Method Blank	BS	% Recovery	True Value QC	RPD	Qualifier
GRO C6-C10*	<10.0	10.0	09/25/2024	ND	221	110	200	2.77	
DRO >C10-C28*	<10.0	10.0	09/25/2024	ND	208	104	200	0.394	
EXT DRO >C28-C36	<10.0	10.0	09/25/2024	ND					

Surrogate: 1-Chlorooctane 91.4 % 48.2-134

Surrogate: 1-Chlorooctadecane 84.9 % 49.1-148

Cardinal Laboratories

*=Accredited Analyte

PLEASE NOTE: Liability and Damages. Cardinal's liability and client's exclusive remedy for any claim arising, whether based in contract or tort, shall be limited to the amount paid by client for analyses. All claims, including those for negligence and any other cause whatsoever shall be deemed waived unless made in writing and received by Cardinal within thirty (30) days after completion of the applicable service. In no event shall Cardinal be liable for incidental or consequential damages, including, without limitation, business interruptions, loss of use, or loss of profits incurred by client, its subsidiaries, affiliates or successors arising out of or related to the performance of the services hereunder by Cardinal, regardless of whether such claim is based upon any of the above stated reasons or otherwise. Results relate only to the samples identified above. This report shall not be reproduced except in full with written approval of Cardinal Laboratories.

Celey D. Keene, Lab Director/Quality Manager



PHONE (575) 393-2326 ° 101 E. MARLAND ° HOBBS, NM 88240

Analytical Results For:

BBC International, Inc.
 Cliff Brunson
 P.O. Box 805
 Hobbs NM, 88241
 Fax To: (575) 397-0397

Received: 09/24/2024
 Reported: 09/27/2024
 Project Name: BRAVO DOME #1934-321A
 Project Number: (11/11/19)
 Project Location: OXY-UNION CO NM

Sampling Date: 09/16/2024
 Sampling Type: Soil
 Sampling Condition: Cool & Intact
 Sample Received By: Shalyn Rodriguez

Sample ID: BOTTOM SAMPLE 4 @ 4' (H245772-04)

BTEx 8021B		mg/kg		Analyzed By: JH						
Analyte	Result	Reporting Limit	Analyzed	Method Blank	BS	% Recovery	True Value QC	RPD	Qualifier	
Benzene*	<0.050	0.050	09/26/2024	ND	1.98	98.8	2.00	6.67		
Toluene*	<0.050	0.050	09/26/2024	ND	2.07	103	2.00	6.73		
Ethylbenzene*	<0.050	0.050	09/26/2024	ND	2.14	107	2.00	8.29		
Total Xylenes*	<0.150	0.150	09/26/2024	ND	6.42	107	6.00	8.09		
Total BTEX	<0.300	0.300	09/26/2024	ND						

Surrogate: 4-Bromofluorobenzene (PID) 115 % 71.5-134

Chloride, SM4500Cl-B		mg/kg		Analyzed By: CT						
Analyte	Result	Reporting Limit	Analyzed	Method Blank	BS	% Recovery	True Value QC	RPD	Qualifier	
Chloride	<16.0	16.0	09/25/2024	ND	416	104	400	3.77		

TPH 8015M		mg/kg		Analyzed By: MS					
Analyte	Result	Reporting Limit	Analyzed	Method Blank	BS	% Recovery	True Value QC	RPD	Qualifier
GRO C6-C10*	<10.0	10.0	09/25/2024	ND	221	110	200	2.77	
DRO >C10-C28*	<10.0	10.0	09/25/2024	ND	208	104	200	0.394	
EXT DRO >C28-C36	<10.0	10.0	09/25/2024	ND					

Surrogate: 1-Chlorooctane 75.0 % 48.2-134

Surrogate: 1-Chlorooctadecane 71.8 % 49.1-148

Cardinal Laboratories

*=Accredited Analyte

PLEASE NOTE: Liability and Damages. Cardinal's liability and client's exclusive remedy for any claim arising, whether based in contract or tort, shall be limited to the amount paid by client for analyses. All claims, including those for negligence and any other cause whatsoever shall be deemed waived unless made in writing and received by Cardinal within thirty (30) days after completion of the applicable service. In no event shall Cardinal be liable for incidental or consequential damages, including, without limitation, business interruptions, loss of use, or loss of profits incurred by client, its subsidiaries, affiliates or successors arising out of or related to the performance of the services hereunder by Cardinal, regardless of whether such claim is based upon any of the above stated reasons or otherwise. Results relate only to the samples identified above. This report shall not be reproduced except in full with written approval of Cardinal Laboratories.

Celey D. Keene, Lab Director/Quality Manager



PHONE (575) 393-2326 ° 101 E. MARLAND ° HOBBS, NM 88240

Analytical Results For:

BBC International, Inc.
 Cliff Brunson
 P.O. Box 805
 Hobbs NM, 88241
 Fax To: (575) 397-0397

Received: 09/24/2024
 Reported: 09/27/2024
 Project Name: BRAVO DOME #1934-321A
 Project Number: (11/11/19)
 Project Location: OXY-UNION CO NM

Sampling Date: 09/16/2024
 Sampling Type: Soil
 Sampling Condition: Cool & Intact
 Sample Received By: Shalyn Rodriguez

Sample ID: BOTTOM SAMPLE 5 @ 4' (H245772-05)

BTX 8021B		mg/kg		Analyzed By: JH						
Analyte	Result	Reporting Limit	Analyzed	Method Blank	BS	% Recovery	True Value QC	RPD	Qualifier	
Benzene*	<0.050	0.050	09/26/2024	ND	1.98	98.8	2.00	6.67		
Toluene*	<0.050	0.050	09/26/2024	ND	2.07	103	2.00	6.73		
Ethylbenzene*	<0.050	0.050	09/26/2024	ND	2.14	107	2.00	8.29		
Total Xylenes*	<0.150	0.150	09/26/2024	ND	6.42	107	6.00	8.09		
Total BTX	<0.300	0.300	09/26/2024	ND						

Surrogate: 4-Bromofluorobenzene (PID) 114 % 71.5-134

Chloride, SM4500CI-B		mg/kg		Analyzed By: CT						
Analyte	Result	Reporting Limit	Analyzed	Method Blank	BS	% Recovery	True Value QC	RPD	Qualifier	
Chloride	<16.0	16.0	09/25/2024	ND	416	104	400	3.77		

TPH 8015M		mg/kg		Analyzed By: MS					
Analyte	Result	Reporting Limit	Analyzed	Method Blank	BS	% Recovery	True Value QC	RPD	Qualifier
GRO C6-C10*	<10.0	10.0	09/25/2024	ND	221	110	200	2.77	
DRO >C10-C28*	<10.0	10.0	09/25/2024	ND	208	104	200	0.394	
EXT DRO >C28-C36	<10.0	10.0	09/25/2024	ND					

Surrogate: 1-Chlorooctane 73.8 % 48.2-134

Surrogate: 1-Chlorooctadecane 68.3 % 49.1-148

Cardinal Laboratories

*=Accredited Analyte

PLEASE NOTE: Liability and Damages. Cardinal's liability and client's exclusive remedy for any claim arising, whether based in contract or tort, shall be limited to the amount paid by client for analyses. All claims, including those for negligence and any other cause whatsoever shall be deemed waived unless made in writing and received by Cardinal within thirty (30) days after completion of the applicable service. In no event shall Cardinal be liable for incidental or consequential damages, including, without limitation, business interruptions, loss of use, or loss of profits incurred by client, its subsidiaries, affiliates or successors arising out of or related to the performance of the services hereunder by Cardinal, regardless of whether such claim is based upon any of the above stated reasons or otherwise. Results relate only to the samples identified above. This report shall not be reproduced except in full with written approval of Cardinal Laboratories.

Celey D. Keene, Lab Director/Quality Manager



PHONE (575) 393-2326 ° 101 E. MARLAND ° HOBBS, NM 88240

Analytical Results For:

BBC International, Inc.
 Cliff Brunson
 P.O. Box 805
 Hobbs NM, 88241
 Fax To: (575) 397-0397

Received: 09/24/2024
 Reported: 09/27/2024
 Project Name: BRAVO DOME #1934-321A
 Project Number: (11/11/19)
 Project Location: OXY-UNION CO NM

Sampling Date: 09/16/2024
 Sampling Type: Soil
 Sampling Condition: Cool & Intact
 Sample Received By: Shalyn Rodriguez

Sample ID: BOTTOM SAMPLE 6 @ 4' (H245772-06)

BTEx 8021B		mg/kg		Analyzed By: JH						
Analyte	Result	Reporting Limit	Analyzed	Method Blank	BS	% Recovery	True Value QC	RPD	Qualifier	
Benzene*	<0.050	0.050	09/26/2024	ND	1.98	98.8	2.00	6.67		
Toluene*	<0.050	0.050	09/26/2024	ND	2.07	103	2.00	6.73		
Ethylbenzene*	<0.050	0.050	09/26/2024	ND	2.14	107	2.00	8.29		
Total Xylenes*	<0.150	0.150	09/26/2024	ND	6.42	107	6.00	8.09		
Total BTEx	<0.300	0.300	09/26/2024	ND						

Surrogate: 4-Bromofluorobenzene (PID) 107 % 71.5-134

Chloride, SM4500CI-B		mg/kg		Analyzed By: CT						
Analyte	Result	Reporting Limit	Analyzed	Method Blank	BS	% Recovery	True Value QC	RPD	Qualifier	
Chloride	<16.0	16.0	09/25/2024	ND	416	104	400	3.77		

TPH 8015M		mg/kg		Analyzed By: MS					
Analyte	Result	Reporting Limit	Analyzed	Method Blank	BS	% Recovery	True Value QC	RPD	Qualifier
GRO C6-C10*	<10.0	10.0	09/25/2024	ND	221	110	200	2.77	
DRO >C10-C28*	<10.0	10.0	09/25/2024	ND	208	104	200	0.394	
EXT DRO >C28-C36	<10.0	10.0	09/25/2024	ND					

Surrogate: 1-Chlorooctane 87.7 % 48.2-134

Surrogate: 1-Chlorooctadecane 83.8 % 49.1-148

Cardinal Laboratories

*=Accredited Analyte

PLEASE NOTE: Liability and Damages. Cardinal's liability and client's exclusive remedy for any claim arising, whether based in contract or tort, shall be limited to the amount paid by client for analyses. All claims, including those for negligence and any other cause whatsoever shall be deemed waived unless made in writing and received by Cardinal within thirty (30) days after completion of the applicable service. In no event shall Cardinal be liable for incidental or consequential damages, including, without limitation, business interruptions, loss of use, or loss of profits incurred by client, its subsidiaries, affiliates or successors arising out of or related to the performance of the services hereunder by Cardinal, regardless of whether such claim is based upon any of the above stated reasons or otherwise. Results relate only to the samples identified above. This report shall not be reproduced except in full with written approval of Cardinal Laboratories.

Celey D. Keene, Lab Director/Quality Manager



PHONE (575) 393-2326 ° 101 E. MARLAND ° HOBBS, NM 88240

Analytical Results For:

BBC International, Inc.
 Cliff Brunson
 P.O. Box 805
 Hobbs NM, 88241
 Fax To: (575) 397-0397

Received: 09/24/2024
 Reported: 09/27/2024
 Project Name: BRAVO DOME #1934-321A
 Project Number: (11/11/19)
 Project Location: OXY-UNION CO NM

Sampling Date: 09/16/2024
 Sampling Type: Soil
 Sampling Condition: Cool & Intact
 Sample Received By: Shalyn Rodriguez

Sample ID: BOTTOM SAMPLE 7 @ 4' (H245772-07)

BTEx 8021B		mg/kg		Analyzed By: JH						
Analyte	Result	Reporting Limit	Analyzed	Method Blank	BS	% Recovery	True Value QC	RPD	Qualifier	
Benzene*	<0.050	0.050	09/26/2024	ND	1.98	98.8	2.00	6.67		
Toluene*	<0.050	0.050	09/26/2024	ND	2.07	103	2.00	6.73		
Ethylbenzene*	<0.050	0.050	09/26/2024	ND	2.14	107	2.00	8.29		
Total Xylenes*	<0.150	0.150	09/26/2024	ND	6.42	107	6.00	8.09		
Total BTEx	<0.300	0.300	09/26/2024	ND						

Surrogate: 4-Bromofluorobenzene (PID) 110 % 71.5-134

Chloride, SM4500CI-B		mg/kg		Analyzed By: CT						
Analyte	Result	Reporting Limit	Analyzed	Method Blank	BS	% Recovery	True Value QC	RPD	Qualifier	
Chloride	<16.0	16.0	09/25/2024	ND	416	104	400	3.77		

TPH 8015M		mg/kg		Analyzed By: MS					
Analyte	Result	Reporting Limit	Analyzed	Method Blank	BS	% Recovery	True Value QC	RPD	Qualifier
GRO C6-C10*	<10.0	10.0	09/25/2024	ND	221	110	200	2.77	
DRO >C10-C28*	<10.0	10.0	09/25/2024	ND	208	104	200	0.394	
EXT DRO >C28-C36	<10.0	10.0	09/25/2024	ND					

Surrogate: 1-Chlorooctane 88.6 % 48.2-134

Surrogate: 1-Chlorooctadecane 82.9 % 49.1-148

Cardinal Laboratories

*=Accredited Analyte

PLEASE NOTE: Liability and Damages. Cardinal's liability and client's exclusive remedy for any claim arising, whether based in contract or tort, shall be limited to the amount paid by client for analyses. All claims, including those for negligence and any other cause whatsoever shall be deemed waived unless made in writing and received by Cardinal within thirty (30) days after completion of the applicable service. In no event shall Cardinal be liable for incidental or consequential damages, including, without limitation, business interruptions, loss of use, or loss of profits incurred by client, its subsidiaries, affiliates or successors arising out of or related to the performance of the services hereunder by Cardinal, regardless of whether such claim is based upon any of the above stated reasons or otherwise. Results relate only to the samples identified above. This report shall not be reproduced except in full with written approval of Cardinal Laboratories.

Celey D. Keene, Lab Director/Quality Manager



PHONE (575) 393-2326 ° 101 E. MARLAND ° HOBBS, NM 88240

Analytical Results For:

BBC International, Inc.
 Cliff Brunson
 P.O. Box 805
 Hobbs NM, 88241
 Fax To: (575) 397-0397

Received: 09/24/2024
 Reported: 09/27/2024
 Project Name: BRAVO DOME #1934-321A
 Project Number: (11/11/19)
 Project Location: OXY-UNION CO NM

Sampling Date: 09/16/2024
 Sampling Type: Soil
 Sampling Condition: Cool & Intact
 Sample Received By: Shalyn Rodriguez

Sample ID: BOTTOM SAMPLE 8 @ 4' (H245772-08)

BTEx 8021B		mg/kg		Analyzed By: JH						
Analyte	Result	Reporting Limit	Analyzed	Method Blank	BS	% Recovery	True Value QC	RPD	Qualifier	
Benzene*	<0.050	0.050	09/26/2024	ND	1.98	98.8	2.00	6.67		
Toluene*	<0.050	0.050	09/26/2024	ND	2.07	103	2.00	6.73		
Ethylbenzene*	<0.050	0.050	09/26/2024	ND	2.14	107	2.00	8.29		
Total Xylenes*	<0.150	0.150	09/26/2024	ND	6.42	107	6.00	8.09		
Total BTEx	<0.300	0.300	09/26/2024	ND						

Surrogate: 4-Bromofluorobenzene (PID) 113 % 71.5-134

Chloride, SM4500CI-B		mg/kg		Analyzed By: CT						
Analyte	Result	Reporting Limit	Analyzed	Method Blank	BS	% Recovery	True Value QC	RPD	Qualifier	
Chloride	<16.0	16.0	09/25/2024	ND	416	104	400	3.77		

TPH 8015M		mg/kg		Analyzed By: MS					
Analyte	Result	Reporting Limit	Analyzed	Method Blank	BS	% Recovery	True Value QC	RPD	Qualifier
GRO C6-C10*	<10.0	10.0	09/25/2024	ND	221	110	200	2.77	
DRO >C10-C28*	<10.0	10.0	09/25/2024	ND	208	104	200	0.394	
EXT DRO >C28-C36	<10.0	10.0	09/25/2024	ND					

Surrogate: 1-Chlorooctane 91.2 % 48.2-134

Surrogate: 1-Chlorooctadecane 84.6 % 49.1-148

Cardinal Laboratories

*=Accredited Analyte

PLEASE NOTE: Liability and Damages. Cardinal's liability and client's exclusive remedy for any claim arising, whether based in contract or tort, shall be limited to the amount paid by client for analyses. All claims, including those for negligence and any other cause whatsoever shall be deemed waived unless made in writing and received by Cardinal within thirty (30) days after completion of the applicable service. In no event shall Cardinal be liable for incidental or consequential damages, including, without limitation, business interruptions, loss of use, or loss of profits incurred by client, its subsidiaries, affiliates or successors arising out of or related to the performance of the services hereunder by Cardinal, regardless of whether such claim is based upon any of the above stated reasons or otherwise. Results relate only to the samples identified above. This report shall not be reproduced except in full with written approval of Cardinal Laboratories.

Celey D. Keene, Lab Director/Quality Manager



PHONE (575) 393-2326 ° 101 E. MARLAND ° HOBBS, NM 88240

Analytical Results For:

BBC International, Inc.
 Cliff Brunson
 P.O. Box 805
 Hobbs NM, 88241
 Fax To: (575) 397-0397

Received: 09/24/2024
 Reported: 09/27/2024
 Project Name: BRAVO DOME #1934-321A
 Project Number: (11/11/19)
 Project Location: OXY-UNION CO NM

Sampling Date: 09/16/2024
 Sampling Type: Soil
 Sampling Condition: Cool & Intact
 Sample Received By: Shalyn Rodriguez

Sample ID: BOTTOM SAMPLE 9 @ 4' (H245772-09)

BTEx 8021B		mg/kg		Analyzed By: JH						
Analyte	Result	Reporting Limit	Analyzed	Method Blank	BS	% Recovery	True Value QC	RPD	Qualifier	
Benzene*	<0.050	0.050	09/26/2024	ND	1.98	98.8	2.00	6.67		
Toluene*	<0.050	0.050	09/26/2024	ND	2.07	103	2.00	6.73		
Ethylbenzene*	<0.050	0.050	09/26/2024	ND	2.14	107	2.00	8.29		
Total Xylenes*	<0.150	0.150	09/26/2024	ND	6.42	107	6.00	8.09		
Total BTEx	<0.300	0.300	09/26/2024	ND						

Surrogate: 4-Bromofluorobenzene (PID) 109 % 71.5-134

Chloride, SM4500CI-B		mg/kg		Analyzed By: AC						
Analyte	Result	Reporting Limit	Analyzed	Method Blank	BS	% Recovery	True Value QC	RPD	Qualifier	
Chloride	<16.0	16.0	09/25/2024	ND	400	100	400	3.92		

TPH 8015M		mg/kg		Analyzed By: MS					
Analyte	Result	Reporting Limit	Analyzed	Method Blank	BS	% Recovery	True Value QC	RPD	Qualifier
GRO C6-C10*	<10.0	10.0	09/25/2024	ND	221	110	200	2.77	
DRO >C10-C28*	<10.0	10.0	09/25/2024	ND	208	104	200	0.394	
EXT DRO >C28-C36	<10.0	10.0	09/25/2024	ND					

Surrogate: 1-Chlorooctane 82.5 % 48.2-134

Surrogate: 1-Chlorooctadecane 76.1 % 49.1-148

Cardinal Laboratories

*=Accredited Analyte

PLEASE NOTE: Liability and Damages. Cardinal's liability and client's exclusive remedy for any claim arising, whether based in contract or tort, shall be limited to the amount paid by client for analyses. All claims, including those for negligence and any other cause whatsoever shall be deemed waived unless made in writing and received by Cardinal within thirty (30) days after completion of the applicable service. In no event shall Cardinal be liable for incidental or consequential damages, including, without limitation, business interruptions, loss of use, or loss of profits incurred by client, its subsidiaries, affiliates or successors arising out of or related to the performance of the services hereunder by Cardinal, regardless of whether such claim is based upon any of the above stated reasons or otherwise. Results relate only to the samples identified above. This report shall not be reproduced except in full with written approval of Cardinal Laboratories.

Celey D. Keene, Lab Director/Quality Manager



PHONE (575) 393-2326 ° 101 E. MARLAND ° HOBBS, NM 88240

Analytical Results For:

BBC International, Inc.
 Cliff Brunson
 P.O. Box 805
 Hobbs NM, 88241
 Fax To: (575) 397-0397

Received: 09/24/2024
 Reported: 09/27/2024
 Project Name: BRAVO DOME #1934-321A
 Project Number: (11/11/19)
 Project Location: OXY-UNION CO NM

Sampling Date: 09/16/2024
 Sampling Type: Soil
 Sampling Condition: Cool & Intact
 Sample Received By: Shalyn Rodriguez

Sample ID: BOTTOM SAMPLE 10 @ 4' (H245772-10)

BTEx 8021B		mg/kg		Analyzed By: JH						
Analyte	Result	Reporting Limit	Analyzed	Method Blank	BS	% Recovery	True Value QC	RPD	Qualifier	
Benzene*	<0.050	0.050	09/26/2024	ND	1.98	98.8	2.00	6.67		
Toluene*	<0.050	0.050	09/26/2024	ND	2.07	103	2.00	6.73		
Ethylbenzene*	<0.050	0.050	09/26/2024	ND	2.14	107	2.00	8.29		
Total Xylenes*	<0.150	0.150	09/26/2024	ND	6.42	107	6.00	8.09		
Total BTEx	<0.300	0.300	09/26/2024	ND						

Surrogate: 4-Bromofluorobenzene (PID) 111 % 71.5-134

Chloride, SM4500CI-B		mg/kg		Analyzed By: AC					
Analyte	Result	Reporting Limit	Analyzed	Method Blank	BS	% Recovery	True Value QC	RPD	Qualifier
Chloride	32.0	16.0	09/25/2024	ND	400	100	400	3.92	

TPH 8015M		mg/kg		Analyzed By: MS					
Analyte	Result	Reporting Limit	Analyzed	Method Blank	BS	% Recovery	True Value QC	RPD	Qualifier
GRO C6-C10*	<10.0	10.0	09/25/2024	ND	221	110	200	2.77	
DRO >C10-C28*	<10.0	10.0	09/25/2024	ND	208	104	200	0.394	
EXT DRO >C28-C36	<10.0	10.0	09/25/2024	ND					

Surrogate: 1-Chlorooctane 76.6 % 48.2-134

Surrogate: 1-Chlorooctadecane 70.3 % 49.1-148

Cardinal Laboratories

*=Accredited Analyte

PLEASE NOTE: Liability and Damages. Cardinal's liability and client's exclusive remedy for any claim arising, whether based in contract or tort, shall be limited to the amount paid by client for analyses. All claims, including those for negligence and any other cause whatsoever shall be deemed waived unless made in writing and received by Cardinal within thirty (30) days after completion of the applicable service. In no event shall Cardinal be liable for incidental or consequential damages, including, without limitation, business interruptions, loss of use, or loss of profits incurred by client, its subsidiaries, affiliates or successors arising out of or related to the performance of the services hereunder by Cardinal, regardless of whether such claim is based upon any of the above stated reasons or otherwise. Results relate only to the samples identified above. This report shall not be reproduced except in full with written approval of Cardinal Laboratories.

Celey D. Keene, Lab Director/Quality Manager



PHONE (575) 393-2326 ° 101 E. MARLAND ° HOBBS, NM 88240

Analytical Results For:

BBC International, Inc.
 Cliff Brunson
 P.O. Box 805
 Hobbs NM, 88241
 Fax To: (575) 397-0397

Received: 09/24/2024
 Reported: 09/27/2024
 Project Name: BRAVO DOME #1934-321A
 Project Number: (11/11/19)
 Project Location: OXY-UNION CO NM

Sampling Date: 09/16/2024
 Sampling Type: Soil
 Sampling Condition: Cool & Intact
 Sample Received By: Shalyn Rodriguez

Sample ID: BOTTOM SAMPLE 11 @ 4' (H245772-11)

BTEx 8021B		mg/kg		Analyzed By: JH						
Analyte	Result	Reporting Limit	Analyzed	Method Blank	BS	% Recovery	True Value QC	RPD	Qualifier	
Benzene*	<0.050	0.050	09/26/2024	ND	1.98	98.8	2.00	6.67		
Toluene*	<0.050	0.050	09/26/2024	ND	2.07	103	2.00	6.73		
Ethylbenzene*	<0.050	0.050	09/26/2024	ND	2.14	107	2.00	8.29		
Total Xylenes*	<0.150	0.150	09/26/2024	ND	6.42	107	6.00	8.09		
Total BTEx	<0.300	0.300	09/26/2024	ND						

Surrogate: 4-Bromofluorobenzene (PID) 113 % 71.5-134

Chloride, SM4500CI-B		mg/kg		Analyzed By: AC						
Analyte	Result	Reporting Limit	Analyzed	Method Blank	BS	% Recovery	True Value QC	RPD	Qualifier	
Chloride	<16.0	16.0	09/25/2024	ND	400	100	400	3.92		

TPH 8015M		mg/kg		Analyzed By: MS					
Analyte	Result	Reporting Limit	Analyzed	Method Blank	BS	% Recovery	True Value QC	RPD	Qualifier
GRO C6-C10*	<10.0	10.0	09/25/2024	ND	221	110	200	2.77	
DRO >C10-C28*	<10.0	10.0	09/25/2024	ND	208	104	200	0.394	
EXT DRO >C28-C36	<10.0	10.0	09/25/2024	ND					

Surrogate: 1-Chlorooctane 85.1 % 48.2-134

Surrogate: 1-Chlorooctadecane 74.4 % 49.1-148

Cardinal Laboratories

*=Accredited Analyte

PLEASE NOTE: Liability and Damages. Cardinal's liability and client's exclusive remedy for any claim arising, whether based in contract or tort, shall be limited to the amount paid by client for analyses. All claims, including those for negligence and any other cause whatsoever shall be deemed waived unless made in writing and received by Cardinal within thirty (30) days after completion of the applicable service. In no event shall Cardinal be liable for incidental or consequential damages, including, without limitation, business interruptions, loss of use, or loss of profits incurred by client, its subsidiaries, affiliates or successors arising out of or related to the performance of the services hereunder by Cardinal, regardless of whether such claim is based upon any of the above stated reasons or otherwise. Results relate only to the samples identified above. This report shall not be reproduced except in full with written approval of Cardinal Laboratories.

Celey D. Keene, Lab Director/Quality Manager



PHONE (575) 393-2326 ° 101 E. MARLAND ° HOBBS, NM 88240

Analytical Results For:

BBC International, Inc.
 Cliff Brunson
 P.O. Box 805
 Hobbs NM, 88241
 Fax To: (575) 397-0397

Received: 09/24/2024
 Reported: 09/27/2024
 Project Name: BRAVO DOME #1934-321A
 Project Number: (11/11/19)
 Project Location: OXY-UNION CO NM

Sampling Date: 09/16/2024
 Sampling Type: Soil
 Sampling Condition: Cool & Intact
 Sample Received By: Shalyn Rodriguez

Sample ID: BOTTOM SAMPLE 12 @ 4' (H245772-12)

BTEx 8021B		mg/kg		Analyzed By: JH					
Analyte	Result	Reporting Limit	Analyzed	Method Blank	BS	% Recovery	True Value QC	RPD	Qualifier
Benzene*	<0.050	0.050	09/25/2024	ND	1.94	96.8	2.00	4.29	
Toluene*	<0.050	0.050	09/25/2024	ND	1.95	97.6	2.00	5.53	
Ethylbenzene*	<0.050	0.050	09/25/2024	ND	2.05	102	2.00	6.03	
Total Xylenes*	<0.150	0.150	09/25/2024	ND	6.13	102	6.00	6.19	
Total BTEX	<0.300	0.300	09/25/2024	ND					

Surrogate: 4-Bromofluorobenzene (PID) 101 % 71.5-134

Chloride, SM4500Cl-B		mg/kg		Analyzed By: AC					
Analyte	Result	Reporting Limit	Analyzed	Method Blank	BS	% Recovery	True Value QC	RPD	Qualifier
Chloride	32.0	16.0	09/25/2024	ND	400	100	400	3.92	

TPH 8015M		mg/kg		Analyzed By: MS					
Analyte	Result	Reporting Limit	Analyzed	Method Blank	BS	% Recovery	True Value QC	RPD	Qualifier
GRO C6-C10*	<10.0	10.0	09/25/2024	ND	221	110	200	2.77	
DRO >C10-C28*	<10.0	10.0	09/25/2024	ND	208	104	200	0.394	
EXT DRO >C28-C36	<10.0	10.0	09/25/2024	ND					

Surrogate: 1-Chlorooctane 93.6 % 48.2-134

Surrogate: 1-Chlorooctadecane 85.5 % 49.1-148

Cardinal Laboratories

*=Accredited Analyte

PLEASE NOTE: Liability and Damages. Cardinal's liability and client's exclusive remedy for any claim arising, whether based in contract or tort, shall be limited to the amount paid by client for analyses. All claims, including those for negligence and any other cause whatsoever shall be deemed waived unless made in writing and received by Cardinal within thirty (30) days after completion of the applicable service. In no event shall Cardinal be liable for incidental or consequential damages, including, without limitation, business interruptions, loss of use, or loss of profits incurred by client, its subsidiaries, affiliates or successors arising out of or related to the performance of the services hereunder by Cardinal, regardless of whether such claim is based upon any of the above stated reasons or otherwise. Results relate only to the samples identified above. This report shall not be reproduced except in full with written approval of Cardinal Laboratories.

Celey D. Keene, Lab Director/Quality Manager



PHONE (575) 393-2326 ° 101 E. MARLAND ° HOBBS, NM 88240

Analytical Results For:

BBC International, Inc.
 Cliff Brunson
 P.O. Box 805
 Hobbs NM, 88241
 Fax To: (575) 397-0397

Received: 09/24/2024
 Reported: 09/27/2024
 Project Name: BRAVO DOME #1934-321A
 Project Number: (11/11/19)
 Project Location: OXY-UNION CO NM

Sampling Date: 09/16/2024
 Sampling Type: Soil
 Sampling Condition: Cool & Intact
 Sample Received By: Shalyn Rodriguez

Sample ID: BOTTOM SAMPLE 13 @ 4' (H245772-13)

BTX 8021B		mg/kg		Analyzed By: JH						
Analyte	Result	Reporting Limit	Analyzed	Method Blank	BS	% Recovery	True Value QC	RPD	Qualifier	
Benzene*	<0.050	0.050	09/25/2024	ND	1.94	96.8	2.00	4.29		
Toluene*	<0.050	0.050	09/25/2024	ND	1.95	97.6	2.00	5.53		
Ethylbenzene*	<0.050	0.050	09/25/2024	ND	2.05	102	2.00	6.03		
Total Xylenes*	<0.150	0.150	09/25/2024	ND	6.13	102	6.00	6.19		
Total BTX	<0.300	0.300	09/25/2024	ND						

Surrogate: 4-Bromofluorobenzene (PID) 101 % 71.5-134

Chloride, SM4500CI-B		mg/kg		Analyzed By: AC						
Analyte	Result	Reporting Limit	Analyzed	Method Blank	BS	% Recovery	True Value QC	RPD	Qualifier	
Chloride	<16.0	16.0	09/25/2024	ND	400	100	400	3.92		

TPH 8015M		mg/kg		Analyzed By: MS					
Analyte	Result	Reporting Limit	Analyzed	Method Blank	BS	% Recovery	True Value QC	RPD	Qualifier
GRO C6-C10*	<10.0	10.0	09/25/2024	ND	221	110	200	2.77	
DRO >C10-C28*	<10.0	10.0	09/25/2024	ND	208	104	200	0.394	
EXT DRO >C28-C36	<10.0	10.0	09/25/2024	ND					

Surrogate: 1-Chlorooctane 87.0 % 48.2-134

Surrogate: 1-Chlorooctadecane 81.3 % 49.1-148

Cardinal Laboratories

*=Accredited Analyte

PLEASE NOTE: Liability and Damages. Cardinal's liability and client's exclusive remedy for any claim arising, whether based in contract or tort, shall be limited to the amount paid by client for analyses. All claims, including those for negligence and any other cause whatsoever shall be deemed waived unless made in writing and received by Cardinal within thirty (30) days after completion of the applicable service. In no event shall Cardinal be liable for incidental or consequential damages, including, without limitation, business interruptions, loss of use, or loss of profits incurred by client, its subsidiaries, affiliates or successors arising out of or related to the performance of the services hereunder by Cardinal, regardless of whether such claim is based upon any of the above stated reasons or otherwise. Results relate only to the samples identified above. This report shall not be reproduced except in full with written approval of Cardinal Laboratories.

Celey D. Keene, Lab Director/Quality Manager



PHONE (575) 393-2326 ° 101 E. MARLAND ° HOBBS, NM 88240

Analytical Results For:

BBC International, Inc.
 Cliff Brunson
 P.O. Box 805
 Hobbs NM, 88241
 Fax To: (575) 397-0397

Received: 09/24/2024
 Reported: 09/27/2024
 Project Name: BRAVO DOME #1934-321A
 Project Number: (11/11/19)
 Project Location: OXY-UNION CO NM

Sampling Date: 09/16/2024
 Sampling Type: Soil
 Sampling Condition: Cool & Intact
 Sample Received By: Shalyn Rodriguez

Sample ID: BOTTOM SAMPLE 14 @ 4' (H245772-14)

BTEx 8021B		mg/kg		Analyzed By: JH						
Analyte	Result	Reporting Limit	Analyzed	Method Blank	BS	% Recovery	True Value QC	RPD	Qualifier	
Benzene*	<0.050	0.050	09/25/2024	ND	1.94	96.8	2.00	4.29		
Toluene*	<0.050	0.050	09/25/2024	ND	1.95	97.6	2.00	5.53		
Ethylbenzene*	<0.050	0.050	09/25/2024	ND	2.05	102	2.00	6.03		
Total Xylenes*	<0.150	0.150	09/25/2024	ND	6.13	102	6.00	6.19		
Total BTEX	<0.300	0.300	09/25/2024	ND						

Surrogate: 4-Bromofluorobenzene (PID) 99.9 % 71.5-134

Chloride, SM4500CI-B		mg/kg		Analyzed By: AC						
Analyte	Result	Reporting Limit	Analyzed	Method Blank	BS	% Recovery	True Value QC	RPD	Qualifier	
Chloride	<16.0	16.0	09/25/2024	ND	400	100	400	3.92		

TPH 8015M		mg/kg		Analyzed By: MS					
Analyte	Result	Reporting Limit	Analyzed	Method Blank	BS	% Recovery	True Value QC	RPD	Qualifier
GRO C6-C10*	<10.0	10.0	09/25/2024	ND	221	110	200	2.77	
DRO >C10-C28*	<10.0	10.0	09/25/2024	ND	208	104	200	0.394	
EXT DRO >C28-C36	<10.0	10.0	09/25/2024	ND					

Surrogate: 1-Chlorooctane 81.4 % 48.2-134

Surrogate: 1-Chlorooctadecane 75.0 % 49.1-148

Cardinal Laboratories

*=Accredited Analyte

PLEASE NOTE: Liability and Damages. Cardinal's liability and client's exclusive remedy for any claim arising, whether based in contract or tort, shall be limited to the amount paid by client for analyses. All claims, including those for negligence and any other cause whatsoever shall be deemed waived unless made in writing and received by Cardinal within thirty (30) days after completion of the applicable service. In no event shall Cardinal be liable for incidental or consequential damages, including, without limitation, business interruptions, loss of use, or loss of profits incurred by client, its subsidiaries, affiliates or successors arising out of or related to the performance of the services hereunder by Cardinal, regardless of whether such claim is based upon any of the above stated reasons or otherwise. Results relate only to the samples identified above. This report shall not be reproduced except in full with written approval of Cardinal Laboratories.

Celey D. Keene, Lab Director/Quality Manager



PHONE (575) 393-2326 ° 101 E. MARLAND ° HOBBS, NM 88240

Analytical Results For:

BBC International, Inc.
 Cliff Brunson
 P.O. Box 805
 Hobbs NM, 88241
 Fax To: (575) 397-0397

Received: 09/24/2024
 Reported: 09/27/2024
 Project Name: BRAVO DOME #1934-321A
 Project Number: (11/11/19)
 Project Location: OXY-UNION CO NM

Sampling Date: 09/16/2024
 Sampling Type: Soil
 Sampling Condition: Cool & Intact
 Sample Received By: Shalyn Rodriguez

Sample ID: BOTTOM SAMPLE 15 @ 4' (H245772-15)

BTEx 8021B		mg/kg		Analyzed By: JH						
Analyte	Result	Reporting Limit	Analyzed	Method Blank	BS	% Recovery	True Value QC	RPD	Qualifier	
Benzene*	<0.050	0.050	09/25/2024	ND	1.94	96.8	2.00	4.29		
Toluene*	<0.050	0.050	09/25/2024	ND	1.95	97.6	2.00	5.53		
Ethylbenzene*	<0.050	0.050	09/25/2024	ND	2.05	102	2.00	6.03		
Total Xylenes*	<0.150	0.150	09/25/2024	ND	6.13	102	6.00	6.19		
Total BTEX	<0.300	0.300	09/25/2024	ND						

Surrogate: 4-Bromofluorobenzene (PID) 99.4 % 71.5-134

Chloride, SM4500CI-B		mg/kg		Analyzed By: AC					
Analyte	Result	Reporting Limit	Analyzed	Method Blank	BS	% Recovery	True Value QC	RPD	Qualifier
Chloride	16.0	16.0	09/25/2024	ND	400	100	400	3.92	

TPH 8015M		mg/kg		Analyzed By: MS					
Analyte	Result	Reporting Limit	Analyzed	Method Blank	BS	% Recovery	True Value QC	RPD	Qualifier
GRO C6-C10*	<10.0	10.0	09/25/2024	ND	216	108	200	1.25	
DRO >C10-C28*	<10.0	10.0	09/25/2024	ND	210	105	200	1.15	
EXT DRO >C28-C36	<10.0	10.0	09/25/2024	ND					

Surrogate: 1-Chlorooctane 97.6 % 48.2-134

Surrogate: 1-Chlorooctadecane 97.3 % 49.1-148

Cardinal Laboratories

*=Accredited Analyte

PLEASE NOTE: Liability and Damages. Cardinal's liability and client's exclusive remedy for any claim arising, whether based in contract or tort, shall be limited to the amount paid by client for analyses. All claims, including those for negligence and any other cause whatsoever shall be deemed waived unless made in writing and received by Cardinal within thirty (30) days after completion of the applicable service. In no event shall Cardinal be liable for incidental or consequential damages, including, without limitation, business interruptions, loss of use, or loss of profits incurred by client, its subsidiaries, affiliates or successors arising out of or related to the performance of the services hereunder by Cardinal, regardless of whether such claim is based upon any of the above stated reasons or otherwise. Results relate only to the samples identified above. This report shall not be reproduced except in full with written approval of Cardinal Laboratories.

Celey D. Keene, Lab Director/Quality Manager



PHONE (575) 393-2326 ° 101 E. MARLAND ° HOBBS, NM 88240

Analytical Results For:

BBC International, Inc.
 Cliff Brunson
 P.O. Box 805
 Hobbs NM, 88241
 Fax To: (575) 397-0397

Received: 09/24/2024
 Reported: 09/27/2024
 Project Name: BRAVO DOME #1934-321A
 Project Number: (11/11/19)
 Project Location: OXY-UNION CO NM

Sampling Date: 09/16/2024
 Sampling Type: Soil
 Sampling Condition: Cool & Intact
 Sample Received By: Shalyn Rodriguez

Sample ID: BOTTOM SAMPLE 16 @ 4' (H245772-16)

BTEx 8021B		mg/kg		Analyzed By: JH						
Analyte	Result	Reporting Limit	Analyzed	Method Blank	BS	% Recovery	True Value QC	RPD	Qualifier	
Benzene*	<0.050	0.050	09/25/2024	ND	1.94	96.8	2.00	4.29		
Toluene*	<0.050	0.050	09/25/2024	ND	1.95	97.6	2.00	5.53		
Ethylbenzene*	<0.050	0.050	09/25/2024	ND	2.05	102	2.00	6.03		
Total Xylenes*	<0.150	0.150	09/25/2024	ND	6.13	102	6.00	6.19		
Total BTEX	<0.300	0.300	09/25/2024	ND						

Surrogate: 4-Bromofluorobenzene (PID) 100 % 71.5-134

Chloride, SM4500CI-B		mg/kg		Analyzed By: AC						
Analyte	Result	Reporting Limit	Analyzed	Method Blank	BS	% Recovery	True Value QC	RPD	Qualifier	
Chloride	<16.0	16.0	09/25/2024	ND	400	100	400	3.92		

TPH 8015M		mg/kg		Analyzed By: MS					
Analyte	Result	Reporting Limit	Analyzed	Method Blank	BS	% Recovery	True Value QC	RPD	Qualifier
GRO C6-C10*	<10.0	10.0	09/25/2024	ND	216	108	200	1.25	
DRO >C10-C28*	<10.0	10.0	09/25/2024	ND	210	105	200	1.15	
EXT DRO >C28-C36	<10.0	10.0	09/25/2024	ND					

Surrogate: 1-Chlorooctane 96.8 % 48.2-134

Surrogate: 1-Chlorooctadecane 95.5 % 49.1-148

Cardinal Laboratories

*=Accredited Analyte

PLEASE NOTE: Liability and Damages. Cardinal's liability and client's exclusive remedy for any claim arising, whether based in contract or tort, shall be limited to the amount paid by client for analyses. All claims, including those for negligence and any other cause whatsoever shall be deemed waived unless made in writing and received by Cardinal within thirty (30) days after completion of the applicable service. In no event shall Cardinal be liable for incidental or consequential damages, including, without limitation, business interruptions, loss of use, or loss of profits incurred by client, its subsidiaries, affiliates or successors arising out of or related to the performance of the services hereunder by Cardinal, regardless of whether such claim is based upon any of the above stated reasons or otherwise. Results relate only to the samples identified above. This report shall not be reproduced except in full with written approval of Cardinal Laboratories.

Celey D. Keene, Lab Director/Quality Manager



PHONE (575) 393-2326 ° 101 E. MARLAND ° HOBBS, NM 88240

Analytical Results For:

BBC International, Inc.
 Cliff Brunson
 P.O. Box 805
 Hobbs NM, 88241
 Fax To: (575) 397-0397

Received: 09/24/2024
 Reported: 09/27/2024
 Project Name: BRAVO DOME #1934-321A
 Project Number: (11/11/19)
 Project Location: OXY-UNION CO NM

Sampling Date: 09/16/2024
 Sampling Type: Soil
 Sampling Condition: Cool & Intact
 Sample Received By: Shalyn Rodriguez

Sample ID: SIDEWALL 1 (H245772-17)

BTX 8021B		mg/kg		Analyzed By: JH					
Analyte	Result	Reporting Limit	Analyzed	Method Blank	BS	% Recovery	True Value QC	RPD	Qualifier
Benzene*	<0.050	0.050	09/25/2024	ND	1.94	96.8	2.00	4.29	
Toluene*	<0.050	0.050	09/25/2024	ND	1.95	97.6	2.00	5.53	
Ethylbenzene*	<0.050	0.050	09/25/2024	ND	2.05	102	2.00	6.03	
Total Xylenes*	<0.150	0.150	09/25/2024	ND	6.13	102	6.00	6.19	
Total BTX	<0.300	0.300	09/25/2024	ND					

Surrogate: 4-Bromofluorobenzene (PID) 99.5 % 71.5-134

Chloride, SM4500CI-B		mg/kg		Analyzed By: AC					
Analyte	Result	Reporting Limit	Analyzed	Method Blank	BS	% Recovery	True Value QC	RPD	Qualifier
Chloride	<16.0	16.0	09/25/2024	ND	400	100	400	3.92	

TPH 8015M		mg/kg		Analyzed By: MS					
Analyte	Result	Reporting Limit	Analyzed	Method Blank	BS	% Recovery	True Value QC	RPD	Qualifier
GRO C6-C10*	<10.0	10.0	09/25/2024	ND	216	108	200	1.25	
DRO >C10-C28*	<10.0	10.0	09/25/2024	ND	210	105	200	1.15	
EXT DRO >C28-C36	<10.0	10.0	09/25/2024	ND					

Surrogate: 1-Chlorooctane 97.8 % 48.2-134

Surrogate: 1-Chlorooctadecane 99.7 % 49.1-148

Cardinal Laboratories

*=Accredited Analyte

PLEASE NOTE: Liability and Damages. Cardinal's liability and client's exclusive remedy for any claim arising, whether based in contract or tort, shall be limited to the amount paid by client for analyses. All claims, including those for negligence and any other cause whatsoever shall be deemed waived unless made in writing and received by Cardinal within thirty (30) days after completion of the applicable service. In no event shall Cardinal be liable for incidental or consequential damages, including, without limitation, business interruptions, loss of use, or loss of profits incurred by client, its subsidiaries, affiliates or successors arising out of or related to the performance of the services hereunder by Cardinal, regardless of whether such claim is based upon any of the above stated reasons or otherwise. Results relate only to the samples identified above. This report shall not be reproduced except in full with written approval of Cardinal Laboratories.

Celey D. Keene, Lab Director/Quality Manager



PHONE (575) 393-2326 ° 101 E. MARLAND ° HOBBS, NM 88240

Analytical Results For:

BBC International, Inc.
 Cliff Brunson
 P.O. Box 805
 Hobbs NM, 88241
 Fax To: (575) 397-0397

Received: 09/24/2024
 Reported: 09/27/2024
 Project Name: BRAVO DOME #1934-321A
 Project Number: (11/11/19)
 Project Location: OXY-UNION CO NM

Sampling Date: 09/16/2024
 Sampling Type: Soil
 Sampling Condition: Cool & Intact
 Sample Received By: Shalyn Rodriguez

Sample ID: SIDEWALL 2 (H245772-18)

BTX 8021B		mg/kg		Analyzed By: JH						
Analyte	Result	Reporting Limit	Analyzed	Method Blank	BS	% Recovery	True Value QC	RPD	Qualifier	
Benzene*	<0.050	0.050	09/25/2024	ND	1.94	96.8	2.00	4.29		
Toluene*	<0.050	0.050	09/25/2024	ND	1.95	97.6	2.00	5.53		
Ethylbenzene*	<0.050	0.050	09/25/2024	ND	2.05	102	2.00	6.03		
Total Xylenes*	<0.150	0.150	09/25/2024	ND	6.13	102	6.00	6.19		
Total BTX	<0.300	0.300	09/25/2024	ND						

Surrogate: 4-Bromofluorobenzene (PID) 99.3 % 71.5-134

Chloride, SM4500CI-B		mg/kg		Analyzed By: AC						
Analyte	Result	Reporting Limit	Analyzed	Method Blank	BS	% Recovery	True Value QC	RPD	Qualifier	
Chloride	<16.0	16.0	09/25/2024	ND	400	100	400	3.92		

TPH 8015M		mg/kg		Analyzed By: MS					
Analyte	Result	Reporting Limit	Analyzed	Method Blank	BS	% Recovery	True Value QC	RPD	Qualifier
GRO C6-C10*	<10.0	10.0	09/25/2024	ND	216	108	200	1.25	
DRO >C10-C28*	<10.0	10.0	09/25/2024	ND	210	105	200	1.15	
EXT DRO >C28-C36	<10.0	10.0	09/25/2024	ND					

Surrogate: 1-Chlorooctane 94.6 % 48.2-134

Surrogate: 1-Chlorooctadecane 95.3 % 49.1-148

Cardinal Laboratories

*=Accredited Analyte

PLEASE NOTE: Liability and Damages. Cardinal's liability and client's exclusive remedy for any claim arising, whether based in contract or tort, shall be limited to the amount paid by client for analyses. All claims, including those for negligence and any other cause whatsoever shall be deemed waived unless made in writing and received by Cardinal within thirty (30) days after completion of the applicable service. In no event shall Cardinal be liable for incidental or consequential damages, including, without limitation, business interruptions, loss of use, or loss of profits incurred by client, its subsidiaries, affiliates or successors arising out of or related to the performance of the services hereunder by Cardinal, regardless of whether such claim is based upon any of the above stated reasons or otherwise. Results relate only to the samples identified above. This report shall not be reproduced except in full with written approval of Cardinal Laboratories.

Celey D. Keene, Lab Director/Quality Manager



PHONE (575) 393-2326 ° 101 E. MARLAND ° HOBBS, NM 88240

Analytical Results For:

BBC International, Inc.
 Cliff Brunson
 P.O. Box 805
 Hobbs NM, 88241
 Fax To: (575) 397-0397

Received: 09/24/2024
 Reported: 09/27/2024
 Project Name: BRAVO DOME #1934-321A
 Project Number: (11/11/19)
 Project Location: OXY-UNION CO NM

Sampling Date: 09/16/2024
 Sampling Type: Soil
 Sampling Condition: Cool & Intact
 Sample Received By: Shalyn Rodriguez

Sample ID: SIDEWALL 3 (H245772-19)

BTX 8021B		mg/kg		Analyzed By: JH					
Analyte	Result	Reporting Limit	Analyzed	Method Blank	BS	% Recovery	True Value QC	RPD	Qualifier
Benzene*	<0.050	0.050	09/25/2024	ND	1.94	96.8	2.00	4.29	
Toluene*	<0.050	0.050	09/25/2024	ND	1.95	97.6	2.00	5.53	
Ethylbenzene*	<0.050	0.050	09/25/2024	ND	2.05	102	2.00	6.03	
Total Xylenes*	<0.150	0.150	09/25/2024	ND	6.13	102	6.00	6.19	
Total BTX	<0.300	0.300	09/25/2024	ND					

Surrogate: 4-Bromofluorobenzene (PID) 101 % 71.5-134

Chloride, SM4500CI-B		mg/kg		Analyzed By: AC					
Analyte	Result	Reporting Limit	Analyzed	Method Blank	BS	% Recovery	True Value QC	RPD	Qualifier
Chloride	<16.0	16.0	09/25/2024	ND	400	100	400	3.92	

TPH 8015M		mg/kg		Analyzed By: MS					
Analyte	Result	Reporting Limit	Analyzed	Method Blank	BS	% Recovery	True Value QC	RPD	Qualifier
GRO C6-C10*	<10.0	10.0	09/25/2024	ND	216	108	200	1.25	
DRO >C10-C28*	<10.0	10.0	09/25/2024	ND	210	105	200	1.15	
EXT DRO >C28-C36	<10.0	10.0	09/25/2024	ND					

Surrogate: 1-Chlorooctane 96.2 % 48.2-134

Surrogate: 1-Chlorooctadecane 96.7 % 49.1-148

Cardinal Laboratories

*=Accredited Analyte

PLEASE NOTE: Liability and Damages. Cardinal's liability and client's exclusive remedy for any claim arising, whether based in contract or tort, shall be limited to the amount paid by client for analyses. All claims, including those for negligence and any other cause whatsoever shall be deemed waived unless made in writing and received by Cardinal within thirty (30) days after completion of the applicable service. In no event shall Cardinal be liable for incidental or consequential damages, including, without limitation, business interruptions, loss of use, or loss of profits incurred by client, its subsidiaries, affiliates or successors arising out of or related to the performance of the services hereunder by Cardinal, regardless of whether such claim is based upon any of the above stated reasons or otherwise. Results relate only to the samples identified above. This report shall not be reproduced except in full with written approval of Cardinal Laboratories.

Celey D. Keene, Lab Director/Quality Manager



PHONE (575) 393-2326 ° 101 E. MARLAND ° HOBBS, NM 88240

Analytical Results For:

BBC International, Inc.
 Cliff Brunson
 P.O. Box 805
 Hobbs NM, 88241
 Fax To: (575) 397-0397

Received: 09/24/2024
 Reported: 09/27/2024
 Project Name: BRAVO DOME #1934-321A
 Project Number: (11/11/19)
 Project Location: OXY-UNION CO NM

Sampling Date: 09/17/2024
 Sampling Type: Soil
 Sampling Condition: Cool & Intact
 Sample Received By: Shalyn Rodriguez

Sample ID: SIDEWALL 4 (H245772-20)

BTX 8021B		mg/kg		Analyzed By: JH						
Analyte	Result	Reporting Limit	Analyzed	Method Blank	BS	% Recovery	True Value QC	RPD	Qualifier	
Benzene*	<0.050	0.050	09/25/2024	ND	1.94	96.8	2.00	4.29		
Toluene*	<0.050	0.050	09/25/2024	ND	1.95	97.6	2.00	5.53		
Ethylbenzene*	<0.050	0.050	09/25/2024	ND	2.05	102	2.00	6.03		
Total Xylenes*	<0.150	0.150	09/25/2024	ND	6.13	102	6.00	6.19		
Total BTX	<0.300	0.300	09/25/2024	ND						

Surrogate: 4-Bromofluorobenzene (PID) 101 % 71.5-134

Chloride, SM4500CI-B		mg/kg		Analyzed By: AC						
Analyte	Result	Reporting Limit	Analyzed	Method Blank	BS	% Recovery	True Value QC	RPD	Qualifier	
Chloride	<16.0	16.0	09/25/2024	ND	400	100	400	3.92		

TPH 8015M		mg/kg		Analyzed By: MS					
Analyte	Result	Reporting Limit	Analyzed	Method Blank	BS	% Recovery	True Value QC	RPD	Qualifier
GRO C6-C10*	<10.0	10.0	09/25/2024	ND	216	108	200	1.25	
DRO >C10-C28*	<10.0	10.0	09/25/2024	ND	210	105	200	1.15	
EXT DRO >C28-C36	<10.0	10.0	09/25/2024	ND					

Surrogate: 1-Chlorooctane 98.2 % 48.2-134

Surrogate: 1-Chlorooctadecane 99.7 % 49.1-148

Cardinal Laboratories

*=Accredited Analyte

PLEASE NOTE: Liability and Damages. Cardinal's liability and client's exclusive remedy for any claim arising, whether based in contract or tort, shall be limited to the amount paid by client for analyses. All claims, including those for negligence and any other cause whatsoever shall be deemed waived unless made in writing and received by Cardinal within thirty (30) days after completion of the applicable service. In no event shall Cardinal be liable for incidental or consequential damages, including, without limitation, business interruptions, loss of use, or loss of profits incurred by client, its subsidiaries, affiliates or successors arising out of or related to the performance of the services hereunder by Cardinal, regardless of whether such claim is based upon any of the above stated reasons or otherwise. Results relate only to the samples identified above. This report shall not be reproduced except in full with written approval of Cardinal Laboratories.

Celey D. Keene, Lab Director/Quality Manager



PHONE (575) 393-2326 ° 101 E. MARLAND ° HOBBS, NM 88240

Analytical Results For:

BBC International, Inc.
 Cliff Brunson
 P.O. Box 805
 Hobbs NM, 88241
 Fax To: (575) 397-0397

Received: 09/24/2024
 Reported: 09/27/2024
 Project Name: BRAVO DOME #1934-321A
 Project Number: (11/11/19)
 Project Location: OXY-UNION CO NM

Sampling Date: 09/17/2024
 Sampling Type: Soil
 Sampling Condition: Cool & Intact
 Sample Received By: Shalyn Rodriguez

Sample ID: SIDEWALL 5 (H245772-21)

BTX 8021B		mg/kg		Analyzed By: JH						
Analyte	Result	Reporting Limit	Analyzed	Method Blank	BS	% Recovery	True Value QC	RPD	Qualifier	
Benzene*	<0.050	0.050	09/25/2024	ND	1.94	96.8	2.00	4.29		
Toluene*	<0.050	0.050	09/25/2024	ND	1.95	97.6	2.00	5.53		
Ethylbenzene*	<0.050	0.050	09/25/2024	ND	2.05	102	2.00	6.03		
Total Xylenes*	<0.150	0.150	09/25/2024	ND	6.13	102	6.00	6.19		
Total BTX	<0.300	0.300	09/25/2024	ND						

Surrogate: 4-Bromofluorobenzene (PID) 100 % 71.5-134

Chloride, SM4500CI-B		mg/kg		Analyzed By: AC						
Analyte	Result	Reporting Limit	Analyzed	Method Blank	BS	% Recovery	True Value QC	RPD	Qualifier	
Chloride	<16.0	16.0	09/25/2024	ND	400	100	400	3.92		

TPH 8015M		mg/kg		Analyzed By: MS					
Analyte	Result	Reporting Limit	Analyzed	Method Blank	BS	% Recovery	True Value QC	RPD	Qualifier
GRO C6-C10*	<10.0	10.0	09/25/2024	ND	216	108	200	1.25	
DRO >C10-C28*	<10.0	10.0	09/25/2024	ND	210	105	200	1.15	
EXT DRO >C28-C36	<10.0	10.0	09/25/2024	ND					

Surrogate: 1-Chlorooctane 105 % 48.2-134

Surrogate: 1-Chlorooctadecane 106 % 49.1-148

Cardinal Laboratories

*=Accredited Analyte

PLEASE NOTE: Liability and Damages. Cardinal's liability and client's exclusive remedy for any claim arising, whether based in contract or tort, shall be limited to the amount paid by client for analyses. All claims, including those for negligence and any other cause whatsoever shall be deemed waived unless made in writing and received by Cardinal within thirty (30) days after completion of the applicable service. In no event shall Cardinal be liable for incidental or consequential damages, including, without limitation, business interruptions, loss of use, or loss of profits incurred by client, its subsidiaries, affiliates or successors arising out of or related to the performance of the services hereunder by Cardinal, regardless of whether such claim is based upon any of the above stated reasons or otherwise. Results relate only to the samples identified above. This report shall not be reproduced except in full with written approval of Cardinal Laboratories.

Celey D. Keene, Lab Director/Quality Manager



PHONE (575) 393-2326 ° 101 E. MARLAND ° HOBBS, NM 88240

Analytical Results For:

BBC International, Inc.
 Cliff Brunson
 P.O. Box 805
 Hobbs NM, 88241
 Fax To: (575) 397-0397

Received: 09/24/2024
 Reported: 09/27/2024
 Project Name: BRAVO DOME #1934-321A
 Project Number: (11/11/19)
 Project Location: OXY-UNION CO NM

Sampling Date: 09/17/2024
 Sampling Type: Soil
 Sampling Condition: Cool & Intact
 Sample Received By: Shalyn Rodriguez

Sample ID: SIDEWALL 6 (H245772-22)

BTX 8021B		mg/kg		Analyzed By: JH					
Analyte	Result	Reporting Limit	Analyzed	Method Blank	BS	% Recovery	True Value QC	RPD	Qualifier
Benzene*	<0.050	0.050	09/26/2024	ND	1.94	96.8	2.00	4.29	
Toluene*	<0.050	0.050	09/26/2024	ND	1.95	97.6	2.00	5.53	
Ethylbenzene*	<0.050	0.050	09/26/2024	ND	2.05	102	2.00	6.03	
Total Xylenes*	<0.150	0.150	09/26/2024	ND	6.13	102	6.00	6.19	
Total BTX	<0.300	0.300	09/26/2024	ND					

Surrogate: 4-Bromofluorobenzene (PID) 101 % 71.5-134

Chloride, SM4500Cl-B		mg/kg		Analyzed By: AC					
Analyte	Result	Reporting Limit	Analyzed	Method Blank	BS	% Recovery	True Value QC	RPD	Qualifier
Chloride	<16.0	16.0	09/25/2024	ND	400	100	400	3.92	

TPH 8015M		mg/kg		Analyzed By: MS					
Analyte	Result	Reporting Limit	Analyzed	Method Blank	BS	% Recovery	True Value QC	RPD	Qualifier
GRO C6-C10*	<10.0	10.0	09/25/2024	ND	216	108	200	1.25	
DRO >C10-C28*	<10.0	10.0	09/25/2024	ND	210	105	200	1.15	
EXT DRO >C28-C36	<10.0	10.0	09/25/2024	ND					

Surrogate: 1-Chlorooctane 104 % 48.2-134

Surrogate: 1-Chlorooctadecane 105 % 49.1-148

Cardinal Laboratories

*=Accredited Analyte

PLEASE NOTE: Liability and Damages. Cardinal's liability and client's exclusive remedy for any claim arising, whether based in contract or tort, shall be limited to the amount paid by client for analyses. All claims, including those for negligence and any other cause whatsoever shall be deemed waived unless made in writing and received by Cardinal within thirty (30) days after completion of the applicable service. In no event shall Cardinal be liable for incidental or consequential damages, including, without limitation, business interruptions, loss of use, or loss of profits incurred by client, its subsidiaries, affiliates or successors arising out of or related to the performance of the services hereunder by Cardinal, regardless of whether such claim is based upon any of the above stated reasons or otherwise. Results relate only to the samples identified above. This report shall not be reproduced except in full with written approval of Cardinal Laboratories.

Celey D. Keene, Lab Director/Quality Manager



PHONE (575) 393-2326 ° 101 E. MARLAND ° HOBBS, NM 88240

Analytical Results For:

BBC International, Inc.
 Cliff Brunson
 P.O. Box 805
 Hobbs NM, 88241
 Fax To: (575) 397-0397

Received: 09/24/2024
 Reported: 09/27/2024
 Project Name: BRAVO DOME #1934-321A
 Project Number: (11/11/19)
 Project Location: OXY-UNION CO NM

Sampling Date: 09/17/2024
 Sampling Type: Soil
 Sampling Condition: Cool & Intact
 Sample Received By: Shalyn Rodriguez

Sample ID: SIDEWALL 7 (H245772-23)

BTEx 8021B		mg/kg		Analyzed By: JH						
Analyte	Result	Reporting Limit	Analyzed	Method Blank	BS	% Recovery	True Value QC	RPD	Qualifier	
Benzene*	<0.050	0.050	09/26/2024	ND	1.94	96.8	2.00	4.29		
Toluene*	<0.050	0.050	09/26/2024	ND	1.95	97.6	2.00	5.53		
Ethylbenzene*	<0.050	0.050	09/26/2024	ND	2.05	102	2.00	6.03		
Total Xylenes*	<0.150	0.150	09/26/2024	ND	6.13	102	6.00	6.19		
Total BTEX	<0.300	0.300	09/26/2024	ND						

Surrogate: 4-Bromofluorobenzene (PID) 99.7 % 71.5-134

Chloride, SM4500Cl-B		mg/kg		Analyzed By: AC						
Analyte	Result	Reporting Limit	Analyzed	Method Blank	BS	% Recovery	True Value QC	RPD	Qualifier	
Chloride	<16.0	16.0	09/25/2024	ND	400	100	400	3.92		

TPH 8015M		mg/kg		Analyzed By: MS					
Analyte	Result	Reporting Limit	Analyzed	Method Blank	BS	% Recovery	True Value QC	RPD	Qualifier
GRO C6-C10*	<10.0	10.0	09/25/2024	ND	216	108	200	1.25	
DRO >C10-C28*	<10.0	10.0	09/25/2024	ND	210	105	200	1.15	
EXT DRO >C28-C36	<10.0	10.0	09/25/2024	ND					

Surrogate: 1-Chlorooctane 105 % 48.2-134

Surrogate: 1-Chlorooctadecane 106 % 49.1-148

Cardinal Laboratories

*=Accredited Analyte

PLEASE NOTE: Liability and Damages. Cardinal's liability and client's exclusive remedy for any claim arising, whether based in contract or tort, shall be limited to the amount paid by client for analyses. All claims, including those for negligence and any other cause whatsoever shall be deemed waived unless made in writing and received by Cardinal within thirty (30) days after completion of the applicable service. In no event shall Cardinal be liable for incidental or consequential damages, including, without limitation, business interruptions, loss of use, or loss of profits incurred by client, its subsidiaries, affiliates or successors arising out of or related to the performance of the services hereunder by Cardinal, regardless of whether such claim is based upon any of the above stated reasons or otherwise. Results relate only to the samples identified above. This report shall not be reproduced except in full with written approval of Cardinal Laboratories.

Celey D. Keene, Lab Director/Quality Manager



PHONE (575) 393-2326 ° 101 E. MARLAND ° HOBBS, NM 88240

Analytical Results For:

BBC International, Inc.
 Cliff Brunson
 P.O. Box 805
 Hobbs NM, 88241
 Fax To: (575) 397-0397

Received: 09/24/2024
 Reported: 09/27/2024
 Project Name: BRAVO DOME #1934-321A
 Project Number: (11/11/19)
 Project Location: OXY-UNION CO NM

Sampling Date: 09/17/2024
 Sampling Type: Soil
 Sampling Condition: Cool & Intact
 Sample Received By: Shalyn Rodriguez

Sample ID: SIDEWALL 8 (H245772-24)

BTX 8021B		mg/kg		Analyzed By: JH					
Analyte	Result	Reporting Limit	Analyzed	Method Blank	BS	% Recovery	True Value QC	RPD	Qualifier
Benzene*	<0.050	0.050	09/26/2024	ND	1.94	96.8	2.00	4.29	
Toluene*	<0.050	0.050	09/26/2024	ND	1.95	97.6	2.00	5.53	
Ethylbenzene*	<0.050	0.050	09/26/2024	ND	2.05	102	2.00	6.03	
Total Xylenes*	<0.150	0.150	09/26/2024	ND	6.13	102	6.00	6.19	
Total BTX	<0.300	0.300	09/26/2024	ND					

Surrogate: 4-Bromofluorobenzene (PID) 101 % 71.5-134

Chloride, SM4500Cl-B		mg/kg		Analyzed By: AC					
Analyte	Result	Reporting Limit	Analyzed	Method Blank	BS	% Recovery	True Value QC	RPD	Qualifier
Chloride	<16.0	16.0	09/25/2024	ND	400	100	400	3.92	

TPH 8015M		mg/kg		Analyzed By: MS					
Analyte	Result	Reporting Limit	Analyzed	Method Blank	BS	% Recovery	True Value QC	RPD	Qualifier
GRO C6-C10*	<10.0	10.0	09/25/2024	ND	216	108	200	1.25	
DRO >C10-C28*	<10.0	10.0	09/25/2024	ND	210	105	200	1.15	
EXT DRO >C28-C36	<10.0	10.0	09/25/2024	ND					

Surrogate: 1-Chlorooctane 108 % 48.2-134

Surrogate: 1-Chlorooctadecane 110 % 49.1-148

Cardinal Laboratories

*=Accredited Analyte

PLEASE NOTE: Liability and Damages. Cardinal's liability and client's exclusive remedy for any claim arising, whether based in contract or tort, shall be limited to the amount paid by client for analyses. All claims, including those for negligence and any other cause whatsoever shall be deemed waived unless made in writing and received by Cardinal within thirty (30) days after completion of the applicable service. In no event shall Cardinal be liable for incidental or consequential damages, including, without limitation, business interruptions, loss of use, or loss of profits incurred by client, its subsidiaries, affiliates or successors arising out of or related to the performance of the services hereunder by Cardinal, regardless of whether such claim is based upon any of the above stated reasons or otherwise. Results relate only to the samples identified above. This report shall not be reproduced except in full with written approval of Cardinal Laboratories.

Celey D. Keene, Lab Director/Quality Manager



PHONE (575) 393-2326 ° 101 E. MARLAND ° HOBBS, NM 88240

Analytical Results For:

BBC International, Inc.
 Cliff Brunson
 P.O. Box 805
 Hobbs NM, 88241
 Fax To: (575) 397-0397

Received: 09/24/2024
 Reported: 09/27/2024
 Project Name: BRAVO DOME #1934-321A
 Project Number: (11/11/19)
 Project Location: OXY-UNION CO NM

Sampling Date: 09/17/2024
 Sampling Type: Soil
 Sampling Condition: Cool & Intact
 Sample Received By: Shalyn Rodriguez

Sample ID: SIDEWALL 9 (H245772-25)

BTX 8021B		mg/kg		Analyzed By: JH					
Analyte	Result	Reporting Limit	Analyzed	Method Blank	BS	% Recovery	True Value QC	RPD	Qualifier
Benzene*	<0.050	0.050	09/26/2024	ND	1.94	96.8	2.00	4.29	
Toluene*	<0.050	0.050	09/26/2024	ND	1.95	97.6	2.00	5.53	
Ethylbenzene*	<0.050	0.050	09/26/2024	ND	2.05	102	2.00	6.03	
Total Xylenes*	<0.150	0.150	09/26/2024	ND	6.13	102	6.00	6.19	
Total BTX	<0.300	0.300	09/26/2024	ND					

Surrogate: 4-Bromofluorobenzene (PID) 100 % 71.5-134

Chloride, SM4500Cl-B		mg/kg		Analyzed By: AC					
Analyte	Result	Reporting Limit	Analyzed	Method Blank	BS	% Recovery	True Value QC	RPD	Qualifier
Chloride	<16.0	16.0	09/25/2024	ND	400	100	400	3.92	

TPH 8015M		mg/kg		Analyzed By: MS					
Analyte	Result	Reporting Limit	Analyzed	Method Blank	BS	% Recovery	True Value QC	RPD	Qualifier
GRO C6-C10*	<10.0	10.0	09/25/2024	ND	216	108	200	1.25	
DRO >C10-C28*	<10.0	10.0	09/25/2024	ND	210	105	200	1.15	
EXT DRO >C28-C36	<10.0	10.0	09/25/2024	ND					

Surrogate: 1-Chlorooctane 112 % 48.2-134

Surrogate: 1-Chlorooctadecane 115 % 49.1-148

Cardinal Laboratories

*=Accredited Analyte

PLEASE NOTE: Liability and Damages. Cardinal's liability and client's exclusive remedy for any claim arising, whether based in contract or tort, shall be limited to the amount paid by client for analyses. All claims, including those for negligence and any other cause whatsoever shall be deemed waived unless made in writing and received by Cardinal within thirty (30) days after completion of the applicable service. In no event shall Cardinal be liable for incidental or consequential damages, including, without limitation, business interruptions, loss of use, or loss of profits incurred by client, its subsidiaries, affiliates or successors arising out of or related to the performance of the services hereunder by Cardinal, regardless of whether such claim is based upon any of the above stated reasons or otherwise. Results relate only to the samples identified above. This report shall not be reproduced except in full with written approval of Cardinal Laboratories.

Celey D. Keene, Lab Director/Quality Manager



PHONE (575) 393-2326 ° 101 E. MARLAND ° HOBBS, NM 88240

Analytical Results For:

BBC International, Inc.
 Cliff Brunson
 P.O. Box 805
 Hobbs NM, 88241
 Fax To: (575) 397-0397

Received: 09/24/2024
 Reported: 09/27/2024
 Project Name: BRAVO DOME #1934-321A
 Project Number: (11/11/19)
 Project Location: OXY-UNION CO NM

Sampling Date: 09/17/2024
 Sampling Type: Soil
 Sampling Condition: Cool & Intact
 Sample Received By: Shalyn Rodriguez

Sample ID: SIDEWALL 10 (H245772-26)

BTX 8021B		mg/kg		Analyzed By: JH					
Analyte	Result	Reporting Limit	Analyzed	Method Blank	BS	% Recovery	True Value QC	RPD	Qualifier
Benzene*	<0.050	0.050	09/26/2024	ND	1.94	96.8	2.00	4.29	
Toluene*	<0.050	0.050	09/26/2024	ND	1.95	97.6	2.00	5.53	
Ethylbenzene*	<0.050	0.050	09/26/2024	ND	2.05	102	2.00	6.03	
Total Xylenes*	<0.150	0.150	09/26/2024	ND	6.13	102	6.00	6.19	
Total BTX	<0.300	0.300	09/26/2024	ND					

Surrogate: 4-Bromofluorobenzene (PID) 101 % 71.5-134

Chloride, SM4500Cl-B		mg/kg		Analyzed By: AC					
Analyte	Result	Reporting Limit	Analyzed	Method Blank	BS	% Recovery	True Value QC	RPD	Qualifier
Chloride	<16.0	16.0	09/25/2024	ND	400	100	400	3.92	

TPH 8015M		mg/kg		Analyzed By: MS					
Analyte	Result	Reporting Limit	Analyzed	Method Blank	BS	% Recovery	True Value QC	RPD	Qualifier
GRO C6-C10*	<10.0	10.0	09/25/2024	ND	216	108	200	1.25	
DRO >C10-C28*	<10.0	10.0	09/25/2024	ND	210	105	200	1.15	
EXT DRO >C28-C36	<10.0	10.0	09/25/2024	ND					

Surrogate: 1-Chlorooctane 108 % 48.2-134

Surrogate: 1-Chlorooctadecane 110 % 49.1-148

Cardinal Laboratories

*=Accredited Analyte

PLEASE NOTE: Liability and Damages. Cardinal's liability and client's exclusive remedy for any claim arising, whether based in contract or tort, shall be limited to the amount paid by client for analyses. All claims, including those for negligence and any other cause whatsoever shall be deemed waived unless made in writing and received by Cardinal within thirty (30) days after completion of the applicable service. In no event shall Cardinal be liable for incidental or consequential damages, including, without limitation, business interruptions, loss of use, or loss of profits incurred by client, its subsidiaries, affiliates or successors arising out of or related to the performance of the services hereunder by Cardinal, regardless of whether such claim is based upon any of the above stated reasons or otherwise. Results relate only to the samples identified above. This report shall not be reproduced except in full with written approval of Cardinal Laboratories.

Celey D. Keene, Lab Director/Quality Manager



PHONE (575) 393-2326 ° 101 E. MARLAND ° HOBBS, NM 88240

Analytical Results For:

BBC International, Inc.
 Cliff Brunson
 P.O. Box 805
 Hobbs NM, 88241
 Fax To: (575) 397-0397

Received: 09/24/2024
 Reported: 09/27/2024
 Project Name: BRAVO DOME #1934-321A
 Project Number: (11/11/19)
 Project Location: OXY-UNION CO NM

Sampling Date: 09/17/2024
 Sampling Type: Soil
 Sampling Condition: Cool & Intact
 Sample Received By: Shalyn Rodriguez

Sample ID: SIDEWALL 11 (H245772-27)

BTEx 8021B		mg/kg		Analyzed By: JH					
Analyte	Result	Reporting Limit	Analyzed	Method Blank	BS	% Recovery	True Value QC	RPD	Qualifier
Benzene*	<0.050	0.050	09/26/2024	ND	1.94	96.8	2.00	4.29	
Toluene*	<0.050	0.050	09/26/2024	ND	1.95	97.6	2.00	5.53	
Ethylbenzene*	<0.050	0.050	09/26/2024	ND	2.05	102	2.00	6.03	
Total Xylenes*	<0.150	0.150	09/26/2024	ND	6.13	102	6.00	6.19	
Total BTEX	<0.300	0.300	09/26/2024	ND					

Surrogate: 4-Bromofluorobenzene (PID) 100 % 71.5-134

Chloride, SM4500Cl-B		mg/kg		Analyzed By: AC					
Analyte	Result	Reporting Limit	Analyzed	Method Blank	BS	% Recovery	True Value QC	RPD	Qualifier
Chloride	<16.0	16.0	09/25/2024	ND	400	100	400	3.92	

TPH 8015M		mg/kg		Analyzed By: MS					
Analyte	Result	Reporting Limit	Analyzed	Method Blank	BS	% Recovery	True Value QC	RPD	Qualifier
GRO C6-C10*	<10.0	10.0	09/25/2024	ND	216	108	200	1.25	
DRO >C10-C28*	<10.0	10.0	09/25/2024	ND	210	105	200	1.15	
EXT DRO >C28-C36	<10.0	10.0	09/25/2024	ND					

Surrogate: 1-Chlorooctane 108 % 48.2-134

Surrogate: 1-Chlorooctadecane 110 % 49.1-148

Cardinal Laboratories

*=Accredited Analyte

PLEASE NOTE: Liability and Damages. Cardinal's liability and client's exclusive remedy for any claim arising, whether based in contract or tort, shall be limited to the amount paid by client for analyses. All claims, including those for negligence and any other cause whatsoever shall be deemed waived unless made in writing and received by Cardinal within thirty (30) days after completion of the applicable service. In no event shall Cardinal be liable for incidental or consequential damages, including, without limitation, business interruptions, loss of use, or loss of profits incurred by client, its subsidiaries, affiliates or successors arising out of or related to the performance of the services hereunder by Cardinal, regardless of whether such claim is based upon any of the above stated reasons or otherwise. Results relate only to the samples identified above. This report shall not be reproduced except in full with written approval of Cardinal Laboratories.

Celey D. Keene, Lab Director/Quality Manager



PHONE (575) 393-2326 ° 101 E. MARLAND ° HOBBS, NM 88240

Analytical Results For:

BBC International, Inc.
 Cliff Brunson
 P.O. Box 805
 Hobbs NM, 88241
 Fax To: (575) 397-0397

Received: 09/24/2024
 Reported: 09/27/2024
 Project Name: BRAVO DOME #1934-321A
 Project Number: (11/11/19)
 Project Location: OXY-UNION CO NM

Sampling Date: 09/17/2024
 Sampling Type: Soil
 Sampling Condition: Cool & Intact
 Sample Received By: Shalyn Rodriguez

Sample ID: SIDEWALL 12 (H245772-28)

BTEx 8021B		mg/kg		Analyzed By: JH						
Analyte	Result	Reporting Limit	Analyzed	Method Blank	BS	% Recovery	True Value QC	RPD	Qualifier	
Benzene*	<0.050	0.050	09/26/2024	ND	1.94	96.8	2.00	4.29		
Toluene*	<0.050	0.050	09/26/2024	ND	1.95	97.6	2.00	5.53		
Ethylbenzene*	<0.050	0.050	09/26/2024	ND	2.05	102	2.00	6.03		
Total Xylenes*	<0.150	0.150	09/26/2024	ND	6.13	102	6.00	6.19		
Total BTEx	<0.300	0.300	09/26/2024	ND						

Surrogate: 4-Bromofluorobenzene (PID) 100 % 71.5-134

Chloride, SM4500CI-B		mg/kg		Analyzed By: AC						
Analyte	Result	Reporting Limit	Analyzed	Method Blank	BS	% Recovery	True Value QC	RPD	Qualifier	
Chloride	<16.0	16.0	09/25/2024	ND	400	100	400	3.92		

TPH 8015M		mg/kg		Analyzed By: MS					
Analyte	Result	Reporting Limit	Analyzed	Method Blank	BS	% Recovery	True Value QC	RPD	Qualifier
GRO C6-C10*	<10.0	10.0	09/25/2024	ND	216	108	200	1.25	
DRO >C10-C28*	<10.0	10.0	09/25/2024	ND	210	105	200	1.15	
EXT DRO >C28-C36	<10.0	10.0	09/25/2024	ND					

Surrogate: 1-Chlorooctane 100 % 48.2-134

Surrogate: 1-Chlorooctadecane 99.8 % 49.1-148

Cardinal Laboratories

*=Accredited Analyte

PLEASE NOTE: Liability and Damages. Cardinal's liability and client's exclusive remedy for any claim arising, whether based in contract or tort, shall be limited to the amount paid by client for analyses. All claims, including those for negligence and any other cause whatsoever shall be deemed waived unless made in writing and received by Cardinal within thirty (30) days after completion of the applicable service. In no event shall Cardinal be liable for incidental or consequential damages, including, without limitation, business interruptions, loss of use, or loss of profits incurred by client, its subsidiaries, affiliates or successors arising out of or related to the performance of the services hereunder by Cardinal, regardless of whether such claim is based upon any of the above stated reasons or otherwise. Results relate only to the samples identified above. This report shall not be reproduced except in full with written approval of Cardinal Laboratories.

Celey D. Keene, Lab Director/Quality Manager



PHONE (575) 393-2326 ° 101 E. MARLAND ° HOBBS, NM 88240

Analytical Results For:

BBC International, Inc.
 Cliff Brunson
 P.O. Box 805
 Hobbs NM, 88241
 Fax To: (575) 397-0397

Received: 09/24/2024
 Reported: 09/27/2024
 Project Name: BRAVO DOME #1934-321A
 Project Number: (11/11/19)
 Project Location: OXY-UNION CO NM

Sampling Date: 09/17/2024
 Sampling Type: Soil
 Sampling Condition: Cool & Intact
 Sample Received By: Shalyn Rodriguez

Sample ID: SIDEWALL 13 (H245772-29)

BTX 8021B		mg/kg		Analyzed By: JH					
Analyte	Result	Reporting Limit	Analyzed	Method Blank	BS	% Recovery	True Value QC	RPD	Qualifier
Benzene*	<0.050	0.050	09/26/2024	ND	1.94	96.8	2.00	4.29	
Toluene*	<0.050	0.050	09/26/2024	ND	1.95	97.6	2.00	5.53	
Ethylbenzene*	<0.050	0.050	09/26/2024	ND	2.05	102	2.00	6.03	
Total Xylenes*	<0.150	0.150	09/26/2024	ND	6.13	102	6.00	6.19	
Total BTX	<0.300	0.300	09/26/2024	ND					

Surrogate: 4-Bromofluorobenzene (PID) 100 % 71.5-134

Chloride, SM4500CI-B		mg/kg		Analyzed By: CT						
Analyte	Result	Reporting Limit	Analyzed	Method Blank	BS	% Recovery	True Value QC	RPD	Qualifier	
Chloride	<16.0	16.0	09/25/2024	ND	400	100	400	7.69		

TPH 8015M		mg/kg		Analyzed By: MS					
Analyte	Result	Reporting Limit	Analyzed	Method Blank	BS	% Recovery	True Value QC	RPD	Qualifier
GRO C6-C10*	<10.0	10.0	09/25/2024	ND	216	108	200	1.25	
DRO >C10-C28*	<10.0	10.0	09/25/2024	ND	210	105	200	1.15	
EXT DRO >C28-C36	<10.0	10.0	09/25/2024	ND					

Surrogate: 1-Chlorooctane 112 % 48.2-134

Surrogate: 1-Chlorooctadecane 112 % 49.1-148

Cardinal Laboratories

*=Accredited Analyte

PLEASE NOTE: Liability and Damages. Cardinal's liability and client's exclusive remedy for any claim arising, whether based in contract or tort, shall be limited to the amount paid by client for analyses. All claims, including those for negligence and any other cause whatsoever shall be deemed waived unless made in writing and received by Cardinal within thirty (30) days after completion of the applicable service. In no event shall Cardinal be liable for incidental or consequential damages, including, without limitation, business interruptions, loss of use, or loss of profits incurred by client, its subsidiaries, affiliates or successors arising out of or related to the performance of the services hereunder by Cardinal, regardless of whether such claim is based upon any of the above stated reasons or otherwise. Results relate only to the samples identified above. This report shall not be reproduced except in full with written approval of Cardinal Laboratories.

Celey D. Keene, Lab Director/Quality Manager



PHONE (575) 393-2326 ° 101 E. MARLAND ° HOBBS, NM 88240

Analytical Results For:

BBC International, Inc.
 Cliff Brunson
 P.O. Box 805
 Hobbs NM, 88241
 Fax To: (575) 397-0397

Received: 09/24/2024
 Reported: 09/27/2024
 Project Name: BRAVO DOME #1934-321A
 Project Number: (11/11/19)
 Project Location: OXY-UNION CO NM

Sampling Date: 09/17/2024
 Sampling Type: Soil
 Sampling Condition: Cool & Intact
 Sample Received By: Shalyn Rodriguez

Sample ID: SIDEWALL 14 (H245772-30)

BTEx 8021B		mg/kg		Analyzed By: JH						
Analyte	Result	Reporting Limit	Analyzed	Method Blank	BS	% Recovery	True Value QC	RPD	Qualifier	
Benzene*	<0.050	0.050	09/26/2024	ND	1.94	96.8	2.00	4.29		
Toluene*	<0.050	0.050	09/26/2024	ND	1.95	97.6	2.00	5.53		
Ethylbenzene*	<0.050	0.050	09/26/2024	ND	2.05	102	2.00	6.03		
Total Xylenes*	<0.150	0.150	09/26/2024	ND	6.13	102	6.00	6.19		
Total BTEx	<0.300	0.300	09/26/2024	ND						

Surrogate: 4-Bromofluorobenzene (PID) 100 % 71.5-134

Chloride, SM4500CI-B		mg/kg		Analyzed By: CT						
Analyte	Result	Reporting Limit	Analyzed	Method Blank	BS	% Recovery	True Value QC	RPD	Qualifier	
Chloride	<16.0	16.0	09/25/2024	ND	400	100	400	7.69		

TPH 8015M		mg/kg		Analyzed By: MS					
Analyte	Result	Reporting Limit	Analyzed	Method Blank	BS	% Recovery	True Value QC	RPD	Qualifier
GRO C6-C10*	<10.0	10.0	09/25/2024	ND	216	108	200	1.25	
DRO >C10-C28*	<10.0	10.0	09/25/2024	ND	210	105	200	1.15	
EXT DRO >C28-C36	<10.0	10.0	09/25/2024	ND					

Surrogate: 1-Chlorooctane 96.5 % 48.2-134

Surrogate: 1-Chlorooctadecane 95.4 % 49.1-148

Cardinal Laboratories

*=Accredited Analyte

PLEASE NOTE: Liability and Damages. Cardinal's liability and client's exclusive remedy for any claim arising, whether based in contract or tort, shall be limited to the amount paid by client for analyses. All claims, including those for negligence and any other cause whatsoever shall be deemed waived unless made in writing and received by Cardinal within thirty (30) days after completion of the applicable service. In no event shall Cardinal be liable for incidental or consequential damages, including, without limitation, business interruptions, loss of use, or loss of profits incurred by client, its subsidiaries, affiliates or successors arising out of or related to the performance of the services hereunder by Cardinal, regardless of whether such claim is based upon any of the above stated reasons or otherwise. Results relate only to the samples identified above. This report shall not be reproduced except in full with written approval of Cardinal Laboratories.

Celey D. Keene, Lab Director/Quality Manager



PHONE (575) 393-2326 ° 101 E. MARLAND ° HOBBS, NM 88240

Analytical Results For:

BBC International, Inc.
 Cliff Brunson
 P.O. Box 805
 Hobbs NM, 88241
 Fax To: (575) 397-0397

Received: 09/24/2024
 Reported: 09/27/2024
 Project Name: BRAVO DOME #1934-321A
 Project Number: (11/11/19)
 Project Location: OXY-UNION CO NM

Sampling Date: 09/17/2024
 Sampling Type: Soil
 Sampling Condition: Cool & Intact
 Sample Received By: Shalyn Rodriguez

Sample ID: SIDEWALL 15 (H245772-31)

BTX 8021B		mg/kg		Analyzed By: JH					
Analyte	Result	Reporting Limit	Analyzed	Method Blank	BS	% Recovery	True Value QC	RPD	Qualifier
Benzene*	<0.050	0.050	09/26/2024	ND	1.94	96.8	2.00	4.29	
Toluene*	<0.050	0.050	09/26/2024	ND	1.95	97.6	2.00	5.53	
Ethylbenzene*	<0.050	0.050	09/26/2024	ND	2.05	102	2.00	6.03	
Total Xylenes*	<0.150	0.150	09/26/2024	ND	6.13	102	6.00	6.19	
Total BTX	<0.300	0.300	09/26/2024	ND					

Surrogate: 4-Bromofluorobenzene (PID) 101 % 71.5-134

Chloride, SM4500Cl-B		mg/kg		Analyzed By: CT					
Analyte	Result	Reporting Limit	Analyzed	Method Blank	BS	% Recovery	True Value QC	RPD	Qualifier
Chloride	16.0	16.0	09/25/2024	ND	400	100	400	7.69	

TPH 8015M		mg/kg		Analyzed By: MS					
Analyte	Result	Reporting Limit	Analyzed	Method Blank	BS	% Recovery	True Value QC	RPD	Qualifier
GRO C6-C10*	<10.0	10.0	09/25/2024	ND	216	108	200	1.25	
DRO >C10-C28*	<10.0	10.0	09/25/2024	ND	210	105	200	1.15	
EXT DRO >C28-C36	<10.0	10.0	09/25/2024	ND					

Surrogate: 1-Chlorooctane 91.1 % 48.2-134

Surrogate: 1-Chlorooctadecane 91.0 % 49.1-148

Cardinal Laboratories

*=Accredited Analyte

PLEASE NOTE: Liability and Damages. Cardinal's liability and client's exclusive remedy for any claim arising, whether based in contract or tort, shall be limited to the amount paid by client for analyses. All claims, including those for negligence and any other cause whatsoever shall be deemed waived unless made in writing and received by Cardinal within thirty (30) days after completion of the applicable service. In no event shall Cardinal be liable for incidental or consequential damages, including, without limitation, business interruptions, loss of use, or loss of profits incurred by client, its subsidiaries, affiliates or successors arising out of or related to the performance of the services hereunder by Cardinal, regardless of whether such claim is based upon any of the above stated reasons or otherwise. Results relate only to the samples identified above. This report shall not be reproduced except in full with written approval of Cardinal Laboratories.

Celey D. Keene, Lab Director/Quality Manager



PHONE (575) 393-2326 ° 101 E. MARLAND ° HOBBS, NM 88240

Analytical Results For:

BBC International, Inc.
 Cliff Brunson
 P.O. Box 805
 Hobbs NM, 88241
 Fax To: (575) 397-0397

Received: 09/24/2024
 Reported: 09/27/2024
 Project Name: BRAVO DOME #1934-321A
 Project Number: (11/11/19)
 Project Location: OXY-UNION CO NM

Sampling Date: 09/17/2024
 Sampling Type: Soil
 Sampling Condition: Cool & Intact
 Sample Received By: Shalyn Rodriguez

Sample ID: SIDEWALL 16 (H245772-32)

BTX 8021B		mg/kg		Analyzed By: JH					
Analyte	Result	Reporting Limit	Analyzed	Method Blank	BS	% Recovery	True Value QC	RPD	Qualifier
Benzene*	<0.050	0.050	09/26/2024	ND	1.83	91.3	2.00	5.03	
Toluene*	<0.050	0.050	09/26/2024	ND	1.91	95.7	2.00	5.62	
Ethylbenzene*	<0.050	0.050	09/26/2024	ND	1.97	98.5	2.00	5.08	
Total Xylenes*	<0.150	0.150	09/26/2024	ND	5.91	98.6	6.00	5.18	
Total BTX	<0.300	0.300	09/26/2024	ND					

Surrogate: 4-Bromofluorobenzene (PID) 103 % 71.5-134

Chloride, SM4500Cl-B		mg/kg		Analyzed By: CT					
Analyte	Result	Reporting Limit	Analyzed	Method Blank	BS	% Recovery	True Value QC	RPD	Qualifier
Chloride	16.0	16.0	09/25/2024	ND	400	100	400	7.69	

TPH 8015M		mg/kg		Analyzed By: MS					
Analyte	Result	Reporting Limit	Analyzed	Method Blank	BS	% Recovery	True Value QC	RPD	Qualifier
GRO C6-C10*	<10.0	10.0	09/26/2024	ND	216	108	200	1.25	
DRO >C10-C28*	<10.0	10.0	09/26/2024	ND	210	105	200	1.15	
EXT DRO >C28-C36	<10.0	10.0	09/26/2024	ND					

Surrogate: 1-Chlorooctane 109 % 48.2-134

Surrogate: 1-Chlorooctadecane 109 % 49.1-148

Cardinal Laboratories

*=Accredited Analyte

PLEASE NOTE: Liability and Damages. Cardinal's liability and client's exclusive remedy for any claim arising, whether based in contract or tort, shall be limited to the amount paid by client for analyses. All claims, including those for negligence and any other cause whatsoever shall be deemed waived unless made in writing and received by Cardinal within thirty (30) days after completion of the applicable service. In no event shall Cardinal be liable for incidental or consequential damages, including, without limitation, business interruptions, loss of use, or loss of profits incurred by client, its subsidiaries, affiliates or successors arising out of or related to the performance of the services hereunder by Cardinal, regardless of whether such claim is based upon any of the above stated reasons or otherwise. Results relate only to the samples identified above. This report shall not be reproduced except in full with written approval of Cardinal Laboratories.

Celey D. Keene, Lab Director/Quality Manager



PHONE (575) 393-2326 ° 101 E. MARLAND ° HOBBS, NM 88240

Notes and Definitions

- QM-07 The spike recovery was outside acceptance limits for the MS and/or MSD. The batch was accepted based on acceptable LCS recovery.
- ND Analyte NOT DETECTED at or above the reporting limit
- RPD Relative Percent Difference
- ** Samples not received at proper temperature of 6°C or below.
- *** Insufficient time to reach temperature.
- Chloride by SM4500Cl-B does not require samples be received at or below 6°C
Samples reported on an as received basis (wet) unless otherwise noted on report

Cardinal Laboratories

*=Accredited Analyte

PLEASE NOTE: Liability and Damages. Cardinal's liability and client's exclusive remedy for any claim arising, whether based in contract or tort, shall be limited to the amount paid by client for analyses. All claims, including those for negligence and any other cause whatsoever shall be deemed waived unless made in writing and received by Cardinal within thirty (30) days after completion of the applicable service. In no event shall Cardinal be liable for incidental or consequential damages, including, without limitation, business interruptions, loss of use, or loss of profits incurred by client, its subsidiaries, affiliates or successors arising out of or related to the performance of the services hereunder by Cardinal, regardless of whether such claim is based upon any of the above stated reasons or otherwise. Results relate only to the samples identified above. This report shall not be reproduced except in full with written approval of Cardinal Laboratories.

A handwritten signature in black ink, appearing to read "Celey D. Keene".

Celey D. Keene, Lab Director/Quality Manager



CHAIN-OF-CUSTODY AND ANALYSIS REQUEST

101 East Marland, Hobbs, NM 88240
(505) 393-2326 FAX (505) 393-2476

Company Name: BBC International, Inc.

Project Manager: Cliff Brunson

Address: P.O. Box 805

City: Hobbs

Phone #: 575-397-6388

Project #:

Project Name: BRAVO DOME UNIT 1934 321A (11/11/19)

Project Location: New Mexico

Sampler Name: SIMON RENDON

BILL TO

P.O. #:

Company: Oxy

Attn:

Address:

City:

State: Zip:

Phone #:

Fax #:

ANALYSIS REQUEST

Lab I.D.	Sample I.D.	(G)RAB OR (C)OMP.	# CONTAINERS	MATRIX	PRESERV	SAMPLING	DATE	TIME	Chloride	BI EX	TPHEXT
H245772	BOTTOM SAMPLE 1@4'			GROUNDWATER			9/16/24	12:20PM	✓	✓	✓
	BOTTOM SAMPLE 2@4'			WASTEWATER			9/16/24	12:34PM	✓	✓	✓
	BOTTOM SAMPLE 3@4'			SOIL			9/16/24	12:47PM	✓	✓	✓
	BOTTOM SAMPLE 4@4'			OIL			9/16/24	1:02PM	✓	✓	✓
	BOTTOM SAMPLE 5@4'			SLUDGE			9/16/24	1:15PM	✓	✓	✓
	BOTTOM SAMPLE 6@4'			OTHER :			9/16/24	1:34PM	✓	✓	✓
	BOTTOM SAMPLE 7@4'			ACID/BASE:			9/16/24	1:43PM	✓	✓	✓
	BOTTOM SAMPLE 8@4'			ICE / COOL			9/16/24	1:57PM	✓	✓	✓
	BOTTOM SAMPLE 9@4'			OTHER :			9/16/24	2:07PM	✓	✓	✓
	BOTTOM SAMPLE 10@4'						9/16/24	2:20PM	✓	✓	✓

PLEASE NOTE: Liability and Damages: Cardinal's liability and damages are limited to the amount paid by the client for the analyses. All claims, including those for negligence and any other cause whatsoever shall be deemed waived unless made in writing and received by Cardinal within 30 days after completion of the applicable service. It is no event that Cardinal be liable for incidental or consequential damages, including without limitation, business interruptions, loss of use, or loss of profits incurred by client, its subsidiaries, affiliates or successors arising out of or from the performance of services hereunder by Cardinal regardless of whether such claim is based upon any of the above stated reasons or otherwise.

Relinquished By:

Date: 9-24-24

Time: 8:00 AM

Received By:

Phone Result: ☐ Yes ☐ No

Fax Result: ☐ Yes ☐ No

REMARKS:

Relinquished By:

Date: 9-24-24

Time: 9:12

Received By:

Phone Result: ☐ Yes ☐ No

Fax Result: ☐ Yes ☐ No

REMARKS:

Delivered By: (Circle One)

Date: 9-24-24

Time: 9:12

Received By:

Phone Result: ☐ Yes ☐ No

Fax Result: ☐ Yes ☐ No

REMARKS:

Sampler - UPS - Bus - Other:

Date: 9-24-24

Time: 9:12

Received By:

Phone Result: ☐ Yes ☐ No

Fax Result: ☐ Yes ☐ No

REMARKS:

† Cardinal cannot accept verbal changes. Please fax written changes to 505-393-2476



ARDINAL LABORATORIES

101 East Marland, Hobbs, NM 88240
(505) 393-2326 FAX (505) 393-2476

CHAIN-OF-CUSTODY AND ANALYSIS REQUEST

2084

Company Name: BBC International, Inc. Project Manager: Cliff Brunson Address: P.O. Box 805 City: Hobbs Phone #: 575-397-6388 State: NM zip: 88241 Fax #: 575-397-0397 Project Owner: Oxy Project Name: BRAVO DOME UNIT 1934 321A (11/11/19) Project Location: New Mexico Sampler Name: SIMON RENDON				P.O. #: Company: Oxy Attn: Address: City: State: Zip: Phone #: Fax #:			
BILL TO							
ANALYSIS REQUEST							

Lab I.D.	Sample I.D.	(G)RAB OR (C)OMP.	# CONTAINERS	GROUNDWATER	WASTEWATER	SOIL	OIL	SLUDGE	OTHER :	ACID/BASE:	ICE / COOL	OTHER :	DATE	TIME	Chloride	BTEX	TPH EXT
11	BOTTOM SAMPLE 11@4'												9/16/24	2:31PM	✓	✓	✓
12	BOTTOM SAMPLE 12@4'												9/16/24	2:43PM	✓	✓	✓
13	BOTTOM SAMPLE 13@4'												9/16/24	2:51PM	✓	✓	✓
14	BOTTOM SAMPLE 14@4'												9/16/24	3:00PM	✓	✓	✓
15	BOTTOM SAMPLE 15@4'												9/16/24	3:11PM	✓	✓	✓
16	BOTTOM SAMPLE 16@4'												9/16/24	3:23PM	✓	✓	✓
17	SIDEWALL 1												9/16/24	3:30PM	✓	✓	✓
18	SIDEWALL 2												9/16/24	3:41PM	✓	✓	✓
19	SIDEWALL 3												9/16/24	3:54PM	✓	✓	✓
20	SIDEWALL 4												9/17/24	8:40AM	✓	✓	✓

PLEASE NOTE: Liability and Damages: Contractor's liability and client's exclusive remedy for any claim arising whether based in contract or tort, shall be limited to the amount paid by the client for the services. All claims, including those for negligence and any other cause whatsoever shall be deemed waived unless made in writing and received by Cardinal within 30 days after completion of the applicable service. In no event shall Cardinal be liable for accidental or consequential damages, including without limitation, business interruptions, loss of use, or loss of profits incurred by client, its subsidiaries, affiliates or successors arising out of or related to the performance of services rendered by Cardinal, regardless of whether such claim is based upon any of the above stated reasons or otherwise.

Relinquished By: Date: 9-24-24 Time: 8:00 AM Received By: JACARF Date: 9-24-24 Time: 8:12 AM	Phone Result: <input type="checkbox"/> Yes <input type="checkbox"/> No <input type="checkbox"/> Add'l Phone #: Fax Result: <input type="checkbox"/> Yes <input type="checkbox"/> No <input type="checkbox"/> Add'l Fax #: REMARKS:
--	---

Relinquished By: Date: 9-24-24 Time: 8:12 AM Received By: JACARF Date: 9-24-24 Time: 8:12 AM	Sample Condition: Cool <input type="checkbox"/> Intact <input type="checkbox"/> Yes <input type="checkbox"/> No <input type="checkbox"/> CHECKED BY: (Initials) JACARF
--	--



CARDINAL LABORATORIES

101 East Marland, Hobbs, NM 88240
(505) 393-2326 FAX (505) 393-2476

CHAIN-OF-CUSTODY AND ANALYSIS REQUEST

3044

Company Name: BBC International, Inc.		BILL TO		ANALYSIS REQUEST													
Project Manager: Cliff Brunson		P.O. #:															
Address: P.O. Box 805		Company: Oxy															
City: Hobbs		Attn:															
Phone #: 575-397-6388		Address:															
State: NM Zip: 88241		City:															
Fax #: 575-397-0397		State:															
Project #:		Zip:															
Project Name: BRAVO DOME UNIT 1934 321A (11/11/19)		Phone #:															
Project Location: New Mexico		Fax #:															
Sampler Name: SIMON RENDON																	
FOR LAB USE ONLY																	
Lab I.D.		Sample I.D.		(G)RAB OR (C)OMP.		# CONTAINERS		GROUNDWATER		WASTEWATER		MATRIX		PRESERV		SAMPLING	
21		SIDEWALL 5		✓		✓		✓		✓		✓		✓		✓	
22		SIDEWALL 6		✓		✓		✓		✓		✓		✓		✓	
23		SIDEWALL 7		✓		✓		✓		✓		✓		✓		✓	
24		SIDEWALL 8		✓		✓		✓		✓		✓		✓		✓	
25		SIDEWALL 9		✓		✓		✓		✓		✓		✓		✓	
26		SIDEWALL 10		✓		✓		✓		✓		✓		✓		✓	
27		SIDEWALL 11		✓		✓		✓		✓		✓		✓		✓	
28		SIDEWALL 12		✓		✓		✓		✓		✓		✓		✓	
29		SIDEWALL 13		✓		✓		✓		✓		✓		✓		✓	
30		SIDEWALL 14		✓		✓		✓		✓		✓		✓		✓	
PLEASE NOTE: Liability and Damages. Cardinal's liability and client's exclusive remedy for any claim arising whether based in contract or tort, shall be limited to the amount paid by the client for the analyses. All claims, including those for negligence and any other cause whatsoever shall be deemed waived unless made in writing and received by Cardinal within 30 days after completion of the applicable analyses. In no event shall Cardinal be liable for incidental or consequential damages, including without limitation, business interruptions, loss of use, or loss of profits incurred by client, its subsidiaries, affiliates or successors arising out of or related to the performance of services hereunder by Cardinal, regardless of whether such claim is based upon any of the above stated reasons or otherwise.																	
Relinquished By: <i>Joe Continous</i>		Date: 9-24-24		Time: 8:00 AM		Received By: <i>Jose Continous</i>		Date: 9-24-24		Time: 8:00 AM		Phone Result: <input type="checkbox"/> Yes <input type="checkbox"/> No		Add'l Phone #: <input type="checkbox"/> Yes <input type="checkbox"/> No		Add'l Fax #: <input type="checkbox"/> Yes <input type="checkbox"/> No	
Relinquished By: <i>Joe Continous</i>		Date: 9-24-24		Time: 8:00 AM		Received By: <i>Jose Continous</i>		Date: 9-24-24		Time: 8:00 AM		Phone Result: <input type="checkbox"/> Yes <input type="checkbox"/> No		Add'l Phone #: <input type="checkbox"/> Yes <input type="checkbox"/> No		Add'l Fax #: <input type="checkbox"/> Yes <input type="checkbox"/> No	
Delivered By: (Circle One) <i>Joe Continous</i>		Date: 9-24-24		Time: 8:00 AM		Received By: <i>Jose Continous</i>		Date: 9-24-24		Time: 8:00 AM		Phone Result: <input type="checkbox"/> Yes <input type="checkbox"/> No		Add'l Phone #: <input type="checkbox"/> Yes <input type="checkbox"/> No		Add'l Fax #: <input type="checkbox"/> Yes <input type="checkbox"/> No	
Sampler - UPS - Bus - Other: <i>-22: #140</i>		Sample Condition: <i>Good</i>		Cool: <input type="checkbox"/> Intact: <input type="checkbox"/> Pres: <input type="checkbox"/> Yes <input type="checkbox"/> No		CHECKED BY: <i>872</i>											

† Cardinal cannot accept verbal changes. Please fax written changes to 505-393-2476



CHAIN-OF-CUSTODY AND ANALYSIS REQUEST

101 East Marland, Hobbs, NM 88240
(505) 393-2326 FAX (505) 393-2476

Company Name: BBC International, Inc.

Project Manager: Cliff Brunson

Address: P.O. Box 805

City: Hobbs

Phone #: 575-397-6388

Project #:

Project Name: BRAVO DOME UNIT 1934 321A (11/11/19)

Project Location: New Mexico

Sampler Name: SIMON RENDON

BILL TO

P.O. #:

Company: Oxy

Attn:

Address:

City:

State:

Phone #:

Fax #:

ANALYSIS REQUEST

Lab I.D.	Sample I.D.	(G)RAB OR (C)OMP.	# CONTAINERS	MATRIX	PRESERV.	SAMPLING	DATE	TIME	Chloride	BTEX	TPH/EXT
4245772	SIDEWALL 15		1	GROUNDWATER			9/17/24	11:21AM	✓	✓	✓
31	SIDEWALL 16		1	WASTEWATER			9/17/24	11:32AM	✓	✓	✓
32				SOIL							
				OIL							
				SLUDGE							
				OTHER :							
				ACID/BASE:							
				ICE / COOL							
				OTHER :							

PLEASE NOTE: Liability and Damages. Cardinal's liability and coverage is limited to the amount paid by the client for the analysis. All claims including those for negligence and any other cause whatsoever shall be deemed waived unless made in writing and received by Cardinal within 30 days after completion of the applicable service. In no event shall Cardinal be liable for incidental or consequential damages, including without limitation, business interruptions, loss of use, or loss of profits incurred by client, its subsidiaries, affiliates or successors arising out of or related to the performance of services hereunder by Cardinal.

Relinquished By:

Date: 9-24-24

Received By:

Phone Result:

Yes ☐ No ☐

Add'l Phone #:

Fax Result:

Yes ☐ No ☐

Add'l Fax #:

Relinquished By:

Date: 9-24-24

Received By:

Phone Result:

Yes ☐ No ☐

Add'l Phone #:

Relinquished By:

Date: 9-24-24

Received By:

Phone Result:

Yes ☐ No ☐

Add'l Phone #:

Relinquished By:

Date: 9-24-24

Received By:

Phone Result:

Yes ☐ No ☐

Add'l Phone #:

Relinquished By:

Date: 9-24-24

Received By:

Phone Result:

Yes ☐ No ☐

Add'l Phone #:

† Cardinal cannot accept verbal changes. Please fax written changes to 505-393-2476

4084

Sante Fe Main Office
Phone: (505) 476-3441

General Information
Phone: (505) 629-6116

Online Phone Directory
<https://www.emnrd.nm.gov/ocd/contact-us>

State of New Mexico
Energy, Minerals and Natural Resources
Oil Conservation Division
1220 S. St Francis Dr.
Santa Fe, NM 87505

QUESTIONS

Action 406889

QUESTIONS

Operator: OXY USA INC P.O. Box 4294 Houston, TX 772104294	OGRID: 16696
	Action Number: 406889
	Action Type: [C-141] Remediation Closure Request C-141 (C-141-v-Closure)

QUESTIONS

Prerequisites	
Incident ID (n#)	nNV2202857516
Incident Name	NNV2202857516 BRAVO DOME UNIT 1934 321A @ 0
Incident Type	Produced Water Release
Incident Status	Remediation Closure Report Received

Location of Release Source*Please answer all the questions in this group.*

Site Name	BRAVO DOME UNIT 1934 321A
Date Release Discovered	11/11/2019
Surface Owner	State

Incident Details*Please answer all the questions in this group.*

Incident Type	Produced Water Release
Did this release result in a fire or is the result of a fire	No
Did this release result in any injuries	No
Has this release reached or does it have a reasonable probability of reaching a watercourse	No
Has this release endangered or does it have a reasonable probability of endangering public health	No
Has this release substantially damaged or will it substantially damage property or the environment	No
Is this release of a volume that is or may with reasonable probability be detrimental to fresh water	No

Nature and Volume of Release*Material(s) released, please answer all that apply below. Any calculations or specific justifications for the volumes provided should be attached to the follow-up C-141 submission.*

Crude Oil Released (bbls) Details	Not answered.
Produced Water Released (bbls) Details	Cause: Equipment Failure Flow Line - Production Produced Water Released: 10 BBL Recovered: 0 BBL Lost: 10 BBL.
Is the concentration of chloride in the produced water >10,000 mg/l	Yes
Condensate Released (bbls) Details	Not answered.
Natural Gas Vented (Mcf) Details	Not answered.
Natural Gas Flared (Mcf) Details	Not answered.
Other Released Details	Not answered.
Are there additional details for the questions above (i.e. any answer containing Other, Specify, Unknown, and/or Fire, or any negative lost amounts)	Not answered.

Sante Fe Main Office
Phone: (505) 476-3441

General Information
Phone: (505) 629-6116

Online Phone Directory
<https://www.emnrd.nm.gov/ocd/contact-us>

State of New Mexico
Energy, Minerals and Natural Resources
Oil Conservation Division
1220 S. St Francis Dr.
Santa Fe, NM 87505

QUESTIONS, Page 2

Action 406889

QUESTIONS (continued)

Operator: OXY USA INC P.O. Box 4294 Houston, TX 772104294	OGRID: 16696
	Action Number: 406889
	Action Type: [C-141] Remediation Closure Request C-141 (C-141-v-Closure)

QUESTIONS

Nature and Volume of Release (continued)	
Is this a gas only submission (i.e. only significant Mcf values reported)	No, according to supplied volumes this does not appear to be a "gas only" report.
Was this a major release as defined by Subsection A of 19.15.29.7 NMAC	No
Reasons why this would be considered a submission for a notification of a major release	Unavailable.
With the implementation of the 19.15.27 NMAC (05/25/2021), venting and/or flaring of natural gas (i.e. gas only) are to be submitted on the C-129 form.	

Initial Response

The responsible party must undertake the following actions immediately unless they could create a safety hazard that would result in injury.

The source of the release has been stopped	True
The impacted area has been secured to protect human health and the environment	True
Released materials have been contained via the use of berms or dikes, absorbent pads, or other containment devices	True
All free liquids and recoverable materials have been removed and managed appropriately	True
If all the actions described above have not been undertaken, explain why	Not answered.

Per Paragraph (4) of Subsection B of 19.15.29.8 NMAC the responsible party may commence remediation immediately after discovery of a release. If remediation has begun, please prepare and attach a narrative of actions to date in the follow-up C-141 submission. If remedial efforts have been successfully completed or if the release occurred within a lined containment area (see Subparagraph (a) of Paragraph (5) of Subsection A of 19.15.29.11 NMAC), please prepare and attach all information needed for closure evaluation in the follow-up C-141 submission.

I hereby certify that the information given above is true and complete to the best of my knowledge and understand that pursuant to OCD rules and regulations all operators are required to report and/or file certain release notifications and perform corrective actions for releases which may endanger public health or the environment. The acceptance of a C-141 report by the OCD does not relieve the operator of liability should their operations have failed to adequately investigate and remediate contamination that pose a threat to groundwater, surface water, human health or the environment. In addition, OCD acceptance of a C-141 report does not relieve the operator of responsibility for compliance with any other federal, state, or local laws and/or regulations.

I hereby agree and sign off to the above statement	Name: Wade Dittrich Title: Environmental Coordinator Email: wade_dittrich@oxy.com Date: 11/26/2024
--	---

Sante Fe Main Office
Phone: (505) 476-3441

General Information
Phone: (505) 629-6116

Online Phone Directory
<https://www.emnrd.nm.gov/ocd/contact-us>

State of New Mexico
Energy, Minerals and Natural Resources
Oil Conservation Division
1220 S. St Francis Dr.
Santa Fe, NM 87505

QUESTIONS, Page 3

Action 406889

QUESTIONS (continued)

Operator: OXY USA INC P.O. Box 4294 Houston, TX 772104294	OGRID: 16696
	Action Number: 406889
	Action Type: [C-141] Remediation Closure Request C-141 (C-141-v-Closure)

QUESTIONS**Site Characterization**

Please answer all the questions in this group (only required when seeking remediation plan approval and beyond). This information must be provided to the appropriate district office no later than 90 days after the release discovery date.

What is the shallowest depth to groundwater beneath the area affected by the release in feet below ground surface (ft bgs)	Between 100 and 500 (ft.)
What method was used to determine the depth to ground water	OCD Imaging Records Lookup
Did this release impact groundwater or surface water	No
What is the minimum distance, between the closest lateral extents of the release and the following surface areas:	
A continuously flowing watercourse or any other significant watercourse	Between ½ and 1 (mi.)
Any lakebed, sinkhole, or playa lake (measured from the ordinary high-water mark)	Between 1 and 5 (mi.)
An occupied permanent residence, school, hospital, institution, or church	Greater than 5 (mi.)
A spring or a private domestic fresh water well used by less than five households for domestic or stock watering purposes	Between 1 and 5 (mi.)
Any other fresh water well or spring	Between 1 and 5 (mi.)
Incorporated municipal boundaries or a defined municipal fresh water well field	Between 1 and 5 (mi.)
A wetland	Between 1 and 5 (mi.)
A subsurface mine	Between 1 and 5 (mi.)
An (non-karst) unstable area	Between 1 and 5 (mi.)
Categorize the risk of this well / site being in a karst geology	Low
A 100-year floodplain	Between 1 and 5 (mi.)
Did the release impact areas not on an exploration, development, production, or storage site	No

Remediation Plan

Please answer all the questions that apply or are indicated. This information must be provided to the appropriate district office no later than 90 days after the release discovery date.

Requesting a remediation plan approval with this submission	Yes
<i>Attach a comprehensive report demonstrating the lateral and vertical extents of soil contamination associated with the release have been determined, pursuant to 19.15.29.11 NMAC and 19.15.29.13 NMAC.</i>	
Have the lateral and vertical extents of contamination been fully delineated	Yes
Was this release entirely contained within a lined containment area	No

Soil Contamination Sampling: (Provide the highest observable value for each, in milligrams per kilograms.)

Chloride (EPA 300.0 or SM4500 Cl B)	32
TPH (GRO+DRO+MRO) (EPA SW-846 Method 8015M)	10
GRO+DRO (EPA SW-846 Method 8015M)	10
BTEX (EPA SW-846 Method 8021B or 8260B)	0.3
Benzene (EPA SW-846 Method 8021B or 8260B)	0.5

Per Subsection B of 19.15.29.11 NMAC unless the site characterization report includes completed efforts at remediation, the report must include a proposed remediation plan in accordance with 19.15.29.12 NMAC, which includes the anticipated timelines for beginning and completing the remediation.

On what estimated date will the remediation commence	09/10/2024
On what date will (or did) the final sampling or liner inspection occur	09/17/2024
On what date will (or was) the remediation complete(d)	10/14/2024
What is the estimated surface area (in square feet) that will be reclaimed	3062
What is the estimated volume (in cubic yards) that will be reclaimed	700
What is the estimated surface area (in square feet) that will be remediated	3062
What is the estimated volume (in cubic yards) that will be remediated	700

These estimated dates and measurements are recognized to be the best guess or calculation at the time of submission and may (be) change(d) over time as more remediation efforts are completed.

The OCD recognizes that proposed remediation measures may have to be minimally adjusted in accordance with the physical realities encountered during remediation. If the responsible party has any need to significantly deviate from the remediation plan proposed, then it should consult with the division to determine if another remediation plan submission is required.

Sante Fe Main Office
Phone: (505) 476-3441

General Information
Phone: (505) 629-6116

Online Phone Directory
<https://www.emnrd.nm.gov/ocd/contact-us>

State of New Mexico
Energy, Minerals and Natural Resources
Oil Conservation Division
1220 S. St Francis Dr.
Santa Fe, NM 87505

QUESTIONS, Page 4

Action 406889

QUESTIONS (continued)

Operator: OXY USA INC P.O. Box 4294 Houston, TX 772104294	OGRID: 16696
	Action Number: 406889
	Action Type: [C-141] Remediation Closure Request C-141 (C-141-v-Closure)

QUESTIONS

Remediation Plan (continued)	
<i>Please answer all the questions that apply or are indicated. This information must be provided to the appropriate district office no later than 90 days after the release discovery date.</i>	
This remediation will (or is expected to) utilize the following processes to remediate / reduce contaminants:	
(Select all answers below that apply.)	
(Ex Situ) Excavation and off-site disposal (i.e. dig and haul, hydrovac, etc.)	Yes
Which OCD approved facility will be used for off-site disposal	GANDY MARLEY LANDFARM/LANDFILL [FEEM0112338393]
OR which OCD approved well (API) will be used for off-site disposal	Not answered.
OR is the off-site disposal site, to be used, out-of-state	Not answered.
OR is the off-site disposal site, to be used, an NMED facility	Not answered.
(Ex Situ) Excavation and on-site remediation (i.e. On-Site Land Farms)	Not answered.
(In Situ) Soil Vapor Extraction	Not answered.
(In Situ) Chemical processing (i.e. Soil Shredding, Potassium Permanganate, etc.)	Not answered.
(In Situ) Biological processing (i.e. Microbes / Fertilizer, etc.)	Not answered.
(In Situ) Physical processing (i.e. Soil Washing, Gypsum, Disking, etc.)	Not answered.
Ground Water Abatement pursuant to 19.15.30 NMAC	Not answered.
OTHER (Non-listed remedial process)	Not answered.
<i>Per Subsection B of 19.15.29.11 NMAC unless the site characterization report includes completed efforts at remediation, the report must include a proposed remediation plan in accordance with 19.15.29.12 NMAC, which includes the anticipated timelines for beginning and completing the remediation.</i>	
I hereby certify that the information given above is true and complete to the best of my knowledge and understand that pursuant to OCD rules and regulations all operators are required to report and/or file certain release notifications and perform corrective actions for releases which may endanger public health or the environment. The acceptance of a C-141 report by the OCD does not relieve the operator of liability should their operations have failed to adequately investigate and remediate contamination that pose a threat to groundwater, surface water, human health or the environment. In addition, OCD acceptance of a C-141 report does not relieve the operator of responsibility for compliance with any other federal, state, or local laws and/or regulations.	
I hereby agree and sign off to the above statement	Name: Wade Dittrich Title: Environmental Coordinator Email: wade_dittrich@oxy.com Date: 11/26/2024
<i>The OCD recognizes that proposed remediation measures may have to be minimally adjusted in accordance with the physical realities encountered during remediation. If the responsible party has any need to significantly deviate from the remediation plan proposed, then it should consult with the division to determine if another remediation plan submission is required.</i>	

Sante Fe Main Office
Phone: (505) 476-3441

General Information
Phone: (505) 629-6116

Online Phone Directory
<https://www.emnrd.nm.gov/ocd/contact-us>

State of New Mexico
Energy, Minerals and Natural Resources
Oil Conservation Division
1220 S. St Francis Dr.
Santa Fe, NM 87505

QUESTIONS, Page 5

Action 406889

QUESTIONS (continued)

Operator: OXY USA INC P.O. Box 4294 Houston, TX 772104294	OGRID: 16696
	Action Number: 406889
	Action Type: [C-141] Remediation Closure Request C-141 (C-141-v-Closure)

QUESTIONS

Deferral Requests Only	
Only answer the questions in this group if seeking a deferral upon approval this submission. Each of the following items must be confirmed as part of any request for deferral of remediation.	
Requesting a deferral of the remediation closure due date with the approval of this submission	No

Sante Fe Main Office
Phone: (505) 476-3441

General Information
Phone: (505) 629-6116

Online Phone Directory
<https://www.emnrd.nm.gov/ocd/contact-us>

State of New Mexico
Energy, Minerals and Natural Resources
Oil Conservation Division
1220 S. St Francis Dr.
Santa Fe, NM 87505

QUESTIONS, Page 6

Action 406889

QUESTIONS (continued)

Operator: OXY USA INC P.O. Box 4294 Houston, TX 772104294	OGRID: 16696
	Action Number: 406889
	Action Type: [C-141] Remediation Closure Request C-141 (C-141-v-Closure)

QUESTIONS

Sampling Event Information	
Last sampling notification (C-141N) recorded	382796
Sampling date pursuant to Subparagraph (a) of Paragraph (1) of Subsection D of 19.15.29.12 NMAC	09/17/2024
What was the (estimated) number of samples that were to be gathered	32
What was the sampling surface area in square feet	3062

Remediation Closure Request

Only answer the questions in this group if seeking remediation closure for this release because all remediation steps have been completed.

Requesting a remediation closure approval with this submission	Yes
Have the lateral and vertical extents of contamination been fully delineated	Yes
Was this release entirely contained within a lined containment area	No
All areas reasonably needed for production or subsequent drilling operations have been stabilized, returned to the sites existing grade, and have a soil cover that prevents ponding of water, minimizing dust and erosion	Yes
What was the total surface area (in square feet) remediated	3062
What was the total volume (cubic yards) remediated	700
All areas not reasonably needed for production or subsequent drilling operations have been reclaimed to contain a minimum of four feet of non-waste contain earthen material with concentrations less than 600 mg/kg chlorides, 100 mg/kg TPH, 50 mg/kg BTEX, and 10 mg/kg Benzene	Yes
What was the total surface area (in square feet) reclaimed	3062
What was the total volume (in cubic yards) reclaimed	700
Summarize any additional remediation activities not included by answers (above)	OXY excavated the spill area as depicted on the following site diagram. The leak area SP 1 (TEAL BLUE shade on diagram) was excavated to a depth of 3' Feet. Leak area around SP2, SP3 SP4 (YELLOW shade on diagram) was be excavated to a depth of 4' Feet. OXY collected bottom and sidewall confirmation samples every 200 square feet.

The responsible party must attach information demonstrating they have complied with all applicable closure requirements and any conditions or directives of the OCD. This demonstration should be in the form of a comprehensive report (in .pdf format) including a scaled site map, sampling diagrams, relevant field notes, photographs of any excavation prior to backfilling, laboratory data including chain of custody documents of final sampling, and a narrative of the remedial activities. Refer to 19.15.29.12 NMAC.

I hereby certify that the information given above is true and complete to the best of my knowledge and understand that pursuant to OCD rules and regulations all operators are required to report and/or file certain release notifications and perform corrective actions for releases which may endanger public health or the environment. The acceptance of a C-141 report by the OCD does not relieve the operator of liability should their operations have failed to adequately investigate and remediate contamination that pose a threat to groundwater, surface water, human health or the environment. In addition, OCD acceptance of a C-141 report does not relieve the operator of responsibility for compliance with any other federal, state, or local laws and/or regulations. The responsible party acknowledges they must substantially restore, reclaim, and re-vegetate the impacted surface area to the conditions that existed prior to the release or their final land use in accordance with 19.15.29.13 NMAC including notification to the OCD when reclamation and re-vegetation are complete.

I hereby agree and sign off to the above statement	Name: Wade Dittrich Title: Environmental Coordinator Email: wade_dittrich@oxy.com Date: 11/26/2024
--	--

Sante Fe Main Office
Phone: (505) 476-3441

General Information
Phone: (505) 629-6116

Online Phone Directory
<https://www.emnrd.nm.gov/ocd/contact-us>

State of New Mexico
Energy, Minerals and Natural Resources
Oil Conservation Division
1220 S. St Francis Dr.
Santa Fe, NM 87505

QUESTIONS, Page 7

Action 406889

QUESTIONS (continued)

Operator: OXY USA INC P.O. Box 4294 Houston, TX 772104294	OGRID: 16696
	Action Number: 406889
	Action Type: [C-141] Remediation Closure Request C-141 (C-141-v-Closure)

QUESTIONS

Reclamation Report	
Only answer the questions in this group if all reclamation steps have been completed.	
Requesting a reclamation approval with this submission	No

Sante Fe Main Office
Phone: (505) 476-3441

General Information
Phone: (505) 629-6116

Online Phone Directory
<https://www.emnrd.nm.gov/ocd/contact-us>

State of New Mexico
Energy, Minerals and Natural Resources
Oil Conservation Division
1220 S. St Francis Dr.
Santa Fe, NM 87505

CONDITIONS

Action 406889

CONDITIONS

Operator: OXY USA INC P.O. Box 4294 Houston, TX 772104294	OGRID: 16696
	Action Number: 406889
	Action Type: [C-141] Remediation Closure Request C-141 (C-141-v-Closure)

CONDITIONS

Created By	Condition	Condition Date
michael.buchanan	Remediation Closure Report is approved.	3/12/2025
michael.buchanan	A reclamation report will not be accepted until reclamation of the release area, including areas reasonably needed for production or drilling activities, is complete and meet the requirements of 19.15.29.13 NMAC. Areas not reasonably needed for production or drilling activities will still need to be reclaimed and revegetated as early as practicable.	3/12/2025
michael.buchanan	The reclamation report will need to include: Executive Summary of the reclamation activities; Scaled Site Map including sampling locations; Analytical results including, but not limited to, results showing that any remaining impacts meet the reclamation standards and results to prove the backfill is non-waste containing; At least one (1) representative 5-point composite sample will need to be collected from the backfill material that will be used for the reclamation of the top four feet of the excavation. The OCD reserves the right to request additional sampling if needed; pictures of the backfilled areas showing that the area is back, as nearly as practical, to the original condition or the final land use and maintain those areas to control dust and minimize erosion to the extent practical; pictures of the top layer, which is either the background thickness of topsoil or one foot of suitable material to establish vegetation at the site, whichever is greater; and a revegetation plan.	3/12/2025
michael.buchanan	A revegetation report will not be accepted until revegetation of the release area, including areas reasonably needed for production or drilling activities, is complete and meet the requirements of 19.15.29.13 NMAC. Areas not reasonably needed for production or drilling activities will still need to be reclaimed and revegetated as early as practicable.	3/12/2025
michael.buchanan	All revegetation activities will need to be documented and included in the revegetation report. The revegetation report will need to include: An executive summary of the revegetation activities including: Seed mix, Method of seeding, dates of when the release area was reseeded, information pertinent to inspections, information about any amendments added to the soil, information on how the vegetative cover established meets the life-form ratio of plus or minus fifty percent of pre-disturbance levels and a total percent plant cover of at least seventy percent of pre-disturbance levels, excluding noxious weeds per 19.15.29.13 D.(3) NMAC, and any additional information; a scaled Site Map including area that was revegetated in square feet; and pictures of the revegetated areas during reseeding activities, inspections, and final pictures when revegetation is achieved.	3/12/2025