



July 17, 2025

New Mexico Oil Conservation Division

1220 South St. Francis Drive
Santa Fe, New Mexico 87505

**Re: Closure Request
PLU BS 22 Federal Battery
Incident Number nAPP2435354652
Eddy County, New Mexico**

To Whom It May Concern:

Ensolum, LLC (Ensolum), on behalf of XTO Energy, Inc. (XTO), has prepared this *Closure Request* to document assessment, excavation, and soil sampling activities at the PLU BS 22 Federal Battery (Site). The purpose of the assessment and soil sampling activities was to assess for the presence or absence of impacts to soil following a flare fire resulting in crude oil overspray and scorching at the Site. Based on field observations, field screening activities, and soil sample laboratory analytical results, XTO is submitting this *Closure Request*, describing assessment, excavation, and soil sampling activities that have occurred and requesting no further remediation for Incident Number nAPP2435354652.

SITE DESCRIPTION AND RELEASE SUMMARY

The Site was reported to be located in Unit A, Section 27, Township 24 South, Range 30 East, in Eddy County, New Mexico (32.19607, -103.86129) at the entrance of a tank battery facility associated with oil and gas exploration and production operations on Federal Land managed by the Bureau of Land Management (BLM); however, after a review of internal documents, including photos, the release was found to be located near the southwest corner of the facility pad in Unit P, Section 22, Township 24 South, Range 30 East, in Eddy County, New Mexico (32.196604°, -103.862512°) and is associated with oil and gas exploration and production operations on Federal Land managed by the BLM.

On December 17, 2024, the flare scrubber sent approximately 6 barrels (bbls) of crude oil out of the flare, which ignited and extinguished by itself on the ground surface. There were no standing fluids to recover. XTO reported the release and fire to the New Mexico Oil Conservation Division (NMOCD) via Notification of Release (NOR) and an Initial C-141 Application (C-141) on December 18, 2024. The incident was assigned Incident Number nAPP2435354652.

Since the release occurred in the pasture, XTO submitted a Form 3160-5 (Sundry Form) to the BLM to request access to the pasture soils on February 6, 2025. XTO received an approved sundry on March 11, 2025, granting access to complete remediation. The approved Sundry Form is presented in Appendix A.

SITE CHARACTERIZATION AND CLOSURE CRITERIA

The Site was characterized to assess the applicability of Table I, Closure Criteria for Soils Impacted by a Release, of Title 19, Chapter 15, Part 29 (19.15.29) of the New Mexico Administrative Code (NMAC). Results from the characterization desktop review are presented below.

Depth to groundwater at the Site is estimated to be greater than 100 feet below ground surface (bgs) based on nearby groundwater data from a soil boring drilled to investigate regional groundwater depth. In August 2023, a soil boring permitted by New Mexico Office of the State Engineer (NMOSE), file number C-4761, was completed approximately 0.26 miles southwest of the Site. Soil boring C-4761 was drilled to a depth of 115 feet bgs. A field geologist logged and described soils continuously. No moisture or groundwater was encountered during drilling activities. A temporary well was installed and set at the total depth of the borehole. After a 72-hour waiting period without observing any groundwater in the well, it was confirmed that groundwater beneath the Site is greater than 115 feet bgs. The borehole was properly abandoned with drill cuttings and hydrated bentonite chips. The Well Record and Log are included in Appendix B.

The closest continuously flowing or significant watercourse to the Site is a freshwater emergent wetland, located approximately 1,729 feet north of the Site. The Site is greater than 200 feet from a lakebed, sinkhole, or playa lake and greater than 300 feet from an occupied residence, school, hospital, institution, church, or wetland. The Site is greater than 1,000 feet to a freshwater well or spring and is not within a 100-year floodplain or overlying a subsurface mine. The Site is not underlain by unstable geology (low potential karst designation area). Potential site receptors are identified on Figure 1.

Based on the results of the Site Characterization, the following NMOCD Table I Closure Criteria (Closure Criteria) apply:

- Benzene: 10 milligrams per kilogram (mg/kg)
- Benzene, toluene, ethylbenzene, and total xylenes (BTEX): 50 mg/kg
- Total petroleum hydrocarbons (TPH)-gasoline range organics (GRO) and TPH-diesel range organics (DRO): 1,000 mg/kg
- TPH: 2,500 mg/kg
- Chloride: 20,000 mg/kg

A reclamation requirement of 600 mg/kg chloride and 100 mg/kg TPH applies to the top 4 feet of the pasture area that was impacted by the release, per 19.15.29.13.D (1) NMAC.

SITE ASSESSMENT ACTIVITIES

On December 18, 2024, Ensolum personnel conducted a site assessment to evaluate the overspray caused by the release and soil staining from the fire based on information provided on the C-141 and visual observations. The overspray area consisted of charred surficial soils from the fire. The release area was mapped utilizing a handheld Global Positioning System (GPS) unit and is depicted on Figure 2. Photographic documentation was collected during the site assessment and Photographic Log is included in Appendix C.

EXCAVATION AND SOIL SAMPLING ACTIVITIES

On April 29 and May 15, 2025, Ensolum personnel returned to the Site to oversee excavation activities. Impacted soil was excavated from the release area as indicated by the charred surficial soils. Excavation activities were performed using heavy equipment. To direct excavation activities, Ensolum personnel field screened for volatile organic compounds (VOCs) utilizing a calibrated photoionization detector (PID) and chloride utilizing Hach® chloride QuanTab® test strips. Following the removal of impacted soil, Ensolum personnel collected 5-point composite soil samples representing no more than 200 square feet from the sidewalls and floor of the excavation. The 5-point composite soil samples were collected by placing five equivalent aliquots of soil into a 1-gallon, resealable plastic bag and homogenizing the samples by thoroughly mixing. Confirmation soil samples FS01 through FS05 were collected from the floor of the excavation at depths ranging from 0.5 feet to 2 feet bgs. Confirmation sidewall soil sample SW01 and SW02 were collected from the sidewall of the excavation at depths ranging from ground surface to 0.5 feet bgs and ground surface to 2 feet bgs, respectively. The excavation extent and soil sample locations are depicted on Figure 2. Photographic documentation is included in Appendix C.

All soil samples collected were placed directly into pre-cleaned glass jars, labeled with the location, date, time, sampler name, method of analysis, and immediately placed on ice. The soil samples were transported under strict chain-of-custody procedures to Cardinal Laboratories (Cardinal) in Hobbs, New Mexico, for analysis of the following contaminants of concern (COCs): BTEX following United States Environmental Protection Agency (EPA) Method 8021B; TPH-GRO, TPH-DRO, and TPH-oil range organics (ORO) following EPA Method 8015M/D; and chloride following Standard Method SM4500.

The final excavation extent measured approximately 990 square feet. A total of approximately 25 cubic yards of impacted soil was removed during the excavation activities. The impacted soil was transported and properly disposed of at the R360 Halfway Disposal in Hobbs, New Mexico. Copies of all soil disposal manifests are available upon request. The final excavation extent was backfilled with material purchased locally and recontoured to match pre-existing Site conditions.

LABORATORY ANALYTICAL RESULTS

Laboratory analytical results for all final confirmation soil samples collected indicated all COC concentrations were in compliance with the Closure Criteria and reclamation requirements. Laboratory analytical results for excavation soil sample FS04 initially indicated TPH concentrations exceeded the reclamation requirement, but the soil represented by this sample was removed during the May 2025 excavation activities and FS04 at 2 feet bgs was subsequently collected. Laboratory analytical results are summarized in Table 1 and laboratory analytical reports are included in Appendix D.

CLOSURE REQUEST

Site assessment and excavation activities were conducted at the Site to address the December 2024 flare fire release. Laboratory analytical results for all final confirmation soil samples collected from the final excavation extent indicated all COC concentrations were compliant with the Site Closure Criteria and reclamation requirements. Based on laboratory analytical results, no further remediation is required. Excavation of soil has mitigated impacts at this Site. Depth to groundwater has been estimated to be greater than 100 feet bgs and no sensitive receptors were identified near the release extent. XTO believes these remedial actions are protective of human health, the environment, and groundwater. As such, XTO respectfully requests no further remediation for Incident Number nAPP2435354652.

XTO Energy, Inc
Closure Request
PLU BS 22 Federal Battery



If you have any questions or comments, please contact Ms. Tacoma Morrissey at (337) 257-8307 or tmorrissey@ensolum.com.

Sincerely,
Ensolum, LLC

A handwritten signature in black ink that reads "Tracy Hillard".

Tracy Hillard
Project Engineer

A handwritten signature in black ink that reads "Ben J. Belill".

Benjamin J. Belill
Senior Geologist

cc: Colton Brown, XTO
Kaylan Dirkx, XTO
BLM

Appendices:

| | |
|------------|--|
| Figure 1 | Site Receptor Map |
| Figure 2 | Confirmation Soil Sample Locations |
| Table 1 | Soil Sample Analytical Results |
| Appendix A | Land Access References |
| Appendix B | Referenced Well Records |
| Appendix C | Photographic Log |
| Appendix D | Laboratory Analytical Reports & Chain-of-Custody Documentation |



FIGURES

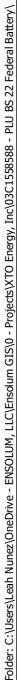
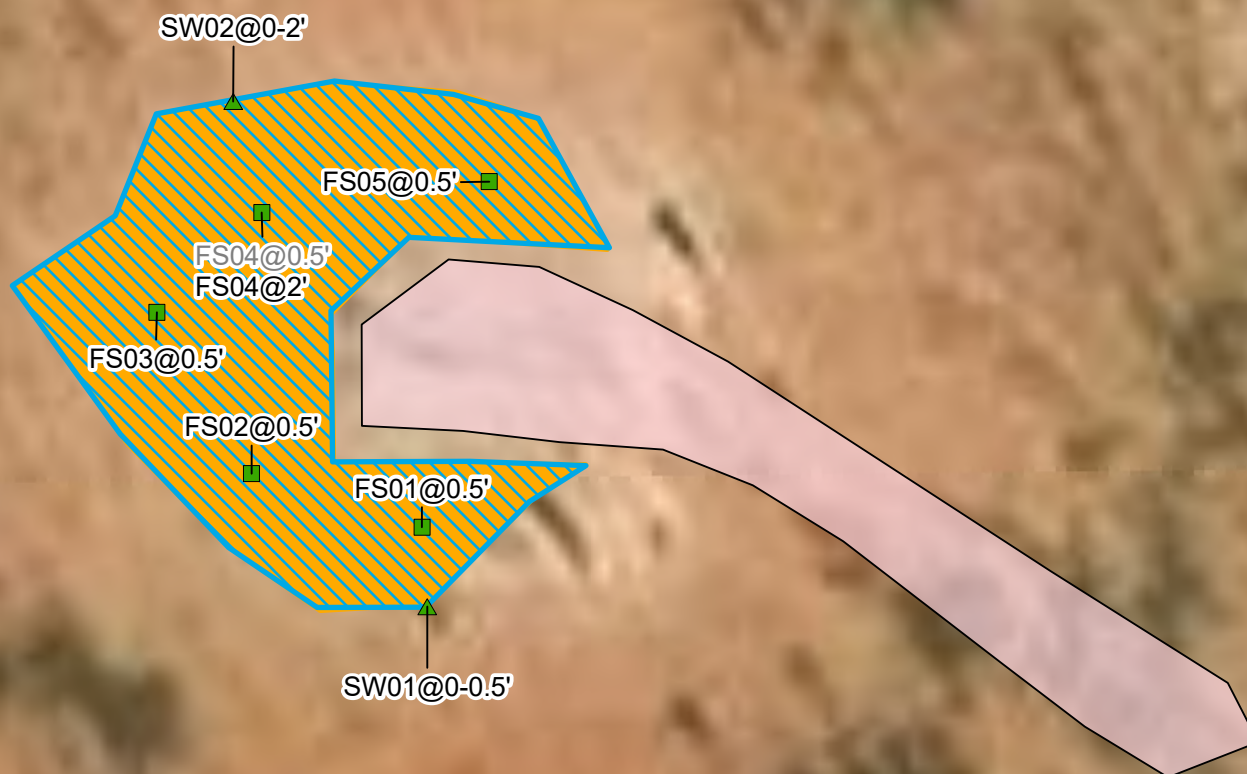

FIGURE
1

Legend

- Excavation Floor Sample in Compliance with Closure Criteria
- ▲ Excavation Sidewall Sample in Compliance with Closure Criteria
- ▨ Excavation Extent
- Release Extent
- Production Equipment



Notes:
 Sample ID @ Depth Below Ground Surface.
 Grey text indicate soil sample was removed during excavation activities.

0 15 30
 Feet

Sources: Environmental Systems Research Institute (ESRI)

Confirmation Soil Sample Locations

XTO Energy, Inc
 PLU BS 22 Federal Battery
 Incident Number: nAPP2435354652
 Unit P, Sec 22, T 24S, R 30E
 Eddy County, New Mexico

FIGURE

2





TABLES



TABLE 1
SOIL SAMPLE ANALYTICAL RESULTS
PLU BS 22 Federal Battery
XTO Energy, Inc
Eddy County, New Mexico

| Sample I.D. | Sample Date | Sample Depth (feet bgs) | Benzene (mg/kg) | Total BTEX (mg/kg) | TPH GRO (mg/kg) | TPH DRO (mg/kg) | TPH ORO (mg/kg) | GRO+DRO (mg/kg) | Total TPH (mg/kg) | Chloride (mg/kg) |
|--|-----------------------|-------------------------|----------------------|----------------------|---------------------|---------------------|---------------------|---------------------|---------------------|---------------------|
| NMOCD Table I Closure Criteria (NMAC 19.15.29) | | | 10 | 50 | NE | NE | NE | 1,000 | 2,500 | 20,000 |
| Confirmation Soil Samples | | | | | | | | | | |
| FS01 | 04/29/2025 | 0.5 | <0.050 | <0.300 | <10.0 | <10.0 | <10.0 | <10.0 | <10.0 | <16.0 |
| FS02 | 04/29/2025 | 0.5 | <0.050 | <0.300 | <10.0 | <10.0 | <10.0 | <10.0 | <10.0 | 432 |
| FS03 | 04/29/2025 | 0.5 | <0.050 | <0.300 | <10.0 | <10.0 | <10.0 | <10.0 | <10.0 | 224 |
| FS04 | 04/29/2025 | 0.5 | <0.050 | <0.300 | <10.0 | <10.0 | <10.0 | <10.0 | <10.0 | <16.0 |
| FS04 | 05/15/2025 | 2 | <0.050 | <0.300 | <10.0 | <10.0 | <10.0 | <10.0 | <10.0 | 80.0 |
| FS05 | 04/29/2025 | 0.5 | <0.050 | <0.300 | <10.0 | 21.1 | <10.0 | 21.1 | 21.1 | 48.0 |
| SW01 | 04/29/2025 | 0-0.5 | <0.050 | <0.300 | <10.0 | <10.0 | <10.0 | <10.0 | <10.0 | 208 |
| SW02 | 05/15/2025 | 0-2 | <0.050 | <0.300 | <10.0 | <10.0 | <10.0 | <10.0 | <10.0 | 80.0 |

Notes:

bgs: below ground surface

mg/kg: milligrams per kilogram

NMOCD: New Mexico Oil Conservation Division

BTEX: Benzene, Toluene, Ethylbenzene, and Xylenes

Concentrations in **bold** exceed the NMOCD Table I Closure Criteria or reclamation requirement where applicable.

GRO: Gasoline Range Organics

DRO: Diesel Range Organics

ORO: Oil Range Organics

TPH: Total Petroleum Hydrocarbon

NMAC: New Mexico Administrative Code

~~Grey~~: text indicates soil sample removed during excavation activities



APPENDIX A

Land Access References

| | | |
|--------------------------------------|--|-----------------------------------|
| Well Name: POKER LAKE UNIT CVX JV BS | Well Location: T24S / R30E / SEC 22 / SESE / 32.1963899 / -103.8615877 | County or Parish/State: EDDY / NM |
| Well Number: 3H | Type of Well: OIL WELL | Allottee or Tribe Name: |
| Lease Number: NMNM02862 | Unit or CA Name: PLU BIG SINKS 26 FEDERAL 1H | Unit or CA Number: NMNM71016L |
| US Well Number: 3001537838 | Operator: XTO PERMIAN OPERATING LLC | |

Notice of Intent

Sundry ID: 2835772

Type of Submission: Notice of Intent Type of Action: Other

Date Sundry Submitted: 02/06/2025 Time Sundry Submitted: 01:35

Date proposed operation will begin: 02/10/2025

Procedure Description: XTO Permian Operating LLC (XTO) respectfully requests access to an off-pad area located 280 feet west of the Poker Lake Unit CVX JV BS #003H well in order to complete remediation activities related to a flare fire (Incident Number nAPP2435354652) which occurred on December 17, 2024. The flare fire release occurred at the flare stack located in an off-pad pasture area. Excavation of scorched surficial soils and vegetation is needed utilizing heavy equipment (backhoe and skid steer). After successful completion of remediation efforts, the disturbed area will be backfilled with topsoil purchased locally and re-contoured to match pre-existing conditions. The disturbed area will be re-seeded with the recommended BLM seed mixture. Excavation activities will begin within 90 days following approval of this request. Please see the attached site map for requested disturbance area.

Surface Disturbance

Is any additional surface disturbance proposed?: Yes

Proposed Disturbance(acres): 1.51 Interim Reclamation (acres): 0.0 Long Term Disturbance (acres): 0.0

Surface Disturbance:

NOI Attachments

Procedure Description

Requested_Disturbance_Site_Map___PLU_BS_22_Battery___nAPP2435354652_20250206133346.pdf

Received by OCD: 7/18/2025 7:19:12 AM

Page 12 of 49

| | | |
|--------------------------------------|--|-----------------------------------|
| Well Name: POKER LAKE UNIT CVX JV BS | Well Location: T24S / R30E / SEC 22 / SESE / 32.1963899 / -103.8615877 | County or Parish/State: EDDY / NM |
| Well Number: 3H | Type of Well: OIL WELL | Allottee or Tribe Name: |
| Lease Number: NMNM02862 | Unit or CA Name: PLU BIG SINKS 26 FEDERAL 1H | Unit or CA Number: NMNM71016L |
| US Well Number: 3001537838 | Operator: XTO PERMIAN OPERATING LLC | |

Operator

I certify that the foregoing is true and correct. Title 18 U.S.C. Section 1001 and Title 43 U.S.C. Section 1212, make it a crime for any person knowingly and willfully to make to any department or agency of the United States any false, fictitious or fraudulent statements or representations as to any matter within its jurisdiction. Electronic submission of Sundry Notices through this system satisfies regulations requiring a

| | |
|---|----------------------------------|
| Operator Electronic Signature: SHERRY MORROW | Signed on: FEB 06, 2025 01:34 PM |
| Name: XTO PERMIAN OPERATING LLC | |
| Title: Regulatory Analyst | |
| Street Address: 6401 HOLIDAY HILL ROAD BLDG 5 | |
| City: MIDLAND | State: TX |
| Phone: (432) 218-3671 | |
| Email address: SHERRY.MORROW@EXXONMOBIL.COM | |

Field

| | | |
|----------------------|--------|------|
| Representative Name: | | |
| Street Address: | | |
| City: | State: | Zip: |
| Phone: | | |
| Email address: | | |

BLM Point of Contact

| | |
|-------------------------------|--|
| BLM POC Name: CRISHA A MORGAN | BLM POC Title: Environmental Protection Specialist |
| BLM POC Phone: 5752345987 | BLM POC Email Address: camorgan@blm.gov |
| Disposition: Approved | Disposition Date: 03/11/2025 |
| Signature: CRISHA A. MORGAN | |

| | | |
|--|--|---|
| Form 3160-5 (June 2019) | UNITED STATES DEPARTMENT OF THE INTERIOR BUREAU OF LAND MANAGEMENT | FORM APPROVED OMB No. 1004-0137 Expires: October 31, 2021 |
| SUNDRY NOTICES AND REPORTS ON WELLS <i>Do not use this form for proposals to drill or to re-enter an abandoned well. Use Form 3160-3 (APD) for such proposals.</i> | | 5. Lease Serial No. |
| | | 6. If Indian, Allottee or Tribe Name |

| | | |
|---|-----------------------------------|---|
| SUBMIT IN TRIPLICATE - Other instructions on page 2 | | 7. If Unit of CA/Agreement, Name and/or No. |
| 1. Type of Well <input type="checkbox"/> Oil Well <input type="checkbox"/> Gas Well <input type="checkbox"/> Other | | 8. Well Name and No. |
| 2. Name of Operator | | 9. API Well No. |
| 3a. Address | 3b. Phone No. (include area code) | 10. Field and Pool or Exploratory Area |
| 4. Location of Well (Footage, Sec., T.,R.,M., or Survey Description) | | 11. Country or Parish, State |

| | | | | |
|--|---|---|--|---|
| 12. CHECK THE APPROPRIATE BOX(ES) TO INDICATE NATURE OF NOTICE, REPORT OR OTHER DATA | | | | |
| TYPE OF SUBMISSION | TYPE OF ACTION | | | |
| <input type="checkbox"/> Notice of Intent | <input type="checkbox"/> Acidize | <input type="checkbox"/> Deepen | <input type="checkbox"/> Production (Start/Resume) | <input type="checkbox"/> Water Shut-Off |
| | <input type="checkbox"/> Alter Casing | <input type="checkbox"/> Hydraulic Fracturing | <input type="checkbox"/> Reclamation | <input type="checkbox"/> Well Integrity |
| <input type="checkbox"/> Subsequent Report | <input type="checkbox"/> Casing Repair | <input type="checkbox"/> New Construction | <input type="checkbox"/> Recomplete | <input type="checkbox"/> Other |
| | <input type="checkbox"/> Change Plans | <input type="checkbox"/> Plug and Abandon | <input type="checkbox"/> Temporarily Abandon | |
| <input type="checkbox"/> Final Abandonment Notice | <input type="checkbox"/> Convert to Injection | <input type="checkbox"/> Plug Back | <input type="checkbox"/> Water Disposal | |

13. Describe Proposed or Completed Operation: Clearly state all pertinent details, including estimated starting date of any proposed work and approximate duration thereof. If the proposal is to deepen directionally or recompleate horizontally, give subsurface locations and measured and true vertical depths of all pertinent markers and zones. Attach the Bond under which the work will be perfonned or provide the Bond No. on file with BLM/BIA. Required subsequent reports must be filed within 30 days following completion of the involved operations. If the operation results in a multiple completion or recompletion in a new interval, a Form 3160-4 must be filed once testing has been completed. Final Abandonment Notices must be filed only after all requirements, including reclamation, have been completed and the operator has detennined that the site is ready for final inspection.)

| | | |
|---|-------|--|
| 14. I hereby certify that the foregoing is true and correct. Name (Printed/Typed) | | |
| | Title | |
| Signature | Date | |

| | | |
|---|--------|------|
| THE SPACE FOR FEDERAL OR STATE OFICE USE | | |
| Approved by | Title | Date |
| Conditions of approval, if any, are attached. Approval of this notice does not warrant or certify that the applicant holds legal or equitable title to those rights in the subject lease which would entitle the applicant to conduct operations thereon. | Office | |

Title 18 U.S.C Section 1001 and Title 43 U.S.C Section 1212, make it a crime for any person knowingly and willfully to make to any department or agency of the United States any false, fictitious or fraudulent statements or representations as to any matter within its jurisdiction.

(Instructions on page 2)

GENERAL INSTRUCTIONS

This form is designed for submitting proposals to perform certain well operations and reports of such operations when completed as indicated on Federal and Indian lands pursuant to applicable Federal law and regulations. Any necessary special instructions concerning the use of this form and the number of copies to be submitted, particularly with regard to local area or regional procedures and practices, are either shown below, will be issued by or may be obtained from the local Federal office.

SPECIFIC INSTRUCTIONS

Item 4 - Locations on Federal or Indian land should be described in accordance with Federal requirements. Consult the local Federal office for specific instructions.

Item 13: Proposals to abandon a well and subsequent reports of abandonment should include such special information as is required by the local Federal office. In addition, such proposals and reports should include reasons for the abandonment; data on any former or present productive zones or other zones with present significant fluid contents not sealed off by cement or otherwise; depths (top and bottom) and method of placement of cement plugs; mud or other material placed below, between and above plugs; amount, size, method of parting of any casing, liner or tubing pulled and the depth to the top of any tubing left in the hole; method of closing top of well and date well site conditioned for final inspection looking for approval of the abandonment. If the proposal will involve **hydraulic fracturing operations**, you must comply with 43 CFR 3162.3-3, including providing information about the protection of usable water. Operators should provide the best available information about all formations containing water and their depths. This information could include data and interpretation of resistivity logs run on nearby wells. Information may also be obtained from state or tribal regulatory agencies and from local BLM offices.

NOTICES

The privacy Act of 1974 and the regulation in 43 CFR 2.48(d) provide that you be furnished the following information in connection with information required by this application.

AUTHORITY: 30 U.S.C. 181 et seq., 351 et seq., 25 U.S.C. 396; 43 CFR 3160.

PRINCIPAL PURPOSE: The information is used to: (1) Evaluate, when appropriate, approve applications, and report completion of subsequent well operations, on a Federal or Indian lease; and (2) document for administrative use, information for the management, disposal and use of National Resource lands and resources, such as: (a) evaluating the equipment and procedures to be used during a proposed subsequent well operation and reviewing the completed well operations for compliance with the approved plan; (b) requesting and granting approval to perform those actions covered by 43 CFR 3162.3-2, 3162.3-3, and 3162.3-4; (c) reporting the beginning or resumption of production, as required by 43 CFR 3162.4-1(c) and (d) analyzing future applications to drill or modify operations in light of data obtained and methods used.

ROUTINE USES: Information from the record and/or the record will be transferred to appropriate Federal, State, local or foreign agencies, when relevant to civil, criminal or regulatory investigations or prosecutions in connection with congressional inquiries or to consumer reporting agencies to facilitate collection of debts owed the Government.

EFFECT OF NOT PROVIDING THE INFORMATION: Filing of this notice and report and disclosure of the information is mandatory for those subsequent well operations specified in 43 CFR 3162.3-2, 3162.3-3, 3162.3-4.

The Paperwork Reduction Act of 1995 requires us to inform you that:

The BLM collects this information to evaluate proposed and/or completed subsequent well operations on Federal or Indian oil and gas leases.

Response to this request is mandatory.

The BLM would like you to know that you do not have to respond to this or any other Federal agency-sponsored information collection unless it displays a currently valid OMB control number.

BURDEN HOURS STATEMENT: Public reporting burden for this form is estimated to average 8 hours per response, including the time for reviewing instructions, gathering and maintaining data, and completing and reviewing the form. Direct comments regarding the burden estimate or any other aspect of this form to U.S. Department of the Interior, Bureau of Land Management (1004-0137), Bureau Information Collection Clearance Officer (WO-630), 1849 C St., N.W., Mail Stop 401 LS, Washington, D.C. 20240

Additional Information

Location of Well

0. SHL: SESE / 175 FSL / 400 FEL / TWSP: 24S / RANGE: 30E / SECTION: 22 / LAT: 32.1963899 / LONG: -103.8615877 (TVD: 8185 feet, MD: 12871 feet)



PPP: SESE / 175 FSL / 400 FEL / TWSP: 24S / RANGE: 30E / SECTION: 22 / LAT: 0.0 / LONG: 0.0 (TVD: 0 feet, MD: 0 feet)

BHL: NENE / 358 FNL / 393 FEL / TWSP: 24S / RANGE: 30E / SECTION: 22 / LAT: 0.0 / LONG: 0.0 (TVD: 8185 feet, MD: 12871 feet)

PLU BS 22 Battery

Requested Area of Disturbance

Legend

-  Disturbance Area
-  Release/Scorched Area



Google Earth

300 ft



APPENDIX B

Referenced Well Records



WELL RECORD & LOG

OFFICE OF THE STATE ENGINEER

www.ose.state.nm.us

| | | | | | | | | |
|---|---|-------------------|---|---|---|--|---|--------------------------|
| 1. GENERAL AND WELL LOCATION | OSE POD NO. (WELL NO.) Pod 1 (BH01) | | WELL TAG ID NO. n/a | | OSE FILE NO(S). C-4761 | | | |
| | WELL OWNER NAME(S) XTO Energy, Inc. | | | | PHONE (OPTIONAL) | | | |
| | WELL OWNER MAILING ADDRESS 3401 E, Greene Street | | | | CITY Carlsbad | STATE NM | ZIP 88220 | |
| | WELL LOCATION (FROM GPS) | DEGREES 32 | MINUTES 11 | SECONDS 43.46 | N | * ACCURACY REQUIRED: ONE TENTH OF A SECOND | | |
| | | LONGITUDE -103 | 51 | 56.21 | W | * DATUM REQUIRED: WGS 84 | | |
| DESCRIPTION RELATING WELL LOCATION TO STREET ADDRESS AND COMMON LANDMARKS – PLSS (SECTION, TOWNSHIP, RANGE) WHERE AVAILABLE Unit B, Section 27, Township 24 South, Range 30 East | | | | | | | | |
| 2. DRILLING & CASING INFORMATION | LICENSE NO. WD-1188 | | NAME OF LICENSED DRILLER Scott Scarborough | | | NAME OF WELL DRILLING COMPANY Scarborough Drilling Inc. | | |
| | DRILLING STARTED 8/3/2023 | | DRILLING ENDED 8/3/2023 | | DEPTH OF COMPLETED WELL (FT) Temp casing only | BORE HOLE DEPTH (FT) 115 | DEPTH WATER FIRST ENCOUNTERED (FT) N/A | |
| | COMPLETED WELL IS: <input type="checkbox"/> ARTESIAN <input checked="" type="checkbox"/> DRY HOLE <input type="checkbox"/> SHALLOW (UNCONFINED) | | | | | STATIC WATER LEVEL IN COMPLETED WELL (FT) N/A | | |
| | DRILLING FLUID: <input checked="" type="checkbox"/> AIR <input type="checkbox"/> MUD ADDITIVES – SPECIFY: | | | | | | | |
| | DRILLING METHOD: <input checked="" type="checkbox"/> ROTARY <input type="checkbox"/> HAMMER <input type="checkbox"/> CABLE TOOL <input type="checkbox"/> OTHER – SPECIFY: | | | | | | | |
| | DEPTH (feet bgl) | | BORE HOLE DIAM. (inches) | CASING MATERIAL AND/OR GRADE (include each casing string, and note sections of screen) | CASING CONNECTION TYPE (add coupling diameter) | CASING INSIDE DIAM. (inches) | CASING WALL THICKNESS (inches) | SLOT SIZE (inches) |
| | FROM | TO | | | | | | |
| | 0 | 115 | 6 | Temporary SCH 40 PVC | - | 2 | - | - |
| | | | | | | | | |
| | | | | | | | | |
| | | | | | | | | |
| | | | | | | | | |
| | | | | | | | | |
| 3. ANNULAR MATERIAL | DEPTH (feet bgl) | | BORE HOLE DIAM. (inches) | LIST ANNULAR SEAL MATERIAL AND GRAVEL PACK SIZE-RANGE BY INTERVAL | AMOUNT (cubic feet) | METHOD OF PLACEMENT | | |
| | FROM | TO | | | | | | |
| | | | | N/A | | | | |
| | | | | | | | | |
| | | | | | | | | |
| | | | | | | | | |
| | | | | | | | | |
| | | | | | | | | |

FOR OSE INTERNAL USE

WR-20 WELL RECORD & LOG (Version 04/30/19)

| | | |
|----------|-----------------|-------------|
| FILE NO. | POD NO. | TRN NO. |
| LOCATION | WELL TAG ID NO. | PAGE 1 OF 2 |

| 4. HYDROGEOLOGIC LOG OF WELL | DEPTH (feet bgl) | | THICKNESS (feet) | COLOR AND TYPE OF MATERIAL ENCOUNTERED - INCLUDE WATER-BEARING CAVITIES OR FRACTURE ZONES (attach supplemental sheets to fully describe all units) | WATER BEARING? (YES / NO) | ESTIMATED YIELD FOR WATER- BEARING ZONES (gpm) |
|---|------------------|-----|---------------------|--|--|--|
| | FROM | TO | | | | |
| | 0 | 20 | 20 | Tan Caliche | Y ✓ N | |
| | 20 | 40 | 20 | Orange-Brown Sand | Y ✓ N | |
| | 40 | 115 | 75 | Orange Sand | Y ✓ N | |
| | | | | | Y N | |
| | | | | | Y N | |
| | | | | | Y N | |
| | | | | | Y N | |
| | | | | | Y N | |
| | | | | | Y N | |
| | | | | | Y N | |
| | | | | | Y N | |
| | | | | | Y N | |
| | | | | | Y N | |
| | | | | | Y N | |
| | | | | | Y N | |
| | | | | | Y N | |
| | | | | | Y N | |
| | | | | | Y N | |
| | | | | | Y N | |
| | | | | | Y N | |
| | | | | | Y N | |
| | | | | | Y N | |
| METHOD USED TO ESTIMATE YIELD OF WATER-BEARING STRATA: <input type="checkbox"/> PUMP <input type="checkbox"/> AIR LIFT <input type="checkbox"/> BAILER <input type="checkbox"/> OTHER – SPECIFY: | | | | | TOTAL ESTIMATED WELL YIELD (gpm): 0.00 | |

| 5. TEST; RIG SUPERVISION | WELL TEST | TEST RESULTS - ATTACH A COPY OF DATA COLLECTED DURING WELL TESTING, INCLUDING DISCHARGE METHOD, START TIME, END TIME, AND A TABLE SHOWING DISCHARGE AND DRAWDOWN OVER THE TESTING PERIOD. |
|--------------------------|--|---|
| | MISCELLANEOUS INFORMATION: Temporary casing removed and soil boring backfilled using drill cuttings from terminal depth to 10 feet below ground surface (bgs), then hydrated bentonite chips from 10 feet bgs to ground surface. | |
| | PRINT NAME(S) OF DRILL RIG SUPERVISOR(S) THAT PROVIDED ONSITE SUPERVISION OF WELL CONSTRUCTION OTHER THAN LICENSEE: Scott Scarborough, Meredith Roberts | |

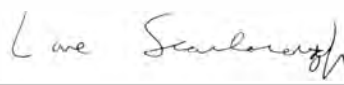
| 6. SIGNATURE | BY SIGNING BELOW, I CERTIFY THAT TO THE BEST OF MY KNOWLEDGE AND BELIEF, THE FOREGOING IS A TRUE AND CORRECT RECORD OF THE ABOVE DESCRIBED WELL. I ALSO CERTIFY THAT THE WELL TAG, IF REQUIRED, HAS BEEN INSTALLED AND THAT THIS WELL RECORD WILL ALSO BE FILED WITH THE PERMIT HOLDER WITHIN 30 DAYS AFTER THE COMPLETION OF WELL DRILLING. | |
|--------------|--|-----------|
| |  Lane Scarborough | 2/25/2025 |
| | SIGNATURE OF DRILLER / PRINT SIGNEE NAME | DATE |

FOR OSE INTERNAL USE

WR-20 WELL RECORD & LOG (Version 04/30/2019)

| | | |
|----------|-----------------|-------------|
| FILE NO. | POD NO. | TRN NO. |
| LOCATION | WELL TAG ID NO. | PAGE 2 OF 2 |



APPENDIX C

Photographic Log



Photographic Log
 XTO Energy, Inc
 PLU BS 22 Federal Battery
 nAPP2435354652



Photograph: 1 Date: 12/18/2024
 Description: Scorching at initial site visit
 View: East



Photograph: 2 Date: 4/29/2025
 Description: Excavation activities; near FS01
 View: Northwest

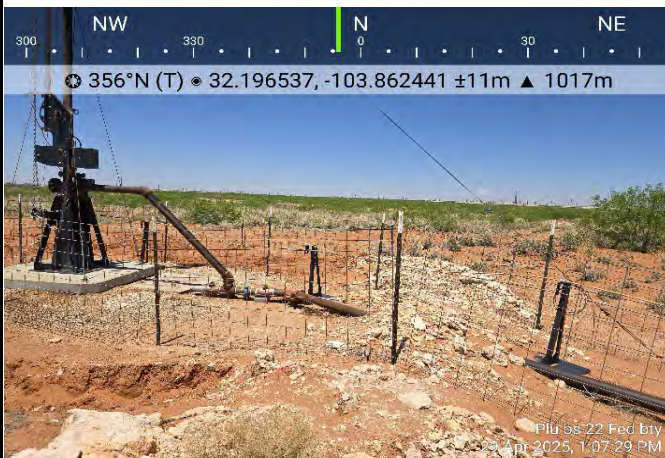

Photograph: 3 Date: 4/29/2025
 Description: Excavation activities; near FS01
 View: North

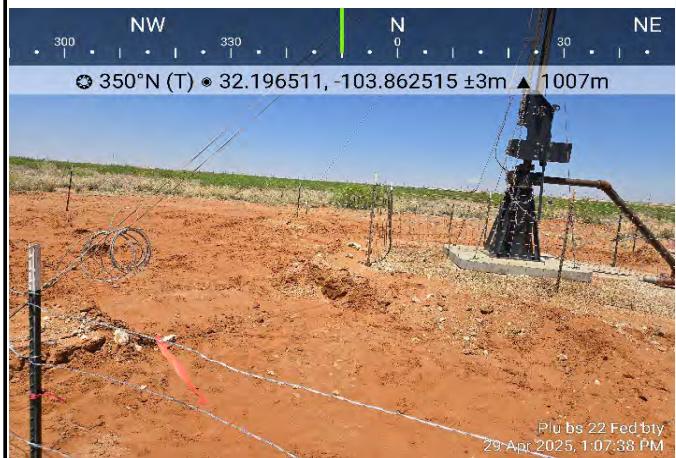

Photograph: 4 Date: 4/29/2025
 Description: Excavation activities; near FS02
 View: North



Photographic Log
 XTO Energy, Inc
 PLU BS 22 Federal Battery
 nAPP2435354652

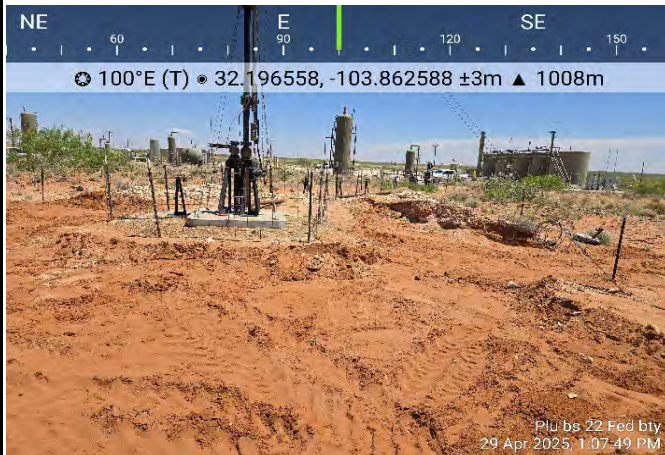

Photograph: 5 Date: 4/29/2024
 Description: Excavation activities; near FS03
 View: East

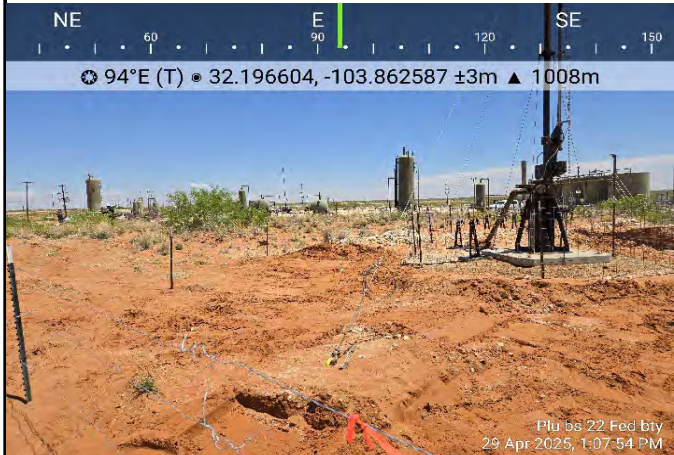

Photograph: 6 Date: 4/29/2025
 Description: Excavation activities; near FS04
 View: East

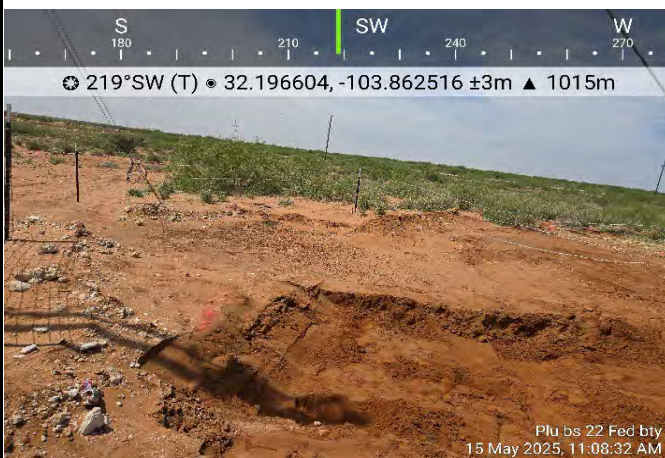

Photograph: 7 Date: 5/15/2025
 Description: Excavation activities; FS04
 View: Southwest



Photograph: 8 Date: 6/11/2025
 Description: Backfilled excavation
 View: Northeast



APPENDIX E

Laboratory Analytical Reports & Chain of Custody Documentation



PHONE (575) 393-2326 ° 101 E. MARLAND ° HOBBS, NM 88240

May 05, 2025

TRACY HILLARD

ENSOLUM, LLC

705 W WADLEY AVE.

MIDLAND, TX 79705

RE: PLU BS 22 FEDERAL BATTERY - SPILLS

Enclosed are the results of analyses for samples received by the laboratory on 05/01/25 13:00.

Cardinal Laboratories is accredited through Texas NELAP under certificate number TX-C24-00112. Accreditation applies to drinking water, non-potable water and solid and chemical materials. All accredited analytes are denoted by an asterisk (*). For a complete list of accredited analytes and matrices visit the TCEQ website at www.tceq.texas.gov/field/qa/lab_accred_certif.html.

Cardinal Laboratories is accredited through the State of Colorado Department of Public Health and Environment for:

| | |
|------------------|------------------------------|
| Method EPA 552.2 | Haloacetic Acids (HAA-5) |
| Method EPA 524.2 | Total Trihalomethanes (TTHM) |
| Method EPA 524.4 | Regulated VOCs (V1, V2, V3) |

Accreditation applies to public drinking water matrices.

This report meets NELAP requirements and is made up of a cover page, analytical results, and a copy of the original chain-of-custody. If you have any questions concerning this report, please feel free to contact me.

Sincerely,

A handwritten signature in black ink that reads "Celey D. Keene". The signature is written in a cursive style with a large, stylized 'C' and 'K'.

Celey D. Keene

Lab Director/Quality Manager



PHONE (575) 393-2326 ° 101 E. MARLAND ° HOBBS, NM 88240

Analytical Results For:

ENSOLUM, LLC
 TRACY HILLARD
 705 W WADLEY AVE.
 MIDLAND TX, 79705
 Fax To:

Received: 05/01/2025
 Reported: 05/05/2025
 Project Name: PLU BS 22 FEDERAL BATTERY - SPILLS
 Project Number: 03C1558588
 Project Location: XTO - 32.19642-103.86117

Sampling Date: 04/29/2025
 Sampling Type: Soil
 Sampling Condition: Cool & Intact
 Sample Received By: Tamara Oldaker

Sample ID: FS 01 0.5' (H252611-01)

| BTEx 8021B | | mg/kg | | Analyzed By: JH | | | | | |
|----------------|--------|-----------------|------------|-----------------|------|------------|---------------|---------|-----------|
| Analyte | Result | Reporting Limit | Analyzed | Method Blank | BS | % Recovery | True Value QC | RPD | Qualifier |
| Benzene* | <0.050 | 0.050 | 05/01/2025 | ND | 1.83 | 91.7 | 2.00 | 1.13 | |
| Toluene* | <0.050 | 0.050 | 05/01/2025 | ND | 1.96 | 98.2 | 2.00 | 0.00372 | |
| Ethylbenzene* | <0.050 | 0.050 | 05/01/2025 | ND | 1.99 | 99.4 | 2.00 | 0.603 | |
| Total Xylenes* | <0.150 | 0.150 | 05/01/2025 | ND | 6.29 | 105 | 6.00 | 0.751 | |
| Total BTEX | <0.300 | 0.300 | 05/01/2025 | ND | | | | | |

Surrogate: 4-Bromofluorobenzene (PID) 113 % 71.5-134

| Chloride, SM4500Cl-B | | mg/kg | | Analyzed By: AC | | | | | | |
|----------------------|--------|-----------------|------------|-----------------|-----|------------|---------------|------|-----------|--|
| Analyte | Result | Reporting Limit | Analyzed | Method Blank | BS | % Recovery | True Value QC | RPD | Qualifier | |
| Chloride | <16.0 | 16.0 | 05/02/2025 | ND | 448 | 112 | 400 | 3.64 | | |

| TPH 8015M | | mg/kg | | Analyzed By: MS | | | | | |
|------------------|--------|-----------------|------------|-----------------|-----|------------|---------------|-------|-----------|
| Analyte | Result | Reporting Limit | Analyzed | Method Blank | BS | % Recovery | True Value QC | RPD | Qualifier |
| GRO C6-C10* | <10.0 | 10.0 | 05/01/2025 | ND | 211 | 105 | 200 | 1.95 | |
| DRO >C10-C28* | <10.0 | 10.0 | 05/01/2025 | ND | 203 | 102 | 200 | 0.488 | |
| EXT DRO >C28-C36 | <10.0 | 10.0 | 05/01/2025 | ND | | | | | |

Surrogate: 1-Chlorooctane 83.5 % 44.4-145

Surrogate: 1-Chlorooctadecane 80.4 % 40.6-153

Cardinal Laboratories

*=Accredited Analyte

PLEASE NOTE: Liability and Damages. Cardinal's liability and client's exclusive remedy for any claim arising, whether based in contract or tort, shall be limited to the amount paid by client for analyses. All claims, including those for negligence and any other cause whatsoever shall be deemed waived unless made in writing and received by Cardinal within thirty (30) days after completion of the applicable service. In no event shall Cardinal be liable for incidental or consequential damages, including, without limitation, business interruptions, loss of use, or loss of profits incurred by client, its subsidiaries, affiliates or successors arising out of or related to the performance of the services hereunder by Cardinal, regardless of whether such claim is based upon any of the above stated reasons or otherwise. Results relate only to the samples identified above. This report shall not be reproduced except in full with written approval of Cardinal Laboratories.

Celey D. Keene, Lab Director/Quality Manager



PHONE (575) 393-2326 ° 101 E. MARLAND ° HOBBS, NM 88240

Analytical Results For:

ENSOLUM, LLC
 TRACY HILLARD
 705 W WADLEY AVE.
 MIDLAND TX, 79705
 Fax To:

Received: 05/01/2025
 Reported: 05/05/2025
 Project Name: PLU BS 22 FEDERAL BATTERY - SPILLS
 Project Number: 03C1558588
 Project Location: XTO - 32.19642-103.86117

Sampling Date: 04/29/2025
 Sampling Type: Soil
 Sampling Condition: Cool & Intact
 Sample Received By: Tamara Oldaker

Sample ID: FS 02 0.5' (H252611-02)

| BTEx 8021B | | mg/kg | | Analyzed By: JH | | | | | |
|----------------|--------|-----------------|------------|-----------------|------|------------|---------------|---------|-----------|
| Analyte | Result | Reporting Limit | Analyzed | Method Blank | BS | % Recovery | True Value QC | RPD | Qualifier |
| Benzene* | <0.050 | 0.050 | 05/01/2025 | ND | 1.83 | 91.7 | 2.00 | 1.13 | |
| Toluene* | <0.050 | 0.050 | 05/01/2025 | ND | 1.96 | 98.2 | 2.00 | 0.00372 | |
| Ethylbenzene* | <0.050 | 0.050 | 05/01/2025 | ND | 1.99 | 99.4 | 2.00 | 0.603 | |
| Total Xylenes* | <0.150 | 0.150 | 05/01/2025 | ND | 6.29 | 105 | 6.00 | 0.751 | |
| Total BTEX | <0.300 | 0.300 | 05/01/2025 | ND | | | | | |

Surrogate: 4-Bromofluorobenzene (PID) 111 % 71.5-134

| Chloride, SM4500Cl-B | | mg/kg | | Analyzed By: AC | | | | | |
|----------------------|--------|-----------------|------------|-----------------|-----|------------|---------------|------|-----------|
| Analyte | Result | Reporting Limit | Analyzed | Method Blank | BS | % Recovery | True Value QC | RPD | Qualifier |
| Chloride | 432 | 16.0 | 05/02/2025 | ND | 448 | 112 | 400 | 3.64 | |

| TPH 8015M | | mg/kg | | Analyzed By: MS | | | | | |
|------------------|--------|-----------------|------------|-----------------|-----|------------|---------------|-------|-----------|
| Analyte | Result | Reporting Limit | Analyzed | Method Blank | BS | % Recovery | True Value QC | RPD | Qualifier |
| GRO C6-C10* | <10.0 | 10.0 | 05/01/2025 | ND | 211 | 105 | 200 | 1.95 | |
| DRO >C10-C28* | <10.0 | 10.0 | 05/01/2025 | ND | 203 | 102 | 200 | 0.488 | |
| EXT DRO >C28-C36 | <10.0 | 10.0 | 05/01/2025 | ND | | | | | |

Surrogate: 1-Chlorooctane 90.1 % 44.4-145

Surrogate: 1-Chlorooctadecane 85.8 % 40.6-153

Cardinal Laboratories

*=Accredited Analyte

PLEASE NOTE: Liability and Damages. Cardinal's liability and client's exclusive remedy for any claim arising, whether based in contract or tort, shall be limited to the amount paid by client for analyses. All claims, including those for negligence and any other cause whatsoever shall be deemed waived unless made in writing and received by Cardinal within thirty (30) days after completion of the applicable service. In no event shall Cardinal be liable for incidental or consequential damages, including, without limitation, business interruptions, loss of use, or loss of profits incurred by client, its subsidiaries, affiliates or successors arising out of or related to the performance of the services hereunder by Cardinal, regardless of whether such claim is based upon any of the above stated reasons or otherwise. Results relate only to the samples identified above. This report shall not be reproduced except in full with written approval of Cardinal Laboratories.

Celey D. Keene, Lab Director/Quality Manager



PHONE (575) 393-2326 ° 101 E. MARLAND ° HOBBS, NM 88240

Analytical Results For:

ENSOLUM, LLC
 TRACY HILLARD
 705 W WADLEY AVE.
 MIDLAND TX, 79705
 Fax To:

Received: 05/01/2025
 Reported: 05/05/2025
 Project Name: PLU BS 22 FEDERAL BATTERY - SPILLS
 Project Number: 03C1558588
 Project Location: XTO - 32.19642-103.86117

Sampling Date: 04/29/2025
 Sampling Type: Soil
 Sampling Condition: Cool & Intact
 Sample Received By: Tamara Oldaker

Sample ID: FS 03 0.5' (H252611-03)

| BTEx 8021B | | mg/kg | | Analyzed By: JH | | | | | |
|----------------|--------|-----------------|------------|-----------------|------|------------|---------------|---------|-----------|
| Analyte | Result | Reporting Limit | Analyzed | Method Blank | BS | % Recovery | True Value QC | RPD | Qualifier |
| Benzene* | <0.050 | 0.050 | 05/01/2025 | ND | 1.83 | 91.7 | 2.00 | 1.13 | |
| Toluene* | <0.050 | 0.050 | 05/01/2025 | ND | 1.96 | 98.2 | 2.00 | 0.00372 | |
| Ethylbenzene* | <0.050 | 0.050 | 05/01/2025 | ND | 1.99 | 99.4 | 2.00 | 0.603 | |
| Total Xylenes* | <0.150 | 0.150 | 05/01/2025 | ND | 6.29 | 105 | 6.00 | 0.751 | |
| Total BTEX | <0.300 | 0.300 | 05/01/2025 | ND | | | | | |

Surrogate: 4-Bromofluorobenzene (PID) 113 % 71.5-134

| Chloride, SM4500Cl-B | | mg/kg | | Analyzed By: AC | | | | | | |
|----------------------|--------|-----------------|------------|-----------------|-----|------------|---------------|------|-----------|--|
| Analyte | Result | Reporting Limit | Analyzed | Method Blank | BS | % Recovery | True Value QC | RPD | Qualifier | |
| Chloride | 224 | 16.0 | 05/02/2025 | ND | 448 | 112 | 400 | 3.64 | | |

| TPH 8015M | | mg/kg | | Analyzed By: MS | | | | | |
|------------------|--------|-----------------|------------|-----------------|-----|------------|---------------|-------|-----------|
| Analyte | Result | Reporting Limit | Analyzed | Method Blank | BS | % Recovery | True Value QC | RPD | Qualifier |
| GRO C6-C10* | <10.0 | 10.0 | 05/01/2025 | ND | 211 | 105 | 200 | 1.95 | |
| DRO >C10-C28* | <10.0 | 10.0 | 05/01/2025 | ND | 203 | 102 | 200 | 0.488 | |
| EXT DRO >C28-C36 | <10.0 | 10.0 | 05/01/2025 | ND | | | | | |

Surrogate: 1-Chlorooctane 85.0 % 44.4-145

Surrogate: 1-Chlorooctadecane 80.7 % 40.6-153

Cardinal Laboratories

*=Accredited Analyte

PLEASE NOTE: Liability and Damages. Cardinal's liability and client's exclusive remedy for any claim arising, whether based in contract or tort, shall be limited to the amount paid by client for analyses. All claims, including those for negligence and any other cause whatsoever shall be deemed waived unless made in writing and received by Cardinal within thirty (30) days after completion of the applicable service. In no event shall Cardinal be liable for incidental or consequential damages, including, without limitation, business interruptions, loss of use, or loss of profits incurred by client, its subsidiaries, affiliates or successors arising out of or related to the performance of the services hereunder by Cardinal, regardless of whether such claim is based upon any of the above stated reasons or otherwise. Results relate only to the samples identified above. This report shall not be reproduced except in full with written approval of Cardinal Laboratories.

Celey D. Keene, Lab Director/Quality Manager



PHONE (575) 393-2326 ° 101 E. MARLAND ° HOBBS, NM 88240

Analytical Results For:

ENSOLUM, LLC
 TRACY HILLARD
 705 W WADLEY AVE.
 MIDLAND TX, 79705
 Fax To:

Received: 05/01/2025
 Reported: 05/05/2025
 Project Name: PLU BS 22 FEDERAL BATTERY - SPILLS
 Project Number: 03C1558588
 Project Location: XTO - 32.19642-103.86117

Sampling Date: 04/29/2025
 Sampling Type: Soil
 Sampling Condition: Cool & Intact
 Sample Received By: Tamara Oldaker

Sample ID: FS 04 0.5' (H252611-04)

| BTEx 8021B | | mg/kg | | Analyzed By: JH | | | | | |
|----------------|--------|-----------------|------------|-----------------|------|------------|---------------|---------|-----------|
| Analyte | Result | Reporting Limit | Analyzed | Method Blank | BS | % Recovery | True Value QC | RPD | Qualifier |
| Benzene* | <0.050 | 0.050 | 05/01/2025 | ND | 1.83 | 91.7 | 2.00 | 1.13 | |
| Toluene* | <0.050 | 0.050 | 05/01/2025 | ND | 1.96 | 98.2 | 2.00 | 0.00372 | |
| Ethylbenzene* | <0.050 | 0.050 | 05/01/2025 | ND | 1.99 | 99.4 | 2.00 | 0.603 | |
| Total Xylenes* | <0.150 | 0.150 | 05/01/2025 | ND | 6.29 | 105 | 6.00 | 0.751 | |
| Total BTEX | <0.300 | 0.300 | 05/01/2025 | ND | | | | | |

Surrogate: 4-Bromofluorobenzene (PID) 110 % 71.5-134

| Chloride, SM4500Cl-B | | mg/kg | | Analyzed By: AC | | | | | |
|----------------------|--------|-----------------|------------|-----------------|-----|------------|---------------|------|-----------|
| Analyte | Result | Reporting Limit | Analyzed | Method Blank | BS | % Recovery | True Value QC | RPD | Qualifier |
| Chloride | 64.0 | 16.0 | 05/02/2025 | ND | 448 | 112 | 400 | 3.64 | |

| TPH 8015M | | mg/kg | | Analyzed By: MS | | | | | |
|------------------|--------|-----------------|------------|-----------------|-----|------------|---------------|-------|-----------|
| Analyte | Result | Reporting Limit | Analyzed | Method Blank | BS | % Recovery | True Value QC | RPD | Qualifier |
| GRO C6-C10* | <10.0 | 10.0 | 05/01/2025 | ND | 205 | 103 | 200 | 0.103 | |
| DRO >C10-C28* | 333 | 10.0 | 05/01/2025 | ND | 194 | 96.9 | 200 | 0.853 | |
| EXT DRO >C28-C36 | 89.6 | 10.0 | 05/01/2025 | ND | | | | | |

Surrogate: 1-Chlorooctane 90.2 % 44.4-145

Surrogate: 1-Chlorooctadecane 92.3 % 40.6-153

Cardinal Laboratories

*=Accredited Analyte

PLEASE NOTE: Liability and Damages. Cardinal's liability and client's exclusive remedy for any claim arising, whether based in contract or tort, shall be limited to the amount paid by client for analyses. All claims, including those for negligence and any other cause whatsoever shall be deemed waived unless made in writing and received by Cardinal within thirty (30) days after completion of the applicable service. In no event shall Cardinal be liable for incidental or consequential damages, including, without limitation, business interruptions, loss of use, or loss of profits incurred by client, its subsidiaries, affiliates or successors arising out of or related to the performance of the services hereunder by Cardinal, regardless of whether such claim is based upon any of the above stated reasons or otherwise. Results relate only to the samples identified above. This report shall not be reproduced except in full with written approval of Cardinal Laboratories.

Celey D. Keene, Lab Director/Quality Manager



PHONE (575) 393-2326 ° 101 E. MARLAND ° HOBBS, NM 88240

Analytical Results For:

ENSOLUM, LLC
 TRACY HILLARD
 705 W WADLEY AVE.
 MIDLAND TX, 79705
 Fax To:

Received: 05/01/2025
 Reported: 05/05/2025
 Project Name: PLU BS 22 FEDERAL BATTERY - SPILLS
 Project Number: 03C1558588
 Project Location: XTO - 32.19642-103.86117

Sampling Date: 04/29/2025
 Sampling Type: Soil
 Sampling Condition: Cool & Intact
 Sample Received By: Tamara Oldaker

Sample ID: FS 05 0.5' (H252611-05)

| BTEx 8021B | | mg/kg | | Analyzed By: JH | | | | | |
|----------------|--------|-----------------|------------|-----------------|------|------------|---------------|---------|-----------|
| Analyte | Result | Reporting Limit | Analyzed | Method Blank | BS | % Recovery | True Value QC | RPD | Qualifier |
| Benzene* | <0.050 | 0.050 | 05/01/2025 | ND | 1.83 | 91.7 | 2.00 | 1.13 | |
| Toluene* | <0.050 | 0.050 | 05/01/2025 | ND | 1.96 | 98.2 | 2.00 | 0.00372 | |
| Ethylbenzene* | <0.050 | 0.050 | 05/01/2025 | ND | 1.99 | 99.4 | 2.00 | 0.603 | |
| Total Xylenes* | <0.150 | 0.150 | 05/01/2025 | ND | 6.29 | 105 | 6.00 | 0.751 | |
| Total BTEX | <0.300 | 0.300 | 05/01/2025 | ND | | | | | |

Surrogate: 4-Bromofluorobenzene (PID) 113 % 71.5-134

| Chloride, SM4500Cl-B | | mg/kg | | Analyzed By: AC | | | | | | |
|----------------------|--------|-----------------|------------|-----------------|-----|------------|---------------|------|-----------|--|
| Analyte | Result | Reporting Limit | Analyzed | Method Blank | BS | % Recovery | True Value QC | RPD | Qualifier | |
| Chloride | 48.0 | 16.0 | 05/02/2025 | ND | 448 | 112 | 400 | 3.64 | | |

| TPH 8015M | | mg/kg | | Analyzed By: MS | | | | | |
|------------------|--------|-----------------|------------|-----------------|-----|------------|---------------|-------|-----------|
| Analyte | Result | Reporting Limit | Analyzed | Method Blank | BS | % Recovery | True Value QC | RPD | Qualifier |
| GRO C6-C10* | <10.0 | 10.0 | 05/01/2025 | ND | 205 | 103 | 200 | 0.103 | |
| DRO >C10-C28* | 21.1 | 10.0 | 05/01/2025 | ND | 194 | 96.9 | 200 | 0.853 | |
| EXT DRO >C28-C36 | <10.0 | 10.0 | 05/01/2025 | ND | | | | | |

Surrogate: 1-Chlorooctane 89.3 % 44.4-145

Surrogate: 1-Chlorooctadecane 88.5 % 40.6-153

Cardinal Laboratories

*=Accredited Analyte

PLEASE NOTE: Liability and Damages. Cardinal's liability and client's exclusive remedy for any claim arising, whether based in contract or tort, shall be limited to the amount paid by client for analyses. All claims, including those for negligence and any other cause whatsoever shall be deemed waived unless made in writing and received by Cardinal within thirty (30) days after completion of the applicable service. In no event shall Cardinal be liable for incidental or consequential damages, including, without limitation, business interruptions, loss of use, or loss of profits incurred by client, its subsidiaries, affiliates or successors arising out of or related to the performance of the services hereunder by Cardinal, regardless of whether such claim is based upon any of the above stated reasons or otherwise. Results relate only to the samples identified above. This report shall not be reproduced except in full with written approval of Cardinal Laboratories.

Celey D. Keene, Lab Director/Quality Manager



PHONE (575) 393-2326 ° 101 E. MARLAND ° HOBBS, NM 88240

Analytical Results For:

ENSOLUM, LLC
 TRACY HILLARD
 705 W WADLEY AVE.
 MIDLAND TX, 79705
 Fax To:

Received: 05/01/2025
 Reported: 05/05/2025
 Project Name: PLU BS 22 FEDERAL BATTERY - SPILLS
 Project Number: 03C1558588
 Project Location: XTO - 32.19642-103.86117

Sampling Date: 04/29/2025
 Sampling Type: Soil
 Sampling Condition: Cool & Intact
 Sample Received By: Tamara Oldaker

Sample ID: SW 01 0-0.5' (H252611-06)

| BTX 8021B | | mg/kg | | Analyzed By: JH | | | | | | |
|----------------|--------|-----------------|------------|-----------------|------|------------|---------------|---------|-----------|--|
| Analyte | Result | Reporting Limit | Analyzed | Method Blank | BS | % Recovery | True Value QC | RPD | Qualifier | |
| Benzene* | <0.050 | 0.050 | 05/01/2025 | ND | 1.83 | 91.7 | 2.00 | 1.13 | | |
| Toluene* | <0.050 | 0.050 | 05/01/2025 | ND | 1.96 | 98.2 | 2.00 | 0.00372 | | |
| Ethylbenzene* | <0.050 | 0.050 | 05/01/2025 | ND | 1.99 | 99.4 | 2.00 | 0.603 | | |
| Total Xylenes* | <0.150 | 0.150 | 05/01/2025 | ND | 6.29 | 105 | 6.00 | 0.751 | | |
| Total BTX | <0.300 | 0.300 | 05/01/2025 | ND | | | | | | |

Surrogate: 4-Bromofluorobenzene (PID) 113 % 71.5-134

| Chloride, SM4500Cl-B | | mg/kg | | Analyzed By: AC | | | | | | |
|----------------------|--------|-----------------|------------|-----------------|-----|------------|---------------|------|-----------|--|
| Analyte | Result | Reporting Limit | Analyzed | Method Blank | BS | % Recovery | True Value QC | RPD | Qualifier | |
| Chloride | 208 | 16.0 | 05/02/2025 | ND | 448 | 112 | 400 | 3.64 | | |

| TPH 8015M | | mg/kg | | Analyzed By: MS | | | | | |
|------------------|--------|-----------------|------------|-----------------|-----|------------|---------------|-------|-----------|
| Analyte | Result | Reporting Limit | Analyzed | Method Blank | BS | % Recovery | True Value QC | RPD | Qualifier |
| GRO C6-C10* | <10.0 | 10.0 | 05/01/2025 | ND | 205 | 103 | 200 | 0.103 | |
| DRO >C10-C28* | <10.0 | 10.0 | 05/01/2025 | ND | 194 | 96.9 | 200 | 0.853 | |
| EXT DRO >C28-C36 | <10.0 | 10.0 | 05/01/2025 | ND | | | | | |

Surrogate: 1-Chlorooctane 88.2 % 44.4-145

Surrogate: 1-Chlorooctadecane 85.5 % 40.6-153

Cardinal Laboratories

*=Accredited Analyte

PLEASE NOTE: Liability and Damages. Cardinal's liability and client's exclusive remedy for any claim arising, whether based in contract or tort, shall be limited to the amount paid by client for analyses. All claims, including those for negligence and any other cause whatsoever shall be deemed waived unless made in writing and received by Cardinal within thirty (30) days after completion of the applicable service. In no event shall Cardinal be liable for incidental or consequential damages, including, without limitation, business interruptions, loss of use, or loss of profits incurred by client, its subsidiaries, affiliates or successors arising out of or related to the performance of the services hereunder by Cardinal, regardless of whether such claim is based upon any of the above stated reasons or otherwise. Results relate only to the samples identified above. This report shall not be reproduced except in full with written approval of Cardinal Laboratories.

Celey D. Keene, Lab Director/Quality Manager

PHONE (575) 393-2326 ° 101 E. MARLAND ° HOBBS, NM 88240

Notes and Definitions

| | |
|-----|--|
| ND | Analyte NOT DETECTED at or above the reporting limit |
| RPD | Relative Percent Difference |
| ** | Samples not received at proper temperature of 6°C or below. |
| *** | Insufficient time to reach temperature. |
| - | Chloride by SM4500Cl-B does not require samples be received at or below 6°C Samples reported on an as received basis (wet) unless otherwise noted on report |

Cardinal Laboratories

*=Accredited Analyte

PLEASE NOTE: Liability and Damages. Cardinal's liability and client's exclusive remedy for any claim arising, whether based in contract or tort, shall be limited to the amount paid by client for analyses. All claims, including those for negligence and any other cause whatsoever shall be deemed waived unless made in writing and received by Cardinal within thirty (30) days after completion of the applicable service. In no event shall Cardinal be liable for incidental or consequential damages, including, without limitation, business interruptions, loss of use, or loss of profits incurred by client, its subsidiaries, affiliates or successors arising out of or related to the performance of the services hereunder by Cardinal, regardless of whether such claim is based upon any of the above stated reasons or otherwise. Results relate only to the samples identified above. This report shall not be reproduced except in full with written approval of Cardinal Laboratories.

A handwritten signature in black ink, appearing to read "Celey D. Keene".

Celey D. Keene, Lab Director/Quality Manager



101 East Marland, Hobbs, NM 88240
(575) 393-2326 FAX (575) 393-2476

CHAIN-OF-CUSTODY AND ANALYSIS REQUEST

| | | | | | | | | | | | | | | | | | | | | | | | |
|--|--|--|--|--|--|--|--|--|--|--|--|---------------------------|--|--|--|--|--|--|--|--|--|--|--|
| BILL TO | | | | | | | | | | | | ANALYSIS REQUEST | | | | | | | | | | | |
| Company Name: Ensolum, LLC | | | | | | | | | | | | P.O. #: | | | | | | | | | | | |
| Project Manager: Tracy Hillard | | | | | | | | | | | | Company: XTO Energy, Inc | | | | | | | | | | | |
| Address: 601 N Marientfeld Street, Suite 400 | | | | | | | | | | | | Attn: Colton Brown | | | | | | | | | | | |
| City: Midland | | | | | | | | | | | | State: TX Zip: 79701 | | | | | | | | | | | |
| Phone #: 575-937-3906 | | | | | | | | | | | | Fax #: | | | | | | | | | | | |
| Project #: 03C1558588 | | | | | | | | | | | | Project Owner: XTO Energy | | | | | | | | | | | |
| Project Location: 32.19642, -103.86117 | | | | | | | | | | | | City: Carlsbad | | | | | | | | | | | |
| Sampler Name: Jesse Dorman | | | | | | | | | | | | State: NM Zip: 88220 | | | | | | | | | | | |
| | | | | | | | | | | | | Phone #: | | | | | | | | | | | |
| | | | | | | | | | | | | Fax #: | | | | | | | | | | | |

| Lab I.D. | Sample I.D. | Depth (feet) | (G)RAB OR (C)OMP. # CONTAINERS | MATRIX | | | | | | PRESERV | SAMPLING DATE | TIME | TPH 8015 | | | BTEX 8021 | | | Chloride 4500 | | |
|--|-------------|--------------|-----------------------------------|-------------|------------|------|-----|--------|---------|---------|---------------|-------|-----------|------------|---------|-----------|--|--|---------------|--|--|
| | | | | GROUNDWATER | WASTEWATER | SOIL | OIL | SLUDGE | OTHER : | | | | ACID/BASE | ICE / COOL | OTHER : | | | | | | |
| H652611 | F501 | .5' | 1 | | | | | | | | 4/29/05 | 11:10 | | | | | | | | | |
| | F502 | | 2 | | | | | | | | | 11:15 | | | | | | | | | |
| | F503 | | 3 | | | | | | | | | 11:20 | | | | | | | | | |
| | F504 | | 4 | | | | | | | | | 11:25 | | | | | | | | | |
| | F505 | | 5 | | | | | | | | | 11:30 | | | | | | | | | |
| | SW01 | 0-5' | 6 | | | | | | | | | 12:05 | | | | | | | | | |
| <i>[Handwritten signature across bottom of grid]</i> | | | | | | | | | | | | | | | | | | | | | |

PLEASE NOTE: Liability and Damages. Cardkraft's liability and clients exclusive remedy for any claim arising whether based in contract or tort, shall be limited to the amount paid by the client for the analyses. All claims including those for negligence and any other cause whatsoever shall be deemed waived unless made in writing and received by Cardkraft within 30 days after completion of the applicable service. In no event shall Cardkraft be liable for incidental or consequential damages, including without limitation, business interruptions, loss of use, or loss of profits incurred by client, its subsidiaries, affiliates or successors arising out of or related to the performance of services hereunder by Cardkraft, regardless of whether such claim is based upon any of the above stated reasons or otherwise.

| | | | |
|------------------------|--|--------------|--------------------|
| Relinquished By: _____ | | Date: 8-1-25 | Received By: _____ |
| Time: 1:00 | | _____ | |
| Date: _____ | | _____ | |
| Time: _____ | | _____ | |

| | | | |
|---|---|---|---------------------------|
| Delivered By: (Circle One) <input checked="" type="checkbox"/> UPS <input type="checkbox"/> Bus <input type="checkbox"/> Other | Observed Temp.: °C Corrected Temp.: °C | Sample Condition <input checked="" type="checkbox"/> Intact <input type="checkbox"/> Not Intact <input checked="" type="checkbox"/> Yes <input type="checkbox"/> No | CHECKED BY: (Initials) |
| Turnaround Time: Standard <input checked="" type="checkbox"/> Rush | Thermometer ID #13 | Correction Factor: .05 | |

REMARKS: Incident Number: MAP2435354652
Cost Center: 1080991001
GF CM: 48605000

All Results are emailed. Please provide Email address: JReich@ensolum.com, BBell@ensolum.com, TMorrissey@ensolum.com, BBeil@ensolum.com, KThomason@ensolum.com, Jdorman@ensolum.com

Verbal Result: ☐ Yes ☐ No Add'l Phone #: _____
Add'l Phone #: _____

Bacteria (only) Sample Condition
☒ Cool ☐ Intact Observed Temp.: °C
☐ Yes ☐ No Corrected Temp.: °C

PHONE (575) 393-2326 ° 101 E. MARLAND ° HOBBS, NM 88240

July 17, 2025

TRACY HILLARD

ENSOLUM, LLC

705 W WADLEY AVE.

MIDLAND, TX 79705

RE: PLU BS 22 FEDERAL BATTERY - SPILLS

Enclosed are the results of analyses for samples received by the laboratory on 05/20/25 13:35.

Cardinal Laboratories is accredited through Texas NELAP under certificate number TX-C25-00101. Accreditation applies to drinking water, non-potable water and solid and chemical materials. All accredited analytes are denoted by an asterisk (*). For a complete list of accredited analytes and matrices visit the TCEQ website at

www.tceq.texas.gov/field/ga/lab_accred_certif.html.

Cardinal Laboratories is accredited through the State of Colorado Department of Public Health and Environment for:

| | |
|------------------|--------------------------------|
| Method EPA 552.2 | Total Haloacetic Acids (HAA-5) |
| Method EPA 524.2 | Total Trihalomethanes (TTHM) |
| Method EPA 524.4 | Regulated VOCs (V1, V2, V3) |

Cardinal Laboratories is accredited through the State of New Mexico Environment Department for:

| | |
|------------------|---|
| Method SM 9223-B | Total Coliform and E. coli (Colilert MMO-MUG) |
| Method EPA 524.2 | Regulated VOCs and Total Trihalomethanes (TTHM) |
| Method EPA 552.2 | Total Haloacetic Acids (HAA-5) |

Accreditation applies to public drinking water matrices for State of Colorado and New Mexico.

This report meets NELAP requirements and is made up of a cover page, analytical results, and a copy of the original chain-of-custody. If you have any questions concerning this report, please feel free to contact me.

Sincerely,

Celey D. Keene

Lab Director/Quality Manager



PHONE (575) 393-2326 ° 101 E. MARLAND ° HOBBS, NM 88240

Analytical Results For:ENSOLUM, LLC
705 W WADLEY AVE.
MIDLAND TX, 79705Project: PLU BS 22 FEDERAL BATTERY - SP
Project Number: 03C1558588
Project Manager: TRACY HILLARD
Fax To:Reported:
17-Jul-25 15:08

| Sample ID | Laboratory ID | Matrix | Date Sampled | Date Received |
|---------------|---------------|--------|-----------------|-----------------|
| FS 04 2' | H253018-01 | Soil | 15-May-25 10:20 | 20-May-25 13:35 |
| SW 02 0' - 2' | H253018-02 | Soil | 15-May-25 11:20 | 20-May-25 13:35 |

07/17/25 - Client changed the sample ID on -02 (see COC). This is the revised report and will replace the one sent on 05/22/25.

Cardinal Laboratories

*=Accredited Analyte

PLEASE NOTE: Liability and Damages. Cardinal's liability and client's exclusive remedy for any claim arising, whether based in contract or tort, shall be limited to the amount paid by client for analyses. All claims, including those for negligence or any other cause whatsoever shall be deemed waived unless made in writing and received by Cardinal within thirty (30) days after completion of the applicable service. In no event shall Cardinal be liable for incidental or consequential damage including, without limitation, business interruptions, loss of use, or loss of profits incurred by client, its subsidiaries, affiliates or successors arising out of or related to the performance of the services hereunder by Cardinal, regardless of whether such claim is based upon any of the above stated reasons or otherwise. Results relate only to the samples identified above. This report shall not be reproduced except in full with written approval of Cardinal Laboratories.

Celey D. Keene, Lab Director/Quality Manager



PHONE (575) 393-2326 ° 101 E. MARLAND ° HOBBS, NM 88240

Analytical Results For:

ENSOLUM, LLC
705 W WADLEY AVE.
MIDLAND TX, 79705

Project: PLU BS 22 FEDERAL BATTERY - SP
Project Number: 03C1558588
Project Manager: TRACY HILLARD
Fax To:

Reported:
17-Jul-25 15:08

FS 04 2'
H253018-01 (Soil)

| Analyte | Result | MDL | Reporting Limit | Units | Dilution | Batch | Analyst | Analyzed | Method | Notes |
|---------|--------|-----|-----------------|-------|----------|-------|---------|----------|--------|-------|
|---------|--------|-----|-----------------|-------|----------|-------|---------|----------|--------|-------|

Cardinal Laboratories**Inorganic Compounds**

| | | | | | | | | | | |
|----------|------|--|------|-------|---|---------|----|-----------|-----------|--|
| Chloride | 80.0 | | 16.0 | mg/kg | 4 | 5052121 | AC | 21-May-25 | 4500-Cl-B | |
|----------|------|--|------|-------|---|---------|----|-----------|-----------|--|

Volatile Organic Compounds by EPA Method 8021

| | | | | | | | | | | |
|----------------|--------|--|-------|-------|----|---------|----|-----------|-------|--|
| Benzene* | <0.050 | | 0.050 | mg/kg | 50 | 5052034 | JH | 20-May-25 | 8021B | |
| Toluene* | <0.050 | | 0.050 | mg/kg | 50 | 5052034 | JH | 20-May-25 | 8021B | |
| Ethylbenzene* | <0.050 | | 0.050 | mg/kg | 50 | 5052034 | JH | 20-May-25 | 8021B | |
| Total Xylenes* | <0.150 | | 0.150 | mg/kg | 50 | 5052034 | JH | 20-May-25 | 8021B | |
| Total BTEX | <0.300 | | 0.300 | mg/kg | 50 | 5052034 | JH | 20-May-25 | 8021B | |

Surrogate: 4-Bromofluorobenzene (PID) 100 % 71.5-134 5052034 JH 20-May-25 8021B

Petroleum Hydrocarbons by GC FID

| | | | | | | | | | | |
|------------------|-------|--|------|-------|---|---------|----|-----------|-------|--|
| GRO C6-C10* | <10.0 | | 10.0 | mg/kg | 1 | 5052013 | MS | 20-May-25 | 8015B | |
| DRO >C10-C28* | <10.0 | | 10.0 | mg/kg | 1 | 5052013 | MS | 20-May-25 | 8015B | |
| EXT DRO >C28-C36 | <10.0 | | 10.0 | mg/kg | 1 | 5052013 | MS | 20-May-25 | 8015B | |

Surrogate: 1-Chlorooctane 78.5 % 44.4-145 5052013 MS 20-May-25 8015B

Surrogate: 1-Chlorooctadecane 75.2 % 40.6-153 5052013 MS 20-May-25 8015B

Cardinal Laboratories

*=Accredited Analyte

PLEASE NOTE: Liability and Damages. Cardinal's liability and client's exclusive remedy for any claim arising, whether based in contract or tort, shall be limited to the amount paid by client for analyses. All claims, including those for negligence or any other cause whatsoever shall be deemed waived unless made in writing and received by Cardinal within thirty (30) days after completion of the applicable service. In no event shall Cardinal be liable for incidental or consequential damage including, without limitation, business interruptions, loss of use, or loss of profits incurred by client, its subsidiaries, affiliates or successors arising out of or related to the performance of the services hereunder by Cardinal, regardless of whether such claim is based upon any of the above stated reasons or otherwise. Results relate only to the samples identified above. This report shall not be reproduced except in full with written approval of Cardinal Laboratories.

Celey D. Keene, Lab Director/Quality Manager



PHONE (575) 393-2326 ° 101 E. MARLAND ° HOBBS, NM 88240

Analytical Results For:

ENSOLUM, LLC
705 W WADLEY AVE.
MIDLAND TX, 79705

Project: PLU BS 22 FEDERAL BATTERY - SP
Project Number: 03C1558588
Project Manager: TRACY HILLARD
Fax To:

Reported:
17-Jul-25 15:08

SW 02 0' - 2'
H253018-02 (Soil)

| Analyte | Result | MDL | Reporting Limit | Units | Dilution | Batch | Analyst | Analyzed | Method | Notes |
|---------|--------|-----|-----------------|-------|----------|-------|---------|----------|--------|-------|
|---------|--------|-----|-----------------|-------|----------|-------|---------|----------|--------|-------|

Cardinal Laboratories**Inorganic Compounds**

| | | | | | | | | | | |
|-----------------|-------------|--|------|-------|---|---------|----|-----------|-----------|--|
| Chloride | 80.0 | | 16.0 | mg/kg | 4 | 5052121 | AC | 21-May-25 | 4500-Cl-B | |
|-----------------|-------------|--|------|-------|---|---------|----|-----------|-----------|--|

Volatile Organic Compounds by EPA Method 8021

| | | | | | | | | | | |
|----------------|--------|--|-------|-------|----|---------|----|-----------|-------|--|
| Benzene* | <0.050 | | 0.050 | mg/kg | 50 | 5052034 | JH | 20-May-25 | 8021B | |
| Toluene* | <0.050 | | 0.050 | mg/kg | 50 | 5052034 | JH | 20-May-25 | 8021B | |
| Ethylbenzene* | <0.050 | | 0.050 | mg/kg | 50 | 5052034 | JH | 20-May-25 | 8021B | |
| Total Xylenes* | <0.150 | | 0.150 | mg/kg | 50 | 5052034 | JH | 20-May-25 | 8021B | |
| Total BTEX | <0.300 | | 0.300 | mg/kg | 50 | 5052034 | JH | 20-May-25 | 8021B | |

| | | | | | | | | | | |
|---------------------------------------|--|--|-------|----------|--|---------|----|-----------|-------|--|
| Surrogate: 4-Bromofluorobenzene (PID) | | | 100 % | 71.5-134 | | 5052034 | JH | 20-May-25 | 8021B | |
|---------------------------------------|--|--|-------|----------|--|---------|----|-----------|-------|--|

Petroleum Hydrocarbons by GC FID

| | | | | | | | | | | |
|------------------|-------|--|------|-------|---|---------|----|-----------|-------|--|
| GRO C6-C10* | <10.0 | | 10.0 | mg/kg | 1 | 5052013 | MS | 20-May-25 | 8015B | |
| DRO >C10-C28* | <10.0 | | 10.0 | mg/kg | 1 | 5052013 | MS | 20-May-25 | 8015B | |
| EXT DRO >C28-C36 | <10.0 | | 10.0 | mg/kg | 1 | 5052013 | MS | 20-May-25 | 8015B | |

| | | | | | | | | | | |
|---------------------------|--|--|--------|----------|--|---------|----|-----------|-------|--|
| Surrogate: 1-Chlorooctane | | | 92.1 % | 44.4-145 | | 5052013 | MS | 20-May-25 | 8015B | |
|---------------------------|--|--|--------|----------|--|---------|----|-----------|-------|--|

| | | | | | | | | | | |
|-------------------------------|--|--|--------|----------|--|---------|----|-----------|-------|--|
| Surrogate: 1-Chlorooctadecane | | | 88.4 % | 40.6-153 | | 5052013 | MS | 20-May-25 | 8015B | |
|-------------------------------|--|--|--------|----------|--|---------|----|-----------|-------|--|

Cardinal Laboratories

*=Accredited Analyte

PLEASE NOTE: Liability and Damages. Cardinal's liability and client's exclusive remedy for any claim arising, whether based in contract or tort, shall be limited to the amount paid by client for analyses. All claims, including those for negligence or any other cause whatsoever shall be deemed waived unless made in writing and received by Cardinal within thirty (30) days after completion of the applicable service. In no event shall Cardinal be liable for incidental or consequential damage including, without limitation, business interruptions, loss of use, or loss of profits incurred by client, its subsidiaries, affiliates or successors arising out of or related to the performance of the services hereunder by Cardinal, regardless of whether such claim is based upon any of the above stated reasons or otherwise. Results relate only to the samples identified above. This report shall not be reproduced except in full with written approval of Cardinal Laboratories.

Celey D. Keene, Lab Director/Quality Manager



PHONE (575) 393-2326 ° 101 E. MARLAND ° HOBBS, NM 88240

Analytical Results For:

ENSOLUM, LLC
705 W WADLEY AVE.
MIDLAND TX, 79705

Project: PLU BS 22 FEDERAL BATTERY - SP
Project Number: 03C1558588
Project Manager: TRACY HILLARD
Fax To:

Reported:
17-Jul-25 15:08

Inorganic Compounds - Quality Control**Cardinal Laboratories**

| Analyte | Result | Reporting Limit | Units | Spike Level | Source Result | %REC Limits | RPD | RPD Limit | Notes |
|-------------------------------------|--------|--------------------|-------|----------------|--------------------------------|----------------|------|--------------|-------|
| Batch 5052121 - 1:4 DI Water | | | | | | | | | |
| Blank (5052121-BLK1) | | | | | Prepared & Analyzed: 21-May-25 | | | | |
| Chloride | ND | 16.0 | mg/kg | | | | | | |
| LCS (5052121-BS1) | | | | | Prepared & Analyzed: 21-May-25 | | | | |
| Chloride | 416 | 16.0 | mg/kg | 400 | 104 | 80-120 | | | |
| LCS Dup (5052121-BSD1) | | | | | Prepared & Analyzed: 21-May-25 | | | | |
| Chloride | 416 | 16.0 | mg/kg | 400 | 104 | 80-120 | 0.00 | 20 | |

Cardinal Laboratories

*=Accredited Analyte

PLEASE NOTE: Liability and Damages. Cardinal's liability and client's exclusive remedy for any claim arising, whether based in contract or tort, shall be limited to the amount paid by client for analyses. All claims, including those for negligence or any other cause whatsoever shall be deemed waived unless made in writing and received by Cardinal within thirty (30) days after completion of the applicable service. In no event shall Cardinal be liable for incidental or consequential damage including, without limitation, business interruptions, loss of use, or loss of profits incurred by client, its subsidiaries, affiliates or successors arising out of or related to the performance of the services hereunder by Cardinal, regardless of whether such claim is based upon any of the above stated reasons or otherwise. Results relate only to the samples identified above. This report shall not be reproduced except in full with written approval of Cardinal Laboratories.

Celey D. Keene, Lab Director/Quality Manager



PHONE (575) 393-2326 • 101 E. MARLAND • HOBBS, NM 88240

Analytical Results For:

ENSOLUM, LLC
705 W WADLEY AVE.
MIDLAND TX, 79705

Project: PLU BS 22 FEDERAL BATTERY - SP
Project Number: 03C1558588
Project Manager: TRACY HILLARD
Fax To:

Reported:
17-Jul-25 15:08

Volatile Organic Compounds by EPA Method 8021 - Quality Control**Cardinal Laboratories**

| Analyte | Result | Reporting Limit | Units | Spike Level | Source Result | %REC | %REC Limits | RPD | RPD Limit | Notes |
|---------|--------|-----------------|-------|-------------|---------------|------|-------------|-----|-----------|-------|
|---------|--------|-----------------|-------|-------------|---------------|------|-------------|-----|-----------|-------|

Batch 5052034 - Volatiles**Blank (5052034-BLK1)**

Prepared & Analyzed: 20-May-25

| | | | | | | | | | | |
|---------------------------------------|----|-------|-------|--------|--|------|----------|--|--|--|
| Benzene | ND | 0.050 | mg/kg | | | | | | | |
| Toluene | ND | 0.050 | mg/kg | | | | | | | |
| Ethylbenzene | ND | 0.050 | mg/kg | | | | | | | |
| Total Xylenes | ND | 0.150 | mg/kg | | | | | | | |
| Total BTEX | ND | 0.300 | mg/kg | | | | | | | |
| Surrogate: 4-Bromofluorobenzene (PID) | ND | | mg/kg | 0.0500 | | 99.6 | 71.5-134 | | | |

LCS (5052034-BS1)

Prepared & Analyzed: 20-May-25

| | | | | | | | | | | |
|---------------------------------------|--------|-------|-------|--------|--|------|----------|--|--|--|
| Benzene | 2.11 | 0.050 | mg/kg | 2.00 | | 105 | 76.3-129 | | | |
| Toluene | 2.18 | 0.050 | mg/kg | 2.00 | | 109 | 84.1-129 | | | |
| Ethylbenzene | 2.13 | 0.050 | mg/kg | 2.00 | | 107 | 80.1-133 | | | |
| m,p-Xylene | 4.20 | 0.100 | mg/kg | 4.00 | | 105 | 81.4-134 | | | |
| o-Xylene | 2.08 | 0.050 | mg/kg | 2.00 | | 104 | 81.4-133 | | | |
| Total Xylenes | 6.28 | 0.150 | mg/kg | 6.00 | | 105 | 81.5-134 | | | |
| Surrogate: 4-Bromofluorobenzene (PID) | 0.0487 | | mg/kg | 0.0500 | | 97.4 | 71.5-134 | | | |

LCS Dup (5052034-BSD1)

Prepared & Analyzed: 20-May-25

| | | | | | | | | | | |
|---------------------------------------|--------|-------|-------|--------|--|------|----------|------|------|--|
| Benzene | 2.16 | 0.050 | mg/kg | 2.00 | | 108 | 76.3-129 | 2.26 | 15.8 | |
| Toluene | 2.23 | 0.050 | mg/kg | 2.00 | | 112 | 84.1-129 | 2.49 | 15.9 | |
| Ethylbenzene | 2.18 | 0.050 | mg/kg | 2.00 | | 109 | 80.1-133 | 2.19 | 16 | |
| m,p-Xylene | 4.30 | 0.100 | mg/kg | 4.00 | | 107 | 81.4-134 | 2.26 | 16.2 | |
| o-Xylene | 2.13 | 0.050 | mg/kg | 2.00 | | 107 | 81.4-133 | 2.55 | 16.7 | |
| Total Xylenes | 6.43 | 0.150 | mg/kg | 6.00 | | 107 | 81.5-134 | 2.36 | 16.3 | |
| Surrogate: 4-Bromofluorobenzene (PID) | 0.0483 | | mg/kg | 0.0500 | | 96.5 | 71.5-134 | | | |

Cardinal Laboratories

*=Accredited Analyte

PLEASE NOTE: Liability and Damages. Cardinal's liability and client's exclusive remedy for any claim arising, whether based in contract or tort, shall be limited to the amount paid by client for analyses. All claims, including those for negligence or any other cause whatsoever shall be deemed waived unless made in writing and received by Cardinal within thirty (30) days after completion of the applicable service. In no event shall Cardinal be liable for incidental or consequential damage including, without limitation, business interruptions, loss of use, or loss of profits incurred by client, its subsidiaries, affiliates or successors arising out of or related to the performance of the services hereunder by Cardinal, regardless of whether such claim is based upon any of the above stated reasons or otherwise. Results relate only to the samples identified above. This report shall not be reproduced except in full with written approval of Cardinal Laboratories.

Celey D. Keene, Lab Director/Quality Manager



PHONE (575) 393-2326 • 101 E. MARLAND • HOBBS, NM 88240

Analytical Results For:

ENSOLUM, LLC
705 W WADLEY AVE.
MIDLAND TX, 79705

Project: PLU BS 22 FEDERAL BATTERY - SP
Project Number: 03C1558588
Project Manager: TRACY HILLARD
Fax To:

Reported:
17-Jul-25 15:08

Petroleum Hydrocarbons by GC FID - Quality Control**Cardinal Laboratories**

| Analyte | Result | Reporting Limit | Units | Spike Level | Source Result | %REC | %REC Limits | RPD | RPD Limit | Notes |
|---------|--------|--------------------|-------|----------------|------------------|------|----------------|-----|--------------|-------|
|---------|--------|--------------------|-------|----------------|------------------|------|----------------|-----|--------------|-------|

Batch 5052013 - General Prep - Organics**Blank (5052013-BLK1)**

Prepared & Analyzed: 20-May-25

| | | | | | | | | | | |
|-------------------------------|------|------|-------|------|--|------|----------|--|--|--|
| GRO C6-C10 | ND | 10.0 | mg/kg | | | | | | | |
| DRO >C10-C28 | ND | 10.0 | mg/kg | | | | | | | |
| EXT DRO >C28-C36 | ND | 10.0 | mg/kg | | | | | | | |
| Surrogate: 1-Chlorooctane | 48.4 | | mg/kg | 50.0 | | 96.8 | 44.4-145 | | | |
| Surrogate: 1-Chlorooctadecane | 45.9 | | mg/kg | 50.0 | | 91.8 | 40.6-153 | | | |

LCS (5052013-BS1)

Prepared & Analyzed: 20-May-25

| | | | | | | | | | | |
|-------------------------------|------|------|-------|------|--|------|----------|--|--|--|
| GRO C6-C10 | 200 | 10.0 | mg/kg | 200 | | 100 | 81.5-123 | | | |
| DRO >C10-C28 | 183 | 10.0 | mg/kg | 200 | | 91.5 | 77.7-122 | | | |
| Total TPH C6-C28 | 384 | 10.0 | mg/kg | 400 | | 95.9 | 80.9-121 | | | |
| Surrogate: 1-Chlorooctane | 49.6 | | mg/kg | 50.0 | | 99.1 | 44.4-145 | | | |
| Surrogate: 1-Chlorooctadecane | 48.7 | | mg/kg | 50.0 | | 97.3 | 40.6-153 | | | |

LCS Dup (5052013-BS1)

Prepared & Analyzed: 20-May-25

| | | | | | | | | | | |
|-------------------------------|------|------|-------|------|--|------|----------|-------|------|--|
| GRO C6-C10 | 200 | 10.0 | mg/kg | 200 | | 99.9 | 81.5-123 | 0.345 | 13 | |
| DRO >C10-C28 | 186 | 10.0 | mg/kg | 200 | | 92.9 | 77.7-122 | 1.50 | 15.6 | |
| Total TPH C6-C28 | 386 | 10.0 | mg/kg | 400 | | 96.4 | 80.9-121 | 0.540 | 18.5 | |
| Surrogate: 1-Chlorooctane | 51.7 | | mg/kg | 50.0 | | 103 | 44.4-145 | | | |
| Surrogate: 1-Chlorooctadecane | 49.9 | | mg/kg | 50.0 | | 99.9 | 40.6-153 | | | |

Cardinal Laboratories

*=Accredited Analyte

PLEASE NOTE: Liability and Damages. Cardinal's liability and client's exclusive remedy for any claim arising, whether based in contract or tort, shall be limited to the amount paid by client for analyses. All claims, including those for negligence or any other cause whatsoever shall be deemed waived unless made in writing and received by Cardinal within thirty (30) days after completion of the applicable service. In no event shall Cardinal be liable for incidental or consequential damage including, without limitation, business interruptions, loss of use, or loss of profits incurred by client, its subsidiaries, affiliates or successors arising out of or related to the performance of the services hereunder by Cardinal, regardless of whether such claim is based upon any of the above stated reasons or otherwise. Results relate only to the samples identified above. This report shall not be reproduced except in full with written approval of Cardinal Laboratories.

Celey D. Keene, Lab Director/Quality Manager



PHONE (575) 393-2326 ° 101 E. MARLAND ° HOBBS, NM 88240

Notes and Definitions

| | |
|-----|--|
| ND | Analyte NOT DETECTED at or above the reporting limit |
| RPD | Relative Percent Difference |
| ** | Samples not received at proper temperature of 6°C or below. |
| *** | Insufficient time to reach temperature. |
| - | Chloride by SM4500Cl-B does not require samples be received at or below 6°C Samples reported on an as received basis (wet) unless otherwise noted on report |

Cardinal Laboratories

*=Accredited Analyte

PLEASE NOTE: Liability and Damages. Cardinal's liability and client's exclusive remedy for any claim arising, whether based in contract or tort, shall be limited to the amount paid by client for analyses. All claims, including those for negligence or any other cause whatsoever shall be deemed waived unless made in writing and received by Cardinal within thirty (30) days after completion of the applicable service. In no event shall Cardinal be liable for incidental or consequential damage including, without limitation, business interruptions, loss of use, or loss of profits incurred by client, its subsidiaries, affiliates or successors arising out of or related to the performance of the services hereunder by Cardinal, regardless of whether such claim is based upon any of the above stated reasons or otherwise. Results relate only to the samples identified above. This report shall not be reproduced except in full with written approval of Cardinal Laboratories.

A handwritten signature in black ink, appearing to read "Celey D. Keene".

Celey D. Keene, Lab Director/Quality Manager



101 East Marland, Hobbs, NM 88240
(575) 393-2326 FAX (575) 393-2476

CHAIN-OF-CUSTODY AND ANALYSIS REQUEST

| BILL TO | | | | | | ANALYSIS REQUEST | | | | | | | | | | | |
|---|--|--|--|--|--|------------------------|--|---|---|--|---|--|---|---|--|--|--|
| Company Name: Ensolum, LLC | | | | | | P.O. #: | | | | | | | | | | | |
| Project Manager: Tracy Hillard | | | | | | Company: | XTO Energy, Inc | | | | | | | | | | |
| Address: 601 N Marienfeld Street, Suite 400 | | | | | | Attn: | Colton Brown | | | | | | | | | | |
| City: Midland | | | | | | State: TX | Zip: 79701 | Address: 3104 E Greene St | | | | | | | | | |
| Phone #: 575-937-3906 | | | | | | Fax #: | | | | | | | | | | | |
| Project #: 03C1558588 | | | | | | Project Owner: | XTO Energy | | | | | | | | | | |
| Project Name: Plu BS 22 Federal Battery- Spill | | | | | | City: | Carlsbad | | | | | | | | | | |
| Project Location: 32.19642, -103.86117 | | | | | | State: NM | Zip: 88220 | Phone #: | | | | | | | | | |
| Sample Name: Jesse Dorman | | | | | | Fax #: | | | | | | | | | | | |
| FOR LAB USE ONLY | | | | | | MATRIX | PRESERV | SAMPLING | | | | | | | | | |
| Lab I.D. | | | | | | (G)RAB OR (C)OMP. | # CONTAINERS | GROUNDWATER WASTEWATER SOIL OIL SLUDGE OTHER : | | | | | | | | | |
| Sample I.D. | | | | | | Depth (feet) | DATE | TIME | TPH 8015 BTEX 8021 Chloride 4500 | | | | | | | | |
| H35-3018 | | | | | | 2' | 5/15/16 | 10:20 | | | | | | | | | |
| F504 | | | | | | SWD | 11:20 | | | | | | | | | | |
| 0-2' * | | | | | | | | | | | | | | | | | |
| SID | | | | | | | | | | | | | | | | | |
| RELEASE NOTE: Liability and Damages. Cardinal's liability and client's exclusive remedy for any claim arising whether based in contract or tort, shall be limited to the amount paid by the client for the analyses. All claims including those for negligence and any other cause whatsoever shall be deemed waived unless made in writing and received by Cardinal within 30 days after completion of the applicable service. In no event shall Cardinal be liable for incidental or consequential damages, including without limitation, business interruptions, loss of use, or loss of profits incurred by client, its subsidiaries, affiliates or successors arising out of or related to the performance of services hereunder by Cardinal, regardless of whether such claim is based upon any of the above stated reasons or otherwise. | | | | | | | | | | | | | | | | | |
| Relinquished By: | | | | | | Date: 5-20-25 | Received By: | | | | | | Verbal Result: <input type="checkbox"/> Yes <input checked="" type="checkbox"/> No Add'l Phone #: | | | | |
| Relinquished By: | | | | | | Date: 5-20-25 | Received By: | | | | | | All Results are emailed. Please provide Email address: jreich@ensolum.com | | | | |
| Delivered By: (Circle One) | | | | | | Observed Temp.: °C 0.4 | Sample Condition Cool Intact <input checked="" type="checkbox"/> Yes <input type="checkbox"/> No | CHECKED BY: (Initials) JS | Turnaround Time: Standard <input checked="" type="checkbox"/> Rush <input type="checkbox"/> | | | | | Bacteria (only) Sample Condition Cool Intact <input checked="" type="checkbox"/> Yes <input type="checkbox"/> No <input type="checkbox"/> Corrected Temp.: °C | | | |
| Sampler - UPS - Bus - Other: | | | | | | Observed Temp.: °C 0.7 | Sample Condition Cool Intact <input checked="" type="checkbox"/> Yes <input type="checkbox"/> No | CHECKED BY: (Initials) JS | Thermometer ID: H14016 | | | | | Bacteria (only) Sample Condition Cool Intact <input checked="" type="checkbox"/> Yes <input type="checkbox"/> No <input type="checkbox"/> Corrected Temp.: °C | | | |
| | | | | | | | | | | | REMARKS: Incident Number: nAPP2435354652 * Changed as per Tracey 7/1/25 | | | | | | |
| | | | | | | | | | | | Cost Center 1080991001 GF CM: 48605000 | | | | | | |

Sante Fe Main Office
Phone: (505) 476-3441

General Information
Phone: (505) 629-6116

Online Phone Directory
<https://www.emnrd.nm.gov/ocd/contact-us>

State of New Mexico
Energy, Minerals and Natural Resources
Oil Conservation Division
1220 S. St Francis Dr.
Santa Fe, NM 87505

QUESTIONS

Action 486320

QUESTIONS

| | |
|---|---|
| Operator: XTO ENERGY, INC 6401 Holiday Hill Road Midland, TX 79707 | OGRID: 5380 |
| | Action Number: 486320 |
| | Action Type: [C-141] Remediation Closure Request C-141 (C-141-v-Closure) |

QUESTIONS

| | |
|-------------------|--|
| Prerequisites | |
| Incident ID (n#) | nAPP2435354652 |
| Incident Name | NAPP2435354652 PLU BS 22 FEDERAL BATTERY @ 0 |
| Incident Type | Oil Release |
| Incident Status | Remediation Closure Report Received |
| Incident Facility | [fAPP2126356445] PLU BIG SINKS 22 FEDERAL BATT |

| | |
|--|---------------------------|
| Location of Release Source | |
| Please answer all the questions in this group. | |
| Site Name | PLU BS 22 FEDERAL BATTERY |
| Date Release Discovered | 12/17/2024 |
| Surface Owner | Federal |

| | |
|--|-------------|
| Incident Details | |
| Please answer all the questions in this group. | |
| Incident Type | Oil Release |
| Did this release result in a fire or is the result of a fire | Yes |
| Did this release result in any injuries | No |
| Has this release reached or does it have a reasonable probability of reaching a watercourse | No |
| Has this release endangered or does it have a reasonable probability of endangering public health | No |
| Has this release substantially damaged or will it substantially damage property or the environment | No |
| Is this release of a volume that is or may with reasonable probability be detrimental to fresh water | No |

| | |
|--|--|
| Nature and Volume of Release | |
| Material(s) released, please answer all that apply below. Any calculations or specific justifications for the volumes provided should be attached to the follow-up C-141 submission. | |
| Crude Oil Released (bbls) Details | Cause: Normal Operations Other (Specify) Crude Oil Released: 6 BBL Recovered: 0 BBL Lost: 6 BBL. |
| Produced Water Released (bbls) Details | Not answered. |
| Is the concentration of chloride in the produced water >10,000 mg/l | No |
| Condensate Released (bbls) Details | Not answered. |
| Natural Gas Vented (Mcf) Details | Not answered. |
| Natural Gas Flared (Mcf) Details | Not answered. |
| Other Released Details | Not answered. |
| Are there additional details for the questions above (i.e. any answer containing Other, Specify, Unknown, and/or Fire, or any negative lost amounts) | Flare |

Sante Fe Main Office
Phone: (505) 476-3441

General Information
Phone: (505) 629-6116

Online Phone Directory
<https://www.emnrd.nm.gov/ocd/contact-us>

State of New Mexico
Energy, Minerals and Natural Resources
Oil Conservation Division
1220 S. St Francis Dr.
Santa Fe, NM 87505

QUESTIONS, Page 2

Action 486320

QUESTIONS (continued)

| | |
|---|---|
| Operator: XTO ENERGY, INC 6401 Holiday Hill Road Midland, TX 79707 | OGRID: 5380 |
| | Action Number: 486320 |
| | Action Type: [C-141] Remediation Closure Request C-141 (C-141-v-Closure) |

QUESTIONS

| Nature and Volume of Release (continued) | |
|---|--|
| Is this a gas only submission (i.e. only significant Mcf values reported) | No, according to supplied volumes this does not appear to be a "gas only" report. |
| Was this a major release as defined by Subsection A of 19.15.29.7 NMAC | Yes |
| Reasons why this would be considered a submission for a notification of a major release | From paragraph A. "Major release" determine using: (2) an unauthorized release of a volume that: (a) results in a fire or is the result of a fire. |
| With the implementation of the 19.15.27 NMAC (05/25/2021), venting and/or flaring of natural gas (i.e. gas only) are to be submitted on the C-129 form. | |

Initial Response

The responsible party must undertake the following actions immediately unless they could create a safety hazard that would result in injury.

| | |
|--|---------------|
| The source of the release has been stopped | True |
| The impacted area has been secured to protect human health and the environment | True |
| Released materials have been contained via the use of berms or dikes, absorbent pads, or other containment devices | True |
| All free liquids and recoverable materials have been removed and managed appropriately | True |
| If all the actions described above have not been undertaken, explain why | Not answered. |

Per Paragraph (4) of Subsection B of 19.15.29.8 NMAC the responsible party may commence remediation immediately after discovery of a release. If remediation has begun, please prepare and attach a narrative of actions to date in the follow-up C-141 submission. If remedial efforts have been successfully completed or if the release occurred within a lined containment area (see Subparagraph (a) of Paragraph (5) of Subsection A of 19.15.29.11 NMAC), please prepare and attach all information needed for closure evaluation in the follow-up C-141 submission.

I hereby certify that the information given above is true and complete to the best of my knowledge and understand that pursuant to OCD rules and regulations all operators are required to report and/or file certain release notifications and perform corrective actions for releases which may endanger public health or the environment. The acceptance of a C-141 report by the OCD does not relieve the operator of liability should their operations have failed to adequately investigate and remediate contamination that pose a threat to groundwater, surface water, human health or the environment. In addition, OCD acceptance of a C-141 report does not relieve the operator of responsibility for compliance with any other federal, state, or local laws and/or regulations.

| | |
|--|--|
| I hereby agree and sign off to the above statement | Name: Colton Brown Title: Environmental Advisor Email: colton.s.brown@exxonmobil.com Date: 12/18/2024 |
|--|--|

Sante Fe Main Office
Phone: (505) 476-3441

General Information
Phone: (505) 629-6116

Online Phone Directory
<https://www.emnrd.nm.gov/ocd/contact-us>

State of New Mexico
Energy, Minerals and Natural Resources
Oil Conservation Division
1220 S. St Francis Dr.
Santa Fe, NM 87505

QUESTIONS, Page 3

Action 486320

QUESTIONS (continued)

| | |
|---|---|
| Operator: XTO ENERGY, INC 6401 Holiday Hill Road Midland, TX 79707 | OGRID: 5380 |
| | Action Number: 486320 |
| | Action Type: [C-141] Remediation Closure Request C-141 (C-141-v-Closure) |

QUESTIONS

| | |
|--|--------------------------------|
| Site Characterization | |
| <i>Please answer all the questions in this group (only required when seeking remediation plan approval and beyond). This information must be provided to the appropriate district office no later than 90 days after the release discovery date.</i> | |
| What is the shallowest depth to groundwater beneath the area affected by the release in feet below ground surface (ft bgs) | Between 100 and 500 (ft.) |
| What method was used to determine the depth to ground water | NM OSE iWaters Database Search |
| Did this release impact groundwater or surface water | No |
| What is the minimum distance, between the closest lateral extents of the release and the following surface areas: | |
| A continuously flowing watercourse or any other significant watercourse | Between 1000 (ft.) and ½ (mi.) |
| Any lakebed, sinkhole, or playa lake (measured from the ordinary high-water mark) | Greater than 5 (mi.) |
| An occupied permanent residence, school, hospital, institution, or church | Between 1 and 5 (mi.) |
| A spring or a private domestic fresh water well used by less than five households for domestic or stock watering purposes | Between 1000 (ft.) and ½ (mi.) |
| Any other fresh water well or spring | Between 1000 (ft.) and ½ (mi.) |
| Incorporated municipal boundaries or a defined municipal fresh water well field | Greater than 5 (mi.) |
| A wetland | Between 1000 (ft.) and ½ (mi.) |
| A subsurface mine | Greater than 5 (mi.) |
| An (non-karst) unstable area | Between 1 and 5 (mi.) |
| Categorize the risk of this well / site being in a karst geology | Low |
| A 100-year floodplain | Between ½ and 1 (mi.) |
| Did the release impact areas not on an exploration, development, production, or storage site | Yes |

| | |
|---|------------|
| Remediation Plan | |
| <i>Please answer all the questions that apply or are indicated. This information must be provided to the appropriate district office no later than 90 days after the release discovery date.</i> | |
| Requesting a remediation plan approval with this submission | Yes |
| <i>Attach a comprehensive report demonstrating the lateral and vertical extents of soil contamination associated with the release have been determined, pursuant to 19.15.29.11 NMAC and 19.15.29.13 NMAC.</i> | |
| Have the lateral and vertical extents of contamination been fully delineated | Yes |
| Was this release entirely contained within a lined containment area | No |
| Soil Contamination Sampling: (Provide the highest observable value for each, in milligrams per kilograms.) | |
| Chloride (EPA 300.0 or SM4500 Cl B) | 432 |
| TPH (GRO+DRO+MRO) (EPA SW-846 Method 8015M) | 21.1 |
| GRO+DRO (EPA SW-846 Method 8015M) | 21.1 |
| BTEX (EPA SW-846 Method 8021B or 8260B) | 0 |
| Benzene (EPA SW-846 Method 8021B or 8260B) | 0 |
| <i>Per Subsection B of 19.15.29.11 NMAC unless the site characterization report includes completed efforts at remediation, the report must include a proposed remediation plan in accordance with 19.15.29.12 NMAC, which includes the anticipated timelines for beginning and completing the remediation.</i> | |
| On what estimated date will the remediation commence | 12/18/2024 |
| On what date will (or did) the final sampling or liner inspection occur | 05/15/2025 |
| On what date will (or was) the remediation complete(d) | 06/11/2025 |
| What is the estimated surface area (in square feet) that will be reclaimed | 990 |
| What is the estimated volume (in cubic yards) that will be reclaimed | 25 |
| What is the estimated surface area (in square feet) that will be remediated | 990 |
| What is the estimated volume (in cubic yards) that will be remediated | 25 |
| <i>These estimated dates and measurements are recognized to be the best guess or calculation at the time of submission and may (be) change(d) over time as more remediation efforts are completed.</i> | |
| <i>The OCD recognizes that proposed remediation measures may have to be minimally adjusted in accordance with the physical realities encountered during remediation. If the responsible party has any need to significantly deviate from the remediation plan proposed, then it should consult with the division to determine if another remediation plan submission is required.</i> | |

Sante Fe Main Office
Phone: (505) 476-3441

General Information
Phone: (505) 629-6116

Online Phone Directory
<https://www.emnrd.nm.gov/ocd/contact-us>

State of New Mexico
Energy, Minerals and Natural Resources
Oil Conservation Division
1220 S. St Francis Dr.
Santa Fe, NM 87505

QUESTIONS, Page 4

Action 486320

QUESTIONS (continued)

| | |
|---|---|
| Operator: XTO ENERGY, INC 6401 Holiday Hill Road Midland, TX 79707 | OGRID: 5380 |
| | Action Number: 486320 |
| | Action Type: [C-141] Remediation Closure Request C-141 (C-141-v-Closure) |

QUESTIONS

| | |
|--|--|
| Remediation Plan (continued) | |
| <i>Please answer all the questions that apply or are indicated. This information must be provided to the appropriate district office no later than 90 days after the release discovery date.</i> | |
| This remediation will (or is expected to) utilize the following processes to remediate / reduce contaminants: | |
| <i>(Select all answers below that apply.)</i> | |
| (Ex Situ) Excavation and off-site disposal (i.e. dig and haul, hydrovac, etc.) | Yes |
| Which OCD approved facility will be used for off-site disposal | HALFWAY DISPOSAL AND LANDFILL [FEEM0112334510] |
| OR which OCD approved well (API) will be used for off-site disposal | Not answered. |
| OR is the off-site disposal site, to be used, out-of-state | Not answered. |
| OR is the off-site disposal site, to be used, an NMED facility | Not answered. |
| (Ex Situ) Excavation and on-site remediation (i.e. On-Site Land Farms) | Not answered. |
| (In Situ) Soil Vapor Extraction | Not answered. |
| (In Situ) Chemical processing (i.e. Soil Shredding, Potassium Permanganate, etc.) | Not answered. |
| (In Situ) Biological processing (i.e. Microbes / Fertilizer, etc.) | Not answered. |
| (In Situ) Physical processing (i.e. Soil Washing, Gypsum, Disking, etc.) | Not answered. |
| Ground Water Abatement pursuant to 19.15.30 NMAC | Not answered. |
| OTHER (Non-listed remedial process) | Not answered. |
| <i>Per Subsection B of 19.15.29.11 NMAC unless the site characterization report includes completed efforts at remediation, the report must include a proposed remediation plan in accordance with 19.15.29.12 NMAC, which includes the anticipated timelines for beginning and completing the remediation.</i> | |
| I hereby certify that the information given above is true and complete to the best of my knowledge and understand that pursuant to OCD rules and regulations all operators are required to report and/or file certain release notifications and perform corrective actions for releases which may endanger public health or the environment. The acceptance of a C-141 report by the OCD does not relieve the operator of liability should their operations have failed to adequately investigate and remediate contamination that pose a threat to groundwater, surface water, human health or the environment. In addition, OCD acceptance of a C-141 report does not relieve the operator of responsibility for compliance with any other federal, state, or local laws and/or regulations. | |
| I hereby agree and sign off to the above statement | Name: Robert Woodall Title: Environmental Analyst Email: robert.d.woodall@exxonmobil.com Date: 07/18/2025 |
| <i>The OCD recognizes that proposed remediation measures may have to be minimally adjusted in accordance with the physical realities encountered during remediation. If the responsible party has any need to significantly deviate from the remediation plan proposed, then it should consult with the division to determine if another remediation plan submission is required.</i> | |

Sante Fe Main Office
Phone: (505) 476-3441

General Information
Phone: (505) 629-6116

Online Phone Directory
<https://www.emnrd.nm.gov/ocd/contact-us>

State of New Mexico
Energy, Minerals and Natural Resources
Oil Conservation Division
1220 S. St Francis Dr.
Santa Fe, NM 87505

QUESTIONS, Page 5

Action 486320

QUESTIONS (continued)

| | |
|---|---|
| Operator: XTO ENERGY, INC 6401 Holiday Hill Road Midland, TX 79707 | OGRID: 5380 |
| | Action Number: 486320 |
| | Action Type: [C-141] Remediation Closure Request C-141 (C-141-v-Closure) |

QUESTIONS

| | |
|--|----|
| Deferral Requests Only | |
| Only answer the questions in this group if seeking a deferral upon approval this submission. Each of the following items must be confirmed as part of any request for deferral of remediation. | |
| Requesting a deferral of the remediation closure due date with the approval of this submission | No |

Sante Fe Main Office
Phone: (505) 476-3441

General Information
Phone: (505) 629-6116

Online Phone Directory
<https://www.emnrd.nm.gov/ocd/contact-us>

State of New Mexico
Energy, Minerals and Natural Resources
Oil Conservation Division
1220 S. St Francis Dr.
Santa Fe, NM 87505

QUESTIONS, Page 6

Action 486320

QUESTIONS (continued)

| | |
|---|---|
| Operator: XTO ENERGY, INC 6401 Holiday Hill Road Midland, TX 79707 | OGRID: 5380 |
| | Action Number: 486320 |
| | Action Type: [C-141] Remediation Closure Request C-141 (C-141-v-Closure) |

QUESTIONS

| Sampling Event Information | |
|---|------------|
| Last sampling notification (C-141N) recorded | 466449 |
| Sampling date pursuant to Subparagraph (a) of Paragraph (1) of Subsection D of 19.15.29.12 NMAC | 05/30/2025 |
| What was the (estimated) number of samples that were to be gathered | 1 |
| What was the sampling surface area in square feet | 200 |

Remediation Closure Request

Only answer the questions in this group if seeking remediation closure for this release because all remediation steps have been completed.

| | |
|--|---|
| Requesting a remediation closure approval with this submission | Yes |
| Have the lateral and vertical extents of contamination been fully delineated | Yes |
| Was this release entirely contained within a lined containment area | No |
| All areas reasonably needed for production or subsequent drilling operations have been stabilized, returned to the sites existing grade, and have a soil cover that prevents ponding of water, minimizing dust and erosion | Yes |
| What was the total surface area (in square feet) remediated | 990 |
| What was the total volume (cubic yards) remediated | 25 |
| All areas not reasonably needed for production or subsequent drilling operations have been reclaimed to contain a minimum of four feet of non-waste contain earthen material with concentrations less than 600 mg/kg chlorides, 100 mg/kg TPH, 50 mg/kg BTEX, and 10 mg/kg Benzene | Yes |
| What was the total surface area (in square feet) reclaimed | 990 |
| What was the total volume (in cubic yards) reclaimed | 25 |
| Summarize any additional remediation activities not included by answers (above) | Site assessment and excavation activities were conducted at the Site to address the December 2024 flare fire resulting in the overspray of 6 bbls of crude oil at the Site. Laboratory analytical results for all final excavation soil samples indicated all COC concentrations were compliant with the Site Closure Criteria and reclamation requirements. Based on laboratory analytical results, no further remediation was required. Excavation of soil has mitigated impacts at this Site. Depth to groundwater has been estimated to be greater than 100 feet bgs and no sensitive receptors were identified near the release extent. XTO believes these remedial actions are protective of human health, the environment, and groundwater. As such, XTO respectfully requests closure for Incident Number nAPP2435354652. |

The responsible party must attach information demonstrating they have complied with all applicable closure requirements and any conditions or directives of the OCD. This demonstration should be in the form of a comprehensive report (in .pdf format) including a scaled site map, sampling diagrams, relevant field notes, photographs of any excavation prior to backfilling, laboratory data including chain of custody documents of final sampling, and a narrative of the remedial activities. Refer to 19.15.29.12 NMAC.

I hereby certify that the information given above is true and complete to the best of my knowledge and understand that pursuant to OCD rules and regulations all operators are required to report and/or file certain release notifications and perform corrective actions for releases which may endanger public health or the environment. The acceptance of a C-141 report by the OCD does not relieve the operator of liability should their operations have failed to adequately investigate and remediate contamination that pose a threat to groundwater, surface water, human health or the environment. In addition, OCD acceptance of a C-141 report does not relieve the operator of responsibility for compliance with any other federal, state, or local laws and/or regulations. The responsible party acknowledges they must substantially restore, reclaim, and re-vegetate the impacted surface area to the conditions that existed prior to the release or their final land use in accordance with 19.15.29.13 NMAC including notification to the OCD when reclamation and re-vegetation are complete.

| | |
|--|--|
| I hereby agree and sign off to the above statement | Name: Robert Woodall Title: Environmental Analyst Email: robert.d.woodall@exxonmobil.com Date: 07/18/2025 |
|--|--|

Sante Fe Main Office
Phone: (505) 476-3441

General Information
Phone: (505) 629-6116

Online Phone Directory
<https://www.emnrd.nm.gov/ocd/contact-us>

State of New Mexico
Energy, Minerals and Natural Resources
Oil Conservation Division
1220 S. St Francis Dr.
Santa Fe, NM 87505

QUESTIONS, Page 7

Action 486320

QUESTIONS (continued)

| | |
|---|---|
| Operator: XTO ENERGY, INC 6401 Holiday Hill Road Midland, TX 79707 | OGRID: 5380 |
| | Action Number: 486320 |
| | Action Type: [C-141] Remediation Closure Request C-141 (C-141-v-Closure) |

QUESTIONS

| | |
|---|----|
| Reclamation Report | |
| Only answer the questions in this group if all reclamation steps have been completed. | |
| Requesting a reclamation approval with this submission | No |

Sante Fe Main Office
Phone: (505) 476-3441

General Information
Phone: (505) 629-6116

Online Phone Directory
<https://www.emnrd.nm.gov/ocd/contact-us>

State of New Mexico
Energy, Minerals and Natural Resources
Oil Conservation Division
1220 S. St Francis Dr.
Santa Fe, NM 87505

CONDITIONS

Action 486320

CONDITIONS

| | |
|---|---|
| Operator: XTO ENERGY, INC 6401 Holiday Hill Road Midland, TX 79707 | OGRID: 5380 |
| | Action Number: 486320 |
| | Action Type: [C-141] Remediation Closure Request C-141 (C-141-v-Closure) |

CONDITIONS

| Created By | Condition | Condition Date |
|------------|--|----------------|
| scwells | Remediation closure approved with the following conditions: | 7/23/2025 |
| scwells | Note that for future releases at this site, the minimum distances to the following should be updated: any lakebed, sinkhole, or playa lake (1000 ft-1/2 mile N). | 7/23/2025 |
| scwells | A C-141N was not submitted for the confirmation samples collected on 5/15/2025. Operator failed to provide proper Sampling Notification pursuant to 19.15.29.12.D.(1).(a) NMAC. Failure to provide proper sampling notice is a compliance issue and the OCD may pursue compliance actions pursuant to 19.15.5 NMAC. Operator shall ensure future compliance with 19.15.29.12.D.(1).(a) NMAC. | 7/23/2025 |