

**State of New Mexico**  
**Energy, Minerals and Natural Resources**  
**Oil Conservation Division**  
**1220 S. St Francis Dr.**  
**Santa Fe, NM 87505**

**APPLICATION FOR PERMIT TO DRILL, RE-ENTER, DEEPEN, PLUGBACK, OR ADD A ZONE**

1. Operator Name and Address CONOCOPHILLIPS COMPANY 3401 E. 30TH STREET FARMINGTON , NM 87402		2. OGRID Number 217817
		3. API Number 30-039-30047
4. Property Code 31325	5. Property Name SAN JUAN 29 5 UNIT	6. Well No. 023B

**7. Surface Location**

UL - Lot	Section	Township	Range	Lot Idn	Feet From	N/S Line	Feet From	E/W Line	County
B	16	29N	05W	B	885	N	2305	E	RIO ARRIBA

**8. Pool Information**

BLANCO-MESAVERDE (PRORATED GAS)	72319
---------------------------------	-------

**Additional Well Information**

9. Work Type New Well	10. Well Type GAS	11. Cable/Rotary	12. Lease Type State	13. Ground Level Elevation 6691
14. Multiple N	15. Proposed Depth 6167	16. Formation Mesa Verde Group	17. Contractor	18. Spud Date
Depth to Ground water 40		Distance from nearest fresh water well 100		Distance to nearest surface water > 1000

Pit: Liner: Synthetic ☒ 12 \_\_\_\_\_ mils thick Clay ☐ Pit Volume: 440 \_\_\_\_\_ bbls Drilling Method:  
 Closed Loop System ☐ Fresh Water ☐ Brine ☐ Diesel/Oil-based ☐ Gas/Air ☐

**19. Proposed Casing and Cement Program**

Type	Hole Size	Casing Type	Casing Weight/ft	Setting Depth	Sacks of Cement	Estimated TOC
Surf	12.25	9.625	32.3	216	132	0
Int1	8.75	7	20	3947	654	0
Prod	6.25	4.5	10.5	6167	252	3847

**Casing/Cement Program: Additional Comments**

If drilled by an H&P rig the surface hole would be 13-1/2" and the cement would be adjusted to circ. to surface. There is also a chance that Mote would pre-set drill & cement the surface hole, cement would be circulated to surface.

**Proposed Blowout Prevention Program**

Type	Working Pressure	Test Pressure	Manufacturer
DoubleRam	2000	2000	Schafer

I hereby certify that the information given above is true and complete to the best of my knowledge and belief. I further certify that the drilling pit will be constructed according to NMOCD guidelines <input type="checkbox"/> a general permit <input checked="" type="checkbox"/> or an (attached) alternative OCD-approved plan <input type="checkbox"/> .	<b>OIL CONSERVATION DIVISION</b>	
Printed Name: Electronically filed by Juanita Farrell	Approved By: Charlie Perin	
Title: Regulatory Analyst	Title: District Supervisor	
Email Address: juanita.r.farrell@conocophillips.com	Approved Date: 8/29/2006	Expiration Date: 8/29/2007
Date: 8/25/2006	Phone: 505-599-3419	

**CONOCOPHILLIPS COMPANY SAN JUAN 29-5 UNIT #23B**  
**885' FNL & 2305' FEL, SECTION 16, T29N, R5W, NMPM**  
**RIO ARriba COUNTY, NEW MEXICO ELEVATION: 6691'**

**LATITUDE: 36.73042° N**  
**LONGITUDE: 107.36157° W**  
 DATUM: NAD1983

PLAT NOTE:

\*SURFACE OWNER\*  
 State of New Mexico

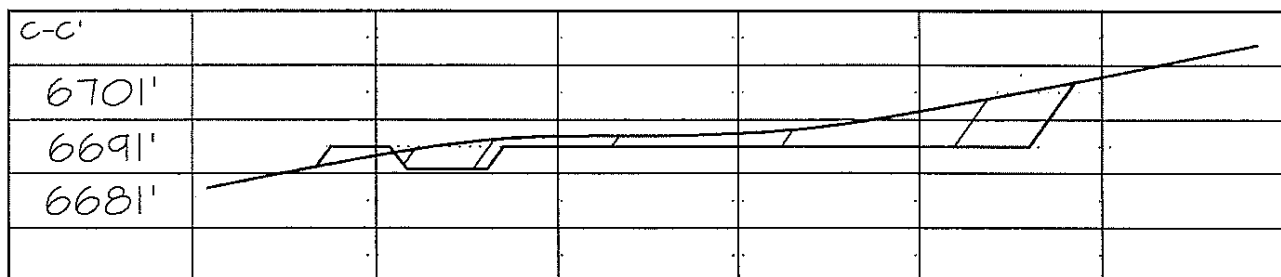
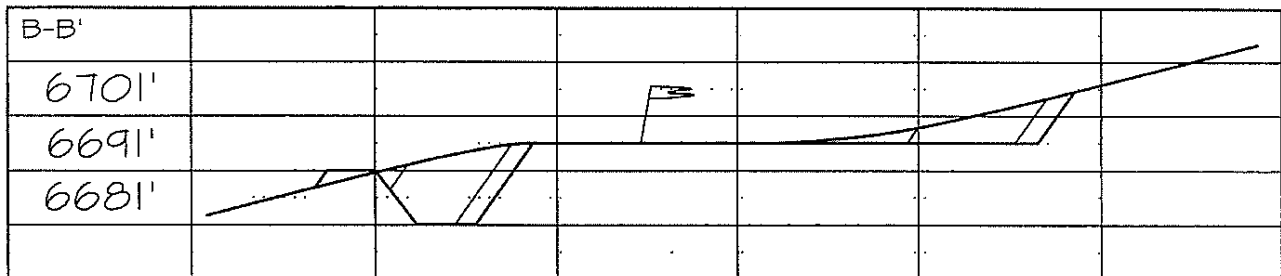
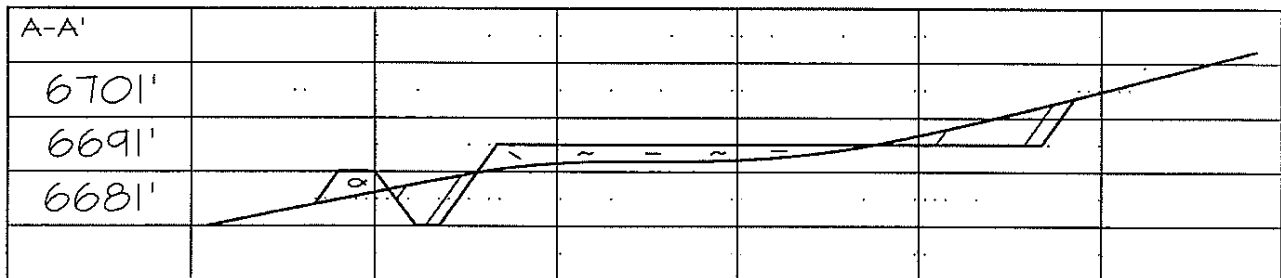
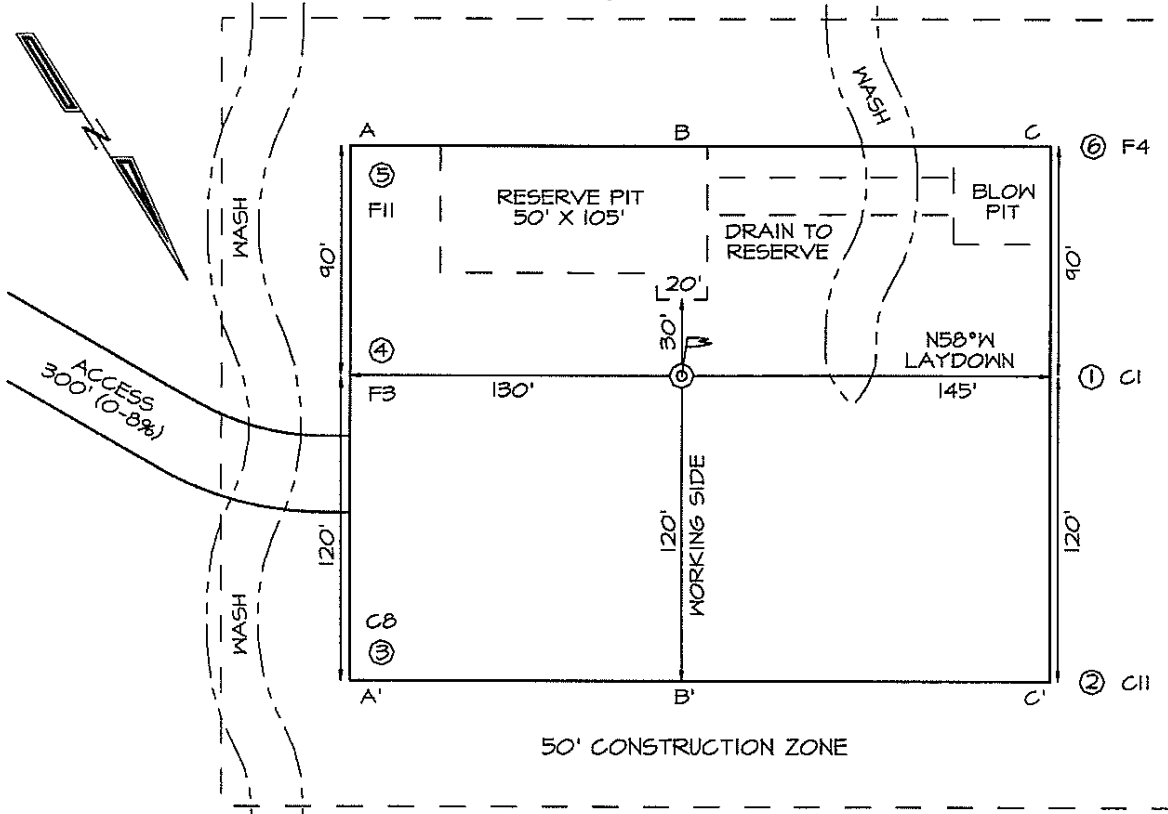

District I  
1625 N. French Dr., Hobbs, NM 88240  
Phone:(505) 393-6161 Fax:(505) 393-0720

District II

1301 W. Grand Ave., Artesia, NM 88210  
Phone:(505) 748-1283 Fax:(505) 748-9720

District III

1000 Rio Brazos Rd., Aztec, NM 87410  
Phone:(505) 334-6178 Fax:(505) 334-6170

District IV

1220 S. St Francis Dr., Santa Fe, NM 87505  
Phone:(505) 476-3470 Fax:(505) 476-3462

**State of New Mexico**  
**Energy, Minerals and Natural Resources**

**Oil Conservation Division**

**1220 S. St Francis Dr.**

**Santa Fe, NM 87505**

Form C-102  
Permit 36648

**WELL LOCATION AND ACREAGE DEDICATION PLAT**

1. API Number 30-039-30047	2. Pool Code 72319	3. Pool Name BLANCO-MESAVERDE (PRORATED GAS)
4. Property Code 31325	5. Property Name SAN JUAN 29 5 UNIT	6. Well No. 023B
7. OGRID No. 217817	8. Operator Name CONOCOPHILLIPS COMPANY	9. Elevation 6691

**10. Surface Location**

UL - Lot B	Section 16	Township 29N	Range 05W	Lot Idn	Feet From 885	N/S Line N	Feet From 2305	E/W Line E	County RIO ARriba
---------------	---------------	-----------------	--------------	---------	------------------	---------------	-------------------	---------------	----------------------

**11. Bottom Hole Location If Different From Surface**

UL - Lot	Section	Township	Range	Lot Idn	Feet From	N/S Line	Feet From	E/W Line	County
12. Dedicated Acres 320.00	13. Joint or Infill	14. Consolidation Code	15. Order No.						

**NO ALLOWABLE WILL BE ASSIGNED TO THIS COMPLETION UNTIL ALL INTERESTS HAVE BEEN CONSOLIDATED OR A NON-STANDARD UNIT HAS BEEN APPROVED BY THE DIVISION**

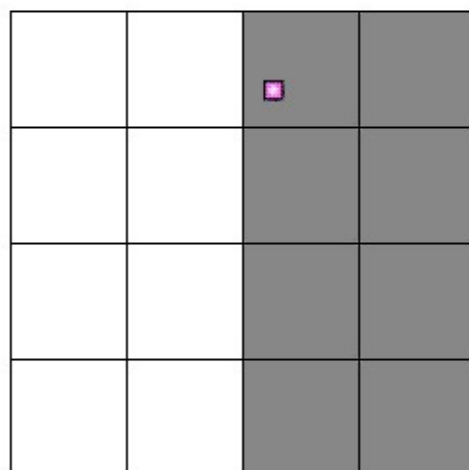

**OPERATOR CERTIFICATION**

*I hereby certify that the information contained herein is true and complete to the best of my knowledge and belief, and that this organization either owns a working interest or unleased mineral interest in the land including the proposed bottom hole location(s) or has a right to drill this well at this location pursuant to a contract with an owner of such a mineral or working interest, or to a voluntary pooling agreement or a compulsory pooling order heretofore entered by the division.*

E-Signed By: Juanita Farrell

Title: Regulatory Analyst

Date: 8/25/2006

**SURVEYOR CERTIFICATION**

*I hereby certify that the well location shown on this plat was plotted from field notes of actual surveys made by me or under my supervision, and that the same is true and correct to the best of my belief.*

Surveyed By: Jason C. Edwards

Date of Survey: 5/18/2006

Certificate Number: 15269