

State of New Mexico
Energy, Minerals and Natural Resources
Oil Conservation Division
1220 S. St Francis Dr.
Santa Fe, NM 87505

APPLICATION FOR PERMIT TO DRILL, RE-ENTER, DEEPEN, PLUGBACK, OR ADD A ZONE

1. Operator Name and Address CHEVRON U S A INC 11111 S. WILCREST HOUSTON , TX 77099		2. OGRID Number 4323
		3. API Number 30-025-38965
4. Property Code 29919	5. Property Name C.H. WEIR "A"	6. Well No. 022

7. Surface Location

UL - Lot	Section	Township	Range	Lot Idn	Feet From	N/S Line	Feet From	E/W Line	County
J	12	20S	37E	J	1650	S	1650	E	LEA

8. Pool Information

WEIR,BLINEBRY, EAST	63800
MONUMENT,TUBB	47090
SKAGGS,DRINKARD	57000

Additional Well Information

9. Work Type New Well	10. Well Type OIL	11. Cable/Rotary	12. Lease Type Private	13. Ground Level Elevation 3559
14. Multiple Y	15. Proposed Depth	16. Formation Drinkard	17. Contractor	18. Spud Date
Depth to Ground water 73		Distance from nearest fresh water well		Distance to nearest surface water
Pit: Liner: Synthetic <input type="checkbox"/> mls thick Clay <input type="checkbox"/> Pit Volume: bbls Drilling Method: Closed Loop System <input checked="" type="checkbox"/> Fresh Water <input type="checkbox"/> Brine <input type="checkbox"/> Diesel/Oil-based <input type="checkbox"/> Gas/Air <input type="checkbox"/>				

19. Proposed Casing and Cement Program

Type	Hole Size	Casing Type	Casing Weight/ft	Setting Depth	Sacks of Cement	Estimated TOC
Surf	14.75	11.75	42	520	1400	
Int1	11	8.625	24	2750	775	
Prod	7.875	5.5	17	7000	1080	

Casing/Cement Program: Additional Comments

SURF:H-40,ST&C,TAIL:NO LEAD,14.8PPG,1.35CU.FT/SX,6.29GAL/SX,CL C,2%CACL,INTER:K-55,ST&C,13.5PPG,1.79CU.FT/SX,9.46GAL/SX,CL C,4% BENTONITE,5%SALT,TAIL:14.8PPG,1.35CU.FT/SX,6.39GAL/SX,CL C,2%CACL, PROD:K-55,LT&C,DV@3800,STG 1:TAIL:NO LEAD,14.4PPG,1.28CU.FT/SX,5.59 GAL/SX,50/50POZ/CL H,2% GEL,0.6%HALAD-9,5%SALT,0.1%HR-7,STG 2:11.9 PPG,2.48CU.FT/SX,13.8GAL/SX,50/50POZ/CL C,10%GEL,8PPS SALT,5LB/SX GILSONITE,0.125LB/SX POLYEFLAKE,TAIL:14.4PPG,1.28CU.FT/SX,5.95GAL/SX

Proposed Blowout Prevention Program

Type	Working Pressure	Test Pressure	Manufacturer
Annular	5000	1000	
DoubleRam	10000	1000	

I hereby certify that the information given above is true and complete to the best of my knowledge and belief. I further certify that the drilling pit will be constructed according to NMOCD guidelines <input type="checkbox"/> , a general permit <input type="checkbox"/> , or an (attached) alternative OCD-approved plan <input type="checkbox"/> . Printed Name: Electronically filed by Denise Pinkerton Title: Regulatory Specialist Email Address: leakejd@chevron.com Date: 6/11/2008 Phone: 432-687-7375	OIL CONSERVATION DIVISION	
	Approved By: Paul Kautz	
	Title: Geologist	
	Approved Date: 6/12/2008 Expiration Date: 6/12/2010	
	Conditions of Approval Attached	

**Nabors M06
Drilling Location Plat
For Closed Loop System
(Revision 2)**

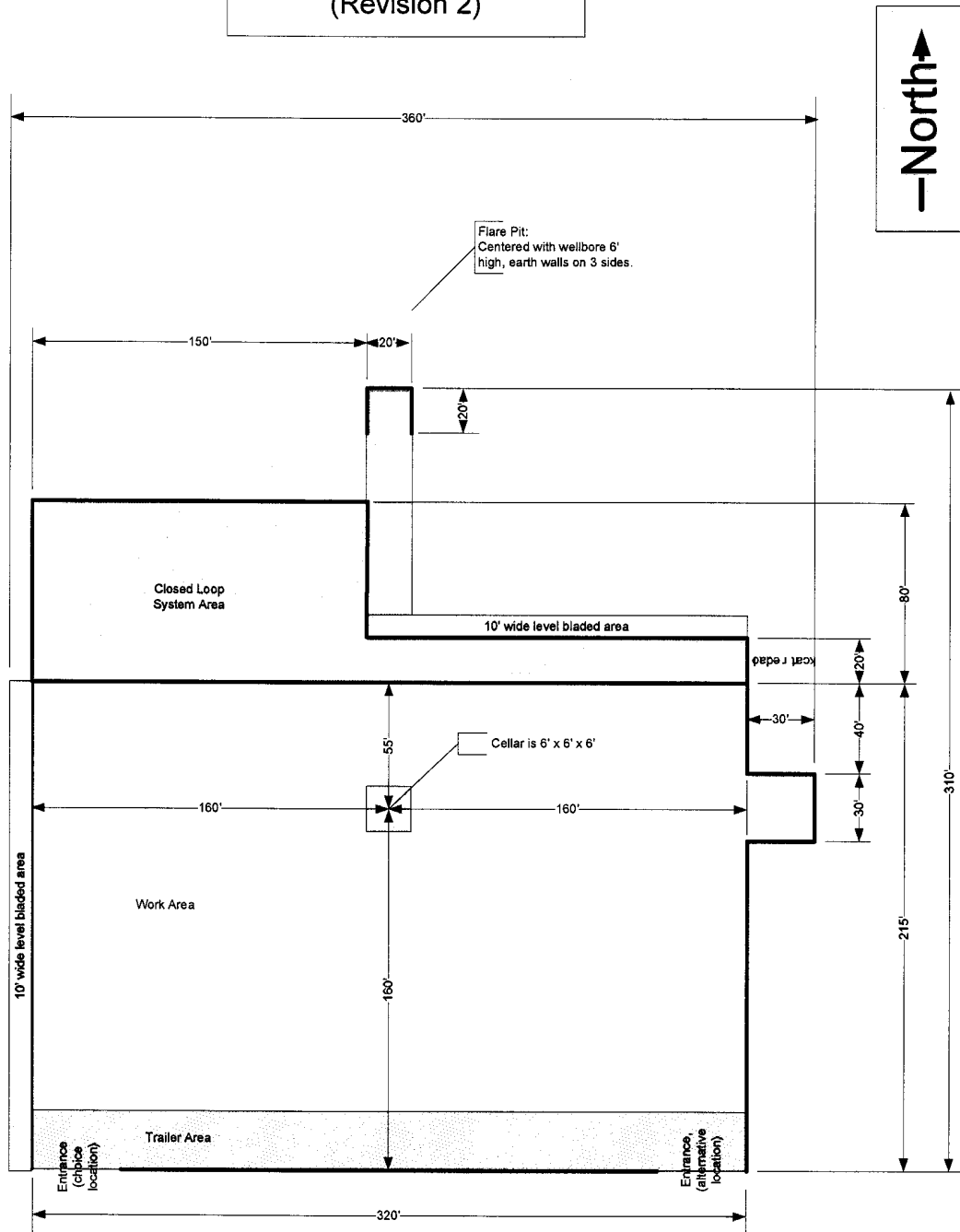

Notes:

1. Flare pit should always be in North or Eastern corner of location, to take advantage of prevailing winds in the event of an H2S occurrence.
2. 20' wide roadway should be included to allow access to skip loader tracks from either end.

District I
 1625 N. French Dr., Hobbs, NM 88240
 Phone:(505) 393-6161 Fax:(505) 393-0720

District II
 1301 W. Grand Ave., Artesia, NM 88210
 Phone:(505) 748-1283 Fax:(505) 748-9720

District III
 1000 Rio Brazos Rd., Aztec, NM 87410
 Phone:(505) 334-6178 Fax:(505) 334-6170

District IV
 1220 S. St Francis Dr., Santa Fe, NM 87505
 Phone:(505) 476-3470 Fax:(505) 476-3462

State of New Mexico
Energy, Minerals and Natural Resources
Oil Conservation Division
1220 S. St Francis Dr.
Santa Fe, NM 87505

Form C-102
 Permit 76671

WELL LOCATION AND ACREAGE DEDICATION PLAT

1. API Number 30-025-38965	2. Pool Code 63800	3. Pool Name WEIR,BLINEBRY, EAST
4. Property Code 29919	5. Property Name C.H. WEIR "A"	6. Well No. 022
7. OGRID No. 4323	8. Operator Name CHEVRON U S A INC	9. Elevation 3559

10. Surface Location

UL - Lot	Section	Township	Range	Lot Idn	Feet From	N/S Line	Feet From	E/W Line	County
J	12	20S	37E		1650	S	1650	E	LEA

11. Bottom Hole Location If Different From Surface

UL - Lot	Section	Township	Range	Lot Idn	Feet From	N/S Line	Feet From	E/W Line	County
12. Dedicated Acres 40.00	13. Joint or Infill	14. Consolidation Code	15. Order No.						

NO ALLOWABLE WILL BE ASSIGNED TO THIS COMPLETION UNTIL ALL INTERESTS HAVE BEEN CONSOLIDATED OR A NON-STANDARD UNIT HAS BEEN APPROVED BY THE DIVISION

	OPERATOR CERTIFICATION	
	<i>I hereby certify that the information contained herein is true and complete to the best of my knowledge and belief, and that this organization either owns a working interest or unleased mineral interest in the land including the proposed bottom hole location(s) or has a right to drill this well at this location pursuant to a contract with an owner of such a mineral or working interest, or to a voluntary pooling agreement or a compulsory pooling order heretofore entered by the division.</i>	
	E-Signed By: Denise Pinkerton Title: Regulatory Specialist Date: 6/11/2008	
	SURVEYOR CERTIFICATION	
<i>I hereby certify that the well location shown on this plat was plotted from field notes of actual surveys made by me or under my supervision, and that the same is true and correct to the best of my belief.</i>		
Surveyed By: RONALD EIDSON Date of Survey: 4/21/2008 Certificate Number: 3239		

District II

1301 W. Grand Ave., Artesia, NM 88210
Phone:(505) 748-1283 Fax:(505) 748-9720

District III

1000 Rio Brazos Rd., Aztec, NM 87410
Phone:(505) 334-6178 Fax:(505) 334-6170

District IV

1220 S. St Francis Dr., Santa Fe, NM 87505
Phone:(505) 476-3470 Fax:(505) 476-3462

State of New Mexico
Energy, Minerals and Natural Resources

Oil Conservation Division

1220 S. St Francis Dr.

Santa Fe, NM 87505

WELL LOCATION AND ACREAGE DEDICATION PLAT

1. API Number 30-025-38965	2. Pool Code 47090	3. Pool Name MONUMENT;TUBB
4. Property Code 29919	5. Property Name C.H. WEIR "A"	6. Well No. 022
7. OGRID No. 4323	8. Operator Name CHEVRON U S A INC	9. Elevation 3559



10. Surface Location

UL - Lot J	Section 12	Township 20S	Range 37E	Lot Idn	Feet From 1650	N/S Line S	Feet From 1650	E/W Line E	County LEA
---------------	---------------	-----------------	--------------	---------	-------------------	---------------	-------------------	---------------	---------------

11. Bottom Hole Location If Different From Surface

UL - Lot	Section	Township	Range	Lot Idn	Feet From	N/S Line	Feet From	E/W Line	County
12. Dedicated Acres 80.00	13. Joint or Infill	14. Consolidation Code	15. Order No.						

NO ALLOWABLE WILL BE ASSIGNED TO THIS COMPLETION UNTIL ALL INTERESTS HAVE BEEN CONSOLIDATED OR A NON-STANDARD UNIT HAS BEEN APPROVED BY THE DIVISION

<table border="1"><tr><td></td><td></td><td></td><td></td></tr><tr><td></td><td></td><td></td><td></td></tr><tr><td></td><td></td><td></td><td></td></tr><tr><td></td><td></td><td></td><td></td></tr></table>																	<p>OPERATOR CERTIFICATION</p> <p><i>I hereby certify that the information contained herein is true and complete to the best of my knowledge and belief, and that this organization either owns a working interest or unleased mineral interest in the land including the proposed bottom hole location(s) or has a right to drill this well at this location pursuant to a contract with an owner of such a mineral or working interest, or to a voluntary pooling agreement or a compulsory pooling order heretofore entered by the division.</i></p> <p>E-Signed By: Denise Pinkerton Title: Regulatory Specialist Date: 6/11/2008</p>
																	
<p>SURVEYOR CERTIFICATION</p> <p><i>I hereby certify that the well location shown on this plat was plotted from field notes of actual surveys made by me or under my supervision, and that the same is true and correct to the best of my belief.</i></p> <p>Surveyed By: RONALD EIDSON Date of Survey: 4/21/2008 Certificate Number: 3239</p>																	

District I
 1625 N. French Dr., Hobbs, NM 88240
 Phone:(505) 393-6161 Fax:(505) 393-0720

District II
 1301 W. Grand Ave., Artesia, NM 88210
 Phone:(505) 748-1283 Fax:(505) 748-9720

District III
 1000 Rio Brazos Rd., Aztec, NM 87410
 Phone:(505) 334-6178 Fax:(505) 334-6170

District IV
 1220 S. St Francis Dr., Santa Fe, NM 87505
 Phone:(505) 476-3470 Fax:(505) 476-3462

State of New Mexico
Energy, Minerals and Natural Resources
Oil Conservation Division
1220 S. St Francis Dr.
Santa Fe, NM 87505

Form C-102
 Permit 76671

WELL LOCATION AND ACREAGE DEDICATION PLAT

1. API Number 30-025-38965	2. Pool Code 57000	3. Pool Name SKAGGS, DRINKARD
4. Property Code 29919	5. Property Name C.H. WEIR "A"	6. Well No. 022
7. OGRID No. 4323	8. Operator Name CHEVRON U S A INC	9. Elevation 3559

10. Surface Location

UL - Lot	Section	Township	Range	Lot Idn	Feet From	N/S Line	Feet From	E/W Line	County
J	12	20S	37E		1650	S	1650	E	LEA

11. Bottom Hole Location If Different From Surface

UL - Lot	Section	Township	Range	Lot Idn	Feet From	N/S Line	Feet From	E/W Line	County
12. Dedicated Acres 40.00		13. Joint or Infill		14. Consolidation Code			15. Order No.		

NO ALLOWABLE WILL BE ASSIGNED TO THIS COMPLETION UNTIL ALL INTERESTS HAVE BEEN CONSOLIDATED OR A NON-STANDARD UNIT HAS BEEN APPROVED BY THE DIVISION

	OPERATOR CERTIFICATION			
	<i>I hereby certify that the information contained herein is true and complete to the best of my knowledge and belief, and that this organization either owns a working interest or unleased mineral interest in the land including the proposed bottom hole location(s) or has a right to drill this well at this location pursuant to a contract with an owner of such a mineral or working interest, or to a voluntary pooling agreement or a compulsory pooling order heretofore entered by the division.</i>			
	E-Signed By: Denise Pinkerton Title: Regulatory Specialist Date: 6/11/2008			
	SURVEYOR CERTIFICATION			
<i>I hereby certify that the well location shown on this plat was plotted from field notes of actual surveys made by me or under my supervision, and that the same is true and correct to the best of my belief.</i>				
Surveyed By: RONALD EIDSON Date of Survey: 4/21/2008 Certificate Number: 3239				

Permit Comments

Operator: CHEVRON U S A INC , 4323

Well: C.H. WEIR "A" #022

API: 30-025-38965

Created By	Comment	Comment Date
DPINKERTON	PLATS COULD NOT BE UPLOADED AND ARE BEING E-MAILED TO DONNA MULL TODAY.	6/11/2008
DPINKERTON	WORKING PRESS:ANN-11"X5000PSI,DBL RAM:11"X10,000PSI,SNG RAM:11"X10,000PSI MAN:4-1/16"X3-1/16" 10,000 PSI TEST:SURF:RAMS,ANN,MAN-1000PSI INTER:ANN:1500PSI,RAMS,MAN-3000PSI	6/11/2008
DMULL	Plats received and will be scanned to well file.	6/12/2008

Permit Conditions of Approval

Operator: CHEVRON U S A INC , 4323

Well: C.H. WEIR "A" #022

API: 30-025-38965

OCD Reviewer	Condition
pkautz	Pit construction and closure must satisfy all requirements of your approved plan, O.C.D. Rule 19.15.2.50, and the Pit and Below-Grade Tank Guidelines
pkautz	Due to fresh water the surface casing must be set in the Rustler Anhydrite
DMULL	Will require the form C-103 per R-11363 "Pre Approved Pools and Area" for Downhole commingling before multiple zones can be produced by commingling in the wellbore accordance with the procedured set forth in Rule 303C(3)(b).