

District I
1625 N. French Dr., Hobbs, NM 88240
Phone:(575) 393-6161 Fax:(575) 393-0720
District II
811 S. First St., Artesia, NM 88210
Phone:(575) 748-1283 Fax:(575) 748-9720
District III
1000 Rio Brazos Rd., Aztec, NM 87410
Phone:(505) 334-6178 Fax:(505) 334-6170
District IV
1220 S. St Francis Dr., Santa Fe, NM 87505
Phone:(505) 476-3470 Fax:(505) 476-3462

State of New Mexico
Energy, Minerals and Natural Resources
Oil Conservation Division
1220 S. St Francis Dr.
Santa Fe, NM 87505

Form C-101
August 1, 2011
Permit 165006

APPLICATION FOR PERMIT TO DRILL, RE-ENTER, DEEPEN, PLUGBACK, OR ADD A ZONE

1. Operator Name and Address OXY USA INC PO Box 4294 Houston, TX 77210		2. OGRID Number 16696
4. Property Code 39668		3. API Number 30-015-41251
5. Property Name CEDAR CANYON 16 STATE		6. Well No. 007H

7. Surface Location

UL - Lot	Section	Township	Range	Lot Idn	Feet From	N/S Line	Feet From	E/W Line	County
E	15	24S	29E	E	2485	N	330	W	EDDY

8. Proposed Bottom Hole Location

UL - Lot	Section	Township	Range	Lot Idn	Feet From	N/S Line	Feet From	E/W Line	County
E	16	24S	29E	E	1980	N	330	W	Eddy

9. Pool Information

PIERCE CROSSING; BONE SPRING, EAST	96473
------------------------------------	-------

Additional Well Information

11. Work Type New Well	12. Well Type OIL	13. Cable/Rotary	14. Lease Type State	15. Ground Level Elevation 2926
16. Multiple N	17. Proposed Depth 13707	18. Formation 2nd Bone Spring Sand	19. Contractor	20. Spud Date 4/17/2013
Depth to Ground water		Distance from nearest fresh water well		Distance to nearest surface water

21. Proposed Casing and Cement Program

Type	Hole Size	Casing Type	Casing Weight/ft	Setting Depth	Sacks of Cement	Estimated TOC
Surf	14.75	11.75	42	320	200	0
Int1	10.625	8.625	32	3100	850	0
Prod	7.875	5.5	17	13707	1560	2500

Casing/Cement Program: Additional Comments

Additional information will be sent with the C-144 CLEZ & H2S Plan.

22. Proposed Blowout Prevention Program

Type	Working Pressure	Test Pressure	Manufacturer
DoubleRam	10000	10000	
Annular	5000	5000	

23. I hereby certify that the information given above is true and complete to the best of my knowledge and belief. I further certify I have complied with 19.15.14.9 (A) NMAC <input checked="" type="checkbox"/> and/or 19.15.14.9 (B) NMAC <input checked="" type="checkbox"/> , if applicable. Signature:	OIL CONSERVATION DIVISION Approved By: Randy Dade	
Printed Name: Electronically filed by KAREN M SINARD	Title: District Supervisor	
Title:	Approved Date: 4/9/2013	Expiration Date: 4/9/2015
Email Address: karen_sinard@oxy.com		
Date: 4/5/2013	Phone: 713-366-5485	Conditions of Approval Attached

DISTRICT I
625 N. Front St., Hobbs, NM 88240
Phone (505) 339-6440 Fax (505) 339-0720
DISTRICT II
511 S. First St., Artesia, NM 88210
Phone (505) 748-1283 Fax (505) 748-9720
DISTRICT III
1000 E. 2nd St., Roswell, NM 87102
Phone (505) 339-0718 Fax (505) 334-6170
DISTRICT IV
1220 S. St. Francis Dr., Santa Fe, NM 87505
Phone (505) 476-3460 Fax (505) 476-3462

State of New Mexico
Energy, Minerals & Natural Resources Department
OIL CONSERVATION DIVISION
1220 South St. Francis Dr.
Santa Fe, New Mexico 87505

Form C-102
Revised August 1, 2011
Submit one copy to appropriate
District Office

DAMNED REPORT

WELL LOCATION AND ACREAGE DEDICATION PLAT

API Number 30-015-	Pool Code 96473	Property Name Pierce Crossing Base Springs, East	Well Number 7H
Property Code 39665	CEDAR CANYON 16 STATE		Elevation 2926
Operator Name OXY U.S.A. INC.			

U/I or lot No.	Section	Township	Range	Lot Idn	Feet from the	North/South line	Feet from the	East/West line	County
E	15	24-S	29-E	2485	330	NORTH	330	WEST	EDDY

U/I or lot No.	Section	Township	Range	Lot Idn	Feet from the	North/South line	Feet from the	East/West line	County
E	16	24-S	29-E	1980	330	NORTH	330	WEST	EDDY

NO ALLOWABLE WILL BE ASSIGNED TO THIS COMPLETION UNTIL ALL INTERESTS HAVE BEEN CONSOLIDATED OR A NON-STANDARD UNIT HAS BEEN APPROVED BY THE DIVISION

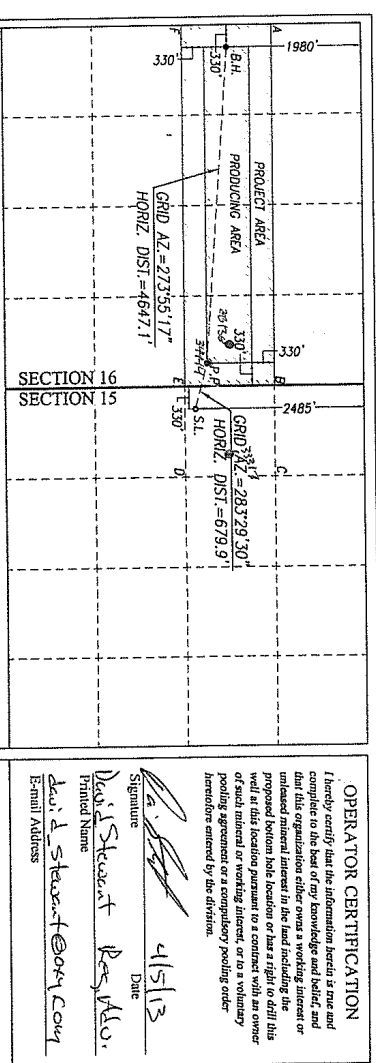

CORNER COORDINATES TABLE		GEODETIC COORDINATES	
A - Y=44309.4 N, X=603845.0 E		SURFACE LOCATION	
B - Y=44340.2 N, X=609137.2 E		Y=443182.6 N	
C - Y=44338.8 N, X=610463.2 E		X=609474.9 E	
D - Y=44301.9 N, X=610470.4 E		LAT=32.217930° N	
E - Y=44301.3 N, X=609146.1 E		LONG=103.979344° W	
F - Y=44298.3 N, X=603852.8 E			
PENETRATION POINT		BOTTOM HOLE LOCATION	
Y=44334.1 N		Y=443658.9 N	
X=609813.9 E		X=604178.8 E	
LAT=32.218372° N		LAT=32.219286° N	
LONG=103.981479° W		LONG=103.996464° W	

SURVEYOR CERTIFICATION	
I hereby certify that the well location shown on this plat was plotted from field notes of actual surveys made by me or under my supervision, and that the same is true and correct to the best of my belief.	
Date of Survey Signature of Professional Surveyor: APRIL 1, 2013 GARY G. EIDSON	Operator Certification I hereby certify that the information herein is true and complete to the best of my knowledge and belief, and that this organization either owns a working interest or undivided mineral interest in the land including the proposed bottom hole location or has a right to drill this well at this location pursuant to a contract with an owner of such mineral or working interest, or to a voluntary pooling agreement or a compulsory pooling order heretofore entered by the division. Signature Date Printed Name David Stewart Res. M.D. E-mail Address david.stewart@oxy.com

Permit Comments

Operator: OXY USA INC , 16696

Well: CEDAR CANYON 16 STATE #007H

API: 30-015-41251

Created By	Comment	Comment Date
STEWARTD	Penetration Point - 2310 FNL 330 FEL H Sec 16 T24S R29E - Lat:32.218372 Long:103.981479	4/5/2013
STEWARTD	Penetration Point - 2310 FNL 330 FEL H Sec 16 T24S R29E - Lat:32.218372 Long:103.981479	4/5/2013
STEWARTD	BOP - 13-5/8" 10M three ram stack w/ 5M annular, 5M choke manifold	4/5/2013
STEWARTD	This well is proposed to be completed in the 2nd Bone Spring. The H Buck State #4, 30-015-34444 is completed in the 1st Bone Spring.	4/5/2013
CSHAPARD	Land p/S	4/5/2013

Permit Conditions of Approval

Operator: OXY USA INC , 16696

Well: CEDAR CANYON 16 STATE #007H

API: 30-015-41251

OCD Reviewer	Condition
CSHAPARD	Once the well is spud, to prevent ground water contamination through whole or partial conduits from the surface, the operator shall drill without interruption through the fresh water zone or zones and shall immediately set in cement the water protection string