

Submit One Copy To Appropriate District
Office
District I
1625 N. French Dr., Hobbs, NM 88240
District II
811 S. First St., Artesia, NM 88210
District III
1000 Rio Brazos Rd., Aztec, NM 87410
District IV
1220 S. St. Francis Dr., Santa Fe, NM
87505

State of New Mexico
Energy, Minerals and Natural Resources

OIL CONSERVATION DIVISION
1220 South St. Francis Dr.
Santa Fe, NM 87505

Form C-103
Revised November 3, 2011

SUNDRY NOTICES AND REPORTS ON WELLS (DO NOT USE THIS FORM FOR PROPOSALS TO DRILL OR TO DEEPEN OR PLUG BACK TO A DIFFERENT RESERVOIR. USE "APPLICATION FOR PERMIT" (FORM C-101) FOR SUCH PROPOSALS.) 1. Type of Well: <input type="checkbox"/> Oil Well <input type="checkbox"/> Gas Well <input checked="" type="checkbox"/> Other P&A		WELL API NO. 30-025-41440
2. Name of Operator Texland Petroleum-Hobbs, LLC		5. Indicate Type of Lease STATE <input checked="" type="checkbox"/> FEE <input type="checkbox"/>
3. Address of Operator 777 Main Street, Suite 3200, Fort Worth, Texas 76102		6. State Oil & Gas Lease No.
4. Well Location Unit Letter <u>H</u> : <u>1880</u> feet from the <u>South</u> line and <u>2045</u> feet from the <u>West</u> line Section <u>3</u> Township <u>17S</u> Range <u>36E</u> NMPM <u> </u> County <u>Lea</u>		7. Lease Name or Unit Agreement Name OPL 3 State
11. Elevation (Show whether DR, RKB, RT, GR, etc.) 3870.5'		8. Well Number #1
12. Check Appropriate Box to Indicate Nature of Notice, Report or Other Data		9. OGRID Number 113315
NOTICE OF INTENTION TO: PERFORM REMEDIAL WORK <input type="checkbox"/> PLUG AND ABANDON <input type="checkbox"/> TEMPORARILY ABANDON <input type="checkbox"/> CHANGE PLANS <input type="checkbox"/> PULL OR ALTER CASING <input type="checkbox"/> MULTIPLE COMPL <input type="checkbox"/>		10. Pool name or Wildcat Lovington, ABO

12. Check Appropriate Box to Indicate Nature of Notice, Report or Other Data

NOTICE OF INTENTION TO: PERFORM REMEDIAL WORK <input type="checkbox"/> PLUG AND ABANDON <input type="checkbox"/> TEMPORARILY ABANDON <input type="checkbox"/> CHANGE PLANS <input type="checkbox"/> PULL OR ALTER CASING <input type="checkbox"/> MULTIPLE COMPL <input type="checkbox"/>	SUBSEQUENT REPORT OF: REMEDIAL WORK <input type="checkbox"/> ALTERING CASING <input type="checkbox"/> COMMENCE DRILLING OPNS. <input type="checkbox"/> P AND A <input type="checkbox"/> CASING/CEMENT JOB <input type="checkbox"/>
OTHER: <input type="checkbox"/>	<input checked="" type="checkbox"/> Location is ready for OCD inspection after P&A

☒ All pits have been remediated in compliance with OCD rules and the terms of the Operator's pit permit and closure plan.
☒ Rat hole and cellar have been filled and leveled. Cathodic protection holes have been properly abandoned.
☒ A steel marker at least 4" in diameter and at least 4' above ground level has been set in concrete. It shows the

OPERATOR NAME, LEASE NAME, WELL NUMBER, API NUMBER, QUARTER/QUARTER LOCATION OR UNIT LETTER, SECTION, TOWNSHIP, AND RANGE. ALL INFORMATION HAS BEEN WELDED OR PERMANENTLY STAMPED ON THE MARKER'S SURFACE.

- ☒ The location has been leveled as nearly as possible to original ground contour and has been cleared of all junk, trash, flow lines and other production equipment.
☒ Anchors, dead men, tie downs and risers have been cut off at least two feet below ground level.
☐ If this is a one-well lease or last remaining well on lease, the battery and pit location(s) have been remediated in compliance with OCD rules and the terms of the Operator's pit permit and closure plan. All flow lines, production equipment and junk have been removed from lease and well location. *See attached pictures*
☒ All metal bolts and other materials have been removed. Portable bases have been removed. (Poured onsite concrete bases do not have to be removed.)
☒ All other environmental concerns have been addressed as per OCD rules.
☒ Pipelines and flow lines have been abandoned in accordance with 19.15.35.10 NMAC. All fluids have been removed from non-retrieved flow lines and pipelines.
☒ If this is a one-well lease or last remaining well on lease: all electrical service poles and lines have been removed from lease and well location, except for utility's distribution infrastructure.

When all work has been completed, return this form to the appropriate District office to schedule an inspection.

SIGNATURE Vickie Smith TITLE Regulatory Analyst DATE 8/30/21

TYPE OR PRINT NAME Vickie Smith E-MAIL: vsmith@texpetro.com PHONE: 575-433-8395

For State Use Only

APPROVED BY: Kerry Fortner TITLE Compliance Officer A DATE 9/2/21
 Conditions of Approval (if any):

OPL 3 State #1
API# 30-025-41440

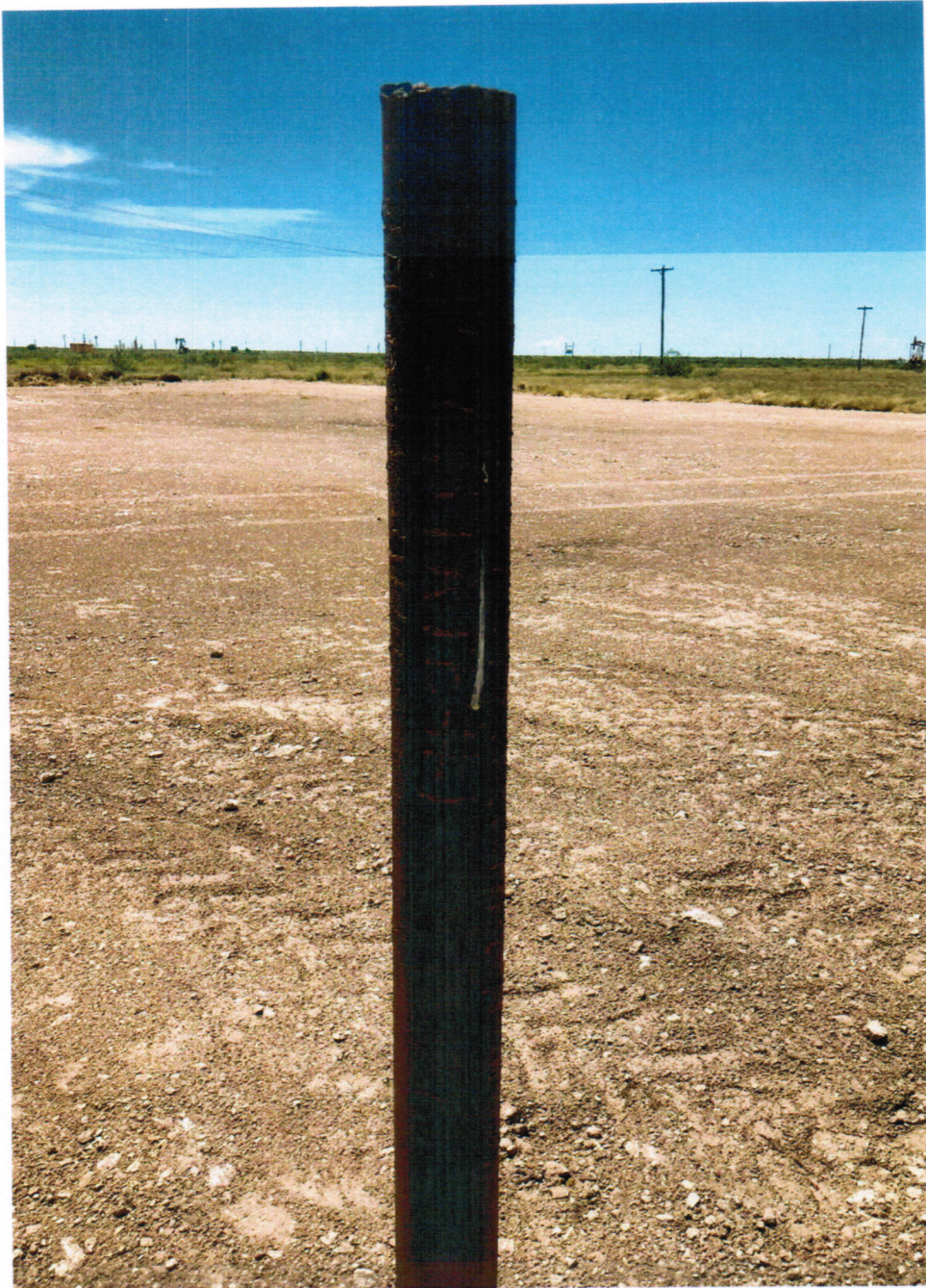

entrance to location
dry hole marker - center
Battery sets to the left
well #2 access road to right



#1 dry hole marker - center of well pad location
Battery sits left and access road to #2 to the right



well #2 pumpjack center left of access road
#1 dry hole marker left

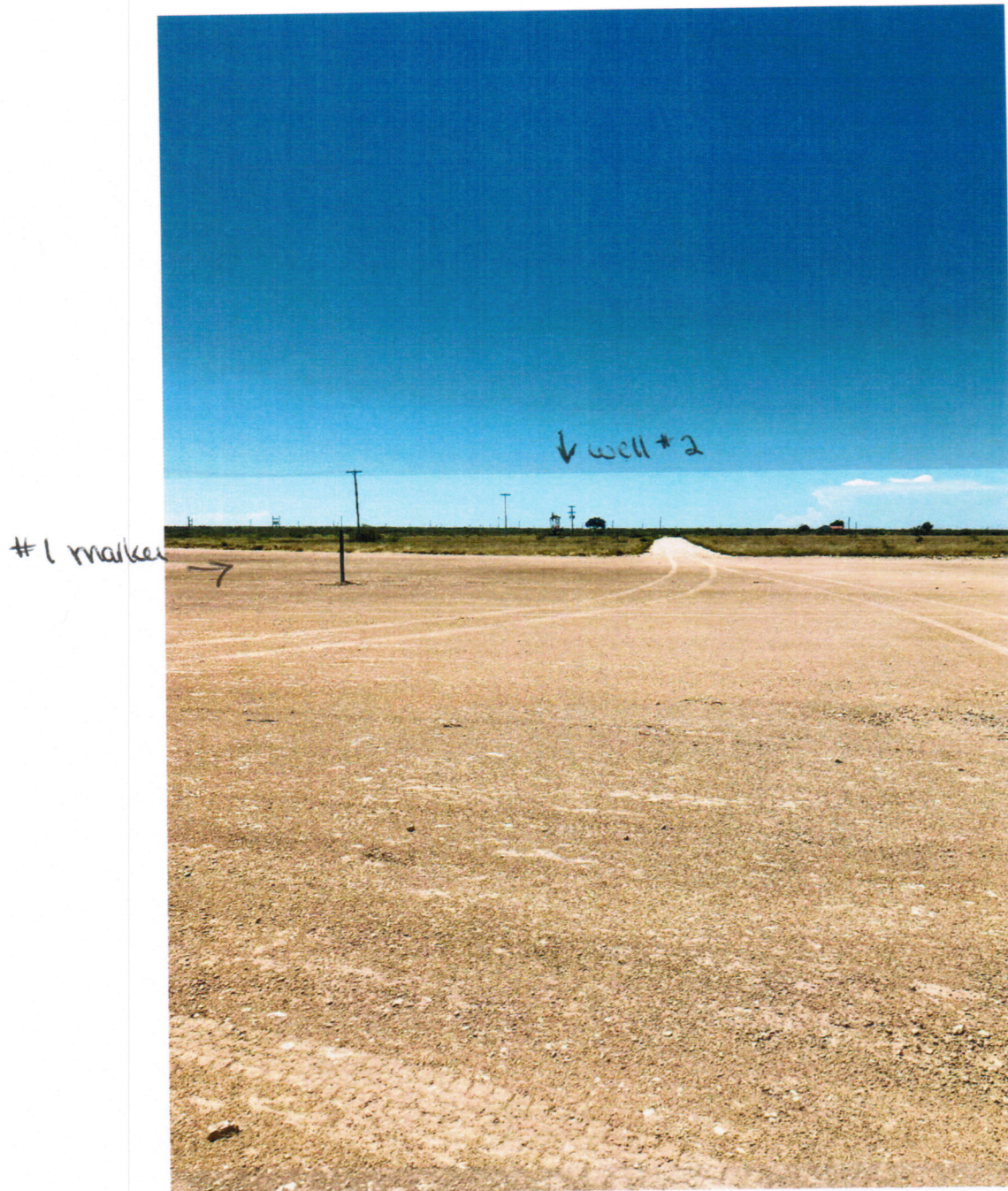



entrance to location
dry hole marker - center
Battery sets to the left
well #2 access road to right



#1 dry hole marker - center of well pad location
Battery sits left and access road to #2 to the right



well #2 pumpjack center left of access road
#1 dry hole marker left

#1 marker





District I

1625 N. French Dr., Hobbs, NM 88240
 Phone:(575) 393-6161 Fax:(575) 393-0720

District II

811 S. First St., Artesia, NM 88210
 Phone:(575) 748-1283 Fax:(575) 748-9720

District III

1000 Rio Brazos Rd., Aztec, NM 87410
 Phone:(505) 334-6178 Fax:(505) 334-6170

District IV

1220 S. St Francis Dr., Santa Fe, NM 87505
 Phone:(505) 476-3470 Fax:(505) 476-3462

State of New Mexico
Energy, Minerals and Natural Resources
Oil Conservation Division
1220 S. St Francis Dr.
Santa Fe, NM 87505

QUESTIONS

Action 45136

QUESTIONS

Operator: TEXLAND PETROLEUM-HOBBS, LLC 777 Main Street Fort Worth, TX 76102	OGRID: 113315
	Action Number: 45136
	Action Type: [C-103] Sub. Release After P&A (C-103Q)

QUESTIONS**Subsequent Report of: Location Ready For OCD Inspection After P&A**

For the sake of brevity and completeness, please allow for the following in all groups of questions and for the rest of this application:

- lease and well location, hereinafter "location";
- flowlines or pipelines, hereinafter "pipelines";
- and non-retrieved or abandoned, hereinafter "abandoned".

Was this the last remaining or only well on the location	Not answered.
Are there any abandoned pipelines that are going to remain on the location	Not answered.
Is there any production equipment or structure (not including steel marker, poured onsite concrete bases, or pipelines) that is going to remain on the location	Not answered.
If any production equipment or structure is to remain on the location, please specify	Not answered.

Site Evaluation

Please answer all questions in this group.

Have all the required pits been remediated in compliance with OCD rules and the terms of the Operator's pit permit and closure plan	Not answered.
Have the rat hole and cellar been filled and leveled	Not answered.
Have the cathodic protection holes been properly abandoned	Not answered.
Has a steel marker, at least 4 inches in diameter and at least 4 feet above ground level, been set in concrete	Not answered.
The (concrete-set) steel marker shows: Must attach marker photograph(s). *	THE OPERATOR NAME, LEASE NAME AND WELL NUMBER AND LOCATION, INCLUDING UNIT LETTER, SECTION, TOWNSHIP AND RANGE, SHALL BE WELDED, STAMPED OR OTHERWISE PERMANENTLY ENGRAVED INTO THE MARKER'S METAL.
Has the location been leveled as nearly as possible to original ground contour	Not answered.
Have all the required pipelines and other production equipment been cleared	Not answered.
Has all the required junk and trash been cleared from the location	Not answered.
Have all the required anchors, dead men, tie downs and risers have been cut off at least two feet below ground level	Not answered.
Have all the required metal bolts and other materials have been removed	Not answered.
Poured onsite concrete bases do not have to be removed.	
Have all the the required portable bases been removed	Not answered.
Have all other environmental concerns have been addressed as per OCD rules	Not answered.
If any environmental concerns remain on the location, please specify	Not answered.

* Proof of the site marker (photograph) is required.

Please submit any other site photographs that would assist in documenting the above answers, site features, additional concerns, or other nearby / remaing structures and equipment.

Abandoned Pipelines

Only need to provide answers in this group, if any pipelines have been abandoned (in accordance with 19.15.35.10 NMAC).

Have all fluids have been removed from any abandoned pipelines	Not answered.
Have all abandoned pipelines been confirmed to NOT contain additional regulated NORM, other than that which accumulated under normal operation	Not answered.
Have all accessible points of abandoned pipelines been permanently capped	Not answered.

Last Remaining or Only Well on the Location

Please answer all questions that apply in this group, specifically if there is no longer going to be any well or facility remaining at this location.

Have all electrical service poles and lines been removed from the location	Not answered.
Is there any electrical utility distribution infrastructure that is remaining on the location	Not answered.
Have all the battery and pit location(s) have been remediated in compliance with OCD rules and the terms of the Operator's pit permit and closure plan	Not answered.
Have all the retrievable pipelines, production equipment been removed from the location	Not answered.
Has all the junk and trash been removed from the location	Not answered.

District I

1625 N. French Dr., Hobbs, NM 88240
Phone:(575) 393-6161 Fax:(575) 393-0720

District II

811 S. First St., Artesia, NM 88210
Phone:(575) 748-1283 Fax:(575) 748-9720

District III

1000 Rio Brazos Rd., Aztec, NM 87410
Phone:(505) 334-6178 Fax:(505) 334-6170

District IV

1220 S. St Francis Dr., Santa Fe, NM 87505
Phone:(505) 476-3470 Fax:(505) 476-3462

State of New Mexico
Energy, Minerals and Natural Resources
Oil Conservation Division
1220 S. St Francis Dr.
Santa Fe, NM 87505

ACKNOWLEDGMENTS

Action 45136

ACKNOWLEDGMENTS

Operator: TEXLAND PETROLEUM-HOBBS, LLC 777 Main Street Fort Worth, TX 76102	OGRID: 113315
	Action Number: 45136
	Action Type: [C-103] Sub. Release After P&A (C-103Q)

ACKNOWLEDGMENTS

<input checked="" type="checkbox"/>	I hereby certify that all the work has been completed for this location and the site is ready for an OCD scheduled inspection.
-------------------------------------	--

District I
1625 N. French Dr., Hobbs, NM 88240
Phone:(575) 393-6161 Fax:(575) 393-0720
District II
811 S. First St., Artesia, NM 88210
Phone:(575) 748-1283 Fax:(575) 748-9720
District III
1000 Rio Brazos Rd., Aztec, NM 87410
Phone:(505) 334-6178 Fax:(505) 334-6170
District IV
1220 S. St Francis Dr., Santa Fe, NM 87505
Phone:(505) 476-3470 Fax:(505) 476-3462

State of New Mexico
Energy, Minerals and Natural Resources
Oil Conservation Division
1220 S. St Francis Dr.
Santa Fe, NM 87505

CONDITIONS

Action 45136

CONDITIONS

Operator: TEXLAND PETROLEUM-HOBBS, LLC 777 Main Street Fort Worth, TX 76102	OGRID: 113315
	Action Number: 45136
	Action Type: [C-103] Sub. Release After P&A (C-103Q)

CONDITIONS

Created By	Condition	Condition Date
kfortner	None	9/2/2021