

Submit 1 Copy To Appropriate District
Office

District I – (575) 393-6161
1625 N. French Dr., Hobbs, NM 88240
District II – (575) 748-1283
811 S. First St., Artesia, NM 88210
District III – (505) 334-6178
1000 Rio Brazos Rd., Aztec, NM 87410
District IV – (505) 476-3460
1220 S. St. Francis Dr., Santa Fe, NM
87505

State of New Mexico
Energy, Minerals and Natural ResourcesOIL CONSERVATION DIVISION
1220 South St. Francis Dr.
Santa Fe, NM 87505Form C-103
Revised July 18, 2013

SUNDRY NOTICES AND REPORTS ON WELLS (DO NOT USE THIS FORM FOR PROPOSALS TO DRILL OR TO DEEPEN OR PLUG BACK TO A DIFFERENT RESERVOIR. USE "APPLICATION FOR PERMIT" (FORM C-101) FOR SUCH PROPOSALS.)		WELL API NO. 30-045-25159
1. Type of Well: Oil Well <input checked="" type="checkbox"/> Gas Well <input type="checkbox"/> Other <input type="checkbox"/>		5. Indicate Type of Lease STATE <input type="checkbox"/> FEE <input checked="" type="checkbox"/>
2. Name of Operator Epic Energy LLC		6. State Oil & Gas Lease No.
3. Address of Operator 332 Road 3100, Aztec, NM 87410		7. Lease Name or Unit Agreement Name Jesse Brown
4. Well Location Unit Letter N <u>708'</u> feet from the <u>South</u> line and <u>1930'</u> feet from the <u>West</u> line Section <u>05</u> Township <u>29N</u> Range <u>15W</u> NMPM San Juan County		8. Well Number #001
11. Elevation (Show whether DR, RKB, RT, GR, etc.) 5136' GL		9. OGRID Number 372834
		10. Pool name or Wildcat Meadows Gallup

12. Check Appropriate Box to Indicate Nature of Notice, Report or Other Data

NOTICE OF INTENTION TO:

PERFORM REMEDIAL WORK ☐ PLUG AND ABANDON ☒
TEMPORARILY ABANDON ☐ CHANGE PLANS ☐
PULL OR ALTER CASING ☐ MULTIPLE COMPL ☐
DOWNHOLE COMMINGLE ☐
CLOSED-LOOP SYSTEM ☐
OTHER: ☐

SUBSEQUENT REPORT OF:

REMEDIAL WORK ☐ ALTERING CASING ☐
COMMENCE DRILLING OPNS. ☐ P AND A ☐
CASING/CEMENT JOB ☐
OTHER: ☐

13. Describe proposed or completed operations. (Clearly state all pertinent details, and give pertinent dates, including estimated date of starting any proposed work). SEE RULE 19.15.7.14 NMAC. For Multiple Completions: Attach wellbore diagram of proposed completion or recompletion.

Epic Energy, LLC plugged and abandoned the Jesse Brown #1 on October 21, 2024. Attached is the summary and WBD

Spud Date:

Rig Release Date:

I hereby certify that the information above is true and complete to the best of my knowledge and belief.

SIGNATURE Arleen Smith TITLE Regulatory DATE 11/14/2024

Type or print name Arleen Smith E-mail address: arleen@walsheng.net PHONE: 505-327-4892

For State Use Only

APPROVED BY: _____ TITLE _____ DATE _____

Conditions of Approval (if any)



Jesse Brown #1 30-045-25159

Plug and Abandonment Report

Epic Energy, LLC
Jesse Brown #1

API# 30-045-25159
708 FSL, 1930 FWL Section 05-T29N-R15W
San Juan County, NM

Notified NMOCD 10/14/2024

Plugging Work Details:

10/15/24 MIRU. SICP-490#/SITP=0#. Bled down well.

10/16/24 ND WH. SICP/SITP=vacuum, SIBHP=static upon arrival. NU BOP Tally out 139 jts of 2-3/8 tbg. EOT @ 4008' KB, SN @ 3989' KB. PU 4-1/2" CIRC, TIH on 130ts and set CIRC @ 3901' KB. SI and SDON.

10/17/24 RU. SICP/SITP=vacuum, SIBHP=static upon arrival. Bled down well.
Gallup Plug #1 (3742 – 4102') Mix and pump 28sx (32.29 cuft, 5.74bbls, 1.15yld, 15.8 ppg.) CI "G" cement neat. Cmt F/3859' – T/4142', CIRC @ 3901'. TOH w/ 130jts of tbg and stinger assembly. RU TWG Wireline. Ran CBL F/3855 – T/Surf. TOC @ 3859'. Circ.; well & PSI test to 575psi -good test. Mix and pumped plug on top of retainer (**Gallup 9 sx 10.4 cuft, 1.8 bbl) CI G cement.** EOT @ 2785'
Mancos Plug #2 (2785 – 2617) Mix & pump 13sx (15 cuft, 2.7 bbls, balanced with 10 bbls of water. EOT @ 869' KB.
Mesaverde Plug #3 (869' - 688') Mix and pump 14sx (16.1 cuft, 2.9 bbl) LD tbg SI & SDON

10/18/24 RU. SICP/STP=0psi, SIBHP = static upon arrival. TWG Wireline Service. RIH, shot 4 holes @ 301'; surface shoe @ 251'. RU Drake Cementing. Attempted to circulate BH valve, pressured up to 700psi, no communication. RU BH valve increased pressure to 120psi, surged off csg pressure, few attempts, no luck. Notified M. Kuehling (NMOCD). Instructed to shoot holes at 95' (CBL shows possible dehydrated mud at ~100') Shot 4 holes @ 95', established circulation at BH valve, 2bpm @ 50psi. RD wireline. ND BOP & NU B-1 Adapter. Mix and pump 48sx (95' – Surface 5.2 cuft, 9.8 bbl, 1.14yld, 15.8 ppg, 5.0 gs) cement to surface, closed BH valve and attempted to squeeze additional cement, surface leaks below wellhead prevented squeeze, opened BH valve and circulated 3bbls to surface. SI RD Drake #24. SDFW

Jesse Brown #1 30-045-25159

10/21/24 Welder cut off casing @ ~51' below ground level and installed P&A marker plate w/ all pertinent data. (Lat 36.751003, Long. -108.443061) NMOCD witness, Thomas Vermersch approved existing cement, no cement top off required. RD Drake. Plugged on 10/21/2024.

Thomas Vermersch (NMOCD) on location to witness/approve procedure and all plugs.

Released to Imaging: 12/10/2024 2:19:23 PM

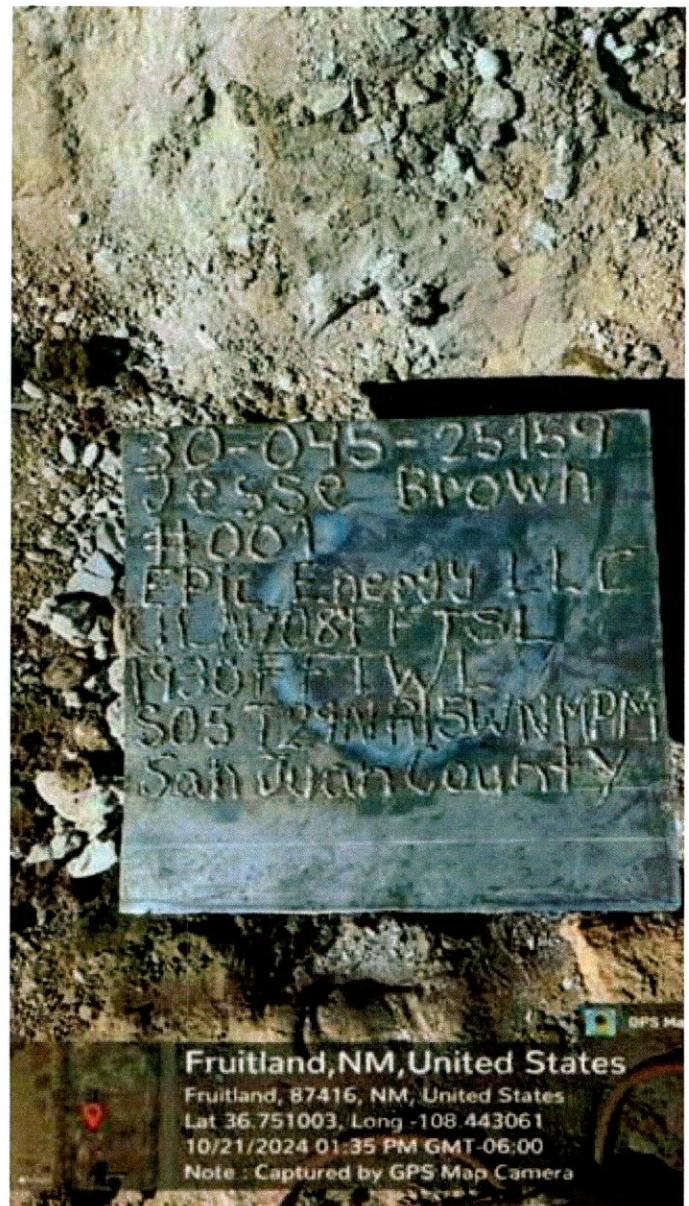
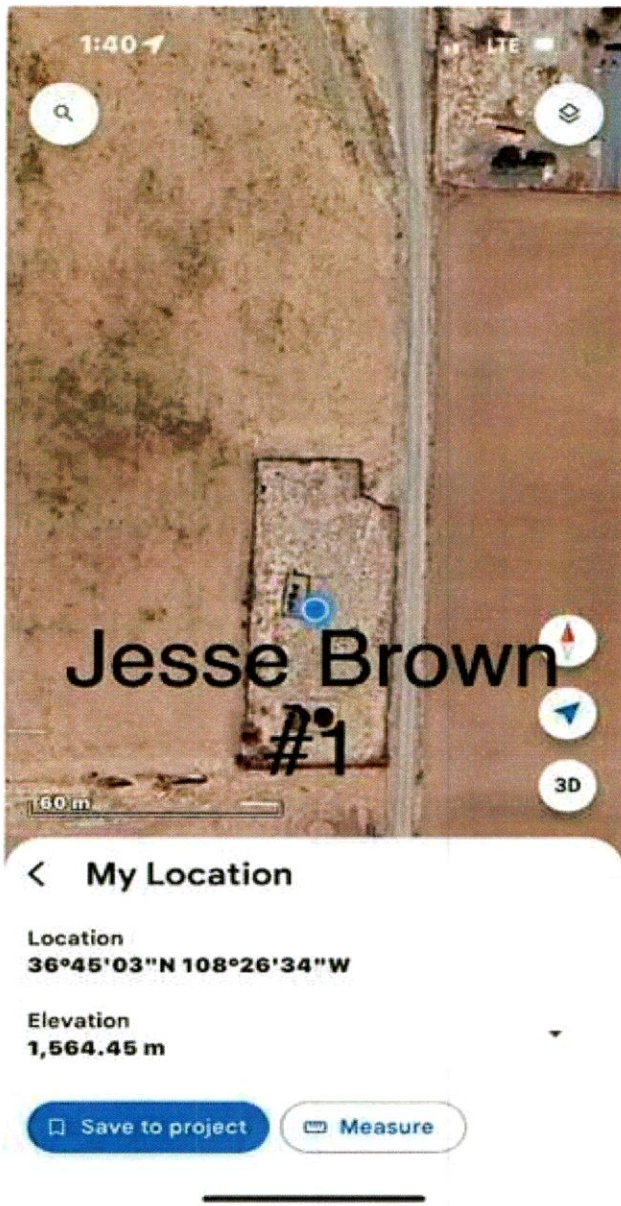

Sante Fe Main Office
Phone: (505) 476-3441

General Information
Phone: (505) 629-6116

Online Phone Directory
<https://www.emnrd.nm.gov/ocd/contact-us>

State of New Mexico
Energy, Minerals and Natural Resources
Oil Conservation Division
1220 S. St Francis Dr.
Santa Fe, NM 87505

CONDITIONS

Action 408473

CONDITIONS

Operator: EPIC ENERGY, L.L.C. 332 Road 3100 Aztec, NM 87410	OGRID: 372834
	Action Number: 408473
	Action Type: [C-103] Sub. Plugging (C-103P)

CONDITIONS

Created By	Condition	Condition Date
mkuehling	CBL in log file	12/5/2024
mkuehling	Well plugged 10/21/2024	12/5/2024