

Well Name: DIAMONDTAIL 3 FEDERAL	Well Location: T24S / R32E / SEC 3 / LOT 2 / 32.2520281 / -103.6603652	County or Parish/State: LEA / NM
Well Number: 01	Type of Well: OIL WELL	Allottee or Tribe Name:
Lease Number: NMNM94850	Unit or CA Name:	Unit or CA Number:
US Well Number: 3002535014	Operator: EOG RESOURCES INCORPORATED	

Notice of Intent

Sundry ID: 2819350

Type of Submission: Notice of Intent	Type of Action: Plug and Abandonment
Date Sundry Submitted: 10/29/2024	Time Sundry Submitted: 07:17
Date proposed operation will begin: 11/05/2024	

Procedure Description: EOG Proposes to P&A this wellbore using the attached procedure. Current and Proposed wellbore schematics attached. NOTE - Updates have been done as requested on Sundry ID 2816764.

Surface Disturbance

Is any additional surface disturbance proposed?: No

NOI Attachments

Procedure Description

- Diamondtail_3_fed_1_PA_Prog_2.0_20241029071113.pdf
- Diamondtail_3_Federal_1_PA_Current_WBD_2.0_20241029071113.pdf
- Diamondtail_3_Federal_1_PA_Proposed_WBD_2.0_20241029071113.pdf

Received by OCD: 11/26/2024 8:19:27 AM

Page 2 of 29

Well Name: DIAMONDTAIL 3 FEDERAL	Well Location: T24S / R32E / SEC 3 / LOT 2 / 32.2520281 / -103.6603652	County or Parish/State: LEA / NM
Well Number: 01	Type of Well: OIL WELL	Allottee or Tribe Name:
Lease Number: NMNM94850	Unit or CA Name:	Unit or CA Number:
US Well Number: 3002535014	Operator: EOG RESOURCES INCORPORATED	

Conditions of Approval

Specialist Review

Diamondtail_3_Federal_1_Sundry_ID_2819350_P_A_20241125143149.pdf

Operator

I certify that the foregoing is true and correct. Title 18 U.S.C. Section 1001 and Title 43 U.S.C. Section 1212, make it a crime for any person knowingly and willfully to make to any department or agency of the United States any false, fictitious or fraudulent statements or representations as to any matter within its jurisdiction. Electronic submission of Sundry Notices through this system satisfies regulations requiring a

Operator Electronic Signature: ALVINO GARCIA

Signed on: OCT 29, 2024 07:17 AM

Name: EOG RESOURCES INCORPORATED

Title: Regulatory Specialist

Street Address: 5509 CHAMPIONS BLVD

City: MIDLANDState: TX

Phone: (432) 236-2924

Email address: ALVINO_GARCIA@EOGRESOURCES.COM

Field

Representative Name:

Street Address:

City:State:Zip:

Phone:

Email address:

BLM Point of Contact

BLM POC Name: LONG VO

BLM POC Title: Petroleum Engineer

BLM POC Phone: 5759885402

BLM POC Email Address: LVO@BLM.GOV

Disposition: Approved

Disposition Date: 11/25/2024

Signature: Long Vo

Form 3160-5 (June 2019)	UNITED STATES DEPARTMENT OF THE INTERIOR BUREAU OF LAND MANAGEMENT	FORM APPROVED OMB No. 1004-0137 Expires: October 31, 2021
SUNDRY NOTICES AND REPORTS ON WELLS <i>Do not use this form for proposals to drill or to re-enter an abandoned well. Use Form 3160-3 (APD) for such proposals.</i>		5. Lease Serial No.
		6. If Indian, Allottee or Tribe Name

SUBMIT IN TRIPLICATE - Other instructions on page 2		7. If Unit of CA/Agreement, Name and/or No.
1. Type of Well <input type="checkbox"/> Oil Well <input type="checkbox"/> Gas Well <input type="checkbox"/> Other		8. Well Name and No.
2. Name of Operator		9. API Well No.
3a. Address	3b. Phone No. (include area code)	10. Field and Pool or Exploratory Area
4. Location of Well (Footage, Sec., T.,R.,M., or Survey Description)		11. Country or Parish, State

12. CHECK THE APPROPRIATE BOX(ES) TO INDICATE NATURE OF NOTICE, REPORT OR OTHER DATA				
TYPE OF SUBMISSION	TYPE OF ACTION			
<input type="checkbox"/> Notice of Intent	<input type="checkbox"/> Acidize	<input type="checkbox"/> Deepen	<input type="checkbox"/> Production (Start/Resume)	<input type="checkbox"/> Water Shut-Off
<input type="checkbox"/> Subsequent Report	<input type="checkbox"/> Alter Casing	<input type="checkbox"/> Hydraulic Fracturing	<input type="checkbox"/> Reclamation	<input type="checkbox"/> Well Integrity
<input type="checkbox"/> Final Abandonment Notice	<input type="checkbox"/> Casing Repair	<input type="checkbox"/> New Construction	<input type="checkbox"/> Recomplete	<input type="checkbox"/> Other
	<input type="checkbox"/> Change Plans	<input type="checkbox"/> Plug and Abandon	<input type="checkbox"/> Temporarily Abandon	
	<input type="checkbox"/> Convert to Injection	<input type="checkbox"/> Plug Back	<input type="checkbox"/> Water Disposal	

13. Describe Proposed or Completed Operation: Clearly state all pertinent details, including estimated starting date of any proposed work and approximate duration thereof. If the proposal is to deepen directionally or recompleate horizontally, give subsurface locations and measured and true vertical depths of all pertinent markers and zones. Attach the Bond under which the work will be perfonned or provide the Bond No. on file with BLM/BIA. Required subsequent reports must be filed within 30 days following completion of the involved operations. If the operation results in a multiple completion or recompletion in a new interval, a Form 3160-4 must be filed once testing has been completed. Final Abandonment Notices must be filed only after all requirements, including reclamation, have been completed and the operator has detennined that the site is ready for final inspection.)

14. I hereby certify that the foregoing is true and correct. Name (Printed/Typed)		
	Title	
Signature	Date	

THE SPACE FOR FEDERAL OR STATE OFFICE USE		
Approved by	Title	Date
Conditions of approval, if any, are attached. Approval of this notice does not warrant or certify that the applicant holds legal or equitable title to those rights in the subject lease which would entitle the applicant to conduct operations thereon.	Office	

Title 18 U.S.C Section 1001 and Title 43 U.S.C Section 1212, make it a crime for any person knowingly and willfully to make to any department or agency of the United States any false, fictitious or fraudulent statements or representations as to any matter within its jurisdiction.

(Instructions on page 2)

GENERAL INSTRUCTIONS

This form is designed for submitting proposals to perform certain well operations and reports of such operations when completed as indicated on Federal and Indian lands pursuant to applicable Federal law and regulations. Any necessary special instructions concerning the use of this form and the number of copies to be submitted, particularly with regard to local area or regional procedures and practices, are either shown below, will be issued by or may be obtained from the local Federal office.

SPECIFIC INSTRUCTIONS

Item 4 - Locations on Federal or Indian land should be described in accordance with Federal requirements. Consult the local Federal office for specific instructions.

Item 13: Proposals to abandon a well and subsequent reports of abandonment should include such special information as is required by the local Federal office. In addition, such proposals and reports should include reasons for the abandonment; data on any former or present productive zones or other zones with present significant fluid contents not sealed off by cement or otherwise; depths (top and bottom) and method of placement of cement plugs; mud or other material placed below, between and above plugs; amount, size, method of parting of any casing, liner or tubing pulled and the depth to the top of any tubing left in the hole; method of closing top of well and date well site conditioned for final inspection looking for approval of the abandonment. If the proposal will involve **hydraulic fracturing operations**, you must comply with 43 CFR 3162.3-3, including providing information about the protection of usable water. Operators should provide the best available information about all formations containing water and their depths. This information could include data and interpretation of resistivity logs run on nearby wells. Information may also be obtained from state or tribal regulatory agencies and from local BLM offices.

NOTICES

The privacy Act of 1974 and the regulation in 43 CFR 2.48(d) provide that you be furnished the following information in connection with information required by this application.

AUTHORITY: 30 U.S.C. 181 et seq., 351 et seq., 25 U.S.C. 396; 43 CFR 3160.

PRINCIPAL PURPOSE: The information is used to: (1) Evaluate, when appropriate, approve applications, and report completion of subsequent well operations, on a Federal or Indian lease; and (2) document for administrative use, information for the management, disposal and use of National Resource lands and resources, such as: (a) evaluating the equipment and procedures to be used during a proposed subsequent well operation and reviewing the completed well operations for compliance with the approved plan; (b) requesting and granting approval to perform those actions covered by 43 CFR 3162.3-2, 3162.3-3, and 3162.3-4; (c) reporting the beginning or resumption of production, as required by 43 CFR 3162.4-1(c) and (d) analyzing future applications to drill or modify operations in light of data obtained and methods used.

ROUTINE USES: Information from the record and/or the record will be transferred to appropriate Federal, State, local or foreign agencies, when relevant to civil, criminal or regulatory investigations or prosecutions in connection with congressional inquiries or to consumer reporting agencies to facilitate collection of debts owed the Government.

EFFECT OF NOT PROVIDING THE INFORMATION: Filing of this notice and report and disclosure of the information is mandatory for those subsequent well operations specified in 43 CFR 3162.3-2, 3162.3-3, 3162.3-4.

The Paperwork Reduction Act of 1995 requires us to inform you that:

The BLM collects this information to evaluate proposed and/or completed subsequent well operations on Federal or Indian oil and gas leases.

Response to this request is mandatory.

The BLM would like you to know that you do not have to respond to this or any other Federal agency-sponsored information collection unless it displays a currently valid OMB control number.

BURDEN HOURS STATEMENT: Public reporting burden for this form is estimated to average 8 hours per response, including the time for reviewing instructions, gathering and maintaining data, and completing and reviewing the form. Direct comments regarding the burden estimate or any other aspect of this form to U.S. Department of the Interior, Bureau of Land Management (1004-0137), Bureau Information Collection Clearance Officer (WO-630), 1849 C St., N.W., Mail Stop 401 LS, Washington, D.C. 20240

Additional Information

Location of Well

0. SHL: LOT 2 / 660 FNL / 1980 FEL / TWSP: 24S / RANGE: 32E / SECTION: 3 / LAT: 32.2520281 / LONG: -103.6603652 (TVD: 0 feet, MD: 0 feet)

BHL: LOT 2 / 660 FNL / 1980 FEL / TWSP: 24S / RANGE: 2 / SECTION: / LAT: 0.0 / LONG: 0.0 (TVD: 0 feet, MD: 0 feet)



Diamondtail 3 Fed 1 P&A
Capital AFE# 184546

Well Name	Diamondtail 3 Fed 1 P&A				
Surface Location	32.2520638,-103.6603165 NAD83			AFE/Sub Code	184546/235
RKB – Sea Level		Area/Field	Red Tank	Spud Date	5/30/00
G.L. Elevation	3,636’	County/Province	Lea	Original Rig Contractor	-
API	30-025-35014	State / Country	NM	Formation	
Comp Date	5/21/95	Total MD	9,000’	Top Perf	4,957
KOP	-	Average Lateral TVD	-	Wellhead MFG	-

STRING NAME	STRING OD	STRING WEIGHT	DESCRIPTION	FINAL DEPTH
SURFACE	13-3/8	48	13-3/8 H40	650’
INTERMEDIATE	8.625	32	8-5/8 K-55	4,690’
PRODUCTION	5.5	17	5 1/2 K55	9,000’

Summary of Procedure: Pull TBG, Run CIBP & dump bail cement, run cbl, Abandon

PROCEDURE:

1. Notify BLM & State 24 hours before beginning work.
2. MIRU & Kill well.
3. ND/NU WH/BOP
4. Release TAC, was set in 20M tension.

a. Currently there is a fish from ~8,170 to 8350 – 1 jt to 1-1/2 jts above TAC is where tbg was cut. No luck fishing it.

	Item	Name	Ran In <input type="checkbox"/>	Pulled <input type="checkbox"/>	Length	# of Items	Joint #	Top Depth (Ft)	Bottom Depth (ft)
+	Bull Plug	3.5" Bull Pl	<input checked="" type="checkbox"/>	<input type="checkbox"/>	0.50	1		8353.1	8353.6
+	Tubing	Tubing	<input checked="" type="checkbox"/>	<input type="checkbox"/>	32.60	1	1	8320.5	8353.1
+	Crossover	Crossover	<input checked="" type="checkbox"/>	<input type="checkbox"/>	1.00	1		8319.5	8320.5
+	Slotted Sub	Slotted Sub	<input checked="" type="checkbox"/>	<input type="checkbox"/>	6.00	1		8313.5	8319.5
+	Mechanical Seat Nipp	Mechanica	<input checked="" type="checkbox"/>	<input type="checkbox"/>	0.60	1		8312.9	8313.5
+	Seating Nipple	Seat Nipple	<input checked="" type="checkbox"/>	<input type="checkbox"/>	1.10	1		8311.8	8312.9
+	Tubing	Tubing	<input checked="" type="checkbox"/>	<input type="checkbox"/>	97.80	3	4	8214	8311.8
+	Tubing Anchor	5.5 x 2 7/8'	<input checked="" type="checkbox"/>	<input type="checkbox"/>	6.00	1		8208	8214



6/7/2018

Event: 14

Event Desc: DIAMONDTAIL 3 FED #1 WO - HOLE IN TUBING - EXPENSE W/O-REPAIR & MAI

AFE No:	110283	WI %:	1.00	NRI%:	0.88
AFE Total:	\$30,000	DHC:	\$0	CWC:	\$0
Rig Contr:		Rig Name:		RigStart:	
Rig Release:					
DAILY: Drill:	\$0	Comp:	\$0	Land:	\$0
CUM: Drill:	\$0	Comp:	\$0	Land:	\$0
MD / TVD:	/	Progress:	Days:	2	MW:
Formation:		Perf:	PBTD:	0	Pkr Dpth:
Total: \$18,295					
Total: \$24,940					
Visc:					
Pkr Dpth:					

CDC

Reported By: Manny Gallegos

Activity at Report Time: Tried to release tac and tbg. Ran freepoint. Cut tbg. Pooh tbg.

Start	End	Hrs	From	To	Phase	Op	Activity Description
05:00	07:00	2			Workover	Safety Meeting	CREW TO LOC. STY MTG ON RELEASE TAC AND TBG.
07:00	08:00	1			Workover	NU BOP	BLED DOWN WELL PRESSURE. OPEN WELL. ND WH NU BOP.
08:00	12:00	4			Workover	Work Stuck Pipe	RU POWER SWIVEL. TRIED TO RELEASE TAC WITH 1700 PSI TORQUE. TAC DIDN'T RELEASE. WORKED ON TBG WITH TORQUE, STILL WOULDN'T RELEASE. RU PUMP TRUCK. PUMPED 70 BBLS OF INHIBITED FW DOWN THE CASING. WELL WAS ON A VACUUM. CONTINUED TO WORK OF TBG WITH TORQUE. STILL NO RESULTS. RD SWIVEL.
12:00	12:30	1			Workover	Lunch Break	CREW TOOK LUNCH BREAK.
12:30	15:30	3			Workover	Cut Tubing	RU WIRELINE TRUCK. RIH WITH FREEPOINT. TAGGED BOTTOM @ 8343' WD. FREEPOINT @ 8276' WAS 100% STUCK @ 8218'- 2' ABOVE TAC. 100% STUCK @ 8184'- 36' ABOVE TAC. 100% FREE. POOH FREEPOINT. INFORMED MIDLAND OFFICE. GOT ORDERS TO CUT @ FREE POINT. RIH WITH CHEM CUTTER. CUT TBG 1 JT AND HALF ABOVE TAC @ 8174'. POOH CUTTER. RD WIRELINE TRUCK.
15:30	18:00	3			Workover	POOH	POOH TBG. GOT OUT WITH 256 JTS OF 2 7/8 TBG AND 17' OF CUT JT # 257. SHUT IN WELL.
18:00	19:30	2			Workover	Well Shut In	SHUT DOWN. CREW DROVE BACK TO THE YARD.

6/7/2018

Event: 14

Event Desc: DIAMONDTAIL 3 FED #1 WO - HOLE IN TUBING - EXPENSE W/O-REPAIR & MAI

5. TOOH Entire string of 2-7/8" Production TBG while scanning – use as plugging string – only rack back enough for 4,950'
6. RIH set CIBP @ 8,170 (right above fish)
7. Dump bail Class H cement on top 35'
8. RIH & set CIBP @ 7402'
9. Dump bail Class H cement on top 35'
10. RIH set CIBP 4907'
11. Run CBL from 4907 to surface – **this will decide if we need to perf or not.**
12. Tag CIBP & Circulate plugging mud
13. RIH to perf @ 4,907 as long as no cement behind csg.
14. TIH with packer & squeeze 80 sxs class c cement from 4,974 to 4,400'. This will cover the Delaware, bottom of salt, & int. shoe.
15. Release packer, spot 57 sxs class c cement from 4,974 to 4,397'. WOC & tag
16. TOOH
17. RIH to 1241' and perf. Squeeze 35 sxs class c cement to cover top of salts. WOC & tag
18. RIH & perf @ 700'
19. TIH with packer & squeeze 105 sxs class c cement from 700' to surface
20. Release packer
21. Spot 75 sxs class c cement to surface.
22. Dig out cellar, cut off wellhead and verify cement behind all casing strings.
23. Install dry hole marker, clean location and RDMO.

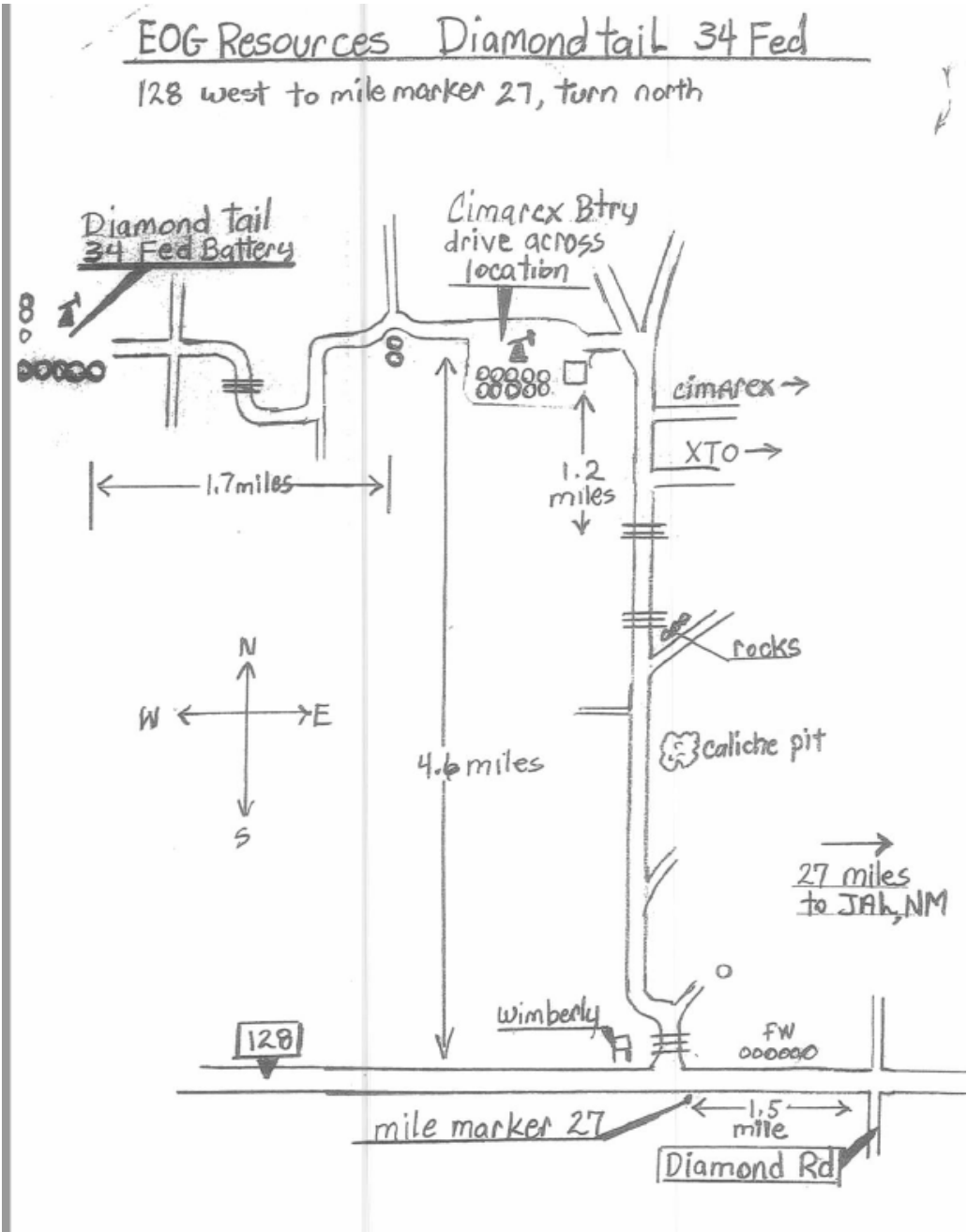

Production Engineer: Chris Caskey Date: 8/28/24
Chris Caskey

AFE Codes



PLUG & ABANDON AFEs		
P&A WELLBORE - COSTS ASSOCIATED WITH RIG WORK TO PLUG THE WELL		
Gen-Sub	Account Title	Comments
231-406	COMP - FUEL	Fuel used during plugging operations
231-407	COMP - WATER	Water used during plugging operations
231-408	COMP - MUD & CHEMICALS	Plugging mud & chemicals used during plugging operations
231-409	COMP - CEMENTING & SERVICE	Plugging company charges, cement charges, plugs
231-415	COMP - TRANSPORTATION	Rig Moves, tubing delivery, moving equipment to the next well
231-417	COMP - EQUIPMENT RENTAL	Trash/Porta Jon, frac tanks, light towers, work strings, any rental not part of the rig package
231-418	COMP - RIG	Pulling Unit & all related equipment, laydown machine, swivel, reverse unit, BOP, etc.
231-420	COMP - FISHING/EQUIP LOST IN HOLE	Fishing expenses
231-421	COMP - SAFETY	Safety Related Equipment not associated with normal rig operations
231-424	COMP - SUPERVISION	Day rate, Mileage, hotel, etc.
231-436	COMP - TUBULAR INSPEC/HANDLING	Scanning & Hydro-testing tubing
231-442	COMP - WIRELINE SERVICES	Wireline work, logging, perforating, etc
231-444	COMP - TUBING SERVICES	Hot Oiling Rods & Tubing
231-446	COMP - CONTRACT LABOR	Roustabout Gangs, NU/ND Crew, Anchors, Torq & Test
231-447	COMP - DISPOSAL COSTS	Disposal Cost including trucking

Well Name: Diamondtail 3 Fed 1
Location: 660 FNL 1980 FEL
County: Lea, NM
Lat/Long: 32.2520638,-103.6603165 NAD83
API #: 30-025-35014
Spud Date: 5/30/00
Compl. Date: 6/22/00

Formation Tops

Top of Salt	1,191'
Bottom of Salt	4,635
Delaware	4,900
Bone Spring	8,660

Current Wellbore Diagram:

KB:
GL: 3632

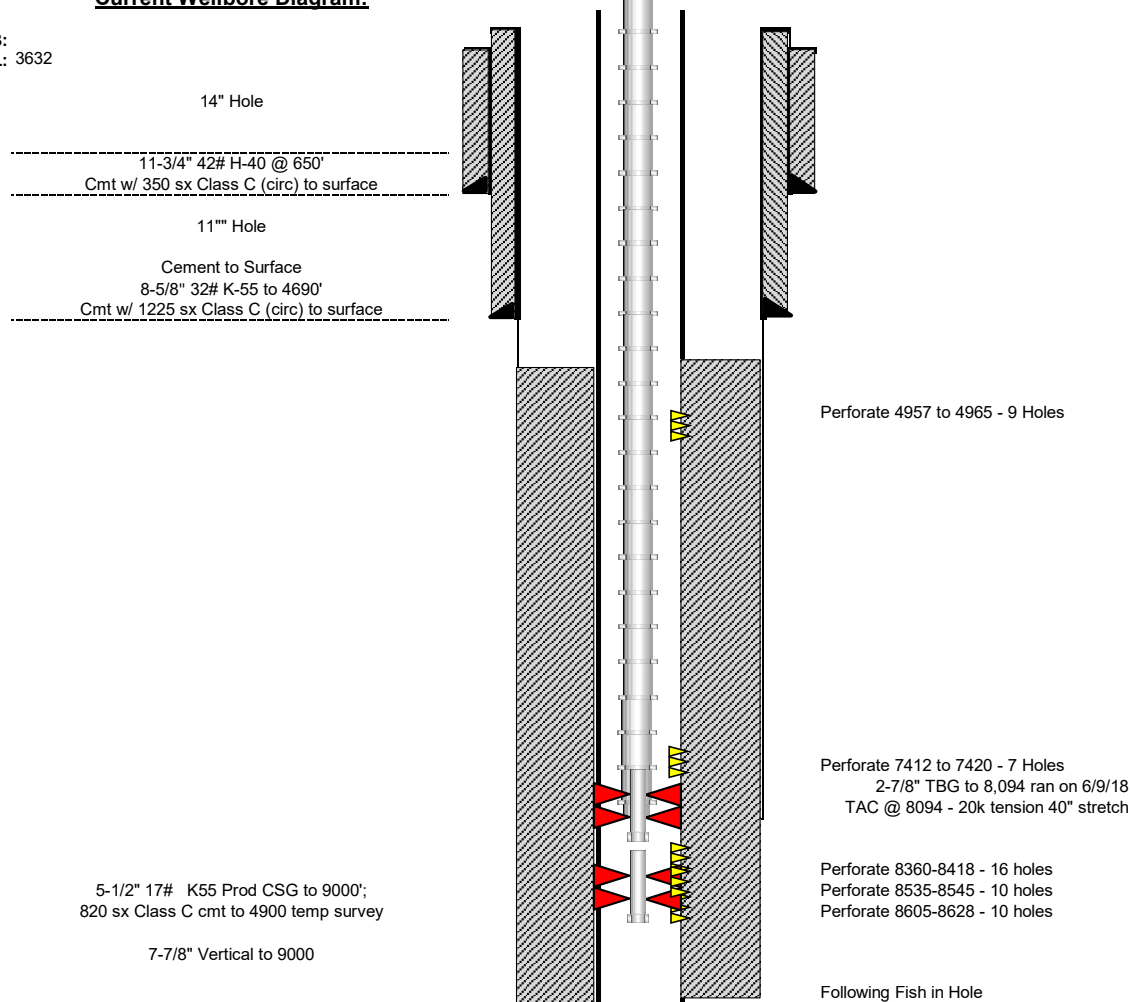
Not to Scale

By: CC 9/24/24

	Item	Name	Ran In	Pulled	Length	# of Items	Joint #	Top Depth (Ft)	Bottom Depth (ft)
+	Bull Plug	3.5" Bull PI	✓	□	0.50	1		8353.1	8353.6
+	Tubing	Tubing	✓	□	32.60	1	1	8320.5	8353.1
+	Crossover	Crossover	✓	□	1.00	1		8319.5	8320.5
+	Slotted Sub	Slotted Sub	✓	□	6.00	1		8313.5	8319.5
+	Mechanical Seat Nipp	Mechanica	✓	□	0.60	1		8312.9	8313.5
+	Seating Nipple	Seat Nipple	✓	□	1.10	1		8311.8	8312.9
+	Tubing	Tubing	✓	□	97.80	3	4	8214	8311.8
+	Tubing Anchor	5.5 x 2 7/8"	✓	□	6.00	1		8208	8214

Well Name: Diamondtail 3 Fed 1
Location: 660 FNL 1980 FEL
County: Lea, NM
Lat/Long: 32.2520638,-103.6603165 NAD83
API #: 30-025-35014
Spud Date: 5/30/00
Compl. Date: 6/22/00

Formation Tops

Top of Salt	1,191'
Bottom of Salt	4,635
Delaware	4,900
Bone Spring	8,660

Proposed Wellbore Diagram:

KB:
GL: 3632

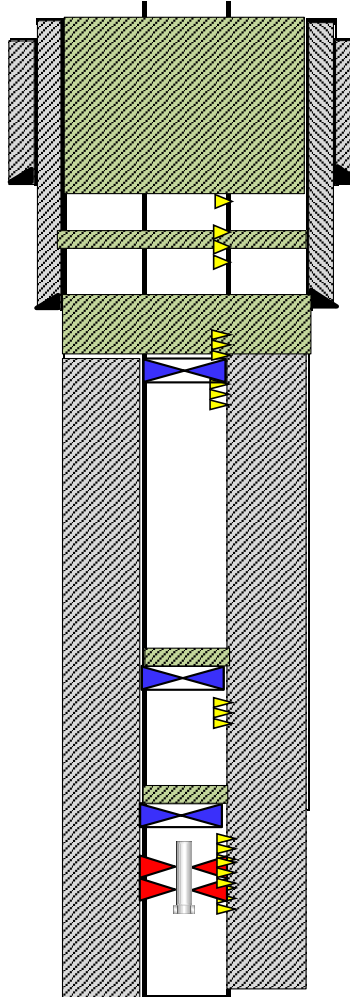
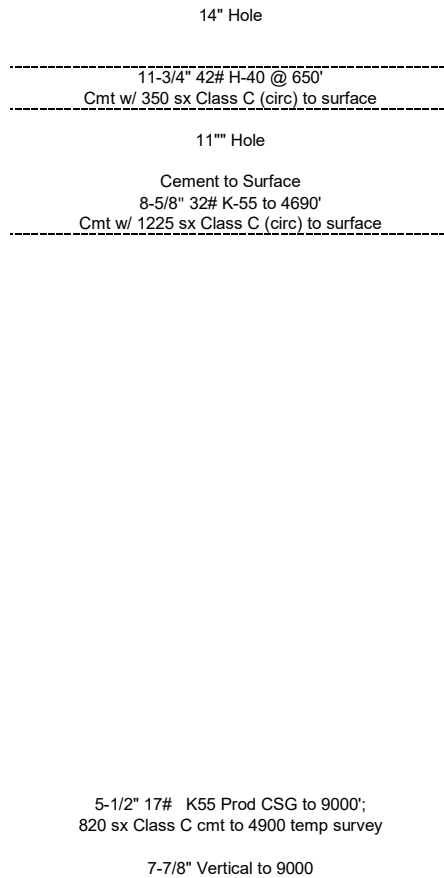

Spot 75 sxs class c cement to surface
 Squeeze 105 sxs Class C cement to surface
 Perforate 50' below shoe @700

Squeeze 35 xxs class c cement @ 1,241 to cover top of salt, WOC & tag
 Perf @ 1,241, 50' below top of salt

Top of cement on inside will be 4468, WOC & tag
 Top of cement on backside will be 4476'
 Spot 50 sx Clas C cement above perfs to cover deleware and int shoe
 Squeeze 70 sxs class C cement above deleware and above int shoe
 Perforate 4900' - 50' below top deleware as long as no cement per log

Run CBL from 4907 to surface
 Set CIBP @ 4,907'
 Perforate 4957 to 4965 - 9 Holes

Dump Bail class H cement on top of CIBP 35'
 Set CIBP @ 7,362
 Perforate 7412 to 7420 - 7 Holes

Dump Bail class H cement on top of CIBP 35'
 Set CIBP @ 8,170
 Leave fish in hole, attempted to fish and no luck

Perforate 8360-8418 - 16 holes
 Perforate 8535-8545 - 10 holes
 Perforate 8605-8628 - 10 holes

Following Fish in Hole

	Item	Name	Ran In	Pulled	Length	# of Items	Joint #	Top Depth (Ft)	Bottom Depth (ft)
<input checked="" type="checkbox"/>	Bull Plug	3.5" Bull Pl	<input checked="" type="checkbox"/>	<input type="checkbox"/>	0.50	1		8353.1	8353.6
<input checked="" type="checkbox"/>	Tubing	Tubing	<input checked="" type="checkbox"/>	<input type="checkbox"/>	32.60	1	1	8320.5	8353.1
<input checked="" type="checkbox"/>	Crossover	Crossover	<input checked="" type="checkbox"/>	<input type="checkbox"/>	1.00	1		8319.5	8320.5
<input checked="" type="checkbox"/>	Slotted Sub	Slotted Sub	<input checked="" type="checkbox"/>	<input type="checkbox"/>	6.00	1		8313.5	8319.5
<input checked="" type="checkbox"/>	Mechanical Seat Nipp	Mechanica	<input checked="" type="checkbox"/>	<input type="checkbox"/>	0.60	1		8312.9	8313.5
<input checked="" type="checkbox"/>	Seating Nipple	Seat Nipple	<input checked="" type="checkbox"/>	<input type="checkbox"/>	1.10	1		8311.8	8312.9
<input checked="" type="checkbox"/>	Tubing	Tubing	<input checked="" type="checkbox"/>	<input type="checkbox"/>	97.80	3	4	8214	8311.8
<input checked="" type="checkbox"/>	Tubing Anchor	5.5 x 2 7/8'	<input checked="" type="checkbox"/>	<input type="checkbox"/>	6.00	1		8208	8214



U.S. Department of the Interior
BUREAU OF LAND MANAGEMENT

Sundry Print Report

11/25/2024

Well Name: DIAMONDTAIL 3
FEDERAL

Well Location: T24S / R32E / SEC 3 /
LOT 2 / 32.2520281 / -103.6603652

County or Parish/State: LEA /
NM

Well Number: 01

Type of Well: OIL WELL

Allottee or Tribe Name:

Lease Number: NMNM94850

Unit or CA Name:

Unit or CA Number:

US Well Number: 3002535014

Operator: EOG RESOURCES
INCORPORATED

Notice of Intent

Sundry ID: 2819350

Type of Submission: Notice of Intent

Type of Action: Plug and Abandonment

Date Sundry Submitted: 10/29/2024

Time Sundry Submitted: 07:17

Date proposed operation will begin: 11/05/2024

Procedure Description: EOG Proposes to P&A this wellbore using the attached procedure. Current and Proposed wellbore schematics attached. NOTE - Updates have been done as requested on Sundry ID 2816764.

Surface Disturbance

Is any additional surface disturbance proposed?: No

NOI Attachments

Procedure Description

Diamondtail_3_fed_1_PA_Prog_2.0__20241029071113.pdf

Diamondtail_3_Federal_1_PA_Current_WBD_2.0_20241029071113.pdf

Diamondtail_3_Federal_1_PA_Proposed_WBD_2.0_20241029071113.pdf

APPROVAL SUBJECT TO
GENERAL REQUIREMENTS AND
SPECIAL STIPULATIONS
ATTACHED

Well Name: DIAMONDTAIL 3 FEDERAL	Well Location: T24S / R32E / SEC 3 / LOT 2 / 32.2520281 / -103.6603652	County or Parish/State: LEA / NM
Well Number: 01	Type of Well: OIL WELL	Allottee or Tribe Name:
Lease Number: NMNM94850	Unit or CA Name:	Unit or CA Number:
US Well Number: 3002535014	Operator: EOG RESOURCES INCORPORATED	

Operator

I certify that the foregoing is true and correct. Title 18 U.S.C. Section 1001 and Title 43 U.S.C. Section 1212, make it a crime for any person knowingly and willfully to make to any department or agency of the United States any false, fictitious or fraudulent statements or representations as to any matter within its jurisdiction. Electronic submission of Sundry Notices through this system satisfies regulations requiring a

Operator Electronic Signature: ALVINO GARCIA**Signed on:** OCT 29, 2024 07:17 AM**Name:** EOG RESOURCES INCORPORATED**Title:** Regulatory Specialist**Street Address:** 5509 CHAMPIONS BLVD**City:** MIDLAND**State:** TX**Phone:** (432) 236-2924**Email address:** ALVINO_GARCIA@EOGRESOURCES.COM**Field****Representative Name:****Street Address:****City:****State:****Zip:****Phone:****Email address:**

Form 3160-5
(June 2019)UNITED STATES
DEPARTMENT OF THE INTERIOR
BUREAU OF LAND MANAGEMENTFORM APPROVED
OMB No. 1004-0137
Expires: October 31, 2021**SUNDRY NOTICES AND REPORTS ON WELLS**
Do not use this form for proposals to drill or to re-enter an abandoned well. Use Form 3160-3 (APD) for such proposals.**SUBMIT IN TRIPLICATE** - Other instructions on page 2

1. Type of Well

☒ Oil Well ☐ Gas Well ☐ Other

2. Name of Operator

EOG RESOURCES INCORPORATED

3a. Address 1111 BAGBY SKY LOBBY 2, HOUSTON, TX 770

3b. Phone No. (include area code)
(713) 651-7000

4. Location of Well (Footage, Sec., T., R., M., or Survey Description)

SEC 3/T24S/R32E/NMP

5. Lease Serial No.

NMNM94850

6. If Indian, Allottee or Tribe Name

7. If Unit of CA/Agreement, Name and/or No.

8. Well Name and No.

DIAMONDTAIL 3 FEDERAL/01

9. API Well No.

3002535014

10. Field and Pool or Exploratory Area

TRISTE DRAW-DELAWARE/TRISTE DRAW-DELAWARE

11. Country or Parish, State

LEA/NM

12. CHECK THE APPROPRIATE BOX(ES) TO INDICATE NATURE OF NOTICE, REPORT OR OTHER DATA

TYPE OF SUBMISSION	TYPE OF ACTION			
<input checked="" type="checkbox"/> Notice of Intent	<input type="checkbox"/> Acidize	<input type="checkbox"/> Deepen	<input type="checkbox"/> Production (Start/Resume)	<input type="checkbox"/> Water Shut-Off
<input type="checkbox"/> Subsequent Report	<input type="checkbox"/> Alter Casing	<input type="checkbox"/> Hydraulic Fracturing	<input type="checkbox"/> Reclamation	<input type="checkbox"/> Well Integrity
<input type="checkbox"/> Final Abandonment Notice	<input type="checkbox"/> Casing Repair	<input type="checkbox"/> New Construction	<input type="checkbox"/> Recomplete	<input type="checkbox"/> Other
	<input type="checkbox"/> Change Plans	<input checked="" type="checkbox"/> Plug and Abandon	<input type="checkbox"/> Temporarily Abandon	
	<input type="checkbox"/> Convert to Injection	<input type="checkbox"/> Plug Back	<input type="checkbox"/> Water Disposal	

13. Describe Proposed or Completed Operation: Clearly state all pertinent details, including estimated starting date of any proposed work and approximate duration thereof. If the proposal is to deepen directionally or recompleat horizontally, give subsurface locations and measured and true vertical depths of all pertinent markers and zones. Attach the Bond under which the work will be performed or provide the Bond No. on file with BLM/BIA. Required subsequent reports must be filed within 30 days following completion of the involved operations. If the operation results in a multiple completion or recompleat in a new interval, a Form 3160-4 must be filed once testing has been completed. Final Abandonment Notices must be filed only after all requirements, including reclamation, have been completed and the operator has determined that the site is ready for final inspection.)

EOG Proposes to P&A this wellbore using the attached procedure. Current and Proposed wellbore schematics attached.

NOTE - Updates have been done as requested on Sundry ID 2816764.

14. I hereby certify that the foregoing is true and correct. Name (Printed Typed)

ALVINO GARCIA / Ph: (432) 236-2924

Title Regulatory Specialist

Signature (Electronic Submission)

Date

10/29/2024

THE SPACE FOR FEDERAL OR STATE OFFICE USE

Approved by

Long V. [Signature]

Title Petroleum Engineer

Date 11/25/2024

Conditions of approval, if any, are attached. Approval of this notice does not warrant or certify that the applicant holds legal or equitable title to those rights in the subject lease which would entitle the applicant to conduct operations thereon.

Office CFO

Title 18 U.S.C Section 1001 and Title 43 U.S.C Section 1212, make it a crime for any person knowingly and willfully to make to any department or agency of the United States any false, fictitious or fraudulent statements or representations as to any matter within its jurisdiction.

(Instructions on page 2)

GENERAL INSTRUCTIONS

This form is designed for submitting proposals to perform certain well operations and reports of such operations when completed as indicated on Federal and Indian lands pursuant to applicable Federal law and regulations. Any necessary special instructions concerning the use of this form and the number of copies to be submitted, particularly with regard to local area or regional procedures and practices, are either shown below, will be issued by or may be obtained from the local Federal office.

SPECIFIC INSTRUCTIONS

Item 4 - Locations on Federal or Indian land should be described in accordance with Federal requirements. Consult the local Federal office for specific instructions.

Item 13: Proposals to abandon a well and subsequent reports of abandonment should include such special information as is required by the local Federal office. In addition, such proposals and reports should include reasons for the abandonment; data on any former or present productive zones or other zones with present significant fluid contents not sealed off by cement or otherwise; depths (top and bottom) and method of placement of cement plugs; mud or other material placed below, between and above plugs; amount, size, method of parting of any casing, liner or tubing pulled and the depth to the top of any tubing left in the hole; method of closing top of well and date well site conditioned for final inspection looking for approval of the abandonment. If the proposal will involve **hydraulic fracturing operations**, you must comply with 43 CFR 3162.3-3, including providing information about the protection of usable water. Operators should provide the best available information about all formations containing water and their depths. This information could include data and interpretation of resistivity logs run on nearby wells. Information may also be obtained from state or tribal regulatory agencies and from local BLM offices.

NOTICES

The privacy Act of 1974 and the regulation in 43 CFR 2.48(d) provide that you be furnished the following information in connection with information required by this application.

AUTHORITY: 30 U.S.C. 181 et seq., 351 et seq., 25 U.S.C. 396; 43 CFR 3160.

PRINCIPAL PURPOSE: The information is used to: (1) Evaluate, when appropriate, approve applications, and report completion of subsequent well operations, on a Federal or Indian lease; and (2) document for administrative use, information for the management, disposal and use of National Resource lands and resources, such as: (a) evaluating the equipment and procedures to be used during a proposed subsequent well operation and reviewing the completed well operations for compliance with the approved plan; (b) requesting and granting approval to perform those actions covered by 43 CFR 3162.3-2, 3162.3-3, and 3162.3-4; (c) reporting the beginning or resumption of production, as required by 43 CFR 3162.4-1(c) and (d) analyzing future applications to drill or modify operations in light of data obtained and methods used.

ROUTINE USES: Information from the record and/or the record will be transferred to appropriate Federal, State, local or foreign agencies, when relevant to civil, criminal or regulatory investigations or prosecutions in connection with congressional inquiries or to consumer reporting agencies to facilitate collection of debts owed the Government.

EFFECT OF NOT PROVIDING THE INFORMATION: Filing of this notice and report and disclosure of the information is mandatory for those subsequent well operations specified in 43 CFR 3162.3-2, 3162.3-3, 3162.3-4.

The Paperwork Reduction Act of 1995 requires us to inform you that:

The BLM collects this information to evaluate proposed and/or completed subsequent well operations on Federal or Indian oil and gas leases.

Response to this request is mandatory.

The BLM would like you to know that you do not have to respond to this or any other Federal agency-sponsored information collection unless it displays a currently valid OMB control number.

BURDEN HOURS STATEMENT: Public reporting burden for this form is estimated to average 8 hours per response, including the time for reviewing instructions, gathering and maintaining data, and completing and reviewing the form. Direct comments regarding the burden estimate or any other aspect of this form to U.S. Department of the Interior, Bureau of Land Management (1004-0137), Bureau Information Collection Clearance Officer (WO-630), 1849 C St., N.W., Mail Stop 401 LS, Washington, D.C. 20240

Additional Information

Location of Well

0. SHL: LOT 2 / 660 FNL / 1980 FEL / TWSP: 24S / RANGE: 32E / SECTION: 3 / LAT: 32.2520281 / LONG: -103.6603652 (TVD: 0 feet, MD: 0 feet)
BHL: LOT 2 / 660 FNL / 1980 FEL / TWSP: 24S / RANGE: 2 / SECTION: / LAT: 0.0 / LONG: 0.0 (TVD: 0 feet, MD: 0 feet)

9/24/24
P&A

Diamondtail 3 Fed 1 P&A
Capital AFE# 184546

Well Name	Diamondtail 3 Fed 1 P&A				
Surface Location	32.2520638, -103.6603165 NAD83			AFE/Sub Code	184546/235
RKB – Sea Level		Area/Field	Red Tank	Spud Date	5/30/00
G.L. Elevation	3,636'	County/Province	Lea	Original Rig Contractor	-
API	30-025-35014	State / Country	NM	Formation	
Comp Date	5/21/95	Total MD	9,000'	Top Perf	4,957
KOP	-	Average Lateral TVD	-	Wellhead MFG	-

STRING NAME	STRING OD	STRING WEIGHT	DESCRIPTION	FINAL DEPTH
SURFACE	13-3/8	48	13-3/8 H40	650'
INTERMEDIATE	8.625	32	8-5/8 K-55	4,690'
PRODUCTION	5.5	17	5 1/2 K55	9,000'

Summary of Procedure: Pull TBG, Run CIBP & dump bail cement, run cbl, Abandon

PROCEDURE:

1. Notify BLM & State 24 hours before beginning work.
2. MIRU & Kill well.
3. ND/NU WH/BOP
4. Release TAC, was set in 20M tension.
 - a. Currently there is a fish from ~8,170 to 8350 – 1 jt to 1-1/2 jts above TAC is where tbg was cut. No luck fishing it.

	Item	Name	Ran In <input type="checkbox"/>	Pulled <input type="checkbox"/>	Length	# of Items	Joint #	Top Depth (Ft)	Bottom Depth (ft)
+	Bull Plug	3.5" Bull Pl	✓		0.50	1		8353.1	8353.6
+	Tubing	Tubing	✓		32.60	1	1	8320.5	8353.1
+	Crossover	Crossover	✓		1.00	1		8319.5	8320.5
+	Slotted Sub	Slotted Sub	✓		6.00	1		8313.5	8319.5
+	Mechanical Seat Nipp	Mechanical	✓		0.60	1		8312.9	8313.5
+	Seating Nipple	Seat Nipple	✓		1.10	1		8311.8	8312.9
+	Tubing	Tubing	✓		97.80	3	4	8214	8311.8
+	Tubing Anchor	5.5 x 2 7/8"	✓		6.00	1		8208	8214

9/24/24
P&A

AFE No:	110283	WI %:	1.00	NR%:	0.88
AFE Total:	\$30,000	DHC:	\$0	CWC:	\$0
Rig Contr:		Rig Name:		Rig Start:	
				Rig Release:	
DAILY: Drill:	\$0	Comp:	\$0	Land:	\$0
CUM: Drill:	\$0	Comp:	\$0	Land:	\$0
MD / TVD:	/	Progress:	Days: 2	MW:	Visc:
Formation:		Perf:		PBTD: 0	Pkr Dpth:
CDC	Reported By:	Manny Gallegos			
Activity at Report Time:	Tried to release tac and tbg. Ran freepoint. Cut tbg. Pooh tbg.				
Start	End	Hrs	From	To	Phase
05:00	07:00	2			Workover
07:00	08:00	1			Workover
08:00	12:00	4			Workover
12:00	12:30	1			Workover
12:30	15:30	3			Workover
15:30	18:00	3			Workover
18:00	19:30	2			Workover
Op Activity Description Safety Meeting CREW TO LOC. STY MTG ON RELEASE TAC AND TBG. NU BOP BLED DOWN WELL PRESSURE. OPEN WELL ND WH NU BOP. Work Stuck Pipe RU POWER SWIVEL. TRIED TO RELEASE TAC WITH 1700 PSI TORQUE. TAC DIDN'T RELEASE. WORKED ON TBG WITH TORQUE. STILL WOULDN'T RELEASE. RU PUMP TRUCK. PUMPED 70 BBLs OF INHIBITED FW DOWN THE CASING. WELL WAS ON A VACUUM. CONTINUED TO WORK OF TBG WITH TORQUE. STILL NO RESULTS. RD SWIVEL. Lunch Break CREW TOOK LUNCH BREAK. Cut Tubing RU WIRELINE TRUCK. RIH WITH FREEPOINT. TAGGED BOTTOM @ 8343' WD. FREEPOINT @ 8278' WAS 100% STUCK @ 8218' 2' ABOVE TAC. 100% STUCK @ 8184' 36' ABOVE TAC. 100% FREE. POOH FREEPOINT. INFORMED MIDLAND OFFICE. GOT ORDERS TO CUT @ FREE POINT. RIH WITH CHEM CUTTER. CUT TBG 1 JT AND HALF ABOVE TAC @ 8174'. POOH CUTTER. RD WIRELINE TRUCK. POOH TBG. GOT OUT WITH 256 JTS OF 2 7/8 TBG AND 17' OF CUT JT #257. SHUT IN WELL. Well Shut In SHUT DOWN. CREW DROVE BACK TO THE YARD.					
9/7/2018	Event:	14	Event Desc:	DIAMONDTAIL 3 FED #1 WO - HOLE IN TUBING - EXPENSE WO-REPAIR & MAI	

5. TOOH Entire string of 2-7/8" Production TBG while scanning – use as plugging string – only rack back enough for 4,950'
6. RIH set CIBP @ 8,170 (right above fish)
7. Dump bail Class H cement on top 35' (WOC & TAG)
8. RIH & set CIBP @ 7402' 73 (2')
9. Dump bail Class H cement on top 35' (WOC & TAG)
10. RIH set CIBP 4907'
11. Run CBL from 4907 to surface – this will decide if we need to perf or not.
12. Tag CIBP & Circulate plugging mud
13. RIH to perf @ 4,907' as long as no cement behind csg. (4900')
14. TIH with packer & squeeze 80 sxs class c cement from 4,974 to 4,400'. This will cover the Delaware, bottom of salt, & int. shoe. 4900' to 4476'
15. Release packer, spot 57 sxs class c cement from 4,974 to 4,397'. WOC & tag 4900' to 4468'
16. TOOH
17. RIH to 1241' and perf. Squeeze 35 sxs class c cement to cover top of salts. WOC & tag
18. RIH & perf @ 700' 1520' 1520'
19. TIH with packer & squeeze 105 sxs class c cement from 700' to surface
20. Release packer 204 sxs (151 sxs In / Out 204 sxs)
21. Spot 75 sxs class c cement to surface.
22. Dig out cellar, cut off wellhead and verify cement behind all casing strings.
23. Install dry hole marker, clean location and RDMO.

Page 3

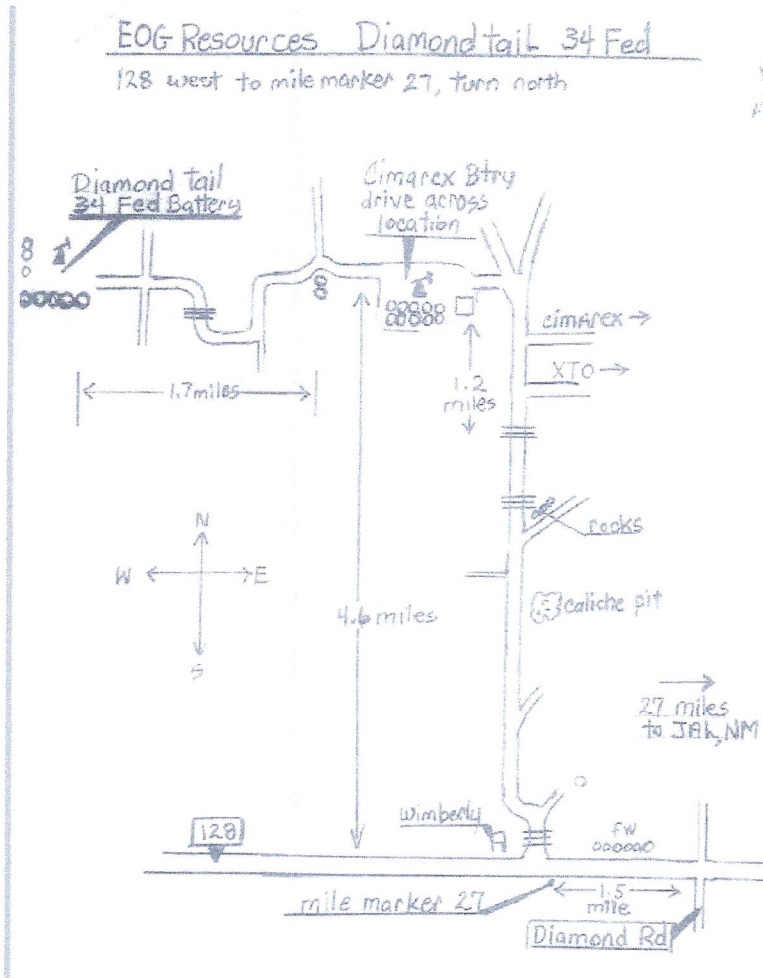
9/24/24
P&A

Production Engineer:

Date: 8/28/24

Chris Caskey

AFE Codes



PLUG & ABANDON AFEs		
P&A WELLBORE COSTS ASSOCIATED WITH RIG WORK TO PLUG THE WELL		
Gen Sub	Account Title	Comments
231-406	COMP - FUEL	Fuel used during plugging operations
231-407	COMP - WATER	Water used during plugging operations
231-408	COMP - MUD & CHEMICALS	Plugging mud & chemicals used during plugging operations
231-409	COMP - CEMENTING & SERVICE	Plugging company charges, cement charges, plugs
231-415	COMP - TRANSPORTATION	Rig Moves, tubing delivery, moving equipment to the next well
231-417	COMP - EQUIPMENT RENTAL	Trash/Porta Jon, frac tanks, light towers, work strings, any rental not part of the rig package
231-418	COMP - RIG	Pulling Unit & all related equipment, laydown machine, swivel, reverse unit, BOP, etc.
231-420	COMP - FISHING/EQUIP LOST IN HOLE	Fishing expenses
231-421	COMP - SAFETY	Safety Related Equipment not associated with normal rig operations
231-424	COMP - SUPERVISION	Day rate, Mileage, hotel, etc.
231-436	COMP - TUBULAR INSPEC/HANDLING	Scanning & Hydro-testing tubing
231-442	COMP - WIRELINE SERVICES	Wireline work, logging, perforating, etc
231-444	COMP - TUBING SERVICES	Hot Oiling Rods & Tubing
231-446	COMP - CONTRACT LABOR	Roustabout Gangs, NU/ND Crew, Anchors, Torq & Test
231-447	COMP - DISPOSAL COSTS	Disposal Cost including trucking

Well Name: Diamondtail 3 Fed 1
 Location: 660 FNL 1980 FEL
 County: Lea, NM
 Lat/Long: 32.2520638, -103.6603165 NAD83
 API #: 30-025-35014
 Spud Date: 5/30/00
 Compl. Date: 6/22/00



Proposed Wellbore Diagram:

KB:
GL: 3632

14" Hole
 11-3/4" 42# H-40 @ 650'
 Cmt w/ 350 sx Class C (circ) to surface
 11" Hole
 Cement to Surface
 8-5/8" 32# K-55 to 4690'
 Cmt w/ 1225 sx Class C (circ) to surface

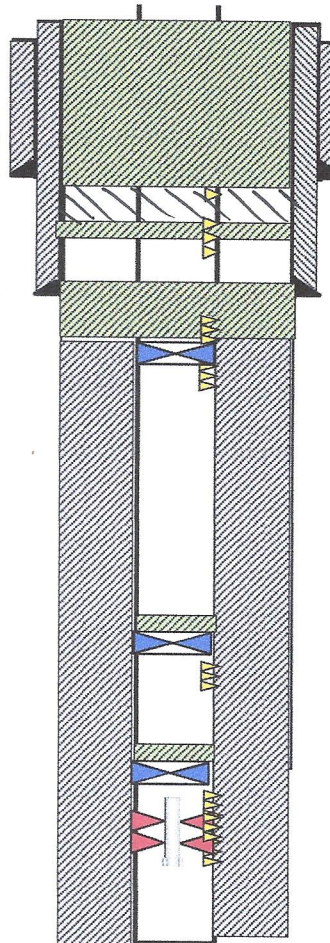

Formation Tops	
Top of Salt	1,191'
Bottom of Salt	4,635
Delaware	4,900
Bone Spring	8,660

Not to Scale
By: CC 9/24/24

Spot 70 sxs class c cement to surface 151 sxs
 Squeeze 105 sxs Class C cement to surface 304 sxs
 Perforate 50' below shoe @ 700' 1520'
 Squeeze 35 sxs class c cement @ 1,241 to cover top of salt, WOC & tag
 Perf @ 1,241, 50' below top of salt
 Top of cement on inside will be 4468, WOC & tag
 Top of cement on backside will be 4476'
 Spot 50 sxs Class C cement above perfs to cover deleware and int shoe 1748 sxs
 Squeeze 70 sxs class C cement above deleware and above int shoe 8092 sxs
 Perforate 4900' - 50' below top deleware as long as no cement per log

Run CBL from 4907 to surface
 Set CIBP @ 4,907'
 Perforate 4957 to 4965 - 9 Holes

Dump Bail class H cement on top of CIBP 35'
 Set CIBP @ 7,362
 Perforate 7412 to 7420 - 7 Holes

Dump Bail class H cement on top of CIBP 35'
 Set CIBP @ 8,170
 Leave fish in hole, attempted to fish and no luck

Perforate 8360-8418 - 16 holes
 Perforate 8535-8545 - 10 holes
 Perforate 8605-8628 - 10 holes

Following Fish in Hole

5-1/2" 17# K55 Prod CSG to 9000';
 820 sx Class C cmt to 4900 temp survey
 7-7/8" Vertical to 9000

Item	Name	Ran In	Pulled	Length	# of Items	Joint #	Top Depth (Ft)	Bottom Depth (ft)
+ Bull Plug	3.5" Bull Pl	✓	✓	0.50	1		8353.1	8353.6
+ Tubing	Tubing	✓	✓	32.60	1	1	8320.5	8353.1
+ Crossover	Crossover	✓	✓	1.00	1		8319.5	8320.5
+ Slotted Sub	Slotted Sub	✓	✓	6.00	1		8313.5	8319.5
+ Mechanical Seat Nipp	Mechanica	✓	✓	0.60	1		8312.9	8313.5
+ Seating Nipple	Seat Nippi	✓	✓	1.10	1		8311.8	8312.9
+ Tubing	Tubing	✓	✓	97.80	3	4	8214	8311.8
+ Tubing Anchor	5.5 x 2 7/8"	✓	✓	6.00	1		8208	8214

Well Name: Diamondtail 3 Fed 1
 Location: 660 FNL 1980 FEL
 County: Lea, NM
 Lat/Long: 32.2520638, -103.6603165 NAD83
 API #: 30-025-35014
 Spud Date: 5/30/00
 Compl. Date: 6/22/00



Current Wellbore Diagram:

KB:
GL: 3632

14" Hole
 11-3/4" 42# H-40 @ 650'
 Cmt w/ 350 sx Class C (circ) to surface
 11" Hole
 Cement to Surface
 8-5/8" 32# K-55 to 4690'
 Cmt w/ 1225 sx Class C (circ) to surface

Formation Tops	
Top of Salt	1,191'
Bottom of Salt	4,635
Delaware	4,900
Bone Spring	8,660

Not to Scale
By: CC 9/24/24

5-1/2" 17# K55 Prod CSG to 9000';
 820 sx Class C cmt to 4900 temp survey
 7-7/8" Vertical to 9000

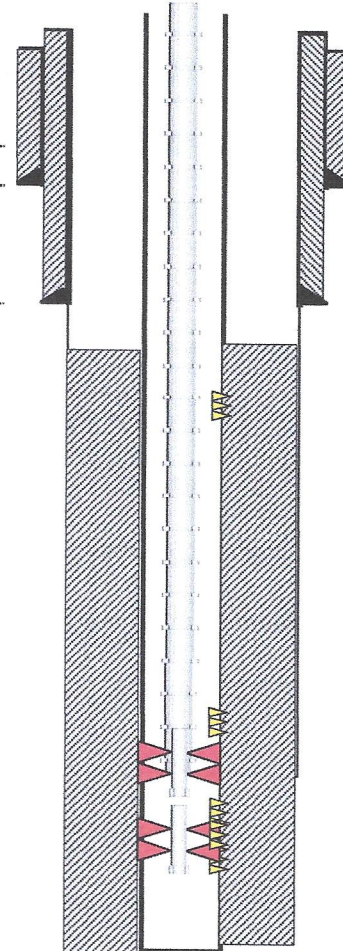

Perforate 4957 to 4965 - 9 Holes

Perforate 7412 to 7420 - 7 Holes
 2-7/8" TBG to 8,094 ran on 6/9/18
 TAC @ 8094 - 20k tension 40" stretch

Perforate 8360-8418 - 16 holes
 Perforate 8535-8545 - 10 holes
 Perforate 8605-8628 - 10 holes

Following Fish in Hole

Item	Name	Ran In	Pulled	Length	# of Items	Joint #	Top Depth (Ft)	Bottom Depth (ft)
+ Bull Plug	3.5" Bull Pl	✓		0.50	1		8353.1	8353.6
+ Tubing	Tubing	✓		32.60	1	1	8320.5	8353.1
+ Crossover	Crossover	✓		1.00	1		8319.5	8320.5
+ Slotted Sub	Slotted Sub	✓		6.00	1		8313.5	8319.5
+ Mechanical Seat Nipp	Mechanica	✓		0.60	1		8312.9	8313.5
+ Seating Nipple	Seat Nipp	✓		1.10	1		8311.8	8312.9
+ Tubing	Tubing	✓		97.80	3	4	8214	8311.8
+ Tubing Anchor	5.5 x 2 7/8"	✓		6.00	1		8208	8214

**BUREAU OF LAND MANAGEMENT
Carlsbad Field Office
620 East Greene Street
Carlsbad, New Mexico 88220
575-234-5972**

**Permanent Abandonment of Federal Wells
Conditions of Approval (LPC Habitat)**

Failure to comply with the following Conditions of Approval may result in a Notice of Incidents of Noncompliance (INC) in accordance with 43 CFR 3163.1.

1. Plugging operations shall commence within **ninety (90)** days from the approval date of this Notice of Intent to Abandon.

If you are unable to plug the well by the 90th day provide this office, prior to the 90th day, with the reason for not meeting the deadline and a date when we can expect the well to be plugged. Failure to do so will result in enforcement action.

The rig used for the plugging procedure cannot be released and moved off without the prior approval of the authorized officer. Failure to do so may result in enforcement action.

2. **Notification:** Contact the appropriate BLM office at least 24 hours prior to the commencing of any plugging operations. For wells in Chaves and Roosevelt County, call 575-627-0272; Eddy County, call 575-361-2822; Lea County, call 575-689-5981.

3. **Blowout Preventers:** A blowout preventer (BOP), as appropriate, shall be installed before commencing any plugging operation. The BOP must be installed and maintained as per API and manufacturer recommendations. The minimum BOP requirement is a 2M system for a well not deeper than 9,090 feet; a 3M system for a well not deeper than 13,636 feet; and a 5M system for a well not deeper than 22,727 feet.

4. **Mud Requirement:** Mud shall be placed between all plugs. Minimum consistency of plugging mud shall be obtained by mixing at the rate of 25 sacks (50 pounds each) of gel per 100 barrels of water. Minimum nine (9) pounds per gallon.

5. **Cement Requirement:** Sufficient cement shall be used to bring any required plug to the specified depth and length. Any given cement volumes on the proposed plugging procedure are merely estimates and are not final. Unless specific approval is received, no plug except the surface plug shall be less than 25 sacks of cement. Any plug that requires a tag will have a minimum WOC time of 4 hours for Class C or accelerated cement (calcium chloride) and 6 hours for Class H. Tagging the plug means running in the hole with a string of tubing or drill pipe and placing sufficient weight on the plug to ensure its integrity. Other methods of tagging the plug may be approved by the BLM authorized officer or BLM field representative.

In lieu of a cement plug across perforations in a cased hole (not for any other plugs), a bridge plug set within 50 feet to 100 feet above the perforations shall be capped with 25 sacks of cement. If a

bailer is used to cap this plug, 35 feet of cement shall be sufficient. **Before pumping or bailing cement on top of CIBP, tag will be required to verify depth. Based on depth, a tag of the cement may be deemed necessary.**

Unless otherwise specified in the approved procedure, the cement plug shall consist of either Neat Class "C", for up to 7,500 feet of depth or Neat Class "H", for deeper than 7,500 feet plugs.

Fluid used to mix the cement in R111Q shall be saturated with the salts common to the section penetrated, and in suitable proportions but not less than 1% and not more than 3% calcium chloride by weight of cement will be considered the desired mixture whenever possible.

6. Below Ground Level Cap (Lesser Prairie-Chicken Habitat): All casing shall be cut-off at the base of the cellar or 3 feet below final restored ground level (whichever is deeper). **The BLM is to be notified *BY PHONE* (numbers listed in 2. Notifications) a minimum of 4 hours prior to the wellhead being cut off to verify that cement is to surface in the casing and all annuluses. Wellhead cut off shall commence within ten (10) calendar days of the well being plugged. If the cut off cannot be done by the 10th day, the BLM is to be contacted with justification to receive an extension for completing the cut off.**

Upon the plugging and subsequent abandonment of wells that are located in lesser prairie-chicken habitat, the casings shall be cut-off at the base of the cellar or 3 feet below final restored ground level (whichever is deeper). The well bore shall then be covered with a metal plate at least ¼ inch thick and welded in place. A weep hole shall be left in the plate and/or casing. The following information shall be permanently inscribed on the plate: well name and number, name of operator, lease serial number, surveyed location (quarter-quarter section, section, township and range or other authorized survey designation acceptable to the authorized officer such as metes and bounds).

NMOCD also requires the operator to notify NMOCD when this type of dry hole marker is used. This can be done on the subsequent report of abandonment which is submitted to the BLM after the well is plugged. State that a below ground cap was installed as required in the COA's from the BLM.

7. Subsequent Plugging Reporting: Within 30 days after plugging work is completed, file one original and three copies of the Subsequent Report of Abandonment, Form 3160-5 to BLM. The report should give in detail the manner in which the plugging work was carried out, the extent (by depths) of cement plugs placed, and the size and location (by depths) of casing left in the well.

Show date well was plugged.

8. Trash: All trash, junk and other waste material shall be contained in trash cages or bins to prevent scattering and will be removed and deposited in an approved sanitary landfill. Burial on site is not permitted.

Following the submission and approval of the Subsequent Report of Abandonment, surface restoration will be required. See attached reclamation objectives.

Timing Limitation Stipulation/ Condition of Approval for Lesser Prairie-Chicken:

From March 1st through June 15th annually, abandonment activities will be allowed except between the hours from 3:00 am and 9:00 am. Normal vehicle use on existing roads will not be restricted



United States Department of the Interior

BUREAU OF LAND MANAGEMENT

Carlsbad Field Office
620 E. Greene St.
Carlsbad, New Mexico 88220-6292
www.blm.gov/nm



In Reply Refer To: 1310

Reclamation Objectives and Procedures

Reclamation Objective: Oil and gas development is one of many uses of the public lands and resources. While development may have a short- or long-term effect on the land, successful reclamation can ensure the effect is not permanent. During the life of the development, all disturbed areas not needed for active support of production operations should undergo “interim” reclamation in order to minimize the environmental impacts of development on other resources and uses. At final abandonment, well locations, production facilities, and access roads must undergo “final” reclamation so that the character and productivity of the land and water are restored.

The long-term objective of final reclamation is to set the course for eventual ecosystem restoration, including the restoration of the natural vegetation community, hydrology, and wildlife habitats. In most cases this means returning the land to a condition approximating or equal to that which existed prior to the disturbance. The final goal of reclamation is to restore the character of the land and water to its pre-disturbance condition. The operator is generally not responsible for achieving full ecological restoration of the site. Instead, the operator must achieve the short-term stability, visual, hydrological, and productivity objectives of the surface management agency and take steps necessary to ensure that long-term objectives will be reached through natural processes.

To achieve these objectives, remove any/all contaminants, scrap/trash, equipment, pipelines and powerlines (**Contact service companies, allowing plenty of time to have the risers and power lines and poles removed prior to reclamation, don't wait till the last day and try to get them to remove infrastructure**). Strip and remove caliche, contour the location to blend with the surrounding landscape, re-distribute the native soils, provide erosion control as needed, rip (across the slope and seed as specified in the original APD COA. **This will apply to well pads, facilities, and access roads**. Barricade access road at the starting point. If reserve pits have not reclaimed due to salts or other contaminants, submit a plan for approval, as to how you propose to provide adequate restoration of the pit area.

1. The Application for Permit to Drill or Reenter (APD, Form 3160-3), Surface Use Plan of Operations must include adequate measures for stabilization and reclamation of disturbed lands. Oil and Gas operators must plan for reclamation, both interim and final, up front in the APD process as per Onshore Oil and Gas Order No. 1.
2. For wells and/or access roads not having an approved plan, or an inadequate plan for surface reclamation (either interim or final reclamation), the operator must submit a proposal describing the procedures for reclamation. For interim reclamation, the appropriate time for submittal would be when filing the Well Completion or Recompletion Report and Log (Form 3160-4). For final reclamation, the appropriate time for submittal would be when filing the Notice of Intent, or the Subsequent Report of Abandonment, Sundry Notices and Reports on Wells (Form 3160-5). Interim reclamation is to be completed within 6 months of well completion, and final reclamation is to be completed within 6 months of well abandonment.
3. The operator must file a Subsequent Report Plug and Abandonment (Form 3160-5) following the plugging of a well.
4. Previous instruction had you waiting for a BLM specialist to inspect the location and provide you with reclamation requirements. If you have an approved Surface Use Plan of Operation and/or an approved Sundry

Notice, you are free to proceed with reclamation as per approved APD. If you have issues or concerns, contact a BLM specialist to assist you. It would be in your interest to have a BLM specialist look at the location and access road prior to the removal of reclamation equipment to ensure that it meets BLM objectives. Upon conclusion submit a Form 3160-5, Subsequent Report of Reclamation. This will prompt a specialist to inspect the location to verify work was completed as per approved plans.

5. The approved Subsequent Report of Reclamation will be your notice that the native soils, contour and seedbed have been reestablished. If the BLM objectives have not been met the operator will be notified and corrective actions may be required.
6. It is the responsibility of the operator to monitor these locations and/or access roads until such time as the operator feels that the BLM objective has been met. If after two growing seasons the location and/or access roads are not showing the potential for successful revegetation, additional actions may be needed. When you feel the BLM objectives have been met submit a Final Abandonment Notice (FAN), Form 3160-5, stating that all reclamation requirements have been achieved and the location and/or access road is ready for a final abandonment inspection.
7. At this time the BLM specialist will inspect the location and/or access road. If the native soils and contour have been restored, and the revegetation is successful, the FAN will be approved, releasing the operator of any further liability of the location and/or access road. If the location and/or access road have not achieved the objective, you will be notified as to additional work needed or additional time being needed to achieve the objective.

If there are any questions, please feel free to contact any of the following specialists:

Jim Amos
Supervisory Petroleum Engineering Tech/Environmental Protection Specialist
575-234-5909 (Office), 575-361-2648 (Cell)

Arthur Arias
Environmental Protection Specialist
575-234-6230

Crisha Morgan
Environmental Protection Specialist
575-234-5987

Jose Martinez-Colon
Environmental Protection Specialist
575-234-5951

Mark Mattozzi
Environmental Protection Specialist
575-234-5713

Robert Duenas
Environmental Protection Specialist
575-234-2229

Doris Lauger Martinez
Environmental Protection Specialist
575-234-5926

Jaden Johnston
Environmental Protection Asst. (Intern)
575-234-6252

Sundry ID

2819350

Plug Type	Top	Bottom	Length	Tag	Sacks	Cement Class	Notes
Surface Plug	0.00	100.00	100.00	Tag/Verify			
11.75 inch- Shoe Plug	593.50	700.00	106.50	Tag/Verify			
Fresh Water @ 1217	1154.83	1267.00	112.17	If solid			
Top of Salt @ 1470	1405.30	1520.00	114.70	Tag/Verify	355.00	C	Perf and squeeze from 1520' to surface. (In 151 sxs/Out 204 sxs) Verify at surface.
8.625 inch- Shoe Plug	4468.00	4740.00	272.00	Tag/Verify			
Base of Salt @ 4720	4622.80	4770.00	147.20	Tag/Verify			
Delaware @ 4940	4840.60	4990.00	149.40	If solid			
Perforations Plug (If No CIBP)	4865.35	5015.00	149.65	Tag/Verify			
CIBP Plug	4872.00	4907.00	35.00	base no need to Tag (CIBP	137.00	C	Perf and squeeze from 4900' to 4468'. WOC and Tag. (In 57 sxs/Out 80 sxs)
Perforations Plug (If No CIBP)	7295.80	7470.00	174.20	Tag/Verify			
CIBP Plug	7327.00	7362.00	35.00	If solid base no need to Tag (CIBP present and/or Mechanical Integrity Test), If Perf & Sqz then Tag, Leak Test all CIBP if no Open Perforations	4.00	C	Set CIBP at 7362'. Dump bail 35' on top. WOC and Tag.
Top of Fish @ 8174	8042.26	8224.00	181.74	If solid			
CIBP Plug	8135.00	8170.00	35.00	If solid base no need to Tag (CIBP present and/or Mechanical Integrity Test), If Perf & Sqz then Tag, Leak Test all CIBP if no Open Perforations	5.00	H	Set CIBP at 8170 feet. Dump bail 35' on top. WOC and Tag.
Bonesprings @ 8680	8543.20	8730.00	186.80	If solid			
5.5 inch- Shoe Plug	8860.00	9050.00	190.00	Tag/Verify			

No more than 2000' is to be allowed between plugs in open hole, and no more than 3000' between plugs in cased hole.

Class H >7500'

Class C <7500'

Fluid used to mix the cement in R111P shall be saturated with the salts common to the section penetrated, and in suitable proportions, but not more than 3% calcium chloride by weight of cement will be considered the desired mixture whenever possible.

Medium, Secretary: Top of salt to surface If no salt take the deepest fresh water or Karst Depth

High, Critical: Bottom of Karst to surface or Deepest fresh water, whichever is greater

R111P: 50 Feet from Base of Salt to surface.

Class C: 1.32 ft³/sx

Class H: 1.06 ft³/sx

Onshore Order 2.III.G Drilling Abandonment Requirements: "All formations bearing usable-quality water, oil, gas, or geothermal resources, and/or a prospectively valuable deposit of minerals shall be protected.

Cave Karst/Potash Cement Requirement:

Low

11.75 inch- Shoe Plug @	650.00		
8.625 inch- Shoe Plug @	4690.00		
5.5 inch- Shoe Plug @	9000.00	TOC @	4900.00
Perforatons Top @	7412.00	Perforations	7420.00
Perforatons Top @	4957.00	Perforations	4965.00
		CIBP @	7362.00
		CIBP @	4907.00
		CIBP @	8170.00

Sante Fe Main Office
Phone: (505) 476-3441

General Information
Phone: (505) 629-6116

Online Phone Directory
<https://www.emnrd.nm.gov/oed/contact-us>

State of New Mexico
Energy, Minerals and Natural Resources
Oil Conservation Division
1220 S. St Francis Dr.
Santa Fe, NM 87505

CONDITIONS

Action 406584

CONDITIONS

Operator: EOG RESOURCES INC 5509 Champions Drive Midland, TX 79706	OGRID: 7377
	Action Number: 406584
	Action Type: [C-103] NOI Plug & Abandon (C-103F)

CONDITIONS

Created By	Condition	Condition Date
gcordero	A Cement Bond Log (CBL) is required to be submitted to electronic permitting.	12/17/2024
gcordero	Submit Cement Bond Logs (CBL) prior to submittal of C-103P.	12/17/2024