



Pre-Plugging Methane Emissions Monitoring Report

Jennifer Chaveroo #005

Prepared by TS-Nano, Inc.
For NM Energy, Minerals and Natural Resources Department, Oil Conservation Division
PO# 52100-0000078682

Well information

ID #: 30-041-10630
Name: Jennifer Chaveroo #005

Coordinates: 33.695507, -103.493828
Surface Location: Roosevelt County

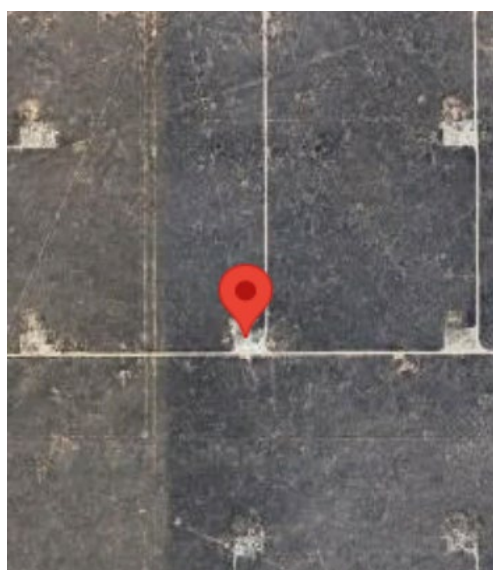

Measurement notes

Device used: VentMedic #DC9447

Test operator: Jay Kitowski

Gas sample taken from well: 11/16/24 11:15

VentMedic connected to well: 11/17/24 12:02

Continuous monitoring of well flowrate, pressure,
temperature, and methane concentration

Hourly measurement of weather data

VentMedic disconnected from well: 11/18/24 9:42

Notes: Very heavy rain for the majority of the test.

Gas sample delivered to laboratory: 11/27/24

Laboratory Name/Location: Laboratory Services / Hobbs, NM



Pre-Plugging Methane Emissions Monitoring Report

Jennifer Chaveroo #005

Measurement data

Wellhead pressure (kPa gage)*: less than detection limit (<10 kPa)

Average flow rate (L/min): 0.025

Average methane mass flow rate (g/hr)

using methane % from lab analysis: 0.00

using methane % from sensor in unit: 0.00

Methane mass flowrate calculation

Variable	Unit	Value
Pressure (P)	kPaA	Measured from the Unit
Volumetric flow (V)	L gas/min	Measured from the Unit
% methane	% (methane/gas)	Measured from Unit or sample
Temperature (T)	Kelvin	Measured from the Unit
Gas constant (R)	Atmosphere·L/(mole·Kelvin)	0.0821
Molecular weight of methane (Mw)	g/mole	16.04

$$\text{Mass flow of methane } \left(\frac{\text{g}}{\text{hr}} \right) = \frac{\%, \text{methane}}{100\%} * V * P * \frac{Mw}{R T} * \frac{60}{101.3}$$

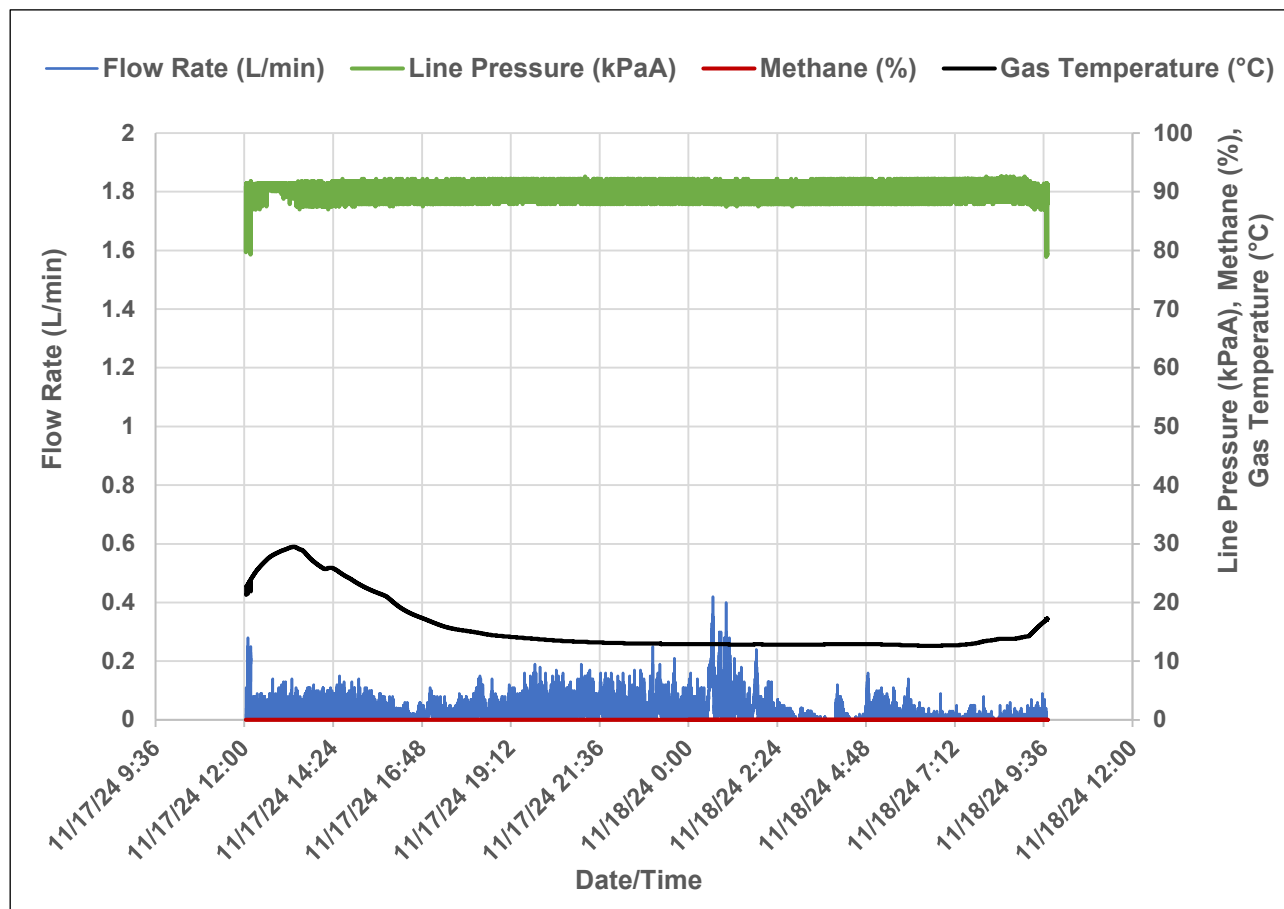



Pre-Plugging Methane Emissions Monitoring Report

Jennifer Chaveroo #005

Weather data

Precipitation during measurement period (in): 1.89

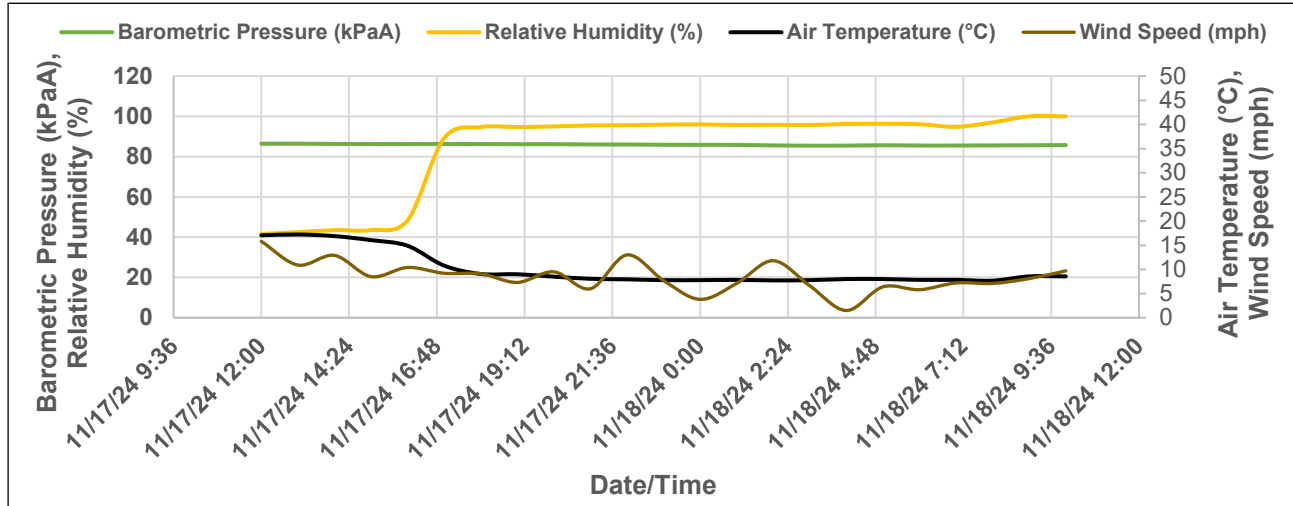

Date and Time	Air Temperature (°C)	Relative Humidity (%)	Barometric Pressure (kPaA)	Wind Speed (mph)
11/17/2024 12:00	17.1	41.6	86.42	15.8
11/17/2024 13:00	17.2	42.5	86.42	10.9
11/17/2024 14:00	16.9	43.5	86.32	12.9
11/17/2024 15:00	16.1	43.5	86.29	8.5
11/17/2024 16:00	14.9	48.4	86.29	10.4
11/17/2024 17:00	10.8	89.2	86.29	9.2
11/17/2024 18:00	9.1	94.7	86.25	9.1
11/17/2024 19:00	9.0	94.7	86.18	7.3
11/17/2024 20:00	8.5	95.0	86.18	9.5
11/17/2024 21:00	8.1	95.5	86.05	6.0
11/17/2024 22:00	7.9	95.6	86.01	13.0
11/17/2024 23:00	7.8	95.9	85.88	7.7
11/18/2024 0:00	7.8	96.0	85.84	3.8
11/18/2024 1:00	7.8	95.7	85.81	7.1
11/18/2024 2:00	7.7	95.8	85.57	11.8
11/18/2024 3:00	7.8	95.7	85.44	6.6
11/18/2024 4:00	8.0	96.2	85.47	1.5
11/18/2024 5:00	8.0	96.3	85.64	6.4
11/18/2024 6:00	7.8	96.1	85.51	5.8
11/18/2024 7:00	7.8	94.8	85.51	7.2
11/18/2024 8:00	7.7	97.0	85.57	7.1
11/18/2024 9:00	8.6	100.0	85.64	8.1
11/18/2024 10:00	8.6	100.0	85.74	9.7



22943G		30-041-10630		Jennifer Chaveroo #005	
Sample Point Code		Sample Point Name		Sample Point Location	
Laboratory Services		2024102059		BAG	
Source Laboratory		Lab File No		Container Identity	
USA		USA		New Mexico	
District		Area Name		Facility Name	
Nov 16, 2024		Nov 1, 2024		Nov 27, 2024 08:54	
Date Sampled		Date Effective		Date Received	
		Luis			
Ambient Temp (°F)		Flow Rate (Mcf)		Press PSI @ Temp °F	
				Source Conditions	
TS-Nano				NG	
Operator				Lab Source Description	

Component	Normalized Mol %	Un-Normalized Mol %	GPM
H2S (H2S)	0.0000	0	
Nitrogen (N2)	99.8950	99.895	
CO2 (CO2)	0.0460	0.04564	
Methane (C1)	0.0000	0	
Ethane (C2)	0.0000	0	0.0000
Propane (C3)	0.0000	0	0.0000
I-Butane (IC4)	0.0000	0	0.0000
N-Butane (NC4)	0.0000	0	0.0000
I-Pentane (IC5)	0.0000	0	0.0000
N-Pentane (NC5)	0.0000	0	0.0000
Hexanes Plus (C6+)	0.0590	0.05932	0.0260
TOTAL	100.0000	100.0000	0.0260

Method(s): Gas C6+ - GPA 2261, Extended Gas - GPA 2286, Calculations - GPA 2172

Analyzer Information			
Device Type:	Gas Chromatograph	Device Make:	Shimadzu
Device Model:	GC-2014	Last Cal Date:	Sep 9, 2024

Gross Heating Values (Real, BTU/ft³)			
14.696 PSI @ 60.00 Å°F		14.73 PSI @ 60.00 Å°F	
Dry	Saturated	Dry	Saturated
3.0	3.9	3.0	3.9

Calculated Total Sample Properties	
GPA2145-16 *Calculated at Contract Conditions	
Relative Density Real	Relative Density Ideal
0.9687	0.9688
Molecular Weight	
28.0592	

C6+ Group Properties		
Assumed Composition		
C6 - 60.000%	C7 - 30.000%	C8 - 10.000%

PROTREND STATUS: Passed By Validator on Dec 4, 2024
DATA SOURCE: Imported
PASSED BY VALIDATOR REASON: First sample taken @ this point, composition looks reasonable
VALIDATOR: Ashley Russell
VALIDATOR COMMENTS: OK



575.397.3713 2609 W Marland Hobbs, NM 88240

Relinquished by Jay Kitowski 		Date: 11.27.24 Time: 10:00 am		Received by:		Phone Result: <input type="checkbox"/> Yes <input type="checkbox"/> No Add'l Phone:	
Relinquished by		Date: Time:		Received by:		Email Result: <input type="checkbox"/> Yes <input type="checkbox"/> No	
Deliver by: (circle one) Sampler - UPS - Bus - other:				Sample Condition Cool Intact Yes <input type="checkbox"/> Yes <input type="checkbox"/> No <input type="checkbox"/> No <input type="checkbox"/>		Checked by (Initials)	
REMARKS:							

Sante Fe Main Office
Phone: (505) 476-3441

General Information
Phone: (505) 629-6116

Online Phone Directory
<https://www.emnrd.nm.gov/ocd/contact-us>

State of New Mexico
Energy, Minerals and Natural Resources
Oil Conservation Division
1220 S. St Francis Dr.
Santa Fe, NM 87505

DEFINITIONS

Action 418586

DEFINITIONS

Operator: RIDGEWAY ARIZONA OIL CORP. 575 N. Dairy Ashford Houston, TX 77079	OGRID: 164557
	Action Number: 418586
	Action Type: [UF-OMA] Pre-Plug Methane Monitoring (UF-OMA-MMA)

DEFINITIONS

The Orphan Well Mitigation Activity (OMA) forms are a subset of the OCD's forms exclusively designed for activities related to State of New Mexico's contracted plugging and reclamation activities. Specifically, these forms are used for orphan wells or associated facilities which are in a "Reclamation Fund Approved" status. This status represents wells or facilities where the OCD has acquired a hearing order allowing the OCD to perform plugging or reclamation on wells and associated facilities that no longer have a viable operator to perform the necessary work. These forms are not to be utilized for any other purpose.

Sante Fe Main Office
Phone: (505) 476-3441

General Information
Phone: (505) 629-6116

Online Phone Directory
<https://www.emnrd.nm.gov/ocd/contact-us>

State of New Mexico
Energy, Minerals and Natural Resources
Oil Conservation Division
1220 S. St Francis Dr.
Santa Fe, NM 87505

QUESTIONS

Action 418586

QUESTIONS

Operator: RIDGEWAY ARIZONA OIL CORP. 575 N. Dairy Ashford Houston, TX 77079	OGRID: 164557
	Action Number: 418586
	Action Type: [UF-OMA] Pre-Plug Methane Monitoring (UF-OMA-MMA)

QUESTIONS

Prerequisites	
[OGRID] Well Operator	[164557] RIDGEWAY ARIZONA OIL CORP.
[API] Well Name and Number	[30-041-10630] JENNIFER CHAVEROO SA UNIT #005
Well Status	Active

Monitoring Event Information	
<i>Please answer all the questions in this group.</i>	
Reason For Filing	Pre-Plug Methane Monitoring
Date of monitoring	11/17/2024
Latitude	33.695507
Longitude	-103.49383

Monitoring Event Details	
<i>Please answer all the questions in this group.</i>	
Flow rate in cubic meters per day (m³/day)	0.04
Test duration in hours (hr)	21.7
Average flow temperature in degrees Celsius (°C)	15.8
Average gauge flow pressure in kilopascals (kPag)	4.7
Methane concentration in part per million (ppm)	0
Methane emission rate in grams per hour (g/hr)	0.00
Testing Method	Steady State

Monitoring Contractor	
<i>Please answer all the questions in this group.</i>	
Name of monitoring contractor	TS-Nano, Inc.