

Well Name: RED TANK FED	Well Location: T22S / R32E / SEC 14 / NESW / 32.389055 / -103.6470904	County or Parish/State: LEA / NM
Well Number: 04	Type of Well: OIL WELL	Allottee or Tribe Name:
Lease Number: NMNM77058	Unit or CA Name:	Unit or CA Number:
US Well Number: 3002532528	Operator: EOG RESOURCES INCORPORATED	

Notice of Intent

Sundry ID: 2878590

Type of Submission: Notice of Intent

Date Sundry Submitted: 10/14/2025

Date proposed operation will begin: 10/20/2025

Type of Action: Plug and Abandonment

Time Sundry Submitted: 02:59

Procedure Description: EOG PROPOSES TO PLUG THIS WELL USING THE ATTACHED PROCEDURE. CURRENT AND PROPOSED WELLBORE DIAGRAMS ARE ALSO ATTACHED.

Surface Disturbance

Is any additional surface disturbance proposed?: No

NOI Attachments

Procedure Description

- Red\_Tank\_Federal\_4\_Proposed\_WBD\_20251014145853.pdf
- Red\_Tank\_Federal\_4\_Current\_WBD\_20251014145848.pdf
- Red\_Tank\_Federal\_4\_P\_A\_Wellwork\_\_20251014145842.pdf

Well Name: RED TANK FED

Well Location: T22S / R32E / SEC 14 /  
NESW / 32.389055 / -103.6470904

County or Parish/State: LEA /  
NM

Well Number: 04

Type of Well: OIL WELL

Allottee or Tribe Name:

Lease Number: NMNM77058

Unit or CA Name:

Unit or CA Number:

US Well Number: 3002532528

Operator: EOG RESOURCES  
INCORPORATED

Conditions of Approval

Specialist Review

Red\_Tank\_Fed\_4\_Sundry\_ID\_2878590\_P\_A\_20260125120805.pdf

Operator

I certify that the foregoing is true and correct. Title 18 U.S.C. Section 1001 and Title 43 U.S.C. Section 1212, make it a crime for any person knowingly and willfully to make to any department or agency of the United States any false, fictitious or fraudulent statements or representations as to any matter within its jurisdiction. Electronic submission of Sundry Notices through this system satisfies regulations requiring a

Operator Electronic Signature: KRISTINA AGEE

Signed on: OCT 14, 2025 02:58 PM

Name: EOG RESOURCES INCORPORATED

Title: Senior Regulatory Administrator

Street Address: 5509 Champions Dr.

City: MidlandState: TX

Phone: (432) 686-6996

Email address: KRISTINA\_AGEE@EOGRESOURCES.COM

Field

Representative Name:

Street Address:

City:State:Zip:

Phone:

Email address:

BLM Point of Contact

BLM POC Name: LONG VO

BLM POC Title: Petroleum Engineer

BLM POC Phone: 5759885402

BLM POC Email Address: LVO@BLM.GOV

Disposition: Approved

Disposition Date: 01/25/2026

Signature: Long Vo

Form 3160-5  
(October 2024)

UNITED STATES  
DEPARTMENT OF THE INTERIOR  
BUREAU OF LAND MANAGEMENT

FORM APPROVED  
OMB No. 1004-0220  
Expires: October 31, 2027

**SUNDRY NOTICES AND REPORTS ON WELLS**  
**Do not use this form for proposals to drill or to re-enter an abandoned well. Use Form 3160-3 (APD) for such proposals.**

5. Lease Serial No.	
6. If Indian, Allottee or Tribe Name	
7. If Unit of CA/Agreement, Name and/or No.	
8. Well Name and No.	
9. API Well No.	
10. Field and Pool or Exploratory Area	
11. Country or Parish, State	

**SUBMIT IN TRIPLICATE - Other instructions on page 2**

1. Type of Well	
<input type="checkbox"/> Oil Well	<input type="checkbox"/> Gas Well <input type="checkbox"/> Other
2. Name of Operator	
3a. Address	3b. Phone No. (include area code)
4. Location of Well (Footage, Sec., T.,R.,M., or Survey Description)	

12. CHECK THE APPROPRIATE BOX(ES) TO INDICATE NATURE OF NOTICE, REPORT OR OTHER DATA

TYPE OF SUBMISSION	TYPE OF ACTION				
<input type="checkbox"/> Notice of Intent	<input type="checkbox"/> Acidize	<input type="checkbox"/> Deepen	<input type="checkbox"/> Production (Start/Resume)	<input type="checkbox"/> Water Shut-Off	
<input type="checkbox"/> Subsequent Report	<input type="checkbox"/> Alter Casing	<input type="checkbox"/> Hydraulic Fracturing	<input type="checkbox"/> Reclamation	<input type="checkbox"/> Well Integrity	
<input type="checkbox"/> Final Abandonment Notice	<input type="checkbox"/> Casing Repair	<input type="checkbox"/> New Construction	<input type="checkbox"/> Recomplete	<input type="checkbox"/> Other	
	<input type="checkbox"/> Change Plans	<input type="checkbox"/> Plug and Abandon	<input type="checkbox"/> Temporarily Abandon		
	<input type="checkbox"/> Convert to Injection	<input type="checkbox"/> Plug Back	<input type="checkbox"/> Water Disposal		

13. Describe Proposed or Completed Operation: Clearly state all pertinent details, including estimated starting date of any proposed work and approximate duration thereof. If the proposal is to deepen directionally or recompleate horizontally, give subsurface locations and measured and true vertical depths of all pertinent markers and zones. Attach the Bond under which the work will be perfonned or provide the Bond No. on file with BLM/BIA. Required subsequent reports must be filed within 30 days following completion of the involved operations. If the operation results in a multiple completion or recompleation in a new interval, a Form 3160-4 must be filed once testing has been completed. Final Abandonment Notices must be filed only after all requirements, including reclamation, have been completed and the operator has detennined that the site is ready for final inspection.)

14. I hereby certify that the foregoing is true and correct. Name (Printed/Typed)	Title
Signature	Date

**THE SPACE FOR FEDERAL OR STATE OFFICE USE**

Approved by	Title	Date
Conditions of approval, if any, are attached. Approval of this notice does not warrant or certify that the applicant holds legal or equitable title to those rights in the subject lease which would entitle the applicant to conduct operations thereon.	Office	

Title 18 U.S.C Section 1001 and Title 43 U.S.C Section 1212, make it a crime for any person knowingly and willfully to make to any department or agency of the United States any false, fictitious or fraudulent statements or representations as to any matter within its jurisdiction.

(Instructions on page 2)

## GENERAL INSTRUCTIONS

This form is designed for submitting proposals to perform certain well operations and reports of such operations when completed as indicated on Federal and Indian lands pursuant to applicable Federal law and regulations. Any necessary special instructions concerning the use of this form and the number of copies to be submitted, particularly with regard to local area or regional procedures and practices, are either shown below, will be issued by or may be obtained from the local Federal office.

## SPECIFIC INSTRUCTIONS

*Item 4* - Locations on Federal or Indian land should be described in accordance with Federal requirements. Consult the local Federal office for specific instructions.

*Item 13*: Proposals to abandon a well and subsequent reports of abandonment should include such special information as is required by the local Federal office. In addition, such proposals and reports should include reasons for the abandonment; data on any former or present productive zones or other zones with present significant fluid contents not sealed off by cement or otherwise; depths (top and bottom) and method of placement of cement plugs; mud or other material placed below, between and above plugs; amount, size, method of parting of any casing, liner or tubing pulled and the depth to the top of any tubing left in the hole; method of closing top of well and date well site conditioned for final inspection looking for approval of the abandonment. If the proposal will involve **hydraulic fracturing operations**, you must comply with 43 CFR 3162.3-3, including providing information about the protection of usable water. Operators should provide the best available information about all formations containing water and their depths. This information could include data and interpretation of resistivity logs run on nearby wells. Information may also be obtained from state or tribal regulatory agencies and from local BLM offices.

## NOTICES

The privacy Act of 1974 and the regulation in 43 CFR 2.48(d) provide that you be furnished the following information in connection with information required by this application.

AUTHORITY: 30 U.S.C. 181 et seq., 351 et seq., 25 U.S.C. 396; 43 CFR 3160.

PRINCIPAL PURPOSE: The information is used to: (1) Evaluate, when appropriate, approve applications, and report completion of subsequent well operations, on a Federal or Indian lease; and (2) document for administrative use, information for the management, disposal and use of National Resource lands and resources, such as: (a) evaluating the equipment and procedures to be used during a proposed subsequent well operation and reviewing the completed well operations for compliance with the approved plan; (b) requesting and granting approval to perform those actions covered by 43 CFR 3162.3-2, 3162.3-3, and 3162.3-4; (c) reporting the beginning or resumption of production, as required by 43 CFR 3162.4-1(c) and (d) analyzing future applications to drill or modify operations in light of data obtained and methods used.

ROUTINE USES: Information from the record and/or the record will be transferred to appropriate Federal, State, local or foreign agencies, when relevant to civil, criminal or regulatory investigations or prosecutions in connection with congressional inquiries or to consumer reporting agencies to facilitate collection of debts owed the Government.

EFFECT OF NOT PROVIDING THE INFORMATION: Filing of this notice and report and disclosure of the information is mandatory for those subsequent well operations specified in 43 CFR 3162.3-2, 3162.3-3, 3162.3-4.

The Paperwork Reduction Act of 1995 requires us to inform you that:

The BLM collects this information to evaluate proposed and/or completed subsequent well operations on Federal or Indian oil and gas leases.

Response to this request is mandatory.

The BLM would like you to know that you do not have to respond to this or any other Federal agency-sponsored information collection unless it displays a currently valid OMB control number.

**BURDEN HOURS STATEMENT:** Public reporting burden for this form is estimated to average 8 hours per response, including the time for reviewing instructions, gathering and maintaining data, and completing and reviewing the form. Direct comments regarding the burden estimate or any other aspect of this form to U.S. Department of the Interior, Bureau of Land Management (1004-0137), Bureau Information Collection Clearance Officer (WO-630), 1849 C St., N.W., Mail Stop 401 LS, Washington, D.C. 20240

## Additional Information

### Location of Well

0. SHL: NESW / 1650 FSL / 2135 FWL / TWSP: 22S / RANGE: 32E / SECTION: 14 / LAT: 32.389055 / LONG: -103.6470904 ( TVD: 0 feet, MD: 0 feet )

BHL: NESW / 1650 FSL / 2135 FWL / TWSP: 22S / SECTION: / LAT: 0.0 / LONG: 0.0 ( TVD: 0 feet, MD: 0 feet )

**Well Name:** Red Tank Fed 4  
**Location:** 1650 FSL 2135 FWL  
**County:** Lea, NM  
**Lat/Long:** 32.3890114,-103.6471481 NAD83  
**API #:** 30-025-32528  
**Spud Date:** 5/30/94  
**Compl. Date:** 9/30/94



**Formation Tops**

Top of Salt	1,100
Bottom of Salt	4,500
Delaware	4,850
Cherry Chyn	5,800
Bone Spring	8,730

**Proposed Wellbore Diagram:**

**KB:**  
**GL:** 3731

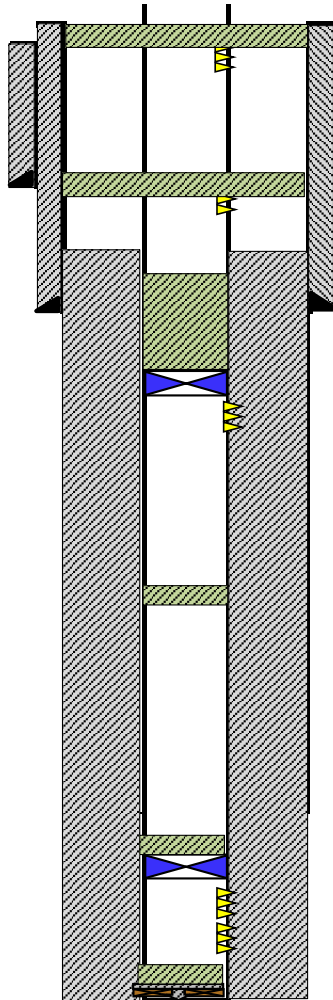
17-1/2" Hole  
 -----  
 13-3/8" 48# H-40 @ 851'  
 Cmt w/ 800 sx Class C (circ) to surface  
 -----  
 12-1/4" Hole  
 Cement to Surface  
 8-5/8" 32# & 28# K-55 to 4550'  
 Cmt w/ 1,600 sx Class C (circ) to surface  
 -----  
 Temp survey TOC 3000  
 -----  
 5-1/2" 17# K55 Prod CSG to 8,900'  
 540 sx Class H cmt 1st stage  
 800 sx class H 2nd stage  
 -----  
 7-7/8" Vertical to 8,900'



Verify cement to surface on annulus and inner  
 Squeeze 15 sxs Class C into annulus  
 Spot 10 sxs Class C cement  
 Perf @ 100'

This will cover top of salt and surface shoe  
 Squeeze 45 sxs class c cement inside csg to 700'  
 Squeeze 63 sxs class C up annulus to 700'  
 Perf @ 1,150'

**Not to Scale**

By: CC 10/14/25

WOC & Tag  
 Covers Delaware, bottom of salt, int shoe  
 Spot 80 sxs Class C cement to 4,100'  
 Test CIBP to 500 psi  
 Set CIBP @ 4,900  
 Perf @ 4,929' to 4,948'

WOC & tag ~5,597'  
 This will cover Cherry Canyon  
 Spot 25 sxs class c cement @ 5,850'

WOC & Tag  
 Spot 25 sxs class H cement on top to 8,197'  
 Set CIBP @ 8,424'

perforated 8,474'-8,588'  
 200 Holes  
 This will cover Bonespring formation  
 Spot or dump ball 25 sxs class H cement @ 8,757'  
 Pushed a cement retainer to 8,757'

**Well Name:** Red Tank Fed 4  
**Location:** 1650 FSL 2135 FWL  
**County:** Lea, NM  
**Lat/Long:** 32.3890114,-103.6471481 NAD83  
**API #:** 30-025-32528  
**Spud Date:** 5/30/94  
**Compl. Date:** 9/30/94

**Formation Tops**

Top of Salt	1,100
Bottom of Salt	4,500
Delaware	4,850
Cherry Chyn	5,800
Bone Spring	8,730

**Current Wellbore Diagram:**

**KB:**  
**GL:** 3731

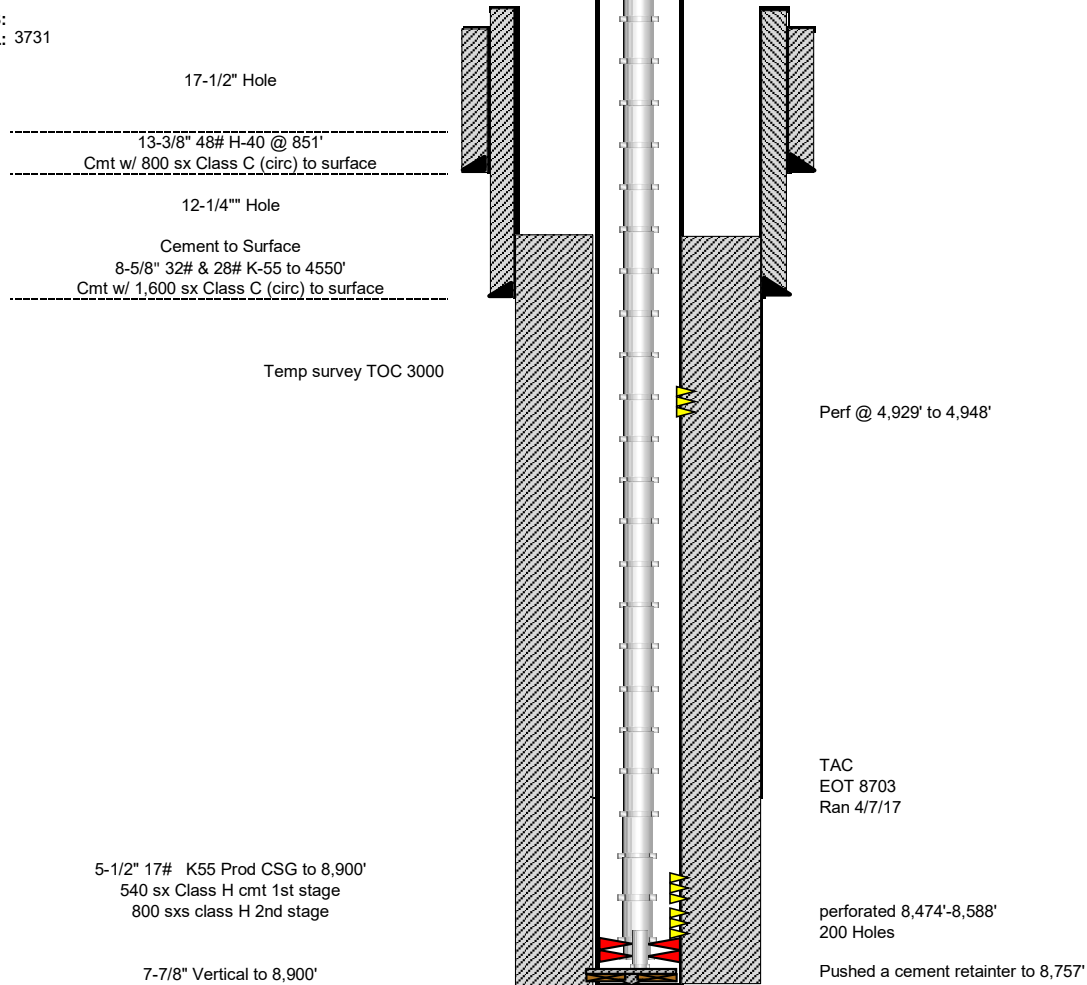
**Not to Scale**

By: CC 10/14/25



Red Tank Federal 4 P&A  
Capital AFE#

Well Name	Red Tank Federal 4 P&A				
Surface Location	32.3890114,-103.6471481 NAD83			AFE/Sub Code	/231
RKB – Sea Level		Area/Field	Red Tank	Spud Date	5/30/94
G.L. Elevation	3731	County/Province	Lea	Original Rig Contractor	-
API	30-025-32528	State / Country	NM	Formation	
Comp Date	9/30/94	Total MD	8,900'	Top Perf	4,929'
KOP	-	Average Lateral TVD	-	Wellhead MFG	-

STRING NAME	STRING OD	STRING WEIGHT	DESCRIPTION	FINAL DEPTH
SURFACE	13.325	48	13-3/8 H40	851
INTERMEDIATE	8.625	32 & 28	8-5/8 K-55	4550
PRODUCTION	5.5	17	5 1/2 K55	8900

**Summary of Procedure:** Release TAC & Pull TBG, Set CIBP, Run CBL/GYRO & Cement, Run CIBP, Pump Cement Plugs, Abandon

**PROCEDURE:**

1. Notify state 24 hours before beginning work.
2. MIRU & Kill well.
3. ND/NU WH/BOP
4. Release TAC
5. TOOH Entire string of 2-7/8” Production TBG while scanning to use as workstring. We will need at least 100’ more of workstring if all tbg is good.
6. TIH & spot or dump bail 25 sxs class H cement on top of the drilled up and pushed down retainer @ 8,757’. Perfs are above. This will cover bone springs. WOC & Tag.
7. TOOH
8. RIH & set CIBP @ 8,424’. Spot 25 sxs Class H cement on top to 8,197’
9. POOH & run gyro/cbl tandem from ~8000’, stay away from cement
- 10.TIH Tag TOC
- 11.TOOH T/5,850’. Pump balance plug of 25 sxs class C cement to 5,597’ to cover cherry canyon
- 12.TOOH
- 13.RIH Tag TOC, Set CIBP @ 4,900’ – 24’ above top perf. Test csg to 500 psi.
- 14.POOH
- 15.TIH & spot 80 sxs class C cement on top of CIBP to 4,100’. This will cover the Delaware, Bottom of Salt, Int. Shoe
- 16.TOOH
- 17.RIH & tag TOC
- 18.Perf @ 1150’.
- 19.POOH





- 
- 20.TIH w/ packer & squeeze 108 sxs class c cement to 700'. This will cover top of salt and surface shoe.
  - 21.TOOH
  - 22.RIH & perf @ 100.
  - 23.TIH w/ packer and squeeze 25 sxs class c cement to surface.
  - 24.Dig out cellar, cut off wellhead and verify cement behind all casing strings.
  - 25.Install dry hole marker, clean location and RDMO.

Production Engineer:  Date: 10/14/25  
Chris Caskey

Well Name: RED TANK FED	Well Location: T22S / R32E / SEC 14 / NESW / 32.389055 / -103.6470904	County or Parish/State: LEA / NM
Well Number: 04	Type of Well: OIL WELL	Allottee or Tribe Name:
Lease Number: NMNM77058	Unit or CA Name:	Unit or CA Number:
US Well Number: 3002532528	Operator: EOG RESOURCES INCORPORATED	

Notice of Intent

Sundry ID: 2878590

Type of Submission: Notice of Intent

Date Sundry Submitted: 10/14/2025

Date proposed operation will begin: 10/20/2025

Type of Action: Plug and Abandonment

Time Sundry Submitted: 02:59

Procedure Description: EOG PROPOSES TO PLUG THIS WELL USING THE ATTACHED PROCEDURE. CURRENT AND PROPOSED WELLBORE DIAGRAMS ARE ALSO ATTACHED.

Surface Disturbance

Is any additional surface disturbance proposed?: No

APPROVAL SUBJECT TO  
GENERAL REQUIREMENTS AND  
SPECIAL STIPULATIONS  
ATTACHED

NOI Attachments

Procedure Description

- Red\_Tank\_Federal\_4\_Proposed\_WBD\_20251014145853.pdf
- Red\_Tank\_Federal\_4\_Current\_WBD\_20251014145848.pdf
- Red\_Tank\_Federal\_4\_P\_A\_Wellwork\_\_20251014145842.pdf

Well Name: RED TANK FED	Well Location: T22S / R32E / SEC 14 / NESW / 32.389055 / -103.6470904	County or Parish/State: LEA / NM
Well Number: 04	Type of Well: OIL WELL	Allottee or Tribe Name:
Lease Number: NMNM77058	Unit or CA Name:	Unit or CA Number:
US Well Number: 3002532528	Operator: EOG RESOURCES INCORPORATED	

Operator

I certify that the foregoing is true and correct. Title 18 U.S.C. Section 1001 and Title 43 U.S.C. Section 1212, make it a crime for any person knowingly and willfully to make to any department or agency of the United States any false, fictitious or fraudulent statements or representations as to any matter within its jurisdiction. Electronic submission of Sundry Notices through this system satisfies regulations requiring a

Operator Electronic Signature: KRISTINA AGEE  
Signed on: OCT 14, 2025 02:58 PM  
Name: EOG RESOURCES INCORPORATED  
Title: Senior Regulatory Administrator  
Street Address: 5509 Champions Dr.  
City: Midland State: TX  
Phone: (432) 686-6996  
Email address: KRISTINA\_AGEE@EOGRESOURCES.COM

Field

Representative Name:  
Street Address:  
City: State: Zip:  
Phone:  
Email address:

APPROVED by Long Vo  
Petroleum Engineer  
Carlsbad Field Office  
575-988-50402  
LVO@BLM.GOV

Lea County Notification: 575-689-5981

Eddy County Notification: [BLM NM CFO PluggingNotifications@BLM.GOV](mailto:BLM_NM_CFO_PluggingNotifications@BLM.GOV)

Secondary Contact: 575-361-2822

Form 3160-5  
(October 2024)

UNITED STATES  
DEPARTMENT OF THE INTERIOR  
BUREAU OF LAND MANAGEMENT

FORM APPROVED  
OMB No. 1004-0220  
Expires: October 31, 2027

**SUNDRY NOTICES AND REPORTS ON WELLS**  
**Do not use this form for proposals to drill or to re-enter an abandoned well. Use Form 3160-3 (APD) for such proposals.**

5. Lease Serial No.	
6. If Indian, Allottee or Tribe Name	
7. If Unit of CA/Agreement, Name and/or No.	
8. Well Name and No.	
9. API Well No.	
10. Field and Pool or Exploratory Area	
11. Country or Parish, State	

**SUBMIT IN TRIPLICATE - Other instructions on page 2**

1. Type of Well		
<input type="checkbox"/> Oil Well	<input type="checkbox"/> Gas Well	<input type="checkbox"/> Other
2. Name of Operator		
3a. Address	3b. Phone No. (include area code)	
4. Location of Well (Footage, Sec., T.,R.,M., or Survey Description)		

12. CHECK THE APPROPRIATE BOX(ES) TO INDICATE NATURE OF NOTICE, REPORT OR OTHER DATA

TYPE OF SUBMISSION	TYPE OF ACTION				
<input type="checkbox"/> Notice of Intent	<input type="checkbox"/> Acidize	<input type="checkbox"/> Deepen	<input type="checkbox"/> Production (Start/Resume)	<input type="checkbox"/> Water Shut-Off	
<input type="checkbox"/> Subsequent Report	<input type="checkbox"/> Alter Casing	<input type="checkbox"/> Hydraulic Fracturing	<input type="checkbox"/> Reclamation	<input type="checkbox"/> Well Integrity	
<input type="checkbox"/> Final Abandonment Notice	<input type="checkbox"/> Casing Repair	<input type="checkbox"/> New Construction	<input type="checkbox"/> Recomplete	<input type="checkbox"/> Other	
	<input type="checkbox"/> Change Plans	<input type="checkbox"/> Plug and Abandon	<input type="checkbox"/> Temporarily Abandon		
	<input type="checkbox"/> Convert to Injection	<input type="checkbox"/> Plug Back	<input type="checkbox"/> Water Disposal		

13. Describe Proposed or Completed Operation: Clearly state all pertinent details, including estimated starting date of any proposed work and approximate duration thereof. If the proposal is to deepen directionally or recompleate horizontally, give subsurface locations and measured and true vertical depths of all pertinent markers and zones. Attach the Bond under which the work will be perfonned or provide the Bond No. on file with BLM/BIA. Required subsequent reports must be filed within 30 days following completion of the involved operations. If the operation results in a multiple completion or recompletion in a new interval, a Form 3160-4 must be filed once testing has been completed. Final Abandonment Notices must be filed only after all requirements, including reclamation, have been completed and the operator has detennined that the site is ready for final inspection.)

14. I hereby certify that the foregoing is true and correct. Name (Printed/Typed)	Title
Signature	Date

**THE SPACE FOR FEDERAL OR STATE OFFICE USE**

Approved by	<b>Long Vo</b>		Title	<b>Petroleum Engineer</b>	Date	1-25-2026
Conditions of approval, if any, are attached. Approval of this notice does not warrant or certify that the applicant holds legal or equitable title to those rights in the subject lease which would entitle the applicant to conduct operations thereon.			Office	<b>Carlsbad Field Office</b>		

Title 18 U.S.C Section 1001 and Title 43 U.S.C Section 1212, make it a crime for any person knowingly and willfully to make to any department or agency of the United States any false, fictitious or fraudulent statements or representations as to any matter within its jurisdiction.

(Instructions on page 2)

## GENERAL INSTRUCTIONS

This form is designed for submitting proposals to perform certain well operations and reports of such operations when completed as indicated on Federal and Indian lands pursuant to applicable Federal law and regulations. Any necessary special instructions concerning the use of this form and the number of copies to be submitted, particularly with regard to local area or regional procedures and practices, are either shown below, will be issued by or may be obtained from the local Federal office.

## SPECIFIC INSTRUCTIONS

*Item 4* - Locations on Federal or Indian land should be described in accordance with Federal requirements. Consult the local Federal office for specific instructions.

*Item 13*: Proposals to abandon a well and subsequent reports of abandonment should include such special information as is required by the local Federal office. In addition, such proposals and reports should include reasons for the abandonment; data on any former or present productive zones or other zones with present significant fluid contents not sealed off by cement or otherwise; depths (top and bottom) and method of placement of cement plugs; mud or other material placed below, between and above plugs; amount, size, method of parting of any casing, liner or tubing pulled and the depth to the top of any tubing left in the hole; method of closing top of well and date well site conditioned for final inspection looking for approval of the abandonment. If the proposal will involve **hydraulic fracturing operations**, you must comply with 43 CFR 3162.3-3, including providing information about the protection of usable water. Operators should provide the best available information about all formations containing water and their depths. This information could include data and interpretation of resistivity logs run on nearby wells. Information may also be obtained from state or tribal regulatory agencies and from local BLM offices.

## NOTICES

The privacy Act of 1974 and the regulation in 43 CFR 2.48(d) provide that you be furnished the following information in connection with information required by this application.

AUTHORITY: 30 U.S.C. 181 et seq., 351 et seq., 25 U.S.C. 396; 43 CFR 3160.

PRINCIPAL PURPOSE: The information is used to: (1) Evaluate, when appropriate, approve applications, and report completion of subsequent well operations, on a Federal or Indian lease; and (2) document for administrative use, information for the management, disposal and use of National Resource lands and resources, such as: (a) evaluating the equipment and procedures to be used during a proposed subsequent well operation and reviewing the completed well operations for compliance with the approved plan; (b) requesting and granting approval to perform those actions covered by 43 CFR 3162.3-2, 3162.3-3, and 3162.3-4; (c) reporting the beginning or resumption of production, as required by 43 CFR 3162.4-1(c) and (d) analyzing future applications to drill or modify operations in light of data obtained and methods used.

ROUTINE USES: Information from the record and/or the record will be transferred to appropriate Federal, State, local or foreign agencies, when relevant to civil, criminal or regulatory investigations or prosecutions in connection with congressional inquiries or to consumer reporting agencies to facilitate collection of debts owed the Government.

EFFECT OF NOT PROVIDING THE INFORMATION: Filing of this notice and report and disclosure of the information is mandatory for those subsequent well operations specified in 43 CFR 3162.3-2, 3162.3-3, 3162.3-4.

The Paperwork Reduction Act of 1995 requires us to inform you that:

The BLM collects this information to evaluate proposed and/or completed subsequent well operations on Federal or Indian oil and gas leases.

Response to this request is mandatory.

The BLM would like you to know that you do not have to respond to this or any other Federal agency-sponsored information collection unless it displays a currently valid OMB control number.

**BURDEN HOURS STATEMENT:** Public reporting burden for this form is estimated to average 8 hours per response, including the time for reviewing instructions, gathering and maintaining data, and completing and reviewing the form. Direct comments regarding the burden estimate or any other aspect of this form to U.S. Department of the Interior, Bureau of Land Management (1004-0137), Bureau Information Collection Clearance Officer (WO-630), 1849 C St., N.W., Mail Stop 401 LS, Washington, D.C. 20240

## **Additional Information**

### **Location of Well**

0. SHL: NESW / 1650 FSL / 2135 FWL / TWSP: 22S / RANGE: 32E / SECTION: 14 / LAT: 32.389055 / LONG: -103.6470904 ( TVD: 0 feet, MD: 0 feet )

BHL: NESW / 1650 FSL / 2135 FWL / TWSP: 22S / SECTION: / LAT: 0.0 / LONG: 0.0 ( TVD: 0 feet, MD: 0 feet )

**Well Name:** Red Tank Fed 4  
**Location:** 1650 FSL 2135 FWL  
**County:** Lea, NM  
**Lat/Long:** 32.3890114,-103.6471481 NAD83  
**API #:** 30-025-32528  
**Spud Date:** 5/30/94  
**Compl. Date:** 9/30/94



Formation Tops	
Top of Salt	1,100
Bottom of Salt	4,500
Delaware	4,850
Cherry Chyn	5,800
Bone Spring	8,730

**Proposed Wellbore Diagram:**

**KB:**  
**GL:** 3731

17-1/2" Hole  
-----  
13-3/8" 48# H-40 @ 851'  
Cmt w/ 800 sx Class C (circ) to surface  
-----  
12-1/4" Hole  
Cement to Surface  
8-5/8" 32# & 28# K-55 to 4550'  
Cmt w/ 1,600 sx Class C (circ) to surface  
-----

Temp survey TOC 3000

5-1/2" 17# K55 Prod CSG to 8,900'  
540 sx Class H cmt 1st stage  
800 sx class H 2nd stage

7-7/8" Vertical to 8,900'

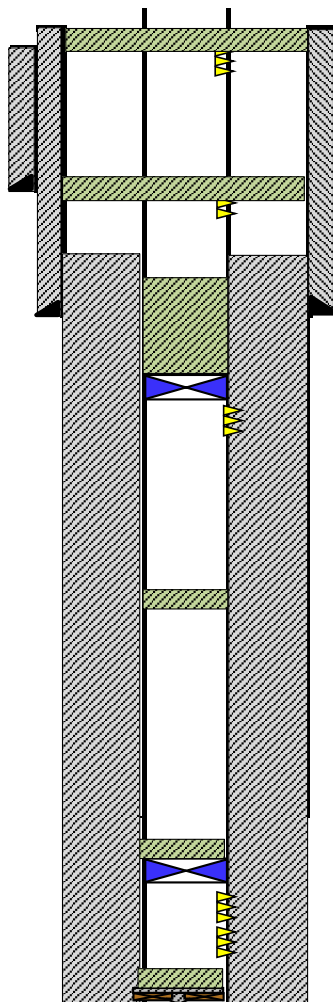

Verify cement to surface on annulus and inner  
Squeeze 15 sxs Class C into annulus  
Spot 10 sxs Class C cement  
Perf @ 100'

This will cover top of salt and surface shoe  
Squeeze 51 sxs class c cement inside csg to 772'  
Squeeze 70 sxs class C up annulus to 772'  
Perf @ 1285'

**Not to Scale**  
By: CC 10/14/25

WOC & Tag  
Covers Delaware, bottom of salt, int shoe  
Spot 80 sxs Class C cement to 4284'  
Test CIBP to 500 psi  
Set CIBP @ 4,879  
Perf @ 4,929' to 4,948'

WOC & tag ~5441'  
This will cover Cherry Canyon  
Spot 25 sxs class c cement @ 5,441'

\*Run CBL from CIBP to surface.

Submit results to BLM.

WOC & Tag  
Spot 25 sxs class H cement on top to 8,221'  
Set CIBP @ 8,424'

perforated 8,474'-8,588'  
200 Holes  
This will cover Bonespring formation  
Spot or dump bail 25 sxs class H cement @ 8,757'  
Pushed a cement retainer to 8,757' WOC and Tag  
at 8588'.

**REVISED**

12:08 pm, Jan 25, 2026

**Well Name:** Red Tank Fed 4  
**Location:** 1650 FSL 2135 FWL  
**County:** Lea, NM  
**Lat/Long:** 32.3890114,-103.6471481 NAD83  
**API #:** 30-025-32528  
**Spud Date:** 5/30/94  
**Compl. Date:** 9/30/94

**Formation Tops**

Top of Salt	1,100
Bottom of Salt	4,500
Delaware	4,850
Cherry Chyn	5,800
Bone Spring	8,730

**Current Wellbore Diagram:**

**KB:**  
**GL:** 3731

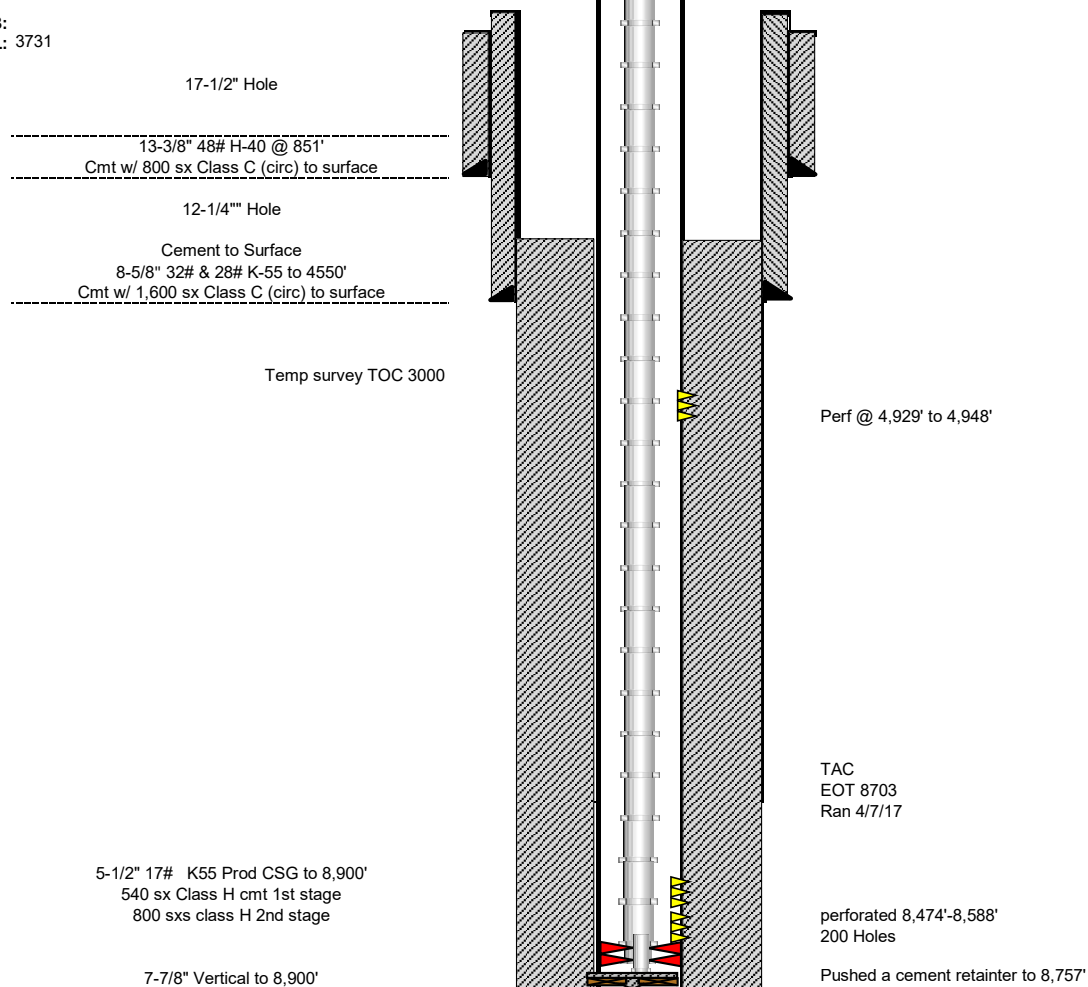
**Not to Scale**

By: CC 10/14/25





Red Tank Federal 4 P&A  
Capital AFE#

Well Name	Red Tank Federal 4 P&A				
Surface Location	32.3890114,-103.6471481 NAD83			AFE/Sub Code	/231
RKB – Sea Level		Area/Field	Red Tank	Spud Date	5/30/94
G.L. Elevation	3731	County/Province	Lea	Original Rig Contractor	-
API	30-025-32528	State / Country	NM	Formation	
Comp Date	9/30/94	Total MD	8,900'	Top Perf	4,929'
KOP	-	Average Lateral TVD	-	Wellhead MFG	-

STRING NAME	STRING OD	STRING WEIGHT	DESCRIPTION	FINAL DEPTH
SURFACE	13.325	48	13-3/8 H40	851
INTERMEDIATE	8.625	32 & 28	8-5/8 K-55	4550
PRODUCTION	5.5	17	5 1/2 K55	8900

**Summary of Procedure:** Release TAC & Pull TBG, Set CIBP, Run CBL/GYRO & Cement, Run CIBP, Pump Cement Plugs, Abandon

**PROCEDURE:**

1. Notify state 24 hours before beginning work.
2. MIRU & Kill well.
3. ND/NU WH/BOP
4. Release TAC
5. TOOH Entire string of 2-7/8” Production TBG while scanning to use as workstring. We will need at least 100’ more of workstring if all tbg is good.
6. TIH & spot or dump bail 25 sxs class H cement on top of the drilled up and pushed down retainer @ 8,757’. Perfs are above. This will cover bone springs. WOC & Tag at 8588.
7. TOOH
8. RIH & set CIBP @ 8,424’. Spot 25 sxs Class H cement on top to 8,221’
9. POOH & run gyro/cbl tandem from ~8000’, stay away from cement
- 10.TIH Tag TOC at 8221'
- 11.TOOH T/5,597’. Pump balance plug of 25 sxs class C cement to 5,441’ to cover cherry canyon
- 12.TOOH
- 13.RIH Tag TOC 5441', Set CIBP @ 4879’ – 50’ above top perf. Test csg to 500 psi.
- 14.POOH
- 15.TIH & spot 80 sxs class C cement on top of CIBP to 4,284’. This will cover the Delaware, Bottom of Salt, Int. Shoe
- 16.TOOH
- 17.RIH & tag TOC 4284'
- 18.Perf @ 1285’.
- 19.POOH

REVISED  
12:08 pm, Jan 25, 2026



- 20.TIH w/ packer & squeeze 121 sxs class c cement to 772'. This will cover top of salt and surface shoe. WOC and Tag at 772'.
- 21.TOOH
- 22.RIH & perf @ 100.
- 23.Circulate 25 sxs class c cement to surface.
- 24.Dig out cellar, cut off wellhead and verify cement behind all casing strings.
- 25.Install dry hole marker, clean location and RDMO.

**REVISED**  
12:08 pm, Jan 25, 2026

Production Engineer:  Date: 10/14/25  
Chris Caskey

**Lesser Prairie Chicken Area**

**BUREAU OF LAND MANAGEMENT  
Carlsbad Field Office  
620 East Greene Street  
Carlsbad, New Mexico 88220  
575-234-5972**

**Permanent Abandonment of Federal Wells  
Conditions of Approval**

Failure to comply with the following Conditions of Approval may result in a Notice of Incidents of Noncompliance (INC) in accordance with 43 CFR 3163.1.

Plugging operations shall commence within **ninety (90)** days from the approval date of this Notice of Intent to Abandon.

**If you are unable to plug the well by the 90<sup>th</sup> day provide this office, prior to the 90<sup>th</sup> day, with the reason for not meeting the deadline and a date when we can expect the well to be plugged. Failure to do so will result in enforcement action.**

**The rig used for the plugging procedure cannot be released and moved off without the prior approval of the authorized officer. Failure to do so may result in enforcement action.**

**Notification: Contact the appropriate BLM office at least 24 hours prior to the commencing of any plugging operations. For wells in Chaves and Roosevelt County, call 575-627-0272; Lea County, call 575-689-5981. Eddy County, please email notifications to: [BLM NM CFO PluggingNotifications@BLM.GOV](mailto:BLM_NM_CFO_PluggingNotifications@BLM.GOV). The Eddy County inspector on call phone, 575-361-2822, will remain active as a secondary contact.**

**Blowout Preventers:** A blowout preventer (BOP), as appropriate, shall be installed before commencing any plugging operation. The BOP must be installed and maintained as per API and manufacturer recommendations. The minimum BOP requirement is a 2M system for a well not deeper than 9,090 feet; a 3M system for a well not deeper than 13,636 feet; and a 5M system for a well not deeper than 22,727 feet.

**Mud Requirement:** Mud shall be placed between all plugs. Minimum consistency of plugging mud shall be obtained by mixing at the rate of 25 sacks (50 pounds each) of gel per 100 barrels of water. Minimum nine (9) pounds per gallon.

**Cement Requirement:** Sufficient cement shall be used to bring any required plug to the specified depth and length. Any given cement volumes on the proposed plugging procedure are merely estimates and are not final. Unless specific approval is received, no plug except the surface plug shall be less than 25 sacks of cement. Any plug that requires a tag will have a minimum WOC time of 4 hours for Class C or accelerated cement (calcium chloride) and 6 hours for Class H. Tagging the plug means running in the hole with a string of tubing or drill pipe and placing sufficient weight on the plug to ensure its integrity. Other methods of tagging the plug may be approved by the BLM authorized officer or BLM field representative.

In lieu of a cement plug across perforations in a cased hole (not for any other plugs), a bridge plug set within 50 feet to 100 feet above the perforations shall be capped with 25 sacks of cement. If a bailer is used to cap this plug, 35 feet of cement shall be sufficient. **Before pumping or bailing cement on top of CIBP, tag will be required to verify depth. Based on depth, a tag of the cement may be deemed necessary.**

Unless otherwise specified in the approved procedure, the cement plug shall consist of either Neat Class "C", for up to 7,500 feet of depth or Neat Class "H", for deeper than 7,500 feet plugs.

Fluid used to mix the cement in R111Q shall be saturated with the salts common to the section penetrated, and in suitable proportions but not less than 1% and not more than 3% calcium chloride by weight of cement will be considered the desired mixture whenever possible.

Above Ground Level Marker: If outside of Lesser Prairie-Chicken Habitat an above ground level marker shall be utilized. All casing shall be cut-off at the base of the cellar or 3 feet below final restored ground level (whichever is deeper). **The BLM is to be notified *BY PHONE* (numbers listed in 2. Notifications) a minimum of 4 hours prior to the wellhead being cut off to verify that cement is to surface in the casing and all annuluses. Wellhead cut off shall commence within fourteen (14) calendar days of the well being plugged. If the cut off cannot be done by the 14<sup>th</sup> day, the BLM is to be contacted with justification to receive an extension for completing the cut off.**

The well bore shall then be capped with a 4-inch pipe, 10-feet in length, 4 feet above ground and embedded in cement, unless otherwise noted in COA (requirements will be attached). The following information shall be permanently inscribed on the dry hole marker: well name and number, name of the operator, lease serial number, surveyed location (quarter-quarter section, section, township and range or other authorized survey designation acceptable to the authorized officer such as metes and bounds). A weep hole shall be left if a metal plate is welded in place.

Below Ground Level Marker: If within Lesser Prairie-Chicken Habitat a below ground level marker shall be utilized. All casing shall be cut-off at the base of the cellar or 3 feet below final restored ground level (whichever is deeper). **The BLM is to be notified *BY PHONE* (numbers listed in 2. Notifications) a minimum of 4 hours prior to the wellhead being cut off to verify that cement is to surface in the casing and all annuluses. Wellhead cut off shall commence within fourteen (14) calendar days of the well being plugged. If the cut off cannot be done by the 14<sup>th</sup> day, the BLM is to be contacted with justification to receive an extension for completing the cut off.**

Upon the plugging and subsequent abandonment of wells that are located in lesser prairie-chicken habitat, the casings shall be cut-off at the base of the cellar or 3 feet below final restored ground level (whichever is deeper). The well bore shall then be covered with a metal plate at least ¼ inch thick and welded in place. A weep hole shall be left in the plate and/or casing. The following information shall be permanently inscribed on the plate: well name and number, name of operator, lease serial number, surveyed location (quarter-quarter section, section, township and range or other authorized survey designation acceptable to the authorized officer such as metes and bounds).

NMOCD also requires the operator to notify NMOCD when this type of dry hole marker is used. This can be done on the subsequent report of abandonment which is submitted to the BLM after the well is plugged. State that a below ground cap was installed as required in the COA's from the BLM.

Operator to verify the ground marker type with the BLM before setting dry hole Marker.

**Subsequent Plugging Reporting:** Within 30 days after plugging work is completed, file via the AFMSS 2 WISx Module a Subsequent Report of Plugging and Abandonment to BLM. Please include the following information:

- The report should give in detail the manner in which the plugging work was carried out, the Extent (by depths) of cement plugs placed, and the size and location (by depths) of casing left In the well.
- The final copy of CBL.
- Any email correspondence regarding changes to originally approved procedure.
- Show date well was plugged.

**Trash:** All trash, junk and other waste material shall be contained in trash cages or bins to prevent scattering and will be removed and deposited in an approved sanitary landfill. Burial on site is not permitted.

Following the submission and approval of the Subsequent Report of Abandonment, surface restoration will be required. See attached reclamation objectives.

**Timing Limitation Stipulation/ Condition of Approval for Lesser Prairie-Chicken:**

From March 1<sup>st</sup> through June 15<sup>th</sup> annually, abandonment activities will be allowed except between the hours from 3:00 am and 9:00 am. Normal vehicle use on existing roads will not be restricted.



# United States Department of the Interior

## BUREAU OF LAND MANAGEMENT

Carlsbad Field Office  
620 E. Greene St.  
Carlsbad, New Mexico 88220-6292  
[www.blm.gov/nm](http://www.blm.gov/nm)



In Reply Refer To: 1310

### Reclamation Objectives and Procedures

**Reclamation Objective:** Oil and gas development is one of many uses of the public lands and resources. While development may have a short- or long-term effect on the land, successful reclamation can ensure the effect is not permanent. During the life of the development, all disturbed areas not needed for active support of production operations should undergo “interim” reclamation in order to minimize the environmental impacts of development on other resources and uses. At final abandonment, well locations, production facilities, and access roads must undergo “final” reclamation so that the character and productivity of the land and water are restored.

The long-term objective of final reclamation is to set the course for eventual ecosystem restoration, including the restoration of the natural vegetation community, hydrology, and wildlife habitats. In most cases this means returning the land to a condition approximating or equal to that which existed prior to the disturbance. The final goal of reclamation is to restore the character of the land and water to its pre-disturbance condition. The operator is generally not responsible for achieving full ecological restoration of the site. Instead, the operator must achieve the short-term stability, visual, hydrological, and productivity objectives of the surface management agency and take steps necessary to ensure that long-term objectives will be reached through natural processes.

To achieve these objectives, remove any/all contaminants, scrap/trash, equipment, pipelines and powerlines **(Contact service companies, allowing plenty of time to have the risers and power lines and poles removed prior to reclamation, don't wait till the last day and try to get them to remove infrastructure)**. Strip and remove caliche, contour the location to blend with the surrounding landscape, re-distribute the native soils, provide erosion control as needed, rip (across the slope and seed as specified in the original APD COA. **This will apply to well pads, facilities, and access roads.** Barricade access road at the starting point. If reserve pits have not reclaimed due to salts or other contaminants, submit a plan for approval, as to how you propose to provide adequate restoration of the pit area.

The Application for Permit to Drill or Reenter (APD, Form 3160-3), Surface Use Plan of Operations must include adequate measures for stabilization and reclamation of disturbed lands. Oil and Gas operators must plan for reclamation, both interim and final, up front in the APD process as per Onshore Oil and Gas Order No. 1.

For wells and/or access roads not having an approved plan, or an inadequate plan for surface reclamation (either interim or final reclamation), the operator must submit a proposal describing the procedures for reclamation. For interim reclamation, the appropriate time for submittal would be when filing the Well Completion or Recompletion Report and Log (Form 3160-4). For final reclamation, the appropriate time for submittal would be when filing the Notice of Intent, or the Subsequent Report of Abandonment, Sundry Notices and Reports on Wells (Form 3160-5). Interim reclamation is to be completed within 6 months of well completion, and final reclamation is to be completed within 6 months of well abandonment.

The operator must file a Subsequent Report Plug and Abandonment (Form 3160-5) following the plugging of a well.

Previous instruction had you waiting for a BLM specialist to inspect the location and provide you with reclamation requirements. If you have an approved Surface Use Plan of Operation and/or an approved Sundry Notice, you are free to proceed with reclamation as per approved APD. If you have issues or concerns, contact a BLM specialist to assist you. It would be in your interest to have a BLM specialist look at the location and

access road prior to the removal of reclamation equipment to ensure that it meets BLM objectives. Upon conclusion submit a Form 3160-5, Subsequent Report of Reclamation. This will prompt a specialist to inspect the location to verify work was completed as per approved plans.

The approved Subsequent Report of Reclamation will be your notice that the native soils, contour and seedbed have been reestablished. If the BLM objectives have not been met the operator will be notified and corrective actions may be required.

It is the responsibility of the operator to monitor these locations and/or access roads until such time as the operator feels that the BLM objective has been met. If after two growing seasons the location and/or access roads are not showing the potential for successful revegetation, additional actions may be needed. When you feel the BLM objectives have been met submit a Final Abandonment Notice (FAN), Form 3160-5, stating that all reclamation requirements have been achieved and the location and/or access road is ready for a final abandonment inspection.

At this time the BLM specialist will inspect the location and/or access road. If the native soils and contour have been restored, and the revegetation is successful, the FAN will be approved, releasing the operator of any further liability of the location and/or access road. If the location and/or access road have not achieved the objective, you will be notified as to additional work needed or additional time being needed to achieve the objective.

If there are any questions, please feel free to contact any of the following specialists:

Jim Amos  
Supervisory Petroleum Engineering Tech/Environmental Protection Specialist  
575-234-5909 (Office), 575-361-2648 (Cell)

Arthur Arias  
Environmental Protection Specialist  
575-234-6230

Crisha Morgan  
Environmental Protection Specialist  
575-234-5987

Jose Martinez-Colon  
Environmental Protection Specialist  
575-234-5951

Angela Mohle  
Environmental Protection Specialist  
575-234-9226

Robert Duenas  
Environmental Protection Specialist  
575-234-2229

Terry Gregston  
Environmental Protection/HAZMAT Specialist  
575-234-5958

Sundry ID

2878590

Plug Type	Top	Bottom	Length	Tag	Sacks	Cement Class	Notes
Surface Plug	0.00	100.00	100.00	Tag/Verify	25.00	C	Perf and circulate from 100' to surface. Verify at surface.
13.375 inch- Shoe Plug	792.49	901.00	108.51	Tag/Verify			
Top of Salt @ 1235	1172.65	1285.00	112.35	Tag/Verify	121.00	C	Perf and squeeze from 1285' to 772'. WOC and Tag. (In 51 sxs/Out 70 sxs)
Base of Salt @ 4450	4284.00	4500.00	216.00	Tag/Verify			
8.625 inch- Shoe Plug	4454.50	4600.00	145.50	Tag/Verify			
Delaware @ 4776	4678.24	4826.00	147.76	If solid			
5.5 inch- Shoe Plug	4801.00	4950.00	149.00	Tag/Verify			
CIBP Plug	4844.00	4879.00	35.00	If solid base no need to Tag (CIBP present and/or Mechanical Integrity Test), If Perf & Sqz then Tag, Leak Test all CIBP if no Open Perforations	80.00	C	Set CIBP at 4879'. Leak test CIBP. Spot cement from 4879' to 4284'. WOC and Tag.
Perforations Plug (If No CIBP)	4848.52	4998.00	149.48	Tag/Verify			
Spacer Plug @ 5547	5441.53	5597.00	155.47	If solid base no need to Tag (CIBP present and/or Mechanical Integrity Test), If Perf & Sqz then Tag, Leak Test all CIBP if no Open Perforations	25.00	C	Spot cement from 5597' to 5441'. WOC and Tag.



				If solid base no need to Tag (CIBP present and/or Mechanic al Integrity Test), If Perf & Sqz then Tag, Leak Test all CIBP if no Open Perforatio ns			
<b>CIBP Plug</b>	8389.00	8424.00	35.00		25.00	H	Set CIBP at 8424'. Spot 25 sxs on top. WOC and Tag.
<b>Perforations Plug (If No CIBP)</b>	8424.00	8638.00	214.00	Tag/Verify			
				If solid base no need to Tag (CIBP present and/or Mechanic al Integrity Test), If Perf & Sqz then Tag, Leak Test all CIBP if no Open Perforatio ns			
<b>Bonesprings @ 8627</b>	8490.73	8677.00	186.27		25.00	H	Dump bail 8757' to 8588'. WOC and Tag.

No more than 2000' is to be allowed between plugs in open hole, and no more than 3000' between plugs in cased hole.

Class H >7500'

Class C <7500'

Fluid used to mix the cement in R111P shall be saturated with the salts common to the section penetrated, and in suitable proportions, but not more than 3% calcium chloride by weight of cement will be considered the desired mixture whenever possible.

Medium, Secretary: Top of salt to surface If no salt take the deepest fresh water or Karst Depth

High, Critical: Bottom of Karst to surface or Deepest fresh water, whichever is greater

R111P: 50 Feet from Base of Salt to surface.

Class C: 1.32 ft<sup>3</sup>/sx

Class H: 1.06 ft<sup>3</sup>/sx

Onshore Order 2.III.G Drilling Abandonment Requirements: "All formations bearing usable-quality water, oil, gas, or geothermal resources, and/or a prospectively valuable deposit of minerals shall be protected.

Cave Karst/Potash Cement Requirement:

Wild Life

13.375 inch- Shoe Plug @

8.625 inch- Shoe Plug @

5.5 inch- Shoe Plug @

Low

Within Lesser Prairie Chicken Area

851.00

4550.00

4900.00

TOC @ 3000.00

Perforatons Top @

8474.00

Perforations 8588.00

Perforatons Top @

4929.00

Perforations 4948.00

CIBP @ 8424.00

CIBP @ 4879.00

Sante Fe Main Office  
Phone: (505) 476-3441

General Information  
Phone: (505) 629-6116

Online Phone Directory  
<https://www.emnrd.nm.gov/oed/contact-us>

State of New Mexico  
Energy, Minerals and Natural Resources  
Oil Conservation Division  
1220 S. St Francis Dr.  
Santa Fe, NM 87505

CONDITIONS

Action 547771

CONDITIONS

Operator: EOG RESOURCES INC 5509 Champions Drive Midland, TX 79706	OGRID: 7377
	Action Number: 547771
	Action Type: [C-103] NOI Plug & Abandon (C-103F)

CONDITIONS

Created By	Condition	Condition Date
gcordero	Adhere to current Plug & Abandon (P&A) Conditions Of Approvals (COA).	1/30/2026
gcordero	A Cement Bond Log (CBL) is required to be submitted to electronic permitting.	1/30/2026
gcordero	Submit Cement Bond Logs (CBL) prior to submittal of C-103P.	1/30/2026