

District I
1625 N. French Dr., Hobbs, NM 88240
District II
1301 W. Grand Avenue, Artesia, NM 88210
District III
1000 Rio Brazos Road, Aztec, NM 87410
District IV
1220 S. St. Francis Dr., Santa Fe, NM 87505

State of New Mexico
Energy Minerals and Natural Resources
RECEIVED
Oil Conservation Division
1220 South St. Francis Dr.
Santa Fe, NM 87505

Form C-101
May 27, 2004

Submit to appropriate District Office

☐ AMENDED REPORT

APPLICATION FOR PERMIT TO DRILL, RE-ENTER, DEEPEN, PLUGBACK, OR ADD A ZONE

¹ Operator Name and Address Ridgeway Arizona Oil Corp P O Box 1110 St Johns AZ 85936		² OGRID Number 164557
³ Property Code 26839	⁴ Property Name	⁵ API Number 30-003-20039
⁹ Proposed Pool 1		⁶ Well No. CC #11
⁹ Proposed Pool 1		¹⁰ Proposed Pool 2

7 Surface Location

UL or lot no.	Section	Township	Range	Lot Idn	Feet from the	North/South line	Feet from the	East/West line	County
N	16	1S	21W		660'	South	660'	West	Catron

8 Proposed Bottom Hole Location If Different From Surface

UL or lot no.	Section	Township	Range	Lot Idn	Feet from the	North/South line	Feet from the	East/West line	County

Additional Well Information

¹¹ Work Type Code N	¹² Well Type Code C	¹³ Cable/Rotary Rotary	¹⁴ Lease Type Code S	¹⁵ Ground Level Elevation 7416'
¹⁶ Multiple	¹⁷ Proposed Depth 2800 +/-	¹⁸ Formation ABO	¹⁹ Contractor Patterson UTI	²⁰ Spud Date 4-15-08
Depth to Groundwater		Distance from nearest fresh water well		Distance from nearest surface water
Pit: Liner: Synthetic <input type="checkbox"/> _____ mils thick Clay <input type="checkbox"/> Pit Volume: _____ bbls Drilling Method:				
Closed-Loop System <input type="checkbox"/> Fresh Water <input type="checkbox"/> Brine <input type="checkbox"/> Diesel/Oil-based <input type="checkbox"/> Gas/Air <input type="checkbox"/>				

21 Proposed Casing and Cement Program

Hole Size	Casing Size	Casing weight/foot	Setting Depth	Sacks of Cement	Estimated TOC
17"	13 3/8"	43#	80'	100 sks	Surface
12 1/4"	9 5/8"	36#	1400'	300 sks	Surface
8 3/4"	7"	23#	2500'	600 sks	Surface

²² Describe the proposed program. If this application is to DEEPEN or PLUG BACK, give the data on the present productive zone and proposed new productive zone. Describe the blowout prevention program, if any. Use additional sheets if necessary.

B.O.P. Ram Type

M.I.R.U. drill out to 1400' run 9 5/8", cement to surface, drill out to 2500' run 7" casing, cement to surface. Drill out to total depth 2800' +/- with air.

²³ I hereby certify that the information given above is true and complete to the best of my knowledge and belief. I further certify that the drilling pit will be constructed according to NMOCD guidelines ☐, a general permit ☐, or an (attached) alternative OCD-approved plan ☐

Signature: 

Printed name: Thomas White

Title: Field Operations Supv

E-mail Address: revtwhite@frontiernet.net

Date: 4-3-08

Phone: 928-337-3230

OIL CONSERVATION DIVISION

Approved by:



Title:

DISTRICT SUPERVISOR

Approval Date:

4/9/08

Expiration Date:

4/9/10

Conditions of Approval Attached ☐

District I
1625 N. French Dr., Hobbs, NM 88240

District II
1301 W. Grand Avenue, Artesia, NM 88210

District III
1000 Rio Brazos Rd., Aztec, NM 87410

District IV
1220 S. St. Francis Dr., Santa Fe, NM 87505

State of New Mexico

Energy, Minerals & Natural Resources Department

OIL CONSERVATION DIVISION

1220 South St. Francis Dr.

Santa Fe, NM 87505

Form C-102

Revised October 12, 2005

Submit to Appropriate District Office

State Lease - 4 Copies

Fee Lease - 3 Copies

☐ AMENDED REPORT

RECEIVED

2008 APR 7 PM 3 42

WELL LOCATION AND ACREAGE DEDICATION PLAT

¹ API Number 30-003-20039	² Pool Code	³ Pool Name Cottonwood Canyon
⁴ Property Code 26839	⁵ Property Name	⁶ Well Number CC #11
⁷ OGRID No.	⁸ Operator Name	⁹ Elevation 7416

¹⁰ Surface Location

UL or lot no.	Section	Township	Range	Lot Idn	Feet from the	North/South line	Feet from the	East/West line	County
N	16	15	21W		660'	South	660'	West	Catron

¹¹ Bottom Hole Location If Different From Surface

UL or lot no.	Section	Township	Range	Lot Idn	Feet from the	North/South line	Feet from the	East/West line	County

¹² Dedicated Acres	¹³ Joint or Infill	¹⁴ Consolidation Code	¹⁵ Order No.

No allowable will be assigned to this completion until all interests have been consolidated or a non-standard unit has been approved by the division.

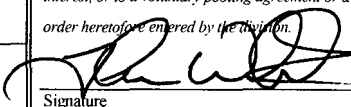
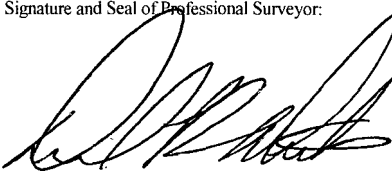
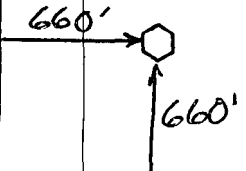
¹⁶						¹⁷ OPERATOR CERTIFICATION I hereby certify that the information contained herein is true and complete to the best of my knowledge and belief, and that this organization either owns a working interest or unleased mineral interest in the land including the proposed bottom hole location or has a right to drill this well at this location pursuant to a contract with an owner of such a mineral or working interest, or to a voluntary pooling agreement or a compulsory pooling order heretofore entered by the Division.  Signature 4-3-08 Date
						Thomas White Printed Name
						¹⁸ SURVEYOR CERTIFICATION I hereby certify that the well location shown on this plat was plotted from field notes of actual surveys made by me or under my supervision, and that the same is true and correct to the best of my belief. 31 Mar 2008 Date of Survey
						Signature and Seal of Professional Surveyor:  Certificate Number NMPS 13239
	Arizona	New Mexico				

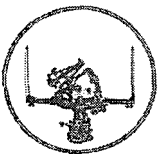
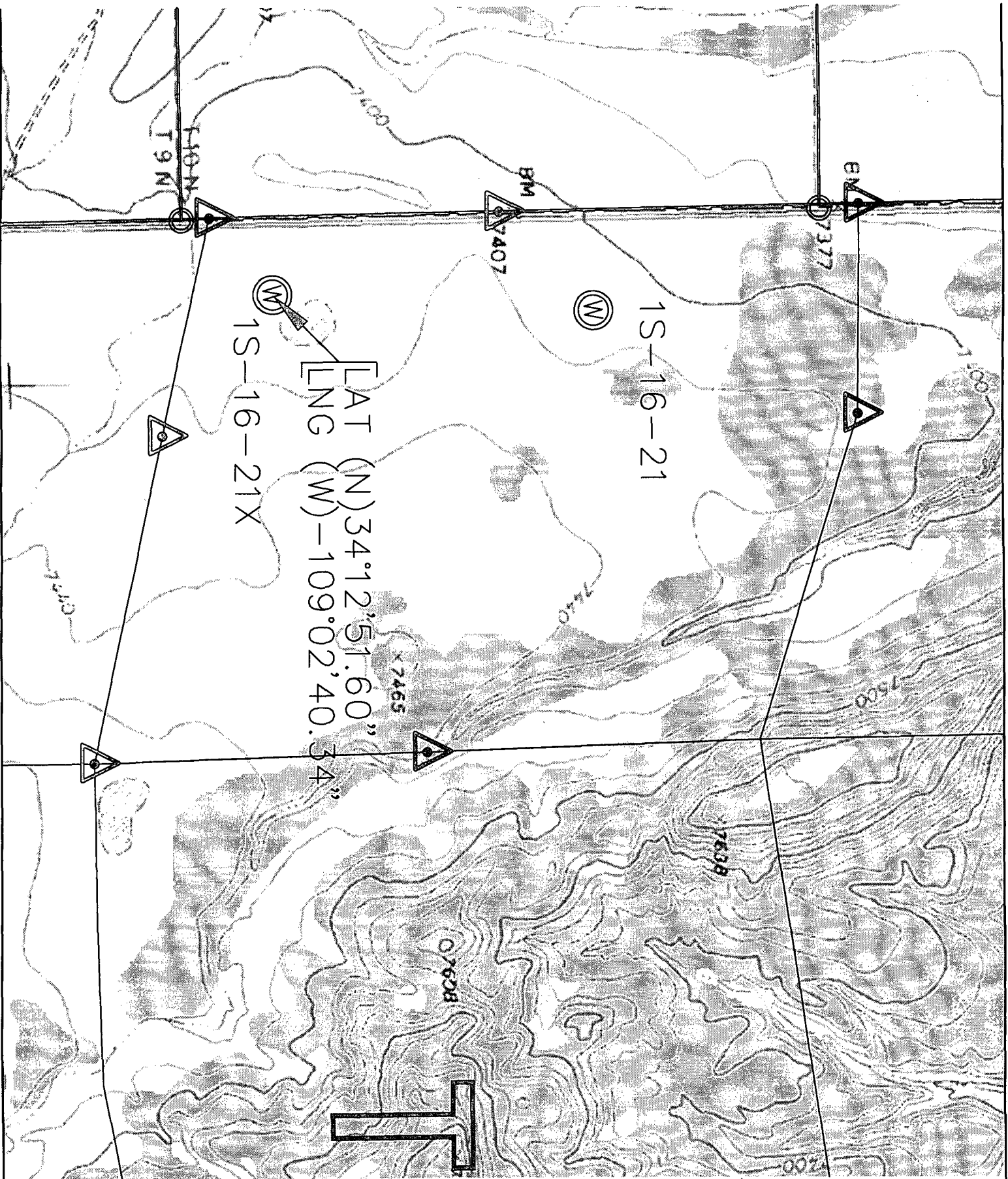

DANIEL R. MUTH PLS
P.O. BOX 1753
SPRINGERVILLE, AZ 85938
928-245-3922

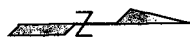

scale
1" = 500'

LOCATION
S. 16
T1SR21W NMPM

DATE OF SURVEY

PROJECT# 2006.027

DRN BY: DRM

THW: S&E 17/11

STATUS: 1