

Sec : 28 Twp : 17S Rng : 29E Section Type : NORMAL

D 40.00 CS B00514 0010 CHASE OIL CORPORA U 12/14/00 A A	C 40.00 CS B00514 0010 CHASE OIL CORPORA U 12/14/00 A A	B 40.00 CS B00514 0010 CHASE OIL CORPORA U 12/14/00 A A	A 40.00 CS B00514 0010 CHASE OIL CORPORA U 12/14/00 A A A A A A
E 40.00 CS B00514 0010 CHASE OIL CORPORA U 12/14/00 A A	F 40.00 CS B00514 0010 CHASE OIL CORPORA U 12/14/00 A A A A	G 40.00 CS B00514 0010 CHASE OIL CORPORA U 12/14/00 A A A A A A	H 40.00 CS B00514 0010 CHASE OIL CORPORA U 12/14/00 A A A A A A
L 40.00 CS B00514 0010 CHASE OIL CORPORA U 12/14/00 A A	K 40.00 CS B00514 0010 CHASE OIL CORPORA U 12/14/00 A P A	J 40.00 CS B00255 0011 CHASE OIL CORPORA U 09/10/41 A A A A	I 40.00 CS B00255 0011 CHASE OIL CORPORA U 09/10/41 A A
M 40.00 CS B00514 0010 CHASE OIL CORPORA U 12/14/00 A	N 40.00 CS B00255 0011 CHASE OIL CORPORA U 09/10/41 A	O 40.00 CS B00255 0011 CHASE OIL CORPORA U 09/10/41 A A	P 40.00 CS B00255 0011 CHASE OIL CORPORA U 09/10/41 A A C

CMD : ONGARD 07/20/04 16:27:07
OG6IWCM INQUIRE WELL COMPLETIONS OGOMES -TPGH

API Well No : 30 15 33203 Eff Date : 05-24-2004 WC Status : P
Pool Idn : 77840 GRAYBURG;MORROW (GAS)
OGRID Idn : 13837 MACK ENERGY CORP
Prop Idn : 33350 DIAMONDBACKS STATE

Well No : 001
GL Elevation: 3565

U/L	Sec	Township	Range	North/South	East/West	Prop/Act (P/A)
---	---	---	---	---	---	---
B.H. Locn	: G	28	17S	29E	FTG 2040 F N FTG 2140 F E	P

Lot Identifier:
Dedicated Acre:
Lease Type : S

Type of consolidation (Comm, Unit, Forced Pooling - C/U/F/O) :

M0025: Enter PF keys to scroll

PF01 HELP	PF02	PF03 EXIT	PF04 GoTo	PF05	PF06
PF07	PF08	PF09	PF10 NEXT-WC	PF11 HISTORY	PF12 NXTREC

District I
PO Box 1980, Hobbs, NM 88241-1980
District II
811 S. 1st Street Artesia, NM 88210-1404
District III
1000 Rio Brazos Rd, Aztec, NM 87410
District IV
PO Box 2088, Santa Fe, NM 87504-2088

State of New Mexico
Energy, Minerals & Natural Resources Department
OIL CONSERVATION DIVISION
PO Box 2088
Santa Fe, NM 87504-2088

Form C-104
Revised February 10, 1994
Instructions on back
Submit to Appropriate District Office
5 Copies

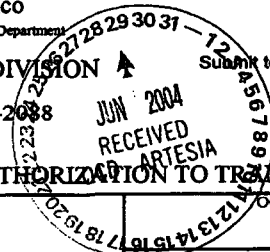

☐ AMENDED REPORT

I. REQUEST FOR ALLOWABLE AND AUTHORIZATION TO TRANSPORT

Operator Name and Address MACK ENERGY CORPORATION P.O. BOX 960 ARTESIA, NM 88211-0960		OGRID Number 013837
Reason for Filing Code NW		
API Number 30-015-33203	Pool Name Grayburg;Morrow	Pool Code 77840
Property Code 33350	Property Name Diamondbacks State	Well Number 1

II. Surface Location

UL or lot no.	Section	Township	Range	Lot Idn	Feet from the	North/South Line	Feet from the	East/West Line	County
G	28	17S	29E		2040	North	2140	East	Eddy

Bottom Hole Location

UL or lot no.	Section	Township	Range	Lot Idn	Feet from the	North/South Line	Feet from the	East/West Line	County
Lease Code S	Producing Method Code F	Gas Connection Date	C-129 Permit Number	C-129 Effective Date	C-129 Expiration Date				

III. Oil and Gas Transporters

Transporter OGRID	Transporter Name and Address	POD	O/G	POD ULSTR Location and Description
015694	Navajo Refining Company P.O. Box 159 Artesia, NM 88211-0159	0104026	O	Unit G, Sec. 28-T17S-R29E
036785	Duke Energy Field Services 4001 Penbrook Odessa, TX 79762	0104027	G	Unit G, Sec. 28-T17S-R29E

IV. Produced Water

POD	POD ULSTR Location and Description
0104028	Unit G, Sec. 28-T17S-R29E

V. Well Completion Data

Spud Date	Ready Date	TD	PBTD	Perforations
2/16/2004	4/28/2004	11204	11152	10698-10800'
Hole Size	Casing & Tubing Size	Depth Set	Sacks Cement	
17 1/2	13 3/8	383	580	
12 1/4	9 5/8	4600	1790	
7 7/8	5 1/2	11200	3280	
	2 7/8	10714		

VI. Well Test Data

Date New Oil	Gas Delivery Date	Test Date	Test Length	Tbg. Pressure	Csg. Pressure
5/8/2004	5/8/2004	5/18/2004	24 hours		
Choke Size	Oil	Water	Gas	AOF	Test Method
	0	0	10		F

I hereby certify that the rules of the Oil Conservation Division have been complied with and that the information given above is true and complete to the best of my knowledge and belief.

Signature:

Jerry W. Sherrell

Printed name:

Jerry W. Sherrell

Title:

Production Clerk

Date:

6/28/2004

Phone:

(505)748-1288

Approved by:

W. H. R. Completed to Artesia

Title:

FOR RECORDS ONLY

Approval Date:

JUL 01 2004

If this is a change of operator fill in the OGRID number and name of the previous operator.

Name:

OGRID #:

Previous Operator Signature

Printed Name

Title

Date

7/1/2004

Wellbore Diagram

r263

30-015-33203-00-00

DIAMONDBACKS STATE

No. 001

Company Name: MACK ENERGY CORP

Location: Sec: 28 T: 17S R: 29E Spot:

String Information

Lat/Long: Lat: 32.8071975274558 Long: -104.07821

Property Name: DIAMONDBACKS STATE

County Name: Eddy

Cement Information

Perforation Information

Formation Information

St Code	Formation	Depth
Psal	Salado	307
Pbslt	Base of Salt	660
Pyts	Yates	816
Psr	Seven Rivers	1116
Psrbs	Bowers Sand	1511
Pqu	Queen	1750
Pgb	Grayburg	2147
Psa	San Andres	2462
Pgl	Glorieta	3968
Pabo	Abo	6080
Pwc	Wolfcamp	7295
Ppcis	Cisco	8548
PPst	Strawn	9952
Ppat	Atoka	10212
Ppmorl	Morrow Limestone	10461
Ppmorc	Morrow Clastics	10643

Hole: Unknown

TD:

TVD: 0

PBTD:

OPERATOR: MACK ENERGY
 WELL/LEASE: DIAMONDBACK ST 1
 COUNTY: EDDY

003-0025

**STATE OF NEW MEXICO
 DEVIATION REPORT**

189	1	7813	1 1/2
383	3/4	8098	1 1/4
673	1	8479	1
1051	1/2	8813	1/2
1524	1/2	9270	1 3/4
1997	1	9460	3/4
2471	3/4	9737	3/4
2945	2 1/4	10019	1/2
3041	2	10238	1/4
3234	1 1/2	10773	1/2
3456	1 1/2	11200	1
3898	1 1/4		
4339	1 1/2		
4600	1 1/4		
4997	1 1/2		
5220	1 3/4		
5472	3		
5599	3		
5820	2 3/4		
6041	2 3/4		
6168	2 1/4		
6389	1 3/4		
6611	2 1/4		
6866	1 3/4		
7118	2		
7370	2 1/2		
7560	1 3/4		

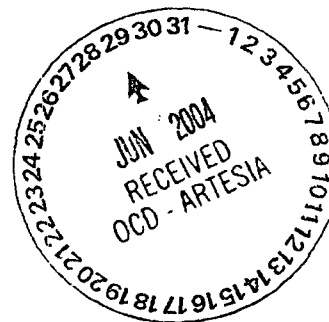
By: 

STATE OF TEXAS
 COUNTY OF MIDLAND

The foregoing instrument was acknowledged before me on this 3rd day of May, 2004, by
 Steve Moore on behalf of Patterson-UTI Drilling Company LP, LLLP.

 Notary Public for Midland County, Texas

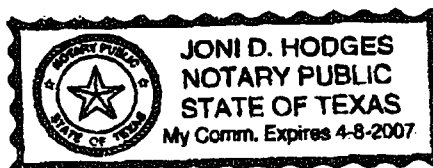

Submit to Appropriate
District Office
State Lease - 6 copies
Fee Lease - 5 copies
DISTRICT I
P O Box 1980, Hobbs, NM 88240

DISTRICT II
811 South First, Artesia, NM 88210

DISTRICT III
1000 Rio Brazos Rd., Aztec, NM 87410

State of New Mexico
Energy, Minerals and Natural Resources Department
OIL CONSERVATION DIVISION
2040 South Pacheco
Santa Fe, New Mexico 87505

Form C-105
Revised 1-1-89

WELL API NO. 30-015-33203	
5. Indicate Type of Lease STATE <input checked="" type="checkbox"/> FEE <input type="checkbox"/>	
6. State Oil & Gas Lease No. B-514	

WELL COMPLETION OR RECOMPLETION REPORT AND LOG

1. Type of Well OIL WELL <input type="checkbox"/> GAS WELL <input checked="" type="checkbox"/> DRY <input type="checkbox"/> OTHER <input type="checkbox"/>		7. Lease Name or Unit Agreement Name Diamondbacks State
b. Type of Completion NEW WELL <input type="checkbox"/> WORK OVER <input type="checkbox"/> Deepen <input type="checkbox"/> PLUG BACK <input type="checkbox"/> DIFF RESVR <input checked="" type="checkbox"/> OTHER <input type="checkbox"/>		
2. Name of Operator Mack Energy Corporation		
3. Address of Operator P.O. Box 960, Artesia, NM 88211-0960		
4. Well Location Unit Letter <u>G</u> : <u>2040</u> Feet From The <u>North</u> <u>2140</u> Feet From The <u>East</u> Line Section <u>28</u> Township <u>17S</u> Range <u>29E</u> NMPM <u>Eddy</u> County		

10. Date Spudded 2/16/2004	11. Date TD Reached 4/4/2004	12. Date Compl. (Ready to Prod.) 5/28/2004	13. Elevations (DF & RKB, RT, GR, etc.) 3582' RKB	14. Elev. Casinghead 3565'
15. Total Depth 11204	16. Plug Back TD 10575	17. If Multiple Compl. How Many Zones?	18. Intervals Drilled By Rotary Tools Yes	Cable Tools
19. Producing Interval(s), of this completion - Top, Bottom, Name 10380-10390', Atoka				20. Was Directional Survey Made Yes
21. Type Electric and Other Logs Run Gamma Ray, Neutron, Density, Lateralog, Spectral Gamma Ray				22. Was Well Cored No

CASING RECORD (Report all strings set in well)

CASING SIZE	WEIGHT LB./FT.	DEPTH SET	HOLE SIZE	CEMENTING RECORD	AMOUNT PULLED
13 3/8	48	383	17 1/2	580 sx	None
9 5/8	40	4600	12 1/4	1790 sx	None
5 1/2	17	11200	7 7/8	3280 sx	None

24. LINER RECORD				25. TUBING RECORD			
SIZE	TOP	BOTTOM	SACKS CEMENT	SCREEN	SIZE	DEPTH SET	PACKER SET
					2 7/8	10328	10328

26. Perforation record (interval, size, and number) 10380-10390', .45, 40	27. ACID, SHOT, FRACTURE, CEMENT, SQUEEZE, ETC.	
	DEPTH INTERVAL	AMOUNT AND KIND MATERIAL USED
	10380-10390'	1500 gals 10% MS/Methanol acid
	10380-10390'	106,000 SCF N2

28. PRODUCTION							
Date First Production 5/30/2004		Production Method (Flowing, gas lift, pumping - Size and type pump) Flowing				Well Status (Prod. or Shut-in) Producing	
Date of Test 6/3/2004	Hours Tested 24 hours	Choke Size	Prod'n For Test Period	Oil - Bbl. 1	Gas - MCF 319	Water - Bbl. 1	Gas - Oil Ratio 319
Flow Tubing Press. 260#	Casing Pressure	Calculated 24-Hour Rate	Oil - Bbl. 1	Gas - MCF 319	Water - Bbl. 1	Oil Gravity - API - (Corr.)	

29. Disposition of Gas (Sold, used for fuel, vented, etc.) Sold	Test Witnessed By Robert C. Chase
--	--------------------------------------

30. List Attachments Deviation Survey and Logs

31. I hereby certify that the information shown on both sides of this form is true and complete to the best of my knowledge and belief

Signature Jerry W. Sherrell Printed Name Jerry W. Sherrell Title Production Clerk Date 6/29/2004

INSTRUCTIONS

This form is to be filed with the appropriate District Office of the Division not later than 20 days after the completion of any newly-drilled or deepened well. It shall be accompanied by one copy of all electrical and radio-activity logs run on the well and a summary of all special tests conducted, including drill stem tests. All depths reported shall be measured depths. In the case of directionally drilled wells, true vertical depths shall also be reported. For multiple completions, Items 25 through 29 shall be reported for each zone. The form is to be filed in quintuplicate except on state land, where six copies are required. See Rule 1105.

INDICATE FORMATION TOPS IN CONFORMANCE WITH GEOGRAPHICAL SECTION OF STATE

Southeastern New Mexico Northwestern New Mexico

T. Anhy _____	T. Canyon _____ 9952	T. Ojo Alamo _____	T. Penn. "B" _____
T. Salt _____	T. Strawn _____	T. Kirtland-Fruitland _____	T. Penn. "C" _____
B. Salt _____	T. Atoka _____ 10212	T. Pictured Cliffs _____	T. Penn. "D" _____
T. Yates _____ 816	T. Miss _____ 11145	T. Cliff House _____	T. Leadville _____
T. 7 Rivers _____ 1116	T. Devonian _____	T. Menefee _____	T. Madison _____
T. Queen _____ 1512	T. Silurian _____	T. Point Lookout _____	T. Elbert _____
T. Grayburg _____ 2147	T. Montoya _____	T. Mancos _____	T. McCracken _____
T. San Andres _____ 2462	T. Simpson _____	T. Gallup _____	T. Ignacio Otzte _____
T. Glorieta _____ 3968	T. McKee _____	Base Greenhorn _____	T. Granite _____
T. Paddock _____	T. Ellenburger _____	T. Dakota _____	T. _____
T. Blinebry _____	T. Gr. Wash _____	T. Morrison _____	T. _____
T. Tubb _____	T. Delaware Sand _____	T. Todilto _____	T. _____
T. Drinkard _____	T. Bone Springs _____	T. Entrada _____	T. _____
T. Abo _____ 6082	T. Morrow Lime _____ 10461	T. Wingate _____	T. _____
T. Wolfcamp _____ 7322	T. Morrow Clastics _____ 10643	T. Chinle _____	T. _____
T. Penn _____	T. _____	T. Permain _____	T. _____
T. Cisco (Bough C) _____ 8548	T. _____	T. Penn "A" _____	T. _____

OIL OR GAS SANDS OR ZONES

No. 1, from.....to.....
No. 2, from.....to.....
No. 3, from.....to.....
No. 4, from.....to.....

IMPORTANT WATER SANDS

Include data on rate of water inflow and elevation to which water rose in hole.

No. 1, from.....to.....feet.....
 No. 2, from.....to.....feet.....
 No. 3, from.....to.....feet.....

LITHOLOGY RECORD (Attach additional sheet if necessary)

From	To	Thickness in Feet	Lithology

From	To	Thickness in Feet	Lithology

Submit to Appropriate
District Office
State Lease - 6 copies
Fee Lease - 5 copies
DISTRICT I
P.O. Box 1980, Hobbs, NM 88240

DISTRICT II
811 South First, Artesia, NM 88210

DISTRICT III
1000 Rio Brazos Rd., Aztec, NM 87410

State of New Mexico
Energy, Minerals and Natural Resources Department
OIL CONSERVATION DIVISION
2040 South Pacheco
Santa Fe, New Mexico 87505

Form C-105
Revised 1-1-89

WELL API NO. 30-015-33203
5. Indicate Type of Lease STATE <input checked="" type="checkbox"/> FEE <input type="checkbox"/>
6. State Oil & Gas Lease No. B-514

WELL COMPLETION OR RECOMPLETION REPORT AND LOG

1. Type of Well: OIL WELL <input type="checkbox"/> GAS WELL <input checked="" type="checkbox"/> DRY <input type="checkbox"/> OTHER <input type="checkbox"/>		7. Lease Name or Unit Agreement Name Diamondbacks State	
b. Type of Completion: NEW WELL <input checked="" type="checkbox"/> WORK OVER <input type="checkbox"/> Deepen <input type="checkbox"/> PLUG BACK <input type="checkbox"/> DIFF RESVR <input type="checkbox"/> OTHER <input type="checkbox"/>		8. Well No.	
2. Name of Operator Mack Energy Corporation		9. Pool name or Wildcat Grayburg; Morrow	
3. Address of Operator P.O. Box 960, Artesia, NM 88211-0960		4. Well Location Unit Letter <u>G</u> : <u>2040</u> Feet From The <u>North</u> Line And <u>2140</u> Feet From The <u>East</u> Line Section <u>28</u> Township <u>17S</u> Range <u>29E</u> NMPM <u>Eddy</u> County	
10. Date Spudded 2/16/2004	11. Date TD Reached 4/4/2004	12. Date Compl. (Ready to Prod.) 4/28/2004	13. Elevations (DF & RKB, RT, GR, etc.) 3582' RKB
14. Elev. Casinghead 3565'	15. Total Depth 11204	16. Plug Back TD 11152	17. If Multiple Compl. How Many Zones?
18. Intervals Drilled By	19. Producing Interval(s), of this completion - Top, Bottom, Name 10698-10800', Morrow	20. Was Directional Survey Made Yes	21. Type Electric and Other Logs Run Gamma Ray, Neutron, Density, Lateralog, Spectral Gamma Ray
22. Was Well Cored No	23. CASING RECORD (Report all strings set in well)		

CASING SIZE	WEIGHT LB./FT.	DEPTH SET	HOLE SIZE	CEMENTING RECORD	AMOUNT PULLED
13 3/8	48	383	17 1/2	580 sx	None
9 5/8	40	4600	12 1/4	1790 sx	None
5 1/2	17	11200	7 7/8	3280 sx	None

24. LINER RECORD				25. TUBING RECORD		
SIZE	TOP	BOTTOM	SACKS CEMENT	SCREEN	SIZE	DEPTH SET
					2 7/8	10714

26. Perforation record (interval, size, and number) 10786-10800', .45, 57 10,698-10,733', .45, 140	27. ACID, SHOT, FRACTURE, CEMENT, SQUEEZE, ETC.	
	DEPTH INTERVAL	AMOUNT AND KIND MATERIAL USED
	10786-10800'	2500 gals 10% Morrow acid
	10786-10800'	28,000 SCF Nitrogen, 467 gals Methanol
	10698-10733'	2000 gals acid, 1790 SCF N2

28. PRODUCTION							
Date First Production 5/8/2004		Production Method (Flowing, gas lift, pumping - Size and type pump) Flowing				Well Status (Prod. or Shut-in) Producing	
Date of Test 5/18/2004	Hours Tested 24 hours	Choke Size	Prod'n For Test Period	Oil - Bbl. 0	Gas - MCF 10	Water - Bbl. 0	Gas - Oil Ratio
Flow Tubing Press. 68#	Casing Pressure	Calculated 24-Hour Rate	Oil - Bbl. 0	Gas - MCF 10	Water - Bbl. 0	Oil Gravity - API - (Corr.)	
29. Disposition of Gas (Sold, used for fuel, vented, etc.) Sold						Test Witnessed By Robert C. Chase	

30. List Attachments
Deviation Survey and Logs

31. I hereby certify that the information shown on both sides of this form is true and complete to the best of my knowledge and belief

Signature Jerry W. Sherrell Printed Name Jerry W. Sherrell Title Production Clerk Date 6/28/2004

INSTRUCTIONS

This form is to be filed with the appropriate District Office of the Division not later than 20 days after the completion of any newly-drilled or deepened well. It shall be accompanied by one copy of all electrical and radio-activity logs run on the well and a summary of all special tests conducted, including drill stem tests. All depths reported shall be measured depths. In the case of directionally drilled wells, true vertical depths shall also be reported. For multiple completions, Items 25 through 29 shall be reported for each zone. The form is to be filed in quintuplicate except on state land, where six copies are required. See Rule 1105.

INDICATE FORMATION TOPS IN CONFORMANCE WITH GEOGRAPHICAL SECTION OF STATE

Southeastern New Mexico Northwestern New Mexico

T. Anhy _____	T. Canyon _____	T. Ojo Alamo _____	T. Penn. "B" _____
T. Salt _____	T. Strawn _____ 9952	T. Kirtland-Fruitland _____	T. Penn. "C" _____
B. Salt _____	T. Atoka _____ 10212	T. Pictured Cliffs _____	T. Penn. "D" _____
T. Yates _____ 816	T. Miss _____ 11145	T. Cliff House _____	T. Leadville _____
T. 7 Rivers _____ 1116	T. Devonian _____	T. Menefee _____	T. Madison _____
T. Queen _____ 1512	T. Silurian _____	T. Point Lookout _____	T. Elbert _____
T. Grayburg _____ 2147	T. Montoya _____	T. Mancos _____	T. McCracken _____
T. San Andres _____ 2462	T. Simpson _____	T. Gallup _____	T. Ignacio Otzte _____
T. Glorieta _____ 3968	T. McKee _____	Base Greenhorn _____	T. Granite _____
T. Paddock _____	T. Ellenburger _____	T. Dakota _____	T. _____
T. Blinebry _____	T. Gr. Wash _____	T. Morrison _____	T. _____
T. Tubb _____	T. Delaware Sand _____	T. Todilto _____	T. _____
T. Drinkard _____	T. Bone Springs _____	T. Entrada _____	T. _____
T. Abo _____ 6082	T. Morrow Lime _____ 10461	T. Wingate _____	T. _____
T. Wolfcamp _____ 7322	T. Morrow Clastics _____ 10643	T. Chinle _____	T. _____
T. Penn _____	T. _____	T. Permian _____	T. _____
T. Cisco (Bough C) _____ 8548	T. _____	T. Penn "A" _____	T. _____

OIL OR GAS SANDS OR ZONES

No. 1, from.....to.....
No. 2, from.....to.....
No. 3, from.....to.....
No. 4, from.....to.....

IMPORTANT WATER SANDS

Include data on rate of water inflow and elevation to which water rose in hole.

No. 1, from to feet

No. 2, from to feet

No. 3, from to feet

LITHOLOGY RECORD (Attach additional sheet if necessary)

From	To	Thickness in Feet	Lithology

OPERATOR: MACK ENERGY
WELL/LEASE: DIAMONDBACK ST 1
COUNTY: EDDY

003-0025

**STATE OF NEW MEXICO
DEVIATION REPORT**

189	1	7813	1 1/2
383	3/4	8098	1 1/4
673	1	8479	1
1051	1/2	8813	1/2
1524	1/2	9270	1 3/4
1997	1	9460	3/4
2471	3/4	9737	3/4
2945	2 1/4	10019	1/2
3041	2	10238	1/4
3234	1 1/2	10773	1/2
3456	1 1/2	11200	1
3898	1 1/4		
4339	1 1/2		
4600	1 1/4		
4997	1 1/2		
5220	1 3/4		
5472	3		
5599	3		
5820	2 3/4		
6041	2 3/4		
6168	2 1/4		
6389	1 3/4		
6611	2 1/4		
6866	1 3/4		
7118	2		
7370	2 1/2		
7560	1 3/4		

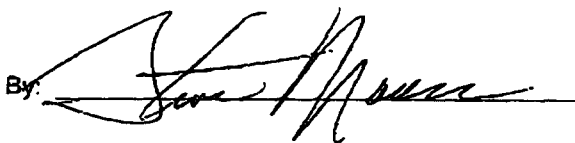

By: 

STATE OF TEXAS
COUNTY OF MIDLAND

The foregoing instrument was acknowledged before me on this 3rd day of May, 2004, by Steve Moore on behalf of Patterson-UTi Drilling Company LP, LLLP.

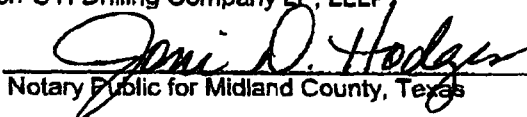
Notary Public for Midland County, Texas

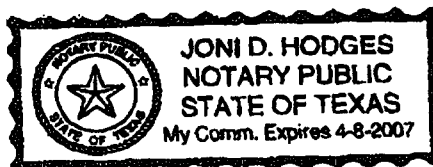

Submit 3 Copies To Appropriate District Office
District I
1625 N. French Dr., Hobbs, NM 88240
District II
1301 W. Grand Ave., Artesia, NM 88210
District III
1000 Rio Brazos Rd., Aztec, NM 87410
District IV
1220 S. St. Francis Dr., Santa Fe, NM 87505

State of New Mexico
Energy, Minerals and Natural Resources

Fonn C-103
March 4, 2004

OIL CONSERVATION DIVISION
1220 South St. Francis Dr.
Santa Fe, NM 87505

WELL API NO. 30-015-33203
5. Indicate Type of Lease STATE <input checked="" type="checkbox"/> FEE <input type="checkbox"/>
6. State Oil & Gas Lease No. B-514
7. Lease Name or Unit Agreement Name Diamondbacks State
8. Well Number 1
OGRID Number 013837
9. Pool name or Wildcat Grayburg;Atoka (Gas)

SUNDRY NOTICES AND REPORTS ON WELLS
(DO NOT USE THIS FORM FOR PROPOSALS TO DRILL OR TO DEEPEN OR PLUG BACK TO A DIFFERENT RESERVOIR. USE "APPLICATION FOR PERMIT" (FORM C-101) FOR PROPOSALS.)

1. Type of Well:
Oil Well ☐ Gas Well ☒ Other

2. Name of Operator
Mack Energy Corporation

3. Address of Operator
P.O. Box 960, Artesia, NM 88211-0960

4. Well Location
Unit Letter **G** **2040** feet from the **North** line and **2140** feet from the **East** line
Section **28** Township **17S** Range **29E** NMPM County **Eddy**

11. Elevation (Show whether DR, RKB, RT, GR, etc)
3565' GR

Pit or Below-grade Tank Application (For pit or below-grade tank closures, a form C-144 must be attached)

Pit Location: UL _____ Sect _____ Twp _____ Rng _____ Pit type _____ Depth to Groundwater _____ Distance from nearest fresh water well _____
Distance from nearest surface water _____ Below-grade Tank Location UL _____ Sect _____ Twp _____ Rng _____
feet from the _____ line and _____ feet from the _____ line

12. Check Appropriate Box to Indicate Nature of Notice, Report or Other Data

NOTICE OF INTENTION TO:

PERFORM REMEDIAL WORK ☐ PLUG AND ABANDON ☐
TEMPORARILY ABANDON ☐ CHANGE PLANS ☐
PULL OR ALTER CASING ☐ MULTIPLE COMPLETION ☐
OTHER: _____ ☐

SUBSEQUENT REPORT OF:

REMEDIAL WORK ☐ ALTERING CASING ☐
COMMENCE DRILLING OPNS. ☐ PLUG AND ABANDONMENT ☐
CASING TEST AND CEMENTJOB ☐
OTHER: **Re-Completion** ☒

13. Describe proposed or completed operations. (Clearly state all pertinent details, and give pertinent dates, including estimated date of starting any proposed work). SEE RULE 1103. For Multiple Completions: Attach wellbore diagram of proposed completion or recompletion.

05/27/2004 Set CIBP @ 10,610' w/35' cement cap and perforate Atoka Zone @ 10,380-10,390' 40 holes.

05/28/2004 RIH w332 joints 2 7/8" tubing L-80 tubing set @ 10,328'. Acidized w/1500 gals 10% MS/Methanol Acid and 106,000 SCF of N2.

I hereby certify that the information above is true and complete to the best of my knowledge and belief. I further certify that any pit or below-grade tank has been/will be constructed or closed according to NMOC guidelines ☐, a general permit ☐ or an (attached) alternative OCD-approved plan ☐

SIGNATURE Jerry W. Sherrell TITLE Production Clerk DATE 6/29/04

Type or print name Jerry W. Sherrell E-mail address: jerrys@mackenergycorp.com Telephone No. (505)748-1288

(This space for State use)

APPROVED BY FOR RECORDS ONLY DATE JUN 29 2004

Conditions of approval, if any:

Submit 3 Copies To Appropriate District
Office
District I
1625 N. French Dr., Hobbs, NM 88240
District II
1301 W. Grand Ave., Artesia, NM 88210
District III
1000 Rio Brazos Rd., Aztec, NM 87410
District IV
1220 S. St. Francis Dr., Santa Fe, NM
87505

State of New Mexico
Energy, Minerals and Natural Resources

Fonn C-103

March 4, 2004

OIL CONSERVATION DIVISION
1220 South St. Francis Dr.
Santa Fe, NM 87505

WELL API NO. 30-015-33203
5. Indicate Type of Lease STATE <input checked="" type="checkbox"/> FEE <input type="checkbox"/>
6. State Oil & Gas Lease No. B-514
7. Lease Name or Unit Agreement Name Diamondbacks State
8. Well Number 1
9. OGRID Number 013837
10. Pool name or Wildcat Grayburg;Morrow

SUNDRY NOTICES AND REPORTS ON WELLS

(DO NOT USE THIS FORM FOR PROPOSALS TO DRILL OR TO DEEPEN OR PLUG BACK TO A DIFFERENT RESERVOIR. USE "APPLICATION FOR PERMIT" (FORM C-101) FOR SUCH PROPOSALS.)

1. Type of Well:

Oil Well ☐ Gas Well ☒ Other

2. Name of Operator

Mack Energy Corporation

3. Address of Operator

P.O. Box 960, Artesia, NM 88211-0960

4. Well Location

Unit Letter **G** **2040** feet from the **North** line and **2140** feet from the **East** line

Section **28** Township **17S** Range **29E** NMPM County **Eddy**

11. Elevation (Show whether DR, RKB, RT, GR, etc)

3565' GR

Pit or Below-grade Tank Application (For pit or below-grade tank closures, a form C-144 must be attached)

Pit Location: UL _____ Sect _____ Twp _____ Rng _____ Pit type _____ Depth to Groundwater _____ Distance from nearest fresh water well _____
Distance from nearest surface water _____ Below-grade Tank Location UL _____ Sect _____ Twp _____ Rng _____
_____ feet from the _____ line and _____ feet from the _____ line

12. Check Appropriate Box to Indicate Nature of Notice, Report or Other Data

NOTICE OF INTENTION TO:

PERFORM REMEDIAL WORK ☐ PLUG AND ABANDON ☐

TEMPORARILY ABANDON ☐ CHANGE PLANS ☐

PULL OR ALTER CASING ☐ MULTIPLE COMPLETION ☐

OTHER: _____ ☐

SUBSEQUENT REPORT OF:

REMEDIAL WORK ☐ ALTERING CASING ☐

COMMENCE DRILLING OPNS. ☐ PLUG AND ABANDONMENT ☐

CASING TEST AND CEMENTJOB ☐

OTHER: **Completion** ☒

13. Describe proposed or completed operations. (Clearly state all pertinent details, and give pertinent dates, including estimated date of starting any proposed work). SEE RULE 1103. For Multiple Completions: Attach wellbore diagram of proposed completion or recompletion.

04/24/2004 Drill out DV tool.

04/27/2004 RIH perforated from 10786-10800' 57 holes, RIH set packer @ 10714' w/344 joints 2 7/8" L-80 tubing.

04/28/2004 Acidized w/2500 gals 10% Morrow acid, 28,000 SCF nitrogen, 467 gals Methanol.

05/24/2004 Set CIBP @ 10,776' w/35' cement cap. Perforated from 10,698-10,733', 140 holes, RIH w/332 joints L-80 2 7/8" tubing @ 10,631'.

05/25/2004 Acidized w/2000 gals 10% w/1790 SCF of N2.

I hereby certify that the information above is true and complete to the best of my knowledge and belief. I further certify that any pit or below-grade tank has been/will be constructed or closed according to NMOCD guidelines ☐, a general permit ☐ or an (attached) alternative OCD-approved plan ☐

SIGNATURE Jerry W. Sherrell TITLE Production Clerk DATE 6/28/04

Type or print name Jerry W. Sherrell E-mail address: jerrys@mackenergycorp.com Telephone No. (505)748-1288

(This space for State use)

FOR RECORDS ONLY

APPROVED BY [Signature] TITLE _____ DATE JUN 29 2004

Conditions of approval, if any:

Submit 3 Copies To Appropriate District
Office
District I
1625 N. French Dr., Hobbs, NM 88240
District II
1301 W. Grand Ave., Artesia, NM 88210
District III
1000 Rio Brazos Rd., Aztec, NM 87410
District IV
1220 S. St. Francis Dr., Santa Fe, NM
87505

State of New Mexico
Energy, Minerals and Natural Resources

Fonn C-103

March 4, 2004

OIL CONSERVATION DIVISION
1220 South St. Francis Dr.
Santa Fe, NM 87505

WELL API NO. 30-015-33203
5. Indicate Type of Lease STATE <input checked="" type="checkbox"/> FEE <input type="checkbox"/>
6. State Oil & Gas Lease No. B-514
7. Lease Name or Unit Agreement Name Diamondbacks State
8. Well Number 1
9. OGRID Number 013837
10. Pool name or Wildcat Grayburg;Morrow

SUNDRY NOTICES AND REPORTS ON WELLS
(DO NOT USE THIS FORM FOR PROPOSALS TO DRILL OR TO DEEPEN OR PLUG BACK TO A
DIFFERENT RESERVOIR. USE "APPLICATION FOR PERMIT" (FORM C-101) FOR SUCH
PROPOSALS.)

1. Type of Well:
Oil Well ☐ Gas Well ☒ Other

RECEIVED

2. Name of Operator
Mack Energy Corporation

APR 26 2004

3. Address of Operator
P.O. Box 960, Artesia, NM 88211-0960

OCD-ARTESIA

4. Well Location

Unit Letter **G** **2040** feet from the **North** line and **2140** feet from the **East** line

Section **28** Township **17S** Range **29E** NMPM County **Eddy**

11. Elevation (Show whether DR, RKB, RT, GR, etc)
3565' GR

Pit or Below-grade Tank Application (For pit or below-grade tank closures, a form C-144 must be attached)

Pit Location: UL _____ Sect _____ Twp _____ Rng _____ Pit type _____ Depth to Groundwater _____ Distance from nearest fresh water well _____
Distance from nearest surface water _____ Below-grade Tank Location UL _____ Sect _____ Twp _____ Rng _____
_____ feet from the _____ line and _____ feet from the _____ line

12. Check Appropriate Box to Indicate Nature of Notice, Report or Other Data

NOTICE OF INTENTION TO:

PERFORM REMEDIAL WORK ☐ PLUG AND ABANDON ☐
TEMPORARILY ABANDON ☐ CHANGE PLANS ☐
PULL OR ALTER CASING ☐ MULTIPLE ☐
COMPLETION ☐
OTHER: _____ ☐

SUBSEQUENT REPORT OF:

REMEDIAL WORK ☐ ALTERING CASING ☐
COMMENCE DRILLING OPNS. ☐ PLUG AND ☐
CASING TEST AND ABANDONMENT
CEMENTJOB ☐
OTHER: **Spud and Cement Casings** ☒

13. Describe proposed or completed operations. (Clearly state all pertinent details, and give pertinent dates, including estimated date
of starting any proposed work). SEE RULE 1103. For Multiple Completions: Attach wellbore diagram of proposed completion or recompletion.

02/16/2004 Spud @ 6:00 AM.

02/17/2004 TD 17 1/2" hole @ 383', RIH w/13 3/8, 48# H-40 set @ 383', Cemented w/180 sx thickset, tail in w/400 sx Class C, 2% CC, circ 84 sx, plug down
@ 10:00 PM 2/16/04. WOC 18 hours tested casing to 1800# for 30 minutes, held OK.

02/28/2004 TD 12 1/4" hole @ 4600'.

02/29/2004 RIH w/109 joints 9 5/8" 40# j-55 set @ 4600', Cemented 1st Stage w/240 sx 50-50-2 Poz C, 2nd Stage w/1150 sx 35-65-6, tail in w/400 sx 50-50-2
Poz C, circ 197 sx, plug down @ 8:00 AM 2/29/04.

03/01/2004 WOC 12 hours tested casing to 600# for 20 minutes, held OK.

04/04/2004 TD 7 7/8" hole @ 11204'.

04/06/2004 RIH w/251 joints 5 1/2" 17# N-80 LT&C set @ 11200'.

04/07/2004 Cemented 1st stage w/1030 sx Super "C", .6% FL25, .6% FL52, 1% BA10, 5# LCM, 2nd stage w/700 sx 35-65-6, .5% FL52, 5# LCM, tail in
w/1550 sx 15-61-11, .6% FL52, .6% FL25, 1% BA10, 5# LCM, circ 125 sx, plug down 3:00 PM 4/6/2004. WOC 12 hours tested casing to 600# for 20 minutes,
held OK.

I hereby certify that the information above is true and complete to the best of my knowledge and belief. I further certify that any pit or below-
grade tank has been/will be constructed or closed according to NMOCD guidelines ☐, a general permit ☐ or an (attached) alternative OCD-approved plan ☐

SIGNATURE Jerry W. Sherrell TITLE Production Clerk DATE 4/26/04
Type or print name Jerry W. Sherrell E-mail address: jerrys@mackenergycorp.com Telephone No. (505)748-1288

(This space for State use)

APPROVED BY _____ TITLE _____ DATE APR 27 2004

Conditions of approval, if any:

District I

1625 N. French Dr., Hobbs, NM 88240

District II

1301 W. Grand Ave., Artesia, NM 88210

District III

1000 Rio Brazos Rd., Aztec, NM 87410

District IV

1220 S. St Francis Dr., Santa Fe, NM 87505

State of New Mexico
Energy, Minerals and Natural Resources
Oil Conservation Division
1220 S. St Francis Dr.
Santa Fe, NM 87505

Form C-

APPLICATION FOR PERMIT TO DRILL

Operator Name and Address MACK ENERGY CORP PO Box 960 Artesia, NM 88211-0960		OGRID Number 13837
		API Number 30-015-33203
Property Code 33350	Property Name Diamondbacks State	Well No. 001

Surface Location

UL or Lot G	Section 28	Township 17S	Range 29E	Lot Idn G	Feet From 2040	N/S Line N	Feet From 2140	E/W Line E	County Eddy
----------------	---------------	-----------------	--------------	--------------	-------------------	---------------	-------------------	---------------	----------------

Proposed Pools

GRAYBURG;MORROW (GAS) 77840				
Work Type New Well	Well Type GAS	Cable/Rotary	Lease Type State	Ground Level Elevation 3565
Multiple N	Proposed Depth 11000	Formation Morrow	Contractor	Spud Date 02/01/2004

Proposed Casing and Cement Program

Type	Hole Size	Casing Size	Casing Weight/ft	Setting Depth	Sacks of Cement	Estimated TOC
Surf	17.5	13.375	48	350	350	0
Int1	12.25	9.625	40	4500	1900	0
Prod	7.875	5.5	17	11000	2200	0

Casing/Cement Program: Additional Comments

Mack Energy proposes to drill to 350, set 13 3/8 casing and cement. Drill to 4500, run 9 5/8 casing and cement. Drill to 11,000 test Morrow Zone, run 5 1/2 casing and cement. Put well on production. Note: On production string fluid clipper will be run and will figure cement with 25% excess, attempt to circulate.

Proposed Blowout Prevention Program

Type	Working Pressure	Test Pressure	Manufacturer
Double Ram	3000	3000	

I hereby certify that the information given above is true and complete to the best of my knowledge and belief.

Electronically Signed By: Jerry Sherrell

Title: Production Clerk

Date: 01/19/2004

Phone: 505-748-1288

OIL CONSERVATION DIVISION

Electronically Approved By: Bryan Arrant

Title: Geologist

Approval Date: 01/26/2004

Expiration Date: 01/26/2005

Conditions of Approval:

No Conditions

District I

1625 N. French Dr., Hobbs, NM 88240

District II

1301 W. Grand Ave., Artesia, NM 88210

District III

1000 Rio Brazos Rd., Aztec, NM 87410

District IV

1220 S. St Francis Dr., Santa Fe, NM 87505

State of New Mexico
Energy, Minerals and Natural Resources
Oil Conservation Division
1220 S. St Francis Dr.
Santa Fe, NM 87505

Form C-

WELL LOCATION AND ACREAGE DEDICATION PLAT

API Number 30-015-33203	Pool Name GRAYBURG;MORROW (GAS)	Pool Code 77840
Property Code 33350	Property Name Diamondbacks State	Well No. 001
OGRID No. 13837	Operator Name MACK ENERGY CORP	Elevation 3565

Surface And Bottom Hole Location

UL or Lot G	Section 28	Township 17S	Range 29E	Lot Idn G	Feet From 2040	N/S Line N	Feet From 2140	E/W Line E	County Eddy
Dedicated Acres 320		Joint or Infill		Consolidation Code		Order No.			

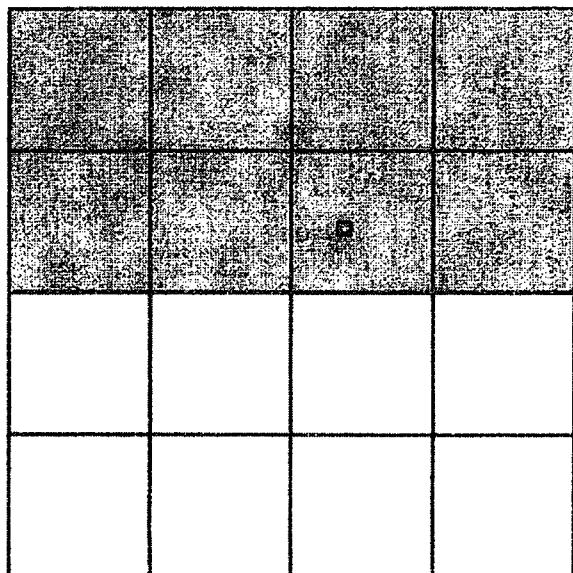
**OPERATOR CERTIFICATION**

I hereby certify that the information contained herein is true and complete to the best of my knowledge and belief.

Electronically Signed By: Jerry Sherrell

Title: Production Clerk

Date: 01/19/2004

SURVEYOR CERTIFICATION

I hereby certify that the well location shown on this plat was plotted from field notes of actual surveys made by me or under my supervision, and that the same is true and correct to the best of my belief.

Surveyed By: Ronald Eidson

Date of Survey: 02/14/2002

Certificate Number: 3239

Permit Comments

Operator: MACK ENERGY CORP , 13837

Well: Diamondbacks State #001

User Name	Comment	Comment Date
JWSHERRELL	H2S content for this well from surface to TD is low enough that a contingency plan is not required.	1/19/2004

COUNTY EddyPOOL North Grayburg-Atoka GasTOWNSHIP 17 SouthRANGE 29 East

NMPM

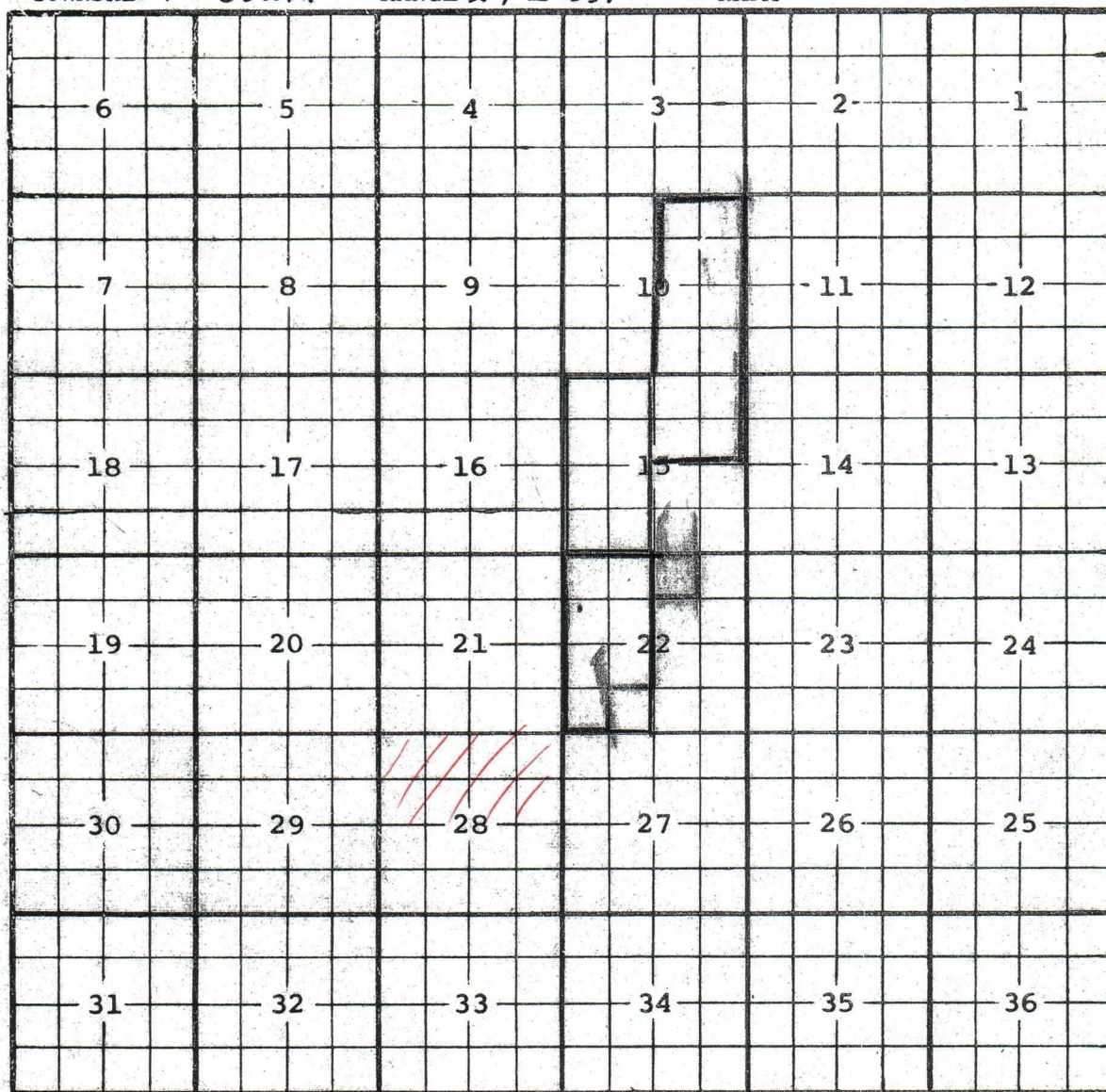

Description: W/2 Sec 15 (R-5334, 12-1-76) EXT: NW 1/4 NE 1/4,
NW 1/4, N/2 SW 1/4, SW 1/4 SW 1/4 SEC 22 W/2 SEC 22 (R-8892, 3-20-89)
Ext: E/2 Sec. 10, NE 1/4 Sec. 15 (R-11800, 7-16-02)

COUNTY EddyPOOL Grayburg - Atoka GasTOWNSHIP 17 SouthRANGE 29 East

NMFM

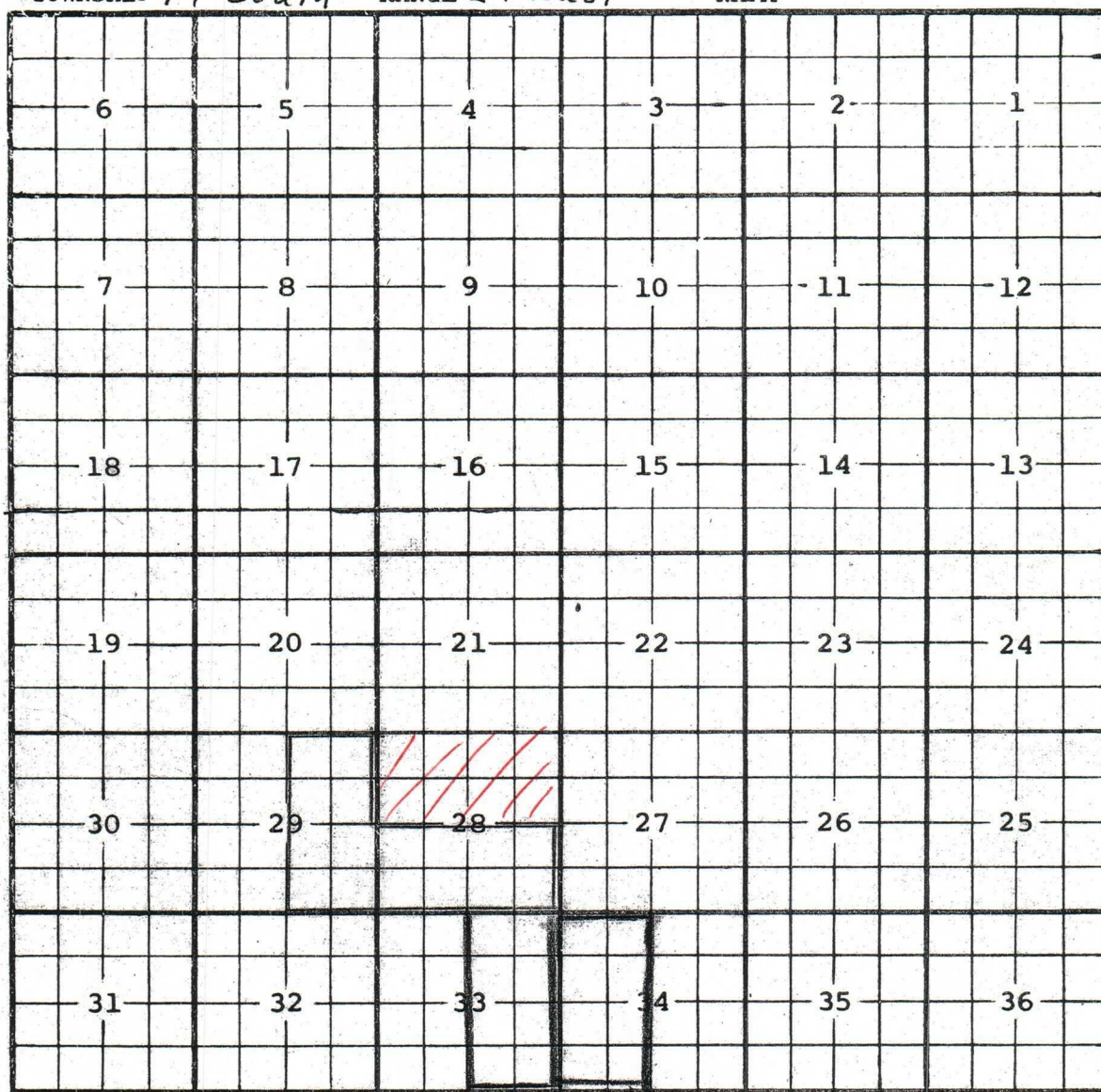

Description: $\frac{S}{2}$ Sec 28, $\frac{E}{2}$ Sec 29 (R-5015, 6-1-75)

Ext: $\frac{E}{2}$ Sec. 33 (R-11411, 7-10-06) Ext: $\frac{W}{2}$ Sec. 34 (R-11908, 2-12-03)

COUNTY EddyPOOL Grayburg-Atoka Gas

Morrow

TOWNSHIP 17-SouthRANGE 29-East

NMPM

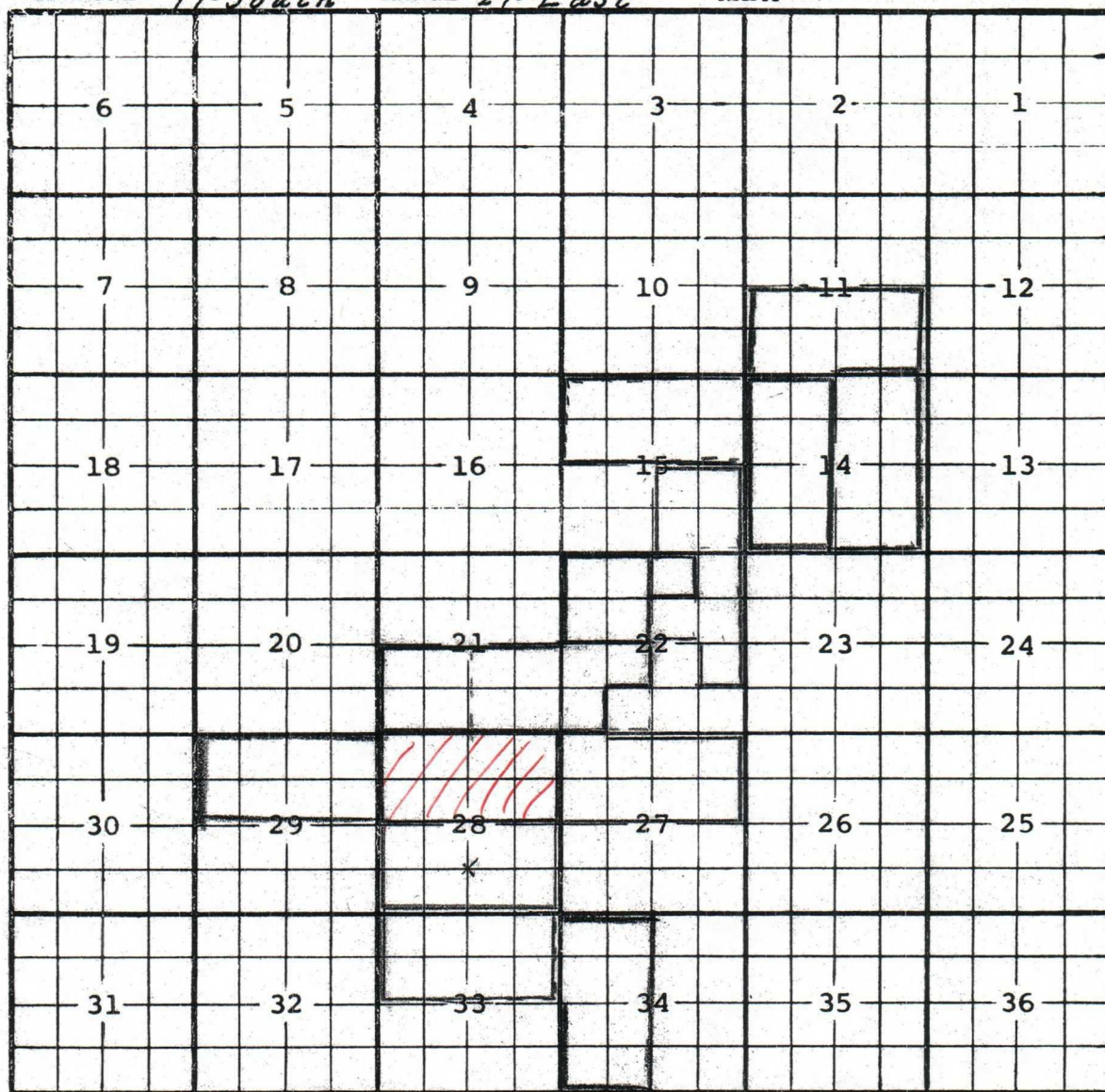

Description: NW 1/4 Sec. 22, (R-1129, 2-20-58).

Redefine vertical limits as Morrow formation and redesignate (R-4137, 5-6-71)

Ext: S 1/2 Sec. 21; NW 1/4, NE 1/4, SW 1/4, SE 1/4 Sec. 22 (R-4232, 1-1-72)

N 1/2 Sec. 28 (R-4540, 6-1-73). Ext: S 1/2 Sec. 28 (R-4734, 3-1-74)

Ext: SE 1/4 Sec. 15, E 1/2 NE 1/4, SW 1/4 NE 1/4, NE 1/4 SE 1/4 Sec. 22 (R-4809, 6-18-74)

Ext: N 1/2 Sec. 33 (R-4937, 2-1-75) Ext: N 1/2 Sec. 27 (R-5511, 9-1-77)

EXT: W 1/2 SEC 14 (R-9171, 6-1-90) EXT: N 1/2 SEC 15 (R-9418, 2-1-91)

Ext: S 1/2 Sec. 11 (R-9578, 9-10-91) Ext: E 1/2 Sec. 14 (R-10951, 2-4-98)

Ext: N 1/2 Sec. 29 (R-11729, 2-22-02) Ext: W 1/2 Sec. 34 (R-11764, 4-24-02)

BEFORE THE OIL CONSERVATION COMMISSION
OF THE STATE OF NEW MEXICO

IN THE MATTER OF THE HEARING
CALLED BY THE OIL CONSERVATION
COMMISSION OF THE STATE OF NEW
MEXICO FOR THE PURPOSE OF
CONSIDERING:

CASE NO. 1379
Order No. R-1129

THE APPLICATION OF THE OIL
CONSERVATION COMMISSION UPON
ITS OWN MOTION FOR AN ORDER
CREATING, EXTENDING, CONTRACTING,
AND ABOLISHING CERTAIN POOLS IN
LEA, EDDY, AND CHAVES COUNTIES,
NEW MEXICO.

ORDER OF THE COMMISSION

BY THE COMMISSION:

This cause came on for hearing at 9 o'clock a.m. on February 13, 1958, at Santa Fe, New Mexico, before the Oil Conservation Commission of New Mexico, hereinafter referred to as the "Commission."

NOW, on this 20th day of February, 1958, the Commission, a quorum being present, having considered the testimony presented and the exhibits received at said hearing, and being fully advised in the premises,

FINDS:

(1) That due public notice having been given as required by law, the Commission has jurisdiction of this cause and the subject matter thereof.

(2) That there is need for the creation of a new pool in Lea County, New Mexico, for the production of gas from the Mississippian formation, said pool to bear the designation Austin-Mississippian Gas Pool. Said Austin-Mississippian Gas Pool was discovered by Phillips Petroleum Company Austin Well No. 1, located in the SW/4 SW/4 Section 17, Township 14 South, Range 36 East, NMPM. It was completed April 7, 1957. The top of the perforations is at 13,194 feet.

(3) That there is need for the creation of a new pool in Eddy County, New Mexico, for the production of oil from the Abo formation, said pool to bear the designation Empire-Abo Pool. Said Empire-Abo Pool was discovered by Pan American Petroleum Corporation Malco "A" Well No. 1, located in the NE/4 NW/4 Section 11, Township 18 South, Range 27 East, NMPM. It was completed November 6, 1957. The top of the perforations is at 6,014 feet.

(4) That there is need for the creation of a new pool in Eddy County, New Mexico, for the production of gas from the Atoka formation, said pool to bear the designation Grayburg-Atoka Gas Pool. Said Grayburg-

Case No. 1379
Order No. R-1129

Atoka Gas Pool was discovered by El Paso Natural Gas Company Leonard State Well No. 1, located in the SW/4 NW/4 Section 22, Township 17 South, Range 29 East, NMPM. It was completed November 27, 1957. The top of the perforations is at 10,680 feet.

(5) That there is need for the creation of a new pool in Lea County, New Mexico, for the production of oil from the Drinkard formation, said pool to bear the designation Justis-Drinkard Pool. Said Justis-Drinkard Pool was discovered by Tidewater Oil Company A. B. Coats "C" Well No. 8, located in the NW/4 NE/4 Section 24, Township 25 South, Range 37 East, NMPM. It was completed November 23, 1957. The top of the perforations is at 5,930 feet.

(6) That there is need for the creation of a new pool in Lea County, New Mexico, for the production of oil from the Devonian formation, said pool to bear the designation Sand Springs-Devonian Pool. Said Sand Springs-Devonian Pool was discovered by Sinclair Oil & Gas Company State Lea 840 Well No. 1, located in the SW/4 SW/4 Section 1, Township 11 South, Range 34 East, NMPM. It was completed November 23, 1957. The top of the perforations is at 13,115 feet.

(7) That there is need for the creation of a new pool in Eddy County, New Mexico, for the production of oil from the Delaware formation, said pool to bear the designation Welch-Delaware Pool. Said Welch-Delaware Pool was discovered by El Paso Natural Gas Company Welch Well No. 2, located in the NW/4 NW/4 Section 21, Township 26 South, Range 27 East, NMPM. It was completed November 26, 1957. The top of the perforations is at 2,105 feet.

(8) That there is need for certain extensions to the Penrose-Skelly Pool, the Crosby-Devonian Gas Pool, the South Eunice Pool, the Four Lakes-Devonian Pool, the Reeves-Pennsylvanian Pool, and to the Tubb Gas Pool, all in Lea County, New Mexico, to the Square Lake Pool, the Dos Hermanos-Yates Seven Rivers Pool, and the West Lusk Pool, all in Eddy County, New Mexico, and to the Caprock-Queen Pool in Lea and Chaves Counties, New Mexico. Further, that there is need for deleting certain acreage from the Arrowhead Pool in Lea County, New Mexico, inasmuch as that acreage has proven unproductive and further, inasmuch as the Anderson Pool in Eddy County, New Mexico, has the same vertical limits as the Square Lake Pool, that the said Anderson pool should be abolished and the acreage included therein should be included in the Square Lake Pool. Further, that the proposed extension to the Townsend-Wolfcamp Pool, and a portion of the deletion from the Arrowhead Pool in Lea County, New Mexico were advertised in error and should therefore be dismissed.

IT IS THEREFORE ORDERED:

(a) That a new pool in Lea County, New Mexico, classified as a gas pool for Mississippian production, be and the same is hereby created and designated as the Austin-Mississippian Gas Pool, consisting of the following described area:

Case No. 1379
Order No. R-1129

TOWNSHIP 14 SOUTH, RANGE 36 EAST, NMPM
Section 17: SW/4

(b) That a new pool in Eddy County, New Mexico, classified as an oil pool for Abo production, be and the same is hereby created and designated as the Empire-Abo Pool, consisting of the following described area:

TOWNSHIP 18 SOUTH, RANGE 27 EAST, NMPM
Section 11: NW/4

(c) That a new pool in Eddy County, New Mexico, classified as a gas pool for Atoka production, be and the same is hereby created and designated as the Grayburg-Atoka Gas Pool, consisting of the following described area:

TOWNSHIP 17 SOUTH, RANGE 29 EAST, NMPM
Section 22: NW/4

(d) That a new pool in Lea County, New Mexico, classified as an oil pool for Drinkard production, be and the same is hereby created and designated as the Justis-Drinkard Pool, consisting of the following described area:

TOWNSHIP 25 SOUTH, RANGE 37 EAST, NMPM
Section 24: NE/4

(e) That a new pool in Lea County, New Mexico, classified as an oil pool for Devonian production, be and the same is hereby created and designated as the Sand Springs-Devonian Pool, consisting of the following described area:

TOWNSHIP 11 SOUTH, RANGE 34 EAST, NMPM
Section 1: SW/4

(f) That a new pool in Eddy County, New Mexico, classified as an oil pool for Delaware production, be and the same is hereby created and designated as the Welch-Delaware Pool, consisting of the following described area:

TOWNSHIP 26 SOUTH, RANGE 27 EAST, NMPM
Section 21: NW/4

(g) That the Arrowhead Pool in Lea County, New Mexico, as heretofore classified, defined, and described, be and the same is hereby contracted by the following described area:

TOWNSHIP 21 SOUTH, RANGE 36 EAST, NMPM
Section 24: All
Section 25: E/2

and further, that the proposed deletion of the following described area

TOWNSHIP 21 SOUTH, RANGE 36 EAST, NMPM
Section 26: NE/4 NE/4

be and the same is hereby designated

Case No. 1379
Order No. R-1129

(h) That the Penrose-Skelly Pool in Lea County, New Mexico, as heretofore classified, defined, and described, be and the same is hereby extended to include therein:

TOWNSHIP 21 SOUTH, RANGE 36 EAST, NMPM
Section 24: E/2
Section 25: NE/4 and E/2 SE/4

TOWNSHIP 21 SOUTH, RANGE 37 EAST, NMPM
Section 19: W/2
Section 30: NW/4 and W/2 SW/4

(i) That the Anderson Pool in Eddy County, New Mexico, as heretofore classified, defined, and described, and consisting of the following described area:

TOWNSHIP 17 SOUTH, RANGE 29 EAST, NMPM
Section 1: S/2
Sections 2, 3, 10, 11, and 12: All
Section 13: N/2
Section 14: N/2
Section 15: NE/4

TOWNSHIP 17 SOUTH, RANGE 30 EAST, NMPM
Section 6: SW/4
Section 7: N/2

be and the same is hereby abolished.

(j) That the Square Lake Pool in Eddy County, New Mexico, as heretofore classified, defined, and described, be and the same is hereby extended to include therein:

TOWNSHIP 16 SOUTH, RANGE 29 EAST, NMPM
Section 36: S/2 S/2

TOWNSHIP 16 SOUTH, RANGE 30 EAST, NMPM
Section 31: S/2
Section 32: SW/4

TOWNSHIP 17 SOUTH, RANGE 29 EAST, NMPM
Sections 1, 2, 3, 10, 11, and 12: All
Section 13: N/2
Section 14: N/2
Section 15: NE/4

TOWNSHIP 17 SOUTH, RANGE 30 EAST, NMPM
Section 5: W/2
Section 6: All
Section 7: N/2

(k) That the Caprock-Queen Pool in Lea and Chaves Counties, New Mexico, as heretofore classified, defined, and described, be and the same is hereby extended to include therein:

TOWNSHIP 14 SOUTH, RANGE 31 EAST, NMPM
Section 17: W/2 SW/4

(l) That the Crosby-Devonian Gas Pool in Lea County, New Mexico, as heretofore classified, defined, and described, be and the same is hereby extended to include therein:

TOWNSHIP 25 SOUTH, RANGE 37 EAST, NMPM
Section 20: SE/4
Section 33: SW/4

(m) That the Dos Hermanos-Yates-Seven Rivers Pool in Eddy County, New Mexico, as heretofore classified, defined, and described, be and the same is hereby extended to include therein:

TOWNSHIP 20 SOUTH, RANGE 30 EAST, NMPM
Section 28: S/2 SE/4

(n) That the South Eunice Pool in Lea County, New Mexico, as heretofore classified, defined, and described, be and the same is hereby extended to include therein:

TOWNSHIP 21 SOUTH, RANGE 36 EAST, NMPM
Section 33: SE/4
Section 34: SW/4

(o) That the Four Lakes-Devonian Pool in Lea County, New Mexico, as heretofore classified, defined, and described, be and the same is hereby extended to include therein:

TOWNSHIP 11 SOUTH, RANGE 34 EAST, NMPM
Section 35: SE/4

(p) That the West Lusk Pool in Eddy County, New Mexico, as heretofore classified, defined, and described, be and the same is hereby extended to include therein:

TOWNSHIP 19 SOUTH, RANGE 31 EAST, NMPM
Section 23: NW/4

(q) That the Reeves-Pennsylvanian Pool in Lea County, New Mexico, as heretofore classified, defined, and described, be and the same is hereby extended to include therein:

TOWNSHIP 18 SOUTH, RANGE 35 EAST, NMPM
Section 14: SE/4
Section 23: N/2

(r) That the proposed extension to the Townsend-Wolfcamp Pool in Lea County, New Mexico, to include therein:

Case No. 1379
Order No. R-1129

TOWNSHIP 16 SOUTH, RANGE 36 EAST, NMPM
Section 6: Lots 9, 10, 11, 14, 15, and 16

be and the same is hereby dismissed.

(s) That the Tubb Gas Pool in Lea County, New Mexico, as heretofore classified, defined, and described, be and the same is hereby extended to include therein:

TOWNSHIP 21 SOUTH, RANGE 37 EAST, NMPM
Section 14: SE/4

IT IS FURTHER ORDERED:

That the effective date of this order and of all the creations, abolitions, contractions and extensions included herein shall be March 1, 1958.

DONE at Santa Fe, New Mexico, on the day and year hereinabove designated.

STATE OF NEW MEXICO
OIL CONSERVATION COMMISSION

EDWIN L. MECHEM, Chairman

MURRAY E. MORGAN, Member

A. L. PORTER, Jr., Member & Secretary

S E A L

ir/

BEFORE THE OIL CONSERVATION COMMISSION
OF THE STATE OF NEW MEXICO

IN THE MATTER OF THE HEARING
CALLED BY THE OIL CONSERVATION
COMMISSION OF NEW MEXICO FOR
THE PURPOSE OF CONSIDERING:

CASE No. 4529
Order No. R-4137

NOMENCLATURE

APPLICATION OF EL PASO NATURAL
GAS COMPANY FOR 320-ACRE SPACING,
EDDY COUNTY, NEW MEXICO.

ORDER OF THE COMMISSION

BY THE COMMISSION:

This cause came on for hearing at 9 a.m. on April 28, 1971, at Santa Fe, New Mexico, before Examiner Elvis A. Utz.

NOW, on this 6th day of May, 1971, the Commission, a quorum being present, having considered the testimony, the record, and the recommendations of the Examiner, and being fully advised in the premises,

FINDS:

(1) That due public notice having been given as required by law, the Commission has jurisdiction of this cause and the subject matter thereof.

(2) That the applicant, El Paso Natural Gas Company, seeks 320-acre spacing for the Grayburg-Atoka Gas Pool, Eddy County, New Mexico.

(3) That by Order No. R-1129, dated February 20, 1958, the Grayburg-Atoka Gas Pool, Eddy County, New Mexico, was created and classified as a gas pool for Atoka production.

(4) That the discovery well for the Grayburg-Atoka Gas Pool is producing from the Morrow formation rather than the Atoka formation.

(5) That the Grayburg-Atoka Gas Pool should be redesignated the Grayburg-Morrow Gas Pool.

(6) That by Order No. R-2707, dated May 25, 1964, Rule 104 of the New Mexico Oil Conservation Commission Rules and Regulations was amended in order to provide for 320-acre spacing for gas pools in Lea, Chaves, Eddy, and Roosevelt Counties of Pennsylvanian age or older and created and defined after June 1, 1964.

(7) That said Order No. R-2707 found that in Lea, Chaves, Eddy, and Roosevelt Counties, New Mexico, a gas well completed in the Pennsylvanian formation or a deeper formation will efficiently and economically drain and develop a 320-acre tract.

(8) That the Morrow formation is a part of the Pennsylvanian formation.

(9) That, in the absence of evidence to the contrary, as prescribed by the notice of this case, the Commission finds that one well can efficiently and economically drain and develop 320 acres in the subject gas pool.

IT IS THEREFORE ORDERED:

(1) That, effective immediately, the Grayburg-Atoka Gas Pool is hereby redesignated the Grayburg-Morrow Gas Pool.

(2) That effective immediately, the Grayburg-Morrow Gas Pool, Eddy County, New Mexico, shall be governed by all Commission Rules and Regulations applicable to gas pools in Lea, Chaves, Eddy, and Roosevelt Counties of Pennsylvanian age or older the same as if the subject pool had been created and defined by the Commission after June 1, 1964.

(3) That any well presently drilling to or completed in the Morrow formation within the Grayburg-Morrow Gas Pool or within one mile of the Grayburg-Morrow Gas Pool that will not comply with the well location requirements governing gas pools in Lea, Chaves, Eddy, and Roosevelt Counties of Pennsylvanian age or older created and defined after June 1, 1964, is hereby granted an exception to such location requirement. The operator shall notify the Artesia District Office of the Commission in writing of the name and location of the well on or before June 1, 1971.

(4) That, pursuant to Paragraph A. of Section 65-3-14.5, NMSA 1953, contained in Chapter 271, Laws of 1969, existing wells in the Grayburg-Morrow Gas Pool shall have dedicated thereto

-3-

CASE NO. 4529

Order No. R-4137

320 acres in accordance with the foregoing pool rules; or, pursuant to Paragraph C. of said Section 65-3-14.5, existing wells may have non-standard spacing or proration units established by the Commission and dedicated thereto.

Failure to file new Forms C-102 with the Commission dedicating 320 acres to a well or to obtain a non-standard unit approved by the Commission within 60 days from the date of this order shall subject the well to cancellation of allowable. Until said Form C-102 has been filed or until a non-standard unit has been approved, and subject to said 60-day limitation, each well presently drilling to or completed in the Grayburg-Morrow Gas Pool or in the Morrow formation within one mile thereof shall receive no more than one-half of a standard allowable for the pool.

(5) That jurisdiction of this cause is retained for the entry of such further orders as the Commission may deem necessary.

DONE at Santa Fe, New Mexico, on the day and year hereinabove designated.

STATE OF NEW MEXICO
OIL CONSERVATION COMMISSION

BRUCE KING, Chairman

ALEX J. ARMIJO, Member

A. L. PORTER, Jr., Member & Secretary

S E A L

dr/