

74160

COUNTY EddyPOOL East Carlsbad - Wolfcamp GasTOWNSHIP 22 SouthRANGE 27 East

NMPM

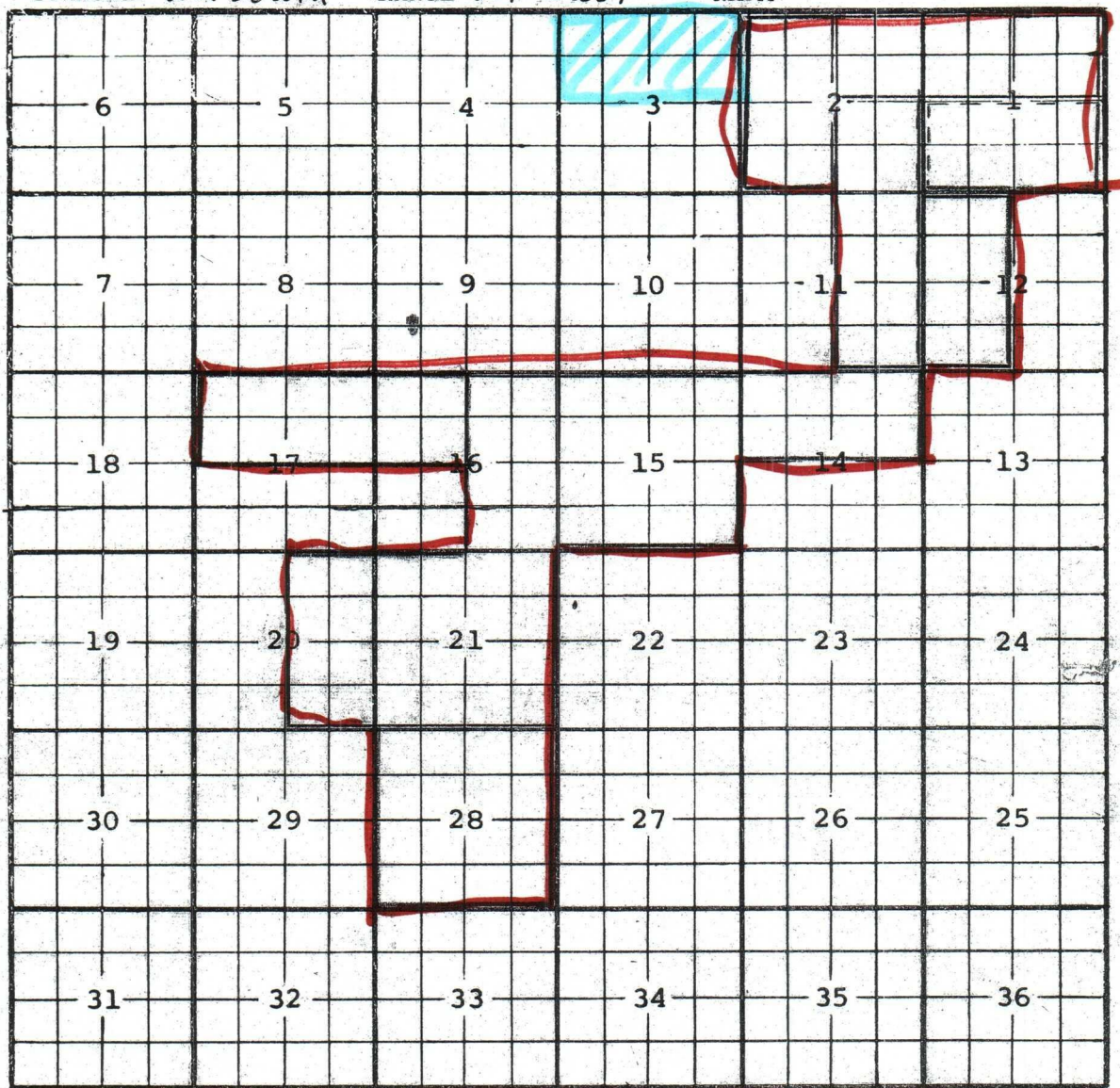

Description:  $NW\frac{1}{4}$  Sec 1,  $NE\frac{1}{4}$  Sec 2 (R-5015, 6-1-75)

Ext:  $NE\frac{1}{4}$  Sec 1 (R-5124, 12-1-75) Ext:  $SE\frac{1}{4}$  Sec 2,  $E\frac{1}{2}$  Sec 11 (R-5667, 4-1-78)

Ext:  $N\frac{1}{2}$  Sec 14, All Sec 15,  $E\frac{1}{2}$  Sec 16,  $E\frac{1}{2}$  Sec 20, All Sec 21 (R-6698, 6-2-81)

Ext: All Sec. 28 (R-8391, 1-22-87) Ext:  $W\frac{1}{2}$  Sec. 12 (R-8431, 4-15-87)

Ext:  $W\frac{1}{2}$  Sec. 2 (R-8455, 6-15-87) Ext:  $S\frac{1}{2}$  Sec. 1 (R-8592, 1/25/88)

Ext:  $NW\frac{1}{4}$  Sec. 16,  $N\frac{1}{2}$  Sec. 17 (R-10724, 1-8-97)



COUNTY EddyPOOL South Carlsbad-Strawn Gas

74120

TOWNSHIP 22 SouthRANGE 27 East

NMPM

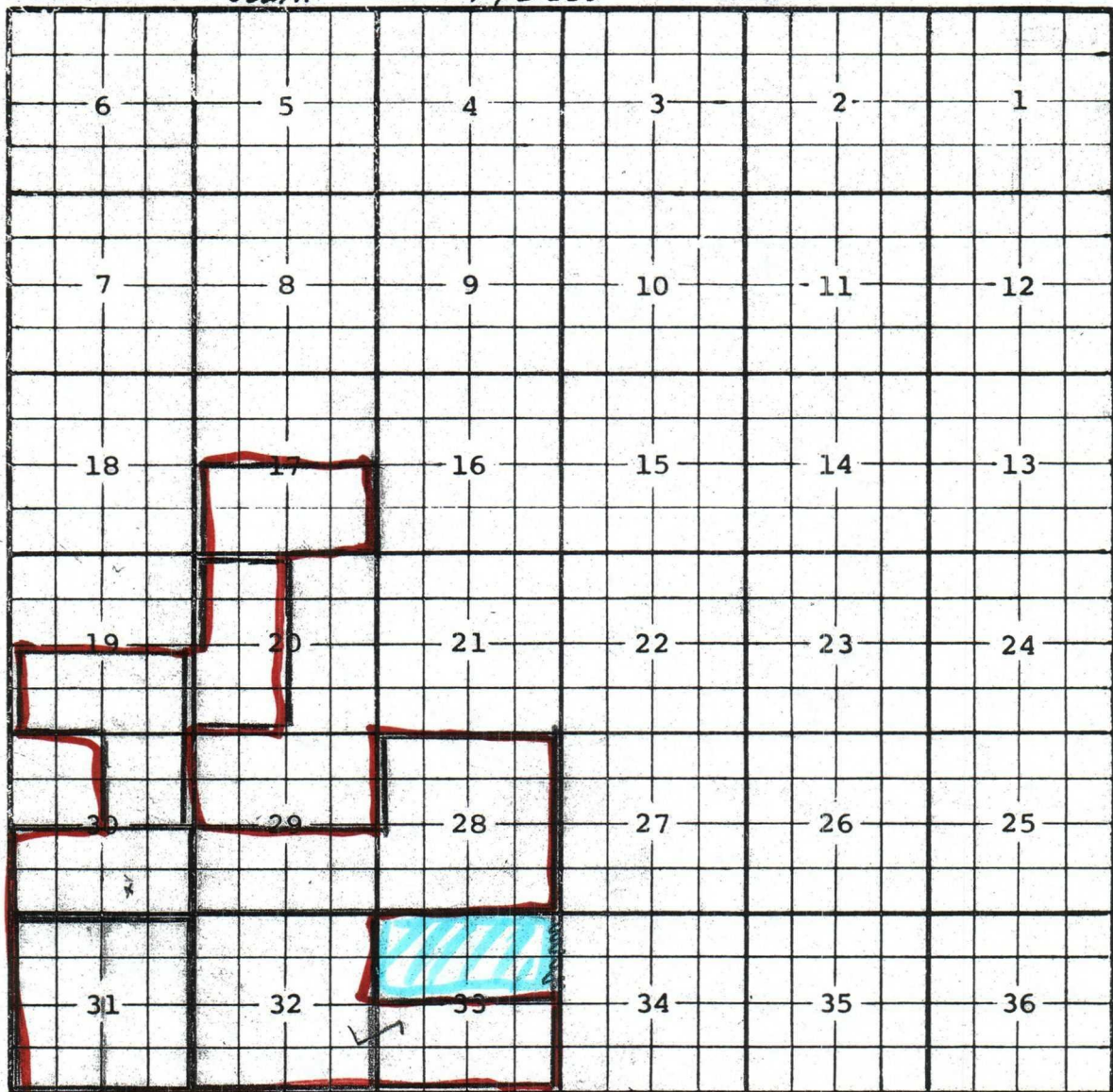

Ext: All Sec 31 (R-4119, 4-1-71) -  $\frac{5}{2}$  Sec. 30 (R-4232, 1-1-72)

Ext: All Sec. 28,  $\frac{5}{2}$  Sec. 29 (R-7668, 9-21-84) EXT: All SEC 32,  $\frac{5}{2}$  SEC 33

(R-9171, 6-1-90) Ext:  $\frac{5}{2}$  Sec. 19,  $\frac{NE}{4}$  Sec. 30 (R-9709, 8-25-92)

Ext:  $\frac{W}{2}$  Sec. 20 (R-10591, 5-8-96) Ext:  $\frac{5}{2}$  Sec. 17 (R-10724, 1-8-92)



COUNTY EddyPOOL South Carlsbad - Morrow Gas

13960

TOWNSHIP 22 SouthRANGE 27 East

NMFM

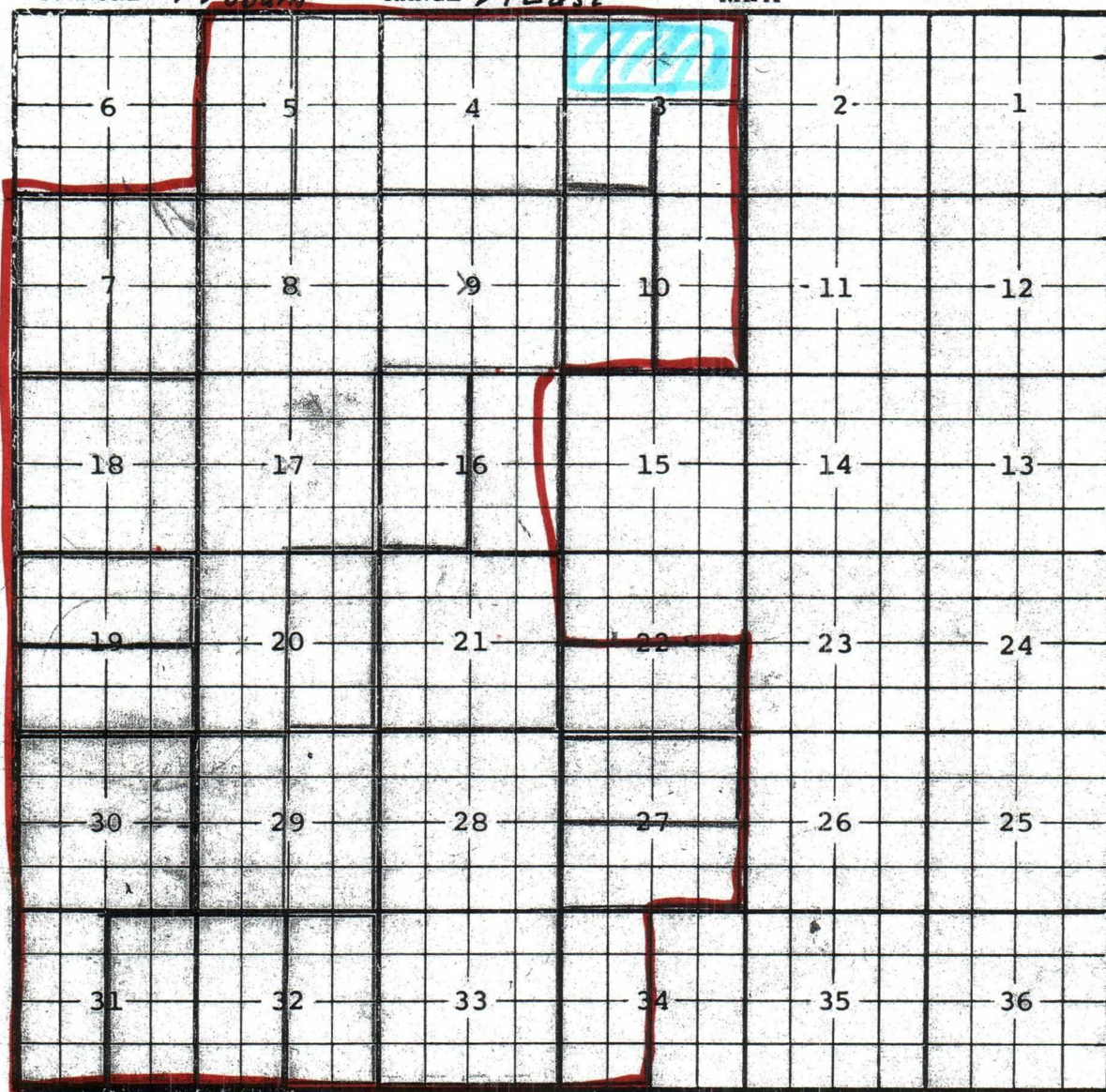

Ext:  $\frac{E}{2}$  Sec 31;  $\frac{W}{2}$  Sec 32 (R-4119, 4-1-71) - All Sec. 30;  $\frac{W}{2}$  Sec 31 (R-4194, 10-1-71)  
 -  $\frac{S}{2}$  Sec 19 (R-4232, 1-1-72). Ext:  $\frac{N}{2}$  Sec 19,  $\frac{W}{2}$  Sec 29 (R-4915, 12-1-74)  
 Ext:  $\frac{N}{2}$  Sec 3, All Sec 4,  $\frac{E}{2}$  Sec 5, All Sec 8, 9, 17 & 18,  $\frac{W}{2}$  Sec 20 (R-5162, 3-1-76)  
 Ext:  $\frac{E}{2}$  Sec 32 (R-5204, 5-1-76) Ext:  $\frac{W}{2}$  Sec 5 (R-5226, 7-1-76)  
 Ext:  $\frac{E}{2}$  Sec 20 (R-5309, 11-1-76) Ext:  $\frac{E}{2}$  Sec 7 (R-5361, 3-1-77)  
 Ext:  $\frac{W}{2}$  Sec 7 (R-5667, 4-1-78) Ext:  $\frac{E}{2}$  Sec 29 (R-5781, 9-1-78)  
 Ext:  $\frac{W}{2}$  Sec 16 (R-6476, 10-1-80) Ext: All Sec. 21 (R-7372, 10-20-83)  
 Ext: All Sec. 28, All Sec. 33 (R-7785, 1-17-85) Ext:  $\frac{S}{2}$  Sec. 27 (R-7875, 4-16-85)  
 Ext:  $\frac{W}{2}$  Sec. 34 (R-9609, 11-7-91) Ext:  $\frac{N}{2}$  Sec. 27 (R-10376, 5-24-95)  
 Ext:  $\frac{S}{2}$  Sec. 22 (R-10724, 1-8-97) Ext:  $\frac{E}{2}$  Sec 16 (R-11678, 10-23-01)  
 Ext:  $\frac{SW}{4}$  Sec. 3 (R-11729, 2-22-02) Ext:  $\frac{W}{2}$  Sec. 10 (R-11800, 7-16-02)  
 Ext:  $\frac{SE}{4}$  Sec. 3,  $\frac{E}{2}$  Sec. 10 (R-12075, 12-18-03)

CMD : ONGARD 08/30/04 11:09:10  
OG6IWCM INQUIRE WELL COMPLETIONS OGOMES -TPOC

API Well No : 30 15 24810 Eff Date : 05-04-1995 WC Status : P  
Pool Idn : 73960 CARLSBAD;MORROW, SOUTH (PRO GAS)  
OGRID Idn : 18917 READ & STEVENS INC  
Prop Idn : 9555 OTIS 33

Well No : 002  
GL Elevation: 3136

U/L	Sec	Township	Range	North/South	East/West	Prop/Act (P/A)
B.H. Locn	: C	33	22S	27E	FTG 990 F N FTG 2130 F W	P

Lot Identifier:

Dedicated Acre:

Lease Type : P

Type of consolidation (Comm, Unit, Forced Pooling - C/U/F/O) :

E6317: No more recs. for this api well no.

PF01 HELP	PF02	PF03 EXIT	PF04 GoTo	PF05	PF06
PF07	PF08	PF09	PF10 NEXT-WC	PF11 HISTORY	PF12 NXTREC

[HOME](#) | [PETROLEUM DATA](#) | [NEWS](#) | [MARKETPLACE](#) | [SOFTWARE](#) | [SPONSORS](#) | [LINKS](#) | [CONTACT](#)

[PTTC](#)  
[PRRC](#)  
[NM-TECH](#)  
[NMBGMR](#)



[NYMEX LS Crude](#) \$43.47  
[Navajo WTXI](#) \$40.00  
[Henry Hub](#) \$5.30

Updated 8/27/2004

[GENERAL](#) | [COUNTY](#) | [OPERATOR](#) | [POOL](#) | [LOCATION](#) | [OCD LOG & WELL FILES](#)

## View Production Data

**In Internet Explorer, right click and select "Save Target As..."**

**In Netscape, right click and select "Save Link As..."**

Download: [HTTP](#)

**Well:** OTIS 33 **No.:** 002

**Operator:** READ & STEVENS INC [ [NM SLO data](#) ]

**API:** 3001524810 **Township:** 22.0S **Range:** 27E

**Section:** 33 **Unit:** C

**Land Type:** P **County:** Eddy **Total Acreage:** Unknown

**Number of Completion with Acreage:** Unknown

**Accumulated:**

**Oil:** 11 (BBLS) **Gas:** 107747 (MCF)

**Water:** 44 (BBLS) **Days Produced:** 695 (Days)

Year: 1989

Pool Name: CARLSBAD;MORROW, SOUTH (PRO GAS)

Month	Oil(BBLS)	Gas(MCF)	Water(BBLS)	Days Produced	Accum. Oil(BBLS)	Accum. Gas(MCF)
January	0	1692	0	16	0	1692
February	0	2249	0	17	0	3941
March	0	3466	0	21	0	7407
April	0	2466	0	19	0	9873
May	0	3195	0	22	0	13068
June	0	1646	0	16	0	14714
July	0	2597	0	17	0	17311
August	0	1156	0	13	0	18467
September	0	661	0	10	0	19128
October	0	3750	0	21	0	22878
November	0	792	0	3	0	23670
December	0	2277	0	16	0	25947
Total	0	25947	0	191		

Year: 1990



Pool Name: CARLSBAD;MORROW, SOUTH (PRO GAS)

Month	Oil(BBLS)	Gas(MCF)	Water(BBLS)	Days Produced	Accum. Oil(BBLS)	Accum. Gas(MCF)
January	0	2731	4	23	0	28678
February	0	918	0	20	0	29596
March	0	3076	0	21	0	32672
April	0	3720	0	27	0	36392
May	0	1379	0	11	0	37771
June	0	1712	0	19	0	39483
July	0	1268	0	17	0	40751
August	0	558	0	7	0	41309
September	0	2373	0	27	0	43682
October	0	0	0	0	0	43682
November	0	4238	0	19	0	47920
December	0	1045	0	18	0	48965
Total	0	23018	4	209		

Year: 1991

Pool Name: CARLSBAD;MORROW, SOUTH (PRO GAS)

Month	Oil(BBLS)	Gas(MCF)	Water(BBLS)	Days Produced	Accum. Oil(BBLS)	Accum. Gas(MCF)
January	0	662	0	2	0	49627
February	0	9482	0	27	0	59109
March	0	8658	0	31	0	67767
April	0	6864	0	0	0	74631
May	0	2102	0	20	0	76733
June	0	4749	0	0	0	81482
July	0	2905	0	16	0	84387
August	0	2039	0	25	0	86426
September	0	1998	5	17	0	88424
October	0	935	21	19	0	89359
November	0	901	0	15	0	90260
December	0	4399	8	31	0	94659
Total	0	45694	34	203		

Year: 1992

Pool Name: CARLSBAD;MORROW, SOUTH (PRO GAS)

Month	Oil(BBLS)	Gas(MCF)	Water(BBLS)	Days Produced	Accum. Oil(BBLS)	Accum. Gas(MCF)
January	0	4185	0	2	0	98844
February	0	0	0	0	0	98844
March	0	3125	6	20	0	101969
April	0	2250	0	22	0	104219

May	0	523	0	8	0	104742
June	11	1713	0	18	11	106455
July	0	1012	0	14	11	107467
August	0	104	0	5	11	107571
September	0	176	0	3	11	107747
October	0	0	0	0	11	107747
November	0	0	0	0	11	107747
December	0	0	0	0	11	107747
Total	11	13088	6	92		

Year: 1994

Pool Name: CARLSBAD;MORROW, SOUTH (PRO GAS)

Month	Oil(BBLS)	Gas(MCF)	Water(BBLS)	Days Produced	Accum. Oil(BBLS)	Accum. Gas(MCF)
January	0	0	0	0	11	107747
February	0	0	0	0	11	107747
March	0	0	0	0	11	107747
April	0	0	0	0	11	107747
May	0	0	0	0	11	107747
June	0	0	0	0	11	107747
July	0	0	0	0	11	107747
August	0	0	0	0	11	107747
September	0	0	0	0	11	107747
October	0	0	0	0	11	107747
November	0	0	0	0	11	107747
December	0	0	0	0	11	107747
Total	0	0	0	0		

Year: 1995

Pool Name: CARLSBAD;MORROW, SOUTH (PRO GAS)

Month	Oil(BBLS)	Gas(MCF)	Water(BBLS)	Days Produced	Accum. Oil(BBLS)	Accum. Gas(MCF)
January	0	0	0	0	11	107747
February	0	0	0	0	11	107747
March	0	0	0	0	11	107747
April	0	0	0	0	11	107747
May	0	0	0	0	11	107747
June	0	0	0	0	11	107747
July	0	0	0	0	11	107747
August	0	0	0	0	11	107747
September	0	0	0	0	11	107747
October	0	0	0	0	11	107747

November	0	0	0	0	11	107747
December	0	0	0	0	11	107747
Total	0	0	0	0		

Page last updated 07/22/2003. Webmaster [gotech@prrc.nmt.edu](mailto:gotech@prrc.nmt.edu)



**STATE OF NEW MEXICO  
ENERGY, MINERALS, AND NATURAL RESOURCES DEPARTMENT  
OIL CONSERVATION DIVISION**

**IN THE MATTER OF THE HEARING  
CALLED BY THE OIL CONSERVATION  
DIVISION FOR THE PURPOSE OF  
CONSIDERING:**

*Case No. 12306  
Order No. R-11315*

**APPLICATION OF MEWBOURNE OIL COMPANY TO ABOLISH THE  
SPECIAL RULES AND REGULATIONS FOR THE SOUTH CARLSBAD-  
MORROW GAS POOL, EDDY COUNTY, NEW MEXICO.**

**ORDER OF THE DIVISION**

**BY THE DIVISION:**

This case came on for hearing at 8:15 a.m. on December 16, 1999, at Santa Fe, New Mexico, before Examiner David R. Catanach.

NOW, on this 31<sup>st</sup> day of January, 2000, the Division Director, having considered the testimony, the record, and the recommendations of the Examiner,

**FINDS THAT:**

(1) Due public notice has been given and the Division has jurisdiction of this case and its subject matter.

(2) By Order No. R-3731 dated April 18, 1969, the Division created the South Carlsbad-Morrow Gas Pool. This pool currently comprises portions of Township 22 South, Ranges 26 and 27 East, Township 23 South, Ranges 26 and 27 East, and Township 24 South, Range 26 East, NMPM, Eddy County, New Mexico.

(3) The South Carlsbad-Morrow Gas Pool is currently a prorated gas pool subject to the General Rules for the Prorated Gas Pools of New Mexico/Special Rules and Regulations for the South Carlsbad-Morrow Gas Pool, as promulgated by Division Order No. R-8170, as amended. The Special Rules and Regulations for the South Carlsbad-Morrow Gas Pool currently require standard 320-acre gas spacing and proration units with wells to be located no closer than 1980 feet to the end boundary nor closer than 660 feet to the side boundary of the proration unit, nor closer than 330 feet to any quarter-quarter section line or subdivision inner boundary.

(4) The applicant, Mewbourne Oil Company (Mewbourne), seeks an order abolishing the Special Rules and Regulations for the South Carlsbad-Morrow Gas Pool so that the well location and infill well requirements of Division Rule 104 apply to this pool.

(5) The notice published for this case stated: "In the Absence of Objection, This Case Will Be Taken Under Advisement."

(6) Mewbourne Oil Company appeared at the hearing through legal counsel.

(7) The applicant sent notice of its application to all operators in the South Carlsbad-Morrow Gas Pool and to all operators within one mile of the outer boundary of the pool. No operator and/or interest owner appeared at the hearing in opposition to the application.

(8) There is currently no provision within the General Rules for the Prorated Gas Pools of New Mexico/Special Rules and Regulations for the South Carlsbad-Morrow Gas Pool prohibiting the drilling of an infill well on a standard 320-acre gas spacing and proration unit.

(9) Division records indicate that by Order No. R-10328, issued in Case No. 11211 on March 27, 1995, the Oil Conservation Commission suspended gas prorationing in the South Carlsbad-Morrow Gas Pool because there were no non-marginal gas wells in the pool. This situation apparently has not changed and gas prorationing remains suspended at this time.

(10) Mewbourne's application in this case does not seek to change the status of the South Carlsbad-Morrow Gas Pool as a prorated gas pool, nor is there evidence in the record to support such action.

(11) By Order No. R-11231 issued in Case No. 12119 on August 12, 1999, the Oil Conservation Commission amended the well setback requirements for wells located within pools spaced on 320-acres in Southeast New Mexico, and not currently subject to special pool rules, to provide that:

- a) the initial well on a 320-acre unit shall be located no closer than 660 feet to the outer boundary of the quarter section on which the well is located and no closer than 10 feet to any quarter-quarter section line or subdivision inner boundary;
- b) only one infill well on a 320-acre unit shall be allowed provided that the well is located in the quarter section of the 320-acre unit not containing the initial well and is no closer than 660 feet to the outer boundary of the quarter section and no closer than 10 feet to any quarter-quarter section line or subdivision inner boundary; and

- c) the Division-designated operator for the infill well is the same operator currently designated by the Division for the initial well.

(12) Approval of the application will provide greater flexibility to operators in the South Carlsbad-Morrow Gas Pool in locating wells so that additional gas reserves may be recovered, thereby preventing waste.

(13) The application of Mewbourne should be approved by abolishing the Special Rules and Regulations for the South Carlsbad-Morrow Gas Pool as contained within Division Order No. R-8170, as amended; provided however, the South Carlsbad-Morrow Gas Pool should remain a prorated gas pool subject to the General Rules for the Prorated Gas Pools of New Mexico.

**IT IS THEREFORE ORDERED THAT:**

(1) The Special Rules and Regulations for the South Carlsbad-Morrow Gas Pool contained within Division Order No. R-8170, as amended, are hereby abolished.

(2) The South Carlsbad-Morrow Gas Pool shall be governed by the spacing, well density and well setback requirements contained within Division Rule 104 as provided in Rule 2 (a) of the General Rules for the Prorated Gas Pools of New Mexico, contained within Division Order No. R-8170, as amended.

(3) The South Carlsbad-Morrow Gas Pool shall remain prorated and subject to the General Rules for the Prorated Gas Pools of New Mexico as contained within Division Order No. R-8170, as amended; provided however, pursuant to Division Order No. R-10328, gas prorationing within the South Carlsbad-Morrow Gas Pool shall remain suspended until further order of the Division.

(4) Jurisdiction is hereby retained for the entry of such further orders as the Division may deem necessary.

DONE at Santa Fe, New Mexico, on the day and year hereinabove designated.

STATE OF NEW MEXICO  
OIL CONSERVATION DIVISION

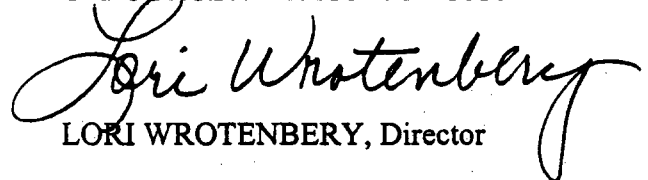
  
LORI WROTENBERY, Director



STATE OF NEW MEXICO  
ENERGY AND MINERALS DEPARTMENT

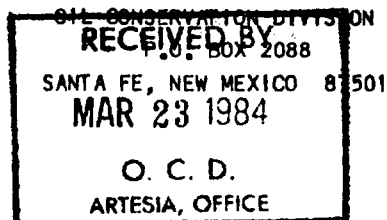

30-015-24810

Form C-101

Revised 1-1-65

NO. OF COPIES RECEIVED	
DISTRIBUTION	
SANTA FE	✓
FILE	✓
U.S.G.S.	✓
LAND OFFICE	✓
OPERATOR	✓

5A. Indicate Type of Lease  
STATE ☐ FEE ☒

5. State Oil & Gas Lease No

XXXXXXXXXXXXXXXXXXXXXXXXXXXX

XXXXXXXXXXXXXXXXXXXXXXXXXXXX

7. Unit Agreement Name

8. Farm or Lease Name

01s "33"

9. Well No.

2

10. Field and Pool, or Wildc  
Und South Carlsbad Morr

XXXXXXXXXXXXXXXXXXXXXXXXXXXX

XXXXXXXXXXXXXXXXXXXXXXXXXXXX

XXXXXXXXXXXXXXXXXXXXXXXXXXXX

XXXXXXXXXXXXXXXXXXXXXXXXXXXX

XXXXXXXXXXXXXXXXXXXXXXXXXXXX

XXXXXXXXXXXXXXXXXXXXXXXXXXXX

XXXXXXXXXXXXXXXXXXXXXXXXXXXX

XXXXXXXXXXXXXXXXXXXXXXXXXXXX

XXXXXXXXXXXXXXXXXXXXXXXXXXXX

XXXXXXXXXXXXXXXXXXXXXXXXXXXX

XXXXXXXXXXXXXXXXXXXXXXXXXXXX

XXXXXXXXXXXXXXXXXXXXXXXXXXXX

XXXXXXXXXXXXXXXXXXXXXXXXXXXX

XXXXXXXXXXXXXXXXXXXXXXXXXXXX

XXXXXXXXXXXXXXXXXXXXXXXXXXXX

XXXXXXXXXXXXXXXXXXXXXXXXXXXX

XXXXXXXXXXXXXXXXXXXXXXXXXXXX

XXXXXXXXXXXXXXXXXXXXXXXXXXXX

XXXXXXXXXXXXXXXXXXXXXXXXXXXX

XXXXXXXXXXXXXXXXXXXXXXXXXXXX

XXXXXXXXXXXXXXXXXXXXXXXXXXXX

XXXXXXXXXXXXXXXXXXXXXXXXXXXX

XXXXXXXXXXXXXXXXXXXXXXXXXXXX

XXXXXXXXXXXXXXXXXXXXXXXXXXXX

XXXXXXXXXXXXXXXXXXXXXXXXXXXX

XXXXXXXXXXXXXXXXXXXXXXXXXXXX

XXXXXXXXXXXXXXXXXXXXXXXXXXXX

XXXXXXXXXXXXXXXXXXXXXXXXXXXX

XXXXXXXXXXXXXXXXXXXXXXXXXXXX

XXXXXXXXXXXXXXXXXXXXXXXXXXXX

XXXXXXXXXXXXXXXXXXXXXXXXXXXX

XXXXXXXXXXXXXXXXXXXXXXXXXXXX

XXXXXXXXXXXXXXXXXXXXXXXXXXXX

XXXXXXXXXXXXXXXXXXXXXXXXXXXX

XXXXXXXXXXXXXXXXXXXXXXXXXXXX

XXXXXXXXXXXXXXXXXXXXXXXXXXXX

XXXXXXXXXXXXXXXXXXXXXXXXXXXX

XXXXXXXXXXXXXXXXXXXXXXXXXXXX

XXXXXXXXXXXXXXXXXXXXXXXXXXXX

XXXXXXXXXXXXXXXXXXXXXXXXXXXX

XXXXXXXXXXXXXXXXXXXXXXXXXXXX

XXXXXXXXXXXXXXXXXXXXXXXXXXXX

XXXXXXXXXXXXXXXXXXXXXXXXXXXX

APPLICATION FOR PERMIT TO DRILL, DEEPEN, OR PLUG BACK

1a. TYPE OF WORK

DRILL ☒

DEEPEN ☐

PLUG BACK ☐

b. TYPE OF WELL

OIL

GAS

SINGLE

MULTIPLE

WELL ☐

WELL ☒

OTHER ☐

ZONE ☐

ZONE ☐

2. Name of Operator

Read & Stevens, Inc. ✓

3. Address of Operator

P.O. Box 1518, Roswell, NM 88201

4. Location of Well

UNIT LETTER C LOCATED 990 FEET FROM THE North LINE

AND 2130 FEET FROM THE West LINE OF SEC. 33 TWP. 22S RGE. 27E NMPM

XX

XX

XX

XX

XX

XX

XX

XX

XX

XX

XX

XX

XX

XX

XX

XX

XX

XX

XX

XX

XX

XX

XX

XX

XX

XX

XX

XX

XX

XX

XX

XX

XX

XX

XX

XX

XX

XX

XX

XX

PROPOSED CASING AND CEMENT PROGRAM

SIZE OF HOLE	SIZE OF CASING	WEIGHT PER FOOT	SETTING DEPTH	SACKS OF CEMENT	EST. TOP
17 1/2"	13 3/8"	54.7#	400'	425sx	Circ.
12 1/4"	9 5/8"	40#	5400'	1800sx	Circ.
8 1/2"-7 7/8"	5 1/2"	17# & 20#	12,000'	1325sx	5000'

We propose to drill and test the Morrow Sand formation at approximately 12,000'. Approximately 400' of 13 3/8" surface casing will be set to protect fresh water sands. Cement will be circulated. If the well is commercial, 5 1/2" production casing will be set at 12,000', cement will be brought back to + 5000'.

Mud Program: 0-400'

Spud mud w/gel & lime, weight 9.0#, vis 34-36.

400'-5400'

Brine water w/gel, weight 10.2#, vis 28.

5400'-12,000'

Brine water w/gel, weight 10.3#, vis 28-40, water loss 10, below 11,500'.

BOP Program: 400'-5400'

Hydril 13 5/8", 5000psi WP type GK.

5400'-12,000'

11" Hydril, 5000psi WP, Double Ram BOP 5000psi WP w/type 80 accumulator unit 3000psi WP.

APPROVED FOR 180 DAYS  
9-26-84

IN ABOVE SPACE DESCRIBE PROPOSED PROGRAM: IF PROPOSAL IS TO DEEPEN OR PLUG BACK, GIVE DATA ON PRESENT PRODUCTIVE ZONE AND PROPOSED NEW PRODUCTIVE ZONE. GIVE BLOWOUT PREVENTER PROGRAM, IF ANY.

I hereby certify that the information above is true and complete to the best of my knowledge and belief.

SIGNED Bruce Stables TITLE Drilling & Production Manager DATE 3-19-84

(This space for State Use)

APPROVED BY Mike Williams TITLE OIL AND GAS INSPECTOR

DATE MAR 26 1984

CONDITIONS OF APPROVAL, IF ANY:

Post. a No.  
SD-12113 to  
3-30-84

**NEW MEXICO OIL CONSERVATION COMMISSION  
WELL LOCATION AND ACREAGE DEDICATION PLAT**

Form C-102  
Supersedes C-128  
Effective 1-1-65

All distances must be from the outer boundaries of the Section.

Operator <b>READ &amp; STEVENS, INC.</b>			Lease <b>Otis 33</b>		Well No. <b>2</b>
Unit Letter <b>C</b>	Section <b>33</b>	Township <b>22 South</b>	Range <b>27 East</b>	County <b>Eddy</b>	
Actual Footage Location of Well: <div style="display: flex; justify-content: space-between; align-items: center;"> <span><b>990</b> feet from the <b>North</b> line and</span> <span><b>2130</b> feet from the <b>West</b> line</span> </div>					
Ground Level Elev. <b>3135.6</b>	Producing Formation <b>Morrow</b>	Foot <b>Und. South Carlsbad Morrow</b>	Dedicated Acreage: <b>320</b> Acres		

1. Outline the acreage dedicated to the subject well by colored pencil or hatchure marks on the plat below.
2. If more than one lease is dedicated to the well, outline each and identify the ownership thereof (both as to working interest and royalty).
3. If more than one lease of different ownership is dedicated to the well, have the interests of all owners been consolidated by communitization, unitization, force-pooling, etc?

☒ Yes    ☐ No    If answer is "yes," type of consolidation Fee acreage

If answer is "no," list the owners and tract descriptions which have actually been consolidated. (Use reverse side of this form if necessary.) \_\_\_\_\_

No allowable will be assigned to the well until all interests have been consolidated (by communitization, unitization, forced-pooling, or otherwise) or until a non-standard unit, eliminating such interests, has been approved by the Commission.

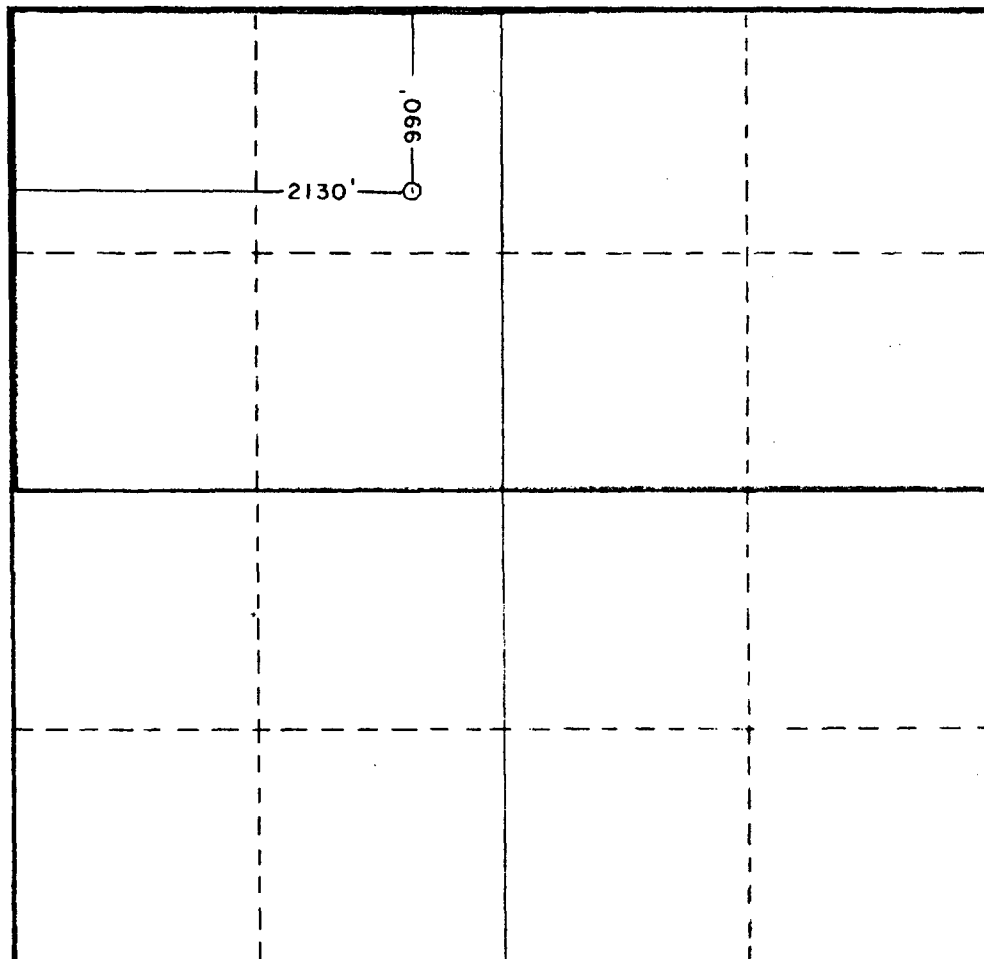

**CERTIFICATION**

I hereby certify that the information contained herein is true and complete to the best of my knowledge and belief.

*Debra Butcher*

Name  
**Debra Butcher**

Position  
**Authorized Agent**

Company  
**Read & Stevens, Inc.**

Date  
**March 22, 1984**

I hereby certify that the well location shown on this plat was plotted from field notes and/or surveys made by me or under my supervision, and that the same is true and correct to the best of my knowledge and belief.

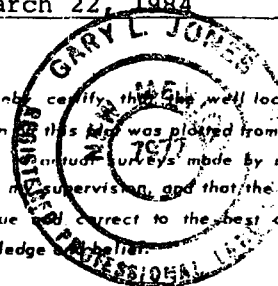

Date Surveyed  
**March 9, 1984**

Registered Professional Engineer and/or Land Surveyor

*Gary L. Jones*

Certificate No. **7977**

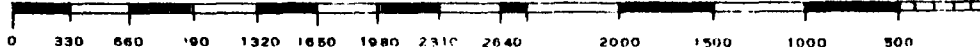

STATE OF NEW MEXICO  
ENERGY AND MINERALS DEPARTMENT

NO. OF COPIES RECEIVED	
DISTRIBUTION	
SANTA FE	<input checked="" type="checkbox"/>
FILE	<input checked="" type="checkbox"/>
U.S.G.S	
LAND OFFICE	
OPERATOR	<input checked="" type="checkbox"/>

OIL CONSERVATION DIVISION  
P.O. Box 2088  
SANTA FE, NEW MEXICO 87501

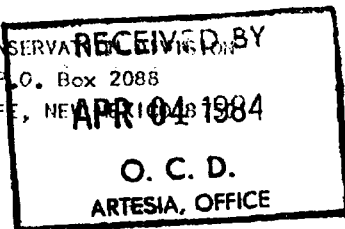

Form C-103  
Revised 10-1-78

5a. Indicate Type of Lease  
State ☐ Fee ☒

5. State Oil & Gas Lease No.

SUNDRY NOTICES AND REPORTS ON WELLS

(DO NOT USE THIS FORM FOR PROPOSALS TO DRILL OR TO DEEPEN OR PLUG BACK TO A DIFFERENT RESERVOIR. USE "APPLICATION FOR PERMIT-" (FORM C-101) FOR SUCH PROPOSALS.)

XXXXXXXXXXXXXXXXXXXXXXXXXXXX  
XXXXXXXXXXXXXXXXXXXXXXXXXXXX  
XXXXXXXXXXXXXXXXXXXXXXXXXXXX

1. OIL WELL ☐ GAS WELL ☒ OTHER

7. Unit Agreement Name

2. Name of Operator  
Read & Stevens, Inc.

8. Farm or Lease Name  
Otis #33

3. Address of Operator  
P.O. Box 1518, Roswell, NM 88201

9. Well No.  
2

4. Location of Well

UNIT LETTER C 990 FEET FROM THE North LINE AND 2130 FEET FROM  
THE West LINE. SECTION 33 TOWNSHIP 22S RANGE 27E NMPM

10. Field and Pool, or Wildcat

Und. South Carlsbad Morrow

5. Elevation(Show whether DF,RT,GR,etc.)

12. County  
Eddy

3135.6 3107 GL

XXXXXXXXXXXXXXXXXXXX  
XXXXXXXXXXXXXXXXXXXX

Check Appropriate Box To Indicate Nature of Notice, Report or Other Data

NOTICE OF INTENTION TO:

SUBSEQUENT REPORT OF:

PERFORM REMEDIAL WORK ☐  
TEMPORARILY ABANDON ☐  
PULL OR ALTER CASING ☐  
OTHER ☐

REMEDIAL WORK ☐  
COMMENCE DRILLING OPNS. ☒  
CASING TEST AND CEMENT JOB ☒  
OTHER ☐

Describe Proposed or Completed Operations(Clearly state all pertinent details, and give pertinent dates, including estimated date of starting any proposed work) SEE RULE 1103.

3-30-84 Spud 17 1/2" hole @ 10:00pm 3-29-84. TD 17 1/2" hole @ 3:15am.

3-31-84 Ran 10jts, total 1425', 13 5/8"-54.5# STBQ, J-55, MP, Insert float @ 400', set @ 443'. Cmt w/ 475sx Class "C" 2% CaCl, circ 136sx, PD @ 8:45am 3-30-84, float did not hold. SI 4hrs. Test BOP, choke, csq & kelly @ 100psi for 30mins. Tested satisfactorily. 18hrs WOC.

I hereby certify that the information above is true and complete to the best of my knowledge and belief.

SIGNED Bruce Stubbins TITLE Drilling & Production Manager DATE 4-2-84

APPROVED BY \_\_\_\_\_ TITLE \_\_\_\_\_ DATE APR 04 1984

Original Signed By  
Leslie A. Clements  
Supervisor District II

CONDITIONS OF APPROVAL, IF ANY:



## ENERGY AND MINERALS DEPARTMENT

Form C-103  
Revised 10-1-78

NO. OF COPIES RECEIVED	
DISTRIBUTION	
SANTA FE	<input checked="" type="checkbox"/>
FILE	<input checked="" type="checkbox"/>
U.S.G.S	
LAND OFFICE	
OPERATOR	<input checked="" type="checkbox"/>

OIL CONSERVATION DIVISION  
P.O. Box 2088  
SANTA FE, NEW MEXICO, 87501  
APR 13 1984  
O. C. D.  
ARTESIA, OFFICE

5a. Indicate Type of Lease  
State ☐ Fee ☒

5. State Oil & Gas Lease No.

## SUNDRY NOTICES AND REPORTS ON WELLS

(DO NOT USE THIS FORM FOR PROPOSALS TO DRILL OR TO DEEPEN OR PLUG BACK TO A DIFFERENT RESERVOIR. USE "APPLICATION FOR PERMIT-" (FORM C-101) FOR SUCH PROPOSALS.)

1. OIL WELL <input type="checkbox"/> GAS WELL <input checked="" type="checkbox"/> OTHER	7. Unit Agreement Name
2. Name of Operator Read & Stevens, Inc. ✓	8. Farm or Lease Name Otis "33"
3. Address of Operator P.O. Box 1518, Roswell, NM 88201	9. Well No. 2
4. Location of Well UNIT LETTER <u>C</u> <u>990</u> FEET FROM THE <u>North</u> LINE AND <u>2130</u> FEET FROM THE <u>West</u> LINE. SECTION <u>33</u> TOWNSHIP <u>22S</u> RANGE <u>27E</u> NMPM	10. Field and Pool, or Wildcat Und. South Carlsbad Morrow
5. Elevation(Show whether DF,RT,GR,etc.) <u>3135.6</u> -3107' GL	12. County Eddy

Check Appropriate Box To Indicate Nature of Notice, Report or Other Data

## NOTICE OF INTENTION TO:

PERFORM REMEDIAL WORK ☐ PLUG AND ABANDON ☐  
TEMPORARILY ABANDON ☐ CHANGE PLANS ☐  
PULL OR ALTER CASING ☐  
OTHER ☐

## SUBSEQUENT REPORT OF:

REMEDIAL WORK ☐ ALTERING CASING ☐  
COMMENCE DRILLING OPNS. ☐ PLUG AND ABANDONMENT ☐  
CASING TEST AND CEMENT JOB ☒  
OTHER ☐

Describe Proposed or Completed Operations(Clearly state all pertinent details, and give pertinent dates, including estimated date of starting any proposed work) SEE RULE 1103.

4-10-84 Ran 135jts, 5462', 9 5/8"-40#, S-95 & N-80, LT&C, set @ 5480', FC @ 5434'. Cmt w/ 1500sx Econolite w/ 6# salt, 1/4# flocele, 400sx Class "H" cmt, circ 300sx. PD @ 11:30pm  
4-9-84. Plug bumped @ 1200psi. 6 1/2hrs WOC.

4-11-84 11 1/2hrs WOC. Test BOP & choke manifold @ 5000psi for 30mins. Tested satisfactorily.  
Test 9 5/8" Flange @ 2500psi for 30mins. Tested satisfactorily. Test csg @ 1200psi for 30mins. Tested satisfactorily.

I hereby certify that the information above is true and complete to the best of my knowledge and belief.

SIGNED Bruce Stobbs TITLE Drilling & Production Manager DATE 4-12-84

APPROVED BY Leslie A. Clements TITLE Supervisor District II DATE APR 17 1984

CONDITIONS OF APPROVAL, IF ANY:

STATE OF NEW MEXICO  
ENERGY AND MINERALS DEPARTMENT

OIL CONSERVATION DIVISION

Form C-103  
Revised 10-1-78

NO. OF COPIES RECEIVED	
DISTRIBUTION	
SANTA FE	<input checked="" type="checkbox"/>
FILE	<input checked="" type="checkbox"/>
U.S.G.S	
LAND OFFICE	
OPERATOR	<input checked="" type="checkbox"/>

RECEIVED BY  
APR 30 1984  
O. C. D.  
ARTESIA, OFFICE

5a. Indicate Type of Lease  
State ☐ Fee ☒

5. State Oil & Gas Lease No.

SUNDRY NOTICES AND REPORTS ON WELLS  
(DO NOT USE THIS FORM FOR PROPOSALS TO DRILL OR TO DEEPEN OR PLUG BACK TO A DIFFERENT RESERVOIR. USE "APPLICATION FOR PERMIT-" (FORM C-101) FOR SUCH PROPOSALS.)

OIL WELL ☐ GAS WELL ☒ OTHER

Name of Operator  
Read & Stevens, Inc. ✓  
Address of Operator  
P.O. Box 1518, Roswell, NM 88201  
Location of Well

7. Unit Agreement Name

8. Farm or Lease Name  
O+ls "33"

9. Well No.  
2

10. Field and Pool, or Wildcat

UNIT LETTER C 990 FEET FROM THE North LINE AND 2130 FEET FROM THE West LINE. SECTION 33 TOWNSHIP 22S RANGE 27E NMPM

Und. South Carlsbad Morrow

5. Elevation(Show whether DF,RT,GR,etc.)  
3135.6 - 3107 GL

12. County  
Eddy

Check Appropriate Box To Indicate Nature of Notice, Report or Other Data

NOTICE OF INTENTION TO:

PERFORM REMEDIAL WORK ☐ PLUG AND ABANDON ☐  
TEMPORARILY ABANDON ☐ CHANGE PLANS ☐  
PULL OR ALTER CASING ☐  
OTHER ☐

SUBSEQUENT REPORT OF:

REMEDIAL WORK ☐ ALTERING CASING ☐  
COMMENCE DRILLING OPNS. ☐ PLUG AND ABANDONMENT ☐  
CASING TEST AND CEMENT JOB ☐  
OTHER DST #1 ☒

Describe Proposed or Completed Operations(Clearly state all pertinent details, and give pertinent dates, including estimated date of starting any proposed work) SEE RULE 1103.

4-26-84	DST #1 10,430'-10,510' Strawn
	Bottom Chart Top Chart
Initial Hydrostatic	5480psi 5508psi
1st Flow	72psi 48psi
30min	90psi 48psi
1st SI 60min	108psi 64psi
2nd Flow	90psi 48psi
60min	90psi 48psi
2nd SI 27min	72psi 48psi
Final Hydrostatic	5516psi 5572psi

Sampler: 25psi, 100cc mud, .273 cu. ft. gas, BHT 170°F. Approximately 10 BBls mud rec'd.

I hereby certify that the information above is true and complete to the best of my knowledge and belief.

SIGNED B. Stubbbs TITLE Drilling & Production Manager DATE 4-26-84

APPROVED BY \_\_\_\_\_ ORIGINAL SIGNED BY LARRY BROOKS TITLE \_\_\_\_\_ DATE APR 30 1984  
CONDITIONS OF APPROVAL, IF ANY: GEOLOGIST - NMOOD

UNITED BANK PLAZA  
400 N. PENN. SUITE 1000

PHONE 505 622-3770

CHARLES B. READ  
PRESIDENT

NORMAN L. STEVENS, JR.  
VICE-PRESIDENT

*Read & Stevens, Inc.*

*Oil Producers*

*P. O. Box 1518*

*Roswell, New Mexico 88201*

May 7, 1984

RECEIVED BY

MAY 8 1984

O. C. D.

ARTESIA, OFFICE

State of New Mexico  
Energy and Minerals Department  
Oil Conservation Division  
Post Office Drawer DD  
Artesia, New Mexico 88210

Re: Otis "33" #2  
Section 33-22S-27E  
Unit Letter: C  
Eddy County, NM

Dear Sirs:

Please note on the enclosed form the change in elevation for the above referenced well. This change is due to the incorrect reporting of the elevation of this well on the Application for Permit to Drill, Deepen, or Plug Back (Form C-101), which was filed by Read & Stevens, Inc. on March 19, 1984 and was approved by your office on March 26, 1984.

The original report reported the elevation of this well as being 3107'GL, and should have been reported as 3135.6'GL. The Well Location and Acreage Dedication Plat which was attached to the original C-101 was reported correctly at 3135.6'GL. The incorrect footage, of 3107'GL, was taken from that of another Read & Stevens operated well (Otis "34" #1).

Please note the change in all necessary areas and notify the necessary people of this change both in your office and those of other district offices that may be involved. Thank you for your cooperation and we are sorry for any inconvenience this may have caused. If we can be of further assistance in this matter, please contact us.

Sincerely,

READ & STEVENS, INC.

*Tricia Boardman*

Tricia Boardman  
Production Clerk  
Engineering Department

Enclosures

cc: Santa Fe District Office



## ENERGY AND MINERALS DEPARTMENT

NO. OF COPIES RECEIVED	
DISTRIBUTION	
SANTA FE	<input checked="" type="checkbox"/>
FILE	<input checked="" type="checkbox"/>
U.S.G.S	
LAND OFFICE	
OPERATOR	<input checked="" type="checkbox"/>

OIL CONSERVATION RECEIVED BY  
P.O. Box 2088  
SANTA FE, NEW MEXICO 87501  
MAY 16 1984  
O. C. D.  
ARTESIA, OFFICE

Form C-103  
Revised 10-1-78

5a. Indicate Type of Lease  
State ☐ Fee ☒

5. State Oil & Gas Lease No.

## SUNDRY NOTICES AND REPORTS ON WELLS

(DO NOT USE THIS FORM FOR PROPOSALS TO DRILL OR TO DEEPEN OR PLUG BACK TO A DIFFERENT RESERVOIR. USE "APPLICATION FOR PERMIT-" (FORM C-101) FOR SUCH PROPOSALS.)

1. OIL WELL <input type="checkbox"/> GAS WELL <input checked="" type="checkbox"/> OTHER	7. Unit Agreement Name
2. Name of Operator Read & Stevens, Inc. ✓	8. Farm or Lease Name Otis "33"
3. Address of Operator P.O. Box 1518, Roswell, NM 88201	9. Well No. 2
4. Location of Well UNIT LETTER <u>C</u> , <u>990</u> FEET FROM THE <u>North</u> LINE AND <u>2130</u> FEET FROM THE <u>West</u> LINE. SECTION <u>33</u> TOWNSHIP <u>22S</u> RANGE <u>27E</u> NMPM	10. Field and Pool, or Wildcat Und. South Carlsbad Morrow
5. Elevation (Show whether DF, RT, GR, etc.) 3135.6' GL	12. County Eddy

Check Appropriate Box To Indicate Nature of Notice, Report or Other Data  
NOTICE OF INTENTION TO:

PERFORM REMEDIAL WORK ☐ PLUG AND ABANDON ☐  
TEMPORARILY ABANDON ☐ CHANGE PLANS ☐  
PULL OR ALTER CASING ☐  
OTHER ☐

SUBSEQUENT REPORT OF:

REMEDIAL WORK ☐ ALTERING CASING ☐  
COMMENCE DRILLING OPNS. ☐ PLUG AND ABANDONMENT ☐  
CASING TEST AND CEMENT JOB ☒  
OTHER ☐

Describe Proposed or Completed Operations (Clearly state all pertinent details, and give pertinent dates, including estimated date of starting any proposed work) SEE RULE 1103.

5-10-84 WOC 18hrs. Ran 305 jts, 5 1/2"-17# & 20# N-80, total 12,052', DV tool @ 9655', FC @ 12,024', ran csg as follows:  
Float Shoe 1.67'  
1 jt 42.87' 5 1/2"- 20# N-80 Lt&C  
FC 1.37'  
56 jts 2365.61' 5 1/2"- 20# N-80 Lt&C  
DV Tool 3.05'  
22 jts 920.44' 5 1/2"- 20# N-80 Lt&C  
167 jts 6425.48' 5 1/2"- 17# N-80 Lt&C  
59 jts 2291.51' 5 1/2"- 17# N-80 Buttress  
18' KB  
12,070'

5-11-84 Release rig @ 6:00am 5-11-84. Cmt 1st stage w/925sx Class "H", .4% Halad-22A, .4% CFR-2, 3# KCl, 2% Lime, .1% HR-5, gas check, bumped plug at 1500psi, open DV tool @ 2600psi, open DV @ 9:45am 5-10-84, circ 25sx cmt. Cmt 2nd stage w/850sx Class "H", 50/50 Pozmix, .3% CFR-2, 625sx Class "H", .6% Halad-22A, .4% CFR-2, 2% Lime, 3# Kel, gas check. Plug down @ 5:45pm, lost circ during last 30min, bump plug @ 1500psi, test csg @ 2600psi, tested 30min, tested satisfactorily.

I hereby certify that the information above is true and complete to the best of my knowledge and belief.

SIGNED Bruce H. Hille TITLE Drilling & Production Manager DATE 5-14-84

Original Signed By  
Leslie A. Clements  
Superior District

APPROVED BY \_\_\_\_\_ TITLE \_\_\_\_\_ DATE MAY 16 1984

CONDITIONS OF APPROVAL, IF ANY:

NO. OF COPIES RECEIVED			
DISTRIBUTION			
SANTA FE	✓		
FILE	✓	✓	
U.S.G.S			
LAND OFFICE			
OPERATOR	✓		

RECEIVED BY  
O 8750 JUN 27 1984  
O. C. D.  
ARTESIA, OFFICE

5a. Indicate Type of Lease  
State ☐ Fee ☒

State Oil &amp; Gas Lease No.

(DO NOT USE THIS FORM FOR PROPOSALS TO DRILL OR TO DEEPEN OR PLUG BACK TO A DIFFERENT RESERVOIR. USE "APPLICATION FOR PERMIT-" (FORM C-101) FOR SUCH PROPOSALS.)

7. Unit Agreement Name

8. Farm or Lease Name  
Otis "33"

9. Well No.

### 10. Field and Pool, or Wildcat

Und. South Carlsbad Morrow

12. County  
Eddy

PERFORM REMEDIAL WORK  
TEMPORARILY ABANDON  
PULL OR ALTER CASING  
OTHER

## PLUG AND ABANDON CHANGE PLANS

REMEDIAL WORK  
COMMENCE DRILLING OPNS.  
CASING TEST AND CEMENT

## ALTERING CASING PLUG AND ABANDONMENT

OTHER Perforate and acidize

6-24-84 Perf 11,934'-11,951', 17', 2 shots/' , tripped in hole w/pkr, ran 387jts, 2 7/8" tbg, set pkr @ 11,830-24'.

6-26-84 TP 50psi, small flare, swbd, no fluid to SN @ 11,830', rec 50' fluid, acidized w/4000qals 7 1/2% Morflow acid, w/1000 SCF/N<sub>2</sub>, w/4 ball sealers, max 3.2 BPM, avg 2.72 BPM, max press 5200psi, avg 3240psi, ISIP 4200psi, 5min 3800psi, 135 BLTR, swbd 3hrs, SSG, FL @ 8300', recd 100 BBLs, 35 BLTR.

I hereby certify that the information above is true and complete to the best of my knowledge and belief.

**SIGNED**

Nicia Boardman

**TITLE****Production Clerk**

DATE 6-26-84

**APPROVED BY**

**TITLE**

Original Signed By  
Lois A. Clements  
Supervisor District II

DATE JUN 28 1984

CONDITIONS OF APPROVAL, IF ANY:

STATE OF NEW MEXICO  
ENERGY AND MINERALS DEPARTMENT

NO. OF COPIES RECEIVED	
DISTRIBUTION	
SANTA FE	<input checked="" type="checkbox"/>
FILE	<input checked="" type="checkbox"/>
U.S.G.S	
LAND OFFICE	
OPERATOR	<input checked="" type="checkbox"/>

OIL CONSERVATION DIVISION  
P.O. Box 2088  
SANTA FE, NEW MEXICO 87501

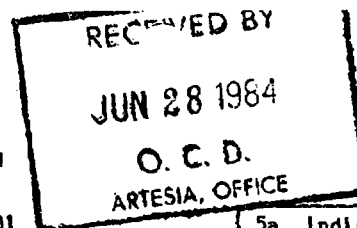

Form C-103  
Revised 10-1-78

SUNDRY NOTICES AND REPORTS ON WELLS (DO NOT USE THIS FORM FOR PROPOSALS TO DRILL OR TO DEEPEN OR PLUG BACK TO A DIFFERENT RESERVOIR, USE "APPLICATION FOR PERMIT-" (FORM C-101) FOR SUCH PROPOSALS.)		5a. Indicate Type of Lease State <input type="checkbox"/> Fee <input checked="" type="checkbox"/>
1. OIL <input type="checkbox"/> GAS <input checked="" type="checkbox"/> WELL <input checked="" type="checkbox"/> OTHER <input type="checkbox"/>		5. State Oil & Gas Lease No. -
2. Name of Operator Read & Stevens, Inc.		7. Unit Agreement Name -
3. Address of Operator P.O. Box 1518, Roswell, NM 88201		8. Farm or Lease Name Otis "33"
4. Location of Well UNIT LETTER <u>C</u> <u>990</u> FEET FROM THE <u>North</u> LINE AND <u>2130</u> FEET FROM THE <u>West</u> LINE. SECTION <u>33</u> TOWNSHIP <u>22S</u> RANGE <u>27E</u> NMPM		9. Well No. 2
5. Elevation (Show whether DF, RT, GR, etc.) 3135.6' GL		10. Field and Pool, or Wildcat Und. South Carlsbad Morrow
12. County Eddy		XXXXXX

Check Appropriate Box To Indicate Nature of Notice, Report or Other Data  
NOTICE OF INTENTION TO:

PERFORM REMEDIAL WORK ☐  
TEMPORARILY ABANDON ☐  
PULL OR ALTER CASING ☐  
OTHER ☐

PLUG AND ABANDON ☐  
CHANGE PLANS ☐

REMEDIAL WORK ☐  
COMMENCE DRILLING OPNS. ☐  
CASING TEST AND CEMENT JOB ☐  
OTHER ☒ Swabbing

ALTERING CASING ☐  
PLUG AND ABANDONMENT ☐

Describe Proposed or Completed Operations (Clearly state all pertinent details, and give pertinent dates, including estimated date of starting any proposed work) SEE RULE 1103.

6-27-84 TP 400psi, bled down, SSG, FL 6300', swbd 11 1/2hrs, rec 30 BLW, 5 BLTR, SION.

6-28-84 TP 100psi, bled down, SSG, 3' flare, FL 8700', swbd 10hrs, recd 5 BLW & 20 BBIs fm water.

I hereby certify that the information above is true and complete to the best of my knowledge and belief.

SIGNED Lucia Beardman TITLE Production Clerk DATE 6-28-84

Original Signed By

APPROVED BY Leslie A. Clements TITLE Supervisor District II DATE JUL 09 1984

CONDITIONS OF APPROVAL, IF ANY:



STATE OF NEW MEXICO  
ENERGY AND MINERALS DEPARTMENT

NO. OF COPIES RECEIVED	
DISTRIBUTION	
SANTA FE	<input checked="" type="checkbox"/>
FILE	<input checked="" type="checkbox"/>
U.S.G.S	<input type="checkbox"/>
LAND OFFICE	<input type="checkbox"/>
OPERATOR	<input checked="" type="checkbox"/>

OIL CONSERVATION DIVISION  
P.O. Box 2088  
SANTA FE, NEW MEXICO 87501

RECEIVED BY

JUL 11 1984

O. C. D.  
ARTESIA OFFICE

Form C-103  
Revised 10-1-78

5a. Indicate Type of Lease  
State ☐ Fee ☒

5. State Oil & Gas Lease No.

SUNDRY NOTICES AND REPORTS ON WELLS

(DO NOT USE THIS FORM FOR PROPOSALS TO DRILL OR TO DEEPEN OR PLUG BACK TO A DIFFERENT RESERVOIR. USE "APPLICATION FOR PERMIT-" (FORM C-101) FOR SUCH PROPOSALS.)

1. OIL WELL ☐ GAS WELL ☒ OTHER

2. Name of Operator  
Read & Stevens, Inc.

3. Address of Operator  
P.O. Box 1518, Roswell, NM 88201

4. Location of Well

UNIT LETTER C . 990 FEET FROM THE North LINE AND 2130 FEET FROM  
THE West LINE. SECTION 33 TOWNSHIP 22S RANGE 27E NMPM

5. Elevation (Show whether DF, RT, GR, etc.)  
3135.6' GL

7. Unit Agreement Name

8. Farm or Lease Name  
Otis #33"

9. Well No.  
2

10. Field and Pool, or Wildcat  
Und. South Carlsbad Morrow

12. County  
Eddy

Check Appropriate Box To Indicate Nature of Notice, Report or Other Data

NOTICE OF INTENTION TO:

PERFORM REMEDIAL WORK ☐ PLUG AND ABANDON ☐  
TEMPORARILY ABANDON ☐ CHANGE PLANS ☐  
PULL OR ALTER CASING ☐  
OTHER ☐

SUBSEQUENT REPORT OF:

REMEDIAL WORK ☐ ALTERING CASING ☐  
COMMENCE DRILLING OPNS. ☐ PLUG AND ABANDONMENT ☐  
CASING TEST AND CEMENT JOB ☐  
OTHER Perforate and run tubing ☒

Describe Proposed or Completed Operations (Clearly state all pertinent details, and give pertinent dates, including estimated date of starting any proposed work) SEE RULE 1103.

7-4-84 Ran 2 7/8" tbq w/Vannquins & Gulberson Uni IV pkr, set pkr @ 11,610.13', tested tbq @ 7000psi, test wellhead @ 4500psi, ran 380jts 2 7/8"-6.5#/' EUE, total 11,625.77'.

7-5-84 Dropped bar @ 7:15am, perfd, 11,761'-11,766', 5', 4 shots/1', .5" diam, 11,664'-11,680', 16', 4 shots/1', .5" diam, GTS in 4min, flwg @ 40psi, 48/64" chk, 800 MCF, 10:00am 250psi, 24/64" chk, 900 MCF, ran BHP Instruments.

I hereby certify that the information above is true and complete to the best of my knowledge and belief.

SIGNED Bruce Stalls TITLE Drilling and Production Manager DATE 7-5-84

APPROVED BY \_\_\_\_\_ TITLE Original Signed By  
Leslie A. Clements  
Supervisor District II

DATE JUL 13 1984

CONDITIONS OF APPROVAL, IF ANY:

## ENERGY AND MINERALS DEPARTMENT

Form C-103

Revised 10-1-78

NO. OF COPIES RECEIVED	
DISTRIBUTION	
SANTA FE	<input checked="" type="checkbox"/>
FILE	<input checked="" type="checkbox"/>
U.S.G.S	<input checked="" type="checkbox"/>
LAND OFFICE	<input checked="" type="checkbox"/>
OPERATOR	<input checked="" type="checkbox"/>

OIL CONSERVATION DIVISION  
P.O. Box 2088  
SANTA FE, NEW MEXICO 87501

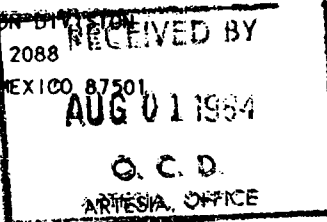

5a. Indicate Type of Lease  
State ☐ Fee ☒

5. State Oil & Gas Lease No.

## SUNDRY NOTICES AND REPORTS ON WELLS

(DO NOT USE THIS FORM FOR PROPOSALS TO DRILL OR TO DEEPEN OR PLUG BACK TO A DIFFERENT RESERVOIR. USE "APPLICATION FOR PERMIT-" (FORM C-101) FOR SUCH PROPOSALS.)

1. OIL WELL <input type="checkbox"/>	GAS WELL <input checked="" type="checkbox"/>	OTHER	7. Unit Agreement Name
2. Name of Operator Read & Stevens, Inc. ✓			8. Farm or Lease Name Otis "33"
3. Address of Operator P.O. Box 1518, Roswell, NM 88201			9. Well No. 2
4. Location of Well  UNIT LETTER <u>C</u> . <u>990</u> FEET FROM THE <u>North</u> LINE AND <u>2130</u> FEET FROM THE <u>West</u> LINE. SECTION <u>33</u> TOWNSHIP <u>22S</u> RANGE <u>27E</u> NMPM			10. Field and Pool, or Wildcat Und. South Carlsbad Morrow
5. Elevation(Show whether DF,RT,GR,etc.) 3135.6' GL			12. County Eddy

Check Appropriate Box To Indicate Nature of Notice, Report or Other Data

## NOTICE OF INTENTION TO:

PERFORM REMEDIAL WORK ☐ PLUG AND ABANDON ☐  
TEMPORARILY ABANDON ☐ CHANGE PLANS ☐  
PULL OR ALTER CASING ☐  
OTHER ☐

## SUBSEQUENT REPORT OF:

REMEDIAL WORK ☐ ALTERING CASING ☐  
COMMENCE DRILLING OPNS. ☐ PLUG AND ABANDONMENT ☐  
CASING TEST AND CEMENT JOB ☐  
OTHER Acidize and run tubing ☒

Describe Proposed or Completed Operations(Clearly state all pertinent details, and give pertinent dates, including estimated date of starting any proposed work) SEE RULE 1103.

7-28-84 Acidize w/4000gals 7 1/2% Morrowflo acid w/60 ball sealers, rate w/acid 3.6 BPM, total w/N<sub>2</sub> 5.3 BPM, avg press 6000psi, max 6200psi, no ball action, ISIP 4900psi, 11,558.3'  
5min 3800psi, 10min 3500psi, 95 BBLs acid, 49.3 BBLs flush, total 143.2 BLW, 2.0'  
started flwg back @ 10:00am, flwd 7 hrs, cleaned up @ 5:00pm, flwg 1800psi on 6.12'  
18/64" chk, 3.5 MMCF, SI 19min, TP 3050psi, still building, ran 381jts 2 7/8" 11,566.42'  
fbq, 6.5#, N-80 8Rd, EUE fbq, 11,558.3', on-off tool w/2.250" profile, Gulberson  
Uni VI pkr.

7-29-84 Flwd 8hrs, SI TP 3900psi-1750psi, 16/64" chk, 2.5 MMCF, 8 BLW, ran BHP instruments, SI 72hrs for build-up & 4pt test.

I hereby certify that the information above is true and complete to the best of my knowledge and belief.

SIGNED Bruce Stodd TITLE Drilling and Production Manager DATE 7-30-84

APPROVED BY Original Signed By TITLE Lelia A. Clements DATE AUG 2 1984

CONDITIONS OF APPROVAL, IF ANY: Supervisor District II



Donald L. Wallace  
President

Read & Stevens, Inc.  
P. O. Box 1518  
Roswell, NM 88201

Attn: Mr. Bruce Stubbs

# SIERRA DRILLING COMPANY

P. O. Box 2681

Midland, Texas 79702

(915) 563-3477

RECEIVED BY

AUG 21 1984

O. C. D.  
ARTESIA, OFFICE

Re: Otis #33

Dear Mr. Stubbs:

The following is a Deviation Survey for the above referenced well located in Eddy County, New Mexico.

206 - 1/4	6700 - 1 3/4
740 - 3/4	6947 - 2 1/2
1324 - 1	7048 - 2
1640 - 1 3/4	7292 - misrun
1953 - 1 3/4	7513 - 1
2200 - 1 1/2	7987 - 3/4
2523 - 1 1/2	8462 - 1
2999 - 1 1/2	8755 - 1
3500 - 1 1/4	9251 - 3/4
3980 - 1	9886 - 1
4230 - 1 1/4	10,365 - 1 3/4
4485 - 1	10,790 - 1 3/4
4999 - 1	11,321 - 4 1/4 -
5480 - 1/2	11,400 - 3 1/2
5968 - 1	11,715 - 1
6443 - 2	11,757 - 1 3/4

Sincerely,

*Garry L. Flynn*  
Garry L. Flynn  
Drilling Superintendent

GLF/jc

STATE OF TEXAS )  
COUNTY OF MIDLAND)

The foregoing was acknowledged before me this 6th day of May, 1984.

My commission expires 12/23/85.

*Milly Wilson*  
Milly Wilson  
Notary Public

Notary Public  
My Comm. Expires 12/23/85

5/11/85

## ENERGY AND MINERALS DEPARTMENT

OIL CONSERVATION DIVISION

P.O. BOX 2088

SANTA FE, NEW MEXICO AUG 27 1984

Form C-105

Revised 10-1-78

NO. OF COPIES RECEIVED	
SANTA FE	<input checked="" type="checkbox"/>
FILE	<input checked="" type="checkbox"/>
U.S.G.S.	<input checked="" type="checkbox"/>
LAND OFFICE	<input checked="" type="checkbox"/>
OPERATOR	<input checked="" type="checkbox"/>

WELL COMPLETION OR RECOMPLETION REPORT AND LOG  
ARTESIA, OFFICE

5a. Indicate Type of Lease

State ☐ Fee ☒

5. State Oil &amp; Gas Lease No.

XXXXXXXXXXXXXXXXXXXXXXXXXXXX  
XXXXXXXXXXXXXXXXXXXXXXXXXXXX

7. Unit Agreement Name

8. Farm or Lease Name

Otis "33"

9. Well No.

2

10. Field and Pool, or Wildcat  
and South Carlsbad MorrowXXXXXXXXXXXXXXXXXXXXXXXXXXXX  
XXXXXXXXXXXXXXXXXXXXXXXXXXXX12. County  
Eddy

1a. TYPE OF WELL

Oil

GAS

WELL ☐WELL ☒DRY ☐OTHER ☐

b. TYPE OF COMPLETION

NEW WORK

PLUG

DIFF.

WELL ☒OVER ☐DEEPEN ☐BACK ☐RESVR. ☐OTHER ☐

2. Name of Operator

Read &amp; Stevens, Inc.

3. Address of Operator

P.O. Box 1518, Roswell, NM 88201

4. Location of Well

UNIT LETTER E LOCATED 2130 FEET FROM THE West LINE AND 990 FEET FROM

THE North LINE OF SEC. 33 TWP. 22S RGE. 27E NMPM

XXXXXXXXXXXXXXXXXXXXXXXXXXXX

12. County  
Eddy

XXXXXXXXXXXXXXXXXXXXXXXXXXXX

15. Date Spudded

3-29-84

16. Date T.D. Reached

5-7-84

17. Date Comp. (Ready to Prod.)

7-31-84

18. Elevations (DF, RKB, RT, GR, etc.)

-3107' GL 2155.6'

19. Elev. Casinghead

-

20. Total Depth

12,070'

21. Plug Back T.D.

11,870'

22. If Multiple Compl., How Many

-

23. Intervals

Drilled By

Rotary Tools

0'-12,070'

Cable Tools

-

24. Producing Interval(s), of this completion-Top, Bottom, Name

11,664'-11,680', 11,761'-11,766'

Morrow

25. Was Directional Survey

Made

No

26. Type Electric and Other Logs Run

DLL, MLL, GR, CNL, FDC, SONIC

27. Was Well Cored

No

28. CASING RECORD (Report all strings set in well)

CASING SIZE	WEIGHT LB./FT.	DEPTH SET	HOLE SIZE	CEMENTING RECORD	AMOUNT PULLED
13 3/8"	54.5#	443'	17 1/2"	475sx	Circ. 136sx
9 5/8"	40#	5480'	12 1/4"	1900sx	Circ. 300sx
5 1/2"	17# & 20#	12052'	7 7/8"	2400sx	None

29.

LINER RECORD

SIZE	TOP	BOTTOM	SACKS CEMENT	SCREEN

30.

TUBING RECORD

SIZE	DEPTH SET	PACKER SET
2 7/8"	9301.36'	11830.24'
2 7/8"	11625.77'	11610.13'

31. Perforation Record (Interval, size and number)

11934'-11951', 17', 2 shots/'

11761'-11766', 5', 4 shots/'

11664'-11680', 16', 4 shots/'

32. ACID, SHOT, FRACTURE, CEMENT SQUEEZE, ETC.

DEPTH INTERVAL	AMOUNT AND KIND MATERIAL USED
11934'-11951'	Acidize w/4000gals 7 1/2% Morrow
	acid w/1000 SCFN <sub>2</sub> w/4 ball sealers
11664'-11766'	Acidize w/4000gals 7 1/2% Morrow
	acid w/60 ball sealers

33.

PRODUCTION

Date First Production		Production Method (Flowing, gas lift, pumping-Size and type pump)				Well Status (Prod. or Shut-in)	
7-28-84		Flowing -				SI WOPL	
Date of Test	Hours Tested	Choke Size	Prod'n For	Oil-Bbl.	Gas-MCF	Water-Bbl.	Gas-Oil Ratio
7-31-84	4	5/64"-10/64"	Test Period	-	CAOF 3870	-	-
Flow Tubing Press.	Casing Pressure	Calculated 24-	Oil-Bbl.	Gas-MCF	Water-Bbl.	Oil Gravity-API (Corr.)	
3645psi-2740psi	-	Hour Rate	-	CAOF 3870	-	-	

34. Disposition of Gas (Sold, used for fuel, vented, etc.)

SI WOPLC

Test Witnessed By

Daryl Lowder

35. List of Attachments

Logs, Deviation Survey

36. I hereby certify that the information shown on both sides of this form is true and complete to the best of my

knowledge and belief

SIGNED

*[Signature]*

TITLE Drilling &amp; Production Manager

DATE 5-17-84

### INSTRUCTIONS

This form is to be filed with the appropriate District Office of the Commission not later than 20 days after the completion of any newly-drilled or deepened well. It shall be accompanied by one copy of all electrical and radio-activity logs run on the well and a summary of all special tests conducted, including drill stem tests. All depths reported shall be measured depths. In the case of directionally drilled wells, true vertical depths shall also be reported. For multiple completions, items 30 through 34 shall be reported for each zone. The form is to be filed in quintuplicate except on state land, where six copies are required. See Rule 1105.

INDICATE FORMATION TOPS IN CONFORMANCE WITH GEOGRAPHICAL SECTION OF STATE

### Southeastern New Mexico

## Northwestern New Mexico

T. Anhy	T. Canyon 9640'	T. Ojo Alamo	T. Penn. "B"
T. Salt	T. Strawn 10279	T. Kirtland-Fruitland	T. Penn. "C"
B. Salt	T. Atoka 10760	T. Pictured Cliffs	T. Penn. "D"
T. Yates	T. Miss	T. Cliff House	T. Leadville
T. 7 Rivers	T. Devonian	T. Menefee	T. Madison
T. Queen	T. Silurian	T. Point Lookout	T. Elbert
T. Grayburg	T. Montoya	T. Mancos	T. McCracken
T. San Andres	T. Simpson	T. Gallup	T. Ignacio Qtzite
T. Glorieta	T. McKee	Base Greenhorn	T. Granite
T. Paddock	T. Ellenburger	T. Dakota	T.
T. Blinberry	T. Gr. Wash	T. Morrison	T.
T. Tubb	T. Granite	T. Todlito	T.
T. Drinkard	T. Delaware Sand	T. Entrada	T.
T. Abo	T. Bone Springs	T. Wingate	T.
T. Wolfcamp 8818'	T.	T. Chinle	T.
T. Penn.	T.	T. Permian	T.
T. Cisco (BoughC)	T.	T. Penn. "A"	T.

## OIL OR GAS SAND OR ZONES

No. 1, from ..... to ..... No. 4, from ..... to .....  
No. 2, from ..... to ..... No. 5, from ..... to .....  
No. 3, from ..... to ..... No. 6, from ..... to .....

## IMPORTANT WATER SANDS

Include data on rate of water inflow and elevation to which water rose in hole.

No. 1, from ..... to ..... feet .....

No. 2, from ..... to ..... feet .....

No. 3, from ..... to ..... feet .....

No. 4, from ..... to ..... feet .....

**FORMATION RECORD** (Attach additional sheets if necessary)

From	To	Thickness In Feet	Formation	From	To	Thickness In Feet	Formation



C/S  
RLM

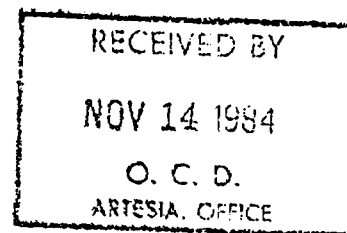

NEW MEXICO  
OIL CONSERVATION DIVISION  
P. O. DRAWER DD  
ARTESIA, NEW MEXICO  
88210

Date November 12, 1984

NOTICE OF LLANO'S GAS CONNECTION:

OPERATOR: READ & STEVENS  
LEASE: OTIS "33"  
WELL NUMBER AND UNIT: 2 C  
LOCATION: 33-22S-27E  
POOL: ~~UNDESIGNATED~~ SOUTH CARLSBAD MORROW  
DATE WELL CONNECTED: NOVEMBER 9, 1984  
DATE OF FIRST GAS SALES: NOVEMBER 9, 1984 11:30 AM  
LLANO'S STATION NUMBER: 384

LLANO, INC.  
TRANSPORTER

  
REPRESENTATIVE  
AL KLAAR

VICE PRESIDENT  
TITLE

xc: Oil Conservation Division, Box 2088, Santa Fe, New Mexico 87501

NO. OF COPIES RECEIVED		
DISTRIBUTION		
SANTA FE	<input checked="" type="checkbox"/>	<input checked="" type="checkbox"/>
FILE	<input checked="" type="checkbox"/>	<input checked="" type="checkbox"/>
U.S.G.S.		
LAND OFFICE		
TRANSPORTER	OIL <input checked="" type="checkbox"/>	GAS <input checked="" type="checkbox"/>
OPERATOR	<input checked="" type="checkbox"/>	
PRORATION OFFICE		

NEW MEXICO CONSERVATION COMMISSION  
REQUEST FOR ALLOWABLE  
AND  
AUTHORIZATION TO TRANSPORT OIL AND NATURAL GAS

Form C-104  
Supersedes Old C-104 and C-10  
Effect **RECEIVED BY**  
**OCT 18 1984**  
O. C. D.  
ARTESIA, OFFICE

Operator  
Read & Stevens, Inc.  
Address  
P.O. Box 1518, Roswell, NM 88201  
Reason(s) for filling (Check proper box) Other (Please explain)  
New Well ☒ Change in Transporter Of:  
Recompletion ☐ Oil ☐ Dry Gas ☐  
Change in Ownership ☐ Casinghead Gas ☐ Condensate ☐

If change of ownership give name and address of previous owner

I. DESCRIPTION OF WELL AND LEASE

Lease Name Otis "33"	Well No. 2	Pool Name, including Formation <del>Unit</del> South Carlsbad Morrow	Kind of Lease Fee	Lease No. -
Location Unit Letter <u>C</u> ; 2130 Feet From The <u>West</u> Line and 990 Feet From The <u>North</u> Line Of Section 33 Township 22S Range 27E, NMPM, Eddy County				

II. DESCRIPTION OF TRANSPORTER OF OIL AND NATURAL GAS

Name of Authorized Transporter of Oil <input type="checkbox"/> or Condensate <input checked="" type="checkbox"/> Koch Oil Company	Address (Give address to which approved copy of this form is to be sent) P.O. Box 2256 Wichita, KS 67201
Name of Authorized Transporter of Casinghead Gas <input type="checkbox"/> Dry Gas <input checked="" type="checkbox"/> Llano, Inc.	Address (Give address to which approved copy of this form is to be sent) P.O. Drawer 1320 Hobbs, NM 88240
If well produces oil or liquids, give location of tanks	Unit <u>C</u> Sec. <u>33</u> Twp. <u>22S</u> Rge. <u>27E</u> Is gas actually connected? <u>yes</u> When <u>10-25-84 11-9-84</u>

If this production is commingled with that from any other lease or pool, give commingling order number:

III. COMPLETION DATA

Designate Type of Completion-(X)	Oil Well <input type="checkbox"/>	Gas Well <input checked="" type="checkbox"/>	New Well <input checked="" type="checkbox"/>	Workover <input type="checkbox"/>	Deepen <input type="checkbox"/>	Plug Back <input type="checkbox"/>	Same Res'v <input type="checkbox"/>	Diff. Res'v <input type="checkbox"/>
Date Spudded 3-29-84	Date Compl. Ready to Prod 7-31-84	Total Depth 12,070'			P.B.T.D. 11,870'			
Elevations (DF, RKB, RT, GR, etc) 3107 GL	Name of Prod. Formation Morrow	Top Oil/Gas Pay 11,664'			Tubing Depth 11,626'			
Perforations 11,664'-11,680', 11,761'-11,766'					Depth Casing Shoe 12,070'			
TUBING, CASING, AND CEMENTING RECORD								
HOLE SIZE	CASING & TUBING SIZE		DEPTH SET		SACKS CEMENT			
17 1/2"	15 3/8"		443'		475sx			
12 1/4"	9 5/8"		5480'		1900sx			
7 7/8"	5 1/2"		12,052'		2400sx			
-	2 7/8"		11,626'		-			

IV. TEST DATA AND REQUEST FOR ALLOWABLE (Test must be after recovery of total volume of load and must be equal to or exceed top allowable for this depth or be for full 24 hours)

Date First New Oil Run To Tanks:	Date of Test	Producing Method (Flow, pump, gas lift, etc.)	
Length of Test	Tubing Pressure	Casing Pressure	Choke Size
Actual Prod. During Test	Oil-Bbls.	Water-Bbls.	Gas-MCF

GAS WELL

Actual Prod. Test-MCF/D 3870 CAOF	Length of Test 4 hrs	Bbls. Condensate/MMCF -	Gravity of Condensate -
Testing Method (pitot, back pr) 4 Point Test	Tubing Pressure (Shut-In) 3900psi	Casing Pressure (Shut-In) 2600psi	Choke Size 5/64"

CERTIFICATE OF COMPLIANCE

I hereby certify that the rules and regulations of the Oil Conservation Commission have been complied with and that the information given above is true and complete to the best of my knowledge and belief.

*B. A. Stevens*  
(Signature)

Drilling & Production Manager  
(Title)

10-17-84  
(Date)

OIL CONSERVATION COMMISSION

APPROVED **NOV 16 1984**  
BY \_\_\_\_\_ Original Signed By \_\_\_\_\_  
TITLE \_\_\_\_\_ Supervisor District II

This form is to be filed in compliance with Rule 1104.  
If this is a request for allowable for a newly drilled well, this form must be accompanied by a tabulation of the deviation tests taken on the well in accordance with Rule 111.  
All sections of this form must be filled out completely for allowable on new and recompleted wells.  
Fill out only Sections I, II, III, and VI for changes of owner, well name or number, or transporter, or other such

changes of conditions must be filled for each pool in multiplicity.

Submit to Appropriate  
District Office  
State Lease - 6 copies  
Fee Lease - 5 copies

State of New Mexico  
Energy, Minerals and Natural Resources Department

Form C-101  
Revised 1-1-89

455  
10

OIL CONSERVATION DIVISION

P.O. Box 2088  
Santa Fe, New Mexico 87504-2088

DISTRICT I  
P.O. Box 1980, Hobbs, NM 88240

DISTRICT II  
P.O. Drawer DD, Artesia, NM 88210

DISTRICT III  
1000 Rio Brazos Rd., Aztec, NM 87410

API NO. (assigned by OCD on New Wells)

5. Indicate Type of Lease

STATE ☐

FEE ☒

6. State Oil & Gas Lease No.

7. Lease Name or Unit Agreement Name

Otis 33

8. Well No.

2

9. Pool name or Wildcat

Und South Carlsbad Strawn

1a. Type of Work:

DRILL ☐

RE-ENTER ☐

DEEPEN ☐

PLUG BACK ☒

b. Type of Well:

OIL

WELL ☐

GAS

WELL ☒

OTHER

SINGLE

ZONE ☒

MULTIPLE

ZONE ☐

2. Name of Operator

Read & Stevens, Inc.

3. Address of Operator

P. O. Box 1518 Roswell, NM 88201

4. Well Location

Unit Letter C : 990 Feet From The North Line and 2130 Feet From The West Line

Section 33

Township 22S

Range 27E

NMPM

Eddy

County

10. Proposed Depth

10,400'

11. Formation

Strawn

12. Rotary or C.T.

Rotary

13. Elevations (Show whether DF, RT, GR, etc.)

3135.6'

14. Kind & Status Plug Bond

Statewide

15. Drilling Contractor

16. Approx. Date Work will start

December 20, 1992

17. PROPOSED CASING AND CEMENT PROGRAM

SIZE OF HOLE	SIZE OF CASING	WEIGHT PER FOOT	SETTING DEPTH	SACKS OF CEMENT	EST. TOP
17 1/2"	13 3/8"	54.7#	443'	425 sx	Circ
12 1/4"	9 5/8"	40#	5,480'	1800 sx	Circ
7 7/8"	5 1/2"	17# & 20#	12,070'	1325 sx	5,800'

Read & Stevens proposes to plug back from the Morrow formation and perforate and test the Strawn interval. The Morrow perforations will be plugged by setting a cast iron bridge plug @ 11,750' and placing 2 sx of cmt on top with a wireline dump bailor. 2 7/8" tbg will be run and a pkr set @ 10,400', and the Strawn will be perforated under balanced in the gross interval from 10,500' to 10,600'. The well will be flow tested and if warranted acid stimulated. A double ram manual BOP will be used throughout the workover operation.

APPROVAL VALID FOR 180 DAYS

PERMIT EXPIRES 6-23-93

UNLESS DRILLING UNDERWAY

IN ABOVE SPACE DESCRIBE PROPOSED PROGRAM: IF PROPOSAL IS TO DEEPEN OR PLUG BACK, GIVE DATA ON PRESENT PRODUCTIVE ZONE AND PROPOSED NEW PRODUCTIVE ZONE. GIVE BLOWOUT PREVENTER PROGRAM, IF ANY.

I hereby certify that the information above is true and complete to the best of my knowledge and belief.

SIGNATURE

John C. Maxey, Jr.

TITLE

Petroleum Engineer

DATE

12-16-92

TYPE OR PRINT NAME

TELEPHONE NO 505-622-37

(This space for State Use)

APPROVED BY

Mark R. Rilling

TITLE

DATE

DEC 23 1992

CONDITIONS OF APPROVAL, IF ANY:

\* AS NOTED ABOVE

Submit to Appropriate  
District Office  
State Lease - 4 copies  
Fee Lease - 3 copies

State of New Mexico  
Energy, Minerals and Natural Resources Department

Form C-102  
Revised 1-1-89

**OIL CONSERVATION DIVISION**

P.O. Box 2088

Santa Fe, New Mexico 87504-2088

**DISTRICT I**  
P.O. Box 1980, Hobbs, NM 88240

**DISTRICT II**  
P.O. Drawer DD, Artesia, NM 88210

**DISTRICT III**  
1000 Rio Brazos Rd., Aztec, NM 87410

**WELL LOCATION AND ACREAGE DEDICATION PLAT**

All Distances must be from the outer boundaries of the section

Operator Read & Stevens, Inc.			Lease Otis 33		Well No. 2
Unit Letter C	Section 33	Township 22 South	Range 27 East	County NMPM	Eddy
Actual Footage Location of Well: 990 feet from the North line and 2130 feet from the West line					
Ground level Elev. 3135.6	Producing Formation Strawn		Pool Und. South Carlsbad Strawn	Dedicated Acreage: 320 Acres	

1. Outline the acreage dedicated to the subject well by colored pencil or hatchure marks on the plat below.
2. If more than one lease is dedicated to the well, outline each and identify the ownership thereof (both as to working interest and royalty).
3. If more than one lease of different ownership is dedicated to the well, have the interest of all owners been consolidated by communitization, unitization, force-pooling, etc.?  
☒ Yes ☐ No If answer is "yes" type of consolidation Fee acreage  
If answer is "no" list the owners and tract descriptions which have actually been consolidated. (Use reverse side of this form if necessary.)  
No allowable will be assigned to the well until all interests have been consolidated (by communitization, unitization, forced-pooling, or otherwise) or until a non-standard unit, eliminating such interest, has been approved by the Division.

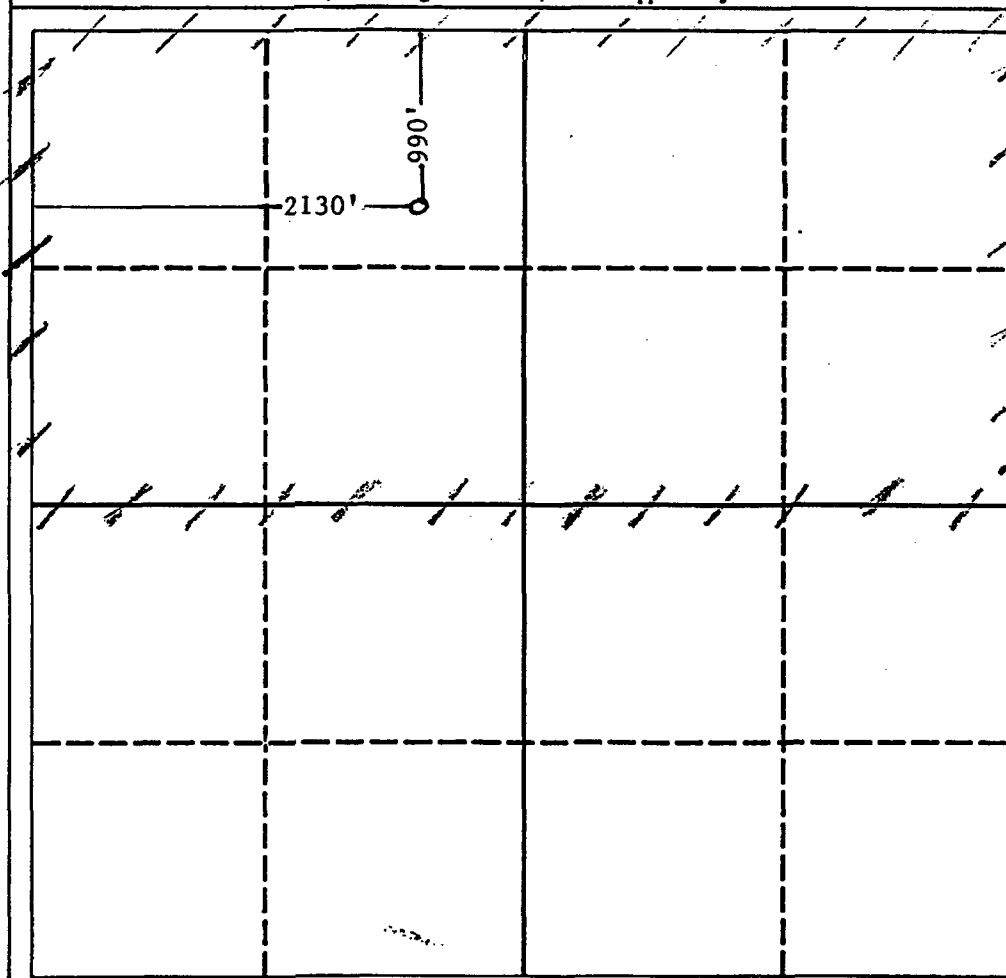

**OPERATOR CERTIFICATION**

I hereby certify that the information contained herein is true and complete to the best of my knowledge and belief.

Signature  
*John C. Maxey, Jr.*  
Printed Name  
John C. Maxey, Jr.  
Position  
Engineer  
Company  
Read & Stevens, Inc.  
Date  
December 16, 1992

**SURVEYOR CERTIFICATION**

I hereby certify that the well location shown on this plat was plotted from field notes of actual surveys made by me or under my supervision, and that the same is true and correct to the best of my knowledge and belief.

Date Surveyed  
Signature & Seal of Professional Surveyor  
Certificate No.

0 330 660 990 1320 1650 1980 2310 2640 2000 1500 1000 500 0

Submit 3 Copies  
to Appropriate  
District Office

State of New Mexico  
Energy, Minerals and Natural Resources Department

Form C-103  
Revised 1-1-89

DISTRICT I  
P.O. Box 1980, Hobbs, NM 88240

DISTRICT II  
P.O. Drawer DD, Artesia, NM 88210

DISTRICT III  
1000 Rio Brazos Rd., Aztec, NM 87410

OIL CONSERVATION DIVISION  
P.O. Box 2088  
Santa Fe, New Mexico 87504-2088  
RECEIVED

WELL API NO.
5. Indicate Type of Lease STATE <input type="checkbox"/> FEE <input checked="" type="checkbox"/>
6. State Oil & Gas Lease No.
7. Lease Name or Unit Agreement Name  Otis 33
8. Well No. #2
9. Pool name or Wildcat Und South Carlsbad Strawn
10. Elevation (Show whether DF, RKB, RT, GR, etc.) 3135.6'

SUNDRY NOTICES AND REPORTS ON WELLS  
(DO NOT USE THIS FORM FOR PROPOSALS TO DRILL OR TO DEEPEN OR PLUG BACK TO A  
DIFFERENT RESERVOIR. USE "APPLICATION FOR PERMIT"  
(FORM C-101) FOR SUCH PROPOSALS.)

1. Type of Well: OIL WELL <input type="checkbox"/> GAS WELL <input checked="" type="checkbox"/> OTHER
2. Name of Operator Read & Stevens, Inc.
3. Address of Operator P. O. Box 1518 Roswell, NM 88202
4. Well Location Unit Letter C : 990 Feet From The North Line and 2130 Feet From The West Line Section 33 Township 22S Range 27E NMPM Eddy County
10. Elevation (Show whether DF, RKB, RT, GR, etc.) 3135.6'

11. Check Appropriate Box to Indicate Nature of Notice, Report, or Other Data	
NOTICE OF INTENTION TO:	SUBSEQUENT REPORT OF:
PERFORM REMEDIAL WORK <input type="checkbox"/>	REMEDIAL WORK <input type="checkbox"/>
TEMPORARILY ABANDON <input type="checkbox"/>	ALTERING CASING <input type="checkbox"/>
PULL OR ALTER CASING <input type="checkbox"/>	COMMENCE DRILLING OPNS. <input type="checkbox"/>
OTHER: <input type="checkbox"/>	PLUG AND ABANDONMENT <input type="checkbox"/>
	CASING TEST AND CEMENT JOB <input type="checkbox"/>
	OTHER: Recompletion to the Strawn <input checked="" type="checkbox"/>

12. Describe Proposed or Completed Operations (Clearly state all pertinent details, and give pertinent dates, including estimated date of starting any proposed work) SEE RULE 1103.

MIRUPU on 12-18-92 to recompleate subject well to the Strawn. Attempt to release pkr and could not, release on-off tool and POH w/ tbg, set a CIBP @ 11,500' and dump 2 sx of cmt on top. RIH w/ 2 3/8" tbg and Guiberson UNI VI pkr and set pkr @ 10,403'. NDBOP, NUWH, perforate Strawn from 10,514' to 10,590' (gross interval). Acidize w/ 5,000 gal of 15% NEFE w/ 1,200 cu ft/bbl of nitrogen. Flow and swab test well, gas production non-commercial. RDMOPU. Well shut-in for pressure build up.

I hereby certify that the information above is true and complete to the best of my knowledge and belief.

SIGNATURE John C. Maxey, Jr. TITLE Petroleum Engineer DATE 1-18-93  
TYPE OR PRINT NAME John C. Maxey, Jr. TELEPHONE NO. 505-622-3770

(This space for State Use)

ORIGINAL SIGNED BY  
MIKE WILLIAMS

JAN 29 1993

APPROVED BY SUPERVISOR, DISTRICT II TITLE  DATE   
CONDITIONS OF APPROVAL, IF ANY:



DISTRICT I  
P.O. Box 1980, Hobbs, NM 88240

DISTRICT II  
P.O. Drawer DD, Artesia, NM 88210

DISTRICT III  
1000 Rio Brazos Rd., Aztec, NM 87410

OIL CONSERVATION DIVISION  
P.O. Box 2088  
Santa Fe, New Mexico 87504-2088

WELL API NO. 30-015-24810
5. Indicate Type of Lease STATE <input type="checkbox"/> FEE <input checked="" type="checkbox"/>
6. State Oil & Gas Lease No.
7. Lease Name or Unit Agreement Name Otis "33"
8. Well No. #2
9. Pool name or Wildcat Carlsbad Morrow South
10. Elevation (Show whether DF, RKB, RT, GR, etc.) 3135.6 GR

SUNDRY NOTICES AND REPORTS ON WELLS  
(DO NOT USE THIS FORM FOR PROPOSALS TO DRILL OR TO DEEPEN OR PLUG BACK TO A  
DIFFERENT RESERVOIR. USE "APPLICATION FOR PERMIT"  
(FORM C-101) FOR SUCH PROPOSALS.)

1. Type of Well: OIL WELL <input type="checkbox"/> GAS WELL <input checked="" type="checkbox"/> OTHER
2. Name of Operator Read & Stevens, Inc.
3. Address of Operator P. O. Box 1518, Roswell, New Mexico 88202-1518
4. Well Location Unit Letter C : 990' Feet From The North Line and 2130' Feet From The West Line Section 33 Township 22S Range 27E NMPM Eddy County

11. Check Appropriate Box to Indicate Nature of Notice, Report, or Other Data	
NOTICE OF INTENTION TO:	SUBSEQUENT REPORT OF:
PERFORM REMEDIAL WORK <input type="checkbox"/>	REMEDIAL WORK <input type="checkbox"/>
TEMPORARILY ABANDON <input type="checkbox"/>	ALTERING CASING <input type="checkbox"/>
PULL OR ALTER CASING <input type="checkbox"/>	COMMENCE DRILLING OPNS. <input type="checkbox"/>
OTHER: <input type="checkbox"/>	PLUG AND ABANDONMENT <input type="checkbox"/>
	CASING TEST AND CEMENT JOB <input type="checkbox"/>
	OTHER: <input type="checkbox"/>

12. Describe Proposed or Completed Operations (Clearly state all pertinent details, and give pertinent dates, including estimated date of starting any proposed work) SEE RULE 1103.

Read & Stevens proposes to plug & abandon the subject well by setting plugs as follows:

CIBP set @10,200' (Above Strawn) w/2 3/4" cem on top.  
200' cem plug f/8,900-8,700' (Top of Wolfcamp)  
150' cem plug half in & half out of the 5 1/2" csg stub @5,500'  
\*100' cem plug f/2,600-2,500'  
\*100' cem plug f/500-400' (13 3/8" csg shoe) - (TAG)  
50' surf plug.

Install dry hole marker & reclaim location.

\* 100' cem plug 1700-1600'

I hereby certify that the information above is true and complete to the best of my knowledge and belief.

SIGNATURE John C. Maxey Jr. TITLE Petroleum Engineer DATE March 14, 1995

TYPE OR PRINT NAME John C. Maxey Jr. TELEPHONE NO. 505-622-3770

(This space for State Use)

ORIGINAL SIGNED BY TIM W. GILMAN  
DISTRICT II SUPERVISOR

APPROVED BY \_\_\_\_\_ TITLE \_\_\_\_\_ DATE MAR 23 1995

CONDITIONS OF APPROVAL, IF ANY:

DISTRICT I  
P.O. Box 1980, Hobbs, NM 88240

DISTRICT II  
P.O. Drawer DD, Artesia, NM 88210

DISTRICT III  
1000 Rio Brazos Rd., Aztec, NM 87410

# CONSERVATION DIVISION

P.O. Box 2088  
Santa Fe, New Mexico 87504-2088

WELL API NO. 30-015-24810
5. Indicate Type of Lease STATE <input type="checkbox"/> FEE <input checked="" type="checkbox"/>
6. State Oil & Gas Lease No.
7. Lease Name or Unit Agreement Name  Otis "33"
8. Well No. #2
9. Pool name or Wildcat Carlsbad Morrow South
10. Elevation (Show whether DF, RKB, RT, GR, etc.) 3135.6 GR

## SUNDRY NOTICES AND REPORTS ON WELLS (DO NOT USE THIS FORM FOR PROPOSALS TO DRILL OR TO DEEPEN OR PLUG BACK TO A DIFFERENT RESERVOIR. USE "APPLICATION FOR PERMIT" (FORM C-101) FOR SUCH PROPOSALS.)

1. Type of Well: OIL WELL <input type="checkbox"/> GAS WELL <input checked="" type="checkbox"/> OTHER <input checked="" type="checkbox"/>	2. Name of Operator Read & Stevens, Inc.
3. Address of Operator P. O. Box 1518, Roswell, New Mexico 88202-1518	4. Well Location Unit Letter <u>C</u> : <u>990'</u> Feet From The <u>North</u> Line and <u>2130'</u> Feet From The <u>West</u> Line Section <u>33</u> Township <u>22S</u> Range <u>27E</u> NMPM <u>Eddy</u> County
10. Elevation (Show whether DF, RKB, RT, GR, etc.) 3135.6 GR	

### 11. Check Appropriate Box to Indicate Nature of Notice, Report, or Other Data

#### NOTICE OF INTENTION TO:

PERFORM REMEDIAL WORK ☐ PLUG AND ABANDON ☒  
 TEMPORARILY ABANDON ☐ CHANGE PLANS ☐  
 PULL OR ALTER CASING ☐  
 OTHER: ☐

#### SUBSEQUENT REPORT OF:

REMEDIAL WORK ☐ ALTERING CASING ☐  
 COMMENCE DRILLING OPNS. ☐ PLUG AND ABANDONMENT ☐  
 CASING TEST AND CEMENT JOB ☐  
 OTHER: ☐

### 12. Describe Proposed or Completed Operations (Clearly state all pertinent details, and give pertinent dates, including estimated date of starting any proposed work) SEE RULE 1103.

Read & Stevens proposes to plug & abandon the subject well by setting plugs as follows:

35' ✓  
 CIBP set @10,200' (Above Strawn) w/2" ~~sc~~ cem on top.  
 200' cem plug f/8,900-8,700' (Top of Wolfcamp) ✓  
 150' cem plug half in & half out of the 5 1/2" csg stub @5,500' (Tag)  
 \* 100' cem plug f/2,600-2,500' ✓  
 \* 100' cem plug f/500-400' (13 3/8" csg shoe) (Tag)  
 50' surf plug.

Install dry hole marker & reclaim location.

\* 100' cem plug f/1700-1600' ✓

witness csg. stub & shoe plug.

I hereby certify that the information above is true and complete to the best of my knowledge and belief.

SIGNATURE John C. Maxey Jr. TITLE Petroleum Engineer DATE March 14, 1995

TYPE OR PRINT NAME John C. Maxey Jr. TELEPHONE NO. 505-622-3770

(This space for State Use)

APPROVED BY Ken Livingston TITLE Field Rep DATE 7-11-15

CONDITIONS OF APPROVAL, IF ANY:

DISTRICT I  
P.O. Box 1980, Hobbs, NM 88240

DISTRICT II  
P.O. Drawer DD, Artesia, NM 88210

DISTRICT III  
1000 Rio Brazos Rd., Aztec, NM 87410

OIL CONSERVATION DIVISION  
P.O. Box 2088  
Santa Fe, New Mexico 87504-2088

WELL API NO. 30-015-24810
5. Indicate Type of Lease STATE <input type="checkbox"/> FEE <input checked="" type="checkbox"/>
6. State Oil & Gas Lease No.
7. Lease Name or Unit Agreement Name Otis 33
8. Well No. 2
9. Pool name or Wildcat Und South Carlsbad Strawn

SUNDRY NOTICES AND REPORTS ON WELLS  
(DO NOT USE THIS FORM FOR PROPOSALS TO DRILL OR TO DEEPEN OR PLUG BACK TO A  
DIFFERENT RESERVOIR. USE "APPLICATION FOR PERMIT"  
(FORM C-101) FOR SUCH PROPOSALS.)

1. Type of Well: OIL WELL <input type="checkbox"/> GAS WELL <input checked="" type="checkbox"/> OTHER	2. Name of Operator Read & Stevnes, Inc.
3. Address of Operator P. O. Box 1518 Roswell, NM 88202	4. Well Location Unit Letter C : 990 Feet From The North Line and 2130 Feet From The West Line Section 33 Township 22S Range 27E NMPM Eddy County
10. Elevation (Show whether DF, RKB, RT, GR, etc.)	

11. Check Appropriate Box to Indicate Nature of Notice, Report, or Other Data	
NOTICE OF INTENTION TO:	SUBSEQUENT REPORT OF:
PERFORM REMEDIAL WORK <input type="checkbox"/>	REMEDIAL WORK <input type="checkbox"/>
TEMPORARILY ABANDON <input type="checkbox"/>	ALTERING CASING <input type="checkbox"/>
PULL OR ALTER CASING <input type="checkbox"/>	COMMENCE DRILLING OPNS. <input type="checkbox"/>
OTHER: <input type="checkbox"/>	PLUG AND ABANDONMENT <input checked="" type="checkbox"/>
	CASING TEST AND CEMENT JOB <input type="checkbox"/>
	OTHER: <input type="checkbox"/>

12. Describe Proposed or Completed Operations (Clearly state all pertinent details, and give pertinent dates, including estimated date of starting any proposed work) SEE RULE 1103.

April 28, 1995 MIRUPU & rls 5 1/2" Guiberson Uni VI pkr. Circ hole w/mud laden fl & POH, LD pkr. RUWL & set CIBP @11,500' w/35' cem plug on top. RDWL. RIH w/CIBP on tbg & set CIBP @10,200' w/10 sx Class H cem on top. Tag top of cem @10,100'. Set 35 sx cem plug @8,900', 306' of fill. Cut 5 1/2" csg @5,500' & POH, LD pkr. Set 35 sx plug f/5,550-5,382'. Set 35 sx cem plug @2,600', 108' of fill. Set 35 sx cem plug @1,700', 108' of fill. Set 35 sx cem plug @500', 108' of fill. Set 50' surf plug w/10 sx cem to surf. Dig out cellar & cut off WH, install dry hole marker, rls rig. Well P&A'd May 1995.

RECEIVED  
MAY 17 1995  
OIL CON. DIV.  
DIST. 2

Post ID-2  
6-2-95  
P&A

I hereby certify that the information above is true and complete to the best of my knowledge and belief.

SIGNATURE John C. Maxey, Jr. TITLE Petroleum Engineer DATE 5-9-95  
TYPE OR PRINT NAME John C. Maxey, Jr. TELEPHONE NO.

This space for State Use)

APPROVED BY Ken Livingston TITLE Field Rep DATE 7-11-95  
CONDITIONS OF APPROVAL, IF ANY:



RE-ISSUED COMPLETE...

© Copyrighted Reproduction Prohibited

COUNTY EDDY FIELD Carlsbad S STATE NM  
OPR READ & STEVENS INC API 30-015-24810  
NO 2 LEASE Otis "33" MAP  
Sec 33, T22S, R27E CO-ORD  
990 FNL, 2130 FWL of Sec 10-2-16 NM  
6 mi SE/Carlsbad SPD 3-29-84 CMP 7-31-84

CSC

13 3/8-443-475 sx  
9 5/8-5480-1500 sx  
5 1/2-12.052-2400 sx  
2 7/8-11.626

WELL CLASS: INIT D FIN DG LSE. CODE

FORMATION	DATUM	FORMATION	DATUM
TD 12,070 (MRRW)		PBD	11,870

\*IP (Morrow) Perfs 11,664-11,766 CAOF 3870 MCFGPD. GOR  
Dry; gty (Gas) .606; SIWHP 3917; SIBHP 3965

\*P.L.C. None

CONTR Sierra #4 OPRSELEV 3136 GR SUBS 18

F.R. 4-2-84  
PD 12,000 RT (Morrow)  
4-3-84 Drlg 2940  
4-9-84 TD 5480; TIH  
4-17-84 Drlg 8270  
4-24-85 Drlg 10,495  
5-3-84 Drlg 11,752  
DST (Strawn) 10,430-10,510, op 1 hr 30  
mins, rec 10 BBL MUD (Sample chamber rec  
100 CC MUD + .273 CFT GAS @ 25), 30 min  
IFP 48-48, 1 hr ISIP 64, 1 hr FFP 48-48,  
27 min FSIP 48, HP 5508-5572, BHT 170 deg  
5-8-84 TD 12,070; Rng Logs

10-2-16 NM

---

EDDY  
READ & STEVENS INC

Carlsbad S  
2 Otis "33"  
Sec 33, T22S, R27E

---

NM  
Page #3

12-1-84 RE-ISSUE OF SUSPENDED COMPLETION  
3-9-85 RE-ISSUED COMPLETION: Formerly Shut In Gas  
Well

10-2-16 NM  
IC 30-015-70093--84

---

---