

CONTINENTAL OIL COMPANY

P. O. Box 460
Hobbs, New Mexico

DHC-50

Rec'd July 19

New Mexico Oil Conservation Commission (3)
P. O. Box 2088
Santa Fe, New Mexico

Attention of Mr. A. L. Porter, Jr., Secretary-Treasurer

Subject: Application for Administrative Approval - Downhole Commingling

Gentlemen:

Forwarded herewith in duplicate is an application for administrative approval to commingle in the well bore production from the Drinkard and Blinebry Pools in Hawk "B-1" Well No. 13. A copy of this application is being forwarded to the Hobbs office of the Commission and to each offset operator.

Your further handling and approval will be sincerely appreciated.

Yours very truly,



G. C. Jamieson
Assistant Division Manager

GCJ:MEW

CC: USGS - HOBBS, NEW MEXICO (2)
GULF OIL CORPORATION
PAN AMERICAN PETROLEUM CORPORATION
HUMBLE OIL & REFINING
GETTY OIL
ATLANTIC RICHFIELD
STANDARD OIL COMPANY OF TEXAS

RLA JJB JWK

C O N T I N E N T A L O I L C O M P A N Y

P. O. Box 460
Hobbs, New Mexico

New Mexico Oil Conservation Commission (3)
P. O. Box 2088
Santa Fe, New Mexico

Attention of Mr. A. L. Porter, Jr., Secretary-Director

Gentlemen:

Subject: Application for Downhole Commingling - Hawk "B-1" Well No. 13
I-9-215-37E

Continental Oil Company, Box 460, Hobbs, New Mexico, as operator of the Hawk "B-1" Lease respectfully requests administrative approval under the provisions of Order No. R-3845 to commingle in the well bore production from the Drinkard and Blinebry Pools in its Hawk "B-1" Well No. 13 located in Unit I of Section 9, T21S, R37E, Lea County, New Mexico. This dual completion was authorized by administrative order No. MC-1315. The attached plat shows the Hawk "B-1" Lease outlined in red and the No. 13 well by the red circle.

Test data for the Hawk "B-1" Well No. 13 for the past two months has not been reliable due to packer leakage which has resulted in communication between the two zones. On April 23, 1970, the Blinebry tested (flowing) 44 BOPD, 6 BWPD and 275 MCFPD of gas, with the Drinkard shut-in. On May 5, 1970, the Drinkard flowed 45 BOPD, 4 BWPD, and 414 MCFPD of gas, with the Blinebry shut-in. With both zones open, neither side will produce at a stabilized rate. Prior to the occurrence of communication between the two zones, the well produced a total of from 25 to 30 BOPD from the two zones. No C-116 is attached for the well, due to the unreliable test data.

On May 26, 1970, the bottom hole pressures in the Drinkard and Blinebry zones were measured in the Hawk "B-10" Well No. 10 located approximately 3700 feet northeast from the Hawk "B-1" Well No. 13. The Blinebry pressure was measured to be 629 psi after shut-in for 24 hours. The Drinkard pressure was measured to be 1201 psi after being shut-in for approximately 2 years. The Blinebry zone in the Hawk "B-10" Well No. 10 is producing by flowing. The Drinkard pressure in Hawk

Mr. A. L. Porter, Jr.
Page 2
June 24, 1970

"B-10" Well No. 10 is considered representative of the Drinkard pool in this area, due to length of shut-in period. This pressure of 1201 psi is undoubtedly higher than what would be measured after a 24 hour shut-in period. It was not considered feasible to obtain pressure surveys in the Hawk "B-1" Well No. 13, due to the communication between the zones. The commingled production from the Hawk "B-1" Well No. 13 will be produced by flowing.

Attached herto is a production decline curve for each zone. The future production from each zone is estimated by the extension, which would be 57.5 percent from the Blinberry and 42.5 percent from the Drinkard. Anticipated production from the well is 30 BOPD by flowing.

The fluid from these two pools has been commingled at the tank battery for a number of years and there has been no indication of incompatibility. Both crudes are typical Permian high gravity crude. Since the crudes have been commingled at the tank battery before sale to the pipe line, there should be no difference between the valve of the commingled stream at the surface and that commingled within the well bore.

The Hawk "B-1" is a Federal Lease and a copy of the application is being furnished the USGS and to all offset operators. Your further handling and approval of this application will be sincerely appreciated.

Yours very truly,

G. C. Jamieson
Assistant Division Manager

GCJ:MEW

CC: Gulf Oil Corporation
Pan American Petroleum Corporation
Humble Oil & Refining
Getty Oil
Atlantic Richfield
Standard Oil Company of Texas

USGS (2) RLA JJB JWK File

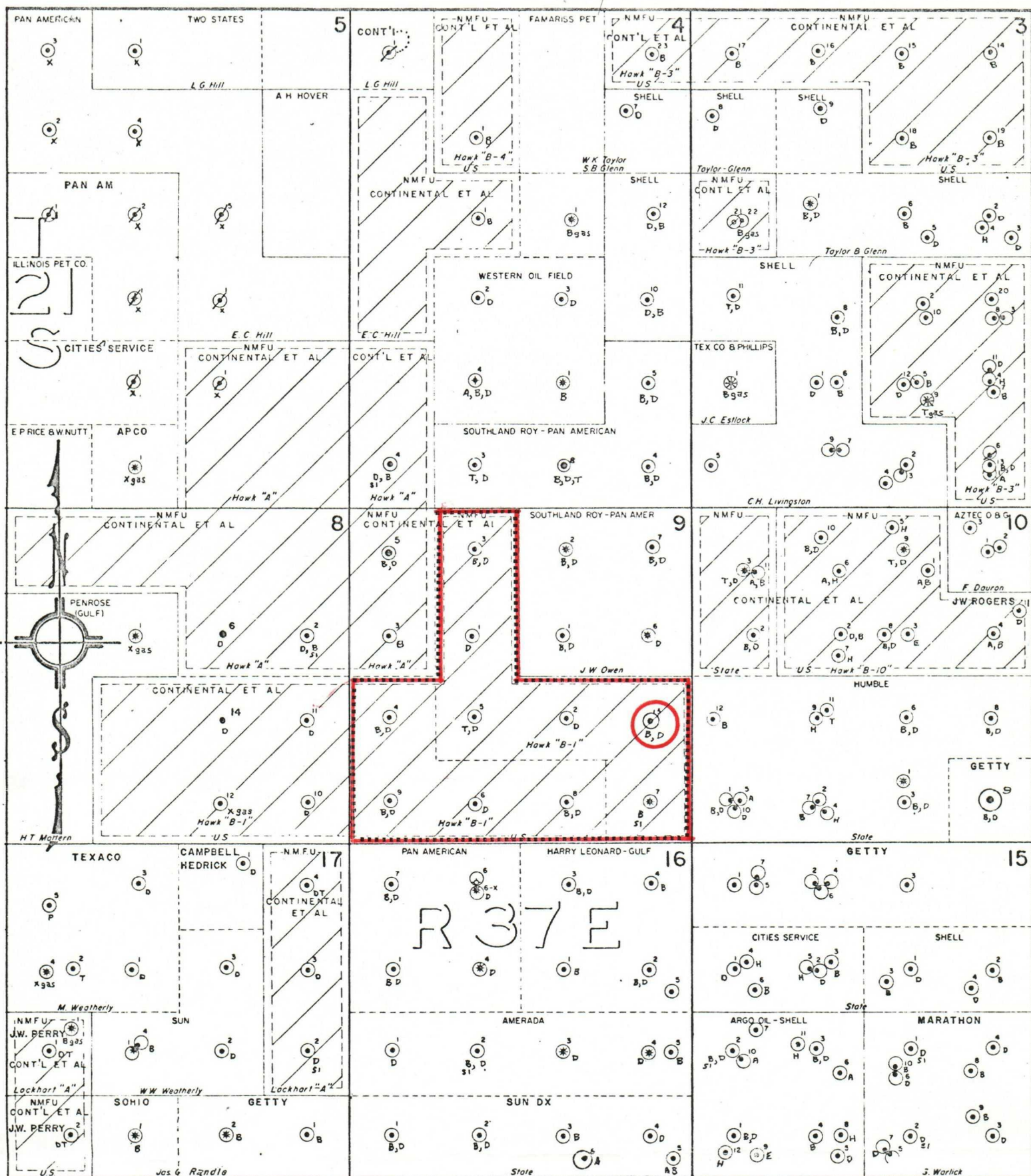

- Blinebry-Terry Blinebry Completion
- Drinkard Oil Completion
- Tubb Oil Completion
- Hare Oil Completion
- Wantz Abo Oil Completion
- Brunson Ellenburger Oil Completion
- Penrose Skelly Oil Completion
- Eumont Queen Oil Completion

..... Hawk B-1 Lease

CONTINENTAL OIL COMPANY
PRODUCTION DEPARTMENT
HOBBS DIVISION
HAWK B-1 LEASE
LOCATION PLAT
LEA COUNTY, NEW MEXICO
Scale: 1" = 2000'

BOPM

10,000

1000

100

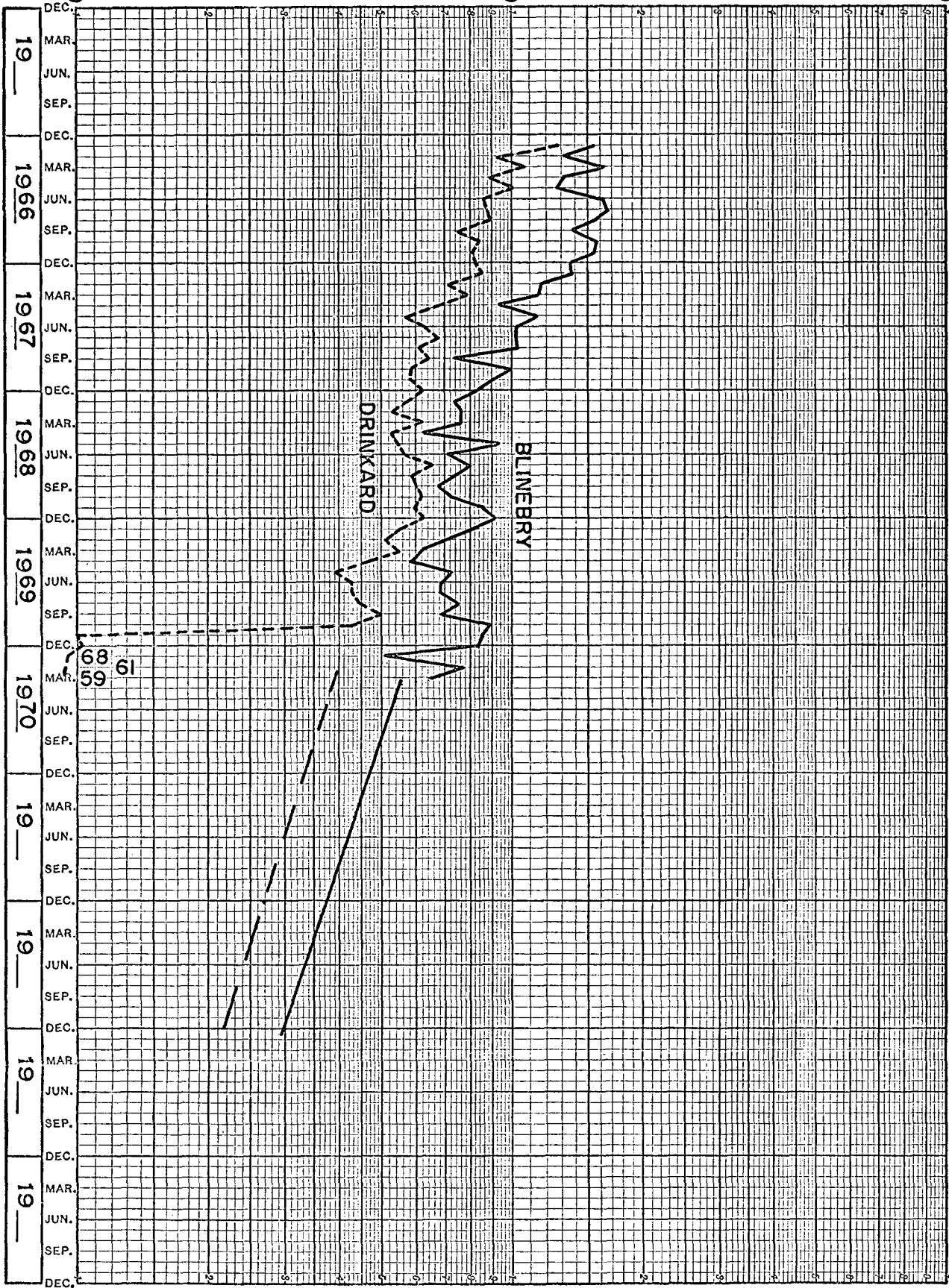

HAWK B-1 NO. 13