

BEFORE THE OIL CONSERVATION COMMISSION
OF THE STATE OF NEW MEXICO

IN THE MATTER OF THE HEARING
CALLED BY THE OIL CONSERVATION
COMMISSION OF NEW MEXICO FOR
THE PURPOSE OF CONSIDERING:

✓
CASE NO. 237
ORDER NO. R-46

THE APPLICATION OF THE OIL
CONSERVATION COMMISSION UPON
ITS OWN MOTION FOR ESTABLISHING
A WELL SPACING PATTERN FOR
EACH OF THE DESIGNATED GAS
POOLS IN THE COUNTIES OF SAN
JUAN AND RIO ARriba, STATE OF
NEW MEXICO PRODUCING OR CAPABLE
OF PRODUCING GAS FROM PICTURED
CLIFFS FORMATION, EXCEPT KUTZ
CANYON-FULCHER BASIN, MESAVERDE
FORMATION (EXCEPT BLANCO POOL)
AND ANY OF THE PENNSYLVANIAN
FORMATIONS.

ORDER OF THE COMMISSION

BY THE COMMISSION:

This cause came on regularly for hearing at 10:00 o'clock A.M.,
November 21, 1950, at Santa Fe, New Mexico, before the Oil Conservation
Commission of New Mexico, hereinafter referred to as the "Commission".

NOW, on this 29th day of December, 1950, the Commission having con-
sidered the whole matter including the testimony adduced at said hearing,

FINDS:

1. That due public notice having been given as required by law, the
Commission has jurisdiction of this cause and the subject matter thereof.
2. That for purposes of orderly development, protection of correlative
rights and the prevention of waste, the following pools in San Juan and Rio
Arriba Counties, New Mexico heretofore by the Commission named, defined
and classified as gas pools, as the respective boundaries thereof may be

changed by extension or otherwise, should be provided with proper spacing pattern and production units;

Aztec (Pictured Cliffs) pool, 160-acre spacing;
 Barker Creek, Paradox (Pennsylvanian) pool, 640-acre spacing;
 Blanco (Pictured Cliffs) pool, 160-acre spacing;
 Gavilan (Pictured Cliffs) pool, 160-acre spacing;
 La Plata (Mesaverde) pool, 320-acre spacing;
 NW La Plata (Mesaverde) pool, 320-acre spacing;
 South La Plata (Mesaverde) pool, 320-acre spacing;
 South Kutz Canyon (Pictured Cliffs) pool, 160-acre spacing;
 West Kutz Canyon (Pictured Cliffs) pool, 160-acre spacing;
 Ute Dome (Paradox) pool, 640-acre spacing.

3. That for La Plata, NW La Plata and South La Plata pools, wells should be orthodox locations on NW/4 and SE/4 of each section in said pools.

4. Under 160-acre spacing for Aztec, Blanco (Pictured Cliffs), Gavilan, South Kutz Canyon and West Kutz Canyon pools, orthodox locations should be required as stated in Rule 104 (or 330' from inner and 660' from outer boundaries of the respective quarter section);

5. For those pools appearing to require 640-acre spacing in Pennsylvanian formation, orthodox locations should be required to be not closer than 330' to center and 1650' from boundary of each section in the Barker Creek (Paradox-Pennsylvanian) and Ute Dome (Paradox-Pennsylvanian) pools.

6. That existing Commission Orders 748 and 815, relating to the Kutz Canyon-Fulcher Basin pool, and Order No. 799 relating to the Blanco pool should be and remain in full effect and undisturbed hereby.

IT IS THEREFORE ORDERED:

1. That for purposes of orderly development, protection of correlative rights, and the prevention of waste, a spacing and production unit pattern is hereby provided for each of the following heretofore named, defined and classified pools, as the respective boundaries thereof may from time to time be changed:

| <u>POOL</u> | <u>FORMATION</u> | <u>SPACING</u> |
|--------------|-----------------------|----------------|
| Aztec | Pictured Cliffs | 160-acre |
| Barker Creek | Paradox-Pennsylvanian | 640-acre |
| Blanco | Pictured Cliffs | 160-acre |
| Gavilan | Pictured Cliffs | 160-acre |
| La Plata | Mesaverde | 320-acre |
| NW La Plata | Mesaverde | 320-acre |

POOL

FORMATION

SPACING

| | | |
|-------------------|-----------------|----------|
| South LaPlata | Mesaverde | 320-acre |
| South Kutz Canyon | Pictured Cliffs | 160-acre |
| West Kutz Canyon | Pictured Cliffs | 160-acre |
| Ute Dome | Paradox | 640-acre |

2. That orthodox locations shall be in the approximate center of the NW/4 and SE/4 of each section within the confines of LaPlata, Northwest LaPlata, and south LaPlata pools, under 320 acre spacing for Mesaverde production.

3. That orthodox locations shall be as in Rule 104 (or 330' from inner and 660' from outer boundaries of the respective quarter section) within the boundaries of the Aztec, Blanco, Gavilan, South Kutz Canyon and West Kutz Canyon pools for 160-acre spacing for Pictured Cliffs production.

4. That orthodox locations shall be not closer than 330' to center of the respective sections and 1650' from boundaries within the boundaries of Barker Creek and Ute Dome pools for 640-acre spacing for Paradox-Pennsylvanian production.

5. That Orders Nos. 748, 815, relative to Kutz Canyon- Fulcher Basin Pool, and 799, relating to Blanco Mesaverde, shall remain in full force and effect.

6. That wells now drilled or drilling are excepted.

IT IS FURTHER ORDERED:

1. That for the purpose of preventing inequities and impairment of correlative rights the Commission upon its own motion or upon its own motion or upon application of any interested person, after notice and hearing grant exceptions in proper cases.

DONE at Santa Fe, New Mexico, on the day and year hereinabove specified.

STATE OF NEW MEXICO
OIL CONSERVATION COMMISSION

THOMAS J. MABRY, CHAIRMAN

GUY SHEPARD, MEMBER

R. R. SPURRIER, SECRETARY

SEAL

BEFORE THE OIL CONSERVATION COMMISSION
OF THE STATE OF NEW MEXICO

CASE No. 258
ORDER No. R-60

IN THE MATTER OF THE APPLICATION OF
BYRD-FROST, INC. FOR PERMISSION TO
COMMUNITIZE THE SHORT SECTIONS ON A
NORTH-SOUTH BASIS, BEING LOCATED ON
THE WEST SIDE OF T. 29 N, R. 8 W, SUCH
UNITS TO APPROXIMATE THE REGULAR 320
ACRE UNITS FOR THE MESAVERDE POOLS
UNDERLYING THE ABOVE DESCRIBED AREA
IN SAN JUAN COUNTY, NEW MEXICO

ORDER OF THE COMMISSION

BY THE COMMISSION:

This cause came on for hearing at Santa Fe, New Mexico, on 20 February 1951 at 10:00 a.m. After hearing testimony, the case was taken under advisement.

NOW, on this 21 day of March 1951, having duly considered the evidence, the Commission finds:

1. That it has jurisdiction of this cause, due notice having been given of the hearing.
2. Sections 6, 7, 18, 19, 30, and 31 of Township 29 North, Range 8 West are less than normal in size, each containing approximately 549 acres. In order to provide a uniform drilling pattern, special drilling units should be established in said sections as to all wells now drilling or hereafter drilled to the Mesaverde gas horizon.
3. In order to prevent waste and protect correlative rights, it is necessary that all lands within each drilling unit be pooled as to production of gas from the Mesaverde gas horizon.

IT IS THEREFORE ORDERED:

1. The following lands shall constitute drilling units for production from the Mesaverde gas horizon:

| | |
|------------|--|
| Unit No. 1 | W/2 sec. 6; NW/4 sec. 7, T. 29 N, R. 8 W |
| Unit No. 2 | SW/4 sec. 7; W/2 sec. 18, T. 29 N, R. 8 W |
| Unit No. 3 | W/2 sec. 19; NW/4 sec. 30, T. 29 N, R. 8 W |
| Unit No. 4 | SW/4 sec. 30; W/2 sec. 31, T. 29 N, R. 8 W |

2. All lands within each of the above drilling units are hereby pooled as to production from the Mesaverde gas horizon. Only one well shall be drilled on each drilling unit.

3. Wells shall be located not closer than 660 feet from the outer boundary of any drilling unit.

4. Wells drilled in the east halves of said sections shall be located in the northeast quarter of said section and not closer than 660 feet to the outer boundaries of said quarter sections.

5. In the event gas proration orders are later issued for said wells, each of Units 1, 2, 3, and 4, as defined above, shall be given an allowable equal to that of a 320-acre tract.

DONE at Santa Fe, New Mexico, on this 21 day of March 1951.

STATE OF NEW MEXICO
OIL CONSERVATION COMMISSION

**BEFORE THE OIL CONSERVATION COMMISSION
OF THE STATE OF NEW MEXICO**

**IN THE MATTER OF THE HEARING
CALLED BY THE OIL CONSERVATION
COMMISSION OF THE STATE OF NEW
MEXICO FOR THE PURPOSE OF
CONSIDERING:**

**CASE NO. 1407
Order No. R-1169**

**APPLICATION OF DELHI-TAYLOR OIL
CORPORATION FOR THE ESTABLISHMENT
OF A 169.42-ACRE NON-STANDARD GAS
PRORATION UNIT IN THE AZTEC-PICTURED
CLIFFS GAS POOL, SAN JUAN COUNTY,
NEW MEXICO.**

ORDER OF THE COMMISSION

BY THE COMMISSION:

This cause came on for hearing at 9 o'clock a.m. on April 9, 1958, at Santa Fe, New Mexico, before Elvis A. Utz, Examiner duly appointed by the New Mexico Oil Conservation Commission, hereinafter referred to as the "Commission," in accordance with Rule 1214 of the Commission Rules and Regulations.

NOW, on this 28th day of April, 1958, the Commission, a quorum being present, having considered the application, the evidence adduced and the recommendations of the Examiner, Elvis A. Utz, and being fully advised in the premises,

FINDS:

- (1) That due public notice having been given as required by law, the Commission has jurisdiction of this cause and the subject matter thereof.
- (2) That the applicant, Delhi-Taylor Oil Corporation, is the owner of the following described acreage: SW/4 and S/2 NW/4 of partial Section 31, Township 29 North, Range 8 West, NMPM, San Juan County, New Mexico.
- (3) That the applicant is the operator of the Prichard Well No. 4-C, located 1450 feet from the South line and 790 feet from the West line of said Section 31.
- (4) That the applicant proposes to dedicate the above-described acreage to the said Prichard Well No. 4-C.
- (5) That the proposed non-standard proration unit is necessitated by a variation in legal subdivision of the United States Public Land Surveys.

CASE NO. 1407
Order No. R-1169

(6) That the establishment of the proposed non-standard proration unit will not cause waste nor impair correlative rights.

(7) That the application should be granted.

IT IS THEREFORE ORDERED:

1. That the application of Delhi-Taylor Oil Corporation for the establishment of a 169.42-acre non-standard gas proration unit in the Aztec-Pictured Cliffs Gas Pool, consisting of the SW/4 and S/2 NW/4 of partial Section 31, Township 29 North, Range 8 West, NMPM, San Juan County, New Mexico, be and the same is hereby granted. Said unit is to be dedicated to the applicant's Prichard Well No. 4-C located 1450 feet from the South line and 790 feet from the West line of said Section 31.

2. That the said Prichard Well No. 4-C be designated as the unit well for said unit and that the same be granted an acreage factor for allowable purposes in the proportion that the above-described acreage bears to the standard proration unit for the Aztec-Pictured Cliffs Gas Pool, subject to the Special Rules and Regulations for the Aztec-Pictured Cliffs Gas Pool as set forth in Order No. R-565-C.

DONE at Santa Fe, New Mexico, on the day and year hereinabove designated.

STATE OF NEW MEXICO
OIL CONSERVATION COMMISSION

EDWIN L. MECHEM, Chairman

MURRAY E. MORGAN, Member

A. L. PORTER, Jr., Member & Secretary

S E A L

ga

BEFORE THE OIL CONSERVATION COMMISSION
OF THE STATE OF NEW MEXICO

IN THE MATTER OF THE HEARING
CALLED BY THE OIL CONSERVATION
COMMISSION OF THE STATE OF NEW
MEXICO FOR THE PURPOSE OF
CONSIDERING:

CASE NO. 1408
Order No. R-1170

APPLICATION OF DELHI-TAYLOR OIL
CORPORATION FOR THE ESTABLISHMENT OF A
170.58-ACRE NON-STANDARD GAS PRORATION
UNIT IN THE AZTEC-PICTURED CLIFFS GAS
POOL, SAN JUAN COUNTY, NEW MEXICO.

ORDER OF THE COMMISSION

BY THE COMMISSION:

This cause came on for hearing at 9 o'clock a.m. on April 9, 1958, at Santa Fe, New Mexico, before Elvis A. Utz, Examiner duly appointed by the New Mexico Oil Conservation Commission, hereinafter referred to as the "Commission," in accordance with Rule 1214 of the Commission Rules and Regulations.

NOW, on this 28th day of April, 1958, the Commission, a quorum being present, having considered the application, the evidence adduced and the recommendations of the Examiner, Elvis A. Utz, and being fully advised in the premises,

FINDS:

- (1) That due public notice having been given as required by law, the Commission has jurisdiction of this cause and the subject matter thereof.
- (2) That the applicant, Delhi-Taylor Oil Corporation, is the owner of two oil and gas leases covering the following described acreage: SW/4 of partial Section 30 and the N/2 NW/4 of partial Section 31, Township 29 North, Range 8 West, NMPM, San Juan County, New Mexico.
- (3) That the applicant is the owner and operator of the Jones Well No. 3 located 1750 feet from the South line and 1090 feet from the West line of said Section 30.
- (4) That the applicant proposes to dedicate the above-described acreage to the said Jones Well No. 3.
- (5) That the proposed non-standard proration unit is necessitated by a variation in legal subdivision of the United States Public Land Surveys.

CASE NO. 1408
Order No. R-1170

(6) That the establishment of the proposed non-standard gas proration unit will not cause waste nor impair correlative rights.

(7) That the application should be granted.

IT IS THEREFORE ORDERED:

1. That the application of Delhi-Taylor Oil Corporation for the establishment of a 170.58-acre non-standard gas proration unit in the Aztec-Pictured Cliffs Gas Pool, consisting of the SW/4 of partial Section 30 and the N/2 NW/4 of partial Section 31, Township 29 North, Range 8 West, NMPM, San Juan County, New Mexico, be and the same is hereby granted. Said unit is to be dedicated to the applicant's Jones Well No. 3 located 1750 feet from the South line and 1090 feet from the West line of said Section 30.

2. That the said Jones Well No. 3 be designated as the unit well for said unit and that the same be granted an acreage factor for allowable purposes in the proportion that the above-described acreage bears to the standard proration unit for the Aztec-Pictured Cliffs Gas Pool, subject to the Special Rules and Regulations for the Aztec-Pictured Cliffs Gas Pool as set forth in Order No. R-565-C.

DONE at Santa Fe, New Mexico, on the day and year hereinabove designated.

STATE OF NEW MEXICO
OIL CONSERVATION COMMISSION

EDWIN L. MECHEM, Chairman

MURRAY E. MORGAN, Member

A. L. PORTER, Jr., Member & Secretary

S E A L

BEFORE THE OIL CONSERVATION COMMISSION
OF THE STATE OF NEW MEXICO

IN THE MATTER OF THE HEARING
CALLED BY THE OIL CONSERVATION
COMMISSION OF NEW MEXICO FOR
THE PURPOSE OF CONSIDERING:

CASE NO. 1642
Order No. R-1390

APPLICATION OF DELHI-TAYLOR OIL
CORPORATION FOR AN AMENDMENT OF
ORDER NOS. R-60, R-1169, AND R-1170
TO CHANGE THE DEDICATED ACREAGE IN
ONE NON-STANDARD GAS PRORATION UNIT
IN THE BLANCO MESAVERDE POOL AND IN
TWO NON-STANDARD GAS PRORATION UNITS
IN THE AZTEC-PICTURED CLIFFS POOL,
SAN JUAN COUNTY, NEW MEXICO.

ORDER OF THE COMMISSION

BY THE COMMISSION:

This cause came on for hearing at 9 o'clock a.m. on April 22, 1959, at Santa Fe, New Mexico, before Daniel S. Nutter, Examiner duly appointed by the Oil Conservation Commission of New Mexico, hereinafter referred to as the "Commission," in accordance with Rule 1214 of the Commission Rules and Regulations.

NOW, on this 7th day of May, 1959, the Commission, a quorum being present, having considered the application, the evidence adduced and the recommendations of the Examiner, Daniel S. Nutter, and being fully advised in the premises,

FINDS:

(1) That due public notice having been given as required by law, the Commission has jurisdiction of this cause and the subject matter thereof.

(2) That by Commission Order No. R-60, the applicant, Delhi-Taylor Oil Corporation, was granted a 340-acre non-standard gas proration unit in the Blanco Mesaverde Pool consisting of the SW/4 of Section 30 and the W/2 of Section 31, Township 29 North, Range 8 West, NMPM, San Juan County, New Mexico, said unit being dedicated to the Delhi-Taylor Prichard Well No. 4-T, located 1450 feet from the South line and 790 feet from the West line of said Section 31.

(3) That a recent Cadastral Survey, accepted April 18, 1958, shows the acreage in said non-standard gas proration unit to be 375.09 acres rather than 340 acres.

(4) That by Commission Order No. R-1169, the applicant was granted a 169.42 acre non-standard gas proration unit in the Aztec-

Pictured Cliffs Pool consisting of the SW/4 and the S/2 NW/4 of said Section 31, said unit being dedicated to the Delhi-Taylor Prichard Well No. 4-C, located 1450 feet from the South line and 790 feet from the West line of said Section 31.

(5) That a recent Cadastral Survey, accepted April 18, 1958, shows the acreage in said non-standard gas proration unit to be 203.34 acres rather than 169.42 acres.

(6) That by Commission Order No. R-1170, the applicant was granted a 170.58 acre non-standard gas proration unit in the Aztec-Pictured Cliffs Pool consisting of the SW/4 of said Section 30 and the N/2 NW/4 of said Section 31, said unit being dedicated to the Delhi-Taylor Jones Well No. 3, located 1750 feet from the South line and 1090 feet from the West line of said Section 30.

(7) That a recent Cadastral Survey, accepted April 18, 1958, shows the acreage in said non-standard gas proration unit to be 171.75 acres rather than 170.58 acres.

(8) That the applicant proposes that Order Nos. R-60, R-1169, and R-1170 be amended to change the dedicated acreage in said non-standard gas proration units to conform with the acreage shown by the Cadastral Survey accepted April 18, 1958.

(9) That amendment of the subject orders as requested by the applicant will not cause waste nor impair correlative rights.

IT IS THEREFORE ORDERED:

(1) That Order No. R-60 be and the same is hereby amended to reflect that applicant's non-standard gas proration unit in the Blanco Mesaverde Pool consisting of the SW/4 of Section 30 and the W/2 of Section 31, Township 29 North, Range 8 West, NMPM, San Juan County, New Mexico, and dedicated to the Delhi-Taylor Prichard Well No. 4-T, located 1450 feet from the South line and 790 feet from the West line of said Section 31, contains 375.09 acres.

(2) That Order No. R-1169 be and the same is hereby amended to reflect that applicant's non-standard gas proration unit in the Aztec-Pictured Cliffs Pool consisting of the SW/4 and the S/2 NW/4 of said Section 31 and dedicated to the Delhi-Taylor Prichard Well No. 4-C, located 1450 feet from the South line and 790 feet from the West line of said Section 31, contains 203.34 acres.

(3) That Order No. R-1170 be and the same is hereby amended to reflect that applicant's non-standard gas proration unit in the Aztec-Pictured Cliffs Pool consisting of the SW/4 of said Section 30 and the N/2 NW/4 of said Section 31 and dedicated to the Delhi-Taylor Jones Well No. 3, located 1750 feet from the South line and

-3-

Case No. 1642
Order No. R-1390

1090 feet from the West line of said Section 30, contains 171.75 acres.

(4) That the effective date of this order changing the acreage dedicated to the above-described wells shall be May 1, 1959.

DONE at Santa Fe, New Mexico, on the day and year hereinabove designated.

STATE OF NEW MEXICO
OIL CONSERVATION COMMISSION

JOHN BURROUGHS, Chairman

MURRAY E. MORGAN, Member

A. L. PORTER, Jr., Member & Secretary

S E A L

ir/

BEFORE THE OIL CONSERVATION COMMISSION
OF THE STATE OF NEW MEXICO

IN THE MATTER OF THE HEARING
CALLED BY THE OIL CONSERVATION
COMMISSION OF NEW MEXICO FOR
THE PURPOSE OF CONSIDERING:

CASE No. 4382
Order No. R-4002
NOMENCLATURE

THE APPLICATION OF THE OIL CONSERVATION
COMMISSION UPON ITS OWN MOTION FOR AN
ORDER CONTRACTING AND EXTENDING CERTAIN
POOLS IN SAN JUAN COUNTY, NEW MEXICO.

ORDER OF THE COMMISSION

BY THE COMMISSION:

This cause came on for hearing at 9:30 a.m. on July 15, 1970,
at Santa Fe, New Mexico, before Examiner Daniel S. Nutter.

NOW, on this 21st. day of July, 1970, the Commission, a
quorum being present, having considered the testimony, the record,
and the recommendations of the Examiner, and being fully advised
in the premises,

FINDS:

- (1) That due public notice having been given as required by
law, the Commission has jurisdiction of this cause and the subject
matter thereof.
- (2) That the evidence indicates that the horizontal limits
of the Aztec-Pictured Cliffs Pool in San Juan County, New Mexico,
presently contain certain lands that properly belong in the
Blanco-Pictured Cliffs Pool or in the South Blanco-Pictured Cliffs
Pool, both in San Juan County, New Mexico, and said lands should
be deleted from the Aztec-Pictured Cliffs Pool and the horizontal
limits of said Blanco-Pictured Cliffs and South Blanco-Pictured
Cliffs Pools should be extended to include substantially all of
said lands.
- (3) That the evidence indicates that a certain well is
producing from the Aztec-Pictured Cliffs reservoir and that the
horizontal limits of said pool should be extended to include said
well.

(4) That the evidence indicates that certain other wells are producing from the Blanco-Pictured Cliffs reservoir and that the horizontal limits of said pool should be further extended to include said wells.

(5) That the deletions and extensions described above in Findings (2), (3), and (4) will not violate correlative rights nor cause waste.

IT IS THEREFORE ORDERED:

(1) That the horizontal limits of the Aztec-Pictured Cliffs Pool, San Juan County, New Mexico, are hereby contracted by the deletion therefrom of the following-described area:

TOWNSHIP 28 NORTH, RANGE 8 WEST, NMPM

Section 7: All Partial
Section 15: S/2
Section 16: S/2 and NW/4
Section 17: S/2
Section 18: S/2
Section 19: All
Section 20: All
Section 21: All
Section 22: All

TOWNSHIP 28 NORTH, RANGE 9 WEST, NMPM

Section 12: All Partial

TOWNSHIP 29 NORTH, RANGE 8 WEST, NMPM

Section 30: W/2
Section 31: W/2

TOWNSHIP 29 NORTH, RANGE 9 WEST, NMPM

Section 25: All
Section 27: SE/4
Section 34: N/2
Section 35: All
Section 36: All

TOWNSHIP 29 NORTH, RANGE 10 WEST, NMPM

Section 1: All

(1) - Continued from Page 2 -

TOWNSHIP 30 NORTH, RANGE 10 WEST, NMPM

Section 7: SE/4
Section 8: S/2
Section 9: S/2
Section 10: SW/4
Section 14: W/2
Section 15: All
Section 16: All
Section 21: N/2
Section 22: N/2
Section 23: N/2
Section 24: NW/4
Section 35: All
Section 36: W/2 and SE/4

(2) That the horizontal limits of the above-described Aztec-Pictured Cliffs Pool, San Juan County, New Mexico, are hereby extended to include the following-described area:

TOWNSHIP 30 NORTH, RANGE 10 WEST, NMPM

Section 27: SW/4

(3) That the horizontal limits of the Blanco-Pictured Cliffs Pool, San Juan County, New Mexico, are hereby extended to include the following-described area:

TOWNSHIP 28 NORTH, RANGE 8 WEST, NMPM

Section 7: All Partial

TOWNSHIP 28 NORTH, RANGE 9 WEST, NMPM

Section 12: All partial

TOWNSHIP 29 NORTH, RANGE 8 WEST, NMPM

Section 14: SW/4
Section 19: All
Section 20: All
Section 21: All
Section 22: All
Section 23: W/2
Section 26: W/2
Section 27: All
Section 28: All

(3) - Continued from page 3 -

TOWNSHIP 29 NORTH, RANGE 8 WEST, NMPM, continued

Section 29: All
Section 30: All
Section 31: W/2 and NE/4
Section 32: N/2

TOWNSHIP 29 NORTH, RANGE 9 WEST, NMPM

Section 6: NW/4
Section 25: All
Section 27: SE/4
Section 34: NE/4
Section 35: All
Section 36: All

TOWNSHIP 29 NORTH, RANGE 10 WEST, NMPM

Section 1: N/2

TOWNSHIP 30 NORTH, RANGE 9 WEST, NMPM

Section 31: W/2

TOWNSHIP 30 NORTH, RANGE 10 WEST, NMPM

Section 4: W/2
Section 5: N/2
Section 9: W/2 and SE/4
Section 10: S/2
Section 14: W/2
Section 15: E/2
Section 22: NE/4
Section 23: N/2
Section 24: NW/4
Section 35: N/2
Section 36: All

TOWNSHIP 31 NORTH, RANGE 10 WEST, NMPM

Section 19: All
Section 20: SW/4
Section 30: All
Section 31: NE/4
Section 32: W/2

TOWNSHIP 31 NORTH, RANGE 11 WEST, NMPM

Section 5: SW/4
Section 6: All

(3) - Continued from Page 4 -

TOWNSHIP 31 NORTH, RANGE 11 WEST, NMPM

Section 8: N/2 and SE/4

Section 9: S/2

Section 10: S/2

Section 14: S/2

Section 15: E/2

Section 23: E/2

Section 24: All

Section 25: NE/4

TOWNSHIP 32 NORTH, RANGE 11 WEST, NMPM

Section 30: SW/4

Section 31: All

(4) That the horizontal limits of the South Blanco-Pictured Cliffs Pool, Rio Arriba, Sandoval, and San Juan Counties, New Mexico, are hereby extended to include the following-described area:

SAN JUAN COUNTY, NEW MEXICO

TOWNSHIP 28 NORTH, RANGE 8 WEST, NMPM

Section 15: S/2

Section 16: S/2 and NW/4

Section 19: S/2 and NW/4

Section 20: S/2 and NE/4

Section 21: All

Section 22: All

(5) That the effective date of this order and all contractions and extensions included herein shall be September 1, 1970.

(6) That jurisdiction of this cause is retained for the entry of such further orders as the Commission may deem necessary.

DONE at Santa Fe, New Mexico, on the day and year hereinabove designated.

STATE OF NEW MEXICO
OIL CONSERVATION COMMISSION

DAVID F. CARGO, Chairman

ALEX J. ARMIJO, Member

S E A L

A. L. PORTER, Jr., Member & Secretary

esr/

OIL CONSERVATION COMMISSION

P. O. BOX 2088

SANTA FE, NEW MEXICO 87501

March 28, 1977

C Tenneco Oil Company
Lincoln Tower Building
Suite 1200
Denver, Colorado 80203

Attention: D. D. Myers

Administrative Order NSL-831

O Gentlemen:

P Reference is made to your application for approval of
a non-standard location for your Pritchard Well No. 4-A
located 1830 feet from the North line and 1705 feet from
the West line of Section 31, Township 29 North, Range 8 West,
NMPM, Blanco-Mesaverde Pool, San Juan County, New Mexico.

Y By authority granted me under the provisions of
Rule 104 F of the Commission Rules and Regulations, the
above-described unorthodox location is hereby approved.

Very truly yours,

JOE D. RAMEY,
Secretary-Director

JDR/JEK/dr

cc: Oil Conservation Commission - Aztec
Oil & Gas Engineering Committee - Hobbs



Preview/Print Permit

Administrative Applications/Orders



Basic Application and Log-In Data

Mod Date: 11/05/2004

| | | | | | | | | |
|-----------------|-------------------------------|-----------|----------|-------------|-------------------|------------|----------|--|
| Application No. | Application Type | Order No. | And # | R-Order No. | Processing Dates | County | San Juan | Approvals |
| PSNH0431038467 | Downhole Commingling | 1689 | 0 | 11363 | Order: 11/05/2004 | Reviewer | Hayden | BLM? <input checked="" type="checkbox"/> |
| Applicant | BP AMERICA PRODUCTION COMPANY | | Rcvd | 11/03/2004 | Exp | District | Aztec | Farmingto |
| Contact | Mary Corley | | Suspnd | | Candl | IssuingOff | Aztec | SLO? <input type="checkbox"/> |
| Notes | Pritchard #4 | | Addl CC: | | | | | |

Permit Level Actions and/or Data

Oil/Gas Gas

DS Approval

| PoolNo | GasPrnt | OilPrnt | Notes | Pool Rules |
|---------------------------------|---------|---------|-------|------------|
| BLANCO-MESAVERDE (PRORATED GAS) | 0.00% | 0.00% | | |
| BLANCO PICTURED CLIFFS (GAS) | 0.00% | 0.00% | | |

Well Specific and Technical Data

Generate Administrative Application Order Summary Reports from [REPORTS] [PERMITS]

CMD :
OG5SECT

ONGARD
INQUIRE LAND BY SECTION

Sec : 31 Twp : 29N Rng : 08W Section Type : NORMAL

| | | | |
|------------------------------|------------------------------|-----------------------------|-----------------------------|
| 6 16.97 Federal owned | 5 40.78 Federal owned | B 40.00 Federal owned | A 40.00 Federal owned |
| 7 18.34 Federal owned | 8 44.40 Federal owned | G 40.00 Federal owned | H 40.00 Federal owned |
| 9 19.76 Federal owned | 10 48.02 Federal owned | J 40.00 Federal owned | I 40.00 Federal owned |
| 11 21.18 Federal owned | 12 51.64 Federal owned | O 40.00 Federal owned | P 40.00 Federal owned |

CMD :
OGSSECT

ONGARD
INQUIRE LAND BY SECTION

Sec : 30 Twp : 29N Rng : 08W Section Type : NORMAL

| | | | |
|-----------------------------|-----------------------------|-----------------------------|-----------------------------|
| 1 18.00 Federal owned | C 40.00 Federal owned | B 40.00 Federal owned | A 40.00 Federal owned |
| 2 17.60 Federal owned | F 40.00 Federal owned | G 40.00 Federal owned | H 40.00 Federal owned |
| 3 17.20 Federal owned | K 40.00 Federal owned | J 40.00 Federal owned | I 40.00 Federal owned |
| 4 16.80 Federal owned | N 40.00 Federal owned | O 40.00 Federal owned | P 40.00 Federal owned |

District I
1625 N. French Dr., Hobbs, NM 88240
District II
1301 W. Grand Avenue, Artesia, NM 88210
District III
1000 Rio Brazos Road, Aztec, NM 87410
District IV
1220 S. St. Francis Dr., Santa Fe, NM 87505

State of New Mexico
Energy Minerals and Natural Resources

Form C-104B
March 19, 2001

Oil Conservation Division
1220 South St. Francis Dr.
Santa Fe, NM 87505

Submit 1 copy of the final affected
wells list along with 1 copy of this form
per number of wells on that list to
appropriate District Office

Change of Operator Name

OGRID: 000778
Effective Date: 12/31/2001

Previous Operator Name and Information:

Name: Amoco Production Company
Address: P.O. Box 3092
Address: _____
City, State, Zip: Houston, Texas 77253

New Operator Name and Information:

New Name: BP America Production Company
Address: P.O. Box 3092
Address: _____
City, State, Zip: Houston, Texas 77253

I hereby certify that the rules of the Oil Conservation Division have been complied with and that the information given on this form and the attached list of wells is true and complete to the best of my knowledge and belief.

Signature: Mary Corley

Printed name: Mary Corley

Title: Senior Regulatory Specialist

Date: 12/10/2001 Phone: 281-366-4491

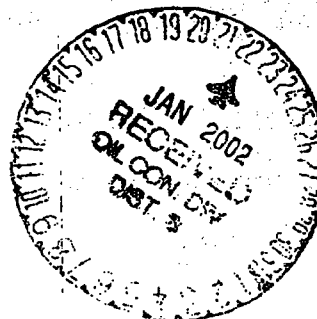

NMOCD Approval

Signature: [Signature]

Printed Name: SUPERVISOR DISTRICT #3

District: JAN 22 2002

Date: _____

UNITED STATES
DEPARTMENT OF THE INTERIOR
BUREAU OF LAND MANAGEMENT

OIL CONSERVATION DIVISION
RECEIVED

FORM APPROVED

Bureau No. 1004-0135
Expires: March 31, 1993

SUNDRY NOTICES AND REPORTS ON WELLS

Do not use this form for proposals to drill or to deepen or reentry to a different reservoir.
Use "APPLICATION FOR PERMIT - " for such proposals

7. Lease Designation and Serial No.

SF-078487-A

8. If Indian, Allottee or Tribe Name

7. If Unit or CA, Agreement Designation

14-08-001-3521

8. Well Name and No.

Pritchard #4

9. API Well No.

30-045-07643

10. Field and Pool, or Exploratory Area

Blanco Pictured Cliffs

11. County or Parish, State

San Juan

New Mexico

1. Type of Well
☐ Oil Well ☒ Gas Well ☐ Other

2. Name of Operator

Attention:

AMOCO PRODUCTION COMPANY

E. W. Baker

3. Address and Telephone No.

P.O. Box 800, Denver, Colorado 80201

(303) 830-4784

4. Location of Well (Footage, Sec., T., R., M., or Survey Description)

1450 FSL

790 FWL

Sec. 31 T 29N R 08W

Unit L

12. CHECK APPROPRIATE BOX(S) TO INDICATE NATURE OF NOTICE, REPORT, OR OTHER DATA

TYPE OF SUBMISSION

TYPE OF ACTION

- ☐ Notice of Intent
☒ Subsequent Report
☐ Final Abandonment Notice

- ☐ Abandonment
☐ Recompletion
☐ Plugging Back
☐ Casing Repair
☐ Altering Casing
☒ Other Workover

- ☐ Change of Plans
☐ New Construction
☐ Non-Routine Fracturing
☐ Water Shut-Off
☐ Conversion to Injection
☐ Dispose Water

(Note: Report results of multiple completion on Well Completion or Recompletion Report and Log form.)

13. Describe Proposed or Completed Operations (Clearly state all pertinent details, and give pertinent dates, including estimated date of starting any proposed work. If well is directionally drilled, give subsurface locations and measured and true vertical depths for all markers and zones pertinent to this work.)*

Please See Attachment.

RECEIVED
MAY 23 1994
OIL CON. DIV.
DIST. 3

RECEIVED
BLM
94 APR 22 AM 10:54
070 FARMINGTON, NM

14. I hereby certify that the foregoing is true and correct

Signed

E.W. Baker

Title

Staff Support

Date

04-20-1994

(This space for Federal or State office use)

Approved by

Title

Conditions of approval, if any:

Title 18 U.S.C. Section 1001, makes it a crime for any person knowingly and willfully to make to any department or agency of the United States any false, fictitious, or fraudulent statements or representations as to any matter within its jurisdiction.

Subsequent Report
Well Name: Pritchard #4
API #: 30-045-07643
San Juan County, New Mexico

2/17/94 MIRUSU. Csg press - 20#, tbg press - 320#, B.head - 20#. Blew dn tbg, killed Mesaverde w/50 bbls 2% clay fix wtr. NDWH & released pkr. NUBOP & reset pkr to keep water from the B.head from Mesaverde formation. Tbg press - 180#, csg - 20#, B.head - 20#. Blew dn tbg & pumped 20 bbls wtr to kill Mesaverde. TOH w/seal assy & 2.875" tbg. Tbg hung in BOP. Stripped off BOP and found rubber tbg guides in BOP. Recovered 26 1' tbg guides. TIH w/junkbasket to 1400'. TOH w/basket & RD Petro. TIH w/ 3-7/8" bit & 4.5" scraper to 2215'. TOH w/tbg & scraper. TIH w/7" scraper to 1400' & tagged. Pushed scraper to 2160'. TOH w/tbg & scraper & found heavy paraffin on scraper. TIH w/7" cup type plg & 7" pkr to 400'. TOH w/plug & pkr. TIH w/7" pkr to 2032' & set pkr to keep OJO fluid off Mesaverde perms. Tbg press. - 220#, csg press - 20#, B.head - 20#. Release pkr & TOH w/tbg & pkr. TIH w/rbp & pkr & tbg. Set rbp @ 2050' & TOH w/1 jt tbg & set pkr. TOH laying dn 2.875" tbg w/2.375" pkr & set pkr @ 1080'. TOH w/tbg laying dn tbg. TIH w/2.375" tbg & tension pkr. Laid dn old tbg string & pu new tbg string. Csg press - 20#, B.head - 20#. TIH w/cbl tool, logged 2000' to surf. Cir B.head w/clean 2% clay fix wtr. TIH w/tbg to 825', RU H.E.S. cmt, pumped 10 bbls wtr ahead of cmt. Pumped 43 bbls cmt mixed w/ 0.8% Halad 322, 2% KCL, 5% Cal seal to fill csg. TOH w/tbg & filled csg w/cmt. Took 8.5 bbls cmt to load csg. Shut in rams, pumped 24 bbls cmt. Well pressured up to 1200# & lost returns up B.head. Started displacement & pumped 1/2 bbl & bridge cleared. Pumped 23 bbls cmt @ avg press of 500#, avg rate of 1.5 bpm w/good returns thru B.head. Started displacement, pumped 11 B.W. When cmt returned to surf, pumped 3 bbls good cmt to pit & SWI w/14 B.W. in csg. Closed in B.head, csg., RD H.E.S. cementers. NDBOP & ND tbg hanger. Weld on 7" csg neck for new seal & new tbg hanger. NU tbg hanger & pres tst'd seals to 1500#. Seals held. NUBOP & TIH w/ 6-3/4" bit, collars & tbg, tagged cmt @ 375'. TOH w/1 std tbg. Csg press - 0#, tbg press - 0#, B.head - 0# w/no wtr flow. Press tst'd csg to 500#, held for 15 min. Started drlg cmt @ 375'. Drilled to 540'. Press tst'd csg to 500#, csg held press for 15 min. Drilled cmt from 540' - 787'. Press tst'd csg to 500#, held. Drilled cmt from 787' - 855' & fell out of good cmt. Drilled stringers to 870'. Press tst'd csg to 500#, held for 15 min. TOH w/tbg & DC's. TIH w/cbl, ran cbl from 2000' to surf. TIH w/ret. head & tbg to 2030'. C/O rig pit, cir sand off rbp w/clean 2% clay fix wtr. TIH & latch onto rbp. Released rbp, & TOH w/tbg & rbp. PU wire shoe, 2 jts wash pipe, collars & TIH w/tbg. Tagged rubbers @ 2160', TOH w/tbg & wash pipe. Recovered two rubbers, TIH w/washpipe & tbg & RU power swivel, worked washpipe over rubbers. TOH w/ washpipe & tbg. 1 jt washpipe was plugged w/rubber. TIH w/1 jt washpipe & tbg. RU pwr swivel, worked washpipe to top of pkr. TOH w/tbg & washpipe. 9' of washpipe plugged w/rubber. TIH w/millshoe, DC's & tbg to pkr top. Milled 36" on pkr & cir hole clean. TOH w/tbg, collars & tbg. TIH w/millshoe, collars & tbg. Milled thru pkr & pkr dropped 13' to top of liner. TIH w/tbg & tagged pkr. TOH w/tbg, collars & millshoe, pkr was not in shoe. RU 4-3/8" grapple & overshot, TIH w/overshot, bumper sub, jars, collars & tbg. Tagged pkr & caught fish. TOH w/tbg, collars, jars, bumper sub & overshot. Laid dn fish, overshot, jars & bumper sub. TIH w/7" scraper & tbg to liner top. TOH w/tbg & scraper. TIH w/ 7" rbp, pkr & tbg, & set rbp @ 2284'. TIH w/1 jt tbg & set pkr. Loaded tbg w/2% clay fix wtr & tst'd plg to 1,000#. Plg tst'd good. TOH w/pkr TO 1748' & tried to cir fluid. Could not get cir to surf. Set pkr @ 1748' & dropped 3 sx sand dn tbg. MIRU H.E.S. to P&A the P.C. zone. Pumped dn backside & loaded csg w/wtr. Pressured csg to 500#. Started wtr dn tbg to establish rate. Established rate of 5 bpm @ 900#. Started pumping cmt & pumped 300 sx class B cmt w/226# Halad 322 & 14 sx Cal seal @ avg rate of 2 bpm & avg press of 600#. Started displacement & pumped 18 B.W. @ 1 bpm & press of 600#. Final press 100#. Released pkr & TOH w/tbg & pkr. TIH w/6-1/4" bit, scraper, collars & tbg. Tagged cmt @ 2012'. RU pwr swivel & pump, started drlg cmt & drilled cmt from 2012' to 2203'. Drilled cmt @ 2203' & drilled out of cmt @ 2271'. Press tst'd csg to 500#. Press bled dn to 415# in ten min. TOH w/tbg, D.C.'s, scraper & bit. Loaded hole w/wtr & SI blind rams. Pressured well to 500#; press held for 15 min. PU ret head & TIH w/tbg & ret head. Cleaned rig pit of cmt, mixed clay fix in clean wtr & prep to cir hole w/ clean wtr. RU pump & cir sand off rbp. Latched onto plg & breleased rbp. TOH w/tbg & rbp. TIH w/4.5" scraper, bit, D.C.'s & tbg, tagged btm @ 4490'. Drilled rubber, sand & metal to PBTD of 4580'. Drilled & swept hole clean w/191,000 scf N2. RD nit. unit & TOH w/tbg, scraper & bit. Laid dn D.C.'s & TIH w/muleshoe, 1 jt 2.375" tbg, SN, F-nipple & 2.375" tbg to 4400'. Csg press - 70#, tbg press - 120#, B.head - 0#. Blew dn press & TIH w/tbg, landed tbg. Prod tbg - muleshoe, 1 jt., SN, F-nipple, 144 jts 2.375" tbg. Btm of tbg @ 4524' w/ K.B., SN @ 4492' w/ K.B. NDBOP & NUWH. TIH w/swab & tagged fluid @ 3000'. Made 24 runs & rec 85 B.W. Total fluid rec w/N2 & swabbing - 195 bbls. Total fluid left to rec - 65 bbls. Final fluid level - 3000'. Final csg press - 320#, final tbg press - 70#. Csg press - 330#, tbg press - 400#, B.head - 0#. Started well flowing to tank, well flowed for 30 min. & flowed 5.1 bbls to tank. TIH w/swab, fluid gas cut. Made 12 runs & on the 6th run well flowed for 20 min. Total fluid swabbed - 21.77 bbls, total fluid flowed - 6.68 bbls. Total fluid recovered - 28.39 bbls. Total fluid left to rec - 37 bbls. SI well w/blow on tbg & 170# csg press. Csg press - 390#, tbg press - 400#, B.head - 0#. Opened well to tank & flowed well to tank for 1 hr. RU swab equip & made 12 runs. Pulled swab from seating nipple after the 5th run. Made 1 run per hr after the 5th run. Recovered a total of 25.09 bbls wtr. Total fluid rec - 53.48 bbls. Total fluid left to rec - 11.52 bbls. Final csg press - 135#. Tbg press - 390#, csg press - 380#. Opened well to tank. well flowed 1 hr. TIH w/swab & made 4 runs. Swabbed & flowed 11.85 bbls. Total fluid rec - 65.33 bbls. Total bbls left to rec - 0. RD & MO swab unit 3/13/94.

UNITED STATES
DEPARTMENT OF THE INTERIOR
BUREAU OF LAND MANAGEMENT

FORM APPROVED
Budget Bureau No. 1004-0135
Expires: March 31, 1993

SUNDRY NOTICES AND REPORTS ON WELLS

Do not use this form for proposals to drill or to deepen or reentry to a different reservoir.
Use "APPLICATION FOR PERMIT - " for such proposals

1. Type of Well

☐ Oil Well ☒ Gas Well ☐ Other

2. Name of Operator

Amoco Production Company

Attention:

D.M. Kilgore

3. Address and Telephone No.

P.O. Box 800, Denver, Colorado 80201

(303) 830-5573

4. Location of Well (Footage, Sec., T., R., M., or Survey Description)

1450FSL

790FWL

Sec. 31 T 29N R 08W

Unit L

5. Lease Designation and Serial No.

SF-078487-A

6. If Indian, Allottee or Tribe Name

7. If Unit or CA, Agreement Designation

14-08-001-3521

8. Well Name and No.

Pritchard #4

9. API Well No.

3004507643

10. Field and Pool, or Exploratory Area

Blanco Pictured Cliffs

11. County or Parish, State

San Juan

New Mexico

12. CHECK APPROPRIATE BOX(s) TO INDICATE NATURE OF NOTICE, REPORT, OR OTHER DATA

TYPE OF SUBMISSION

TYPE OF ACTION

- ☒ Notice of Intent
☐ Subsequent Report
☐ Final Abandonment Notice

- ☒ Abandonment
☐ Recompletion
☐ Plugging Back
☐ Casing Repair
☐ Altering Casing
☐ Other

- ☐ Change of Plans
☐ New Construction
☐ Non-Routine Fracturing
☐ Water Shut-Off
☐ Conversion to Injection
☐ Dispose Water

(Note: Report results of multiple completion on Well Completion or Recompletion Report and Log form.)

13. Describe Proposed or Completed Operations (Clearly state all pertinent details, and give pertinent dates, including estimated date of starting any proposed work. If well is directionally drilled, give subsurface locations and measured and true vertical depths for all markers and zones pertinent to this work.)*

During Bradenhead repair (previously approved), mechanical problems were discovered at the Pictured Cliffs formation. The PC is a low producer (10 MCFD). The cost to fix outweighs the ability to produce. Amoco would like to P&A this formation so that the Mesaverde will produce at a higher rate.

squeeze formation & fill w/ cement approx 25 sack

RECEIVED
MAR 4 1994
OIL CON. DIV. I
DIST 3

Verbal approval
3/2/94 12:20pm
RECEIVED
3/2/94 11:54
W. J. J. J.

14. I hereby certify that the foregoing is true and correct

Signed

Clayton M. Kilgore

Title

Business Analyst

Date

03-01-1994

(This space for Federal or State office use)

Approved by

Title

APPROVED

Conditions of approval, if any:

MAR 09 1994

Title 18 U.S.C. Section 1001, makes it a crime for any person knowingly and willfully to make to any department or agency of the United States any false, fictitious or fraudulent statements or representations as to any matter within its jurisdiction.

AMOCO

DISTRICT MANAGER

CMD :
OG6IWCM

ONGARD
INQUIRE WELL COMPLETIONS

11/17/04 14:31:55
OGOMES -TPL3

API Well No : 30 45 7643 Eff Date : 01-01-1900 WC Status : A
Pool Idn : 72359 BLANCO PICTURED CLIFFS (GAS)
OGRID Idn : 778 BP AMERICA PRODUCTION COMPANY
Prop Idn : 959 PRITCHARD

Well No : 004
GL Elevation: 5769

| | U/L | Sec | Township | Range | North/South | East/West | Prop/Act (P/A) |
|-----------|------|-----|----------|-------|--------------|-------------|----------------|
| E.H. Loop | : 10 | 31 | 29N | 08W | PTG 1450 F S | PTG 790 F W | P |

Lot Identifier:
Dedicated Acre: 160.00
Lease Type : F
Type of consolidation (Comm, Unit, Forced Pooling - C/U/F/O) :

| | | | | | |
|-----------|------|-----------|--------------|--------------|-------------|
| PF01 HELP | PF02 | PF03 EXIT | PF04 GoTo | PF05 | PF06 |
| PF07 | PF08 | PF09 | PF10 NEXT-WC | PF11 HISTORY | PF12 NXTREC |

CMD :
OG6ACRE

ONGARD
C102-DEDICATE ACREAGE

11/17/04 14:32:00
OGOMES -TPL3
Page No : 1

API Well No : 30 45 7643 Eff Date : 04-30-1991
Pool Idn : 72359 BLANCO PICTURED CLIFFS (GAS)
Prop Idn : 959 PRITCHARD Well No : 004
Spacing Unit : 5700 OCD Order : Simultaneous Dedication:
Sect/Twp/Rng : 31 29N 08W Acreage : 160.00 Revised C102? (Y/N) :
Dedicated Land:

| S | Base | U/L | Sec | Twp | Rng | Acreage | L/W | Ownership | Lot | Idn |
|---|------|-----|-----|-----|-------|---------|-----|-----------|-----|-----|
| L | 10 | 31 | 29N | 08W | 19.76 | N | FD | | | |
| M | 11 | 31 | 29N | 08W | 21.18 | N | FD | | | |
| N | 12 | 31 | 29N | 08W | 51.64 | N | FD | | | |
| K | 9 | 31 | 29N | 08W | 48.02 | N | FD | | | |

E0005: Enter data to modify or PF keys to scroll

| | | | | | |
|-----------|----------|-----------|-----------|-------------|--------------|
| PF01 HELP | PF02 | PF03 EXIT | PF04 GoTo | PF05 | PF06 CONFIRM |
| PF07 BKWD | PF08 FWD | PF09 | PF10 LAND | PF11 NXTSEC | PF12 RECONF |

CMD :
OG6IPRD

ONGARD
INQUIRE PRODUCTION BY POOL/WELL

11/17/04 14:31:30
OGOMES -TPL3
Page No: 1

OGRID Identifier : 778 BP AMERICA PRODUCTION COMPANY
Pool Identifier : 72359 BLANCO PICTURED CLIFFS (GAS)
API Well No : 30 45 7643 Report Period - From : 01 1993 To : 09 2004

| API Well No | Property Name | Prod. | Days | Production Volumes | Well |
|-------------|---------------|-------|------|--------------------|------|
| | | MM/YY | Prod | Gas Oil Water | Stat |
| 30 45 7643 | PRITCHARD | 01 93 | 31 | 2322 | F |
| 30 45 7643 | PRITCHARD | 02 93 | 28 | 2145 | F |
| 30 45 7643 | PRITCHARD | 03 93 | 31 | 2306 | F |
| 30 45 7643 | PRITCHARD | 04 93 | 30 | 2006 | F |
| 30 45 7643 | PRITCHARD | 05 93 | 31 | 1689 | F |
| 30 45 7643 | PRITCHARD | 06 93 | 30 | 393 | F |
| 30 45 7643 | PRITCHARD | 01 94 | 20 | | F |

Reporting Period Total (Gas, Oil) :

M0002: This is the first page

| | | | | | |
|-----------|----------|-----------|--------------|-------------|--------------|
| PF01 HELP | PF02 | PF03 EXIT | PF04 GoTo | PF05 | PF06 CONFIRM |
| PF07 BKWD | PF08 FWD | PF09 | PF10 NXTPOOL | PF11 NXTOGD | PF12 |

CMD :
OG6IPRD

ONGARD
INQUIRE PRODUCTION BY POOL/WELL

11/17/04 14:31:33
OGOMES -TPL3
Page No: 2

OGRID Identifier : 778 BP AMERICA PRODUCTION COMPANY
Pool Identifier : 72359 BLANCO PICTURED CLIFFS (GAS)
API Well No : 30 45 7643 Report Period - From : 01 1993 To : 09 2004

| API Well No | Property Name | Prod. Days MM/YY Prod | Production Volumes Gas Oil Water | Well Stat |
|-------------|---------------|--------------------------|-------------------------------------|--------------|
| 30 45 7643 | PRITCHARD | 02 94 16 | 174 | F |
| 30 45 7643 | PRITCHARD | 03 94 | | F |
| 30 45 7643 | PRITCHARD | 04 94 | | S |
| 30 45 7643 | PRITCHARD | 05 94 | | S |
| 30 45 7643 | PRITCHARD | 06 94 | | S |
| 30 45 7643 | PRITCHARD | 07 94 | | S |
| 30 45 7643 | PRITCHARD | 08 94 | | S |

Reporting Period Total (Gas, Oil) :

E0049: User may continue scrolling.

| | | | | | |
|-----------|----------|-----------|--------------|-------------|--------------|
| PF01 HELP | PF02 | PF03 EXIT | PF04 GoTo | PF05 | PF06 CONFIRM |
| PF07 BKWD | PF08 FWD | PF09 | PF10 NXTPOOL | PF11 NXTOGD | PF12 |

CMD :
OG6IPRD

ONGARD
INQUIRE PRODUCTION BY POOL/WELL

11/17/04 14:31:35
OGOMES -TPL3
Page No: 3

OGRID Identifier : 778 BP AMERICA PRODUCTION COMPANY
Pool Identifier : 72359 BLANCO PICTURED CLIFFS (GAS)
API Well No : 30 45 7643 Report Period - From : 01 1993 To : 09 2004

| API Well No | Property Name | Prodn. Days MM/YY Prod | Production Volumes Gas Oil Water | Well Stat |
|-------------|---------------|---------------------------|-------------------------------------|--------------|
| 30 45 7643 | PRITCHARD | 09 94 | | S |
| 30 45 7643 | PRITCHARD | 10 94 | | S |
| 30 45 7643 | PRITCHARD | 11 94 | | S |
| 30 45 7643 | PRITCHARD | 12 94 | | S |
| 30 45 7643 | PRITCHARD | 01 95 | | S |
| 30 45 7643 | PRITCHARD | 02 95 | | S |
| 30 45 7643 | PRITCHARD | 03 95 | | S |

Reporting Period Total (Gas, Oil) :

E0049: User may continue scrolling.

| | | | | | |
|-----------|----------|-----------|--------------|-------------|--------------|
| PF01 HELP | PF02 | PF03 EXIT | PF04 GoTo | PF05 | PF06 CONFIRM |
| PF07 BKWD | PF08 FWD | PF09 | PF10 NXTPOOL | PF11 NXTOGD | PF12 |

CMD :
OC61PRD

ONGARD
INQUIRE PRODUCTION BY POOL/WELL

11/17/04 14:31:34
OGOMES -TPL3
Page No: 4

OGRID Identifier : 778 BP AMERICA PRODUCTION COMPANY
Pool Identifier : 72359 BLANCO PICTURED CLIFFS (GAS)
API Well No : 30 45 7643 Report Period - From : 01 1993 To : 09 2004

| API Well No | Property Name | Prod. Days MM/YY Prod | Production Volumes Gas Oil Water | Well Stat |
|-------------|---------------|--------------------------|-------------------------------------|--------------|
| 30 45 7643 | PRITCHARD | 04 95 | | S |
| 30 45 7643 | PRITCHARD | 05 95 | | S |
| 30 45 7643 | PRITCHARD | 06 95 | | S |
| 30 45 7643 | PRITCHARD | 07 95 | | S |
| 30 45 7643 | PRITCHARD | 08 95 | | S |
| 30 45 7643 | PRITCHARD | 09 95 | | S |
| 30 45 7643 | PRITCHARD | 10 95 | | S |

Reporting Period Total (Gas, Oil) :

E0049: User may continue scrolling.

| | | | | | |
|-----------|----------|-----------|--------------|-------------|--------------|
| PF01 HELP | PF02 | PF03 EXIT | PF04 GoTo | PF05 | PF06 CONFIRM |
| PF07 BKWD | PF08 FWD | PF09 | PF10 NXTPOOL | PF11 NXTOGD | PF12 |

CMD :
OG6IPRD

ONGARD
INQUIRE PRODUCTION BY POOL/WELL

11/17/04 14:31:37
OGOMES -TPL3
Page No: 5

OGRID Identifier : 778 BP AMERICA PRODUCTION COMPANY
Pool Identifier : 72359 BLANCO PICTURED CLIFFS (GAS)
API Well No : 30 45 7643 Report Period - From : 01 1993 To : 09 2004

| API Well No | Property Name | Prodn. Days MM/YY Prod | Production Volumes Gas Oil Water | Well Stat |
|-------------|---------------|---------------------------|-------------------------------------|--------------|
| 30 45 7643 | PRITCHARD | 11 95 | | S |
| 30 45 7643 | PRITCHARD | 12 95 | | S |
| 30 45 7643 | PRITCHARD | 01 96 | | S |
| 30 45 7643 | PRITCHARD | 02 96 | | S |
| 30 45 7643 | PRITCHARD | 03 96 | | S |
| 30 45 7643 | PRITCHARD | 04 96 | | S |
| 30 45 7643 | PRITCHARD | 05 96 | | S |

Reporting Period Total (Gas, Oil) :

E0049: User may continue scrolling.

| | | | | | |
|-----------|----------|-----------|--------------|-------------|--------------|
| PF01 HELP | PF02 | PF03 EXIT | PF04 GoTo | PF05 | PF06 CONFIRM |
| PF07 BKWD | PF08 FWD | PF09 | PF10 NXTPOOL | PF11 NXTOGD | PF12 |

CMD :
OG6IPRD

ONGARD
INQUIRE PRODUCTION BY POOL/WELL

11/17/04 14:31:38
OGOMES -TPL3
Page No: 6

OGRID Identifier : 778 BP AMERICA PRODUCTION COMPANY
Pool Identifier : 72359 BLANCO PICTURED CLIFFS (GAS)
API Well No : 30 45 7643 Report Period - From : 01 1993 To : 09 2004

| API Well No | Property Name | Prodn. Days MM/YY Prod | Production Volumes Gas Oil Water | Well Stat |
|-------------|---------------|---------------------------|-------------------------------------|--------------|
| 30 45 7643 | PRITCHARD | 06 96 | | S |
| 30 45 7643 | PRITCHARD | 07 96 | | S |
| 30 45 7643 | PRITCHARD | 08 96 | | S |
| 30 45 7643 | PRITCHARD | 09 96 | | S |
| 30 45 7643 | PRITCHARD | 10 96 | | S |
| 30 45 7643 | PRITCHARD | 11 96 | | S |
| 30 45 7643 | PRITCHARD | 12 96 | | S |

Reporting Period Total (Gas, Oil) :

E0049: User may continue scrolling.

| | | | | | |
|-----------|----------|-----------|--------------|-------------|--------------|
| PF01 HELP | PF02 | PF03 EXIT | PF04 GoTo | PF05 | PF06 CONFIRM |
| PF07 BKWD | PF08 FWD | PF09 | PF10 NXTPOOL | PF11 NXTOGD | PF12 |

CMD :
OG6IPRD

ONGARD
INQUIRE PRODUCTION BY POOL/WELL

11/17/04 14:31:39
OGOMES -TPL3
Page No: 7

OGRID Identifier : 778 BP AMERICA PRODUCTION COMPANY
Pool Identifier : 72359 BLANCO PICTURED CLIFFS (GAS)
API Well No : 30 45 7643 Report Period - From : 01 1993 To : 09 2004

| API Well No | Property Name | Prod. | Days | Production Volumes | Well |
|-------------|---------------|-------|------|--------------------|------|
| | | MM/YY | Prod | Gas Oil Water | Stat |
| 30 45 7643 | PRITCHARD | 01 | 97 | | S |
| 30 45 7643 | PRITCHARD | 02 | 97 | | S |
| 30 45 7643 | PRITCHARD | 03 | 97 | | S |
| 30 45 7643 | PRITCHARD | 04 | 97 | | S |
| 30 45 7643 | PRITCHARD | 05 | 97 | | S |
| 30 45 7643 | PRITCHARD | 06 | 97 | | S |
| 30 45 7643 | PRITCHARD | 07 | 97 | | S |

Reporting Period Total (Gas, Oil) :

E0049: User may continue scrolling.

| | | | | | |
|-----------|----------|-----------|--------------|-------------|--------------|
| PF01 HELP | PF02 | PF03 EXIT | PF04 GoTo | PF05 | PF06 CONFIRM |
| PF07 BKWD | PF08 FWD | PF09 | PF10 NXTPOOL | PF11 NXTOGD | PF12 |

CMD :
OG6IPRD

ONGARD
INQUIRE PRODUCTION BY POOL/WELL

11/17/04 14:31:40
OGOMES -TPL3
Page No: 8

OGRID Identifier : 778 BP AMERICA PRODUCTION COMPANY
Pool Identifier : 72359 BLANCO PICTURED CLIFFS (GAS)
API Well No : 30 45 7643 Report Period - From : 01 1993 To : 09 2004

| API Well No | Property Name | Prodn. Days MM/YY Prod | Production Volumes Gas Oil Water | Well Stat |
|-------------|---------------|---------------------------|-------------------------------------|--------------|
| 30 45 7643 | PRITCHARD | 08 97 | | S |
| 30 45 7643 | PRITCHARD | 09 97 | | S |
| 30 45 7643 | PRITCHARD | 10 97 | | S |
| 30 45 7643 | PRITCHARD | 11 97 | | S |
| 30 45 7643 | PRITCHARD | 12 97 | | S |
| 30 45 7643 | PRITCHARD | 01 98 | | S |
| 30 45 7643 | PRITCHARD | 02 98 | | S |

Reporting Period Total (Gas, Oil) :

E0049: User may continue scrolling.

| | | | | | |
|-----------|----------|-----------|--------------|-------------|--------------|
| PF01 HELP | PF02 | PF03 EXIT | PF04 GoTo | PF05 | PF06 CONFIRM |
| PF07 BKWD | PF08 FWD | PF09 | PF10 NXTPOOL | PF11 NXTOGD | PF12 |

CMD :
OG6IPRD

ONGARD
INQUIRE PRODUCTION BY POOL/WELL

11/17/04 14:31:41
OGOMES -TPL3
Page No: 9

OGRID Identifier : 778 BP AMERICA PRODUCTION COMPANY
Pool Identifier : 72359 BLANCO PICTURED CLIFFS (GAS)
API Well No : 30 45 7643 Report Period - From : 01 1993 To : 09 2004

| API Well No | Property Name | Prod. Days MM/YY Prod | Production Volumes Gas Oil Water | Well Stat |
|-------------|---------------|--------------------------|-------------------------------------|--------------|
| 30 45 7643 | PRITCHARD | 03 98 | | S |
| 30 45 7643 | PRITCHARD | 04 98 | | S |
| 30 45 7643 | PRITCHARD | 05 98 | | S |
| 30 45 7643 | PRITCHARD | 06 98 | | S |
| 30 45 7643 | PRITCHARD | 07 98 | | S |
| 30 45 7643 | PRITCHARD | 08 98 | | S |
| 30 45 7643 | PRITCHARD | 09 98 | | S |

Reporting Period Total (Gas, Oil) :

E0049: User may continue scrolling.

| | | | | | |
|-----------|----------|-----------|--------------|-------------|--------------|
| PF01 HELP | PF02 | PF03 EXIT | PF04 GoTo | PF05 | PF06 CONFIRM |
| PF07 BKWD | PF08 FWD | PF09 | PF10 NXTPOOL | PF11 NXTOGD | PF12 |

CMD :
OG6IPRD

ONGARD
INQUIRE PRODUCTION BY POOL/WELL

11/17/04 14:31:42
OGOMES -TPL3
Page No: 10

OGRID Identifier : 778 BP AMERICA PRODUCTION COMPANY
Pool Identifier : 72359 BLANCO PICTURED CLIFFS (GAS)
API Well No : 30 45 7643 Report Period - From : 01 1993 To : 09 2004

| API Well No | Property Name | Prodn. Days MM/YY Prod | Production Volumes Gas Oil Water | Well Stat |
|-------------|---------------|---------------------------|-------------------------------------|--------------|
| 30 45 7643 | PRITCHARD | 10 98 | | S |
| 30 45 7643 | PRITCHARD | 11 98 | | S |
| 30 45 7643 | PRITCHARD | 12 98 | | S |
| 30 45 7643 | PRITCHARD | 01 99 | | S |
| 30 45 7643 | PRITCHARD | 02 99 | | S |
| 30 45 7643 | PRITCHARD | 03 99 | | S |
| 30 45 7643 | PRITCHARD | 04 99 | | S |

Reporting Period Total (Gas, Oil) :

E0049: User may continue scrolling.

| | | | | | |
|-----------|----------|-----------|--------------|-------------|--------------|
| PF01 HELP | PF02 | PF03 EXIT | PF04 GoTo | PF05 | PF06 CONFIRM |
| PF07 BKWD | PF08 FWD | PF09 | PF10 NXTPOOL | PF11 NXTOGD | PF12 |

CMD :
OG6IPRD

ONGARD
INQUIRE PRODUCTION BY POOL/WELL

11/17/04 14:31:43
OGOMES -TPL3
Page No: 11

OGRID Identifier : 778 BP AMERICA PRODUCTION COMPANY
Pool Identifier : 72359 BLANCO PICTURED CLIFFS (GAS)
API Well No : 30 45 7643 Report Period - From : 01 1993 To : 09 2004

| API Well No | Property Name | Prodn. Days MM/YY Prod | Production Volumes Gas Oil Water | Well Stat |
|-------------|---------------|---------------------------|-------------------------------------|--------------|
| 30 45 7643 | PRITCHARD | 05 99 | | S |
| 30 45 7643 | PRITCHARD | 06 99 | | S |
| 30 45 7643 | PRITCHARD | 07 99 | | S |
| 30 45 7643 | PRITCHARD | 08 99 | | S |
| 30 45 7643 | PRITCHARD | 09 99 | | S |
| 30 45 7643 | PRITCHARD | 10 99 | | S |
| 30 45 7643 | PRITCHARD | 11 99 | | S |

Reporting Period Total (Gas, Oil) :

E0049: User may continue scrolling.

| | | | | | |
|-----------|----------|-----------|--------------|-------------|--------------|
| PF01 HELP | PF02 | PF03 EXIT | PF04 GoTo | PF05 | PF06 CONFIRM |
| PF07 BKWD | PF08 FWD | PF09 | PF10 NXTPOOL | PF11 NXTOGD | PF12 |

CMD :
OG6IPRD

ONGARD
INQUIRE PRODUCTION BY POOL/WELL

11/17/04 14:31:44
OGOMES -TPL3
Page No: 12

OGRID Identifier : 778 BP AMERICA PRODUCTION COMPANY
Pool Identifier : 72359 BLANCO PICTURED CLIFFS (GAS)
API Well No : 30 45 7643 Report Period - From : 01 1993 To : 09 2004

| API Well No | Property Name | Prodn. Days MM/YY Prod | Production Volumes Gas Oil Water | Well Stat |
|-------------|---------------|---------------------------|-------------------------------------|--------------|
| 30 45 7643 | PRITCHARD | 12 99 | | S |
| 30 45 7643 | PRITCHARD | 01 00 | | S |
| 30 45 7643 | PRITCHARD | 02 00 | | S |
| 30 45 7643 | PRITCHARD | 03 00 | | S |
| 30 45 7643 | PRITCHARD | 08 00 | | S |
| 30 45 7643 | PRITCHARD | 09 00 | | S |
| 30 45 7643 | PRITCHARD | 01 03 | | S |

Reporting Period Total (Gas, Oil) :

E0049: User may continue scrolling.

| | | | | | |
|-----------|----------|-----------|--------------|-------------|--------------|
| PF01 HELP | PF02 | PF03 EXIT | PF04 GoTo | PF05 | PF06 CONFIRM |
| PF07 BKWD | PF08 FWD | PF09 | PF10 NXTPOOL | PF11 NXTOGD | PF12 |

CMD :
OG6IPRD

ONGARD
INQUIRE PRODUCTION BY POOL/WELL

11/17/04 14:31:45
OGOMES -TPL3
Page No: 13

OGRID Identifier : 778 BP AMERICA PRODUCTION COMPANY
Pool Identifier : 72359 BLANCO PICTURED CLIFFS (GAS)
API Well No : 30 45 7643 Report Period - From : 01 1993 To : 09 2004

| API Well No | Property Name | Prodn. Days MM/YY Prod | Production Volumes Gas Oil Water | Well Stat |
|-------------|---------------|---------------------------|-------------------------------------|--------------|
| 30 45 7643 | PRITCHARD | 02 03 | | S |
| 30 45 7643 | PRITCHARD | 03 03 | | S |
| 30 45 7643 | PRITCHARD | 04 03 | | S |
| 30 45 7643 | PRITCHARD | 05 03 | | S |
| 30 45 7643 | PRITCHARD | 06 03 | | S |
| 30 45 7643 | PRITCHARD | 07 03 | | S |
| 30 45 7643 | PRITCHARD | 08 03 | | S |

Reporting Period Total (Gas, Oil) :

E0049: User may continue scrolling.

| | | | | | |
|-----------|----------|-----------|--------------|-------------|--------------|
| PF01 HELP | PF02 | PF03 EXIT | PF04 GoTo | PF05 | PF06 CONFIRM |
| PF07 BKWD | PF08 FWD | PF09 | PF10 NXTPOOL | PF11 NXTOGD | PF12 |

CMD :
OG6IPRD

ONGARD
INQUIRE PRODUCTION BY POOL/WELL

11/17/04 14:31:46
OGOMES -TPL3
Page No: 14

OGRID Identifier : 778 BP AMERICA PRODUCTION COMPANY

Pool Identifier : 72359 BLANCO PICTURED CLIFFS (GAS)

API Well No : 30 45 7643 Report Period - From : 01 1993 To : 09 2004

| API Well No | Property Name | Prodn. Days MM/YY Prod | Production Volumes Gas Oil Water | Well Stat |
|-------------|---------------|---------------------------|-------------------------------------|--------------|
| 30 45 7643 | PRITCHARD | 09 03 | | S |
| 30 45 7643 | PRITCHARD | 10 03 | | S |
| 30 45 7643 | PRITCHARD | 11 03 | | S |
| 30 45 7643 | PRITCHARD | 12 03 | | S |
| 30 45 7643 | PRITCHARD | 01 04 | | S |
| 30 45 7643 | PRITCHARD | 02 04 | | S |
| 30 45 7643 | PRITCHARD | 03 04 | | S |

Reporting Period Total (Gas, Oil) :

E0049: User may continue scrolling.

| | | | | | |
|-----------|----------|-----------|--------------|-------------|--------------|
| PF01 HELP | PF02 | PF03 EXIT | PF04 GoTo | PF05 | PF06 CONFIRM |
| PF07 BKWD | PF08 FWD | PF09 | PF10 NXTPOOL | PF11 NXTOGD | PF12 |

CMD :
OG6IPRD

ONGARD
INQUIRE PRODUCTION BY POOL/WELL

11/17/04 14:31:47
OGOMES -TPL3
Page No: 15

OGRID Identifier : 778 BP AMERICA PRODUCTION COMPANY
Pool Identifier : 72359 BLANCO PICTURED CLIFFS (GAS)
API Well No : 30 45 7643 Report Period - From : 01 1993 To : 09 2004

| API Well No | Property Name | Prod. | Days | Production Volumes | Well |
|-------------|---------------|-------|------|--------------------|------|
| | | MM/YY | Prod | Gas Oil Water | Stat |
| 30 45 7643 | PRITCHARD | 04 | 04 | | S |
| 30 45 7643 | PRITCHARD | 05 | 04 | | S |
| 30 45 7643 | PRITCHARD | 06 | 04 | | S |
| 30 45 7643 | PRITCHARD | 07 | 04 | | S |
| 30 45 7643 | PRITCHARD | 08 | 04 | | S |

Reporting Period Total (Gas, Oil) : 11035

E0049: User may continue scrolling.

| | | | | | |
|-----------|----------|-----------|--------------|-------------|--------------|
| PF01 HELP | PF02 | PF03 EXIT | PF04 GoTo | PF05 | PF06 CONFIRM |
| PF07 BKWD | PF08 FWD | PF09 | PF10 NXTPOOL | PF11 NXTOGD | PF12 |

CMD :
OG6IWCM

ONGARD
INQUIRE WELL COMPLETIONS

11/17/04 13:44:59
OGOMES -TPL3

API Well No : 30 45 7643 Eff Date : 01-01-1900 WC Status : A
Pool Idn : 72359 BLANCO PICTURED CLIFFS (GAS)
OGRID Idn : 778 BP AMERICA PRODUCTION COMPANY
Prop Idn : 959 PRITCHARD

Well No : 004
GL Elevation: 5769

| | U/L | Sec | Township | Range | North/South | East/West | Prop/Act(P/A) |
|--|--------|-----|----------|-------|--------------|-------------|---------------|
| B.H. Locn | : 10 | 31 | 29N | 08W | FTG 1450 F S | FTG 790 F W | P |
| Lot Identifier: | | | | | | | |
| Dedicated Acre: | 160.00 | | | | | | |
| Lease Type | : F | | | | | | |
| Type of consolidation (Comm, Unit, Forced Pooling - C/U/F/O) | : | | | | | | |

| | | | | | |
|-----------|------|-----------|--------------|--------------|-------------|
| PF01 HELP | PF02 | PF03 EXIT | PF04 GoTo | PF05 | PF06 |
| PF07 | PF08 | PF09 | PF10 NEXT-WC | PF11 HISTORY | PF12 NXTREC |

CMD :
OG6ACRE

ONGARD
C102-DEDICATE ACREAGE

11/17/04 13:45:06
OGOMES -TPL3
Page No : 1

API Well No : 30 45 7643 Eff Date : 04-30-1991
Pool Idn : 72359 BLANCO PICTURED CLIFFS (GAS)
Prop Idn : 959 PRITCHARD Well No : 004
Spacing Unit : 5700 OCD Order : Simultaneous Dedication:
Sect/Twp/Rng : 31 29N 08W Acreage : 160.00 Revised C102? (Y/N) :
Dedicated Land:

| S | Base | U/L | Sec | Twp | Rng | Acreage | L/W | Ownership | Lot Idn |
|---|------|-----|-----|-----|-----|---------|-----|-----------|---------|
| | L | 10 | 31 | 29N | 08W | 19.76 | N | FD | |
| | M | 11 | 31 | 29N | 08W | 21.18 | N | FD | |
| | N | 12 | 31 | 29N | 08W | 51.64 | N | FD | |
| | K | 9 | 31 | 29N | 08W | 48.02 | N | FD | |

E0005: Enter data to modify or PF keys to scroll

| | | | | | |
|-----------|----------|-----------|-----------|-------------|--------------|
| PF01 HELP | PF02 | PF03 EXIT | PF04 GoTo | PF05 | PF06 CONFIRM |
| PF07 BKWD | PF08 FWD | PF09 | PF10 LAND | PF11 NXTSEC | PF12 RECONF |

Submit 3 Copies To Appropriate District Office
District I
1625 N. French Dr., Hobbs, NM 88240
District II
1301 W. Grand Ave., Artesia, NM 88210
District III
1000 Rio Brazos Rd., Aztec, NM 87410
District IV
1220 S. St. Francis Dr., Santa Fe, NM 87505

State of New Mexico
Energy, Minerals and Natural Resources

Form C-103
March 4, 2004

OIL CONSERVATION DIVISION
1220 South St. Francis Dr.
Santa Fe, NM 87505

| |
|---|
| WELL API NO. 30-045-22497 |
| 5. Indicate Type of Lease STATE <input type="checkbox"/> FEE <input type="checkbox"/> |
| 6. State Oil & Gas Lease No. |
| 7. Lease Name or Unit Agreement Name Pritchard (Filed with BLM - Federal Lease SF -078487-A) |
| 8. Well Number 4A |
| 9. OGRID Number 000778 |
| 10. Pool name or Wildcat Blanco Mesaverde & Pictured Cliffs |

SUNDRY NOTICES AND REPORTS ON WELLS
(DO NOT USE THIS FORM FOR PROPOSALS TO DRILL OR TO DEEEN OR PLUG BACK A DIFFERENT RESERVOIR. USE "APPLICATION FOR PERMIT" (FORM C-101) FOR SUCH PROPOSALS.)

1. Type of Well:
Oil Well ☐ Gas Well ☒ Other

2. Name of Operator
BP America Production Company

3. Address of Operator
P O Box 3092 Houston, TX 77253 Attn: Mary Corley Rm 19.171

4. Well Location

Unit Letter F : 1830 feet from the North line and 1705 feet from the West line

Section 31 Township 29N Range 08W NMPM San Juan County

11. Elevation (Show whether DR, RKB, RT, GR, etc.)
6011' GL

Pit or Below-grade Tank Application (For pit or below-grade tank closures, a form C-144 must be attached)

Pit Location: UL F Sect 31 Twp 29N Rng 08W Pit type Workover Depth to Groundwater >100 Distance from nearest fresh water well >1000

Distance from nearest surface water >1000' Below-grade Tank Location UL Sect Twp Rng ;

+/- 1830 feet from the North line and +/- 1705 feet from the West line

12. Check Appropriate Box to Indicate Nature of Notice, Report or Other Data

NOTICE OF INTENTION TO:

PERFORM REMEDIAL WORK ☐ PLUG AND ABANDON ☐

TEMPORARILY ABANDON ☐ CHANGE PLANS ☐

PULL OR ALTER CASING ☐ MULTIPLE COMPLETION ☐

OTHER: Recompletion & DHC - Pit Permit ☒

SUBSEQUENT REPORT OF:

REMEDIAL WORK ☐ ALTERING CASING ☐

COMMENCE DRILLING OPNS. ☐ PLUG AND ABANDONMENT ☐

CASING TEST AND CEMENT JOB ☐

OTHER: ☐

13. Describe proposed or completed operations. (Clearly state all pertinent details, and give pertinent dates, including estimated date of starting any proposed work). SEE RULE 1103. For Multiple Completions: Attach wellbore diagram of proposed completion or recompletion.

BP America Production Company request permission to recomplete the subject well into the Blanco Pictured Cliffs and commingle production Downhole with the existing Blanco Mesaverde as per the attached procedure.

DHC 1689 AZ

I hereby certify that the information above is true and complete to the best of my knowledge and belief. I further certify that any pit or below-grade tank has been/will be constructed or closed according to NMOCD guidelines ☐ , a general permit ☐ or an (attached) alternative OCD-approved plan ☐.

SIGNATURE Mary Corley TITLE Sr. Regulatory Analyst DATE 11/01/2004

Type or print name Mary Corley E-mail address: corleym1@bp.com Telephone No. 281-366-4491

(This Space for State Use)

APPROVED BY [Signature] TITLE DEPUTY OIL & GAS INSPECTOR, DIST. 03 DATE NOV - 3 2004

Conditions of approval, if any: Commingle only, recompletion must be on Federal Form

Pritchard 4A

Downhole Commingling

The Blanco Mesaverde (72319) and Blanco Pictured Cliffs (72359) Pools are Pre-Approved Pools for Downhole Commingling per NMOCD order R-11363. The working and overriding royalty interest owners in the proposed commingled pools are identical, therefore no additional notification is required.

Production is proposed to be allocated based on the subtraction method using the projected future decline for production from the Mesaverde. That production shall serve as a base for production subtracted from the total production for the commingled well. The balance of the production will be attributed to the Pictured Cliffs. Attached is the future production decline estimates for the Mesaverde.

Commingling Production Downhole in the subject well from the proposed Pools with not reduce the value of the total remaining production.

PIT

Construct a lined workover pit per BP America – San Juan Basin Drilling/ Workover Pit Construction Plan issued date of 04/15/2004. Pit will be closed according to closure plan on file.

Pritchard 4 A
Recompletion and Downhole Commingle Procedure
October 28, 2004

Procedure:

1. Check anchors. Check ID wellhead, if earth pit is required have One Call made 48 hours prior to digging.
2. Check and record tubing, casing, and bradenhead pressures. Ensure production casing has double casing valves installed. Double valve all casing strings.
3. RU slickline unit or wireline unit. RIH and set two barriers (CIBP, tbg collar stop w/plug, or plug set in nipple) for isolation.
4. MIRU workover rig.
5. Blow down well. Kill with 2% KCL water ONLY if necessary. Check all casing strings to ensure no pressure exist on any annulus.
6. Nipple down Wellhead. NU BOPs and diversion spool with 3" outlets and 3" pipe to the blow tank. Pressure test BOPs to 200 psi above BHP. Monitor flowing casing pressure with gauge (with casing flowing to blow tank) throughout workover.
7. Pull tubing hanger and shut pipe rams and install stripping rubber.
8. TOH with 2-3/8" production tubing currently set at 4,822' using approved "Under Balance Well Control Tripping Procedure".

Contingency: *If the tubing is in poor condition, replace entire tubing string.*

9. TIH with bit and scraper for 7" casing to 2,800' with approved barriers. Check the distance between the top of the blind ram and the length of the bottom hole assembly that is being run. If the BHA is too long then the well has to be top killed and monitored prior to opening blind rams.
10. Set retrievable bridge plug w/ 10' of sand at +/- 2,700' to isolate Mesaverde and liner top. Ensure BP is not set in casing collar.
11. Load hole w/ 2% KCl and pressure test casing to 2,500 psi w/ rig pumps
12. RU E-line and run CBL from 2,700' to surface. Confirm that top of cement is above 2,000' – if not, contact engineer to discuss cement squeeze.
13. RIH with 3-1/8" casing guns (Lubricator required). Perforate Pictured Cliffs formation (correlate to GR log). RDWL and lubricator.

Pictured Cliffs perforations, 4 spf (15 shots/ 60 holes):

14. NU Wellhead Isolation tool Spearhead 500 gal 15% HCL, establish injection rate, and proceed with fracture stimulation according to Schlumberger schedule. Maintain surface pressures ≤ 3000 psi during frac job. Flush frac with foam. Fill out GWSI scorecard.
15. Remove Isolation Tool, Flowback frac immediately. Flow well through the 3" line and into the choke manifold until well dies or stabilizes.
16. Rig up air package/unit, pressure test all lines (Testing procedure to be supplied from air company), TIH with tubing and bit. Cleanout fill and pull bridge plug set at 2,700'.
17. TIH w/ bit and scraper for 4-1/2" casing. Cleanout fill to PBTD at 5,020'. Blow well dry at PBTD. Reference Under Balanced Well Control Tripping Procedure.
18. Rabbit tubing and RIH with 2-3/8" production tubing (with muleshoe, F-nipple with plug, 4 ft pup, X-nipple with plug).
19. Land 2-3/8" production tubing with hanger, lock down hanger at +/-4,875'.
20. Pressure test tubing to 500 psi with air unit, make sure tubing spool valves are open. Check all casing string for pressure.
21. ND BOP's. NU WH. Test well for air. Return well to production and downhole co-mingle Chacra, and Mesaverde.
22. RU WL unit. Run gauge ring for 2-3/8" tubing. Pull plugs and set tubing stop for plunger. RD slickline unit.

Pritchard 4 A

Sec 31, T29N, R8W

API # 30-045-22497

GL: 6011'

History:

Completed in MV in 7/77

Mesaverde Perforations

4119' - 4545' w/ 86,750 #'s sand

4665' - 4921' w/ 100,000 #'s sand

Formation tops: Pictured Cliffs 2450
 Lewis Shale 2580
 Cliff House 4116
 Menefee 4218
 Point Lookout 4662

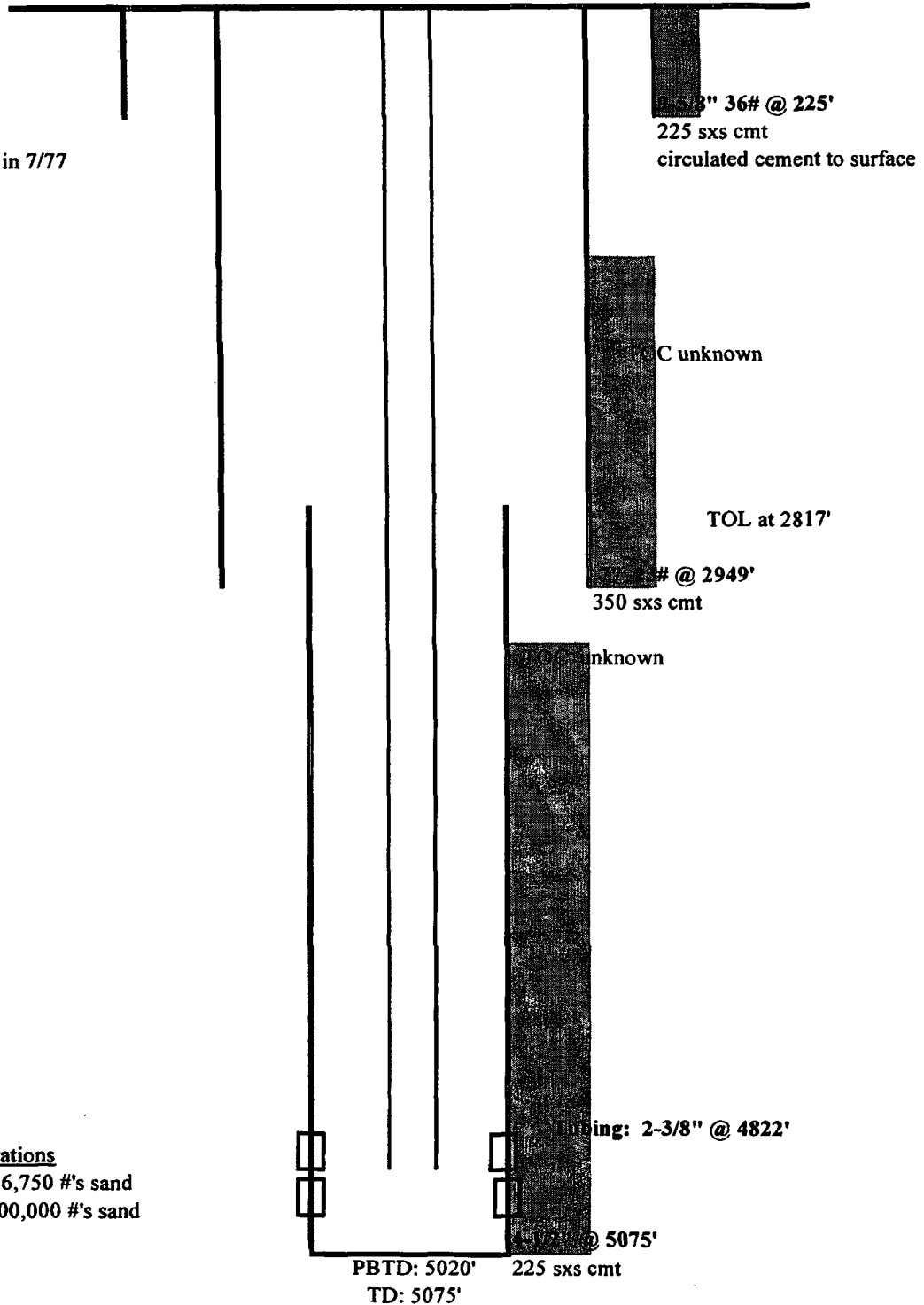

updated: 8/25/04 CFR

Submit 3 Copies To Appropriate District Office
District I
1625 N. French Dr., Hobbs, NM 88240
District II
1301 W. Grand Ave., Artesia, NM 88210
District III
1000 Rio Brazos Rd., Aztec, NM 87410
District IV
1220 S. St. Francis Dr., Santa Fe, NM 87505

State of New Mexico
Energy, Minerals and Natural Resources

Form C-103
March 4, 2004

OIL CONSERVATION DIVISION
1220 South St. Francis Dr.
Santa Fe, NM 87505

| |
|---|
| WELL API NO. 3004522497 |
| 5. Indicate Type of Lease STATE <input checked="" type="checkbox"/> FEE <input type="checkbox"/> |
| 6. State Oil & Gas Lease No. 078487-A |
| 7. Lease Name or Unit Agreement Name Pritchard |
| 8. Well Number 4A |
| 9. OGRID Number |
| 10. Pool name or Wildcat INV |

SUNDRY NOTICES AND REPORTS ON WELL (DO NOT USE THIS FORM FOR PROPOSALS TO DRILL OR TO DEEPEN OR PLUG BACK TO DIFFERENT RESERVOIR. USE "APPLICATION FOR PERMIT" (FORM 66-101) FOR SUCH PROPOSALS.)

1. Type of Well:
Oil Well ☐ Gas Well ☒ Other

2. Name of Operator
BP America

3. Address of Operator
200 Energy Court Farmington, NM 87401

4. Well Location

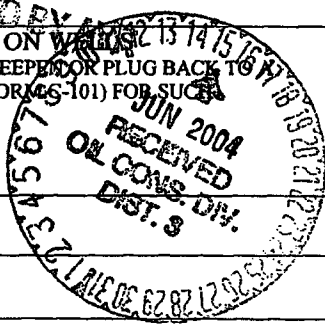

Unit Letter F : 1830 feet from the FNL line and 1705 feet from the FNL line
Section 31 Township 29 N Range 8 W NMPM County San Juan

11. Elevation (Show whether DR, RKB, RT, GR, etc.)

Pit or Below-grade Tank Application (For pit or below-grade tank closures, a form C-144 must be attached)

Pit Location: UL F Sect 31 Twp 29 N Rng 8 W Pit type STEEL Depth to Groundwater 2100' Distance from nearest fresh water well 21000'
Distance from nearest surface water 21000' Below-grade Tank Location UL F Sect 31 Twp 29 N Rng 8 W ;
1830 feet from the FNL line and 1705 feet from the FNL line

12. Check Appropriate Box to Indicate Nature of Notice, Report or Other Data
NOTICE OF INTENTION TO:

PERFORM REMEDIAL WORK ☒ PLUG AND ABANDON ☐
TEMPORARILY ABANDON ☐ CHANGE PLANS ☐
PULL OR ALTER CASING ☐ MULTIPLE COMPLETION ☐
OTHER: ☐

SUBSEQUENT REPORT OF:

REMEDIAL WORK ☐ ALTERING CASING ☐
COMMENCE DRILLING OPNS. ☐ PLUG AND ABANDONMENT ☐
CASING TEST AND CEMENT JOB ☐
OTHER: ☐

13. Describe proposed or completed operations. (Clearly state all pertinent details, and give pertinent dates, including estimated date of starting any proposed work). SEE RULE 1103. For Multiple Completions: Attach wellbore diagram of proposed completion or recompletion.

Construct a below grade tank installation per BP America - San Juan Basin Below Grade Tank Installation Plan issue date of 4/15/2004. At time of closure, pit(s) will be closed according to closure plan on file.

95 DBL/036

I hereby certify that the information above is true and complete to the best of my knowledge and belief. I further certify that any pit or below-grade tank has been/will be constructed or closed according to NMOCD guidelines ☐, a general permit ☐ or an (attached) alternative OCD-approved plan ☐.

SIGNATURE Allen W. Riser TITLE Scheduler DATE 6-15-04
Type or print name Allen W. Riser E-mail address: 1141RISER@bp.com Telephone No. 321-922

(This space for State use)

APPROVED BY Denny Fain
Conditions of approval, if any:

TITLE

DEPUTY OIL & GAS INSPECTOR, DIST. 30

DATE

JUN 15 2004

District I
1625 N. French Dr., Hobbs, NM 88240
District II
1301 W. Grand Avenue, Artesia, NM 88210
District III
1000 Rio Brazos Road, Aztec, NM 87410
District IV
1220 S. St. Francis Dr., Santa Fe, NM 87505

State of New Mexico
Energy Minerals and Natural Resources

Form C-104B
March 19, 2001

Oil Conservation Division
1220 South St. Francis Dr.
Santa Fe, NM 87505

Submit 1 copy of the final affected
wells list along with 1 copy of this form
per number of wells on that list to
appropriate District Office

Change of Operator Name

OGRID: 000778
Effective Date: 12/31/2001

Previous Operator Name and Information:

Name: Amoco Production Company
Address: P.O. Box 3092
Address: _____
City, State, Zip: Houston, Texas 77253

New Operator Name and Information:

New Name: BP America Production Company
Address: P.O. Box 3092
Address: _____
City, State, Zip: Houston, Texas 77253

I hereby certify that the rules of the Oil Conservation Division have been complied with and that the information given on this form and the attached list of wells is true and complete to the best of my knowledge and belief.

Signature: Mary Corley

Printed name: Mary Corley

Title: Senior Regulatory Specialist

Date: 12/10/2001 Phone: 281-366-4491

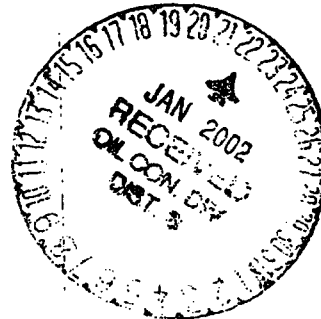

NMOCD Approval

Signature: [Signature]

Printed Name: SUPERVISOR DISTRICT #3

District: JAN 22 2002

Date: _____

Submit 3 Copies
Appropriate District Office
DISTRICT I
P.O. Box 1980, Hobbs, NM 88240

DISTRICT II
P.O. Drawer DD, Artesia, NM 88210

DISTRICT III
1000 Rio Brazos Rd., Aztec, NM 87410

State of New Mexico
Energy, Minerals and Natural Resources Department

OIL CONSERVATION DIVISION

P.O. Box 2088

Santa Fe, New Mexico 87504-2088

Form C-104
Revised 1-1-89
See Instructions
at Bottom of Page

REQUEST FOR ALLOWABLE AND AUTHORIZATION
TO TRANSPORT OIL AND NATURAL GAS

| | | |
|--|--|--|
| Operator AMOCO PRODUCTION COMPANY | | Well APN No. 3004522497 |
| Address P.O. BOX 800, DENVER, COLORADO 80201 | | |
| Reason(s) for Filing (Check proper box) | | |
| New Well <input type="checkbox"/> | Change in Transporter of: Oil <input type="checkbox"/> Dry Gas <input type="checkbox"/> | Other (Please explain)  |
| Recompletion <input type="checkbox"/> | Casinghead Gas <input type="checkbox"/> Condensate <input checked="" type="checkbox"/> | |
| Change in Operator <input type="checkbox"/> | | |
| If change of operator give name and address of previous operator | | |

II. DESCRIPTION OF WELL AND LEASE

| | | | | |
|--------------------------------|-----------------------|---|---------------------------------|-------------------------------|
| Lease Name PRITCHARD | Well No. 4A | Pool Name, Including Formation BLANCO (MESAVERDE) | Kind of Lease FEDERAL | Lease No. 820780390 |
| Location | | | | |
| Unit Letter F | 1830 | Feet From The ENL Line and 1705 | Feet From The FWL Line | |
| Section 31 | Township 29N | Range 8W | NMPM, SAN JUAN | County |

III. DESIGNATION OF TRANSPORTER OF OIL AND NATURAL GAS

| | | |
|--|--|----------------------------------|
| Name of Authorized Transporter of Oil <input type="checkbox"/> or Condensate <input type="checkbox"/> MERIDIAN OIL INC. | Address (Give address to which approved copy of this form is to be sent) 3535 EAST 30TH STREET, FARMINGTON, NM 87401 | |
| Name of Authorized Transporter of Casinghead Gas <input type="checkbox"/> or Dry Gas <input type="checkbox"/> SUNTERRA GAS GATHERING CO. | Address (Give address to which approved copy of this form is to be sent) P.O. BOX 1899, BLOOMFIELD, NM 87413 | |
| If well produces oil or liquids, give location of tanks. | Unit | Soc. |
| | Twsp. | Rge. |
| | | Is gas actually connected? When? |

If this production is commingled with that from any other lease or pool, give commingling order number.

IV. COMPLETION DATA

| | | | | | | | | |
|-------------------------------------|-----------------------------|----------|-----------------|----------|-------------------|-----------|------------|------------|
| Designate Type of Completion - (X) | Oil Well | Gas Well | New Well | Workover | Deepen | Plug Back | Same Res'v | Diff Res'v |
| Date Spudded | Date Compl. Ready to Prod. | | Total Depth | | P.B.T.D. | | | |
| Elevations (DF, RAB, RT, GR, etc.) | Name of Producing Formation | | Top Oil/Gas Pay | | Tubing Depth | | | |
| Perforations | | | | | Depth Casing Shoe | | | |
| TUBING, CASING AND CEMENTING RECORD | | | | | | | | |
| HOLE SIZE | CASING & TUBING SIZE | | DEPTH SET | | SACKS CEMENT | | | |
| | | | | | | | | |
| | | | | | | | | |
| | | | | | | | | |

V. TEST DATA AND REQUEST FOR ALLOWABLE

OIL WELL (Test must be after recovery of total volume of load oil and must be equal to or exceed top allowable for this depth or be for full 24 hours.)

| | | | |
|--------------------------------|-----------------|---|-----------|
| Date First New Oil Run To Tank | Date of Test | Producing Method (Flow, pump, gas lift, etc.) | |
| Length of Test | Tubing Pressure | Casing Pressure | Flow Rate |
| Actual Prod. During Test | Oil - bbls. | Water - bbls. | MCF |

GAS WELL

| | | | |
|----------------------------------|---------------------------|---------------------------|-----------------------|
| Actual Prod. Test - MCF/D | Length of Test | Bbls. Condensate/MCF | Gravity of Condensate |
| Testing Method (pilot, back pr.) | Tubing Pressure (Shut-in) | Casing Pressure (Shut-in) | Choke Size |

VI. OPERATOR CERTIFICATE OF COMPLIANCE

I hereby certify that the rules and regulations of the Oil Conservation Division have been complied with and that the information given above is true and complete to the best of my knowledge and belief.

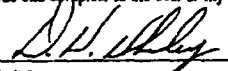
Signature
Doug W. Whaley, Staff Admin. Supervisor
Printed Name
February 8, 1991
Date
303-830-4280
Telephone No.

OIL CONSERVATION DIVISION

FEB 25 1991

Date Approved

By 

SUPERVISOR DISTRICT #3

Title

INSTRUCTIONS: This form is to be filed in compliance with Rule 1104

- 1) Request for allowable for newly drilled or deepened well must be accompanied by tabulation of deviation tests taken in accordance with Rule 111.
- 2) All sections of this form must be filled out for allowable on new and recompleted wells.
- 3) Fill out only Sections I, II, III, and VI for changes of operator, well name or number, transporter, or other such changes.
- 4) Separate Form C-104 must be filed for each pool in multiply completed wells.

Submit 5 Copies
Appropriate District Office
DISTRICT I
P.O. Box 1980, Hobbs, NM 88240

DISTRICT II
P.O. Drawer DD, Artesia, NM 88210

DISTRICT III
1000 Rio Brazos Rd., Aztec, NM 87410

State of New Mexico
Energy, Minerals and Natural Resources Department

OIL CONSERVATION DIVISION

P.O. Box 2088
Santa Fe, New Mexico 87504-2088

Form C-104
Revised 1-1-89
See Instructions
at Bottom of Page

REQUEST FOR ALLOWABLE AND AUTHORIZATION
TO TRANSPORT OIL AND NATURAL GAS

| | | |
|--|---|-------------------------------------|
| Operator Amoco Production Company | | Well API No. 3004522497 |
| Address 1670 Broadway, P. O. Box 800, Denver, Colorado 80201 | | |
| Reason(s) for Filing (Check proper box) <input type="checkbox"/> Other (Please explain) | | |
| New Well <input type="checkbox"/> | Change in Transporter of: | |
| Recompletion <input type="checkbox"/> | Oil <input type="checkbox"/> | Dry Gas <input type="checkbox"/> |
| Change in Operator <input checked="" type="checkbox"/> | Casinghead Gas <input type="checkbox"/> | Condensate <input type="checkbox"/> |
| If change of operator give name and address of previous operator Tenneco Oil E & P, 6162 S. Willow, Englewood, Colorado 80155 | | |

II. DESCRIPTION OF WELL AND LEASE

| | | | | |
|--------------------------------|-----------------------|---|----------------------|-------------------------------|
| Lease Name PRITCHARD | Well No. 4A | Pool Name, Including Formation BLANCO (MESAVERDE) | FEDERAL | Lease No. 820780390 |
| Location | | | | |
| Unit Letter F | 1830 | Feet From The FNL | Line and 1705 | Feet From The FWL |
| Section 31 | Township 29N | Range 8W | NMPM | SAN JUAN County |

III. DESIGNATION OF TRANSPORTER OF OIL AND NATURAL GAS

| | |
|--|---|
| Name of Authorized Transporter of Oil <input type="checkbox"/> or Condensate <input checked="" type="checkbox"/> | Address (Give address to which approved copy of this form is to be sent) P. O. BOX 256, FARMINGTON, NM 87499 |
| GIANT REFINING | |
| Name of Authorized Transporter of Casinghead Gas <input type="checkbox"/> or Dry Gas <input checked="" type="checkbox"/> | Address (Give address to which approved copy of this form is to be sent) P. O. BOX 1899, BLOOMFIELD, NM 87413 |
| SUNTERRA GAS GATHERING CO. | |
| If well produces oil or liquids, give location of tanks. | Unit Sec. Twp. Rge. Is gas actually connected? When? |

If this production is commingled with that from any other lease or pool, give commingling order number:

IV. COMPLETION DATA

| | | | | | | | | |
|-------------------------------------|-----------------------------|----------|-----------------|-------------------|--------------|-----------|------------|------------|
| Designate Type of Completion - (X) | Oil Well | Gas Well | New Well | Workover | Deepen | Plug Back | Same Res'v | Diff Res'v |
| Date Spudded | Date Compl. Ready to Prod. | | Total Depth | P.B.T.D. | | | | |
| Elevations (DF, RKB, RT, GR, etc.) | Name of Producing Formation | | Top Oil/Gas Pay | Tubing Depth | | | | |
| Perforations | | | | Depth Casing Shoe | | | | |
| TUBING, CASING AND CEMENTING RECORD | | | | | | | | |
| HOLE SIZE | CASING & TUBING SIZE | | DEPTH SET | | SACKS CEMENT | | | |
| | | | | | | | | |
| | | | | | | | | |
| | | | | | | | | |

V. TEST DATA AND REQUEST FOR ALLOWABLE

OIL WELL (Test must be after recovery of total volume of load oil and must be equal to or exceed top allowable for this depth or be for full 24 hours.)

| | | | |
|--------------------------------|-----------------|---|------------|
| Date First New Oil Run To Tank | Date of Test | Producing Method (Flow, pump, gas lift, etc.) | |
| Length of Test | Tubing Pressure | Casing Pressure | Choke Size |
| Actual Prod. During Test | Oil - Bbls. | Water - Bbls. | Gas - MCF |

GAS WELL

| | | | |
|----------------------------------|---------------------------|---------------------------|-----------------------|
| Actual Prod. Test - MCF/D | Length of Test | Bbls. Condensate/MCF | Gravity of Condensate |
| Testing Method (pilot, back pr.) | Tubing Pressure (Shut-in) | Casing Pressure (Shut-in) | Choke Size |

VI. OPERATOR CERTIFICATE OF COMPLIANCE

I hereby certify that the rules and regulations of the Oil Conservation Division have been complied with and that the information given above is true and complete to the best of my knowledge and belief.

J. L. Hampton
Signature
J. L. Hampton Sr. Staff Admin. Suprv.
Printed Name Title
January 16, 1989 303-830-5025
Date Telephone No.

OIL CONSERVATION DIVISION

Date Approved **MAY 08 1989**

By *[Signature]*
Title **SUPERVISION DISTRICT # 8**

INSTRUCTIONS: This form is to be filed in compliance with Rule 1104

- 1) Request for allowable for newly drilled or deepened well must be accompanied by tabulation of deviation tests taken in accordance with Rule 111.
- 2) All sections of this form must be filled out for allowable on new and recompleted wells.
- 3) Fill out only Sections I, II, III, and VI for changes of operator, well name or number, transporter, or other such changes.
- 4) Separate Form C-104 must be filed for each pool in multiply completed wells.

STATE OF NEW MEXICO
ENERGY AND MINERALS DEPARTMENT

OIL CONSERVATION DIVISION
P.O. BOX 2088
SANTA FE, NEW MEXICO 87501

Form C-104
Revised 10-01-78
Format 06-01-83
Page 1

| | |
|------------------------|-----|
| NO. OF COPIES RECEIVED | |
| DISTRIBUTION | |
| SANTA FE | |
| FILE | |
| U.S.O.S. | |
| LAND OFFICE | |
| TRANSPORTER | OIL |
| OPERATOR | GAS |
| PRORATION OFFICE | |

REQUEST FOR ALLOWABLE
AND
AUTHORIZATION TO TRANSPORT OIL AND NATURAL GAS

RECEIVED
JUL 20 1987
OIL CON. DIV.
LIST. 3

| | |
|--|--|
| Operator TENNECO OIL COMPANY | |
| Address P.O. BOX 3249, ENGLEWOOD, COLORADO 80155 | |
| Reasons for filing (Check proper box) | Other (Please explain) |
| <input type="checkbox"/> New Well <input type="checkbox"/> Recompletion <input type="checkbox"/> Change in Ownership | Change in Transporter of: <input type="checkbox"/> Oil <input type="checkbox"/> Casinghead Gas <input checked="" type="checkbox"/> Dry Gas <input type="checkbox"/> Condensate |
| THE TRANSPORTER'S NAME CHANGED FROM SOUTHERN UNION TO SUNTERRA | |

If change of ownership give name
and address of previous owner:

II. DESCRIPTION OF WELL AND LEASE

| | | | | |
|--------------------------------|------------------------|---|--|--------------------------------|
| Lease Name Pritchard | Well No. 4A | Pool Name, including Formation Blanco Mesaverde | Kind of Lease State, Federal or Fee Federal | SF Lease No. 078487A |
| Location | | | | |
| Unit Letter F | : 1830 | Feet From The North | Line and 1705 | Feet From The West |
| Line of Section 31 | Township 29N | Range 8W | NMPM San Juan | County |

III. DESIGNATION OF TRANSPORTER OF OIL AND NATURAL GAS

| | |
|---|---|
| Name of Authorized Transporter of Oil or Condensate = <input checked="" type="checkbox"/> | Address (Give address to which approved copy of this form is to be sent.) |
| GIANT REFINING | P.O.B. 256, Farmington, NM 87499 |
| Name of Authorized Transporter of Casinghead Gas or Dry Gas = <input checked="" type="checkbox"/> | Address (Give address to which approved copy of this form is to be sent.) |
| SUNTERRA GAS GATHERING COMPANY | P.O. BOX 1899, BLOOMFIELD, NM 87413 |
| If well produces oil or liquids, give location of tanks | Unit Sec. Twp. Rge |
| | Is gas actually connected? When |

If this production is commingled with that from any other lease or pool, give commingling order number

NOTE: Complete Parts IV and V on reverse side if necessary.

VI. CERTIFICATE OF COMPLIANCE

I hereby certify that the rules and regulations of the Oil Conservation Division have been complied with and that the information given is true and complete to the best of my knowledge and belief.

[Signature]
(Signature)
ADMINISTRATIVE SUPERVISOR
(Title)
6/29/87
(Date)

OIL CONSERVATION DIVISION
APPROVED **JUL 20 1987**, 19
BY *[Signature]*
TITLE **SUPERVISION DISTRICT #3**
This form is to be filed in compliance with RULE 1104.
If this is a request for allowable for a newly drilled or deepened well, this form must be accompanied by a tabulation of the deviation tests taken on the well in accordance with RULE 111.
All sections of this form must be filled out completely for allowable on new and recompleted wells.
Fill out only Section I, II, III, and VI for changes of owner, well name and or number, or transporter or other such change of condition.
Separate Forms C-104 must be filed for each pool in multiply completed wells.

| | |
|-----------------|-----|
| DISTRICT | |
| COUNTY | |
| TAX MAP | |
| U.S.G.S. | |
| LAND OFFICE | |
| TRANSPORTER | OIL |
| | GAS |
| OPERATOR | |
| PADRATON OFFICE | |

NEW MEXICO OIL CONSERVATION COMMISSION
REQUEST FOR ALLOWABLE
AND
AUTHORIZATION TO TRANSPORT OIL AND NATURAL GAS

Form C-104
 Supersedes Old C-104 and C-
 Effective 1-1-83

I. OPERATOR

TENNECO OIL COMPANY

Address
BOX 3249, ENGLEWOOD, CO 80155

Reason(s) for filing (check proper box)

New Well ☐ Change in Transporter of: Oil ☐ Dry Gas ☐

Recompletion ☐ Gas ☐ Condensate ☒

Change in Ownership ☐

Other (Please explain)

If change of ownership give name and address of previous owner

II. DESCRIPTION OF WELL AND LEASE

| | | | | |
|--------------------------------|------------------------------|---|---|-----------|
| Lease Name Pritchard | Well No. 4A | Prop. Name, including Formation Blanco MV | Kind of Lease State (Federal) or Fee SF-078487A | Lease No. |
| Location | | | | |
| Unit Letter F | Foot From The 1830 | North 1705 | Foot From The west | |
| Line of Section 31 | Township 29N | Range 8W | N.M.P.M. San Juan | County |

III. DESIGNATION OF TRANSPORTER OF OIL AND NATURAL GAS

| | |
|--|--|
| Name of Authorized Transporter of Oil <input type="checkbox"/> or Condensate <input checked="" type="checkbox"/> | Address (Give address to which approved copy of this form is to be sent) |
| GIANT REFINING CO. | BOX 256, FARMINGTON, NM 87401 |
| Name of Authorized Transporter of Gas <input type="checkbox"/> or Dry Gas <input checked="" type="checkbox"/> | Address (Give address to which approved copy of this form is to be sent) |
| Southern Union Gathering | Box 1899 Bloomfield, NM 87413 |
| If well produces oil or liquids, give location of tanks. | Is gas actually connected? When |
| Unit F Sec. 31 Twp. 29 Rng. 8 | YES |

If this production is commingled with that from any other lease or pool, give commingling order number:

IV. COMPLETION DATA

| | | | | | | | | |
|---|-----------------------------|-------------------|----------|--------------|--------------|--------|-----------|------------------------|
| Designate Type of Completion - (X) | | Oil well | Gas well | New well | Recompletion | Deepen | Plug Back | Same Well, Diff. Prod. |
| Date Spudded | Date Compl. Ready to Prod. | Total Depth | | P.B.T.D. | | | | |
| Elevations (DF, RAB, RT, CR, etc.) | Name of Producing Formation | Top Oil/Gas Pay | | Tubing Depth | | | | |
| Perforations | | Depth Casing Shoe | | | | | | |
| TUBING, CASING, AND CEMENTING RECORD | | | | | | | | |
| HOLE SIZE | CASING & TUBING SIZE | DEPTH SET | | SACKS CEMENT | | | | |
| | | | | | | | | |
| | | | | | | | | |
| | | | | | | | | |
| | | | | | | | | |

V. TEST DATA AND REQUEST FOR ALLOWABLE OIL WELL

(Test must be after recovery of total volume of load oil and must be equal to or exceed top oil able for this depth or be for full 24 hours)

| | | | |
|---------------------------------|-----------------|---|-------------|
| Date Test: New Oil Run To Tanks | Date of Test | Producing Method (Flow, pump, gas lift, etc.) | |
| Length of Test | Tubing Pressure | Casing Pressure | Casing Size |
| Actual Prod. During Test | Oil-Basis | Water-Basis | Gas-MCF |

GAS WELL

| | | | |
|---------------------------------|---------------------------|---------------------------|-----------------------|
| Actual Prod. Test-MCF/D | Length of Test | Basis: Condensate/MCF | Gravity of Condensate |
| Testing Method (pump, back pr.) | Tubing Pressure (Shot-In) | Casing Pressure (Shot-In) | Casing Size |

VI. CERTIFICATE OF COMPLIANCE

I hereby certify that the rules and regulations of the Oil Conservation Commission have been complied with and that the information given above is true and complete to the best of my knowledge and belief.

Renee Wilson
 PRODUCTION ANALYST
 AUGUST 1, 1982

OIL CONSERVATION COMMISSION

APPROVED _____
 BY Original Signed by **FRANK T. CHAVEZ**
 TITLE **SUPERVISOR DISTRICT #3**

This form is to be filed in compliance with RULE 1904.
 If this is a request for allowable for a newly drilled or deepened well, this form must be accompanied by a tabulation of the deviate tests taken on the well in accordance with RULE 1911.
 All sections of this form must be filled out completely for all wells on new and recompleted wells.
 Fill out only Sections I, II, III, and VI for changes of owner, well name or number, or transporter, or other such change of condition.
 Separate Forms C-104 must be filed for each pool in existing completed wells.

| | |
|------------------------|-----|
| NO. OF COPIES RECEIVED | 5 |
| DISTRIBUTION | |
| SANTA FE | 1 |
| FILE | 1 |
| U.S.G.S. | |
| LAND OFFICE | |
| TRANSPORTER | OIL |
| | GAS |
| OPERATOR | 2 |
| PRODUCTION OFFICE | |

**NEW MEXICO OIL CONSERVATION COMMISSION
REQUEST FOR ALLOWABLE
AND
AUTHORIZATION TO TRANSPORT OIL AND NATURAL GAS**

Form C-104
Supersedes Old C-104 and C-110
Effective 1-1-55

| | |
|---|---|
| Operator Tenneco Oil Company | |
| Address 1860 Lincoln St. Suite 1200, Denver, Colorado 80295 | |
| Reason(s) for filing (Check proper box) | |
| New Well <input checked="" type="checkbox"/> | Change in Transporter of: |
| Recompletion <input type="checkbox"/> | Oil <input type="checkbox"/> Dry Gas <input type="checkbox"/> |
| Change in Ownership <input type="checkbox"/> | Casinghead Gas <input type="checkbox"/> Condensate <input type="checkbox"/> |
| Other (Please explain) | |

If change of ownership give name and address of previous owner _____

I. DESCRIPTION OF WELL AND LEASE

SF-078487-A

| | | | | |
|--------------------------------|-----------------------|--|---|---------------------------|
| Lease Name Pritchard | Well No. 4A | Pool Name, including Formation Blanco Mesa Verde | Kind of Lease State, Federal or Fee Federal | Lease No. * |
| Location | | | | |
| Unit Letter F | 1830 | Feet From The North | Line and 1705 | Feet From The West |
| Line of Section 31 | Township 29N | Range 8W | NMPM, | San Juan County |

II. DESIGNATION OF TRANSPORTER OF OIL AND NATURAL GAS

| | |
|--|--|
| Name of Authorized Transporter of Oil <input type="checkbox"/> or Condensate <input type="checkbox"/> | Address (Give address to which approved copy of this form is to be sent) |
| Name of Authorized Transporter of Casinghead Gas <input type="checkbox"/> or Dry Gas <input checked="" type="checkbox"/> | Address (Give address to which approved copy of this form is to be sent) |
| Southern Union Gathering Company | P.O. Box 398, Bloomfield, New Mexico 87413 |
| If well produces oil or liquids, give location of tanks. | When |
| Unit F Sec. 31 Twp. 29N Rge. 8W | Is gas actually connected? No Near future |

If this production is commingled with that from any other lease or pool, give commingling order number: _____

III. COMPLETION DATA

| | | | | | | | | |
|---|---|--|--|-----------------------------------|---------------------------------|------------------------------------|--------------------------------------|---------------------------------------|
| Designate Type of Completion - (X) | Oil Well <input type="checkbox"/> | Gas Well <input checked="" type="checkbox"/> | New Well <input checked="" type="checkbox"/> | Workover <input type="checkbox"/> | Deepen <input type="checkbox"/> | Plug Back <input type="checkbox"/> | Same Res'v. <input type="checkbox"/> | Diff. Res'v. <input type="checkbox"/> |
| Date Spudded 5-25-77 | Date Compl. Ready to Prod. 6-19-77 | | Total Depth 5075' | | P.B.T.D. 5020' | | | |
| Elevations (DF, RKB, RT, GR, etc.) 6011' GL | Name of Producing Formation Blanco Mesa Verde | | Top Oil/Gas Pay 4116' | | Tubing Depth 4822 | | | |
| Perforations 15 holes from 4921' - 4665'; 20 holes from 4545' - 4119' | | | | Depth Casing Shoe | | | | |
| TUBING, CASING, AND CEMENTING RECORD | | | | | | | | |
| HOLE SIZE | CASING & TUBING SIZE | | DEPTH SET | | SACKS CEMENT | | | |
| 12-1/4" | 9-5/8" Casing | | 225' | | 225 Sacks | | | |
| 8-3/4" | 7" Casing | | 2949' | | 350 Sacks | | | |
| 6-1/8" | 4-1/2" Casing Lnr. | | 2817' - 5075' | | 225 Sacks | | | |
| | 2-3/8" Tubing | | 4832' | | | | | |

IV. TEST DATA AND REQUEST FOR ALLOWABLE OIL WELL

(Test must be after recovery of total volume of load oil and must be equal to or exceed top allowable for this depth or be for full 24 hours)

| | | | |
|---------------------------------|-----------------|---|------------|
| Date First New Oil Run To Tanks | Date of Test | Producing Method (Flow, pump, gas lift, etc.) | |
| | | | |
| Length of Test | Tubing Pressure | Casing Pressure | Choke Size |
| | | | |
| Actual Prod. During Test | Oil - Bbls. | Water - Bbls. | Gas - MCF |
| | | | |

GAS WELL

| | | | |
|--|---|---|-------------------------------------|
| Actual Prod. Test-MCF/D 8767 AOF | Length of Test 3 Hours | Bbls. Condensate/MMCF -0- | Gravity of Condensate -0- |
| Testing Method (pilot, back pr.) Back Pressure | Tubing Pressure (shut-in) 796 | Casing Pressure (shut-in) 796 | Choke Size 3/4" |

CERTIFICATE OF COMPLIANCE

I hereby certify that the rules and regulations of the Oil Conservation Commission have been complied with and that the information given above is true and complete to the best of my knowledge and belief.

A. B. Myers
(Signature)
Division Production Manager
(Title)
7-27-77
(Date)

OIL CONSERVATION COMMISSION

APPROVED _____, 19____
BY Original Signed by A. B. Vondrick
TITLE Production Manager

This form is to be filed in compliance with RULE 1101.
If this is a request for allowable for a newly drilled or deepened well, this form must be accompanied by a tabulation of the deviation tests taken on the well in accordance with RULE 111.
All sections of this form must be filled out completely for allowable on new and recompleted wells.
Fill out only Sections I, II, III, and VI for changes of owner, well name or number, or transporter, or other such change of condition.
Separate Forms C-104 must be filed for each pool in multiply completed wells.

UNITED STATES
DEPARTMENT OF THE INTERIOR
GEOLOGICAL SURVEY

SUBMIT IN DUPLICATE*

(See other In-
structions on
reverse side)Form approved
Budget Bureau No. 42-R350.5.

WELL COMPLETION OR RECOMPLETION REPORT AND LOG *

| | | | | | | | | | | | | | | | |
|---|--|--|--|--|--|---|--|--|--|--|--|--------------------------------|--|-----------------|--|
| 1. TYPE OF WELL OIL WELL <input type="checkbox"/> GAS WELL <input checked="" type="checkbox"/> DRY <input type="checkbox"/> Other _____ | | | | 5. LEASE DESIGNATION AND SERIAL NO. SF-078487-A | | | | | | | | | | | |
| 2. TYPE OF COMPLETION NEW <input checked="" type="checkbox"/> WORK OVER <input type="checkbox"/> DEEP-EN <input type="checkbox"/> PLUG BACK <input type="checkbox"/> DIFF. RESVR. <input type="checkbox"/> Other _____ | | | | 6. IN INDIAN, ALLOTTEE OR TRIBE NAME | | | | | | | | | | | |
| 2. NAME OF OPERATOR Tenneco Oil Company | | | | 7. UNIT AGREEMENT NAME | | | | | | | | | | | |
| 3. ADDRESS OF OPERATOR 1860 Lincoln St., Suite 1200, Denver, Colorado 80203 | | | | 8. FARM OR LEASE NAME Pritchard | | | | | | | | | | | |
| 4. LOCATION OF WELL (Report location clearly and in accordance with any State requirements)* At surface 1830' FNL and 1705' FWL At top prod. interval reported below At total depth | | | | 9. WELL NO. 4A | | | | | | | | | | | |
| 14. PERMIT NO. _____ DATE ISSUED _____ | | | | 10. FIELD AND POOL, OR WILDCAT Blanco Mesa Verde | | | | | | | | | | | |
| 15. DATE SPUDDED 5-25-77 | | | | 11. SEC., T., R., M., OR BLOCK AND SURVEY OR AREA Sec 31, T29N, R8W | | | | | | | | | | | |
| 16. DATE T.D. REACHED 5-31-77 | | | | 12. COUNTY OR PARISH San Juan | | | | | | | | | | | |
| 17. DATE COMPL. (Ready to prod.) 6-19-77 | | | | 13. STATE New Mexico | | | | | | | | | | | |
| 18. ELEVATIONS (DP, HKB, RT, CR, ETC.)* 6011' GL | | | | 19. ELEV. CASINGHEAD | | | | | | | | | | | |
| 20. TOTAL DEPTH, MD & TVD 5075' | | 21. PLUG BACK T.D., MD & TVD 5020' | | 22. IF MULTIPLE COMPL., HOW MANY* | | 23. INTERVALS DRILLED BY ROTARY TOOLS 0-TD CABLE TOOLS None | | | | | | | | | |
| 24. PRODUCING INTERVAL(S), OF THIS COMPLETION—TOP, BOTTOM, NAME (MD AND TVD)* Blanco Mesa Verde = 4116' - 4980' | | | | 25. WAS DIRECTIONAL SURVEY MADE Yes | | | | | | | | | | | |
| 26. TYPE ELECTRIC AND OTHER LOGS RUN Comp. Density & Gamma Ray | | | | 27. WAS WELL CORRO No | | | | | | | | | | | |
| 28. CASING RECORD (Report all strings set in well) | | | | | | | | | | | | | | | |
| CASING SIZE | | WEIGHT, LB./FT. | | DEPTH SET (MD) | | HOLE SIZE | | CEMENTING RECORD | | AMOUNT PULLED | | | | | |
| 9-5/8" | | 36# | | 225' | | 12-1/4" | | 225 sacks | | None | | | | | |
| 7" | | 23# | | 2949' | | 8-3/4" | | 350 sacks | | None | | | | | |
| 29. LINER RECORD | | | | | | | | 30. TUBING RECORD | | | | | | | |
| SIZE | | TOP (MD) | | BOTTOM (VD) | | SACKS CEMENT* | | SCREEN (MD) | | SIZE | | DEPTH SET (MD) | | PACKER SET (MD) | |
| 4-1/2" | | 2817' | | 5075' | | 225 | | | | 2-3/8" | | 4822' | | None Set | |
| 31. PERFORATION RECORD (Interval, size and number) Blanco Mesa Verde 15 holes from 4921' - 4665' 20 holes from 4545' - 4119' | | | | | | | | 32. ACID, SHOT, FRACTURE, CEMENT SQUEEZE, ETC. | | | | | | | |
| | | | | | | | | DEPTH INTERVAL (MD) | | AMOUNT AND KIND OF MATERIAL USED | | | | | |
| | | | | | | | | 4921' - 4665' | | Frac'd W/ 86,750 lbs. of 20/40 mesh sand | | | | | |
| | | | | | | | | 4545' - 4119' | | Frac'd W/ 100,000 lbs. of 20/40 mesh sand | | | | | |
| 33. PRODUCTION | | | | | | | | | | | | | | | |
| DATE FIRST PRODUCTION 6-19-77 | | PRODUCTION METHOD (Flowing, gas lift, pumping—size and type of pump) Flowing. | | | | WELL STATUS (Producing or shut-in) Shut-in pending hookup. | | | | | | | | | |
| DATE OF TEST 7-24-77 | | HOURS TESTED 3 Hours | | CHOKE SIZE 3/4" | | PRESS. FOR TEST PERIOD → | | BBL. GAS—MCF. -0- 414 | | WATER—BBL. -0- | | GAS—OIL RATIO -0- | | | |
| 227 | | 677 | | CALCULATED 24-HOUR RATE → | | OIL—BBL. -0- | | GAS—MCF. 8767 | | WATER—BBL. -0- | | OIL GRAVITY-API (CORR.) -0- | | | |
| 34. DISPOSITION OF GAS (If sold, used for fuel, vented, etc.) To be sold. | | | | | | | | 35. LIST OF ATTACHMENTS Logs have already been mailed to your office. | | | | | | | |
| 36. I hereby certify that the foregoing and attached information is complete and correct as determined from all available records | | | | | | | | AUG 1 1977 | | | | | | | |
| SIGNED <u>D. D. Myers</u> | | | | TITLE <u>Div. Production Manager</u> | | | | U. S. GEOLOGICAL SURVEY WASHINGTON, D. C. | | | | | | | |

(See Instructions and Spaces for Additional Data on Reverse Side)

INSTRUCTIONS

General: This form is designed for submitting a complete and correct well completion report and log on all types of lands and leases to either a Federal agency or a State agency, or both, pursuant to applicable Federal and/or State laws and regulations. Any necessary special instructions concerning the use of this form and the number of copies to be submitted, particularly with regard to local, area, or regional procedures and practices, either are shown below or will be issued by, or may be obtained from, the local Federal and/or State office. See instructions on items 22 and 24, and 33, below regarding separate reports for separate completions.

If not filed prior to the time this summary record is submitted, copies of all currently available logs (drillers', geologists', sample and core analysis, all types electric, etc.), formation and pressure tests, and directional surveys, should be attached hereto, to the extent required by applicable Federal and/or State laws and regulations. All attachments should be listed on this form, as in item 33.

Item 4: If there are any special requirements, locations on Federal or Indian land should be described in accordance with Federal requirements. Attach local State or Federal office for more information.

Item 18: Indicate which completion is used as reference (where not otherwise shown) for depth measurements given in other spaces on this form and in any attachments.

Items 22 and 24: If this well is completed for separate production from more than one interval zone (multiple completion), so state in item 22, and in item 24 show the producing interval, or intervals, top(s), bottom(s) and name(s) (if any) for only the interval reported in item 33. Submit a separate report (page) on this form, adequately identified, for each additional interval to be separately produced, showing the additional data pertinent to such interval.

Item 29: "Sacks Cement." Attached supplemental records for this well should show the details of any multiple stage cementing and the location of the cementing tool.

Item 33: Submit a separate completion report on this form for each interval to be separately produced. (See instruction for items 22 and 24 above.)

| 37. SUMMARY OF FORMER ZONES. | | | 38. GEOLOGIC MARKERS | | | |
|--|------|--------|-----------------------------|------|-------------|------------------|
| SHOW ALL IMPORTANT ZONES OF POROSITY AND CONTENTS THEREOF; CORDED INTERVALS; AND ALL DRILL-STEM TESTS, INCLUDING DEPTH INTERVAL TESTED, CRITICAL USED, TIME TOOL OPEN, FLOWING AND SHUT-IN PRESSURES, AND RECOVERIES | | | | | | |
| FORMATION | TOP | BOTTOM | DESCRIPTION, CONTENTS, ETC. | NAME | MEAS. DEPTH | TRUE VERT. DEPTH |
| Pictured Cliffs | 2450 | 2580 | Sandstone & shale | | | |
| Lewis Shale | 2580 | 4116 | Shale | | | |
| Cliff House | 4116 | 4218 | Sandstone & shale | | | |
| Menefee | 4218 | 4662 | Sandstone, shale, coal | | | |
| Point Lookout | 4662 | 4980 | Sandstone, shale | | | |
| Mancos Shale | 4980 | TD | Shale | | | |



TABULATION OF DEVIATION TESTS

TENNECO OIL COMPANY

| <u>DEPTH</u> | <u>INCLINATION</u> |
|--------------|--------------------|
| 720' | 1/20 |
| 1250' | 1/20 |
| 1725' | 3/40 |
| 2214' | 3/40 |
| 2604' | 10 |
| 2954' | 10 |
| 3425' | 1/20 |
| 3537' | 3/40 |
| 4990' | 1/20 |

AFFIDAVIT

This is to certify that to the best of my knowledge, the above tabulation details the deviation test taken on Tenneco Oil Company's well: Pritchard No. 4A, Unit F, Sec. 31, T29N, R8W, San Juan County, New Mexico.

Signed *D. D. Myers*
Agent for Tenneco Oil Company

THE STATE OF COLORADO)
CITY AND COUNTY OF DENVER)

Before me, the undersigned authority, on this day, personally appeared,

D. D. Myers, known to me to be an Agent for Tenneco Oil Company, and to be the person whose name is subscribed to the above statement, who, being by me duly sworn on oath, states that he has knowledge of the facts stated herein, and that said statement is true and correct. Subscribed and sworn to before me, a Notary Public in and for said County and State, this

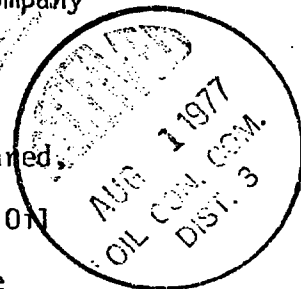

[Signature]
Notary Public

My Commission Expires:

July 1, 1980

UNITED STATES
DEPARTMENT OF THE INTERIOR
GEOLOGICAL SURVEY

SUBMIT IN TRIPLICATE*
(Other instructions on re-
verse side)

Form approved.
Budget Bureau No. 42-P1424.

SUNDRY NOTICES AND REPORTS ON WELLS

(Do not use this form for proposals to drill or to deepen or plug back to a different reservoir.
Use "APPLICATION FOR PERMIT—" for such proposals.)

| | | |
|--|--|--|
| 1. <input type="checkbox"/> OIL WELL <input type="checkbox"/> GAS WELL <input checked="" type="checkbox"/> OTHER | | 5. LEASE DESIGNATION AND SERIAL NO. SF-078487-A |
| 2. NAME OF OPERATOR Tenneco Oil Company | | 6. IF INDIAN, ALLOTTEE OR TRIBE NAME |
| 3. ADDRESS OF OPERATOR 1860 Lincoln, Suite 1200, Denver, Colorado 80295 | | 7. UNIT AGREEMENT NAME |
| 4. LOCATION OF WELL (Report location clearly and in accordance with any State requirements.* See also space 17 below.) At surface 1830' FNL and 1705' FWL | | 8. FARM OR LEASE NAME Pritchard |
| 14. PERMIT NO. | | 9. WELL NO. #4A |
| 15. ELEVATIONS (Show whether DF, RT, CR, etc.) Unit F 6011' GL | | 10. FIELD AND POOL, OR WILDCAT Blanco Mesa Verde |
| | | 11. SEC., T., R., M., OR BLK. AND SURVEY OR AREA Sec. 31, T29N, R8W |
| | | 12. COUNTY OR PARISH San Juan |
| | | 13. STATE New Mexico |

16. Check Appropriate Box To Indicate Nature of Notice, Report, or Other Data

| NOTICE OF INTENTION TO: | | SUBSEQUENT REPORT OF | |
|-------------------------|--------------------------|---|-------------------------------------|
| TEST WATER SHUT-OFF | <input type="checkbox"/> | WATER SHUT-OFF | <input type="checkbox"/> |
| FRACTURE TREAT | <input type="checkbox"/> | FRACTURE TREATMENT | <input checked="" type="checkbox"/> |
| SHOOT OR ACIDIZE | <input type="checkbox"/> | SHOOTING OR ACIDIZING | <input checked="" type="checkbox"/> |
| REPAIR WELL | <input type="checkbox"/> | (Other) | <input type="checkbox"/> |
| (Other) | <input type="checkbox"/> | (NOTE: Report results of multiple completion on Well Completion or Recompletion Report and Log form.) | <input type="checkbox"/> |
| PULL OR ALTER CASING | <input type="checkbox"/> | REPAIRING WELL | <input type="checkbox"/> |
| MULTIPLE COMPLETION | <input type="checkbox"/> | ALTERING CASING | <input type="checkbox"/> |
| ABANDON* | <input type="checkbox"/> | ABANDONMENT* | <input type="checkbox"/> |
| CHANGE PLANS | <input type="checkbox"/> | | |

17. DESCRIBE PROPOSED OR COMPLETED OPERATIONS (Clearly state all pertinent details, and give pertinent dates, including estimated date of starting any proposed work. If well is directionally drilled, give subsurface locations and measured and true vertical depths for all markers and zones pertinent to this work.) *

6/14 - 6/22/77 Perf'd 15 holes from 4921' - 4665'. Broke down and sand/water frac'd formation with 86,750 lbs of 20/40 mesh sand. Perf'd 20 holes from 4545' - 4119'. Broke down and sand/water frac'd formation with 100,000 lbs of 20/40 mesh sand. Flowed well to clean up. Present status = SI for AOF test.

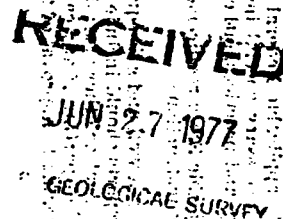

18. I hereby certify that the foregoing is true and correct

SIGNED [Signature] TITLE Div. General Manager DATE 6-24-77

(This space for Federal or State office use)

APPROVED BY _____ TITLE _____ DATE _____

CONDITIONS OF APPROVAL, IF ANY:

UNITED STATES
DEPARTMENT OF THE INTERIOR
GEOLOGICAL SURVEY

SUBMIT IN TRIPLICATE*
(Other instructions on re-verse side)

Form approved
Budget Bureau No. 42-R1424

5. LEASE DESIGNATION AND SERIAL NO.

SF-078487-A

6. IF INDIAN, ALLOTTEE OR TRIBE NAME

7. UNIT AGREEMENT NAME

8. FARM OR LEASE NAME

Pritchard

9. WELL NO.

#4A

10. FIELD AND POOL, OR WILDCAT

Blanco Mesa Verde

11. SEC., T., R., M., OR BLK. AND SURVEY OR AREA

Sec. 31, 29N, R8W

12. COUNTY OR PARISH

San Juan

13. STATE

New Mexico

SUNDRY NOTICES AND REPORTS ON WELLS
(Do not use this form for proposals to drill or to deepen or plug back to a different reservoir. Use "APPLICATION FOR PERMIT" for such proposals.)

1. OIL WELL ☐ GAS WELL ☒ OTHER

2. NAME OF OPERATOR
Tenneco Oil Company

3. ADDRESS OF OPERATOR
1860 Lincoln Street, Suite 1200, Denver, Colorado 80295

4. LOCATION OF WELL (Report location clearly and in accordance with any State requirements.* See also space 17 below.)
At surface

1830' FNL and 1705' FWL, Unit F

14. PERMIT NO.

15. ELEVATIONS (Show whether DF, RT, GR, etc.)

6011' GL

16. Check Appropriate Box To Indicate Nature of Notice, Report, or Other Data

NOTICE OF INTENTION TO:

TEST WATER SHUT-OFF

FRACTURE TREAT

SHOOT OR ACIDIZE

REPAIR WELL

(Other)

PCLL OR ALTER CASING

MULTIPLE COMPLETE

ABANDON*

CHANGE PLANS

SUBSEQUENT REPORT OF:

WATER SHUT-OFF

FRACTURE TREATMENT

SHOOTING OR ACIDIZING

(Other)

REPAIRING WELL

ALTERING CASING

ABANDONMENT*

(NOTE: Report results of multiple completion on Well Completion or Recombination Report and Log form.)

17. DESCRIBE PROPOSED OR COMPLETED OPERATIONS (Clearly state all pertinent details, and give pertinent dates, including estimated date of starting any proposed work. If well is directionally drilled, give subsurface locations and measured and true vertical depths for all markers and zones pertinent to this work.)*

5/26 - 6/6/77 Drilled 8 3/4" hole to 2949'. Set and cemented 77 jts. of 7" casing at 2949' with 350 sacks of cement. Drilled 6 1/8" hole to 5075'. Set and cemented 52 jts. of 4 1/2" casing liner from 2817' - 5075' with 225 sacks of cement. Present status = waiting on completion unit.

JUN 16 1977

18. I hereby certify that the foregoing is true and correct

SIGNED

R. H. Myers

TITLE

Div. Production Manager

DATE

(This space for Federal or State office use)

APPROVED BY

TITLE

DATE

CONDITIONS OF APPROVAL, IF ANY:

UNITED STATES
DEPARTMENT OF THE INTERIOR
GEOLOGICAL SURVEY

SUBMIT IN TRIPPLICATE*
(Other instructions on reverse side)

Form approved,
Budget Bureau No. 42-R1424.
5. LEASE DESIGNATION AND SERIAL NO.
SF-078487-A
6. IF INDIAN, ALLOTTEE OR TRIBE NAME

SUNDRY NOTICES AND REPORTS ON WELLS

(Do not use this form for proposals to drill or to deepen or plug back to a different reservoir.
Use "APPLICATION FOR PERMIT" for such proposals.)

| | | | |
|--|--|--|--|
| 1. <input type="checkbox"/> OIL WELL <input type="checkbox"/> GAS WELL <input checked="" type="checkbox"/> OTHER | | 7. UNIT AGREEMENT NAME | |
| 2. NAME OF OPERATOR Tenneco Oil Company | | 8. FARM OR LEASE NAME Pritchard | |
| 3. ADDRESS OF OPERATOR 1860 Lincoln St., Suite 1200, Denver, Colo. 80295 | | 9. WELL NO. #4A | |
| 4. LOCATION OF WELL (Report location clearly and in accordance with any State requirements.* See also space 17 below.) At surface 1830' FNL and 1705' FWL, Unit F | | 10. FIELD AND POOL, OR WILDCAT Blanco Mesa Verde | |
| 14. PERMIT NO. | | 11. SEC., T., R., M., OR BLK. AND SURVEY OR AREA Sec. 31. 29N, R8W | |
| 15. ELEVATIONS (Show whether DF, RT, GR, etc.) 6011' GL | | 12. COUNTY OR PARISH San Juan | |
| | | 13. STATE New Mexico | |

16. Check Appropriate Box To Indicate Nature of Notice, Report, or Other Data

NOTICE OF INTENTION TO:

| | |
|--|---|
| TEST WATER SHUT-OFF <input type="checkbox"/> | PULL OR ALTER CASING <input type="checkbox"/> |
| FRACTURE TREAT <input type="checkbox"/> | MULTIPLE COMPLETE <input type="checkbox"/> |
| SHOOT OR ACIDIZE <input type="checkbox"/> | ABANDON* <input type="checkbox"/> |
| REPAIR WELL <input type="checkbox"/> | CHANGE PLANS <input type="checkbox"/> |
| (Other) <input type="checkbox"/> | |

SUBSEQUENT REPORT OF:

| | |
|--|--|
| WATER SHUT-OFF <input checked="" type="checkbox"/> | REPAIRING WELL <input type="checkbox"/> |
| FRACTURE TREATMENT <input type="checkbox"/> | ALTERING CASING <input type="checkbox"/> |
| SHOOTING OR ACIDIZING <input type="checkbox"/> | ABANDONMENT* <input type="checkbox"/> |
| (Other) <input type="checkbox"/> | |

(NOTE: Report results of multiple completion on Well Completion or Recompletion Report and Log form.)

17. DESCRIBE PROPOSED OR COMPLETED OPERATIONS (Clearly state all pertinent details, and give pertinent dates, including estimated date of starting any proposed work. If well is directionally drilled, give subsurface locations and measured and true vertical depths for all markers and zones pertinent to this work.)*

5-25-77

Spudded 13 3/4" hole at 11:30 A.M. Drilled to 225'.
Set and cemented 5 jts of 9 5/8" casing at 225' with
225 sacks of cement. Circulated and waited on cement.

JUN 16 1977

18. I hereby certify that the foregoing is true and correct

SIGNED *D.H. Meyer*

TITLE Div. Production Manager

DATE 6-9-77

(This space for Federal or State office use)

APPROVED BY _____
CONDITIONS OF APPROVAL, IF ANY:

TITLE _____

DATE _____

*See Instructions on Reverse Side

| APPLICATION FOR PERMIT TO DRILL, DEEPEN, OR PLUG BACK | | | |
|---|----------------|---|---------------------------------|
| 1. TYPE OF WORK DRILL <input checked="" type="checkbox"/> DEEPEN <input type="checkbox"/> PLUG BACK <input type="checkbox"/> | | 6. IF INDIAN, ALLOTTEE OR TRUST NAME | |
| 2. TYPE OF WELL OIL <input type="checkbox"/> GAS <input checked="" type="checkbox"/> OTHER <input type="checkbox"/> MINOR <input type="checkbox"/> TITLE <input type="checkbox"/> | | 7. UNIT AGREEMENT NAME | |
| 3. NAME OF OPERATOR TENNECO OIL COMPANY | | 8. FARM OR LEASE NAME Pritchard | |
| 4. ADDRESS OF OPERATOR 1800 Lincoln St., Suite 1200, Denver, Colorado 80295 | | 9. WELL NO. #4A | |
| 5. LOCATION OF WELL (Report location clearly and in accordance with any State requirements.) At surface 1830 'FILL and 1705 'MWL. Unit F | | 10. FIELD AND POOL OR WILDCAT Blanco Mesa Verde | |
| 11. DISTANCE IN MILES AND DIRECTION FROM NEAREST TOWN OR POST OFFICE From Canyon Largo Rd. turn up Cutter Canyon for 1 mi. Turn left on Lease Rd. for 4 mi. Follow existing trail to location. | | 12. COUNTY OR PARISH 13. STATE San Juan New Mexico | |
| 14. DISTANCE FROM PROPOSED LOCATION TO NEAREST PROPERTY OR LEASE LINE, FT. (Also to nearest drlg. unit line, if any) | | 17. NO. OF ACRES ASSIGNED TO THIS WELL 375.09 | |
| 15. DISTANCE FROM PROPOSED LOCATION TO NEAREST WELL, DRILLING, COMPLETED, OR APPLIED FOR, ON THIS LEASE, FT. | | 18. PROPOSED DEPTH +4989 | |
| 16. ELEVATIONS (Show whether D.F., K.T., G.R., etc.) 6011' GL | | 19. ROTARY OR CABLE TOOLS Rotary | |
| 20. APPROX. DATE WORK WILL START May 6, 1977 | | 21. APPROX. DATE WORK WILL START May 6, 1977 | |
| 22. PROPOSED CASING AND CEMENTING PROGRAM | | | |
| SIZE OF HOLE | SIZE OF CASING | WEIGHT PER FOOT | SETTING DEPTH |
| 12-1/4" | 9-5/8" | 36# | + 200' |
| 8-3/4" | 7" | 23# | + 2954' |
| 6-1/8" | 4-1/2" | 10.5# | + 2654'-4989' |
| | | | QUANTITY OF CEMENT |
| | | | Suff. to circulate to surface |
| | | | Suff. to cement to surface csg. |
| | | | Suff. to cement to 40' T.D. |

1- The geologic name of this surface formation is (~~XXXXXXXXXXXX~~ Nacimiento)

2&3 Formation Tops (Estimated)

| | | | |
|-----------------|---|-------|-------------------------------|
| Pictured Cliffs | + | 2,454 | 'Possible oil or gas producer |
| Cliff House | + | 4,094 | 'Possible oil or gas producer |
| Menefee | + | 4,209 | 'Possible oil or gas producer |
| Point Lookout | + | 4,709 | 'Possible oil or gas producer |
| Mancos Shale | + | 4,869 | ' |

4- Run 9-5/8" OD, K-55 new casing to +200' and circulate cement to surface. Run 7" OD, 23#, K-55 new casing to + 2954' and circulate cement up through the 9-5/8" csg. Run a 4 1/2" csg. Liner from 300' above bottom of 7" csg. to T.D. and circulate cement back to the top of 4 1/2" csg. Casinghead will be a 10" 900 series w/a 3000 psi. rating.

5- Blowout preventors: Hydraulic, double ram, 10". One set of rams will be provided for each size drill pipe in the hole. One set of blind rams at all times. Fill line will be 2", kill line will be 2", choke relief line will be 2" with variable choke.

6- We will use; spud mud from 0-+200'; Gel Chemical w/low solids as needed to maintain good hole conditions from +200'-+2954'; Compressed gas from +2954' to T.D..

7- Auxiliary Equipment

- Kelly cock will be in use at all times.
- Stabbing valve to fit drill pipe will be present on floor at all times.
- Mud monitoring will be visual, no abnormal pressures are anticipated in this area.
- Rotating head will be used when drilling with gas.

8- An AOF test will be taken at the completion of this well. No cores will be taken. Gamma Ray and Compensated Density logs will be run. Any other evaluation that may be necessary during the drilling of this well will be conducted as needed.

9- No abnormal pressures or temperatures are anticipated. See point #5 for blowout prevention equipment.

10- The drilling of this well will take approximately eight days. The gas is contracted to Southern Union Gathering Co.

IN ABOVE SPACE DESCRIBE PROPOSED PROGRAM: If proposal is to deepen or plug back, give data on present productive zone and proposed new productive zone. If proposal is to drill or deepen directionally, give pertinent data on subsurface locations and measured and true vertical depths. Give blowout prevention program, if any.

24. SIGNED: W. H. Meyer TITLE: Div. Production Manager DATE: 4.2.77
(This space for Federal or State office use)

PERMIT NO. _____ APPROVAL DATE _____

APPROVED BY _____ TITLE _____ DATE _____
CONDITIONS OF APPROVAL, IF ANY:

NSL-831
NWU-R-139

**NEW MEXICO OIL CONSERVATION COMMISSION
WELL LOCATION AND ACERAGE DEDICATION PLAT**

All distances must be from the outer boundaries of the Section

| | | | | |
|--|---|----------------------------------|---|---------------------------|
| Operator TENNECO OIL COMPANY | | Lease PRITCHARD | | Well No. 4 - A |
| Unit Letter F | Section 31 | Township 29 NORTH | Range 8 WEST | County SAN JUAN |
| Actual Footage Location of Well: 1830 feet from the NORTH line and 1705 feet from the WEST line | | | | |
| Ground Level Elev. 6011 | Producing Formation Blanco Mesa Verde | Pool Blanco Mesa Verde | Dedicated Acreage: 375.09 Acres | |

1. Outline the acreage dedicated to the subject well by colored pencil or hatchure marks on the plat below. W/2 of Sec. 31
SW/4 of Sec. 30
2. If more than one lease is dedicated to the well, outline each and identify the ownership thereof (both as to working interest and royalty),
3. If more than one lease of different ownership is dedicated to the well, have the interests of all owners been consolidated by communization, unitization, force-pooling, etc?

(X) Yes () No If answer is "yes," type of consolidation Communization

If answer is "no," list the owners and tract descriptions which have actually consolidated. (Use reverse side of this form if necessary.)

No allowable will be assigned to the well until all interests have been consolidated (by communization, unitization, forced-pooling, or otherwise) or until a non standard unit, eliminating such interests, has been approved by the Commission.

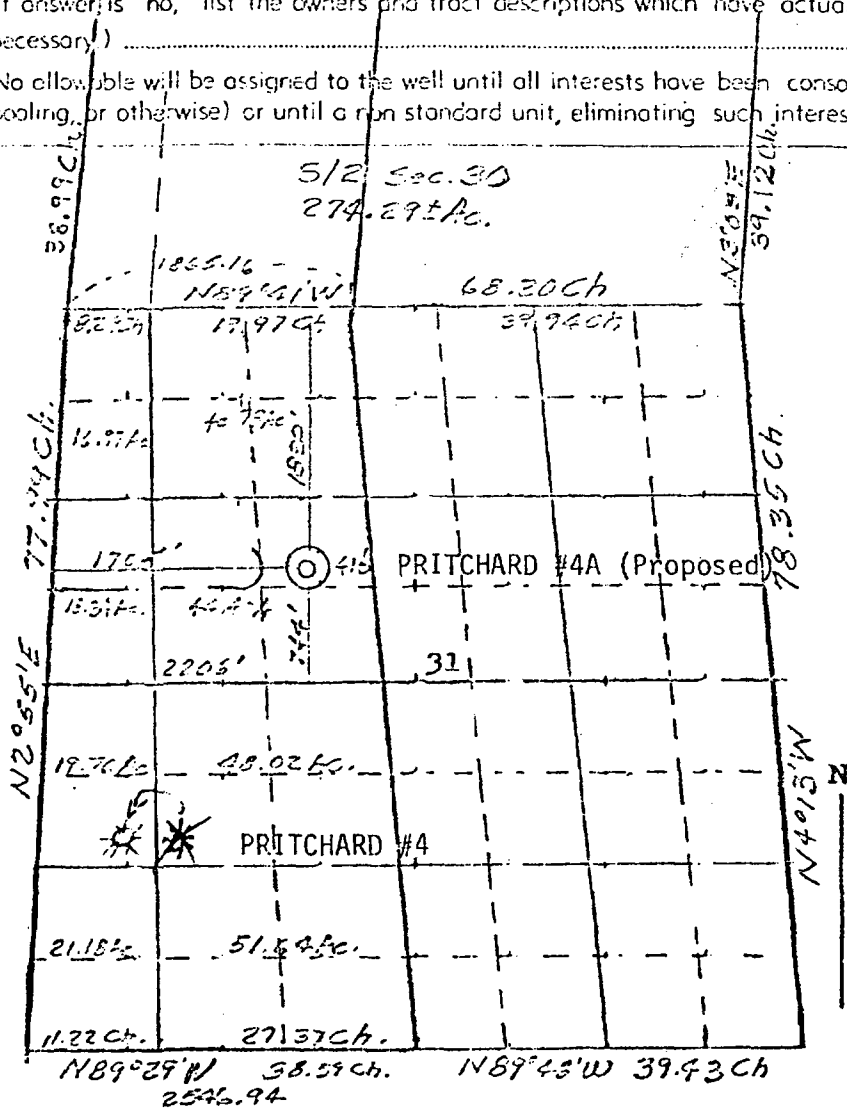

CERTIFICATION

I hereby certify that the information contained herein is true and complete to the best of my knowledge and belief.

Name Red F. Drake
 Position Production Analyst
 Company Tenneco Oil Company

Date March 15, 1977

I hereby certify that the well location shown on this plat was plotted from field notes of actual surveys made by me or under my supervision, and that the same is true and correct to the best of my knowledge and belief.

Date Surveyed 6 February 1977
James P. Leese
 Registered Professional Engineer
 and/or Land Surveyor **James P. Leese**

1463

Certificate No.

Existing Roads:

- a. See surveyors plat for actual staking.
- b. The well site is located approximately
- c. See Exhibit "B" for access roads.
- d. Not applicable.
- e. See Exhibit "B" for one mile radius road map.
- f. Plan to construct 2500' of 14' wide road to well site following existing trail. We will construct water bars where necessary, and slope road through all arroyos.

Planned Access Roads:

- a. See Exhibit "B".
- b. Width=14'
- c. No turnouts.
- d. Drainage-Water bars will be constructed where required to prevent erosion.
- e. Road will be cut into any arroyos and sloped across the bottom to maintain normal drainage. Cuts or fills will be kept to a minimum.
- f. No gates or cattle guards are needed.
- g. Road is center line flagged.

Location of Existing Wells.

- a. See Exhibits "B" and "C" for well locations.

Location of Existing and/or Proposed Facilities.

- a. See Exhibit "B" and "C". Lines are buried.
- b. This is expected to be a dry gas well. If condensate is encountered, a 300 bbl steel tank painted green to match the surrounding area, will be set on a gravel base near the well as shown on Exhibit "A". A dirt bank will be erected around the tank to contain any spills. The possible spill area will be fenced.
- c. If well is productive, pits will be backfilled, leveled and reseeded as soon as practical to original contours.

Location and type of Water Supply

- a. Water will be hauled from the San Juan River, or El Paso water wells.
- b. Trucks will be used to haul water.
- c. No water well will be drilled.

Source of Construction Materials

- a. No construction materials will be used. Surface soil will be stockpiled.
- b. We will not be getting any construction materials from Federal or Indian lands.
- c. No construction materials will be used.
- d. No access roads for construction materials will be needed.

Methods for Handling Waste Disposal

- a. Cuttings will be disposed of in the reserve pit.
- b&c. Drilling fluids and produced water will be collected in the reserve pit and hauled away to an approved disposal system or a separate disposal application will be submitted. Any produced oil will be run to the tank (see 4:8)
- d&e. All detrimental waste will be hauled away, burned or buried with a minimum cover of 24" of dirt.
- f. After the rig moves out, See 4:C. If unproductive, a dry hole marker will be installed and all pits will be filled, leveled and entire location reseeded to your specifications. Roads will be leveled and reseeded.

Ancillary Facilities

- a. No camps or airstrips will be needed in the drilling of this well.

Well Site Layout.

- a. See Exhibit "A".
- b. Pits will be unlined.

Plans for Restoration of Surface.

- a. See 4:C and 7:A-F
- b. BLM SEEDING REQUIREMENTS IN THE FARMINGTON RESOURCE AREA

We will use seed mixture (X, 2). A disc-type drill set for 8"-10" rows with two boxes for various seed sizes will be used. The seed will be drilled on the contour not less than 1/2" deep or more than 1" deep, followed by a drag, packer, or roller to compact and cover the seed adequately. Where slopes are to steep for contour drilling, a "cyclone" hand seeder or similar broadcast seeder will be used. Seed will then be covered by whatever means are practical. The following species in lbs. pure-live-seed per acre will be used:

| SEED MIXTURE 1 | SPECIES | SEED MIXTURE 2 |
|----------------|---|----------------|
| 2-1/2 lbs. | Smooth Brome (Bromus inermis) | |
| 1 lb. | Monard Alfalfa (Medicago sativa) | |
| 1 lb. | Fourwing Saltbush (dewinged) (Atriplex canescens) | 1/2 lb. |
| 2-1/2 lbs. | Crested Wheatgrass (Agropyron desertorum) | 3-1/2 lbs. |
| | Sand Dropseed (Sporobolus cryptandrus) | 1 lb. |
| | Winterfat (Eurotia lanata) | 1 lb. |
| | Alkali Sacaton (Sporobolus airoides) | 2 lb. |

- c. Prior to rig release, pits will be fenced and so maintained until clean up.
 - d. If any oil is on the pit, it will be removed or flagged.
 - e. Rehabilitation operations will be done during the best weather conditions to promote regrowth in area. All seeding will take place between July 1 and Sept.
11. Other information.
- a. Site is located in Junipers with bentonite and sand for soil. The vegetat is predominately Juniper and grass.
 - b. The surface is used for grazing, for wildlife.
 - c. No open water, occupied dwellings, archaeological, historical or cultural sites will be disturbed by this location.
- 12- Operator's Representative.
- a. Field personnel who can be contacted concerning compliance of this Surface Use Plan are as follows: Darrell Brown, 1850 Lincoln, Suite 1700, Denver, Colorado 80295
Office: 303-292-9920 ext. 254 Home: 303-771-8297
- 13- Certification.
- I hereby certify that I, or persons under my direct supervision, have inspected the proposed drill site and access route; that I am familiar with the conditions as they actually exist; that the statements made in this plan are, to the best of my knowledge, true and correct; and that the proposed work performed by Tenneco Oil Company and its contractors and sub-contractors will conform to this plan.

2-16-77
Date

D.E. Brown
D.E. Brown
Division Drilling Engineer

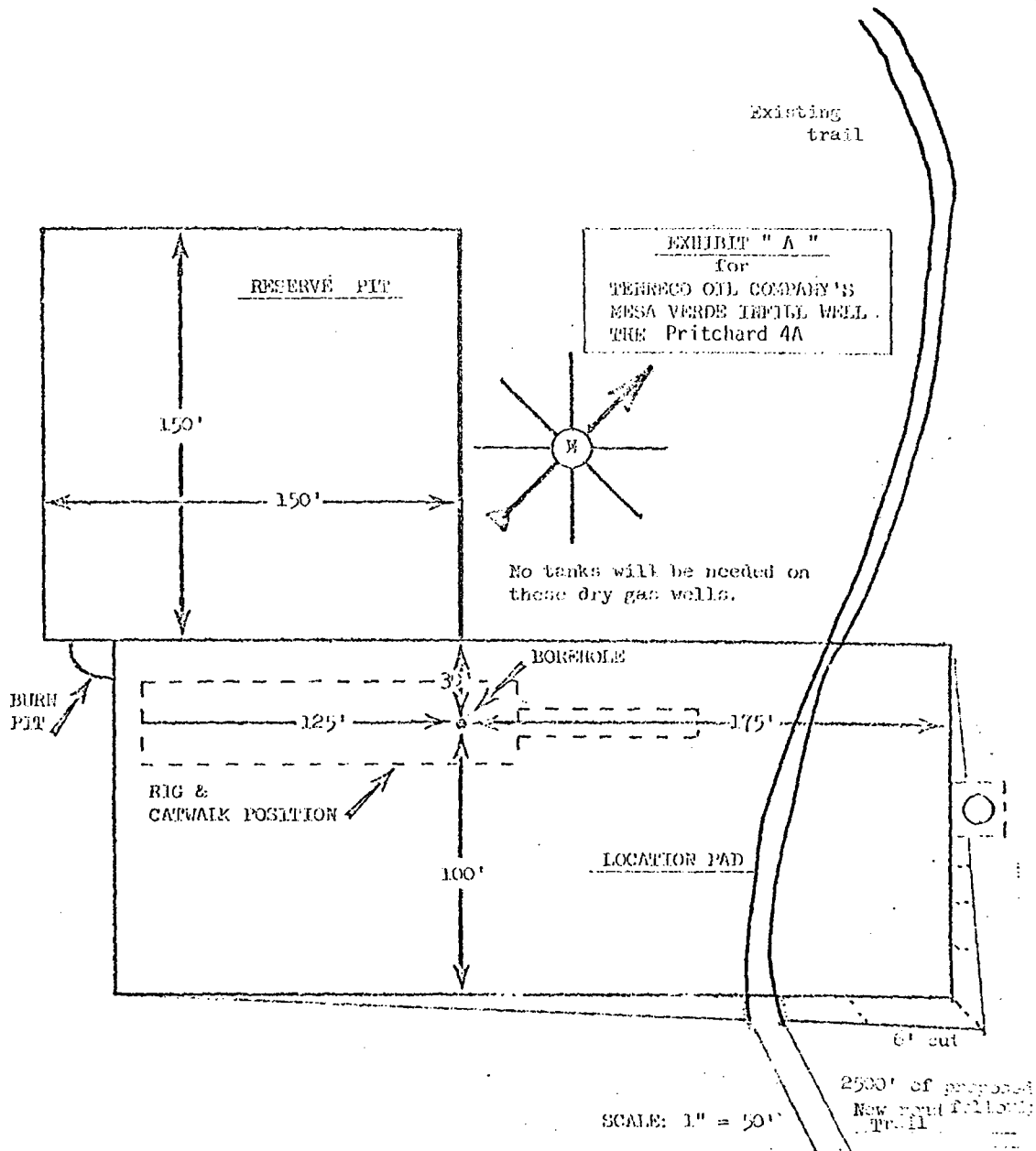
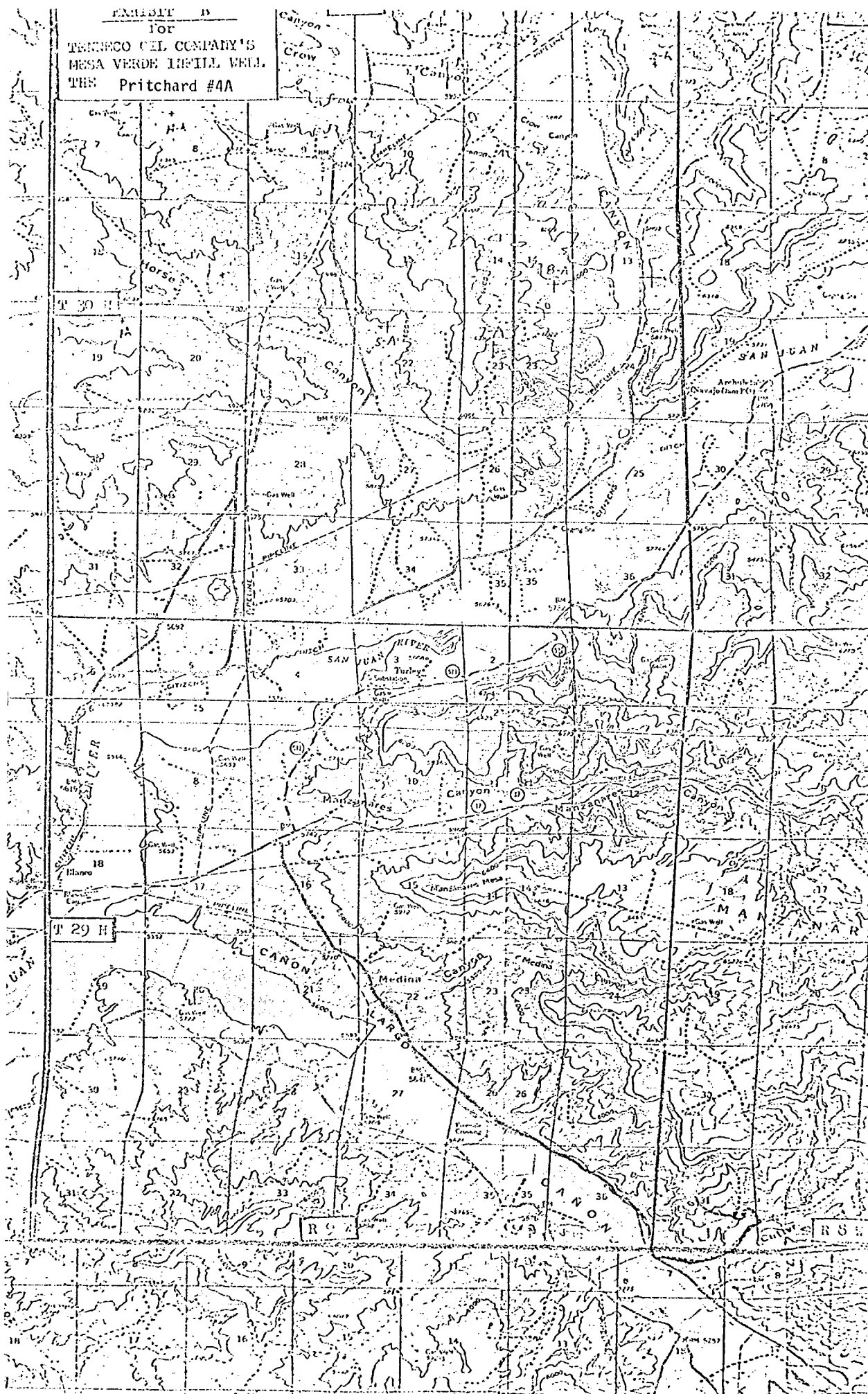

EXHIBIT D
for
TRIENCO OIL COMPANY'S
MESA VERDE INFILL WELL
THE Pritchard #4A



R 9 W

T
30
N

EXHIBIT "C"
FOR
VENISCO OIL COMPANY'S INFILL WELL
WELL

GATHERING SYSTEMS
SOUTHERN UNION GATHERING LINES
EL PASO GATHERING LINES

SCALE IN FEET
4000 0 4000 8000

FOUR TOWNSHIP AREA
San Juan County, New Mexico

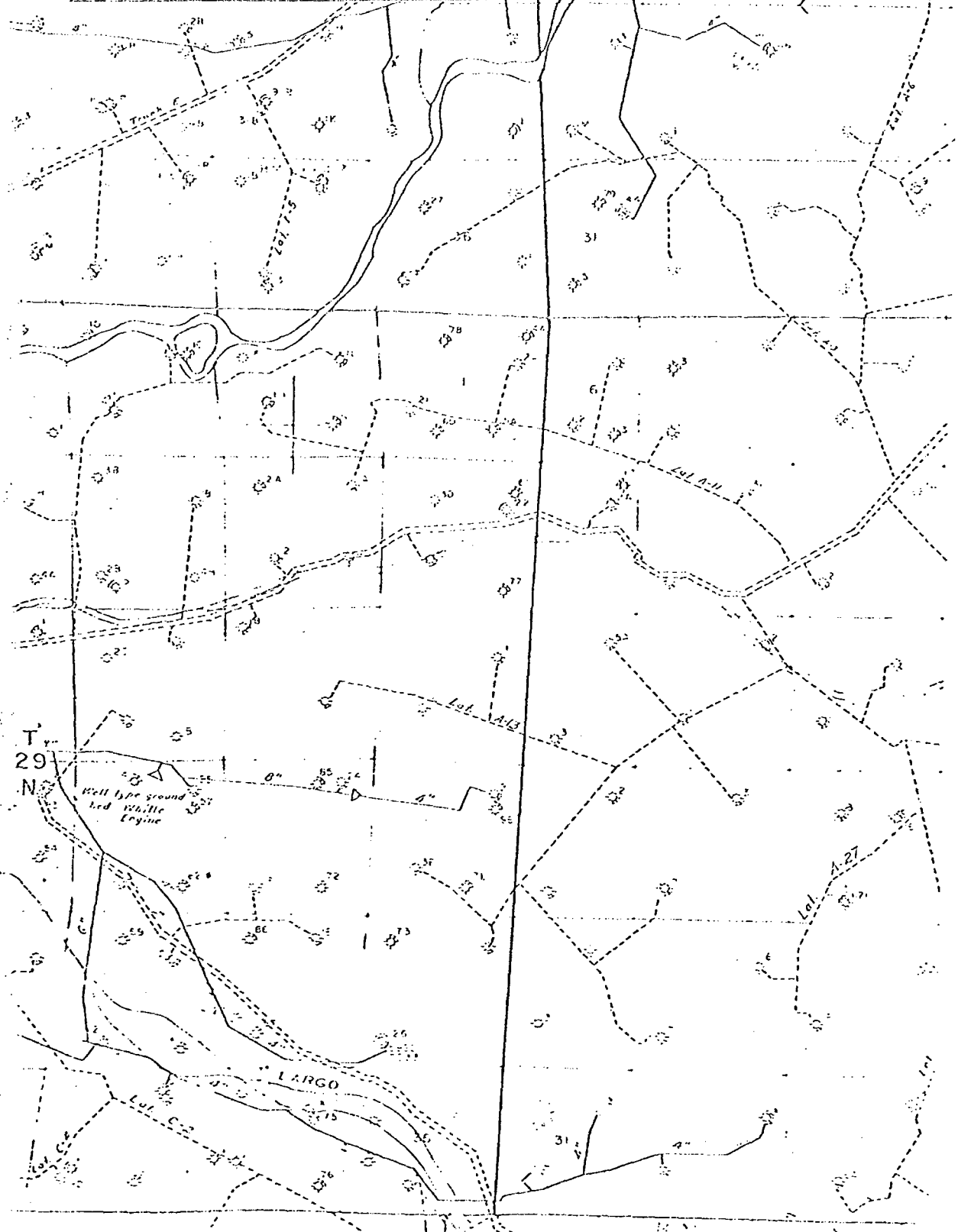

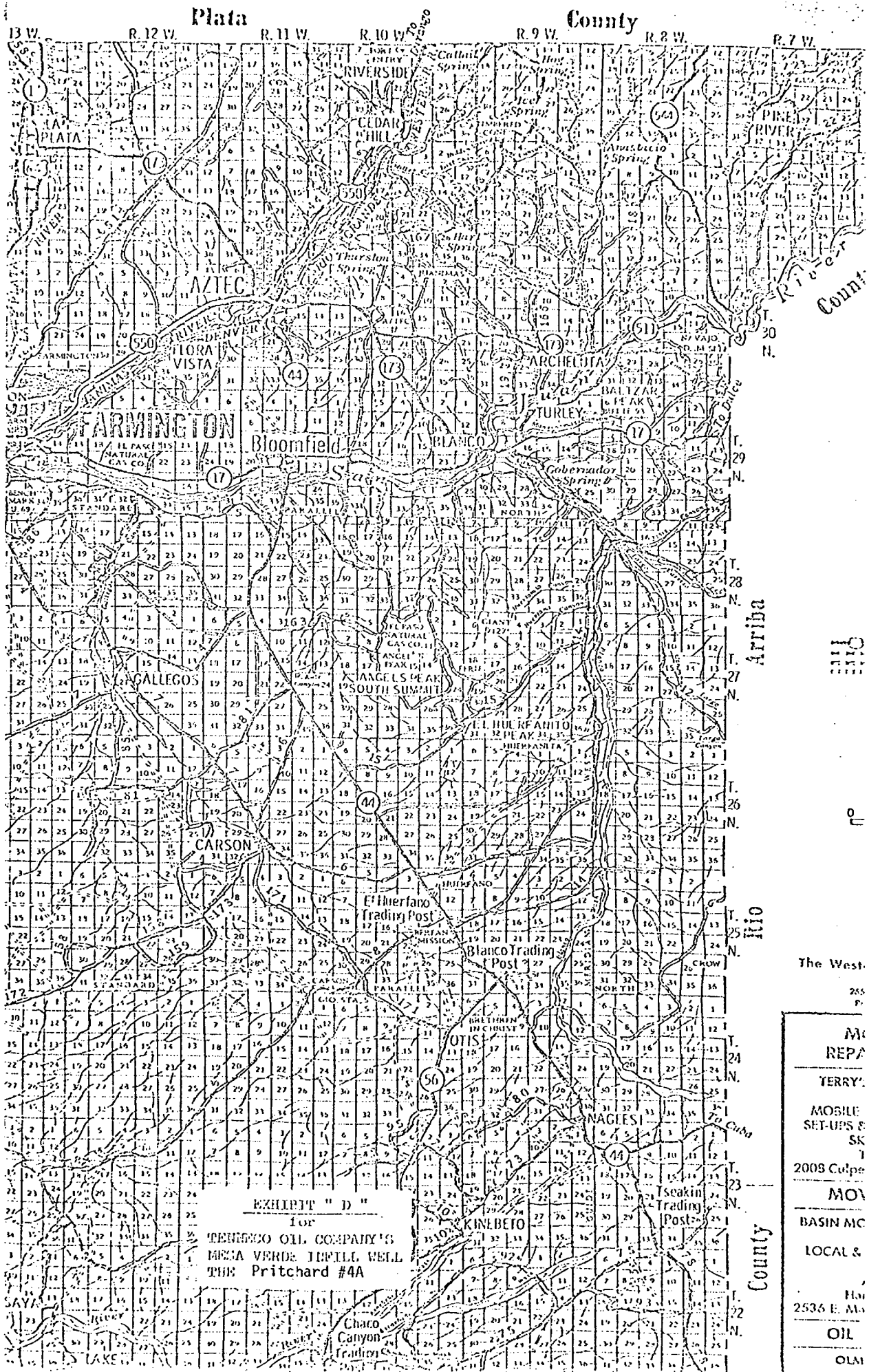

EXHIBIT "D"

for
 TENNECO OIL COMPANY'S
 MECA VERDE INFILL WELL
 THE Pritchard #4A

The West.

285
 P.

MO
 REPA

TERRY:

MOBILE
 SET-UPS &
 SK
 1

2009 Coupe

MOA

BASIN MC

LOCAL &

Has
 2536 E. Main

OIL

OLM

2011-2012-2013

25
11-11-11

- 5

City of Chicago, Illinois

- 2025

2. 2000-2001

- 100

ה'תשנ"ח

development and shooting

- (5) Monitoring or observing

4. Location of Existing and/or

Office of the Secretary of the Navy

3. If new facilities are

City:

() 2000000000

Cheng's use of the term "China" is not surprising, given that the book is written for a general audience. However, it is worth noting that the book's title, "China's Foreign Relations," is more specific than the content, which covers a wide range of international relations topics.

- Location and Type of Injury

4. Show location and type

U.S. DEPARTMENT OF AGRICULTURE

- Show information on the

1. The first group of people who are not in the labor force are those who are not in the labor force because they are not in the labor force.

• Show any needed access

- (2) **Coatings and**

3. Excess Ties

for the purpose of the study.

- When it comes out

300

601 S. 2nd St.

- (b) (5) DPP, (b) (7)(C), (b) (7)(D)

100

Plans for Resurrection

- ## Operations

General: discussion of

2nd July
Colony

- SECRET

THE WIND IS RISING
THE WIND IS RISING
THE WIND IS RISING

in the plain and west

- to this plan.

_____ Amount and Date