

SHELL OIL COMPANY

PETROLEUM BUILDING
P.O. BOX 1509
MIDLAND, TEXAS 79702

DHC-278
Due-5/6/79

April 12, 1979

Subject: Application to Downhole Commingle
for Shell Turner Well No. 15,
Unit Letter O, Located 990' FSL
and 2310' FEL Section 22, T-21-S,
R-37-E, Lea County, New Mexico
Drinkard Field

State of New Mexico (3)
Energy and Minerals Department
Oil Conservation Division
P. O. Box 2088
Santa Fe, NM 87501

Attention Mr. J. D. Ramey, Secretary-Director

Gentlemen:

Shell Oil Company requests administrative approval under the provisions of Rule 303-C to commingle within the wellbore production from the Blinebry and Drinkard pools in its Turner Well No. 15, located in Unit O of Section 22, T-21-S, R-37-E, Lea County, New Mexico.

The Subject well has been flowing from the Blinebry zone at a rate of 10 BOPD + 1 BWPD + 246 MCFGPD with a GOR of 24,600 CF/B. The Drinkard zone was reclassified as an oil zone on March 15, 1979 showing a test of 3 BOPD + 0 BWPD + 266 MCFGPD, GOR 88,667 CF/B.

Production from the Blinebry and Drinkard formations has been surface commingled in the Turner Battery for a number of years without any indication of fluid incompatibility. Since the crudes are commingled at the Battery before being sold, no differences in value will result by commingling within the wellbore of the subject well.

The static BHP for the Blinebry was 535 PSIG, and the Drinkard is 270 PSIG.

81-1080 11% 246 mcf 44%
Dr - $\frac{3}{13}$ 23% $\frac{266}{512}$ 52%
RECEIVED
APR 16 1979
OIL CONSERVATION DIVISION
SANTA FE

GOR
BL - 4000
Dr - 6000

Battery Pf 6604
max = 40 BOPD

A copy of this application is being sent to all offset operators. Your further handling and approval of this application will be sincerely appreciated.

Yours very truly,

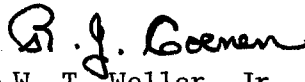

for W. T. Weller, Jr.
Operations Manager-Midland
Mid-Continent Division

JWH:JAH

Attachments

cc - Offset Operators

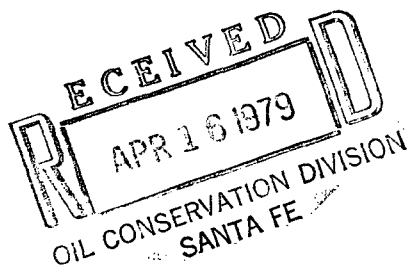
- State of New Mexico
Energy and Minerals Department
Oil Conservation Division
P. O. Box 1980
Hobbs, NM 88240



OFFSET OPERATORS

SHELL TURNER LEASE
SECTION 22, T-21-S, R-37-E
LEA COUNTY, NEW MEXICO

J. R. CONE
P. O. BOX 871
LUBBOCK, TX 79408

CONTINENTAL OIL COMPANY
P. O. BOX 1959
MIDLAND, TX 79702

GETTY OIL COMPANY
P. O. BOX 1231
MIDLAND, TX 79702

GULF OIL CORPORATION
P. O. BOX 1150
MIDLAND, TX 79702

SUN OIL COMPANY
P. O. BOX 1861
MIDLAND, TX 79701

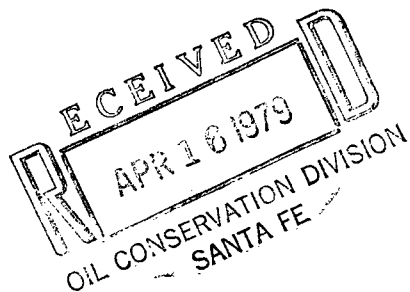

GAS-OIL RATIO TESTS

Downhole Commingle Permission

C-116
Revised 1-1-65

Operator
Shell Oil Company

Pool
Blinebry - Drinkard

County
Lea

Address

P. O. Box 576, Houston, TX 77001

TYPE OF
TEST - (X)

Scheduled ☐

Completion ☐

Special ☒

LEASE NAME	WELL NO.	LOCATION				DATE OF TEST	CHOKE SIZE	TBG. PRESS.	DAILY ALLOW-ABLE	LENGTH OF TEST HOURS	PROD. DURING TEST				GAS - OIL RATIO CU.FT/BBL
		U	S	T	R						WATER BBL.S	GRAV. OIL	OIL BBL.S	GAS M.C.F.	
Turner (Blinebry)	15	0	22	21	37	3-06-79	F 48/64	90		24	1	36.0	10	246	24,600
Turner (Drinkard)	15	0	22	21	37	3-12-79	F 74/64	50		24	0	38.3	3	266	88,667

No well will be assigned an allowable greater than the amount of oil produced on the official test.

During gas-oil ratio test, each well shall be produced at a rate not exceeding the top unit allowable for the pool in which well is located by more than 25 percent. Operator is encouraged to take advantage of this 25 percent tolerance in order that well can be assigned increased allowable when authorized by the Commission.

Gas volumes must be reported in MCF measured at a pressure base of 15.025 psia and a temperature of 60° F. Specific gravity base will be 0.60.

Report casing pressure in lieu of tubing pressure for any well producing through casing.

Mail original and one copy of this report to the district office of the New Mexico Oil Conservation Commission in accordance with Rule 301 and appropriate pool rules.

I hereby certify that the above information is true and complete to the best of my knowledge and belief.

A. Ramirez
A. Ramirez

Supervisor Oil Accounting

3-28-79

(Title)

[illegible]

[illegible]

TURNER #15 - BLINEBRY

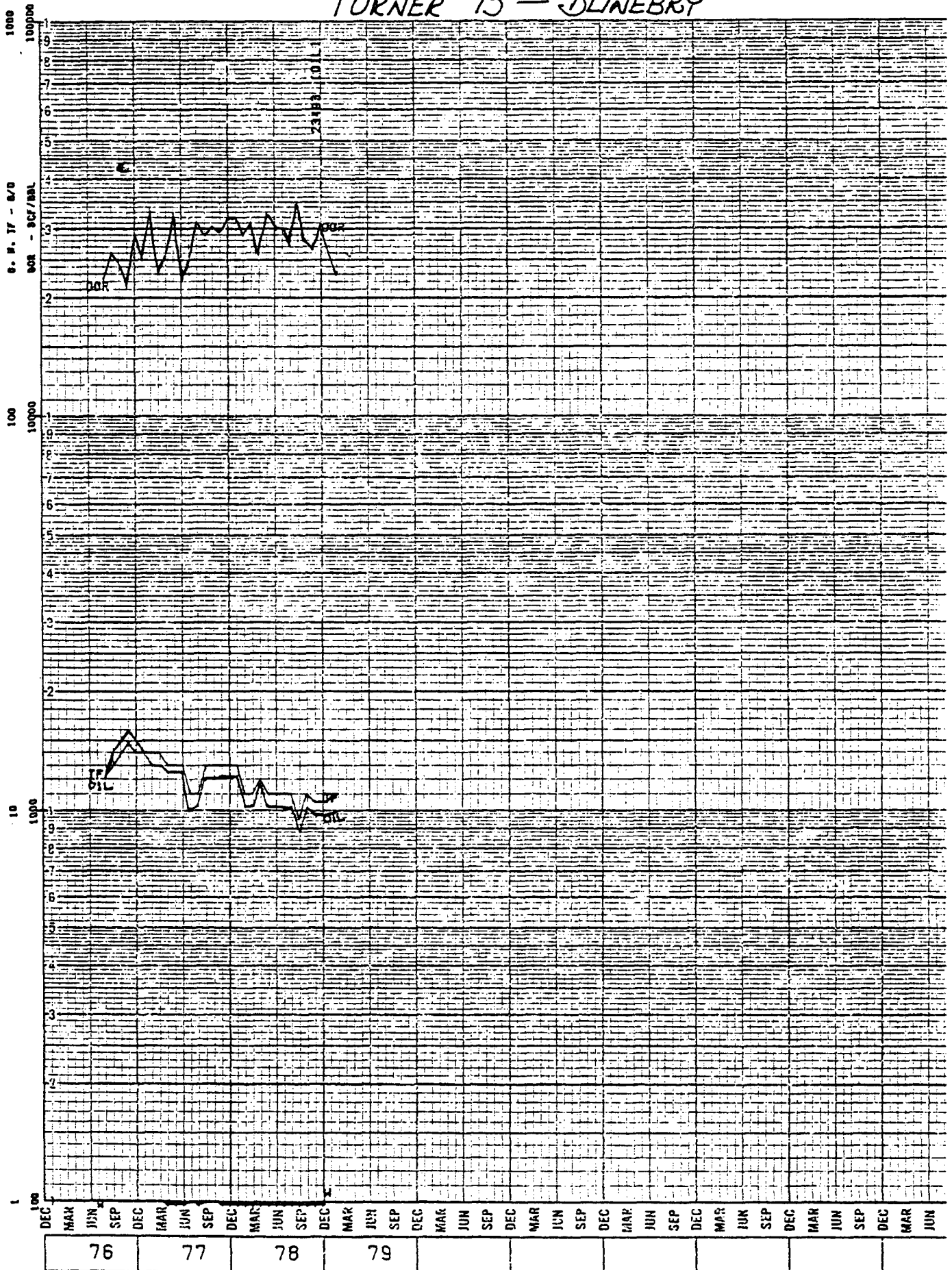

10,000

9
8
7
6
5
4
3
2
1

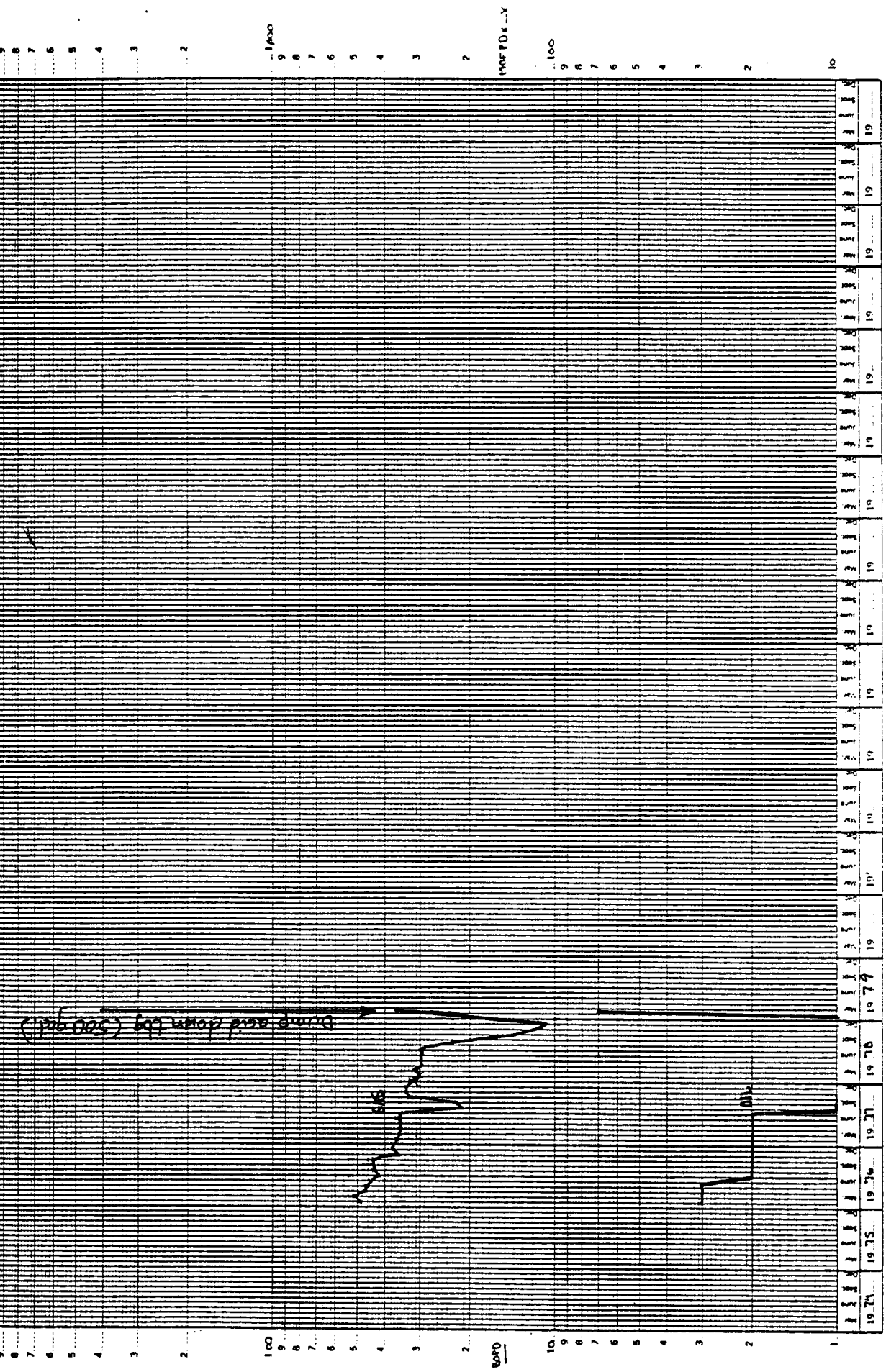

Turner #15 - Drinkard

Shell Turner No. 15
Drinkard Field
Drinkard & Blinebry Pools
Lea County, New Mexico
Present Downhole Equipment

Elev.: DF = 3416'
TD = 7472'
PBTD = 6625'

13 ³/₈" 32 # csq @ 254', cmt'd
w/ 300 sx

TOL @ 2671'

8 ⁵/₈" 32 # csq @ 2887', cmt'd
w/ 1450 sx

184 jts, 2 ¹/₁₆" tbq,
hung open-ended @ 5704'

195 jts, 2 ¹/₁₆" tbq
@ 6304'

(Baker) Model D pkr @ 6304'

Drinkard Perforations
6356' to 6604'

CIBP @ 6660'

CIBP @ 7340'

Ellenberger Perforations
7414' to 7433'

5 ¹/₂" (full string), 17# and 15.5#
@ 7472', cmt'd w/ 800 sx.

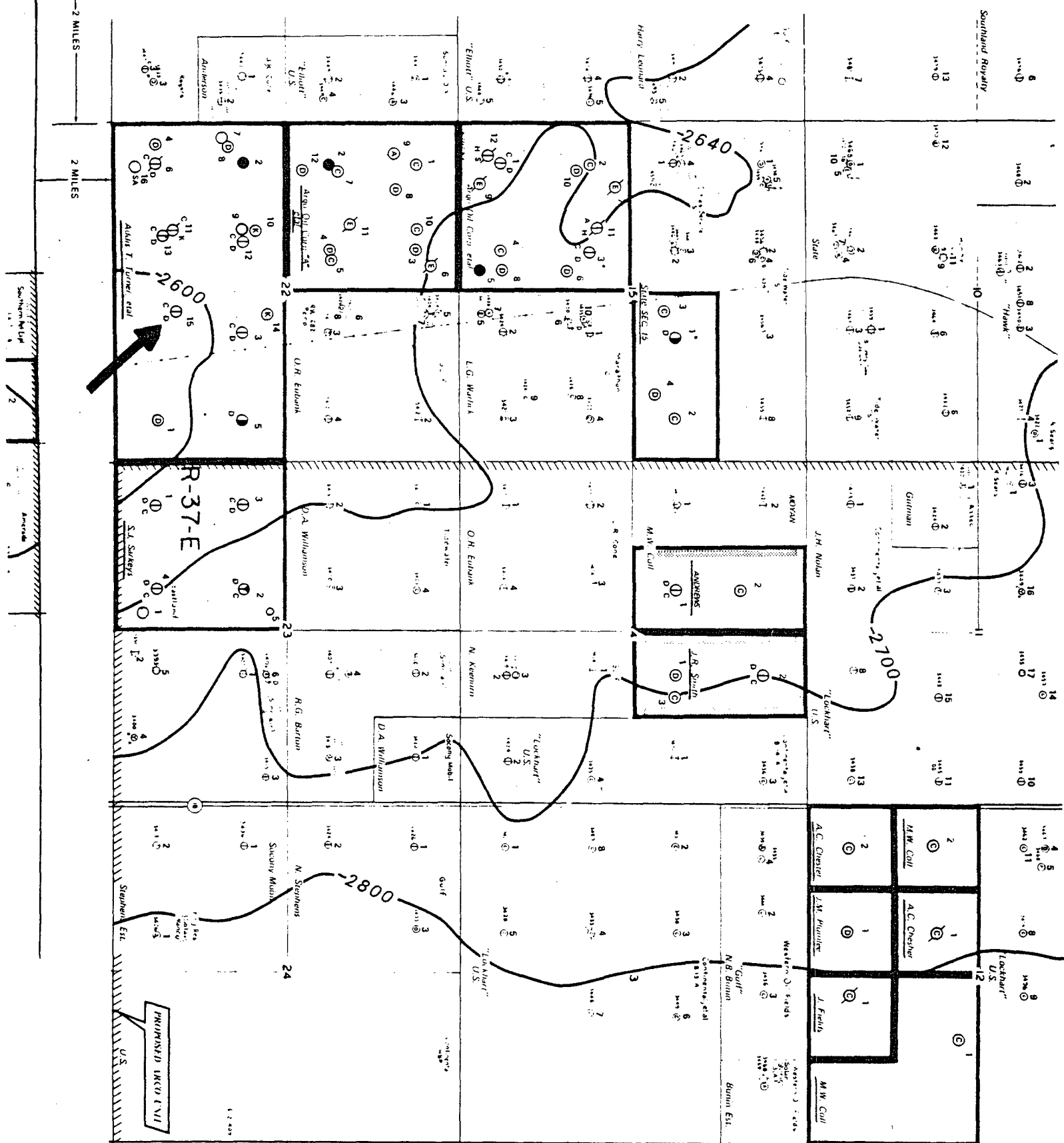

OIL CONSERVATION COMMISSION
Hobbs DISTRICT

OIL CONSERVATION COMMISSION
BOX 2088
SANTA FE, NEW MEXICO

DATE April 16, 1979

RE: Proposed MC _____
Proposed DHC X _____
Proposed NSL _____
Proposed SWD _____
Proposed WFX _____
Proposed PMX _____

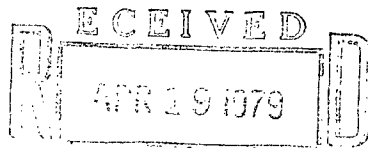

Gentlemen:

OIL CONSERVATION DIVISION
SANTA FE

I have examined the application dated _____

for the Shell Oil Co. Turner #15-0 22-21-37
Operator Lease and Well No. Unit, S-T-R

and my recommendations are as follows:

O.K.----J.S.

Yours very truly,

A handwritten signature in cursive script, appearing to read "James L. S." or similar, written over a horizontal line.