

CMD :
OGSSECT

ONGARD
INQUIRE LAND BY SECTION

Sec : 32 Twp : 17S Rng : 34E Section Type : NORMAL

D
40.00
CS
E01447 0002
BP AMERICA PRODUC
C U 08/11/57
A

C
40.00
CS
E01447 0002
BP AMERICA PRODUC
C U 08/11/57
A

B
40.00
CS
B00143 0005
BURGUNDY OIL & GA
U 08/14/41
A

A
40.00
CS
B00143 0005
BURGUNDY OIL & GA
08/14/41
A

E
40.00
CS
E01447 0002
BP AMERICA PRODUC
C U 08/11/57
A

F
40.00
CS
E01447 0002
BP AMERICA PRODUC
C U 08/11/57
A A

G
40.00
CS
B00143 0005
BURGUNDY OIL & GA
U 08/14/41
A A

H
40.00
CS
B00143 0005
BURGUNDY OIL & GA
U 08/14/41
A A

L
40.00
CS
E01448 0002
BP AMERICA PRODUC
C U 08/11/57
A A A

K
40.00
CS
E01448 0002
BP AMERICA PRODUC
C U 08/11/57
A

J
40.00
CS
E01448 0002
BP AMERICA PRODUC
U 08/11/57
A A

I
40.00
CS
E01448 0002
BP AMERICA PRODUC
U 08/11/57
A

M
40.00
CS
E01448 0002
BP AMERICA PRODUC
C U 08/11/57
A

N
40.00
CS
E01448 0002
BP AMERICA PRODUC
C U 08/11/57
A A A

O
40.00
CS
E01448 0002
BP AMERICA PRODUC
U 08/11/57
A

P
40.00
CS
E01448 0002
BP AMERICA PRODUC
U 08/11/57
A

CMD :
OG6C101

ONGARD
C101-APPLICATION FOR PERMIT TO DRILL

11/24/04 15:34:35
OGOMBS -TPIM

OGRID Idn : 141928 APD Well No: 30 25 26942 APD Status(A/C/P): A
Opr Name, Addr: PATTERSON PETROLEUM LP Aprvl/Cncl Date : 11-16-2004
P O DRAWER 1416
SNYDER, TX 79550

Prop Idn: 34383 DUNCAN 32 STATE COM

Well No: 1

| | U/L | Sec | Township | Range | Lot Idn | North/South | East/West |
|----------------|-----|-----|--------------|-------|---------|--------------|-------------|
| Surface Locn : | H | 32 | 17S | 34E | | FTG 2245 F N | FTG 660 F E |
| OCD U/L : | H | | API County : | 25 | | | |

Work typ(N/E/D/P/A) : N Well typ(O/G/M/I/S/W/C): G Cable/Rotary (C/R) : R
Lease typ(F/S/P/N/J/U/I): S Ground Level Elevation : 4068

State Lease No: Multiple Comp (S/X/C) : S
Prpsd Depth : 13800 Prpsd Frmtm : MORROW 320 E/2

E0009: Enter data to modify record

| | | | | | |
|-----------|------|------------|-----------|--------------|--------------|
| PF01 HELP | PF02 | PF03 EXIT | PF04 GoTo | PF05 | PF06 CONFIRM |
| PF07 | PF08 | PF09 PRINT | PF10 C102 | PF11 HISTORY | PF12 |

District I
1625 N. French Dr., Hobbs, NM 88240
District II
1301 W. Grand Avenue, Artesia, NM 88210
District III
1000 Rio Brazos Road, Aztec, NM 87410
District IV
1220 S. St. Francis Dr., Santa Fe, NM 87505

State of New Mexico
Energy Minerals and Natural Resources

Form C-101
May 27, 2004

Oil Conservation Division
1220 South St. Francis Dr.
Santa Fe, NM 87505

Submit to appropriate District Office

☐ AMENDED REPORT

APPLICATION FOR PERMIT TO DRILL, RE-ENTER, DEEPEN, PLUGBACK, OR ADD A ZONE

| | | |
|--|---|---|
| ¹ Operator Name and Address PATTERSON PETROLEUM LP P.O. DRAWER 1416 SNYDER, TX 79550 | | ² OGRID Number 141928 |
| ³ Property Code 34383 | ⁴ Property Name DUNCAN "32" STATE COM | ⁵ API Number 30-025-36942 |
| ⁶ Proposed Pool 1 VACUUM; MORROW | | ⁷ Proposed Pool 2 VACUUM; ATOKA, WEST |

7 Surface Location

| UL or lot no. | Section | Township | Range | Lot Idn | Feet from the | North/South line | Feet from the | East/West line | County |
|---------------|---------|----------|-------|---------|---------------|------------------|---------------|----------------|--------|
| H | 32 | 17-S | 34-E | | 2245 | NORTH | 660 | EAST | LEA |

8 Proposed Bottom Hole Location If Different From Surface

| UL or lot no. | Section | Township | Range | Lot Idn | Feet from the | North/South line | Feet from the | East/West line | County |
|---------------|---------|----------|-------|---------|---------------|------------------|---------------|----------------|--------|
| | | | | | | | | | |

Additional Well Information

| | | | | |
|--|--|--|---|---|
| ¹¹ Work Type Code N | ¹² Well Type Code G | ¹³ Cable/Rotary ROTARY | ¹⁴ Lease Type Code S | ¹⁵ Ground Level Elevation 4068' |
| ¹⁶ Multiple NO | ¹⁷ Proposed Depth 13,800 | ¹⁸ Formation MORROW | ¹⁹ Contractor PATTERSON-UTI DRLG CO | ²⁰ Spud Date 12/20/04 |
| Depth to Groundwater 140' | | Distance from nearest fresh water well 4000' | | Distance from nearest surface water NONE |
| Pit: Liner: Synthetic <input checked="" type="checkbox"/> 12_mils thick Clay <input type="checkbox"/> Pit Volume: 15,000_bbls Drilling Method: Closed-Loop System <input type="checkbox"/> Fresh Water <input checked="" type="checkbox"/> Brine <input checked="" type="checkbox"/> Diesel/Oil-based <input type="checkbox"/> Gas/Air <input type="checkbox"/> | | | | |

21 Proposed Casing and Cement Program

| Hole Size | Casing Size | Casing weight/foot | Setting Depth | Sacks of Cement | Estimated TOC |
|-----------|-------------|--------------------|---------------|-----------------|---------------|
| 17-1/2" | 13-3/8" | 48# | 400' | 500 | SURFACE |
| 12-1/4" | 9-5/8" | 40# | 4800' | 1750 | SURFACE |
| 8-3/4" | 5-1/2" | 17# | 13,800' | 1000 | 8000' |
| | | | | | |
| | | | | | |

²² Describe the proposed program. If this application is to DEEPEN or PLUG BACK, give the data on the present productive zone and proposed new productive zone. Describe the blowout prevention program, if any. Use additional sheets if necessary.

Drilling fluid synopsis attached.
BOP: Series 900, 5000# WP - See figure 25 attached.
Additional casing & cementing information attached.

**Permit Expires 1 Year From Approval
Date Unless Drilling Underway**

²³ I hereby certify that the information given above is true and complete to the best of my knowledge and belief. I further certify that the drilling pit will be constructed according to NMOCD guidelines ☒, a general permit ☐, or an (attached) alternative OCD-approved plan ☐.

Printed name: NOLAN VON ROEDER
Title: ENGINEER
E-mail Address: vonroedern@patenergy.com
Date: 10/28/04

Phone: 325/573-1938

OIL CONSERVATION DIVISION

Approved by:

Title: PETROLEUM ENGINEER

Approval Date:

Expiration Date:

NOV 16 2004

Conditions of Approval Attached ☐

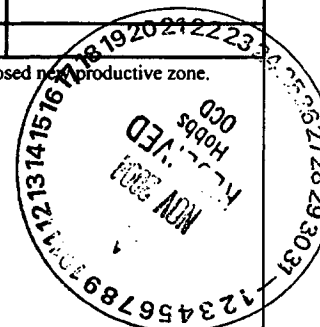

DISTRICT I

1625 N. FRENCH DR., HOBBES, NM 88240

DISTRICT II

1301 W. GRAND AVENUE, ARTESIA, NM 88210

DISTRICT III

1000 Rio Brazos Rd., Aztec, NM 87410

DISTRICT IV

1220 S. ST. FRANCIS DR., SANTA FE, NM 87505

State of New Mexico

Energy, Minerals and Natural Resources Department

OIL CONSERVATION DIVISION
1220 SOUTH ST. FRANCIS DR.
Santa Fe, New Mexico 87505

Form C-102

Revised JUNE 10, 2003

Submit to Appropriate District Office

State Lease - 4 Copies

Fee Lease - 3 Copies

WELL LOCATION AND ACREAGE DEDICATION PLAT

☐ AMENDED REPORT

| | | |
|-----------------------------------|---|-----------------------------------|
| API Number 30-025-36942 | Pool Code 86840 | Pool Name Vacuum Morrow |
| Property Code 34383 | Property Name DUNCAN "32" STATE COM | Well Number 1 |
| OGRID No. 141928 | Operator Name PATTERSON PETROLEUM, L.P. | Elevation 4068' |

Surface Location

| UL or lot No. | Section | Township | Range | Lot Idn | Feet from the | North/South line | Feet from the | East/West line | County |
|---------------|---------|----------|-------|---------|---------------|------------------|---------------|----------------|--------|
| H | 32 | 17-S | 34-E | | 2245 | NORTH | 660 | EAST | LEA |

Bottom Hole Location If Different From Surface

| UL or lot No. | Section | Township | Range | Lot Idn | Feet from the | North/South line | Feet from the | East/West line | County |
|---------------|---------|----------|-------|---------|---------------|------------------|---------------|----------------|--------|
| | | | | | | | | | |

| | | | |
|-------------------------------|-----------------|--------------------|-----------|
| Dedicated Acres 320 | Joint or Infill | Consolidation Code | Order No. |
|-------------------------------|-----------------|--------------------|-----------|

NO ALLOWABLE WILL BE ASSIGNED TO THIS COMPLETION UNTIL ALL INTERESTS HAVE BEEN CONSOLIDATED
OR A NON-STANDARD UNIT HAS BEEN APPROVED BY THE DIVISION

| | | |
|---|--------------------------|--|
| <p>GEODETTIC COORDINATES NAD 27 NME</p> <p>Y=652761.5 N X=732798.7 E</p> <p>LAT.=32°47'32.06" N LONG.=103°34'32.81" W</p> | <p>2245'</p> <p>660'</p> | <p>OPERATOR CERTIFICATION</p> <p>I hereby certify the the information contained herein is true and complete to the best of my knowledge and belief.</p> <p>Signature <i>[Signature]</i></p> <p>Printed Name Ge. Fitzgerald</p> <p>Title Attorney-In-Fact</p> <p>Date 11-10-04</p> |
| | | <p>SURVEYOR CERTIFICATION</p> <p>I hereby certify that the well location shown on this plat was plotted from field notes of actual surveys made by me or under my supervision, and that the same is true and correct to the best of my belief.</p> <p>NOVEMBER 3, 2004</p> <p>Date Surveyed</p> <p>Signature & Seal of Professional Surveyor <i>[Signature]</i></p> <p>04-11-1358</p> <p>Certificate No. GARY EIDSON 12641</p> |
| | | |
| | | |



PATTERSON PETROLEUM LP

A LIMITED PARTNERSHIP

P.O. Box 1416, Snyder, TX 79550

4510 Lamesa Hwy., Snyder, TX 79549

Phone: 325-573-1938 • Fax 325-573-1939

DRILLING FLUID SYNOPSIS

PATTERSON PETROLEUM LP

Duncan "32" State Com No. 1

Section 32

T-17-S

R-34-E

Lea County, New Mexico

CASING

13 3/8" at 400'

9 5/8" at 4800'

5 1/2" at 13,800'

| DEPTH | MUD WT. | VISCOSITY | FLUID LOSS | DRILL SOLIDS | COMMENTS |
|------------------|-------------|-----------|---------------|--------------|-------------------------------------|
| 0' - 400' | 8.4 to 9.0 | 28 to 40 | No Control | 5% | Spud mud & paper |
| 400' - 4800' | 8.4 to 10.3 | 28 to 33 | No Control | 1% | Brine water, paper, caustic |
| 4800 - 12,900' | 8.4 to 9.2 | 28 to 30 | No Control | 1% | Cut-brine, paper & caustic |
| 12,900 - 13,800' | 10 to 10.5 | 36 to 46 | 10 cc or less | < 5% | Xanthan gum, starch, pac, & caustic |

PATTERSON PETROLEUM LP
PROPOSED CASING & CEMENTING PROGRAM
DUNCAN "32" STATE COM WELL NO. 1

13 3/8", 48 lb/ft, H-40 Surface Casing Set at 400' - in a 17 1/2" Hole

Circulate to surface with 500 sacks of Class "C" + 2% CaCl₂ + ¼ lb/sk celloflake

| | |
|--------------------|---------------|
| Slurry Weight: | 14.8 ppg |
| Slurry Yield: | 1.32 cu.ft/sk |
| Water Requirement: | 6.3 gal./sk |

9 5/8", 40 lb/ft, J-55 & N-80 Intermediate Casing Set at 4800' - in a 12 1/4" Hole

Lead : 1500 sx of 35:65 Poz Class "C" + 5% salt + 6% gel + 1/4 lb/sk celloflake
+ 2/10 % antifoamer

Desired TOC = Surface

| | |
|--------------------|---------------|
| Slurry Weight: | 12.4 ppg |
| Slurry Yield: | 2.15 cu.ft/sk |
| Water Requirement: | 11.99 gal/sk |

Tail : 250 sx of Class "C" Neat

| | |
|--------------------|---------------|
| Slurry Weight: | 14.8 ppg |
| Slurry Yield: | 1.32 cu.ft/sk |
| Water Requirement: | 6.31 gal/sk |

5 1/2", 17 lb/ft, N-80 & P110 Production String Casing Set at 13,800' - in an 8 3/4" Hole

Lead : 700 sx of Halliburton Light H + 5% salt + 3/10% HR-7 retarder

Desired TOC = 8000'

| | |
|--------------------|---------------|
| Slurry Weight: | 12.7 ppg |
| Slurry Yield: | 1.95 cu.ft/sk |
| Water Requirement: | 10.48 gal/sk |

Tail : 300 sx of Halliburton Super H w/ 0.5% Lap-1+ 0.4% dispersant +
0.25% antifoamer and 0.25% retarder

| | |
|--------------------|---------------|
| Slurry Weight: | 13.2 ppg |
| Slurry Yield: | 1.60 cu.ft/sk |
| Water Requirement: | 8.21 gal/sk |



Fig. 2.5. Class 3 BOP and Choke Manifold.

SECTION 32, TOWNSHIP 17 SOUTH, RANGE 34 EAST, N.M.P.M.,
 LEA COUNTY, NEW MEXICO

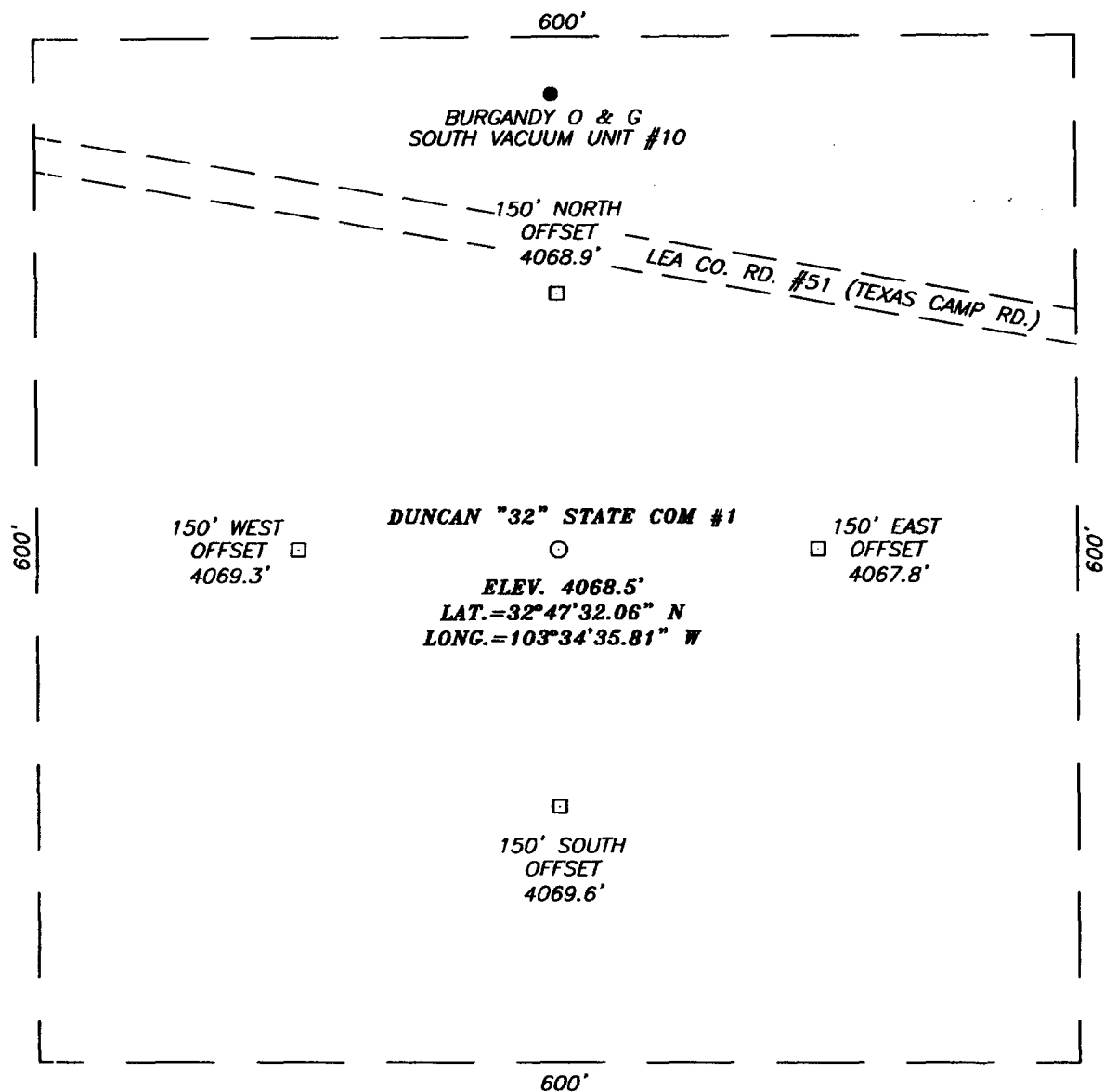

DIRECTIONS TO LOCATION

FROM THE INTERSECTION OF LEA CO. RD. #125 (QUERECHO RD.) AND LEA CO. RD. #51 (TEXAS CAMP RD.) GO EAST ON CO. RD. #51 FOR APPROX. 1.1 MILES. PROPOSED LOCATION IS APPROX. 150' SOUTH.

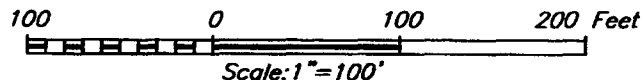

PATTERSON PETROLEUM, L.P.

DUNCAN "32" STATE COM #1 WELL
 LOCATED 2245 FEET FROM THE NORTH LINE
 AND 660 FEET FROM THE EAST LINE OF SECTION 32,
 TOWNSHIP 17 SOUTH, RANGE 34 EAST, N.M.P.M.,
 LEA COUNTY, NEW MEXICO.

| | |
|-------------------------|---------------------|
| Survey Date: 11/3/04 | Sheet 1 of 1 Sheets |
| W.O. Number: 04.11.1358 | Dr By: J.R. |
| Date: 11/9/04 | Disk: CD#10 |
| 04111358 | Scale: 1"=100' |

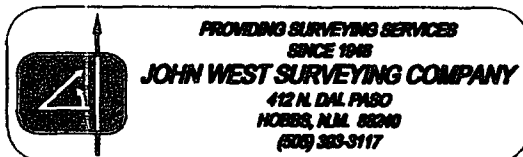

VICINITY MAP

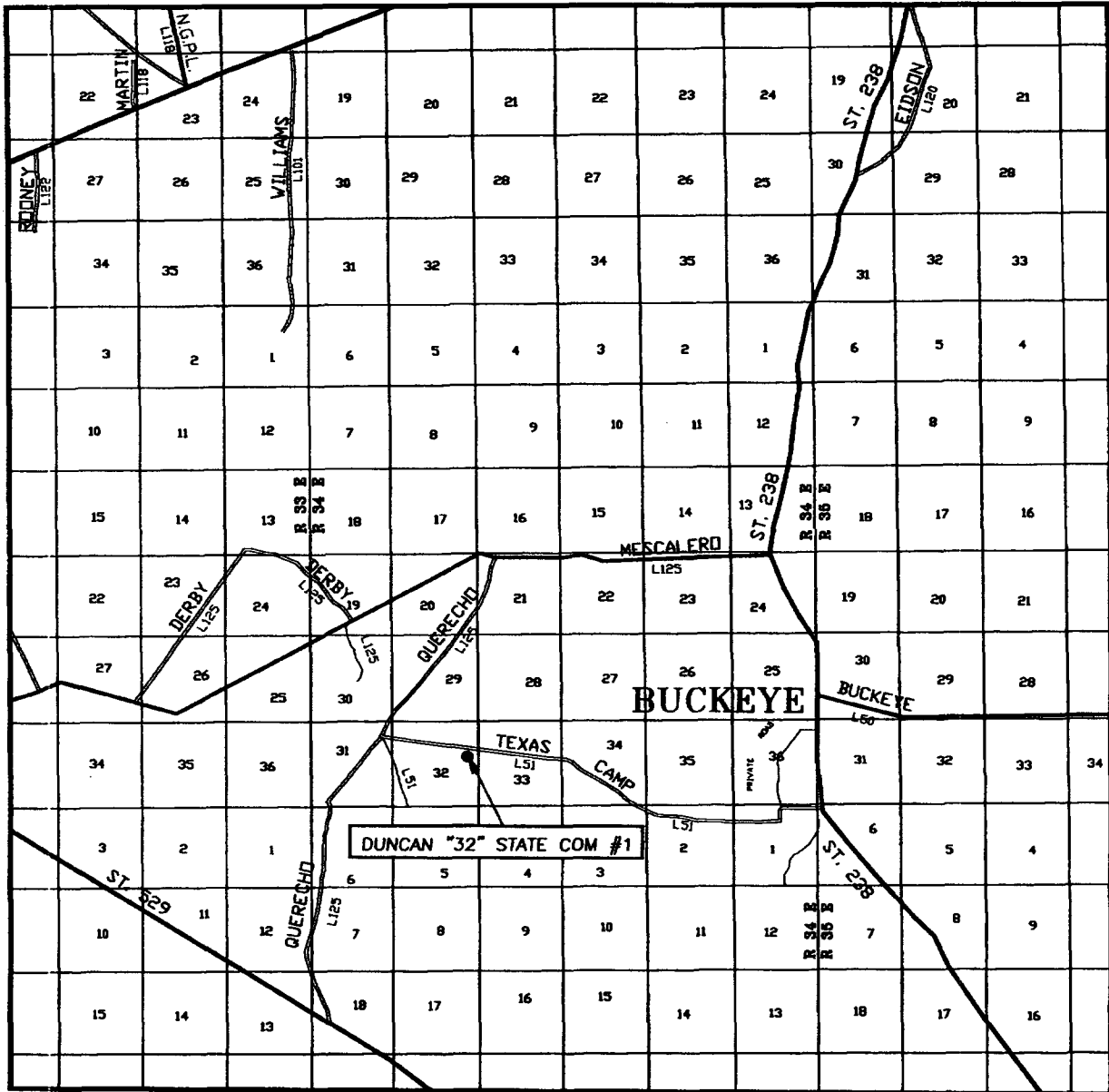

SCALE: 1" = 2 MILES

SEC. 32 TWP. 17-S RGE. 34-E
 SURVEY N.M.P.M.
 COUNTY LEA
 DESCRIPTION 2245' FNL & 660' FEL
 ELEVATION 4068'
 OPERATOR PATTERSON
PETROLEUM, L.P.
 LEASE DUNCAN "32" STATE COM

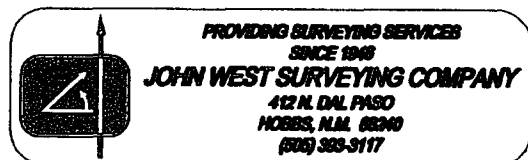

LOCATION VERIFICATION MAP

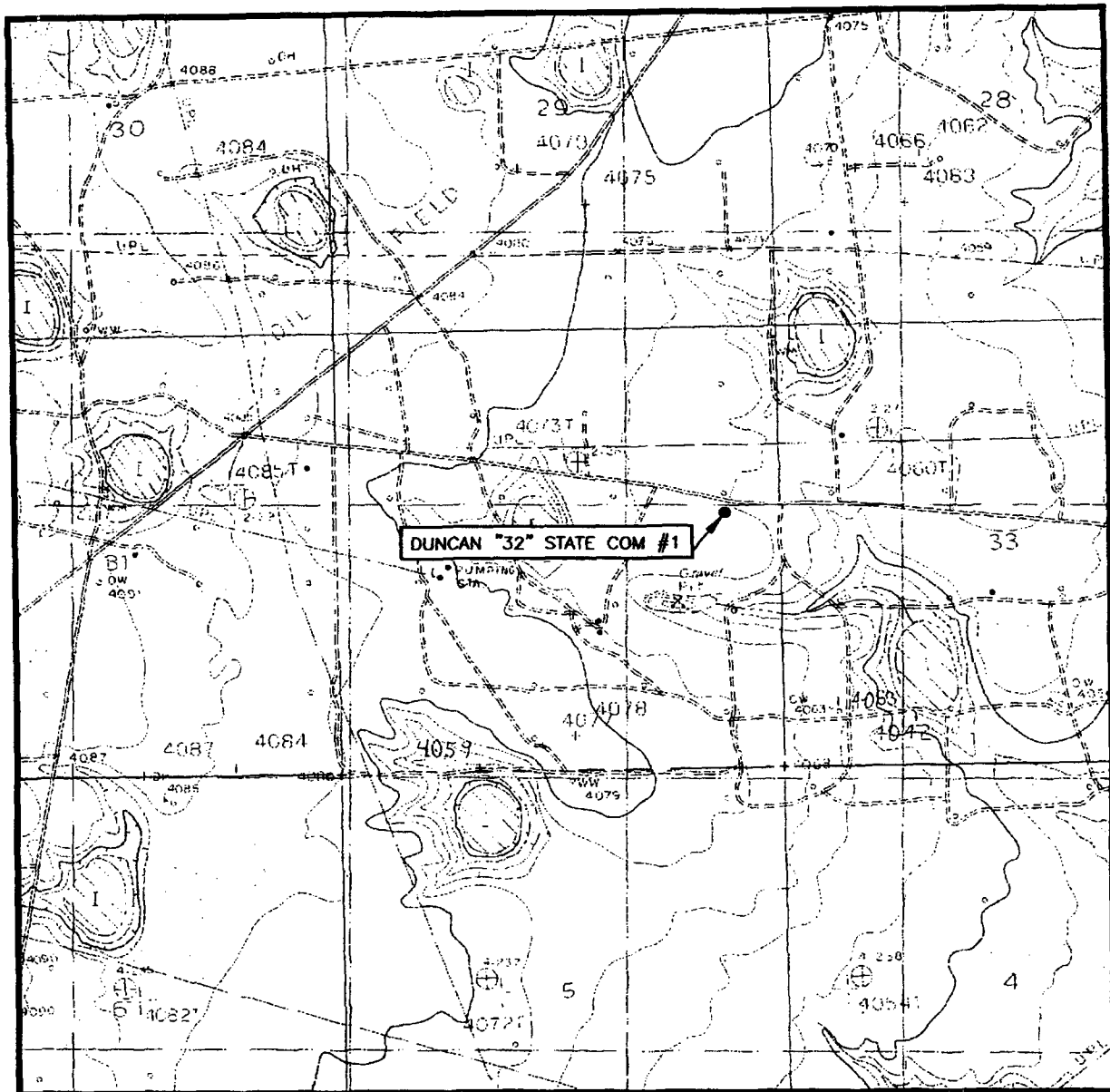

SCALE: 1" = 2000'

CONTOUR INTERVAL:
BUCKEYE, N.M. - 5'

SEC. 32 TWP. 17-S RGE. 34-E

SURVEY N.M.P.M.

COUNTY LEA

DESCRIPTION 2245' FNL & 660' FEL

ELEVATION 4068'

OPERATOR PATTERSON
PETROLEUM, L.P.

LEASE DUNCAN "32" STATE COM

U.S.G.S. TOPOGRAPHIC MAP
BUCKEYE, N.M.

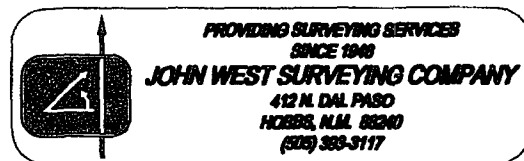

COUNTY *Lea*POOL *East Corbin - Wolfcamp*

(13310)

TOWNSHIP *17 South*RANGE *34 East*

NMFM

| | | | | | |
|----|----|----|----|----|----|
| 6 | 5 | 4 | 3 | 2 | 1 |
| 7 | 8 | 9 | 10 | 11 | 12 |
| 18 | 17 | 16 | 15 | 14 | 13 |
| 19 | 20 | 21 | 22 | 23 | 24 |
| 30 | 29 | 28 | 27 | 26 | 25 |
| 31 | 32 | 33 | 34 | 35 | 36 |

Description: $\frac{SE}{4}$ Sec. 30 (R-4041, 11-1-70)

COUNTY LeePOOL North Vacuum - Abo

(61760)

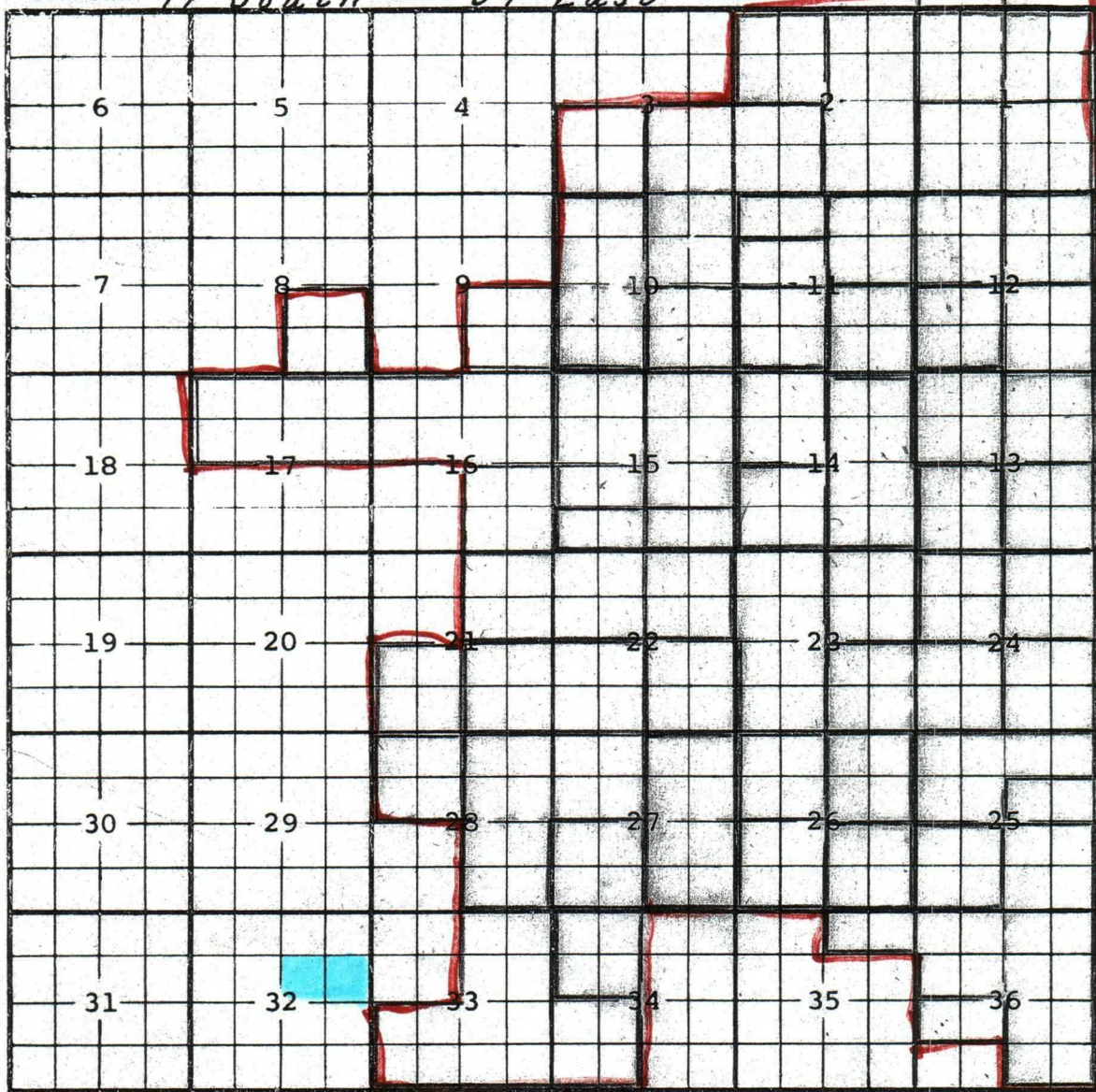
TOWNSHIP 17-South RANGE 34-East NMPM

Description: $\frac{SE}{4}$ Sec. 26 (R-2421, 2-13-63).

Ext: $\frac{SW}{4}$ Sec. 25; $\frac{NE}{4}$ Sec. 26 (R-2527, 8-1-63) - $\frac{SE}{4}$ Sec. 25; $\frac{N}{2}$ $\frac{NE}{4}$ Sec. 35;
 $\frac{NW}{4}$ $\frac{E}{2}$ $\frac{F}{2}$ Sec. 36 (R-2569, 10-1-63) - $\frac{S}{2}$ $\frac{NE}{4}$ Sec. 25; $\frac{N}{2}$ $\frac{SW}{4}$ Sec. 36 (R-2771, 10-1-64)
 - $\frac{N}{2}$ $\frac{NE}{4}$ $\frac{NW}{4}$ Sec. 25 (R-2985, 11-1-65) - $\frac{SE}{4}$ Sec. 23; $\frac{SW}{4}$ Sec. 24 (R-3182, 2-1-67)
 - $\frac{NW}{4}$ Sec. 24 (R-3280, 8-1-67) - $\frac{SW}{4}$ Sec. 13; $\frac{NE}{4}$ Sec. 24 (R-3329, 11-1-67) - $\frac{SE}{4}$ Sec. 13;
 $\frac{E}{2}$ Sec. 14 (R-3411, 6-1-68) - $\frac{SE}{4}$ Sec. 11 (R-3530, 11-1-68) - $\frac{NE}{4}$ Sec. 23; $\frac{SE}{4}$ Sec. 24 (R-3681, 3-1-69)
 - $\frac{NE}{4}$ Sec. 11; $\frac{SW}{4}$ Sec. 12; $\frac{NW}{4}$ Sec. 26 (R-3979, 7-1-70) - $\frac{SW}{4}$ Sec. 11; $\frac{SW}{4}$ Sec. 14;
 $\frac{SW}{4}$ Sec. 26 (R-4032, 10-1-70) - $\frac{NW}{4}$ Sec. 14; $\frac{S}{2}$ $\frac{SE}{4}$ Sec. 15; $\frac{E}{2}$ Sec. 27 (R-4063, 12-1-70)
 - $\frac{NW}{4}$ Sec. 3 (R-4086, 2-1-71) - $\frac{SE}{4}$ Sec. 10; $\frac{S}{2}$ $\frac{NW}{4}$ Sec. 11; $\frac{NW}{4}$ Sec. 12;
 $\frac{NE}{4}$ Sec. 22 (R-4132, 5-1-71) - $\frac{N}{2}$ $\frac{NW}{4}$ Sec. 11; $\frac{SE}{4}$ Sec. 12; $\frac{NE}{4}$ Sec. 13; $\frac{S}{2}$ $\frac{SW}{4}$ Sec. 15;
 $\frac{W}{2}$ Sec. 23 (R-4155, 7-1-71) - $\frac{NE}{4}$ Sec. 12; $\frac{SE}{4}$ Sec. 22 (R-4184, 9-1-71) - $\frac{SW}{4}$ Sec. 2; $\frac{SE}{4}$ Sec. 3;
 $\frac{NE}{4}$ Sec. 10 (R-4194, 10-1-71) - $\frac{NE}{4}$ $\frac{S}{2}$ $\frac{SE}{4}$ Sec. 15; $\frac{NW}{4}$ Sec. 27; $\frac{E}{2}$ Sec. 28 (R-4219, 12-1-71)
 $\frac{SW}{4}$ Sec. 1; $\frac{W}{2}$ Sec. 10; $\frac{NE}{4}$ Sec. 21; $\frac{NW}{4}$ Sec. 22; $\frac{SW}{4}$ Sec. 27 (R-4279, 4-1-72) - $\frac{SE}{4}$ Sec. 21;
 $\frac{SW}{4}$ Sec. 22; $\frac{NW}{4}$ Sec. 28; $\frac{NW}{4}$ Sec. 34 (R-4304, 6-1-72)

Continued Next Page

BEFORE THE OIL CONSERVATION COMMISSION
OF THE STATE OF NEW MEXICO

IN THE MATTER OF THE HEARING
CALLED BY THE OIL CONSERVATION
COMMISSION OF NEW MEXICO FOR
THE PURPOSE OF CONSIDERING:

CASE No. 2739
Order No. R-2421
NOMENCLATURE

APPLICATION OF SOCONY MOBIL OIL
COMPANY, INC., TO CREATE A NEW
POOL FOR ABO PRODUCTION AND FOR
SPECIAL POOL RULES, LEA COUNTY,
NEW MEXICO.

ORDER OF THE COMMISSION

BY THE COMMISSION:

This cause came on for hearing at 9 o'clock a.m. on January 23, 1963, at Santa Fe, New Mexico, before Elvis A. Utz, Examiner duly appointed by the Oil Conservation Commission of New Mexico, hereinafter referred to as the "Commission," in accordance with Rule 1214 of the Commission Rules and Regulations.

NOW, on this 13th day of February, 1963, the Commission, a quorum being present, having considered the application, the evidence adduced, and the recommendations of the Examiner, Elvis A. Utz, and being fully advised in the premises,

FINDS:

(1) That due public notice having been given as required by law, the Commission has jurisdiction of this cause and the subject matter thereof.

(2) That the applicant, Socony Mobil Oil Company, Inc., seeks the creation of a new pool for Abo production and the promulgation of temporary special rules and regulations governing said pool, including a provision for 80-acre spacing units.

(3) That a new oil pool for Abo production should be created and designated the North Vacuum-Abo Oil Pool. This pool was discovered by the Socony Mobil State Bridges Well No. 95, located in Unit P of Section 26, Township 17 South, Range 34 East, NMPM, Lea County, New Mexico. The top of the perforations in the Abo formation is at 9070 feet.

(4) That temporary special rules and regulations establishing 80-acre spacing should be promulgated for the subject pool in order to prevent the possibility of economic loss resulting from the drilling of unnecessary wells and in order to allow the operators in the subject pool to gather information concerning the reservoir characteristics of the pool.

(5) That the temporary special rules and regulations should provide for limited well locations in order to assure orderly development of the pool and protect correlative rights.

(6) That the temporary special rules and regulations should be established for a one-year period and that during this one-year period all operators in the subject pool should gather all available information relative to drainage and recoverable reserves.

(7) That this case should be reopened at an examiner hearing in February, 1964, at which time the operators in the subject pool should appear and show cause why the North Vacuum-Abo Oil Pool should not be developed on 40-acre proration units.

IT IS THEREFORE ORDERED:

(1) That a new pool in Lea County, New Mexico, classified as an oil pool for Abo production is hereby created and designated the North Vacuum-Abo Oil Pool, consisting of the following-described area:

TOWNSHIP 17 SOUTH, RANGE 34 EAST, NMPM
Section 26: SE/4

(2) That special rules and regulations for the North Vacuum-Abo Oil Pool are hereby promulgated as follows, effective March 1, 1963.

SPECIAL RULES AND REGULATIONS
FOR THE
NORTH VACUUM-ABO OIL POOL

RULE 1. Each well completed or recompleted in the North Vacuum-Abo Oil Pool or in the Abo formation within one mile of the North Vacuum-Abo Oil Pool, and not nearer to or within the limits of another designated Abo pool, shall be spaced, drilled, operated, and produced in accordance with the Special Rules and Regulations hereinafter set forth.

RULE 2. Each well completed or recompleted in the North Vacuum-Abo Oil Pool shall be located on a standard unit containing 80 acres, more or less, consisting of the N/2, S/2, E/2, or W/2 of a single governmental quarter section; provided, however, that nothing contained herein shall be construed as prohibiting the drilling of a well on each of the quarter-quarter sections in the unit.

RULE 3. The Secretary-Director may grant an exception to the requirements of Rule 2 without notice and hearing when an application has been filed for a non-standard unit comprising

a single quarter-quarter section or lot. All operators offsetting the proposed non-standard unit shall be notified of the application by registered or certified mail, and the application shall state that such notice has been furnished. The Secretary-Director may approve the application upon receipt of written waivers from all offset operators or if no offset operator has entered an objection to the formation of the non-standard unit within 30 days after the Secretary-Director has received the application.

RULE 4. The first well drilled on every standard or non-standard unit in the North Vacuum-Abo Oil Pool shall be located within 200 feet of the center of either the NW/4 or the SE/4 of a governmental quarter section.

RULE 5. The Secretary-Director may grant an exception to the requirements of Rule 4 without notice and hearing when an application has been filed for an unorthodox location necessitated by topographical conditions or the recompletion of a well previously drilled to another horizon. All operators offsetting the proposed unorthodox location shall be notified of the application by registered or certified mail, and the application shall state that such notice has been furnished. The Secretary-Director may approve the application upon receipt of written waivers from all offset operators or if no offset operator has entered an objection to the unorthodox location within 20 days after the Secretary-Director has received the application.

RULE 6. A standard proration unit (79 through 81 acres) in the North Vacuum-Abo Oil Pool shall be assigned an 80-acre proportional factor of 4.77 for allowable purposes, and in the event there is more than one well on an 80-acre proration unit, the operator may produce the allowable assigned to the unit from the wells on the unit in any proportion.

The allowable assigned to a non-standard proration unit shall bear the same ratio to a standard allowable in the North Vacuum-Abo Oil Pool as the acreage in such non-standard unit bears to 80 acres.

IT IS FURTHER ORDERED:

(1) That any well presently drilling to or completed in the Abo formation within the North Vacuum-Abo Oil Pool or within one mile of the North Vacuum-Abo Oil Pool that will not comply with the well location requirements of Rule 4 is hereby granted an exception to the requirements of Rule 4. The operator shall notify the Hobbs District Office in writing of the name and location of the well on or before March 1, 1963.

(2) That any operator desiring to dedicate 80 acres to a well presently drilling or completed in the North Vacuum-Abo Oil

-4-

CASE No. 2739
Order No. R-2421

Pool shall file a new Form C-128 with the Commission on or before March 1, 1963.

(3) That this case shall be reopened at an examiner hearing in February, 1964, at which time the operators in the subject pool may appear and show cause why the North Vacuum-Abo Oil Pool should not be developed on 40-acre proration units.

(4) That jurisdiction of this cause is retained for the entry of such further orders as the Commission may deem necessary.

DONE at Santa Fe, New Mexico, on the day and year hereinabove designated.

STATE OF NEW MEXICO
OIL CONSERVATION COMMISSION

JACK M. CAMPBELL, Chairman

E. S. WALKER, Member

A. L. PORTER, Jr., Member & Secretary

S E A L

esr/

BEFORE THE OIL CONSERVATION COMMISSION
OF THE STATE OF NEW MEXICO

IN THE MATTER OF THE HEARING
CALLED BY THE OIL CONSERVATION
COMMISSION OF NEW MEXICO FOR
THE PURPOSE OF CONSIDERING:

CASE No. 2739
Order No. R-2421-A

APPLICATION OF SOCONY MOBIL OIL
COMPANY, INC., TO CREATE A NEW
POOL FOR ABO PRODUCTION AND FOR
SPECIAL POOL RULES, LEA COUNTY,
NEW MEXICO.

ORDER OF THE COMMISSION

BY THE COMMISSION:

This cause came on for hearing at 9 o'clock a.m. on February 19, 1964, at Santa Fe, New Mexico, before Examiner Elvis A. Utz.

NOW, on this 13th day of March, 1964, the Commission, a quorum being present, having considered the testimony, the record, and the recommendations of the Examiner, and being fully advised in the premises,

FINDS:

(1) That due public notice having been given as required by law, the Commission has jurisdiction of this cause and the subject matter thereof.

(2) That by Order No. R-2421 dated February 13, 1963, temporary Special Rules and Regulations were promulgated for the North Vacuum-Abo Oil Pool.

(3) That pursuant to the provisions of Order No. R-2421, this case was reopened to allow the operators in the subject pool to appear and show cause why the North Vacuum-Abo Oil Pool should not be developed on 40-acre proration units.

(4) That the evidence establishes that one well in the North Vacuum-Abo Oil Pool can efficiently and economically drain and develop 80 acres.

(5) That to prevent the economic loss caused by the drilling of unnecessary wells, to avoid the augmentation of risk arising from the drilling of an excessive number of wells, to prevent reduced recovery which might result from the drilling of

too few wells, and to otherwise prevent waste and protect correlative rights, the Special Rules and Regulations promulgated by Order No. R-2421 should be continued in full force and effect until further order of the Commission.

(6) That the Special Rules and Regulations promulgated by Order No. R-2421 have afforded and will afford to the owner of each property in the pool the opportunity to produce his just and equitable share of the oil in the pool.

IT IS THEREFORE ORDERED:

(1) That the Special Rules and Regulations governing the North Vacuum-Abo Oil Pool promulgated by Order No. R-2421 are hereby continued in full force and effect until further order of the Commission.

(2) That jurisdiction of this cause is retained for the entry of such further orders as the Commission may deem necessary.

DONE at Santa Fe, New Mexico, on the day and year hereinabove designated.

STATE OF NEW MEXICO
OIL CONSERVATION COMMISSION

JACK M. CAMPBELL, Chairman

E. S. WALKER, Member

A. L. PORTER, Jr., Member & Secretary

S E A L

esr/

County Lea

Pool West Vacuum-Atoka Gas

97326

TOWNSHIP 17 South

Range 34 East

NMPM

| | | | | | |
|----|----|----|----|----|----|
| 6 | 5 | 4 | 3 | 2 | 1 |
| 7 | 8 | 9 | 10 | 11 | 12 |
| 18 | 17 | 16 | 15 | 14 | 13 |
| 19 | 20 | 21 | 22 | 23 | 24 |
| 30 | 29 | 28 | 27 | 26 | 25 |
| 31 | 32 | 33 | 34 | 35 | 36 |

Description: SW 1/4 Sec. 8 (R-12141, 5-10-04)

COUNTY LeaPOOL Vacuum-Morrow Gas (86840)TOWNSHIP 17 SouthRANGE 34 East

NMPM

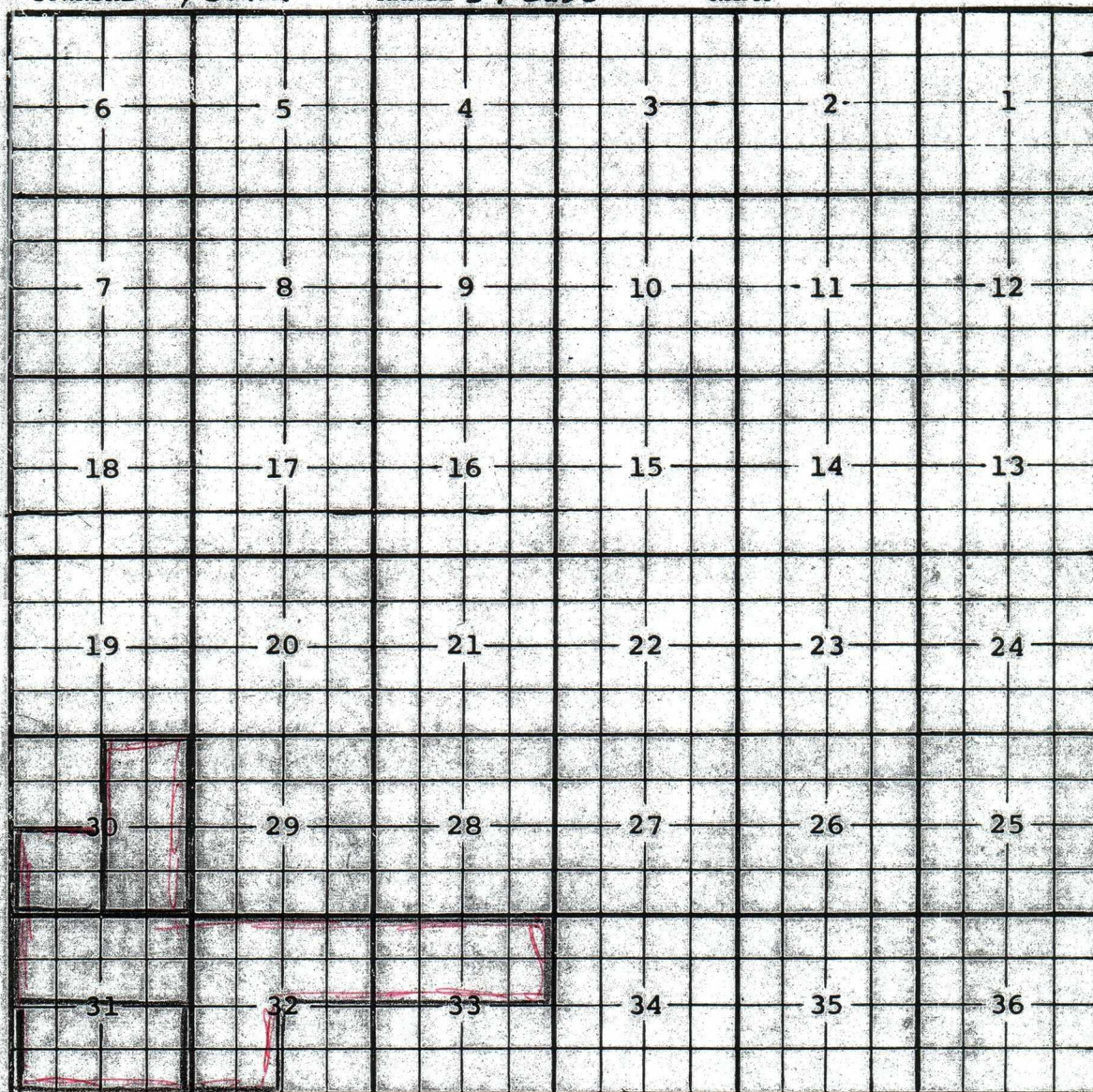
Description: $\frac{1}{2}$ Sec. 30 (R-3662, 2-1-69)Ext. $\frac{1}{4}$ Sec. 30 (R-11475, 10-24-00) Ext. $\frac{1}{4}$ Sec. 31 (R-11662, 10-12-01)Ext. $\frac{1}{2}$ Sec. 31 (R-12046, 11-3-03) Ext. $\frac{1}{2}$ and $\frac{1}{4}$ Sec. 32, $\frac{1}{2}$ Sec. 33 (R-12141, 5-10-04)