

Sec : 35 Twp : 28N Rng : 09W Section Type : NORMAL

D 40.00 Federal owned	C 40.00 Federal owned	B 40.00 Federal owned	A 40.00 Federal owned
E 40.00 Federal owned	F 40.00 Federal owned	G 40.00 Federal owned	H 40.00 Federal owned
A 40.00 Federal owned	K 40.00 Federal owned	J 40.00 Federal owned	I 40.00 Federal owned
1 42.26 Federal owned	2 41.39 Federal owned	3 40.51 Federal owned	4 39.64 Federal owned
A Federal owned	A Federal owned	A A Federal owned	A Federal owned

UNITED STATES
DEPARTMENT OF THE INTERIOR
BUREAU OF LAND MANAGEMENT

FORM APPROVED
OMB NO. 1004-0135
Expires: November 30, 2000

SUNDRY NOTICES AND REPORTS ON WELLS
Do not use this form for proposals to drill or to re-enter an abandoned well. Use form 3160-3 (APD) for such proposals.

SUBMIT IN TRIPLICATE - Other Instructions on reverse side.

1. Type of Well <input type="checkbox"/> Oil Well <input checked="" type="checkbox"/> Gas Well <input type="checkbox"/> Other		5. Lease Serial No. NMNM - 077111
2. Name of Operator BP AMERICA PRODUCTION COMPANY		6. If Indian, Allottee or Tribe Name
Contact: MARY CORLEY E-Mail: corleym@bp.com		7. If Unit or CA/Agreement, Name and/or No.
3a. Address P.O. BOX 3092 HOUSTON, TX 77253	3b. Phone No. (include area code) Ph: 281.366.4491 Fx: 281.366.0700	8. Well Name and No. STOREY C L S 5
4. Location of Well (Footage, Sec., T., R., M., or Survey Description) Sec 35 T28N R9W SWNW 1973FNL 402FWL		9. API Well No. 30-045-07018
		10. Field and Pool, or Exploratory BLANCO PICTURED CLIFFS SOUTH
		11. County or Parish, and State SAN JUAN COUNTY, NM

12. CHECK APPROPRIATE BOX(ES) TO INDICATE NATURE OF NOTICE, REPORT, OR OTHER DATA

TYPE OF SUBMISSION	TYPE OF ACTION			
<input checked="" type="checkbox"/> Notice of Intent	<input type="checkbox"/> Acidize	<input type="checkbox"/> Deepen	<input type="checkbox"/> Production (Start/Resume)	<input type="checkbox"/> Water Shut-Off
<input type="checkbox"/> Subsequent Report	<input type="checkbox"/> Alter Casing	<input type="checkbox"/> Fracture Treat	<input type="checkbox"/> Reclamation	<input type="checkbox"/> Well Integrity
<input type="checkbox"/> Final Abandonment Notice	<input type="checkbox"/> Casing Repair	<input type="checkbox"/> New Construction	<input type="checkbox"/> Recomplete	<input type="checkbox"/> Other
	<input type="checkbox"/> Change Plans	<input checked="" type="checkbox"/> Plug and Abandon	<input type="checkbox"/> Temporarily Abandon	
	<input type="checkbox"/> Convert to Injection	<input type="checkbox"/> Plug Back	<input type="checkbox"/> Water Disposal	

13. Describe Proposed or Completed Operation (clearly state all pertinent details, including estimated starting date of any proposed work and approximate duration thereof. If the proposal is to deepen directionally or recompleat horizontally, give subsurface locations and measured and true vertical depths of all pertinent markers and zones. Attach the Bond under which the work will be performed or provide the Bond No. on file with BLM/BIA. Required subsequent reports shall be filed within 30 days following completion of the involved operations. If the operation results in a multiple completion or recompleat in a new interval, a Form 3160-4 shall be filed once testing has been completed. Final Abandonment Notices shall be filed only after all requirements, including reclamation, have been completed, and the operator has determined that the site is ready for final inspection.)

BP America request permission to plug and abandon the subject well as per the attached procedure.



14. I hereby certify that the foregoing is true and correct. Electronic Submission #31888 verified by the BLM Well Information System For BP AMERICA PRODUCTION COMPANY, sent to the Farmington	
Name (Printed/Typed) MARY CORLEY	Title AUTHORIZED REPRESENTATIVE
Signature (Electronic Submission)	Date 06/14/2004

THIS SPACE FOR FEDERAL OR STATE OFFICE USE

Approved By	Title	Date JUN 29 2004
Conditions of approval, if any, are attached. Approval of this notice does not warrant or certify that the applicant holds legal or equitable title to those rights in the subject lease which would entitle the applicant to conduct operations thereon.		Office

Title 18 U.S.C. Section 1001 and Title 43 U.S.C. Section 1212, make it a crime for any person knowingly and willfully to make to any department or agency of the United States any false, fictitious or fraudulent statements or representations as to any matter within its jurisdiction.

**** OPERATOR-SUBMITTED ** OPERATOR-SUBMITTED ** OPERATOR-SUBMITTED ****

NMOCD

Storey C LS 5
Plug and Abandonment Procedure

Procedure:

1. Hold safety meeting and perform JSA.
2. Contact BLM and NMOCD 24 hrs prior to beginning operations.
3. Check and record tubing, casing, and bradenhead pressures.
4. Nipple down WH. NU BOPs and diversion spool with 3" outlets and 3" pipe to the blow tank. Pressure test BOPs to 500 psi. Monitor flowing casing pressure with gauge (with casing flowing to blow tank) throughout workover.
5. TOH with 1-1/4" production tubing currently set at 2975'.
6. PU 2-3/8 workstring and strip cement plug from PBTD to 2,020'.
7. RU wireline unit. Perforate squeeze holes at +/-2000
8. Set cement retainer at 1,500'. Sting into retainer and establish circulation up annulus. Pump cement to fill from retainer to 1500' on annulus.
9. Perforate squeeze holes at ~~800'~~⁸⁷⁵. Establish circulation down casing and up annulus. Spot balance plug from ~~800'~~⁸⁷⁵ to surface on inside and outside of casing.
10. Install 4' cement well marker and identification plate per NMOCD requirements.
11. Restore location.

Storey C LS 5

Sec 35, T28N, R9W

API: 30-045-07018

6798' GL

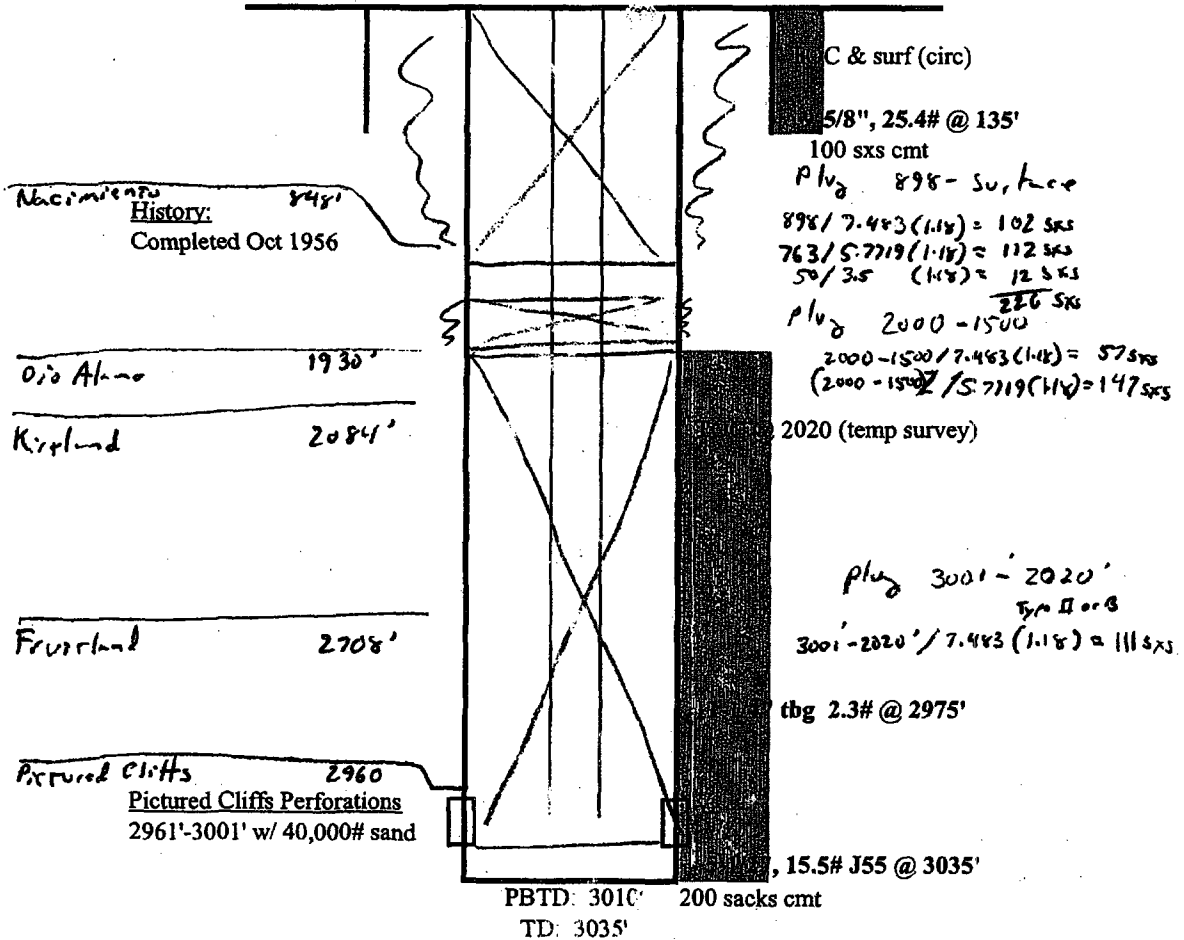

updated: 6/11/04 CFR

UNITED STATES
DEPARTMENT OF THE INTERIOR
BUREAU OF LAND MANAGEMENTFORM APPROVED
OMB NO. 1004-0135
Expires: November 30, 2000**SUNDRY NOTICES AND REPORTS ON WELLS**
*Do not use this form for proposals to drill or to re-enter an abandoned well. Use form 3160-3 (APD) for such proposals.*5. Lease Serial No.
NMSF077111

6. If Indian, Allottee or Tribe Name

7. If Unit or CA/Agreement, Name and/or No.

SUBMIT IN TRIPLICATE - Other instructions on reverse side.8. Well Name and No.
STOREY C LS 59. API Well No.
30-045-07018-00-S110. Field and Pool, or Exploratory
BLANCO P.C. SOUTH11. County or Parish, and State
SAN JUAN COUNTY, NM

1. Type of Well

☐ Oil Well ☒ Gas Well ☐ Other2. Name of Operator
BP AMERICA PRODUCTION COContact: MARY CORLEY
E-Mail: corleyml@bp.com3a. Address
P. O. BOX 3092
HOUSTON, TX 772533b. Phone No. (include area code)
Ph: 281.366.4491
Fx: 281.366.0700

4. Location of Well (Footage, Sec., T., R., M., or Survey Description)

Sec 35 T28N R9W SWNW 1973FNL 0402FWL
36.62036 N Lat, 107.76508 W Lon**12. CHECK APPROPRIATE BOX(ES) TO INDICATE NATURE OF NOTICE, REPORT, OR OTHER DATA**

TYPE OF SUBMISSION	TYPE OF ACTION			
<input checked="" type="checkbox"/> Notice of Intent	<input type="checkbox"/> Acidize	<input type="checkbox"/> Deepen	<input type="checkbox"/> Production (Start/Resume)	<input type="checkbox"/> Water Shut-Off
<input type="checkbox"/> Subsequent Report	<input type="checkbox"/> Alter Casing	<input type="checkbox"/> Fracture Treat	<input type="checkbox"/> Reclamation	<input type="checkbox"/> Well Integrity
<input type="checkbox"/> Final Abandonment Notice	<input type="checkbox"/> Casing Repair	<input type="checkbox"/> New Construction	<input type="checkbox"/> Recomplete	<input checked="" type="checkbox"/> Other Well Test
	<input type="checkbox"/> Change Plans	<input type="checkbox"/> Plug and Abandon	<input type="checkbox"/> Temporarily Abandon	
	<input type="checkbox"/> Convert to Injection	<input type="checkbox"/> Plug Back	<input type="checkbox"/> Water Disposal	

13. Describe Proposed or Completed Operation (clearly state all pertinent details, including estimated starting date of any proposed work and approximate duration thereof. If the proposal is to deepen directionally or recompleat horizontally, give subsurface locations and measured and true vertical depths of all pertinent markers and zones. Attach the Bond under which the work will be performed or provide the Bond No. on file with BLM/BLA. Required subsequent reports shall be filed within 30 days following completion of the involved operations. If the operation results in a multiple completion or recompleat in a new interval, a Form 3160-4 shall be filed once testing has been completed. Final Abandonment Notices shall be filed only after all requirements, including reclamation, have been completed, and the operator has determined that the site is ready for final inspection.)

Please reference BLM letter of March 04, 2004. 1-1/2" tubing prevents slick line work, however, we anticipate conduction a 3 day flow test scheduled within the next 30 days. Based on the three day test, we will determine if it is worth putting the well on compression. Pending the results of these tests, a further plan of action will be determined.

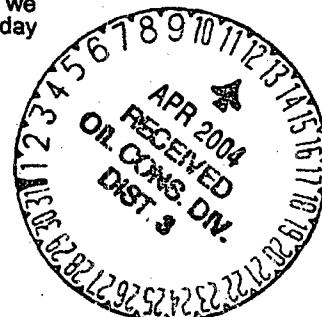

14. I hereby certify that the foregoing is true and correct.

Electronic Submission #29389 verified by the BLM Well Information System
For BP AMERICA PRODUCTION CO, sent to the Farmington
Committed to AFMSS for processing by STEVE MASON on 04/08/2004 (04SXM1456SE)

Name (Printed/Typed) MARY CORLEY

Title AUTHORIZED REPRESENTATIVE

Signature (Electronic Submission)

Date 04/07/2004

THIS SPACE FOR FEDERAL OR STATE OFFICE USE

Approved By STEPHEN MASON

Title PETROLEUM ENGINEER

Date 04/08/2004

Conditions of approval, if any, are attached. Approval of this notice does not warrant or certify that the applicant holds legal or equitable title to those rights in the subject lease which would entitle the applicant to conduct operations thereon.

Office Farmington

Title 18 U.S.C. Section 1001 and Title 43 U.S.C. Section 1212, make it a crime for any person knowingly and willfully to make to any department or agency of the United States any false, fictitious or fraudulent statements or representations as to any matter within its jurisdiction.

**** BLM REVISED ** BLM REVISED ** BLM REVISED ** BLM REVISED ** BLM REVISED ******NMOCD**

District I
1625 N. French Dr., Hobbs, NM 88240
District II
1301 W. Grand Avenue, Artesia, NM 88210
District III
1000 Rio Brazos Road, Aztec, NM 87410
District IV
1220 S. St. Francis Dr., Santa Fe, NM 87505

State of New Mexico
Energy Minerals and Natural Resources

Form C-104B
March 19, 2001

Oil Conservation Division
1220 South St. Francis Dr.
Santa Fe, NM 87505

Submit 1 copy of the final affected
wells list along with 1 copy of this form
per number of wells on that list to
appropriate District Office

Change of Operator Name

OGRID: 000778
Effective Date: 12/31/2001

Previous Operator Name and Information:

Name: Amoco Production Company
Address: P.O. Box 3092
Address: _____
City, State, Zip: Houston, Texas 77253

New Operator Name and Information:

New Name: BP America Production Company
Address: P.O. Box 3092
Address: _____
City, State, Zip: Houston, Texas 77253

I hereby certify that the rules of the Oil Conservation Division have been complied with and that the information given on this form and the attached list of wells is true and complete to the best of my knowledge and belief.

Signature: Mary Corley

Printed name: Mary Corley

Title: Senior Regulatory Specialist

Date: 12/10/2001 Phone: 281-366-4491



NMOCD Approval	
Signature:	<u>278</u>
Printed Name:	<u>SUPERVISOR DISTRICT #3</u>
District:	<u>JAN 22 2002</u>
Date:	

OIL CONSERVATION DIVISION

Santa Fe, New Mexico 87504-1088

REQUEST FOR ALLOWABLE AND AUTHORIZATION
TO TRANSPORT OIL AND NATURAL GAS

Operator AMOCO PRODUCTION COMPANY		Well APN No. 3004507018
Address P.O. BOX 800, DENVER, COLORADO 80201		
Reason(s) for Filing (Check proper box) <input type="checkbox"/> (Other (Please explain))		
New Well <input type="checkbox"/>	Change in Transporter of: Oil <input type="checkbox"/> Dry Gas <input type="checkbox"/>	
Recompletion <input type="checkbox"/>	Casinghead Gas <input type="checkbox"/> Condensate <input checked="" type="checkbox"/>	
Change in Operator <input type="checkbox"/>		
If change of operator give name and address of previous operator		

II. DESCRIPTION OF WELL AND LEASE

Lease Name STOREY C LS	Well No. 5	Pool Name, including Formations BLANCO SOUTH (PICT CLIFFS)	Kind of Lease FEDERAL	Lease No. SF077111
Location Unit Letter E : 1973 Foot From The FNL Line and 402 Foot From The FWL Line Section 35 Township 28N Range 9W 14MPM SAN JUAN County				

III. DESIGNATION OF TRANSPORTER OF OIL AND NATURAL GAS

Name of Authorized Transporter of Oil MERIDIAN OIL INC.	<input type="checkbox"/> or Condensate <input type="checkbox"/>	Address (Give address to which approved copy of this form is to be sent) 3535 EAST 30TH STREET, FARMINGTON, NM 87401				
Name of Authorized Transporter of Casinghead Gas EL PASO NATURAL GAS COMPANY	<input type="checkbox"/> or Dry Gas <input type="checkbox"/>	Address (Give address to which approved copy of this form is to be sent) P.O. BOX 1492, EL PASO, TX 79978				
If well produces oil or liquids, give location of tanks.	Unit	Soc.	Twp.	Rge.	Is gas actually connected?	When?

If this production is commingled with that from any other lease or pool, give commingling order number.

IV. COMPLETION DATA

Designate Type of Completion - (X)	Oil Well	Gas Well	New Well	Workover	Deepen	Plug Back	Same Res'v	Diff Res'v
Date Spudded	Date Compl. Ready to Prod.		Total Depth		P.B.T.D.			
Elevations (DF, RKB, RT, GR, etc.)	Name of Producing Formation		Top Oil/Gas Pay		Tubing Depth			
Perforations					Depth Casing Shoe			
TUBING, CASING AND CEMENTING RECORD								
HOLE SIZE	CASING & TUBING SIZE		DEPTH SET		SACKS CEMENT			

V. TEST DATA AND REQUEST FOR ALLOWABLE

OIL WELL (Test must be after recovery of total volume of load oil and must be equal to or exceed top allowable for this depth or be for full 24 hours.)			
Date First New Oil Run To Tank	Date of Test	Producing Method (Flow, pump, gas lift, etc.)	
Length of Test	Tubing Pressure	Casing Pressure	Choke Size
Actual Prod. During Test	Oil - bbls.	Water - bbls.	Gas - MCF
FEB 25 1991			
OIL CON. DIV.			
GAS WELL			
Actual Prod. Test - MCF/D	Length of Test	Bbls. Condensate/MCF	Gravity of Condensate
Testing Method (pilot, back pr.)	Tubing Pressure (Shut-in)	Casing Pressure (Shut-in)	Choke Size

VI. OPERATOR CERTIFICATE OF COMPLIANCE

I hereby certify that the rules and regulations of the Oil Conservation Division have been complied with and that the information given above is true and complete to the best of my knowledge and belief.

[Signature]

Signature
Doug W. Whaley, Staff Admin. Supervisor

Printed Name
February 8, 1991

Date
303-830-4280

Telephone No.

OIL CONSERVATION DIVISION

Date Approved **FEB 25 1991**

By *[Signature]*

Title **SUPERVISOR DISTRICT #3**

INSTRUCTIONS: This form is to be filed in compliance with Rule 1104

- 1) Request for allowable for newly drilled or deepened well must be accompanied by tabulation of deviation tests taken in accordance with Rule 111.
- 2) All sections of this form must be filled out for allowable on new and recompleted wells.
- 3) Fill out only Sections I, II, III, and VI for changes of operator, well name or number, transporter, or other such changes.
- 4) Separate Form C-104 must be filed for each pool in multiply completed wells.

Submit 5 Copies
Appropriate District Office
DISTRICT I
P.O. Box 1980, Hobbs, NM 88240

DISTRICT II
P.O. Drawer DD, Artesia, NM 88210

DISTRICT III
1000 Rio Brazos Rd., Aztec, NM 87410

State of New Mexico
Energy, Minerals and Natural Resources Department

OIL CONSERVATION DIVISION

P.O. Box 7088
Santa Fe, New Mexico 87501-2088

Form C-104
Revised 1-1-89
See Instructions
at Bottom of Page

REQUEST FOR ALLOWABLE AND AUTHORIZATION TO TRANSPORT OIL AND NATURAL GAS

Operator Amoco Production Company		Well API No. 3004507018
Address 1670 Broadway, P. O. Box 800, Denver, Colorado 80201		
Reason(s) for filing (Check proper box) <input type="checkbox"/> Other (Please explain)		
New Well <input type="checkbox"/>	Change in Transporter of: <input type="checkbox"/> Oil <input type="checkbox"/> Dry Gas <input type="checkbox"/>	
Recompletion <input type="checkbox"/>	Casinghead Gas <input type="checkbox"/> Condensate <input type="checkbox"/>	
Change in Operator <input checked="" type="checkbox"/>		
If change of operator give name and address of previous operator Tenneco Oil E & P, 6162 S. Willow, Englewood, Colorado 80155		

II. DESCRIPTION OF WELL AND LEASE

Lease Name STOREY C LS	Well No. 5	Pool Name, including Formation BLANCO SOUTH (PICT CLIFFS)	FEDERAL	Lease No. SF077111
Location				
Unit Letter E	1973	Feet From The FNL	Line and 402	Feet From The FWL Line
Section 35	Township 28N	Range 9W	NMPM	SAN JUAN County

III. DESIGNATION OF TRANSPORTER OF OIL AND NATURAL GAS

Name of Authorized Transporter of Oil <input type="checkbox"/> or Condensate <input checked="" type="checkbox"/> CST	Address (Give address to which approved copy of this form is to be sent)					
Name of Authorized Transporter of Casinghead Gas <input type="checkbox"/> or Dry Gas <input checked="" type="checkbox"/> EL PASO NATURAL GAS COMPANY	Address (Give address to which approved copy of this form is to be sent) P. O. BOX 1492, EL PASO, TX 79978					
If well produces oil or liquids, give location of tanks.	Unit	Soc.	Twp.	Rge.	Is gas actually connected?	When?

If this production is commingled with that from any other lease or pool, give commingling order number:

IV. COMPLETION DATA

Designate Type of Completion - (X)	Oil Well	Gas Well	New Well	Workover	Deepen	Plug Back	Same Res'v	Diff Res'v
Date Spudded	Date Compl. Ready to Prod.		Total Depth		P.B.T.D.			
Elevations (DF, RKB, RT, GR, etc.)	Name of Producing Formation		Top Oil/Gas Pay		Tubing Depth			
Perforations					Depth Casing Shoe			
TUBING, CASING AND CEMENTING RECORD								
HOLE SIZE	CASING & TUBING SIZE		DEPTH SET		SACKS CEMENT			

V. TEST DATA AND REQUEST FOR ALLOWABLE

OIL WELL (Test must be after recovery of total volume of load oil and must be equal to or exceed top allowable for this depth or be for full 24 hours.)			
Date First New Oil Run To Tank	Date of Test	Producing Method (Flow, pump, gas lift, etc.)	
Length of Test	Tubing Pressure	Casing Pressure	Choke Size
Actual Prod. During Test	Oil - bbls.	Water - Bbls.	Gas - MCF

GAS WELL

Actual Prod. Test - MCF/D	Length of Test	Bbls. Condensate/MMBtu	Gravity of Condensate
Testing Method (prior, back pr.)	Tubing Pressure (Shut-in)	Casing Pressure (Shut-in)	Choke Size

VI. OPERATOR CERTIFICATE OF COMPLIANCE

I hereby certify that the rules and regulations of the Oil Conservation Division have been complied with and that the information given above is true and complete to the best of my knowledge and belief.

J. L. Hampton
Signature

J. L. Hampton Sr. Staff Admin. Suprv.
Printed Name Title
January 16, 1989 303-830-5025
Date Telephone No.

OIL CONSERVATION DIVISION

Date Approved **MAY 08 1989**

By *[Signature]*

Title **SUPERVISION DISTRICT # 3**

INSTRUCTIONS: This form is to be filed in compliance with Rule 1104

- 1) Request for allowable for newly drilled or deepened well must be accompanied by tabulation of deviation tests taken in accordance with Rule 111.
- 2) All sections of this form must be filled out for allowable on new and recompleted wells.
- 3) Fill out only Sections I, II, III, and VI for changes of operator, well name or number, transporter, or other such changes.
- 4) Separate Form C-104 must be filed for each pool in multiply completed wells.

STATE OF NEW MEXICO
ENERGY AND MINERALS DEPARTMENT

NO. OF COPIES RECEIVED	
DISTRIBUTION	
SANTA FE	
FILE	
U.S.G.S.	
LAND OFFICE	
TRANSPORTER	OIL
OPERATOR	GAS
PRORATION OFFICE	

OIL CONSERVATION DIVISION
P.O. BOX 2088
SANTA FE, NEW MEXICO 87501

Form C-104
Revised 10-01-78
Format 06-01-83
Page 1

REQUEST FOR ALLOWABLE
AND
AUTHORIZATION TO TRANSPORT OIL AND NATURAL GAS

Operator Tenneco Oil Company		RECEIVED SEP 06 1985 OIL CON. DIV. DIST. 3
Address P. O. Box 3249, Englewood, CO 80155		
Reason(s) for filing (Check proper box)		Other (Please explain)
<input type="checkbox"/> New Well	Change in Transporter of:	Well Name
<input type="checkbox"/> Recompletion	<input type="checkbox"/> Oil	
<input checked="" type="checkbox"/> Change in Ownership	<input type="checkbox"/> Casinghead Gas	
<input type="checkbox"/> Dry Gas		
<input checked="" type="checkbox"/> Condensate		

If change of ownership give name and address of previous owner **El Paso Natural Gas, P.O. Box 4990, Farmington, NM 87499**

II. DESCRIPTION OF WELL AND LEASE

Lease Name Storey C LS	Well No. 5	Pool Name, including Formation So. Blanco-PC	Kind of Lease State, Federal or Fee USA SF	Lease No. 077111
Location				
Unit Letter E	1972 1973	Feet From The N	Line and 402	Feet From The W
Line of Section 35	Township 28N	Range 9W	NMPM, San Juan County	

III. DESIGNATION OF TRANSPORTER OF OIL AND NATURAL GAS

Name of Authorized Transporter of Oil <input type="checkbox"/> or Condensate <input checked="" type="checkbox"/>	Address (Give address to which approved copy of this form is to be sent)
Conoco Inc. Surface Transportation	P. O. Box 460, Hobbs, NM 88240
Name of Authorized Transporter of Casinghead Gas <input type="checkbox"/> or Dry Gas <input checked="" type="checkbox"/>	Address (Give address to which approved copy of this form is to be sent)
El Paso Natural Gas	P. J. Box 4990, Farmington, NM 87499
If well produces oil or liquids, give location of tanks.	Unit Sec. Twp. Rge. Is gas actually connected? When
	E. 35 28N 9W Yes

If this production is commingled with that from any other lease or pool, give commingling order number

NOTE: Complete Parts IV and V on reverse side if necessary.

VI. CERTIFICATE OF COMPLIANCE

I hereby certify that the rules and regulations of the Oil Conservation Division have been complied with and that the information given is true and complete to the best of my knowledge and belief.

John M. Kelly
(Signature)
Sr. Regulatory Analyst

(Title)
SEP 1 1985
(Date)

OIL CONSERVATION DIVISION
APPROVED **SEP 06 1985**
BY *Frank J. [Signature]*
TITLE **SUPERVISOR DISTRICT 3**

This form is to be filed in compliance with RULE 1104.
If this is a request for allowable for a newly drilled or deepened well, this form must be accompanied by a tabulation of the deviation tests taken on the well in accordance with RULE 111.
All sections of this form must be filled out completely for allowable on new and recompleted wells.
Fill out only Section I, II, III, and VI for changes of owner, well name and or number, or transporter, or other such change of condition.
Separate Forms C-104 must be filed for each pool in multiply completed wells.

Santa Fe
U.S. LAND OFFICE
07/111
SERIAL NUMBER
LEASE OR PERMIT TO PROSPECT

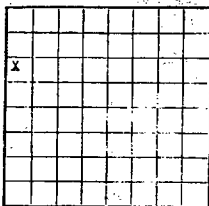

LOCATE WELL CORRECTLY

UNITED STATES
DEPARTMENT OF THE INTERIOR
GEOLOGICAL SURVEY

LOG OF OIL OR GAS WELL

Company El Paso Natural Gas Company Address Box 991, Farmington, New Mexico
Lessor or Tract Storey Field So. El Paso Co. Oil State New Mexico
Well No. 2-C Sec. 35 T. 24N R. 2W Meridian 104N County San Juan
Location 172.6 ft. S. of Line and 402 ft. E. of Line of Section 35 Elevation 5808'

The information given herewith is a complete and correct record of the well and all work done thereon so far as can be determined from all available records.

Signed ORIGINAL SIGNED E. S. GILBERT

Date December 4, 1955 Title Storey, San Juan Co.

The summary on this page is for the condition of the well at above date.

Commenced drilling 10-10-55, 19... Finished drilling 10-12-55, 19...

OIL OR GAS SANDS OR ZONES

(Denote gas by G)

No. 1, from 2950 to 3031 (G) No. 4, from
No. 2, from to No. 5, from
No. 3, from to No. 6, from to

IMPORTANT WATER SANDS

No. 1, from to No. 3, from
No. 2, from to No. 4, from to

CASING RECORD

Size casing	Weight per foot	Threads per foot	Make	Amount	Kind of shoe	Cut and pulled from	Perforated		Purpose
							From	To	
9 5/8"	25.4	1.31	J.W.	121'	Howood				Surface
5 1/2"	18.5	1.55	J.W.	3035'	Howood				3035' to 3037'
1 1/4"	2.3	4.85	Granda	2375'					2375' to 2376'

MUDDING AND CEMENTING RECORD

Size casing	Where set	Number sacks of cement	Method used	Mud gravity	Amount of mud used
9 5/8"	151'	100	Circulated		
5 1/2"	3035'	200	Single stage		

PLUGS AND ADAPTERS

Heaving plug—Material Length Depth set
Adapters—Material Size

SHOOTING RECORD

Size	Shall used	Explosive used	Quantity	Date	Depth shot	Depth cleaned out

Casing History

TOOLS USED

Rotary tools were used from feet to 3037 feet, and from feet to feet
Cable tools were used from feet to feet, and from feet to feet

DATES

11-12-55, 19... Put to producing 19...

The production for the first 24 hours was barrels of fluid of which% was oil;%
emulsion;% water; and% sediment. Gravity, °Bé.

It gas well, cu. ft. per 24 hours 3,094,000 Gasoline per 1,000 cu. ft. of gas
Rock pressure, lbs. per sq. in. 730

EMPLOYEES

Driller Driller
Driller Driller

FORMATION RECORD

FROM—	TO—	TOTAL FEET	FORMATION
0	1850	1850	Tan to gry cr-grn ss interbedded w/gry sh.
1850	2035	235	Mo Alamo ss. white cr-grn s.
2035	2710	625	Kirtland form. Gry sh interbedded, w/tight gry fine-grn ss.
2710	2960	250	Fruitland form. Gry carb sh, scattered coals coals and gry, tight, fine-grn ss.
2960	3031	71	Pictured Cliffs form. Gry, fine-grn, tight, varicolored soft ss.
3031	3037	6	Levis formation. Gry to white dense sh w/silty to sandy ss breakd.

[illegible]

It is of the greatest importance to have a complete history of the well. Please state in detail the date of drilling, together with the reasons for the work and its results. If there were any changes made in the casing, state fully, and if any casing was "sidetracked" or left in the well, give its size and location. If the well has been dynamited, give date, area, position, and number of shots. If stops or bridges were put in to test for water, state kind of material used, position, and results of pumping or bulging.

11-10-36 Pictured Cliff Total Depth 3035'. P.F.T.D. 3610'. Perforated 2561'-2997', 2997'-3006'. Water fractured with 26,560 gallons water & 94,000 gal. gas. Breakdown Pressure & Maximum Pressure 3200psi, Treating pressure 190psi. Injection rate 63.5 RPM. Flush 3500 gallons. Natural gas none.



08 0677 FIGHTED C

TOP SECRET NO FOR ALICE

34

NEW MEXICO OIL CONSERVATION COMMISSION
SANTA FE, NEW MEXICO

Form C-110
Revised 7/1/55

(File the original and 4 copies with the appropriate district office)

CERTIFICATE OF COMPLIANCE AND AUTHORIZATION
TO TRANSPORT OIL AND NATURAL GAS

Company or Operator El Paso Natural Gas Company Lease Storey
Well No. 5-C Unit Letter E S35 T 28N R 9W Pool So. Blanco P.C. Ext.

County San Juan Kind of Lease (State, Fed. or Patented) Federal
If well produces oil or condensate, give location of tanks: Unit S T R
Authorized Transporter of Oil or Condensate El Paso Natural Gas Products Inc.

Address _____
(Give address to which approved copy of this form is to be sent)

Authorized Transporter of Gas El Paso Natural Gas Co.
Address Box 997, Farmington, N.M.

(Give address to which approved copy of this form is to be sent)
If Gas is not being sold, give reasons and also explain its present disposition:

Reasons for Filing: (Please check proper box) New Well (X)
Change in Transporter of (Check One): Oil () Dry Gas () C'head () Condensate ()

Change in Ownership () Other ()
Remarks: (Give explanation below)

NOTES
The undersigned certifies that the Rules and Regulations of the Oil Conservation Com-

mission have been complied with.

Executed this the 30 day of November 19 56

Approved DEC 1 1956 19

OIL CONSERVATION COMMISSION

By [Signature]
Title Oil and Gas Inspector Dist. #3

Title Petroleum Engineer

Company El Paso Natural Gas Co.

Address Box 997, Farmington, N.M.



NEW MEXICO OIL CONSERVATION COMMISSION

Santa Fe, New Mexico

(Form C-104)
(Revised 7/1/52)

REQUEST FOR (OIL) - (GAS) ALLOWABLE

New Well
~~Recompletion~~

This form shall be submitted by the operator before an initial allowable will be assigned to any completed Oil or Gas well. Form C-104 is to be submitted in QUADRUPLICATE to the same District Office to which Form C-101 was sent. The allowable will be assigned effective 7:00 A.M. on date of completion or recompletion, provided this form is filed during calendar month of completion or recompletion. The completion date shall be that date in the case of an oil well when oil is delivered into the stock tanks. Gas must be reported on 15.025 psia at 60° Fahrenheit.

Farmington, N.M.

November 30, 1956

(Place)

(Date)

WE ARE HEREBY REQUESTING AN ALLOWABLE FOR A WELL KNOWN AS:

El Paso Natural Gas Co.

Storey

Well No. 5-C

SW

NW

(Company or Operator)

(Lease)

E

Sec. 35

T. 28N

R. 9W

So. Blance P.O. Ext.

Unit Letter

NMPM,

Pool

San Juan

County. Date Spudded 10-10-56

Date Completed 11-12-56

Please indicate location:

D	C	B	A
E	F	G	H
X			
L	K	J	I
M	N	O	P

1972.6'N, 402'W

Casing and Cementing Record

Size Feet Sax

9 5/8"	121'	100
5 1/2"	3025'	200
1 1/4"	2975'	---

Elevation 6798' Total Depth 3037' F.M. 6.0. 3010'

Top oil/gas pay 2961' (Perf.) Name of Prod. Form Pictured Cliff

Casing Perforations 2961-2967, 2975-3001 or

Depth to Casing shoe of Prod. String 3035'

Natural Prod. Test BOPD

based on bbls. Oil in Hrs. Mins.

Test after acid or shot BOPD

Based on bbls. Oil in Hrs. Mins.

Gas Well Potential A.O.F. - 4,487 MCF/D, Ch. Volume - 3,894 MCF/D.

Size choke in inches 3/4"

Date first oil run to tanks or gas to Transmission system: w/o Pipeline

Transporter taking Oil or Gas: El Paso Natural Gas Company

Remarks:

I hereby certify that the information given above is true and complete to the best of my knowledge.

Approved DEC 4 1956, 19.

El Paso Natural Gas Company

(Company or Operator)

By:

(Signature)

Title:

Petroleum Engineer

Send Communications regarding well to:

Name:

E. J. Coal

Address:

Box 997, Farmington, N.M.

OIL CONSERVATION COMMISSION

By:

Title PETROLEUM ENGINEER DIST. NO. 3

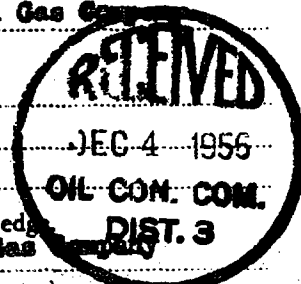

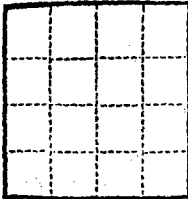

(SUBMIT IN TRIPLICATE)

UNITED STATES
DEPARTMENT OF THE INTERIOR
GEOLOGICAL SURVEY

Land Office Santa Fe
Lease No. 077111
Unit Storey

SUNDRY NOTICES AND REPORTS ON WELLS

NOTICE OF INTENTION TO DRILL	SUBSEQUENT REPORT OF WATER SHUT-OFF	
NOTICE OF INTENTION TO CHANGE PLANS	SUBSEQUENT REPORT OF SHOOTING OR ACIDIZING	
NOTICE OF INTENTION TO TEST WATER SHUT-OFF	SUBSEQUENT REPORT OF ALTERING CASING	
NOTICE OF INTENTION TO RE-DRILL OR REPAIR WELL	SUBSEQUENT REPORT OF RE-DRILLING OR REPAIR	
NOTICE OF INTENTION TO SHOOT OR ACIDIZE	SUBSEQUENT REPORT OF ABANDONMENT	
NOTICE OF INTENTION TO PULL OR ALTER CASING	SUPPLEMENTARY WELL HISTORY	
NOTICE OF INTENTION TO ABANDON WELL	<u>Water Fracture</u>	<u>X</u>

(INDICATE ABOVE BY CHECK MARK NATURE OF REPORT, NOTICE, OR OTHER DATA)

November 14, 1956

Well No. 5-C is located 900 ft. from S line and 1090 ft. from E line of sec. 34
SE section 34 28N 9W 10N10E
 (1/4 Sec. and Sec. No.) (Twp.) (Range) (Meridian)
So. Blanco Ext. San Juan New Mexico
 (Field) (County or Subdivision) (State or Territory)

The elevation of the derrick floor above sea level is 6206 ft.

DETAILS OF WORK

(State names of and expected depths to objective sands; show sizes, weights, and lengths of proposed casings; indicate mudding jobs, cementing points, and all other important proposed work)

11-10-56 Total Depth 3035'. Plug back T.D. 3010'.
 Water fractured Pictured Cliff perforated intervals 2961-2967, 2975-3001
 with 34,660 gallons water and 40,000# sand. Breakdown pressure 3200#,
 maximum pressure 3200#, average treating pressure 1900#. Injection rate
 63.5 bbls./min. Flush 3500 gallons. Natural gas



I understand that this plan of work must receive approval in writing by the Geological Survey before operations may be commenced.

Company El Paso Natural Gas Company

Address Box 97
Farmington, New Mexico

By WELLS N. WALSH

Title Petroleum Engineer

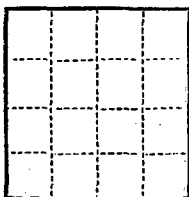

(SUBMIT IN TRIPLICATE)

UNITED STATES
DEPARTMENT OF THE INTERIOR
GEOLOGICAL SURVEY

Land Office Santa Fe
Lease No. 077111
Unit Storey

SUNDRY NOTICES AND REPORTS ON WELLS

NOTICE OF INTENTION TO DRILL	SUBSEQUENT REPORT OF WATER SHUT-OFF	<input checked="" type="checkbox"/>
NOTICE OF INTENTION TO CHANGE PLANS	SUBSEQUENT REPORT OF SHOOTING OR ACIDIZING	
NOTICE OF INTENTION TO TEST WATER SHUT-OFF	SUBSEQUENT REPORT OF ALTERING CASING	
NOTICE OF INTENTION TO RE-DRILL OR REPAIR WELL	SUBSEQUENT REPORT OF RE-DRILLING OR REPAIR	
NOTICE OF INTENTION TO SHOOT OR ACIDIZE	SUBSEQUENT REPORT OF ABANDONMENT	
NOTICE OF INTENTION TO PULL OR ALTER CASING	SUPPLEMENTARY WELL HISTORY	
NOTICE OF INTENTION TO ABANDON WELL		

(INDICATE ABOVE BY CHECK MARK NATURE OF REPORT, NOTICE, OR OTHER DATA)

October 25, 1956

Well No. 5-C is located 1972.5 ft. from [N] line and 402 ft. from [E] line of sec. 35
SW Section 35 SW SW SE
 (1/4 Sec. and Sec. No.) (Twp.) (Range) (Meridian)
So. Blanco Rkt. San Juan New Mexico
 (Field) (County or Subdivision) (State or Territory)

The elevation of the derrick floor above sea level is 6806 ft.

DETAILS OF WORK

(State names of and expected depths to objective sands; show sizes, weights, and lengths of proposed casings; indicate mudding jobs, cementing points, and all other important proposed work)

Spud date 10-10-56.
On 10-11-56. Total Depth 135'.
Ran 3 joints 9 5/8", 25.4#, Armaco spiral weld casing (121') set at 131'
with 100 sacks regular cement circulated to surface.
Held 500# 30 minutes.

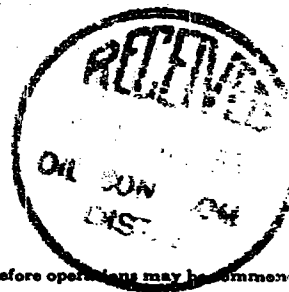

I understand that this plan of work must receive approval in writing by the Geological Survey before operations may be commenced.

Company El Paso Natural Gas Company
Address Box 997
Farmington, New Mexico

By Original Signed DWELL N. WALSH
Title Petroleum Engineer

(SUBMIT IN TRIPLICATE)

UNITED STATES
DEPARTMENT OF THE INTERIOR
GEOLOGICAL SURVEY

Land Office Santa Fe
Lease No. 57111
Unit Storey

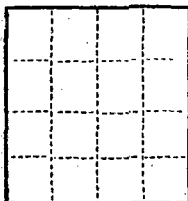

SUNDRY NOTICES AND REPORTS ON WELLS

NOTICE OF INTENTION TO DRILL	SUBSEQUENT REPORT OF WATER SHUT-OFF	1
NOTICE OF INTENTION TO CHANGE PLANS	SUBSEQUENT REPORT OF SHOOTING OR ACIDIZING	
NOTICE OF INTENTION TO TEST WATER SHUT-OFF	SUBSEQUENT REPORT OF ALTERING CASING	
NOTICE OF INTENTION TO RE-DRILL OR REPAIR WELL	SUBSEQUENT REPORT OF RE-DRILLING OR REPAIR	
NOTICE OF INTENTION TO SHOOT OR ACIDIZE	SUBSEQUENT REPORT OF ABANDONMENT	
NOTICE OF INTENTION TO PULL OR ALTER CASING	SUPPLEMENTARY WELL HISTORY	
NOTICE OF INTENTION TO ABANDON WELL		

(INDICATE ABOVE BY CHECK MARK NATURE OF REPORT, NOTICE, OR OTHER DATA)

October 23, 1950

Well No. 5-C is located 172.6 ft. from N line and 402 ft. from W line of sec. 22

Sec. 22 (Sec. and Sec. No.) 24 (Twp.) 3 (Range) 10N (Meridian)
So. Blanco Nat. (Field) Blanco (County or Subdivision) N. M. (State or Territory)

The elevation of the derrick floor above sea level is 4000 ft.

DETAILS OF WORK

(State names of and expected depths to objective sands; show sizes, weights, and lengths of proposed casings; indicate mudding jobs, cementing points, and all other important proposed work)

10-20-50, Total Depth 303'.
Run 21 joints 5 1/2" 15.5 lb. 3-55 casing (3025') set at 303' with 100 sacks
regular cement, 100 sacks Portland, 4% Cel.
Bld 1000, for 30 minutes.
Top of cement by temperature survey at 3020'.

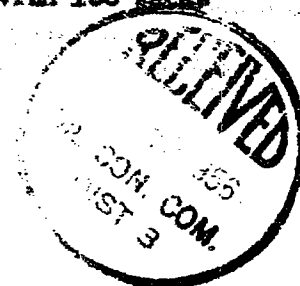

I understand that this plan of work must receive approval in writing by the Geological Survey before operations may be commenced.

Company El Paso Natural Gas Company

Address Box 211
Farrington, New Mexico

By Charles E. ...

Title Petroleum Eng. Sec.

Location changed due to terrain conditions.

Form 9-331a
(Feb. 1951)

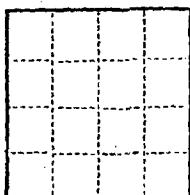

(SUBMIT IN TRIPLICATE)

UNITED STATES
DEPARTMENT OF THE INTERIOR
GEOLOGICAL SURVEY

Budget Bureau No. 42-R338.4
Approval expires 12-31-60.

Land Office Santa Fe
Lease No. 077111
Unit Storey

SUNDRY NOTICES AND REPORTS ON WELLS

NOTICE OF INTENTION TO DRILL.....	<input checked="" type="checkbox"/>	SUBSEQUENT REPORT OF WATER SHUT-OFF.....
NOTICE OF INTENTION TO CHANGE PLANS.....		SUBSEQUENT REPORT OF SHOOTING OR ACIDIZING.....
NOTICE OF INTENTION TO TEST WATER SHUT-OFF.....		SUBSEQUENT REPORT OF ALTERING CASING.....
NOTICE OF INTENTION TO RE-DRILL OR REPAIR WELL.....		SUBSEQUENT REPORT OF RE-DRILLING OR REPAIR.....
NOTICE OF INTENTION TO SHOOT OR ACIDIZE.....		SUBSEQUENT REPORT OF ABANDONMENT.....
NOTICE OF INTENTION TO PULL OR ALTER CASING.....		SUPPLEMENTARY WELL HISTORY.....
NOTICE OF INTENTION TO ABANDON WELL.....		

(INDICATE ABOVE BY CHECK MARK NATURE OF REPORT, NOTICE, OR OTHER DATA)

July 25, 1956

Well No. 5-C is located 1972.6 ft. from [N] line and 402 ft. from [W] line of sec. 35.
NW Section 35 28N 9W NMPM
(1/4 Sec. and Sec. No.) (Twp.) (Range) (Meridian)
So. Blanco Ext. San Juan New Mexico
(Field) (County or Subdivision) (State or Territory)

The elevation of the derrick floor above sea level is 6808 ft.

DETAILS OF WORK

(State names of and expected depths to objective sands; show sizes, weights, and lengths of proposed casings; indicate mudlogging jobs, cementing points, and all other important proposed work)

It is intended to drill a well thru the Pictured Cliff formation using rotary tools and to perforate and water fracture possible producing zones. Estimated Total Depth 3070'.

Casing Program:

9 5/8" at 120' with 125 sacks regular cement circulated to surface
5 1/2" at 3070' with 75 sacks regular cement, 75 sacks Portland Cement

The NW/4 of Section 35 is dedicated to this well.
NW/4 (SF 077111).

I understand that this plan of work must receive approval in writing by the Geological Survey before operations may be commenced.

Company El Paso Natural Gas Company

Address Box 997

Farmington, New Mexico

Original Signed EWELL N. WALSH

By _____

Title Petroleum Engineer

NEW MEXICO
OIL CONSERVATION COMMISSION

WELL LOCATION AND GAS PRODUCTION PLAT

JULY 6, 1936

EL PASO NATURAL GAS COMPANY

STOREY "C"

SF 077111

5

35

28 N

9 W

1972.6

NORTH

402

WEST

SAN JUAN

6797.88

PICTURED CLIFF

SO. BLANCO
EXTENSION

160 AC.
(1916 PLAT)

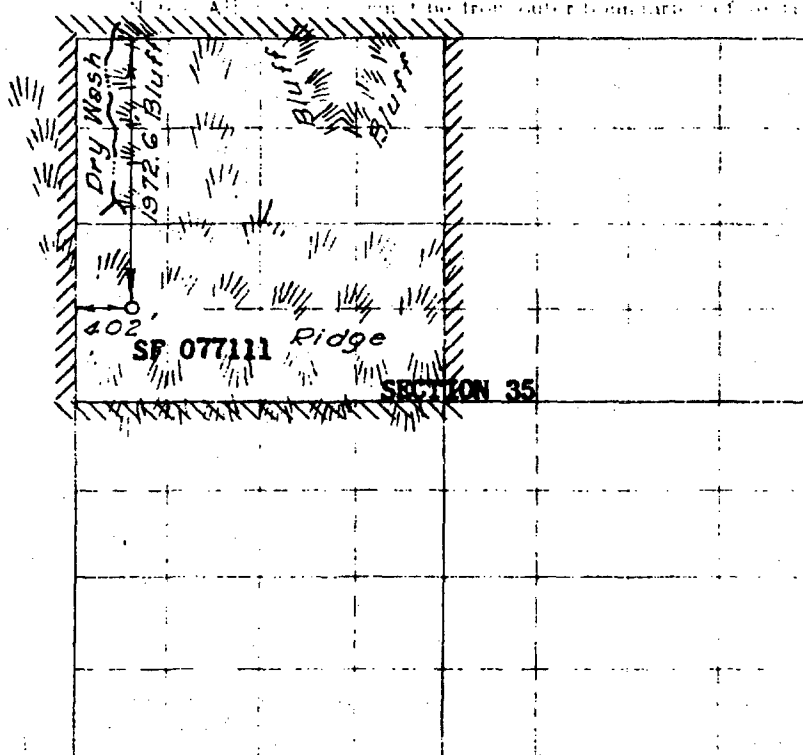

NOTE
This section of
form is to be used
for gas wells only

Scale: 1 inch = equal 1 mile

I hereby certify that the plat was prepared from
the records of actual surveys made by me or under my
supervision and that the same are true and correct to the
best of my knowledge and belief.

Date Surveyed

JULY 2, 1936

E. O. Walker
Registered Professional Engineer and of Land Surveyor

1. Is this well a Dual Comp.

Yes _____ No **X**

2. If the answer to Question

14 yes, are there any other dual
completed wells within the
dedicated acreage.

Yes _____ No _____

Original Signed EWELL N. WALSH

Position **Petroleum Engineer**

Representing **El Paso Natural Gas Co.**

Address **Box 997, Farmington, N.M.**

NOTE: WELL LOCATION MOVED - PLAT REISSUED, 7-17-56.

Farmington, New Mexico

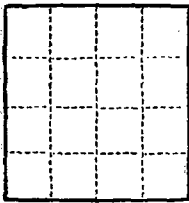

(SUBMIT IN TRIPLICATE)

UNITED STATES
DEPARTMENT OF THE INTERIOR
GEOLOGICAL SURVEY

Land Office Santa Fe
Lease No. 07711
Unit Starry

SUNDRY NOTICES AND REPORTS ON WELLS

NOTICE OF INTENTION TO DRILL.....	<input checked="" type="checkbox"/>	SUBSEQUENT REPORT OF WATER SHUT-OFF.....	
NOTICE OF INTENTION TO CHANGE PLANS.....		SUBSEQUENT REPORT OF SHOOTING OR ACIDIZING.....	
NOTICE OF INTENTION TO TEST WATER SHUT-OFF.....		SUBSEQUENT REPORT OF ALTERING CASING.....	
NOTICE OF INTENTION TO RE-DRILL OR REPAIR WELL.....		SUBSEQUENT REPORT OF RE-DRILLING OR REPAIR.....	
NOTICE OF INTENTION TO SHOOT OR ACIDIZE.....		SUBSEQUENT REPORT OF ABANDONMENT.....	
NOTICE OF INTENTION TO PULL OR ALTER CASING.....		SUPPLEMENTARY WELL HISTORY.....	
NOTICE OF INTENTION TO ABANDON WELL.....			

(INDICATE ABOVE BY CHECK MARK NATURE OF REPORT, NOTICE, OR OTHER DATA)

July 13, 1956

Well No. 5-C is located 401 ft. from N line and 362 ft. from W line of sec. 35
SW Section 35 28N 5W PMPM
 (1/4 Sec. and Sec. No.) (Twp.) (Range) (Meridian)
So. Blasco P.C. Extension San Juan New Mexico
 (Field) (County or Subdivision) (State or Territory)

The elevation of the derrick floor above sea level is 6184 ft.

DETAILS OF WORK

(State names of and expected depths to objective sands; show sizes, weights, and lengths of proposed casings; indicate mudding jobs, cementing points, and all other important proposed work)

It is intended to drill a well thru the Pictured Cliff formation using rotary tools and to perforate and water fracture possible producing zones. Estimated Total Depth 2460'.

Casing Program:

9 5/8" at 120' with 125 sacks regular cement circulated to surface.
5 1/2" at 2460' with 75 sacks regular cement, 75 sacks Pozzix.

The NW/4 of Section 35 is dedicated to this well
NW/4, SF 07711.

I understand that this plan of work must receive approval in writing by the Geological Survey before operations may be commenced.

Company El Paso Natural Gas Company

Address Box 997

Permiton, New Mexico

By

E. S. Olney
Petroleum Engineer

Title

NEW MEXICO

DEPARTMENT OF LAND AND MINES

LAND LOCATION AND SURVEY DATA

JULY 6, 1956

EL PASO NATURAL GAS COMPANY

STOREY "C"

SF 077111

5

35

28 N

9 W

401

NORTH

362

WEST

SAN JUAN

6174

PICTURED CLIFF

SO. BLANCO
EXTENSION

160 AC.
(1916 PLAT)

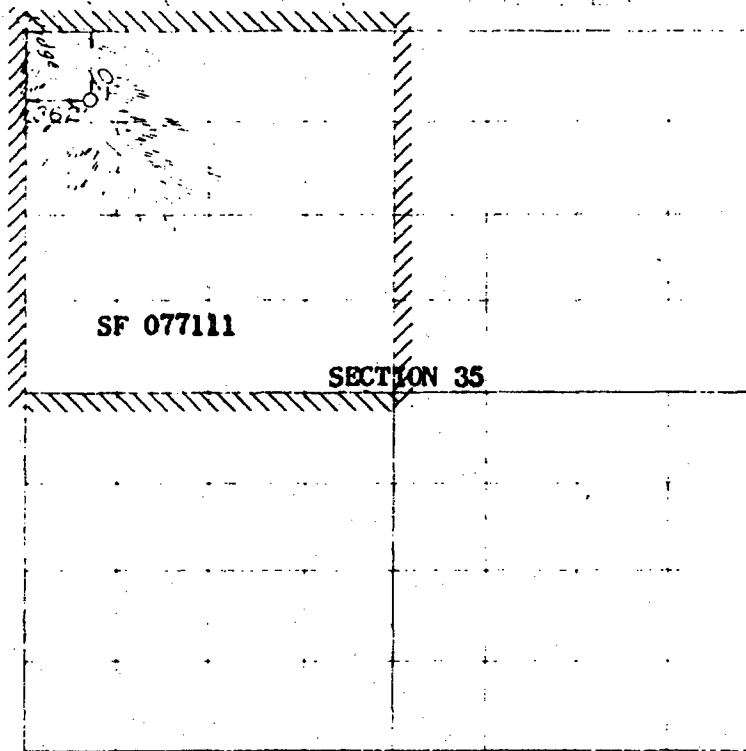

NOTE

1. This survey was made by the
Bureau of Land Management
Department of the Interior



JULY 21 1956

C. O. Walker



E. S. Olney
Petroleum Engineer

El Paso Natural Gas Co.

Box 997, Farmington, N.M.