

12-22-04 DATE IN	SUSPENSE	Catanach ENGINEER	1-4-05 LOGGED IN	TYPE	DSEMO500445756 APP NO.
---------------------	----------	----------------------	---------------------	------	---------------------------

ABOVE THIS LINE FOR DIVISION USE ONLY

NEW MEXICO OIL CONSERVATION DIVISION

- Engineering Bureau -

1220 South St. Francis Drive, Santa Fe, NM 87505



265

ADMINISTRATIVE APPLICATION CHECKLIST

THIS CHECKLIST IS MANDATORY FOR ALL ADMINISTRATIVE APPLICATIONS FOR EXCEPTIONS TO DIVISION RULES AND REGULATIONS WHICH REQUIRE PROCESSING AT THE DIVISION LEVEL IN SANTA FE

Application Acronyms:

[NSL-Non-Standard Location] [NSP-Non-Standard Proration Unit] [SD-Simultaneous Dedication]
 [DHC-Downhole Commingling] [CTB-Lease Commingling] [PLC-Pool/Lease Commingling]
 [PC-Pool Commingling] [OLS - Off-Lease Storage] [OLM-Off-Lease Measurement]
 [WFX-Waterflood Expansion] [PMX-Pressure Maintenance Expansion]
 [SWD-Salt Water Disposal] [IPI-Injection Pressure Increase]
 [EOR-Qualified Enhanced Oil Recovery Certification] [PPR-Positive Production Response]

[1] TYPE OF APPLICATION - Check Those Which Apply for [A]

- [A] Location - Spacing Unit - Simultaneous Dedication
☐ NSL ☐ NSP ☐ SD

Check One Only for [B] or [C]

- [B] Commingling - Storage - Measurement
☐ DHC ☒ CTB ☐ PLC ☐ PC ☐ OLS ☐ OLM

- [C] Injection - Disposal - Pressure Increase - Enhanced Oil Recovery
☐ WFX ☐ PMX ☐ SWD ☐ IPI ☐ EOR ☐ PPR

- [D] Other: Specify _____

[2] NOTIFICATION REQUIRED TO: - Check Those Which Apply, or ☐ Does Not Apply

- [A] ☐ Working, Royalty or Overriding Royalty Interest Owners
 [B] ☐ Offset Operators, Leaseholders or Surface Owner
 [C] ☐ Application is One Which Requires Published Legal Notice
 [D] ☐ Notification and/or Concurrent Approval by BLM or SLO
U.S. Bureau of Land Management - Commissioner of Public Lands, State Land Office
 [E] ☐ For all of the above, Proof of Notification or Publication is Attached, and/or,
 [F] ☐ Waivers are Attached

[3] SUBMIT ACCURATE AND COMPLETE INFORMATION REQUIRED TO PROCESS THE TYPE OF APPLICATION INDICATED ABOVE.

[4] **CERTIFICATION:** I hereby certify that the information submitted with this application for administrative approval is **accurate** and **complete** to the best of my knowledge. I also understand that **no action** will be taken on this application until the required information and notifications are submitted to the Division.

Note: Statement must be completed by an individual with managerial and/or supervisory capacity.

Print or Type Name

Signature

Title

Date

e-mail Address



2004 DEC 22 AM 11 37

2700 Farmington Ave, K-1 Farmington, NM 87401
Phone: (505) 324-1090 FAX: (505) 564-6700

December 22, 2004

Mr. William Jones
New Mexico Oil Conservation Division
1220 S. St. Francis Drive
Santa Fe, NM 87505

Mr. Jim Lovato
Bureau of Land Management
1235 LaPlata Hwy
Farmington, NM 87401

Subject: Proposed Surface Commingle
Bolack 9 #1 and Alice Bolack #5
Federal Lease NMNM078872A

Dear Mr. Jones & Mr. Lovato:

XTO Energy Inc. requests administrative approval for surface commingling natural gas produced from the wells operated in the Bolack 9 #1 and the Alice Bolack #5. These wells are both located in Sec 9-T27N-R11W, San Juan County, New Mexico.

XTO plans to produce the commingled gas through a central compressor, thus lowering operating expenses and extending the economic life of the wells and increasing their ultimate recoveries on all Indians and non-Indian leases. The anticipated fuel requirements for each well is also presented, and currently we anticipate the only fuel requirements to be for pumping unit engines, separators and for the compressor engine. There are no bypass gas lines for this system.

Each well will be equipped with allocation meters, which will be maintained by XTO Energy in accordance with State and Federal Regulations (Onshore Order No. 5). To ensure the initial system integrity, all flowlines will be pressure tested appropriately. Produced liquids will not be surface commingled. All interest owners have been notified via certified mail, return receipt, on December 14, 2004.

The following attachments are included with this application:

- Form C107B (application for surface commingle; diverse ownership)
- Map of all wells and their associated leases
- Form C-102 for each well (plats)
- Table of well & lease information, spacing, permits, lease numbers, gravities/BTU, MCF
- Schematic diagram showing all flowlines, compressors & equipment
- Details of allocation formula, including line purging and venting
- Letter to WI, NRI & ORRI owners & list of owners
- Administrative Application Checklist

Sincerely,

A handwritten signature in cursive script, appearing to read 'Holly C. Perkins'.

Holly C. Perkins
Regulatory Compliance Tech

xc: OCD, Aztec Office

District I
1625 N. French Drive, Hobbs, NM 88240
District II
1301 W. Grand Ave, Artesia, NM 88210
District III
1000 Rio Brazos Road, Aztec, NM 87410
District IV
1220 S. St Francis Dr, Santa Fe, NM
87505

State of New Mexico
Energy, Minerals and Natural Resources Department

Form C-107-B
Revised June 10, 2003

OIL CONSERVATION DIVISION
1220 S. St Francis Drive
Santa Fe, New Mexico 87505

Submit the original
application to the Santa Fe
office with one copy to the
appropriate District Office.

APPLICATION FOR SURFACE COMMINGLING (DIVERSE OWNERSHIP)

OPERATOR NAME: XTO ENERGY INC.

OPERATOR ADDRESS: 2700 FARMINGTON AVE, SUITE K-1

APPLICATION TYPE:

☒ Pool Commingling ☐ Lease Commingling ☐ Pool and Lease Commingling ☐ Off-Lease Storage and Measurement (Only if not Surface Commingled)

LEASE TYPE: ☐ Fee ☐ State ☒ Federal

Is this an Amendment to existing Order? ☐ Yes ☒ No If "Yes", please include the appropriate Order No. _____

Have the Bureau of Land Management (BLM) and State Land office (SLO) been notified in writing of the proposed commingling

☒ Yes ☐ No

(A) POOL COMMINGLING

Please attach sheets with the following information

(1) Pool Names and Codes	Gravities / BTU of Non-Commingled Production	Calculated Gravities / BTU of Commingled Production		Calculated Value of Commingled Production	Volumes
KUTZ W PICTURED CLIFFS 79680	.5980				
BASIN FRUITLAND COAL 71629	.6090				

(2) Are any wells producing at top allowables? ☐ Yes ☒ No

(3) Have all interest owners been notified by certified mail of the proposed commingling? ☒ Yes ☐ No.

(4) Measurement type: ☒ Metering ☐ Other (Specify)

(5) Will commingling decrease the value of production? ☐ Yes ☒ No If "yes", describe why commingling should be approved

(B) LEASE COMMINGLING

Please attach sheets with the following information

(1) Pool Name and Code.

(2) Is all production from same source of supply? ☐ Yes ☐ No

(3) Has all interest owners been notified by certified mail of the proposed commingling? ☐ Yes ☐ No

(4) Measurement type: ☐ Metering ☐ Other (Specify)

(C) POOL and LEASE COMMINGLING

Please attach sheets with the following information

(1) Complete Sections A and E.

(D) OFF-LEASE STORAGE and MEASUREMENT

Please attached sheets with the following information

(1) Is all production from same source of supply? ☐ Yes ☐ No

(2) Include proof of notice to all interest owners.

(E) ADDITIONAL INFORMATION (for all application types)

Please attach sheets with the following information

(1) A schematic diagram of facility, including legal location.

(2) A plat with lease boundaries showing all well and facility locations. Include lease numbers if Federal or State lands are involved.

(3) Lease Names, Lease and Well Numbers, and API Numbers.

I hereby certify that the information above is true and complete to the best of my knowledge and belief.

SIGNATURE: Holly C Perkins

TITLE: REGULATORY COMPLIANCE TECH

DATE: 12/13/2004

TYPE OR PRINT NAME HOLLY C. PERKINS

TELEPHONE NO.: (505) 564-6720

E-MAIL ADDRESS: Holly_perkins@xtoenergy.com

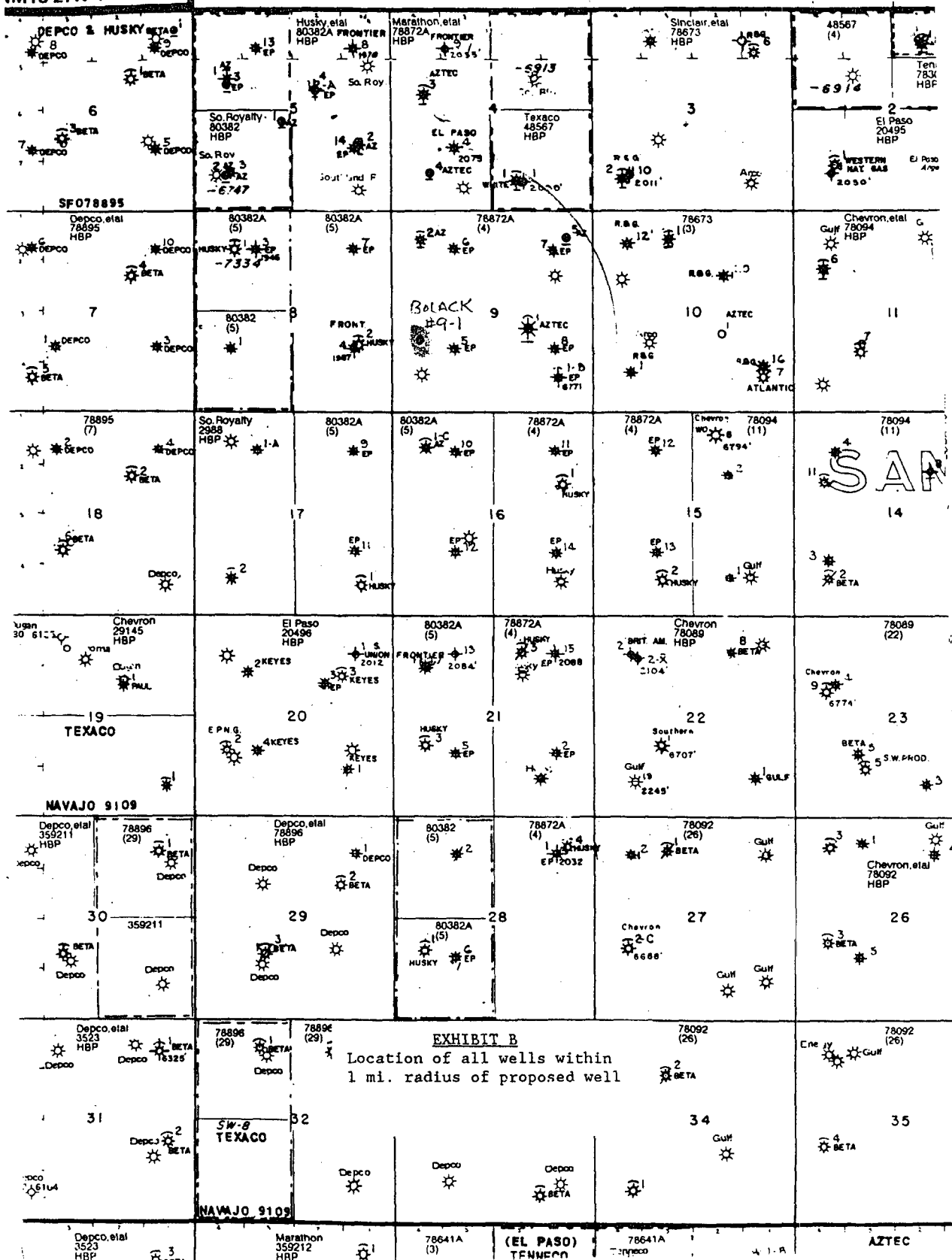

District I
1625 N. French Dr., Hobbs, NM 88240

District II
811 South First, Artesia, NM 88210

District III
1000 Rio Brazos Rd., Aztec, NM 87410

District IV
1220 S. St. Francis Dr., Santa Fe, NM 87505

State of New Mexico
Energy, Minerals & Natural Resources Department

Form C-102
Revised August 15, 2000

OIL CONSERVATION DIVISION
1220 South St. Francis Dr.
Santa Fe, NM 87505

Submit to Appropriate District Office
State Lease - 4 Copies
Fee Lease - 3 Copies

WELL LOCATION AND ACREAGE DEDICATION PLAT



AMENDED
REPORT

¹ API Number 30-045-27857		² Pool Code 71629	³ Pool Name BASIN FRUITLAND COAL
⁴ Property Code	⁵ Property Name BOLACK 9		⁶ Well Number 1
⁷ OGRID No. 167067	⁸ Operator Name XTO Energy, Inc.		⁹ Elevation 6339' GR

¹⁰ Surface Location

UL or lot no.	Section	Township	Range	Lot Idn	Feet from the	North/South line	Feet from the	East/West line	County
L	9	27N	11W		1877	SOUTH	796	WEST	San Juan

¹¹ Bottom Hole Location If Different From Surface

UL or lot no.	Section	Township	Range	Lot Idn	Feet from the	North/South line	Feet from the	East/West line	County
¹² Dedicated Acres 320	¹³ Joint or Infill	¹⁴ Consolidation Code			¹⁵ Order No.				

NO ALLOWABLE WILL BE ASSIGNED TO THIS COMPLETION UNTIL ALL INTERESTS HAVE BEEN CONSOLIDATED OR A NON-STANDARD UNIT HAS BEEN APPROVED BY THE DIVISION

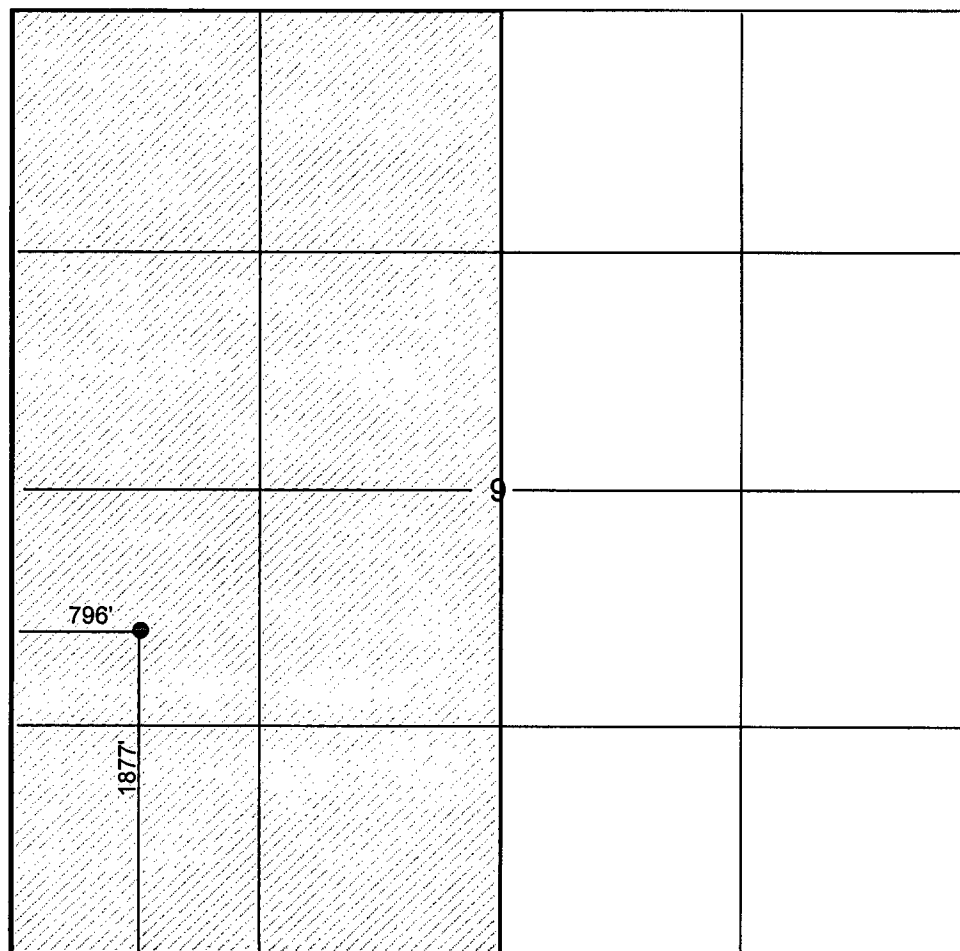

OPERATOR CERTIFICATION

I hereby certify that the information contained herein is true and complete to the best of my knowledge and belief

Holly C. Perkins
Signature

Holly C. Perkins
Printed Name

Regulatory compliance Tech
Title

December 12, 2004
Date

SURVEYOR CERTIFICATION

I hereby certify that the well location shown on this plat was plotted from field notes of actual surveys made by me or under my supervision, and that the same is true and correct to the best of my belief.

March 8, 1990
Date of Survey

Signature and Seal of Professional Surveyor:
Original signed by William E. Mahnke II

8466
Certificate Number

District I
1625 N. French Dr., Hobbs, NM 88240
District II
811 South First, Artesia, NM 88210
District III
1000 Rio Brazos Rd., Aztec, NM 87410
District IV
1220 S. St. Francis Dr., Santa Fe, NM 87505

State of New Mexico
Energy, Minerals & Natural Resources Department

Form C-102
Revised August 15, 2000

OIL CONSERVATION DIVISION
1220 South St. Francis Dr.
Santa Fe, NM 87505

Submit to Appropriate District Office
State Lease - 4 Copies
Fee Lease - 3 Copies

WELL LOCATION AND ACREAGE DEDICATION PLAT



AMENDED
REPORT

¹ API Number 30-045-27857		² Pool Code 79680	³ Pool Name Kutz W Pictured Cliffs
⁴ Property Code	⁵ Property Name ALICE BOLACK		⁶ Well Number 5
⁷ OGRID No. 167067	⁸ Operator Name XTO Energy, Inc.		⁹ Elevation 6339' GR

¹⁰ Surface Location

UL or lot no.	Section	Township	Range	Lot Idn	Feet from the	North/South line	Feet from the	East/West line	County
K	9	27N	11W		1650	SOUTH	1650	WEST	San Juan

¹¹ Bottom Hole Location If Different From Surface

UL or lot no.	Section	Township	Range	Lot Idn	Feet from the	North/South line	Feet from the	East/West line	County

¹² Dedicated Acres 160 SW/4	¹³ Joint or Infill	¹⁴ Consolidation Code	¹⁵ Order No.
---	-------------------------------	----------------------------------	-------------------------

NO ALLOWABLE WILL BE ASSIGNED TO THIS COMPLETION UNTIL ALL INTERESTS HAVE BEEN CONSOLIDATED OR A NON-STANDARD UNIT HAS BEEN APPROVED BY THE DIVISION

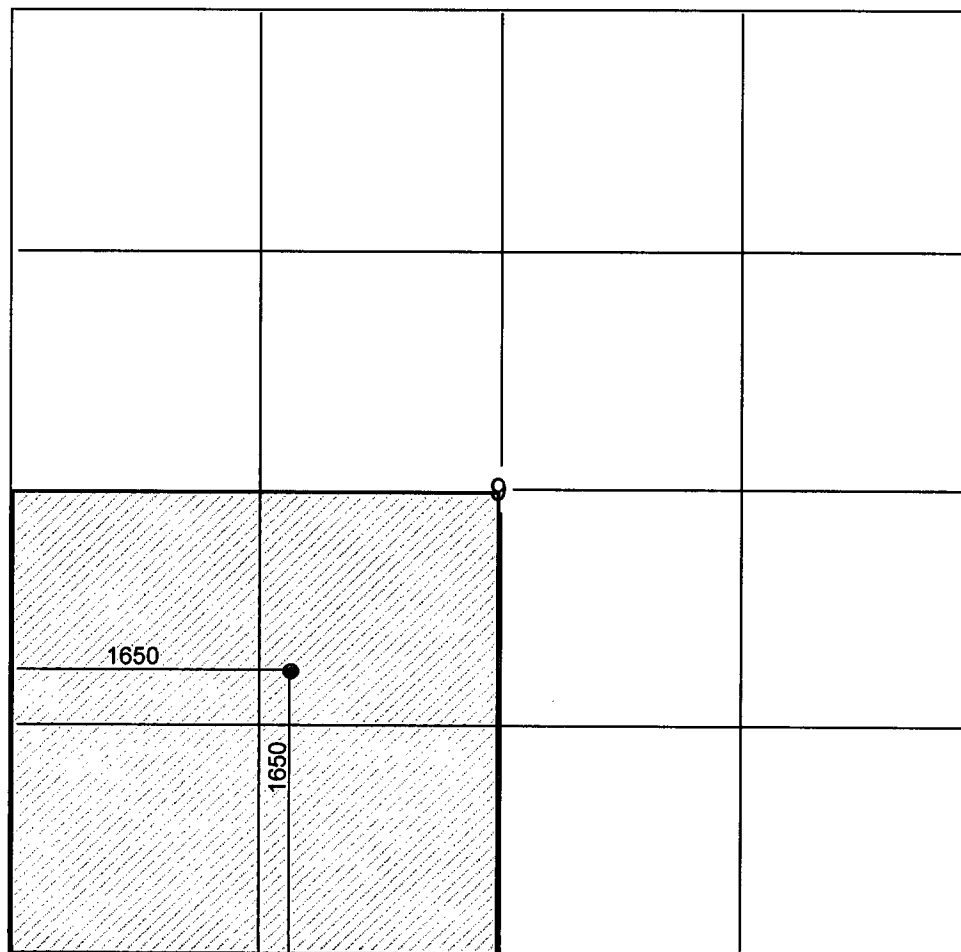

OPERATOR CERTIFICATION

I hereby certify that the information contained herein is true and complete to the best of my knowledge and belief

Holly C. Perkins
Signature

Holly C. Perkins
Printed Name

Regulatory compliance Tech
Title

December 20, 2004
Date

SURVEYOR CERTIFICATION

I hereby certify that the well location shown on this plat was plotted from field notes of actual surveys made by me or under my supervision, and that the same is true and correct to the best of my belief.

August 9, 2001
Date of Survey

Signature and Seal of Professional Surveyor:
Original signed by Charles J. Finklea

1302
Certificate Number

BOLACK 9 #1 & ALICE BOLACK #5 SURF CMGL				
	Well Name	Bolack 9 #1	Alice Bolack #5	
	API#	30-045-27857	30-045-06661	
	Sec-T-R	Sec 9-T27N-R11W	Sec 9-T27N-R11W	
	FNL/FSL	1877' FSL	1650' FSL	
	FEL/FWL	796' FWL	1650' FWL	
	Lease #	NMNM078872A	NMNM078872A	
	Pool	Basin Fruitland Coal	Kutz W Pictured Cliffs	
	Permits	N/A	N/A	
	Spacing	W/2 320 acres	SW/4 160 acres	
	Gravity	0.609	0.598	
	BTU	52.64	105.237	
	Est Daily Gas Rate	50.95	103.5	
	WI	1	0.5	
	NRI	0.8	0.4125	
Compressor and other equipment fuel usage will be determined based on manufacturer's specifications				
Pumping unit & separator fuel will be allocated to well if equipment exists				

XTO ENERGY INC.

Proposed Comingle - Alice Bolack #005 & Bolack 9 #001

Sec. 09, T27N, R11W, Unit K & L

Federal Lease #: NMSF078872A

API #: 30-045-06661 & 30-045-27857

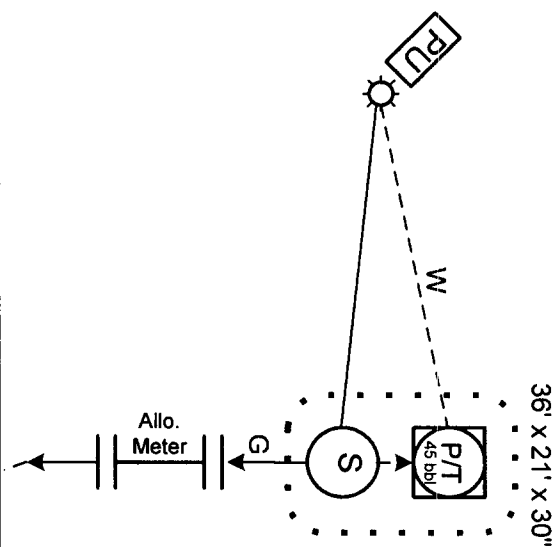
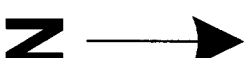

Dirt Road

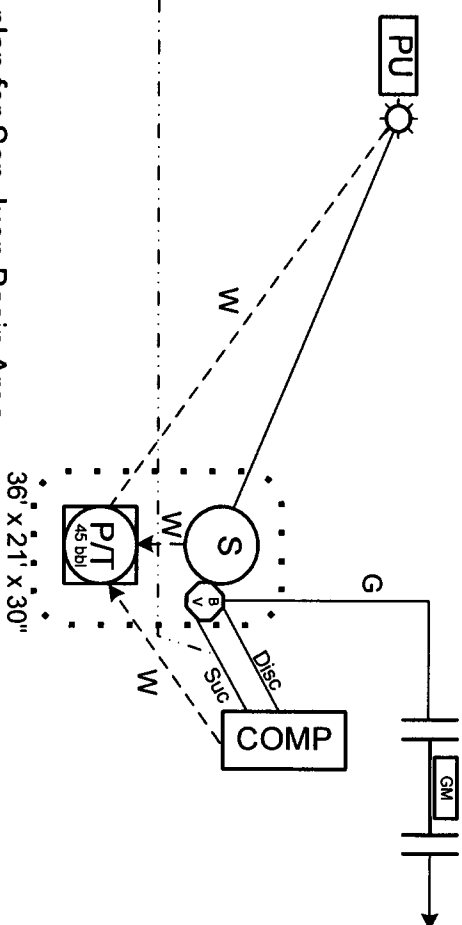

This lease is subject to the site security plan for San Juan Basin Area.

The plan is located at: XTO Energy Inc

2700 Farmington Ave., Bldg. K, Ste. 1

Farmington, NM 87401

Updated: 12/21/04

XTO ENERGY INC.
Bolack 9 #001
Sec. 09, T27N, R11W, Unit L
Federal Lease #: NMSF078872A
API #: 30-045-27857

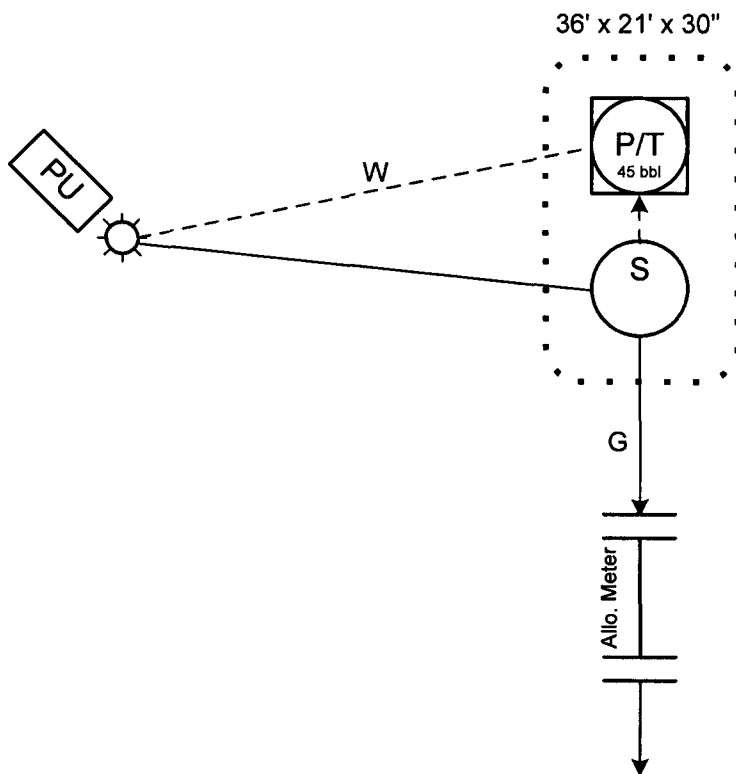

This lease is subject to the site security plan for San Juan Basin Area.
The plan is located at: XTO Energy Inc
2700 Farmington Ave., Bldg. K, Ste. 1
Farmington, NM 87401
Updated: 12/21/04

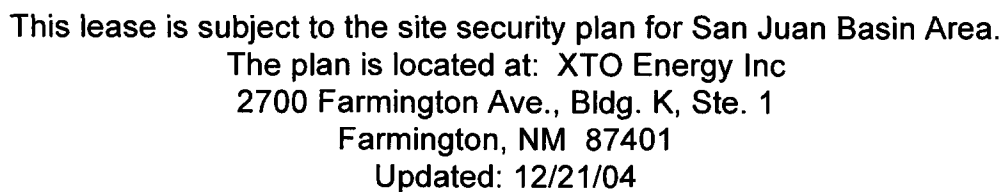

Bolack 9 #1 & Alice Bolack #5
PROPOSED ALLOCATION PROCEDURES

Base Data:

W = Gas Volume (MCF) from allocation meters at individual wells during allocation period

X = Gas Volume (MCF) from CDP sales meter during allocation period

Y = BTU's from CDP sales meter during allocation period

Allocation period is typically a calendar month & will be the same for all wells

Individual Well Gas Production = A + B + C + D + E

A = Allocated Sales Volume, MCF $(W / \text{SUM } W) \times X$

B = On lease fuel usage, MCF. Determined fr/equipment specification & operating conditions

C = Purged and/or vented gas fr/well and/or lease equipment, MCF. Calculated using equipment specifications & pressures.

D = Allocated fuel fr/gathering system equipment, MCF> The total fuel required to operate gathering system equipment will be allocated to the individual wells benefiting fr/the equipment using allocation factors determined by $W / \text{SUM } W$ for the wells involved.

E = Allocated volume of gas lost and/or vented fr/the gathering system and/or gathering system equipment, MCF. The total volume will be determined using industry accepted procedures for the conditions existing at the time of the loss. All volumes corresponding to liquid condensation within the gathering system will also be determined. The total volume lost and/or vented will be allocated to the individual wells affected using factors determined by $W / \text{SUM } W$.

Allocated individual Well BTU's = $(W \times \text{Individual well BTU}) / \text{SUM } (W \times \text{individual well BTU}) \times Y$.
Individual well gas heating values to be determined in accordance w/BLM regulations
(Onshore Order No. 5)



2700 Farmington Ave, K-1 Farmington, NM 87401
Phone: (505) 324-1090 FAX: (505) 564-6700

December 13, 2004

RE: Notice to Working and Royalty Interest Owners
Application to Surface Commingle Gas Production
San Juan County, NM

XTO Energy Inc. is applying to the New Mexico Oil Conservation Division (NMOCD) and Bureau of Land Management (BLM) for approval to surface commingle gas production from the Bolack 9 #1 and the Alice Bolack #5. The Bolack 9 #1 is a Basin Fruitland Coal well and the Alice Bolack #5 is a Kutz W Pictured Cliffs well. The NMOCD requires all interest owners be notified of plans to surface commingle when ownership is different between wells.

Produced gas from each well will be measured separately prior to being commingled. We plan to produce the commingled gas through a shared compressor. Produced liquids will not be surface commingled. In the future, additional wells, pools, and acreage may be added to this surface commingle or this gathering system. At such time, as an owner in this system, you will not be noticed as this commingle is expanded unless this method of allocating production between pools and wells changes.

If you need additional information or have any questions, I may be contacted at (505) 324-1090. If you have an objection to our application you must file a protest in writing to the NMOCD Santa Fe office at 1220 So. St. Francis Drive, Santa Fe, NM 87505 within 20 days from the date the NMOCD received the application.

Sincerely,

A handwritten signature in black ink that reads 'Holly C. Perkins'.

Holly C. Perkins
Regulatory Compliance Tech

xc: Well Files
FW Land Dept.
NMOCD, Aztec

Bolack 9 #1 & Alice Bolack #5 Surf CmgI Owner List

Harold D. Carter, Trustee
5949 Sherry Lane, Suite 1475
Dallas, TX 75225

Grover Family L.P.
Attn: Arden R. Grover
P O Box 3666
Midland, TX 79702-3666

Cooksey Family Trust
Robert A Cooksey, Trustee
4925 Greenville, Box 92
Dallas, TX 75206

Jones Family Trust
8080 N Central Suite 1420
Dallas, TX 75206

Claire S. K. Chun
& Sun Oi Chun J/T
2054 S. Beretania Street
Honolulu, HI 96826-1312

Henry W. O. Chun
2054 S. Beretania Street
Honolulu, HI 96826-1312

Amy L. Fern
719 12th Ave.
Honolulu, HI 96816-2247

Dennis Y. Y. Hew
& Jane G. K. Hew
2233 Hoonanea Street
Honolulu, HI 96822-2428

Anita C. Luke
& Charles W. W. Luke J/T
3216 Kaohinani Drive
Honolulu, HI 96817-1041

Dorothy Lyum Park
1116 A. Clio Street
Honolulu, HI 96822-2701

Bolack 9 #1 & Alice Bolack #5 Surf CmgI Owner List

Mildred O. Togikawa
1020 8th Ave. #A
Honolulu, HI 96816-2449

Thomas F. Schmidt
& Lorinna Schmidt Jtwros
2333 Kapiolani Blvd Ste 2
Honolulu, HI 96826-4400

Henry Hung Pui Chun Revocable Trust
Henry Hung Pui Chun Trustee
2137 Liliha St.reet
Honolulu, HI 96817-1639

Patsy Chun Chun Revocable Trust
Patsy Chun Chun Trustee
2137 Liliha St.reet
Honolulu, HI 96817-1639

John Lawrence Kolivas
& Deanna L. Carpenter Kolivas
2927 Hibiscus Place
Honolulu, HI 96815-4727

Alice L. Heu Revocable Living Trust
Alice L. Heu, Trustee
921 Hala Drive
Honolulu, HI 96817-2122

Emily Hee Fasick
P.O. Box 1831
Honolulu, HI 96805-1831

Bolack Minerals Company
A New Mexico Ltd Partnership
3901 Bloomfield Hwy.
Farmington, NM 87401-2831

MMS – Notify BLM

May Ruth Gaudin
525 Granada Crescent
N. Vancouver British Columbia
Canada V7N 3A7

Bolack 9 #1 & Alice Bolack #5 Surf Cmgl Owner List

W. D. Kennedy Properties Ltd
Attn: W. D. Kennedy
550 West Texas #1225
Midland, TX 79701-4257

Burlington Resources Oil & Gas
Company LP
P.O. Box 4289
Farmington, NM 87499-0656



2700 Farmington Ave, K-1 Farmington, NM 87401
Phone: (505) 324-1090 FAX: (505) 564-6700

December 17, 2004

Ms. Connie Pruitt
Farmington Daily Times
P.O. Box 450,
Farmington, NM 87499

Subject: Affidavit of Publication
Bolack 9 #1 and Alice Bolack #5 Surface Commingle

Dear Ms. Pruitt:

Please publish the following legal notice for us pertaining to surface commingle of wells in San Juan County. After publication please send a notarized Affidavit of Publication to our company at the above address. Should any further information be necessary, please do not hesitate to call me at (505) 564-6720.

Public Notice

XTO Energy Inc. is applying to the New Mexico Oil Conservation Division (NMOCD) to surface commingle gas from two wells: the Bolack 9 #1 and the Alice Bolack #5. There will not be any commingling of oil, condensate or water. The wells and the commingling facility are located in Section 9 Township 27N, Range 11W, San Juan County, New Mexico. The producing pools are the Basin Fruitland Coal and the Alice Bolack #5. Any questions should be directed to Holly Perkins at 505-564-6720 or by mail to 2700 Farmington Avenue, Suite K-1, Farmington, NM 87401. Any objection or request for a formal hearing should be filed in writing with the NMOCD's Santa Fe office within 20 days from date of this publication. In the absence of any objection, XTO has requested that the NMOCD approve its application administratively. The NMOCD's address is 1220 South St. Francis Drive, Santa Fe, NM 87505.

Sincerely,

A handwritten signature in cursive script that reads 'Holly C. Perkins'.

Holly C. Perkins
Regulatory Compliance Tech

xc: Well Files
Ft. Worth Land Dept

PAGE IN	SUSPENSE	ENGINEER	LOGGED IN	TYPE	APP NO.
---------	----------	----------	-----------	------	---------

ABOVE THIS LINE FOR DIVISION USE ONLY

NEW MEXICO OIL CONSERVATION DIVISION
- Engineering Bureau -
 1220 South St. Francis Drive, Santa Fe, NM 87505



ADMINISTRATIVE APPLICATION CHECKLIST

THIS CHECKLIST IS MANDATORY FOR ALL ADMINISTRATIVE APPLICATIONS FOR EXCEPTIONS TO DIVISION RULES AND REGULATIONS WHICH REQUIRE PROCESSING AT THE DIVISION LEVEL IN SANTA FE

Application Acronyms:

[NSL-Non-Standard Location] [NSP-Non-Standard Proration Unit] [SD-Simultaneous Dedication]
[DHC-Downhole Commingling] [CTB-Lease Commingling] [PLC-Pool/Lease Commingling]
[PC-Pool Commingling] [OLS - Off-Lease Storage] [OLM-Off-Lease Measurement]
[WFX-Waterflood Expansion] [PMX-Pressure Maintenance Expansion]
[SWD-Salt Water Disposal] [IPI-Injection Pressure Increase]
[EOR-Qualified Enhanced Oil Recovery Certification] [PPR-Positive Production Response]

[1] TYPE OF APPLICATION - Check Those Which Apply for [A]

[A] Location - Spacing Unit - Simultaneous Dedication
☐ NSL ☐ NSP ☐ SD

Check One Only for [B] or [C]

[B] Commingling - Storage - Measurement
☐ DHC ☐ CTB ☐ PLC ☒ PC ☐ OLS ☐ OLM

[C] Injection - Disposal - Pressure Increase - Enhanced Oil Recovery
☐ WFX ☐ PMX ☐ SWD ☐ IPI ☐ EOR ☐ PPR

[D] Other: Specify _____

[2] NOTIFICATION REQUIRED TO: - Check Those Which Apply, or ☐ Does Not Apply

[A] ☒ Working, Royalty or Overriding Royalty Interest Owners

[B] ☐ Offset Operators, Leaseholders or Surface Owner

[C] ☐ Application is One Which Requires Published Legal Notice

[D] ☒ Notification and/or Concurrent Approval by BLM or SLO
 U.S. Bureau of Land Management - Commissioner of Public Lands, State Land Office

[E] ☐ For all of the above, Proof of Notification or Publication is Attached, and/or,

[F] ☐ Waivers are Attached

[3] SUBMIT ACCURATE AND COMPLETE INFORMATION REQUIRED TO PROCESS THE TYPE OF APPLICATION INDICATED ABOVE.

[4] CERTIFICATION: I hereby certify that the information submitted with this application for administrative approval is **accurate** and **complete** to the best of my knowledge. I also understand that **no action** will be taken on this application until the required information and notifications are submitted to the Division.

Note: Statement must be completed by an individual with managerial and/or supervisory capacity.

HOLLY C. PERKINS
 Print or Type Name

Signature

REGULATORY COMPLIANCE TECH 12/20/04
 Title Date

Holly_perkins@xtoenergy.com
 e-mail Address