

A33 *Samy*  
N.M. Oil Conservation District 2  
UNITED STATES 301 W. Grant Avenue  
DEPARTMENT OF THE INTERIOR  
BUREAU OF LAND MANAGEMENT  
Artesia, NM 88210FORM APPROVED  
OMB NO. 1004-0136  
Expires: February 28, 1995

## APPLICATION FOR PERMIT TO DRILL OR DEEPEN

## 1a. TYPE OF WORK

DRILL ☒DEEPEN ☐

## b. TYPE OF WELL

OIL WELL ☐GAS WELL ☒OTHER ☐SINGLE ZONE ☒MULTIPLE ZONE ☐

## 2. NAME OF OPERATOR

Energy Prod Co LP 6137  
DEVON - SPS OPERATING INC. (WALLY FRANK 405-552-4595)

## 3. ADDRESS AND TELEPHONE NO.

20 NORTH BROADWAY SUITE 1500  
OKLAHOMA CITY, OKLAHOMA 73102-8260 (405-552-4595)

## 4. LOCATION OF WELL (Report location clearly and in accordance with any State requirements.)

At surface

1790' FNL & 2170' FEL SEC. 8 T22S-R24E EDDY CO. ut. G  
At proposed prod. zone BHL. 1980' FSL & 1980' FEL SEC. 8 T22S-R24E

## 14. DISTANCE IN MILES AND DIRECTION FROM NEAREST TOWN OR POST OFFICE

Approximately 30 miles Northwest of Carlsbad, New Mexico.

## 15. DISTANCE FROM PROPOSED

LOCATION TO NEAREST  
PROPERTY OR LEASE LINE, FT. 1980'  
(Also to nearest drilg. unit line, if any)18. DISTANCE FROM PROPOSED LOCATION  
TO NEAREST WELL, DRILLING, COMPLETED, 1800'  
OR APPLIED FOR, ON THIS LEASE, FT.16. NO. OF ACRES IN LEASE  
64019. PROPOSED DEPTH  
MD 9904 TVD 8600'17. NO. OF ACRES ASSIGNED  
TO THIS WELL 32020. ROTARY OR CABLE TOOLS  
ROTARY

21. ELEVATIONS (Show whether DF, RT, GR, etc.) 4290' GR.

SUBJECT TO LIKE APPROVAL BY STATE

22. APPROX. DATE WORK WILL START  
WHEN APPROVED

## PROPOSED CASING AND CEMENTING PROGRAM

SIZE OF HOLE	GRADE SIZE OF CASING	WEIGHT PER FOOT	SETTING DEPTH	QUANTITY OF CEMENT
25"	Conductor	NA	40'	Cement to surface with Redi-mix
12 1/4"	H-40 9 5/8"	36	1600'	600 Sx. circulate cement
8 3/4"	HCL-80, L-80 7"	23	9904'	500 Sx. estimate TOC 6400'

1. Drill 25" hole to 40'. Set 40' of 20" conductor pipe and cement to surface with Redi-mix.
2. Drill 12 1/4" hole to 1600'. Run and set 1600' of 9 5/8" H-40 36# ST&C casing. Cement with 400 Sx. of 35/65 Class "C" POZ, + 2% CaCl, + 1/2# Celo flakes/Sx. + + 3#/Sx. of Kol Seal, + 6% Bentonite, tail in with 200 Sx. of Class "C" cement + 2% CaCl, + 1/2# Celo flakes/Sx. Circulate cement to surface.
3. Drill 8 3/4" hole to 9904'. Run and set 9904' of 7" casing as follows: 2404' of 7" 23# HCL-80 LT&C, 7500' of 7" 23# L-80 LT&C casing. Cement with 500 Sx. of Class "C" 15/61/11 Class "C" cement + 5#/Sx. of LCM-1, + 2% CaCl, + 1% EC-1, + .6% FL-25, + .6% FL-52, + .3% CD-32, + .3% Sodium Metasilicate, + 1/2# Celo flakes/Sx. Estimate top of cement 6400'.

Controlled Controlled Water Basin

APPROVAL SUBJECT TO  
GENERAL REQUIREMENTS AND  
SPECIAL STIPULATIONS

ATTACHED

IN ABOVE SPACE DESCRIBE PROPOSED PROGRAM: If proposal is to deepen, give data on present productive zone and proposed new productive zone. If proposal is to drill or deepen directionally, give pertinent data on subsurface locations and measured and true vertical depths. Give blowout prevention program, if any.

24.

SIGNED

Agent

DATE 10/16/02

(This space for Federal or State office use)

PERMIT NO.

APPROVAL DATE

Application approval does not warrant or certify that the applicant holds legal or equitable title to those rights in the subject lease which would entitle the applicant to conduct operations thereon.

CONDITIONS OF APPROVAL: JOE G. LARA

APPROVED BY

TITLE

FIELD MANAGER

DATE

\*See Instructions On Reverse Side

Title 18 U.S.C. Section 1001, makes it a crime for any person knowingly and willfully to make to any department or agency of the

# State of New Mexico

Energy, Minerals and Natural Resources Department

## DISTRICT I

P.O. Box 1980, Hobbs, NM 88241-1980

## DISTRICT II

P.O. Drawer 110, Artesia, NM 88211-0710

## DISTRICT III

1000 Rio Brazos Rd., Aztec, NM 87410

## DISTRICT IV

P.O. Box 2088, Santa Fe, N.M. 87504-2088

# OIL CONSERVATION DIVISION

P.O. Box 2088

Santa Fe, New Mexico 87504-2088

Form C-102

Revised February 10, 1994

Submit to Appropriate District Office

State Lease - 4 Copies

Fee Lease - 3 Copies

## WELL LOCATION AND ACREAGE DEDICATION PLAT

☐ AMENDED REPORT

API Number	Pool Code	Pool Name
	33685	INDIAN BASIN UPPER PENN (ASSOC)
Property Code	Property Name	Well Number
16875	OLD RANCH KNOLL "8" FEDERAL	7
OGRID No.	Operator Name	Elevation
20305	DEVON SFS OPERATING, INC.	4290'

### Surface Location

UL or lot No.	Section	Township	Range	Lot Idn	Feet from the	North/South line	Feet from the	East/West line	County
G	8	22-S	24-E		1790'	NORTH	2170'	EAST	EDDY

### Bottom Hole Location If Different From Surface

UL or lot No.	Section	Township	Range	Lot Idn	Feet from the	North/South line	Feet from the	East/West line	County
J	8	22-S	24-E		1980'	SOUTH	1980'	EAST	EDDY

Dedicated Acres	Joint or Infill	Consolidation Code	Order No.
320			

NO ALLOWABLE WILL BE ASSIGNED TO THIS COMPLETION UNTIL ALL INTERESTS HAVE BEEN CONSOLIDATED OR A NON-STANDARD UNIT HAS BEEN APPROVED BY THE DIVISION

	<h3>OPERATOR CERTIFICATION</h3> <p>I hereby certify that the information contained herein is true and complete to the best of my knowledge and belief.</p> <p><i>Joe T. Janica</i> Signature</p> <p>Joe T. Janica Printed Name</p> <p>Agent</p> <p>Title</p> <p>10/16/02 Date</p>
	<h3>SURVEYOR CERTIFICATION</h3> <p>I hereby certify that the well location shown on this plat was plotted from field notes of actual surveys made by me or under my supervision, and that the same is true and correct to the best of my belief.</p> <p>SEPTEMBER 25, 2002</p> <p>Date Surveyed</p> <p>Signature &amp; Seal of Professional Surveyor</p> <p>RONALD E. EDSON Professional Surveyor</p> <p>9/26/02 02.11.0704</p> <p>Certificate No. RONALD E. EDSON 3239 GAR E. EDSON 12841</p>

EXHIBIT "A"

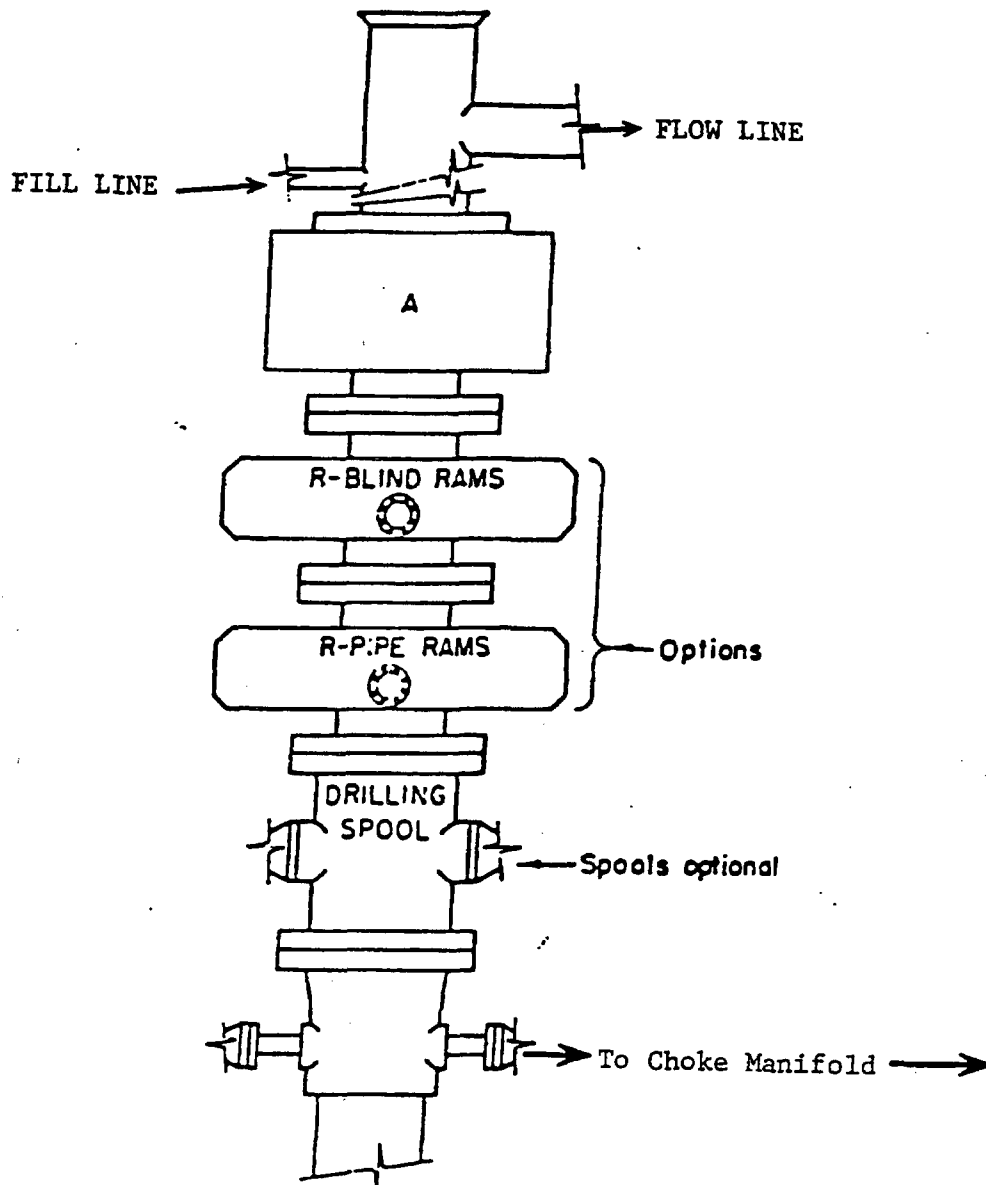

# **ARRANGEMENT SRRA**

900 Series  
3000 PSI WP

EXHIBIT "E"  
SKETCH OF B.O.P. TO BE USED O

DEVON-SFS OPERATING, INC.  
OLD RANCH KNOLL "8" FEDERAL #  
UNIT "J" SECTION  
T22S-R24E EDDY CO. N

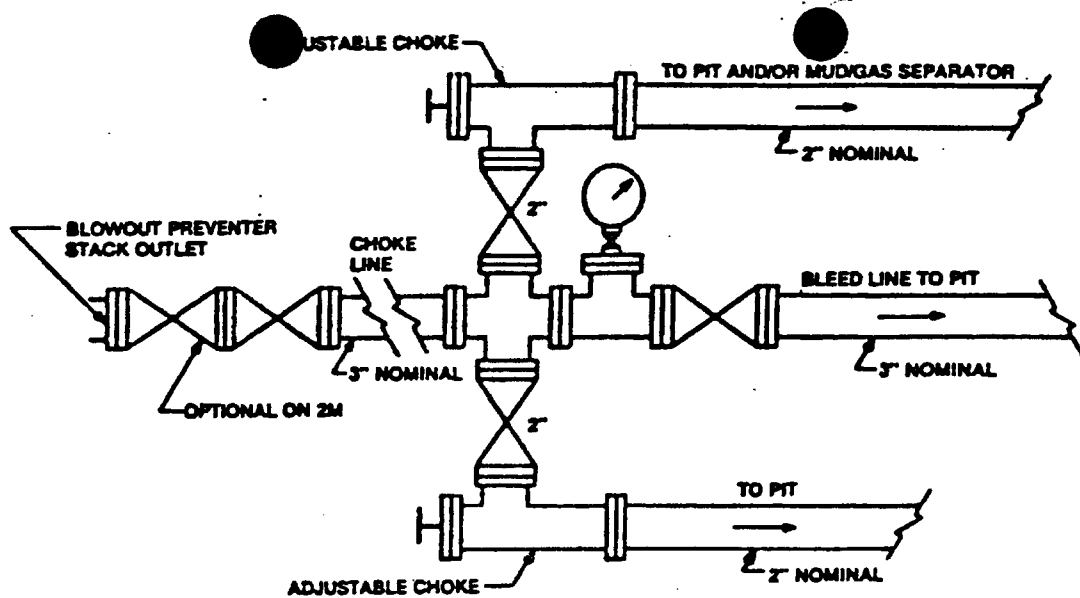

Typical choke manifold assembly for 3M WP system

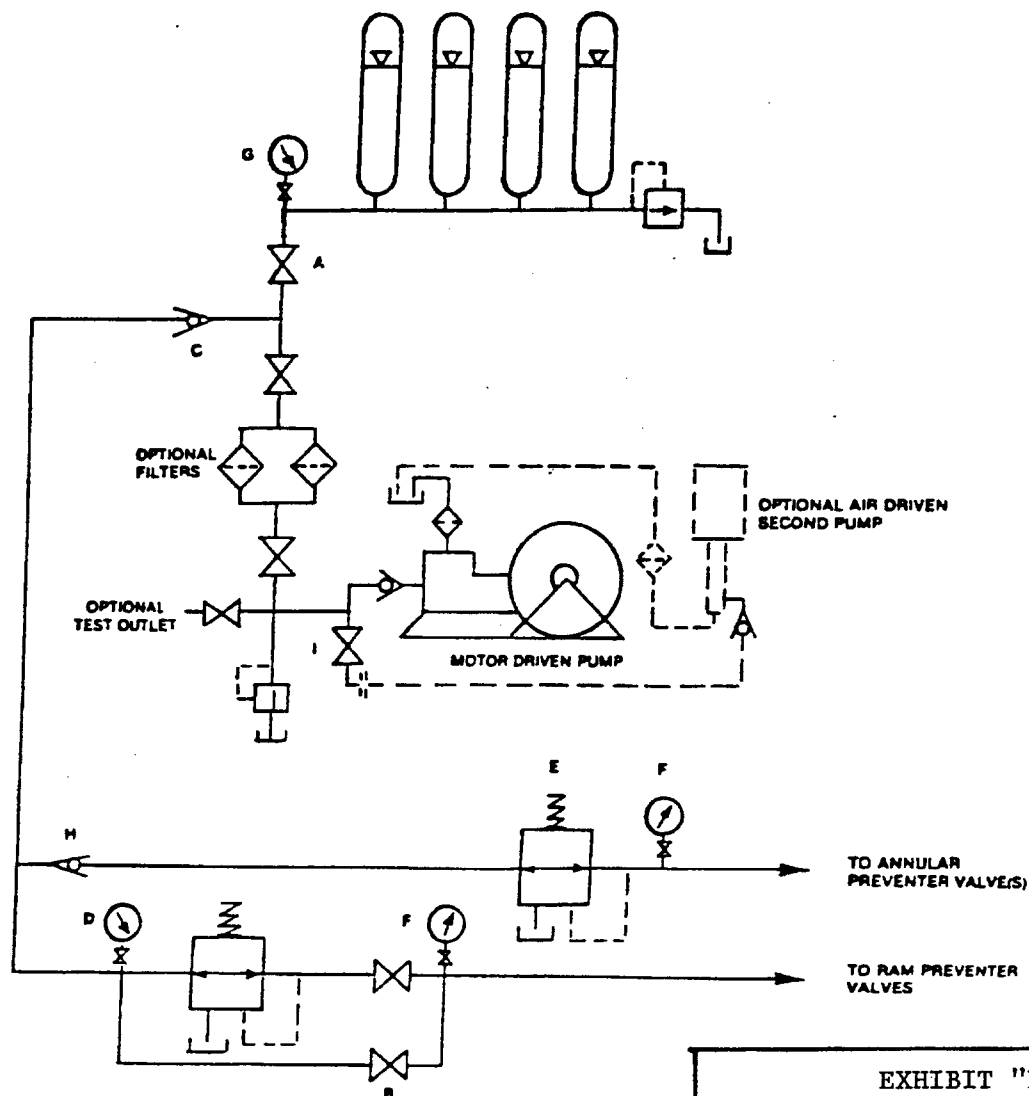

EXHIBIT "E-1"  
CHOKE MANIFOLD & CLOSING UNIT

DEVON-SFS OPERATING, INC.  
OLD RANCH KNOLL "8" FEDERAL #  
UNIT "J" SECTION  
T22S-R24E EDDY CO. 1

A-33 *Bunny*  
N.M. Oil Cons. DIV. 2  
UNITED STATES 301 W. GATE AVENUE  
DEPARTMENT OF THE INTERIOR  
Alamogordo, NM 88210  
BUREAU OF LAND MANAGEMENTFORM APPROVED  
OMB NO. 1004-0136  
Expires: February 28, 1995

## APPLICATION FOR PERMIT TO DRILL OR DEEPEN

## 1a. TYPE OF WORK

DRILL ☒DEEPEN ☐

## b. TYPE OF WELL

OIL WELL ☐GAS WELL ☒OTHER ☐SINGLE ZONE ☒MULTIPLE ZONE ☐

## 2. NAME OF OPERATOR

Energy Prod Co LP 6137  
DEVON - SPS OPERATING, INC. (WALLY FRANK 405-552-4595)

## 3. ADDRESS AND TELEPHONE NO.

20 NORTH BROADWAY SUITE 1500  
OKLAHOMA CITY, OKLAHOMA 73102-8260 (405-552-4595)

## 4. LOCATION OF WELL (Report location clearly and in accordance with any State requirements.)

At surface

1790' FNL & 2170' FEL SEC. 8 T22S-R24E EDDY CO. ut. G  
At proposed prod. zone BHL. 1980' FSL & 1980' FEL SEC. 8 T22S-R24E

## 14. DISTANCE IN MILES AND DIRECTION FROM NEAREST TOWN OR POST OFFICE\*

Approximately 30 miles Northwest of Carlsbad, New Mexico.

## 15. DISTANCE FROM PROPOSED\*

LOCATION TO NEAREST  
PROPERTY OR LEASE LINE, FT. 1980'

(Also to nearest drig. unit line, if any)

15. DISTANCE FROM PROPOSED LOCATION\*  
TO NEAREST WELL, DRILLING, COMPLETED,  
OR APPLIED FOR, ON THIS LEASE, FT. 1800'

## 16. NO. OF ACRES IN LEASE

640

17. NO. OF ACRES ASSIGNED  
TO THIS WELL

320

19. PROPOSED DEPTH

MD 9904 TVD 8600'

## 20. ROTARY OR CABLE TOOLS

ROTARY

## 21. ELEVATIONS (Show whether DF, RT, GR, etc.)

4290' GR.

SUBJECT TO LIKE APPROVAL BY STATE

## 22. APPROX. DATE WORK WILL START\*

WHEN APPROVED

## 23. PROPOSED CASING AND CEMENTING PROGRAM

SIZE OF HOLE	GRADE, SIZE OF CASING	WEIGHT PER FOOT	SETTING DEPTH	QUANTITY OF CEMENT
25"	Conductor	NA	40'	Cement to surface with Redi-mix
12 1/4"	H-40 9 5/8"	36	1600'	600 Sx. circulate cement
8 3/4"	HCL-80, L-80 7"	23	9904'	500 Sx. estimate TOC 6400'

1. Drill 25" hole to 40'. Set 40' of 20" conductor pipe and cement to surface with Redi-mix.
2. Drill 12 1/4" hole to 1600'. Run and set 1600' of 9 5/8" H-40 36# ST&C casing. Cement with 400 Sx. of 35/65 Class "C" POZ, + 2% CaCl, + 1/4# Celo flakes/Sx. + 3#/Sx. of Kol Seal, + 6% Bentonite, tail in with 200 Sx. of Class "C" cement + 2% CaCl, + 1/4# Celo flakes/Sx. Circulate cement to surface.
3. Drill 8 3/4" hole to 9904'. Run and set 9904' of 7" casing as follows: 2404' of 7" 23# HCL-80 LT&C, 7500' of 7" 23# L-80 LT&C casing. Cement with 500 Sx. of Class "C" 15/61/11 Class "C" cement + 5#/Sx. of LCM-1, + 2% CaCl, + 1% EC-1, + .6% FL-25, + .6% FL-52, + .3% CD-32, + .3% Sodium Metasilicate, + 1/4# Celo flakes/Sx. Estimate top of cement 6400'.

Carlsbad Controlled Water Basin

APPROVAL SUBJECT TO  
GENERAL REQUIREMENTS AND  
SPECIAL STIPULATIONS

ATTACHED

IN ABOVE SPACE DESCRIBE PROPOSED PROGRAM: If proposal is to deepen, give data on present productive zone and proposed new productive zone. If proposal is to drill or deepen directionally, give pertinent data on subsurface locations and measured and true vertical depths. Give blowout prevention program, if any.

24.

SIGNED

TITLE Agent

DATE 10/16/02

(This space for Federal or State office use)

PERMIT NO.

APPROVAL DATE

Application approval does not warrant or certify that the applicant holds legal or equitable title to those rights in the subject lease which would entitle the applicant to conduct operations thereon.

CONDITIONS OF APPROVAL: JOE G. LARA

APPROVED BY

TITLE

DATE

\*See Instructions On Reverse Side

## State of New Mexico

Energy, Minerals and Natural Resources Department

## DISTRICT I

P.O. Box 1980, Hobbs, NM 88241-1980

## DISTRICT II

P.O. Drawer DD, Artesia, NM 88211-0719

## DISTRICT III

1000 Rio Brazos Rd., Aztec, NM 87410

## DISTRICT IV

P.O. BOX 2088, SANTA FE, N.M. 87504-2088

## OIL CONSERVATION DIVISION

P.O. Box 2088

Santa Fe, New Mexico 87504-2088

Form C-102

Revised February 10, 1994

Submit to Appropriate District Office

State Lease - 4 Copies

Fee Lease - 3 Copies

## WELL LOCATION AND ACREAGE DEDICATION PLAT

☐ AMENDED REPORT

API Number	Pool Code	Pool Name
	33685	INDIAN BASIN UPPER PENN (ASSOC)
Property Code	Property Name	Well Number
16875	OLD RANCH KNOLL "8" FEDERAL	7
OGRID No.	Operator Name	Elevation
20305	DEVON SFS OPERATING, INC.	4290'

## Surface Location

UL or lot No.	Section	Township	Range	Lot Idn	Feet from the	North/South line	Feet from the	East/West line	County
G	8	22-S	24-E		1790'	NORTH	2170'	EAST	EDDY

## Bottom Hole Location If Different From Surface

UL or lot No.	Section	Township	Range	Lot Idn	Feet from the	North/South line	Feet from the	East/West line	County
J	8	22-S	24-E		1980'	SOUTH	1980'	EAST	EDDY

Dedicated Acres	Joint or Infill	Consolidation Code	Order No.
320			

NO ALLOWABLE WILL BE ASSIGNED TO THIS COMPLETION UNTIL ALL INTERESTS HAVE BEEN CONSOLIDATED  
OR A NON-STANDARD UNIT HAS BEEN APPROVED BY THE DIVISION

	<b>OPERATOR CERTIFICATION</b>  I hereby certify the the information contained herein is true and complete to the best of my knowledge and belief.   Signature  Joe T. Janica Printed Name  Agent Title 10/16/02 Date
	<b>SURVEYOR CERTIFICATION</b>  I hereby certify that the well location shown on this plat was plotted from field notes of actual surveys made by me or under my supervision, and that the same is true and correct to the best of my belief.  SEPTEMBER 25, 2002 Date Surveyed AWB Signature Professional Surveyor  9/26/02 Certificate No. RONALD J. EDSON 3239 GARY EIDSON 12641

EXHIBIT "A"

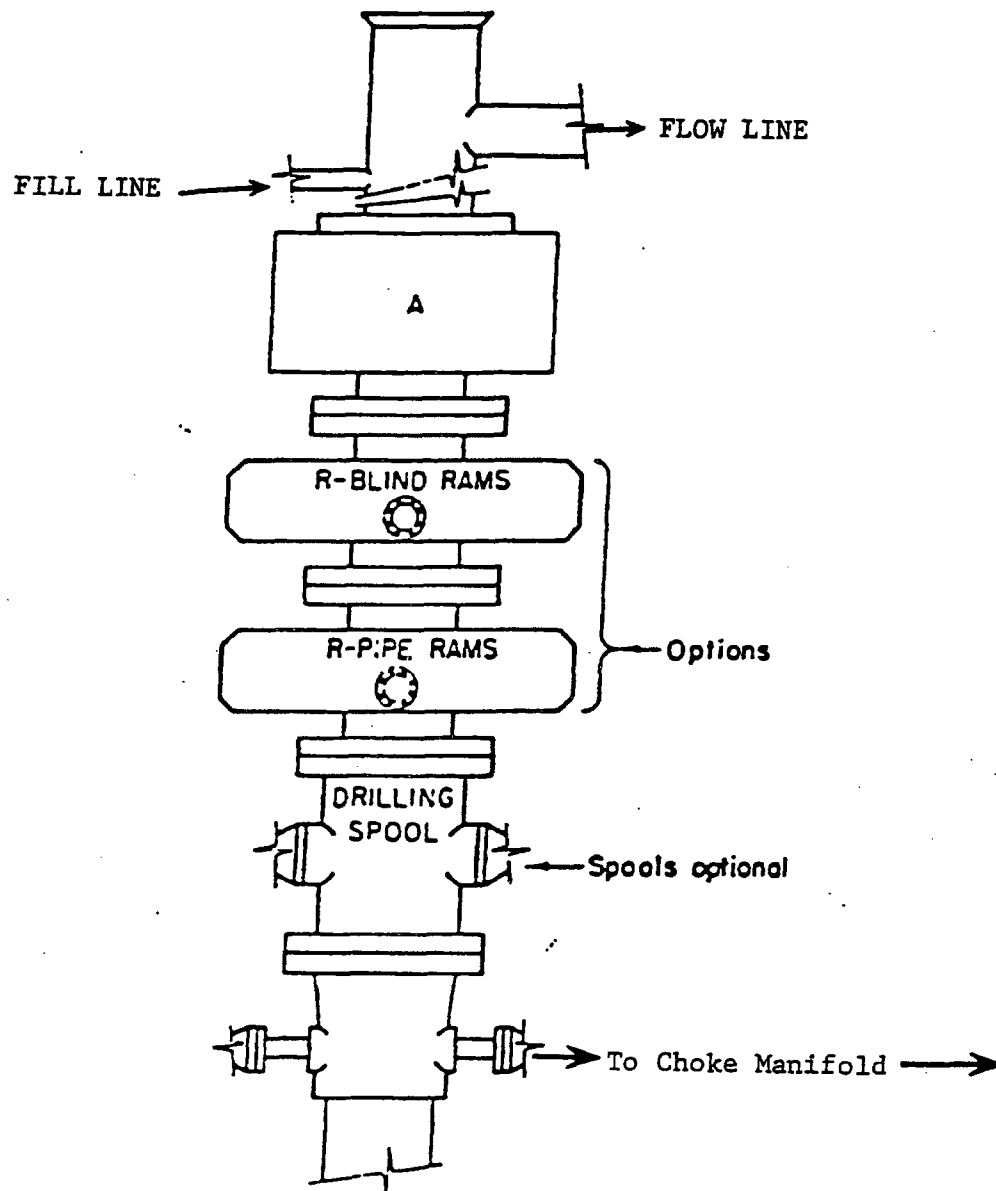

# **ARRANGEMENT SRRA**

900 Series  
3000 PSI WP

EXHIBIT "E"  
SKETCH OF B.O.P. TO BE USED ON

DEVON-SFS OPERATING, INC.  
OLD RANCH KNOLL "8" FEDERAL #  
UNIT "J" SECTION 8  
T22S-R24E EDDY CO. NE

DISTRICT I  
P.O. Box 1980, Hobbs, NM 88241-1980

DISTRICT II  
P.O. Drawer DD, Artesia, NM 88211-0719

DISTRICT III  
1000 Rio Brazos Rd., Aztec, NM 87410

DISTRICT IV  
P.O. BOX 2088, SANTA FE, N.M. 87504-2088

State of New Mexico  
Energy, Minerals and Natural Resources Department

OIL CONSERVATION DIVISION

P.O. Box 2088  
Santa Fe, New Mexico 87504-2088

FILE COPY  
Form C-102  
Revised February 10, 1994  
Submit to Appropriate District Office  
State Lease - 4 Copies  
Fee Lease - 3 Copies

WELL LOCATION AND ACREAGE DEDICATION PLAT  
Change unit configuration  
X AMENDED REPORT

API Number 30-015- <b>39621</b>	Pool Code 33685	Pool Name Indian Basin (Upper Penn) Assoc.
Property Code 16875	Property Name OLD RANCH KNOLL 8 FEDERAL	Well Number 7
OGRID No. 6137	DEVON ENERGY PRODUCTION Operator Name COMPANY, L.P. <del>DEVON-SFS-OPERATING, INC.</del>	Elevation 4290'

Surface Location

UL or lot No.	Section	Township	Range	Lot Idn	Feet from the	North/South line	Feet from the	East/West line	County
G	8	22-S	24-E		1790'	NORTH	2170'	EAST	EDDY

Bottom Hole Location If Different From Surface

UL or lot No.	Section	Township	Range	Lot Idn	Feet from the	North/South line	Feet from the	East/West line	County
J	8	22-S	24-E		1980'	SOUTH	1980'	EAST	EDDY

Dedicated Acres 320	Joint or Infill	Consolidation Code	Order No.
------------------------	-----------------	--------------------	-----------

NO ALLOWABLE WILL BE ASSIGNED TO THIS COMPLETION UNTIL ALL INTERESTS HAVE BEEN CONSOLIDATED  
OR A NON-STANDARD UNIT HAS BEEN APPROVED BY THE DIVISION

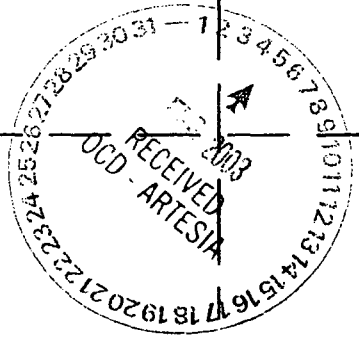
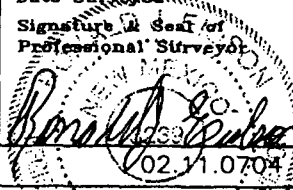
  <p>SURF. LOC. GEODETIC COORDINATES NAD 1927 NME Y=512075.8 X=442878.0 LAT. 32°24'27.63"N LONG. 104°31'06.33"W</p> <p>B.H. LOC.</p>	<p>OPERATOR CERTIFICATION</p> <p>I hereby certify that the information contained herein is true and complete to the best of my knowledge and belief.</p> <p><u>Candace R. Graham</u> Signature</p> <p>Candace R. Graham Printed Name</p> <p>Engineering Tech. Title</p> <p>November 20, 2002 Date</p> <p>SURVEYOR CERTIFICATION</p> <p>I hereby certify that the well location shown on this plat was plotted from field notes of actual surveys made by me or under my supervision, and that the same is true and correct to the best of my belief.</p> <p>SEPTEMBER 25, 2002</p> <p>Date Surveyed: _____ AWB</p> <p>Signature &amp; Seal of Professional Surveyor</p> <p> 9/26/02 02.11.0704</p> <p>Certificate No. RONALD E. EIDSON 3239 CARY EIDSON 12641</p>
--	--

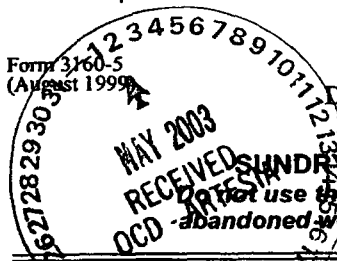

Form 3160-5  
(August 1999)

UNITED STATES

DEPARTMENT OF THE INTERIOR  
BUREAU OF LAND MANAGEMENT

Oil Cons.

N.M. DIV-Dist. 2

1801 W. Grand Avenue  
Alamogordo, NM 88210FORM APPROVED  
OMB No. 1004-0135  
Expires November 30, 2000

5. Lease Serial No.

NM-NM81220

6. If Indian, Allottee or Tribe Name

N/A

7. If Unit or CA/Agreement, Name and/or No.

N/A

8. Well Name and No.

Old Ranch Knoll 8 Federal Com. #7

9. API Well No.

30-015-32621

10. Field and Pool, or Exploratory Area

Indian Basin (Upper Penn) Assoc.

11. County or Parish, State

Eddy Cnty,  
New Mexico

1. Type of Well

☐ Oil Well ☒ Gas Well ☐ Other

2. Name of Operator

Devon Energy Production Company, L.P.

Wally Frank

Senior Operations Engr.

3a. Address

20 N. Broadway, Ste 1500, OKC, OK 73102

3b. Phone No. (include area code)

(405)552-4595

4. Location of Well (Footage, Sec., T., R., M., or Survey Description)

SHL: 1790' FNL &amp; 2170' FEL, Unit G, Section 8-T22S-R24E, Eddy Cnty, NM

BHL: 1980' FSL &amp; 1980' FEL, Unit J, Section 8-T22S-R24E, Eddy Cnty, NM

## 12. CHECK APPROPRIATE BOX(ES) TO INDICATE NATURE OF NOTICE, REPORT, OR OTHER DATA

TYPE OF SUBMISSION	TYPE OF ACTION			
<input type="checkbox"/> Notice of Intent	<input type="checkbox"/> Acidize	<input type="checkbox"/> Deepen	<input type="checkbox"/> Production (Start/ Resume)	<input type="checkbox"/> Water Shut-Off
<input checked="" type="checkbox"/> Subsequent Report	<input type="checkbox"/> Alter Casing	<input type="checkbox"/> Fracture Treat	<input type="checkbox"/> Reclamation	<input type="checkbox"/> Well Integrity
<input type="checkbox"/> Final Abandonment Notice	<input type="checkbox"/> Casing Repair	<input type="checkbox"/> New Construction	<input type="checkbox"/> Recomplete	<input checked="" type="checkbox"/> Other <u>spud,</u>
	<input type="checkbox"/> Change Plans	<input type="checkbox"/> Plug and Abandon	<input type="checkbox"/> Temporarily Abandon	<u>casing strings,</u>
	<input type="checkbox"/> Convert to Injection	<input type="checkbox"/> Plug Back	<input type="checkbox"/> Water Disposal	<u>WOCU</u>

13. Describe Proposed or Completed Operation (clearly state all pertinent details, including estimated starting date of any proposed work and approximate duration thereof. If the proposal is to deepen directionally or recompleat horizontally, give subsurface locations measured and true vertical depths of all pertinent markers and zones. Attach the Bond under which the work will be performed or provide the Bond No. on file with BLM/BIA. Required subsequent reports shall be filed within 30 days following completion of the involved operations. If the operation results in a multiple completion or recompleat in a new interval, a Form 3160-4 shall be filed once testing has been completed. Final Abandonment Notices shall be filed only after all requirements, including reclamation, have been completed, and the operator has determined that the site is ready for final inspection.)

3-15-2003 thru 4-14-2003 This well spud at 0000 hrs on 3-14-2003. Alternately drld with hammer bit and standard bit to 1015' (losing returns, boulders sloughing in hole, set lost circulation cement plugs thru windows cut in conductor pipe). At 410' pumped in 288 sx Class H. Drld cement, washed, reamed, circulated, pumped sweeps.

Ran (and washed down hole) 10 jts 13 3/8" 68# N-80 ST&C casing on 3-24-2003, set at 410'; dumped 4 yds Redi-mix down backside of 13 3/8". WOC 14 hrs.

Drld 12 1/4" hole to 1603'. On 3-26-2003 ran 35 jts 9 5/8" 36# J-55 ST&C casing, set at 1603'; cemented with 400 sx 35/65 Poz C + 200 sx Class C. Ran Temp Svy which showed TOC at 304'. Down 1" tubing (on annulus of 9 5/8" casing) topped cement with 280 sx Class C. WOC 19 hrs. RU H2S equipment. Drld formation to 1613' and press tested to 150 psi or 10.13 EMW.

(Continued on the reverse.)

14. I hereby certify that the foregoing is true and correct

Name (Printed/Typed)

Candace R. Graham 405/235-3611 X4520

Signature

Candace R. Graham

Title

Engineering Tech.

Date

04/23/2003

ACCEPTED FOR RECORD

APR 28 2003

ALEXIS C. SWOBODA  
PETROLEUM ENGINEER

THIS SPACE FOR FEDERAL OR STATE OFFICE USE

Approved by

Title

Date

Conditions of approval, if any, are attached. Approval of this notice does not warrant or certify that the applicant holds legal or equitable title to those rights in the subject lease which would entitle the applicant to conduct operations thereon.

Office

Title 18 U.S.C. Section 1001, makes it a crime for any person knowingly and willfully to make to any department or agency of the United States any false, fictitious or fraudulent statements or representations as to any matter within its jurisdiction.

(Instructions on reverse)

Devon Energy Production Company, L.P.

API 30-015-32621, BLM #NM-NM81220

Old Ranch Knoll "8" Federal Com. #7

SHL: 1790' FNL & 2170' FEL, Unit G, Section 8-T22S-R24E, Eddy Cnty, NM

BHL: 1980' FSL & 1980' FEL, Unit J, Section 8-T22S-24E, Eddy Cnty, NM

Drilling Sundry 3160-5

April 23, 2003

Page 2

RECEIVED

2003 APR 28 AM 7:40

BUREAU OF LAND MGMT  
ROSSELL OFFICE

3-15-2003 thru 4-14-2003 (Continued from the front)

Drld 8 3/4" hole. Reached kick-off point at 4000' on 3-30-2003. Reached TD 9040' at 1500 hrs on 4-11-2003. Schlumberger ran Platform Express Three Detector Litho-Density Compensated Neutron/NGT and Azimuthal Laterolog MCFL/NGT logs. Circ'd and conditioned hole.

Ran 211 jts 7" 23# HCL-80 and J-55 LT&C casing on 4-13-2003; casing set at 9040', DV tool at 8299', ESP 8345'; cemented: 1st stage with 175 sx Class H, preceded by 1000 gals Superbond III; 2nd stage with 450 sx 60/40 Pozmix C, preceded by 1000 gals Mud Clean II.

Released rig at 0500 hrs 4-14-2003. WOCU.