

NSL 1/6/99

AMERADA HESS CORPORATION

P. O. BOX 840
SEMINOLE, TEXAS 79360

915-758-6700

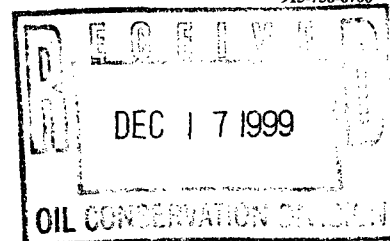

December 14, 1999

Attn: Lori Wrotenbery
State of New Mexico
Energy, Minerals and Natural Resources Department
Oil Conservation Division
2040 South Pacheco Street
Santa Fe, New Mexico 87505-5472

Re: Administrative Application for Non-Standard
Location & Simultaneous Dedication
State "Q" Well No. 1
API No. 30-025-06116
Lea County, New Mexico

Dear Ms. Wrotenbery,

Amerada Hess Corporation respectfully request administrative approval for a Non-Standard Location and for Simultaneous Dedication of State "Q" Well No. 1 located in Unit J, (1980' FSL, 2310' FEL), Sec. 16, T20S, R37E, Lea County, New Mexico. Well will be producing from Eumont Prorated Gas Pool.

State "Q" Well No. 1 is currently completed in Monument Paddock with plans to re-enter and downhole commingle well in Eumont, Grayburg, and Paddock Zones.

The State "Q" Lease was approved as a 160 acre non-standard proration unit in the SE Quarter of Sec. 16, T20S, R37E, Lea County, N.M. by order in 1953. This acreage will be shared by Well No. 2 located in Unit I, (1980' FSL, 990' FEL), Sec. 16, T20S, R37E, and Well No. 3 located in Unit O, (660' FSL, 1980' FEL), Sec. 16, T20S, R37E.

Attached are a well location map, plat, off-set operator listing, and waiver request. A copy of application has been forwarded by certified mail to offset operators.

If we can furnish additional information, please let us know at your earliest convenience.

Sincerely,

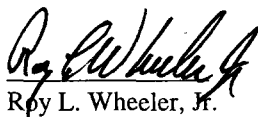

Roy L. Wheeler, Jr.

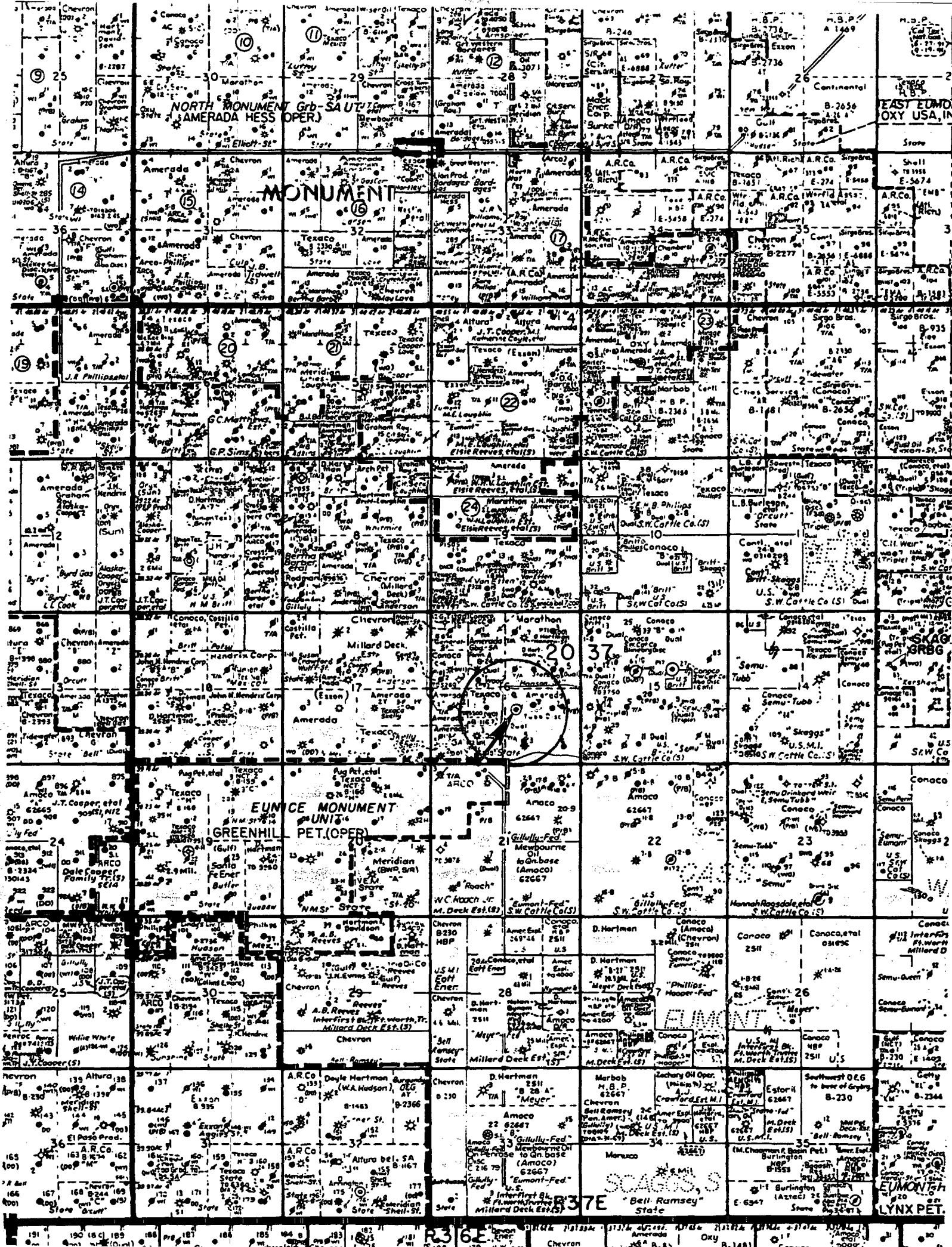
Xc: Mr. Chris Williams - NMOCD, Hobbs
Robert L. Williams, Jr.
Duwayne Perry

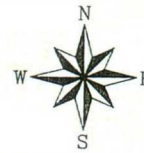

EUMONT FIELD
LEA COUNTY, NEW MEXICO

ONSHORE PRODUCTION
MONUMENT AREA
SEMINOLE DISTRICT



R-37-E

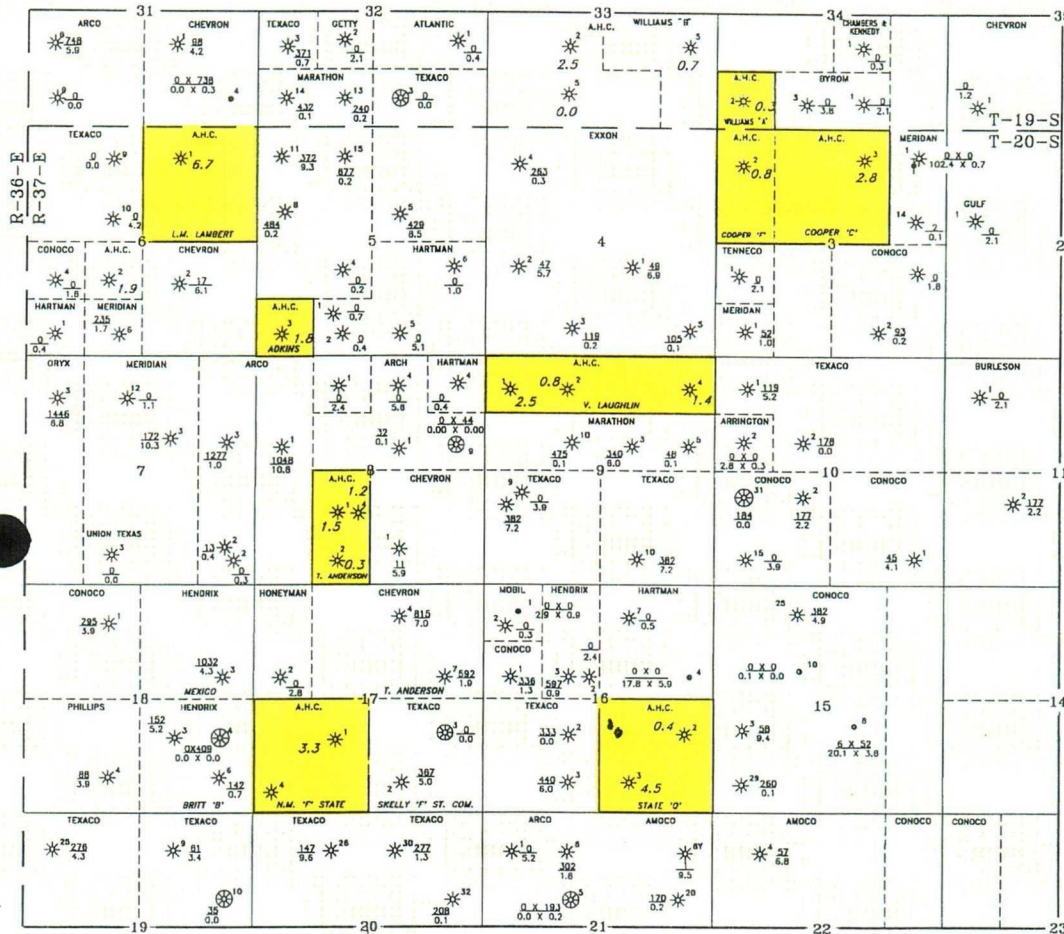

WELL INFORMATION

LEASE INFORMATION

- OIL WELL BOPD X MCFPD
MBO X BCF
- TA'D
- P & A
- ★ GAS WELL MCFPD
BCF
- AHC CUMULATIVE - BCF

AHC FULL

AMERADA HESS CORPORATIC

BASE MAP
FIGURE 3

JULY, 1996
PRU3-B.DWG

Page

OIL CONSERVATION DIVISION
2040 South Pacheco
Santa Fe, NM 87505

Submit to Appropriate District Office
State Lease - 4 Copies
Fee Lease - 3 Copies

AMENDED REPORT

WELL LOCATION AND ACREAGE DEDICATION PLAT

¹ API Number 30-025-06116	² Pool Code 76480	³ Pool Name Eumont Yates 7RQ
⁴ Property Code 000206	⁵ Property Name State "Q"	⁶ Well Number 1
⁷ OGRID No. 000495	⁸ Operator Name Amerada Hess Corporation	⁹ Elevation 3545' DF

10 Surface Location

UL or lot no.	Section	Township	Range	Lot. Idn	Feet from the	North/South Line	Feet from the	East/West line	County
J	16	20S	37E		1980	South	2310	East	Lea

11 Bottom Hole Location If Different From Surface

UL or lot no.	Section	Township	Range	Lot. Idn	Feet from the	North/South Line	Feet from the	East/West line	County
¹² Dedicated Acres 160	¹³ Joint or Infill	¹⁴ Consolidation Code		¹⁵ Order No.					

**NO ALLOWABLE WILL BE ASSIGNED TO THIS COMPLETION UNTIL ALL INTERESTS HAVE BEEN CONSOLIDATED
OR A NON-STANDARD UNIT HAS BEEN APPROVED BY THE DIVISION**

	<p align="center">17 OPERATOR CERTIFICATION</p> <p><i>I hereby certify that the information contained herein is true and complete to the best of my knowledge and belief.</i></p> <p align="right"><i>Roy L. Wheeler Jr.</i></p> <hr/> <p>Signature Roy L. Wheeler, Jr.</p> <hr/> <p>Printed Name Bus. Svc. Spec. II</p> <hr/> <p>Title 12-14-99</p> <hr/> <p>Date</p>
	<p align="center">18 SURVEYOR CERTIFICATION</p> <p><i>I hereby certify that the well location shown on this plat was plotted from field notes of actual surveys made by me or under my supervision, and that the same is true and correct to the best of my belief.</i></p> <hr/> <p>Date of Survey</p> <hr/> <p>Signature and Seal of Professional Surveyor:</p> <hr/> <p>Certificate Number</p>

**AMERADA HESS CORPORATION
STATE "Q" WELL NO. 1
NOTIFICATION LIST**

OFF-SET OPERATORS

- Amoco Production Company
P. O. Box 3092
Houston, Texas 77253
- ARCO Permian
P. O. Box 1089
Eunice, New Mexico 88231
- Conoco Inc.
10 Desta Drive, Ste. 100W
Midland, Texas 79705
- Doyle Hartman
500 N. Main
Midland, Texas 79701
- John H. Hendrix Corporation
P. O. Box 3040
Midland, Texas 79702-3040
- Marathon Oil Company
P. O. Box 2409
Hobbs, New Mexico 88240
- Texaco Exploration & Production, Inc.
205 E. Bender
Hobbs, New Mexico 88240

WAIVER TO OBJECTION

STATE Q WELL NO. 1

We the undersigned, as an offset operator, waive any objection to Amerada Hess Corporation's application for NMOCD approval of a non-standard location and simultaneous dedication in the Eumont Prorated Gas Pool. The proposed well is located 1980' FSL and 2310' FEL, Sec. 16, T20S, R37E, Lea County, New Mexico. The 160 acre proration unit consist of the SE Quarter of Sec. 16, T20S, R37E, originally established in 1953.

COMPANY: _____

REPRESENTATIVE: _____

SIGNATURE: _____

DATE: _____

AMERADA HESS CORPORATION

P. O. BOX 840
SEMINOLE, TEXAS 79360
915-758-6700

December 14, 1999

Amoco Production Company
P. O. Box 3092
Houston, Texas 77253

Re: Waiver Request
Administrative Application for Non-Standard
Location & Simultaneous Dedication
Eumont Prorated Gas Pool
State "Q" Well No. 1

Dear Sir,

Enclosed is copy of application mailed to New Mexico Oil Conservation Division for approval of a non-standard location and simultaneous dedication of State "Q" Well No. 1 located in Unit J, (1980' FSL, 2310' FEL), Sec. 16, T20S, R37E, Lea County, New Mexico.

Amerada Hess plans to downhole commingle this existing wellbore in the Eumont, Grayburg and Paddock Zones.

As an offset operator, if you do not have an objection to this application, please sign the enclosed waiver and mail original to New Mexico Oil Conservation Division, Santa Fe, with a copy to Amerada Hess Corporation in Seminole. Self-addressed stamped envelopes are provided.

Objections are to be filed with NMOCD within 20 days of this notice.

If we can furnish additional information, please let us know at your earliest convenience.

Thank you for your prompt consideration.

Sincerely,

Roy L. Wheeler, Jr.

AMERADA HESS CORPORATION

P. O. BOX 840
SEMINOLE, TEXAS 79360
915-758-6700

December 14, 1999

ARCO Permian
P. O. Box 1089
Eunice, New Mexico 88231

Re: Waiver Request
Administrative Application for Non-Standard
Location & Simultaneous Dedication
Eumont Prorated Gas Pool
State "Q" Well No. 1

Dear Sir,

Enclosed is copy of application mailed to New Mexico Oil Conservation Division for approval of a non-standard location and simultaneous dedication of State "Q" Well No. 1 located in Unit J, (1980' FSL, 2310' FEL), Sec. 16, T20S, R37E, Lea County, New Mexico.

Amerada Hess plans to downhole commingle this existing wellbore in the Eumont, Grayburg and Paddock Zones.

As an offset operator, if you do not have an objection to this application, please sign the enclosed waiver and mail original to New Mexico Oil Conservation Division, Santa Fe, with a copy to Amerada Hess Corporation in Seminole. Self-addressed stamped envelopes are provided.

Objections are to be filed with NMOCD within 20 days of this notice.

If we can furnish additional information, please let us know at your earliest convenience.

Thank you for your prompt consideration.

Sincerely,



Roy L. Wheeler, Jr.

AMERADA HESS CORPORATION

P. O. BOX 840
SEMINOLE, TEXAS 79360
915-758-6700

December 14, 1999

Conoco Inc.
10 Desta Drive, Ste. 100W
Midland, Texas 79705

Re: Waiver Request
Administrative Application for Non-Standard
Location & Simultaneous Dedication
Eumont Prorated Gas Pool
State "Q" Well No. 1

Dear Sir,

Enclosed is copy of application mailed to New Mexico Oil Conservation Division for approval of a non-standard location and simultaneous dedication of State "Q" Well No. 1 located in Unit J, (1980' FSL, 2310' FEL), Sec. 16, T20S, R37E, Lea County, New Mexico.

Amerada Hess plans to downhole commingle this existing wellbore in the Eumont, Grayburg and Paddock Zones.

As an offset operator, if you do not have an objection to this application, please sign the enclosed waiver and mail original to New Mexico Oil Conservation Division, Santa Fe, with a copy to Amerada Hess Corporation in Seminole. Self-addressed stamped envelopes are provided.

Objections are to be filed with NMOCD within 20 days of this notice.

If we can furnish additional information, please let us know at your earliest convenience.

Thank you for your prompt consideration.

Sincerely,

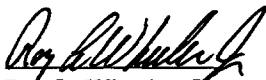
Roy L. Wheeler, Jr.

AMERADA HESS CORPORATION

P. O. BOX 840
SEMINOLE, TEXAS 79360
915-758-6700

December 14, 1999

Doyle Hartman
500 N. Main
Midland, Texas 79701

Re: Waiver Request
Administrative Application for Non-Standard
Location & Simultaneous Dedication
Eumont Prorated Gas Pool
State "Q" Well No. 1

Dear Sir,

Enclosed is copy of application mailed to New Mexico Oil Conservation Division for approval of a non-standard location and simultaneous dedication of State "Q" Well No. 1 located in Unit J, (1980' FSL, 2310' FEL), Sec. 16, T20S, R37E, Lea County, New Mexico.

Amerada Hess plans to downhole commingle this existing wellbore in the Eumont, Grayburg and Paddock Zones.

As an offset operator, if you do not have an objection to this application, please sign the enclosed waiver and mail original to New Mexico Oil Conservation Division, Santa Fe, with a copy to Amerada Hess Corporation in Seminole. Self-addressed stamped envelopes are provided.

Objections are to be filed with NMOCD within 20 days of this notice.

If we can furnish additional information, please let us know at your earliest convenience.

Thank you for your prompt consideration.

Sincerely,



Roy L. Wheeler, Jr.

AMERADA HESS CORPORATION

P. O. BOX 840
SEMINOLE, TEXAS 79360
915-758-6700

December 14, 1999

John H. Hendrix Corporation
P. O. Box 3040
Midland, Texas 79702-3040

Re: Waiver Request
Administrative Application for Non-Standard
Location & Simultaneous Dedication
Eumont Prorated Gas Pool
State "Q" Well No. 1

Dear Sir,

Enclosed is copy of application mailed to New Mexico Oil Conservation Division for approval of a non-standard location and simultaneous dedication of State "Q" Well No. 1 located in Unit J, (1980' FSL, 2310' FEL), Sec. 16, T20S, R37E, Lea County, New Mexico.

Amerada Hess plans to downhole commingle this existing wellbore in the Eumont, Grayburg and Paddock Zones.

As an offset operator, if you do not have an objection to this application, please sign the enclosed waiver and mail original to New Mexico Oil Conservation Division, Santa Fe, with a copy to Amerada Hess Corporation in Seminole. Self-addressed stamped envelopes are provided.

Objections are to be filed with NMOCD within 20 days of this notice.

If we can furnish additional information, please let us know at your earliest convenience.

Thank you for your prompt consideration.

Sincerely,

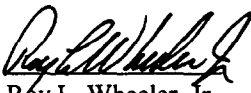

Roy L. Wheeler, Jr.

AMERADA HESS CORPORATION

P. O. BOX 840
SEMINOLE, TEXAS 79360
915-758-6700

December 14, 1999

Marathon Oil Company
P. O. Box 2409
Hobbs, New Mexico 88240

Re: Waiver Request
Administrative Application for Non-Standard
Location & Simultaneous Dedication
Eumont Prorated Gas Pool
State "Q" Well No. 1

Dear Sir,

Enclosed is copy of application mailed to New Mexico Oil Conservation Division for approval of a non-standard location and simultaneous dedication of State "Q" Well No. 1 located in Unit J, (1980' FSL, 2310' FEL), Sec. 16, T20S, R37E, Lea County, New Mexico.

Amerada Hess plans to downhole commingle this existing wellbore in the Eumont, Grayburg and Paddock Zones.

As an offset operator, if you do not have an objection to this application, please sign the enclosed waiver and mail original to New Mexico Oil Conservation Division, Santa Fe, with a copy to Amerada Hess Corporation in Seminole. Self-addressed stamped envelopes are provided.

Objections are to be filed with NMOCD within 20 days of this notice.

If we can furnish additional information, please let us know at your earliest convenience.

Thank you for your prompt consideration.

Sincerely,



Roy L. Wheeler, Jr.

AMERADA HESS CORPORATION

P. O. BOX 840
SEMINOLE, TEXAS 79360
915-758-6700

December 14, 1999

Texaco Exploration & Production, Inc.
205 E. Bender
Hobbs, New Mexico 88240

Re: Waiver Request
Administrative Application for Non-Standard
Location & Simultaneous Dedication
Eumont Prorated Gas Pool
State "Q" Well No. 1

Dear Sir,

Enclosed is copy of application mailed to New Mexico Oil Conservation Division for approval of a non-standard location and simultaneous dedication of State "Q" Well No. 1 located in Unit J, (1980' FSL, 2310' FEL), Sec. 16, T20S, R37E, Lea County, New Mexico.

Amerada Hess plans to downhole commingle this existing wellbore in the Eumont, Grayburg and Paddock Zones.

As an offset operator, if you do not have an objection to this application, please sign the enclosed waiver and mail original to New Mexico Oil Conservation Division, Santa Fe, with a copy to Amerada Hess Corporation in Seminole. Self-addressed stamped envelopes are provided.

Objections are to be filed with NMOCD within 20 days of this notice.

If we can furnish additional information, please let us know at your earliest convenience.

Thank you for your prompt consideration.

Sincerely,



Roy L. Wheeler, Jr.

Z 437 801 907

US Postal Service

Receipt for Certified Mail

No Insurance Coverage Provided.

Do not use for International Mail (See reverse)

Sent to	CONOCO, Inc.	
Street & Number	10 Delta Drive, STE. 100W	
Post Office, State, & ZIP Code	Midland, Tx. 79705	
Postage	\$.77
Certified Fee		1.40
Special Delivery Fee		
Restricted Delivery Fee		
Return Receipt Showing to Whom & Date Delivered		1.25
Return Receipt Showing to Whom, Date, & Addressee's Address		DEC 15 1999
TOTAL Postage & Fees	\$	3.42
Postmark or Date		

PS Form 3800, April 1995

Z 437 801 906

US Postal Service

Receipt for Certified Mail

No Insurance Coverage Provided.

Do not use for International Mail (See reverse)

Sent to	ARCO Permian	
Street & Number	P.O. Box 1089	
Post Office, State, & ZIP Code	Eunice, N.M. 88231	
Postage	\$.77
Certified Fee		1.40
Special Delivery Fee		
Restricted Delivery Fee		
Return Receipt Showing to Whom & Date Delivered		1.25
Return Receipt Showing to Whom, Date, & Addressee's Address		DEC 15 1999
TOTAL Postage & Fees	\$	3.42
Postmark or Date		

PS Form 3800, April 1995

Z 437 801 905

US Postal Service

Receipt for Certified Mail

No Insurance Coverage Provided.

Do not use for International Mail (See reverse)

Sent to	Amoco Production Company	
Street & Number	P.O. Box 3092	
Post Office, State, & ZIP Code	Houston, Texas 77253	
Postage	\$.77
Certified Fee		1.40
Special Delivery Fee		
Restricted Delivery Fee		
Return Receipt Showing to Whom & Date Delivered		1.25
Return Receipt Showing to Whom, Date, & Addressee's Address		DEC 15 1999
TOTAL Postage & Fees	\$	3.42
Postmark or Date		

PS Form 3800, April 1995

Z 437 801 909

US Postal Service

Receipt for Certified Mail

No Insurance Coverage Provided.

Do not use for International Mail (See reverse)

Sent to	John H. Hendrix Corporation	
Street & Number	P.O. Box 3040	
Post Office, State, & ZIP Code	Midland, Tx. 79702-3040	
Postage	\$.77
Certified Fee		1.40
Special Delivery Fee		
Restricted Delivery Fee		
Return Receipt Showing to Whom & Date Delivered		1.25
Return Receipt Showing to Whom, Date, & Addressee's Address		DEC 15 1999
TOTAL Postage & Fees	\$	3.42
Postmark or Date		

PS Form 3800, April 1995

Z 437 801 908

US Postal Service

Receipt for Certified Mail

No Insurance Coverage Provided.

Do not use for International Mail (See reverse)

Sent to	Doyle Hartman	
Street & Number	500 N. Main	
Post Office, State, & ZIP Code	Midland, Tx. 79701	
Postage	\$.77
Certified Fee		1.40
Special Delivery Fee		
Restricted Delivery Fee		
Return Receipt Showing to Whom & Date Delivered		1.25
Return Receipt Showing to Whom, Date, & Addressee's Address		DEC 15 1999
TOTAL Postage & Fees	\$	3.42
Postmark or Date		

PS Form 3800, April 1995

Z 437 801 911

US Postal Service

Receipt for Certified Mail

No Insurance Coverage Provided.

Do not use for International Mail (See reverse)

Sent to	
Texaco Expl. & Prod. Inc.	
Street & Number	
205 E. Bender	
Post Office, State, & ZIP Code	
Hobbs, N.M. 88240	
Postage	\$.77
Certified Fee	1.40
Special Delivery Fee	
Restricted Delivery Fee	
Return Receipt Showing to Whom, Date, & Addressee's Address	7.25
Return Receipt Showing to Whom, Date, & Addressee's Address	
TOTAL Postage & Fees	3.92
Postmark or Date	DEC 15 1999

PS Form 3800, April 1995

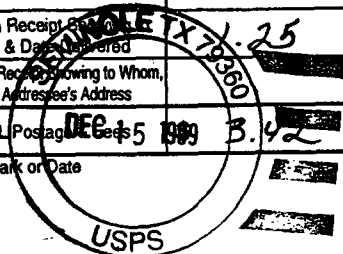

Z 437 801 910

US Postal Service

Receipt for Certified Mail

No Insurance Coverage Provided.

Do not use for International Mail (See reverse)

Sent to	
Mare Thon Oil Company	
Street & Number	
P.O. Box 2409	
Post Office, State, & ZIP Code	
Hobbs, N.M. 88240	
Postage	\$.77
Certified Fee	1.40
Special Delivery Fee	
Restricted Delivery Fee	
Return Receipt Showing to Whom, Date, & Addressee's Address	7.25
Return Receipt Showing to Whom, Date, & Addressee's Address	
TOTAL Postage & Fees	3.92
Postmark or Date	DEC 12 1999

PS Form 3800, April 1995

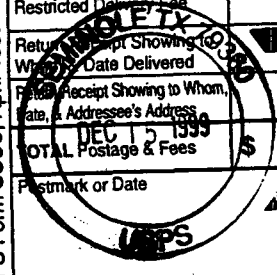

CMD :
OG6IWCM

ONGARD
INQUIRE WELL COMPLETIONS

12/29/99 17:13:36
OGOMES -TPEN

API Well No : 30 25 6116 Eff Date : 08-01-1973 WC Status : A
Pool Idn : 47080 MONUMENT;PADDOCK
OGRID Idn : 495 AMERADA HESS CORP
Prop Idn : 206 STATE Q

Well No : 001
GL Elevation: 3533

	U/L	Sec	Township	Range	North/South	East/West	Prop/Act (P/A)
	---	---	-----	-----	-----	-----	-----
B.H. Locn	: J	16	20S	37E	FTG 1980 F S	FTG 2310 F E	A

Lot Identifier:

Dedicated Acre: 40.00

Lease Type : S

Type of consolidation (Comm, Unit, Forced Pooling - C/U/F/O) :

M0025: Enter PF keys to scroll

PF01 HELP	PF02	PF03 EXIT	PF04 GoTo	PF05	PF06
PF07	PF08	PF09	PF10 NEXT-WC	PF11 HISTORY	PF12 NXTREC

CMD :
OG6IWCM

ONGARD
INQUIRE WELL COMPLETIONS

12/29/99 17:13:41
OGOMES -TPEN

API Well No : 30 25 6116 Eff Date : 08-01-1973 WC Status : A
Pool Idn : 47080 MONUMENT;PADDOCK
OGRID Idn : 495 AMERADA HESS CORP
Prop Idn : 206 STATE Q

Well No : 001
GL Elevation: 3533

	U/L	Sec	Township	Range	North/South	East/West	Prop/Act (P/A)
B.H. Locn	: J	16	20S	37E	FTG 1980 F S	FTG 2310 F E	A

Lot Identifier:

Dedicated Acre: 40.00

Lease Type : S

Type of consolidation (Comm, Unit, Forced Pooling - C/U/F/O) :

E6317: No more recs. for this api well no.

PF01 HELP	PF02	PF03 EXIT	PF04 GoTo	PF05	PF06
PF07	PF08	PF09	PF10 NEXT-WC	PF11 HISTORY	PF12 NXTREC