

DATE IN 3/19/2014	SUSPENSE	ENGINEER PRG	LOGGED IN 3/24/2014	TYPE SWD	APP NO. PMAM1408329036
----------------------	----------	-----------------	------------------------	-------------	---------------------------

ABOVE THIS LINE FOR DIVISION USE ONLY

## NEW MEXICO OIL CONSERVATION DIVISION

- Engineering Bureau -  
1220 South St. Francis Drive, Santa Fe, NM 87505



### ADMINISTRATIVE APPLICATION CHECKLIST

THIS CHECKLIST IS MANDATORY FOR ALL ADMINISTRATIVE APPLICATIONS FOR EXCEPTIONS TO DIVISION RULES AND REGULATIONS WHICH REQUIRE PROCESSING AT THE DIVISION LEVEL IN SANTA FE

#### Application Acronyms:

[NSL-Non-Standard Location] [NSP-Non-Standard Proration Unit] [SD-Simultaneous Dedication]  
[DHC-Downhole Commingling] [CTB-Lease Commingling] [PLC-Pool/Lease Commingling]  
[PC-Pool Commingling] [OLS - Off-Lease Storage] [OLM-Off-Lease Measurement]  
[WFX-Waterflood Expansion] [PMX-Pressure Maintenance Expansion]  
[SWD-Salt Water Disposal] [IPI-Injection Pressure Increase]  
[EOR-Qualified Enhanced Oil Recovery Certification] [PPR-Positive Production Response]

- [1] **TYPE OF APPLICATION** - Check Those Which Apply for [A]
- [A] Location - Spacing Unit - Simultaneous Dedication  
☐ NSL ☐ NSP ☐ SD
- Check One Only for [B] or [C]
- [B] Commingling - Storage - Measurement  
☐ DHC ☐ CTB ☐ PLC ☐ PC ☐ OLS ☐ OLM
- [C] Injection - Disposal - Pressure Increase - Enhanced Oil Recovery  
☐ WFX ☐ PMX ☒ SWD ☐ IPI ☐ EOR ☐ PPR
- [D] Other: Specify \_\_\_\_\_

- [2] **NOTIFICATION REQUIRED TO:** - Check Those Which Apply, or ☒ Does Not Apply
- [A] ☐ Working, Royalty or Overriding Royalty Interest Owners
- [B] ☒ Offset Operators, Leaseholders or Surface Owner
- [C] ☒ Application is One Which Requires Published Legal Notice
- [D] ☒ Notification and/or Concurrent Approval by BLM or SLO  
 U.S. Bureau of Land Management - Commissioner of Public Lands, State Land Office
- [E] ☐ For all of the above, Proof of Notification or Publication is Attached, and/or,
- [F] ☐ Waivers are Attached

- [3] **SUBMIT ACCURATE AND COMPLETE INFORMATION REQUIRED TO PROCESS THE TYPE OF APPLICATION INDICATED ABOVE.**

- [4] **CERTIFICATION:** I hereby certify that the information submitted with this application for administrative approval is **accurate** and **complete** to the best of my knowledge. I also understand that **no action** will be taken on this application until the required information and notifications are submitted to the Division.

Note: Statement must be completed by an individual with managerial and/or supervisory capacity.

Leslie M. Garvis  
Print or Type Name

*Leslie M. Garvis*  
Signature

Regulatory Coordinator  
Title

3/19/14  
Date

lgarvis@burnettoil.com  
e-mail Address

SWD  
- Burnett Oil Co  
3080 well  
- Cedar Lake  
36 State Com #1  
30-015-  
30405  
2014 MAR 19 P 7:56  
RECEIVED OGD  
Pool  
- SWD, Wolf Camp  
96135

**APPLICATION FOR AUTHORIZATION TO INJECT**

- I. PURPOSE: Secondary Recovery Pressure Maintenance X Disposal Storage  
Application qualifies for administrative approval? Yes No
- II. OPERATOR: Burnett Oil Co., Inc.  
ADDRESS: Burnett Plaza - Suite 1500, 801 Cherry Street - Unit 9, Fort Worth, Texas 76102  
CONTACT PARTY: Leslie Garvis - Regulatory Coordinator (email:lgarvis@burnettoil.com) PHONE: 817-332-5108
- III. WELL DATA: Complete the data required on the reverse side of this form for each well proposed for injection.  
Additional sheets may be attached if necessary.
- IV. Is this an expansion of an existing project? Yes X No  
If yes, give the Division order number authorizing the project: \_\_\_\_\_
- V. Attach a map that identifies all wells and leases within two miles of any proposed injection well with a one-half mile radius circle drawn around each proposed injection well. This circle identifies the well's area of review.
- VI. Attach a tabulation of data on all wells of public record within the area of review which penetrate the proposed injection zone. Such data shall include a description of each well's type, construction, date drilled, location, depth, record of completion, and a schematic of any plugged well illustrating all plugging detail.
- VII. Attach data on the proposed operation, including:
1. Proposed average and maximum daily rate and volume of fluids to be injected;
  2. Whether the system is open or closed;
  3. Proposed average and maximum injection pressure;
  4. Sources and an appropriate analysis of injection fluid and compatibility with the receiving formation if other than reinjected produced water; and,
  5. If injection is for disposal purposes into a zone not productive of oil or gas at or within one mile of the proposed well, attach a chemical analysis of the disposal zone formation water (may be measured or inferred from existing literature, studies, nearby wells, etc.).
- \*VIII. Attach appropriate geologic data on the injection zone including appropriate lithologic detail, geologic name, thickness, and depth. Give the geologic name, and depth to bottom of all underground sources of drinking water (aquifers containing waters with total dissolved solids concentrations of 10,000 mg/l or less) overlying the proposed injection zone as well as any such sources known to be immediately underlying the injection interval.
- IX. Describe the proposed stimulation program, if any.
- \*X. Attach appropriate logging and test data on the well. (If well logs have been filed with the Division, they need not be resubmitted).
- \*XI. Attach a chemical analysis of fresh water from two or more fresh water wells (if available and producing) within one mile of any injection or disposal well showing location of wells and dates samples were taken.
- XII. Applicants for disposal wells must make an affirmative statement that they have examined available geologic and engineering data and find no evidence of open faults or any other hydrologic connection between the disposal zone and any underground sources of drinking water.
- XIII. Applicants must complete the "Proof of Notice" section on the reverse side of this form.
- XIV. Certification: I hereby certify that the information submitted with this application is true and correct to the best of my knowledge and belief.
- NAME: Mark Jacoby TITLE: VP of Production, Permian Basin  
SIGNATURE: Mark A. Jacoby DATE: 3/18/14  
E-MAIL ADDRESS: mjacoby@burnettoil.com
- \* If the information required under Sections VI, VIII, X, and XI above has been previously submitted, it need not be resubmitted. Please show the date and circumstances of the earlier submittal: \_\_\_\_\_

### III. WELL DATA

A. The following well data must be submitted for each injection well covered by this application. The data must be both in tabular and schematic form and shall include:

- (1) Lease name; Well No.; Location by Section, Township and Range; and footage location within the section.
- (2) Each casing string used with its size, setting depth, sacks of cement used, hole size, top of cement, and how such top was determined.
- (3) A description of the tubing to be used including its size, lining material, and setting depth.
- (4) The name, model, and setting depth of the packer used or a description of any other seal system or assembly used.

Division District Offices have supplies of Well Data Sheets which may be used or which may be used as models for this purpose. Applicants for several identical wells may submit a "typical data sheet" rather than submitting the data for each well.

B. The following must be submitted for each injection well covered by this application. All items must be addressed for the initial well. Responses for additional wells need be shown only when different. Information shown on schematics need not be repeated.

- (1) The name of the injection formation and, if applicable, the field or pool name.
- (2) The injection interval and whether it is perforated or open-hole.
- (3) State if the well was drilled for injection or, if not, the original purpose of the well.
- (4) Give the depths of any other perforated intervals and detail on the sacks of cement or bridge plugs used to seal off such perforations.
- (5) Give the depth to and the name of the next higher and next lower oil or gas zone in the area of the well, if any.

### XIV. PROOF OF NOTICE

All applicants must furnish proof that a copy of the application has been furnished, by certified or registered mail, to the owner of the surface of the land on which the well is to be located and to each leasehold operator within one-half mile of the well location.

Where an application is subject to administrative approval, a proof of publication must be submitted. Such proof shall consist of a copy of the legal advertisement which was published in the county in which the well is located. The contents of such advertisement must include:

- (1) The name, address, phone number, and contact party for the applicant;
- (2) The intended purpose of the injection well; with the exact location of single wells or the Section, Township, and Range location of multiple wells;
- (3) The formation name and depth with expected maximum injection rates and pressures; and,
- (4) A notation that interested parties must file objections or requests for hearing with the Oil Conservation Division, 1220 South St. Francis Dr., Santa Fe, New Mexico 87505, within 15 days.

NO ACTION WILL BE TAKEN ON THE APPLICATION UNTIL PROPER PROOF OF NOTICE HAS BEEN SUBMITTED.

---

NOTICE: Surface owners or offset operators must file any objections or requests for hearing of administrative applications within 15 days from the date this application was mailed to them.

## INJECTION WELL DATA SHEET

OPERATOR: Burnett Oil Co., Inc.WELL NAME & NUMBER: Cedar Lake 36 State Com No 1    API# 30-015-30405

WELL LOCATION:	1980' FSL, 1650' FWL	K	36	T17S	R30E
	FOOTAGE LOCATION	UNIT LETTER	SECTION	TOWNSHIP	RANGE

WELLBORE SCHEMATICWELL CONSTRUCTION DATASurface Casing

Hole Size: 14 3/4"                      Casing Size: 11 3/4" 42#

Cemented with: 425 sx.    *or*                      ft<sup>3</sup>

Top of Cement: Surface                      Method Determined: Circ 56 sx

Intermediate Casing

Hole Size: 11"                      Casing Size: 8 5/8" 32#

Cemented with: 1350 sx.    *or*                      ft<sup>3</sup>

Top of Cement: Surface                      Method Determined: Circ 240 sx

Production Casing-PROPOSED

Note: See attached Drilling Plan

Hole Size: 7 7/8"                      Casing Size: 5 1/2" 17#

Cemented with: 1265 sx.    *or*                      ft<sup>3</sup>

Top of Cement: Surface                      Method Determined: Circ 100 sx

Total Depth: 9215'

Injection Interval

8500                      feet    to    9191

(Perforated or Open Hole; indicate which)

**INJECTION WELL DATA SHEET**

Tubing Size: 3.5" 9.3# L80 Lining Material: Plastic  
Type of Packer: Lok Set  
Packer Setting Depth: Approx. 8450'  
Other Type of Tubing/Casing Seal (if applicable): N/A

**Additional Data**

1. Is this a new well drilled for injection? Yes X No  
If no, for what purpose was the well originally drilled? Oil/Gas
2. Name of the Injection Formation: Wolfcamp
3. Name of Field or Pool (if applicable):
4. Has the well ever been perforated in any other zone(s)? List all such perforated intervals and give plugging detail, i.e. sacks of cement or plug(s) used. No. Plugging detail listed below in Item VI (a).
5. Give the name and depths of any oil or gas zones underlying or overlying the proposed injection zone in this area: Grayburg- Jackson, Seven Rivers, Queen, Grayburg, San Andres and Loco Hills Glorieta  
Yeso above 6000'. Loco Hills Atoka and Cedar Lake Morrow below 10,500'.



### **III. WELL DATA**

- A.1.** Cedar Lake 36 State No. 1  
API#30-015-30405  
Township 17S, Range 30E, Section 36, Unit K  
1980' FSL, 1650' FWL  
Eddy Co., NM
- A.2** See attached Well Data Sheets and attached schematics
- A.3** 3.5" 9.3# L80. 8450'
- A.4** Lok Set – set at approx.. 8450'
- B.1** Injection formation is Wolfcamp Reef.
- B.2** Injection interval will be from 8500 to 9191 feet. Perforated
- B.3** The original intent of this well was for a oil/gas.
- B.4** N/A. Plugging details listed below in Item VI (a)
- B.5** The next higher producing zone is Loco Hills Glorieta Yeso at approximately 6000'. The next lower producing zone is Loco Hills Atoka and Cedar Lake Morrow at approximately 10,500'.

**IV.** No

**V.** Maps Attached

**VI.** List of Wells and Data Attached

**VII.** See attached drilling re-entry plan.

1. Maximum injection volume is 10,000 bwpd. Average anticipated is approximately

8,500 bpd of produced water from Burnett's own operation.

2. Closed system



3. Maximum injection pressure is expected to be 1700 psi.
4. Sources will be produced water. These will be compatible with waters in the disposal zone.
5. Water sample analysis from the Enervest Operating, LLC Cedar Lake ADI Federal #1, sec. 24, T17S, R30E, Eddy Co., NM, API #30-015-25494, Loco Hills Atoka. See attached. (Source: NM WAIDS)

VIII. The Wolfcamp carbonates in this area are believed to have been diagenetically dolomitized. Such carbonate alterations often results in enhanced porosity. Testing, in Nadel and Gussman Permian, LLC Atalaya Federal No 1, Sec. 26, T17S, R30E, confirms water in those carbonates. The Wolfcamp formation is overlain and underlain by bounding shales and carbonates of the Abo and Cisco, respectively, that essentially prevent vertical migration of formation or disposal waters.

The surface geology of the greater area, including the 2-mile radius as shown in Item V above, is Quaternary eolian and piedmont deposits of Holocene to middle Pleistocene age. These are underlain by the Permian Rustler Formation and some evaporates. The top of the Yates Formation of the Artesia Group is at 1,465'. 8-5/8 casing set @ 4,012' has cement circulate to the surface.

- IX. Perforate Wolfcamp Reef with casing gun per selections to be provided after log is run. Injection interval will be 8500' to 9191'. Acidize perfs with volume per design (estimated 30,000 gals 15% NEFE HCL in 5 equal stages with 1000# rock salt in saturated brine water for blocks to divert acid).
- X. Logs are on file with the OCD.
- XI. No water wells are reported in the 2-mile area. Please note item VIII above.
- XII. I, Mark Jacoby, have examined all available geologic and engineering data and find no evidence of open faults or any other hydrologic connection between the disposal zones and any underground source of drinking water pertaining to this well.
- XIII. Proof of Notice Attached.

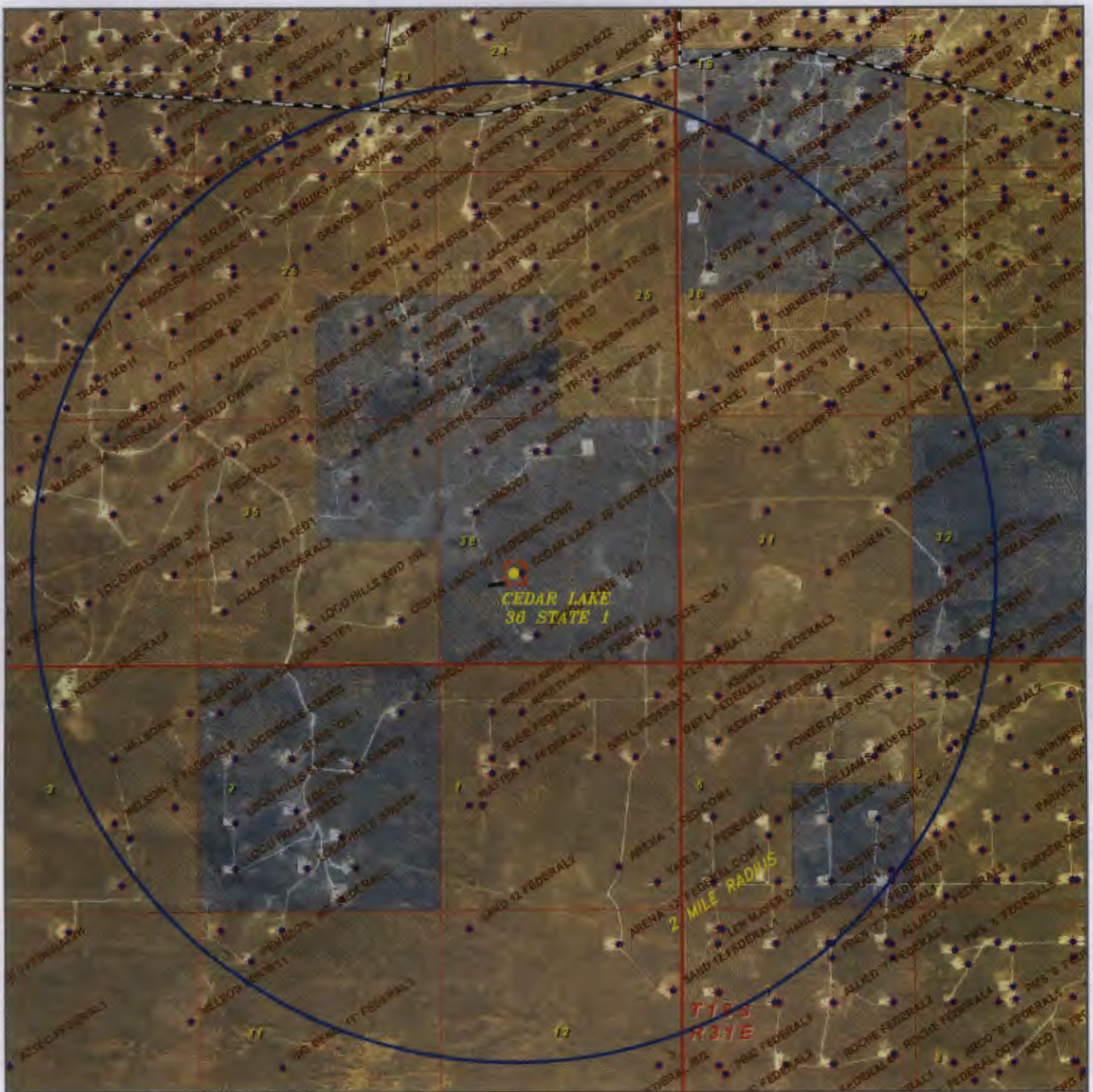

## CEDAR LAKE 36 STATE #1

Located 1980' FSL and 1650' FWL  
Section 36, Township 17 South, Range 30 East,  
N.M.P.M., Eddy County, New Mexico.



P.O. Box 1786  
1120 N. West County Rd.  
Hobbs, New Mexico 88241  
(575) 393-7316 - Office  
(575) 392-2206 - Fax  
basinsurveys.com

0' 1500' 3000' 4500' 6000'  
SCALE: 1" = 3000'

W.O. Number: KAN 30025

Survey Date: 01-24-2014

YELLOW TINT - USA LAND  
BLUE TINT - STATE LAND  
NATURAL COLOR - USA LAND



**Burnett Oil Co., Inc.**  
**6666**

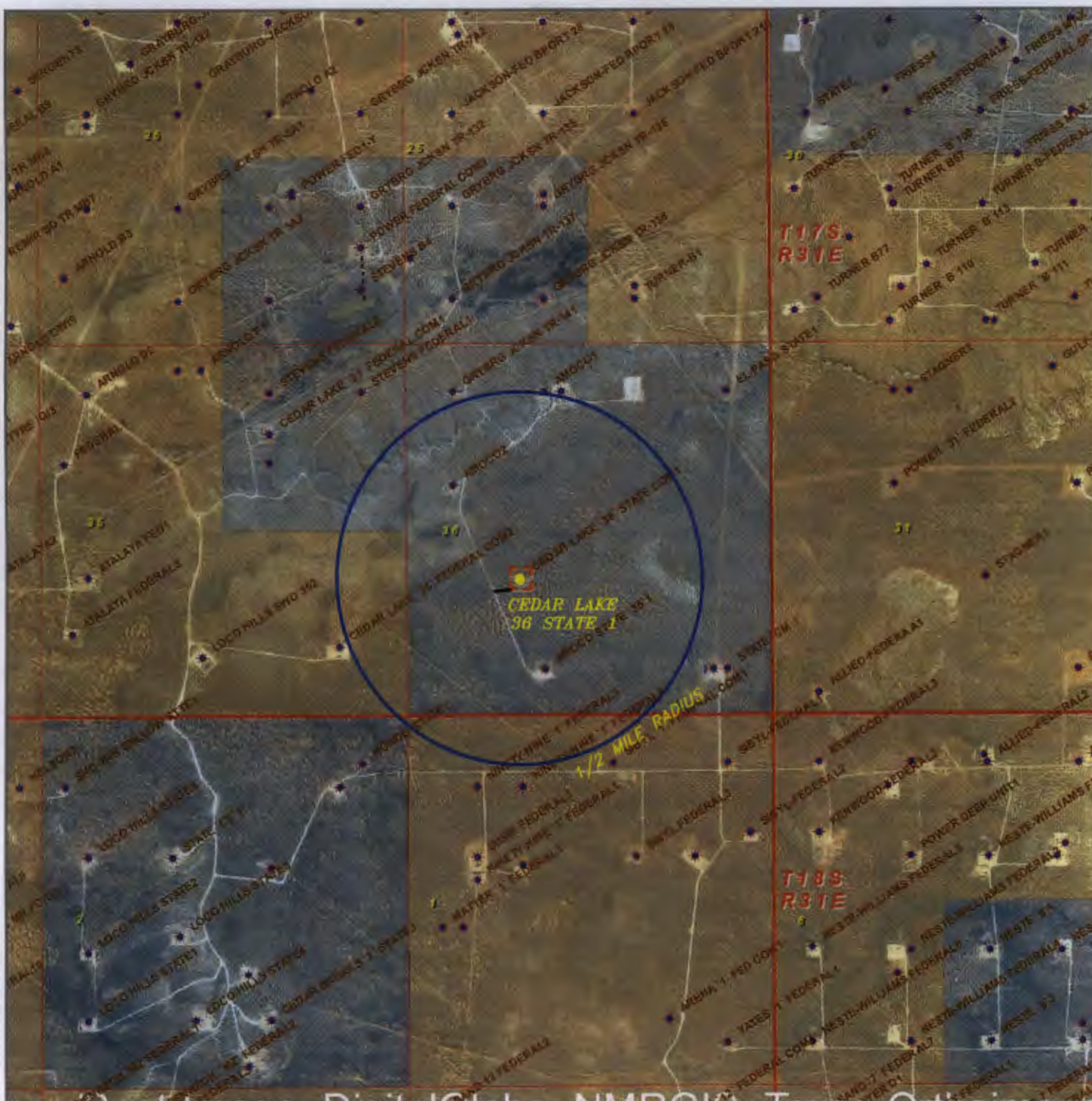

## CEDAR LAKE 36 STATE #1

Located 1980' FSL and 1650' FWL  
 Section 36, Township 17 South, Range 30 East,  
 N.M.P.M., Eddy County, New Mexico.



P.O. Box 1786  
 1120 N. West County Rd.  
 Hobbs, New Mexico 88241  
 (575) 393-7316 - Office  
 (575) 392-2206 - Fax  
 basinsurveys.com

0'	1000'	2000'	3000'	4000'
SCALE: 1" = 2000'				
W.O. Number: KAN 30025				
Survey Date: 01-24-2014				
YELLOW TINT - USA LAND				
BLUE TINT - STATE LAND				
NATURAL COLOR - USA LAND				



**Burnett Oil Co., Inc.**  
**6666**

**Burnett Oil Co., Inc.**

API # 30-015-30405  
 Cedar Lake 36 State No. 1  
 1980' FSL, 1650' FWL  
 T17S, R30E, Sec. 36  
 Eddy County, NM

**Item VI: Date on Wells in AOR:**

API	Well Name	Status	UL	Sec	Township	Range	FTG	NS	FTG	EW	Operator	Land	Type	Plug Date	Spud Date	GL Elevation	TVD	Highest Perf
30-015-04451	Amoco State 002	Plugged	E	36	17S	30E	1980	N	660	W	Pendragon Energy	S	O	2/2/2001	8/27/1943	3065'	3420'	3065'
30-015-30405	Cedar Lake 36	Plugged	K	36	17S	30E	1980	S	1650	W	EOG Resources, Inc.	S	G	11/2/1998	10/3/1998	3585'	11750'	None
30-015-25961	Amoco State 001	Plugged	N	36	17S	30E	660	S	1980	W	Anadarko	S	O	11/7/1988	8/22/1988	3592'	3540'	3197'

**Item VI (a): Construction of wells in the AOR that penetrate into the proposed injection interval:**

1. 30-015-30405. Cedar Lake 36 State Com #1. EOG Resources Inc.

OCD Unit K, Sec.36, T17S, R30E, 1980' FSL, 1650' FWL

Spud 10/3/1998. 11-3/4" 42# @ 665' w/425 sxs cmt. Circ 56 sxs to surface. 8 5/8" 32# @ 4449' w/1350 sxs cmt, circ 240sxx. TD 11,750'. 25 sx plug @11,244', 25 sxs @10,660', 25 sxs @ 8,506'. 25 sxs 6,700'. 25 sxs 3,967'-4,067' ( 8-5/8' shoe) tagged @ 3,991. 100' plug 1,310-1,410 tagged @ 1,310'. 30sxs @ 712' tagged @ 316'. 20 sxs @60' to surface. P & A 11/2/1998.

**Item VI (b): All known wells in the AOR that penetrate the proposed injection interval are label in red.**

API	Well Name	Status	UL	Sec	Township	Range	FTG	NS	FTG	EW	Operator	Land	Type	Plug Date	Spud Date	GL Elevation	TVD	Highest Perf
30-015-04451	Amoco State 002	Plugged	E	36	17S	30E	1980	N	660	W	Pendragon Energy	S	O	2/2/2001	8/27/1943	3065'	3420'	3065'
30-015-30405	Cedar Lake 36	Plugged	K	36	17S	30E	1980	S	1650	W	EOG Resources, Inc.	S	G	11/2/1998	10/3/1998	3585'	11750'	None
30-015-25961	Amoco State 001	Plugged	N	36	17S	30E	660	S	1980	W	Anadarko	S	O	11/7/1988	8/22/1988	3592'	3540'	3197'

**Burnett Oil Company**FIELD: Cedar Lake**CURRENT**WELL NAME: Cedar Lake 36 State ComWell Number: 1Unit: NSEC: 36GL: 3585'Formation: MorrowSURVEY: T17S R30ECOUNTY: EDDYKB: 3606'STATUS: API NO: 30-015-30405LOCATION: 1980' FSL 1650' FWLSTATE: NMDF: LAT: LONG: SPUD: 10/3/1998 11/2/1998COMP: 10/31/1998 Set plugs @:P&A: 11/2/1998 0-60' w/ 20 sx

Formation	Depth
Rustler	300

Yates 1617

Queen 2620

Grayburg 2990

San Andres 3405

Yeso 5215

Abo 7337

B/Abo 8229

Wolfcamp 8456

WC Reef 8618

Penn 9216

Cisco 9461

Atoka 10610

Morrow 11100

612'-712' w/30sx

1310'-1400' w/30 sx

3991'-4067' w/25 sx

4448' w/ 25 sx

8506' w/25 sx

10660' w/25 sx

11244' w/25 sx

11 3/4" 42# Surface Csg @ 665'  
in 14 3/4" hole  
Cemented w/ 425 sx  
TOC @ Surface

8 5/8" 32# Prod Csg @4459'  
in 11" Hole  
Cemented w/ 1350 sx  
TOC @ Surface

OPEN HOLE

Updated: 3/5/2014  
By: CTS

# Burnett Oil Company

## PROPOSED

FIELD: Cedar Lake

WELL NAME: Cedar Lake 36 State Com

Well Number: 1

Unit: N

SEC: 36

GL: 3585'

Formation: Morrow

SURVEY: T17S R30E

COUNTY: EDDY

KB: 3606'

STATUS:

LOCATION: 1980' FSL 1650' FWL

STATE: NM

DF:

API NO: 30-015-30405

LAT:

LONG:

SPUD: 10/3/1998

COMP: 10/31/1998

P&A: 11/2/1998

Formation	Depth
Rustler	300

Yates 1617

PROPOSED IN RED

Queen 2620

Grayburg 2990

San Andres 3405

Yeso 5215

Abo 7337

B/Abo 8229

Wolfcamp 8456

WC Reef 8618

Penn 9216

Cisco 9461

Atoka 10610

Morrow 11100

11 3/4" 42# Surface Csg @ 665'  
In 14 3/4" hole  
Cemented w/ 425 sx  
TOC @ Surface

8 5/8" 32# Prod Csg @ 4459'  
in 11" Hole  
Cemented w/ 1350 sx  
TOC @ Surface

PROPOSED IN RED

DV Tool @ 7000

Perf Interval @ 8500'-9191'

5 1/2" Csg @ 9215'

PLUG 25 SX @ 9215'

11/2/1998  
Set plugs @:

10660' w/25 sx

11244' w/25 sx

OPEN HOLE

*Per Cement Program - 5 1/2 to 9215 & cont to surface*

Updated: 3/5/2014  
By: CTS

Water sample analysis from the Enervest Operating, LLC Cedar Lake ADI  
Federal #1, sec. 24, T17S, R30E, Eddy Co., NM, API #30-015-25494, Loco  
Hills Atoka. See attached. (Source: NM WAIDS)

Sample ID	Well Name	Well ID	API	Latitude	Longitude	Section	Township	Township Dir	Range	Range Dir	Feet N	Feet E	Feet W	Feet S	County	State	Company	Field	Formation	Depth	Lab No	Sample No	Sample Source	Water Type	Sample Date	Analysis Date	pH	Temp F	Specific Gravity	Specific Gravity Temp F	TDS mg/L	TDS mg/L @ 18°C	Alkalinity as CaCO3 mg/L	Hardness as CaCO3 mg/L	Hardness mg/L
5959	CEDAR LAKE ADI FEDERAL	001	3001525494	32.80593	103.10326	26	17S	S	30	E	24	N	66	W	Eddy	NM		LOCO HILLS	ATO KA						12/27/2000		6.2	1.04			0				

Resistivity ohm-cm	Resistivity ohm-cm Temp F	Conductivity	Conductivity Temp F	Sodium mg/L	Calcium mg/L	Iron mg/L	Barium mg/L	Magnesium mg/L	Potassium mg/L	Strontium mg/L	Manganese mg/L	Chloride mg/L	Carbonate mg/L	Bicarbonate mg/L	Sulfate mg/L	Hydroxide mg/L	H2S mg/L	CO2 mg/L	O2 mg/L	Anion Remarks	General Remarks	Corrected
--------------------	---------------------------	--------------	---------------------	-------------	--------------	-----------	-------------	----------------	----------------	----------------	----------------	---------------	----------------	------------------	--------------	----------------	----------	----------	---------	---------------	-----------------	-----------

3640 26.3 0 342.5

35784

451 2.5

2

-1

Records of wells from Eddy County, New Mexico

Location	Well Status	Altitude (feet)	Depth of Well(ft.)	Depth to Water(ft.)	Aquifer	Date of Measurement	Remarks
17.28.14.220	Stock/domestic			80	Dckm ?		
19.200	Stock			224.3	Ckbf/Rslr	Dec.2,1948	
22.230	Abandoned stock			45.5	Rslr/Dckm	Dec.1,1948	
24.224	Stock	3565	33.88	24.2		Oct.14,1977	
17.29. 8.231	Stock	3617	92.7	90.13		Oct.14,1977	
No water listed							
22.110	Stock	3550		79.7	Dckm ?	Nov.29,1948	
No water 29.400	Stock			210	Dckm ?	Dec.3,1948	
17.31.34.000	Stock			271+	Dckm	Dec.6,1948	
18.27. 8.240	Unused	3505		181.40		Jan.9,1964	
8.244	Industrial	3513	381	325 ?		Apr.,1951	Oil test
10.200	Unused	3470		46.92		Jan.9,1964	
10.214	Industrial	3493	130	50		Jul.,1958	Oil test
28.13	Domestic/stock	3377	120	100		May,1960	
28.140	Unused	3415		91.37		Jan.9,1964	
33.42	Stock	3447	90	49.3		Sep.,1969	
18.28. 8.330	Stock			81.6	Ckbf/Rslr	Dec.3,1948	
30.110	Stock/domestic	3560		137.1	Ckbf ?	Dec.2,1948	
18.29.24.142	Windmill	3436		156.44		Oct.18,1977	S.C.2600; 21°C
24.23311	Windmill	3436		160.20	Trsc	Apr.8,1971	
24.300	Stock	3430		158.3	Dckm	Apr.28,1950	
34.324	Stock	3440	250	230		Mar.,1960	Yield: 63gpm
18.30.21.4200	Open cased hole	3495		266.48	Trcl	Dec.9,1965	
22.2220	Open cased hole	3430		239.26	Trcl	Apr.8,1971	
26.4140	Stock	3430	223.0	201.67	Trcl	Dec.14,1977	S.C. 1100
31.323	Observation	3370	161.0	157.80		Nov.18,1977	
32.32422	Windmill	3380		161.28	Trcl	Apr.8,1971	
32.413	Abandoned windmill	3370	266	158.77		Oct.18,1977	
18.31. 1.44432	Windmill	3797		460.42	Trcl	Apr.7,1971	
12.223	Stock	3795	480+	453.39		Oct.18,1977	
12.23144	Stock	3775	600	435.34	Trcl	Apr.7,1971	

**Burnett Oil Co., Inc.**

**API #30-015-30405**

**Cedar Lake 36 State No. 1**

**1980' FSL, 1650' FWL**

**T17S, R30E, Sec. 36**

**Eddy County, NM**

**Item XIII:**

**Surface and Minerals Owner:**

State Land Office, New Mexico  
P.O. Box 1148  
Sante Fe, NM 87504

**Operators:**

Enervest Operation, LLC.  
1001 Fannin St. Ste. 800  
Houston, Texas 77002

EOG Resources, Inc.  
P.O. Box 2267  
Midland, Texas 79701

OXY USA, Inc.  
P.O. Box 4292  
Houston, Texas 77210

Yates Petroleum Corp.  
105 S. 4<sup>th</sup> Street  
Artesia, New Mexico

7012 1010 0000 2330 4602

U.S. Postal Service™  
**CERTIFIED MAIL™ RECEIPT**  
 (Domestic Mail Only; No Insurance Coverage Provided)

For delivery information visit our website at [www.usps.com](http://www.usps.com)

SANTA FE NM 87504

Postage	\$ 1.40
Certified Fee	\$3.30
Return Receipt Fee (Endorsement Required)	\$2.70
Restricted Delivery Fee (Endorsement Required)	\$0.00
<b>Total Postage &amp; Fees</b>	<b>\$ 7.40</b>



Sent To *State Land Ofc, NM*  
 Street, Apt. No.,  
 or PO Box No. *P.O. Box 1148*  
 City, State, ZIP+4 *Santa Fe, NM 87504*

PS Form 3800, August 2006

See Reverse for Instructions

7012 1010 0000 2330 4596

U.S. Postal Service™  
**CERTIFIED MAIL™ RECEIPT**  
 (Domestic Mail Only; No Insurance Coverage Provided)

For delivery information visit our website at [www.usps.com](http://www.usps.com)

Midland TX 79701

Postage	\$ 1.40
Certified Fee	\$3.30
Return Receipt Fee (Endorsement Required)	\$2.70
Restricted Delivery Fee (Endorsement Required)	\$0.00
<b>Total Postage &amp; Fees</b>	<b>\$ 7.40</b>

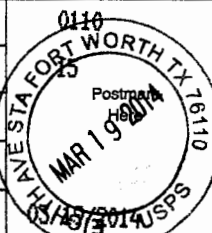

Sent To *EOG Resources, Inc.*  
 Street, Apt. No.,  
 or PO Box No. *P.O. Box 2267*  
 City, State, ZIP+4 *Midland, TX 79701*

PS Form 3800, August 2006

See Reverse for Instructions

7011 2970 0002 9847 1444

U.S. Postal Service™  
**CERTIFIED MAIL™ RECEIPT**  
 (Domestic Mail Only; No Insurance Coverage Provided)

For delivery information visit our website at [www.usps.com](http://www.usps.com)

HOUSTON TX 77210

Postage	\$ 1.40
Certified Fee	\$3.30
Return Receipt Fee (Endorsement Required)	\$2.70
Restricted Delivery Fee (Endorsement Required)	\$0.00
<b>Total Postage &amp; Fees</b>	<b>\$ 7.40</b>



Sent To *OXY USA, Inc.*  
 Street, Apt. No.,  
 or PO Box No. *P.O. Box 4292*  
 City, State, ZIP+4 *Houston, TX 77210*

PS Form 3800, August 2006

See Reverse for Instructions

7012 1010 0000 2330 4961

U.S. Postal Service™  
**CERTIFIED MAIL™ RECEIPT**  
 (Domestic Mail Only; No Insurance Coverage Provided)

For delivery information visit our website at [www.usps.com](http://www.usps.com)

HOUSTON TX 77002

Postage	\$ 1.40
Certified Fee	\$3.30
Return Receipt Fee (Endorsement Required)	\$2.70
Restricted Delivery Fee (Endorsement Required)	\$0.00
<b>Total Postage &amp; Fees</b>	<b>\$ 7.40</b>



Sent To *Energus Operations LLC*  
 Street, Apt. No.,  
 or PO Box No. *1001 Fannin St, Suite 800*  
 City, State, ZIP+4 *Houston, TX 77002*

PS Form 3800, August 2006

See Reverse for Instructions

7012 1010 0000 2330 4657

U.S. Postal Service™  
**CERTIFIED MAIL™ RECEIPT**  
 (Domestic Mail Only; No Insurance Coverage Provided)

For delivery information visit our website at [www.usps.com](http://www.usps.com)

ARTESIA NM 88210

Postage	\$ 1.40
Certified Fee	\$3.30
Return Receipt Fee (Endorsement Required)	\$2.70
Restricted Delivery Fee (Endorsement Required)	\$0.00
<b>Total Postage &amp; Fees</b>	<b>\$ 7.40</b>

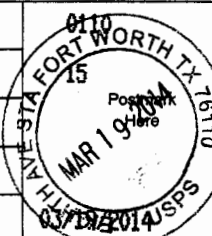

Sent To *Yates Petroleum Corp*  
 Street, Apt. No.,  
 or PO Box No. *105 S 4th Street*  
 City, State, ZIP+4 *Artesia, NM 88210*

PS Form 3800, August 2006

See Reverse for Instructions



19 March 2014

OXY USA, Inc.  
P.O. Box 4292  
Houston, Texas 77210

Re: Cedar Lake State Well No. 1 | API # 30-015-30405  
Unit K, Sec. 36, T17S, R30E  
1980' FSL, 1650' FWL  
Eddy County, New Mexico

Dear Sir or Madam

In accordance with the Rules and Regulations of the Oil Conservation Division of the State of New Mexico, you are being provided a copy of the C-108, Application for Authorization to Inject into the well referenced above.

Any questions about the permit can be directed to Mark A Jacoby at (817) 332-5108. Any objections or request for hearing must be filed with the Oil Conservation Division within fifteen (15) days from the date received. The OCD address is 1220 South St. Francis Drive, Santa Fe, NM 87505, (505) 476-3440

Regards,

A handwritten signature in black ink, appearing to read 'Leslie M. Garvis', is written over a light blue horizontal line.

Leslie M. Garvis  
Regulatory Coordinator



19 March 2014

EOG Resources, Inc.  
P.O. Box 2267  
Midland, Texas 79701

Re: Cedar Lake State Well No. 1 | API # 30-015-30405  
Unit K, Sec. 36, T17S, R30E  
1980' FSL, 1650' FWL  
Eddy County, New Mexico

Dear Sir or Madam

In accordance with the Rules and Regulations of the Oil Conservation Division of the State of New Mexico, you are being provided a copy of the C-108, Application for Authorization to Inject into the well referenced above.

Any questions about the permit can be directed to Mark A Jacoby at (817) 332-5108. Any objections or request for hearing must be filed with the Oil Conservation Division within fifteen (15) days from the date received. The OCD address is 1220 South St. Francis Drive, Santa Fe, NM 87505, (505) 476-3440

Regards,

A handwritten signature in black ink, appearing to read 'Leslie Garvis', is written over a light blue horizontal line.

Leslie M. Garvis  
Regulatory Coordinator



19 March 2014

Enervest Operation, LLC  
1001 Fannin Street, Suite 800  
Houston, Texas 77002

Re: Cedar Lake State Well No. 1 | API # 30-015-30405  
Unit K, Sec. 36, T17S, R30E  
1980' FSL, 1650' FWL  
Eddy County, New Mexico

Dear Sir or Madam

In accordance with the Rules and Regulations of the Oil Conservation Division of the State of New Mexico, you are being provided a copy of the C-108, Application for Authorization to Inject into the well referenced above.

Any questions about the permit can be directed to Mark A Jacoby at (817) 332-5108. Any objections or request for hearing must be filed with the Oil Conservation Division within fifteen (15) days from the date received. The OCD address is 1220 South St. Francis Drive, Santa Fe, NM 87505, (505) 476-3440

Regards,

A handwritten signature in black ink, appearing to read 'Leslie M. Garvis', is written over a light blue horizontal line.

Leslie M. Garvis  
Regulatory Coordinator



19 March 2014

State Land Office, New Mexico  
P.O. Box 1148  
Santa Fe, New Mexico 87504

Re: Cedar Lake State Well No. 1 | API # 30-015-30405  
Unit K, Sec. 36, T17S, R30E  
1980' FSL, 1650' FWL  
Eddy County, New Mexico

Dear Sir or Madam

In accordance with the Rules and Regulations of the Oil Conservation Division of the State of New Mexico, you are being provided a copy of the C-108, Application for Authorization to Inject into the well referenced above.

Any questions about the permit can be directed to Mark A Jacoby at (817) 332-5108. Any objections or request for hearing must be filed with the Oil Conservation Division within fifteen (15) days from the date received. The OCD address is 1220 South St. Francis Drive, Santa Fe, NM 87505, (505) 476-3440

Regards,

A handwritten signature in black ink, appearing to read 'Leslie Garvis', is written over a light blue horizontal line.

Leslie M. Garvis  
Regulatory Coordinator



19 March 2014

Yates Petroleum Corp  
105 S. 4<sup>th</sup> Street  
Artesia, New Mexico 88210

Re: Cedar Lake State Well No. 1 | API # 30-015-30405  
Unit K, Sec. 36, T17S, R30E  
1980' FSL, 1650' FWL  
Eddy County, New Mexico

Dear Sir or Madam

In accordance with the Rules and Regulations of the Oil Conservation Division of the State of New Mexico, you are being provided a copy of the C-108, Application for Authorization to Inject into the well referenced above.

Any questions about the permit can be directed to Mark A Jacoby at (817) 332-5108. Any objections or request for hearing must be filed with the Oil Conservation Division within fifteen (15) days from the date received. The OCD address is 1220 South St. Francis Drive, Santa Fe, NM 87505, (505) 476-3440

Regards,

A handwritten signature in black ink, appearing to read 'Leslie Garvis', is written in a cursive style.

Leslie M. Garvis  
Regulatory Coordinator

# Affidavit of Publication

No. 22903

State of New Mexico

County of Eddy:

## Danny Scott

being duly sworn, sayes that he is the **Publisher**

of the Artesia Daily Press, a daily newspaper of General

circulation, published in English at Artesia, said county

and state, and that the hereto attached

## Legal Notice

was published in a regular and entire issue of the said

Artesia Daily Press, a daily newspaper duly qualified

for that purpose within the meaning of Chapter 167 of

the 1937 Session Laws of the state of New Mexico for

1 Consecutive weeks/day on the same

day as follows:

First Publication March 19, 2014

## Second Publication

### Third Publication

### Fourth Publication

### Fifth Publication

Subscribed and sworn before me this

19th day of March 2014



OFFICIAL SEAL  
Latisha Romine  
NOTARY PUBLIC-STATE OF NEW MEXICO

My commission expires: 5/12/2013

Latusha Romine

Latisha Romine

Notary Public, Eddy County, New Mexico

**Copy of Publication:**

## LEGAL NOTICE

Pursuant to the rules and regulation of the Oil Conservation Division of the State of New Mexico, Burnett Oil Co., Inc. Burnett Plaza, Suite 1500, 801 Cherry St. Unit #9, Fort Worth, Texas 76102, is seeking approval from the New Mexico Oil Conservation District to re-enter the EOG Resources, Inc. Cedar Lake 36 State No. 1 well, API # 30-015-30405, located 1980 feet from the south line and 1500 feet from the west line of Section 36, T17S, R30E, Eddy County, NM, 4.0 miles southeast of Loco Hills intersection of CR-217 and US-82 and complete for a Salt Water Disposal as the Burnett Oil Co. Inc. Cedar Lake SWD 36 State No. 1.

The proposed disposal interval is the Wolfcamp formation through casing perforations approximately 8,500 feet to 9,190 feet (OA). Burnett Oil Co., Inc. plans to dispose of a maximum 10,000 BWPD with a maximum pressure of 1,700 psi.

Any question about the application can be directed to Mark A. Jacoby (817) 332-5108, or any objection or request for hearing must be directed to the Oil Conservation Division, (505) 476-3440, 1120 South Saint Francis Drive, Santa Fe, NM 87504, within fifteen (15) days.

Published in the Artesia Daily Press, Artesia, N.M., March, 19 2014 Legal No 22903.



**C-108 Review Checklist:** Received 03/24/14 Add. Request: — Reply Date: — Suspended: — [Ver 13]

PERMIT TYPE: WFX / PMX / SWD Number: 1477 Permit Date: 04/14/14 Legacy Permits/Orders: CA-1

Well No. 1 Well Name(s): Cedar Lake 36 State [Previously Mesquite well] Occ appeared ext.

API: 30-0 15-30405 Spud Date: 10/03/98 New or Old: N (UIC Class II Primacy 03/07/1982)

Footages 1980 FSL / 1650 FWL Lot — or Unit K Sec 36 Tsp 17S Rge 30E County Eddy

General Location: 4 mi NE of Loco Hills Pool: Sand Tank Morrow Pool No.: 84872

BLM 100K Map: Hobbs Operator: Burnett Oil Company Inc OGRID: 3080 Contact: Leslie Garvis

COMPLIANCE RULE 5.9: Total Wells: 280 Inactive: 4 Fincl Assur: Yes Compl. Order? No IS 5.9 OK? Yes Date: 04/14/14

WELL FILE REVIEWED ☒ Current Status: P&A - prior approval as SWD

WELL DIAGRAMS: NEW: Proposed ☐ or RE-ENTER: Before Conv. ☐ After Conv. ☒ Logs in Imaging: GR/Neutron/Cal - Dual Laterolog & Sonic/Digital Acoustic

Planned Rehab Work to Well: Drill out P&A plugs 8506'; set cmt plug at 9315'-9215'; run casing/cmt; perf.

Well Construction Details:		Sizes (in)	Setting	Cement	Cement Top and
		Borehole / Pipe	Depths (ft)	Sx or Cf	Determination Method
Planned <input type="checkbox"/> or Existing <input checked="" type="checkbox"/> Surface		14 3/4 / 11 3/4	0 to 665	425	Cmt to surface
Planned <input type="checkbox"/> or Existing <input checked="" type="checkbox"/> Interm/Prod		11 / 8 5/8	0 to 4439	1350	Cir to surface
Planned <input checked="" type="checkbox"/> or Existing <input checked="" type="checkbox"/> Interm/Prod		7 7/8 / 5 1/2	0 to 9215	Lead 125 / Tail 400	Cir to surface
Planned <input type="checkbox"/> or Existing <input type="checkbox"/> Prod/Liner					
Planned <input type="checkbox"/> or Existing <input type="checkbox"/> Liner		Original well had open hole to 11244 - prior to P&A			
Planned <input type="checkbox"/> or Existing <input type="checkbox"/> OH / PERF			8506 to 9191	Inj Length	

Injection Stratigraphic Units:		Depths (ft)	Injection or Confining Units	Tops
Adjacent Unit: Litho. Struc. Por.				
Confining Unit: <input checked="" type="checkbox"/> Litho <input checked="" type="checkbox"/> Struc <input checked="" type="checkbox"/> Por		+45	Bone Spring	5695
Proposed Inj Interval TOP:		8500	Wolfcamp	8435
Proposed Inj Interval BOTTOM:		9191	formation	
Confining Unit: <input checked="" type="checkbox"/> Litho <input checked="" type="checkbox"/> Struc. Por.		+929	Strawn	10120
Adjacent Unit: Litho. Struc. Por.				

Completion/Operation Details:	
Drilled TD	11750
PBTD	11244
NEW TD	9215
NEW PBTD	9215
NEW Open Hole <input type="checkbox"/> or NEW Perfs <input checked="" type="checkbox"/>	
Tubing Size	3.5 in. Inter Coated? <u>Yes</u>
Proposed Packer Depth	8450 ft
Min. Packer Depth	8400 (100-ft limit)
Proposed Max. Surface Press.	1700 psi
Admin. Inj. Press.	1700 (0.2 psi per ft)

**AOR: Hydrologic and Geologic Information**

POTASH: R-111-P NA Noticed? NA BLM Sec Ord NA WIPP NA Noticed? NA SALT/SALADO T: — B: — CLIFF HOUSE NA

FRESH WATER: Aquifer Alluvial / unconfined Max Depth <200 HYDRO AFFIRM STATEMENT By Qualified Person ☒

NMOSE Basin: Roswell Artesian CAPITAN REEF: thru ☐ adj ☒ NA No. Wells within 1-Mile Radius? 0 FW Analysis NA

Disposal Fluid: Formation Source(s) Atoka / BS / WESA Analysis? Yes On Lease ☐ Operator Only ☒ or Commercial ☐

Disposal Int: Inject Rate (Avg/Max BWPD): 9500/10000 Protectable Waters? No Source: Geotech System: Closed ☒ or Open ☐

HC Potential: Producing Interval? No Formerly Producing? No Method: Logs ☒ P&A/Other — 2-Mile Radius Pool Map NA

AOR Wells: 1/2-M Radius Map? Yes Well List? Yes Total No. Wells Penetrating Interval: 0 Horizontals? 0

Penetrating Wells: No. Active Wells 0 Num Repairs? 0 on which well(s)? — Diagrams? NA

Penetrating Wells: No. P&A Wells 0 Num Repairs? 0 on which well(s)? — Diagrams? NA

NOTICE: Newspaper Date 03/19/14 Mineral Owner SLO Surface Owner SLO N. Date 03/19/14

RULE 26.7(A): Identified Tracts? Yes Affected Persons: Yates / EOG / OXY USA / Envervest Operations Date 03/19/14

Permit Conditions: Issues: None - Cedar Lake Event not applicable

Add Permit Cond: No special requirements