

Submit 1 Copy To Appropriate District Office  
District I – (575) 393-6161  
1625 N. French Dr., Hobbs, NM 88240  
District II – (575) 748-1283  
811 S. First St., Artesia, NM 88210  
District III – (505) 334-6178  
1000 Rio Brazos Rd., Aztec, NM 87410  
District IV – (505) 476-3460  
1220 S. St. Francis Dr., Santa Fe, NM 87505

State of New Mexico  
Energy, Minerals and Natural Resources

Form C-103  
Revised August 1, 2011

OIL CONSERVATION DIVISION  
1220 South St. Francis Dr.  
Santa Fe, NM 87505

WELL API NO. 30-015-00259
5. Indicate Type of Lease STATE <input type="checkbox"/> FEE <input checked="" type="checkbox"/>
6. State Oil & Gas Lease No.
7. Lease Name or Unit Agreement Name Cleaveland
8. Well Number 1
9. OGRID Number 025575
10. Pool name or Wildcat Atoka; Glorieta-Yeso

SUNDRY NOTICES AND REPORTS ON WELLS  
(DO NOT USE THIS FORM FOR PROPOSALS TO DRILL OR TO DEEPEN OR PLUG BACK TO A DIFFERENT RESERVOIR. USE "APPLICATION FOR PERMIT" (FORM C-101) FOR SUCH PROPOSALS.)

1. Type of Well: Oil Well ☒ Gas Well ☐ Other

2. Name of Operator  
EOG Y Resources, Inc.

3. Address of Operator  
104 S. Fourth Street Artesia, NM 88210

4. Well Location

Unit Letter B : 660 feet from the N line and 1980 feet from the E line  
Section 33 Township 18S Range 26E NMPM Eddy County

11. Elevation (Show whether DR, RKB, RT, GR, etc.)  
3386' GR

12. Check Appropriate Box to Indicate Nature of Notice, Report or Other Data

NOTICE OF INTENTION TO:

PERFORM REMEDIAL WORK ☐ PLUG AND ABANDON ☐  
TEMPORARILY ABANDON ☐ CHANGE PLANS ☐  
PULL OR ALTER CASING ☐ MULTIPLE COMPL ☐  
DOWNHOLE COMMINGLE ☐

OTHER: Surface Pool Commingle ☒

SUBSEQUENT REPORT OF:

REMEDIAL WORK ☐ ALTERING CASING ☐  
COMMENCE DRILLING OPNS. ☐ P AND A ☐  
CASING/CEMENT JOB ☐

OTHER: PL - 1333 ☐

13. Describe proposed or completed operations. (Clearly state all pertinent details, and give pertinent dates, including estimated date of starting any proposed work). SEE RULE 19.15.7.14 NMAC. For Multiple Completions: Attach wellbore diagram of proposed completion or recompletion.

EOG Y Resources respectfully requests administrative approval to Surface Pool commingle gas for the following wells:

Cleaveland #1  
Atoka; Glorieta-Yeso (3250)  
Sec. 33-T18S-R26E  
API #30-015-00259  
Fee lease  
Eddy County, NM

Cleaveland #2  
Dayton; San Andres, west (16160)  
Sec. 33-T18S-R26E  
API #30-015-00260  
Fee lease  
Eddy County, NM

The battery is located at Sec.33-T18S-R26E. Please see attach site security diagram.  
The ownership is identical. Statement from landman included.

Gas Measurement

Total sales/production volumes will be allocated back to individual wells based on periodic well test.

Estimated daily gas production for the Cleaveland #1 is 5 MCF and for the Cleaveland #2 is 2 MCF.

The proposed pool commingling is necessary for economic operations of these leases.

The purpose of the Surface Pool Commingle is to reduce operating costs for operating and treating, the interest of economic feasibility, the reduction of environmental impact area, and overall emissions. It will not result in reduced royalty or improper measurement of production.

Recommend Signature by Director mth  
I hereby certify that the information above is true and complete to the best of my knowledge and belief.

SIGNATURE Miriam Morales TITLE Production Acct. Asst. DATE \_\_\_\_\_  
Type or print name Miriam Morales E-mail address: Miriam\_morales@eogresources.com PHONE: 575-748-4200

For State Use Only

APPROVED BY: Nathan Riley TITLE Director DATE 10/10/18  
Conditions of Approval (if any):

DATE IN 10/05/2018	SUSPENSE	ENGINEER	LOGGED IN 10/09/2018	TYPE PL	APP NO. PLM18282 48288
-----------------------	----------	----------	-------------------------	------------	---------------------------

ABOVE THIS LINE FOR DIVISION USE ONLY

**NEW MEXICO OIL CONSERVATION DIVISION**  
 - Engineering Bureau -  
 1220 South St. Francis Drive, Santa Fe, NM 87505



**ADMINISTRATIVE APPLICATION CHECKLIST**

THIS CHECKLIST IS MANDATORY FOR ALL ADMINISTRATIVE APPLICATIONS FOR EXCEPTIONS TO DIVISION RULES AND REGULATIONS WHICH REQUIRE PROCESSING AT THE DIVISION LEVEL IN SANTA FE

**Application Acronyms:**

**[NSL-Non-Standard Location] [NSP-Non-Standard Proration Unit] [SD-Simultaneous Dedication]**  
**[DHC-Downhole Commingling] [CTB-Lease Commingling] [PLC-Pool/Lease Commingling]**  
**[PC-Pool Commingling] [OLS - Off-Lease Storage] [OLM-Off-Lease Measurement]**  
**[WFX-Waterflood Expansion] [PMX-Pressure Maintenance Expansion]**  
**[SWD-Salt Water Disposal] [IPI-Injection Pressure Increase]**  
**[EOR-Qualified Enhanced Oil Recovery Certification] [PPR-Positive Production Response]**

- [1] **TYPE OF APPLICATION** - Check Those Which Apply for [A]  
 [A] Location - Spacing Unit - Simultaneous Dedication  
☐ NSL ☐ NSP ☐ SD
- Check One Only for [B] or [C]  
 [B] Commingling - Storage - Measurement  
☐ DHC ☐ CTB ☐ PLC ☒ PC ☐ OLS ☐ OLM
- [C] Injection - Disposal - Pressure Increase - Enhanced Oil Recovery  
☐ WFX ☐ PMX ☐ SWD ☐ IPI ☐ EOR ☐ PPR
- [D] Other: Specify \_\_\_\_\_

- [2] **NOTIFICATION REQUIRED TO:** - Check Those Which Apply, or ☐ Does Not Apply  
 [A] ☐ Working, Royalty or Overriding Royalty Interest Owners  
 [B] ☐ Offset Operators, Leaseholders or Surface Owner  
 [C] ☐ Application is One Which Requires Published Legal Notice  
 [D] ☒ Notification and/or Concurrent Approval by BLM or SLO  
 U.S. Bureau of Land Management - Commissioner of Public Lands, State Land Office  
 [E] ☒ For all of the above, Proof of Notification or Publication is Attached; and/or,  
 [F] ☐ Waivers are Attached

- [3] **SUBMIT ACCURATE AND COMPLETE INFORMATION REQUIRED TO PROCESS THE TYPE OF APPLICATION INDICATED ABOVE.**

[4] **CERTIFICATION:** I hereby certify that the information submitted with this application for administrative approval is **accurate** and **complete** to the best of my knowledge. I also understand that **no action** will be taken on this application until the required information and notifications are submitted to the Division.

**Note: Statement must be completed by an individual with managerial and/or supervisory capacity.**

Miriam Morales  
 Print or Type Name

*Miriam Morales*  
 Signature

Production Acct. Asst.  
 Title

10/31/18  
 Date

Miriam\_morales@eogresources.com  
 e-mail Address

District I  
1625 N. French Drive, Hobbs, NM 88240  
District II  
1301 W. Grand Ave, Artesia, NM 88210  
District III  
1000 Rio Brazos Road, Aztec, NM 87410  
District IV  
1220 S. St Francis Dr, Santa Fe, NM  
87505

State of New Mexico  
Energy, Minerals and Natural Resources Department

Form C-107-B  
Revised June 10, 2003

**OIL CONSERVATION DIVISION**  
1220 S. St Francis Drive  
Santa Fe, New Mexico 87505

Submit the original  
application to the Santa Fe  
office with one copy to the  
appropriate District Office.

**APPLICATION FOR SURFACE COMMINGLING (DIVERSE OWNERSHIP)**

OPERATOR NAME: EOGY Resources, Inc

OPERATOR ADDRESS: 104 South Fourth St. Artesia, NM 88210

APPLICATION TYPE:

☒ Pool Commingling ☐ Lease Commingling ☐ Pool and Lease Commingling ☐ Off-Lease Storage and Measurement (Only if not Surface Commingled)

LEASE TYPE: ☒ Fee ☐ State ☐ Federal

Is this an Amendment to existing Order? ☐ Yes ☒ No If "Yes", please include the appropriate Order No. \_\_\_\_\_

Have the Bureau of Land Management (BLM) and State Land office (SLO) been notified in writing of the proposed commingling

☒ Yes ☐ No

**(A) POOL COMMINGLING**

Please attach sheets with the following information

(1) Pool Names and Codes	Gravities / BTU of Non-Commingled Production	Calculated Gravities / BTU of Commingled Production		Calculated Value of Commingled Production	Volumes
Atoka; Glorieta-Yeso (3250)	1085.9	1111.95			
Dayton; San Andres, west (16160)	1138				

(2) Are any wells producing at top allowables? ☐ Yes ☒ No

(3) Has all interest owners been notified by certified mail of the proposed commingling? ☒ Yes ☐ No.

(4) Measurement type: ☒ Metering ☐ Other (Specify)

(5) Will commingling decrease the value of production? ☐ Yes ☒ No If "yes", describe why commingling should be approved

**(B) LEASE COMMINGLING**

Please attach sheets with the following information

(1) Pool Name and Code.

(2) Is all production from same source of supply? ☐ Yes ☐ No

(3) Has all interest owners been notified by certified mail of the proposed commingling? ☐ Yes ☐ No

(4) Measurement type: ☐ Metering ☐ Other (Specify)

**(C) POOL and LEASE COMMINGLING**

Please attach sheets with the following information

(1) Complete Sections A and E.

**(D) OFF-LEASE STORAGE and MEASUREMENT**

Please attached sheets with the following information

(1) Is all production from same source of supply? ☐ Yes ☐ No

(2) Include proof of notice to all interest owners.

**(E) ADDITIONAL INFORMATION (for all application types)**

Please attach sheets with the following information

(1) A schematic diagram of facility, including legal location.

(2) A plat with lease boundaries showing all well and facility locations. Include lease numbers if Federal or State lands are involved.

(3) Lease Names, Lease and Well Numbers, and API Numbers.

I hereby certify that the information above is true and complete to the best of my knowledge and belief.

SIGNATURE:

TITLE: Production Acct. Asst.

DATE:

10/3/18

TYPE OR PRINT NAME Miriam Morales

TELEPHONE NO.: (575) 748-1471

E-MAIL ADDRESS: miriam\_morales@eogresources.com

**NEW MEXICO OIL CONSERVATION COMMISSION  
WELL LOCATION AND ACREAGE DEDICATION PLAT**

Form C-102  
Supersedes C-128  
Effective 1-1-65

All distances must be from the outer boundaries of the Section.

Operator <b>Yates Petroleum Corporation</b>			Lease <b>Cleveland</b>		Well No. <b>1</b>
Unit Letter <b>B</b>	Section <b>33</b>	Township <b>18S</b>	Range <b>26E</b>	County <b>Eddy</b>	
Actual Footage Location of Well: <b>660</b> feet from the <b>North</b> line and <b>1980</b> feet from the <b>East</b> line					
Ground Level Elev. <b>3386</b>	Producing Formation <b>Glor-Yeso, SA</b>		Pool <b>Atoka Penasco Draw</b>	Dedicated Acreage: <b>40</b> Acres	

1. Outline the acreage dedicated to the subject well by colored pencil or hachure marks on the plat below.
2. If more than one lease is dedicated to the well, outline each and identify the ownership thereof (both as to working interest and royalty).
3. If more than one lease of different ownership is dedicated to the well, have the interests of all owners been consolidated by communitization, unitization, force-pooling, etc?

☐ Yes    ☐ No    If answer is "yes," type of consolidation \_\_\_\_\_

If answer is "no," list the owners and tract descriptions which have actually been consolidated. (Use reverse side of this form if necessary.) \_\_\_\_\_

No allowable will be assigned to the well until all interests have been consolidated (by communitization, unitization, forced-pooling, or otherwise) or until a non-standard unit, eliminating such interests, has been approved by the Commission.

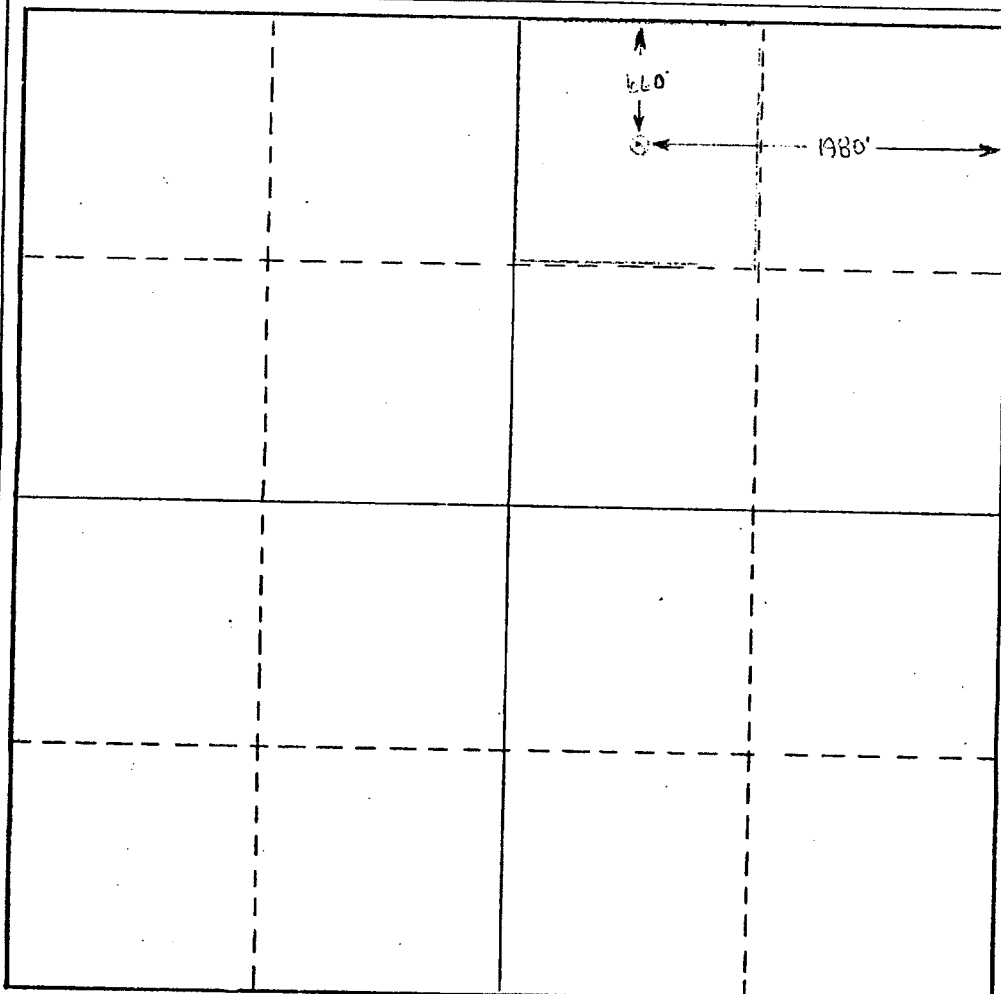

**CERTIFICATION**

I hereby certify that the information contained herein is true and complete to the best of my knowledge and belief.

Name  
*J. Morgan*  
Position  
**Production Supt**  
Company  
**Yates Petroleum Corp.**  
Date  
**October 13, 1977**

I hereby certify that the well location shown on this plat was plotted from field notes of actual surveys made by me or under my supervision, and that the same is true and correct to the best of my knowledge and belief.

Date Surveyed  
  
Registered Professional Engineer and/or Land Surveyor

Certificate No. \_\_\_\_\_

NEW MEXICO OIL CONSERVATION COMMISSION  
Well Location and Acreage Dedication Plat

Section A.

Date January 16, 1959

Operator E. P. CAMPBELL Lease CLEVELAND  
Well No. 2 Unit Letter B Section 33 Township 10 South Range 26 East NMPM  
Located 330 Feet From North Line, 2310 Feet From East Line  
County Eddy G. L. Elevation \_\_\_\_\_ Dedicated Acreage 40 Acres  
Name of Producing Formation San Andres Pool Dayton Undesignated

1. Is the Operator the only owner\* in the dedicated acreage outlined on the plat below?  
Yes x No \_\_\_\_\_.
2. If the answer to question one is "no," have the interests of all the owners been consolidated by communitization agreement or otherwise? Yes ✓ No \_\_\_\_\_. If answer is "yes," Type of Consolidation Operating Agreement from original Lessors
3. If the answer to question two is "no," list all the owners and their respective interests below:

Owner

Land Description

Section B

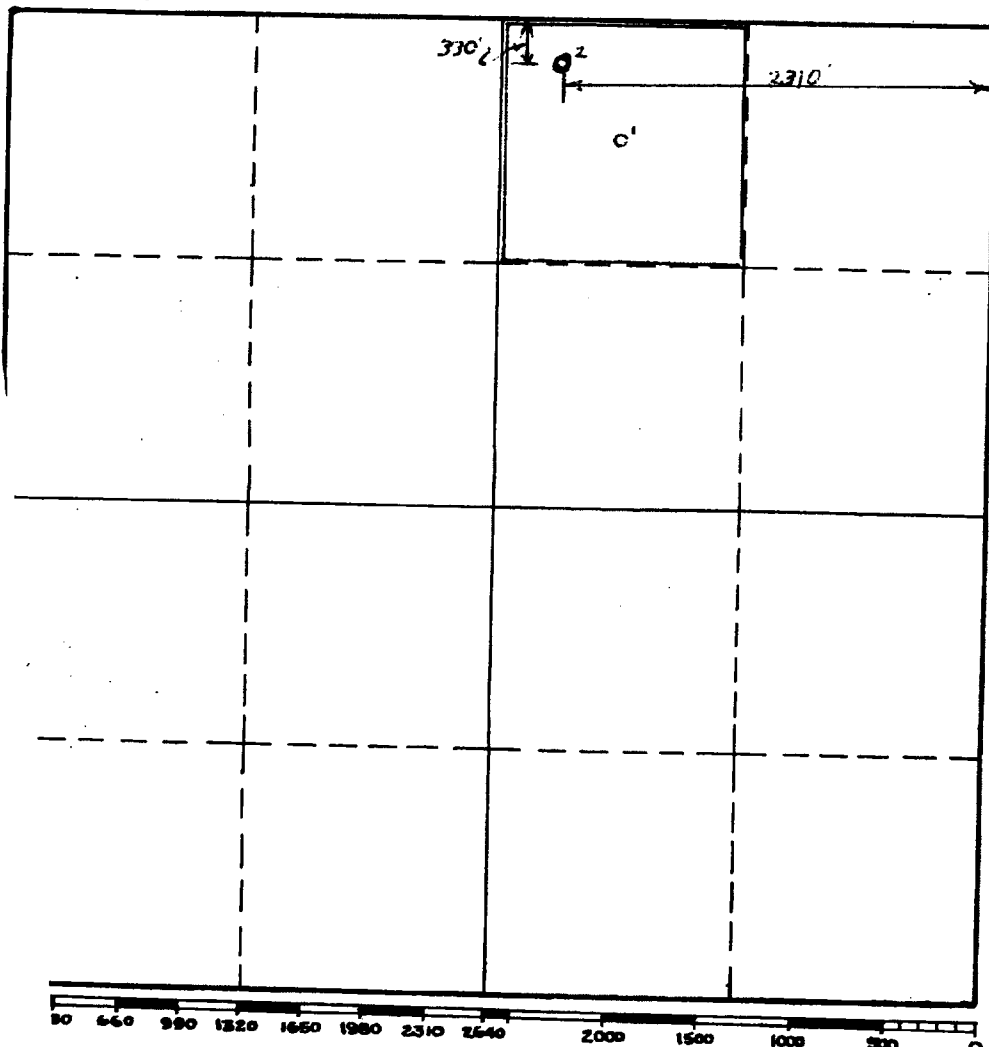

This is to certify that the information in Section A above is true and complete to the best of my knowledge and belief.

E. P. Campbell

(Operator)

Guy A. Swartz

(Representative)

902 Lubbock Nat. Bank Bldg.  
Lubbock, Texas

Address

This is to certify that the well location shown on the plat in Section B was plotted from field notes of actual surveys made by me or under my supervision and that the same is true and correct to the best of my knowledge and belief.

Date Surveyed 1-15-59

Guy A. Swartz  
Registered Professional  
Engineer and/or Land Surveyor.

Certificate No. 2787  
(See instructions for completing this form on the reverse side)





### Artesia Division

105 South 4th Street • Artesia, NM 88210  
(575) 748-1471

# Cleaveland Battery

## NE 1/4 - NE 1/4 \* Sec 33 - T18S-R26E\* Unit C Eddy County, NM

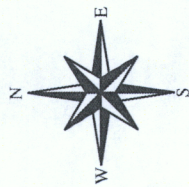

- = Valve Closed
- = Valve Opened

BS&W  
= Bottom Sediment & Water  
(Skip Tank)

[S] = Separator

[G] = Gas Meter

[C] = Back Pressure Valve

[3] = 3 Phase Separator

[W] = Water Pump

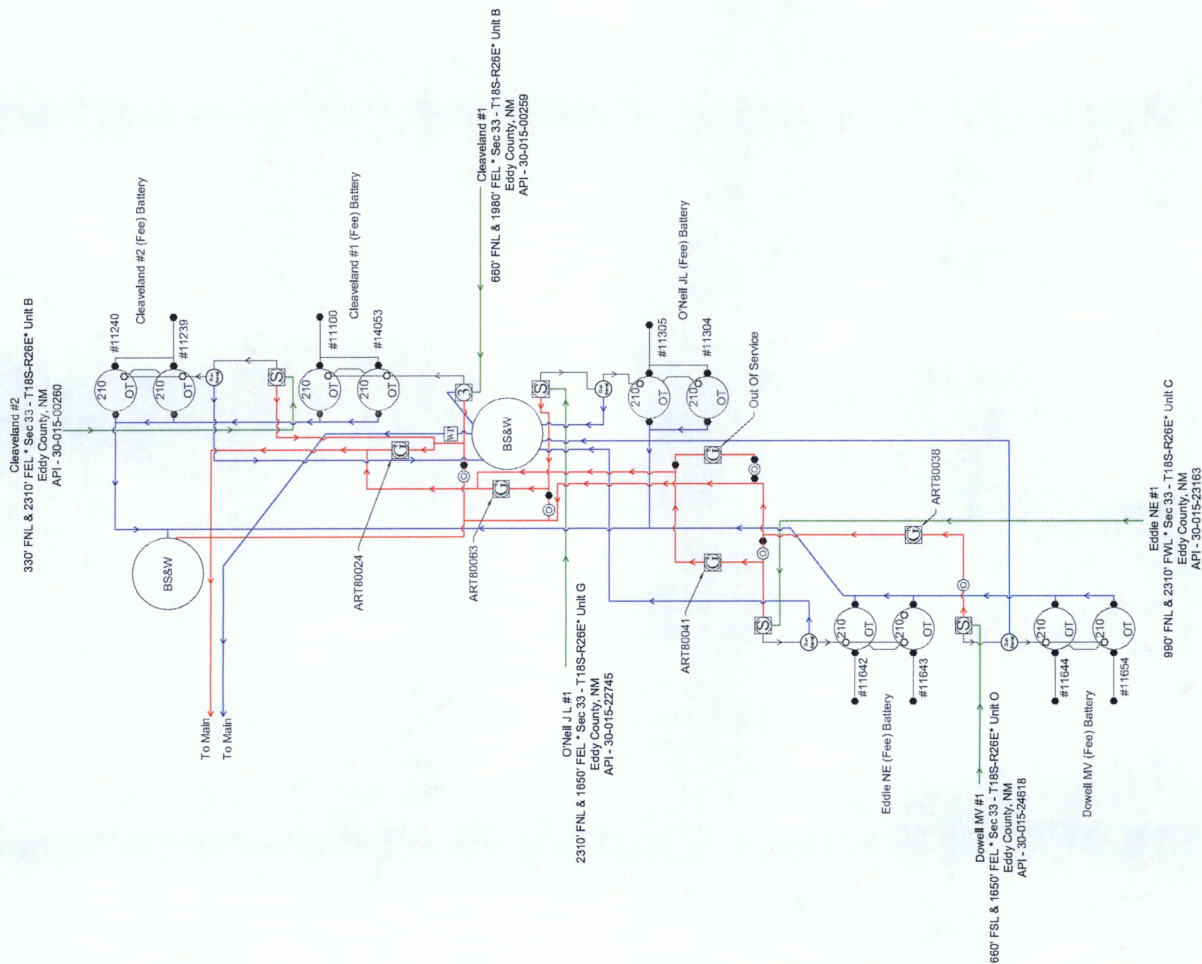

Corey Windham  
10-3-2019  
Owen Mainke

Rev	Description	Date	Prod	Measure	Facility
-	Original Release	09-18-2018	Owen M	Corey W	

To whom it may concern:

The ownership of the following wells and associated pools are identical in working, royalty, and overriding royalty interest and percentages.

Well Name: Cleaveland #1  
Formation: Atoka; Glorieta-Yeso

Well Name: Cleaveland #2  
Formation: Dayton; San Andres, west

I certified that this information is true to the best of my knowledge.

  
\_\_\_\_\_  
Landman

**eogresources**

104 South Fourth Street  
Artesia, New Mexico 88210



7014 0510 0001 0744 2608

7014 0510 0001 0744 2608

**U.S. Postal Service™**  
**CERTIFIED MAIL™ RECEIPT**  
(Domestic Mail Only; No Insurance Coverage Provided)

For delivery information visit our website at [www.usps.com](http://www.usps.com)

*PC Official Mail 1/2 1/19/04*

Postage	\$
Certified Fee	
Return Receipt Fee (Endorsement Required)	
Restricted Delivery Fee (Endorsement Required)	
Total Postage & Fees	\$

Postmark  
Here

Sent To *S.L.O.*  
Street, Apt. No.,  
or PO Box No. *310 Old Santa Fe Trail*  
City, State, ZIP+4 *Santa Fe, NM 87504*

PS Form 3800, August 2006

See Reverse for Instructions

New Mexico State  
Commissioner of Public Lands  
310 Old Santa Fe Trail  
P.O. Box 1148  
Santa Fe, New Mexico 87504-1148

**SENDER: COMPLETE THIS SECTION**

- Complete items 1, 2, and 3. Also complete item 4 if Restricted Delivery is desired.
- Print your name and address on the reverse so that we can return the card to you.
- Attach this card to the back of the mailpiece, or on the front if space permits.

1. Article Addressed to:

New Mexico State Land Office  
Commissioner of Public Lands  
310 Old Santa Fe Trail  
P.O. Box 1148  
Santa Fe, New Mexico 87504-1148

**COMPLETE THIS SECTION ON DELIVERY**

A. Signature <b>X</b>	<input type="checkbox"/> Agent <input type="checkbox"/> Addressee
B. Received by (Printed Name)	C. Date of Delivery
D. Is delivery address different from item 1? If YES, enter delivery address below:	
<input type="checkbox"/> Yes <input type="checkbox"/> No	
3. Service Type <input checked="" type="checkbox"/> Certified Mail <input type="checkbox"/> Registered Mail <input type="checkbox"/> Insured Mail <input type="checkbox"/> Express Mail <input type="checkbox"/> Return Receipt for Merchandise <input type="checkbox"/> C.O.D.	
4. Restricted Delivery? (Extra Fee) <input type="checkbox"/> Yes <input type="checkbox"/> No	

2. Article Number  
(Transfer from se) 7014 0510 0001 0744 2608

PS Form 3811, February 2004

Domestic Return Receipt

102595-02-M-1540



## McMillan, Michael, EMNRD

---

**From:** Miriam Morales <Miriam\_Morales@eogresources.com>  
**Sent:** Tuesday, October 9, 2018 1:49 PM  
**To:** McMillan, Michael, EMNRD  
**Subject:** [EXT] Cleaveland #1 & 2 PC

Michael,

This is to confirm that I accidently sent the application for the above mentioned wells to the SLO. These wells are fee wells.

Thank you,

*Miriam Morales*