

Initial Application Part I

Received: 12/16/2019

This application is placed in file for record. It MAY or MAY NOT have been reviewed to be determined Administratively Complete



December 13, 2019

Oil Conservation Division
1220 South St. Francis Dr.
Santa Fe, New Mexico 87505

Subject: Vista Disposal Solutions, LLC – Karen Federal SWD #2
Application for Authorization to Inject

To Whom It May Concern,

On behalf of Vista Disposal Solutions, LLC (Vista), ALL Consulting, LLC (ALL) is submitting the enclosed Application for Authorization to Inject for the Karen Federal SWD #2, a proposed salt water disposal well, in Lea County, NM.

Should you have any questions regarding the enclosed application, please contact Dan Arthur at (918) 382-7581 or darthur@all-llc.com.

Sincerely,
ALL Consulting

Dan Arthur
President/Chief Engineer

3O56L-191216-C-1080

Revised March 23, 2017

RECEIVED: 12/16/19	REVIEWER: BLL	TYPE: SWD	APP NO: pBL1935132692
--------------------	---------------	-----------	-----------------------

ABOVE THIS TABLE FOR OCD DIVISION USE ONLY

NEW MEXICO OIL CONSERVATION DIVISION
 - Geological & Engineering Bureau -
 1220 South St. Francis Drive, Santa Fe, NM 87505

**ADMINISTRATIVE APPLICATION CHECKLIST**

THIS CHECKLIST IS MANDATORY FOR ALL ADMINISTRATIVE APPLICATIONS FOR EXCEPTIONS TO DIVISION RULES AND REGULATIONS WHICH REQUIRE PROCESSING AT THE DIVISION LEVEL IN SANTA FE

Applicant: _____ OGRID Number: _____
 Well Name: _____ API: _____
 Pool: _____ Pool Code: _____

SUBMIT ACCURATE AND COMPLETE INFORMATION REQUIRED TO PROCESS THE TYPE OF APPLICATION INDICATED BELOW

1) **TYPE OF APPLICATION:** Check those which apply for [A]

A. Location - Spacing Unit - Simultaneous Dedication

☐ NSL ☐ NSP (PROJECT AREA) ☐ NSP (PRORATION UNIT) ☐ SD

B. Check one only for [I] or [II]

[I] Commingling - Storage - Measurement

☐ DHC ☐ CTB ☐ PLC ☐ PC ☐ OLS ☐ OLM

[II] Injection - Disposal - Pressure Increase - Enhanced Oil Recovery

☐ WFX ☐ PMX ☐ SWD ☐ IPI ☐ EOR ☐ PPR

SWD-2358

2) **NOTIFICATION REQUIRED TO:** Check those which apply.

- A. ☐ Offset operators or lease holders
 B. ☐ Royalty, overriding royalty owners, revenue owners
 C. ☐ Application requires published notice
 D. ☐ Notification and/or concurrent approval by SLO
 E. ☐ Notification and/or concurrent approval by BLM
 F. ☐ Surface owner
 G. ☐ For all of the above, proof of notification or publication is attached, and/or,
 H. ☐ No notice required

FOR OCD ONLY

- ☐ Notice Complete
☐ Application Content Complete

3) **CERTIFICATION:** I hereby certify that the information submitted with this application for administrative approval is **accurate** and **complete** to the best of my knowledge. I also understand that **no action** will be taken on this application until the required information and notifications are submitted to the Division.

Note: Statement must be completed by an individual with managerial and/or supervisory capacity.

Print or Type Name

Signature

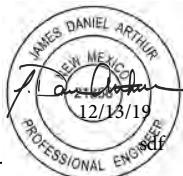

Date

Phone Number

e-mail Address

STATE OF NEW MEXICO
ENERGY, MINERALS AND NATURAL
RESOURCES DEPARTMENT

Oil Conservation Division
1220 South St. Francis Dr.
Santa Fe, New Mexico 87505

FORM C-108
Revised June 10, 2003

APPLICATION FOR AUTHORIZATION TO INJECT

- I. PURPOSE: _____ Secondary Recovery _____ Pressure Maintenance X Disposal
_____ Storage Application qualifies for administrative approval? X Yes _____ No
- II. OPERATOR: Vista Disposal Solutions, LLC
ADDRESS: 12444 NM 10th St., Building G, Suite 202-512, Yukon, OK 73099
CONTACT PARTY Nate Alleman PHONE: 918-382-7581
- III. WELL DATA: Complete the data required on the reverse side of this form for each well proposed for injection.
Additional sheets may be attached if necessary.
- IV. Is this an expansion of an existing project? _____ Yes X No
If yes, give the Division order number authorizing the project: _____
- V. Attach a map that identifies all wells and leases within two miles of any proposed injection well with a one-half mile radius circle drawn around each proposed injection well. This circle identifies the well's area of review.
- VI. Attach a tabulation of data on all wells of public record within the area of review which penetrate the proposed injection zone. Such data shall include a description of each well's type, construction, date drilled, location, depth, record of completion, and a schematic of any plugged well illustrating all plugging detail.
- VII. Attach data on the proposed operation, including:
1. Proposed average and maximum daily rate and volume of fluids to be injected;
 2. Whether the system is open or closed;
 3. Proposed average and maximum injection pressure;
 4. Sources and an appropriate analysis of injection fluid and compatibility with the receiving formation if other than reinjected produced water; and,
 5. If injection is for disposal purposes into a zone not productive of oil or gas at or within one mile of the proposed well, attach a chemical analysis of the disposal zone formation water (may be measured or inferred from existing literature, studies, nearby wells, etc.).
- *VIII. Attach appropriate geologic data on the injection zone including appropriate lithologic detail, geologic name, thickness, and depth. Give the geologic name, and depth to bottom of all underground sources of drinking water (aquifers containing waters with total dissolved solids concentrations of 10,000 mg/l or less) overlying the proposed injection zone as well as any such sources known to be immediately underlying the injection interval.
- IX. Describe the proposed stimulation program, if any.
- *X. Attach appropriate logging and test data on the well. (If well logs have been filed with the Division, they need not be resubmitted).
- *XI. Attach a chemical analysis of fresh water from two or more fresh water wells (if available and producing) within one mile of any injection or disposal well showing location of wells and dates samples were taken.
- XII. Applicants for disposal wells must make an affirmative statement that they have examined available geologic and engineering data and find no evidence of open faults or any other hydrologic connection between the disposal zone and any underground sources of drinking water.
- XIII. Applicants must complete the "Proof of Notice" section on the reverse side of this form.
- XIV. Certification: I hereby certify that the information submitted with this application is true and correct to the best of my knowledge and belief.
NAME: Dan Arthur, P.E., SPEC TITLE: President/Chief Engineer
SIGNATURE: [Signature] DATE: 12/13/2019
E-MAIL ADDRESS: darthur@all-llc.com
- XV. If the information required under Sections VI, V _____ ve has been previously submitted, it need not be resubmitted.
Please show the date and circumstances of the earlier submittal: _____



DISTRIBUTION: Original and one copy to Santa Fe with one copy to the appropriate District Office

Side 2

III. WELL DATA

A. The following well data must be submitted for each injection well covered by this application. The data must be both in tabular and schematic form and shall include:

- (1) Lease name; Well No.; Location by Section, Township and Range; and footage location within the section.
- (2) Each casing string used with its size, setting depth, sacks of cement used, hole size, top of cement, and how such top was determined.
- (3) A description of the tubing to be used including its size, lining material, and setting depth.
- (4) The name, model, and setting depth of the packer used or a description of any other seal system or assembly used.

Division District Offices have supplies of Well Data Sheets which may be used or which may be used as models for this purpose. Applicants for several identical wells may submit a "typical data sheet" rather than submitting the data for each well.

B. The following must be submitted for each injection well covered by this application. All items must be addressed for the initial well. Responses for additional wells need be shown only when different. Information shown on schematics need not be repeated.

- (1) The name of the injection formation and, if applicable, the field or pool name.
- (2) The injection interval and whether it is perforated or open-hole.
- (3) State if the well was drilled for injection or, if not, the original purpose of the well.
- (4) Give the depths of any other perforated intervals and detail on the sacks of cement or bridge plugs used to seal off such perforations.
- (5) Give the depth to and the name of the next higher and next lower oil or gas zone in the area of the well, if any.

XIV. PROOF OF NOTICE

All applicants must furnish proof that a copy of the application has been furnished, by certified or registered mail, to the owner of the surface of the land on which the well is to be located and to each leasehold operator within one-half mile of the well location.

Where an application is subject to administrative approval, a proof of publication must be submitted. Such proof shall consist of a copy of the legal advertisement which was published in the county in which the well is located. The contents of such advertisement must include:

- (1) The name, address, phone number, and contact party for the applicant;
- (2) The intended purpose of the injection well; with the exact location of single wells or the Section, Township, and Range location of multiple wells;
- (3) The formation name and depth with expected maximum injection rates and pressures; and,
- (4) A notation that interested parties must file objections or requests for hearing with the Oil Conservation Division, 1220 South St. Francis Dr., Santa Fe, New Mexico 87505, within 15 days.

NO ACTION WILL BE TAKEN ON THE APPLICATION UNTIL PROPER PROOF OF NOTICE HAS BEEN SUBMITTED.

NOTICE: Surface owners or offset operators must file any objections or requests for hearing of administrative applications within 15 days from the date this application was mailed to them.

Application for Authorization to Inject
Well Name: Karen Federal SWD #2

III – Well Data *(The Wellbore Diagram is included as Attachment 1)*

A.

(1) General Well Information:

Operator: Vista Disposal Solutions, LLC (OGRID No. 329051)
Lease Name & Well Number: Karen Federal SWD #2
Location Footage Calls: 2,334' FSL & 2,416' FWL
Legal Location: Unit Letter K, S5 T26S R34E
Ground Elevation: 3,366'
Proposed Injection Interval: 5,355' – 6,165'
County: Lea

(2) Casing Information:

Type	Hole Size	Casing Size	Casing Weight	Setting Depth	Sacks of Cement	Estimated TOC	Method Determined
Surface	24"	20"	133.0 lb./ft	800'	780	Surface	Circulation
Intermediate 1	14-3/4"	13-3/8"	68.0 lb./ft	5,315'	1,190	Surface	Circulation
Production	12-1/4"	9-5/8"	39.0 lb./ft	6,265'	355	5,200'	CBL

(3) Tubing Information:

5-1/2" (composite weight string) of fiberglass-coated tubing with setting depth of 5,335'

(4) Packer Information: Baker Hornet or equivalent packer set at 5,335'

B.

(1) Injection Formation Name: Bell Canyon

Pool Name: SWD; Bell Canyon

Pool Code: 96769

(2) Injection Interval: Perforated injection between 5,355' – 6,165'

(3) Drilling Purpose: New Drill for Salt Water Disposal

(4) Other Perforated Intervals: No other perforated intervals exist.

(5) Overlying Oil and Gas Zones: No Overlying oil and gas zones exist.

Underlying Oil and Gas Zones: Below are the approximate formation tops for known oil and gas producing zones in the area.

- Bone Springs (9,475')

V – Well and Lease Maps

The following maps are included in **Attachment 2**:

- 2-mile Oil & Gas Well Map
- 2-mile Lease Map
- 2-mile Mineral Ownership Map
- 2-mile Surface Ownership Map
- 1/2-mile Well Detail List
- Potash Lease Map

VI – AOR Well List

There are no wells within the 1/2-mile AOR that penetrate the proposed injection zone.

A list of the wells within the 1/2-mile AOR is included in **Attachment 2**.

VII – Proposed Operation

- (1) **Proposed Maximum Injection Rate:** 25,000 bpd
Proposed Average Injection Rate: 12,500 bpd
- (2) A closed system will be used.
- (3) **Proposed Maximum Surface Injection Pressure:** 1,071 psi (Based on 0.2 psi per Foot)
Proposed Average Surface Injection Pressure: approximately 750 psi
- (4) **Source Water Analysis:** It is expected that the injectate will consist of produced water from production wells completed in the Wolfcamp and Bone Springs formations. Analysis of water from these formations is included in **Attachment 3**.
- (5) **Injection Formation Water Analysis:** The proposed SWD will be injecting water into the Bell Canyon formation which is a non-productive zone known to be compatible with formation water from the Wolfcamp and Bone Springs formations. Water analyses results were selected from intervals comparable to that of the injection zone in the Bell Canyon Formation - Delaware Mountain Group. Water analysis from in the area are included in **Attachment 4**.

VIII – Geologic Description

The proposed injection interval includes the Bell Canyon formations from 5,335 – 6,165 feet. This formation consists of clastic sandstones, interbedded with several tight limestone members. Several thick sections of porous sandstone capable of taking water are present within the subject formation in the area.

The base of the deepest Underground Source of Drinking Water (USDW) is at a depth of approximately 775 feet. Surface casing will be set at a depth of 800 feet, which is 25 feet below the top of the Rustler formation, which isolates the USDW. Geophysical log assessment was conducted to accurately determine the top of the Rustler formation, and the top and the base of the Salado formation in this area. Water well depths in the area range from approximately 50 - 200 feet below ground surface.

IX – Proposed Stimulation Program

A small cleanup acid job may be used to remove mud and drill cuttings from the formation. However, no other formation stimulation is currently planned.

X – Logging and Test Data

Geophysical logs will be submitted to the Division upon completion of the well.

XI – Fresh Groundwater Samples

Based on a review of data from the New Mexico Office of the State Engineer, 3 water wells are located within 1-mile of the proposed SWD location; however, after numerous attempts to contact, and determine the status of the water wells from Intrepid Potash, permission to sample could not be obtained; therefore, no groundwater samples were collected in association with this application.

A water well map of the area is included in **Attachment 5**.

XII – No Hydrologic Connection Statement & Technical Assessment & Feasibility for Injection

ALL Consulting (ALL) has examined all available public and published geologic and engineering data and has found no evidence of open faults or any other hydrologic connection between the injection interval and overlying Underground Sources of Drinking Water (USDWs). Additionally, the casing, cementing, and completion program has been designed to further ensure that there will be no hydrologic connection, nor will it allow for migration of injectate below the proposed injection interval that could affect correlative rights issues.

Additionally, ALL Consulting has conducted an extensive technical review and geologic assessment of the alleged New Mexico Oil Conservation Division Delaware Mountain Group (DMG) saltwater disposal well impacts to production wells and drilling operations associated with the Brushy Canyon Formation. A letter from ALL's qualified geological expert not only addresses the issue of no hydrologic connection, but also states that the Bell Canyon Formation includes viable injection intervals with multiple confining zones is included in **Attachment 6**.

XIII – Proof of Notice

A Public Notice was filed with the Hobbs News-Sun newspaper and an affidavit is included in **Attachment 7**.

A copy of the application was mailed to the OCD District Office, landowner, and leasehold operators within 1/2-mile of the proposed SWD location. A list of the recipients, as well as delivery confirmations, are included in **Attachment 7**.

Attachments

Attachment 1:

- C-102
- Wellbore Diagram

Attachment 2: Area of Review Information:

- 2-mile Oil & Gas Well Map
- 2-mile Lease Map
- 2-mile Mineral Ownership Map
- 2-mile Surface Ownership Map
- 1/2-mile Well Detail List
- Potash Lease Map

Attachment 3: Source Water Analyses

Attachment 4: Injection Formation Water Analyses

Attachment 5: Water Well Map and Well Data

Attachment 6: No Hydrologic Connection Statement & Technical Assessment & Feasibility for Injection

Attachment 7: Public Notice Affidavit and Notice of Application Confirmations

Attachment 1

- C-102
- Wellbore Diagram

DISTRICT I
1625 N. French Dr., Hobbs, NM 88240
Phone: (575) 393-6161 Fax: (575) 393-0720

DISTRICT II
811 S. First St., Artesia, NM 88210
Phone: (575) 748-1283 Fax: (575) 748-9720

DISTRICT III
1000 Rio Brazos Road, Aztec, NM 87410
Phone: (505) 334-6178 Fax: (505) 334-6170

DISTRICT IV
1220 S. St. Francis Dr., Santa Fe, NM 87505
Phone: (505) 476-3460 Fax: (505) 476-3462

State of New Mexico
Energy, Minerals & Natural Resources Department
OIL CONSERVATION DIVISION
1220 South St. Francis Dr.
Santa Fe, NM 87505

Form C-102
Revised August 1, 2011
Submit one copy to appropriate
District Office

☐ AMENDED REPORT

WELL LOCATION AND ACREAGE DEDICATION PLAT

¹ API Number	² Pool Code 96769	³ Pool Name SWD; Bell Canyon
⁴ Property Code	⁵ Property Name Karen Federal SWD	⁶ Well Number 2
⁷ GRID No. 329051	⁸ Operator Name Vista Disposal Solutions, LLC	⁹ Elevation 3366'

¹⁰Surface Location

UL or lot no.	Section	Township	Range	Lot Idn	Feet from the	North/South line	Feet from the	East/West line	County
K	5	26-S	34-E		2334'	South	2416'	West	Lea

¹¹Bottom Hole Location If Different From Surface

UL or lot no.	Section	Township	Range	Lot Idn	Feet from the	North/South line	Feet from the	East/West line	County

¹² Dedicated Acres	¹³ Joint or Infill	¹⁴ Consolidation Code	¹⁵ Order No.

No allowable will be assigned to this completion until all interests have been consolidated or a non-standard unit has been approved by the division.

<p>T-26-S, R-34-E N.M.P.M.</p> <p>Sec. 5</p> <p>Karen Federal SWD #2 Elev. 3366' NAD 83 NM East N = 390813.9' E = 801736.5' Lat. = 32.0716387 Long. = -103.4926630</p>						<p>¹⁷OPERATOR CERTIFICATION</p> <p>I hereby certify that the information contained herein is true and complete to the best of my knowledge and belief, and that this organization either owns a working interest or unleased mineral interest in the land including the proposed bottom hole location or has a right to drill this well at this location pursuant to a contract with an owner of such a mineral or working interest, or to a voluntary pooling agreement or a compulsory pooling order heretofore entered by the division.</p> <p>Signature _____ Date _____</p> <p>Printed Name _____</p> <p>E-mail Address _____</p>
<p>¹⁸SURVEYOR CERTIFICATION</p> <p>I hereby certify that the well location shown on this plat was plotted from field notes of actual surveys made by me or under my supervision, and that the same is true and correct to the best of my belief.</p> <p>7-22-2019 Date of Survey</p> <p>Signature and Seal of Professional Surveyor</p> <p>10324 Certificate Number</p>						

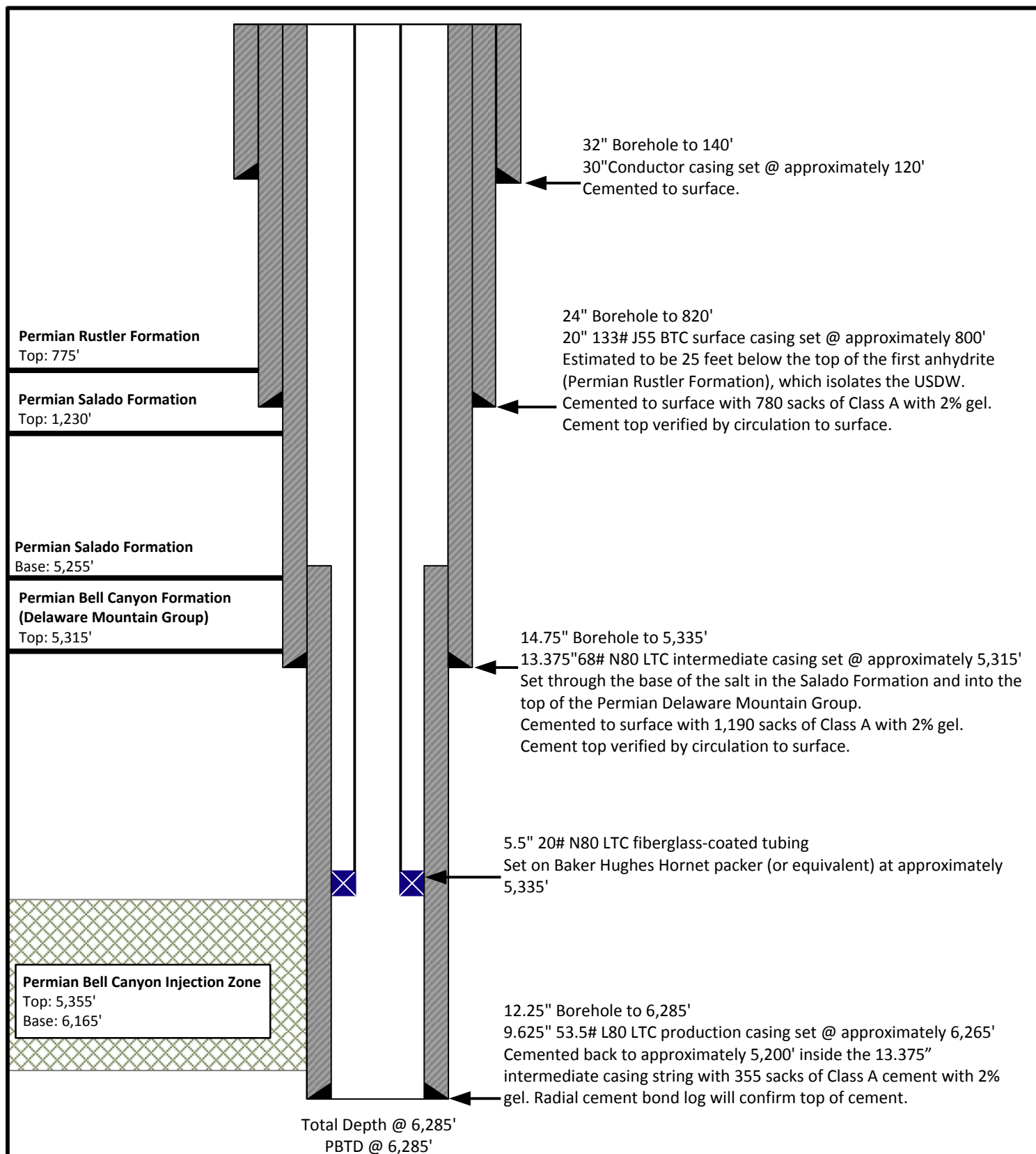

NOT TO SCALE

Note: Listed depths and cement volumes are approximates based on available information. All cement calculations use yield of 1.18 cubic foot per sack and include 40% excess.



Drawn by: Joshua Ticknor

Project Manager:
Dan Arthur

Date: 11/25/2019

Vista Disposal Solutions, LLC
Karen Federal SWD #2

HORNET Packer

Product Family No. H64682

HORNET EL Packer

Product Family No. H64683

The mechanically set HORNET™ packer offers ease of operation with quarter-turn right to set and release. Converting it for wireline-setting applications is simple and inexpensive. The HORNET packer provides for landing in compression, tension, or neutral positions. Every component from the jay track, to the internal bypass, to the packing-element system and the upper slip assembly has been developed to ensure the HORNET's setting and releasing reliability.

The HORNET EL packer is run and set on electric line using an E-4™ (Product Family No. H43702) with a slow-set power charge or a J™ setting tool (Product Family No. H41371) and a special wireline adapter kit. An L-10™ type on/off seal nipple is run on top of the packer to connect the tubing to the packer and to house a blanking plug when the packer is used as a temporary bridge plug.

Features and Benefits

- Upper Slip Assembly:
 - Thoroughly tested across API minimum to maximum casing ID tolerances for each specified casing weight, for setting and releasing reliability
 - Slip-wicker configuration providing bidirectional-load support with solid upper cone to support highest tensile loads
 - Staged-release action eliminates high-overpull requirement
 - Minimal set-down weight required to anchor slips
- Internal Bypass Seal:
 - Durable bypass seal design provides sealing after unloading, under differential pressures
 - No O-ring sealing system
- Packing Element System:
 - Fully tested to combined ratings at the API's maximum ID tolerance
- Patented enhancements to control overboost
- High-performance, three-piece element system
- Lower Slip and Jay Assembly:
 - Slips and drag blocks tested to maximum API tolerance ID for positive set and ease of release
 - One-quarter-turn right setting and releasing action
 - Packoff of packing elements with applied tension or compression
 - Spacing in jay ensures opening of internal bypass, before slip releasing action begins—important to both ease of release and safety
 - Automatically returns to running position

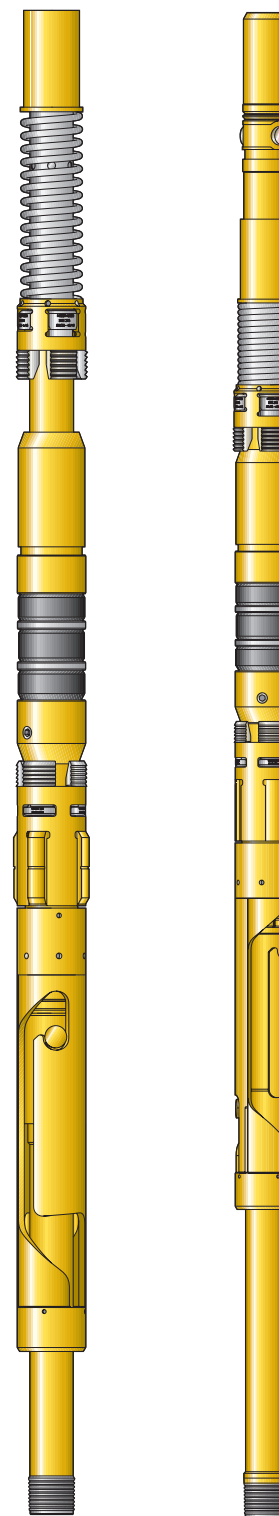

HORNET Packer
Product Family
No. H64682

HORNET EL Packer
Product Family
No. H64683

Attachment 2

Area of Review Information:

- 2-mile Oil & Gas Well Map
- 2-mile Lease Map
- 2-mile Mineral Ownership Map
- 2-mile Surface Ownership Map
- 1/2-mile Well Detail List
- Potash Lease Map

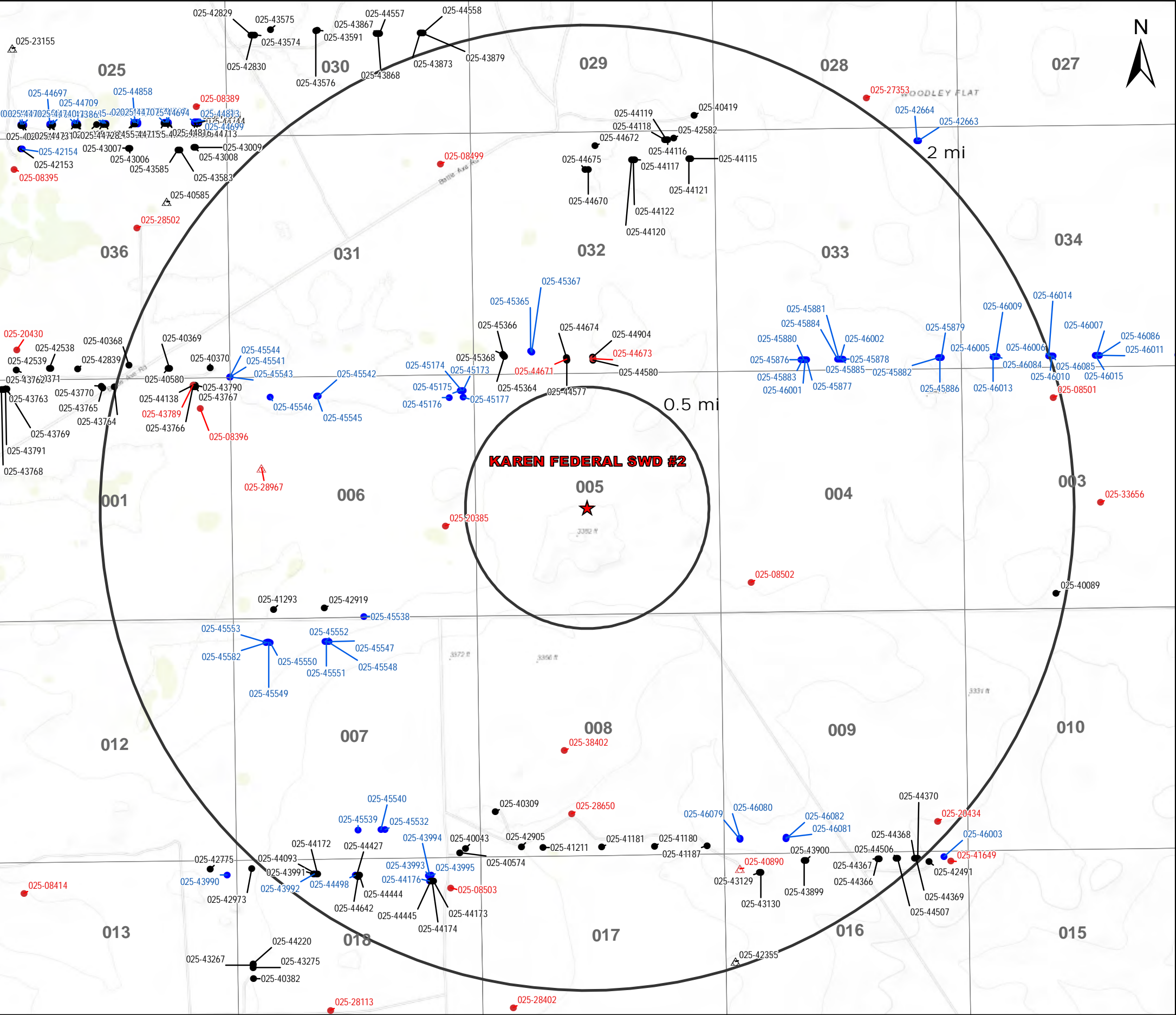

Legend

- ★ Proposed SWD
- Oil, Active (119)
- Oil, New (91)
- Oil, Plugged (22)
- △ Salt Water Injection, Active (3)
- △ Salt Water Injection, Plugged (2)

Source Info: NMOCD O&G Wells updated 7/30/2019
(<http://www.emnrd.state.nm.us/OCD/ocdgis.html>)

O&G Wells Area of Review		
KAREN FEDERAL SWD #2 Lea County, New Mexico		
Proj Mgr: Dan Arthur	December 12, 2019	Mapped by: Ben Bockelmann
Prepared for: 		Prepared by: 



Service Layer Credits: Sources: Esri, HERE, Garmin, Intermap, increment P Corp., GEBCO, USGS, FAO, NPS, NRCAN, GeoBase, IGN, Kadaster NL, Ordnance Survey, Esri Japan, METI, Esri China (Hong Kong), (c) OpenStreetMap contributors, and the GIS User Community

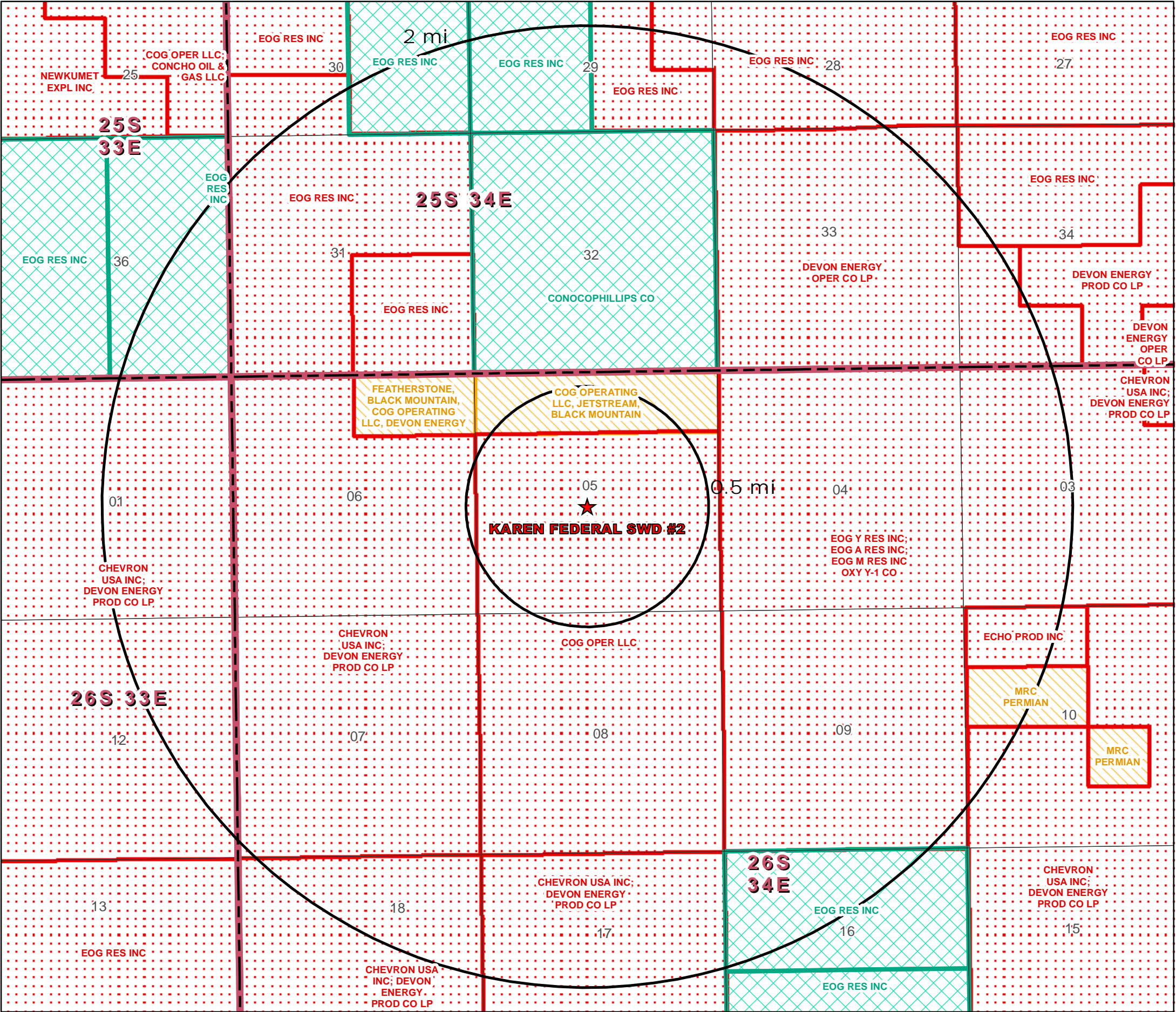

Legend

- ★ Proposed SWD
- NMSLO Mineral Leases
- BLM Mineral Leases
- Private Mineral Leases
- Unleased Minerals - Private Owned



Mineral Lease
Area of Review

KAREN FEDERAL SWD #2
Lea County, New Mexico

Proj Mgr:
Dan Arthur

December 12, 2019

Mapped by:
Ben Bockelmann

Prepared for:

Prepared by:



Source Info: BLM Mineral Leases (<https://catalog.data.gov/dataset/blm-new-mexico-mineral-ownership>) & NMSLO O&G Leases (<http://www.nmstatelands.org/maps-gis/gis-data-download/>)

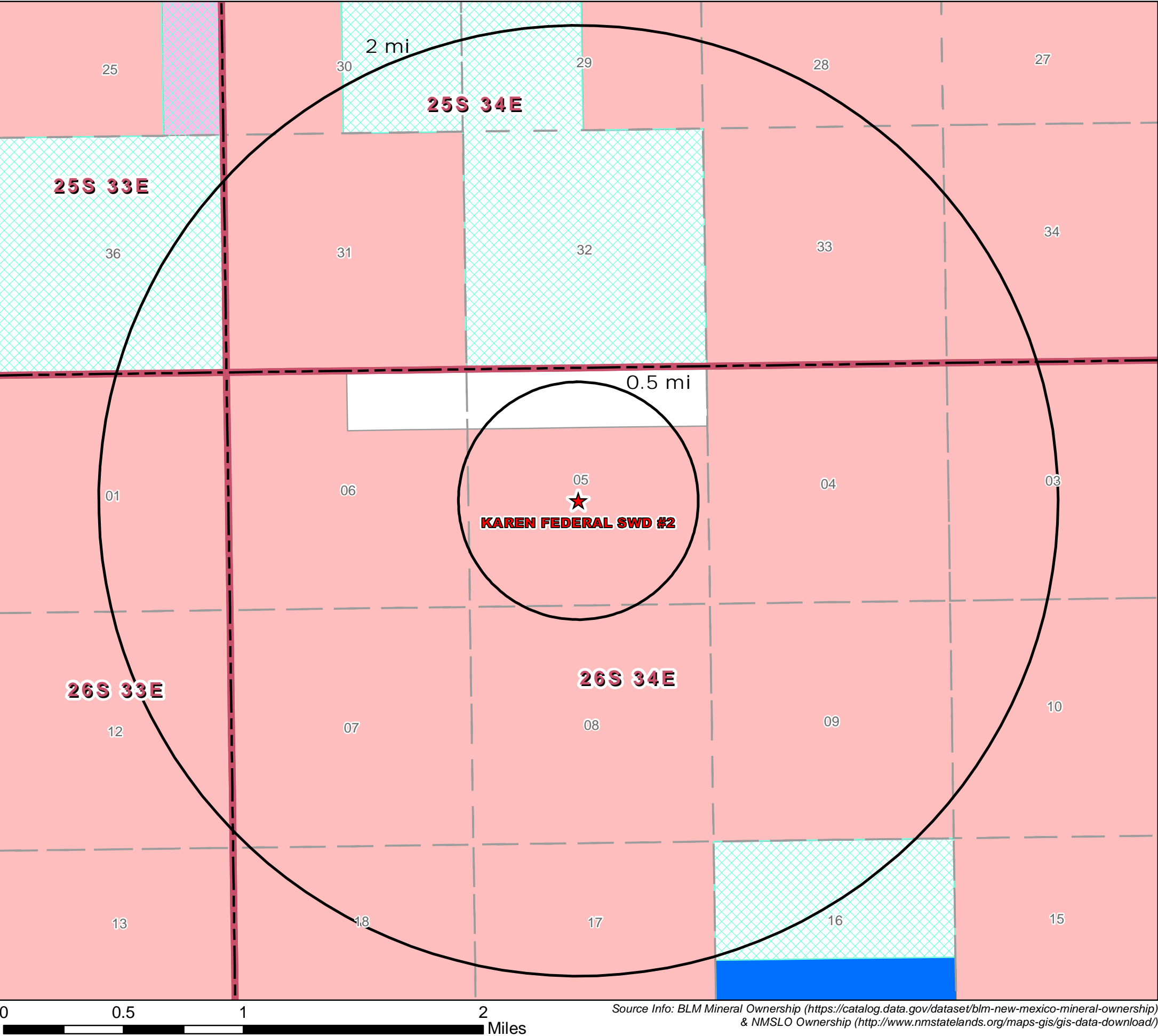

Legend

★ Proposed SWD

Mineral Ownership

- All minerals are owned by U.S. (BLM)
- Other minerals are owned by the U.S. (BLM)
- Subsurface minerals (NMSLO)
- Surface and Subsurface minerals (NMSLO)
- Private minerals

Mineral Ownership Area of Review		
KAREN FEDERAL SWD #2 Lea County, New Mexico		
Proj Mgr: Dan Arthur	December 12, 2019	Mapped by: Ben Bockelmann
Prepared for: 	Prepared by: 	

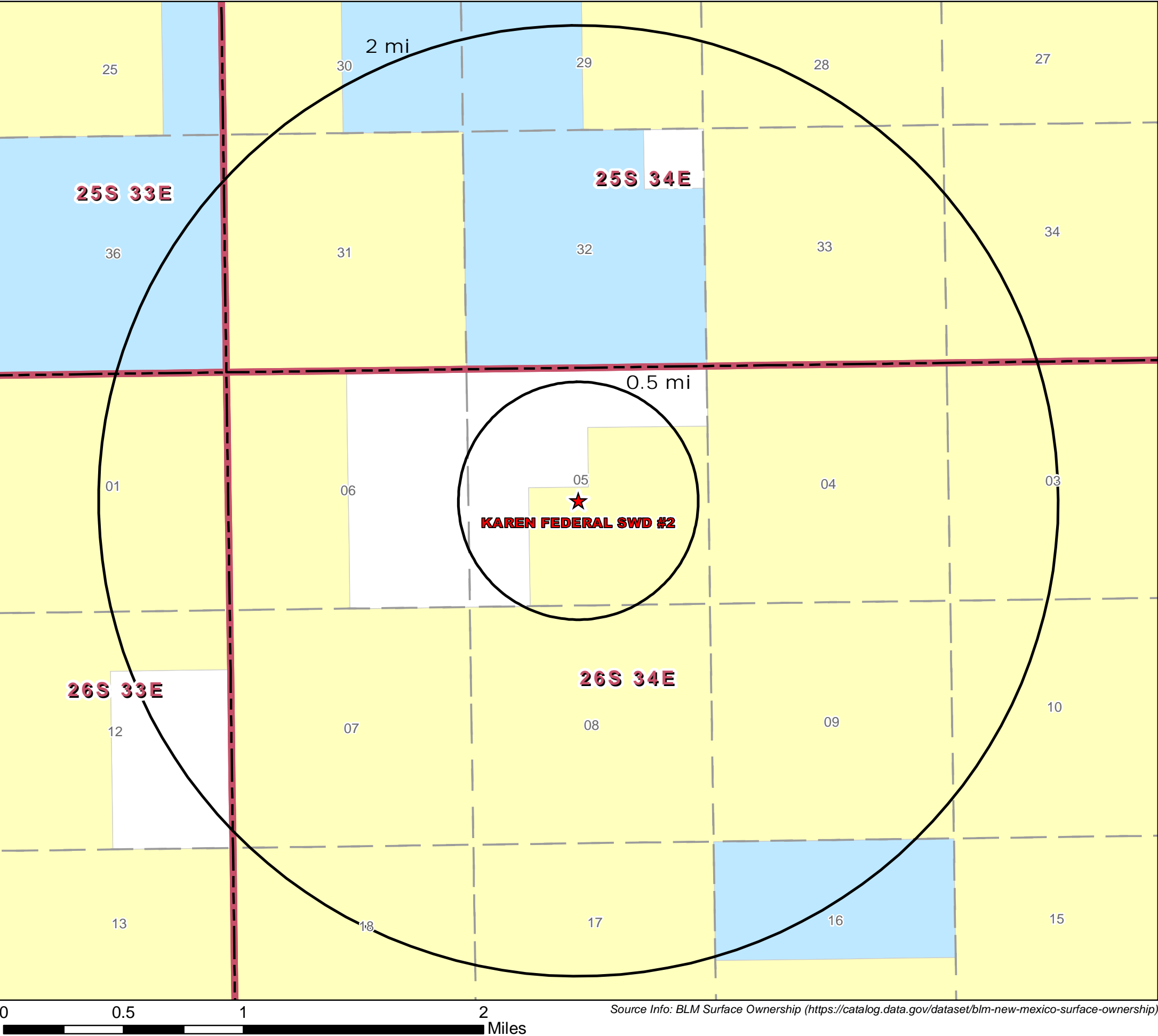

Legend

★ Proposed SWD

Surface Ownership

- BLM
- Private
- State

Surface Ownership Area of Review		
KAREN FEDERAL SWD #2 Lea County, New Mexico		
Proj Mgr: Dan Arthur	December 12, 2019	Mapped by: Ben Bockelmann
Prepared for: 	Prepared by: 	

AOR Tabulation for Karen Federal SWD #2 (Top of Injection Interval: 5,355')							
Well Name	API#	Well Type	Operator	Spud Date	Location (Sec., Tn., Rng.)	Total Vertical Depth (feet)	Penetrate Inj. Zone?

Notes: There are no wells within the 1/2-mile AOR.

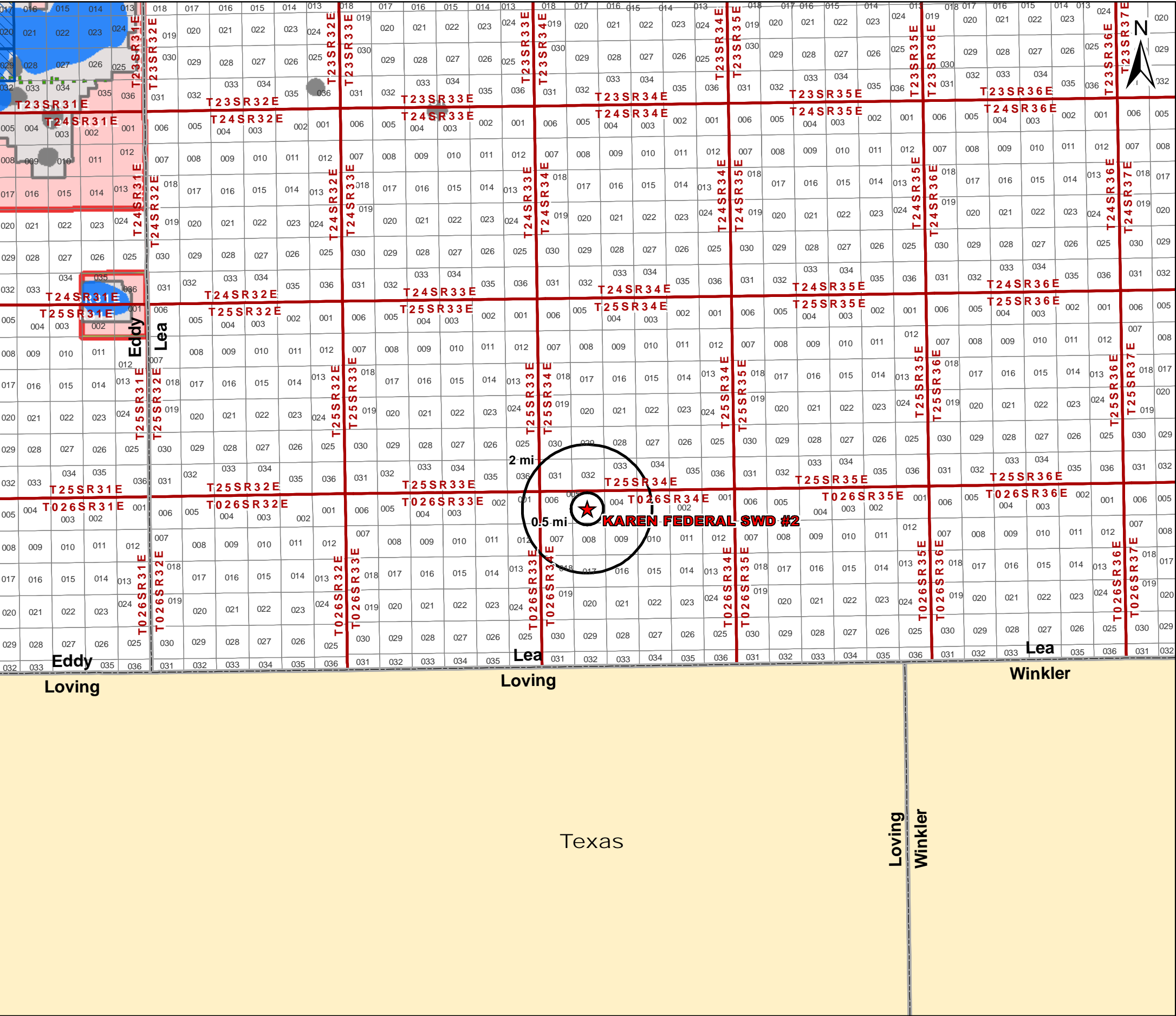

Legend

- ★ Proposed SWD
- Potash Leases
- Ore Type - Measured
- Ore Type - Indicated
- KPLA
- SOPA
- Drill Islands
- Status
 - Approved
 - Nominated

Potash Leases
Area of Review

KAREN FEDERAL SWD #2
Lea County, New Mexico

Proj Mgr:
Dan Arthur

December 12, 2019

Mapped by:
Ben Bockelmann

Prepared for:

Prepared by:

Source Info: BLM CFO Potash (https://www.nm.blm.gov/shapeFiles/cfo/carlsbad_spatial_data.html)

Attachment 3

Source Water Analyses

Wolfcamp



Water Analysis

Date: 23-Aug-11

2708 West County Road, Hobbs NM 88240

Phone (575) 392-5556 Fax (575) 392-7307

Analyzed For

Brushy Draw 1#1

Company	Well Name	County	State
	BD	Lee	New Mexico
		Eddy	1-265-295
Sample Source	Swab Sample	Sample #	1

Formation

Depth

Specific Gravity	1.170	SG @ 60 °F	1.172
pH	6.30	Sulfides	Absent
Temperature (°F)	70	Reducing Agents	

Cations

Sodium (Calc)	in Mg/L	77,962	in PPM	66,520
Calcium	in Mg/L	4,000	in PPM	3,413
Magnesium	in Mg/L	1,200	in PPM	1,024
Soluble Iron (FE2)	in Mg/L	10.0	in PPM	9

Anions

Chlorides	in Mg/L	130,000	in PPM	110,922
Sulfates	in Mg/L	250	in PPM	213
Bicarbonates	in Mg/L	127	in PPM	108
Total Hardness (as CaCO3)	in Mg/L	15,000	in PPM	12,799
Total Dissolved Solids (Calc)	in Mg/L	213,549	in PPM	182,209
Equivalent NaCl Concentration	in Mg/L	182,868	in PPM	156,031

Scaling Tendencies

*Calcium Carbonate Index 507,520

Below 500,000 Remote / 500,000 - 1,000,000 Possible / Above 1,000,000 Probable

*Calcium Sulfate (Gyp) Index 1,000,000

Below 500,000 Remote / 500,000 - 10,000,000 Possible / Above 10,000,000 Probable

*This Calculation is only an approximation and is only valid before treatment of a well or several weeks after treatment.

Remarks RW=.048@70F

Report # 3188

Sec 22, T25S, R28E

Bone Spring

Water Analysis Report by Baker Petrolite

North Permian Basin Region

P.O. Box 740

Sundown, TX 79372-0740

(806) 229-8121

Lab Team Leader - Sheila Hernandez

(432) 495-7240

Company:		Sales RDT:	33514.1
Region:	PERMIAN BASIN	Account Manager:	TONY HERNANDEZ (575) 910-7135
Area:	ARTESIA, NM	Sample #:	534665
Lease/Platform:	PINOCHLE 'BPN' STATE COM	Analysis ID #:	106795
Entity (or well #):	2 H	Analysis Cost:	\$90.00
Formation:	UNKNOWN		
Sample Point:	WELLHEAD		

Summary		Analysis of Sample 534665 @ 75 F							
Sampling Date:	03/10/11	Anions		mg/l	meq/l	Cations		mg/l	meq/l
Analysis Date:	03/18/11	Chloride:	109618.0		3091.92	Sodium:	70275.7		3056.82
Analyst:	SANDRA GOMEZ	Bicarbonate:	2135.0		34.99	Magnesium:	195.0		18.04
		Carbonate:	0.0		0.	Calcium:	844.0		42.12
TDS (mg/l or g/m3):	184911.1	Sulfate:	747.0		15.55	Strontium:	220.0		5.02
Density (g/cm3, tonne/m3):	1.113	Phosphate:				Barium:	0.8		0.01
Anion/Cation Ratio:	1	Borate:				Iron:	6.5		0.23
		Silicate:				Potassium:	889.0		22.22
						Aluminum:			
Carbon Dioxide:	0.50 PPM	Hydrogen Sulfide:			0 PPM	Chromium:			
Oxygen:		pH at time of sampling:			7	Copper:			
Comments:		pH at time of analysis:				Lead:			
		pH used in Calculation:			7	Manganese:	0.100		0.
						Nickel:			

Conditions		Values Calculated at the Given Conditions - Amounts of Scale in lb/1000 bbl										
Temp	Gauge Press.	Calcite CaCO ₃		Gypsum CaSO ₄ ·2H ₂ O		Anhydrite CaSO ₄		Celestite SrSO ₄		Barite BaSO ₄		CO ₂ Press
F	psi	Index	Amount	Index	Amount	Index	Amount	Index	Amount	Index	Amount	psi
80	0	1.06	188.52	-1.20	0.00	-1.18	0.00	-0.11	0.00	0.58	0.29	1.72
100	0	1.10	206.05	-1.29	0.00	-1.20	0.00	-0.15	0.00	0.35	0.29	2.35
120	0	1.12	224.17	-1.38	0.00	-1.19	0.00	-0.17	0.00	0.16	0.00	3.17
140	0	1.13	243.17	-1.42	0.00	-1.18	0.00	-0.18	0.00	0.00	0.00	4.21

Note 1: When assessing the severity of the scale problem, both the saturation index (SI) and amount of scale must be considered.

Note 2: Precipitation of each scale is considered separately. Total scale will be less than the sum of the amounts of the five scales.

Note 3: The reported CO₂ pressure is actually the calculated CO₂ fugacity. It is usually nearly the same as the CO₂ partial pressure.

Attachment 4

Injection Formation Water Analyses

Injection Formation Water Analysis																			
Vista Disposal Solutions, LLC - Delaware Mountain Group Formation																			
Wellname	API	Latitude	Longitude	Section	Township	Range	Unit	Ftgns	Ftgew	County	State	Company	Field	Formation	Depth	Tds_mgL	Chloride_mgL	Bicarbonate_mgL	Sulfate_mgL
NORTH EL MAR UNIT #017	3002508430	32.016605	-103.617691	30	26S	33E	E	1880N	660W	LEA	NM		EL MAR	DELAWARE	4742	254756	159400	80	210
NORTH EL MAR UNIT #057	3002508440	32.001946	-103.6131134	31	26S	33E	F	1935N	2090W	LEA	NM		EL MAR	DELAWARE	4777	259554	163000	61	253
GOEDEKE #002	3002508407	32.059799	-103.5579987	10	26S	33E	G	1980N	1980E	LEA	NM		SALADO DRAW	DELAWARE	5200	293925	184000	85	210
MARSHALL #001	3002508358	32.284832	-103.6176224	19	23S	33E	M	660S	660W	LEA	NM		CRUZ	DELAWARE	5237	238931	148600	127	156
NORTH EL MAR UNIT #022	3002508278	32.011662	-103.6262207	25	26S	32E	J	1980S	1980E	LEA	NM		EL MAR	DELAWARE	4749	244815	153500	88	220
NORTH EL MAR UNIT #032	3002508291	32.008019	-103.6434479	26	26S	32E	O	660S	1980E	LEA	NM		EL MAR	DELAWARE	4605	254895			
NORTH EL MAR UNIT #028	3002508296	32.011654	-103.6521072	26	26S	32E	L	1980S	660W	LEA	NM		EL MAR	DELAWARE	4565	249479	156000	976	373
NORTH EL MAR UNIT #045	3002508308	32.004387	-103.6381302	35	26S	32E	A	660N	330E	LEA	NM		EL MAR	DELAWARE	4633	255115	160000	85	310
COTTON DRAW UNIT #024	3002508176	32.143189	-103.6650696	10	25S	32E	K	1980S	1980W	LEA	NM		PADUCA	DELAWARE	4787	246555	152600	112	939
COTTON DRAW UNIT #001	3002508182	32.125053	-103.6693573	15	25S	32E	M	660S	660W	LEA	NM		PADUCA	DELAWARE	4804	308600			
COTTON DRAW UNIT #001	3002508182	32.125053	-103.6693573	15	25S	32E	M	660S	660W	LEA	NM		PADUCA	DELAWARE	4804	309990			
MONSANTO STATE #001	3002508196	32.128666	-103.6736145	16	25S	32E	I	1980S	660E	LEA	NM		PADUCA	DELAWARE	4800	224016	138600	139	462
COTTON DRAW UNIT #004	3002508221	32.121422	-103.6693649	22	25S	32E	D	660N	660W	LEA	NM		PADUCA	DELAWARE	4685	276839	170500	198	552
G E JORDAN NCT-1 #021	3002508226	32.107822	-103.6704102	27	25S	32E	D	330N	330W	LEA	NM		PADUCA	DELAWARE	4498	239464	147800	64	908
HANAGAN B FEDERAL #001	3002508151	32.212124	-103.6603851	15	24S	32E	O	660S	1980E	LEA	NM		DOUBLE X	DELAWARE	4955	229878	142200	168	491
HANAGAN B FEDERAL #001	3002508151	32.212124	-103.6603851	15	24S	32E	O	660S	1980E	LEA	NM		DOUBLE X	DELAWARE	4955	229709	142100	168	491

Attachment 5

Water Well Map and Well Data



Legend

★ Proposed SWD

NMOSE PODs

Status

- Active (2)
- Pending (0)
- Change Location of Well (0)
- Capped (0)
- Plugged (0)
- Incomplete (0)
- Unknown (2)

Water Wells Area of Review

KAREN FEDERAL SWD #2
Lea County, New Mexico

Proj Mgr:
Dan Arthur

December 12, 2019

Mapped by:
Ben Bockelmann



Water Well Sampling Rationale						
Vista Disposal Solutions, LLC - Karen Federal SWD #2						
SWD	Water Wells	Owner	Available Contact Information	Use	Sampling Required	Notes
Karen Federal SWD #2	C-02292 Pod 1	Intrepid Potash Contact: Katie Keller (Land Manager)	Corporate Head Quarters: 1-303-296-3006 1001 17th St., Suite 1050 Denver, Colorado 80202	Livestock Watering	No	After a conversation with Mr. Dinwiddie, (Previous Owner; 7-8-2019), we were informed that the ranch, and the wells, were sold to Intrepid Potash as of May, 2019. We spoke with Katie Keller, Intrepid Potash, on (12-13-2019), and she was unaware of the wells and their statuses. Mrs. Keller requested additional information regarding the water wells that is detailed in the email below. However, no response to the email was received, and after an additional phone call on (12-16-2019), Katie Keller, or another staff member at Intrepid Potash, could not be reached. Therefore, after numerous attempts to determined the status of the water wells from Intrepid Potash, we were unable to confirm whether the wells are active and obtain permission to sample. Therefore, no water well samples were collected in association with this application.
Karen Federal SWD #2	C-03441 Pod 1				No	
Karen Federal SWD #2	C-03442 Pod 1				No	

Daniel Arthur

From: Oliver Seekins <oseekins@all-llc.com>
Sent: Friday, December 13, 2019 5:08 PM
To: katie.keller@intrepidpotash.com
Cc: 'Daniel Arthur'; 'Kris Andersen'; 'Nathan Alleman'
Subject: Request to Sample Water Wells C-02292, C-03441, and C-03442
Attachments: Karen Federal SWD #2 - Public Notice.pdf; 1-Mile Water Well Map.pdf

Mrs. Keller,

Thank you for taking the time to talk with me on the phone today. To summarize our phone call, our client Vista Disposal solutions, LLC is in the process of applying for an injection well permit in Lea County, NM (Proposed well location NE ¼ SW ¼ of section 05, Township 26S Range 34E 2,334 FSL & 2,416 FWL). As part of the application process the New Mexico Oil Conservation District requires applicants to confirm that status of each permitted water well within a 1-mile radius of their proposed location. Attached is a copy of the public noticed being published by Hobbs News Sun on Sunday, December 15th 2019, as well as a copy of the water well AOR map that is being used in the application.

Could you or one of staff members at the mine confirm the status of the water wells listed below(Active – has a functioning pump currently installed at the well; Non-active – water is removed by a manual system, or the well is not in use) and indicate if the well produces freshwater.

- C-02292 Pod 1
- C-03441 Pod 1
- C-03442 Pod 1

If the water well is operational and producing freshwater, we request Intrepid's permission to collect or have a third-party water sampling company collect a sample.

Please let me know if you need further information, or if there are any questions.

Best Regards

Oliver W. Seekins
Consultant



1718 S. Cheyenne Ave.
Tulsa, Oklahoma 74119
office: 918-382-7581
Cell: 918-805-5037

Attachment 6
No Hydrologic Connection Statement & Technical
Assessment & Feasibility for Injection



December 13, 2019

Oil Conservation Division
1220 South St. Francis Dr.
Santa Fe, New Mexico 87505

Subject: Vista Disposal Solutions, LLC – Hydrologic Connection Statement

To Whom It May Concern:

The purpose of this letter is to affirm that ALL Consulting (ALL), on behalf of Vista Disposal Solutions, LLC (Vista), has conducted an extensive technical review of the available geologic and engineering data and finds no evidence of open faults or any other hydrologic connection between the proposed Bell Canyon Formation disposal zone and any underground sources of drinking water.

Additionally, please find attached ALL's Technical Assessment and Feasibility document addressing injection into the Bell Canyon Formation at the proposed disposal well location.

Sincerely,

Tom Tomastik

Tom Tomastik, CPG
Chief Geologist
ALL Consulting



VISTA DISPOSAL SOLUTIONS

TECHNICAL ASSESSMENT AND FEASIBILITY FOR INJECTION INTO THE BELL CANYON FORMATION OF THE DELAWARE MOUNTAIN GROUP

ALL Consulting (ALL) has conducted an extensive technical review and geological assessment of the alleged New Mexico Oil Conservation Division (OCD) Delaware Mountain Group (DMG) saltwater disposal well (SWD) impacts to production wells and drilling operations associated with the Brushy Canyon Formation of the DMG in the Lea County, New Mexico area. This technical review included evaluation and analysis of the OCD DMG Cases and technical data submitted by both Chevron and Occidental (OXY) in defense of their disposal operations into the Bell Canyon and Cherry Canyon formations in Eddy County. OCD found in favor of both Chevron and OXY to continue disposal operations at their injection wells with additional technical requirements and testing. ALL is providing the following technical information in support of allowing the permitting of new disposal operations by Vista Disposal Solutions, LLC (Vista) into the Bell Canyon Formation (Bell Canyon).

- ALL will be submitting permit applications for Vista to dispose of oilfield waste fluids into only the Bell Canyon of the DMG.
- All disposal operations will be cased hole with perforations.
- There is approximately 600 to 800 feet of viable injection interval within the Bell Canyon with porosities ranging from 12 to 28% and averaging approximately 18%. These zones are consistent with the Bell Canyon across the area of interest (AOI) for Vista.
- All these proposed injection intervals show resistivity readings less than 10 ohm/meters, which is indicative of natural brine in the formation, so there is adequate porosity and permeability.
- Proposed bottom perforations would be approximate 100 to 150 feet above the top of the Cherry Canyon Formation and at least 1,500 to 1,600 feet above the top of the Brushy Canyon Formation.
- ALL has identified three to four consistent confining zones within the bottom of the Bell Canyon that have low porosities and high resistivities indicating that these zones will serve as barriers to downward fluid migration.
- There is no oil and gas production from the Bell Canyon or Cherry Canyon formations within a two-mile radius of the proposed SWD and there are adequate barriers and rock thickness to prevent fluid migration into the Brushy Canyon Formation.
- Injection pressures will be limited to the regulatory approved maximum allowable surface pressure based on 0.2 psi per foot.
- If OCD requires additional downhole testing requirements like was required in the Chevron and Oxy cases, Vista would be willing to perform the OCD required downhole testing such as initial pressure fall-off testing, radioactive tracer and temperature surveys,

and record original bottom hole pressures to further demonstrate the technical feasibility of injection into the Bell Canyon.

- The potential for over pressurization of this injection interval can be addressed with the spacing of hundreds of perforations into porous and permeable zones within the Bell Canyon, which allows for injectate dispersion and reduces the potential for pressure build-up. Additionally, ALL has found several Bell Canyon SWDs in the OCD records that operated under a vacuum situation.
- With a sound pre-treatment and filtering system at the surface, issues such as skin effect and even potential formation damage can be avoided, which often leads to formation pressure build-up. ALL has extensive experience and expertise with pre-treatment and filtering systems to avoid these issues.
- Additional technical documentation can be provided by ALL if OCD deems additional information is necessary.

Attachment 7

Public Notice Affidavit and Notice of Application Confirmations

Affidavit of Publication

STATE OF NEW MEXICO
COUNTY OF LEA

I, Daniel Russell, Publisher of the Hobbs News-Sun, a newspaper published at Hobbs, New Mexico, solemnly swear that the clipping attached hereto was published in the regular and entire issue of said newspaper, and not a supplement thereof for a period of 1 issue(s).

Beginning with the issue dated
December 14, 2019
and ending with the issue dated
December 14, 2019.

Publisher

Sworn and subscribed to before me this
14th day of December 2019.

Business Manager

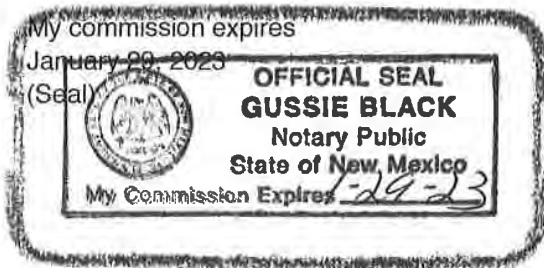

This newspaper is duly qualified to publish legal notices or advertisements within the meaning of Section 3, Chapter 167, Laws of 1937 and payment of fees for said

LEGAL	LEGAL
LEGAL NOTICE DECEMBER 14, 2019	
APPLICATION FOR AUTHORIZATION TO INJECT	
NOTICE IS HEREBY GIVEN: That Vista Disposal Solutions, LLC, 12444 NW 10th St., Building G, Suite 202-512, Yukon, OK 73099, is requesting that the New Mexico Oil Conservation Division administratively approve the APPLICATION FOR AUTHORIZATION TO INJECT as follows:	
PURPOSE: The intended purpose of the injection well is to dispose of salt water produced from permitted oil and gas wells.	
WELL NAME AND LOCATION: <u>Karen Federal SWD #2</u> <u>NE 1/4 SW 1/4, Section 05, Township 26S, Range 34E</u> <u>2,334' FSL & 2,416' FWL</u> <u>Lea County, NM</u>	
NAME AND DEPTH OF DISPOSAL ZONE: <u>Bell Canyon (5,355 - 6,165)</u>	
EXPECTED MAXIMUM INJECTION RATE: <u>25,000 Bbls/day</u>	
EXPECTED MAXIMUM INJECTION PRESSURE: <u>1,071 psi (surface)</u>	
Objections or requests for hearing must be filed with the New Mexico Oil Conservation Division within fifteen (15) days. Any objection or request for hearing should be mailed to the Oil Conservation Division, 1220 South St. Francis Dr., Santa Fe, New Mexico 87505.	
Additional information may be obtained by contacting Nate Alleman at 918-382-7581, #34982	

67115320

00237215

DANIEL ARTHUR
ALL CONSULTING
1718 S. CHEYENNE AVE.
TULSA, OK 74119

APPLICATION FOR AUTHORIZATION TO INJECT

NOTICE IS HEREBY GIVEN: That Vista Disposal Solutions, LLC, 12444 NW 10th St., Building G, Suite 202-512, Yukon, OK 73099, is requesting that the New Mexico Oil Conservation Division administratively approve the APPLICATION FOR AUTHORIZATION TO INJECT as follows:

PURPOSE: The intended purpose of the injection well is to dispose of salt water produced from permitted oil and gas wells.

WELL NAME AND LOCATION: Karen Federal SWD #2
NE ¼ SW ¼, Section 05, Township 26S, Range 34E
2,334' FSL & 2,416' FWL
Lea County, NM

NAME AND DEPTH OF DISPOSAL ZONE: Bell Canyon (5,355 – 6,165)

EXPECTED MAXIMUM INJECTION RATE: 25,000 Bbls/day

EXPECTED MAXIMUM INJECTION PRESSURE: 1,071 psi (surface)

Objections or requests for hearing must be filed with the New Mexico Oil Conservation Division within fifteen (15) days. Any objection or request for hearing should be mailed to the Oil Conservation Division, 1220 South St. Francis Dr., Santa Fe, New Mexico 87505.

Additional information may be obtained by contacting Nate Alleman at 918-382-7581.

Karen Federal SWD #2 - Notice of Application Recipients				
Entity	Address	City	State	Zip Code
Landowner & Mineral Owner				
New Mexico BLM	620 E Greene St.	Carlsbad	NM	88220
OCD District				
NMOCD District 1	1625 N. French Drive	Hobbs	NM	88240
Leasehold Operators				
Black Mountain Operating, LLC (BLACK MOUNTAIN)	500 Main Street, Suite 1200	Fort Worth	TX	76102
Chevron USA Inc. (CHEVRON USA INC)	6301 Deauville	Midland	TX	79706
COG Operating, LLC (COG OPERATING LLC) (COG OPER LLC)	600 W. Illinois Ave.	Midland	TX	79701
Devon Energy Production Company, LP (DEVON ENERGY PROD CO LP)	6488 Seven Rivers Hwy.	Artesia	NM	88210
Jetstream Wind, Inc. (JETSTREAM)	19 Plaza La Prensa	Santa Fe	NM	87507
Notes: The table above shows the Entities who were identified as parties of interest requiring notification on either the 1/2-mile well detail list (Attachment 2) or on the 2-mile Mineral Lease Map (Attachment 2). The names listed above in parenthesis, are the abbreviated entity names used on either the 1/2-mile well detail list (Attachment 2) or on the 2-mile Mineral Lease Map (Attachment 2).				

Certified Mail® Labels
 **Top of the page**
Print postage using Stamps.com Template **SDC-3610**

ALL Consulting
1718 S. Cheyenne Ave.
Tulsa, OK 74119

\$5.600
US POSTAGE
FIRST-CLASS
FROM 74119
DEC 16 2019
stamps.com



Place label at top of the center of the
envelope and fold at dotted line.

CERTIFIED MAIL®



9414 8118 9956 1126 9644 04

ALL Consulting
1718 S. Cheyenne Ave.
Tulsa, OK 74119

\$5.600
US POSTAGE
FIRST-CLASS
FROM 74119
DEC 16 2019
stamps.com



Place label at top of the center of the
envelope and fold at dotted line.

CERTIFIED MAIL®



9414 8118 9956 1126 9645 96

Jetstream Wind, Inc.
19 Plaza La Prensa
Santa Fe NM 87507-9702

New Mexico BLM
620 E Greene St.
Carlsbad NM 88220-6292

ALL Consulting
1718 S. Cheyenne Ave.
Tulsa, OK 74119

\$5.600
US POSTAGE
FIRST-CLASS
FROM 74119
DEC 16 2019
stamps.com



Place label at top of the center of the
envelope and fold at dotted line.

CERTIFIED MAIL®



9414 8118 9956 1126 9652 34

Place label at top of the center of the
envelope and fold at dotted line.

CERTIFIED MAIL®

NMOCD District 1
1625 N. French Drive
Hobbs NM 88240-9273

Certified Mail® Labels↑ **Top of the page**Print postage using Stamps.com Template **SDC-3610**

ALL Consulting
1718 S. Cheyenne Ave.
Tulsa, OK 74119

\$5.600
US POSTAGE
FIRST-CLASS
FROM 74119
DEC 16 2019
stamps.com



Place label at top of the center of the envelope and fold at dotted line.

CERTIFIED MAIL®



9414 8118 9956 1126 9649 30

Black Mountain Operating, LLC
500 Main Street, Suite 1200
Fort Worth TX 76102-3926

ALL Consulting
1718 S. Cheyenne Ave.
Tulsa, OK 74119

\$5.600
US POSTAGE
FIRST-CLASS
FROM 74119
DEC 16 2019
stamps.com



Place label at top of the center of the envelope and fold at dotted line.

CERTIFIED MAIL®



9414 8118 9956 1126 9646 71

Chevron USA Inc.
6301 Deauville
Midland TX 79706-2964

ALL Consulting
1718 S. Cheyenne Ave.
Tulsa, OK 74119

\$5.600
US POSTAGE
FIRST-CLASS
FROM 74119
DEC 16 2019
stamps.com



Place label at top of the center of the envelope and fold at dotted line.

CERTIFIED MAIL®



9414 8118 9956 1126 9643 29

COG Operating, LLC
600 W. Illinois Ave.
Midland TX 79701-4882

ALL Consulting
1718 S. Cheyenne Ave.
Tulsa, OK 74119

\$5.600
US POSTAGE
FIRST-CLASS
FROM 74119
DEC 16 2019
stamps.com



Place label at top of the center of the envelope and fold at dotted line.

CERTIFIED MAIL®



9414 8118 9956 1126 9640 22

Devon Energy Production Company, LP
6488 Seven Rivers Hwy.
Artesia NM 88210-9134