

Revised March 23, 2017

1LTLI-200806-C-107B OLM-206

RECEIVED: 8/6/20	REVIEWER: DM	TYPE: OLM	APP NO: pDM2022347150
----------------------------	------------------------	---------------------	---------------------------------

ABOVE THIS TABLE FOR OCD DIVISION USE ONLY

NEW MEXICO OIL CONSERVATION DIVISION
 - Geological & Engineering Bureau -
 1220 South St. Francis Drive, Santa Fe, NM 87505

**ADMINISTRATIVE APPLICATION CHECKLIST**

THIS CHECKLIST IS MANDATORY FOR ALL ADMINISTRATIVE APPLICATIONS FOR EXCEPTIONS TO DIVISION RULES AND REGULATIONS WHICH REQUIRE PROCESSING AT THE DIVISION LEVEL IN SANTA FE

Applicant: OXY USA INC **OGRID Number:** 16696
Well Name: CEDAR CANYON 23 24 FEDERAL COM #034H **API:** 30-015-44178
Pool: PIERCE CROSSING; BONE SPRINGS, EAST **Pool Code:** 96473

SUBMIT ACCURATE AND COMPLETE INFORMATION REQUIRED TO PROCESS THE TYPE OF APPLICATION INDICATED BELOW

1) TYPE OF APPLICATION: Check those which apply for [A]

A. Location – Spacing Unit – Simultaneous Dedication

☐ NSL ☐ NSP_(PROJECT AREA) ☐ NSP_(PRORATION UNIT) ☐ SD

B. Check one only for [I] or [II]

[I] Commingling – Storage – Measurement

☐ DHC ☐ CTB ☐ PLC ☐ PC ☐ OLS ☒ OLM

[II] Injection – Disposal – Pressure Increase – Enhanced Oil Recovery

☐ WFX ☐ PMX ☐ SWD ☐ IPI ☐ EOR ☐ PPR

2) NOTIFICATION REQUIRED TO: Check those which apply.

- A. ☐ Offset operators or lease holders
 B. ☐ Royalty, overriding royalty owners, revenue owners
 C. ☐ Application requires published notice
 D. ☐ Notification and/or concurrent approval by SLO
 E. ☒ Notification and/or concurrent approval by BLM
 F. ☐ Surface owner
 G. ☐ For all of the above, proof of notification or publication is attached, and/or,
 H. ☒ No notice required OXY is 100% WIO

FOR OCD ONLY

☐ Notice Complete
☐ Application Content Complete

- 3) CERTIFICATION:** I hereby certify that the information submitted with this application for administrative approval is **accurate** and **complete** to the best of my knowledge. I also understand that **no action** will be taken on this application until the required information and notifications are submitted to the Division.

Note: Statement must be completed by an individual with managerial and/or supervisory capacity.

Elizabeth Schenkel

Print or Type Name

Signature

August 4, 2020

Date

713-497-2055

Phone Number

Beth_Schenkel@oxy.com

e-mail Address

District I
1625 N. French Drive, Hobbs, NM 88240
District II
811 S. First St., Artesia, NM 88210
District III
1000 Rio Brazos Road, Aztec, NM 87410
District IV
1220 S. St Francis Dr, Santa Fe, NM
87505

State of New Mexico
Energy, Minerals and Natural Resources Department

Form C-107-B
Revised August 1, 2011

OIL CONSERVATION DIVISION

1220 S. St Francis Drive
Santa Fe, New Mexico 87505

Submit the original
application to the Santa Fe
office with one copy to the
appropriate District Office.

APPLICATION FOR SURFACE COMMINGLING (DIVERSE OWNERSHIP)

OPERATOR NAME: OXY USA INC

OPERATOR ADDRESS: PO BOX 4294 HOUSTON, TX 77210

APPLICATION TYPE:

☐ Pool Commingling ☐ Lease Commingling ☐ Pool and Lease Commingling ☒ Off-Lease Storage and Measurement (Only if not Surface Commingled)

LEASE TYPE: ☐ Fee ☐ State ☒ Federal

Is this an Amendment to existing Order? ☐ Yes ☒ No If "Yes", please include the appropriate Order No. _____
Have the Bureau of Land Management (BLM) and State Land office (SLO) been notified in writing of the proposed commingling
☒ Yes ☐ No

(A) POOL COMMINGLING Please attach sheets with the following information

(1) Pool Names and Codes	Gravities / BTU of Non-Commingled Production	Calculated Gravities / BTU of Commingled Production		Calculated Value of Commingled Production	Volumes

- (2) Are any wells producing at top allowables? ☐ Yes ☐ No
(3) Has all interest owners been notified by certified mail of the proposed commingling? ☐ Yes ☐ No.
(4) Measurement type: ☐ Metering ☐ Other (Specify)
(5) Will commingling decrease the value of production? ☐ Yes ☐ No If "yes", describe why commingling should be approved

(B) LEASE COMMINGLING Please attach sheets with the following information

- (1) Pool Name and Code.
(2) Is all production from same source of supply? ☐ Yes ☐ No
(3) Has all interest owners been notified by certified mail of the proposed commingling? ☐ Yes ☐ No
(4) Measurement type: ☐ Metering ☐ Other (Specify)

(C) POOL and LEASE COMMINGLING Please attach sheets with the following information

- (1) Complete Sections A and E.

(D) OFF-LEASE STORAGE and MEASUREMENT Please attached sheets with the following information

- (1) Is all production from same source of supply? ☒ Yes ☐ No
(2) Include proof of notice to all interest owners. OXY IS 100% WIO

(E) ADDITIONAL INFORMATION (for all application types) Please attach sheets with the following information

- (1) A schematic diagram of facility, including legal location.
(2) A plat with lease boundaries showing all well and facility locations. Include lease numbers if Federal or State lands are involved.
(3) Lease Names, Lease and Well Numbers, and API Numbers.

I hereby certify that the information above is true and complete to the best of my knowledge and belief.

SIGNATURE: Elizabeth Schenkel TITLE: FACILITES ENGINEER DATE: AUG 5 2020

TYPE OR PRINT NAME ELIZABETH SCHENKEL TELEPHONE NO.: 713-497-2055

E-MAIL ADDRESS: BETH_SCHENKEL@OXY.COM

**APPLICATION FOR OFF LEASE MEASUREMENT, STORAGE, AND SALES
Cedar Canyon 23 24 Federal Com #034H**

OXY USA INC requests approval for off-lease measurement for the well listed below.

Well Name	API	Lease	Pool	Pool Code
Cedar Canyon 23 24 Federal Com #034H	30-015-44178	NMNM81586	PIERCE CROSSING; BONE SPRING, EAST	96473

OXY proposes to meter production from the Cedar Canyon 23 24 #034H through a three phase separator, located at the Cedar Canyon 22 Satellite Facility in Section 22 T24S R29E.

After separation, gas will flow through an orifice meter (S/N T151222196), which will serve as the gas custody transfer point. Oil will flow through a turbine meter into a dedicated 1000 bbl oil tank and then through a Coriolis meter. The Coriolis meter (S/N 14258276) will serve as the oil custody transfer point.

Royalty payments for oil and gas production will be paid off of the custody transfer meters. Meter will be proved and calibrated according to current API, NMOCD, and BLM standards.

Additional Application Components:

The flow of production is shown in detail on the enclosed facility diagram. Also enclosed is a map detailing the lease boundaries, well and battery locations.

OXY is the only working interest owner, so notice was not required.

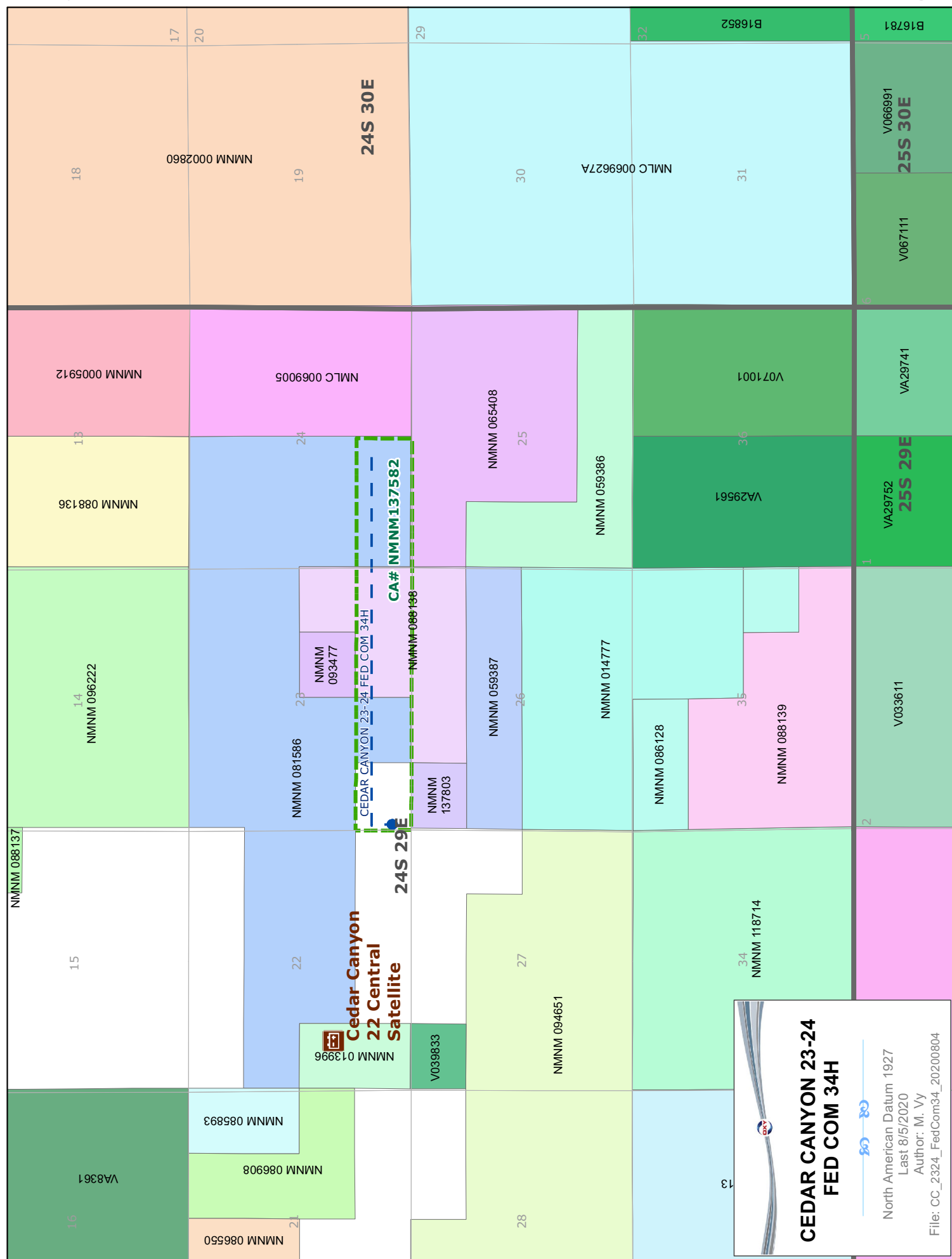

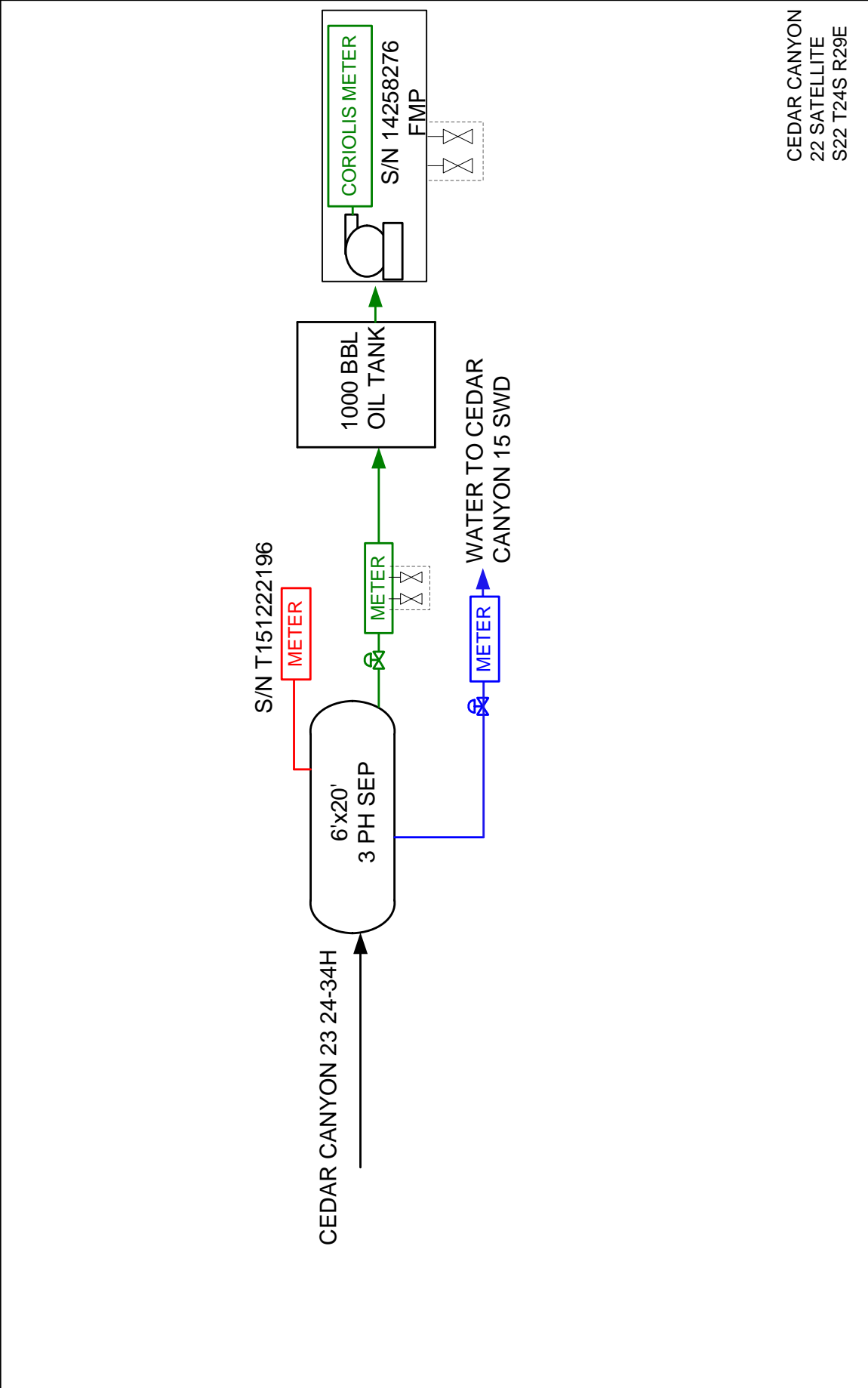

CEDAR CANYON
22 SATELLITE
S22 T24S R29E

LEGEND	REVISION BLOCK			
	NO.	DATE	DESCRIPTION	BY
	0		PRELIMINARY DRAFT	KAO
	1		REVISION	JC
	2		OFF LEASE MEASUREMENT APPLICATION	TS
— PRODUCTION MIX				
— OIL				
— GAS				
— WATER				
— EQUIPMENT				

PROCESS FLOW DIAGRAM
CEDAR CANYON 23 24-34H