

# Initial Application Part I

Received: 04/05/2022

*This application is placed in file for record. It MAY or MAY NOT have been reviewed to be determined Administratively Complete*

RECEIVED: 4/05/2022	REVIEWER:	TYPE: SWD	APP NO: pJZT2209855768
---------------------	-----------	-----------	------------------------

ABOVE THIS TABLE FOR OCD DIVISION USE ONLY

**NEW MEXICO OIL CONSERVATION DIVISION**  
 - Geological & Engineering Bureau -  
 1220 South St. Francis Drive, Santa Fe, NM 87505



### ADMINISTRATIVE APPLICATION CHECKLIST

THIS CHECKLIST IS MANDATORY FOR ALL ADMINISTRATIVE APPLICATIONS FOR EXCEPTIONS TO DIVISION RULES AND REGULATIONS WHICH REQUIRE PROCESSING AT THE DIVISION LEVEL IN SANTA FE

Applicant: OXY USA INC. OGRID Number: 16696  
 Well Name: FEDERAL 12 #001 API: 30-015-26742  
 Pool: SWD BELL CANYON Pool Code: 96769

### SUBMIT ACCURATE AND COMPLETE INFORMATION REQUIRED TO PROCESS THE TYPE OF APPLICATION INDICATED BELOW

1) **TYPE OF APPLICATION:** Check those which apply for [A]

A. Location – Spacing Unit – Simultaneous Dedication

☐ NSL

☐ NSP (PROJECT AREA)

☐ NSP (PRORATION UNIT)

☐ SD

SWD-2476

B. Check one only for [ I ] or [ II ]

[ I ] Commingling – Storage – Measurement

☐ DHC

☐ CTB

☐ PLC

☐ PC

☐ OLS

☐ OLM

[ II ] Injection – Disposal – Pressure Increase – Enhanced Oil Recovery

☐ WFX

☐ PMX

☒ SWD

☐ IPI

☐ EOR

☐ PPR

2) **NOTIFICATION REQUIRED TO:** Check those which apply.

A. ☒ Offset operators or lease holders

B. ☐ Royalty, overriding royalty owners, revenue owners

C. ☒ Application requires published notice

D. ☐ Notification and/or concurrent approval by SLO

E. ☒ Notification and/or concurrent approval by BLM

F. ☒ Surface owner

G. ☐ For all of the above, proof of notification or publication is attached, and/or,

H. ☐ No notice required

#### FOR OCD ONLY

☐

Notice Complete

☐

Application  
Content  
Complete

**NOTICE SENT 3/30/2022**

3) **CERTIFICATION:** I hereby certify that the information submitted with this application for administrative approval is **accurate** and **complete** to the best of my knowledge. I also understand that **no action** will be taken on this application until the required information and notifications are submitted to the Division.

Note: Statement must be completed by an individual with managerial and/or supervisory capacity.

STEPHEN JANACEK

Print or Type Name

Stephen Janacek  
 Signature

3/30/2022

Date

713-493-1986

Phone Number

STEPHEN\_JANACEK@OXY.COM

e-mail Address

**APPLICATION FOR AUTHORIZATION TO INJECT**

- I. PURPOSE: \_\_\_\_\_ Secondary Recovery \_\_\_\_\_ Pressure Maintenance   X   Disposal \_\_\_\_\_ Storage  
Application qualifies for administrative approval?   X   Yes \_\_\_\_\_ No
- II. OPERATOR:   OXY USA INC   FEDERAL 12 #1 30-015-26742  
ADDRESS:   PO BOX 4294, HOUSTON, TX 77210    
CONTACT PARTY:   STEPHEN JANACEK   PHONE:   713-493-1986
- III. WELL DATA: Complete the data required on the reverse side of this form for each well proposed for injection.  
Additional sheets may be attached if necessary.
- IV. Is this an expansion of an existing project? \_\_\_\_\_ Yes   X   No  
If yes, give the Division order number authorizing the project: \_\_\_\_\_
- V. Attach a map that identifies all wells and leases within two miles of any proposed injection well with a one-half mile radius circle drawn around each proposed injection well. This circle identifies the well's area of review. Attached
- VI. Attach a tabulation of data on all wells of public record within the area of review which penetrate the proposed injection zone. Such data shall include a description of each well's type, construction, date drilled, location, depth, record of completion, and a schematic of any plugged well illustrating all plugging detail. Attached
- VII. Attach data on the proposed operation, including:
1. Proposed average and maximum daily rate and volume of fluids to be injected; Avg- 900 bwpd , Max- 2500 bwpd
  2. Whether the system is open or closed; Closed
  3. Proposed average and maximum injection pressure; Avg- 900 psi , Max- 934 psi
  4. Sources and an appropriate analysis of injection fluid and compatibility with the receiving formation if other than reinjected produced water; and, Previously submitted in 2013.
  5. If injection is for disposal purposes into a zone not productive of oil or gas at or within one mile of the proposed well, attach a chemical analysis of the disposal zone formation water (may be measured or inferred from existing literature, studies, nearby wells, etc.). Previously submitted in 2013.
- \*VIII. Attach appropriate geologic data on the injection zone including appropriate lithologic detail, geologic name, thickness, and depth. Give the geologic name, and depth to bottom of all underground sources of drinking water (aquifers containing waters with total dissolved solids concentrations of 10,000 mg/l or less) overlying the proposed injection zone as well as any such sources known to be immediately underlying the injection interval. Previously submitted in 2013.
- IX. Describe the proposed stimulation program, if any. No planned stimulation program.
- \*X. Attach appropriate logging and test data on the well. (If well logs have been filed with the Division, they need not be resubmitted).
- \*XI. Attach a chemical analysis of fresh water from two or more fresh water wells (if available and producing) within one mile of any injection or disposal well showing location of wells and dates samples were taken. Previously submitted in 2013. There are no water sourcing wells located within a 5+ mile radius of the Federal 12-1 based on the OSE POD.
- XII. Applicants for disposal wells must make an affirmative statement that they have examined available geologic and engineering data and find no evidence of open faults or any other hydrologic connection between the disposal zone and any underground sources of drinking water. Attached
- XIII. Applicants must complete the "Proof of Notice" section on the reverse side of this form. Attached
- XIV. Certification: I hereby certify that the information submitted with this application is true and correct to the best of my knowledge and belief.
- NAME: STEPHEN JANACEK TITLE: REGULATORY ENGINEER  
SIGNATURE: Stephen Janacek DATE: 3/30/22  
E-MAIL ADDRESS: STEPHEN\_JANACEK@OXY.COM
- \* If the information required under Sections VI, VIII, X, and XI above has been previously submitted, it need not be resubmitted. Please show the date and circumstances of the earlier submittal: 4/15/13 SWD Application SWD-1423

# III.

WELL DATA: Complete the data required on the reverse side of this form for each well proposed for injection.  
Additional sheets may be attached if necessary.

District I  
1625 N. French Dr., Hobbs, NM 88240  
Phone: (575) 393-6161 Fax: (575) 393-0729  
District II  
811 S. First St., Artesia, NM 88210  
Phone: (575) 748-1283 Fax: (575) 748-9720  
District III  
1000 Rio Brazos Road, Aztec, NM 87410  
Phone: (505) 334-6178 Fax: (505) 334-6170  
District IV  
1220 S. St. Francis Dr., Santa Fe, NM 87505  
Phone: (505) 476-3460 Fax: (505) 476-3462

State of New Mexico  
Energy, Minerals & Natural Resources Department  
OIL CONSERVATION DIVISION  
1220 South St. Francis Dr.  
Santa Fe, NM 87505

Form C-102  
Revised August 1, 2011  
Submit one copy to appropriate  
District Office  
☒ AMENDED REPORT

APR 29 2015

WELL LOCATION AND ACREAGE DEDICATION RECEIVED

<sup>1</sup> API Number 30-015-26742	<sup>2</sup> Pool Code 96769	<sup>3</sup> Pool Name SWD Bell Canyon
<sup>4</sup> Property Code 304814	<sup>5</sup> Property Name Federal 12	<sup>6</sup> Well Number 1
<sup>7</sup> OGRID No. 16696	<sup>8</sup> Operator Name OXY USA INC.	<sup>9</sup> Elevation 3578

" Surface Location

UL or lot no.	Section	Township	Range	Lot Idn	Feet from the	North/South line	Feet from the	East/West line	County
M	12	22S	31E		660	South	660	West	Eddy

" Bottom Hole Location If Different From Surface

UL or lot no.	Section	Township	Range	Lot Idn	Feet from the	North/South line	Feet from the	East/West line	County

<sup>12</sup> Dedicated Acres	<sup>13</sup> Joint or Infill	<sup>14</sup> Consolidation Code	<sup>15</sup> Order No. SWD 1423
-------------------------------	-------------------------------	----------------------------------	-------------------------------------

No allowable will be assigned to this completion until all interests have been consolidated or a non-standard unit has been approved by the division.

	<p><b>" OPERATOR CERTIFICATION</b></p> <p>I hereby certify that the information contained herein is true and complete to the best of my knowledge and belief, and that this organization either owns a working interest or unleased mineral interest in the land including the proposed bottom hole location or has a right to drill this well at this location pursuant to a contract with an owner of such a mineral or working interest, or to a voluntary pooling agreement or a compulsory pooling order heretofore entered by the division.</p> <p><i>David Stewart</i> 4/29/15 Signature Date</p> <p>David Stewart SR. Reg. A.G.U. Printed Name</p> <p>david_stewart@oxy.com E-mail Address</p>			
	<p><b>"SURVEYOR CERTIFICATION</b></p> <p>I hereby certify that the well location shown on this plat was plotted from field notes of actual surveys made by me or under my supervision, and that the same is true and correct to the best of my belief.</p>			
	<p>Date of Survey</p> <p>Signature and Seal of Professional Surveyor:</p>			
	<p>Certificate Number</p>			

OPERATOR: OXY USA Inc.WELL NAME & NUMBER: Federal 12 #1

WELL LOCATION: <u>660 FSL 660 FWL</u>	<u>SWSW (M)</u>	<u>12</u>	<u>22S</u>	<u>31E</u>
FOOTAGE LOCATION	UNIT LETTER	SECTION	TOWNSHIP	RANGE

**WELLBORE SCHEMATIC**

SEE ATTACHED WELLBORE DIAGRAM.

**WELL CONSTRUCTION DATA**Surface CasingHole Size: 17-1/2" Casing Size: 13-3/8" @ 828'Cemented with: 950 sx. **or** 1254 ft<sup>3</sup>Top of Cement: Surface Method Determined: CircIntermediate CasingHole Size: 11" Casing Size: 8-5/8" @ 4325'Cemented with: 1900 sx. **or** 2508 ft<sup>3</sup>Top of Cement: Surface Method Determined: CircProduction CasingHole Size: 7-7/8" Casing Size: 5-1/2" @ 8439'Cemented with: 1402 sx. **or** 1472 ft<sup>3</sup>Top of Cement: 4472' Method Determined: CBLTotal Depth: 8439'Injection IntervalPERFS- 4672 feet to 4962 FT

(Perforated or Open Hole; indicate which)

\_\_\_\_\_

Tubing Size: 2-7/8" 6.5# J55 PLS-20 Lining Material: Composite

Type of Packer: Nickel Plated AS-1X

Packer Setting Depth: 4520'

Other Type of Tubing/Casing Seal (if applicable): \_\_\_\_\_

Additional Data

1. Is this a new well drilled for injection? \_\_\_\_\_ Yes X No

If no, for what purpose was the well originally drilled? Oil Producer

2. Name of the Injection Formation: Delaware - Bell Canyon

3. Name of Field or Pool (if applicable): Livingston Ridge Delaware

4. Has the well ever been perforated in any other zone(s)? List all such perforated intervals and give plugging detail, i.e. sacks of cement or plug(s) used. Yes  
7042'-8336' (plugged with CIBP and 30 sx of cmt); 8270'-8336' (plugged with CIBP and 30 sx cmt)

5. Give the name and depths of any oil or gas zones underlying or overlying the proposed injection zone in this area: Delaware/Bone Springs

Delaware- Cherry Canyon 5588' MD

Bone Spring 8360' MD

Stephen Janacek  
3/24/2022

Current/Proposed Wellbore  
**FEDERAL 12 #1**  
30-015-26742-0000  
Eddy

String 1  
OD 13.375 in  
TD 828 ft  
TOC 0 ft

String 2  
OD 8.625 in  
TD 4325 ft  
TOC 0 ft

String 3  
OD 5.5 in  
TD 8439 ft  
TOC 5765' (CBL-ORIGINAL), **4472'**  
**(CBL-REMEDIAL WORK)**  
PBSD 8439 ft

CICR 5724' W/ 25 SX TO  
5442'. TAGGED.

25 SX 6260'-6004'. TAGGED.

CIBP @ 6995' W/ 30  
SX TO 6638'. TAGGED.

CIBP @ 8220' W/ 30  
SX TO 7948'. TAGGED.

2-7/8" 6.5# PLS-20 Composite tbg

Nickel Plated AS-1X Packer @ 4620'  
Perfs 4672'-4962'

2014- Sqz Holes 5745'. Sqz 380 sx  
cmt to 4472' (CBL).

DVT 6197'

Perfs 7042'-7074'

Perfs 8270'-8336'

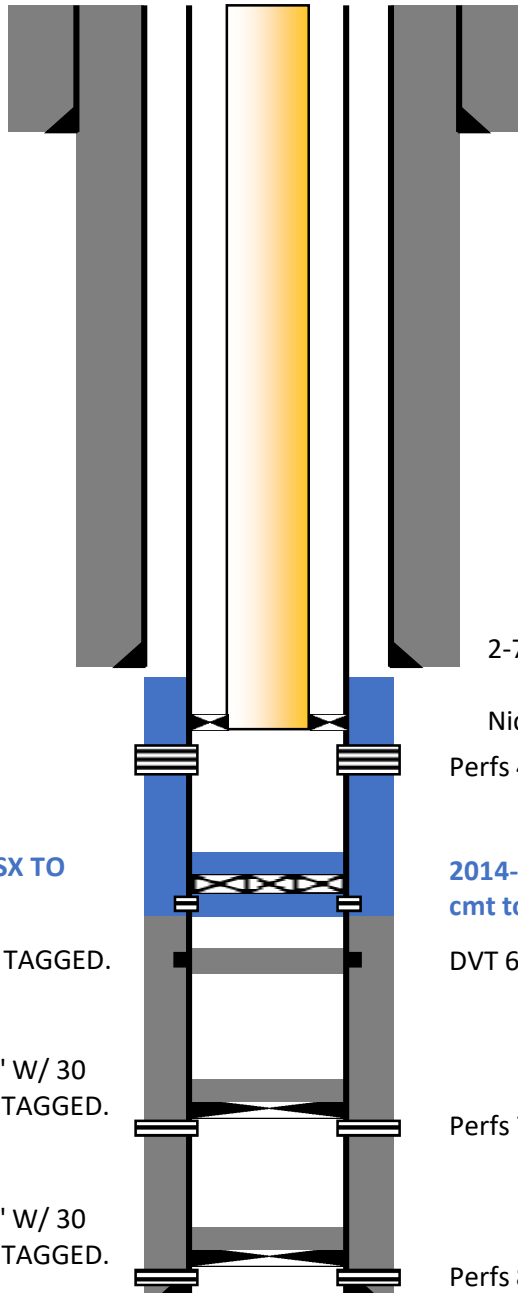



V.

Attach a map that identifies all wells and leases within two miles of any proposed injection well with a one-half mile radius circle drawn around each proposed injection well. This circle identifies the well's area of review.

# Federal 12 Well No. 1 - AOR Map (0.5 mi)

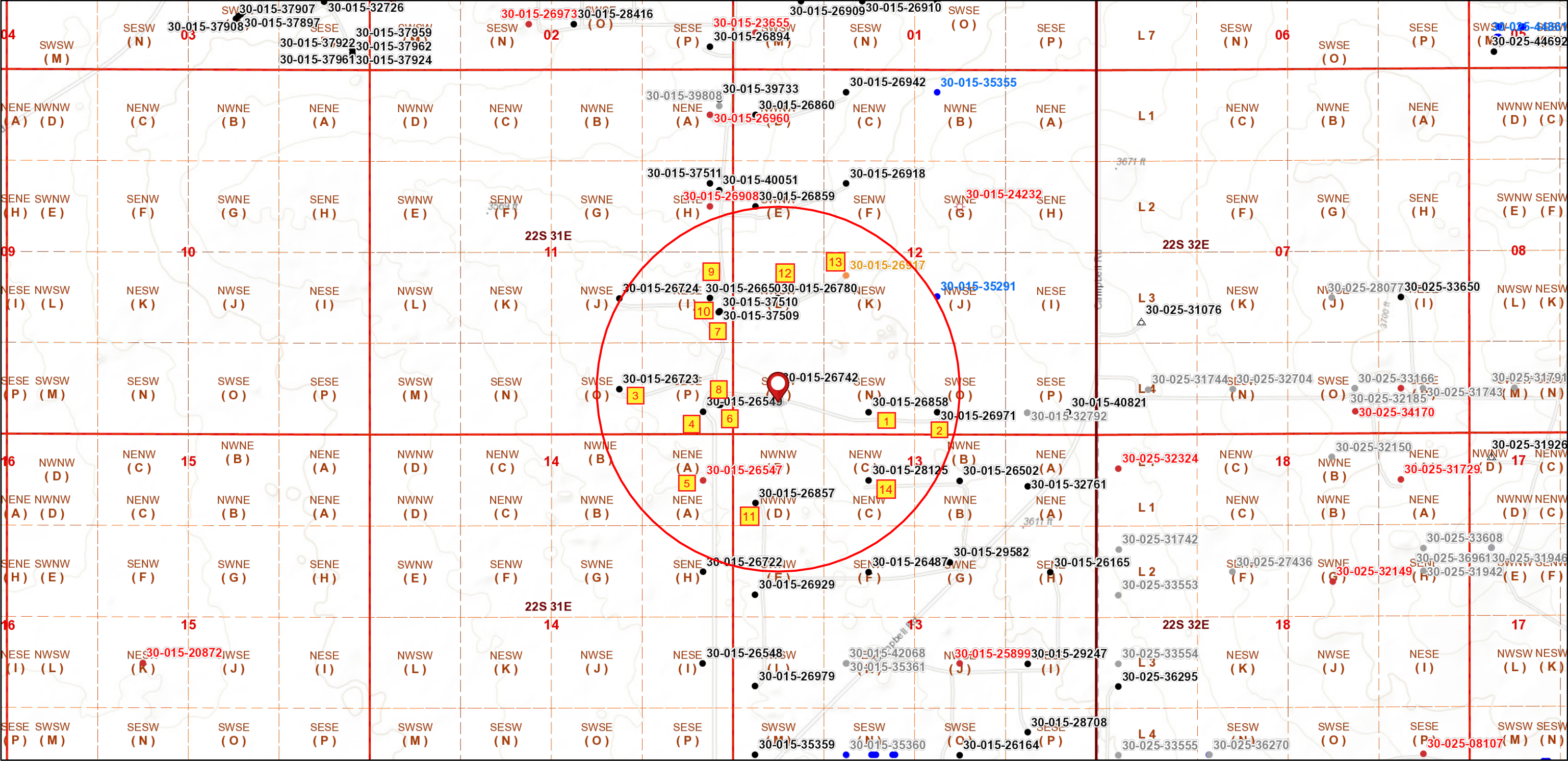

1/19/2022, 9:29:41 AM

Wells - Large Scale

- ? undefined
- Miscellaneous
- ✱ CO2, Active
- ✱ CO2, Cancelled
- ✱ CO2, New
- ✱ CO2, Plugged
- ✱ CO2, Temporarily Abandoned

- ✱ Gas, Active
- ✱ Gas, Cancelled
- ✱ Gas, New
- ✱ Gas, Plugged
- ✱ Gas, Temporarily Abandoned
- ✱ Injection, Active
- ✱ Injection, Cancelled

- ✱ Injection, New
- ✱ Injection, Plugged
- ✱ Injection, Temporarily Abandoned
- Oil, Active
- Oil, Cancelled
- Oil, New
- Oil, Plugged

- Oil, Temporarily Abandoned
- △ Salt Water Injection, Active
- △ Salt Water Injection, Cancelled
- △ Salt Water Injection, New
- △ Salt Water Injection, Plugged
- △ Salt Water Injection, Temporarily Abandoned
- Water, Active

- Water, Cancelled
- Water, New
- Water, Plugged
- Water, Temporarily Abandoned
- ★ OCD District Offices
- PLSS First Division
- PLSS Second Division

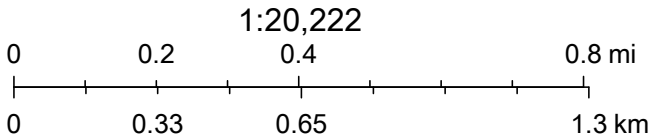

Oil Conservation Division of the New Mexico Energy, Minerals and Natural Resources Department., Bureau of Land Management, Texas Parks & Wildlife, Esri, HERE, Garmin, INCREMENT P, USGS, METI/NASA, EPA, USDA, OCD, BLM





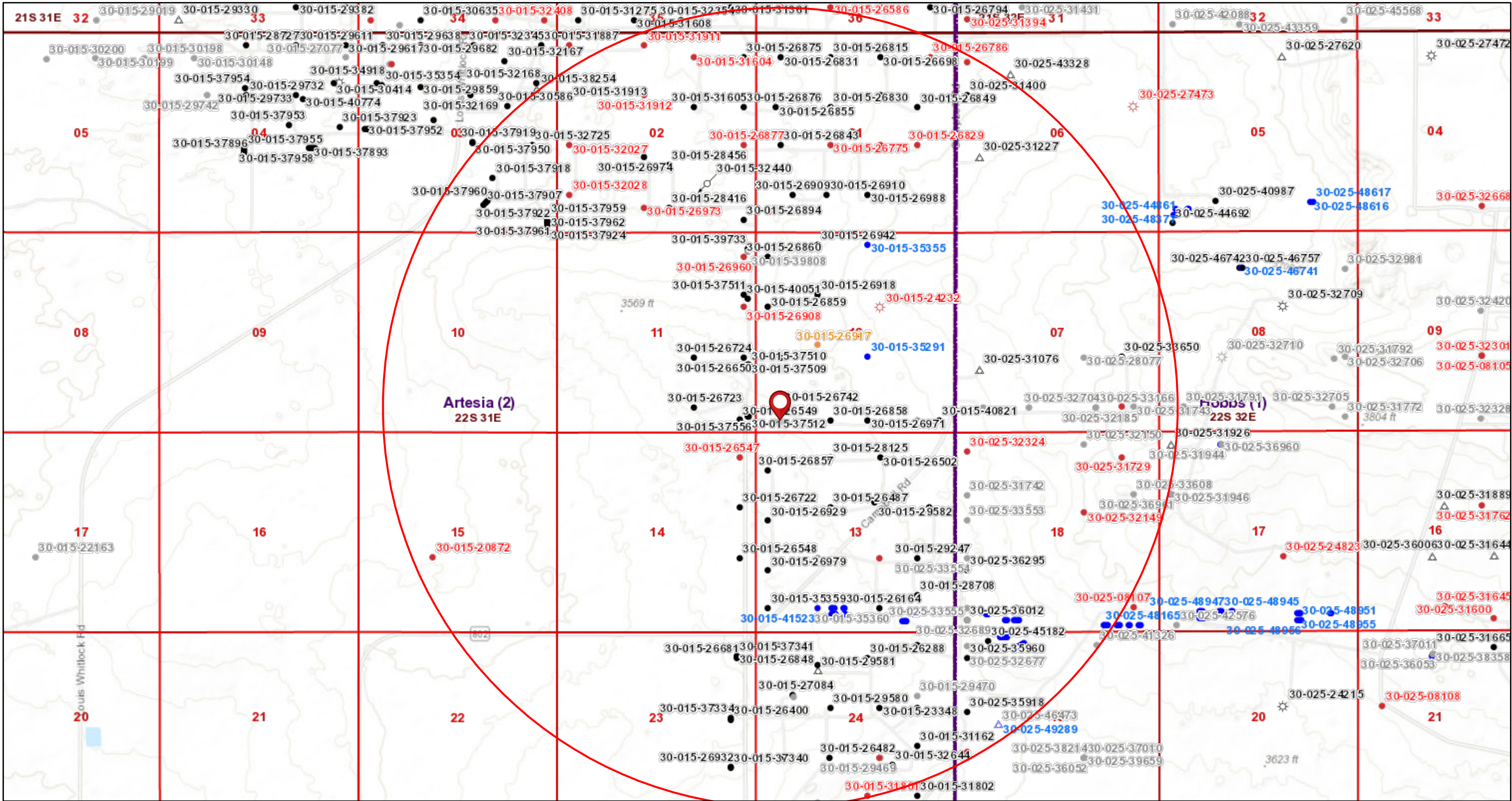







# Federal 12 Well No. 1 - AOR (2 mi)



1/27/2022, 2:52:48 PM

## Wells - Large Scale

- |   |                            |   |                            |   |                                  |
|---|----------------------------|---|----------------------------|---|----------------------------------|
| ? | undefined                  | ⚙ | Gas, Cancelled             | 🔧 | Injection, Temporarily Abandoned |
| 🌀 | Miscellaneous              | ⚙ | Gas, New                   | ● | Oil, Active                      |
| ☀ | CO2, Active                | ⚙ | Gas, Plugged               | ● | Oil, Cancelled                   |
| ☀ | CO2, Cancelled             | 🔧 | Gas, Temporarily Abandoned | ● | Oil, New                         |
| ☀ | CO2, New                   | 🔧 | Injection, Active          | ● | Oil, Plugged                     |
| ☀ | CO2, Plugged               | 🔧 | Injection, Cancelled       | ● | Oil, Temporarily Abandoned       |
| ☀ | CO2, Temporarily Abandoned | 🔧 | Injection, New             | ⚠ | Salt Water Injection, Active     |

- |   |   |   |                      |
|---|---|---|----------------------|
|  | Salt Water Injection, New                   |  | OCD Districts        |
|  | Salt Water Injection, Plugged               |  | OCD District Offices |
|  | Salt Water Injection, Temporarily Abandoned |  | PLSS First Division  |
|  | Water, Active                               |  | PLSS Townships       |
|  | Water, Cancelled                            |   |                      |
|  | Water, New                                  |   |                      |
|  | Water, Plugged                              |   |                      |

-  OCD Districts
-  OCD District Offices
-  PLSS First Division
-  PLSS Townships

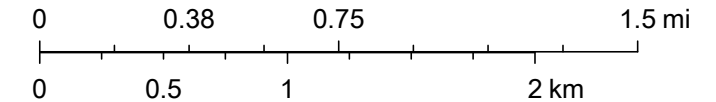

Oil Conservation Division of the New Mexico Energy, Minerals and Natural Resources Department., Bureau of Land Management, Texas Parks & Wildlife, Esri, HERE, Garmin, INCREMENT P, USGS, METI/NASA, EPA, USDA, OCD, BLM

# VI.

Attach a tabulation of data on all wells of public record within the area of review which penetrate the proposed injection zone. Such data shall include a description of each well's type, construction, date drilled, location, depth, record of completion, and a schematic of any plugged well illustrating all plugging detail.

AOR Table

Map #	API No.	Current Operator	Lease Name	Well No.	Well Type:	Status:	Location	Spud:	TVD	MD	Current Completion	Hole Size	CSG Size	Set At	SX CMT	TOC	How Measured	Current Producing Pool
1	30-015-26858	OXY USA INC	FEDERAL 12	003	Oil	Active	330S X 1980W N-12-22S-31E	1/19/1992	8515	8515	6980-6997	17.5 11 7.875	13.375 8.625 5.5	804 4335 8515	1025 1575 1655	Surf Surf 1350	Circ Circ CBL	[39360] LIVINGSTON RIDGE; DELAWARE
2	30-015-26971	OXY USA INC	FEDERAL 12	009	Oil	Active	330S X 2310E O-12-22S-31E	3/6/1995	8535	8535	7117-8318	17.5 11 7.875	13.375 8.625 5.500	630 4285 8535	950 1550 1625	Surf Surf Surf	Circ Circ Circ	[39360] LIVINGSTON RIDGE; DELAWARE
3	30-015-26723	EOG RESOURCES INC	MARTHA AIK FEDERAL	003	Oil	Active	660S X 1650E O-11-22S-31E	5/6/1991	8411	8411	6715-7128	17.5 11 7.875	13.375 8.625 5.500	850 4227 8411	750 2100 1110	Surf Surf 580	Circ Circ TS	[39360] LIVINGSTON RIDGE; DELAWARE
4	30-015-26549	EOG RESOURCES INC	MARTHA AIK FEDERAL	001	Oil	Active	330S X 430E P-11-22S-31E	12/7/1990	8425	8425	6629-8308	17.5 11 7.875	13.375 8.625 5.500	851 4485 8416	900 1700 1200	Surf Surf 3400	Circ Circ Calc	[39360] LIVINGSTON RIDGE; DELAWARE
5	30-015-26547	EOG Y RESOURCES, INC.	DOLORES AIL FEDERAL	001	Oil	PxA	660N X 430E A-14-22S-31E	2/16/1991	8425	8425	6615-8297	17.5 12.25 7.875	13.375 8.625 5.500	855 4460 8425	775 1500 1400	Surf Surf 3400	Circ Circ CBL	NA
6	30-015-37556	EOG RESOURCES INC	MARTHA AIK FEDERAL	014H	Oil	Active	430S X 178E P-11-22S-31E BHL - 626S X 1657W N-11-22S-31E	11/7/2012	7019	10330	7456-10281	17.500 12.250 8.750 6.125	13.375 9.625 7.000 4.500	862 4499 7439 10330	760 1170 785 259	Surf Surf Surf 5204	Circ Circ Circ CBL	[39360] LIVINGSTON RIDGE; DELAWARE
7	30-015-37509	EOG RESOURCES INC	MARTHA AIK FEDERAL	010H	Oil	Active	SHL - 1780S X 178E I-11-22S-31E BHL - 1900S X 360W L-11-22S-31E	9/21/2012	7984	12526	8410-12440	17.500 12.250 8.750 6.125	13.375 9.625 7.000 4.500	859 4562 7420 6922-12520	760 1370 825 400	Surf Surf Surf Surf	Circ Circ Circ Circ	[39360] LIVINGSTON RIDGE; DELAWARE
8	30-015-37512	EOG RESOURCES INC	MARTHA AIK FEDERAL	009H	Oil	Active	430S X 200E P-11-22S-31E BHL - 435S X 1650W N-11-22S-31E	11/7/2012	7720	11456	8606-11397	17.500 12.250 8.750 6.125	13.375 9.625 7.000 4.500	802 4545 7450 6600-11456	760 1140 1410 330	Surf Surf Surf 7070	Circ Circ Circ Calc	[39360] LIVINGSTON RIDGE; DELAWARE
9	30-015-26650	EOG RESOURCES INC	MARTHA AIK FEDERAL	002	Oil	Active	1980S X 330E I-11-22S-31E	3/19/1991	8450	8450	6968-8307	17.5 11 7.875	13.375 8.625 5.500	854 4505 8450	700 1600 790	Surf Surf 4007	Circ Circ Calc	[39360] LIVINGSTON RIDGE; DELAWARE
10	30-015-37510	EOG RESOURCES INC	MARTHA AIK FEDERAL	011H	Oil	Active	SHL - 1780S X 200E I-11-22S-31E BHL - 1774S X 378W L-11-22S-31E	9/21/2012	7045	11498	7353-11405	17.500 12.250 8.750	13.375 9.625 5.5	835 4366 11498	680 1260 2230	Surf Surf Surf	Circ Circ Circ	[39360] LIVINGSTON RIDGE; DELAWARE
11	30-015-26857	CHEVRON U S A INC	NEFF 13 FEDERAL	006	Oil	Active	990N X 330W D-13-22S-31E	10/19/1991	8400	8400	6940-7058	14.75 11 7.875	11.75 8.625 5.5	880 4400 8400	775 1600 1725	Surf Surf Surf	Circ Circ Circ	[39360] LIVINGSTON RIDGE; DELAWARE
12	30-015-26780	OXY USA INC	FEDERAL 12	002	Oil	Active	1980S X 660W L-12-22S-31E	8/21/1991	8490	8490	6874-7080	17.5 11 7.875	13.375 8.625 5.500	840 4315 8490	950 1800 1450	Surf Surf 3375	Circ Circ CBL	[39360] LIVINGSTON RIDGE; DELAWARE
13	30-015-26917	OXY USA INC	FEDERAL 12	006	Oil	TA	2310S X 1650W K-12-22S-31E	3/2/1992	8525	8525	7052-7096	17.5 11 7.875	13.375 8.625 5.500	818 4310 8525	1000 1700 1375	Surf Surf 2200	Circ Circ CBL	[39360] LIVINGSTON RIDGE; DELAWARE
14	30-015-28125	CHEVRON U S A INC	NEFF 13 FEDERAL	009	Oil	Active	660N X 1980W C-13-22S-31E	12/7/1994	8750	8750	6543-7088	14.75 11 7.875	11.750 8.625 5.500	830 4393 8747	575 1200 1750	Surf Surf Surf	Circ Circ Circ	[39360] LIVINGSTON RIDGE; DELAWARE

Roni Mathew  
1/22/2022

PxA Wellbore  
**DOLORES AIL FEDERAL #001**  
30-015-26547  
Eddy

17-1/2" hole @ 855'  
13-3/8" 54.5# csg @ 855'  
w/ 775sx-TOC-Surf-Circ.

12-1/4" hole @ 4460'  
8-5/8" 32# csg @ 4460'  
w/ 1500sx - TOC-Surf-Circ.

7-7/8" hole @ 8425'  
5-1/2" 15.5, 17# csg @ 8425'  
w/ 1400sx - TOC~3400' (CBL)

Prod Zone  
6615' - 8297'

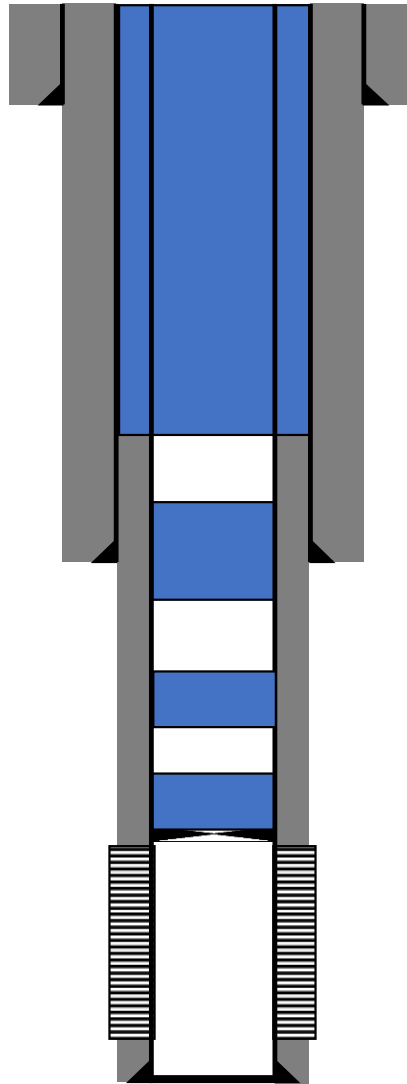

Perf & Sqz w/ 850sx @ 3390'-Surf  
Verified @ Surf

Spot 120sx @ 4550', TOC @ 3461'

Spot 25sx @ 5489', TOC @ 5242'

Set 5-1/2" CIBP @ 6565'  
Cap w/25sx cmt, TOC 6318'

TD - 8425'

UNITED STATES  
DEPARTMENT OF THE INTERIOR  
BUREAU OF LAND MANAGEMENTFORM APPROVED  
OMB NO. 1004-0137  
Expires: January 31, 2018**SUNDRY NOTICES AND REPORTS ON WELLS OIL CONSERVATION**  
*Do not use this form for proposals to drill or to re-enter an abandoned well. Use form 3160-3 (APD) for such proposals.*

OCD Artesia

ARTESIA DISTRICT

JUN 27 2018

RECEIVED

**SUBMIT IN TRIPLICATE - Other instructions on page 2**

1. Type of Well <input checked="" type="checkbox"/> Oil Well <input type="checkbox"/> Gas Well <input type="checkbox"/> Other		5. Lease Serial No. NMNM65418
2. Name of Operator EOG Y RESOURCES INC Contact: KAY MADDOX E-Mail: Kay_Maddox@EOGRESOURCES.com		6. If Indian, Allottee or Tribe Name
3a. Address 104 S 4TH STREET ARTESIA, NM 88210	3b. Phone No. (include area code) Ph: 432-686-3658	7. If Unit or CA/Agreement, Name and/or No.
4. Location of Well (Footage, Sec., T., R., M., or Survey Description) Sec 14 T22S R31E NENE 660FNL 430FEL		8. Well Name and No. DOLORES AIL FED 1
		9. API Well No. 30-015-26547-00-S1
		10. Field and Pool or Exploratory Area LIVINGSTON RIDGE
		11. County or Parish, State EDDY COUNTY, NM

**12. CHECK THE APPROPRIATE BOX(ES) TO INDICATE NATURE OF NOTICE, REPORT, OR OTHER DATA**

TYPE OF SUBMISSION	TYPE OF ACTION			
<input type="checkbox"/> Notice of Intent	<input type="checkbox"/> Acidize	<input type="checkbox"/> Deepen	<input type="checkbox"/> Production (Start/Resume)	<input type="checkbox"/> Water Shut-Off
<input checked="" type="checkbox"/> Subsequent Report	<input type="checkbox"/> Alter Casing	<input type="checkbox"/> Hydraulic Fracturing	<input type="checkbox"/> Reclamation	<input type="checkbox"/> Well Integrity
<input type="checkbox"/> Final Abandonment Notice	<input type="checkbox"/> Casing Repair	<input type="checkbox"/> New Construction	<input type="checkbox"/> Recomplete	<input type="checkbox"/> Other
	<input type="checkbox"/> Change Plans	<input checked="" type="checkbox"/> Plug and Abandon	<input type="checkbox"/> Temporarily Abandon	
	<input type="checkbox"/> Convert to Injection	<input type="checkbox"/> Plug Back	<input type="checkbox"/> Water Disposal	

13. Describe Proposed or Completed Operation: Clearly state all pertinent details, including estimated starting date of any proposed work and approximate duration thereof. If the proposal is to deepen directionally or recompleat horizontally, give subsurface locations and measured and true vertical depths of all pertinent markers and zones. Attach the Bond under which the work will be performed or provide the Bond No. on file with BLM/BIA. Required subsequent reports must be filed within 30 days following completion of the involved operations. If the operation results in a multiple completion or recompleat in a new interval, a Form 3160-4 must be filed once testing has been completed. Final Abandonment Notices must be filed only after all requirements, including reclamation, have been completed and the operator has determined that the site is ready for final inspection.

5/25/2018 MIRU, SET 5 1/2" CIBP @ 6565'

GC 6-27-18  
Accepted for record - NMOCD

5/29/2018 CAP CIBP W/25 SXS CMT, TOC @ 6318', SPOT 25 SXS CMT @ 5489', TOC @ 5242', PERF @ 4510', SET PKR @ 1000', PRESS UP

5/30/2018 RUN CBL, TOC BEHIND 5 1/2" CSG @ 3400', SPOT 120 SXS CMT @ 4550', TOC @ 3400', WOC, TAG TOC @ 3461'

5/31/2018 PERF @ 3390', SQZ W/850 SXS CMT TO SURFACE, VERIFIED CMT RDMO

WELL IS PERMANENTLY PLUGGED AND ABANDONED

RECLAMATION PROCEDURE  
ATTACHEDRECLAMATION  
DUE 12-1-18

14. I hereby certify that the foregoing is true and correct. Electronic Submission #422859 verified by the BLM Well Information System For EOG Y RESOURCES INC, sent to the Carlsbad Committed to AFMSS for processing by DEBORAH MCKINNEY on 06/06/2018 (18PP1521SE)	
Name (Printed/Typed) KAY MADDOX	Title REGULATORY ANALYST
Signature (Electronic Submission)	Date 06/06/2018

**THIS SPACE FOR FEDERAL OR STATE OFFICE USE**

ACCEPTED FOR RECORD

Approved By _____	Title _____
Conditions of approval, if any, are attached. Approval of this notice does not warrant or certify that the applicant holds legal or equitable title to those rights in the subject lease which would entitle the applicant to conduct operations thereon.	Office _____

Title 18 U.S.C. Section 1001 and Title 43 U.S.C. Section 1212, make it a crime for any person knowingly and willfully to make to any department or agency of the United States any false, fictitious or fraudulent statements or representations as to any matter within its jurisdiction.

(Instructions on page 2)

\*\* BLM REVISED \*\* BLM REVISED \*\* BLM REVISED \*\* BLM REVISED \*\* BLM REVISED \*\*

## XII.

Applicants for disposal wells must make an affirmative statement that they have examined available geologic and engineering data and find no evidence of open faults or any other hydrologic connection between the disposal zone and any underground sources of drinking water. [Attached](#)



### **Geological Statement**

- All available geologic and engineering data has been examined and no evidence of open faults or fractures was detected between the Bell Canyon disposal zone and any known underground sources of drinking water.
- There are no water sourcing wells located within a 5+ mile radius of the Federal 12-1 based on the OSE POD Locations map on state website.

**OXY New Mexico, Tanks Area Production Geologist**

A handwritten signature in black ink, appearing to read 'Dan Burnett', with a stylized, cursive script.

Daniel Burnett

# XIII.

Applicants must complete the "Proof of Notice" section on the reverse side of this form. [Attached](#)

**Affidavit of Publication**

Ad # 0005182320

**This is not an invoice**

**OXY USA INC**  
5 GREENWAY PLAZA OFFICE 29.076

**HOUSTON, TX 77046**

I, a legal clerk of the **Carlsbad Current Argus**, a newspaper published daily at the City of Carlsbad, in said county of Eddy, state of New Mexico and of general paid circulation in said county; that the same is a duly qualified newspaper under the laws of the State wherein legal notices and advertisements may be published; that the printed notice attached hereto was published in the regular and entire edition of said newspaper and not in supplement thereof in editions dated as follows:

**03/23/2022**

  
Legal Clerk

Subscribed and sworn before me this March 23, 2022:

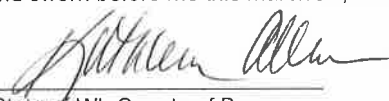
  
State of WI, County of Brown  
NOTARY PUBLIC  
1-7-25  
My commission expires

Notice of Application for  
Fluid Disposal

Applicant:  
OXY USA Inc.  
P.O. Box 4294  
Houston, TX 77210-4294  
ATTN: Stephen Janacek  
Phone: 713-493-1986

Purpose of well:  
Disposal of produced water  
into a non-productive oil  
and gas zone in the Federal  
12 #1. The well is located  
660 ft FSL and 660 ft FWL,  
SWSW (M), Sec 12, T22S,  
R31E. Eddy County, NM.

Formation: Delaware- Bell  
Canyon 4672-4962 ft. Maxi-  
mum Injection Rate: 4000  
BWPD. Maximum Injection  
Pressure: 915 psi.

Interested parties must file  
objections or requests for  
hearing with the Oil Conser-  
vation Division, 1220 South  
St. Francis Dr., Santa Fe,  
New Mexico 87505 within  
15 days of this application.  
#5182320, Current Argus,  
March 23, 2022

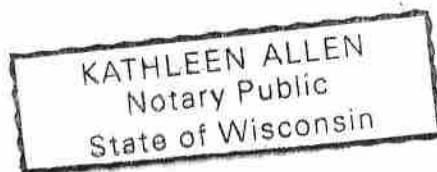

Ad # 0005182320  
PO #: 5182320  
# of Affidavits 1

**This is not an invoice**

## Notice List

Party	Street	City	State	Zip Code	Merged
New Mexico Oil Conservation Division	1220 South St. Francis Dr	Santa Fe	NM	87505	New Mexico Oil Conservation Division 1220 South St. Francis Dr Santa Fe, NM 87505
New Mexico Oil Conservation Division, Artesia	811 S. First St.	Artesia	NM	88210	New Mexico Oil Conservation Division, Artesia 811 S. First St. Artesia, NM 88210
<b>Surface Owner</b>					
BLM	620 E Greene St.	Carlsbad	NM	88220	BLM 620 E Greene St. Carlsbad, NM 88220
<b>Offset Operators within 1/2 mile</b>					
CHEVRON U S A INC	6301 Deauville Blvd	Midland	TX	79706	CHEVRON U S A INC 6301 Deauville Blvd Midland, TX 79706
EOG Resources, INC.	1111 Bagby St Lbby 2	Houston	TX	77002	EOG Resources, INC. 1111 Bagby St Lbby 2 Houston, TX 77002
<b>Potash Lessees within 1 mile</b>					
Intrepid Potash LLC	707 17th St.	Denver	CO	80202	Intrepid Potash LLC 707 17th St. Denver, CO 80202
Western Ag-Mineral Co	5516 Hobbs Hwy	Carlsbad	NM	88220	Western Ag-Mineral Co 5516 Hobbs Hwy Carlsbad, NM 88220
<b>Affected Persons within 1/2 mile</b>					
Adex Resources Corp	PO Box 109	Argillite	KY	41121	Adex Resources Corp PO Box 109 Argillite, KY 41121
Billy Glenn Spradin	19 Rim Road	Kilgore	TX	75662	Billy Glenn Spradin 19 Rim Road Kilgore, TX 75662
Chisos, Ltd.	1331 Lamar St. Suite 1077	Houston	TX	77010	Chisos, Ltd. 1331 Lamar St. Suite 1077 Houston, TX 77010
CNX Gas Co LLC	PO Box 1248	Jane Lew	WV	26378	CNX Gas Co LLC PO Box 1248 Jane Lew, WV 26378
EOG RESOURCES INC	P.O. Box 2267	Midland	TX	79702	EOG RESOURCES INC P.O. Box 2267 Midland, TX 79702
Larry T. Long, L. Allan Long and Sammy Adamson, Trustees of the Larry Thomas Long Trust, the Charles Edward Long Trust, the Lawrence Allan Long Trust, and the John Stephen Long Trust, collectively d/b/a the Long Trust	P.O. Box 3096, Attn: R. Davis Sherman	Kilgore	TX	75663	Larry T. Long, L. Allan Long and Sammy Adamson, Trustees of the Larry Thomas Long Trust, the Charles Edward Long Trust, the Lawrence Allan Long Trust, and the John Stephen Long Trust, collectively d/b/a the Long Trust P.O. Box 3096, Attn: R. Davis Sherman Kilgore, TX 75663
Long Trusts	PO Box 1336	Kilgore	TX	75662	Long Trusts PO Box 1336 Kilgore, TX 75662
Midwest Resources 2001-1 O & G Income	PO Box 76	Elm Grove	WI	53122	Midwest Resources 2001-1 O & G Income PO Box 76 Elm Grove, WI 53122
Nielson & Assoc Inc.	PO Box 2850	Cody	WY	82414	Nielson & Assoc Inc. PO Box 2850 Cody, WY 82414
PXP Producing Co LLC	171 Texas St, Ste 2100	Houston	TX	77002	PXP Producing Co LLC 171 Texas St, Ste 2100 Houston, TX 77002
Rockport Oil and Gas, LLC	P.O. Box 847	Houston	TX	77001	Rockport Oil and Gas, LLC P.O. Box 847 Houston, TX 77001
Torch Oil & Gas Co	1221 Lamar, #1600	Houston	TX	77010	Torch Oil & Gas Co 1221 Lamar, #1600 Houston, TX 77010

US Borax & Chem Corp	3075 Wilshire Blvd	Los Angeles	CA	90010	US Borax & Chem Corp 3075 Wilshire Blvd Los Angeles, CA 90010
XTO Holdings, LLC	801 Houston St, Attn: Permian Land Manager	Fort Worth	TX	76102	XTO Holdings, LLC 801 Houston St, Attn: Permian Land Manager Fort Worth, TX 76102



**OXY USA WTP Limited Partnership / OXY USA INC /  
OCCIDENTAL PERMIAN LTD.**  
A subsidiary of Occidental Petroleum Corporation

5 Greenway Plaza, Suite 110, Houston, Texas 77046  
P.O. Box 4294, Houston, Texas 77210-4294  
Direct: 713-493-1986  
Stephen\_Janacek@oxy.com

3/30/2022

Re: Application for Administrative Approval of  
SWD Federal 12 #001 (30-015-26742)  
Eddy County, New Mexico

**COPY**

To Whom it May Concern:

Enclosed is a copy of an application, filed with the New Mexico Oil Conservation Division (NMOCD) by OXY USA Inc., requesting administrative approval for a salt water disposal well. As an affected party, notice is being provided to you pursuant to Rule 19.15.26.8 (1)(C) NMAC, and 19.15.26.8 (2)(B). The well is located as follows:

- Surface hole location- Unit Letter M, Section 12, Township 22 South, Range 31 East, 660 ft from South line, 660 ft from West line, Eddy County

If you object to this application, you must notify the NMOCD within 15 days from the date the original application was mailed. You can notify the NMOCD (1220 South St. Francis Drive, Santa Fe, NM 87505) via phone (505-476-3441).

If you need any additional information, please feel free to contact me via email at Stephen\_Janacek@oxy.com or by telephone at 713-493-1986.

Respectfully,

*Stephen Janacek*

OXY USA INC.  
Stephen Janacek  
Regulatory Engineer  
Stephen\_Janacek@oxy.com

## Notice Mailings sent on 3/30/22

To Name	To Address Line 1	To City	To State	To ZIP	Tracking Number
New Mexico Oil Conservation Division	1220 South St Francis Dr	Santa Fe	NM	87505	_9414811898765841481340
New Mexico Oil Conservation Division, Artesia	811 S First St	Artesia	NM	88210	_9414811898765841481388
BLM	620 E Greene St	Carlsbad	NM	88220	_9414811898765841481333
CHEVRON U S A INC	6301 Deauville Blvd	Midland	TX	79706	_9414811898765841481012
EOG Resources, INC.	1111 Bagby St Lobby 2	Houston	TX	77002	_9414811898765841481050
Intrepid Potash LLC	707 17th St	Denver	CO	80202	_9414811898765841481067
Western Ag-Mineral Co	5516 Hobbs Hwy	Carlsbad	NM	88220	_9414811898765841481029
Adex Resources Corp	PO Box 109	Argillite	KY	41121	_9414811898765841481005
Billy Glenn Spradin	19 Rim Road	Kilgore	TX	75662	_9414811898765841481098
Chisos Ltd.	1331 Lamar St Suite 1077	Houston	TX	77010	_9414811898765841481043
CNX Gas Co LLC	PO Box 1248	Jane Lew	WV	26378	_9414811898765841481081
EOG RESOURCES INC	PO Box 2267	Midland	TX	79702	_9414811898765841481036
The Long Trust Attn R Davis Sherman	PO Box 3096	Kilgore	TX	75663	_9414811898765841481418
Long Trusts	PO Box 1336	Kilgore	TX	75662	_9414811898765841481456
Midwest Resources 2001-1 O & G Income	PO Box 76	Elm Grove	WI	53122	_9414811898765841481463
Nielson & Assoc Inc.	PO Box 2850	Cody	WY	82414	_9414811898765841481425
PXP Producing Co LLC	171 Texas St Ste 2100	Houston	TX	77002	_9414811898765841481401
Rockport Oil and Gas, LLC	PO Box 847	Houston	TX	77001	_9414811898765841481494
Torch Oil & Gas Co	1221 Lamar No 1600	Houston	TX	77010	_9414811898765841481449
US Borax & Chem Corp	3075 Wilshire Blvd	Los Angeles	CA	90010	_9414811898765841481487
XTO Holdings, LLC Attn Permian Land Manager	801 Houston St	Fort Worth	TX	76102	_9414811898765841481470