

District I
1625 N. Freuch Dr., Hobbs, NM 88240
District II
1301 W. Grand Avenue, Artesia, NM 88210
District III
1000 Rio Brazos Road, Aztec, NM 87410
District IV
1220 S. St. Francis Dr., Santa Fe, NM 87505

State of New Mexico
Energy Minerals and Natural Resources
Oil Conservation Division
1220 South St. Francis Dr.
Santa Fe, NM 87505

Form C-141
Revised January 1, 2008

Submit 1 Copy to appropriate
District Office

Release Notification and Corrective Action

OPERATOR

☒ Initial Report ☐ Final Report

Name of Company: DCP Midstream, LP	Contact: Johnnie Bradford
Address: 10 Desta Drive, Suite 400 W, Midland, TX., 79705	Telephone# & E-mail: 432.620.4166 / jbradford@dcpmidstream.com
Facility Name: W-13 pipeline	Facility Type: Pipeline

Surface Owner: Unk	Mineral Owner: Unk	Well API No.: NA
--------------------	--------------------	------------------

LOCATION OF RELEASE

Unit Letter J	Section 14	Township 19	Range 31	Feet from the	North/South Line S	Feet from the	East/West Line E	County Lee Eddy County
------------------	---------------	----------------	-------------	---------------	-----------------------	---------------	---------------------	------------------------------

Latitude N32.6610 Longitude W103.8363

NATURE OF RELEASE

Type of Release : Liquid and Gas	Volume of Release: ~20-25 bbls oil/~430 Mcf of Gas	Volume Recovered: 0
Source of Release: Pipeline	Date & Hour of Occurrence: 05/19/2011 unknown hour	Date & Hour of Discovery: 5/19/2011 ~09:00 MST
Was Immediate Notice Given OCD? <input type="checkbox"/> Yes <input checked="" type="checkbox"/> No <input type="checkbox"/> Not Required	If YES, To Whom @ OCD? NA	
By Whom? NA	Date and Hour: NA	
Was a Watercourse Reached? <input type="checkbox"/> Yes <input checked="" type="checkbox"/> No	If YES, Volume Impacting the Watercourse: NA	

If a Watercourse was Impacted, Describe Fully.*
NA

Describe Cause of Problem and Remedial Action Taken. (If water spilled, give Chloride content)*

The W-13 pipeline developed a leak at the coordinates listed above. The pipeline was isolated to prevent additional leakage to the environment and a crew was dispatched to begin the process of making repairs. The pipeline will be repaired by digging up the affected area and applying a clamp to seal the hole. Any contaminated soil will be removed and disposed in an approved OCD landfill. Once the contamination has been removed, the affected area will be backfilled with material indigenous to the area.

Describe Area Affected, Dimensions, and Cleanup Action Taken.*

Affected area consisted of mostly over spray with some liquid that followed cow trails for several feet. Overall demensions of the spill area is approximately 75 feet by 150 feet.

I hereby certify that the information given above is true and complete to the best of my knowledge and understand that pursuant to NMOCD rules and regulations all operators are required to report and/or file certain release notifications and perform corrective actions for releases which may endanger public health or the environment. The acceptance of a C-141 report by the NMOCD marked as "Final Report" does not relieve the operator of liability should their operations have failed to adequately investigate and remediate contamination that pose a threat to ground water, surface water, human health or the environment. In addition, NMOCD acceptance of a C-141 report does not relieve the operator of responsibility for compliance with any other federal, state, or local laws and/or regulations.

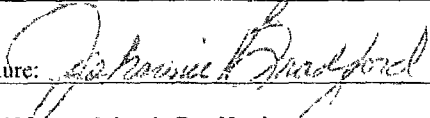
Signature: 		OIL CONSERVATION DIVISION	
Printed Name: Johnnie Bradford		Approved by District Supervisor:	
Title: Sr. Environmental Specialist		Approval Date:	Expiration Date:
E-mail Address: jbradford@dcpmidstream.com		Conditions of Approval:	
Date: 06/07/2011 Phone: 432.620.4166		RP#	

Vernon Black

From: Bratcher, Mike, EMNRD [mike.bratcher@state.nm.us]
Sent: Thursday, August 04, 2011 2:55 PM
To: Vernon Black; Paul_Evans@nm.blm.gov
Cc: jbradford@dcpmidstream.com
Subject: RE: Emailing: DCP W 13 Line Closure Request

Reference: DCP Midstream * W 13 Pipeline Release * J-14-19s-31e * Eddy County, New Mexico
2RP-811 * DOR:5/19/11

Greetings,

Your request for closure/backfill is approved. Like approval by BLM or any other regulatory authority, as may be applicable, may be required.

Please submit a Form C-141 Final Report to NMOCD District 2 office for final closure of incident.

If you have any questions or concerns, please contact me.

Mike Bratcher
NMOCD District 2
811 S. First Street
Artesia, NM 88210
575-748-1283 Ext. 108
575-626-0857
mike.bratcher@state.nm.us

-----Original Message-----

From: Vernon Black [mailto:vernon@hungry-horse.com]
Sent: Tuesday, July 19, 2011 10:28 AM
To: Bratcher, Mike, EMNRD; Paul__Evans@nm.blm.gov
Subject: Emailing: DCP W 13 Line Closure Request

Good Morning Gentlemen,

Please see the attached Closure Request Packet for DCP's W 13 Line. Please feel free to give me a call if you have any questions.

Thanks,

HUNGRY HORSE, LLC ENVIRONMENTAL SERVICES

Dirt Work

*

On-Site Remediation

*

Soil Testing

*

Excavation

18July11

To: Mike Bratcher, NM OCD

Paul Evans, BLM

Reference: Request for Closure

Location: W 13 Line

Operator: DCP Midstream

Legals: Ul. J, Sec. 14, T19S, R31E

GPS: N32.6610 W103.8363

Site Background

The affected area is west of DCP's Lusk Plant which is located just off CR 126 on Lusk Plant Road. This site is on BLM land with a local rancher having the lease for grazing of cattle. There are no know water wells and no surface bodies of water within 1000' of the site. Based upon the Eddy County Depth to Groundwater Map, depth to groundwater is 300'. Thus, this site receives a site ranking score of "0".

Work Conducted

Upon discovery of the release, the line was shut in and a section, approximately 200', was removed and replaced. The line was left exposed to accommodate remedial action and the remediation process.

Remedial action consisted of promptly recovering the saturated soil and placing it on plastic for disposal. Chloride field test were conducted to determine if chlorides were present. Field test indicated a heavy concentration of chlorides at approximately 1.5' BGS. Trucks were dispatched to transport the saturated material. Due the limited availability of trucks, the excavation and hauling continued with chloride field tests being conducted regularly. At approximately 10' BGS field test indicated chloride contamination had been mitigated.

Four soil samples (see attached sketch) were obtained to confirm field test results. Samples were analyzed for TPH, BTEX, and Chlorides. Lab results (see attached) indicated levels at or below required closure limit levels.

I am requesting approval for closure. Upon receipt, the area will back filled with clean material from a nearby source, contoured to match the surrounding terrain, and seeded using a BLM approved seed mixture.

Sincerely,

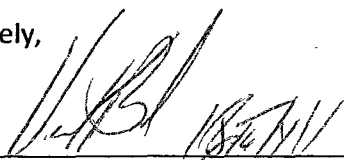

Vernon K. Black, Hungry Horse, LLC

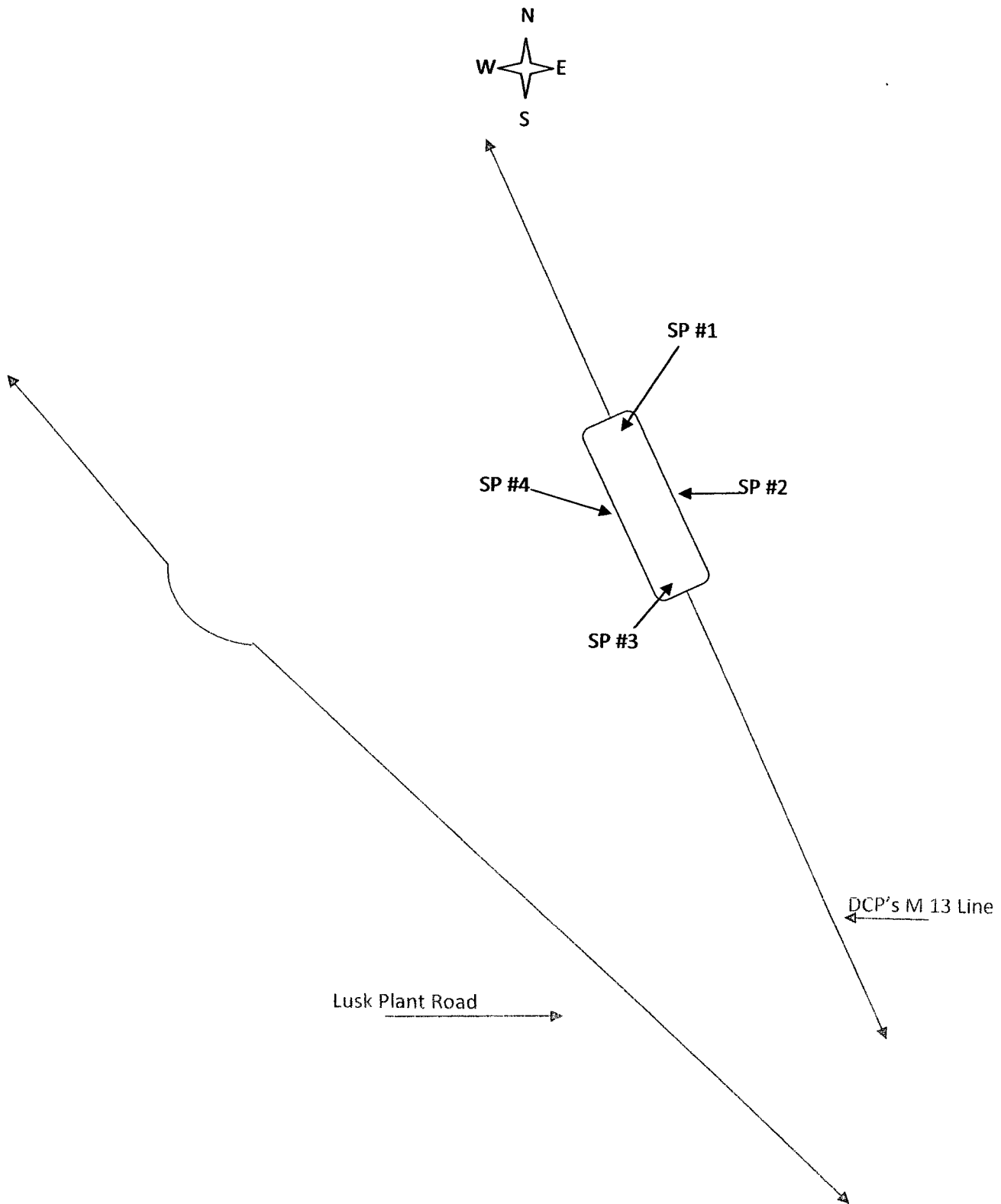

Note: Drawing is not to scale.

DCP's W13 Line lab Results for Closure

	SP#1 Under Pipe	SP#2 East Wall	SP#3 Under Pipe	SP#4 West Wall
	<.15ppm	<.15ppm	.57ppm	<.15ppm

Total BTEX

	SP#1 Under Pipe	SP#2 East Wall	SP#3 Under Pipe	SP#4 West Wall
	<16ppm	48ppm	480ppm	<16ppm

Chlorides

	SP#1 Under Pipe	SP#2 East Wall	SP#3 Under Pipe	SP#4 West Wall
	<10/<10ppm	<10/<10ppm	1750ppm	<10/<10ppm

TPH (GRO/DRO)



CHAIN-OF-CUSTODY AND ANALYSIS REQUEST

101 East Marland, Hobbs, NM 88240
(575) 393-2326 FAX (575) 393-2476

Company Name: <u>Hungry Horse</u>		BILL TO		ANALYSIS REQUEST											
Project Manager:		P.O. #:		<div style="display: flex; flex-direction: column; align-items: center; justify-content: center;"><div>1 PH</div><div>BTEX</div><div>Chlorides</div></div>											
Address:		Company:													
City:		Attn:													
State:		Address:													
Zip:		City:													
Phone #:		State:													
Fax #:		Zip:													
Project #:		Phone #:													
Project Name: <u>Det. Lingo</u>		Fax #:													
Project Location: <u>Eddy Co.</u>		Sampler Name:													
FOR LAB USE ONLY															
Lab I.D.		Sample I.D.													
H101416		SP1													
2 SP2															
3 SP3															
4 SP4															

PLEASE NOTE: Liability and Damages. Cardinal's liability and client's exclusive remedy for any claim arising whether based in contract or tort, shall be limited to the amount paid by the client for the analyses. All claims, including those for negligence and any other cause whatsoever shall be deemed waived unless made in writing and received by Cardinal within 30 days after completion of the applicable service. In no event shall Cardinal be liable for incidental or consequential damages, including without limitation, business interruptions, loss of use, or loss of profits incurred by client, its subsidiaries, affiliates or successors arising out of or related to the performance of services hereunder by Cardinal, regardless of whether such claim is based upon any of the above stated reasons or otherwise.

Relinquished By: <u>[Signature]</u>	Date: <u>7-8-11</u>	Received By: <u>[Signature]</u>	Phone Result: <input type="checkbox"/> Yes <input type="checkbox"/> No	Add'l Phone #:
Relinquished By:	Time: <u>1:34:15</u>	Received By:	Fax Result: <input type="checkbox"/> Yes <input type="checkbox"/> No	Add'l Fax #:
Delivered By: (Circle One) Sampler - UPS - Bus - Other:		Sample Condition Cool <input checked="" type="checkbox"/> Intact <input checked="" type="checkbox"/> Yes <input type="checkbox"/> No <input type="checkbox"/>	CHECKED BY: <u>[Signature]</u>	
REMARKS: <u>1/8: John changed name to W-13. JH</u>				

Analytical Results For:

 Hungry Horse Environmental
 VERNON BLACK
 P.O. Box 1058
 Hobbs NM, 88240
 Fax To: (505) 391-4585

 Received: 07/08/2011
 Reported: 07/14/2011
 Project Name: W-13 LINE
 Project Number: NONE GIVEN
 Project Location: EDDY COUNTY, NM

 Sampling Date: 07/08/2011
 Sampling Type: Soil
 Sampling Condition: Cool & Intact
 Sample Received By: Jodi Henson

Sample ID: SP 1 (H101416-01)

8TEX 80218		mg/kg		Analyzed By: CDK						
Analyte	Result	Reporting Limit	Analyzed	Method Blank	BS	% Recovery	True Value QC	RPD	Qualifier	
Benzene*	<0.050	0.050	07/13/2011	ND	1.65	82.4	2.00	3.17		
Toluene*	<0.050	0.050	07/13/2011	ND	1.84	91.9	2.00	3.84		
Ethylbenzene*	<0.050	0.050	07/13/2011	ND	1.93	96.4	2.00	3.88		
Total Xylenes*	<0.150	0.150	07/13/2011	ND	5.66	94.4	6.00	3.97		

Surrogate 4-Bromofluorobenzene (PIL) 106 % 70-130

Chloride, SM4500Cl-B		mg/kg		Analyzed By: HM						
Analyte	Result	Reporting Limit	Analyzed	Method Blank	BS	% Recovery	True Value QC	RPD	Qualifier	
Chloride	<16.0	16.0	07/11/2011	ND	464	116	400	7.14		

TPH 8015M		mg/kg		Analyzed By: ab					
Analyte	Result	Reporting Limit	Analyzed	Method Blank	BS	% Recovery	True Value QC	RPD	Qualifier
GRO C6-C10	<10.0	10.0	07/12/2011	ND	171	85.7	200	16.6	
DRO >C10-C28	<10.0	10.0	07/12/2011	ND	156	78.2	200	0.924	

Surrogate: 1-Chlorooctane 98.1 % 70-130

Surrogate: 1-Chlorooctadecane 104 % 70-130

Cardinal Laboratories

*=Accredited Analyte

PLEASE NOTE: Liability and Damages. Cardinal's liability and client's exclusive remedy for any claim arising, whether based in contract or tort, shall be limited to the amount paid by client for analyses. All claims, including those for negligence and any other cause whatsoever shall be deemed waived unless made in writing and received by Cardinal within thirty (30) days after completion of the applicable service. In no event shall Cardinal be liable for incidental or consequential damages, including, without limitation, business interruptions, loss of use, or loss of profits incurred by client, its subsidiaries, affiliates or successors arising out of or related to the performance of the services hereunder by Cardinal, regardless of whether such claim is based upon any of the above stated reasons or otherwise. Results relate only to the samples identified above. This report shall not be reproduced except in full with written approval of Cardinal Laboratories.

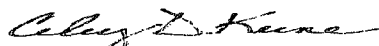

Celey D. Keene, Lab Director/Quality Manager

Analytical Results For:

Hungry Horse Environmental
VERNON BLACK
P.O. Box 1058
Hobbs NM, 88240
Fax To: (505) 391-4585

Received: 07/08/2011
Reported: 07/14/2011
Project Name: W-13 LINE
Project Number: NONE GIVEN
Project Location: EDDY COUNTY, NM

Sampling Date: 07/08/2011
Sampling Type: Soil
Sampling Condition: Cool & Intact
Sample Received By: Jodi Henson

Sample ID: SP 2 (H101416-02)

BTEX 8021B		mg/kg		Analyzed By: CDK						
Analyte	Result	Reporting Limit	Analyzed	Method Blank	BS	% Recovery	True Value QC	RPD	Qualifier	
Benzene*	<0.050	0.050	07/13/2011	ND	1.65	82.4	2.00	3.17		
Toluene*	<0.050	0.050	07/13/2011	ND	1.84	91.9	2.00	3.84		
Ethylbenzene*	<0.050	0.050	07/13/2011	ND	1.93	96.4	2.00	3.88		
Total Xylenes*	<0.150	0.150	07/13/2011	ND	5.66	94.4	6.00	3.97		

Surrogate: 4-Bromofluorobenzene (PIL) 106 % 70-130

Chloride, SM4500Cl-B		mg/kg		Analyzed By: HM					
Analyte	Result	Reporting Limit	Analyzed	Method Blank	BS	% Recovery	True Value QC	RPD	Qualifier
Chloride	48.0	16.0	07/11/2011	ND	464	116	400	7.14	

TPH 8015M		mg/kg		Analyzed By: ab					
Analyte	Result	Reporting Limit	Analyzed	Method Blank	BS	% Recovery	True Value QC	RPD	Qualifier
GRO C6-C10	<10.0	10.0	07/13/2011	ND	171	85.7	200	16.6	
DRO >C10-C28	<10.0	10.0	07/13/2011	ND	156	78.2	200	0.924	

Surrogate: 1-Chlorooctane 99.1 % 70-130

Surrogate: 1-Chlorooctadecane 104 % 70-130

Cardinal Laboratories

*=Accredited Analyte

PLEASE NOTE: Liability and Damages. Cardinal's liability and client's exclusive remedy for any claim arising, whether based in contract or tort, shall be limited to the amount paid by client for analyses. All claims, including those for negligence and any other cause whatsoever shall be deemed waived unless made in writing and received by Cardinal within thirty (30) days after completion of the applicable service. In no event shall Cardinal be liable for incidental or consequential damages, including, without limitation, business interruptions, loss of use, or loss of profits incurred by client, its subsidiaries, affiliates or successors arising out of or related to the performance of the services hereunder by Cardinal, regardless of whether such claim is based upon any of the above stated reasons or otherwise. Results relate only to the samples identified above. This report shall not be reproduced except in full with written approval of Cardinal Laboratories.

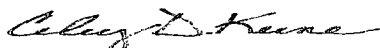

Celey D. Keene, Lab Director/Quality Manager

Analytical Results For:

 Hungry Horse Environmental
 VERNON BLACK
 P.O. Box 1058
 Hobbs NM, 88240
 Fax To: (505) 391-4585

 Received: 07/08/2011
 Reported: 07/14/2011
 Project Name: W-13 LINE
 Project Number: NONE GIVEN
 Project Location: EDDY COUNTY, NM

 Sampling Date: 07/08/2011
 Sampling Type: Soil
 Sampling Condition: Cool & Intact
 Sample Received By: Jodi Henson

Sample ID: SP 3 (H101416-03)

BTX 8021B		mg/kg	Analyzed By: CDK						
Analyte	Result	Reporting Limit	Analyzed	Method Blank	BS	% Recovery	True Value QC	RPD	Qualifier
Benzene*	<0.050	0.050	07/13/2011	ND	1.65	82.4	2.00	3.17	
Toluene*	0.184	0.050	07/13/2011	ND	1.84	91.9	2.00	3.84	
Ethylbenzene*	<0.050	0.050	07/13/2011	ND	1.93	96.4	2.00	3.88	
Total Xylenes*	0.389	0.150	07/13/2011	ND	5.66	94.4	6.00	3.97	

Surrogate: 4-Bromofluorobenzene (PIL) 104 % 70-130

Chloride, SM4500Cl-B		mg/kg	Analyzed By: HM						
Analyte	Result	Reporting Limit	Analyzed	Method Blank	BS	% Recovery	True Value QC	RPD	Qualifier
Chloride	480	16.0	07/11/2011	ND	464	116	400	7.14	
TPH 8015M		mg/kg	Analyzed By: ab						
Analyte	Result	Reporting Limit	Analyzed	Method Blank	BS	% Recovery	True Value QC	RPD	Qualifier
GRO C6-C10	<10.0	10.0	07/13/2011	ND	171	85.7	200	16.6	
DRO >C10-C28	1750	10.0	07/13/2011	ND	156	78.2	200	0.924	

Surrogate: 1-Chlorooctane 97.9 % 70-130

Surrogate: 1-Chlorooctadecane 101 % 70-130

Cardinal Laboratories

*=Accredited Analyte

PLEASE NOTE: Liability and Damages. Cardinal's liability and client's exclusive remedy for any claim arising, whether based in contract or tort, shall be limited to the amount paid by client for analyses. All claims, including those for negligence and any other cause whatsoever shall be deemed waived unless made in writing and received by Cardinal within thirty (30) days after completion of the applicable service. In no event shall Cardinal be liable for incidental or consequential damages, including, without limitation, business interruptions, loss of use, or loss of profits incurred by client, its subsidiaries, affiliates or successors arising out of or related to the performance of the services hereunder by Cardinal, regardless of whether such claim is based upon any of the above stated reasons or otherwise. Results relate only to the samples identified above. This report shall not be reproduced except in full with written approval of Cardinal Laboratories.

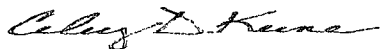

Celey D. Keene, Lab Director/Quality Manager

Analytical Results For:

 Hungry Horse Environmental
 VERNON BLACK
 P.O. Box 1058
 Hobbs NM, 88240
 Fax To: (505) 391-4585

 Received: 07/08/2011
 Reported: 07/14/2011
 Project Name: W-13 LINE
 Project Number: NONE GIVEN
 Project Location: EDDY COUNTY, NM

 Sampling Date: 07/08/2011
 Sampling Type: Soil
 Sampling Condition: Cool & Intact
 Sample Received By: Jodi Henson

Sample ID: SP 4 (H101416-04)

BTEX 8021B			mg/kg Analyzed By: CDK						
Analyte	Result	Reporting Limit	Analyzed	Method Blank	BS	% Recovery	True Value QC	RPD	Qualifier
Benzene*	<0.050	0.050	07/13/2011	ND	1.65	82.4	2.00	3.17	
Toluene*	<0.050	0.050	07/13/2011	ND	1.84	91.9	2.00	3.84	
Ethylbenzene*	<0.050	0.050	07/13/2011	ND	1.93	96.4	2.00	3.88	
Total Xylenes*	<0.150	0.150	07/13/2011	ND	5.66	94.4	6.00	3.97	

Surrogate: 4-Bromofluorobenzene (PIL) 106 % 70-130

Chloride, SM4500Cl-B		mg/kg		Analyzed By: HM					
Analyte	Result	Reporting Limit	Analyzed	Method Blank	BS	% Recovery	True Value QC	RPD	Qualifier
Chloride	<16.0	16.0	07/11/2011	ND	464	116	400	7.14	

TPH 8015M		mg/kg		Analyzed By: ab					
Analyte	Result	Reporting Limit	Analyzed	Method Blank	BS	% Recovery	True Value QC	RPD	Qualifier
GRO C6-C10	<10.0	10.0	07/13/2011	ND	171	85.7	200	16.6	
DRO >C10-C28	<10.0	10.0	07/13/2011	ND	156	78.2	200	0.924	

Surrogate: 1-Chlorooctane 95.5 % 70-130

Surrogate: 1-Chlorooctadecane 97.5 % 70-130

Cardinal Laboratories

*=Accredited Analyte

PLEASE NOTE: Liability and Damages. Cardinal's liability and client's exclusive remedy for any claim arising, whether based in contract or tort, shall be limited to the amount paid by client for analyses. All claims, including those for negligence and any other cause whatsoever shall be deemed waived unless made in writing and received by Cardinal within thirty (30) days after completion of the applicable service. In no event shall Cardinal be liable for incidental or consequential damages, including, without limitation, business interruptions, loss of use, or loss of profits incurred by client, its subsidiaries, affiliates or successors arising out of or related to the performance of the services hereunder by Cardinal, regardless of whether such claim is based upon any of the above stated reasons or otherwise. Results relate only to the samples identified above. This report shall not be reproduced except in full with written approval of Cardinal Laboratories.

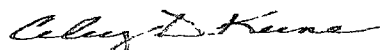

Celey D. Keene, Lab Director/Quality Manager