

MOBIL EXPLORATION & PRODUCING U.S.

KRITI STATE 31 #1

DOWNHOLE COMMINGLING REQUIRED DATA

1. (a) Well involves a oil zone.
  1. Combined daily production from oil zones before commingling as determined in accordance with section D, paragraphs 4 and 5 of rule 303-C does not exceed 80 bbls/day limitation with the perforations of lowermost pool at greater than 10,000 ft.
  2. Artificial lift will be used to bring fluid from both zones.
  3. Neither zone produced more water than the combined oil limitation as determined in 1(a)1.
  4. Combining fluid from both zones does not result in the formation of precipitates at the formation.
  5. Value of the crude will not be reduced by commingling.
  6. Ownership is common.
  7. Commingling will not jeopardize efficiency of future secondary recovery operations.
2. (a) Mobil Exploration & Producing U.S.  
12450 Greenspoint Dr.  
Houston, Tx 77060-1991
- (b) Kriti State 31 #1  
Sec 31, T-16S, R-36E  
Lea County, New Mexico  
Upper Pennsylvanian and Wolfcamp zones.
- (c) Ownership plat (attached).
- (d) A current 24-hr test of the Wolfcamp is 21 BOPD and 11 BWPD. Production on the Upper Pennsylvanian immediately prior to recompletion to the Wolfcamp is 5 BOPD and 49 BWPD.
- (e) Production curves for both zones (attached).

- (f) Bottom hole pressures for each zone (attached).
- (g) Each zone is oil and there is no evidence of incompatibility.
- (h) Test the Wolfcamp prior to commingling, then test the commingled production. Allocate initial test production to the Wolfcamp. Allocated the differential of the commingled production and the Wolfcamp to the Upper Pennsylvanian.
- (i) Researched offset acreage, and Mobil is the only operator in this field.

B.P. PATERNOSTRO

Multiphase Curve Analysis

Rate vs Time

(c) 1989 SoftSearch, Inc

S. SHOEBAR FIELD

KRITI STATE 31 #1

UPERR PENN PRODUCTION

4/17/1993

Project: KRITI31#1 PENN

### Production Curves

OIL: ■ OIL DATA  
0 History 10/88 - 7/91  
1 Const Percent 10/88 - 9/91  
Q1 : 2208.248 BBL/N  
Q1 : 66.001 %  
Q2 : 86.789 BBL/N  
Np : 23.589 M88L

GAS: ♦ GAS DATA  
0 History 11/88 - 9/91

WTR: ♦ WATER DATA  
0 History 11/88 - 9/91

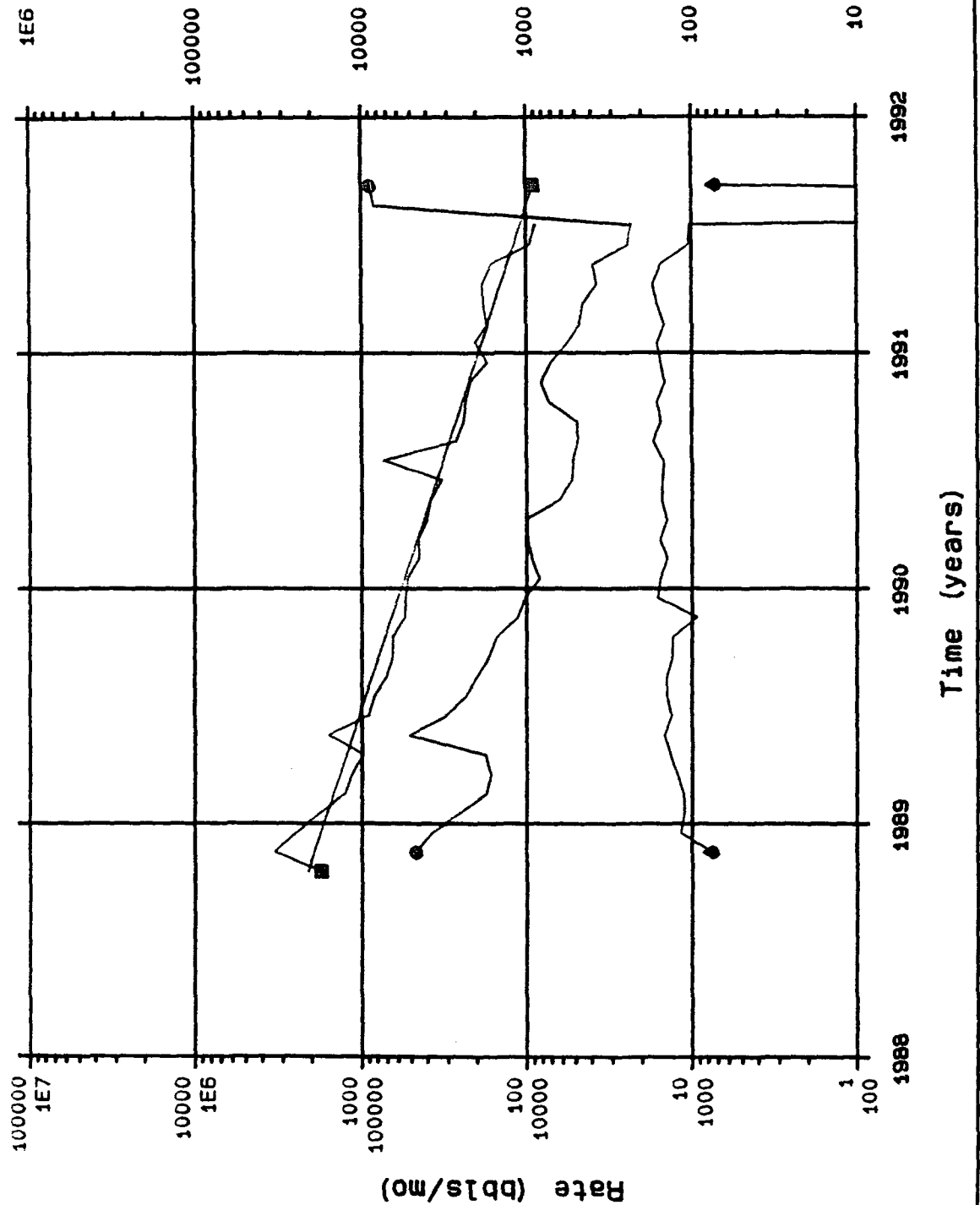

**B.P. PATERNOSTRO**  
**Multiphase Curve Analysis**  
**Rate vs Time**  
(c) 1990 Softsearch, Inc

**KRITI ST 31 #1**  
**UPPER WOLFCAMP SAND**  
**PRODUCTION FIT**

6/03/1992

Project: KRITI ST#1-MOL

**Production Curves**

OIL: ■ OIL DATA  
 0 History 10/91 - 4/92  
 1 Hyperbolic 10/91 - 4/92  
 Q1 : 1433.747 BBL/M  
 D1 : 56.261 %  
 n : 0.811  
 Qe : 830.317 BBL/M  
 De : 44.562 %  
 Np : 7.575 MBBL

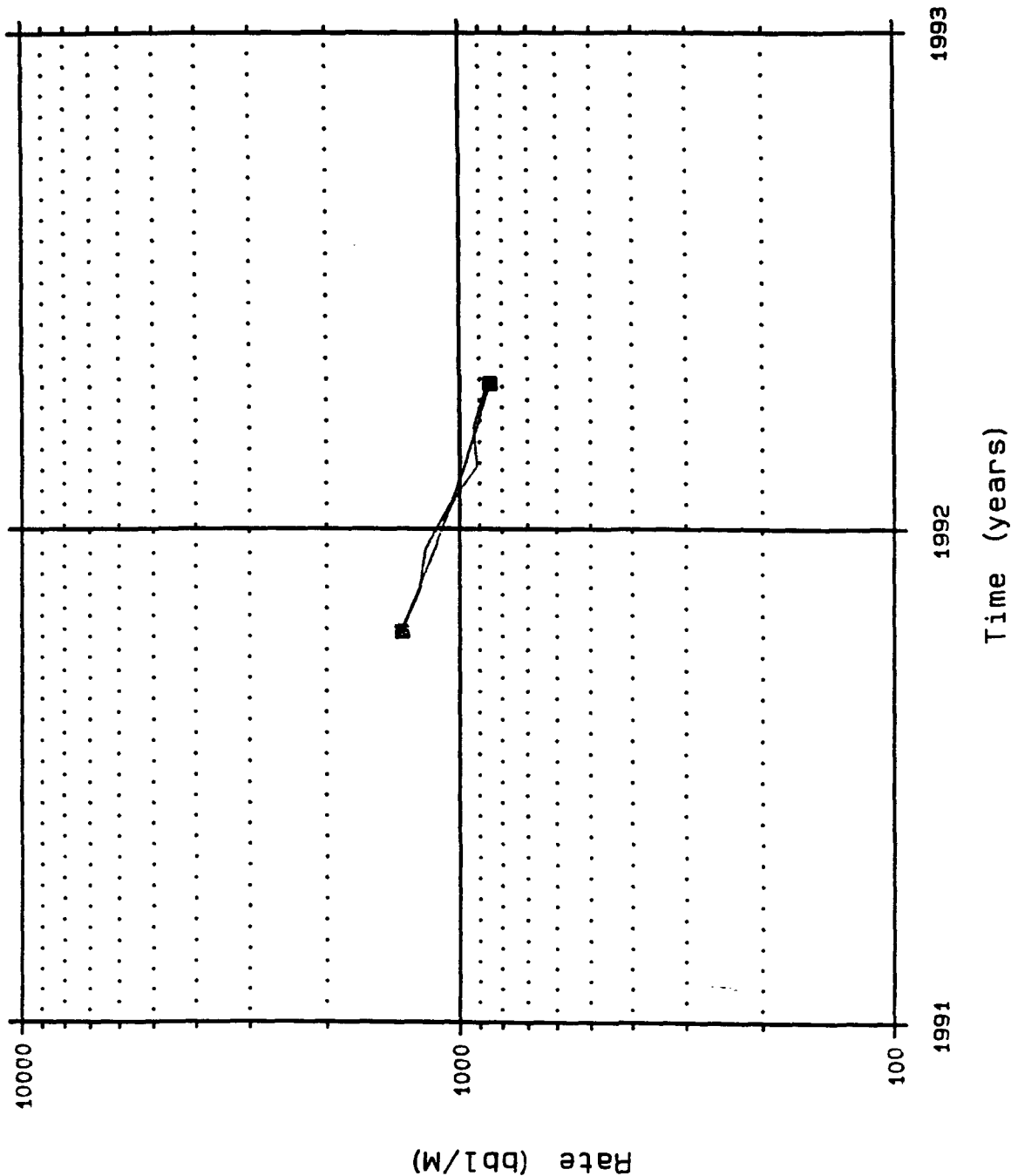

1993

1992

1991

THIS DRAWING AND ALL INFORMATION THEREON IS THE PROPERTY OF MOBIL PRODUCING TEXAS & NEW MEXICO INC. AND SHALL NOT BE COPIED OR USED EXCEPT FOR THE PURPOSE FOR WHICH IT IS EXPRESSLY FURNISHED. THE DRAWING AND ANY COPIES THEREON (PARTIAL OR COMPLETE) SHALL BE RETURNED TO THE OWNER ON DEMAND.

Petrus	Maralo	Major, etal	Major, etal
Payne 24	State K-33	Mobil-St. 30	29 State
Petrus 25	Texaco	J. L. Hamon, etal 31	32 Yates Petr., etal
		Exxon	H. E. Yates
State Yates	J. L. Hamon Kriti Expl.		
State	Kriti State 31	State	State
Texaco 36	Amoco (Mobil)	Mobil 6	5 Turner
Lovington Deep State	Lovington Deep Amoco State	"V"	"D"

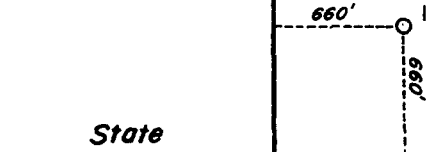

Reserve \_\_\_\_\_ Permit Depth \_\_\_\_\_

Special Instructions \_\_\_\_\_

THE STATE OF TEXAS  
COUNTY OF Midland

I hereby certify that this plat truly represents conditions as they actually exist on this lease; that said plat which is drawn to the scale indicated hereon, is to the best of my knowledge true and correct; that it accurately shows said lease with all wells on same; that number and locations of said wells are as indicated hereon; and that this plat correctly reflects all pertinent and required data.

Mobil Producing Texas & New Mexico Inc.  
Midland Division

LEASE Kriti State 31

WELL NO. 1 DATE \_\_\_\_\_ 19\_\_\_\_

LEASE NO. \_\_\_\_\_

TOTAL ACRES IN LEASE 154.73 ACRES COVERED BY PLAT 154.73

DESCRIPTION SW 1/4 of Sec. 31, T-16-S, R-36-E

5 Miles SW of Lovington, N.W.

Lea County, New Mexico

DRAWN ARH  
SCALE 1"=1000'

DATE 2-16-89  
FILE NO. 36

FIELD Shoe Bar, South  
WOLFCAMP