

ABOVE THIS LINE FOR DIVISION USE ONLY

NEW MEXICO OIL CONSERVATION DIVISION
- Engineering Bureau -
1220 South St. Francis Drive, Santa Fe, NM 87505



ADMINISTRATIVE APPLICATION CHECKLIST

THIS CHECKLIST IS MANDATORY FOR ALL ADMINISTRATIVE APPLICATIONS FOR EXCEPTIONS TO DIVISION RULES AND REGULATIONS WHICH REQUIRE PROCESSING AT THE DIVISION LEVEL IN SANTA FE

Application Acronyms:

[NSL-Non-Standard Location] [NSP-Non-Standard Proration Unit] [SD-Simultaneous Dedication]
[DHC-Downhole Commingling] [CTB-Lease Commingling] [PLC-Pool/Lease Commingling]
[PC-Pool Commingling] [OLS - Off-Lease Storage] [OLM-Off-Lease Measurement]
[WFX-Waterflood Expansion] [PMX-Pressure Maintenance Expansion]
[SWD-Salt Water Disposal] [IPI-Injection Pressure Increase]
[EOR-Qualified Enhanced Oil Recovery Certification] [PPR-Positive Production Response]

[1] **TYPE OF APPLICATION** - Check Those Which Apply for [A]

[A] Location - Spacing Unit - Simultaneous Dedication
☒ NSL ☐ NSP ☐ SD

Check One Only for [B] or [C]

[B] Commingling - Storage - Measurement
☐ DHC ☐ CTB ☐ PLC ☐ PC ☐ OLS ☐ OLM

[C] Injection - Disposal - Pressure Increase - Enhanced Oil Recovery
☐ WFX ☐ PMX ☐ SWD ☐ IPI ☐ EOR ☐ PPR

[D] Other: Specify _____

[2] **NOTIFICATION REQUIRED TO:** - Check Those Which Apply, or ☐ Does Not Apply

[A] ☐ Working, Royalty or Overriding Royalty Interest Owners

[B] ☐ Offset Operators, Leaseholders or Surface Owner

[C] ☐ Application is One Which Requires Published Legal Notice

[D] ☐ Notification and/or Concurrent Approval by BLM or SLO
U.S. Bureau of Land Management - Commissioner of Public Lands, State Land Office

[E] ☐ For all of the above, Proof of Notification or Publication is Attached, and/or,

[F] ☐ Waivers are Attached

[3] **SUBMIT ACCURATE AND COMPLETE INFORMATION REQUIRED TO PROCESS THE TYPE OF APPLICATION INDICATED ABOVE.**

[4] **CERTIFICATION:** I hereby certify that the information submitted with this application for administrative approval is accurate and complete to the best of my knowledge. I also understand that no action will be taken on this application until the required information and notifications are submitted to the Division.

Note: Statement must be completed by an individual with managerial and/or supervisory capacity.

Print or Type Name

Signature

Title

Date

e-mail Address

RECEIVED

APR 13 2005

March 31, 2005 CONSERVATION
DIVISION
New Mexico Oil Conservation Division
1220 South St. Francis Drive
Santa Fe, NM 87505

**RE: Melrose Operating Company, Non-Standard Locations on the Cone Jalmat Yates
Unit, Wells # 123 and # 124, Section 13, T22S, R35E, Lea County, New Mexico**

Concerning the above referenced operator and wells, we are respectfully requesting permission to drill these lease line wells located between the Melrose Operating Company Jalmat Yates Unit, with the southern unit boundary in the north half of Section 13, and the Cone Jalmat Yates Unit located in the south half of Section 13, T22S, R35E.

The well locations are as follows:

*Cone Jalmat Yates Unit #123: Section 13, T22S, R35E, 2630 FSL & 2460' FWL, Lea County
Cone Jalmat Yates Unit #124: Section 13, T22S, R35E, 2630 FSL & 1365' FEL, Lea County*

Melrose has drilled several 5-spot infill wells in the Jalmat Yates Sand Unit. The average reserves for this infill drilling are 60 MBO & 35 MMCF per well. Recently, three unit line wells were drilled with initial rates from 36 to 90 BOPD. Ultimate recovery on the Cone #123 & #124 is estimated to be 115 MBO and 67 MMCF in reserves that otherwise would not be recoverable.

Waterflooding commenced in these units in the mid 1960s on 40 acre well spacing with a 5-spot pattern. Due to various reservoir rock and fluid properties, poor horizontal seep efficiency can leave areas between the producing and injection wells with banked up, unswept, unrecoverable oil. This is physically demonstrated by the positive results of the new 20-acre infill wells and recent lease line wells which have proven effective and enhanced the value of the property.

Melrose has a long range plan to drill these units on 20 acre spacing and collapse the injection pattern to a 5 spot throughout. They have discussed future plans for the units with the Hobbs OCD office and provided them with a plan of continued reactivation. Melrose has already commenced spending money towards the goal of reactivating the waterfloods, drilling 5 wells with the last 90 days.

Melrose owns 100% of the working interest in each of the Units. The production will be monitored for the lease line wells by portable testing on a monthly basis to insure that the revenue from these wells will be allocated correctly and equitably between the two waterflood units.

Based on the success of recent wells in this area, it is evidence that there are oil & gas reserves that will not be drained without tighter wells spacing. It is therefore recommended that these lease line wells be approved to prevent waste and recover reserves that would not otherwise be recovered.

Yours truly,



Ann E. Ritchie, Regulatory Agent
Melrose Operating Company
c/o P.O. Box 953
Midland, TX 79702
432 684-6381; 432 682-1458-fax
ann.ritchie@wtor.net

Copy of request letter, C-101 & C-102 sent by certified mail to all interest owners.
Cc: Tony Beilman-Melrose/Midland; Michael Corjay-Melrose/Oklahoma City, OK

District I
1625 N. Ranch Dr., Hobbs, N.M. 88240
District II
1301 W. Grand Ave., Artesia, N.M. 88210
District III
1000 Rio Brazos Rd., Aztec, N.M. 87410
District IV
1220 S. St. Francis Dr., Santa Fe, N.M. 87505

State of New Mexico
Energy, Minerals & Natural Resources Department

OIL CONSERVATION DIVISION
1220 S. St. Francis Dr.
Santa Fe, NM 87505

Form C-101

Revised February 10, 1994

Instructions on back

Submit to Appropriate District Office

State Lease - 6 Copies

Fee lease - 5 Copies

☐ AMENDED REPORT

APPLICATION FOR PERMIT TO DRILL, RE - ENTER, DEEPEN, PLUGBACK, OR ADD A ZONE

¹ Operator Name and Address Melrose Operating Co. c/o P.O. Box 953 Midland, TX 79702		² OGRID Number 184860
		³ API Number 30-0 25
⁴ Property Code 14576	⁵ Property Name Cone Jalmat Yates Pool Unit	⁶ Well No. 123

7 Surface Location

UL or Lot No.	Section	Township	Range	Lot Idn	Feet from the	North/South line	Feet from the	East/West line	County
K	13	22S	35E		2630'	South	2460'	West	Lea

8. Proposed Bottom Hole Location If Different From Surface

UL or Lot No.	Section	Township	Range	Lot Idn	Feet from the	North/South line	Feet from the	East/West line	County

9. Proposed Pool 1
Jalmat (T-Y-7R)

10. Proposed Pool 2

11. Work Type Code N	12. Well Type Code O	13. Cable/Rotary R	14. Lease Type Code S	15. Ground Level Elevation 3582'
16. Multiple no	17. Proposed Depth 4200'	18. Formation Yates	19. Contractor United Drig.	20. Spud Date 3-27-05

21. Proposed Casing and Cement Program

Hole Size	Casing Size	Casing weight/foot	Setting Depth	Sacks of Cement	Estimated TOC
12 1/4"	8 5/8"	24#	350'	250 sx	surface
7 7/8"	5 1/2"	15.5#	4200'	1200 sx	surface

22. Describe the proposed program. If this is to DEEPEN or PLUG BACK give the data on the present productive zone and proposed new productive zone. Describe the blowout prevention program, if any. Use additional sheets if necessary.

Propose to drill 12 1/4" hole to 350', set 8 5/8" casing to 350', cement w/250 sx Cl C circulating to surface. Drill 7 7/8" hole to 4200', run open hole logs, set production string casing to TD, cementing w/1200 sx Cl C, circulating to surface. Will perforate and stimulate and test.

23. I hereby certify that the information given above is true and complete to the best of my knowledge and belief.
Signature: 

OIL CONSERVATION DIVISION

Approved by:

Title:

Approval Date:

Expiration Date:

Conditions of Approval:

Attached: ☐

Printed Name:

Ann E. Ritchie

Title:

Regulatory Agent

Date:

3-31-05

Phone:

432 684-6381

DISTRICT I

1625 N. FRENCH DR., HOBBBS, NM 88240

DISTRICT II

1301 W. GRAND AVENUE, ARTESIA, NM 88210

DISTRICT III

1000 Rio Brazos Rd., Aztec, NM 87410

DISTRICT IV

1220 S. ST. FRANCIS DR., SANTA FE, NM 87505

State of New Mexico

Energy, Minerals and Natural Resources Department

OIL CONSERVATION DIVISION

1220 SOUTH ST. FRANCIS DR.
Santa Fe, New Mexico 87505

Form C-102

Revised JUNE 10, 2003

Submit to Appropriate District Office

State Lease - 4 Copies

Fee Lease - 3 Copies

WELL LOCATION AND ACREAGE DEDICATION PLAT

☐ AMENDED REPORT

API Number <i>30-025-</i>	Pool Code <i>33820</i>	Pool Name <i>Jalmat (T-Y-7R)</i>
Property Code <i>14576</i>	Property Name <i>CONE Jalmat Yates Unit</i>	Well Number <i>123</i>
OGRID No. <i>184860</i>	Operator Name <i>MELROSE OPERATING COMPANY</i>	Elevation <i>3582'</i>

Surface Location

UL or lot No.	Section	Township	Range	Lot Idn	Feet from the	North/South line	Feet from the	East/West line	County
<i>K</i>	<i>13</i>	<i>22-S</i>	<i>35-E</i>		<i>2630</i>	<i>SOUTH</i>	<i>2460</i>	<i>WEST</i>	<i>LEA</i>

Bottom Hole Location If Different From Surface

UL or lot No.	Section	Township	Range	Lot Idn	Feet from the	North/South line	Feet from the	East/West line	County

Dedicated Acres <i>40</i>	Joint or Infill	Consolidation Code	Order No. <i>Water Flood Unit</i>
------------------------------	-----------------	--------------------	--------------------------------------

NO ALLOWABLE WILL BE ASSIGNED TO THIS COMPLETION UNTIL ALL INTERESTS HAVE BEEN CONSOLIDATED
OR A NON-STANDARD UNIT HAS BEEN APPROVED BY THE DIVISION

GEODETIC COORDINATES
NAD 27 NME

Y=507675.7 N
X=812375.9 E

LAT.=32°23'29.95" N
LONG.=103°19'16.86" W

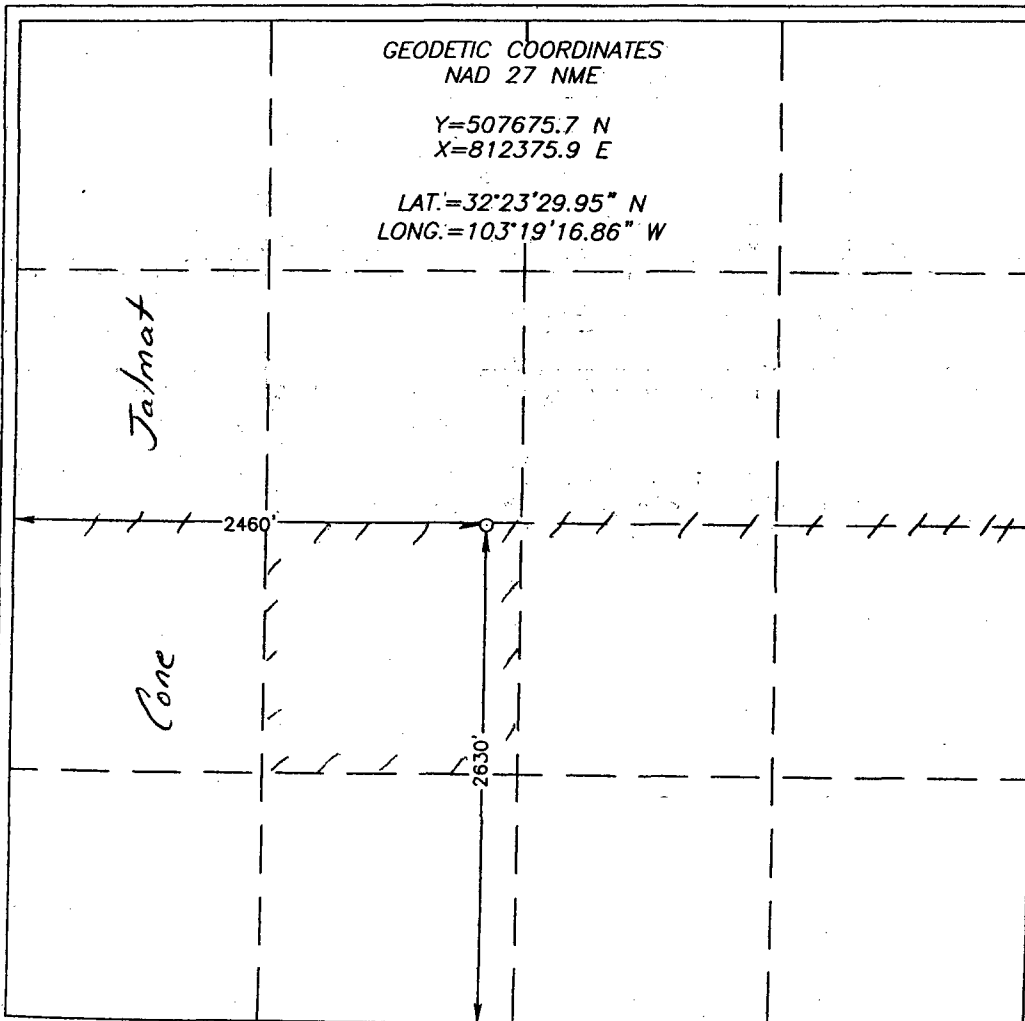

OPERATOR CERTIFICATION

I hereby certify the the information
contained herein is true and complete to the
best of my knowledge and belief.

[Signature]

Signature

Ann E. Ritchie

Printed Name

Regulatory Agent

Title

3-8-05

Date

SURVEYOR CERTIFICATION

I hereby certify that the well location shown
on this plat was plotted from field notes of
actual surveys made by me or under my
supervision, and that the same is true and
correct to the best of my belief.

FEBRUARY 18, 2005

Date Surveyed REV: 3/1/05 JR

[Signature]
Professional Surveyor

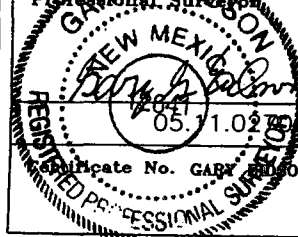

Certificate No. GARY SEIDSON

12641

LOCATION VERIFICATION MAP

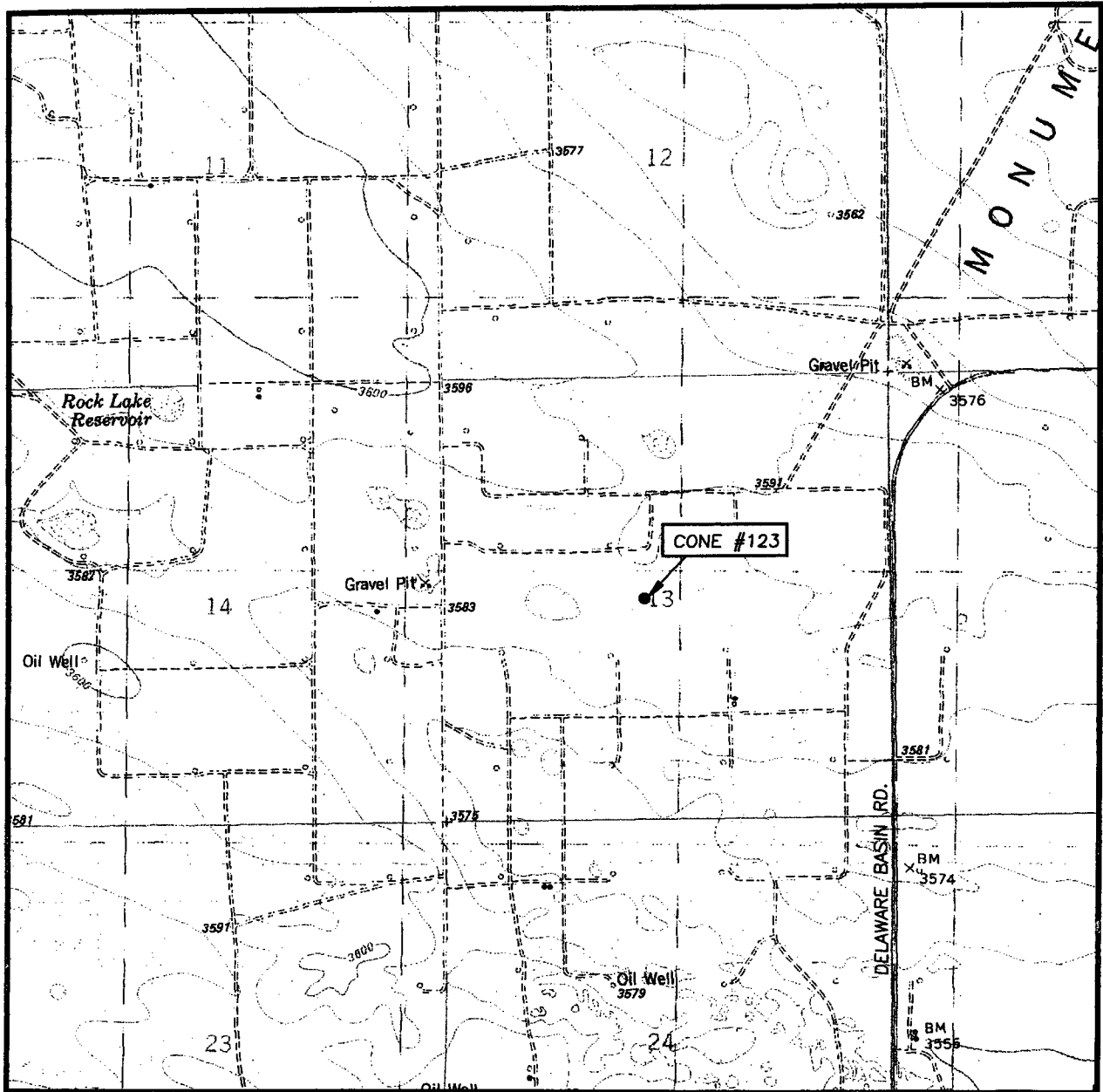

SCALE: 1" = 2000'

CONTOUR INTERVAL:
OIL CENTER, N.M. - 10'

SEC. 13 TWP. 22-S RGE. 35-E

SURVEY N.M.P.M.

COUNTY LEA

DESCRIPTION 2630' FSL & 2460' FWL

ELEVATION 3582'

OPERATOR MELROSE
OPERATING COMPANY

LEASE CONE

U.S.G.S. TOPOGRAPHIC MAP
OIL CENTER, N.M.

PROVIDING SURVEYING SERVICES
SINCE 1946
JOHN WEST SURVEYING COMPANY
412 N. DAL PASO
HOBBBS, N.M. 88240
(505) 383-3117

SECTION 13, TOWNSHIP 22 SOUTH, RANGE 35 EAST, N.M.P.M.,
 LEA COUNTY, NEW MEXICO

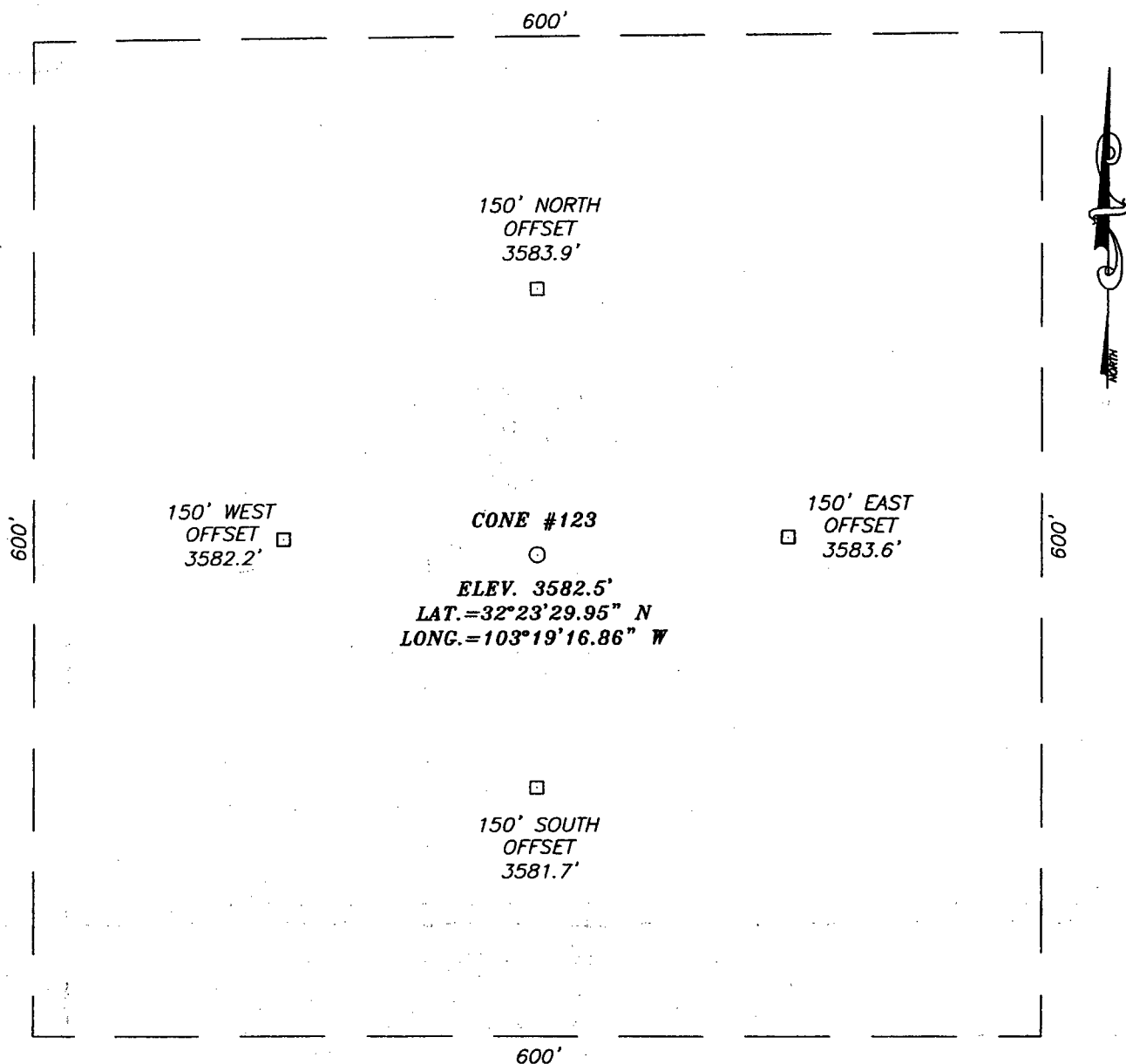

DIRECTIONS TO LOCATION

FROM THE INTERSECTION OF CO. RD. #21
 (DELAWARE BASIN RD.) AND WEAVER RD., GO
 WEST CO. RD. #21 FOR APPROX. 1.0 MILES.
 FOLLOW ROAD AND GO SOUTH APPROX. 0.8 MILES
 TO A CALICHE ROAD (LYNX RD.) ON THE RIGHT.
 TURN RIGHT (WEST) AND GO APPROX. 0.1 MILES.
 TURN RIGHT (NORTH) AND GO APPROX. 0.15
 MILES. TURN LEFT (WEST) AND GO APPROX. 0.15
 MILES TO A TWO-TRACK RD.. FOLLOW TWO-TRACK
 ROAD FOR APPROX. 0.1 MILES. THIS LOCATION IS
 APPROX. 800' WEST.

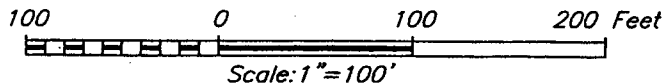

MELROSE OPERATING COMPANY

CONE #123 WELL
 LOCATED 2630 FEET FROM THE SOUTH LINE
 AND 2460 FEET FROM THE WEST LINE OF SECTION 13,
 TOWNSHIP 22 SOUTH, RANGE 35 EAST, N.M.P.M.,
 LEA COUNTY, NEW MEXICO.

Survey Date: 2/18/05	Sheet 1 of 1 Sheets
W.O. Number: 05.11.0270	Dr By: J.R.
Date: 2/22/05	Disk: CD#5
05110270	Scale: 1"=100'



PROVIDING SURVEYING SERVICES
 SINCE 1946
JOHN WEST SURVEYING COMPANY
 412 N. DAL PASO
 HOBBS, N.M. 88240
 (505) 393-3117

VICINITY MAP

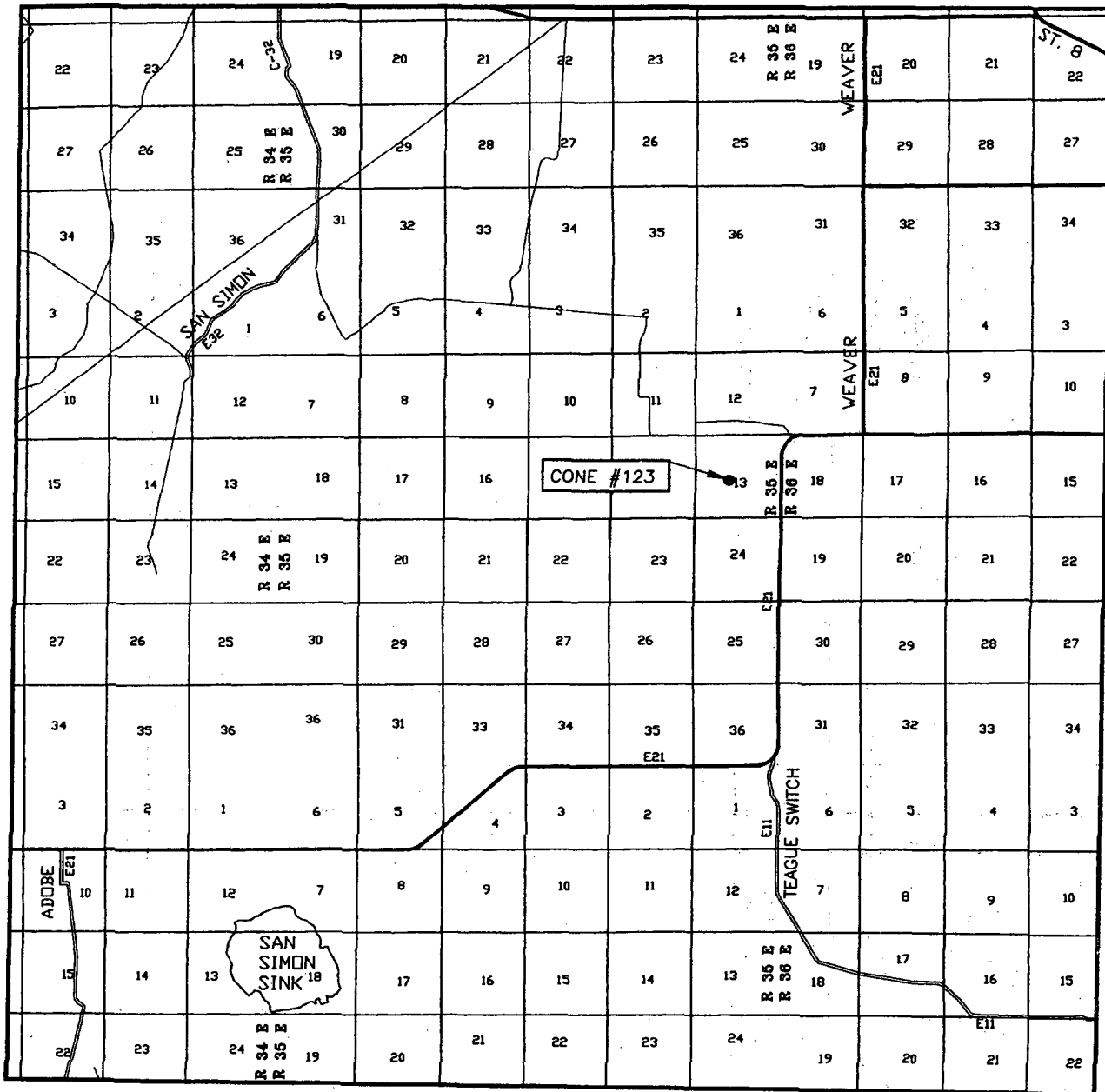

SCALE: 1" = 2 MILES

SEC. 13 TWP. 22-S RGE. 35-E

SURVEY N.M.P.M.

COUNTY LEA

DESCRIPTION 2630' FSL & 2460' FWL

ELEVATION 3582'

OPERATOR MELROSE OPERATING COMPANY

LEASE CONE

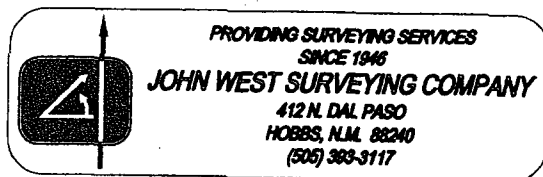

District I
1625 N. French Dr., Hobbs, N.M. 88240
District II
1301 W. Grand Ave., Artesia, N.M. 88210
District III
1000 Rio Brazos Rd., Aztec, N.M. 87410
District IV
1220 S. St. Francis Dr., Santa Fe, N.M. 87505

State of New Mexico
Energy, Minerals & Natural Resources Department

OIL CONSERVATION DIVISION
1220 S. St. Francis Dr.
Santa Fe, NM 87505

Form C-101
Revised February 10, 1994
Instructions on back
Submit to Appropriate District Office
State Lease - 6 Copies
Fee lease - 5 Copies

☐ AMENDED REPORT

APPLICATION FOR PERMIT TO DRILL, RE - ENTER, DEEPEN, PLUGBACK, OR ADD A ZONE

1 Operator Name and Address Melrose Operating Co. c/o P.O. Box 953 Midland, TX 79702		2 OGRID Number 184860
		3 API Number 30-0 25
4 Property Code 14576	5 Property Name Cone Jalmat Yates Pool Unit	6 Well No. 124

7 Surface Location

UL or Lot No.	Section	Township	Range	Lot Idn	Feet from the	North/South line	Feet from the	East/West line	County
J	13	22S	35E		2630'	South	1365'	East	Lea

8. Proposed Bottom Hole Location If Different From Surface

UL or Lot No.	Section	Township	Range	Lot Idn	Feet from the	North/South line	Feet from the	East/West line	County
9. Proposed Pool 1 Jalmat (T-Y-7R)					10. Proposed Pool 2				

11. Work Type Code N	12. Well Type Code O	13. Cable/Rotary R	14. Lease Type Code S	15. Ground Level Elevation 3586'
16. Multiple no	17. Proposed Depth 4200'	18. Formation Yates	19. Contractor United Drlg.	20. Spud Date 3-25-05

21. Proposed Casing and Cement Program

Hole Size	Casing Size	Casing weight/foot	Setting Depth	Sacks of Cement	Estimated TOC
12 1/4"	8 5/8"	24#	350'	250 sx	surface
7 7/8"	5 1/2"	15.5#	4200'	1200 sx	surface

22. Describe the proposed program. If this is to DEEPEN or PLUG BACK give the data on the present productive zone and proposed new productive zone. Describe the blowout prevention program, if any. Use additional sheets if necessary.

Propose to drill 12 1/4" hole to 350', set 8 5/8" casing to 350', cement w/250 sx CI C circulating to surface. Drill 7 7/8" hole to 4200', run open hole logs, set production string casing to TD, cementing w/1200 sx CI C, circulating to surface. Will perforate and stimulate and test.

23. I hereby certify that the information given above is true and complete to the best of my knowledge and belief.
Signature:

Printed Name: **Ann E. Ritchie**

Title: **Regulatory Agent**

Date: **3-31-05** Phone: **432 684-6381**

OIL CONSERVATION DIVISION

Approved by:

Title:

Approval Date:

Expiration Date:

Conditions of Approval:

Attached: ☐

DISTRICT I
1625 N. FRENCH DR., HOBBS, NM 88240

DISTRICT II
1301 W. GRAND AVENUE, ARTESIA, NM 88210

DISTRICT III
1000 Rio Brazos Rd., Aztec, NM 87410

DISTRICT IV
1220 S. ST. FRANCIS DR., SANTA FE, NM 87505

State of New Mexico
Energy, Minerals and Natural Resources Department

OIL CONSERVATION DIVISION
1220 SOUTH ST. FRANCIS DR.
Santa Fe, New Mexico 87505

Form C-102
Revised JUNE 10, 2003
Submit to Appropriate District Office
State Lease - 4 Copies
Fee Lease - 3 Copies

WELL LOCATION AND ACREAGE DEDICATION PLAT

☐ AMENDED REPORT

API Number 30-025-	Pool Code 33820	Pool Name Jalmat (T-Y-7R)
Property Code 14576	Property Name CONE Jalmat Yates Unit	Well Number 124
GRID No.	Operator Name MELROSE OPERATING COMPANY	Elevation 3586'

Surface Location

UL or lot No.	Section	Township	Range	Lot Idn	Feet from the	North/South line	Feet from the	East/West line	County
J	13	22-S	35-E		2630	SOUTH	1365	EAST	LEA

Bottom Hole Location If Different From Surface

UL or lot No.	Section	Township	Range	Lot Idn	Feet from the	North/South line	Feet from the	East/West line	County
Dedicated Acres 40	Joint or Infill	Consolidation Code	Order No. Water Flood Unit						

NO ALLOWABLE WILL BE ASSIGNED TO THIS COMPLETION UNTIL ALL INTERESTS HAVE BEEN CONSOLIDATED
OR A NON-STANDARD UNIT HAS BEEN APPROVED BY THE DIVISION

GEODETIC COORDINATES
NAD 27 NME

Y=507695.2 N
X=813833.8 E

LAT.=32°23'30.00" N
LONG.=103°18'59.85" W

OPERATOR CERTIFICATION

I hereby certify the the information
contained herein is true and complete to the
best of my knowledge and belief.

Signature

Ann E. Ritchie

Printed Name

Regulatory Agent

Title

3-8-05

Date

SURVEYOR CERTIFICATION

I hereby certify that the well location shown
on this plat was plotted from field notes of
actual surveys made by me or under my
supervision, and that the same is true and
correct to the best of my belief.

FEBRUARY 18, 2005

Date Surveyed REV: 3/1/05 JR

Signature

Professional Surveyor

GARY EDISON
3/2/05

GARY EDISON
05.11.02

State No. GARY EDISON

12841

LOCATION VERIFICATION MAP

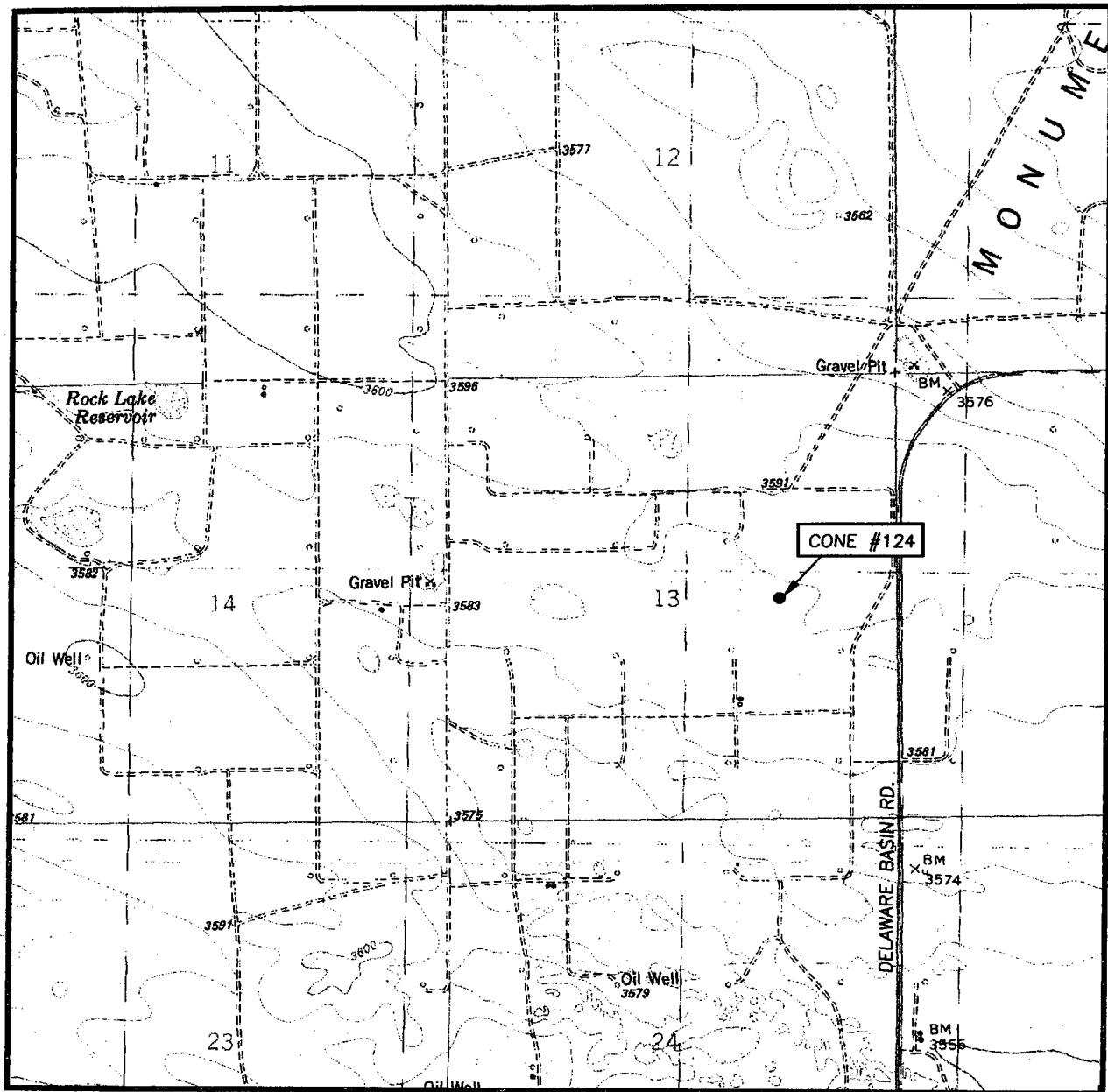

SCALE: 1" = 2000'

CONTOUR INTERVAL:
OIL CENTER, N.M. - 10'

SEC. 13 TWP. 22-S RGE. 35-E

SURVEY N.M.P.M.

COUNTY LEA

DESCRIPTION 2630' FSL & 1365' FEL

ELEVATION 3586'

OPERATOR MELROSE
OPERATING COMPANY

LEASE CONE

U.S.G.S. TOPOGRAPHIC MAP
OIL CENTER, N.M.

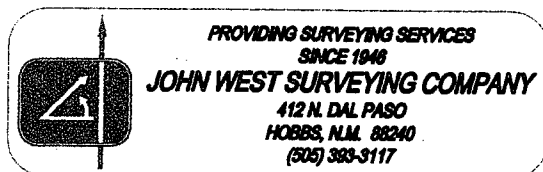

SECTION 13, TOWNSHIP 22 SOUTH, RANGE 35 EAST, N.M.P.M.,
 LEA COUNTY, NEW MEXICO

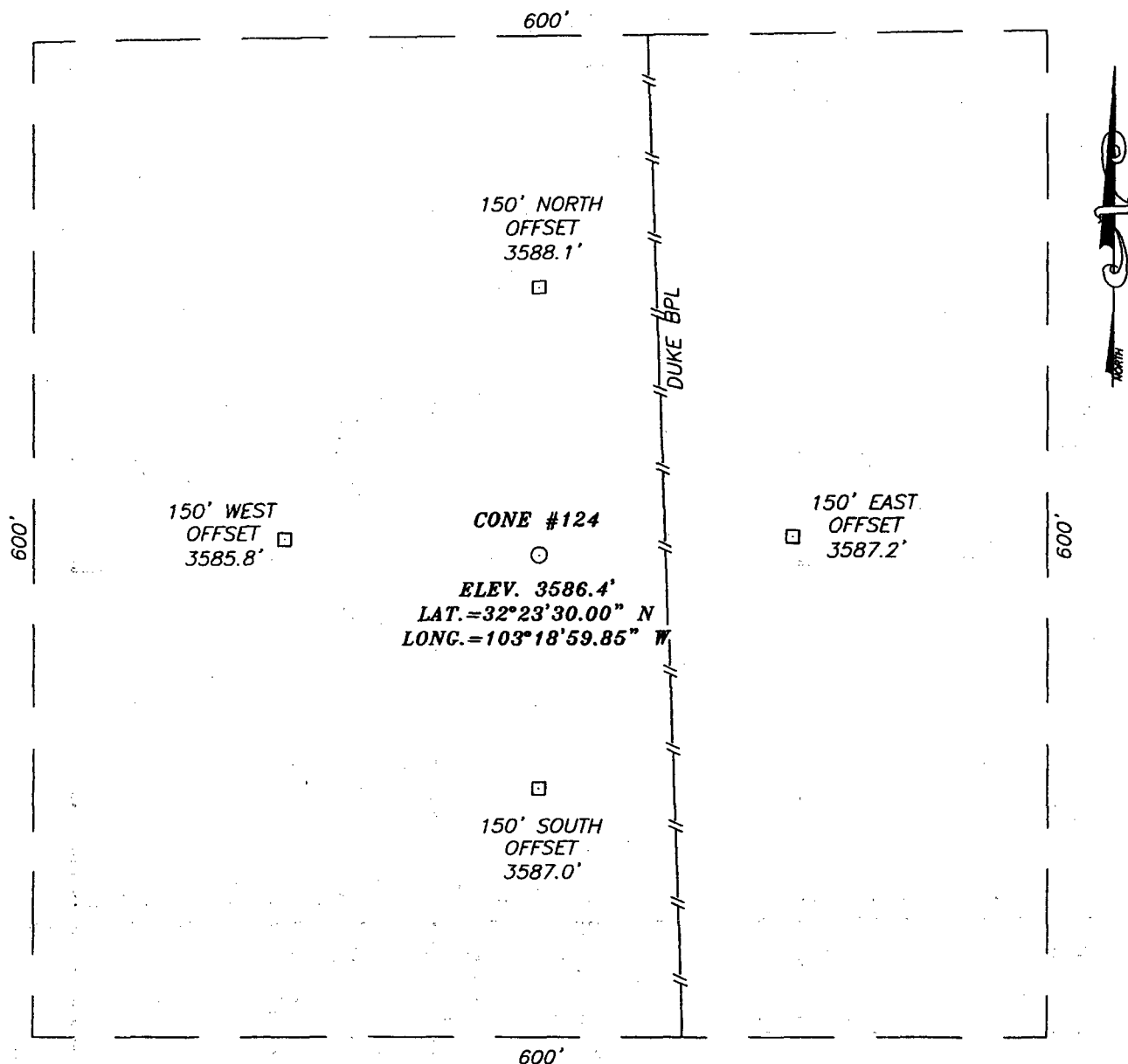

DIRECTIONS TO LOCATION

FROM THE INTERSECTION OF CO. RD. #21
 (DELAWARE BASIN RD.) AND WEAVER RD., GO
 WEST CO. RD. #21 FOR APPROX. 1.0 MILES.
 FOLLOW ROAD AND GO SOUTH APPROX. 0.8 MILES
 TO A CALICHE ROAD (LYNX RD.) ON THE RIGHT.
 TURN RIGHT (WEST) AND GO APPROX. 0.1 MILES.
 TURN RIGHT (NORTH) AND GO APPROX. 0.25
 MILES. THIS LOCATION IS APPROX. 800' NW.

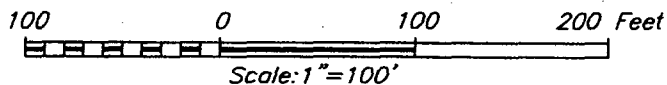

MELROSE OPERATING COMPANY

CONE #124 WELL
 LOCATED 2630 FEET FROM THE SOUTH LINE
 AND 1365 FEET FROM THE EAST LINE OF SECTION 13,
 TOWNSHIP 22 SOUTH, RANGE 35 EAST, N.M.P.M.,
 LEA COUNTY, NEW MEXICO.

Survey Date: 2/18/05	Sheet 1 of 1 Sheets
W.O. Number: 05.11.0271	Dr By: J.R.
Date: 2/22/05	Rev 1:3/1/05
Disk: CD#5	05110271
	Scale: 1"=100'

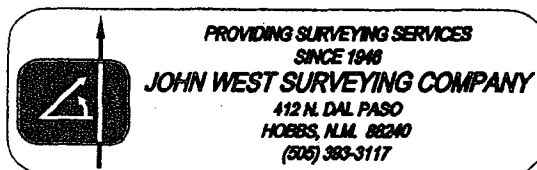

VICINITY MAP

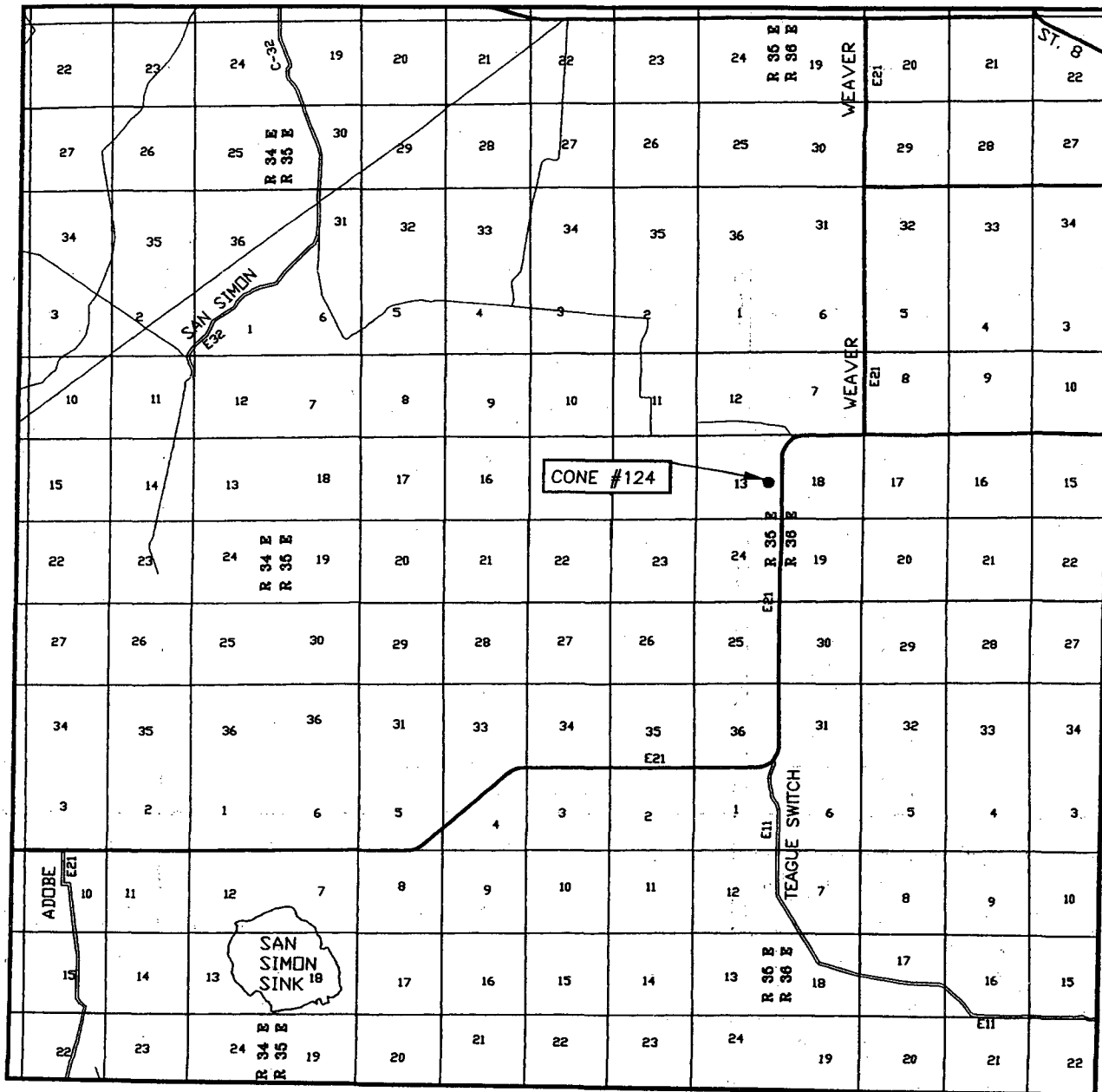

SCALE: 1" = 2 MILES

SEC. 13 TWP. 22-S RGE. 35-E

SURVEY N.M.P.M.

COUNTY LEA

DESCRIPTION 2630' FSL & 1365' FEL

ELEVATION 3586'

OPERATOR MELROSE OPERATING COMPANY

LEASE CONE

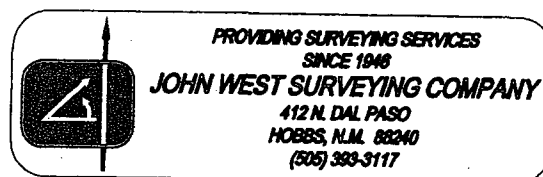

U.S. Postal Service
CERTIFIED MAIL RECEIPT
(Domestic Mail Only; No Insurance Coverage Provided)

ARTESIA, NM 88211-0840

Postage \$.3737
Certified Fee 2.3030
Return Receipt Fee (Endorsement Required) 1.7575
Restricted Delivery Fee (Endorsement Required)
Total Postage & Fees \$ 4.4242

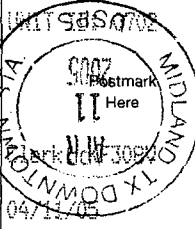

Recipient's Name (Please Print Clearly) (to be completed by mailer)

SHARBRO OIL LTD. CO.

Street, Apt. No., or PO Box No.

Box 840

City, State, ZIP+4

ARTESIA, NM 88211-0840

PS Form 3800, February 2000

See Reverse for Instructions

U.S. Postal Service
CERTIFIED MAIL RECEIPT
(Domestic Mail Only; No Insurance Coverage Provided)

FREEPORT, TX 77541

Postage \$.3737
Certified Fee 2.3030
Return Receipt Fee (Endorsement Required) 1.7575
Restricted Delivery Fee (Endorsement Required)
Total Postage & Fees \$ 4.4242

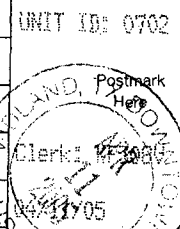

Recipient's Name (Please Print Clearly) (to be completed by mailer)

LOUIS H. MAZZA

Street, Apt. No., or PO Box No.

3029 County Rd. 476A

City, State, ZIP+4

FREEPORT, TX 77541

PS Form 3800, February 2000

See Reverse for Instructions

U.S. Postal Service
CERTIFIED MAIL RECEIPT
(Domestic Mail Only; No Insurance Coverage Provided)

DALLAS, TX 75391-0833

Postage \$.3737
Certified Fee 2.3030
Return Receipt Fee (Endorsement Required) 1.7575
Restricted Delivery Fee (Endorsement Required)
Total Postage & Fees \$ 4.4242

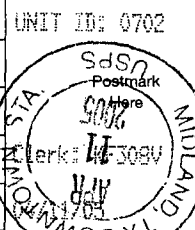

Recipient's Name (Please Print Clearly) (to be completed by mailer)

S. HIRAM

Street, Apt. No., or PO Box No.

Box 910833

City, State, ZIP+4

DALLAS, TX 75391-0833

PS Form 3800, February 2000

See Reverse for Instructions

U.S. Postal Service
CERTIFIED MAIL RECEIPT
(Domestic Mail Only; No Insurance Coverage Provided)

CORRALES, NM 87048-1427

Postage \$.3737
Certified Fee 2.3030
Return Receipt Fee (Endorsement Required) 1.7575
Restricted Delivery Fee (Endorsement Required)
Total Postage & Fees \$ 4.4242

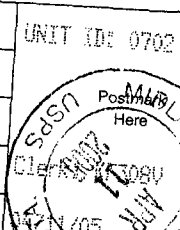

Recipient's Name (Please Print Clearly) (to be completed by mailer)

SHAWNAN LYNN UNZER

Street, Apt. No., or PO Box No.

Box 1427

City, State, ZIP+4

CORRALES, NM 87048-1427

PS Form 3800, February 2000

See Reverse for Instructions

U.S. Postal Service
CERTIFIED MAIL RECEIPT
(Domestic Mail Only; No Insurance Coverage Provided)

HOUSTON, TX 77019-5898

Postage \$.3737
Certified Fee 2.3030
Return Receipt Fee (Endorsement Required) 1.7575
Restricted Delivery Fee (Endorsement Required)
Total Postage & Fees \$ 4.4242

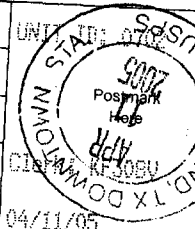

Recipient's Name (Please Print Clearly) (to be completed by mailer)

ST John The Deviser / Epis. Church

Street, Apt. No., or PO Box No.

2450 RIVER OAKS Blvd/Mem End Fund

City, State, ZIP+4

HOUSTON, TX 77019-5898

PS Form 3800, February 2000

See Reverse for Instructions

U.S. Postal Service
CERTIFIED MAIL RECEIPT
(Domestic Mail Only; No Insurance Coverage Provided)

ALBUQUERQUE, NM 87102

Postage \$.3737
Certified Fee 2.3030
Return Receipt Fee (Endorsement Required) 1.7575
Restricted Delivery Fee (Endorsement Required)
Total Postage & Fees \$ 4.4242



Recipient's Name (Please Print Clearly) (to be completed by mailer)

KELLY SAMANTHA LANGLEY KEU TR

Street, Apt. No., or PO Box No.

500 MARQUETTE NW STE 400

City, State, ZIP+4

ALBUQUERQUE, NM 87102

PS Form 3800, February 2000

See Reverse for Instructions

U.S. Postal Service CERTIFIED MAIL RECEIPT (Domestic Mail Only; No Insurance Coverage Provided)

SAN ANTONIO, TX 78296-1600

Postage	\$.370.37	UNIT ID: 0702
Certified Fee	2.30	
Return Receipt Fee (Endorsement Required)	1.75	
Restricted Delivery Fee (Endorsement Required)		
Total Postage & Fees	\$ 4.4242	

Recipient's Name (Please Print Clearly) (to be completed by mailer)
Richard G. Huel Jr. #4422 / Frost Nat'l BC Jntn
 Street, Apt. No., or PO Box No.
 P.O. Box 1600
 City, State, ZIP+4
San Antonio, TX 78296-1600
 PS Form 3800, February 2000 See Reverse for Instructions

U.S. Postal Service CERTIFIED MAIL RECEIPT (Domestic Mail Only; No Insurance Coverage Provided)

ARRESTA, NM 98211-0840

Postage	\$.37.37
Certified Fee	2.30.30
Return Receipt Fee (Endorsement Required)	1.75.75
Restricted Delivery Fee (Endorsement Required)	
Total Postage & Fees	\$ 4.4242

UNIT ID: 0702
 MIDLAND, TX DOWNTOWN STA
 Postmark Here
 APR 11 2005
 Clerk: KF308V
 04/11/05

Recipient's Name (Please Print Clearly) (to be completed by mailer)
LILLIE M. YATES ESTATE / SP YATES
 Street, Apt. No., or PO Box No.
 Box 840
 City, State, ZIP+4
ARRESTA, NM 98211-0840
 PS Form 3800, February 2000 See Reverse for Instructions

U.S. Postal Service CERTIFIED MAIL RECEIPT (Domestic Mail Only; No Insurance Coverage Provided)

MIDLAND, TX 79701-4121

Postage	\$.37.37	UNIT ID: 0702
Certified Fee	2.30.30	
Return Receipt Fee (Endorsement Required)	1.75.75	
Restricted Delivery Fee (Endorsement Required)		
Total Postage & Fees	\$ 4.4242	

UNIT ID: 0702
 MIDLAND, TX DOWNTOWN STA
 Postmark Here
 APR 11 2005
 Clerk: KF308V
 04/11/05

Recipient's Name (Please Print Clearly) (to be completed by mailer)
DANIEL L. VEIKS DBA
 Street, Apt. No., or PO Box No.
 1309 W. Cuthbert Ave.
 City, State, ZIP+4
Midland, TX 79701-4121
 PS Form 3800, February 2000 See Reverse for Instructions

U.S. Postal Service CERTIFIED MAIL RECEIPT (Domestic Mail Only; No Insurance Coverage Provided)

MIDLAND, TX 79702-0430

Postage	\$.37.37
Certified Fee	2.30.30
Return Receipt Fee (Endorsement Required)	1.75.75
Restricted Delivery Fee (Endorsement Required)	
Total Postage & Fees	\$ 4.4242

UNIT ID: 0702
 MIDLAND, TX DOWNTOWN STA
 Postmark Here
 APR 11 2005
 Clerk: KF308V
 04/11/05

Recipient's Name (Please Print Clearly) (to be completed by mailer)
ABELL HANGAR Foundation
 Street, Apt. No., or PO Box No.
 Box 430
 City, State, ZIP+4
Midland, TX 79702-0430
 PS Form 3800, February 2000 See Reverse for Instructions

U.S. Postal Service CERTIFIED MAIL RECEIPT (Domestic Mail Only; No Insurance Coverage Provided)

FAYETTEVILLE, AR 72702-1785

Postage	\$.37.37	UNIT ID: 0702
Certified Fee	2.30.30	
Return Receipt Fee (Endorsement Required)	1.75.75	
Restricted Delivery Fee (Endorsement Required)		
Total Postage & Fees	\$ 4.4242	

UNIT ID: 0702
 MIDLAND, TX DOWNTOWN STA
 Postmark Here
 APR 11 2005
 Clerk: KF308V
 04/11/05

Recipient's Name (Please Print Clearly) (to be completed by mailer)
Virginia Ann Coogan
 Street, Apt. No., or PO Box No.
 Box 1785
 City, State, ZIP+4
FAYETTEVILLE, AR 72702-1785
 PS Form 3800, February 2000 See Reverse for Instructions

U.S. Postal Service CERTIFIED MAIL RECEIPT (Domestic Mail Only; No Insurance Coverage Provided)

SEBRING, FL 33871-4433

Postage	\$.37.37
Certified Fee	2.30.30
Return Receipt Fee (Endorsement Required)	1.75.75
Restricted Delivery Fee (Endorsement Required)	
Total Postage & Fees	\$ 4.4242

UNIT ID: 0702
 MIDLAND, TX DOWNTOWN STA
 Postmark Here
 APR 11 2005
 Clerk: KF308V
 04/11/05

Recipient's Name (Please Print Clearly) (to be completed by mailer)
Patrick Francoeur 40 LEA County Court House
 Street, Apt. No., or PO Box No.
 Box 4433
 City, State, ZIP+4
SEBRING, FL 33871-4433
 PS Form 3800, February 2000 See Reverse for Instructions

U.S. Postal Service
CERTIFIED MAIL RECEIPT
(Domestic Mail Only; No Insurance Coverage Provided)

TULSA, OK 74136

Postage \$.37³⁷
Certified Fee 2.30³⁰
Return Receipt Fee (Endorsement Required) 1.75⁷⁵
Restricted Delivery Fee (Endorsement Required)
Total Postage & Fees \$ 4.42⁴²

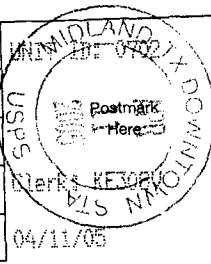

Recipient's Name (Please Print Clearly) (to be completed by mailer)
Mark P. Hoken Revocable TR
Street, Apt. No., or PO Box No.
7928 S. Hudson Place
City, State, ZIP+4
Tulsa, OK 74136
PS Form 3800, February 2000 See Reverse for Instructions

U.S. Postal Service
CERTIFIED MAIL RECEIPT
(Domestic Mail Only; No Insurance Coverage Provided)

MIDLAND, TX 79702-7666

Postage \$.37³⁷
Certified Fee 2.30³⁰
Return Receipt Fee (Endorsement Required) 1.75⁷⁵
Restricted Delivery Fee (Endorsement Required)
Total Postage & Fees \$ 4.42⁴²

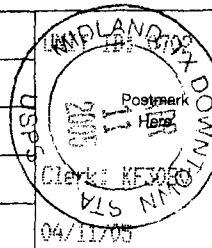

Recipient's Name (Please Print Clearly) (to be completed by mailer)
Charles L. Hae
Street, Apt. No., or PO Box No.
Box 10666
City, State, ZIP+4
Midland TX 79702-7666
PS Form 3800, February 2000 See Reverse for Instructions

U.S. Postal Service
CERTIFIED MAIL RECEIPT
(Domestic Mail Only; No Insurance Coverage Provided)

AMARILLO, TX 79174-0001

Postage \$.37³⁷
Certified Fee 2.30³⁰
Return Receipt Fee (Endorsement Required) 1.75⁷⁵
Restricted Delivery Fee (Endorsement Required)
Total Postage & Fees \$ 4.42⁴²

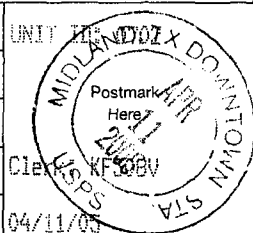

Recipient's Name (Please Print Clearly) (to be completed by mailer)
CAL FARM Boys Ranch
Street, Apt. No., or PO Box No.
Box 1890
City, State, ZIP+4
Amarillo, TX 79174-0001
PS Form 3800, February 2000 See Reverse for Instructions

U.S. Postal Service
CERTIFIED MAIL RECEIPT
(Domestic Mail Only; No Insurance Coverage Provided)

OAKLAND, CA 94611-5127

Postage \$.37³⁷
Certified Fee 2.30³⁰
Return Receipt Fee (Endorsement Required) 1.75⁷⁵
Restricted Delivery Fee (Endorsement Required)
Total Postage & Fees \$ 4.42⁴²

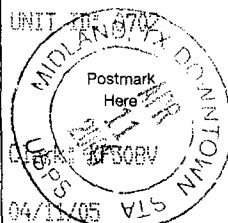

Recipient's Name (Please Print Clearly) (to be completed by mailer)
KATHRYN RAE BRANDENBURG
Street, Apt. No., or PO Box No.
4243 TERRACE ST.
City, State, ZIP+4
Oakland, CA 94611-5127
PS Form 3800, February 2000 See Reverse for Instructions

U.S. Postal Service
CERTIFIED MAIL RECEIPT
(Domestic Mail Only; No Insurance Coverage Provided)

FORT WORTH, TX 76199

Postage \$.37³⁷
Certified Fee 2.30³⁰
Return Receipt Fee (Endorsement Required) 1.75⁷⁵
Restricted Delivery Fee (Endorsement Required)
Total Postage & Fees \$ 4.42⁴²

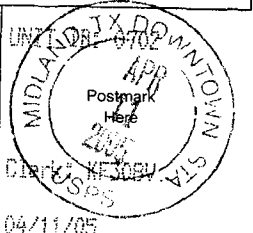

Recipient's Name (Please Print Clearly) (to be completed by mailer)
Fortson Oil Co. Cg + Chem
Street, Apt. No., or PO Box No.
Box 99084
City, State, ZIP+4
Fort Worth, TX 76199
PS Form 3800, February 2000 See Reverse for Instructions

U.S. Postal Service
CERTIFIED MAIL RECEIPT
(Domestic Mail Only; No Insurance Coverage Provided)

OKLAHOMA CITY, OK 73102

Postage \$.37³⁷
Certified Fee 2.30³⁰
Return Receipt Fee (Endorsement Required) 1.75⁷⁵
Restricted Delivery Fee (Endorsement Required)
Total Postage & Fees \$ 4.42⁴²

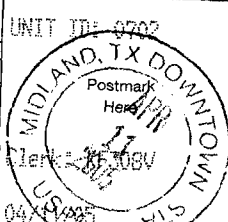

Recipient's Name (Please Print Clearly) (to be completed by mailer)
MA-Pop-Net An OKLA Rem Partnership
Street, Apt. No., or PO Box No.
100 Park Ave, Ste. 1008
City, State, ZIP+4
Oklahoma City, OK 73102
PS Form 3800, February 2000 See Reverse for Instructions

U.S. Postal Service
CERTIFIED MAIL RECEIPT
(Domestic Mail Only; No Insurance Coverage Provided)

ROSWELL, NM 88202

Postage	\$.37 ³⁷
Certified Fee	2.30 ³⁰
Return Receipt Fee (Endorsement Required)	1.75 ¹⁷⁵
Restricted Delivery Fee (Endorsement Required)	
Total Postage & Fees	\$ 4.42⁴²

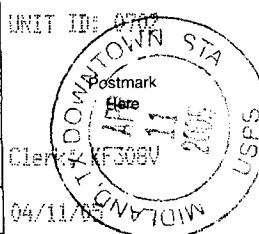

Recipient's Name (Please Print Clearly) (to be completed by mailer)
BOLING ENTERPRISES, LTD.
Street, Apt. No., or PO Box No. **ROBERT MICHAEL BOLING MANAGER**
Box 2563
City, State, ZIP+4
ROSWELL, NM 88202
PS Form 3800, February 2000 See Reverse for Instructions

U.S. Postal Service
CERTIFIED MAIL RECEIPT
(Domestic Mail Only; No Insurance Coverage Provided)

MIDLAND, TX 79710

Postage	\$.37 ³⁷
Certified Fee	2.30 ³⁰
Return Receipt Fee (Endorsement Required)	1.75 ¹⁷⁵
Restricted Delivery Fee (Endorsement Required)	
Total Postage & Fees	\$ 4.42⁴²

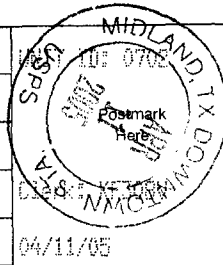

Recipient's Name (Please Print Clearly) (to be completed by mailer)
DEBRA J. Hamilton
Street, Apt. No., or PO Box No.
Box 51988
City, State, ZIP+4
Midland, TX 79710
PS Form 3800, February 2000 See Reverse for Instructions

U.S. Postal Service
CERTIFIED MAIL RECEIPT
(Domestic Mail Only; No Insurance Coverage Provided)

NORTH RICHLAND HILLS, TX 76182-1011

Postage	\$.37 ³⁷
Certified Fee	2.30 ³⁰
Return Receipt Fee (Endorsement Required)	1.75 ¹⁷⁵
Restricted Delivery Fee (Endorsement Required)	
Total Postage & Fees	\$ 4.42⁴²

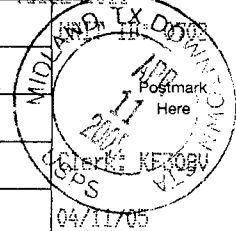

Recipient's Name (Please Print Clearly) (to be completed by mailer)
RANDEL MARITAL TRUST w/w/o Ralph M. Randel
Street, Apt. No., or PO Box No. **Clifford M. Randel Trustee**
Box 821011
City, State, ZIP+4
North Richland Hills, TX 76182
PS Form 3800, February 2000 See Reverse for Instructions

U.S. Postal Service
CERTIFIED MAIL RECEIPT
(Domestic Mail Only; No Insurance Coverage Provided)

FAIRFIELD, CA 94533-9706

Postage	\$.37 ³⁷
Certified Fee	2.30 ³⁰
Return Receipt Fee (Endorsement Required)	1.75 ¹⁷⁵
Restricted Delivery Fee (Endorsement Required)	
Total Postage & Fees	\$ 4.42⁴²

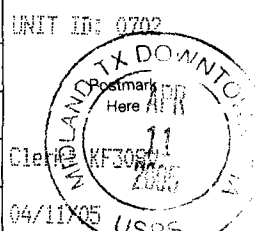

Recipient's Name (Please Print Clearly) (to be completed by mailer)
KATHERINE A. Johnson-Barger
Street, Apt. No., or PO Box No.
866 Emerald Hills Cir
City, State, ZIP+4
Fairfield, CA 94533-9706
PS Form 3800, February 2000 See Reverse for Instructions

U.S. Postal Service
CERTIFIED MAIL RECEIPT
(Domestic Mail Only; No Insurance Coverage Provided)

ROSWELL, NM 88202

Postage	\$.37 ³⁷
Certified Fee	2.30 ³⁰
Return Receipt Fee (Endorsement Required)	1.75 ¹⁷⁵
Restricted Delivery Fee (Endorsement Required)	
Total Postage & Fees	\$ 4.42⁴²

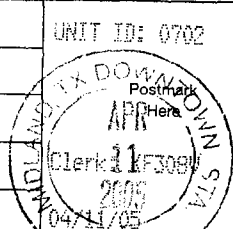

Recipient's Name (Please Print Clearly) (to be completed by mailer)
ML BOLING DEVELOPMENT LLC
Street, Apt. No., or PO Box No.
Box 1514
City, State, ZIP+4
ROSWELL, NM 88202
PS Form 3800, February 2000 See Reverse for Instructions

U.S. Postal Service
CERTIFIED MAIL RECEIPT
(Domestic Mail Only; No Insurance Coverage Provided)

MIDLAND, TX 79702-7666

Postage	\$.37 ³⁷
Certified Fee	2.30 ³⁰
Return Receipt Fee (Endorsement Required)	1.75 ¹⁷⁵
Restricted Delivery Fee (Endorsement Required)	
Total Postage & Fees	\$ 4.42⁴²

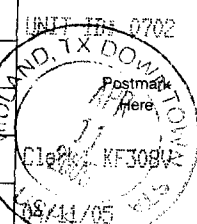

Recipient's Name (Please Print Clearly) (to be completed by mailer)
James E. Stace
Street, Apt. No., or PO Box No.
Box 10666
City, State, ZIP+4
Midland, TX 79702-7666
PS Form 3800, February 2000 See Reverse for Instructions

U.S. Postal Service
CERTIFIED MAIL RECEIPT
 (Domestic Mail Only; No Insurance Coverage Provided)

MIDLAND, TX 79704-5334

Postage	\$.39.37
Certified Fee	2.30.30
Return Receipt Fee (Endorsement Required)	1.75.75
Restricted Delivery Fee (Endorsement Required)	
Total Postage & Fees	\$ 4.42.42

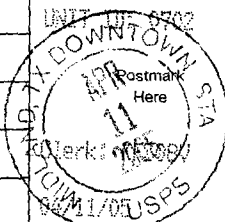

Recipient's Name (Please Print Clearly) (to be completed by mailer)
MAYHILL OIL CORPORATION
 Street, Apt. No., or PO Box No.
Box 5334
 City, State, ZIP+4
MIDLAND, TX 79704-5334

PS Form 3800, February 2000

See Reverse for Instructions

U.S. Postal Service
CERTIFIED MAIL RECEIPT
 (Domestic Mail Only; No Insurance Coverage Provided)

OAKLEY, KS 67748-1839

Postage	\$.39.37
Certified Fee	2.30.30
Return Receipt Fee (Endorsement Required)	1.75.75
Restricted Delivery Fee (Endorsement Required)	
Total Postage & Fees	\$ 4.42.42

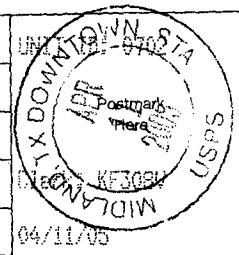

Recipient's Name (Please Print Clearly) (to be completed by mailer)
ROY LEE BOSSERMAN
 Street, Apt. No., or PO Box No.
317 Smokyhill Ave.
 City, State, ZIP+4
OAKLEY, KS 67748-1839

PS Form 3800, February 2000

See Reverse for Instructions

U.S. Postal Service
CERTIFIED MAIL RECEIPT
 (Domestic Mail Only; No Insurance Coverage Provided)

MIDLAND, TX 79704-5441

Postage	\$.39.37
Certified Fee	2.30.30
Return Receipt Fee (Endorsement Required)	1.75.75
Restricted Delivery Fee (Endorsement Required)	
Total Postage & Fees	\$ 4.42.42

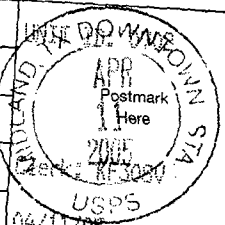

Recipient's Name (Please Print Clearly) (to be completed by mailer)
John Pool
 Street, Apt. No., or PO Box No.
Box 5441
 City, State, ZIP+4
MIDLAND, TX 79704-5441

PS Form 3800, February 2000

See Reverse for Instructions

U.S. Postal Service
CERTIFIED MAIL RECEIPT
 (Domestic Mail Only; No Insurance Coverage Provided)

MIDLAND, TX 79707-4723

Postage	\$.39.37
Certified Fee	2.30.30
Return Receipt Fee (Endorsement Required)	1.75.75
Restricted Delivery Fee (Endorsement Required)	
Total Postage & Fees	\$ 4.42.42

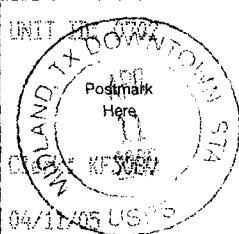

Recipient's Name (Please Print Clearly) (to be completed by mailer)
TAY-MOR ENTERPRISES, INC.
 Street, Apt. No., or PO Box No.
Box 4723
 City, State, ZIP+4
MIDLAND, TX 79707-4723

PS Form 3800, February 2000

See Reverse for Instructions

U.S. Postal Service
CERTIFIED MAIL RECEIPT
 (Domestic Mail Only; No Insurance Coverage Provided)

KERMIT, TX 79745

Postage	\$.39.37
Certified Fee	2.30.30
Return Receipt Fee (Endorsement Required)	1.75.75
Restricted Delivery Fee (Endorsement Required)	
Total Postage & Fees	\$ 4.42.42

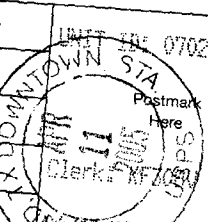

Recipient's Name (Please Print Clearly) (to be completed by mailer)
MARILYN SMITH
 Street, Apt. No., or PO Box No.
Box 481
 City, State, ZIP+4
KERMIT, TX 79745

PS Form 3800, February 2000

See Reverse for Instructions

U.S. Postal Service
CERTIFIED MAIL RECEIPT
 (Domestic Mail Only; No Insurance Coverage Provided)

OAKLEY, KS 67748-1352

Postage	\$.39.37
Certified Fee	2.30.30
Return Receipt Fee (Endorsement Required)	1.75.75
Restricted Delivery Fee (Endorsement Required)	
Total Postage & Fees	\$ 4.42.42

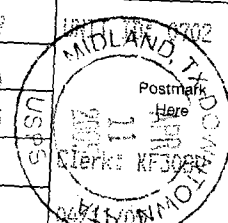

Recipient's Name (Please Print Clearly) (to be completed by mailer)
Donald John Bosserman
 Street, Apt. No., or PO Box No.
710 Wisk Ave.
 City, State, ZIP+4
OAKLEY, KS 67748-1352

PS Form 3800, February 2000

See Reverse for Instructions

7099 3400 0016 0187 4489

U.S. Postal Service CERTIFIED MAIL RECEIPT

(Domestic Mail Only; No Insurance Coverage Provided)

ARLESIA, NM 88211-0304

Postage \$.37.37

Certified Fee 2.30.30

Return Receipt Fee (Endorsement Required) 1.75.75

Restricted Delivery Fee (Endorsement Required)

Total Postage & Fees \$4.42.42

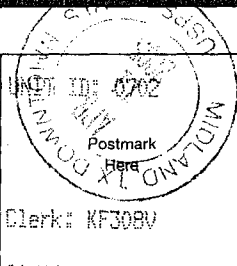

Recipient's Name (Please Print Clearly) (to be completed by mailer)

Pitch Energy Corp.

Street, Apt. No., or PO Box No.

Box 304

City, State, ZIP+4

Arlesia, NM 88211-0304

PS Form 3800, February 2000

See Reverse for Instructions

7099 3400 0016 0187 4502

U.S. Postal Service CERTIFIED MAIL RECEIPT

(Domestic Mail Only; No Insurance Coverage Provided)

HOBBS, NM 88240

Postage \$.37.37

Certified Fee 2.30.30

Return Receipt Fee (Endorsement Required) 1.75.75

Restricted Delivery Fee (Endorsement Required)

Total Postage & Fees \$4.42.42

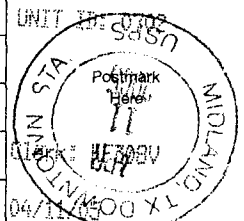

Recipient's Name (Please Print Clearly) (to be completed by mailer)

WARREN F. REYNOLDS

Street, Apt. No., or PO Box No.

1825 N. Rojo

City, State, ZIP+4

Hobbs, NM 88240

PS Form 3800, February 2000

See Reverse for Instructions

7099 3400 0016 0187 4458

U.S. Postal Service CERTIFIED MAIL RECEIPT

(Domestic Mail Only; No Insurance Coverage Provided)

MERMENTAU, LA 70556-0277

Postage \$.37.37

Certified Fee 2.30.30

Return Receipt Fee (Endorsement Required) 1.75.75

Restricted Delivery Fee (Endorsement Required)

Total Postage & Fees \$4.42.42

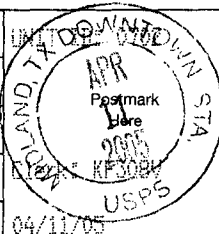

Recipient's Name (Please Print Clearly) (to be completed by mailer)

RAY SHUMAN

Street, Apt. No., or PO Box No.

Box 277

City, State, ZIP+4

MERMENTAU, LA 70556-0277

PS Form 3800, February 2000

See Reverse for Instructions

7099 3400 0016 0187 4434

U.S. Postal Service CERTIFIED MAIL RECEIPT

(Domestic Mail Only; No Insurance Coverage Provided)

LAS VEGAS, NM 87701

Postage \$.37.37

Certified Fee 2.30.30

Return Receipt Fee (Endorsement Required) 1.75.75

Restricted Delivery Fee (Endorsement Required)

Total Postage & Fees \$4.42.42

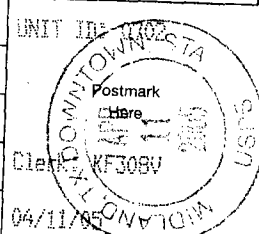

Recipient's Name (Please Print Clearly) (to be completed by mailer)

W. Gilbert Bryan

Street, Apt. No., or PO Box No.

720 Mills #19

City, State, ZIP+4

LAS VEGAS, NM 87701

PS Form 3800, February 2000

See Reverse for Instructions

7099 3400 0016 0187 4410

U.S. Postal Service CERTIFIED MAIL RECEIPT

(Domestic Mail Only; No Insurance Coverage Provided)

CARLSBAD, NM 88220-1166

Postage \$.37.37

Certified Fee 2.30.30

Return Receipt Fee (Endorsement Required) 1.75.75

Restricted Delivery Fee (Endorsement Required)

Total Postage & Fees \$4.42.42

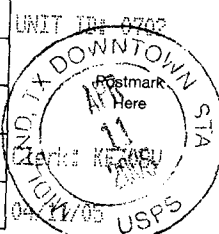

Recipient's Name (Please Print Clearly) (to be completed by mailer)

MERCHANT LIVESTOCK

Street, Apt. No., or PO Box No.

Box 1166

City, State, ZIP+4

CARLSBAD, NM 88220-1166

PS Form 3800, February 2000

See Reverse for Instructions

7099 3400 0016 0187 4427

U.S. Postal Service CERTIFIED MAIL RECEIPT

(Domestic Mail Only; No Insurance Coverage Provided)

KERMIT, TX 79745-0863

Postage \$.37.37

Certified Fee 2.30.30

Return Receipt Fee (Endorsement Required) 1.75.75

Restricted Delivery Fee (Endorsement Required)

Total Postage & Fees \$4.42.42

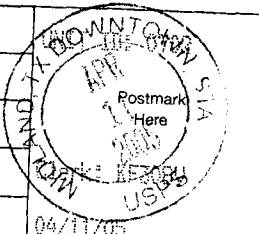

Recipient's Name (Please Print Clearly) (to be completed by mailer)

MARKS + Smith Partnership

Street, Apt. No., or PO Box No.

Box 863

City, State, ZIP+4

KERMIT, TX 79745-0863

PS Form 3800, February 2000

See Reverse for Instructions

U.S. Postal Service
CERTIFIED MAIL RECEIPT
(Domestic Mail Only; No Insurance Coverage Provided)

TULSA, OK 74152-0553

Postage	\$.37.37
Certified Fee	2.30.30
Return Receipt Fee (Endorsement Required)	1.75.75
Restricted Delivery Fee (Endorsement Required)	
Total Postage & Fees	\$ 4.42.42

UNIT ID: 0702



Recipient's Name (Please Print Clearly) (to be completed by mailer)

DENNA MIZ Ind + Ex / SAM MIZ Est.
Street, Apt. No., or PO Box No.
Box 52553

TULSA, OK 74152-0553
City, State, ZIP+4

PS Form 3800, February 2000

See Reverse for Instructions

U.S. Postal Service
CERTIFIED MAIL RECEIPT
(Domestic Mail Only; No Insurance Coverage Provided)

BARTLESVILLE, OK 74005

Postage	\$.37.37
Certified Fee	2.30.30
Return Receipt Fee (Endorsement Required)	1.75.75
Restricted Delivery Fee (Endorsement Required)	
Total Postage & Fees	\$ 4.42.42

UNIT ID: 0702



Recipient's Name (Please Print Clearly) (to be completed by mailer)

CONCEAL PHILLIPS Company
Street, Apt. No., or PO Box No.
Box 7500

BARTLESVILLE, OK 74005
City, State, ZIP+4

PS Form 3800, February 2000

See Reverse for Instructions

U.S. Postal Service
CERTIFIED MAIL RECEIPT
(Domestic Mail Only; No Insurance Coverage Provided)

MCALLEN, TX 78504-1148

Postage	\$.37.37
Certified Fee	2.30.30
Return Receipt Fee (Endorsement Required)	1.75.75
Restricted Delivery Fee (Endorsement Required)	
Total Postage & Fees	\$ 4.42.42

UNIT ID: 0702



Recipient's Name (Please Print Clearly) (to be completed by mailer)

Commissioner of Public Lands
Street, Apt. No., or PO Box No.
Box 1148

SANTA FE, NM 87504-1148
City, State, ZIP+4

PS Form 3800, February 2000

See Reverse for Instructions

U.S. Postal Service
CERTIFIED MAIL RECEIPT
(Domestic Mail Only; No Insurance Coverage Provided)

TULSA, OK 74170-1828

Postage	\$.37.37
Certified Fee	2.30.30
Return Receipt Fee (Endorsement Required)	1.75.75
Restricted Delivery Fee (Endorsement Required)	
Total Postage & Fees	\$ 4.42.42

UNIT ID: 0702



Recipient's Name (Please Print Clearly) (to be completed by mailer)

PROVIDENCE OIL & GAS Corp.
Street, Apt. No., or PO Box No.
Box 701828

TULSA, OK 74170-1828
City, State, ZIP+4

PS Form 3800, February 2000

See Reverse for Instructions

U.S. Postal Service
CERTIFIED MAIL RECEIPT
(Domestic Mail Only; No Insurance Coverage Provided)

OKLAHOMA CITY, OK 73118

Postage	\$.37.37
Certified Fee	2.30.30
Return Receipt Fee (Endorsement Required)	1.75.75
Restricted Delivery Fee (Endorsement Required)	
Total Postage & Fees	\$ 4.42.42

UNIT ID: 0702

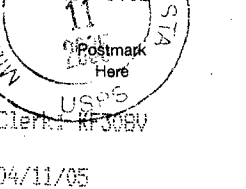

Recipient's Name (Please Print Clearly) (to be completed by mailer)

MELROSE ENERGY CO. ATTN: MICHAEL CORJAY
Street, Apt. No., or PO Box No.
5813 NW BRAND BLVD, STE B

OKLAHOMA CITY, OK 73118
City, State, ZIP+4

PS Form 3800, February 2000

See Reverse for Instructions

U.S. Postal Service
CERTIFIED MAIL RECEIPT
(Domestic Mail Only; No Insurance Coverage Provided)

MIDLAND, TX 79710-0820

Postage	\$.37.37
Certified Fee	2.30.30
Return Receipt Fee (Endorsement Required)	1.75.75
Restricted Delivery Fee (Endorsement Required)	
Total Postage & Fees	\$ 4.42.42

UNIT ID: 0702



Recipient's Name (Please Print Clearly) (to be completed by mailer)

BLACK FAMILY PARTNERSHIP
Street, Apt. No., or PO Box No.
Box 50820

MIDLAND, TX 79710-0820
City, State, ZIP+4

PS Form 3800, February 2000

See Reverse for Instructions

U.S. Postal Service
CERTIFIED MAIL RECEIPT
(Domestic Mail Only; No Insurance Coverage Provided)

READING, PA 19612-4811

Postage	\$.37.37
Certified Fee	2.30.30
Return Receipt Fee (Endorsement Required)	1.75.75
Restricted Delivery Fee (Endorsement Required)	
Total Postage & Fees	\$ 4.42.42

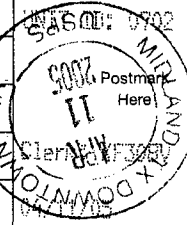

Recipient's Name (Please Print Clearly) (to be completed by mailer)

SA - SAN FA PUTNAM

Street, Apt. No., or PO Box No.

Box 14811

City, State, ZIP+4

Reading, PA 19612-4811

PS Form 3800, February 2000

See Reverse for Instructions

U.S. Postal Service
CERTIFIED MAIL RECEIPT
(Domestic Mail Only; No Insurance Coverage Provided)

KERMIT, TX 79745-0613

Postage	\$.37.37
Certified Fee	2.30.30
Return Receipt Fee (Endorsement Required)	1.75.75
Restricted Delivery Fee (Endorsement Required)	
Total Postage & Fees	\$ 4.42.42

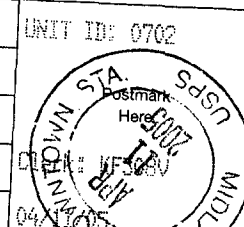

Recipient's Name (Please Print Clearly) (to be completed by mailer)

MAYO MARKS

Street, Apt. No., or PO Box No.

Box 613

City, State, ZIP+4

Kermit, TX 79745-0613

PS Form 3800, February 2000

See Reverse for Instructions

U.S. Postal Service
CERTIFIED MAIL RECEIPT
(Domestic Mail Only; No Insurance Coverage Provided)

HOUSTON, TX 77014

Postage	\$.37.37
Certified Fee	2.30.30
Return Receipt Fee (Endorsement Required)	1.75.75
Restricted Delivery Fee (Endorsement Required)	
Total Postage & Fees	\$ 4.42.42

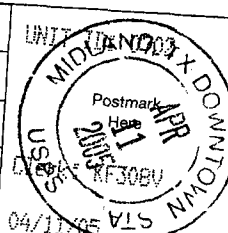

Recipient's Name (Please Print Clearly) (to be completed by mailer)

Wadi Petroleum, Inc.

Street, Apt. No., or PO Box No.

14405 WALTERS Rd., Ste. 400

City, State, ZIP+4

Houston, TX 77014

PS Form 3800, February 2000

See Reverse for Instructions